



US00RE45430E

(19) **United States**
(12) **Reissued Patent**
Gorman

(10) **Patent Number:** **US RE45,430 E**
(45) **Date of Reissued Patent:** ***Mar. 24, 2015**

(54) **UNIVERSAL ELECTRICAL WIRING COMPONENT**

(71) Applicant: **ProtectConnect, Inc.**, Oceanside, CA (US)

(72) Inventor: **Michael P. Gorman**, Laguna Niguel, CA (US)

(73) Assignee: **ProtectConnect**, Oceanside, CA (US)

(*) Notice: This patent is subject to a terminal disclaimer.

(21) Appl. No.: **14/050,794**

(22) Filed: **Oct. 10, 2013**

Related U.S. Patent Documents

Reissue of:

(64) Patent No.: **7,572,977**
Issued: **Aug. 11, 2009**
Appl. No.: **11/782,082**
Filed: **Jul. 24, 2007**

U.S. Applications:

(63) Continuation of application No. 13/208,260, filed on Aug. 11, 2011, now Pat. No. Re. 44,546, which is an application for the reissue of Pat. No. 7,572,977, which is

(Continued)

(51) **Int. Cl.**
H01H 9/02 (2006.01)

(52) **U.S. Cl.**
USPC **174/58**; 174/60; 174/480; 248/906; 220/3.8

(58) **Field of Classification Search**
USPC 174/50, 58, 60, 63; 248/906, 298.1, 248/219.1; 220/3.7, 3.8; 439/535-537, 107, 439/652; 29/729

See application file for complete search history.

(56) **References Cited**

U.S. PATENT DOCUMENTS

723,866 A 3/1903 Hart
776,855 A 12/1904 La Har
949,123 A 2/1910 Klein

(Continued)

FOREIGN PATENT DOCUMENTS

CN 2381040 Y 5/2000
GB 1 420 748 1/1976
GB 2 341 733 A 3/2000

OTHER PUBLICATIONS

U.S. Appl. No. 10/685,294, filed Oct. 14, 2003, Gorman, Michael.

(Continued)

Primary Examiner — Dhirubhai R Patel

(74) *Attorney, Agent, or Firm* — Knobbe, Martens, Olson & Bear, LLP

(57) **ABSTRACT**

A modular electrical wiring component [comprises] *includes* a wiring module having a wiring portion for coupling to a source of electrical power and a user-accessible portion configured to accept and provide electrical power to a functional module that provides a selected electrical distribution function, wherein the wiring module is configured to accept the functional module without access to the wiring portion. The modular electrical wiring component also [comprises] *includes* an adjustable plaster ring configured to couple to the wiring module and to an electrical junction box, wherein the adjustable plaster ring provides a variable distance between the electrical junction box and the wiring module.

14 Claims, 14 Drawing Sheets

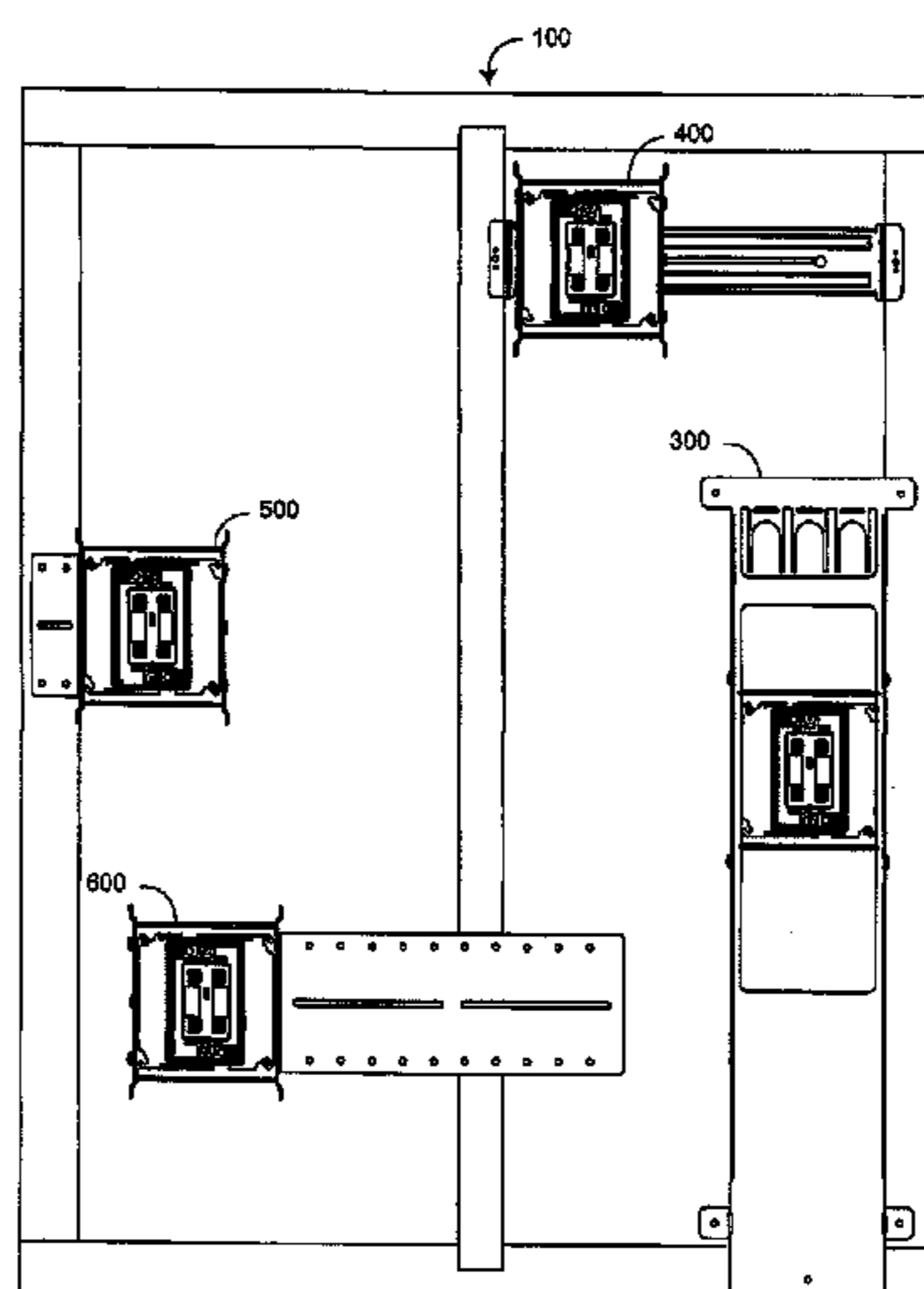

Related U.S. Application Data

continuation of application No. 10/924,555, filed on Aug. 24, 2004, now Pat. No. 7,312,396.

(60) Provisional application No. 60/552,546, filed on Mar. 13, 2004.

(56) **References Cited**

U.S. PATENT DOCUMENTS

1,171,914 A	2/1916	Wright	4,679,123 A	7/1987	Young
1,328,224 A	1/1920	Benjamin	4,722,693 A	2/1988	Rose
1,758,126 A	5/1930	Peterson	4,747,506 A	5/1988	Stuchlik, III
1,938,309 A	12/1930	Williams	4,750,890 A	6/1988	Dube et al.
1,923,893 A	8/1933	Smith	4,780,088 A	10/1988	Means
1,935,565 A	11/1933	Goetzelman	4,784,614 A	11/1988	Sadigh-Behzadi
1,956,196 A	4/1934	Korab	4,798,916 A	1/1989	Engel et al.
2,140,376 A	12/1938	Anderson	4,808,127 A	2/1989	Swanic
2,163,201 A	6/1939	Kalencik	4,842,551 A	6/1989	Heimann
2,189,251 A	2/1940	Potter	4,871,893 A	10/1989	Slovak et al.
2,397,688 A	4/1946	Osinski	4,873,469 A	10/1989	Young et al.
2,433,917 A	1/1948	McCartney	4,880,950 A	11/1989	Carson et al.
2,447,597 A	8/1948	Reed	4,907,711 A	3/1990	Stuchlik, III
2,477,803 A	8/1949	Huber	4,914,265 A	4/1990	Mongeau
2,524,701 A	10/1950	Grill	D308,045 S	5/1990	Counts et al.
2,908,743 A	10/1959	Premoshis	4,952,164 A	8/1990	Weber et al.
2,969,518 A	1/1961	Slater	D310,814 S	9/1990	Rosenbaum
3,087,984 A	4/1963	Myer	4,967,990 A	11/1990	Rinderer
3,156,761 A	11/1964	Schinske	4,972,045 A	11/1990	Primeau
3,189,077 A	6/1965	Willis, Jr. et al.	4,988,840 A	1/1991	Carson et al.
3,214,726 A	10/1965	Cardenas et al.	4,998,343 A	3/1991	Costello
3,317,881 A	5/1967	Setecka	5,002,501 A	3/1991	Tucker
3,467,941 A	9/1969	Martin	5,003,128 A	3/1991	Grondin
3,489,985 A	1/1970	Martin	D316,250 S	4/1991	Mongeau
3,510,822 A	5/1970	Patterson	5,004,432 A	4/1991	Tucker
3,588,786 A	6/1971	Alfiero	5,012,043 A *	4/1991	Seymour 174/57
3,609,647 A	9/1971	Castellano	5,030,119 A	7/1991	Lowe
3,654,663 A	4/1972	Algotsson	5,042,673 A	8/1991	McShane
3,710,287 A	1/1973	Eckert	5,092,787 A	3/1992	Wise et al.
3,716,651 A	2/1973	Werner	5,098,046 A	3/1992	Webb
3,732,524 A	5/1973	Reed et al.	5,178,555 A	1/1993	Kilpatrick et al.
3,868,161 A	2/1975	Frantz	5,209,444 A	5/1993	Rinderer
3,879,101 A	4/1975	McKissic	5,245,507 A	9/1993	Ericksen
3,930,704 A	1/1976	Dekanic	D341,125 S	11/1993	Miller
3,972,498 A	8/1976	Paskert	5,285,014 A	2/1994	Gilchrist
3,989,338 A	11/1976	Gosser	5,288,041 A	2/1994	Webb
4,103,125 A	7/1978	Marrero	5,289,934 A	3/1994	Smith et al.
4,105,884 A	8/1978	Damsky	5,293,097 A	3/1994	Elwell
4,117,258 A	9/1978	Shanker	5,297,973 A	3/1994	Gorman
4,148,536 A	4/1979	Petropoulos et al.	5,330,137 A	7/1994	Oliva
4,165,443 A	8/1979	Figart et al.	5,342,993 A	8/1994	Siems
4,166,934 A	9/1979	Marrero	5,386,959 A	2/1995	Laughlin et al.
4,179,175 A	12/1979	Farnworth et al.	5,397,929 A	3/1995	Hogarth et al.
4,196,521 A	4/1980	Hutchinson et al.	5,399,806 A	3/1995	Olson
4,230,386 A	10/1980	Farnworth et al.	5,415,564 A	5/1995	Winter et al.
4,263,472 A	4/1981	Maheu	5,448,011 A	9/1995	Laughlin
4,295,018 A	10/1981	Borrelli	5,466,164 A	11/1995	Miyazaki et al.
4,343,411 A	8/1982	Chesnut et al.	5,486,121 A	1/1996	Miller
4,372,634 A	2/1983	Ritchie et al.	5,488,121 A	1/1996	O'Lenick, Jr.
4,403,824 A	9/1983	Scott	5,500,487 A	3/1996	Leon
4,427,864 A	1/1984	Oster	5,503,565 A	4/1996	McCoy
4,445,739 A	5/1984	Wooten	5,516,068 A	5/1996	Rice
4,485,282 A	11/1984	Lee	5,525,755 A	6/1996	Christensen
4,493,517 A	1/1985	Hillary	5,533,917 A	7/1996	Schmitz
4,585,902 A	4/1986	Munroe	5,551,884 A	9/1996	Burkhart, Sr.
4,599,485 A	7/1986	Smolik	5,562,222 A	10/1996	Jordan
4,600,258 A	7/1986	Hu	5,562,952 A	10/1996	Nakahigashi et al.
4,605,270 A	8/1986	Aslizadeh	5,599,199 A	2/1997	Wright
4,607,906 A	8/1986	Munroe	5,608,196 A	3/1997	Hall et al.
4,612,412 A	9/1986	Johnston	5,611,701 A	3/1997	Hahn
4,617,613 A	10/1986	Rice	5,613,874 A	3/1997	Orlando et al.
4,626,052 A	12/1986	Rumble	5,625,531 A	4/1997	Padilla et al.
4,627,675 A	12/1986	Taylor et al.	5,639,991 A	6/1997	Schuette
4,634,015 A	1/1987	Taylor	D380,452 S	7/1997	Mix et al.
4,640,564 A	2/1987	Hill	D384,643 S	10/1997	Nierlich et al.
4,645,089 A	2/1987	Horsley	5,730,617 A	3/1998	Araki et al.
4,664,457 A	5/1987	Suchy	5,741,153 A	4/1998	Schwer
			5,773,757 A	6/1998	Kenney et al.
			5,775,935 A	7/1998	Barna
			5,785,551 A	7/1998	Libby
			5,786,551 A	7/1998	Thangavelu
			5,807,139 A	9/1998	Volansky et al.
			D399,495 S	10/1998	Bachschnid
			5,885,088 A	3/1999	Brennan et al.
			5,902,960 A	5/1999	Smith
			5,906,497 A	5/1999	Pham et al.
			5,924,888 A	7/1999	Larkin
			5,925,850 A	7/1999	Park
			5,931,325 A	8/1999	Filipov

(56)

References Cited

U.S. PATENT DOCUMENTS

D415,472 S 10/1999 Kelso et al.
 5,967,354 A 10/1999 Whitehead et al.
 5,980,279 A 11/1999 Muller
 5,998,747 A 12/1999 Kelso et al.
 6,029,581 A 2/2000 Daoud
 6,036,516 A 3/2000 Byrne
 D430,114 S 8/2000 Bachschmid et al.
 6,098,939 A 8/2000 He
 6,201,187 B1 3/2001 Burbine
 6,209,836 B1 4/2001 Swanson
 6,231,358 B1 5/2001 Kerr, Jr. et al.
 6,259,351 B1 7/2001 Radosavljevic et al.
 6,309,248 B1 10/2001 King
 6,311,229 B1 10/2001 Burchard et al.
 6,341,981 B1 1/2002 Gorman
 6,371,790 B1 4/2002 Huang
 6,392,140 B1 5/2002 Yee et al.
 D461,775 S 8/2002 Littrell et al.
 6,441,304 B1 8/2002 Currier et al.
 6,461,189 B1 10/2002 Koh
 6,465,735 B2 10/2002 May
 6,484,979 B1 11/2002 Medlin, Jr.
 6,485,336 B1 11/2002 Zebermann et al.
 6,492,591 B1 12/2002 Metcalf
 6,494,728 B1 12/2002 Gorman
 6,530,806 B2 3/2003 Nelson
 D472,883 S 4/2003 Harvey
 6,590,155 B2 7/2003 Vrame et al.
 6,617,511 B2 9/2003 Schultz
 6,623,296 B2 9/2003 Okamoto
 6,642,450 B1 11/2003 Hsiao
 6,648,678 B1 11/2003 Kaneko
 6,653,566 B2 11/2003 Petak et al.
 6,686,540 B2 2/2004 Compagnone, Jr.
 6,700,062 B1 3/2004 Allen, Jr.
 6,718,674 B2 4/2004 Caveney et al.
 6,730,845 B1 5/2004 Criniti et al.
 6,747,206 B1 6/2004 Law
 6,765,146 B1 7/2004 Gerardo
 6,767,245 B2 7/2004 King
 6,770,814 B2 8/2004 Shotey et al.
 6,774,307 B2 8/2004 Kruse et al.
 6,803,521 B2 10/2004 Vrame
 6,805,567 B2 10/2004 Chapman et al.
 6,817,873 B1 11/2004 Gorman
 6,820,760 B2 11/2004 Wegner et al.
 6,830,477 B2 12/2004 Vander Vorste et al.
 6,840,785 B2 1/2005 Drane
 6,843,680 B2 1/2005 Gorman
 6,850,159 B1 2/2005 Mudge
 6,863,561 B2 3/2005 Gorman
 6,867,370 B2 3/2005 Compagnone, Jr.
 6,870,099 B1 3/2005 Schultz et al.
 6,875,922 B1 4/2005 Petak et al.
 6,884,111 B2 4/2005 Gorman
 6,894,221 B2 5/2005 Gorman
 6,906,260 B2 6/2005 Grendahl
 6,908,334 B2 6/2005 Huang
 6,923,663 B2 8/2005 Oddsen et al.
 6,925,850 B2 8/2005 Comer et al.
 6,956,169 B1* 10/2005 Shotey et al. 174/58
 6,967,284 B1 11/2005 Gretz
 6,979,212 B1 12/2005 Gorman
 6,986,674 B1 1/2006 Gorman
 6,986,676 B1 1/2006 Tronolone et al.
 7,052,313 B2 5/2006 Gorman
 7,060,897 B2 6/2006 Gorman

7,071,414 B2 7/2006 Kim
 7,081,009 B2 7/2006 Gorman
 7,081,010 B2 7/2006 Gorman
 7,083,466 B1 8/2006 Hwang
 7,104,836 B1 9/2006 Gorman
 7,265,291 B1 9/2007 Gorman
 7,273,392 B2 9/2007 Fields
 7,312,396 B1 12/2007 Gorman
 7,321,120 B1 1/2008 Gorman et al.
 7,323,638 B1 1/2008 Radosavljevic et al.
 7,332,683 B2 2/2008 Gorman
 7,357,652 B1 4/2008 Arenas et al.
 7,361,051 B2 4/2008 Gorman
 7,367,121 B1 5/2008 Gorman
 7,390,965 B2 6/2008 Hartwig
 7,410,072 B2 8/2008 Wegner et al.
 7,442,874 B2 10/2008 Compagnone, Jr.
 7,468,486 B2 12/2008 Yan
 7,495,170 B2 2/2009 Dinh et al.
 7,544,941 B2 6/2009 Gorman et al.
 7,572,977 B2 8/2009 Gorman
 7,718,893 B2 5/2010 Purves et al.
 7,762,838 B2 7/2010 Gorman
 8,028,408 B2 10/2011 Gorman
 8,058,552 B2* 11/2011 Kruse et al. 174/53
 8,096,818 B2* 1/2012 Arenas et al. 439/107
 8,105,107 B2 1/2012 Gorman
 8,139,761 B2* 3/2012 Vo et al. 379/413.04
 8,388,371 B2 3/2013 Gorman
 2002/0055301 A1 5/2002 Gorman
 2002/0185296 A1 12/2002 Schultz et al.
 2003/0178218 A1 9/2003 Shotey et al.
 2003/0189043 A1 10/2003 Wegner et al.
 2003/0205654 A1 11/2003 Petak et al.
 2003/0213801 A1 11/2003 Bradley et al.
 2004/0048507 A1 3/2004 Hage
 2004/0129444 A1 7/2004 Adams et al.
 2005/0001123 A1 1/2005 Cheatham et al.
 2005/0067180 A1 3/2005 Dinh
 2005/0067546 A1 3/2005 Dinh
 2005/0176278 A1 8/2005 Cheatham et al.
 2005/0224249 A2 10/2005 Wegner et al.
 2005/0250378 A1 11/2005 Gorman
 2006/0021780 A1 2/2006 Hill
 2006/0065510 A1 3/2006 Kiko et al.
 2007/0072486 A1 3/2007 Gorman
 2007/0072487 A1 3/2007 Gorman
 2008/0053698 A1 3/2008 Purves et al.
 2010/0218969 A1 9/2010 Purves et al.
 2012/0021623 A1 1/2012 Gorman

OTHER PUBLICATIONS

U.S. Appl. No. 10/923,393, filed Dec. 17, 2001, Gorman, Michael.
 U.S. Appl. No. 10/988,742, filed Nov. 15, 2004, Gorman, Michael.
 U.S. Appl. No. 11/287,883, filed Nov. 26, 2005, Gorman, Michael.
 U.S. Appl. No. 11/287,885, filed Nov. 26, 2005, Gorman, Michael.
 U.S. Appl. No. 11/452,130, filed Jun. 12, 2006, Gorman, Michael.
 U.S. Appl. No. 11/519,447, filed Sep. 12, 2006, Gorman, Michael.
 U.S. Appl. No. 12/106,984, filed Apr. 21, 2008, Gorman, Michael.
 U.S. Appl. No. 12/115,419, filed May 5, 2008, Gorman, Michael.
 Cooper Industries, Inc.; Crouse-Hinds Division, Power-Lock Locking Device—Product Specification, 1996, pp. B6. B55, Syracuse, NY.
 U.S. Appl. No. 60/174,521, filed Jan. 5, 2000, Gorman, Michael.
 U.S. Appl. No. 60/176,123, filed Jan. 14, 2000, Gorman, Michael.
 U.S. Appl. No. 90/011,258, filed Jan. 12, 2011, Gorman, Michael.
 U.S. Appl. No. 90/011,275, filed Oct. 8, 2010, Gorman, Michael.

* cited by examiner

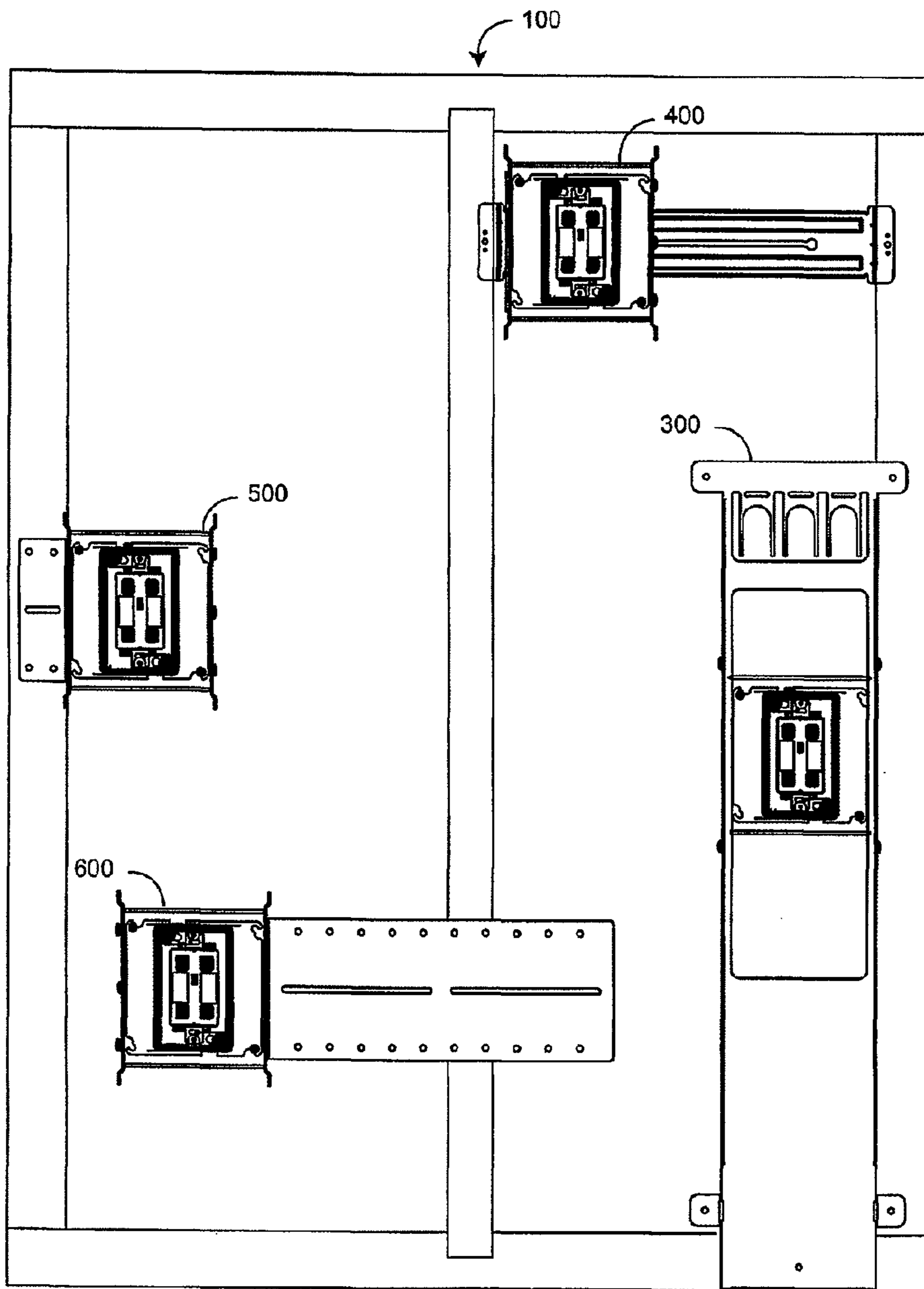

FIG. 1

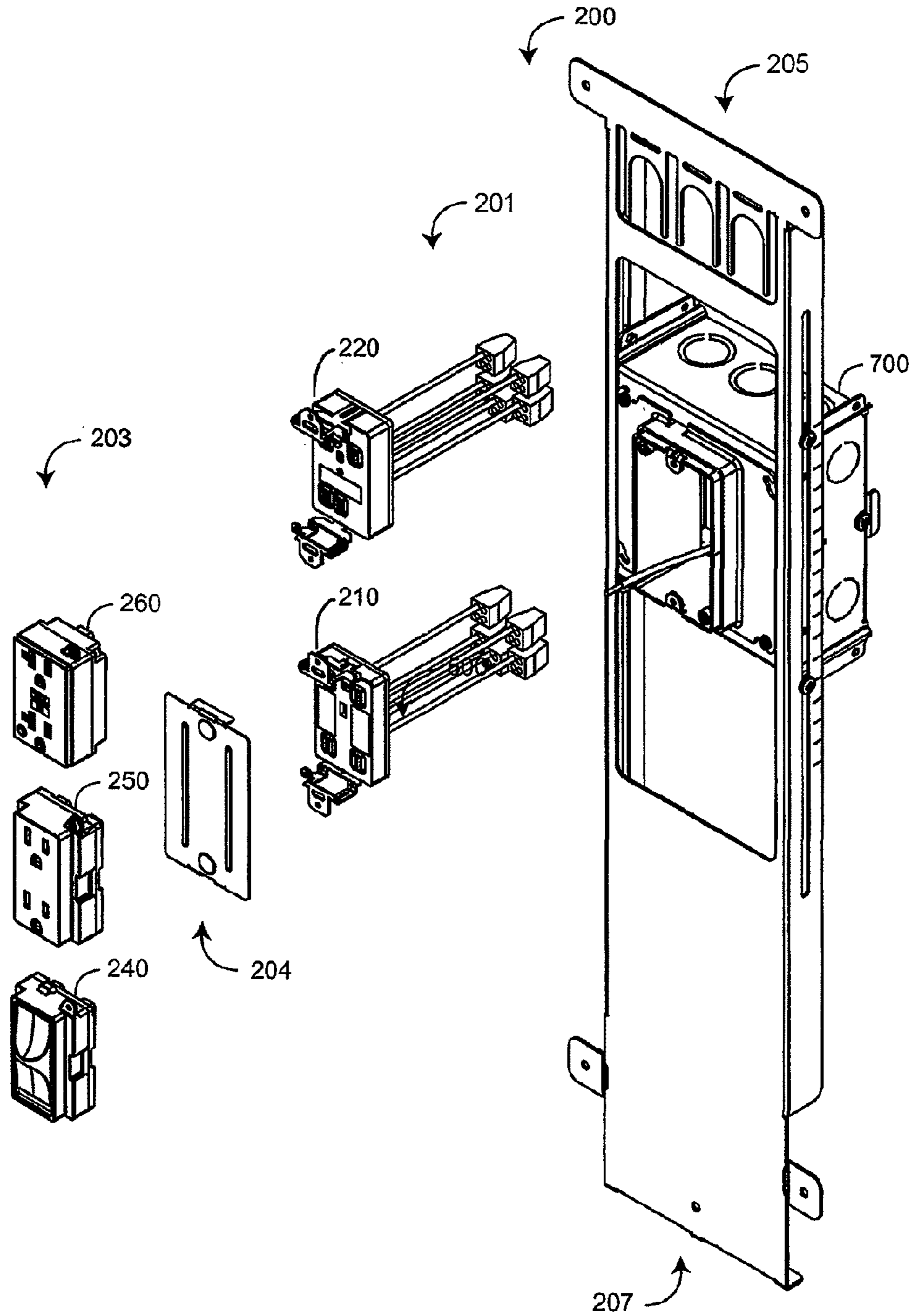

FIG. 2

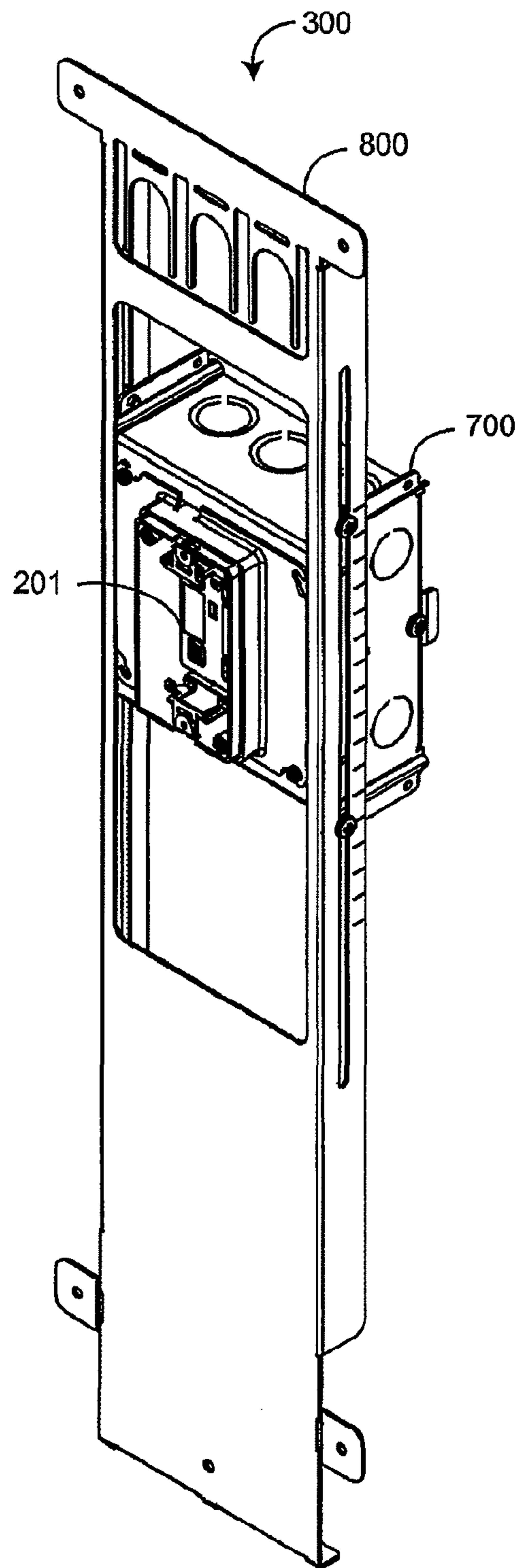
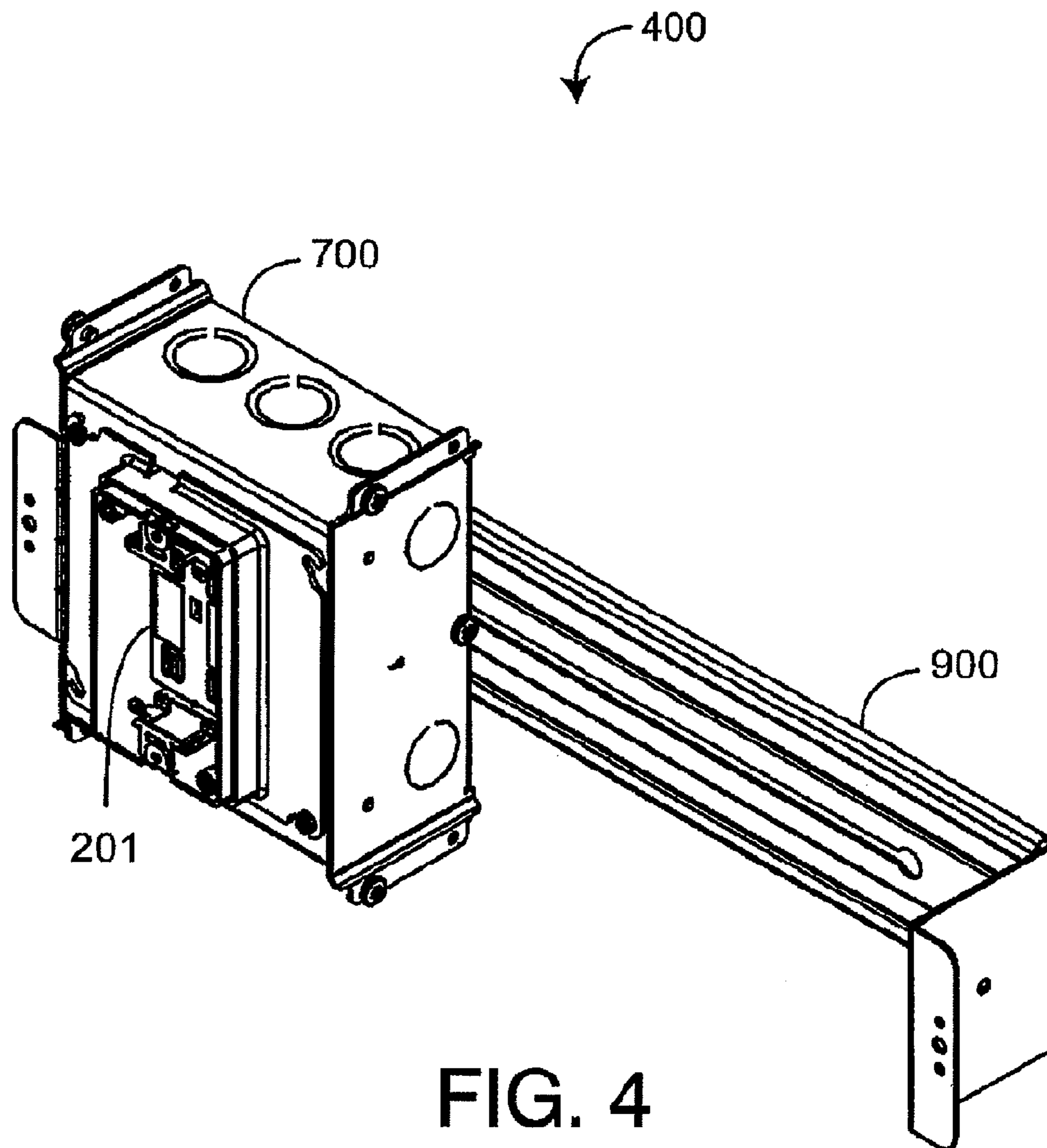

FIG. 3



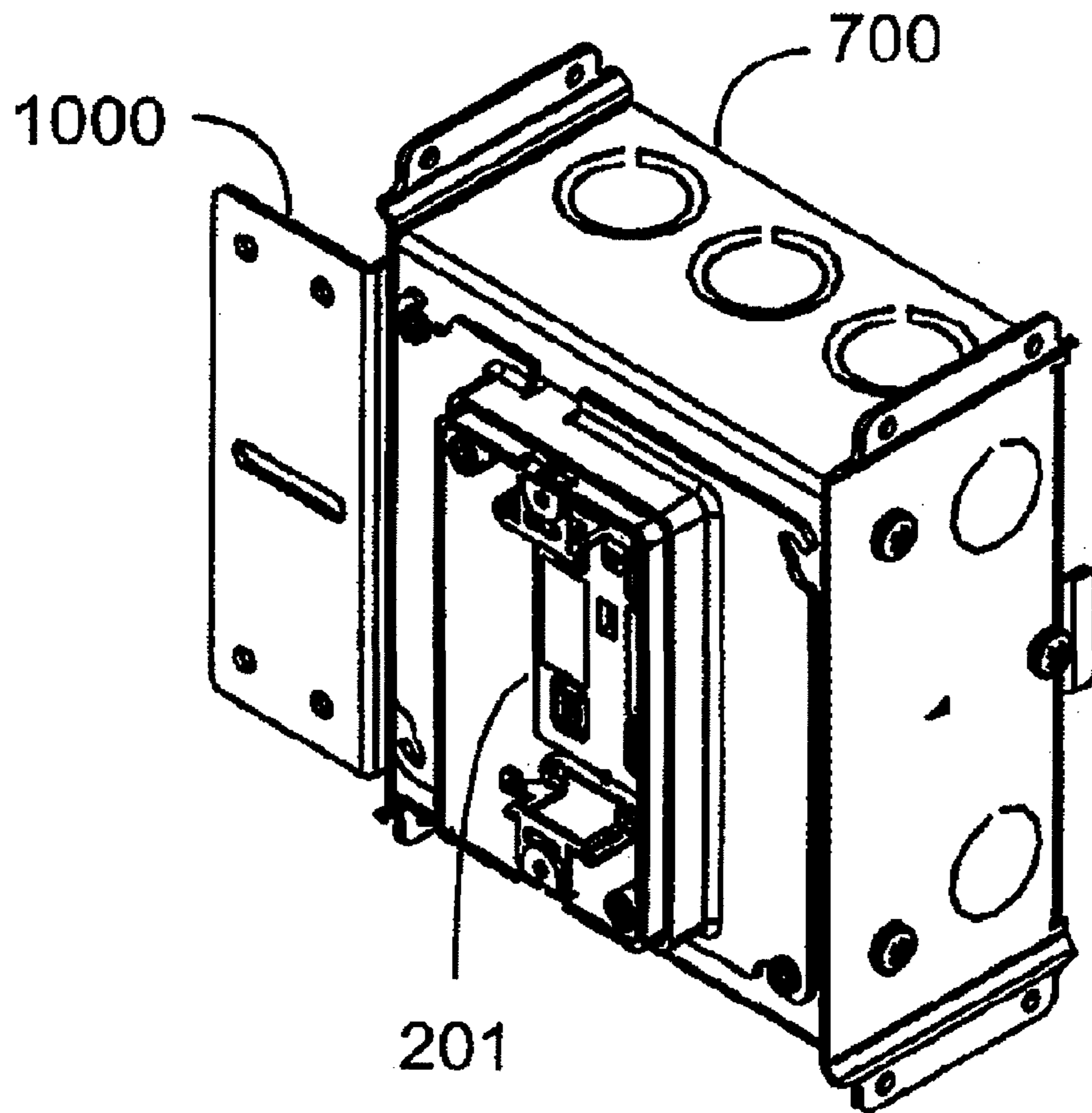

FIG. 5

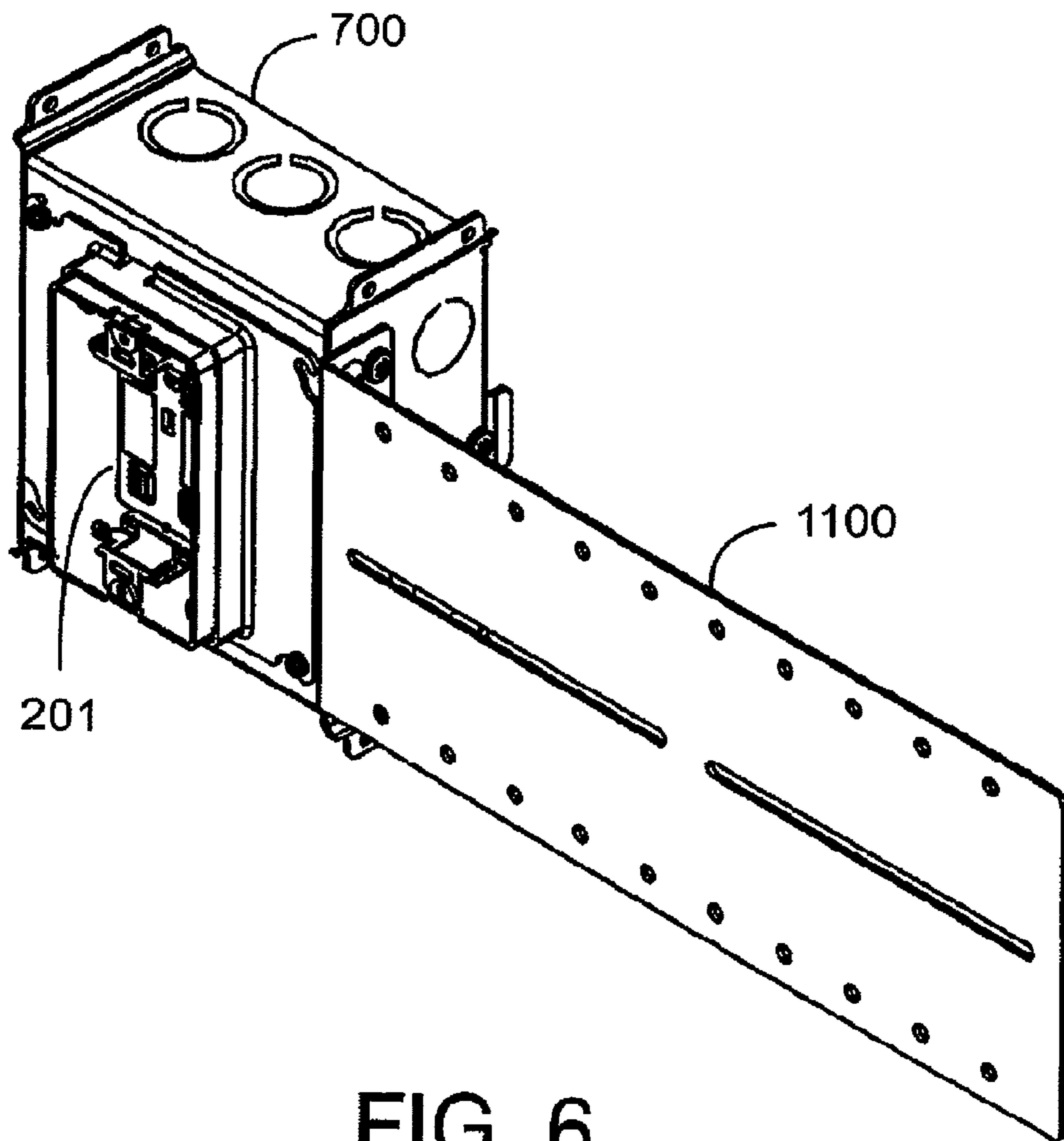

FIG. 6

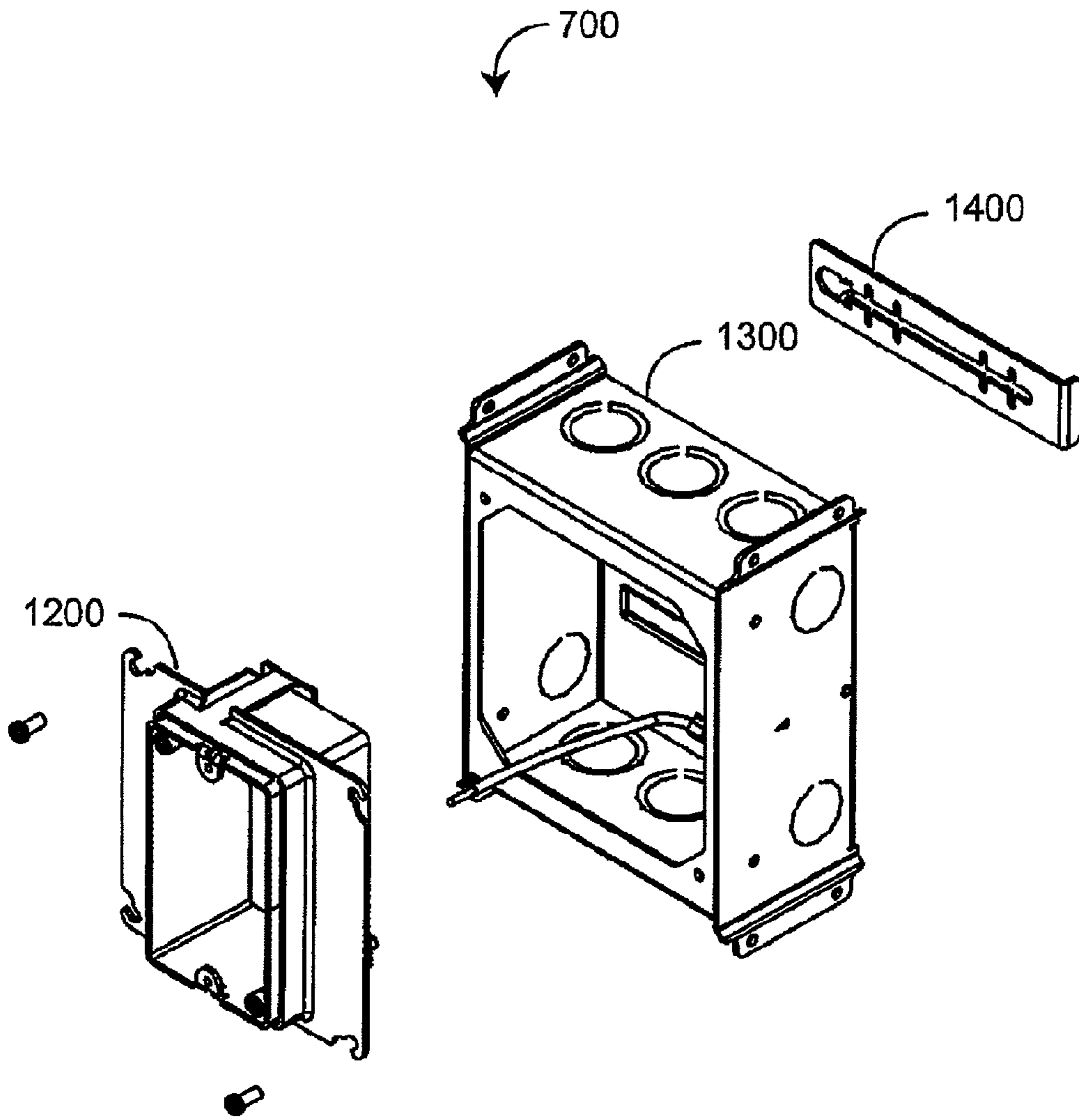

FIG. 7

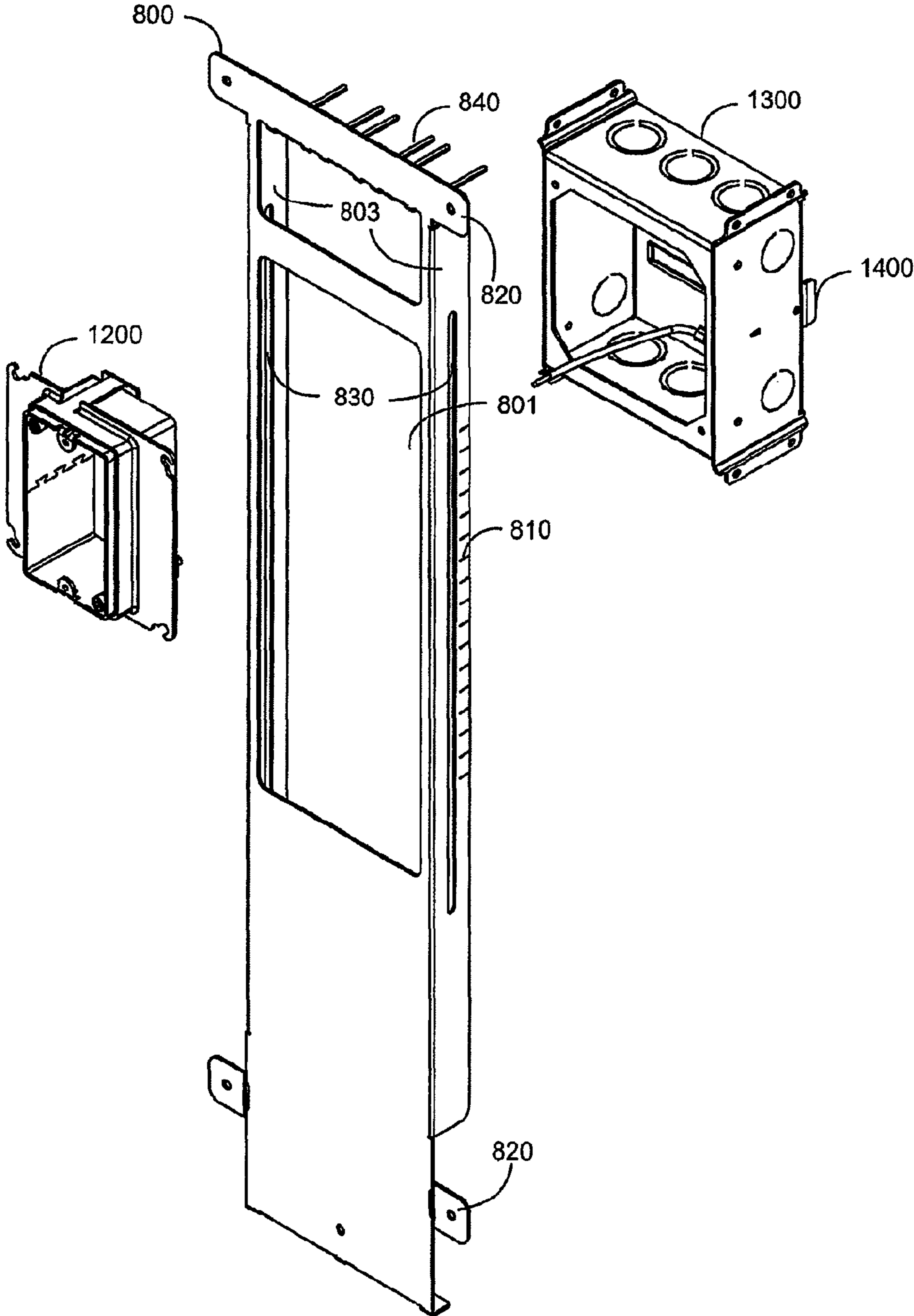

FIG. 8

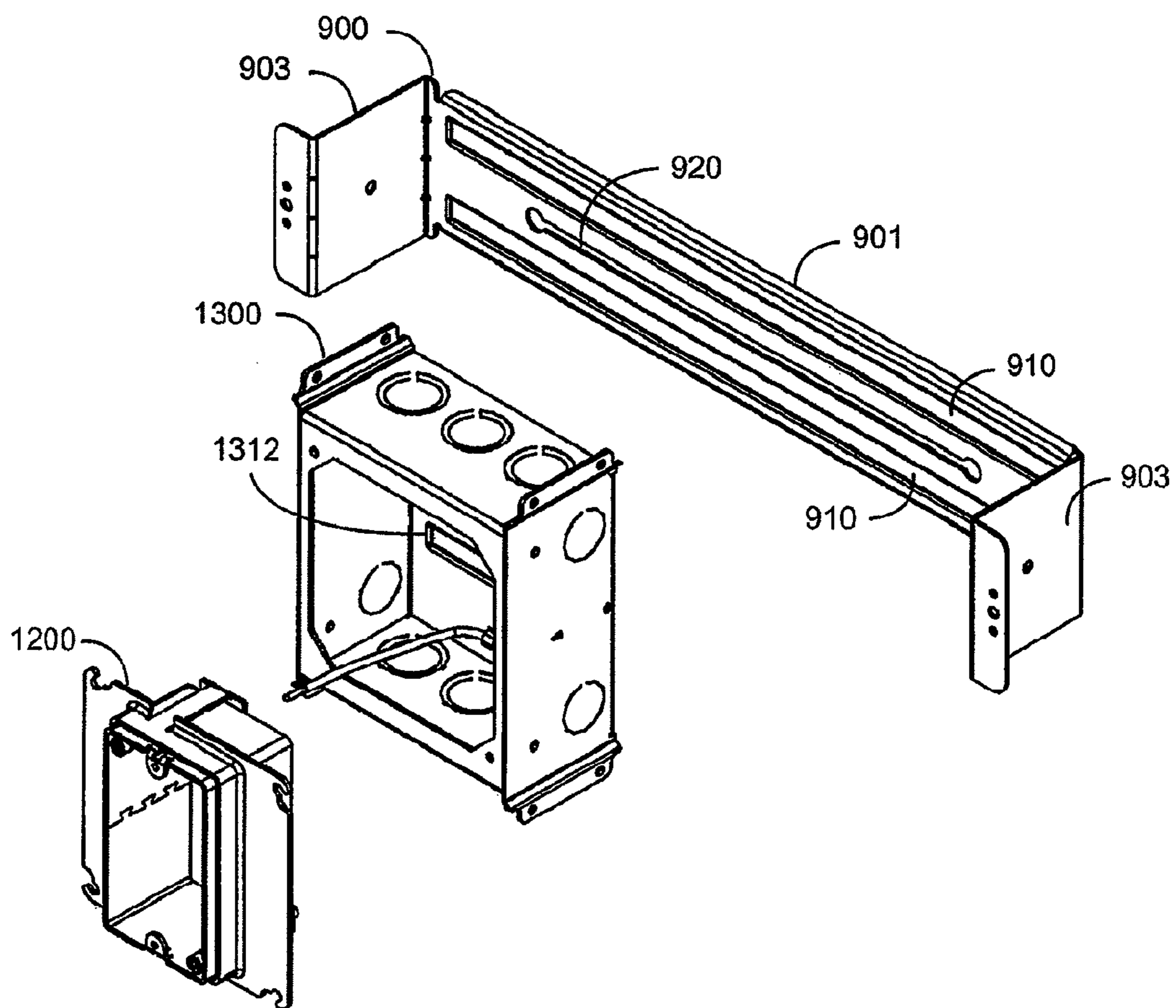

FIG. 9

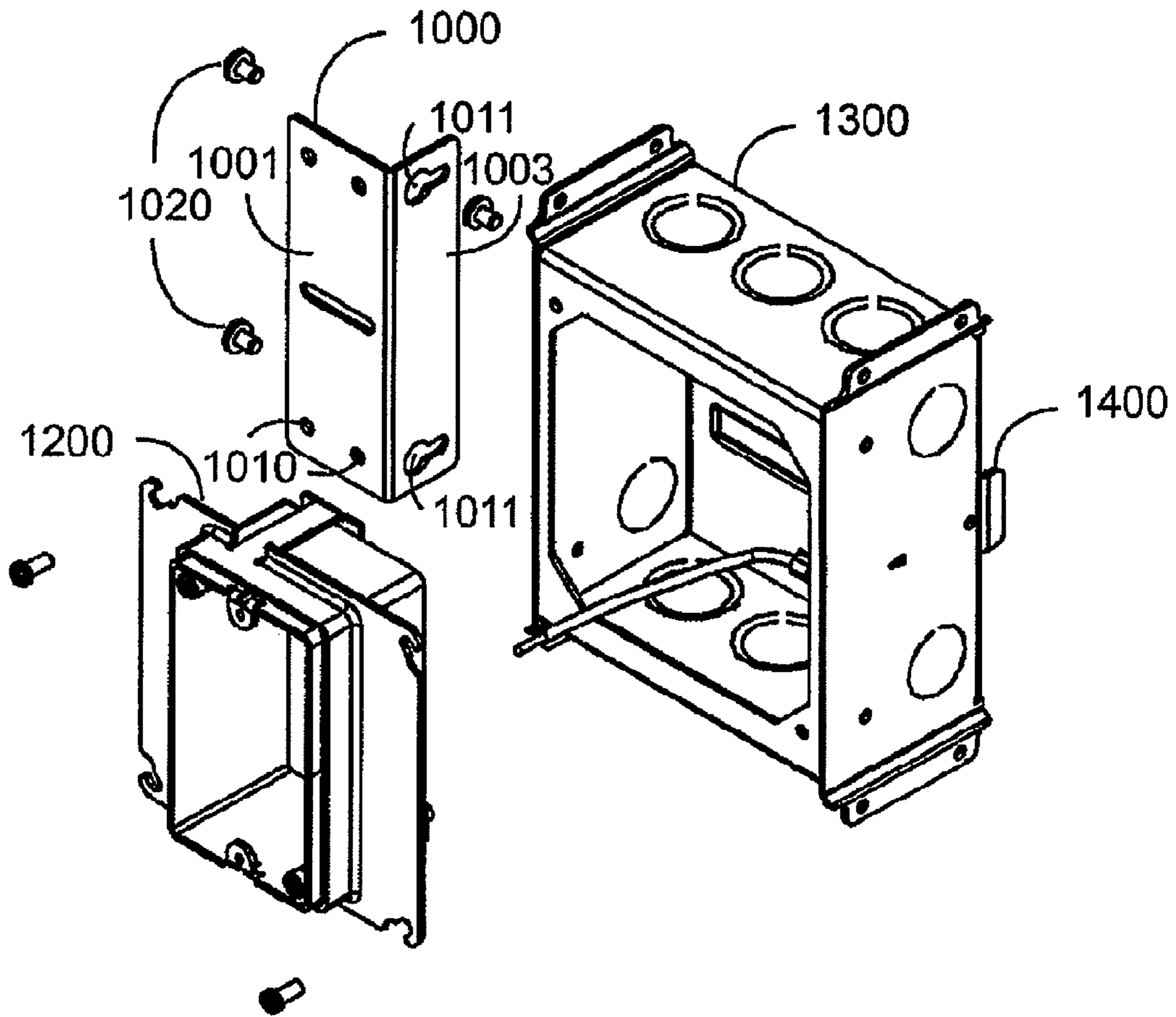

FIG. 10

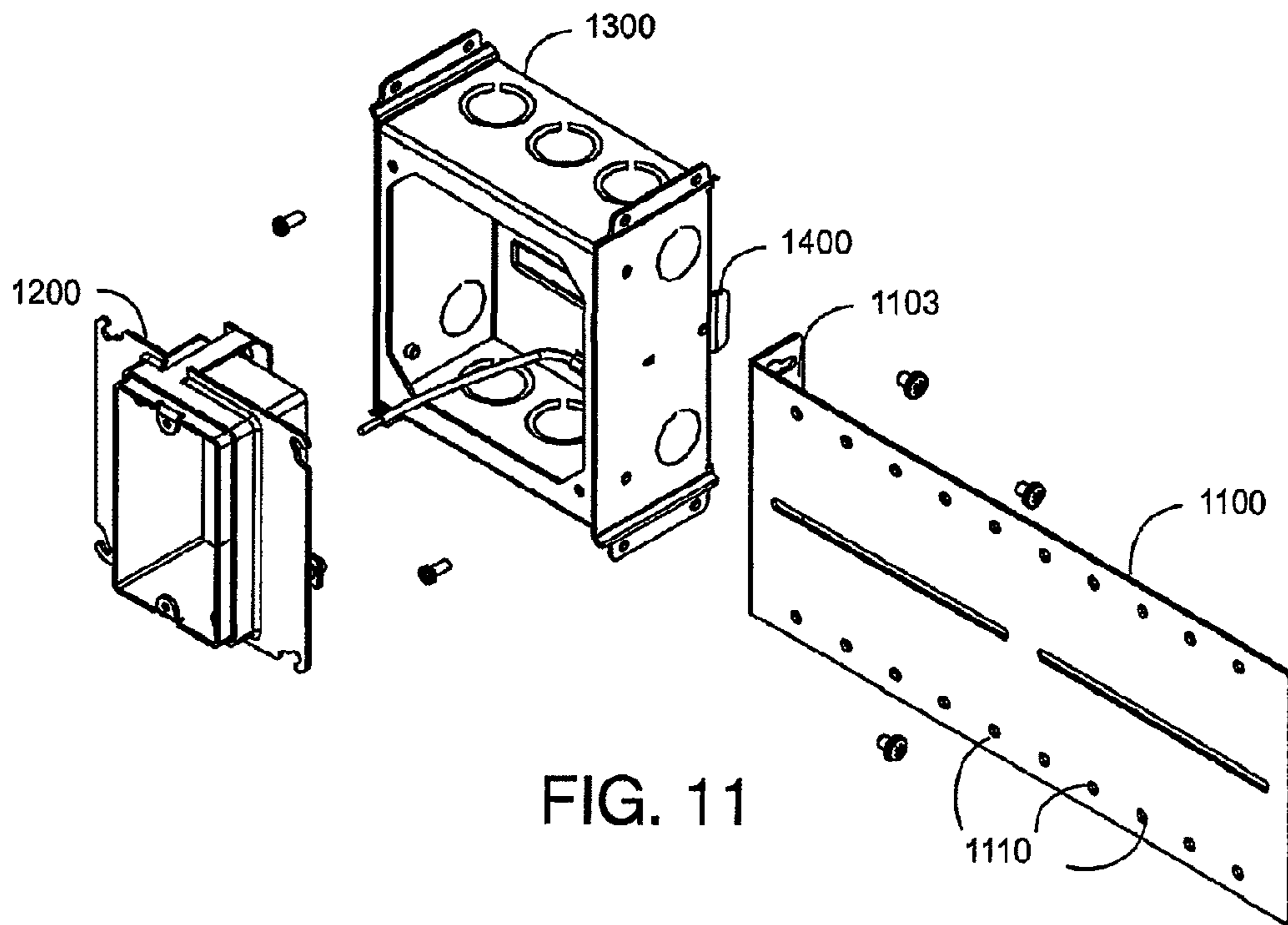

FIG. 11

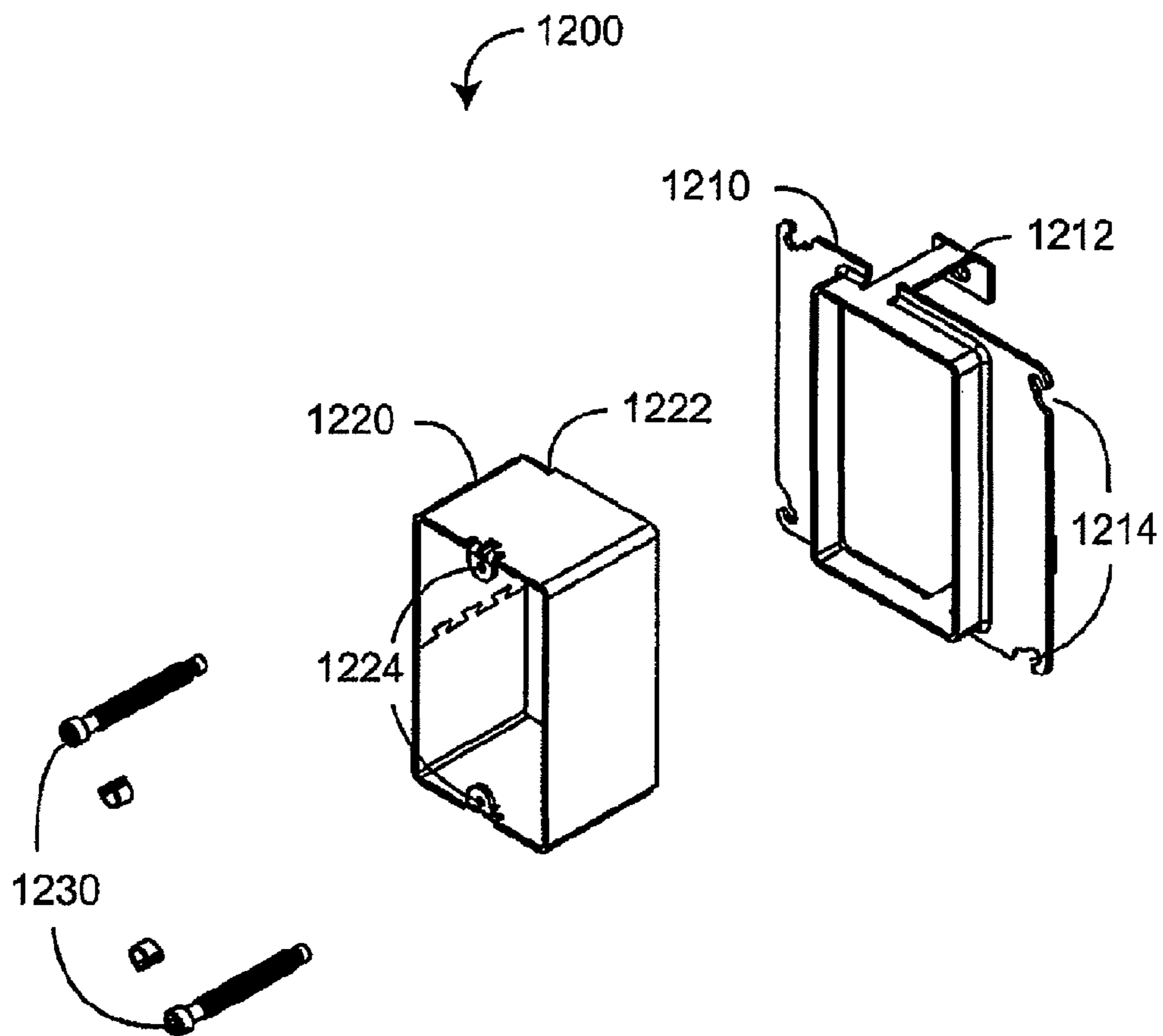

FIG. 12

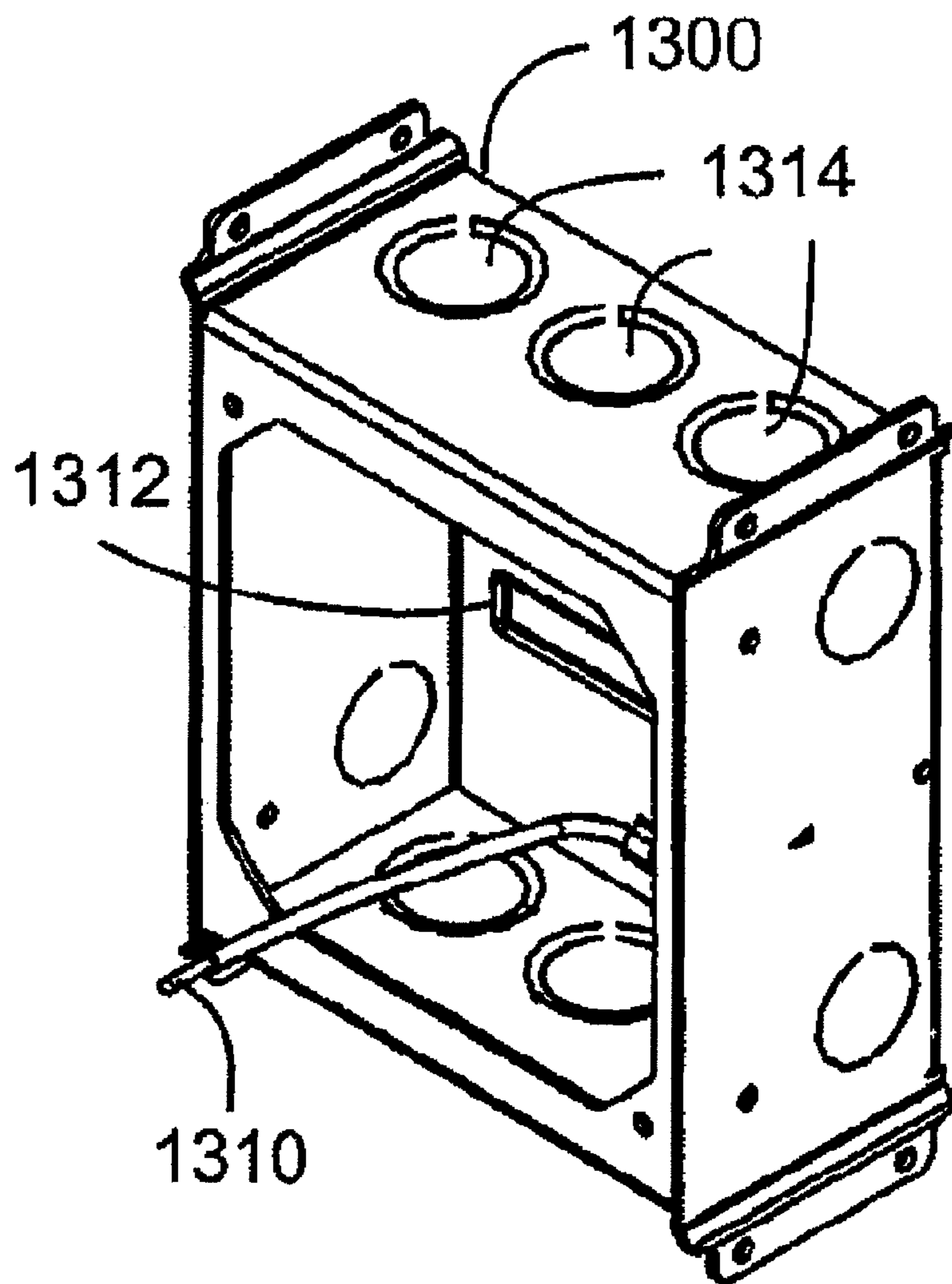

FIG. 13

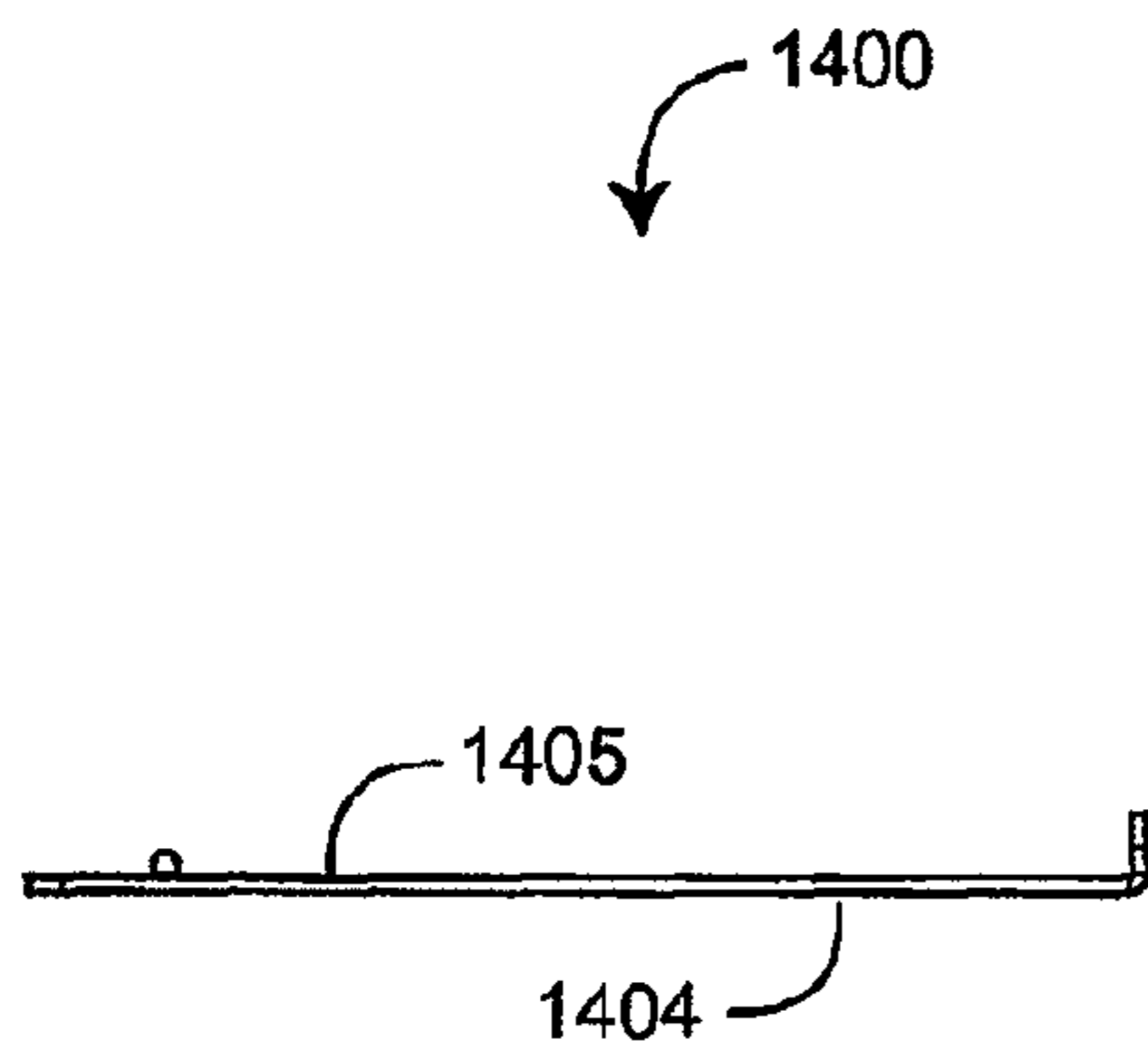

FIG. 14A

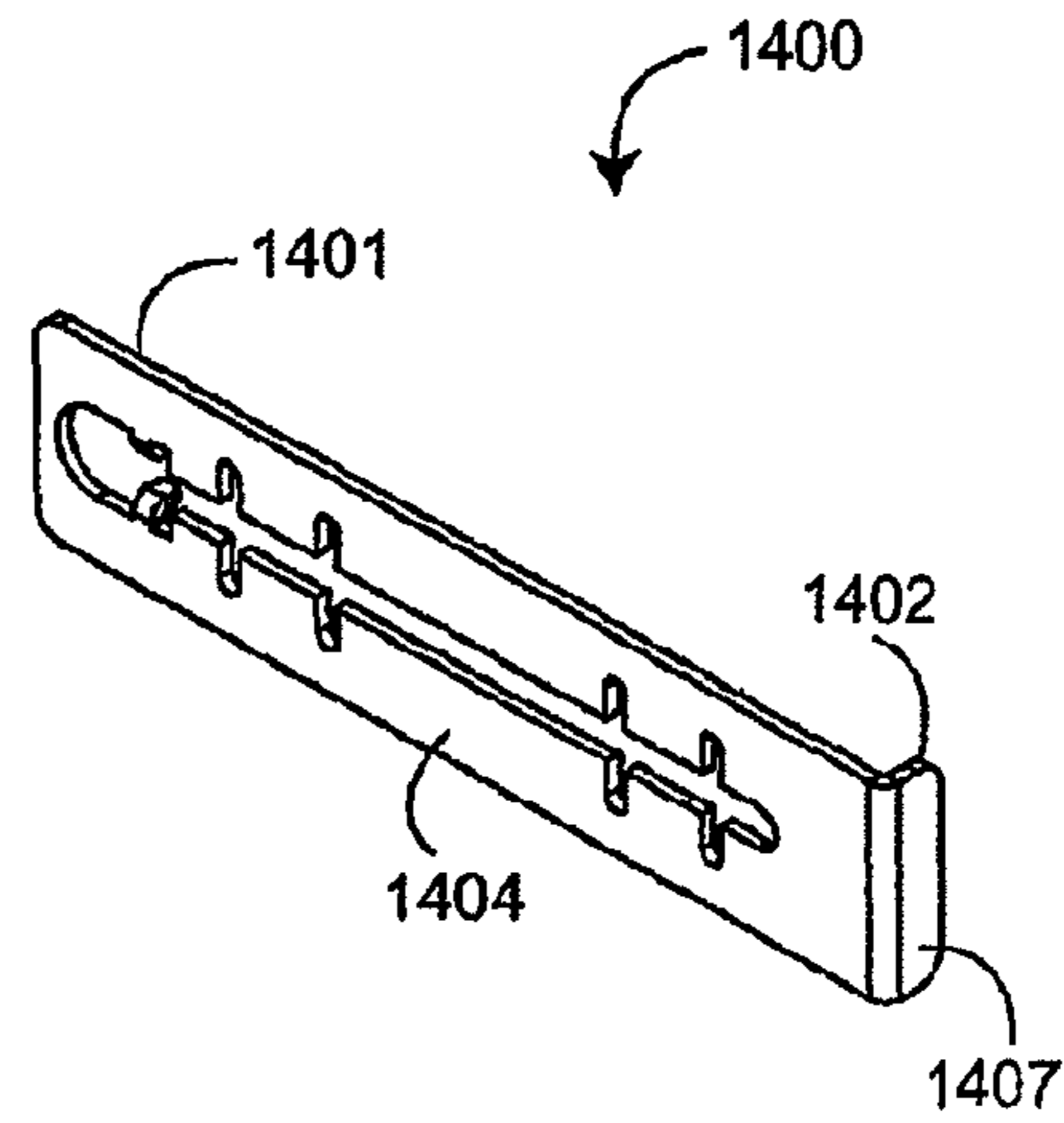

FIG. 14B

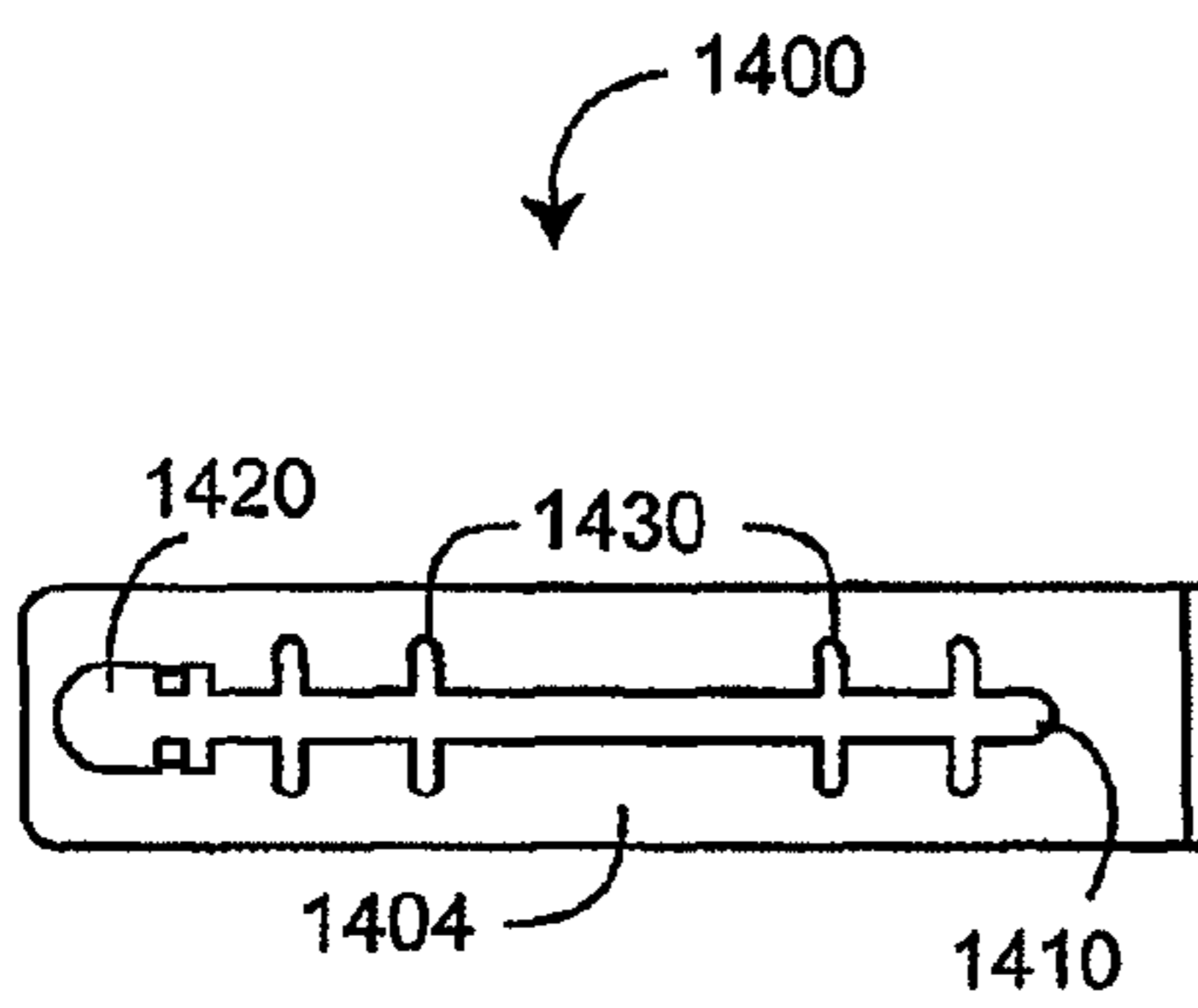

FIG. 14C

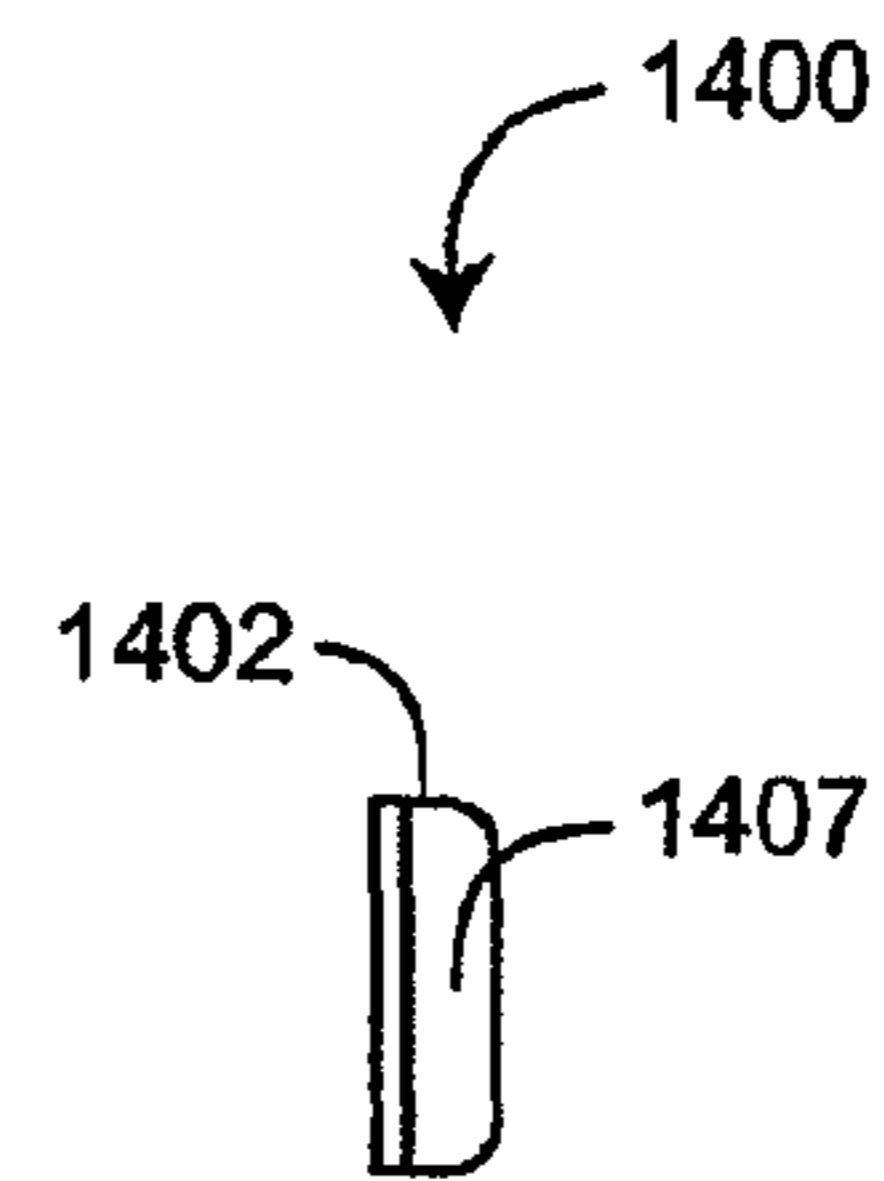

FIG. 14D

UNIVERSAL ELECTRICAL WIRING COMPONENT

Matter enclosed in heavy brackets [] appears in the original patent but forms no part of this reissue specification; matter printed in italics indicates the additions made by reissue; a claim printed with strikethrough indicates that the claim was canceled, disclaimed, or held invalid by a prior post-patent action or proceeding.

CROSS-REFERENCE TO RELATED APPLICATIONS

Notice: More than one reissue application has been filed for the reissue of U.S. Pat. No. 7,572,977. The reissue applications include the present application, which is a continuation reissue application of reissue application Ser. No. 13/208,260, filed Aug. 11, 2011, both of which are broadening reissues of U.S. Pat. No. 7,572,977.

[This application] U.S. Pat. No. 7,572,977 is a continuation of [co-pending] U.S. application Ser. No. 10/924,555 filed Aug. 24, 2004 and entitled "Universal Electrical Wiring Component," now U.S. Pat. No. 7,312,396, issued on Dec. 25, 2007, which claims priority from U.S. Provisional Application No. 60/552,546 filed Mar. 13, 2004 and entitled "Modular Integrated Wiring System," both of which are incorporated by reference in their entirety.

BACKGROUND OF THE INVENTION

Conventional AC electrical systems are comprised of a junction box and an electrical device, such as an outlet or switch, installed within the box. During a rough-in phase of construction, power cables are routed through building framing to junction boxes mounted at predetermined electrical distribution locations. The power cables are fed through openings in the rear or sides of the junction boxes and folded back inside, unterminated, so as to be out of the way until the next phase. During a makeup phase, wall panels are installed and painted, and electrical devices are installed into the boxes. After conductors are wired to an electrical device, it and the attached conductors are pushed into the electrical box and the device is attached to the top and bottom of the box. During a trim phase, face plates are mounted over the open end of the junction boxes, completing the conventional electrical wiring process.

SUMMARY OF THE INVENTION

Conventional electrical wiring installation is a logistical nightmare of schedules, inventory, design changes and rework to correct design and installation errors and product defects. Prefabricated units having brackets with pre-mounted junction boxes and pre-wired outlets and switches installed within the boxes are sometimes utilized in an effort to save installation time. These units are manufactured per contractor specification and delivered to the job site. An electrician attaches a particular unit at a specific location and attaches a corresponding power cable to a standard connector.

Such prefabricated electrical systems, however, do not solve all of the logistical problems associated with electrical wiring system design and installation and create additional ones. Each prefabricated unit is typically specified as to mounting height, plaster ring depth, support arm length and electrical device type, to name a few, and are given unique part numbers. Each part number represents a different stock

keeping unit (SKU) for the distributor and contractor. The contractor must sort each SKU to corresponding installation locations at the job site. If an SKU malfunctions, there is typically no replacement part, and the SKU has to be returned to the manufacturer. Each prefabricated part is custom made so there is much room for mistakes to be made in the specification and assembly process. If an electrician opens the SKU to fix a problem inside, the product warranty may be void.

A universal electrical wiring component advantageously combines an adjustable, modular mount with modular electrical devices to reduce installation costs over conventional wiring in much the same manner as a typical prefabricated system. Because a universal electrical wiring component is modular, a limited number of such components can be combined and configured as a substitute for many conventional assemblies. This significantly reduces the number of SKUs and associated inventory and planning headaches. Because a universal wiring component is adjustable, it greatly reduces specification requirements and eliminates the possibility of assembly errors associated with custom prefabricated parts. A universal electrical wiring component also advantageously accommodates design changes including the location and the type of an electrical distribution point and the function and color of an installed electrical device. Testing of the wiring system can be accomplished at the rough-in phase while walls are open rather than the trim-out phase. Trim-out can be completed without touching a wire. Devices can finish flush with the wall every time.

BRIEF DESCRIPTION OF THE DRAWINGS

FIG. 1 is a front view of a modular integrated wiring system utilizing various embodiments of a universal electrical wiring component;

FIG. 2 is a front perspective exploded view of a universal electrical wiring component having modular electrical devices combined with an adjustable, modular mount;

FIG. 3 is a front perspective view of a floor bracket electrical wiring component;

FIG. 4 is a front perspective view of a stud bracket electrical wiring component;

FIG. 5 is a front perspective view of a box bracket electrical wiring component;

FIG. 6 is a front perspective view of an extended box bracket electrical wiring component;

FIG. 7 is an exploded perspective view of a junction box assembly;

FIG. 8 is an exploded perspective view of a floor bracket assembly;

FIG. 9 is an exploded perspective view of a stud bracket assembly;

FIG. 10 is an exploded perspective view of a box bracket assembly;

FIG. 11 is an exploded perspective view of an extended BOX bracket assembly;

FIG. 12 is an exploded perspective view of an adjustable plaster ring;

FIG. 13 is a perspective view of a junction box; and
FIGS. 14A-D are top, perspective, front and side views, respectively, of a support arm.

DETAILED DESCRIPTION OF THE PREFERRED EMBODIMENTS

FIG. 1 illustrates a modular integrated wiring system 100 utilizing universal electrical wiring component embodiments

300-600. A floor bracket component **300**, a stud bracket component **400**, a box bracket component **500** and an extended box bracket **600** are included, providing adaptability for different electrical power distribution designs. Each wiring component **300-600** provides mounting flexibility by adjusting to various wall dimensions, stud configurations, and electrical distribution point locations. Specifically, each component **300-600** has an adjustable depth into the wall, guaranteeing a flush finish with the wall surface at every electrical distribution point. In addition, the floor bracket component **300** provides an adjustable height. The stud bracket component **400** can be positioned at any height and provides an adjustable distance between studs. The box bracket component **500** can be positioned at any height, and the extended box bracket component **600** can be positioned at any height and at various locations between studs. Further, each wiring component **300-600** accommodates a variety of functional modules, including various outlets, switches, GFCI devices, and motion detectors to name few. Advantageously, the color of the functional modules and even some functionality can be readily changed at anytime without rewiring, as described below. The resulting modular integrated wiring system **100** has the labor saving advantages of prefabrication with the design and installation flexibility of individually configured and wired components.

A universal electrical wiring component combining modular electrical devices and an adjustable, modular mount is described with respect to FIG. 2, below. A floor bracket component **300** is described in further detail with respect to FIG. 3, below. A stud bracket component **400** is described in further detail with respect to FIG. 4, below. A box bracket component **500** is described in further detail with respect to FIG. 5, below, and an extended box bracket component **600** is described in further detail with respect to FIG. 6, below. Adjustable mounts are described in detail with respect to FIGS. 7-11, below.

FIG. 2 further illustrates a universal electrical wiring component **200** having an adjustable mount **205** combined with a wiring module **201**. The adjustable mount **205** includes a bracket **207** and a box assembly **700**. The bracket **207** can be, for example, a vertically adjustable floor bracket **800** (FIG. 8), a horizontally adjustable stud bracket **900** (FIG. 9), a box bracket **1000** (FIG. 10), or an extended box bracket **1100** (FIG. 11). The box assembly **700** is mounted to the bracket **207** and the wiring module **201** is mounted in the box assembly **700**. The wiring module **201** may be a regular wiring module **210** or a GFCI wiring module **220**. The adjustable mount **205** is configured to position the wiring module **201** at any of various locations within a building wall. The wiring module **201** is configured to connect to a source of electrical power and to removably accept a functional module **203**. Advantageously, the combination of adjustable mount and wiring module form a universal electrical wiring component that can implement a variety of electrical distribution points of an electrical system. For example, a universal electrical wiring component can accept various outlet modules **250-260** and can be adjusted to implement a wall outlet. As another example, a universal electrical wiring component can accept various switch modules **240** and can be adjusted to implement a switch outlet. A universal electrical wiring component **200** may be, for example, a floor bracket component **300** (FIG. 3), a stud bracket component **400** (FIG. 4), a box bracket component **500** (FIG. 5) or an extended box bracket component **600** (FIG. 6). A cover **204** may be used to protect a wiring module **201** from damage prior to functional module installation.

FIG. 3 illustrates a floor bracket component **300** having a wiring module **201** and an adjustable mount comprising a box assembly **700** and a floor bracket **800**. In this embodiment, the floor bracket **800** provides the wiring module **201** an adjustable height from the floor and the box assembly **700** provides the wiring module **201** an adjustable distance from the box assembly **700** for a flush position with a wall surface.

FIG. 4 illustrates a stud bracket component **400** having a wiring module **201** and an adjustable mount comprising a box assembly **700** and a stud bracket **900**. In this embodiment, the stud bracket **900** provides the wiring module **201** an adjustable distance between studs and the box assembly **700** provides the wiring module **201** an adjustable distance from the box assembly **700** for a flush position with a wall surface.

FIG. 5 illustrates a box bracket component **500** having a wiring module **201** and an adjustable mount comprising a box assembly **700** and a box bracket **1000**. In this embodiment, the box bracket **1000** allows positioning of the wiring module **201** along a vertical stud. Also, the box assembly **700** provides the wiring module **201** an adjustable distance from the box assembly **700** for a flush position with a wall surface.

FIG. 6 illustrates an extended box bracket component **600** having a wiring module **201** and an adjustable mount comprising a box assembly **700** and an extended box bracket **1100**. In this embodiment, the extended box bracket **1100** allows vertical positioning of the wiring module **201** along a stud and horizontal positioning between studs. Also, the box assembly **700** provides the wiring module **201** an adjustable distance from the box assembly **700** for a flush position with a wall surface.

FIG. 7 illustrates a box assembly **700** having a junction box **1300**, an adjustable plaster ring **1200** and a support arm **1400**. The plaster ring **1200** removably attaches to the junction box **1300** and a wiring module **201** (FIG. 2) attaches to the plaster ring **1200**. The plaster ring provides the wiring module **201** (FIG. 2) with an adjustable distance from the junction box **1300**, as described in detail with respect to FIG. 12. The junction box **1300** advantageously has an attached ground wire that can be quickly connected to a wiring module **201** (FIG. 2). The plaster ring **1200** has slotted fastener apertures so that the plaster ring **1200** along with an attached wiring module can be removed from, and reattached to, the junction box **1300** by merely loosening and tightening, respectively, the fasteners. The support arm **1400** attaches to the back of the junction box to provide support against an inside wall surface, as described in further detail with respect to FIGS. 14A-D, below.

FIG. 8 illustrates a floor bracket **800** having an open front **801** and ruled sides **810**. The floor bracket **800** has tabs **820** for attaching the bracket **800** to one or both of a floor joist or a wall stud. Side grooves **830** allow fasteners to attach the junction box **1300** at an adjustable height from the floor. Conduit supports **840** are adapted for attachment to conduits running to the junction box **1300**. The plaster ring **1200** is attached to the box **1300** through the open front **801** so that the plaster ring **1100** can be removed from the box **1130** without removing the box **1300** from the bracket **800**.

FIG. 9 illustrates a stud bracket **900** having a horizontal bar **901** and ends **903**. The ends **903** are folded perpendicularly to the bar **901** and adapted to secure the bracket **900** horizontally between wall studs. The bar **901** has grooves **910** and a slot **920** that extend horizontally to proximate both ends **903** of the bracket **900**. The grooves **910** are adapted to slideably retain corresponding box tongues **1312** (FIG. 13). The slot **920** is centered between the grooves **910** and accommodates a fastener that secures the junction box **1300** to the bracket **900** while allowing the box to slideably adjust in position along

5

the bar 901. The plaster ring 1200 is attached to the box 1300 and can be removed from the box 1300 without removing the box 1300 from the bracket 900.

FIG. 10 illustrates a box bracket 1000 having a stud mounting face 1001 and a box mounting face 1003. The stud mounting face 1001 is disposed perpendicular to the box mounting face 1003 and is adapted to fasten to a wall stud. Either side of the junction box 1300 attaches to the box mounting face 1003. The box mounting face 1003 has a keyhole slots 1011 allowing the junction box 1300 to fasten and unfasten to the bracket 1000 without removing the fasteners 1020. The stud mounting face 1001 has a plurality of mounting holes 1110 to accommodate fasteners that allow the junction box 1300 to be positioned along a stud.

FIG. 11 illustrates an extended box bracket 1100 having an extended stud mounting face 1101 and a box mounting face 1103. The box mounting face 1103 is disposed perpendicular to the extended stud mounting face 1101 and is adapted to fasten to the junction box 1300. The extended stud mounting face 1101 is adapted to fasten to a wall stud. The extended stud mounting face 1101 has a plurality of mounting holes 1110 spaced along the length of the bracket 1100 to accommodate fasteners that allows the junction box 1300 to be position vertically along a stud and horizontally between studs.

FIG. 12 further illustrates an adjustable plaster ring 1200 having a base ring 1210, an insert ring 1220 and adjusting screws 1230. The insert ring 1220 is slideably retained by the base ring 1210 and secured to the base ring 1210 by the adjusting screws 1230. The insert ring 1220 is adapted to mount a wiring module and to adjust the wiring module position relative to the base ring 1210 in response to turning of the screws 1230. The base ring 1210 has keyhole slots 1214 adapted to accommodate fasteners that attach the plaster ring 1200 to a junction box. The keyhole slot 1214 allows the plaster ring 1200 to fasten and unfasten to the junction box without removing the fasteners.

FIG. 13 further illustrates a junction box 1300 having a ground wire 1310, a tongue 1312 and knockouts 1314. The ground wire 1310, being pre-wired to the box, advantageously saves a fabrication step on the job site. Further, the ground wire 1310 is configured to insert into a push-wire connector on a pre-wired wiring module, providing a plug-in function module with a path to ground. The tongue 1312 stabilizes the box within a groove on a stud bracket, if used. The knockouts 1314 provide attachment points for power cable conduits.

FIGS. 14A-D further illustrate a support arm 1400 adapted to attach to a back face of the junction box 1300 (FIG. 13) and provide support against an inside wall surface. In particular, the support arm 1400 has an attachment section 1401 and a support section 1402 extending generally perpendicularly from one end of the attachment section 1401. The attachment section is generally planar having an inside face 1404 that is disposed against the junction box 1300 and an opposite outside face 1405 that is disposed distal the junction box 1300. The support section 1402 has a support face 1407 that is disposed against an inside wall surface. The attachment section 1401 has an adjustment slot 1410, a fastener hole 1420, and a plurality of bending slots 1430 distributed along and extending perpendicularly across the adjustment slot 1410. The attachment section 1401 is configured to bend along one of the bending slots 1430 so as to provide a variable length support extending generally normal to the junction box back face. The support arm 1400 is held to the box 1300 with a fastener that is slideable along the adjustment slot 1410, providing an adjustable support arm position.

6

A universal electrical wiring component has been disclosed in detail in connection with various embodiments. These embodiments are disclosed by way of examples only and are not to limit the scope of the claims that follow. One of ordinary skill in the art will appreciate many variations and modifications.

What is claimed is:

[1. A modular electrical wiring component comprising:

a wiring module having a first portion configured to couple to a source of electrical power and a second portion configured to couple and provide the electrical power to a separate functional module that provides a selected electrical distribution function, wherein the wiring module is configured to couple to the functional module without accessing the wiring first portion;

an adjustable plaster ring configured to couple to the wiring module and to an electrical box, wherein the adjustable plaster ring is configured to provide a variable distance between the electrical junction box and the wiring module; and

a protective cover to shield the second portion of the wiring module when no functional module is coupled to the wiring module.]

[2. The modular electrical wiring component of claim 1, wherein the adjustable plaster ring comprises a base ring and an insert ring that is slidably retained within the base ring.]

[3. The modular electrical wiring component of claim 2, wherein the insert ring is slidably retained within the base ring by adjusting screws.]

[4. The modular electrical wiring component of claim 3, wherein turning the adjusting screws varies the distance between the electrical box and the wiring module.]

[5. The modular electrical wiring component of claim 2, wherein the base ring is configured to couple to the electrical box and the insert ring is configured to couple to the wiring module.]

[6. The modular electrical wiring component of claim 1, wherein the wiring module is configured to accept a plug-in functional module.]

[7. The modular electrical wiring component of claim 1, further comprising the electrical box.]

[8. An electrical wiring method comprising:

providing a wiring module having a first portion configured to couple to a source of electrical power and a second portion configured to couple and provide electrical power to a functional module that provides a selected electrical distribution function, wherein the wiring module is configured to couple to the functional module without accessing the first portion;

providing an adjustable plaster ring configured to couple to the wiring module and to an electrical box, wherein the adjustable plaster ring is configured to provide a variable distance between the electrical junction box and the wiring module;

coupling the wiring module to the adjustable plaster ring; and

coupling a protective cover with respect to the wiring module so as to shield the second portion of the wiring module when no functional module is coupled to the wiring module.]

[9. The electrical wiring method of claim 8, further comprising mechanically coupling the adjustable plaster ring to the electrical box.]

[10. The electrical wiring method of claim 9, further comprising adjusting the distance between the electrical box and the wiring module using the adjustable plaster ring.]

7

[11. The electrical wiring method of claim 8, further comprising electrically and mechanically coupling the functional module to the wiring module.]

[12. The electrical wiring method of claim 11, wherein electrically and mechanically coupling the functional module to the wiring module comprises plugging the functional module into the second portion of the wiring module.]

13. A modular electrical wiring component comprising:
a wiring module coupled to an electrical box, the electrical box comprising a front, a back and sides,

the wiring module coupled to the electrical box via a ground wire, wherein the ground wire connects the electrical box with a first portion of the wiring module, the first portion of the wiring module configured to couple to a source of electrical power via a plurality of electrical wires, and

a second portion of the wiring module configured to couple and provide the electrical power to a functional module that provides a selected electrical distribution function, wherein the second portion of the wiring module is configured to couple to the functional module without accessing the first portion of the wiring module coupled to the source of electrical power;

a plaster ring configured to couple to the front of the electrical box;

a protective cover configured to shield the second portion of the wiring module when no functional module is coupled to the wiring module; and

a mounting bracket configured to attach to the electrical box and mount the electrical box to a wall stud.

14. The modular electrical wiring component of claim 13 wherein the mounting bracket is a vertically adjustable floor bracket configured to vertically adjust the location of the electrical box with respect to the floor.

15. The modular electrical wiring component of claim 13 wherein the mounting bracket is a vertically adjustable floor bracket comprising ruled sides.

16. The modular electrical wiring component of claim 13 wherein the mounting bracket is a stud bracket configured to mount the electrical box to the wall stud.

17. The modular electrical wiring component of claim 13 wherein the mounting bracket is a horizontally adjustable stud bracket configured to horizontally adjust the location of the electrical box.

18. The modular electrical wiring component of claim 13 wherein the mounting bracket comprises a horizontal bar configured to horizontally adjust the location of the electrical box.

8

19. The modular electrical wiring component of claim 13 wherein the mounting bracket is configured to adjust the location of the electrical box both vertically and horizontally.

20. An electrical wiring method comprising:

providing a wiring module coupled to an electrical box, the electrical box comprising a front, a back and sides, coupling the wiring module to the electrical box via a ground wire that connects the electrical box with a first portion of the wiring module, the first portion of the wiring module configured to couple to a source of electrical power via a plurality of electrical wires, and

coupling the wiring module to a functional module via a second portion of the wiring module, the second portion of the wiring module configured to couple and provide electrical power to a functional module that provides a selected electrical distribution function, wherein the second portion of the wiring module is configured to couple to the functional module without accessing the first portion of the wiring module coupled to the source of electrical power;

providing a plaster ring configured to couple to the front of the electrical box;

coupling the plaster ring to the front of the electrical box; coupling a protective cover to shield the second portion of the wiring module when no functional module is coupled to the wiring module; and

attaching a mounting bracket to the electrical box, the mounting bracket configured to mount the electrical box to a wall stud.

21. The electrical wiring method of claim 20 wherein the mounting bracket is a vertically adjustable floor bracket that vertically adjusts the location of the electrical box with respect to the floor.

22. The electrical wiring method of claim 20 wherein the mounting bracket is a vertically adjustable floor bracket comprising ruled sides.

23. The electrical wiring method of claim 20 wherein the mounting bracket is a stud bracket that mounts the electrical box to a wall stud.

24. The electrical wiring method of claim 20 wherein the mounting bracket is a horizontally adjustable stud bracket that horizontally adjusts the location of the electrical box.

25. The electrical wiring method of claim 20 wherein the mounting bracket comprises a horizontal bar that horizontally adjusts the location of the electrical box.

26. The electrical wiring method of claim 20 wherein the mounting bracket adjusts the location of the electrical box both horizontally and vertically.

* * * * *