

US00RE43629E

(19) **United States**
(12) **Reissued Patent**
Wu

(10) **Patent Number:** **US RE43,629 E**
(45) **Date of Reissued Patent:** ***Sep. 4, 2012**

(54) **CONNECTING DEVICE FOR CONNECTING
A FAN BLADE TO A ROTOR OF A MOTOR OF
A CEILING FAN**

(75) Inventor: **San-Chi Wu**, Taichung (TW)

(73) Assignee: **Chien Luen Industries Co., Ltd., Inc.**,
Oakland Park, FL (US)

(*) Notice: This patent is subject to a terminal dis-
claimer.

(21) Appl. No.: **11/388,362**

(22) Filed: **Mar. 24, 2006**

Related U.S. Patent Documents

Reissue of:

(64) Patent No.: **5,951,197**
Issued: **Sep. 14, 1999**
Appl. No.: **09/193,429**
Filed: **Nov. 17, 1998**

U.S. Applications:

(62) Division of application No. 09/952,421, filed on Sep.
14, 2001, now Pat. No. Re. 39,448.

(51) **Int. Cl.**
B25G 3/00 (2006.01)

(52) **U.S. Cl.** **403/315; 403/363; 403/329; 416/206**

(58) **Field of Classification Search** **403/315,**
403/363, 329; 416/206, 210 R, 205, 5, 207,
416/220 A, 214 K

See application file for complete search history.

(56) **References Cited**

U.S. PATENT DOCUMENTS

1,485,552 A 3/1924 Colby 416/206
1,804,831 A 5/1931 Hardesty

1,935,314 A 11/1933 Finch et al. 416/5
2,610,377 A 9/1952 Bedford 24/213
2,771,259 A 11/1956 Laystrom 248/28
2,965,180 A 12/1960 Killam 416/210
4,050,771 A 9/1977 Watson 339/263
4,121,495 A 10/1978 Malo 85/1
4,396,352 A 8/1983 Pearce 416/206
4,511,310 A 4/1985 Pearce 416/134

(Continued)

FOREIGN PATENT DOCUMENTS

GB 2 276 219 9/1994 267/141

(Continued)

Primary Examiner — David E Bochna

(74) *Attorney, Agent, or Firm* — Brian S. Steinberger; Law
Offices of Brian S. Steinberger, P.A.

(57) **ABSTRACT**

A connecting device includes a bottom member with a periphery for attaching on a rotor of a motor, a circumferential wall which extends upwardly from the periphery, and a mounting arm which has an anchored end adapted for mounting the fan blade thereon and an anchoring end for anchoring on the bottom member such that the mounting arm is oriented in a radial direction relative to the bottom member by guidance of a guiding member. A tightening member is disposed to tighten the anchoring end relative to the bottom member through a clamping force generated in a circumferential direction of the bottom member when the anchoring end is pulled away from the bottom member in the radial direction. A retaining member is disposed between the tightening member and the anchored end in the radial direction, and has an engaging spring member that abuts against the circumferential wall once the anchoring end is moved away from the bottom member.

4 Claims, 9 Drawing Sheets

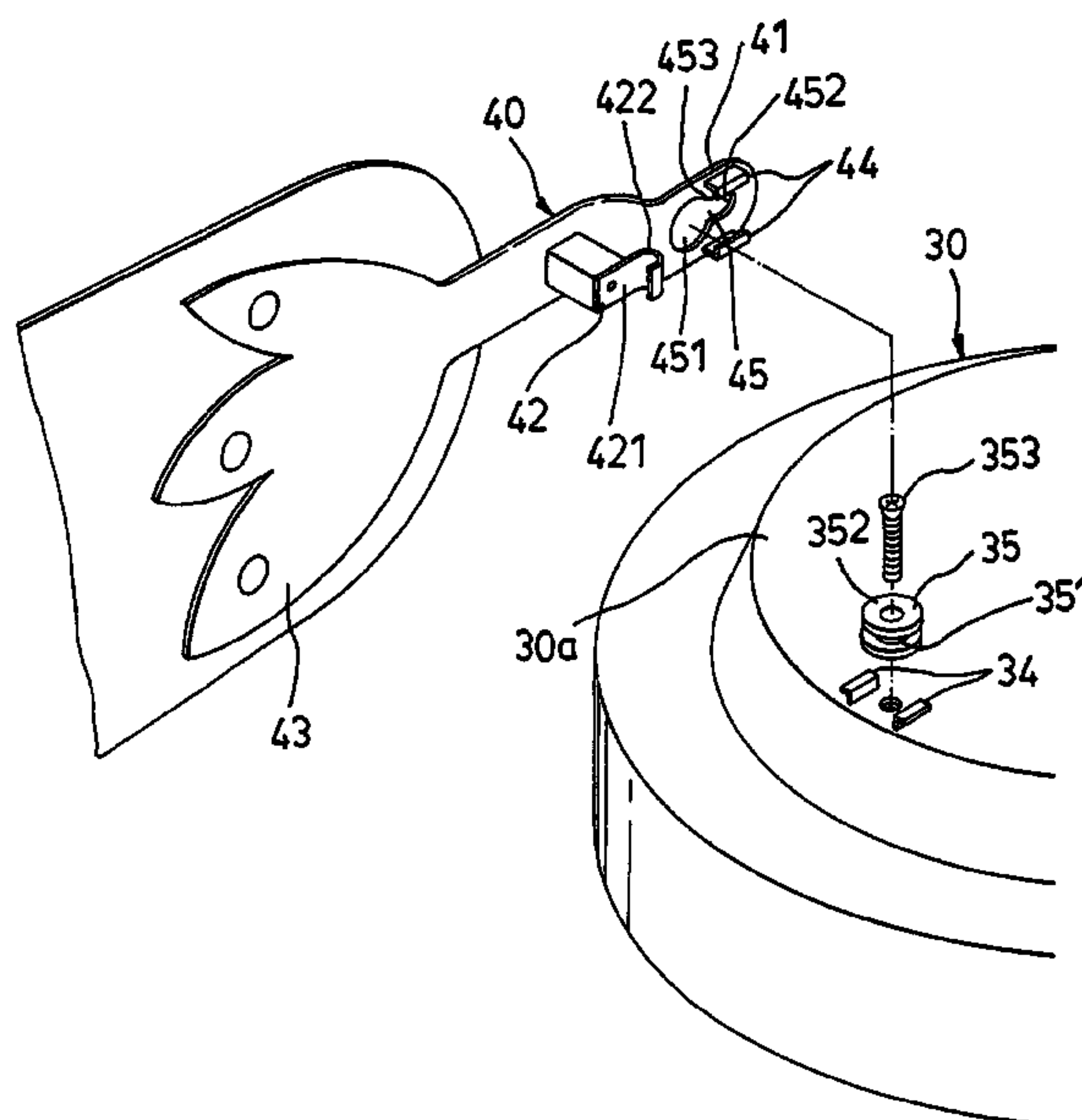

US RE43,629 E

Page 2

U.S. PATENT DOCUMENTS

5,135,341 A 8/1992 Leyder 411/182
5,180,284 A 1/1993 Monroe, III 416/204 R
5,237,889 A 8/1993 Conrad 74/502.4
5,384,940 A 1/1995 Soule 24/453
5,397,206 A 3/1995 Sihon 411/544
5,462,412 A 10/1995 Scofield 416/210
5,599,512 A 2/1997 Latulippe 422/300
5,722,814 A 3/1998 Yu 416/5
5,873,701 A 2/1999 Shiu 416/207
5,927,945 A 7/1999 Chen 416/5
5,944,486 A 8/1999 Hodgkins, Jr. 416/210
5,944,487 A 8/1999 Pearce 416/244 R
5,951,197 A 9/1999 Wu 403/315

5,954,449 A 9/1999 Wu 403/315
5,980,353 A 11/1999 Wu 416/210 R
6,010,306 A 1/2000 Bucher et al. 416/210
6,027,310 A 2/2000 Kerr, Jr. 416/210
6,039,540 A 3/2000 Wu 416/210
6,059,531 A 5/2000 Tai 416/220
6,095,753 A 8/2000 Hsu 416/210
6,139,276 A 10/2000 Blateri 416/210 R
6,210,117 B1 4/2001 Bucher 416/210 R
RE39,448 E * 12/2006 Wu 403/315

FOREIGN PATENT DOCUMENTS

JP 403272308 A 12/1991

* cited by examiner

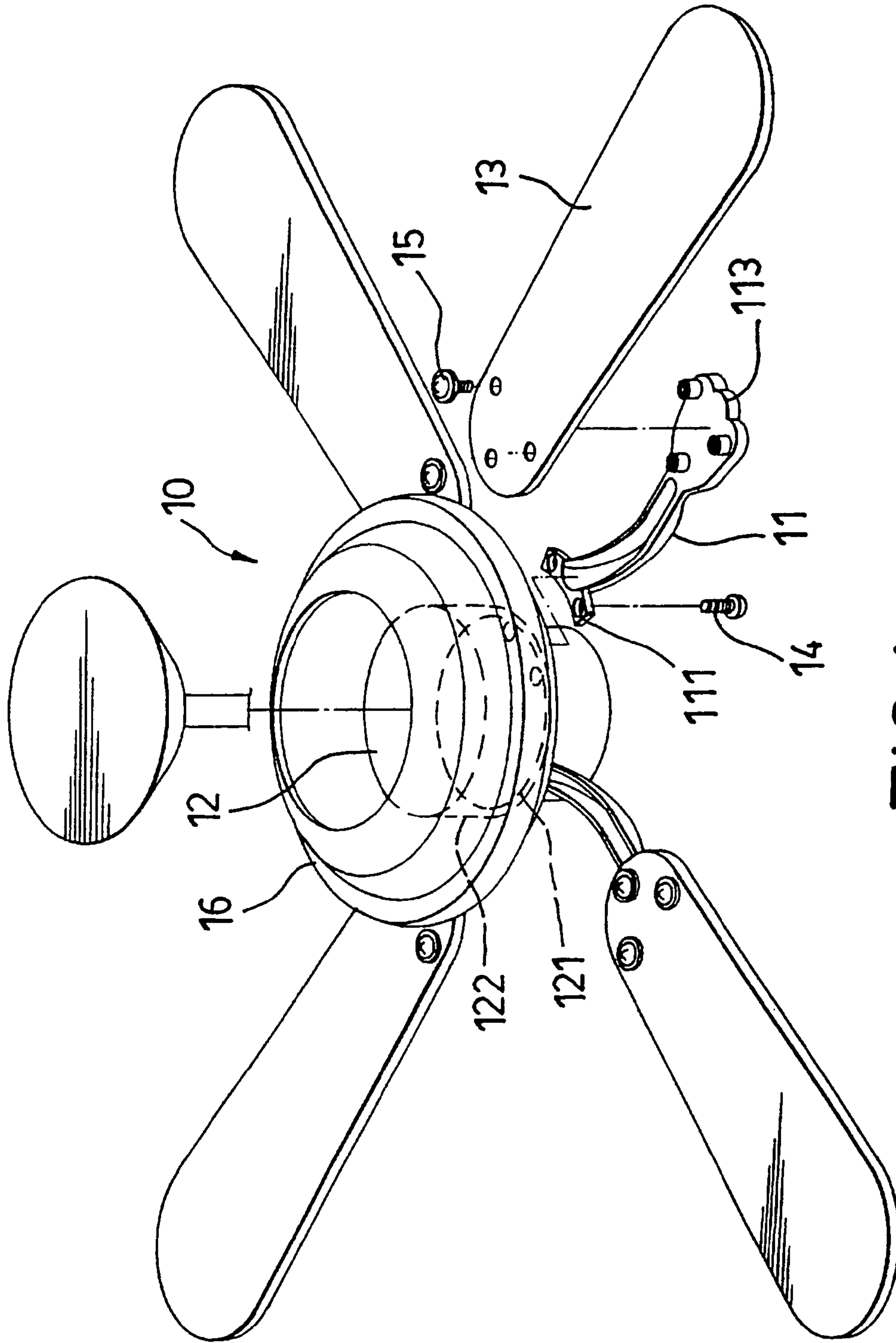

FIG. 1
PRIOR ART

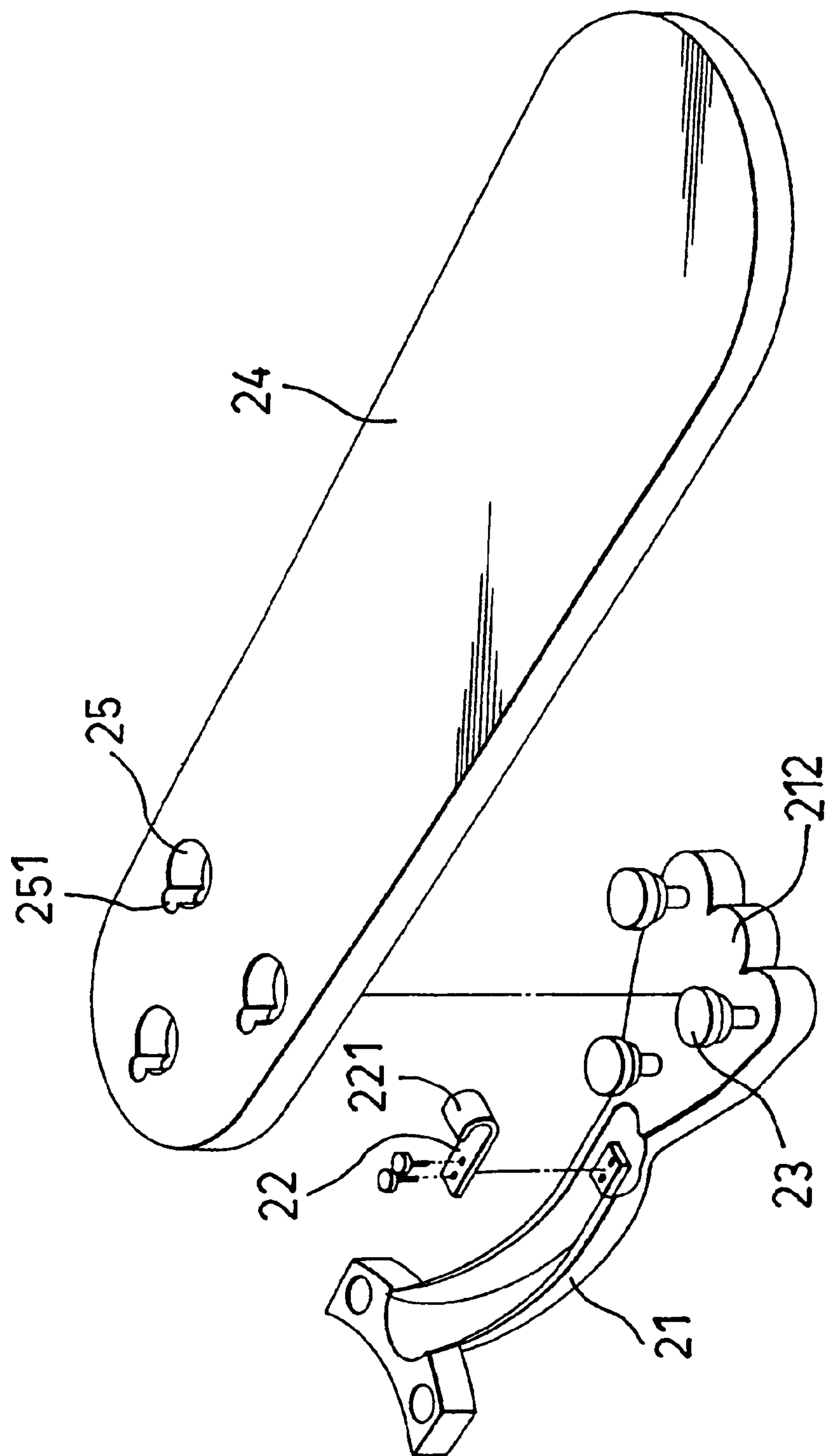

FIG. 2
PRIOR ART

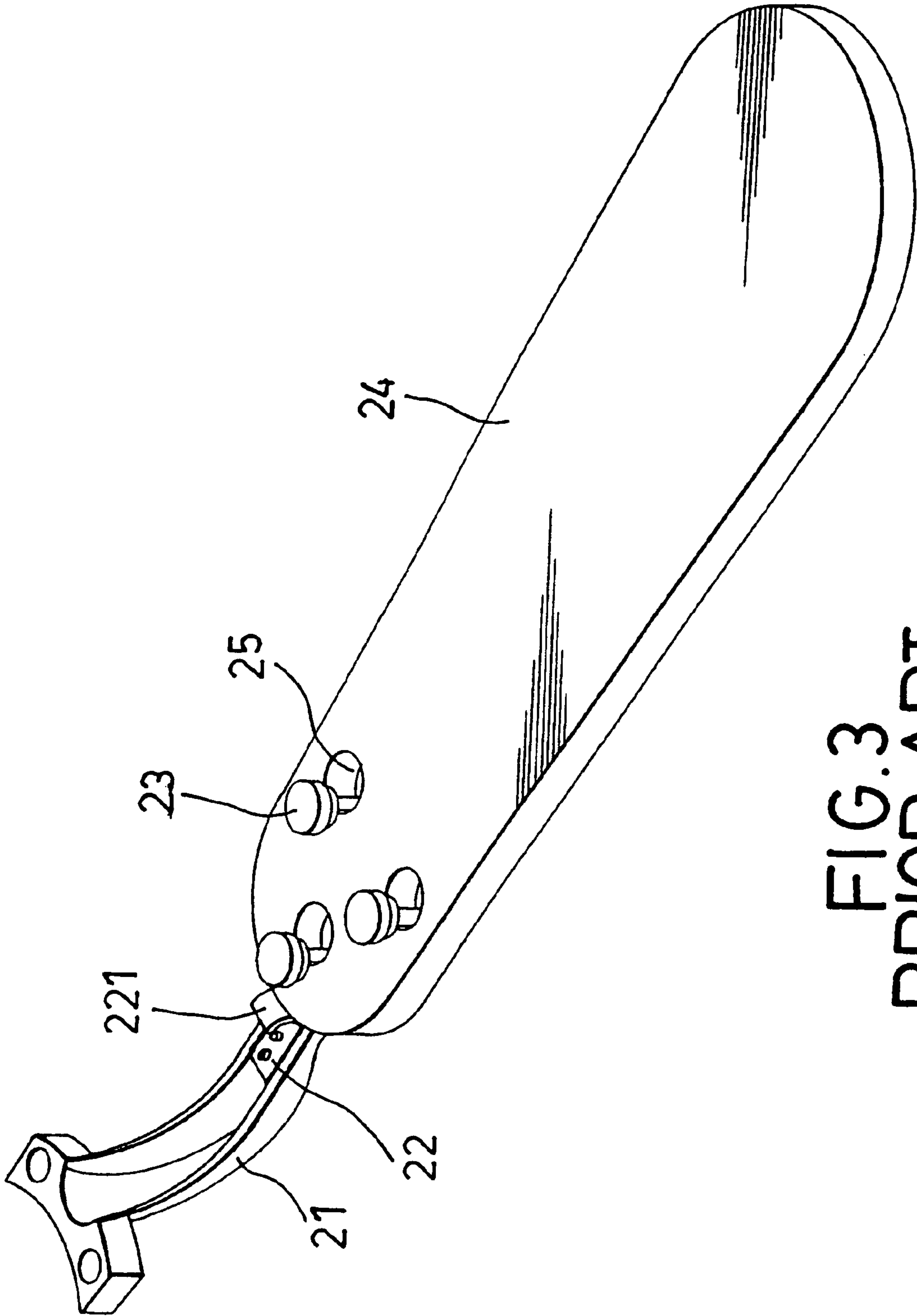

FIG. 3
PRIOR ART

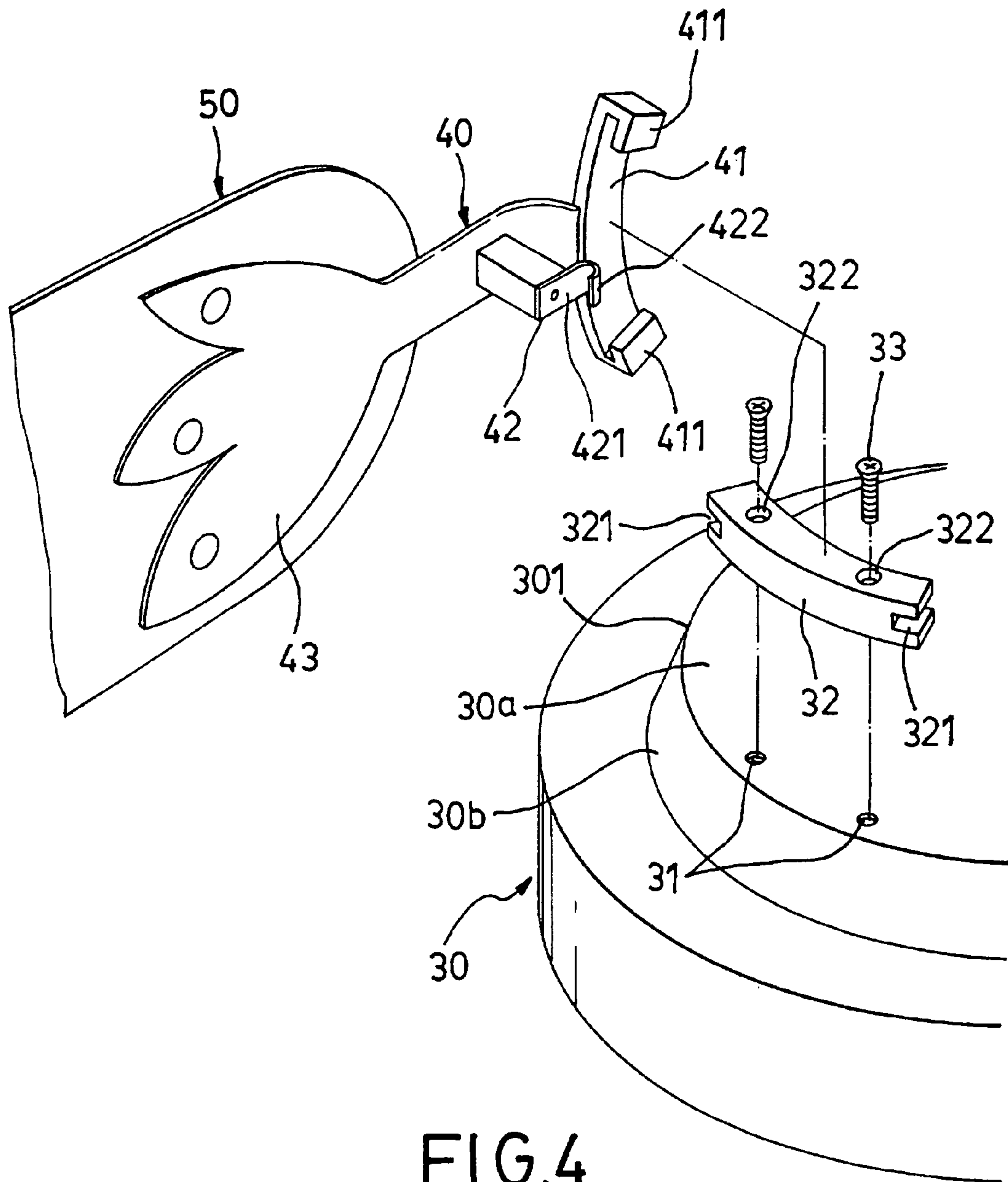

FIG. 4

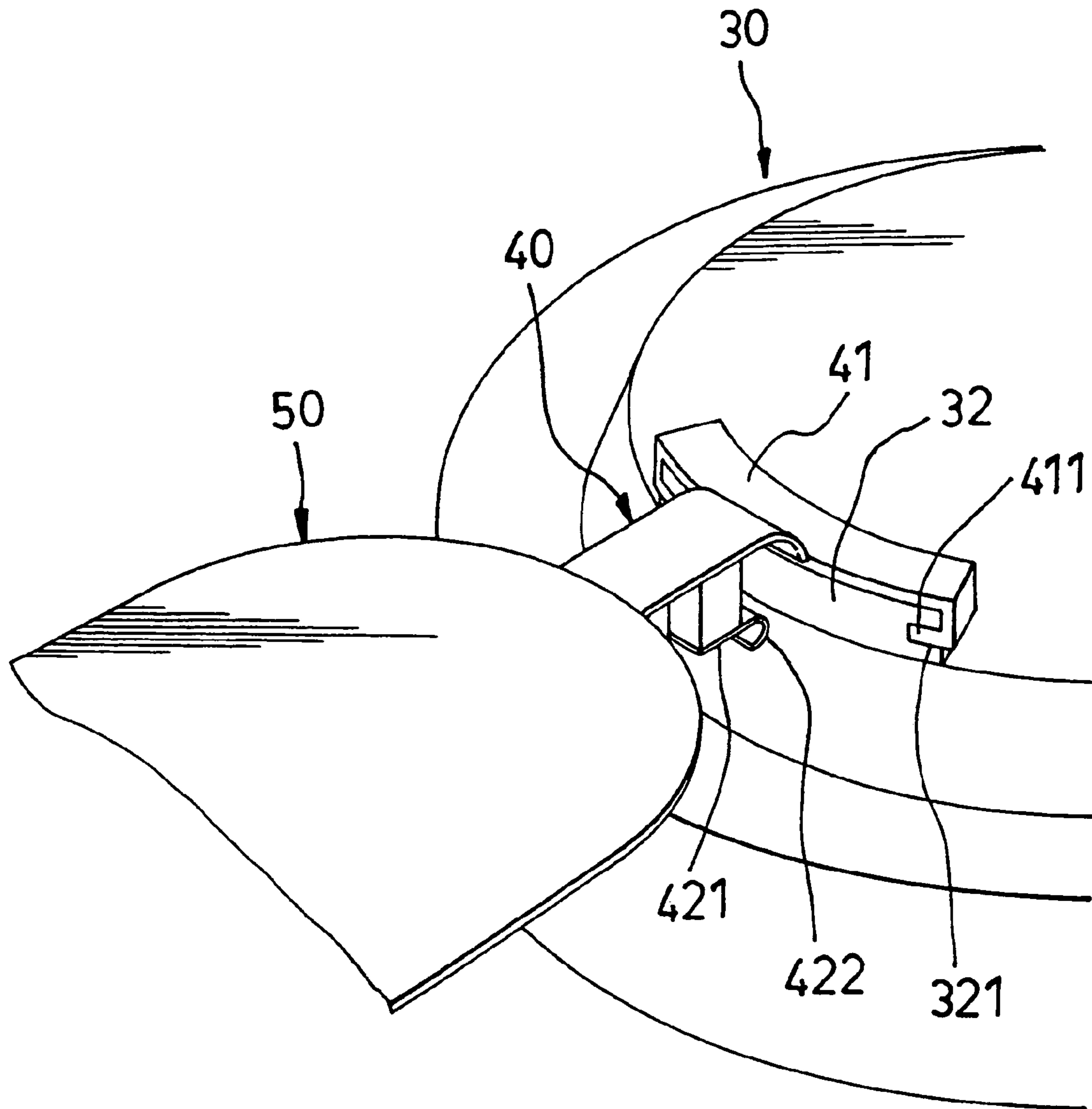

FIG.5

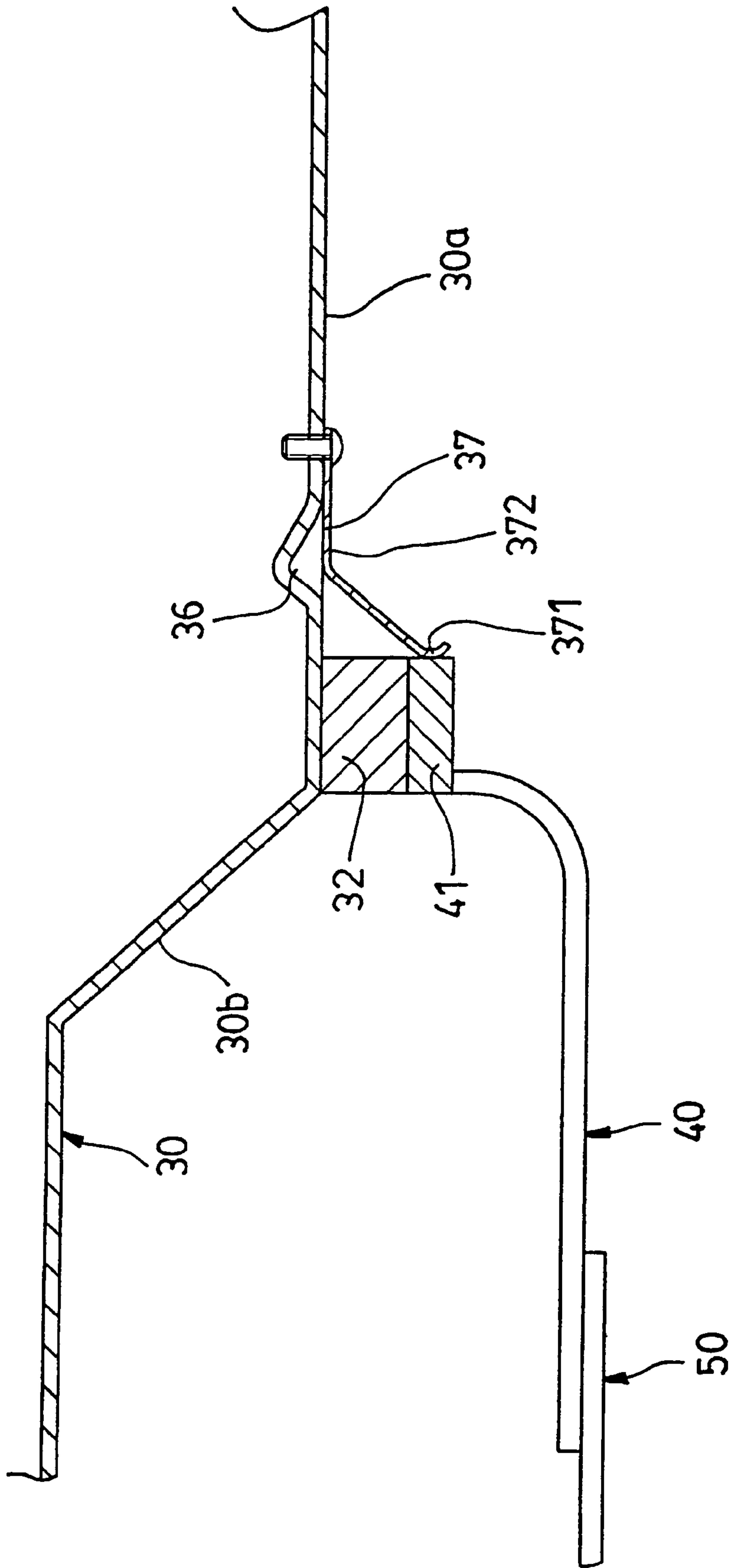

FIG.6

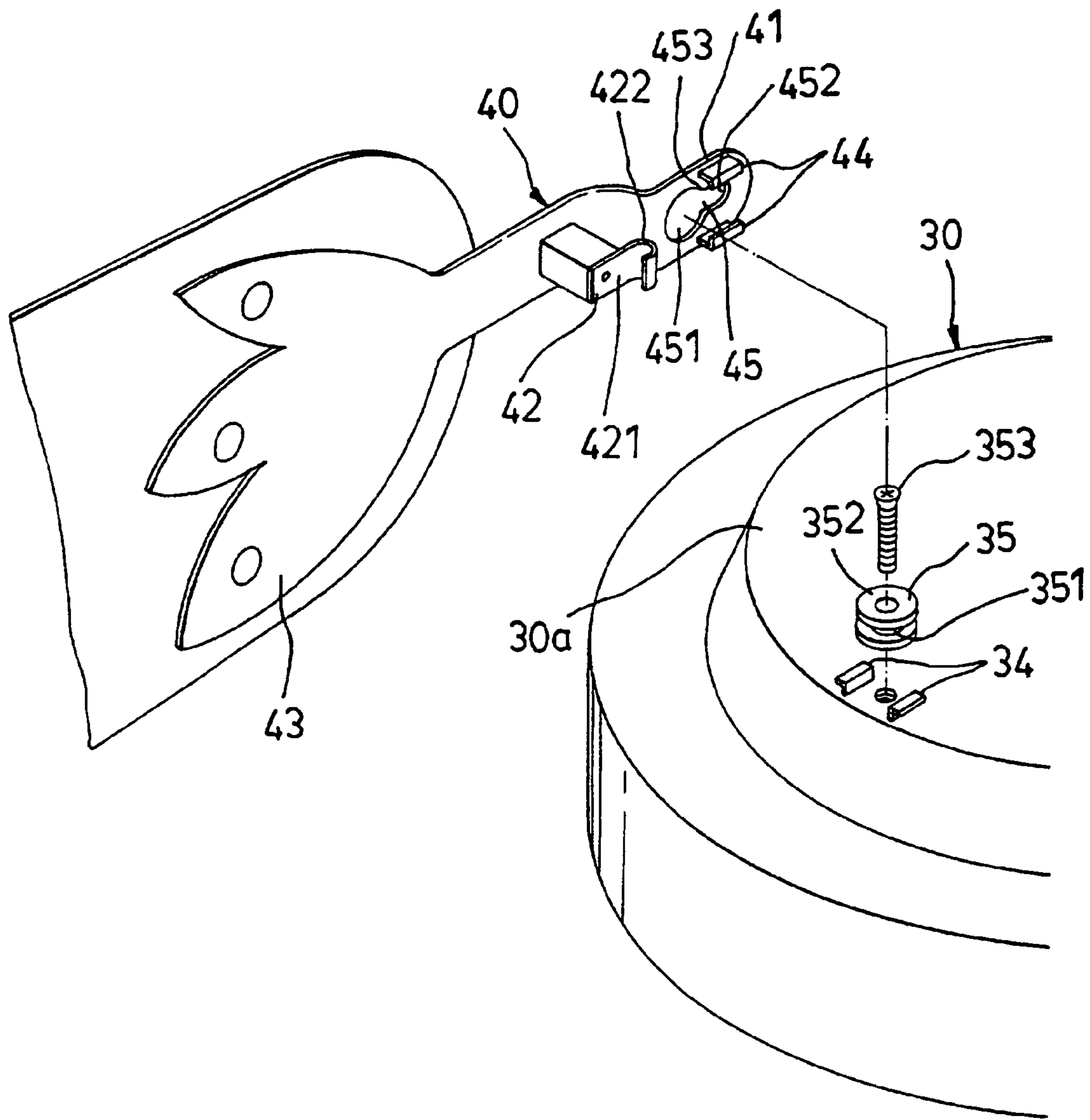

FIG. 7

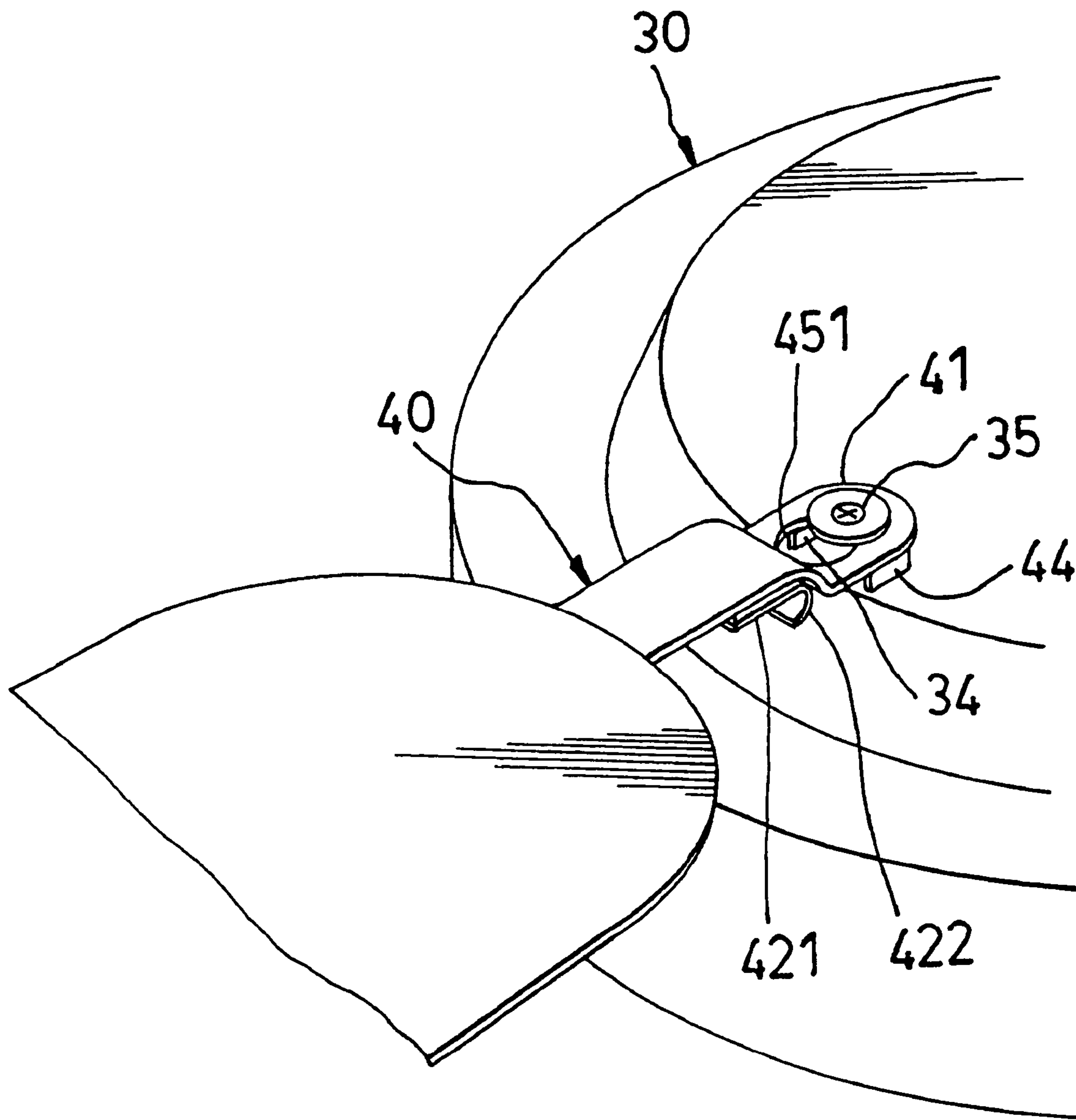

FIG.8

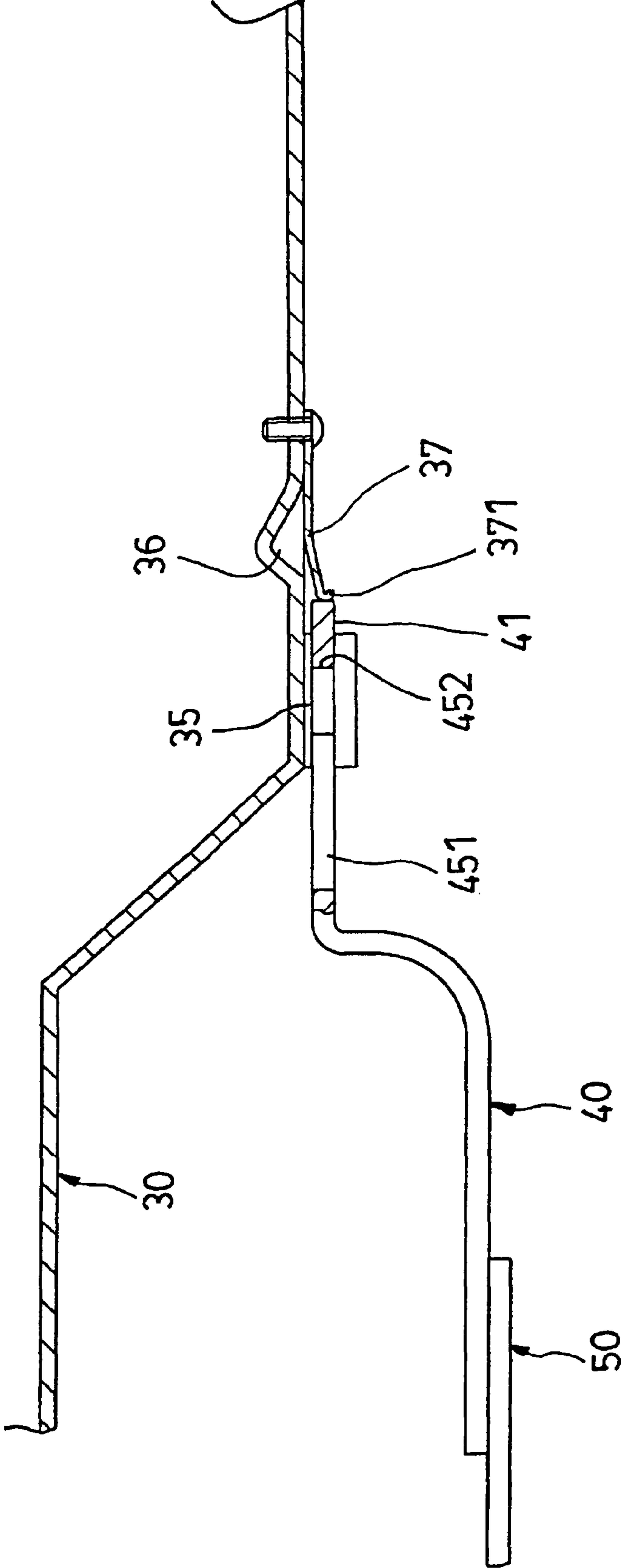

FIG.9

1

**CONNECTING DEVICE FOR CONNECTING
A FAN BLADE TO A ROTOR OF A MOTOR OF
A CEILING FAN**

Matter enclosed in heavy brackets [] appears in the original patent but forms no part of this reissue specification; matter printed in italics indicates the additions made by reissue.

Notice: More than one reissue application has been filed for the reissue of U.S. Pat. No. 5,951,197. The reissue applications are application Ser. Nos. 11/388,362 (the present application) and 11/788,467, all of which are divisional reissues of U.S. Pat. No. 5,951,197, and application Ser. No. 09/952,421, now patent U.S. Pat. No. Re. 39,448, which is the reissue of U.S. Pat. No. 5,951,197.

BACKGROUND OF THE INVENTION

1. Field of the Invention

This invention relates to a connecting device for a ceiling fan, more particularly to a connecting device for connecting a fan blade to a rotor of a motor of a ceiling fan.

2. Description of the Related Art

Referring to FIG. 1, a conventional ceiling fan 10 is shown to comprise a motor casing 16 for housing a motor 12 which includes a stator 122 and a rotor 121 that is concentrically surrounded by the stator 122 and that is rotatable about an axial direction. A plurality of fan blades 13 are connected to the rotor 121 by mounting arms 11, respectively. Each mounting arm 11 has two plate-like connecting ends 111, 113 which are mounted respectively and securely on the rotor 121 and the corresponding fan blade 13 by means of screw fasteners 14, 15. It is inconvenient to assemble the fan blades 13 due to the use of the screw fasteners 14, 15.

To facilitate assembly of the ceiling fan, referring to FIGS. 2 and 3, another mounting arm 21 for the conventional ceiling fan is shown to have three coupling members 23 at one connecting end 212. Three mounting holes 25 are formed in the fan blade 24. Each mounting hole 25 has a notch portion 251 and a bore portion of a dimension larger than that of the notch portion 251 such that each coupling member 23 can be brought to fit snugly in the notch portion 251 of the respective mounting hole 25 by passing through the bore portion. A spring plate 22 is secured on the mounting arm 21 and has an engaging spring tongue 221 at one end thereof for abutting against the fan blade 24.

However, the assembly of the mounting arm 21 on the rotor (not shown) is still inconvenient to conduct. In addition, the mounting arm 21 involves increased packaging and transport costs.

SUMMARY OF THE INVENTION

The object of the present invention is to provide a connecting device which is easy to fabricate and which can permit substantial reductions in the packaging and transport costs thereof.

According to this invention, a connecting device includes a bottom member with a periphery for attaching on a rotor of a motor, a circumferential wall which extends upwardly from the periphery, and a mounting arm which has an anchored end for mounting the fan blade thereon, and an anchoring end for anchoring on the bottom member such that the mounting arm is oriented in a radial direction relative to the bottom member.

2

A tightening member is disposed between the anchoring end and the bottom member to tighten the anchoring end relative to the bottom member through a clamping force generated in a circumferential direction of the bottom member when the anchoring end is pulled away from the bottom member in the radial direction. A guiding member is disposed between the anchoring end and the bottom member to guide the anchoring end to move in the radial direction relative to the bottom member. A retaining member is disposed between the tightening member and the anchored end in the radial direction, and has an engaging spring member abutting against the circumferential wall once the anchoring end is moved away from the bottom member.

BRIEF DESCRIPTION OF THE DRAWINGS

Other features and advantages of the present invention will become apparent in the following detailed description of the preferred embodiments of the invention, with reference to the accompanying drawings, in which:

FIG. 1 is an exploded view of a conventional ceiling fan;

FIG. 2 is an exploded view of another connecting device for the conventional ceiling fan;

FIG. 3 is a perspective view of the assembly of the connecting device and the fan blade in FIG. 2;

FIG. 4 is an exploded view of a first preferred embodiment of a connecting device according to this invention;

FIG. 5 is an inverted perspective view showing how the first preferred embodiment connects a fan blade to a rotor;

FIG. 6 is a sectional view showing the first preferred embodiment of the connecting device with another retaining member;

FIG. 7 is an exploded view of a second preferred embodiment of a connecting device according to this invention;

FIG. 8 is an inverted perspective view showing how the second preferred embodiment interconnects the rotor and the fan blade; and

FIG. 9 is a sectional view showing the second preferred embodiment of the connecting device with another retaining member.

DETAILED DESCRIPTION OF THE PREFERRED EMBODIMENTS

Before the present invention is described in greater detail, it should be noted that same reference numerals have been used to denote like elements throughout the specification.

Referring to FIGS. 4 and 5, a first preferred embodiment of a connecting device according to the present invention is shown to be adapted to connect a fan blade 50 to a rotor 301 of a motor 30. The rotor 301 has a bottom member 30a which is disposed transverse to the axial direction, and which has two screw holes 31 formed therein adjacent to a periphery thereof. A circumferential wall extends upwardly from the periphery of the bottom member 30a and diverges upwardly so as to form an annular slanting wall 30b. An elongate mounting block 32 is mounted on the bottom member 30a, and has two through holes 322 such that two screw fasteners 33 respectively pass through the through holes 322 to engage threadedly the screw holes 31 so as to secure the mounting block 32 on the bottom member 30a. Two elongate grooves 321 are formed in the mounting block 32 at opposite ends thereof, and extend in the radial direction to pass through from an inner side distal to the periphery of the bottom member 30a to an outer side of the mounting block 32.

A mounting arm 40 includes a plate-like anchored end 43 which is adapted to be secured on an upper surface wall of the

fan blade 50, and an anchoring end 41 opposite to the anchored end 43 in the radial direction. The anchoring end 41 has two elongate rails 411, each of which extends in the radial direction to correspond with a respective one of the elongate grooves 321 so as to fit slidably in the respective elongate groove 321. Since each of the elongate grooves 321 and the elongate rails 411 extends in the radial direction, that is, a distance between the elongate grooves 321 is increased gradually from the inner side of the mounting block 32 to the outer side, a clamping force is generated to tighten each elongate rail 411 in the corresponding elongate groove 321 when the anchoring end 41 of the mounting arm 40 is pulled outwardly from the inner side of the mounting block 32 to the outer side. Thus, the anchoring end 41 can anchor tightly on the mounting block 32 to prevent further outward movement of the anchoring end 41 relative to the mounting block 32.

A retaining member 42 includes a spring plate 421 which is mounted on the mounting arm 40 at one end, and which has an engaging spring member or tongue 422 at the other end that extends toward the anchoring end 41. Thus, once the elongate rails 411 of the anchoring end 41 are moved in the elongate grooves 321 from the inner side toward the outer side, the engaging spring tongue 422 abuts against the annular slanting wall 30b and provides an upward biasing force thereto, thereby preventing movement of the anchoring end 41 inwardly relative to the mounting block 32.

Alternatively, referring to FIG. 6, instead of the retaining member 42, a biasing member 37 has an inner end which is secured to the bottom member 30a, an outer end which extends outwardly and downwardly and which has an engaging spring tongue 371 with a biasing force so as to abut against the anchoring end 41, and a middle portion 372 between the inner and outer ends. The bottom member 30a further has a concavity 36 which can receive the middle portion 372 when the biasing member 37 is bent against the biasing force thereof so as to be steered away from the anchoring end 41, thereby preventing the biasing member 37 from hindering the assembly of the anchoring end 41 to the mounting block 32.

As illustrated, the anchored end 43 of the mounting arm 40 and the mounting block 32 can be mounted respectively on the fan blade 50 and the bottom member 30a by operators in a manufacturing plant. There is no need to increase the size of the package, thereby reducing substantially the packaging and transport costs.

Subsequently, when it is desired to assemble the fan blade 50 on the bottom member 30a, the elongate rails 411 of the anchoring end 41 are moved in the elongate grooves 321 from the inner side toward the outer side in the radial direction. Then, the engaging spring tongue 422 (or 371) of the retaining member 42 (or the biasing member 37) abuts against the slanting wall 30b (or the anchoring end 30b) so as to retain firmly the anchoring end 41 to the mounting arm 32.

Referring to FIGS. 7 and 8, the second preferred embodiment of the connecting device according to this invention is shown to include a guiding member with two L-shaped elongate rails 34 which are disposed on the bottom member 30a adjacent to the periphery of the bottom member 30a to confine two elongate grooves respectively, and two inverted L-shaped elongate rails 44 which are disposed on the anchoring end 41 of the mounting arm 40 and which correspond to the elongate rails 34 to engage slidably the elongate grooves, respectively.

A tightening member includes a mounting hole 45 which is formed in the anchoring end 41 between the elongate rails 44, and an elastomeric coupling member 35 which is mounted securely on the bottom member 30a between the elongate rails 34 by a screw fastener 353. The mounting hole 45 is confined by an inner peripheral wall which has a constricted

portion 453 to divide the mounting hole 45 into a notch portion 452 and a bore portion 451 that is distal to the bottom member 30a and that has a dimension larger than that of the notch portion 452. The coupling member 35 includes a shank 351 which has an upper end for mounting on the bottom member 30a and a lower end that extends downward from the upper end, and a peripheral flange 352 which projects radially and outwardly from the lower end of the shank 351 and which has a dimension larger than that of the notch portion 452 and smaller than that of the bore portion 451. Thus, the coupling member 35 can fit snugly in the notch portion 452 by passing the shank 351 thereto after the peripheral flange 352 has been brought to pass through the bore portion 451.

In assembly, similar to the first preferred embodiment, the elongate rails 44 of the anchoring end 41 are fitted in the elongate grooves of the bottom member 30a outwardly to the periphery of the bottom member 30a. At the same time, the shank 351 of the coupling member 35 is moved to be fitted snugly in the notch portion 452, thereby retaining the anchoring end 41 to the bottom member 30a and avoiding further outward movement of the anchoring end 41 relative to the bottom member 30a by virtue of the inner peripheral wall of the notch portion 452.

In addition, with reference to FIGS. 8 and 9, a retaining member 42 and a biasing member 37 are disposed similar to those of the first preferred embodiment shown in FIGS. 5 and 6.

While the present invention has been described in connection with what is considered the most practical and preferred embodiments, it is understood that this invention is not limited to the disclosed embodiments but is intended to cover various arrangements included within the spirit and scope of the broadest interpretations and equivalent arrangements.

I claim:

[1. A connecting device for connecting a fan blade to a rotor of a motor of a ceiling fan, the motor including a stator and the rotor which is concentrically surrounded by the stator and which is rotated about an axial direction, said connecting device comprising:

- a bottom member with a periphery adapted to be attached on the rotor and spaced apart from the stator in the axial direction, said bottom member being disposed transverse to and being rotatable about the axial direction;
- a circumferential wall extending upwardly from said periphery toward the stator and diverging away from said bottom member so as to form an annular slanting wall;
- a mounting arm including an anchored end adapted for mounting the fan blade thereon, and an anchoring end disposed to be brought to anchor on said bottom member such that said mounting arm is oriented in a radial direction relative to said bottom member;
- means for tightening said anchoring end relative to said bottom member through a clamping force generated in a circumferential direction of said bottom member when said anchoring end is pulled away from said bottom member in said radial direction, said tightening means being disposed between said mounting arm and said bottom member;
- a guiding member disposed between said anchoring end and said bottom member to guide said anchoring end to move in said radial direction relative to said bottom member; and
- a retaining member disposed between said tightening means and said anchored end in said radial direction, and including an engaging spring member mounted on said mounting arm, said engaging spring member abutting

5

against said annular slanting wall and providing an upward biasing force to said annular slanting wall once said anchoring end is moved away from said bottom member in said radial direction.]

[2. The connecting device as claimed in claim 1, wherein said guiding member includes two elongate grooves formed in said bottom member, and two elongate rails disposed on said anchoring end and respectively corresponding to said elongate grooves so as to fit slidably in said elongate grooves.]

[3. The connecting device as claimed in claim 2, wherein each of said elongate grooves extends in said radial direction such that the clamping force is generated to tighten each of said elongate rails in a respective one of said elongate grooves when said anchoring end is pulled away from said bottom member in said radial direction.]

[4. The connecting device as claimed in claim 2, wherein said tightening means includes:

an inner peripheral wall formed on said anchoring end between said elongate rails, said inner peripheral wall confining a mounting hole, and having a constricted portion to divide said mounting hole into a notch portion and a bore portion, said bore portion being distal to said bottom member in said radial direction and having a dimension larger than that of said notch portion; and
a coupling member disposed on said bottom member between said elongate grooves, and including a shank having an upper end which is mounted on said bottom member and a lower end which extends downwardly from said upper end, and a peripheral flange projecting radially and outwardly from said lower end of said shank and of a dimension larger than that of said notch portion and smaller than that of said bore portion such that said coupling member is fitted snugly in said notch portion by passing said shank thereinto after said peripheral flange has been brought to pass through said bore portion.]

[5. The connecting device as claimed in claim 1, wherein said retaining member has an end disposed on said mounting arm adjacent to said anchoring end, and an opposite end extending toward said tightening means in said radial direction and formed with said engaging spring member that abuts against said annular slanting wall.]

[6. A connecting device for connecting a fan blade to a rotor of a motor of a ceiling fan, the motor including a stator and the rotor which is concentrically surrounded by the stator and which is rotated about an axial direction, said connecting device comprising:

a bottom member with a periphery adapted to be attached on the rotor and spaced apart from the stator in the axial direction, said bottom member being disposed transverse to and being rotated about the axial direction;
a circumferential wall extending upwardly from said periphery towards the stator and diverging away from said bottom member so as to form an annular slanting wall;
a mounting arm including an anchored end adapted for mounting the fan blade thereon, and an anchoring end disposed to be brought to anchor on said bottom member such that said mounting arm is oriented in a radial direction relative to said bottom member;

means for tightening said anchoring end relative to said bottom member through a clamping force generated in a circumferential direction of said bottom member when said anchoring end is pulled away from said bottom

6

member in said radial direction, said tightening means being disposed between said mounting arm and said bottom member;

a guiding member disposed between said anchoring end and said bottom member to guide said anchoring end to move in said radial direction relative to said bottom member; and

a biasing member disposed to bias said anchoring end away from said bottom member in said radial direction once said anchoring end has been brought toward said bottom member in said radial direction.]

[7. The connecting device as claimed in claim 6, wherein said guiding member includes two elongate grooves formed in said bottom member, and two elongate rails disposed on said anchoring end and respectively corresponding to said elongate grooves so as to fit slidably in said elongate grooves.]

[8. The connecting device as claimed in claim 7, wherein each of said elongate grooves extends in said radial direction such that the clamping force is generated to tighten each of said elongate rails in a respective one of said elongate grooves when said anchoring end is pulled away from said bottom member in said radial direction.]

[9. The connecting device as claimed in claim 7, wherein said tightening means includes:

an inner peripheral wall formed on said anchoring end between said elongate rails, said inner peripheral wall confining a mounting hole, and having a constricted portion to divide said mounting hole into a notch portion and a bore portion, said bore portion being distal to said bottom member in said radial direction and having a dimension larger than that of said notch portion; and
a coupling member disposed on said bottom member between said elongate grooves, and including a shank having an upper end which is mounted on said bottom member and a lower end which extends downwardly from said upper end, and a peripheral flange projecting radially and outwardly from said lower end of said shank and of a dimension larger than that of said notch portion and smaller than that of said bore portion such that said coupling member is fitted snugly in said notch portion by passing said shank thereinto after said peripheral flange has been brought to pass through said bore portion.]

[10. The connecting device as claimed in claim 6, wherein said biasing member has an inner end secured to said bottom member, an outer end extending outwardly in said radial direction inward said anchoring end of said mounting arm and having an engaging spring tongue to provide a biasing force for biasing said anchoring end away from said bottom member, and a middle portion between said inner and outer ends, said bottom member having a concavity adjacent to said guiding member for receiving said middle portion of said biasing member when said biasing member is bent against said biasing force thereof so as to permit said engaging spring tongue to be steered away from said anchoring end.]

11. A connecting device for connecting a fan blade to a motor of a ceiling fan comprising:

a motor mounting member under the motor;
a mounting arm including an anchored end adapted for mounting the fan blade thereon, and an anchoring end to anchor the arm to the motor mounting member such that said mounting arm is oriented in a radial direction relative to said motor;
a single mounting hole having a bore portion and a notch portion;

7

a single coupling member having a shank portion and a peripheral flange about an upper end of the coupling member, wherein said mounting arm is anchored to the motor by the coupling member and the single mounting hole when the mounting arm is pulled away from said motor in said radial direction;

a guiding member disposed between said anchoring end and said motor to guide said anchoring end to move in said radial direction relative to said bottom member, the guiding member having an elongated rail that slides within an elongated groove.

8

12. The connecting device of claim 11, wherein the elongated rail includes two parallel rails and the elongated groove includes two parallel grooves.

13. The connecting device of claim 11, wherein the single mounting hole is on the anchoring end of the mounting arm, and the single coupling member is attached underneath the motor.

14. The connecting device of claim 11, further comprising: a retaining member for retaining the mounting arm to the motor of the ceiling fan.

* * * * *