



US00D989858S

(12) **United States Design Patent** (10) **Patent No.:** **US D989,858 S**
Hattori et al. (45) **Date of Patent:** **** Jun. 20, 2023**

(54) **TEXTILE PRINTING MACHINE**
(71) Applicant: **BROTHER INDUSTRIES, LTD.,**
Nagoya (JP)
(72) Inventors: **Mitsuharu Hattori,** Nagoya (JP);
Tetsuro Kobayashi, Chiryu (JP);
Shuichi Tamaki, Nagoya (JP)
(73) Assignee: **BROTHER INDUSTRIES, LTD.,**
Nagoya (JP)
(**) Term: **15 Years**
(21) Appl. No.: **29/775,190**
(22) Filed: **Mar. 22, 2021**
(30) **Foreign Application Priority Data**
Oct. 16, 2020 (JP) 2020-022300 D
(51) **LOC (14) Cl.** **18-02**
(52) **U.S. Cl.**
USPC **D18/53**
(58) **Field of Classification Search**
USPC D18/40, 43, 46, 47, 48, 50, 53, 54, 55,
D18/56; D15/122, 135, 138; D14/307,
D14/314, 432
CPC . G06T 2207/30196; G06T 2207/30242; G06T
7/70; G06F 3/126; G06F 3/1284
See application file for complete search history.

(56) **References Cited**
U.S. PATENT DOCUMENTS
D389,178 S * 1/1998 Chow D18/50
D532,451 S * 11/2006 Ito D18/55

D566,170 S * 4/2008 Yonekawa D18/55
D566,757 S * 4/2008 Yonekawa D18/55
D640,737 S * 6/2011 Tsuruta D18/53
D667,871 S * 9/2012 Suzuki D18/50
D680,160 S * 4/2013 Egami D18/50
D788,214 S * 5/2017 Egami D18/50
D799,569 S * 10/2017 Cesar D15/122
D935,523 S * 11/2021 Cesar D18/53
D947,278 S * 3/2022 Cesar D18/53

OTHER PUBLICATIONS

Brother GTX Textile Printer, youtube.com,date published Dec. 22, 2017,date retrieved Jan. 10, 2023,U.S. Appl. No. 29/775,190—
<https://www.youtube.com/watch?v=5dAxvDCu1Vk> (Year: 2017).*

* cited by examiner

Primary Examiner — Nicole C Shiflet
Assistant Examiner — Danielle Nichole Bowly
(74) *Attorney, Agent, or Firm* — Oliff PLC

(57) **CLAIM**

The ornamental design for a textile printing machine, as shown and described.

DESCRIPTION

FIG. 1 is a perspective view of the textile printing machine; FIG. 2 is a front elevational view thereof; FIG. 3 is a rear elevational view thereof; FIG. 4 is a left-side elevational view thereof; FIG. 5 is a right-side elevational view thereof; FIG. 6 is a top plan view thereof; and, FIG. 7 is a bottom plan view thereof. The evenly spaced broken lines depict unclaimed parts of the textile printing machine and form no part of the claimed design.

1 Claim, 7 Drawing Sheets

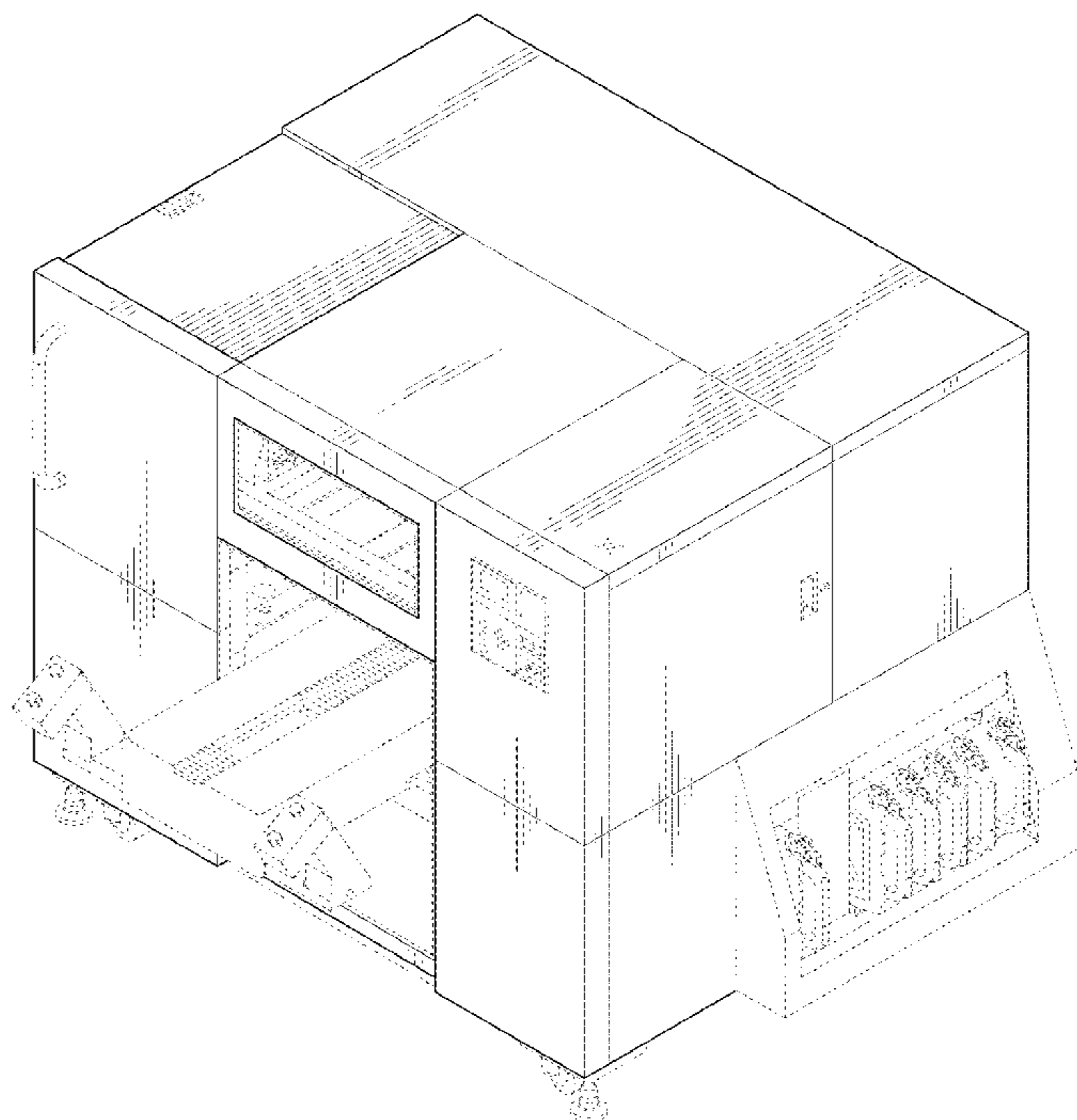

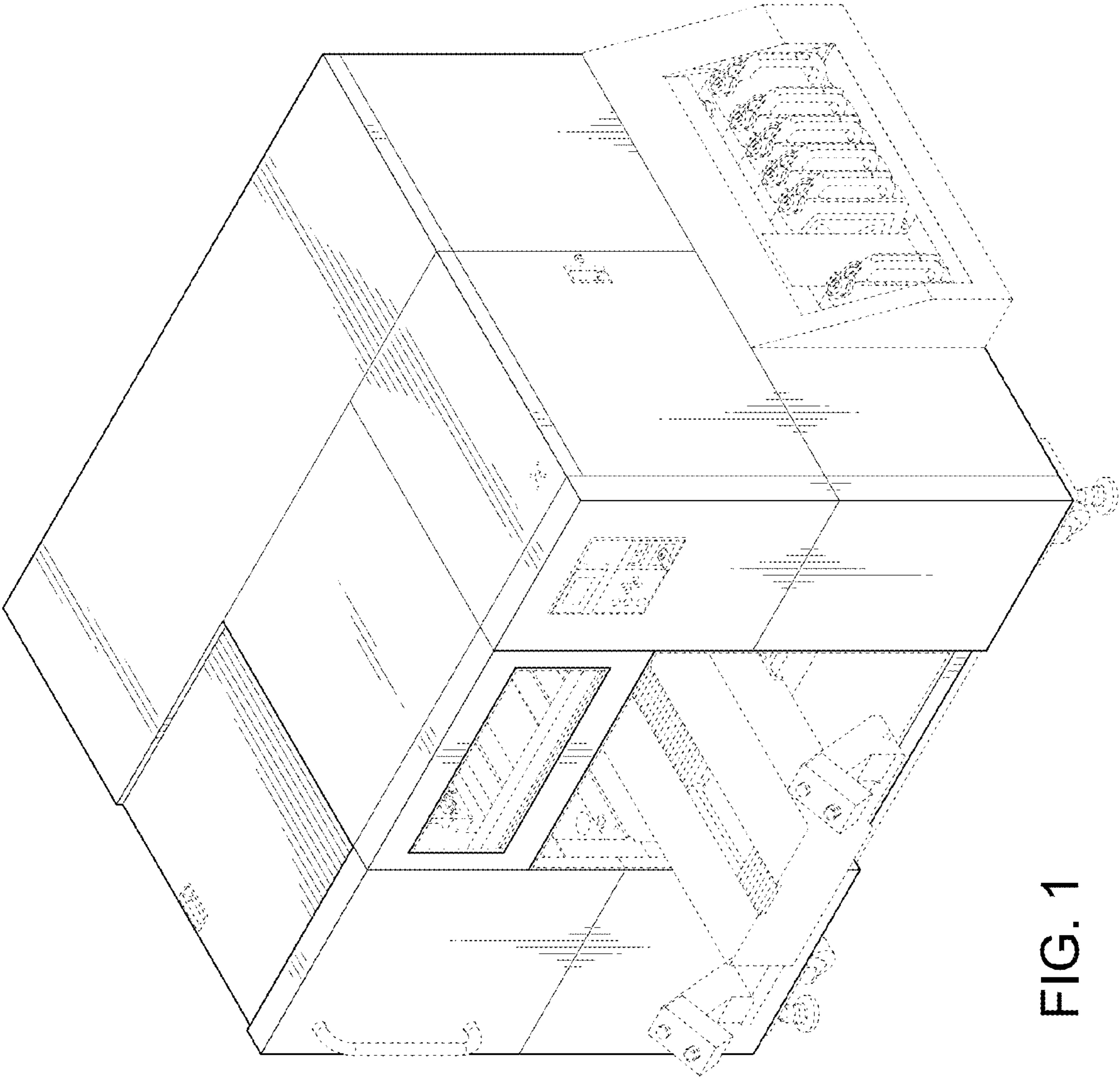

FIG. 1

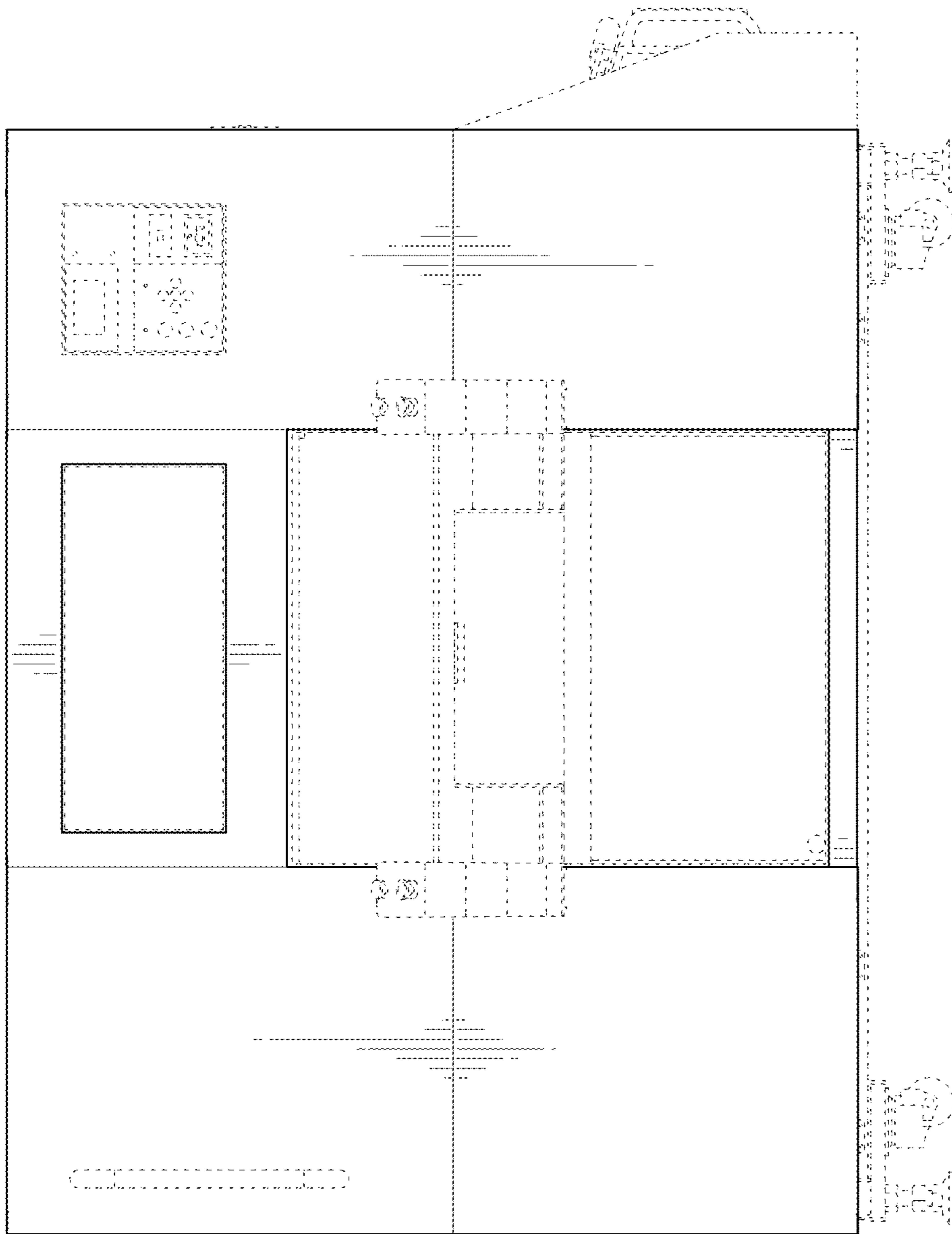

FIG. 2

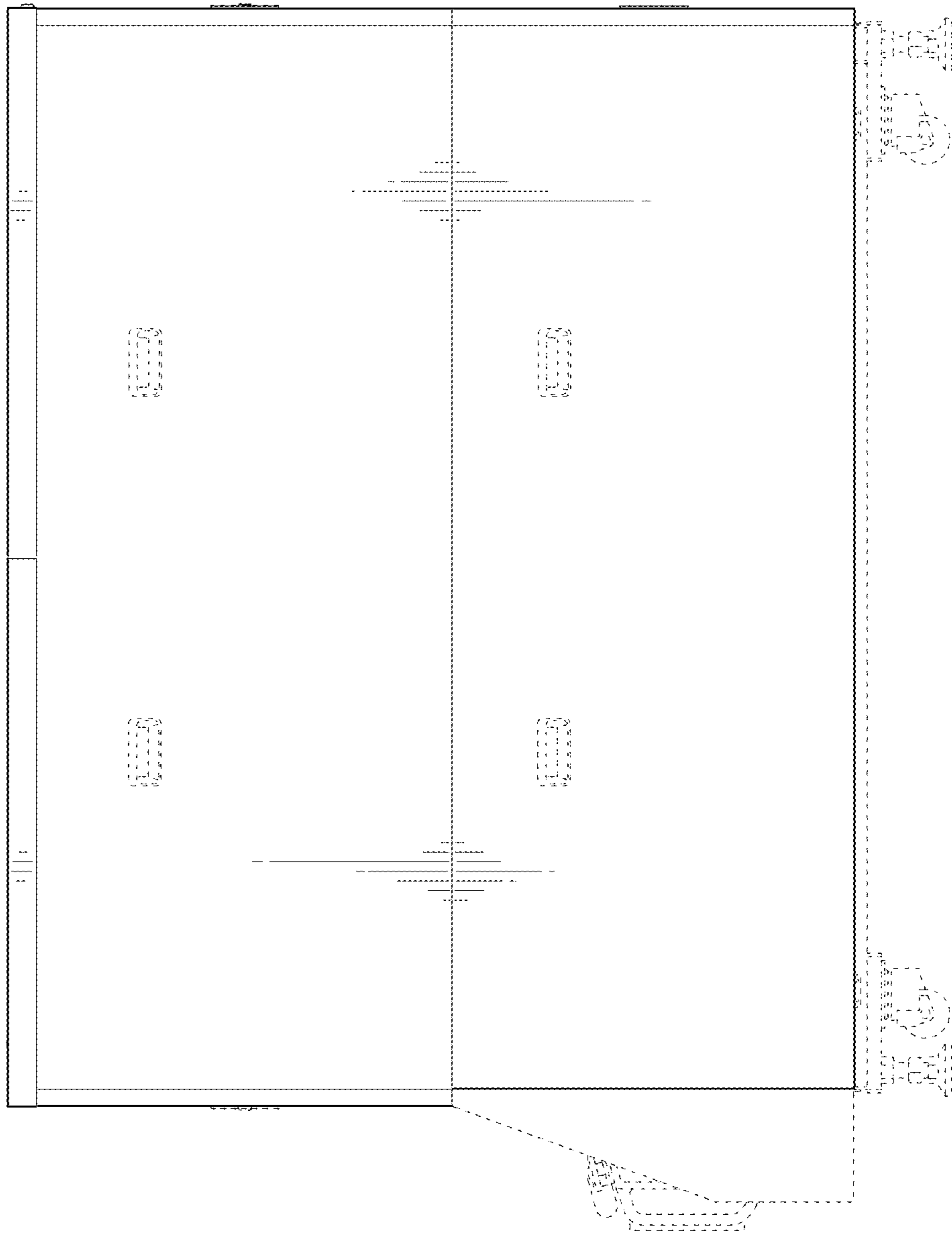

FIG. 3

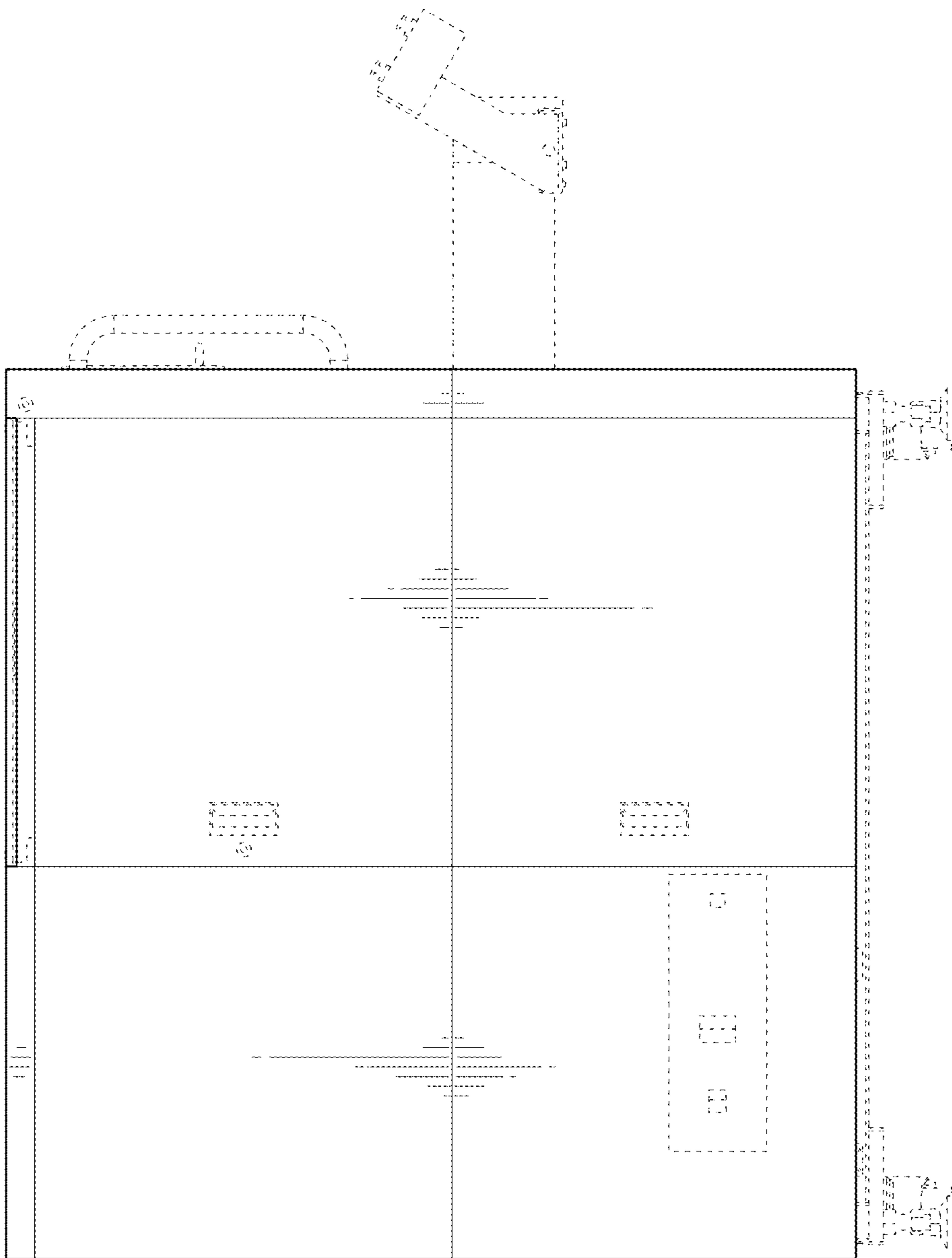

FIG. 4

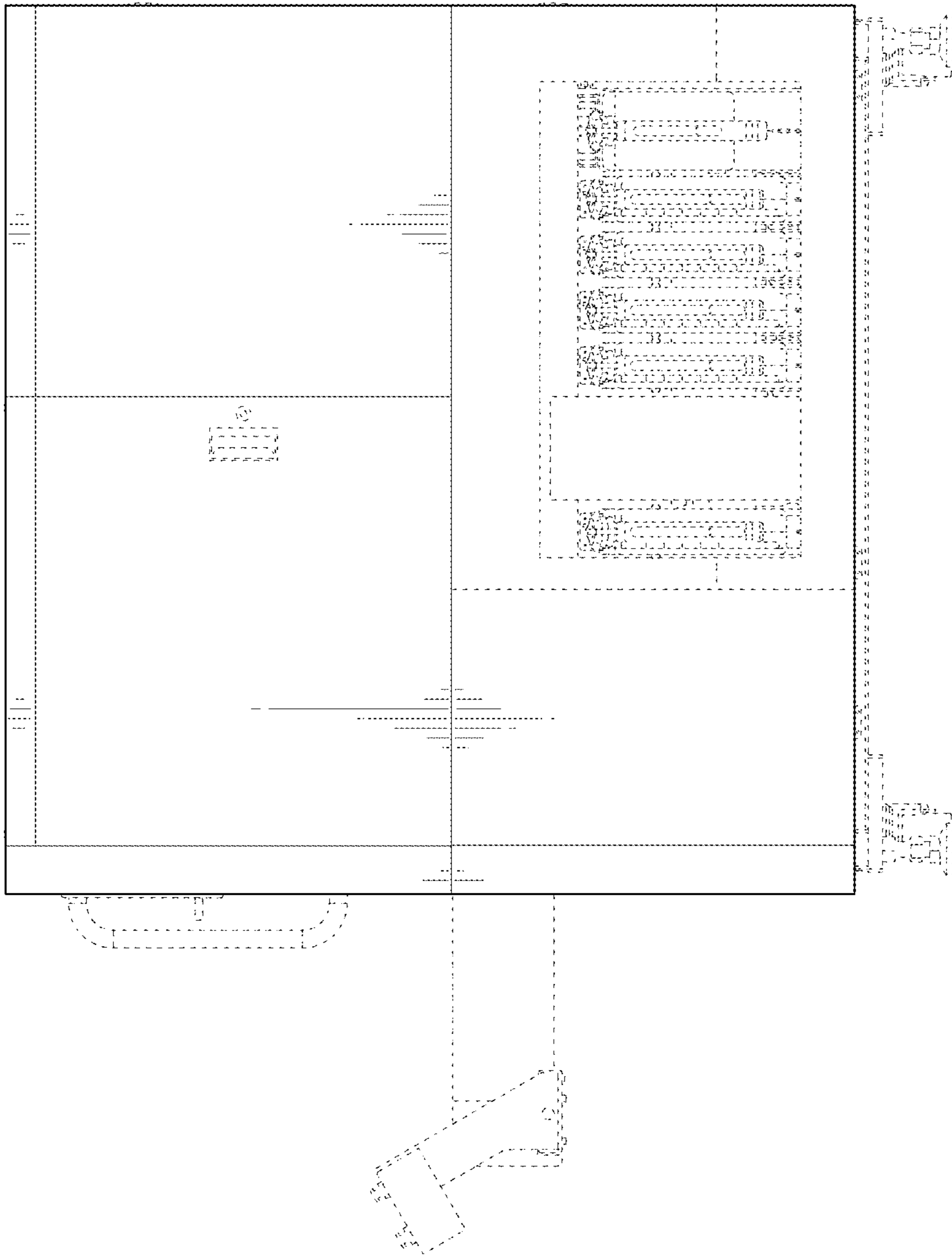

FIG. 5

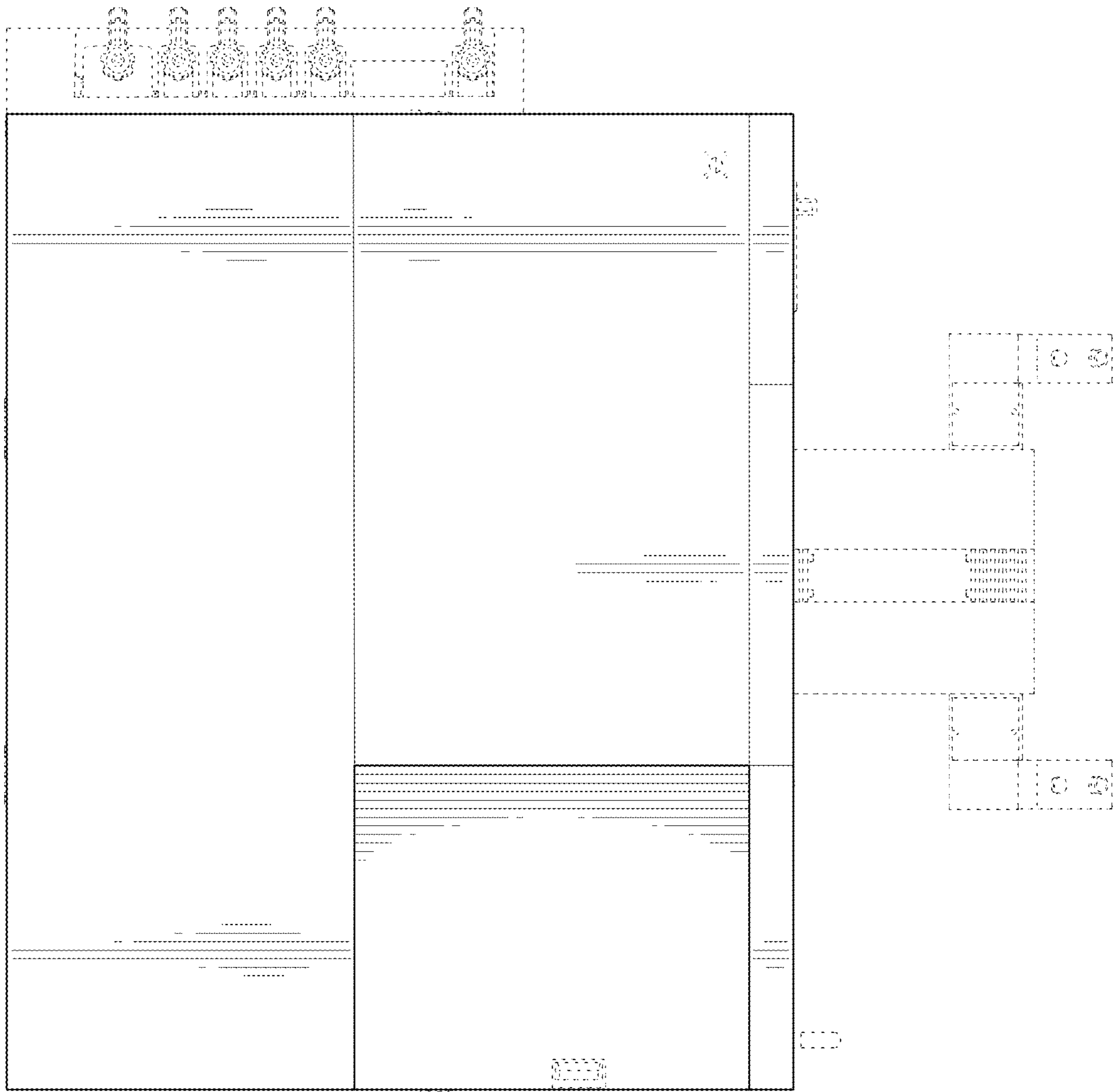

FIG. 6

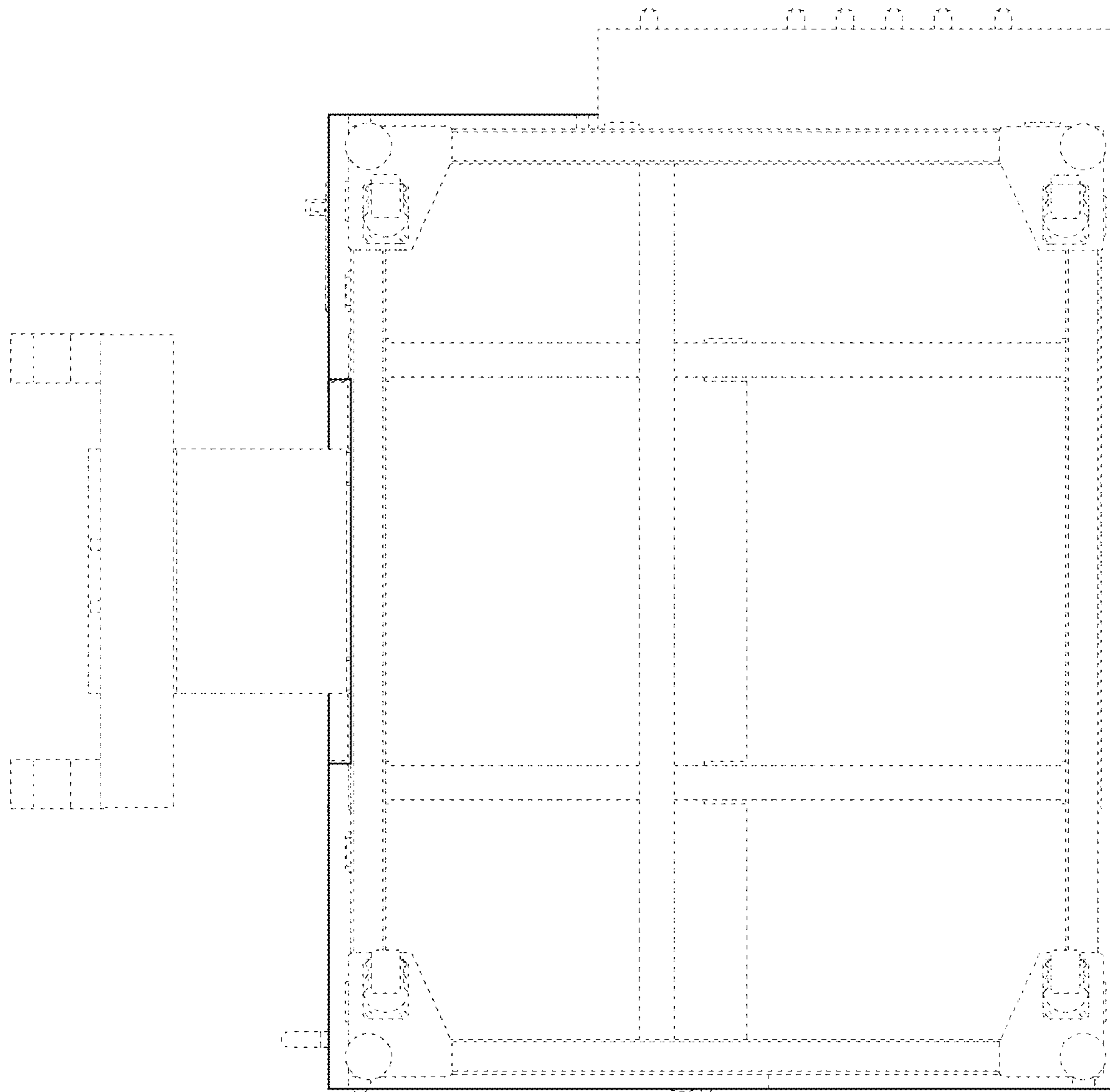

FIG. 7