



US00D988037S

(12) **United States Design Patent**
Tong

(10) **Patent No.:** **US D988,037 S**

(45) **Date of Patent:** **** Jun. 6, 2023**

(54) **CABINET**

(71) Applicant: **ZHEJIANG TIMECHEE INTERNATIONAL TRADE GROUP CO., LTD**, Ningbo (CN)

(72) Inventor: **Jiancheng Tong**, Ningbo (CN)

(**) Term: **15 Years**

(21) Appl. No.: **29/871,074**

(22) Filed: **Feb. 10, 2023**

(51) **LOC (14) Cl.** **06-04**

(52) **U.S. Cl.**
USPC **D6/657**

(58) **Field of Classification Search**
USPC D6/657, 660, 661, 662, 662.1, 663, 664, D6/668.1, 671, 671.1, 671.2, 671.3, D6/671.4, 672, 675, 675.1, 675.3; D23/286
CPC A47B 47/03; A47B 47/04; A47B 57/00; A47B 57/30; A47B 63/00; A47B 67/00; A47B 67/04; A47B 2220/03
See application file for complete search history.

(56) **References Cited**

U.S. PATENT DOCUMENTS

D249,992 S	*	10/1978	Adkinson	D6/660
D263,359 S	*	3/1982	Parrish, III	D6/661
D314,096 S	*	1/1991	Bush	D6/657
D346,914 S	*	5/1994	Wegener	D6/660
D357,598 S	*	4/1995	Keller	D6/660
D794,360 S	*	8/2017	Siekman	D6/662
D794,361 S	*	8/2017	Siekman	D6/662
D913,022 S		3/2021	Li		

OTHER PUBLICATIONS

Baudemont 31.5" Wide Display Stand, available in Wayfair.com, site visited on Mar. 24, 2023, URL:https://www.wayfair.com/furniture/pdp/ebern-designs-baudemont-display-stand-w010774533.html?piid= 1/ (Year: 2023).*

Shuangz 3 Tier Bookcase with Doors, available in Amazon.com, date first available of Oct. 9, 2021, site visited on Mar. 24, 2023, URL:https://www.amazon.com/SHUANGZ-Bookcase-Storage-Organizer-Standing/dp/B09J25PSP3 (Year: 2021).*

* cited by examiner

Primary Examiner — Mary Ann Calabrese

Assistant Examiner — Mark David Wolfley

(57) **CLAIM**

The ornamental design for a cabinet, as shown and described.

DESCRIPTION

FIG. 1 is a front, left, bottom perspective view of a cabinet, showing my new design;
FIG. 2 is a front view thereof;
FIG. 3 is a rear view thereof;
FIG. 4 is a left side view thereof;
FIG. 5 is a right side view thereof;
FIG. 6 is a top view thereof;
FIG. 7 is a bottom view thereof; and,
FIG. 8 is a front, right, bottom perspective view thereof, with the doors in an open position.
The broken lines in the drawings illustrate the portions of the cabinet, which form no part of the claimed design.

1 Claim, 8 Drawing Sheets

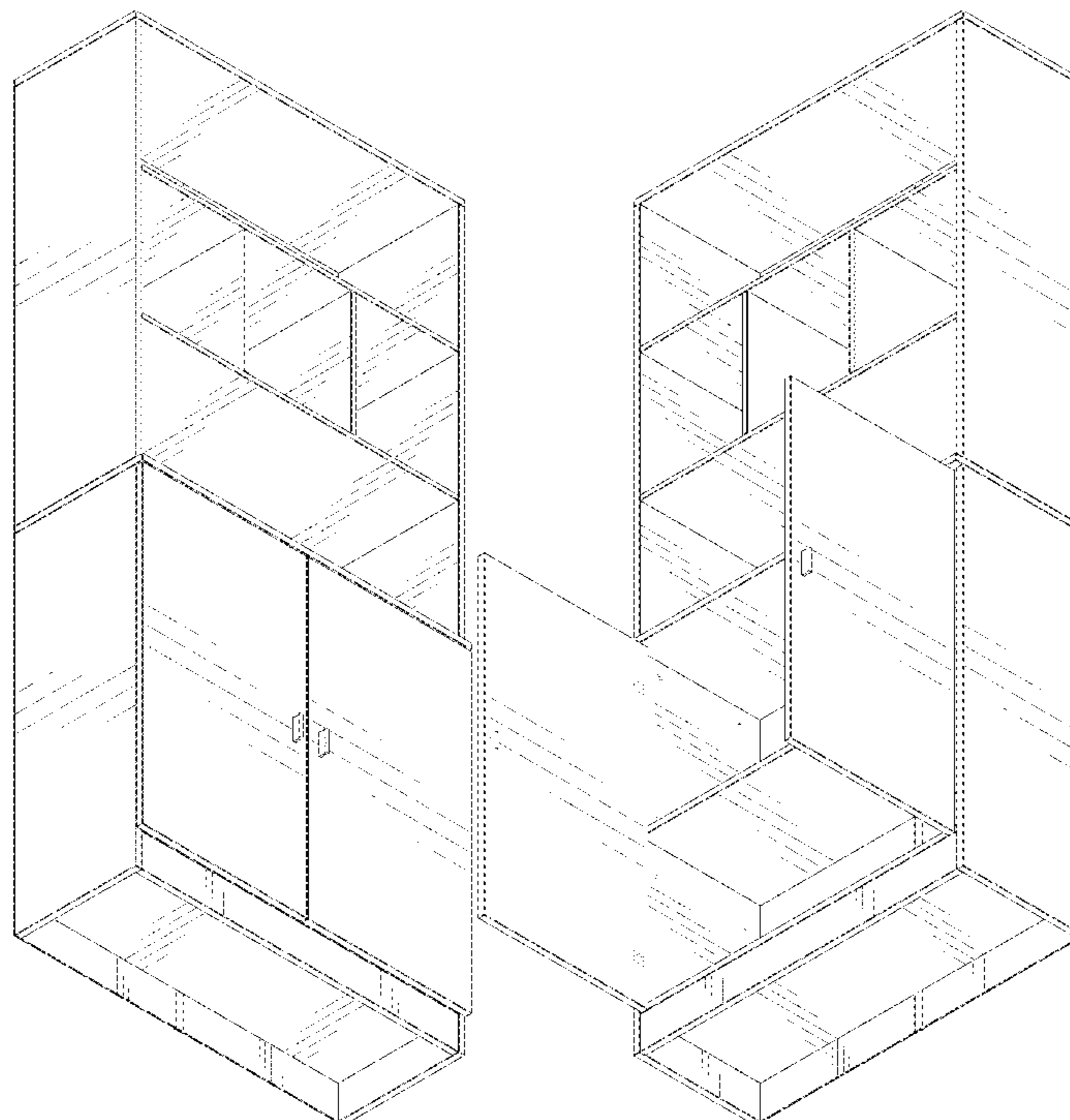

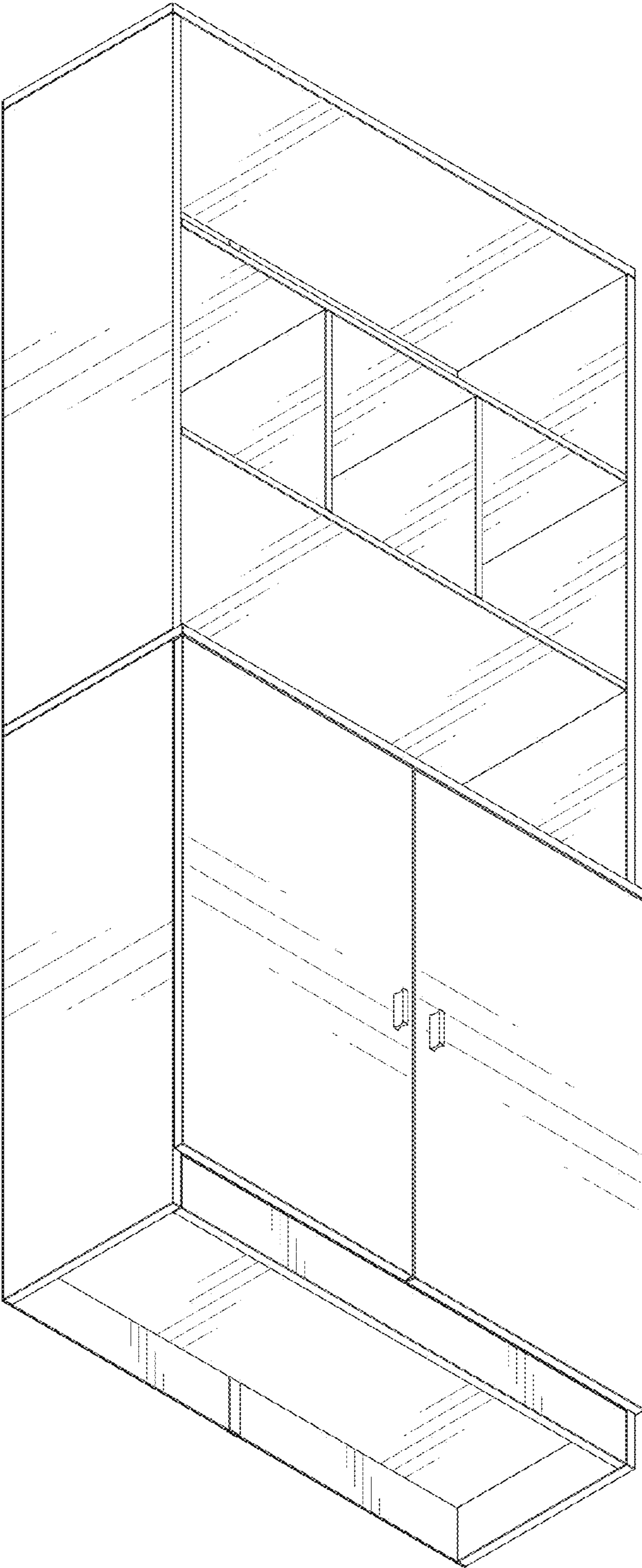

FIG. 1

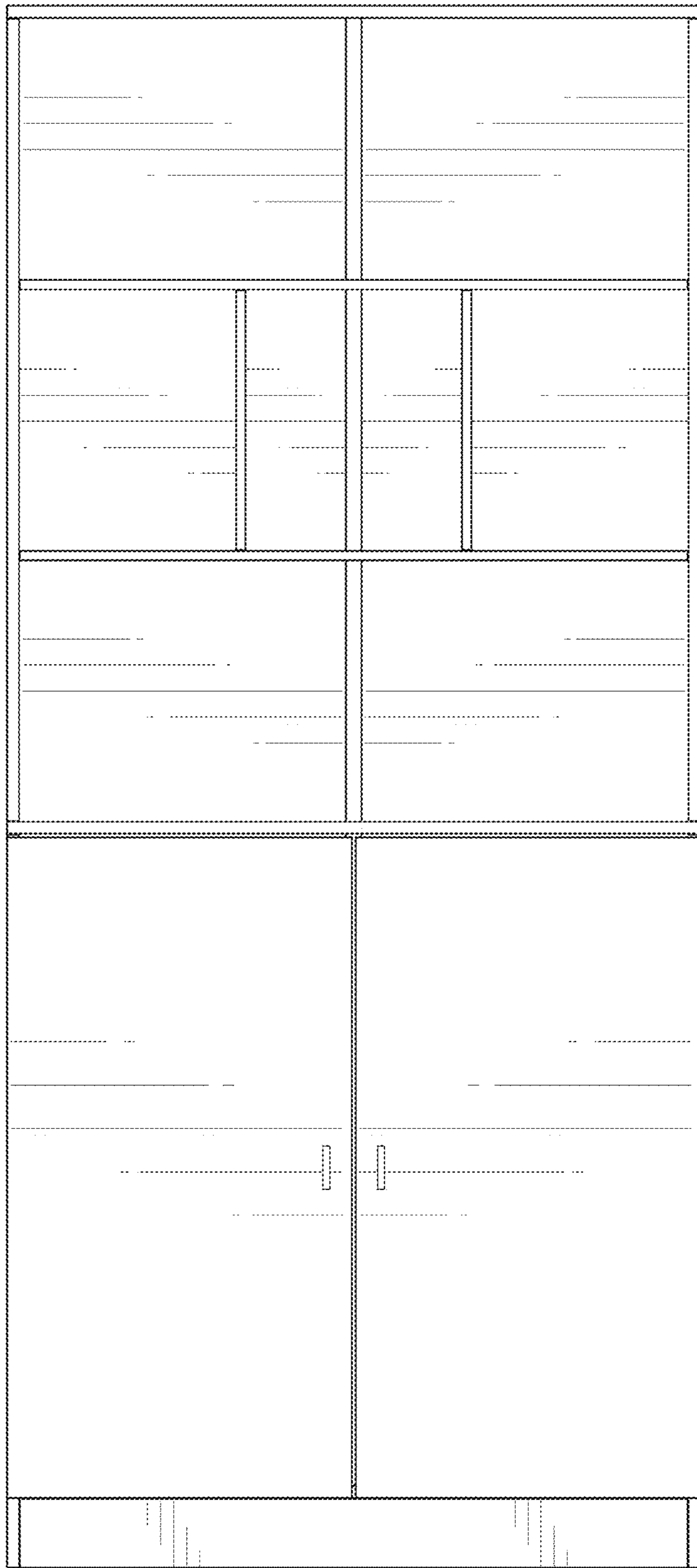

FIG. 2

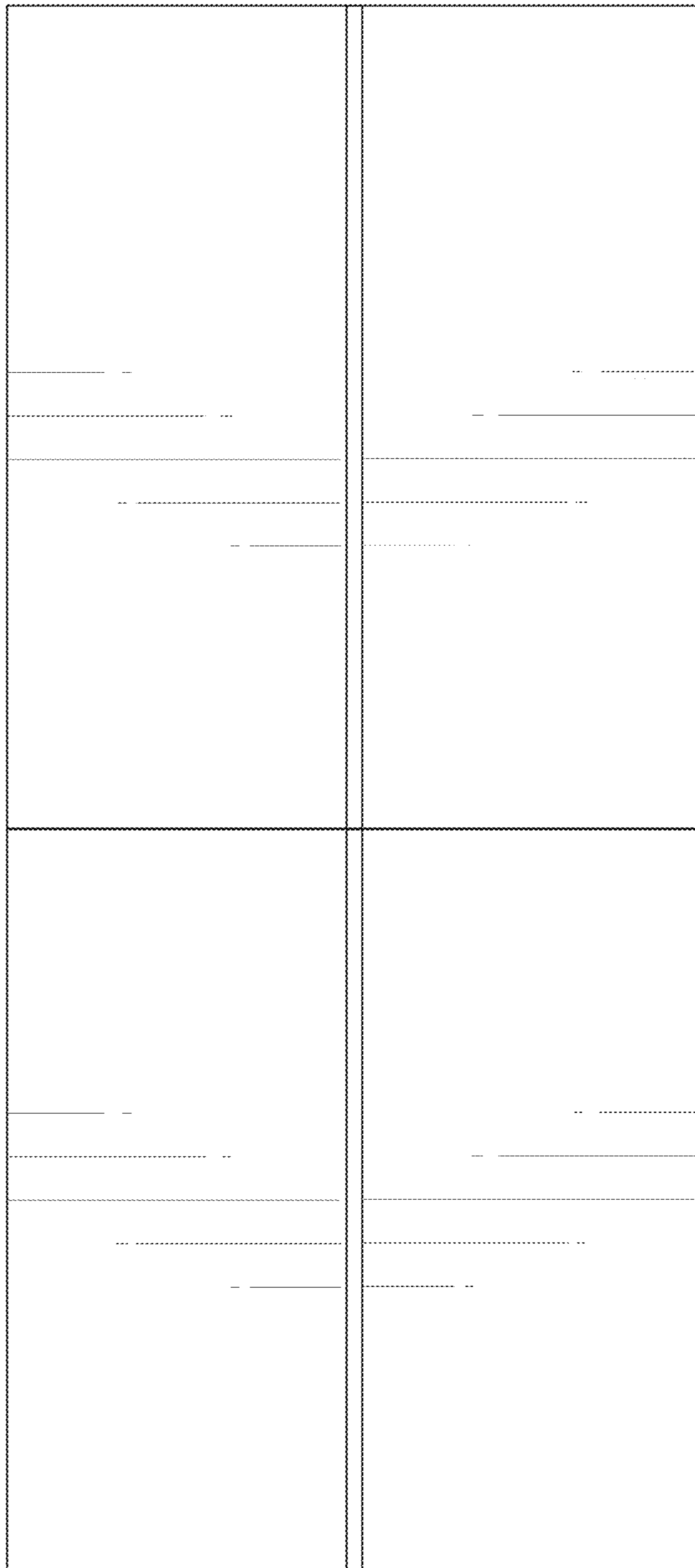

FIG. 3

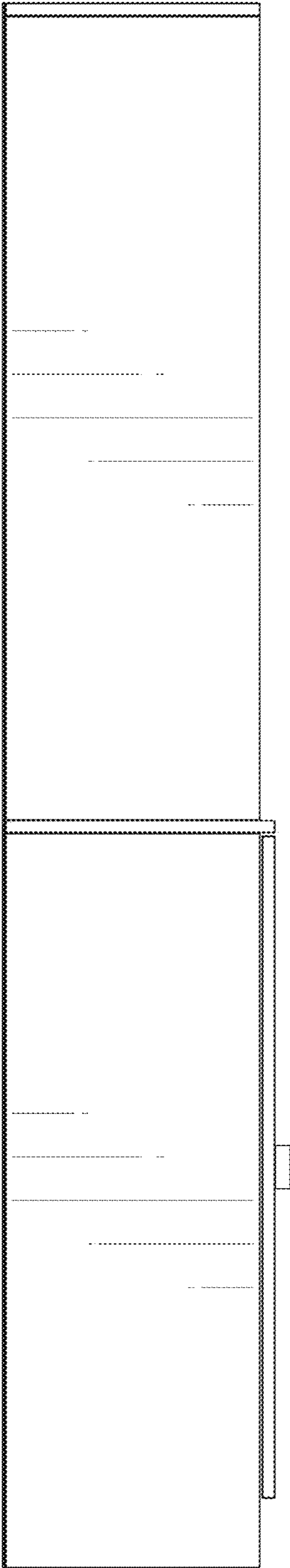

FIG. 4

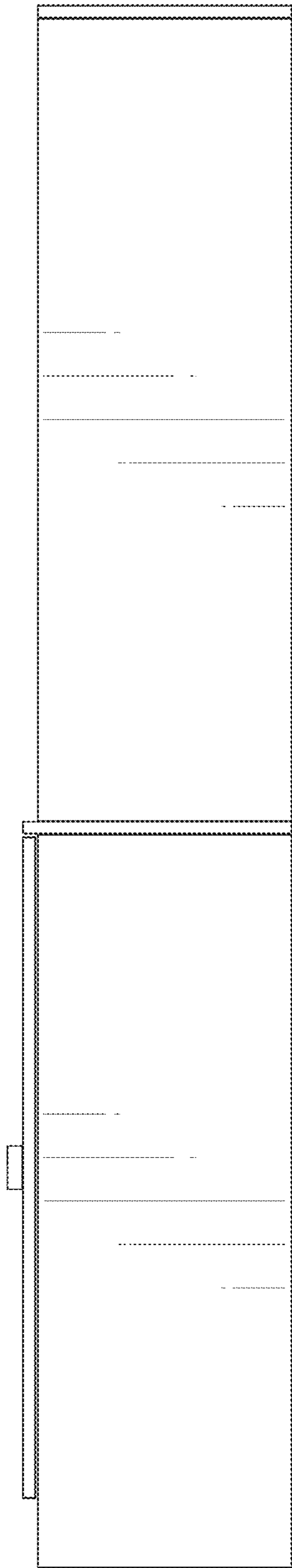

FIG. 5

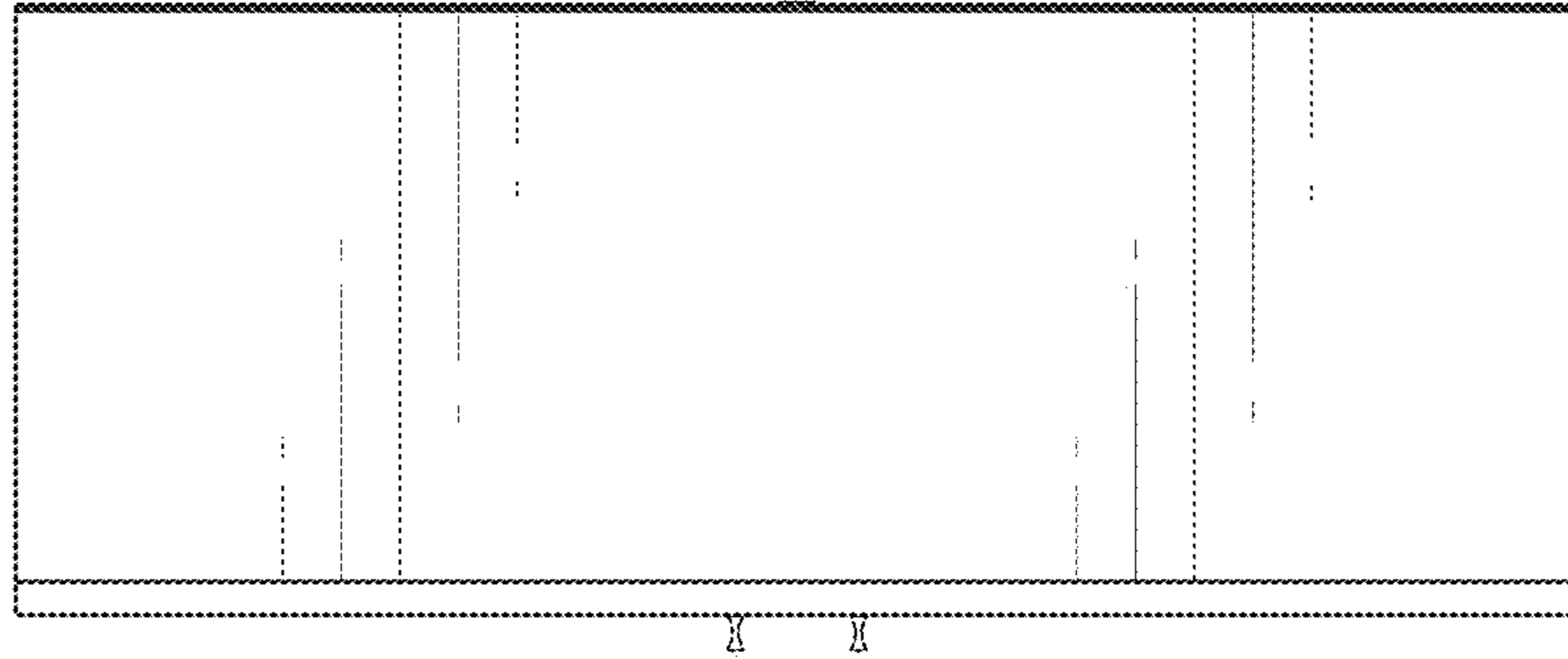

FIG. 6

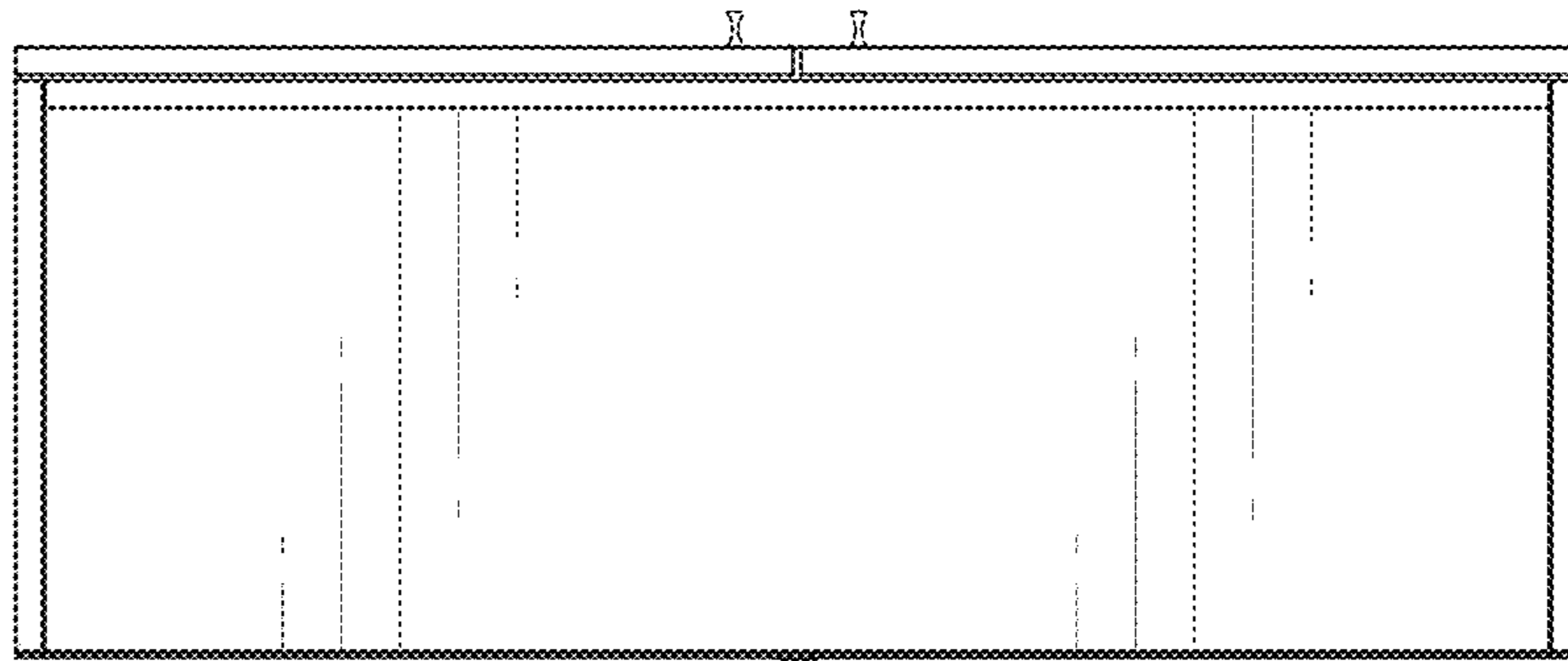

FIG. 7

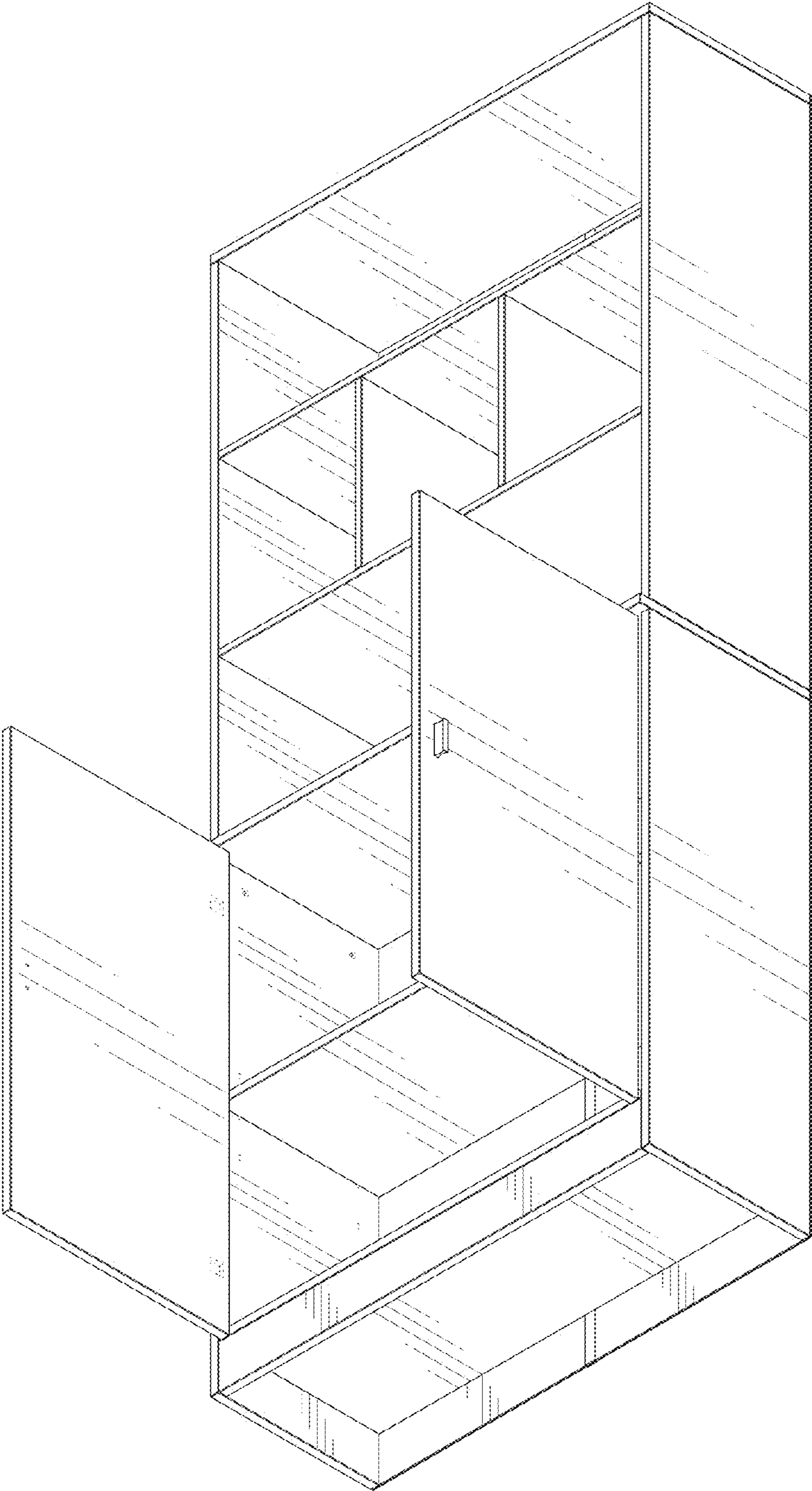

FIG. 8