



US00D987501S

(12) **United States Design Patent**  
**Willing et al.**

(10) **Patent No.:** **US D987,501 S**

(45) **Date of Patent:** **\*\* May 30, 2023**

(54) **VEHICLE FRONT LOWER BUMPER COVER**

(71) Applicant: **Ford Global Technologies, LLC,**  
Dearborn, MI (US)

(72) Inventors: **Todd Willing**, Grosse Pointe, MI (US);  
**Max Wolff**, Elsternwick (AU); **Max Tran**, Pascoe Vale (AU); **Leigh H. Cosentino**, Seddon (AU); **Tae Hoon Kang**, Essendon (AU); **Lee P. Imrie**, Bundoora (AU)

(73) Assignee: **Ford Global Technologies, LLC,**  
Dearborn, MI (US)

(\*\*) Term: **15 Years**

(21) Appl. No.: **29/814,427**

(22) Filed: **Nov. 5, 2021**

(51) **LOC (14) Cl.** ..... **12-16**

(52) **U.S. Cl.**  
USPC ..... **D12/169**

(58) **Field of Classification Search**  
USPC ..... D12/169, 196, 86, 90-92, 163, 190, 98,  
D12/164; 293/102, 113, 115, 117, 120,  
293/193.11; 296/180.1, 180.2  
CPC ..... B60R 19/02; B60R 19/04; B62D 25/08  
See application file for complete search history.

(56) **References Cited**

**U.S. PATENT DOCUMENTS**

D923,531 S \* 6/2021 Kaoud ..... D12/169  
D923,532 S \* 6/2021 Kaoud ..... D12/169

D925,412 S \* 7/2021 Ponomarenko ..... D12/169  
D930,525 S \* 9/2021 Lee ..... D12/169  
D945,331 S \* 3/2022 Koo ..... D12/169  
D947,731 S \* 4/2022 Hoste ..... D12/169  
D969,681 S \* 11/2022 Ruiz ..... D12/169  
D976,775 S \* 1/2023 Kaoud ..... D12/169

\* cited by examiner

*Primary Examiner* — Melody N Brown

(74) *Attorney, Agent, or Firm* — Vichit Chea

(57) **CLAIM**

The ornamental design for a vehicle front lower bumper cover, as shown and described.

**DESCRIPTION**

FIG. 1 is a front elevational view of a vehicle front lower bumper cover, showing our new design;  
FIG. 2 is a left side elevational view thereof;  
FIG. 3 is a right side elevational view thereof;  
FIG. 4 is a top plan view thereof;  
FIG. 5 is a bottom plan view thereof;  
FIG. 6 is a bottom, front and left side perspective view thereof; and,  
FIG. 7 is a top, front and left side perspective view thereof. The claimed design is indicated by the relatively dark portions in the figures. The de-emphasized and relatively light portions form no part of the claimed design.

**1 Claim, 7 Drawing Sheets**

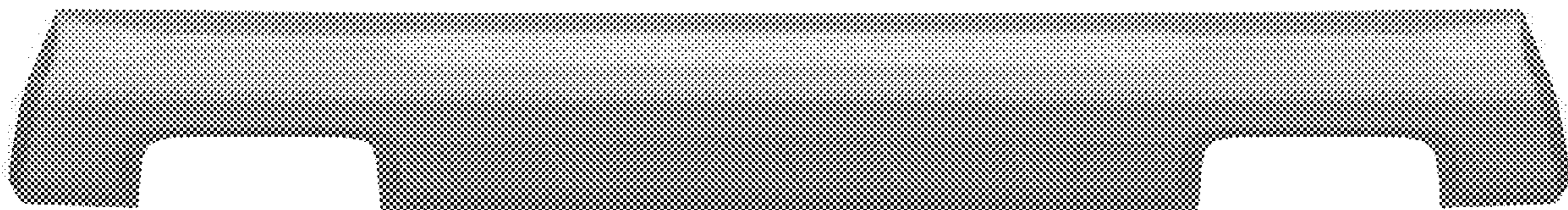

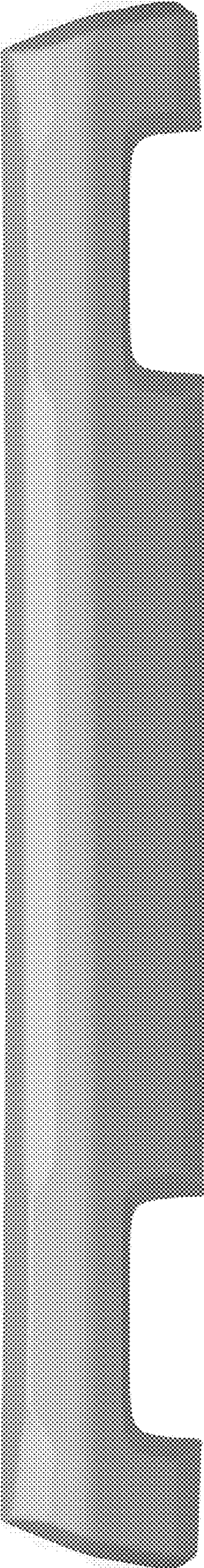

Fig. 1



Fig. 2

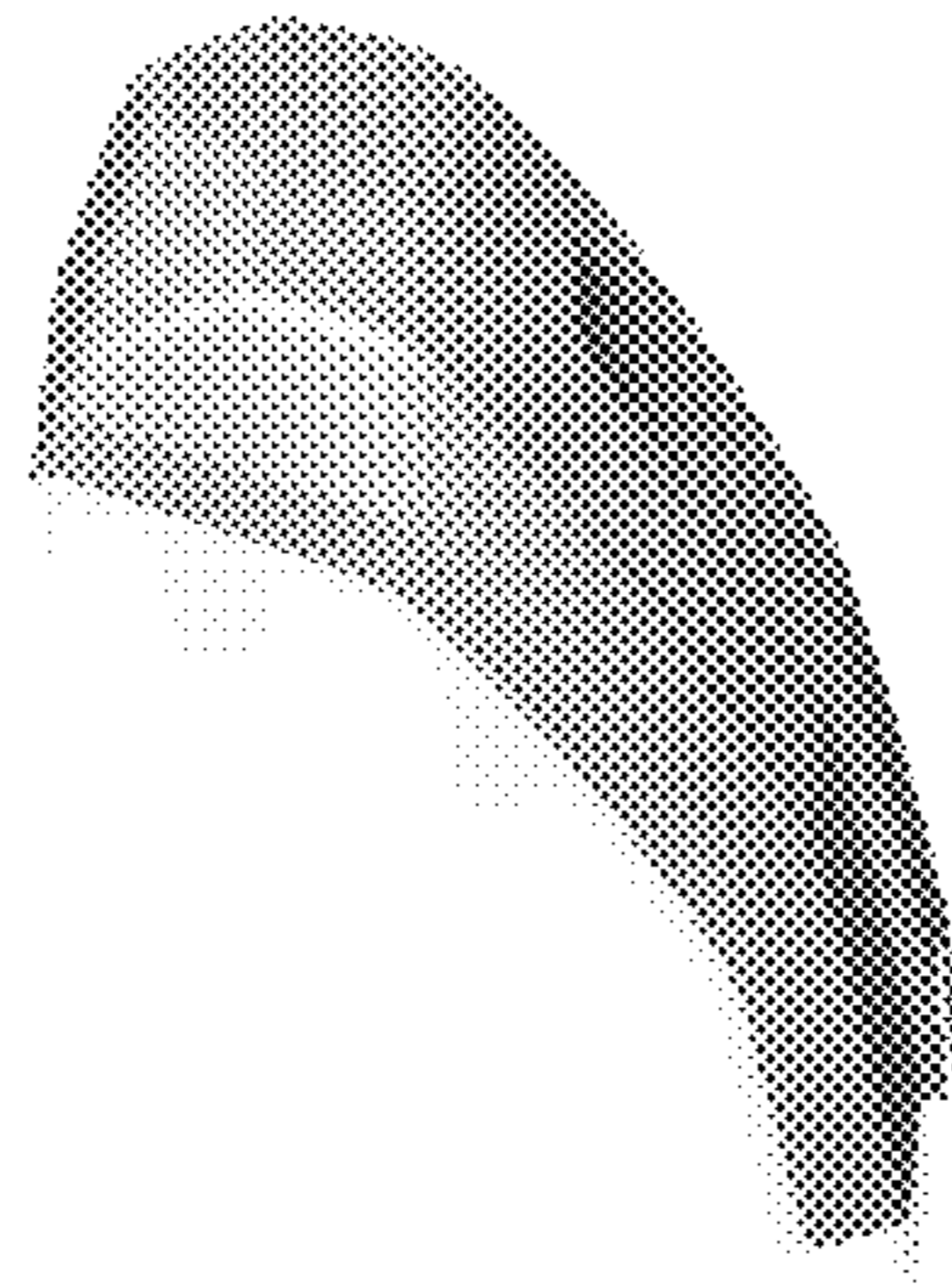

Fig. 3

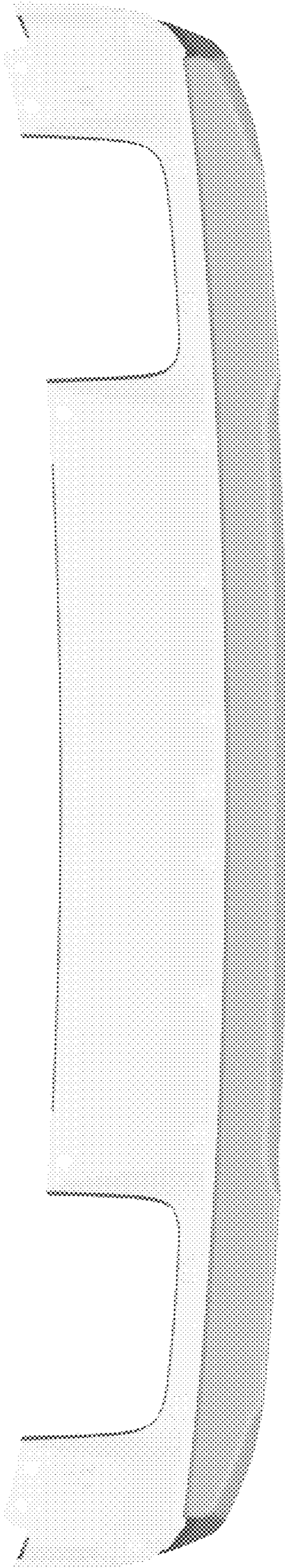

Fig.4

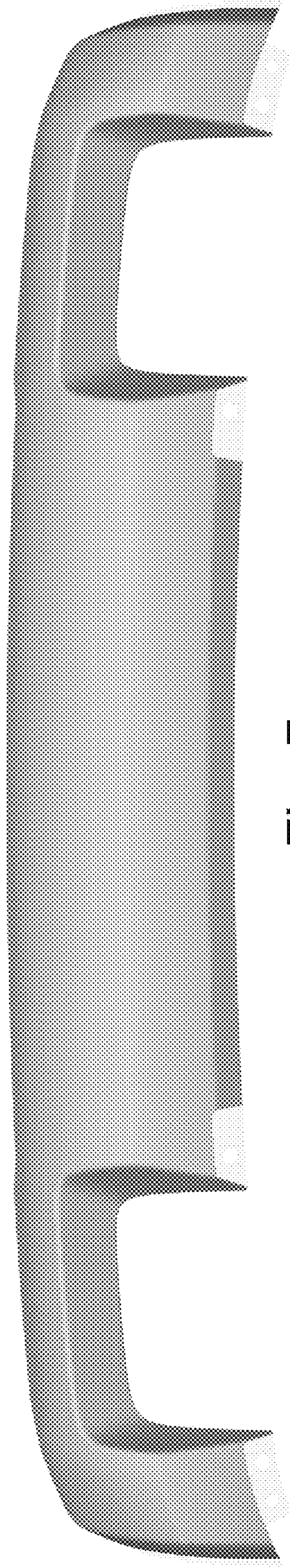

Fig. 5

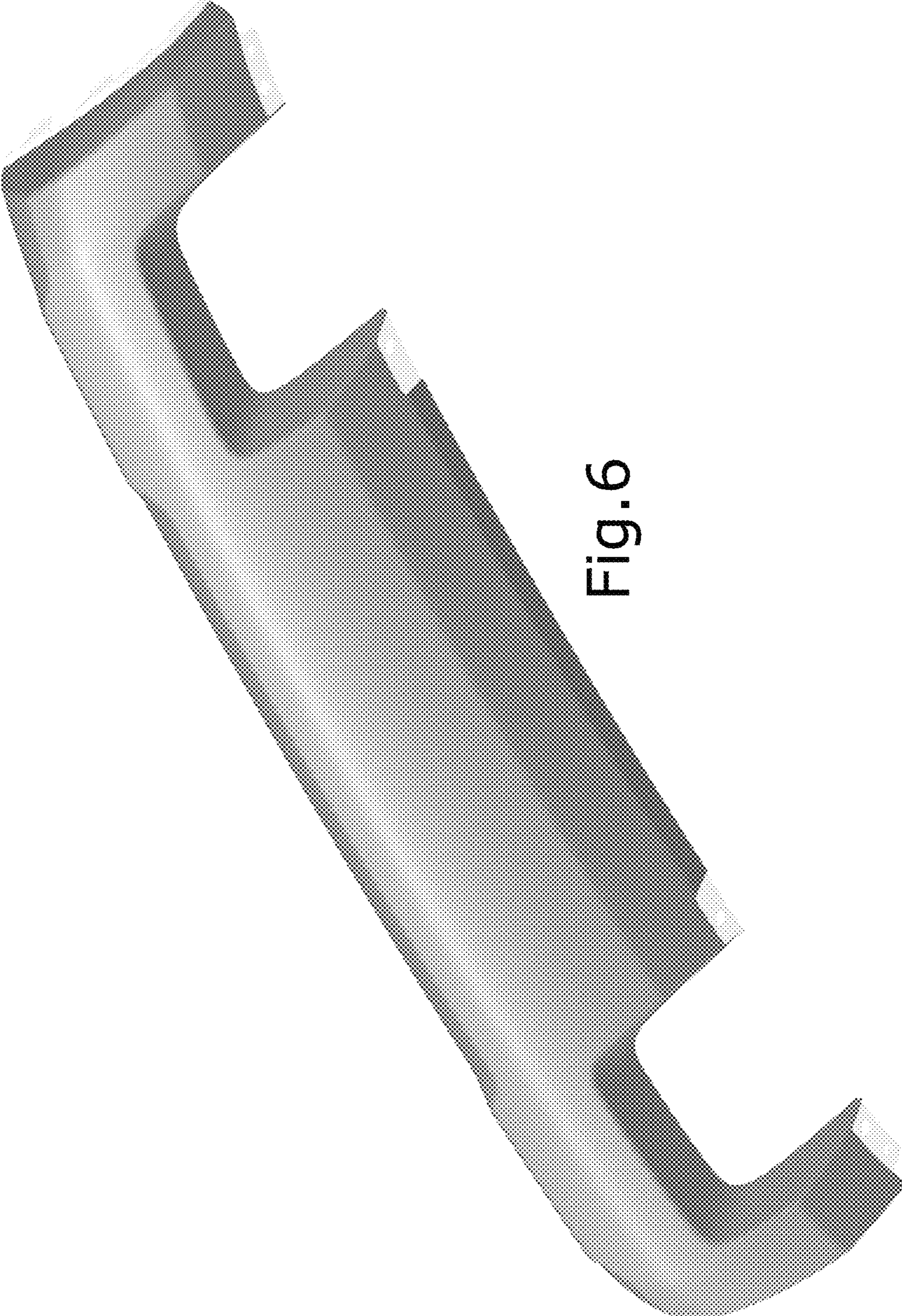

Fig. 6

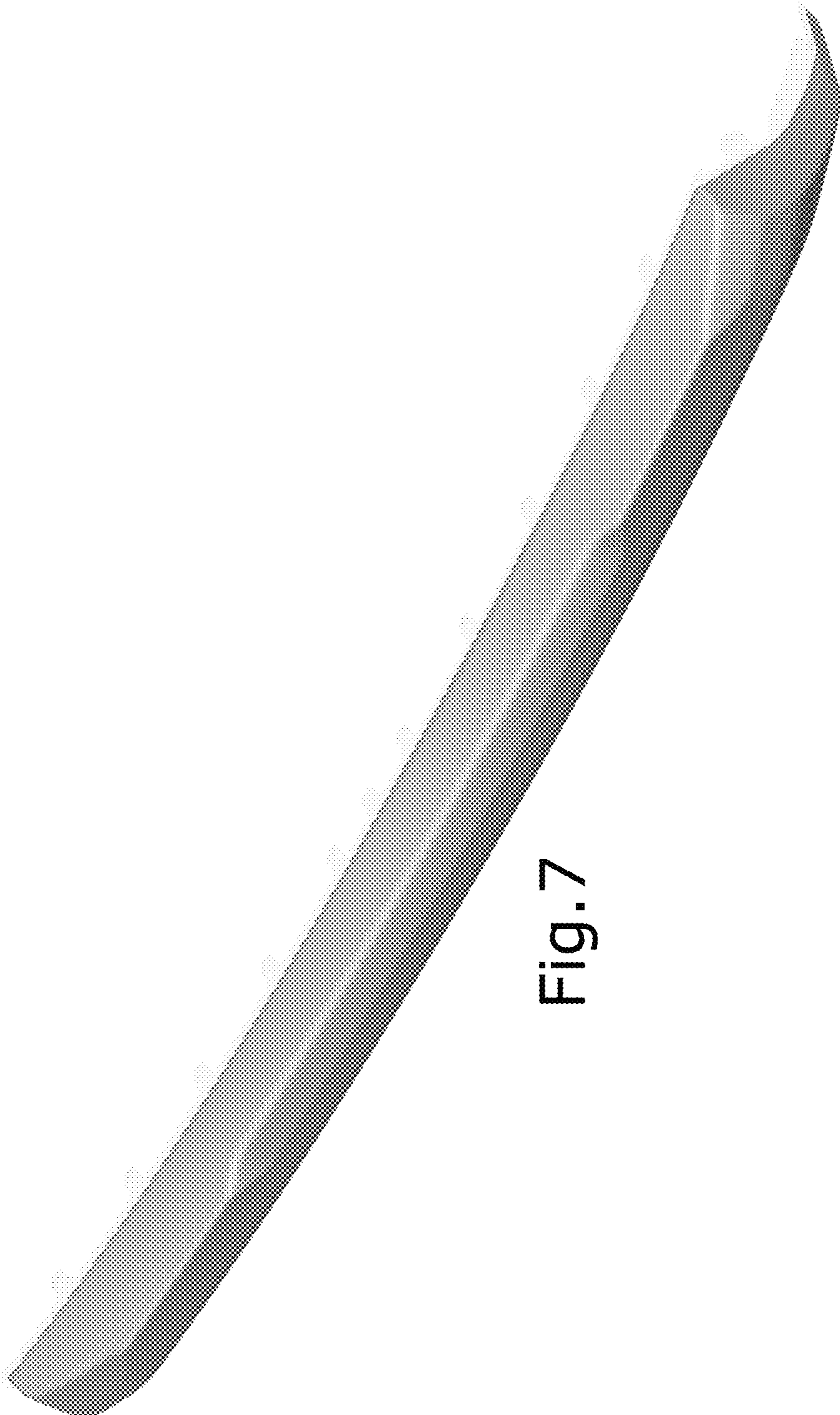

Fig. 7