



US00D986644S

(12) **United States Design Patent**  
**Tong**

(10) **Patent No.:** **US D986,644 S**  
(45) **Date of Patent:** **\*\* May 23, 2023**

(54) **CABINET**

(71) Applicant: **ZHEJIANG TIMECHEE INTERNATIONAL TRADE GROUP CO., LTD**, Ningbo (CN)

(72) Inventor: **Jiancheng Tong**, Ningbo (CN)

(\*\*) Term: **15 Years**

(21) Appl. No.: **29/871,072**

(22) Filed: **Feb. 10, 2023**

(51) **LOC (14) Cl.** ..... **06-04**

(52) **U.S. Cl.**  
USPC ..... **D6/657**

(58) **Field of Classification Search**  
USPC ..... D6/657, 660, 661, 662, 662.1, 663, 664, D6/668.1, 671.1, 671.2, 671.3, 671.4, D6/672, 675, 675.1, 675.3; D23/286  
CPC ..... A47B 47/03; A47B 47/04; A47B 57/00; A47B 57/30; A47B 63/00; A47B 67/00; A47B 67/04; A47B 2220/03

See application file for complete search history.

(56) **References Cited**

**U.S. PATENT DOCUMENTS**

D249,992 S	*	10/1978	Adkinson	.....	D6/660
D263,359 S	*	3/1982	Parrish, III	.....	D6/661
D314,096 S	*	1/1991	Bush	.....	D6/657
D346,914 S	*	5/1994	Wegener	.....	D6/660
D357,598 S	*	4/1995	Keller	.....	D6/660
D794,360 S	*	8/2017	Siekman	.....	D6/662
D794,361 S	*	8/2017	Siekman	.....	D6/662
D923,977 S		7/2021	Xiao		

**OTHER PUBLICATIONS**

Design 307656473, application date Sep. 10, 2022, country code CN, publication date Nov. 15, 2022, owner Zhejiang fuming weiertai Furniture Co Ltd, creator Zhou Yibin (Year: 2022).\*  
LXingStore 71\_ Bookcase with Doors, available in Amazon.com, oldest review date of Jan. 24, 2019, site visited on Mar. 21, 2023, URL: <https://www.walmart.com/ip/LXingStore-71-Bookcase-Doors-38-x-11-8-71-Inch-Storage-Organizer-Cabinet-4-Open-Shelves-Tall-Book-Shelf-Free-Stan...> (Year: 2019).\*  
Mercury Row® Brandi, available in wayfair.com, review date of Nov. 4, 2022, site visited on Mar. 21, 2023, URL: <https://www.wayfair.com/furniture/pdp/mercury-row-brandi-71-h-x-35-w-standard-bookcase-w007762396.html?piid=> (Year: 2022).\*

\* cited by examiner

*Primary Examiner* — Mary Ann Calabrese  
*Assistant Examiner* — Mark David Wolfley

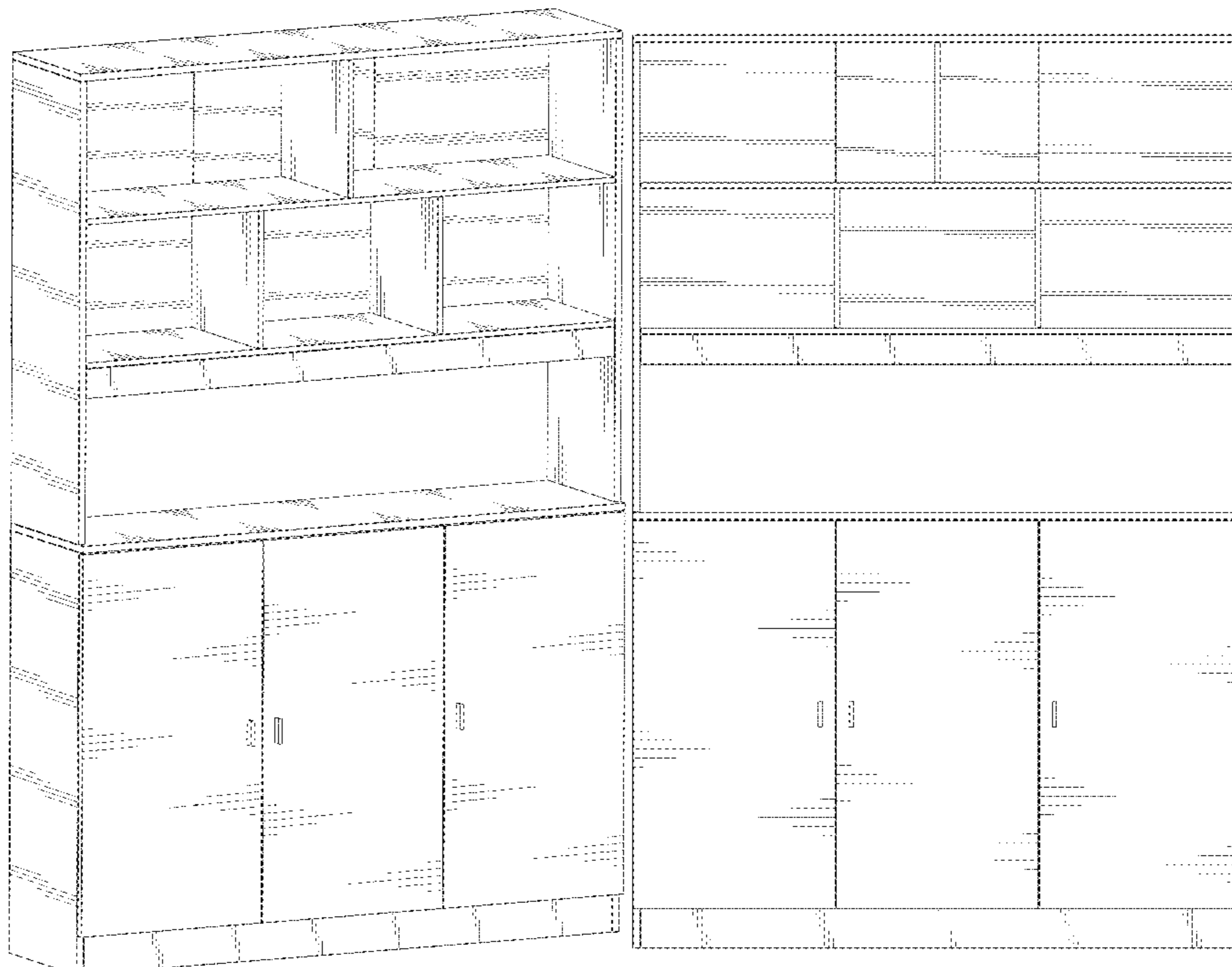
(57) **CLAIM**

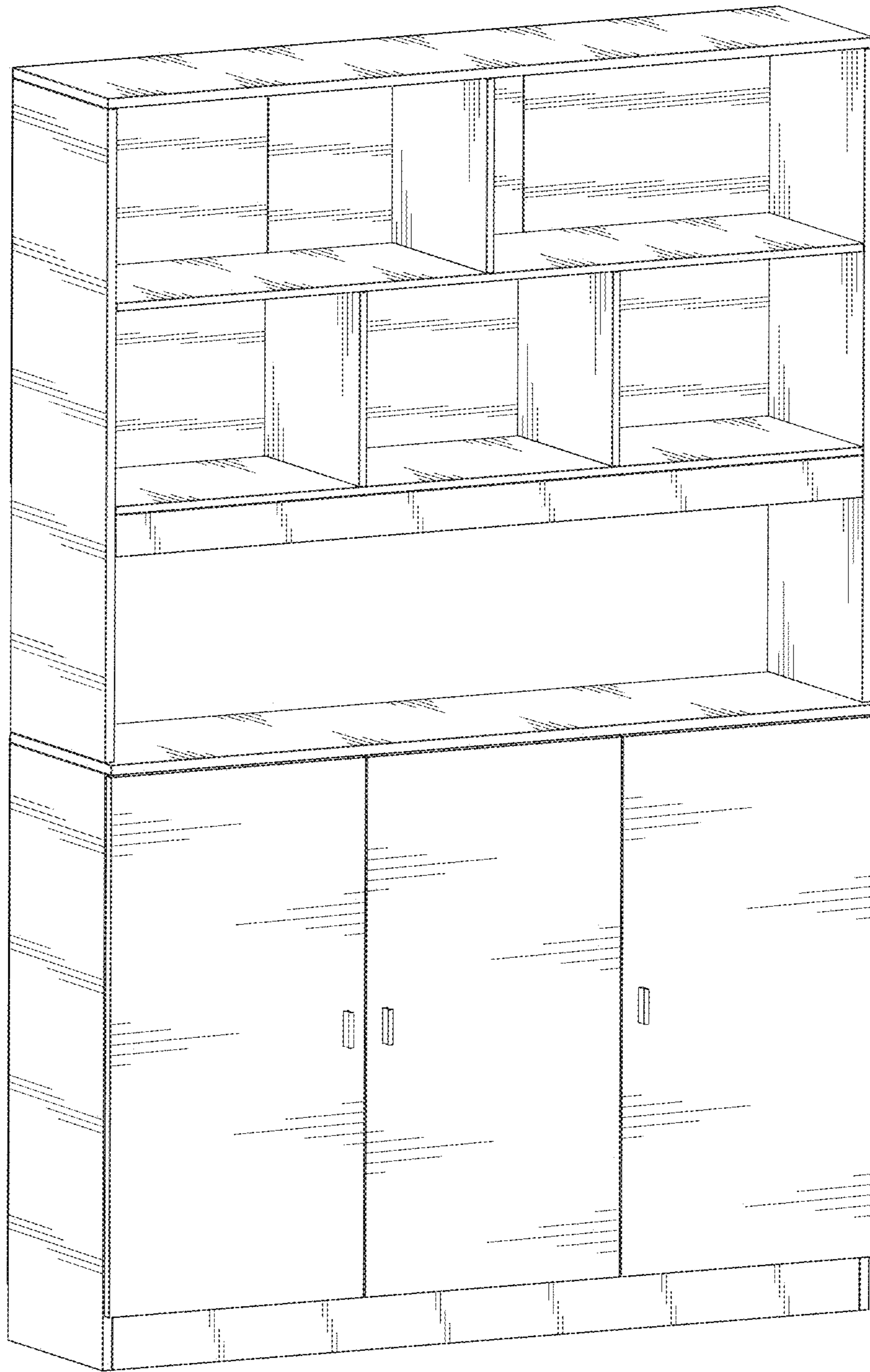
The ornamental design for a cabinet, as shown and described.

**DESCRIPTION**

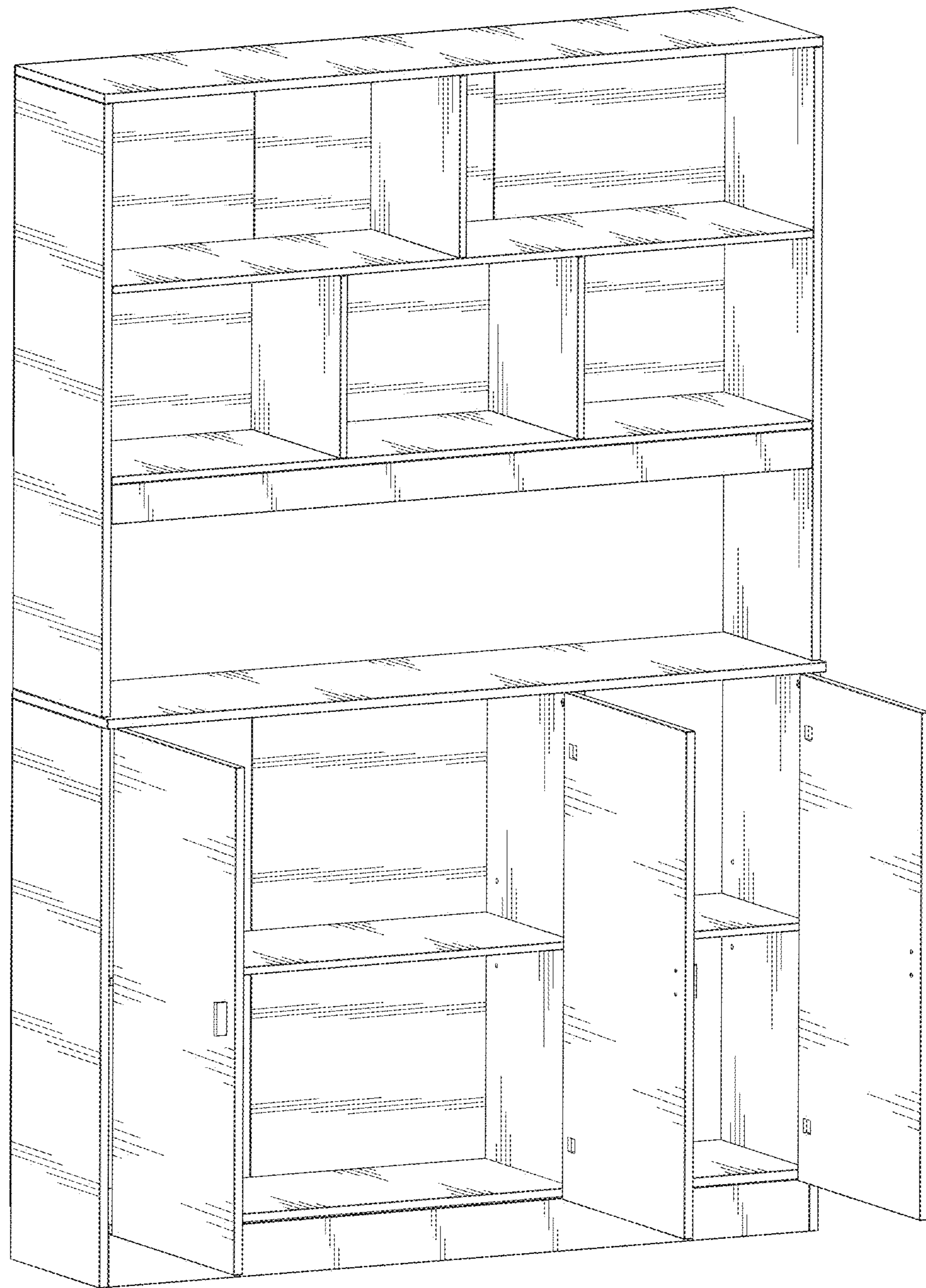
FIG. 1 is a front, top, left side perspective view of a cabinet, showing my new design;  
FIG. 2 is a front, top, left side perspective view thereof, with the doors in an alternate open position;  
FIG. 3 is a front view thereof;  
FIG. 4 is a rear view thereof;  
FIG. 5 is a left side view thereof;  
FIG. 6 is a right side view thereof;  
FIG. 7 is a top view thereof; and,  
FIG. 8 is a bottom view thereof.

**1 Claim, 8 Drawing Sheets**



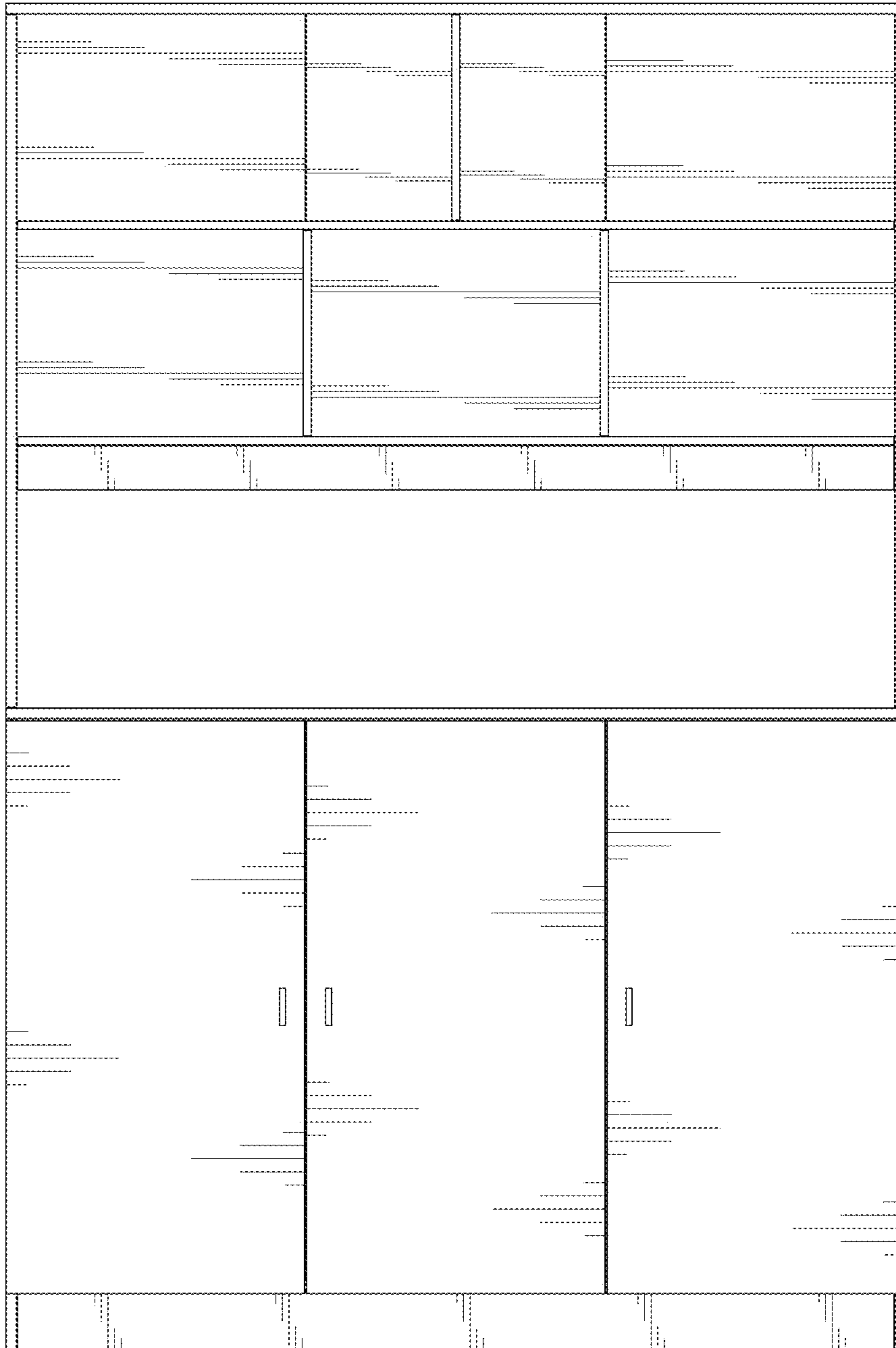


**FIG. 1**

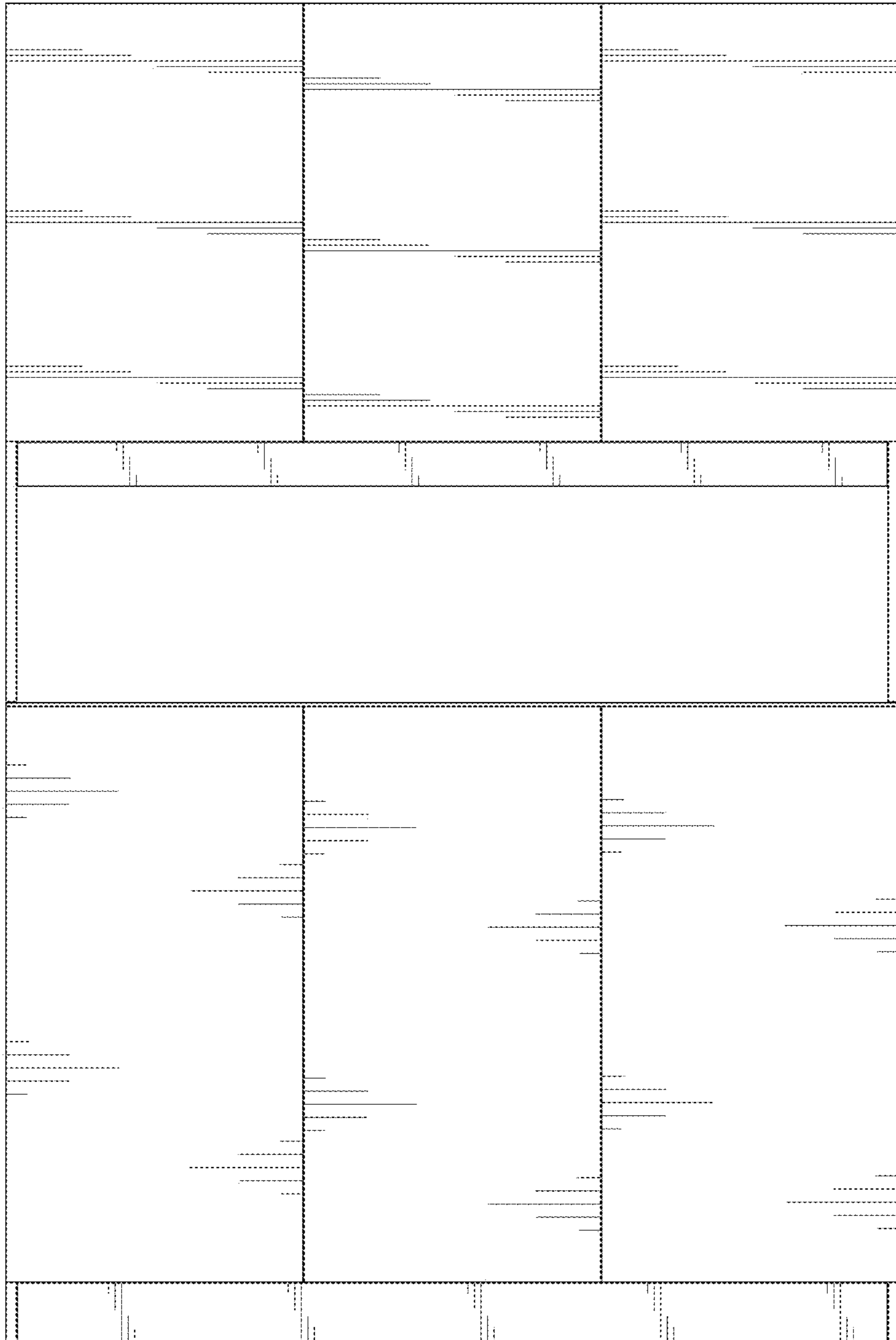


**FIG. 2**

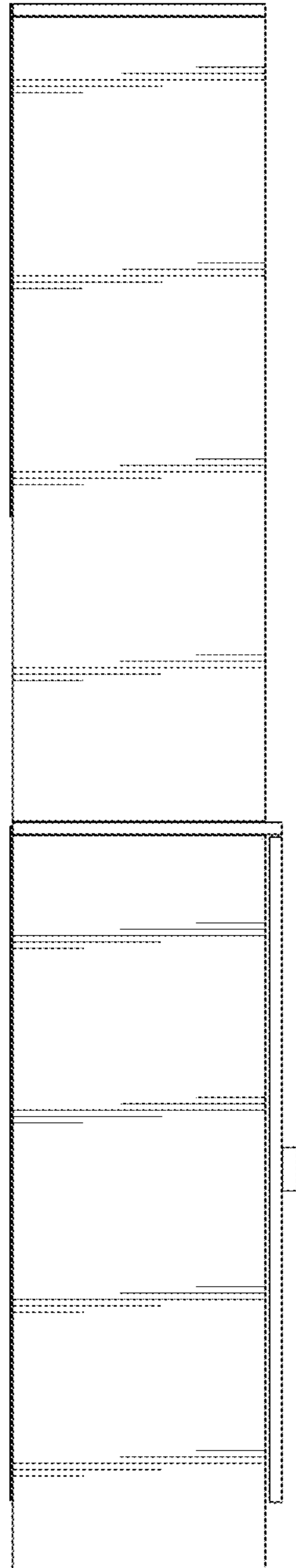




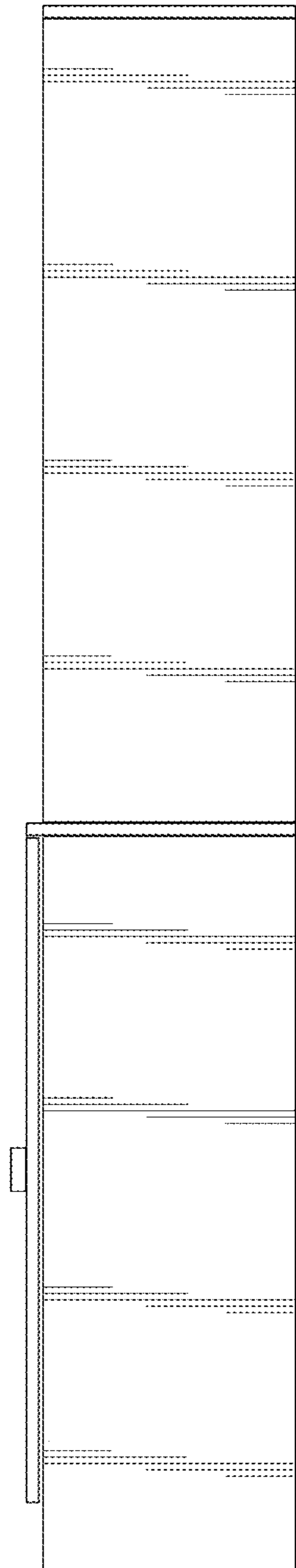
**FIG. 3**



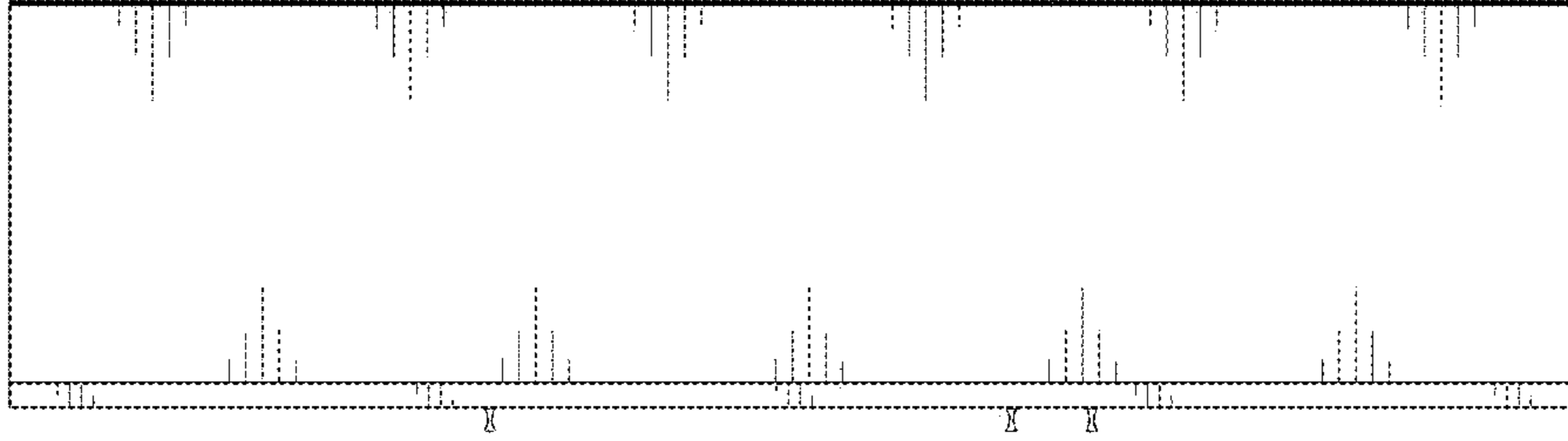
**FIG. 4**



***FIG. 5***

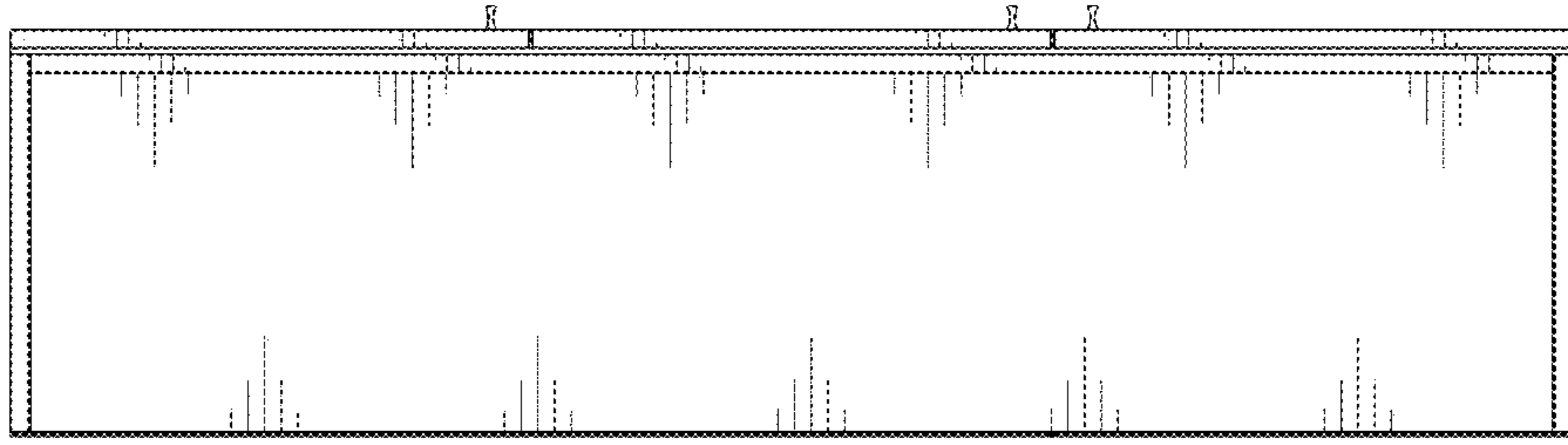


**FIG. 6**



***FIG. 7***





**FIG. 8**