



US00D986120S

(12) **United States Design Patent** (10) **Patent No.:** **US D986,120 S**
Smith (45) **Date of Patent:** **** May 16, 2023**

(54) **HITCH MOUNT**

(71) Applicant: **Country Innovation and Supply, LLC, Winder, GA (US)**

(72) Inventor: **Keaton Smith, Winder, GA (US)**

(**) Term: **15 Years**

(21) Appl. No.: **29/785,207**

(22) Filed: **May 24, 2021**

(51) **LOC (14) Cl.** **12-16**

(52) **U.S. Cl.**
USPC **D12/162**

(58) **Field of Classification Search**
USPC D12/159, 160, 161, 162, 203, 223, 317, D12/400; D21/777, 810
CPC B60D 1/363; B60D 1/241; B60D 1/30; B60D 1/58; B60D 1/06; B60D 1/52
See application file for complete search history.

(56) **References Cited**

U.S. PATENT DOCUMENTS

2,976,040	A	3/1961	Bales
4,145,054	A	3/1979	Stewart
5,244,392	A	9/1993	Maursetter
5,421,579	A	6/1995	Ubele, Jr.
5,454,561	A	10/1995	Smith
5,911,635	A	6/1999	Ogden
6,129,637	A	10/2000	Wang et al.
6,290,618	B1	9/2001	Ring
6,530,845	B1	3/2003	Corbett
6,783,464	B1	8/2004	Romano
6,951,287	B1	10/2005	Randazzo
7,048,638	B2	5/2006	Novotny
7,131,916	B2	11/2006	Griffin
7,134,968	B1	11/2006	Pryor
7,198,579	B2	4/2007	Moss et al.
7,338,064	B1	3/2008	Williams
7,874,930	B2	1/2011	Hubley
7,955,196	B2	6/2011	Constant

8,033,934	B1	10/2011	Clancy
8,141,760	B2	3/2012	Kuschmeader et al.
8,490,847	B2	7/2013	Sautter et al.
8,500,569	B2	8/2013	Moore
8,585,516	B1	11/2013	Buono et al.
8,746,725	B2	6/2014	Harkcom et al.
8,784,240	B1	7/2014	Buono et al.
8,900,075	B2	12/2014	Gu

(Continued)

OTHER PUBLICATIONS

etrailer.com, Curt Solid Steel 2" Hitch Bar with Raw Finish 10" long, published Dec. 18, 2014 [retrieved Jan. 9, 2023]. Retrieved from the internet<<https://www.etrailer.com/Hitch-Fabrication-Parts/CURT/D29.html>> (Year: 2014).*

(Continued)

Primary Examiner — Joseph Kukella
Assistant Examiner — Lavon M. Amerson
(74) *Attorney, Agent, or Firm* — Patricia C. Brzostowicz

(57) **CLAIM**

The ornamental design for a hitch mount, as shown and described herein.

DESCRIPTION

FIG. 1 is a side view of the hitch mount in use;
FIG. 2 is a top side view of the hitch mount;
FIG. 3 is a left side view of the hitch mount;
FIG. 4 is a bottom view of the hitch mount;
FIG. 5 is a right side view of the hitch mount;
FIG. 6 is a front view of the hitch mount;
FIG. 7 is a back view of the hitch mount;
FIG. 8 is a cross section right side view of the hitch mount;
and,
FIG. 9 is a schematic view of the hitch mount.
The dotted lines are for purposes of illustrating a use and form no part of the claimed design.

1 Claim, 3 Drawing Sheets

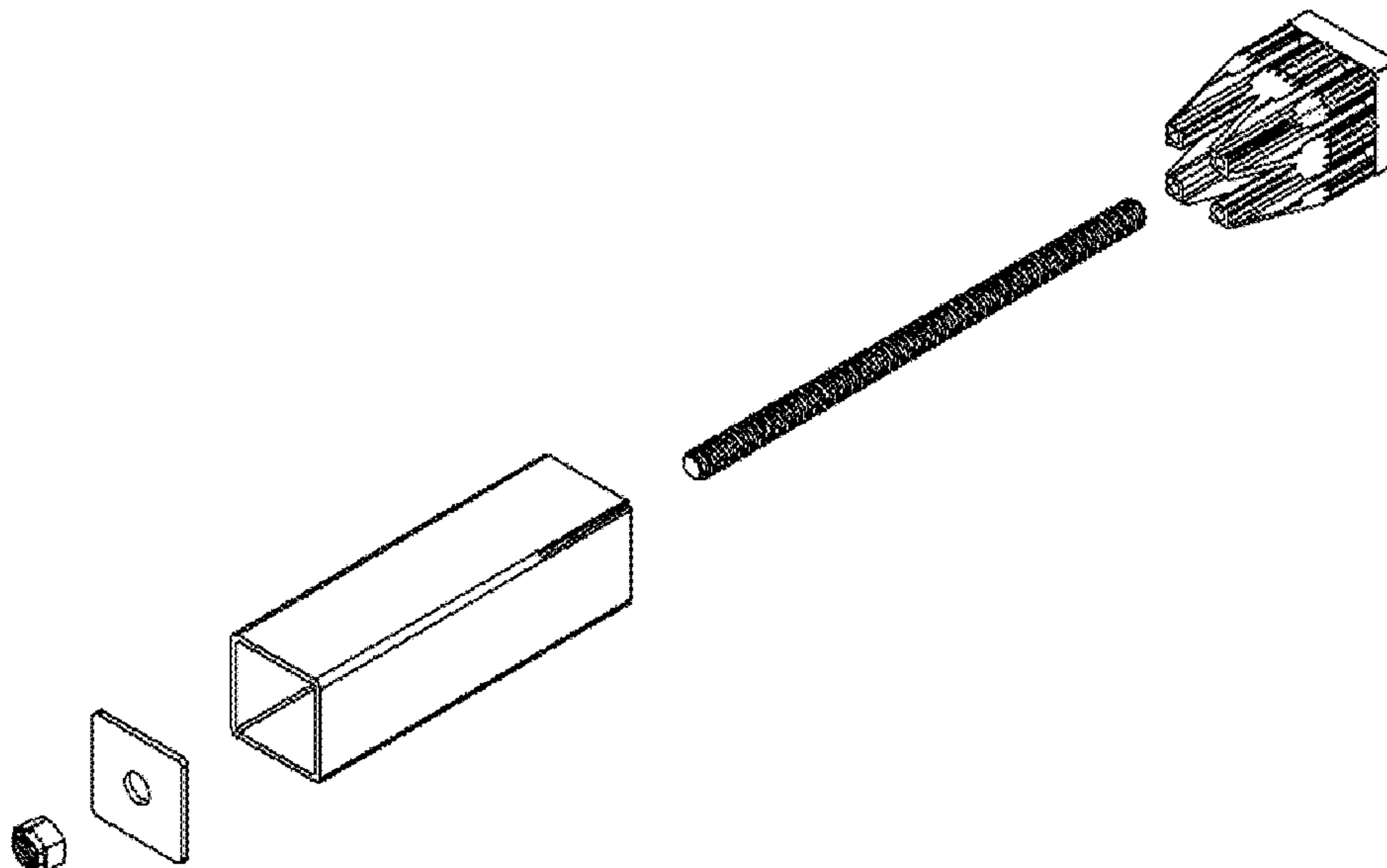

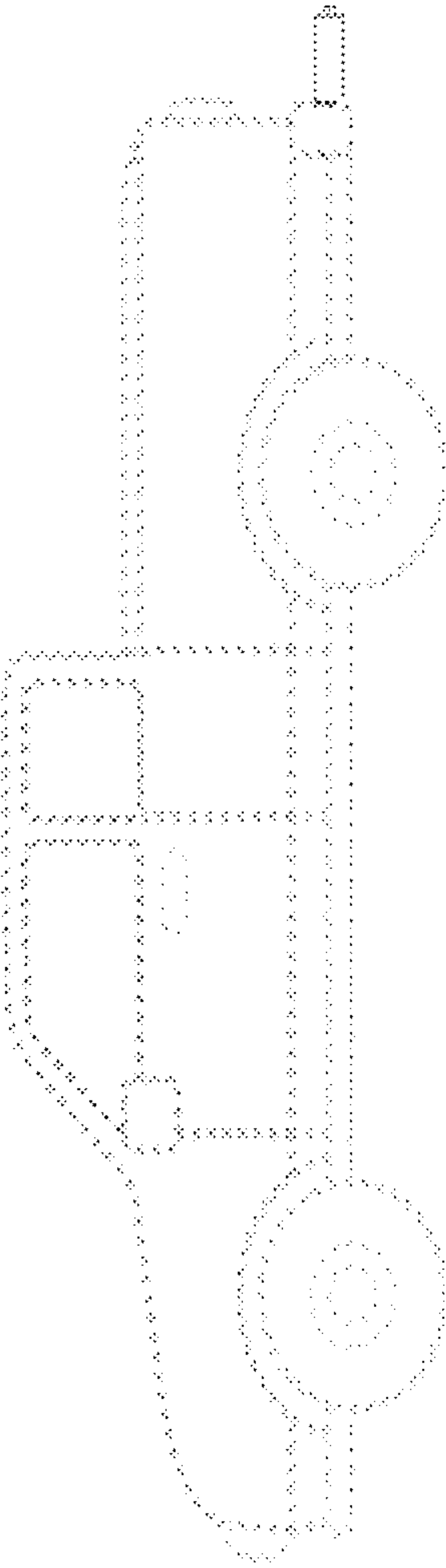

FIG. 1

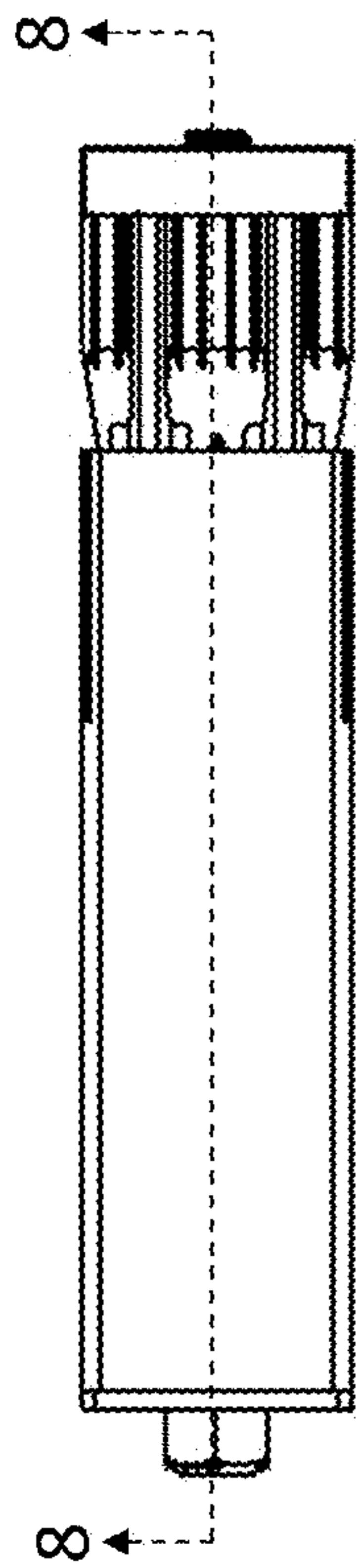

FIG. 2

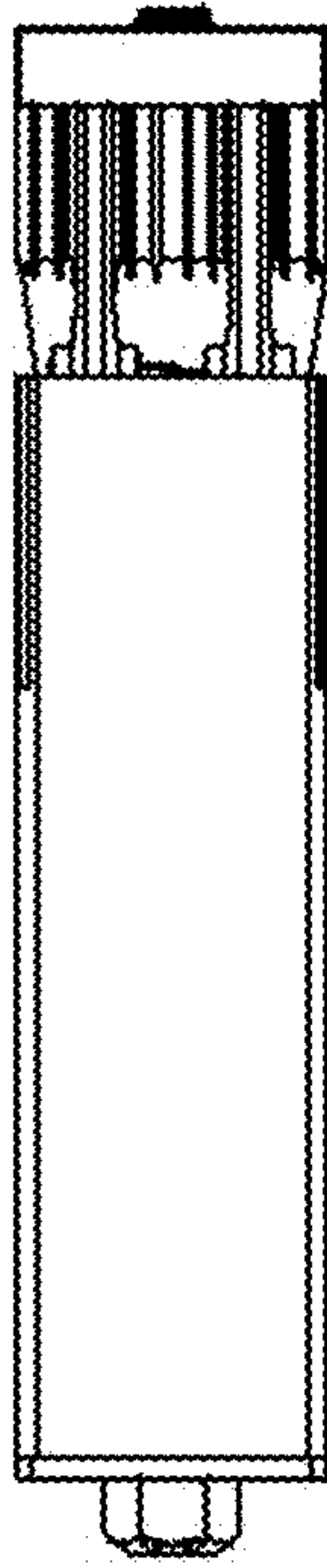

FIG. 3

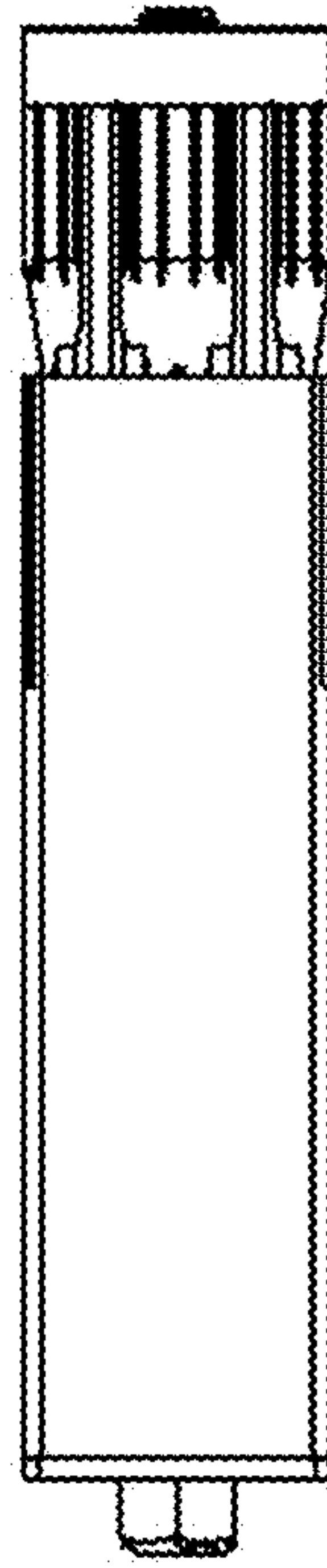

FIG. 4

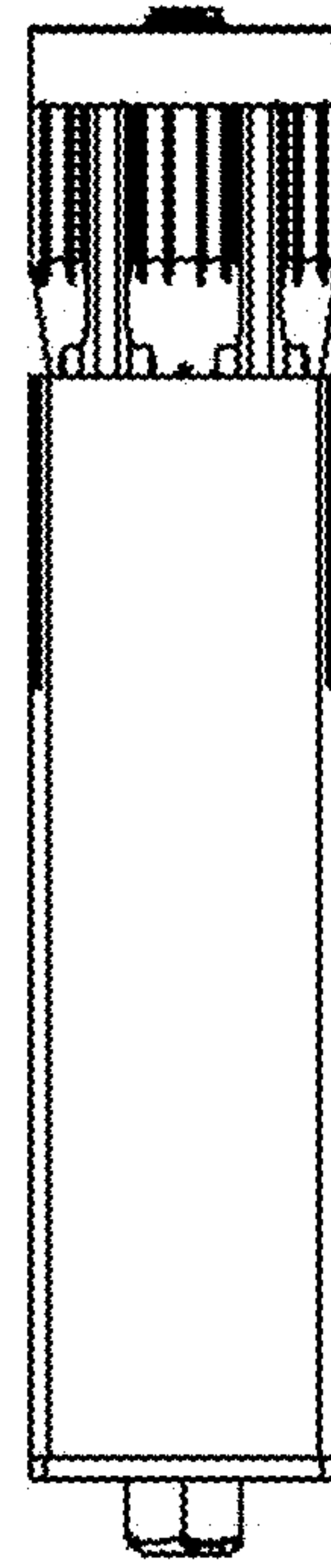

FIG. 5

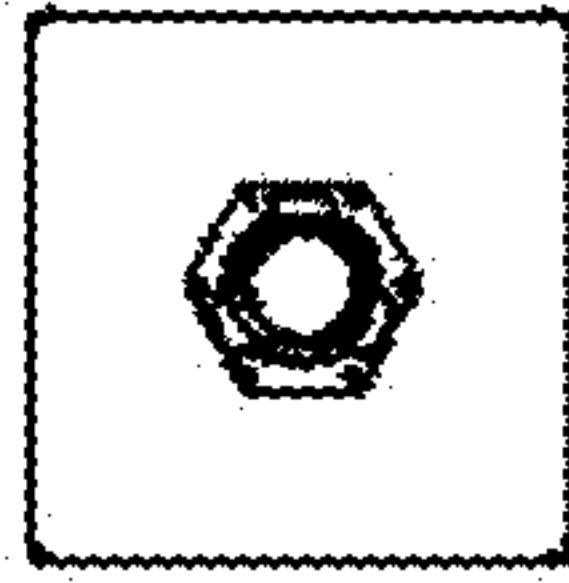

FIG. 6

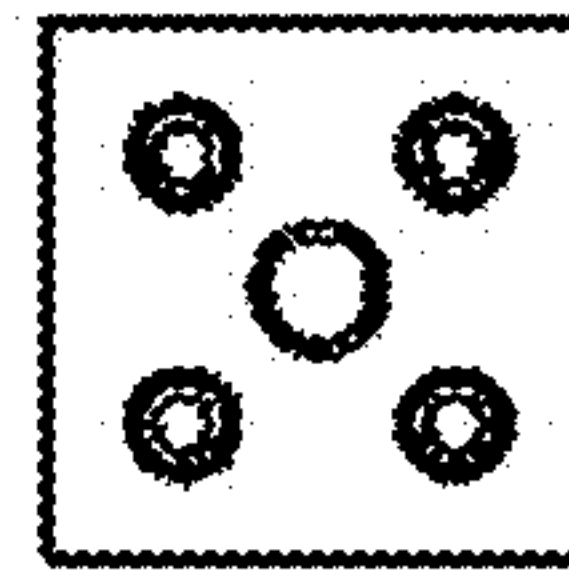

FIG. 7

