



US00D984835S

(12) **United States Design Patent** (10) **Patent No.:** **US D984,835 S**
Hanlon et al. (45) **Date of Patent:** **** May 2, 2023**

(54) **SUPPORT BEAM PROFILE**
(71) Applicant: **JS Products, Inc.**, Las Vegas, NV (US)
(72) Inventors: **Jared Hanlon**, Las Vegas, NV (US);
Dylan Williams, Las Vegas, NV (US)
(73) Assignee: **JS Products, Inc.**, Las Vegas, NV (US)
(**) Term: **15 Years**
(21) Appl. No.: **29/652,181**
(22) Filed: **Jun. 4, 2020**
(51) **LOC (14) Cl.** **06-06**
(52) **U.S. Cl.**
USPC **D6/702; D8/349**
(58) **Field of Classification Search**
USPC ... D6/320, 553–555, 574, 675, 675.1, 675.2,
D6/675.5, 700, 702, 705, 705.4, 705.5;
D25/119, 125–126; D8/349, 354, 373
CPC A47B 96/021; A47B 96/06; A47B 96/066;
A47B 96/14; A47B 47/00; A47B
47/0041; A47B 47/0083; A47B 47/027;
A47F 5/0043; A47F 5/08; A47F 5/0807;
H05K 7/183; H05K 7/14; H05K 7/18;
B63B 32/77; B63B 32/83
See application file for complete search history.

D543,094 S 5/2007 Remmers
7,252,202 B2 8/2007 Saltzberg et al.
D572,066 S * 7/2008 Swanson D6/553
D584,425 S * 1/2009 Chaney D25/124
D585,681 S 2/2009 Liss et al.
D585,682 S * 2/2009 Liss D6/705.4
D595,069 S * 6/2009 Berry D25/119
D597,354 S 8/2009 Liss
D604,978 S * 12/2009 Shaha D6/553
D618,365 S 6/2010 Crane
D621,964 S 8/2010 Zadeh
7,854,527 B2 * 12/2010 Anderson F21V 33/0012
362/217.1
D637,427 S 5/2011 Troyner et al.
D665,123 S * 8/2012 Douglas D26/138
D668,945 S 10/2012 Fernandez
D674,220 S * 1/2013 Kim D6/702
D674,221 S * 1/2013 Kim D6/702
D702,466 S * 4/2014 Kim D6/702

(Continued)

Primary Examiner — Kelley A Donnelly
(74) *Attorney, Agent, or Firm* — Weide & Miller, Ltd.

(57) **CLAIM**

The ornamental design for a support beam profile, as shown and described.

DESCRIPTION

FIG. 1 is a front perspective view of a support beam profile showing the new design, shown with environment.
FIG. 2 is a top view of the support beam profile of FIG. 1, shown separately from environment.
FIG. 3 is a front view thereof.
FIG. 4 is a right-side view thereof.
FIG. 5 is a bottom view thereof.
FIG. 6 is a rear view thereof; and,
FIG. 7 is a left-side view thereof.
The broken line showing of a shelving unit in FIG. 1 depicts an exemplary environment that forms no part of the claimed design.

1 Claim, 2 Drawing Sheets

(56) **References Cited**
U.S. PATENT DOCUMENTS
D247,194 S * 2/1978 Win D26/152
D261,311 S * 10/1981 Schmidt D25/124
D288,881 S * 3/1987 Cowdroy D8/382
D290,404 S * 6/1987 Stoler D25/119
D306,878 S * 3/1990 Crowley D20/43
D374,650 S * 10/1996 Shermeto D8/349
D424,836 S 5/2000 Kopala, Jr.
6,698,155 B2 3/2004 Menendez
D507,131 S * 7/2005 Pingel D6/702
D523,667 S 6/2006 Bisson

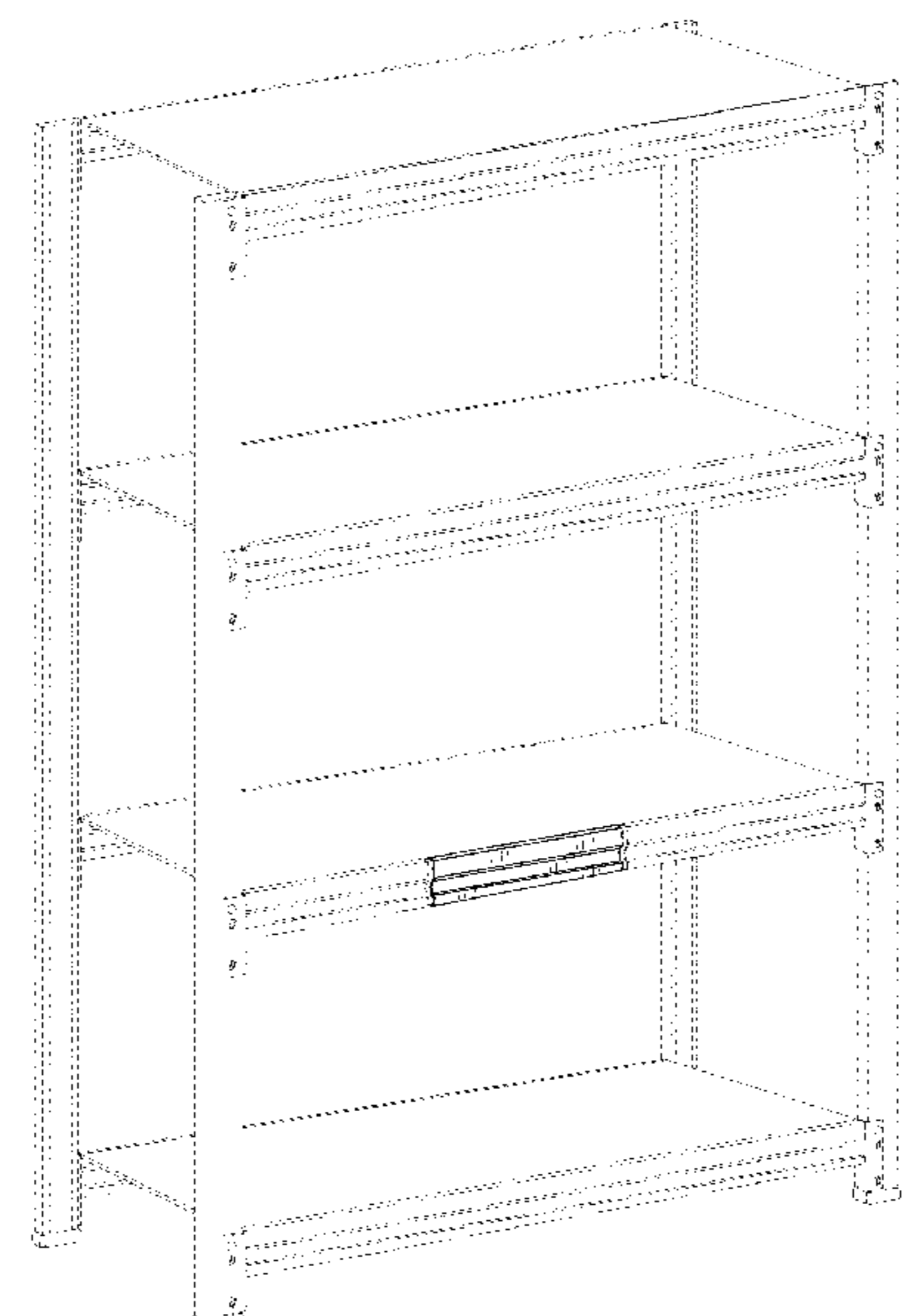

(56)

References Cited

U.S. PATENT DOCUMENTS

D713,187	S	9/2014	Troyner et al.	
D714,577	S	10/2014	Troyner et al.	
D716,089	S	10/2014	Bittle	
D728,979	S *	5/2015	K'Nell	D6/675.3
D732,863	S	6/2015	Troyner et al.	
D733,473	S	7/2015	Troyner et al.	
D737,613	S	9/2015	Troyner et al.	
D738,653	S	9/2015	Troyner et al.	
D747,120	S *	1/2016	Ng	D6/580
D753,420	S	4/2016	Cheng	
D753,421	S	4/2016	Cheng	
D757,474	S *	5/2016	Grabber	D6/705.5
9,375,102	B2	6/2016	Troyner et al.	
D777,479	S	1/2017	Anderson	
D778,641	S	2/2017	Anderson	
9,661,921	B1	5/2017	Tsai	
D799,870	S	10/2017	Liss	
D843,600	S *	3/2019	Schmidt	D25/126
D906,740	S *	1/2021	Parab	D6/675.5
D907,946	S *	1/2021	Parab	D6/675.5
D922,809	S *	6/2021	Parab	D6/675.5
D950,993	S *	5/2022	Beach	D6/702
D960,617	S *	8/2022	Case	D6/675.3
D966,764	S *	10/2022	Siekman	D6/702

* cited by examiner

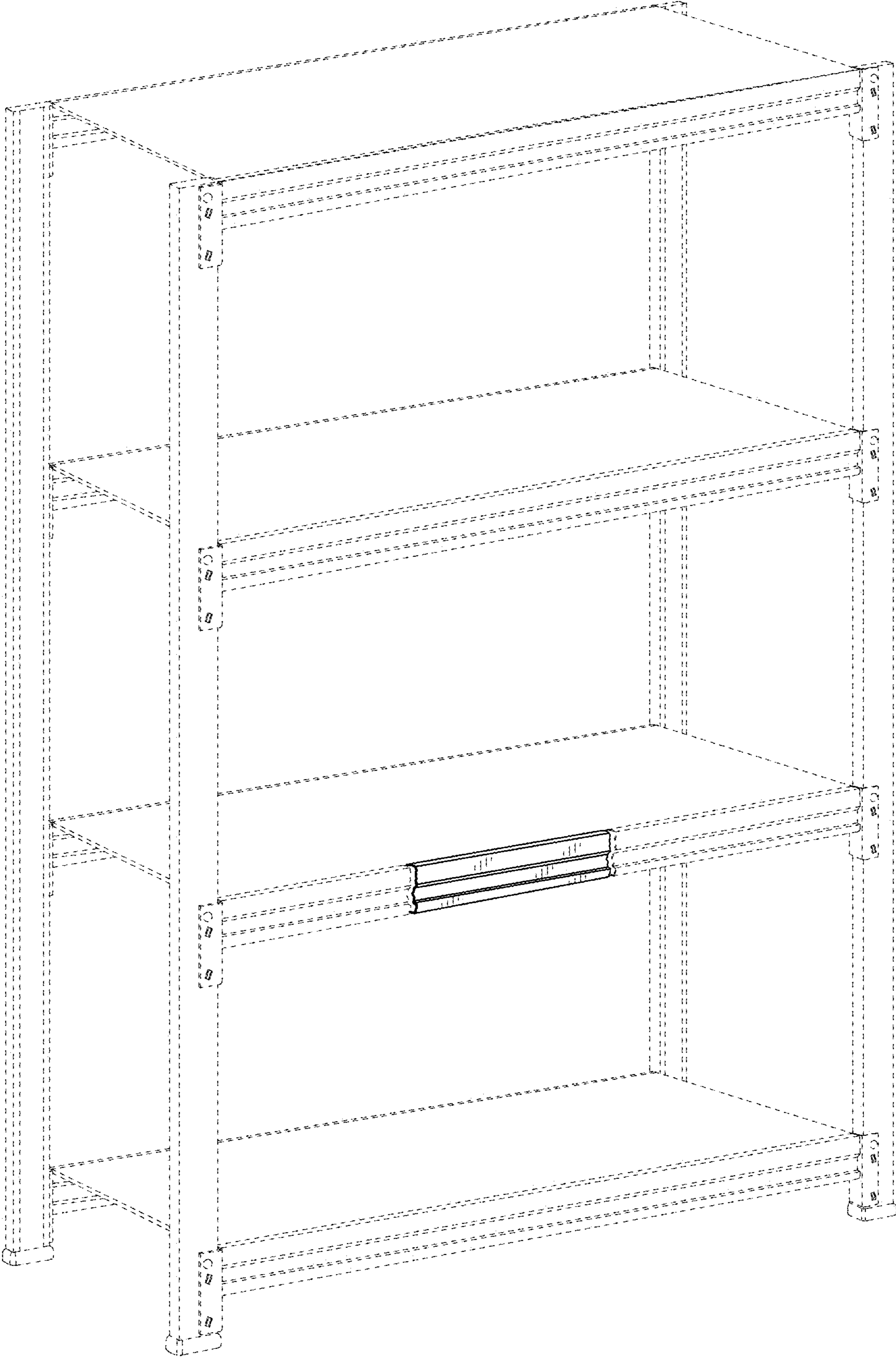

FIG. 1

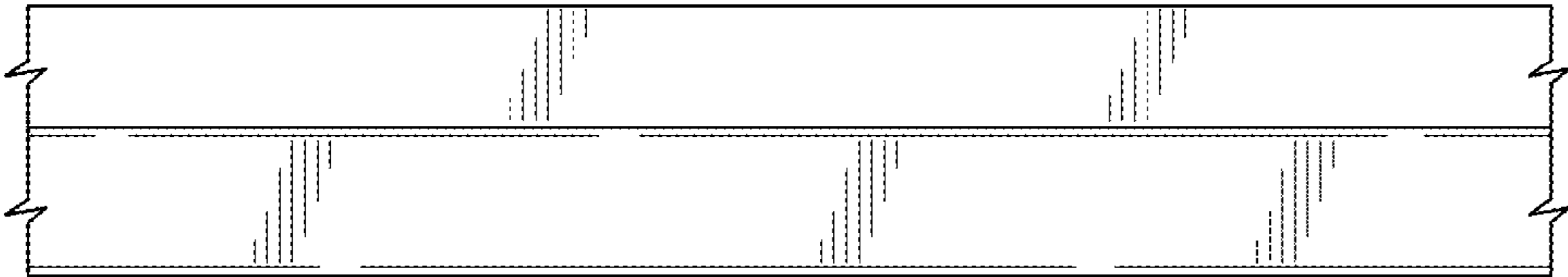

FIG. 2

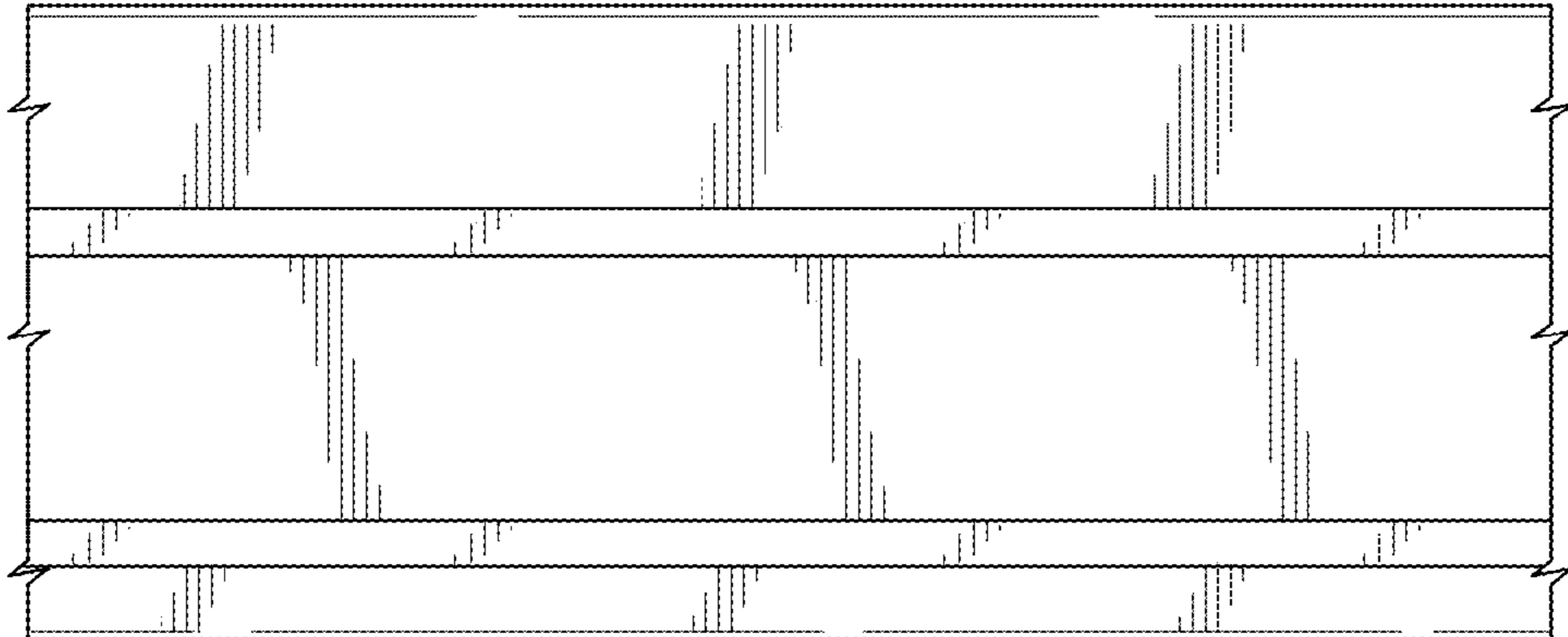

FIG. 3

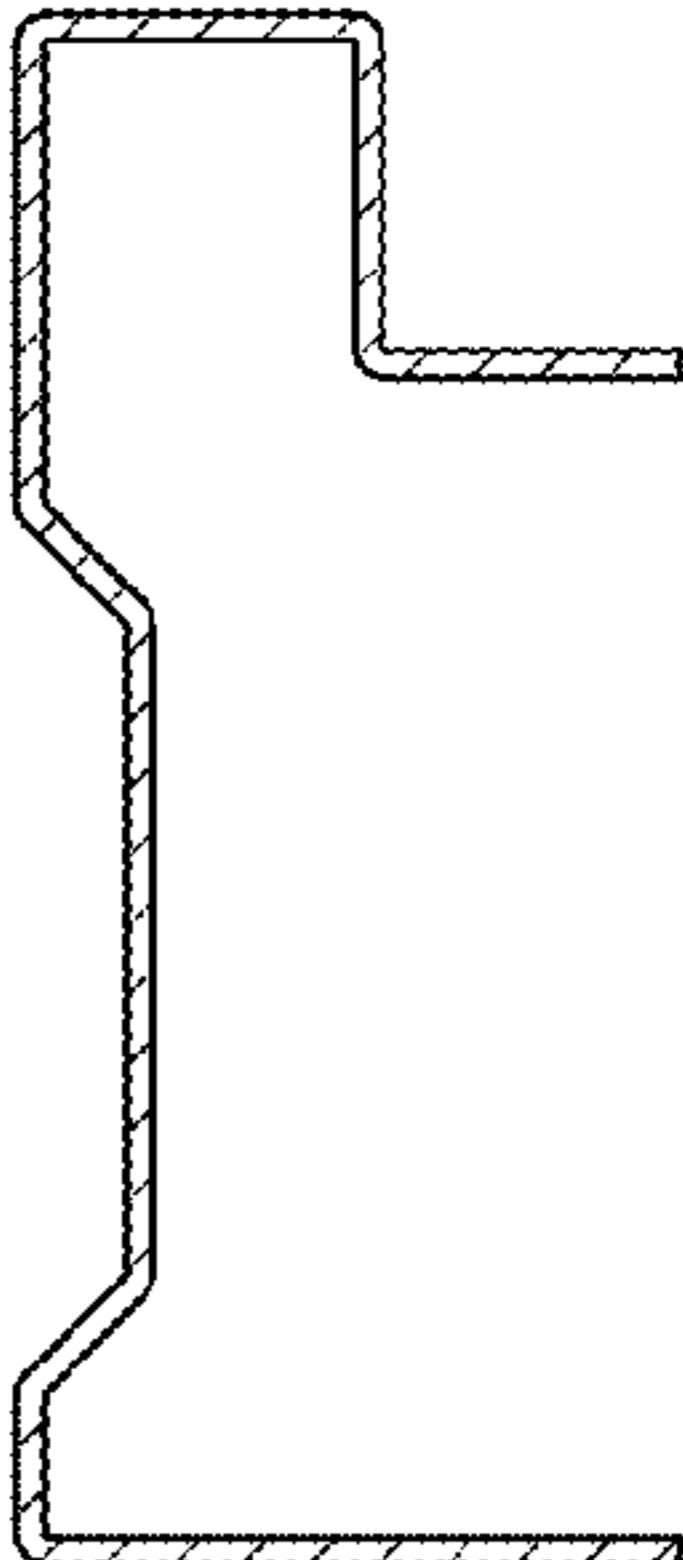

FIG. 4



FIG. 5

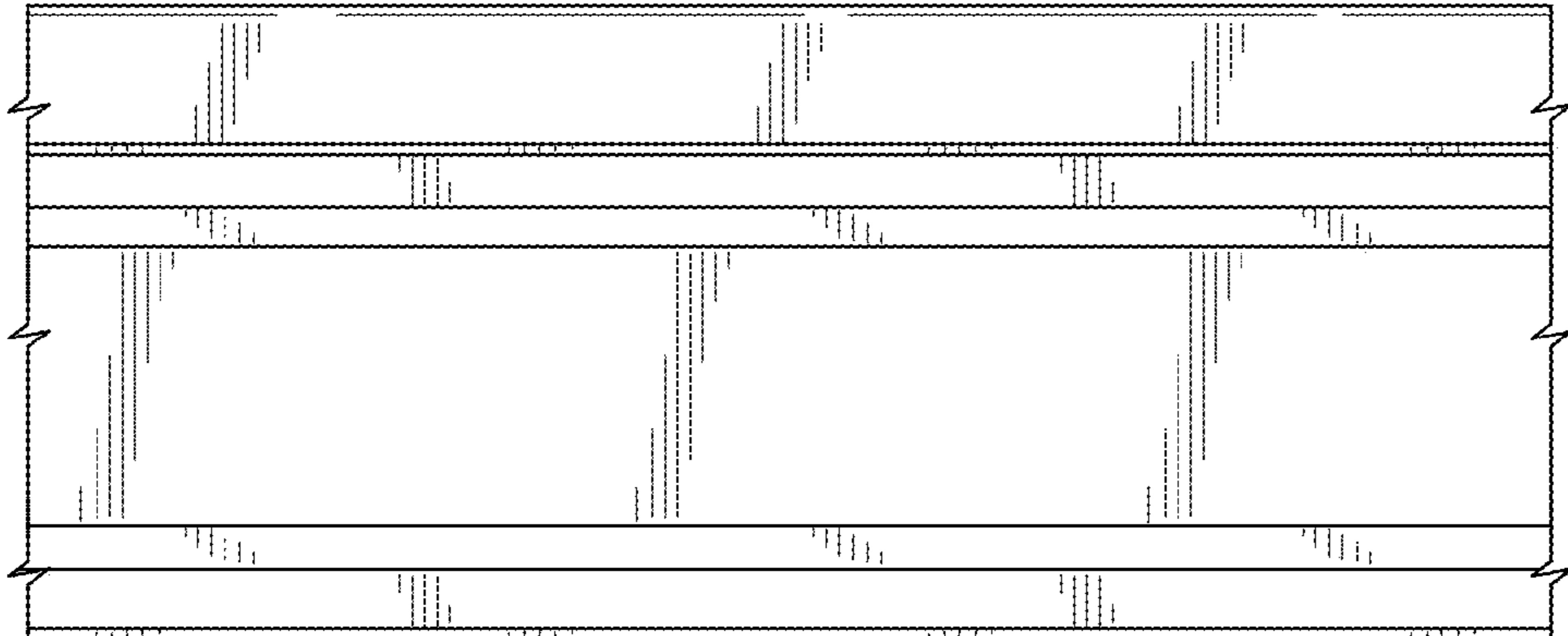

FIG. 6

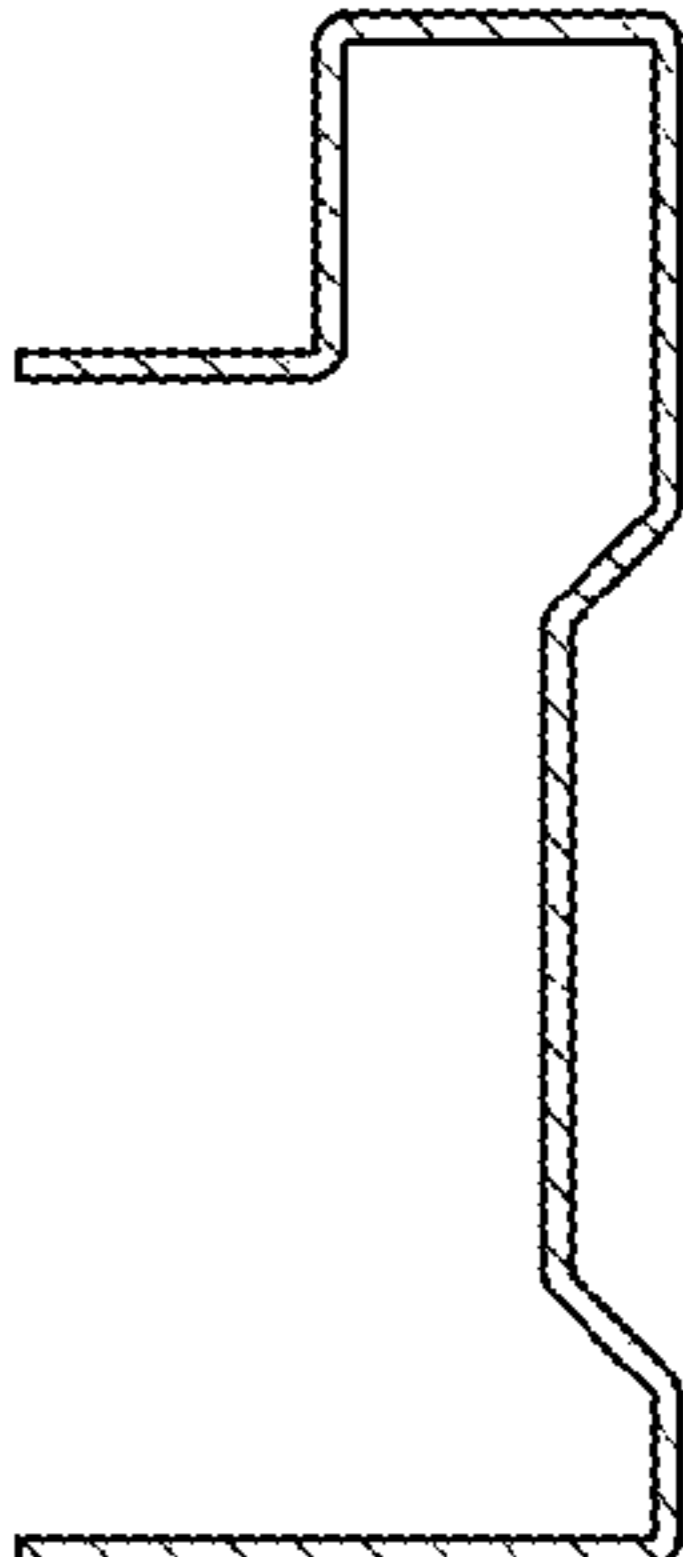

FIG. 7