



US00D980639S

(12) **United States Design Patent** (10) **Patent No.:** **US D980,639 S**  
**Li** (45) **Date of Patent:** **\*\* Mar. 14, 2023**

(54) **CHAIR**  
(71) Applicant: **Hangzhou Ruiyi Outdoor Leisure Products Co., Ltd, Zhejiang (CN)**

D357,137 S \* 4/1995 Hess ..... D6/379  
D358,264 S \* 5/1995 Vanderminden, Sr. .... D6/375  
D358,721 S \* 5/1995 Hess ..... D6/373

(Continued)

(72) Inventor: **Ren Li, Zhejiang (CN)**

**OTHER PUBLICATIONS**

(\*\*) Term: **15 Years**

“Kingsley Bate Tivoli Stainless Steel and Teak Sling Dining Armchair (Stacking)” Jan. 29, 2017, frontera.com, site visited Jun. 7, 2022 <<https://www.frontera.com/kingsley-bate-tivoli-stainless-steel-and-teak-sling-dining-armchair-stacking/>> (Year: 2017).\*

(21) Appl. No.: **29/726,686**

(22) Filed: **Mar. 5, 2020**

*Primary Examiner* — Kevin K Rudzinski

*Assistant Examiner* — Paul D Bohannon

(30) **Foreign Application Priority Data**

Sep. 12, 2019 (CN) ..... 201930502272.5

(74) *Attorney, Agent, or Firm* — Prakash Nama; Global IP Services, PLLC

(51) **LOC (14) Cl.** ..... **06-01**

(57) **CLAIM**

(52) **U.S. Cl.**  
USPC ..... **D6/375**

The ornamental design for a chair, as shown and described.

(58) **Field of Classification Search**

**DESCRIPTION**

USPC ..... D6/360, 369, 374, 376, 379, 380, 358, D6/365, 370, 373, 377, 716; D21/521  
CPC .. A47C 3/023; A47C 3/04; A47C 3/14; A47C 3/34; A47C 4/028; A47C 4/02; A47C 4/03; A47C 5/04; A47C 5/10; A47C 7/002; A47C 7/029; A47C 7/506; A47C 9/007; A47C 9/005; A47C 9/00; A47C 13/023; A47B 1/00; A47B 7/02; A47B 39/08; A47B 41/00; A47B 41/04; A47B 2200/0011; A47B 2200/0027

FIG. 1 is a front elevational view of a chair showing my new design;  
FIG. 2 is a rear elevational view thereof;  
FIG. 3 is a left side view thereof;  
FIG. 4 is a right side view thereof;  
FIG. 5 is a top plan view thereof;  
FIG. 6 is a bottom plan view thereof;  
FIG. 7 is a perspective view thereof;  
FIG. 8 is an enlarged view of portion 8 shown in FIG. 2;  
FIG. 9 is an enlarged view of portion 9 shown in FIG. 5;  
FIG. 10 is an enlarged view of portion 10 shown in FIG. 5;  
FIG. 11 is an enlarged view of portion 11 shown in FIG. 5;  
FIG. 12 is an enlarged view of portion 12 shown in FIG. 5;  
and,  
FIG. 13 is an enlarged view of portion 13 shown in FIG. 6.  
The broken lines shown in the drawings illustrate portions of the article that form no part of the claimed design.

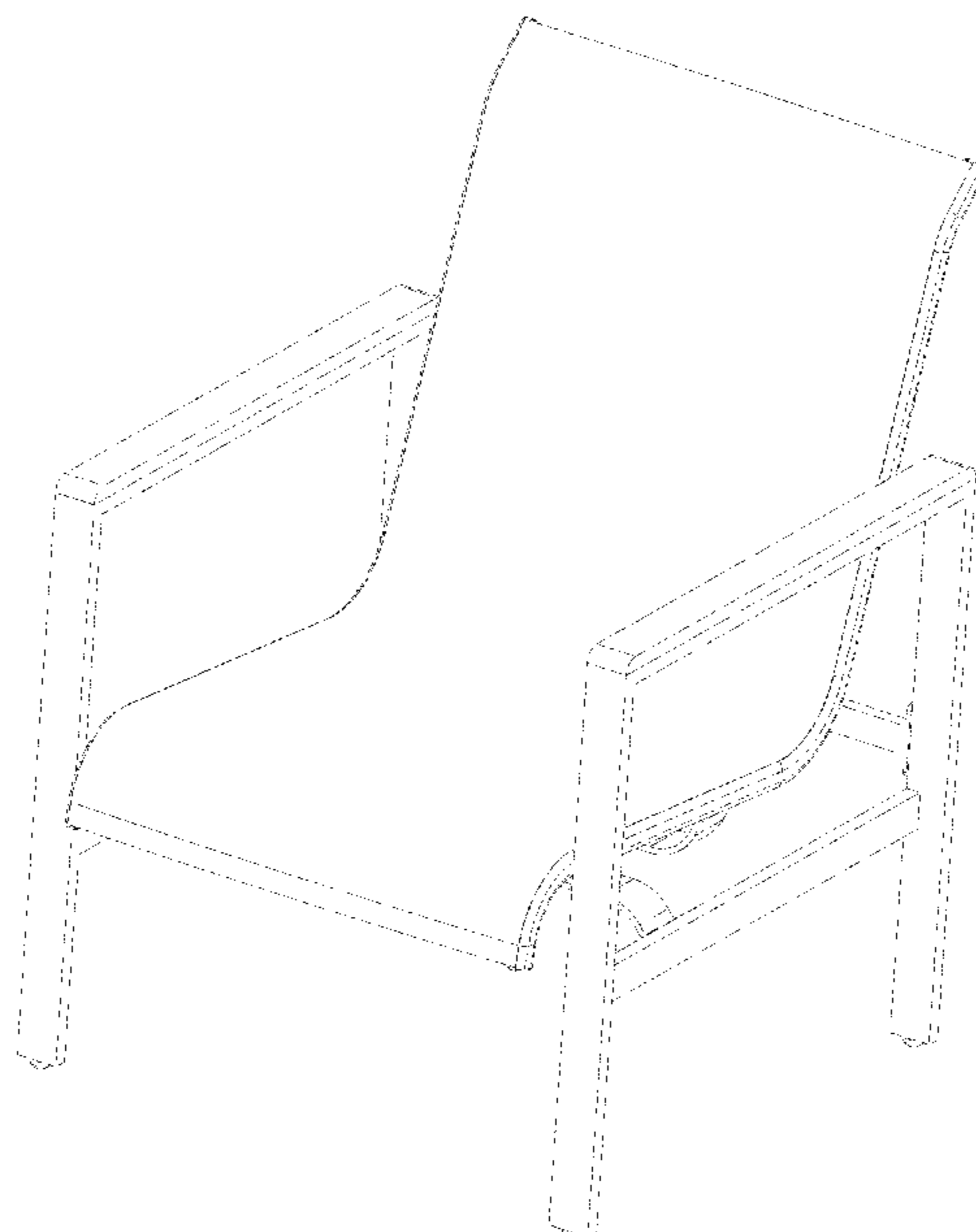
See application file for complete search history.

(56) **References Cited**

**U.S. PATENT DOCUMENTS**

D169,299 S \* 4/1953 Willemin ..... D6/375  
D227,633 S \* 7/1973 Kellman ..... D6/375  
D235,947 S \* 7/1975 Uyeda ..... D6/373  
D287,437 S \* 12/1986 Frinier ..... D6/373  
D289,349 S \* 4/1987 Vanderminden ..... D6/379

**1 Claim, 13 Drawing Sheets**



(56)

**References Cited**

U.S. PATENT DOCUMENTS

5,599,064 A \* 2/1997 Vanderminden, Sr. ....  
A47C 7/445  
297/344.21  
D426,971 S \* 6/2000 Tseng ..... D6/375  
D438,398 S \* 3/2001 Frinier ..... D6/375  
D449,176 S \* 10/2001 Schulte ..... D6/375  
D450,945 S \* 11/2001 Lo ..... D6/375  
D469,972 S \* 2/2003 Vanderminden, Sr. .... D6/373  
D482,541 S \* 11/2003 Puer ..... D6/373  
D486,002 S \* 2/2004 Lederman ..... D6/375  
D496,172 S \* 9/2004 Puer ..... D6/375  
D497,491 S \* 10/2004 Puer ..... D6/375  
D502,332 S \* 3/2005 Puer ..... D6/379  
D513,910 S \* 1/2006 Gehry ..... D6/375  
D514,835 S \* 2/2006 Grosfillex ..... D6/379  
11,234,527 B2 \* 2/2022 Hsu Besner ..... A47C 4/52  
2021/0153657 A1 \* 5/2021 Cook ..... A47C 7/002

\* cited by examiner

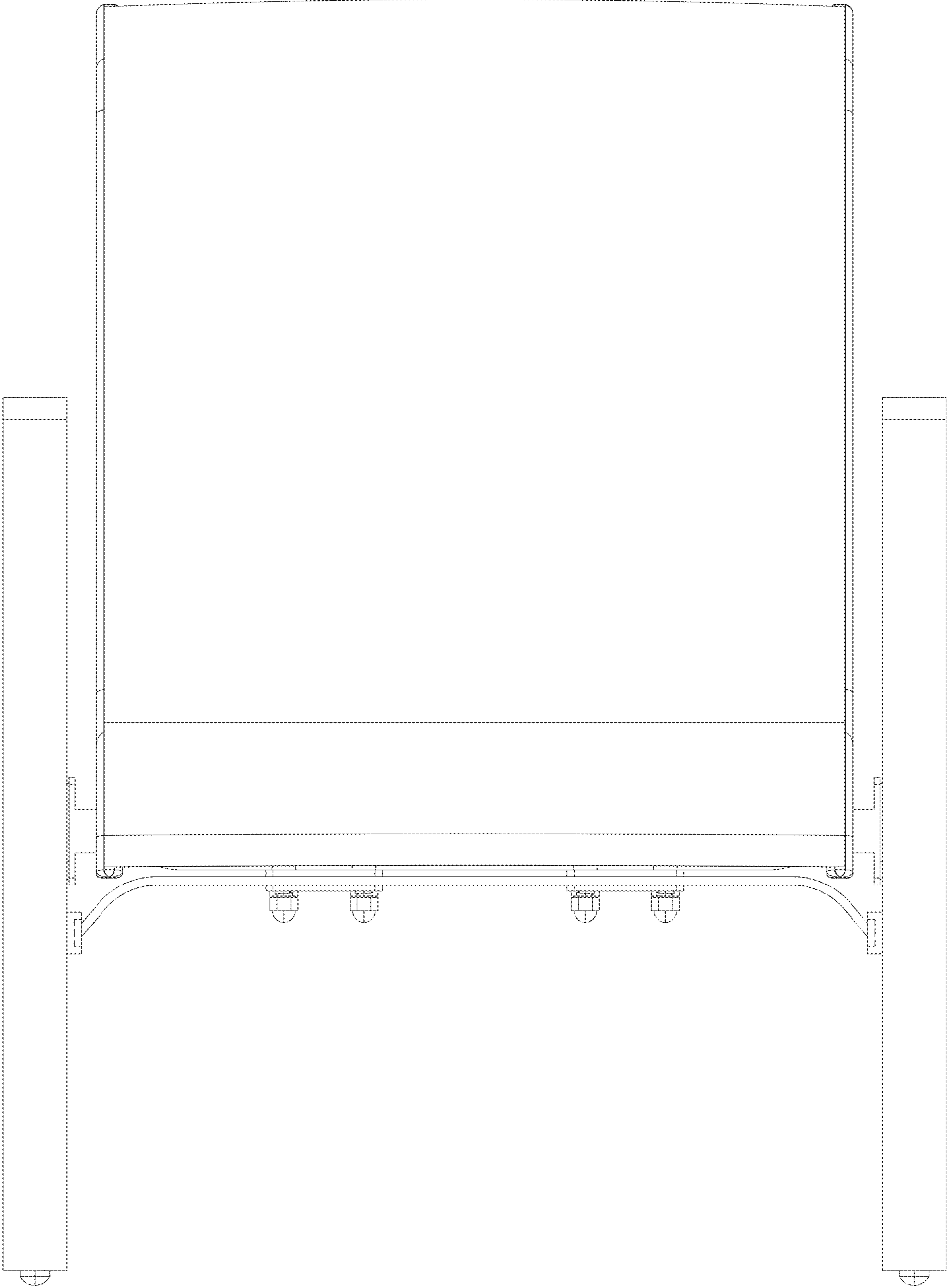
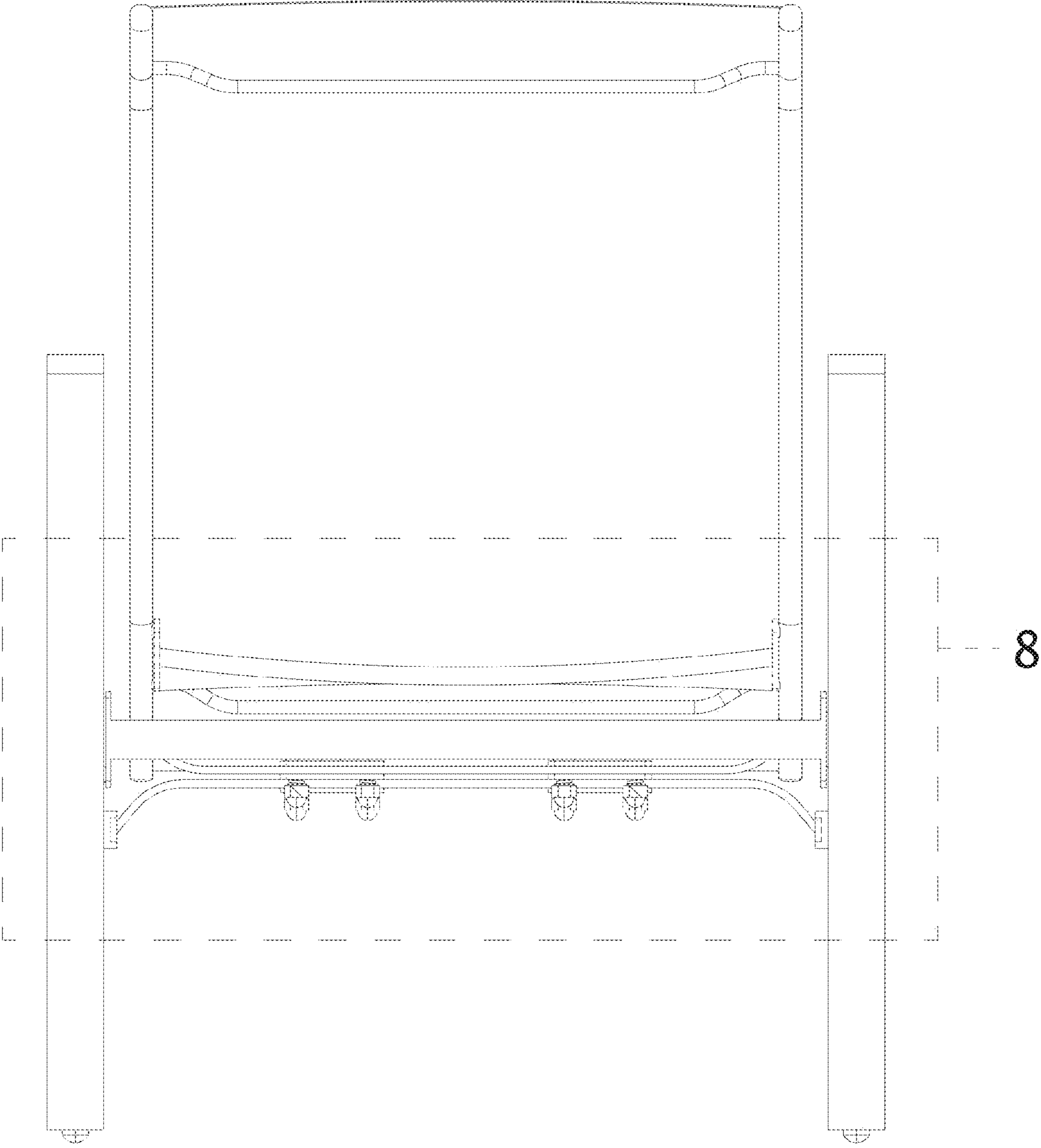
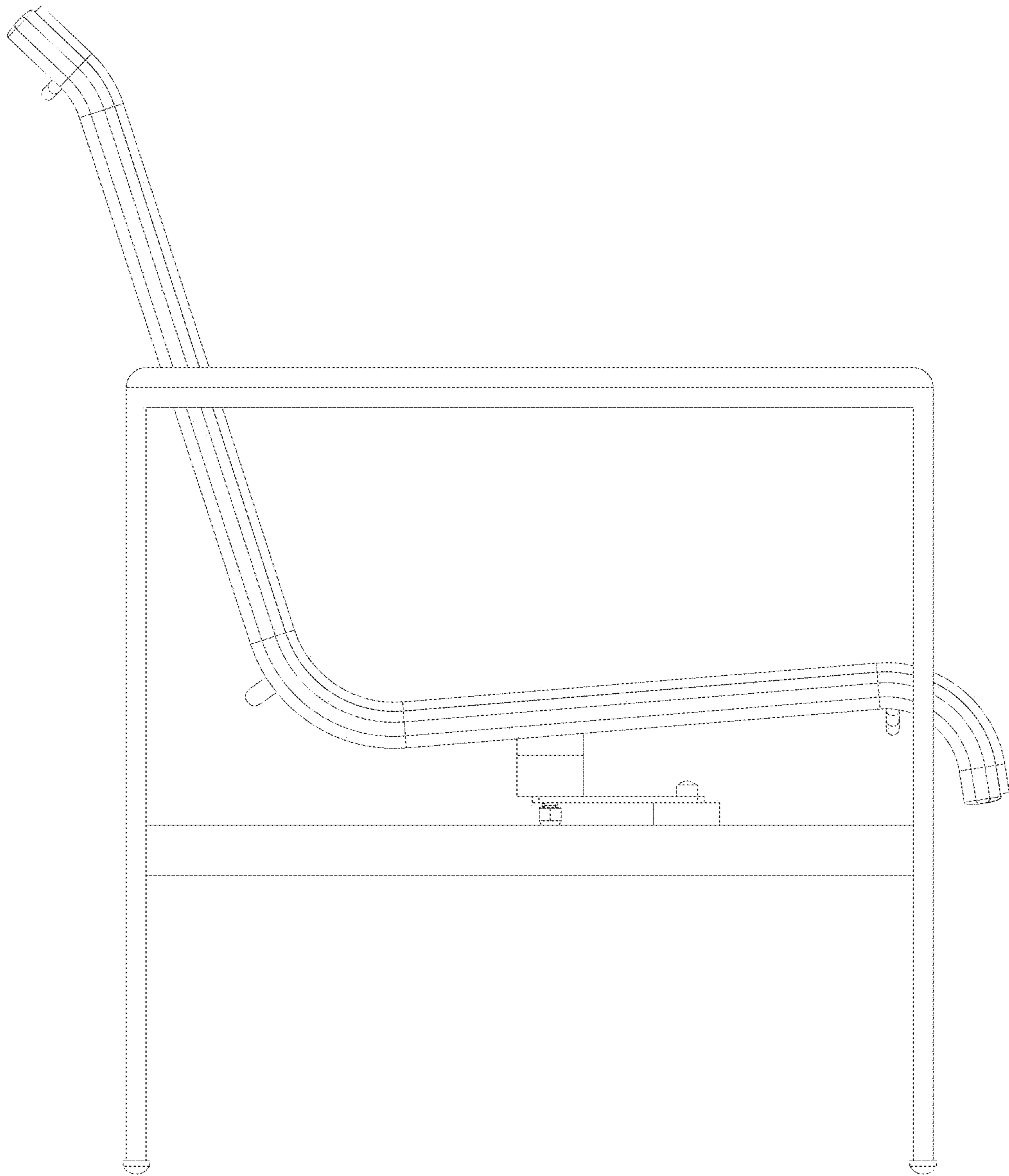


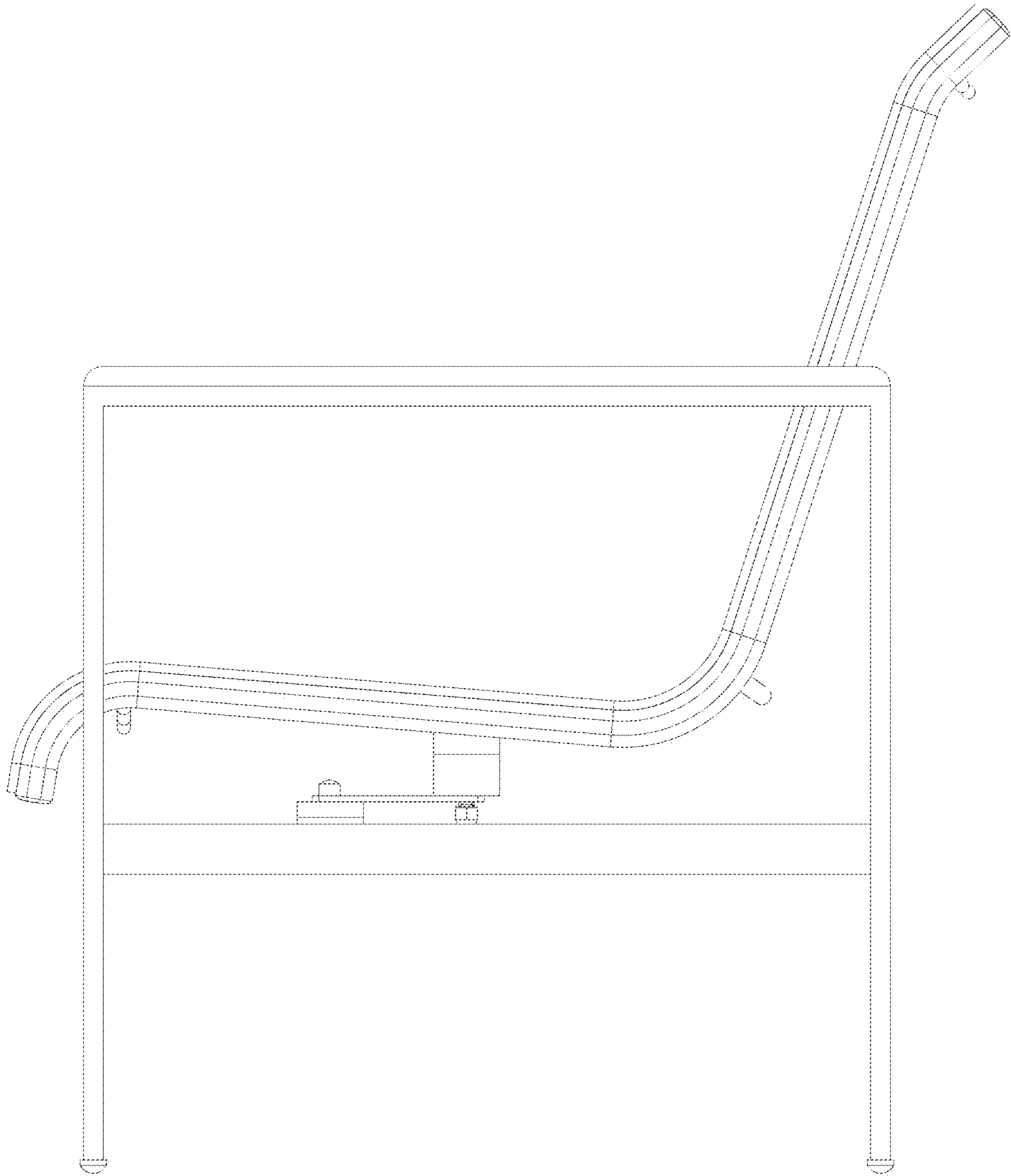
FIG. 1



**FIG.2**

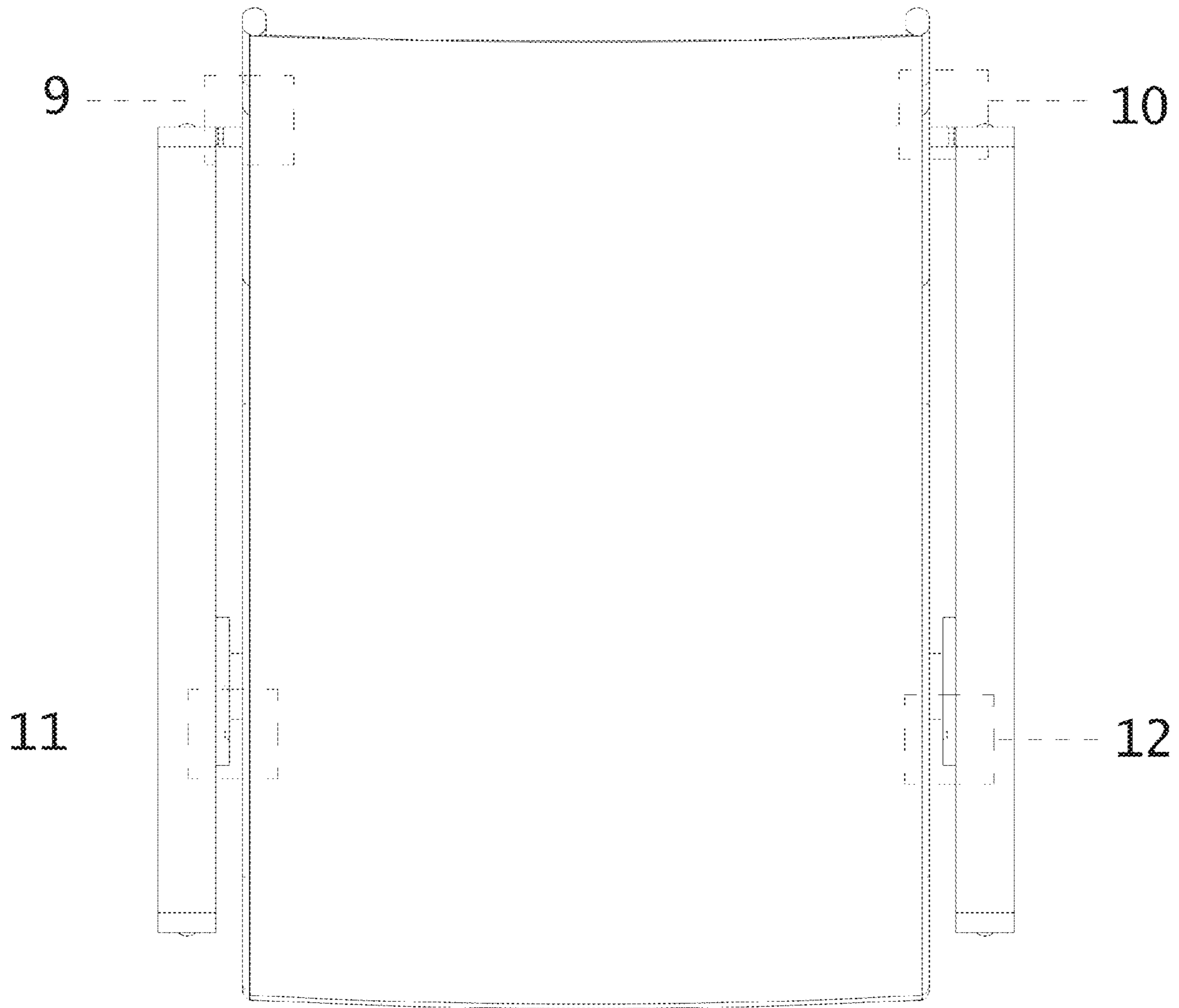


**FIG.3**

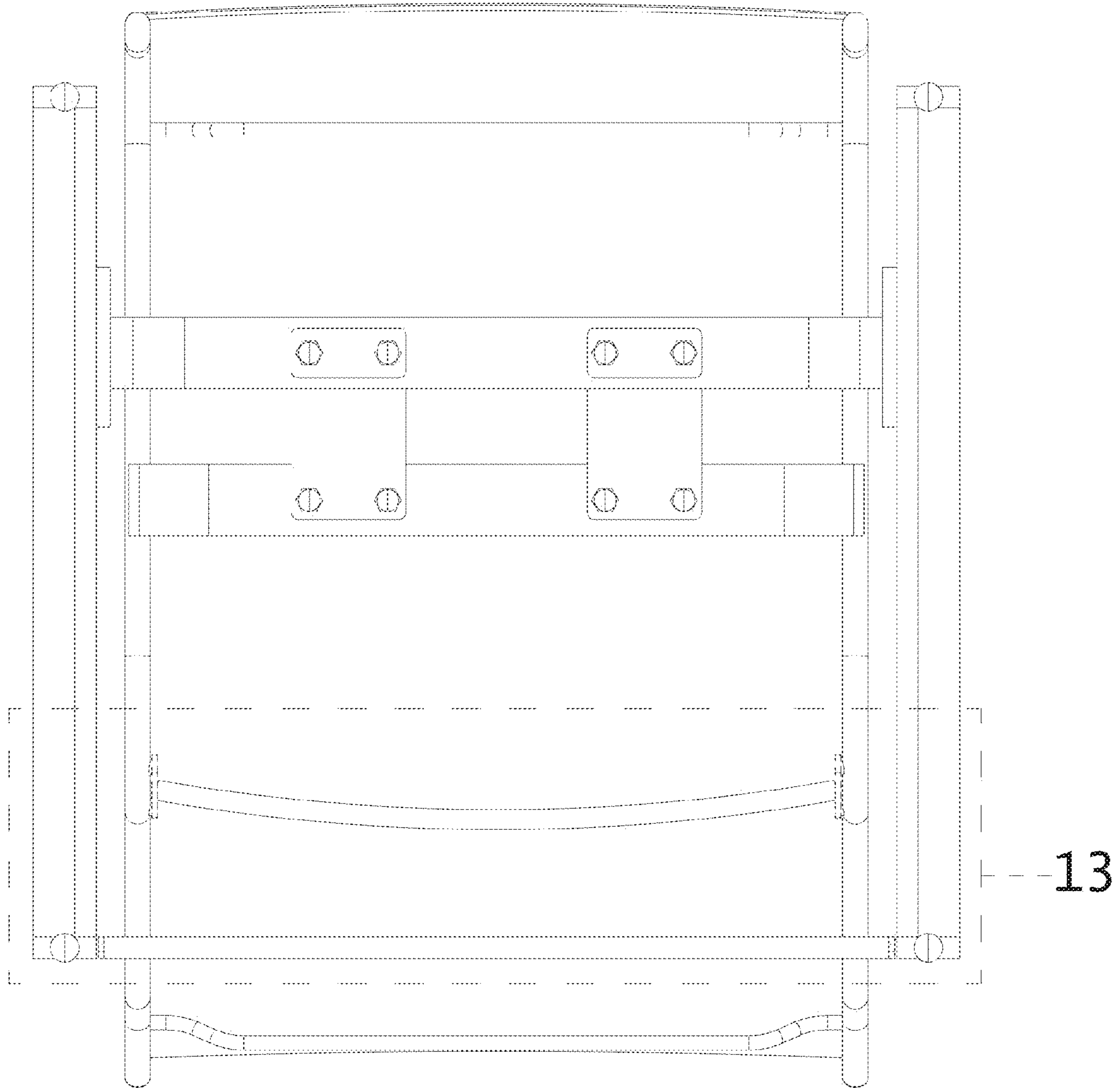


**FIG. 4**



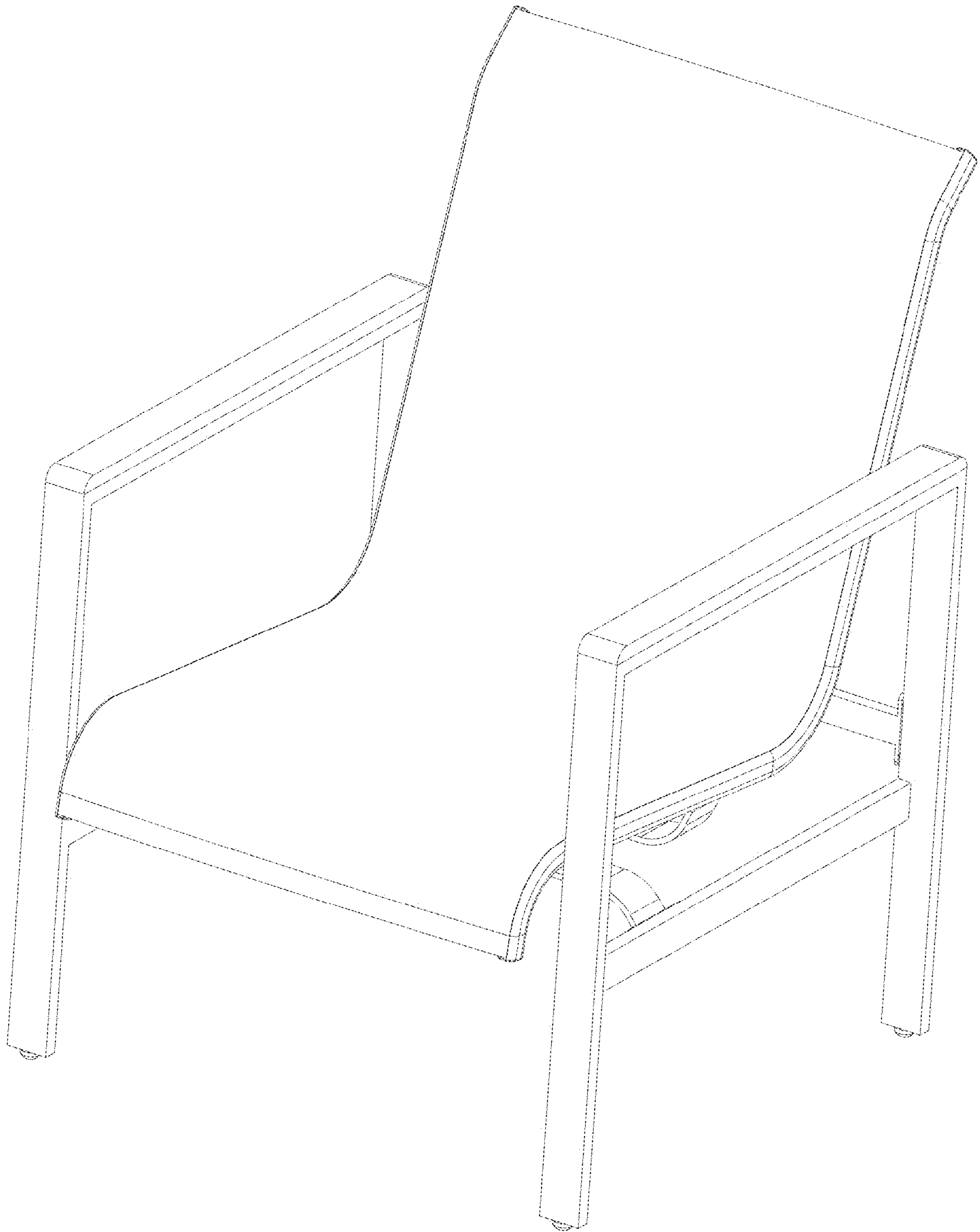


**FIG.5**

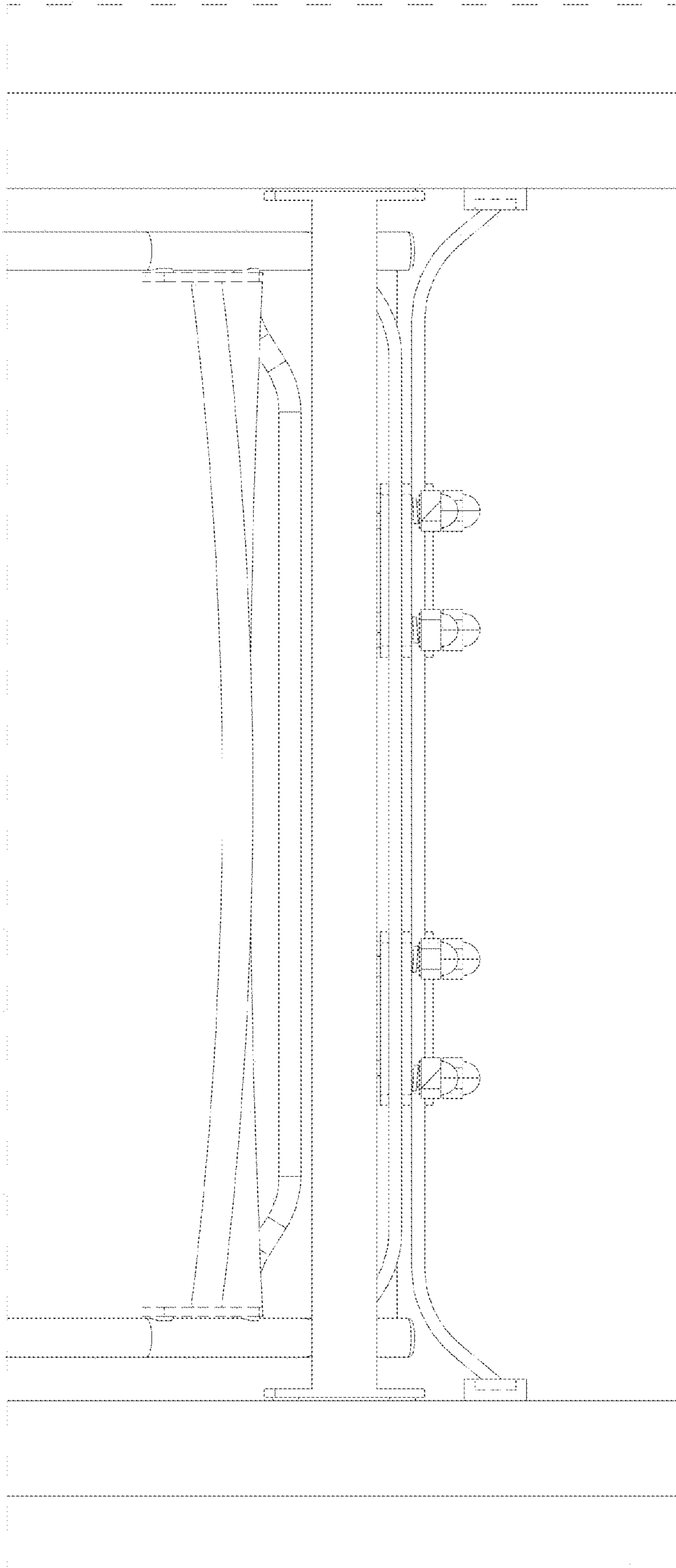


**Fig.6**

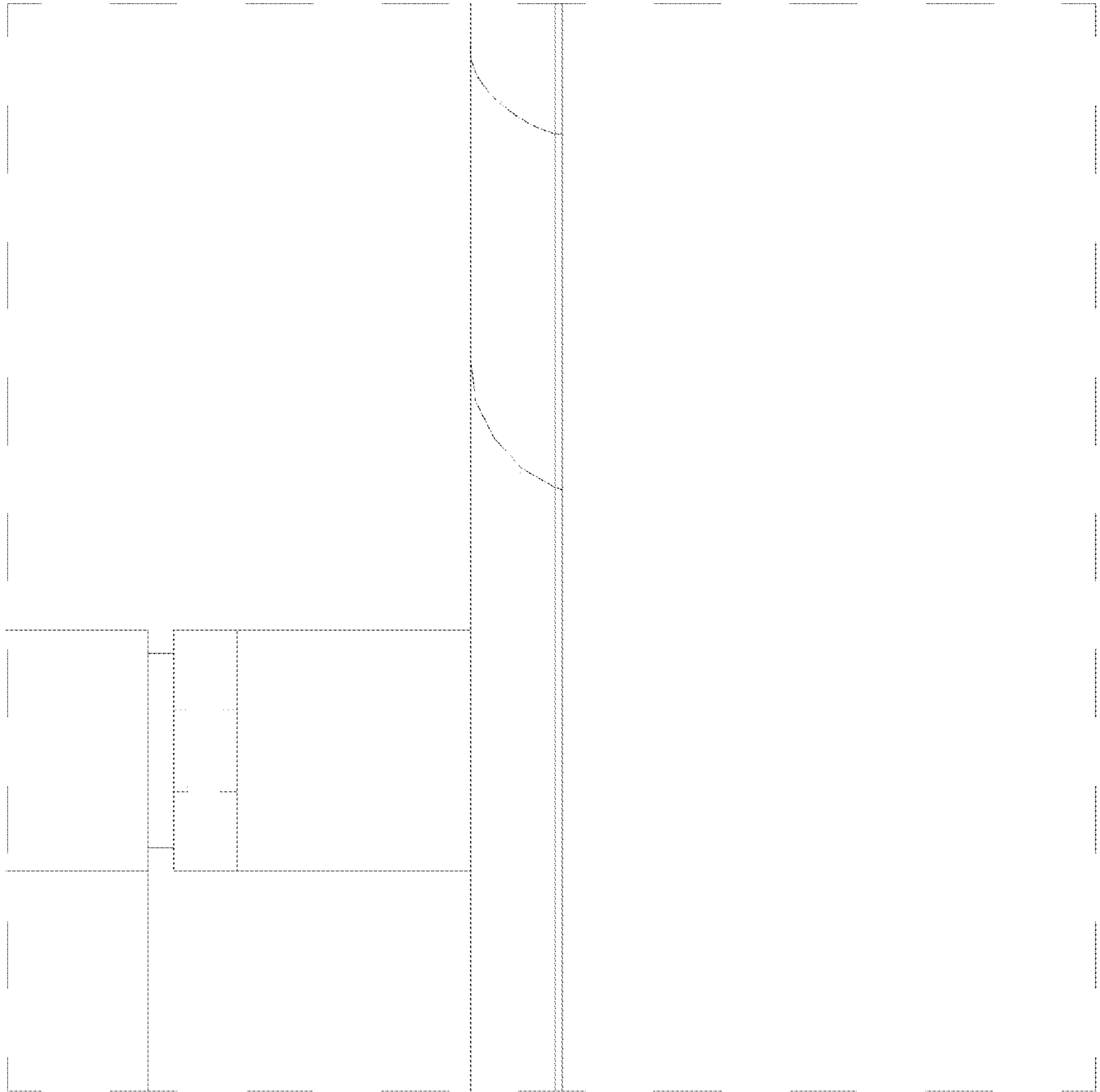




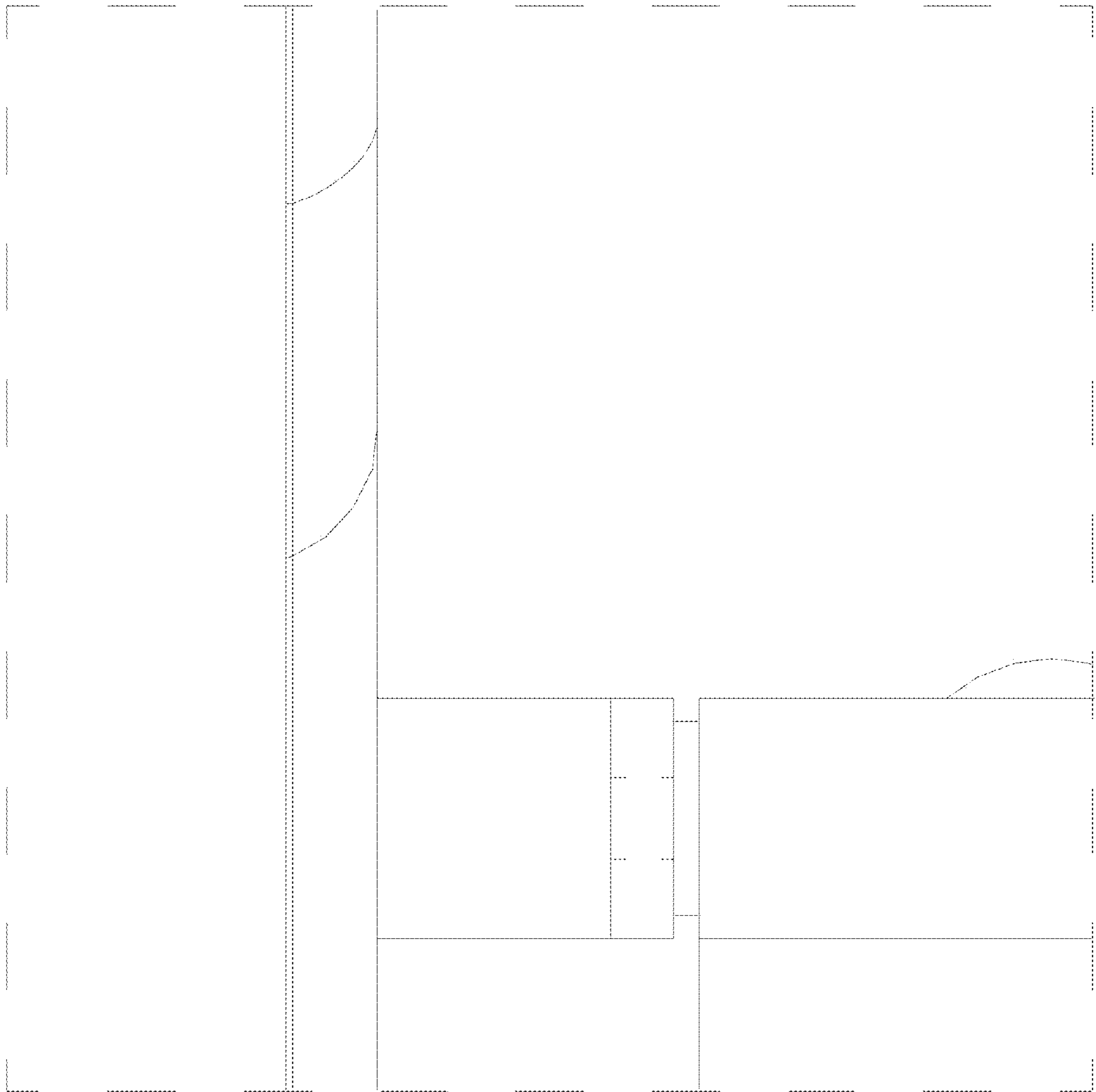
**FIG. 7**



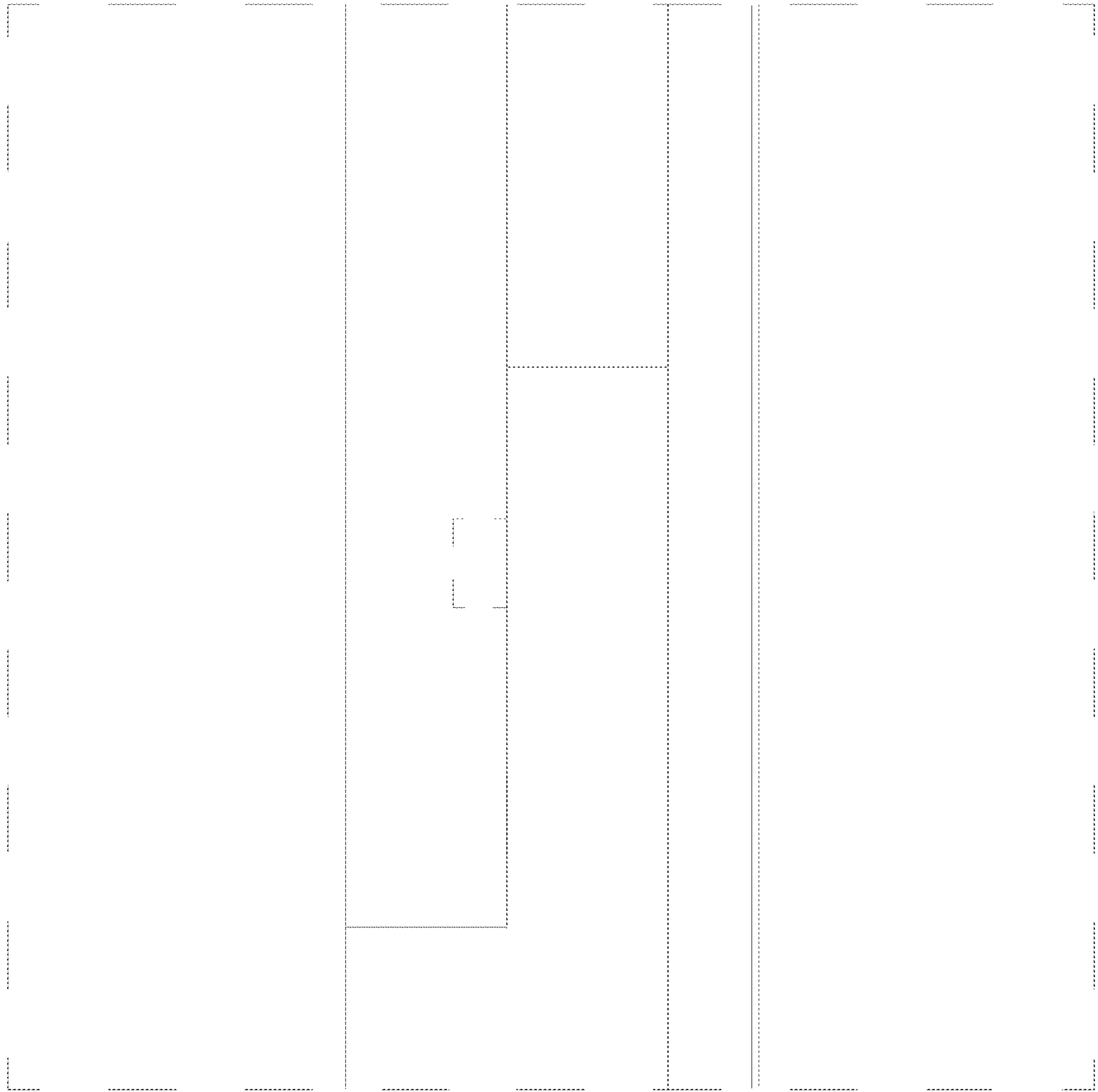
**FIG. 8**



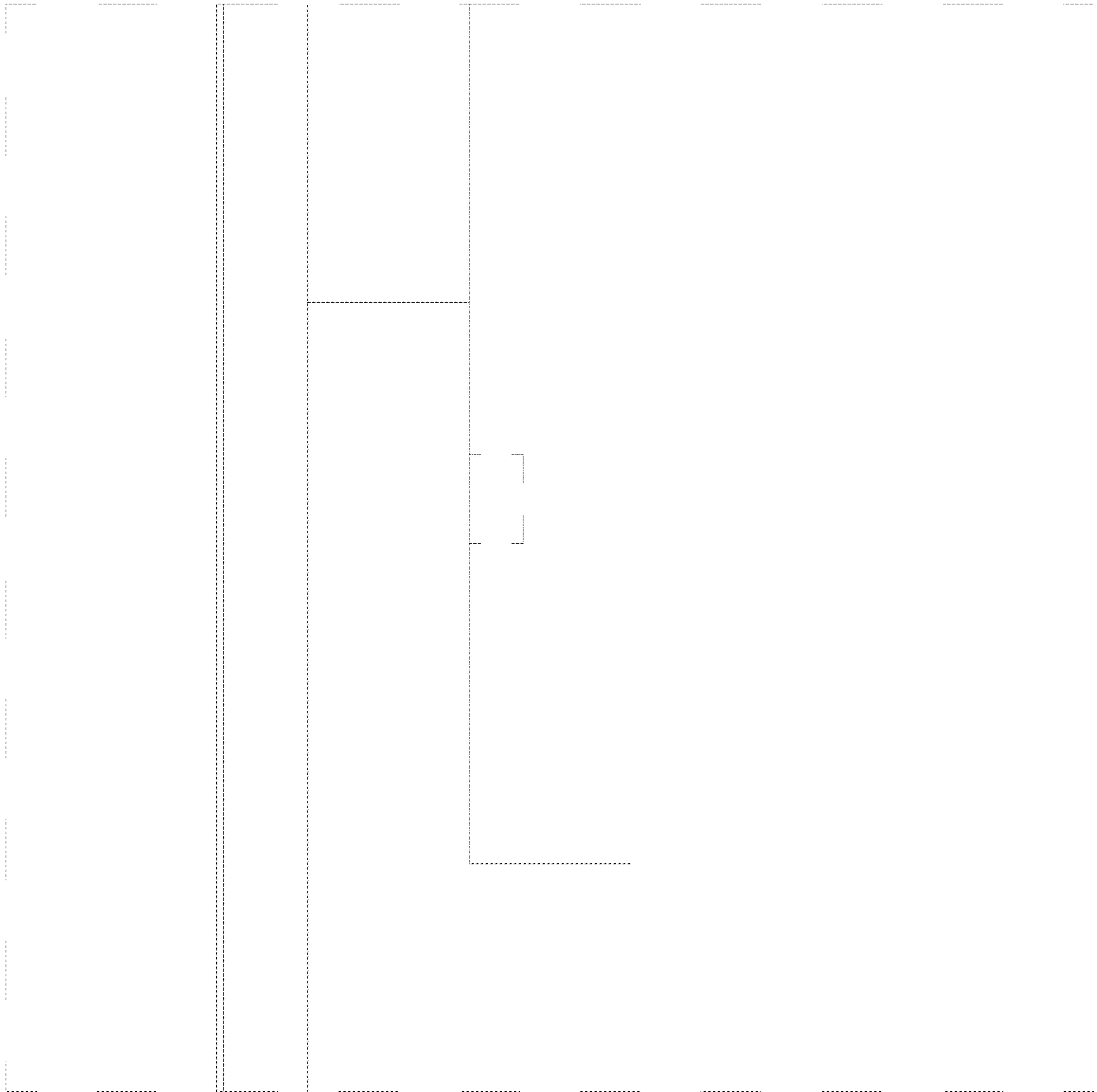
**FIG. 9**



**FIG.10**



**FIG. 11**



**FIG. 12**



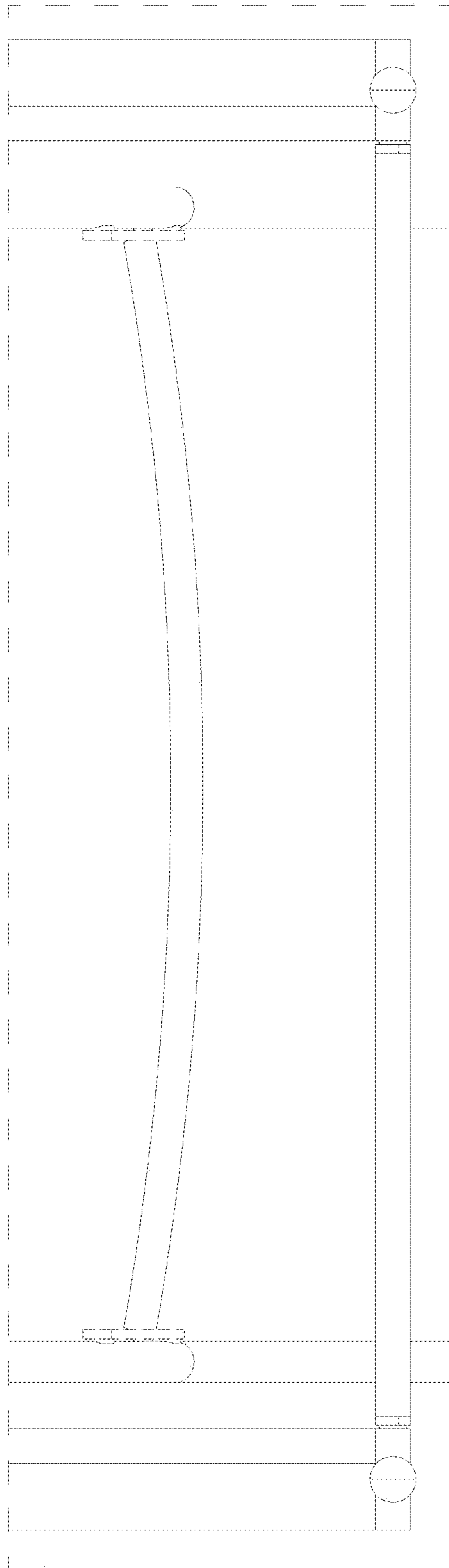


FIG. 13