



US00D980042S

(12) **United States Design Patent** (10) **Patent No.:** **US D980,042 S**  
**Zhong** (45) **Date of Patent:** **\*\* Mar. 7, 2023**

(54) **WINDOW LOCK**

(71) Applicant: **Shenzhen Kuaikelai Technology Co., Ltd.**, Shenzhen (CN)

(72) Inventor: **Yunhai Zhong**, Shenzhen (CN)

(73) Assignee: **Shenzhen Kuaikelai Technology Co., Ltd.**, Shenzhen (CN)

(\*\*) Term: **15 Years**

(21) Appl. No.: **29/865,127**

(22) Filed: **Jul. 9, 2022**

(51) **LOC (14) Cl.** ..... **08-07**

(52) **U.S. Cl.**  
USPC ..... **D8/331**

(58) **Field of Classification Search**  
USPC ..... D8/330, 331, 333, 334, 337, 357, 341,  
D8/342, 346, 349  
CPC .... E05C 1/14; E05B 15/0033; E05B 47/0045;  
E05B 3/08; E05F 15/40  
See application file for complete search history.

(56) **References Cited**

**U.S. PATENT DOCUMENTS**

D251,542 S *	4/1979	Ozvath	.....	D8/343
D303,079 S *	8/1989	Parthenis	.....	D8/331
D495,582 S *	9/2004	Richardson	.....	D8/337
D542,624 S *	5/2007	Vickers	.....	D8/331
D578,375 S *	10/2008	Samhammer	.....	D8/331
D635,436 S	4/2011	Barton		
D635,437 S *	4/2011	Barton	.....	D8/331
D635,438 S	4/2011	Barton		
D635,439 S	4/2011	Barton		
D635,440 S	4/2011	Barton		
9,062,487 B2 *	6/2015	Perry	.....	E05F 15/40
D762,447 S *	8/2016	Sanz	.....	D8/331
D842,680 S *	3/2019	Huang	.....	D8/330
D956,515 S *	7/2022	Gokcebay	.....	D8/331
11,428,027 B2 *	8/2022	Huang	.....	E05B 47/0045

**OTHER PUBLICATIONS**

<https://www.amazon.com/Sliding-Glass-Door-Child-Lock/dp/B07TQJVQG6>, from Amazon.com, printed on Jul. 5, 2022.  
<https://www.amazon.com/dp/B086C3WR1B>, from Amazon.com, printed on Jul. 5, 2022.  
<https://www.amazon.com/dp/B0879BD8J9>, from Amazon.com, printed on Jul. 5, 2022.

\* cited by examiner

*Primary Examiner* — Ramzi Almatrahi

(74) *Attorney, Agent, or Firm* — Vladimir Postnikov

(57) **CLAIM**

The ornamental design for a window lock, as shown and described.

**DESCRIPTION**

FIG. 1 is a front elevation view of a window lock showing the new design;  
FIG. 2 is a back elevation view thereof;  
FIG. 3 is a left side elevation view thereof;  
FIG. 4 is a right side elevation view thereof;  
FIG. 5 is a top plan view thereof;  
FIG. 6 is a bottom plan view thereof;  
FIG. 7 is a top, front and left side perspective view thereof;  
FIG. 8 is a bottom, back and left side perspective view thereof;  
FIG. 9 is a top, front and left side perspective view thereof, shown in an opened configuration; and,  
FIG. 10 is a left side elevation view thereof, shown in an opened configuration.  
The broken lines depict portions of the window lock in which the design is embodied that form no part of the claimed design.

**1 Claim, 10 Drawing Sheets**

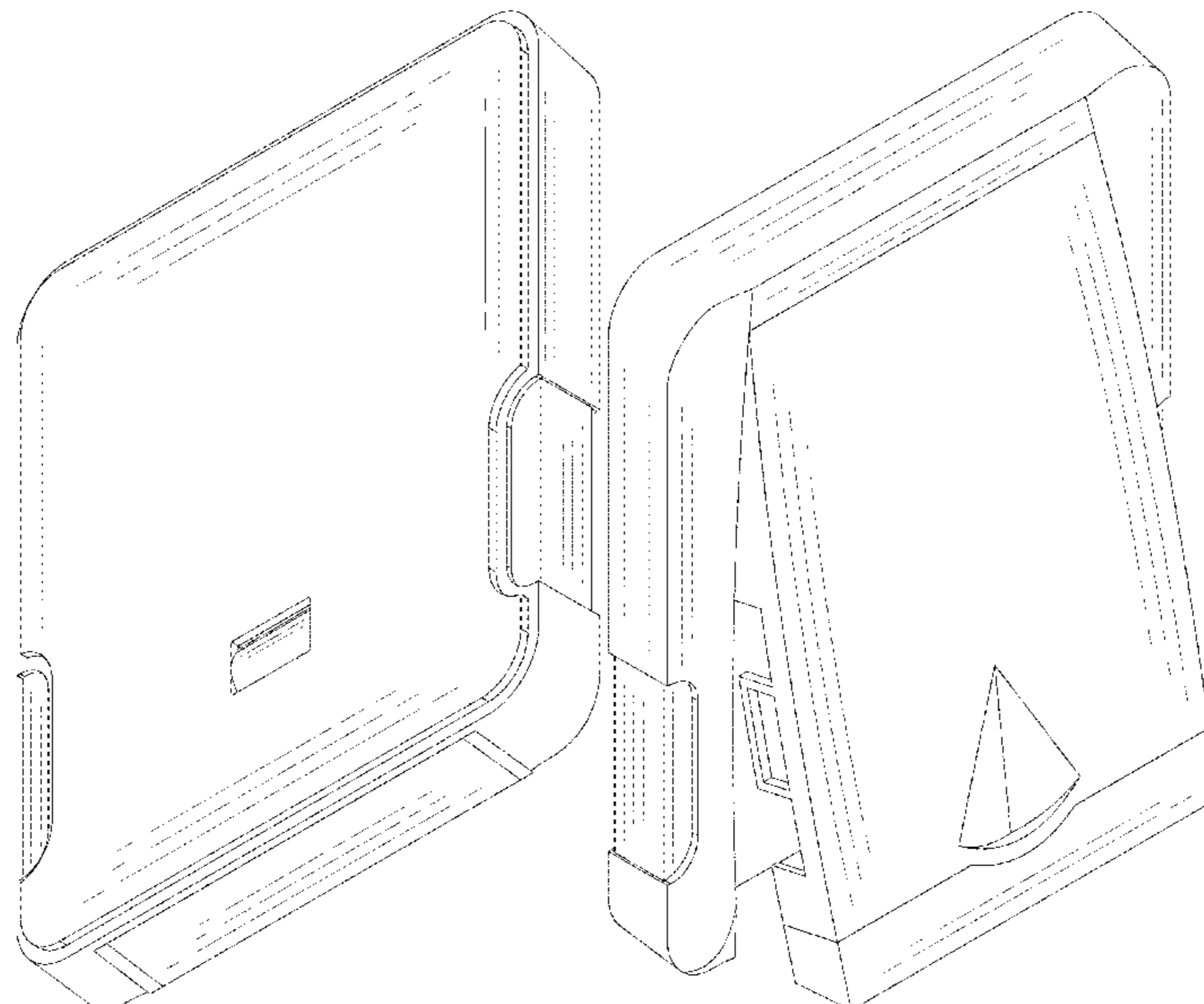

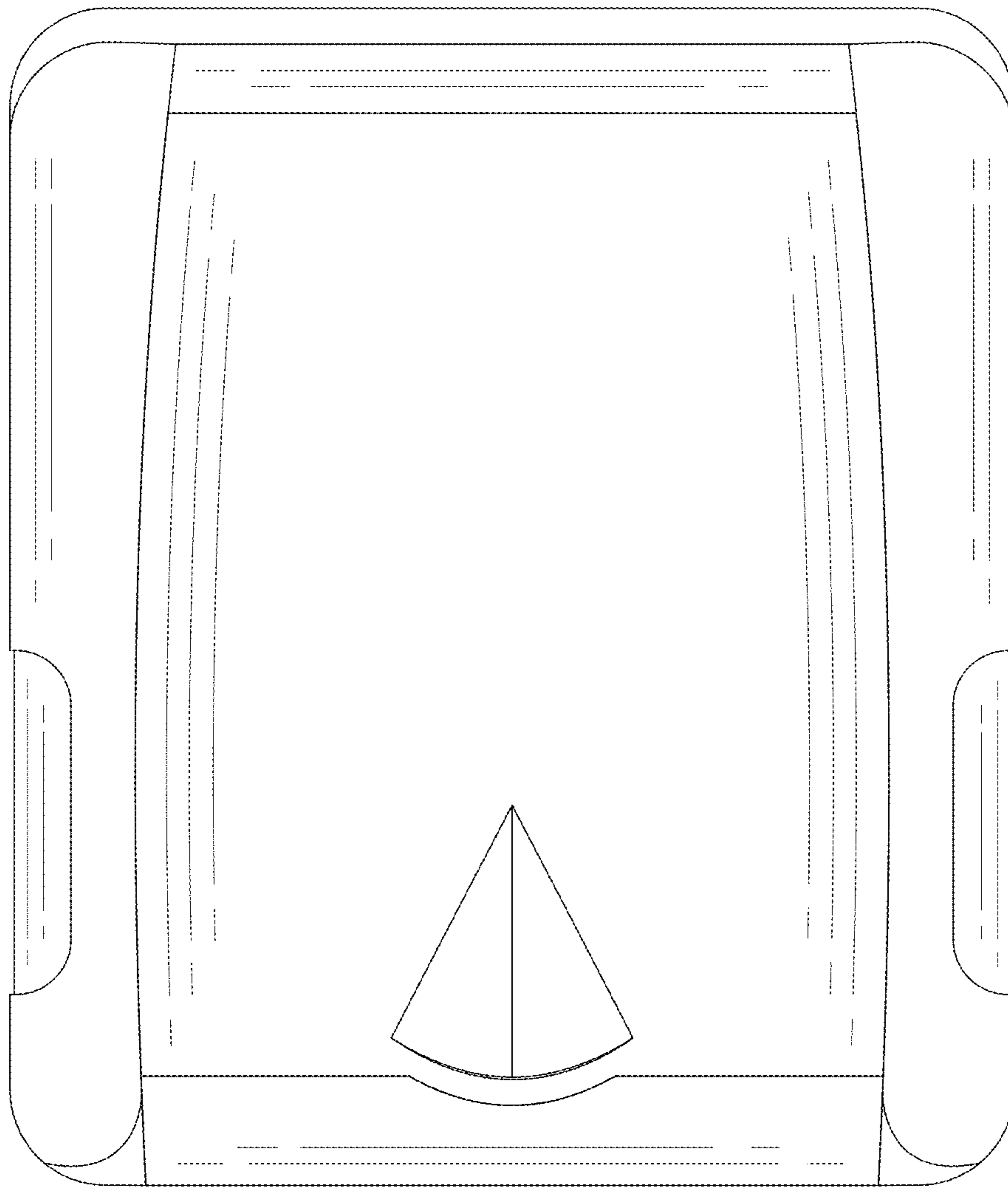

FIG. 1

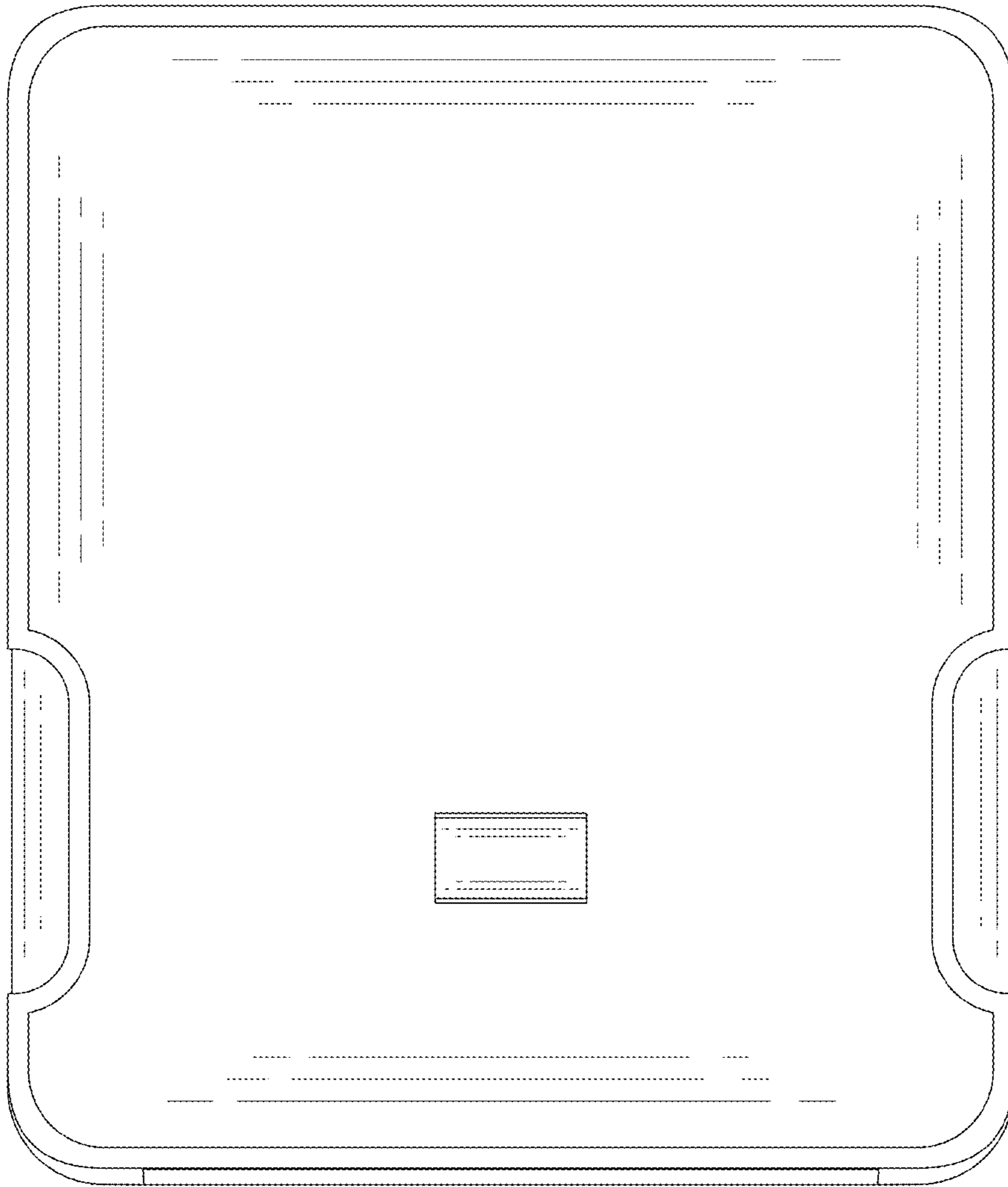

FIG. 2

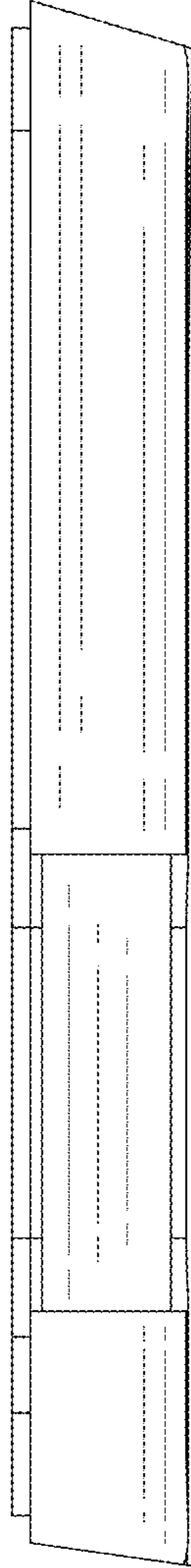

FIG. 3

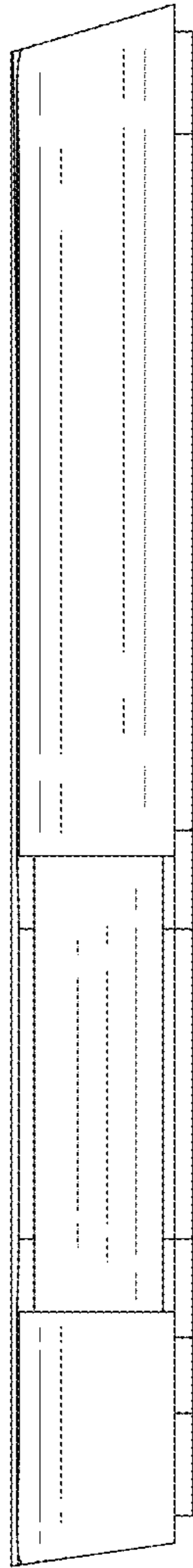

FIG. 4

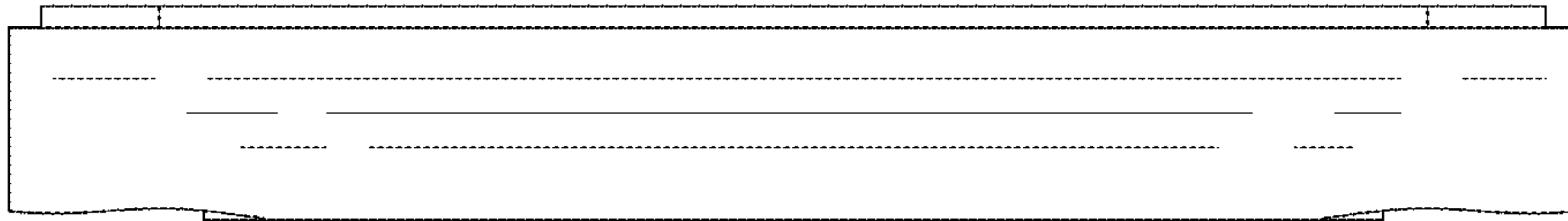

FIG. 5

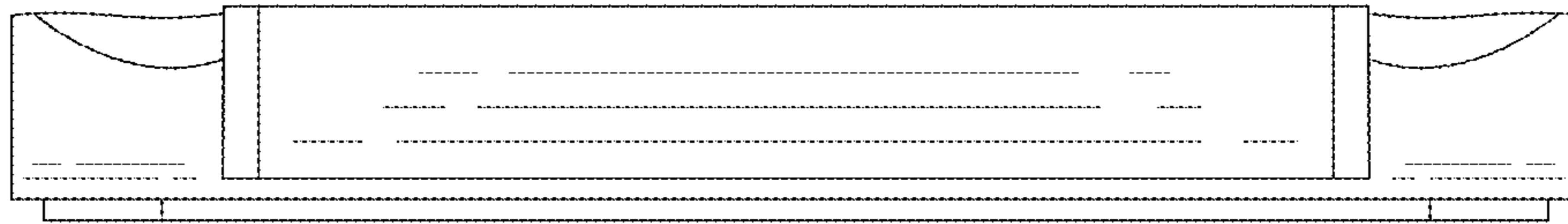

FIG. 6

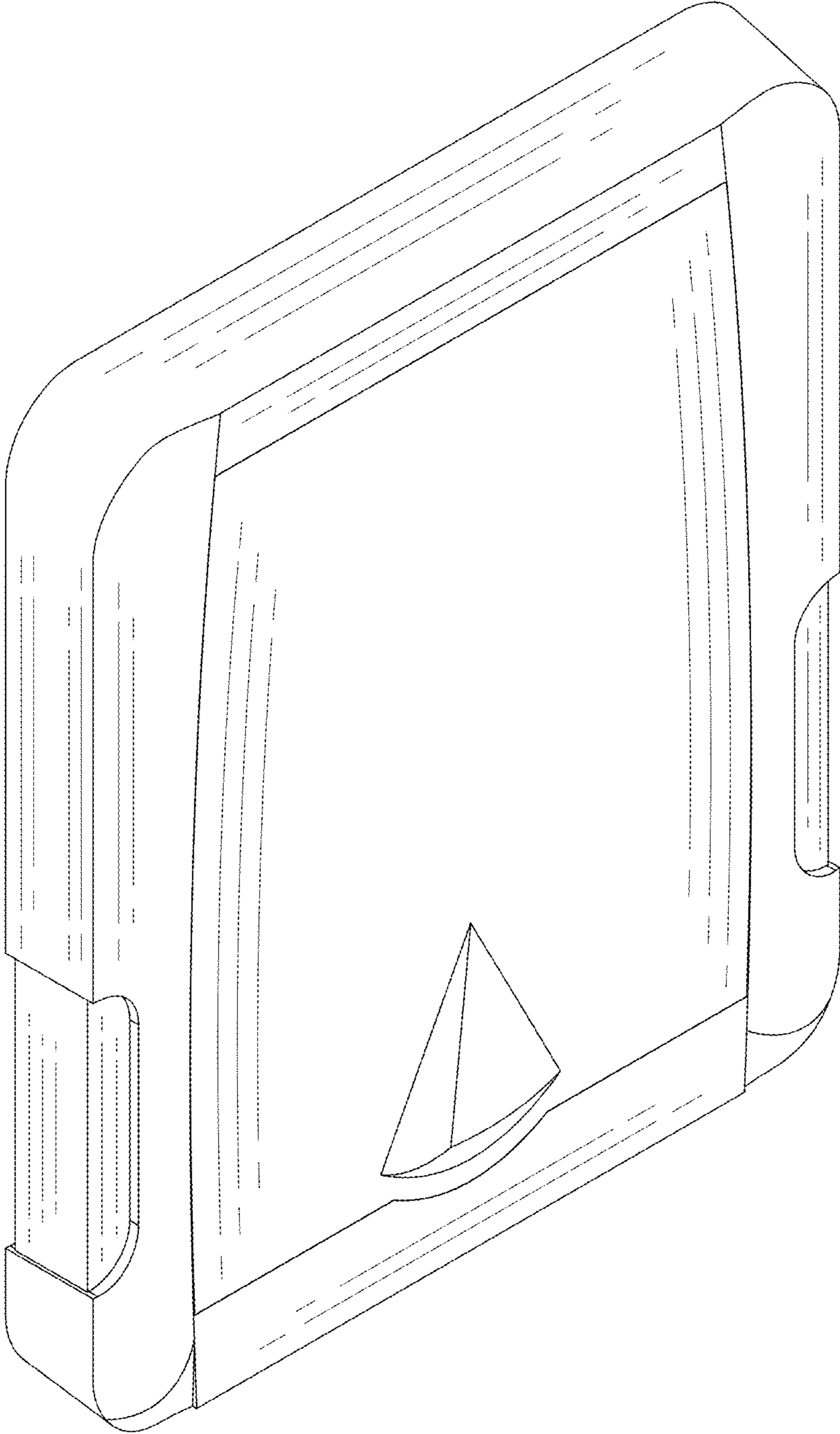

FIG. 7



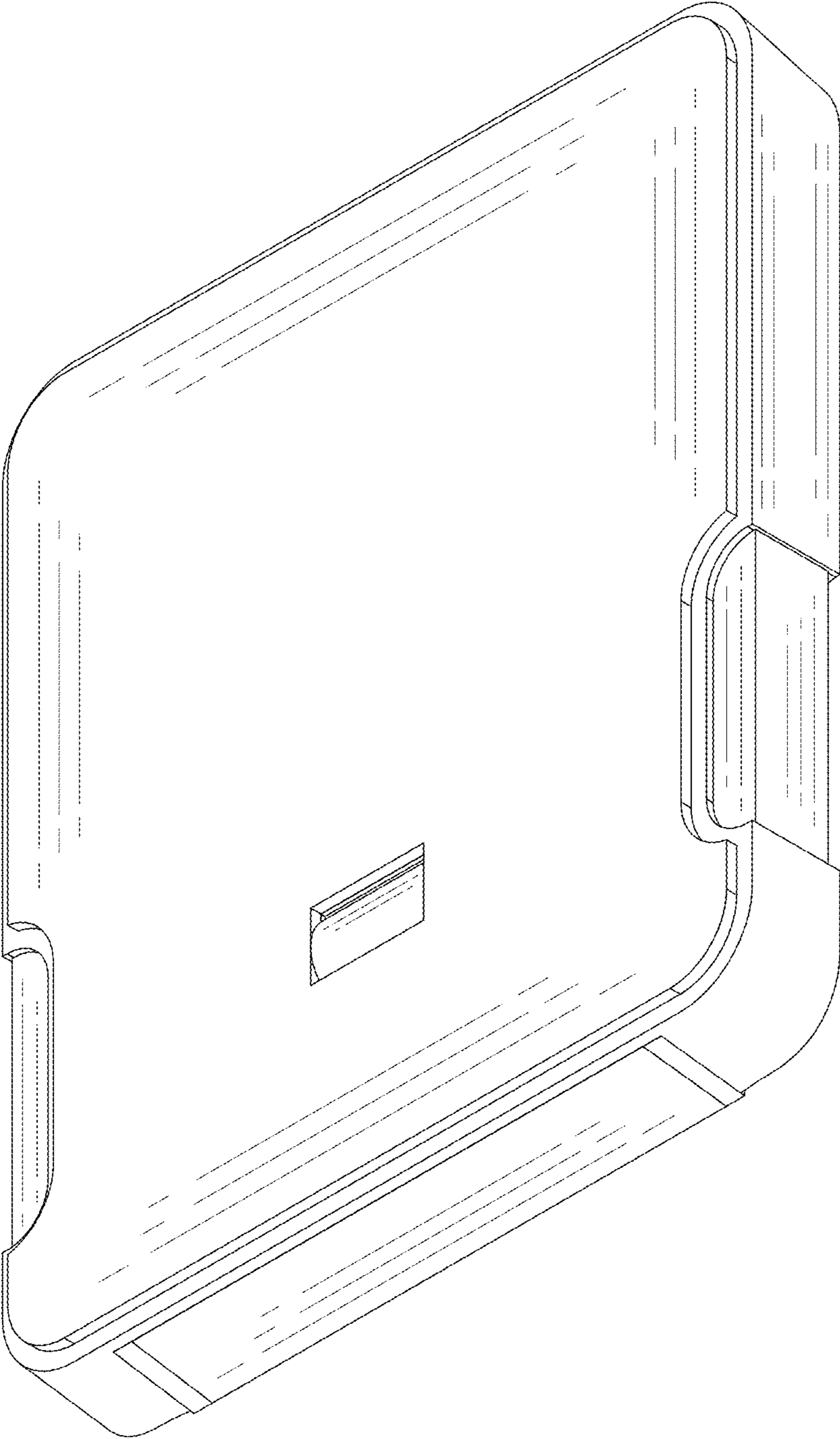

FIG. 8

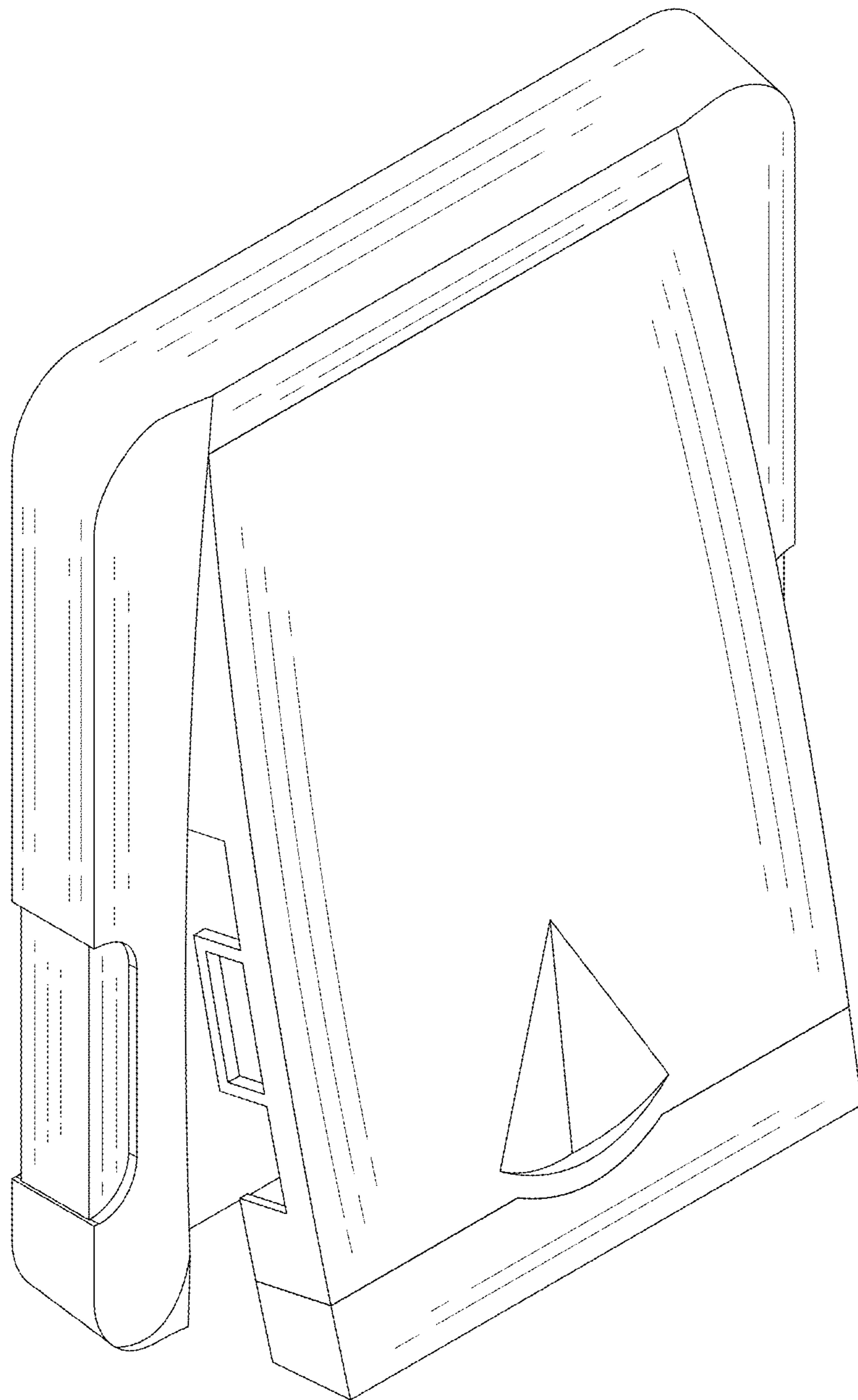

FIG. 9

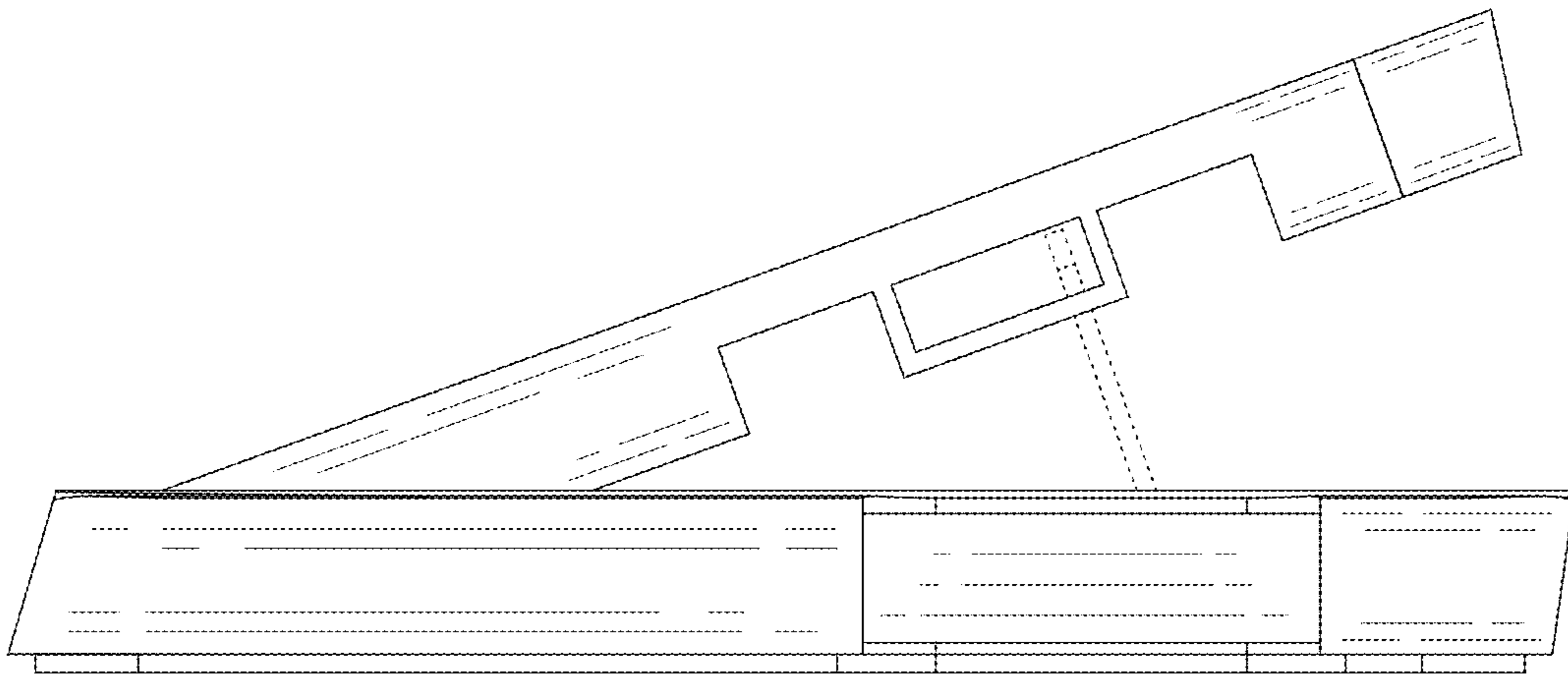

FIG. 10