



US00D979719S

(12) **United States Design Patent**
Xu

(10) **Patent No.:** **US D979,719 S**

(45) **Date of Patent:** **** Feb. 28, 2023**

(54) **WATER PRESSURE REGULATOR FOR RV**

7,753,414 B2 * 7/2010 Hauki F16L 33/04
285/253

(71) Applicant: **Ningbo Eastpure Environmental
Technology Co., Ltd., Ningbo (CN)**

D758,555 S * 6/2016 Van Dyke D23/262

D787,648 S * 5/2017 Smith D23/259

D896,930 S * 9/2020 Vranish D23/262

D922,541 S * 6/2021 Mulhern D23/262

(72) Inventor: **Yanfeng Xu, Ningbo (CN)**

* cited by examiner

(73) Assignee: **Ningbo Eastpure Environmental
Technology Co., Ltd., Ningbo (CN)**

Primary Examiner — Gino Colan

(74) *Attorney, Agent, or Firm* — ScienBiziP, P.C.

(**) Term: **15 Years**

(57) **CLAIM**

(21) Appl. No.: **29/741,513**

The ornamental design for a water pressure regulator for RV,
as shown and described.

(22) Filed: **Jul. 14, 2020**

DESCRIPTION

(51) **LOC (14) Cl.** **23-07**

(52) **U.S. Cl.**
USPC **D23/259**

(58) **Field of Classification Search**
USPC D23/262, 259, 233, 235, 247, 248, 266;
285/253, 903
CPC B60R 15/00; E03F 1/008; F16L 33/08
See application file for complete search history.

FIG. 1 is a top perspective view of a water pressure regulator
for RV, showing my design.

FIG. 2 is a bottom perspective view thereof.

FIG. 3 is a front elevation view thereof.

FIG. 4 is a rear elevation view thereof.

FIG. 5 is a left side elevation view thereof.

FIG. 6 is a right side elevation view thereof.

FIG. 7 is a top plan view thereof; and,

FIG. 8 is a bottom plan view thereof.

The broken lines in the drawings depict environmental
structure and boundaries and form no part of the claimed
design.

(56) **References Cited**

U.S. PATENT DOCUMENTS

7,063,358 B2 * 6/2006 Ingram F16L 47/22
285/903

D554,237 S * 10/2007 Lewis D23/259

1 Claim, 8 Drawing Sheets

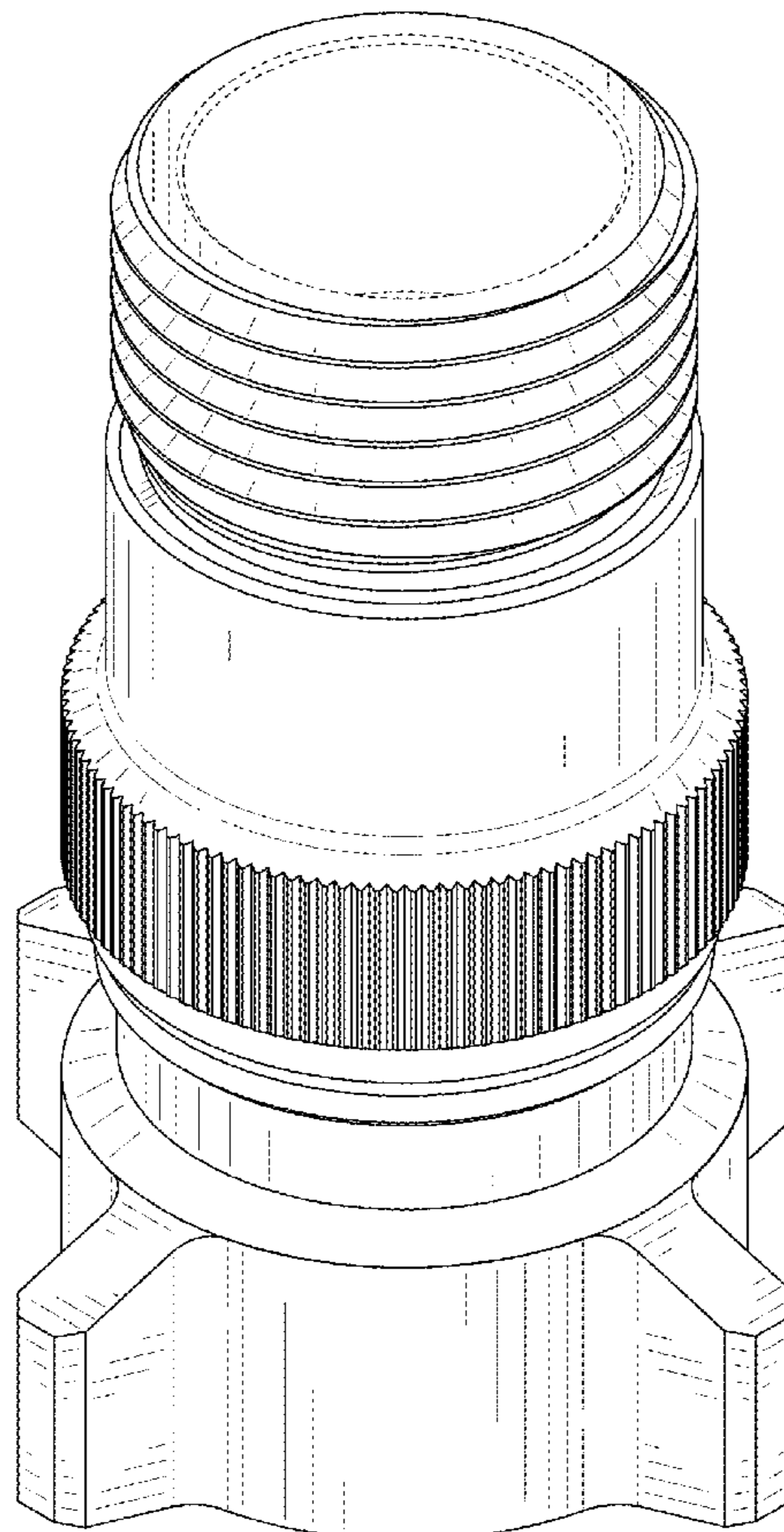

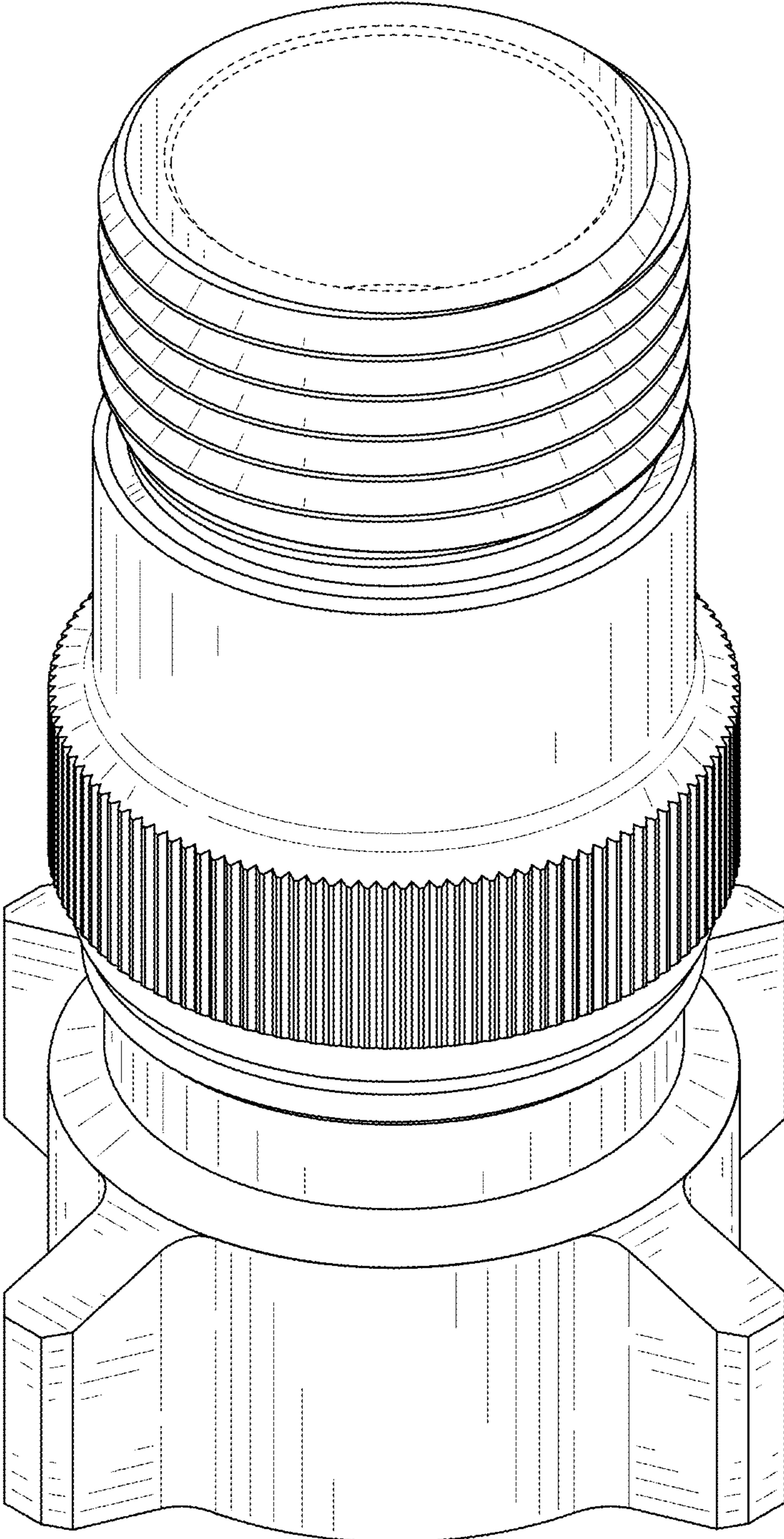

FIG. 1

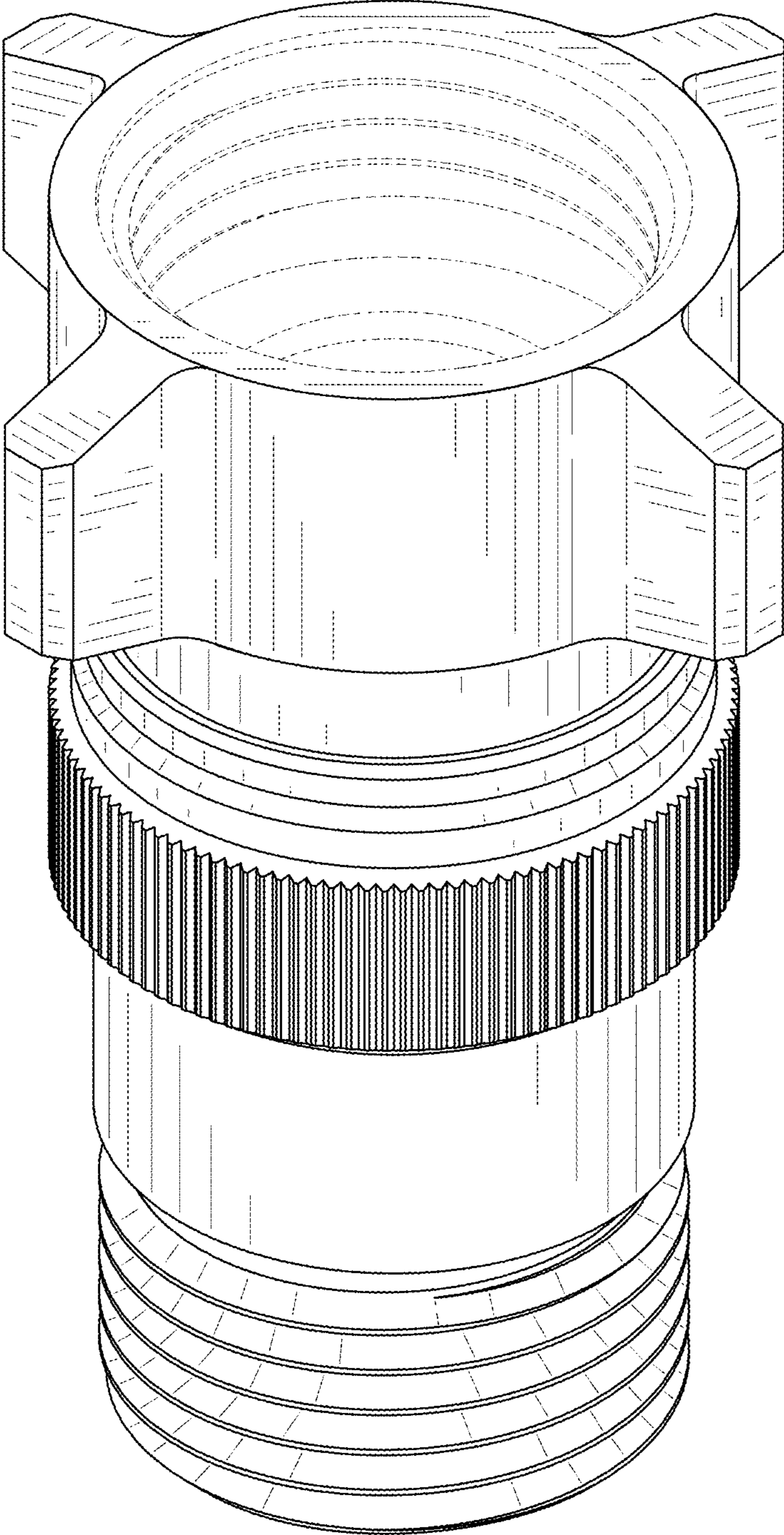

FIG. 2

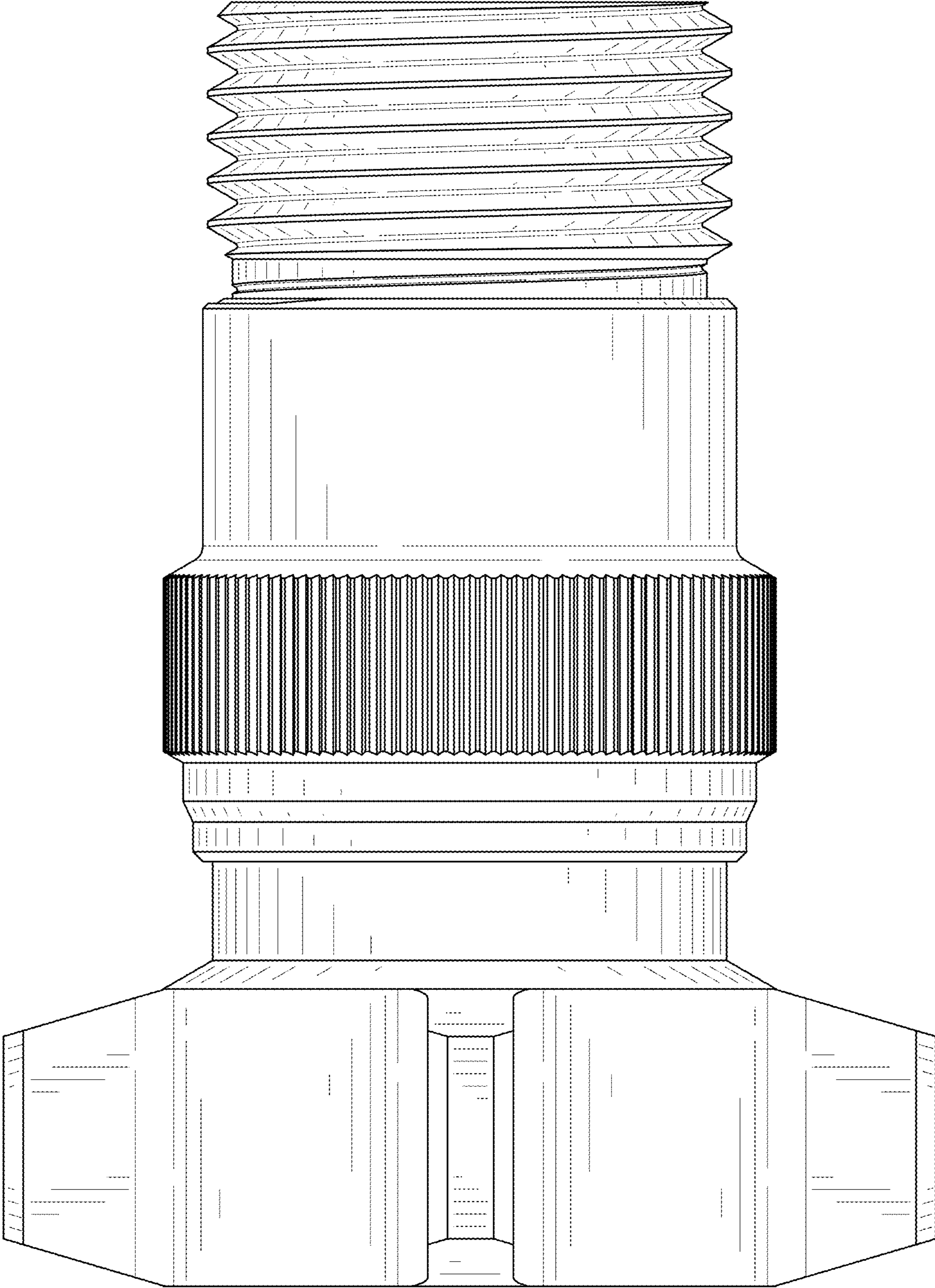

FIG. 3

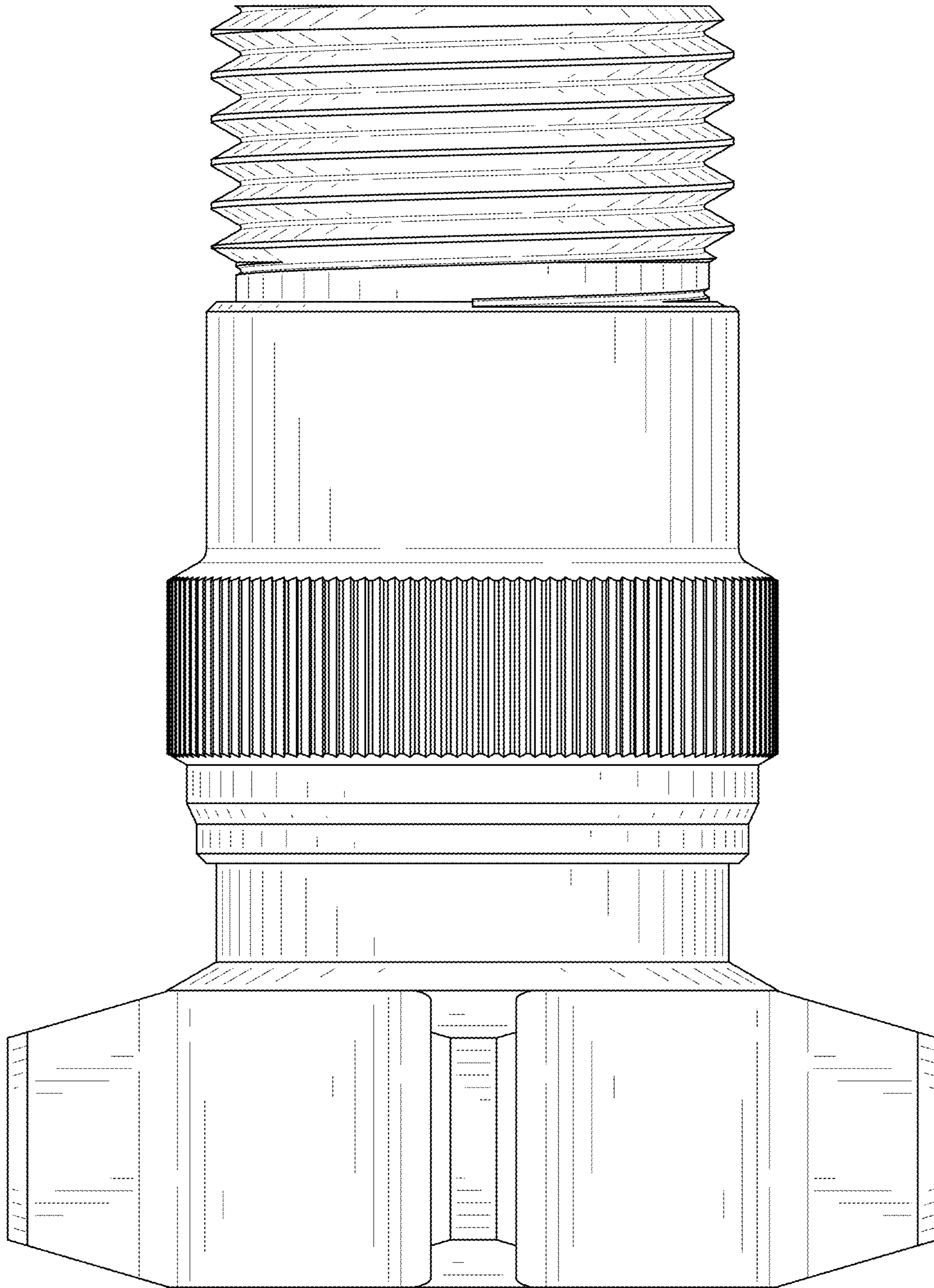

FIG. 4

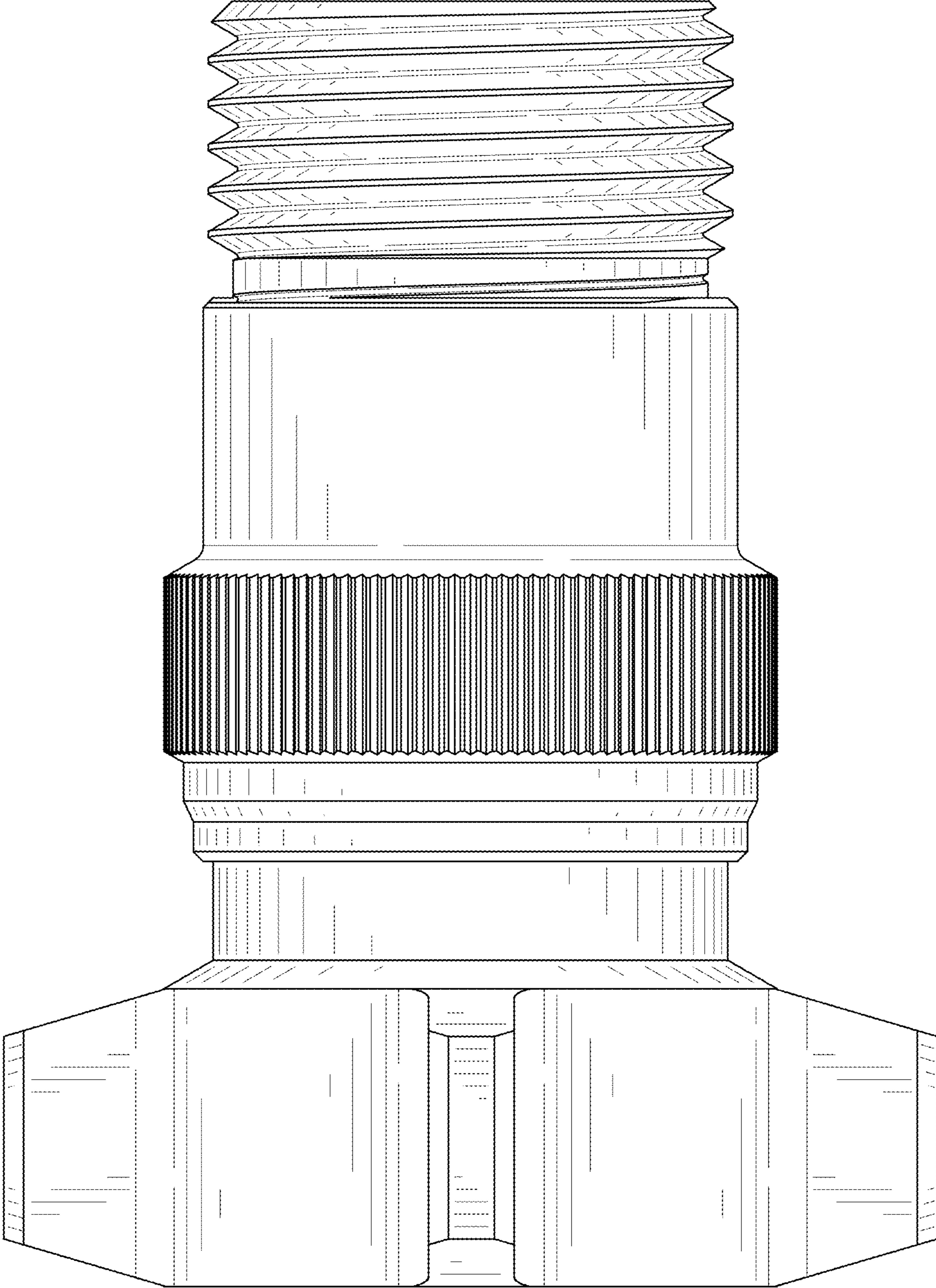

FIG. 5

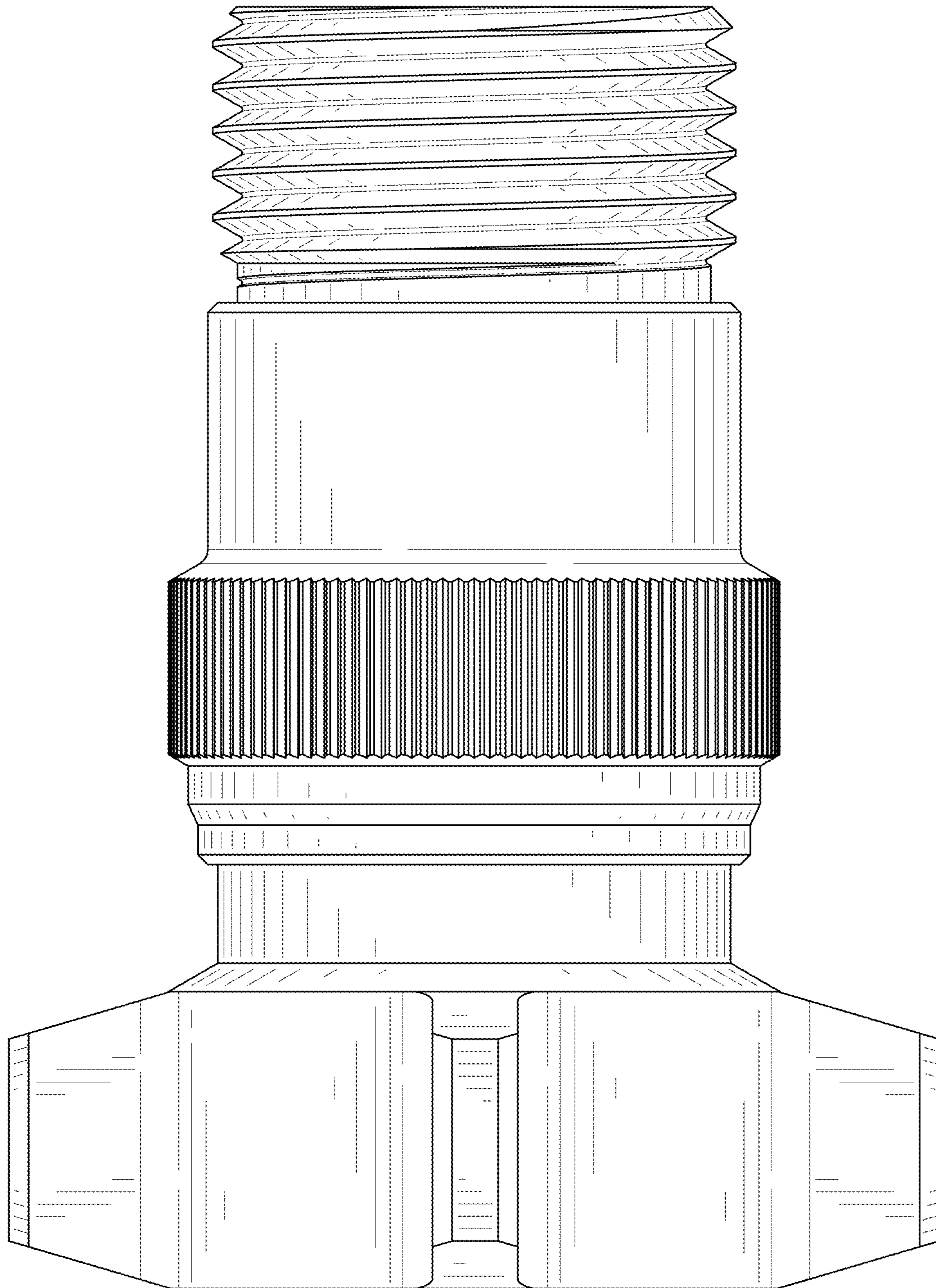

FIG. 6

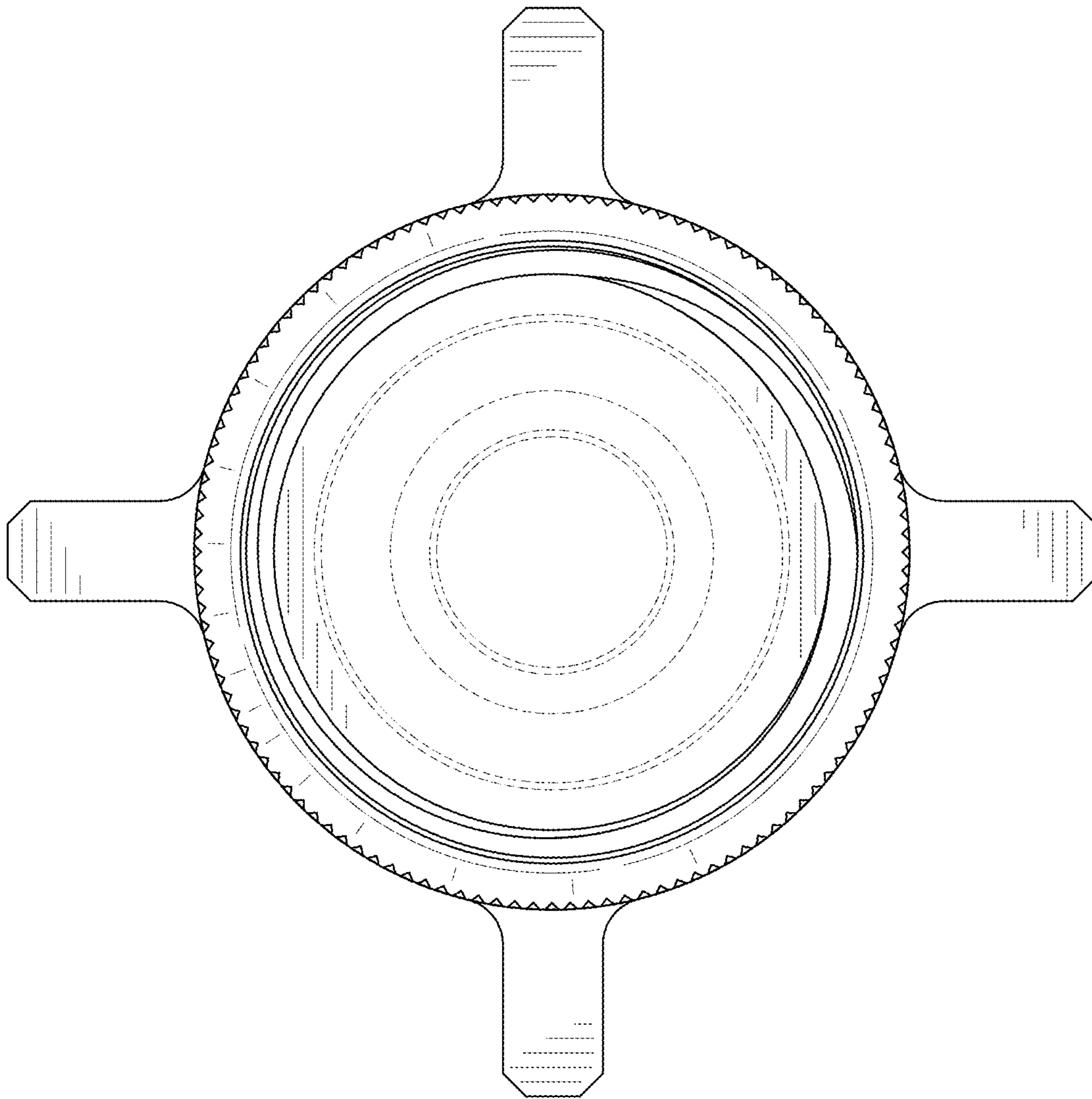

FIG. 7

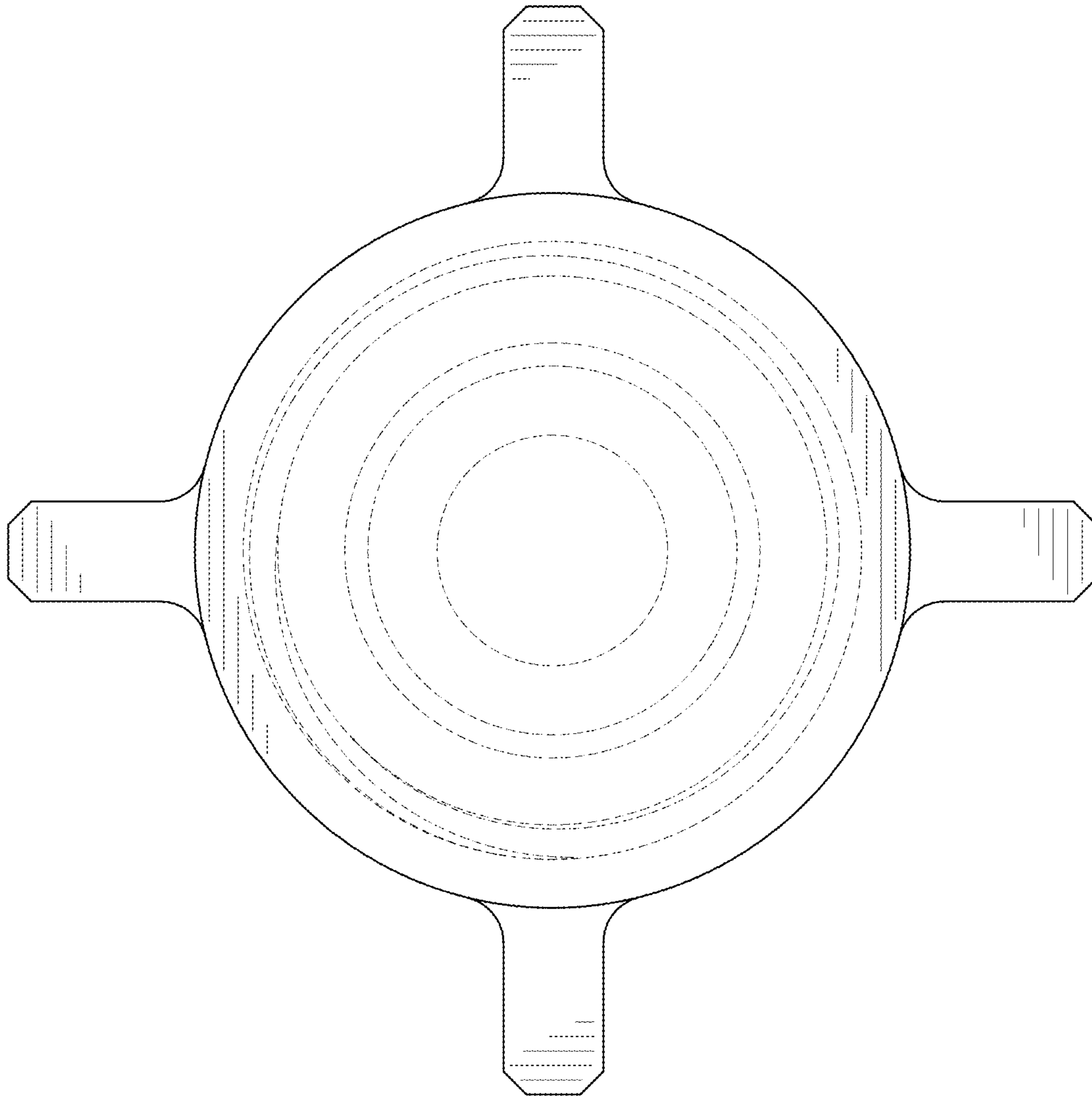

FIG. 8