

US00D979618S

(12) **United States Design Patent**
Wu et al.

(10) **Patent No.:** **US D979,618 S**

(45) **Date of Patent:** **** Feb. 28, 2023**

(54) **LABELING MACHINE**

(71) Applicant: **ZHEJIANG YOULIAN
MACHINERY MANUFACTURING
CO., LTD., Wenzhou (CN)**

(72) Inventors: **Shudong Wu, Wenzhou (CN); Oubin
Wu, Wenzhou (CN)**

(73) Assignee: **ZHEJIANG YOULIAN
MACHINERY MANUFACTURING
CO., LTD., Wenzhou (CN)**

(**) Term: **15 Years**

(21) Appl. No.: **29/796,381**

(22) Filed: **Jun. 24, 2021**

(51) **LOC (14) Cl.** **15-09**

(52) **U.S. Cl.**
USPC **D15/145; D15/122**

(58) **Field of Classification Search**
USPC D15/122, 145, 146, 199
CPC B65C 1/04; B65C 1/045; B65C 9/1884;
B65C 9/34
See application file for complete search history.

(56) **References Cited**

U.S. PATENT DOCUMENTS

- 1,402,262 A * 1/1922 Smith B65C 1/042
156/487
- D140,596 S * 3/1945 Carter D15/145
- 3,194,710 A * 7/1965 Stremke B65C 9/02
53/131.2
- 3,284,271 A * 11/1966 Parks G01G 23/18
156/566
- 3,822,163 A * 7/1974 Bilotti B65B 11/02
156/484
- 3,904,466 A * 9/1975 Jones B65C 1/047
156/364
- D241,237 S * 8/1976 Pettis B65C 9/42
D10/88

- D241,677 S * 9/1976 Pacholok B65C 9/1865
D15/145
- D300,326 S * 3/1989 Chilcoate B65B 11/28
D15/145
- D333,143 S * 2/1993 West B65C 1/042
D15/145
- 5,188,696 A * 2/1993 Good, Jr. B65C 3/16
156/542

(Continued)

FOREIGN PATENT DOCUMENTS

- WO WO-9509772 A1 * 4/1995 B65C 1/02
- WO WO-2012155290 A1 * 11/2012 B29C 63/423
- WO WO-2015140570 A1 * 9/2015 B65C 1/04

Primary Examiner — Patricia A Palasik

(57) **CLAIM**

The ornamental design for a labeling machine, as shown and described.

DESCRIPTION

FIG. 1 is a perspective view of a labeling machine showing my new design;
 FIG. 2 is another perspective view thereof;
 FIG. 3 is a front elevational view thereof;
 FIG. 4 is a rear elevational view thereof;
 FIG. 5 is a left side elevational view thereof;
 FIG. 6 is a right side elevational view thereof;
 FIG. 7 is a top plan view thereof;
 FIG. 8 is a bottom plan view thereof;
 FIG. 9 is an enlarged view of portion 9 shown in FIG. 1;
 FIG. 10 is an enlarged view of portion 10 shown in FIG. 1;
 FIG. 11 is an enlarged view of portion 11 shown in FIG. 2;
 and,
 FIG. 12 is an enlarged view of portion 12 shown in FIG. 2.
 The broken lines in the drawings depict portions of the labeling machine that form no part of the claimed design.

1 Claim, 12 Drawing Sheets

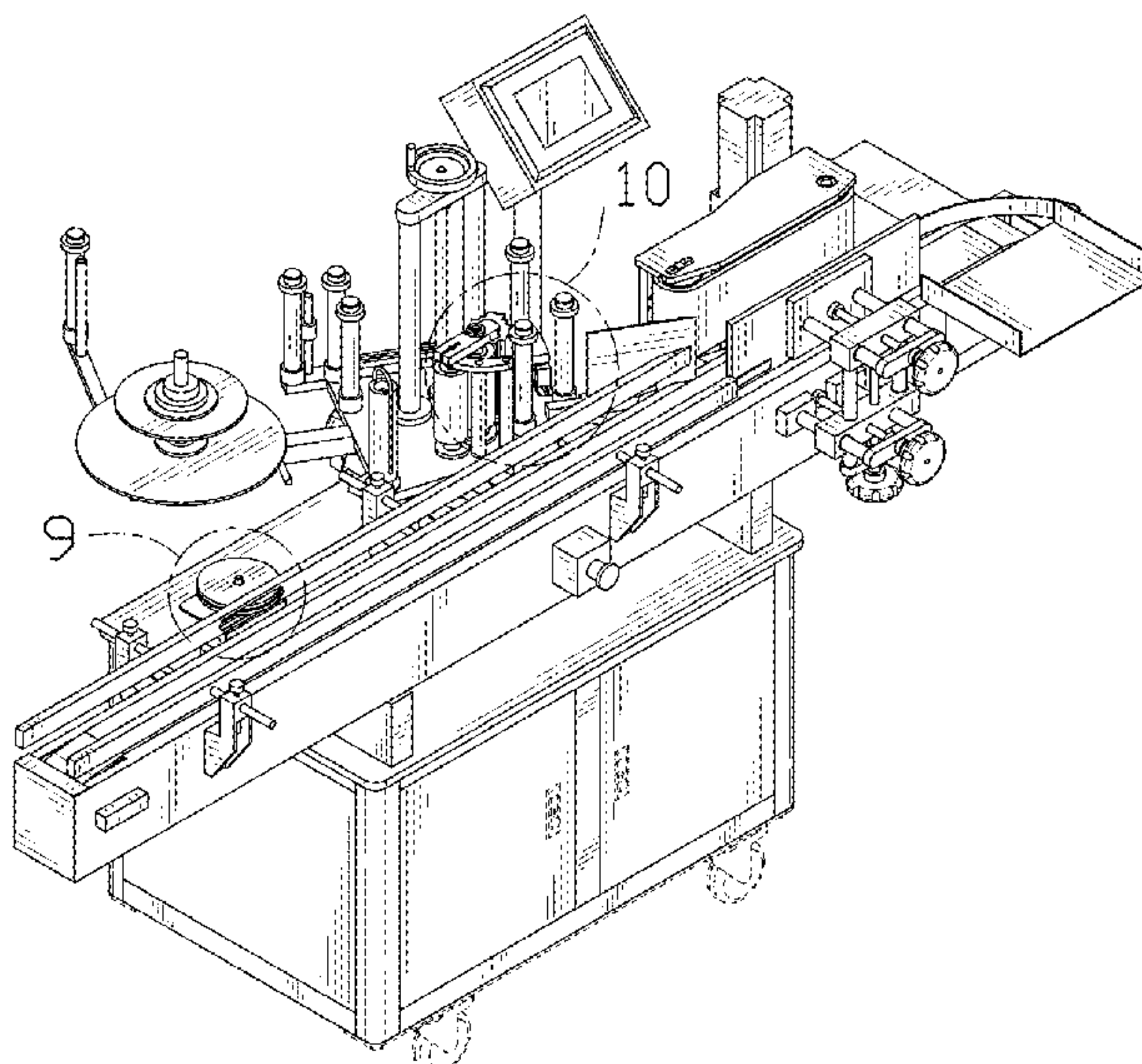

(56)

References Cited

U.S. PATENT DOCUMENTS

6,199,614 B1 * 3/2001 Snyder B65C 9/42
156/496
D629,432 S * 12/2010 Herzog G01G 23/18
D15/145
10,507,947 B2 * 12/2019 Pfeffer B65C 9/1865
2002/0096260 A1 * 7/2002 Yang B65C 9/06
156/566
2002/0096261 A1 * 7/2002 Yang B65C 9/46
156/352
2002/0096264 A1 * 7/2002 Yang B65C 3/14
156/64
2006/0065371 A1 * 3/2006 Grabowski B65C 9/1869
156/542
2021/0039821 A1 * 2/2021 Harvey B65C 9/1892

* cited by examiner

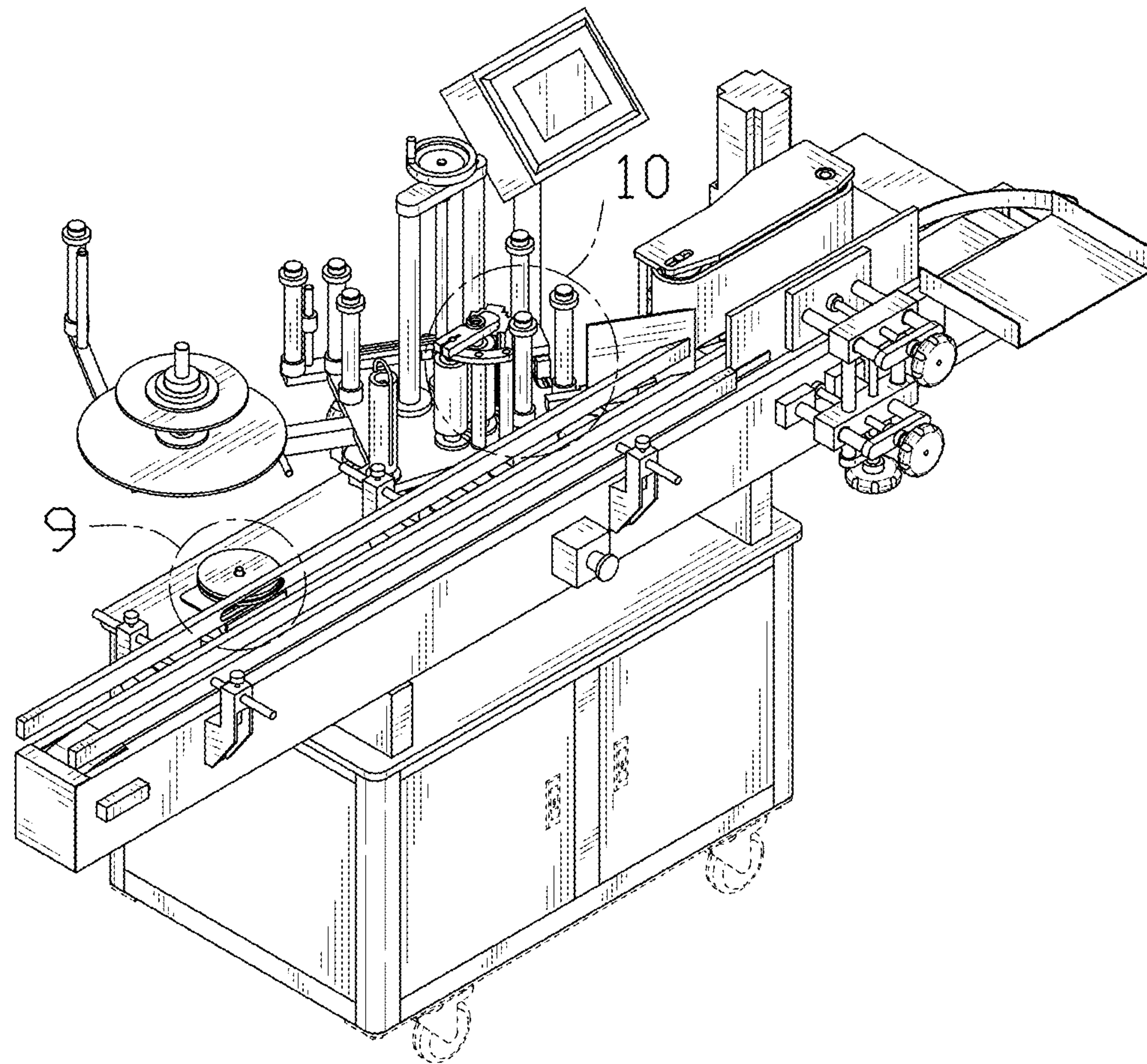

FIG. 1

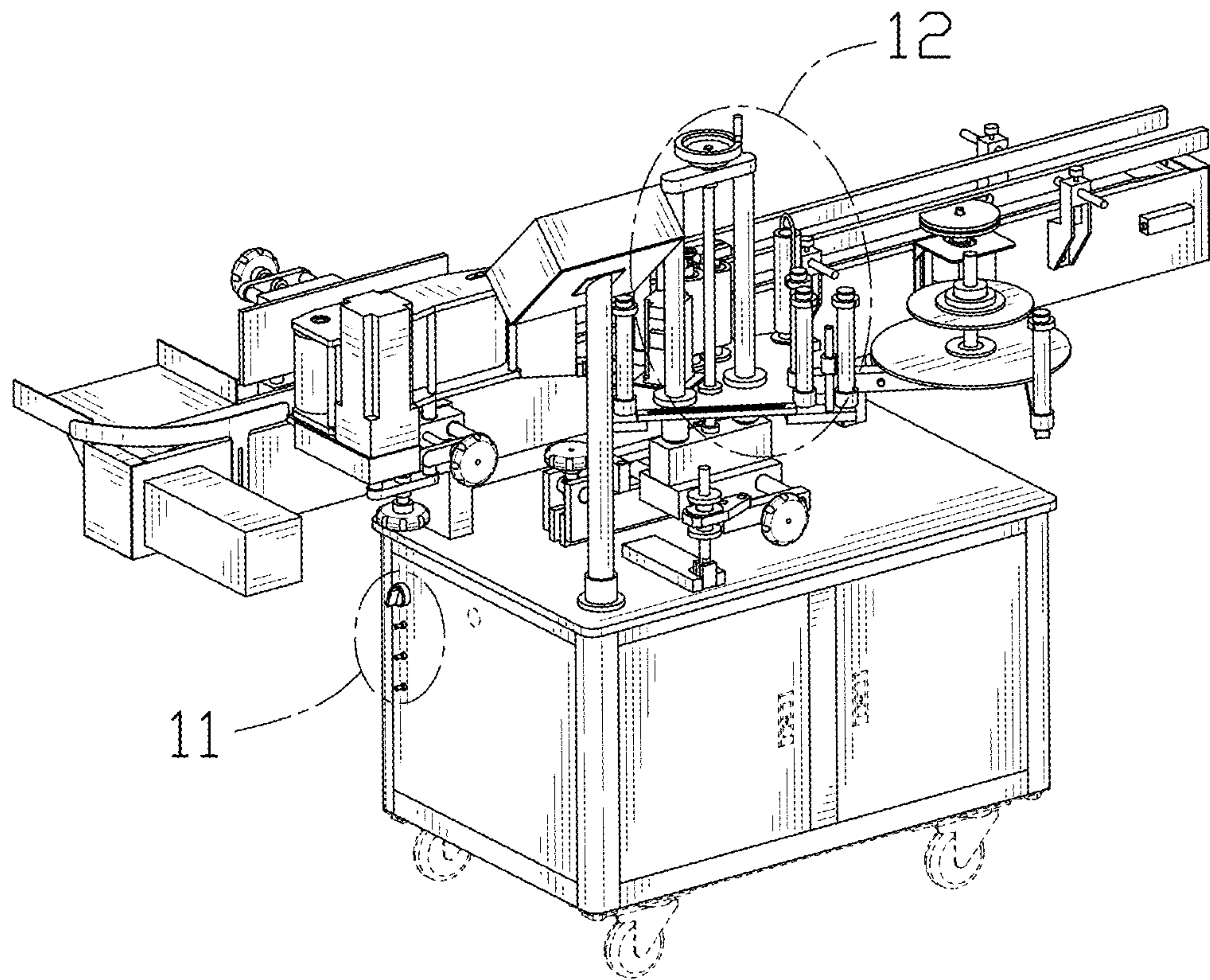

FIG. 2

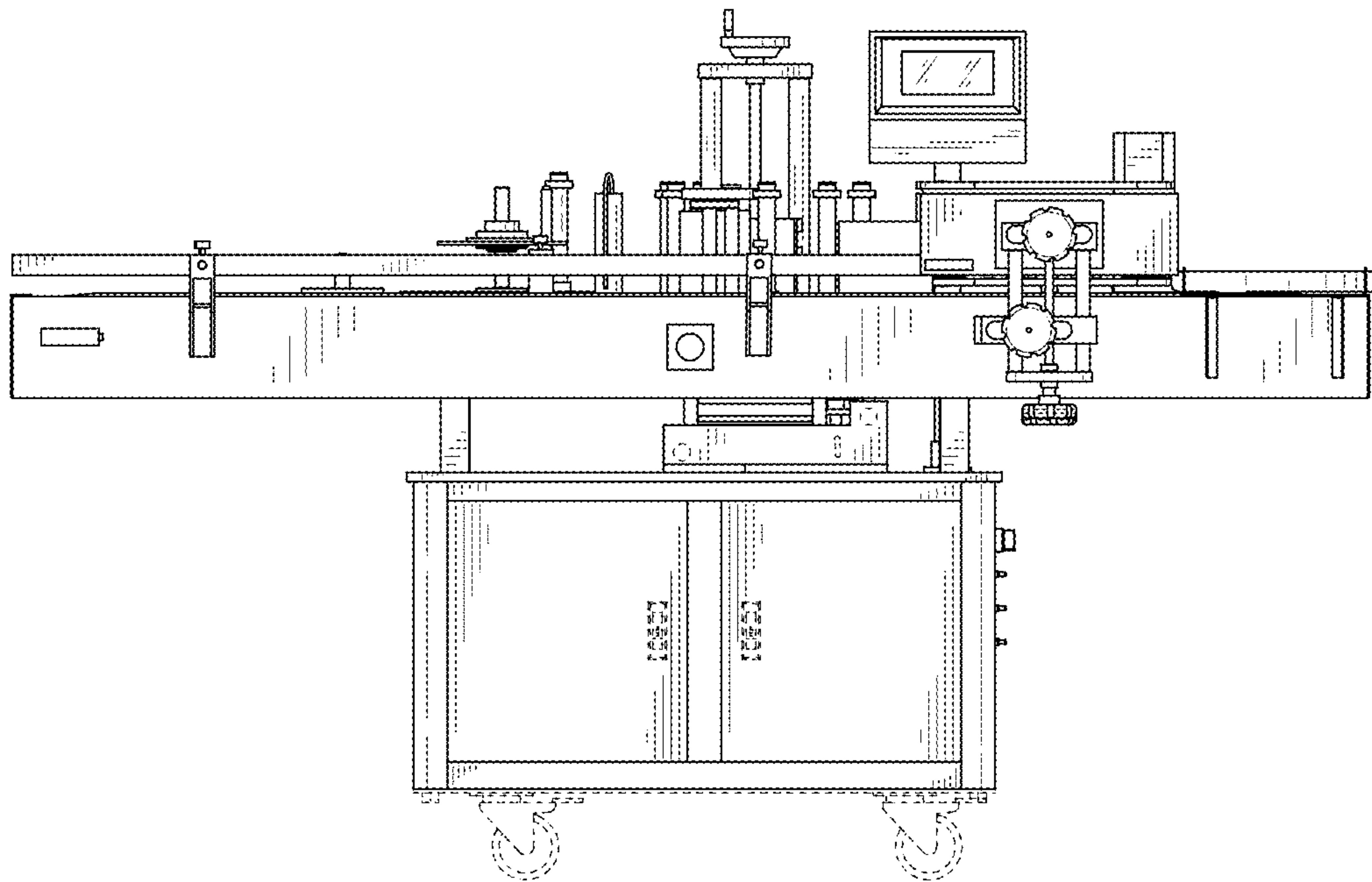

FIG. 3

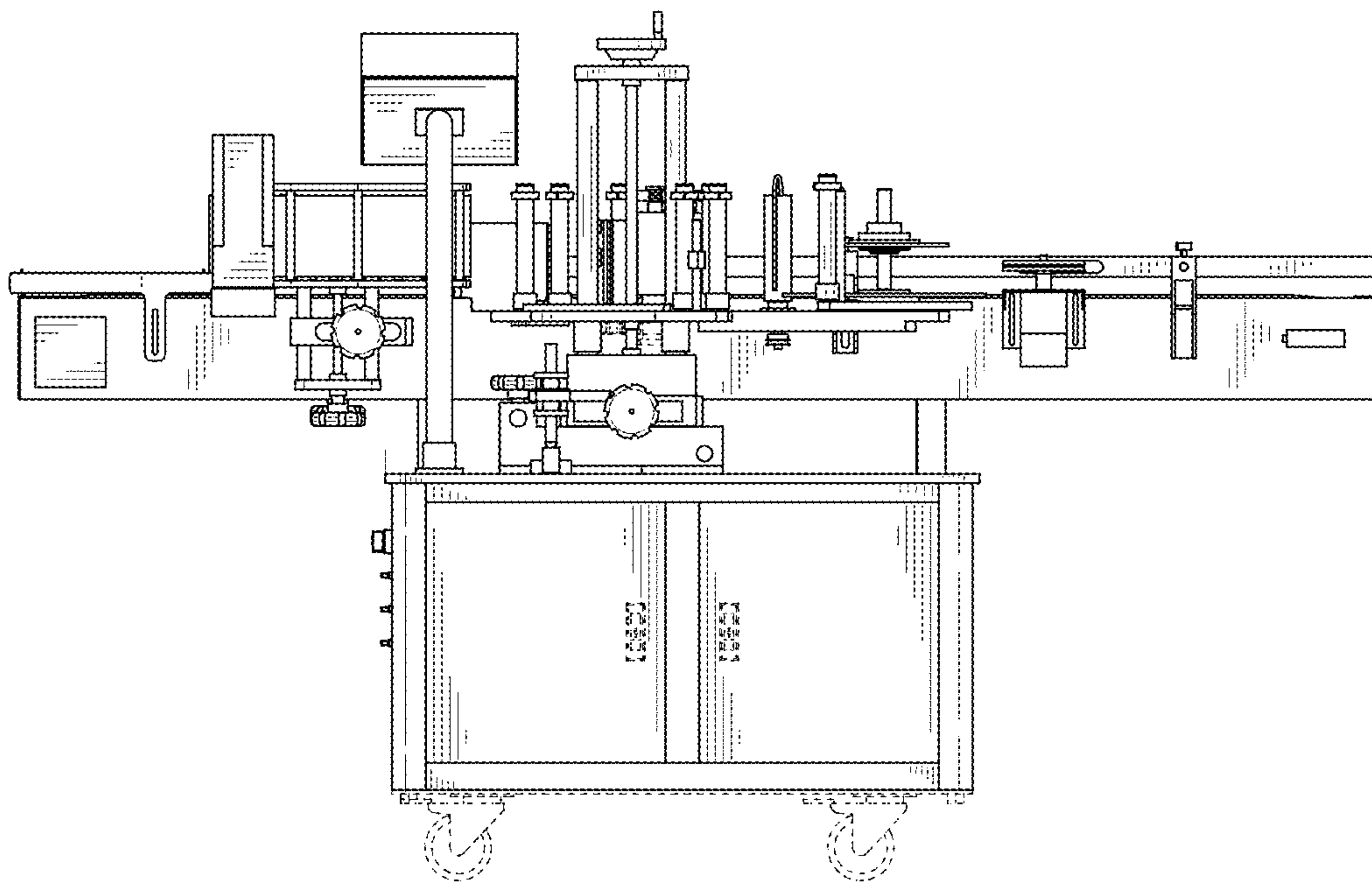

FIG. 4

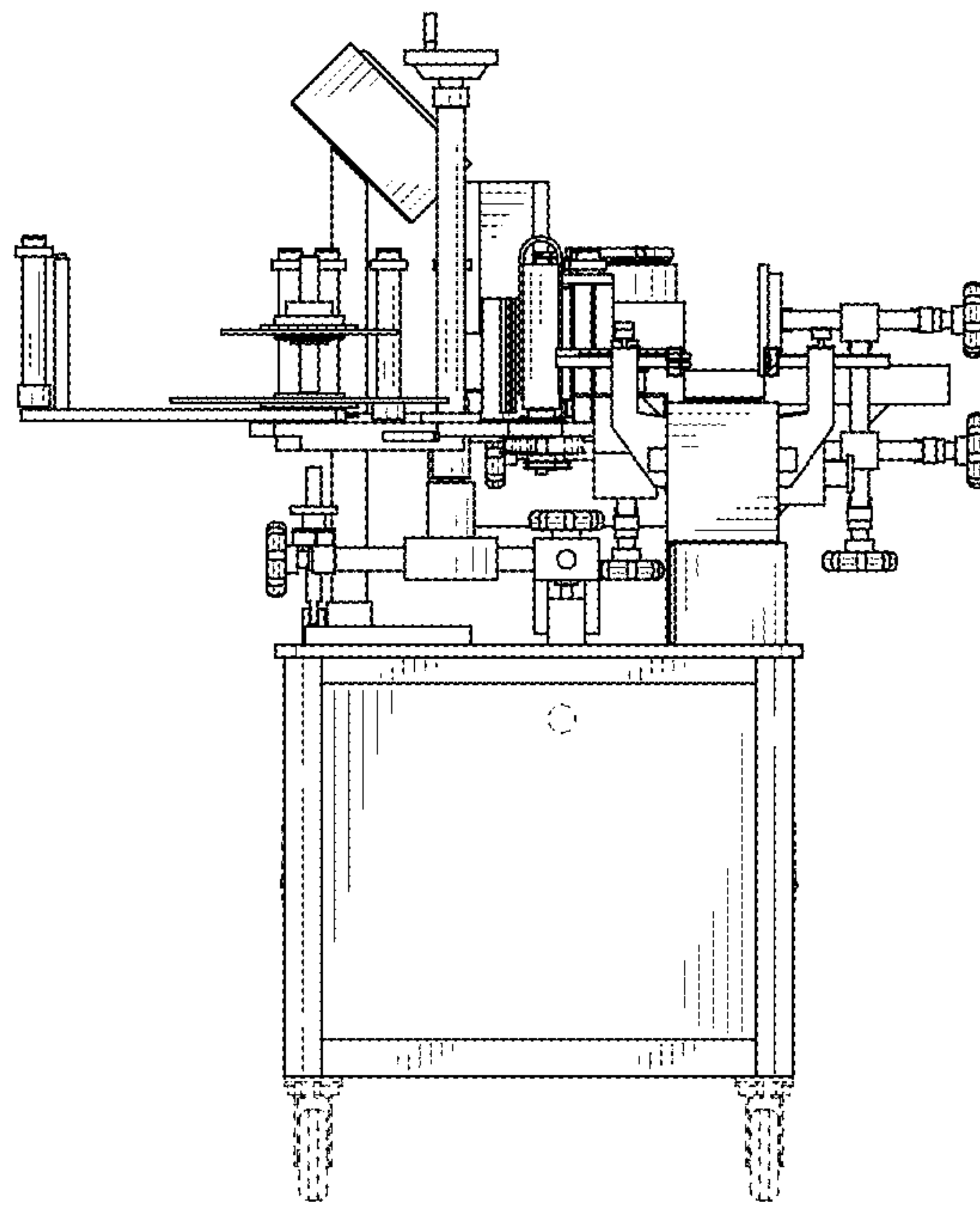

FIG. 5

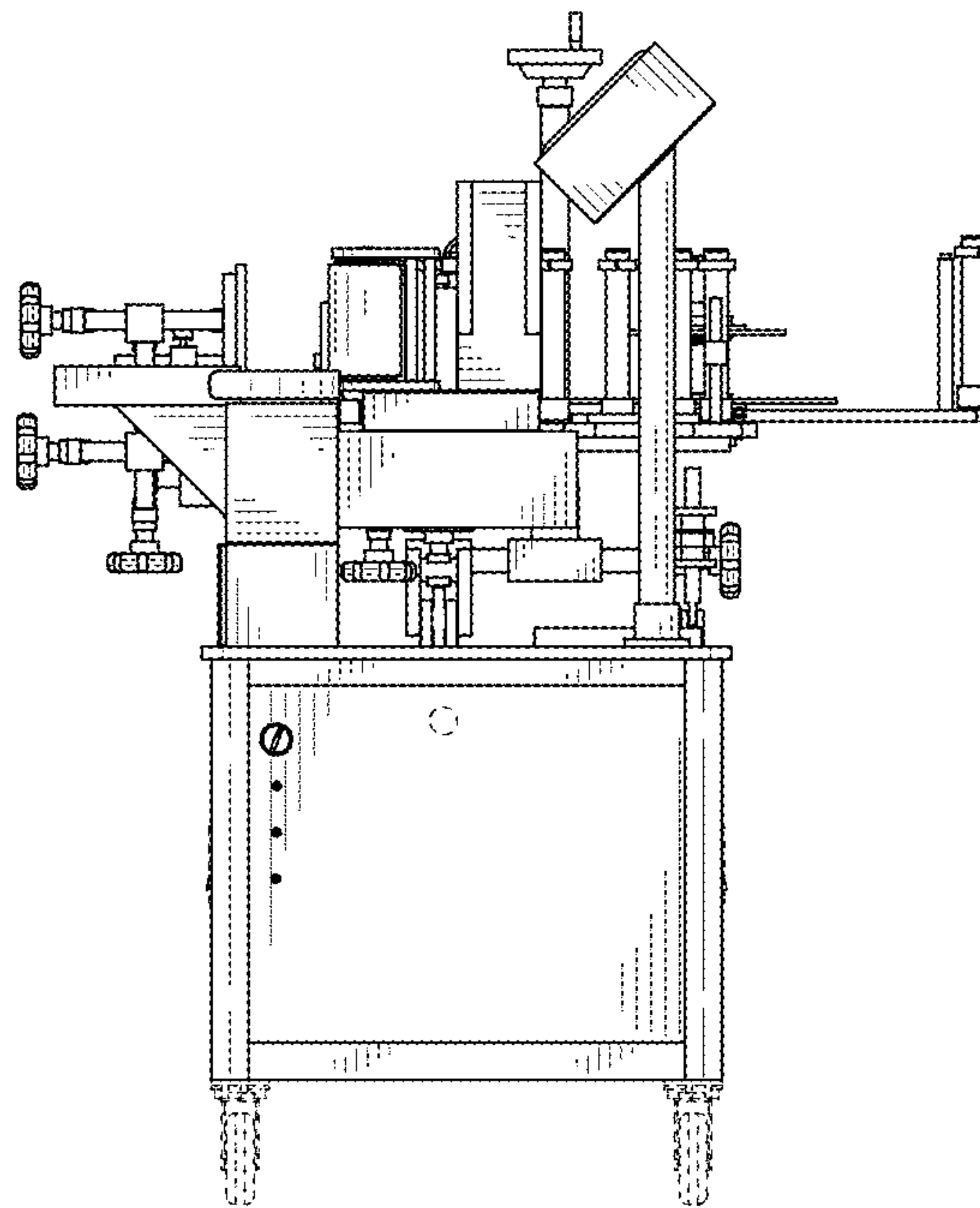

FIG. 6

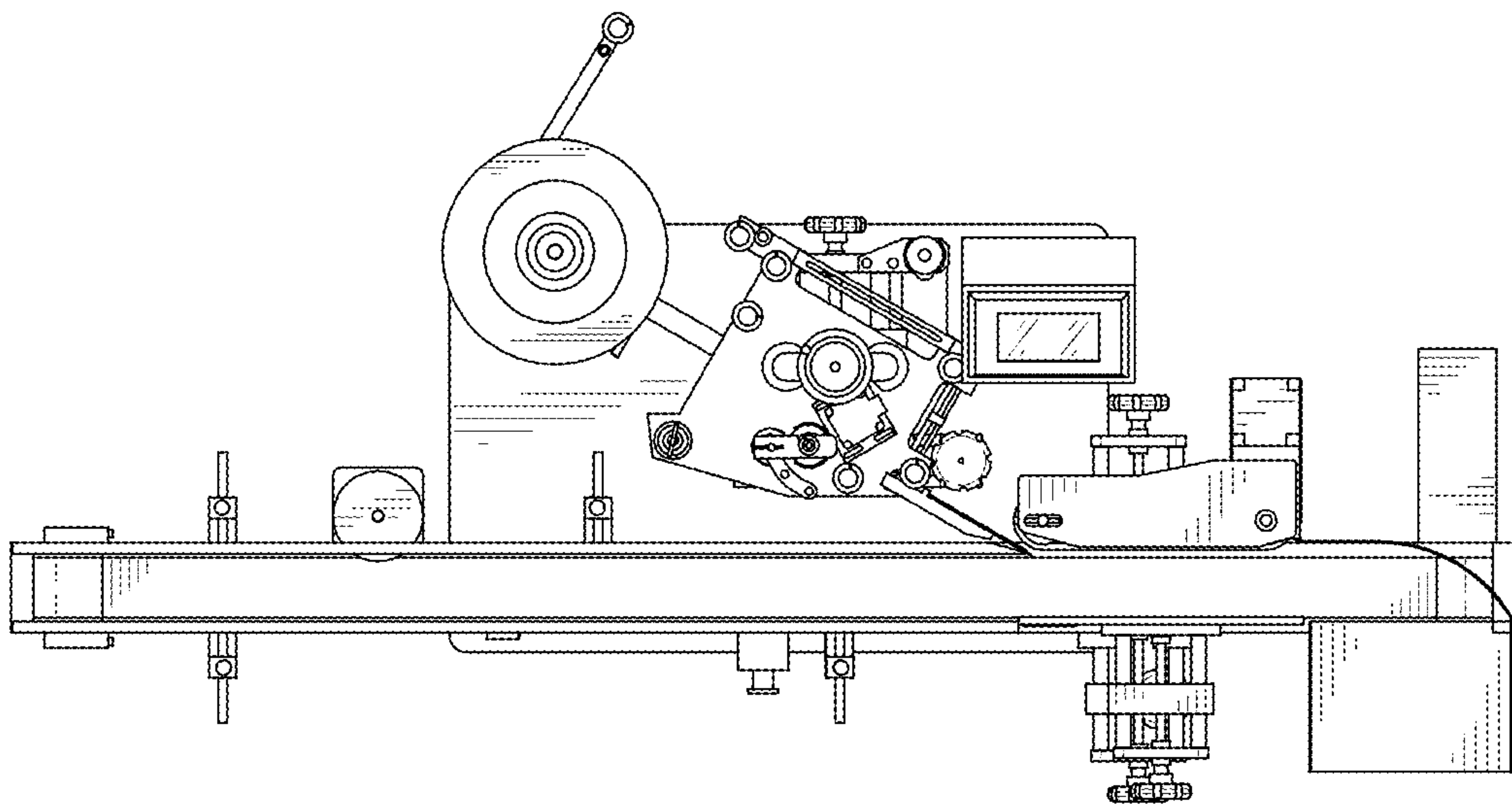

FIG. 7

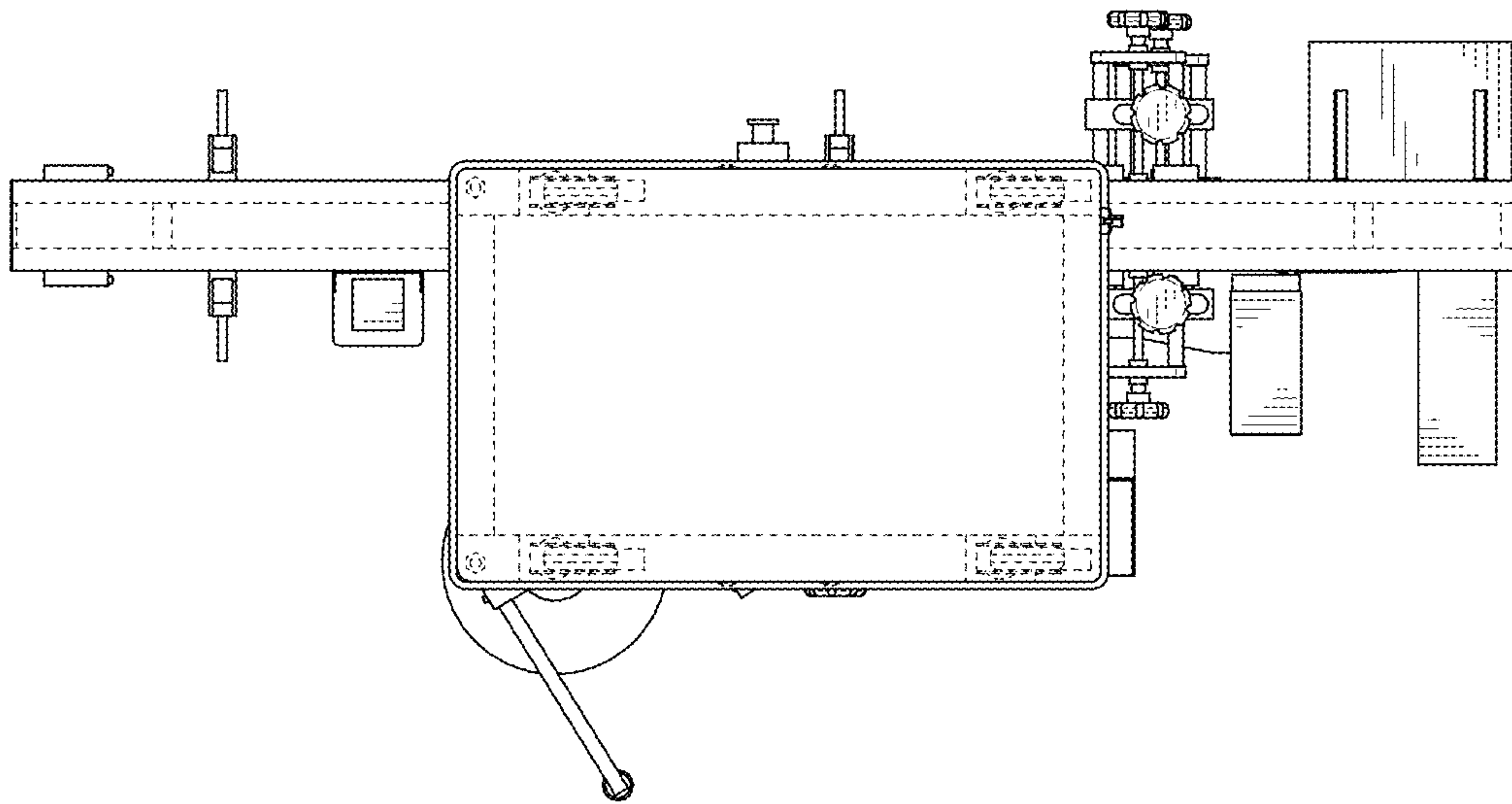

FIG. 8

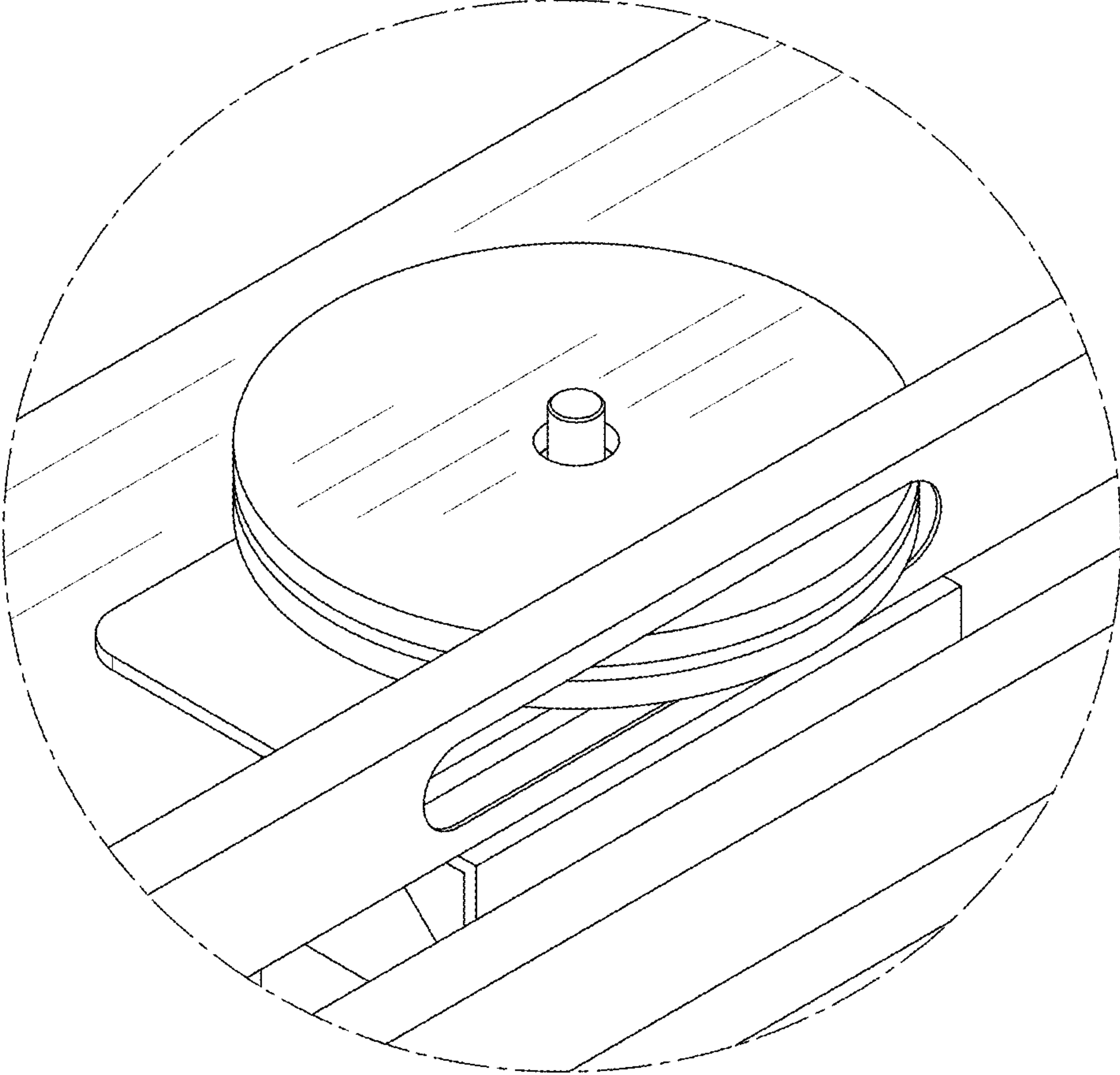

FIG. 9

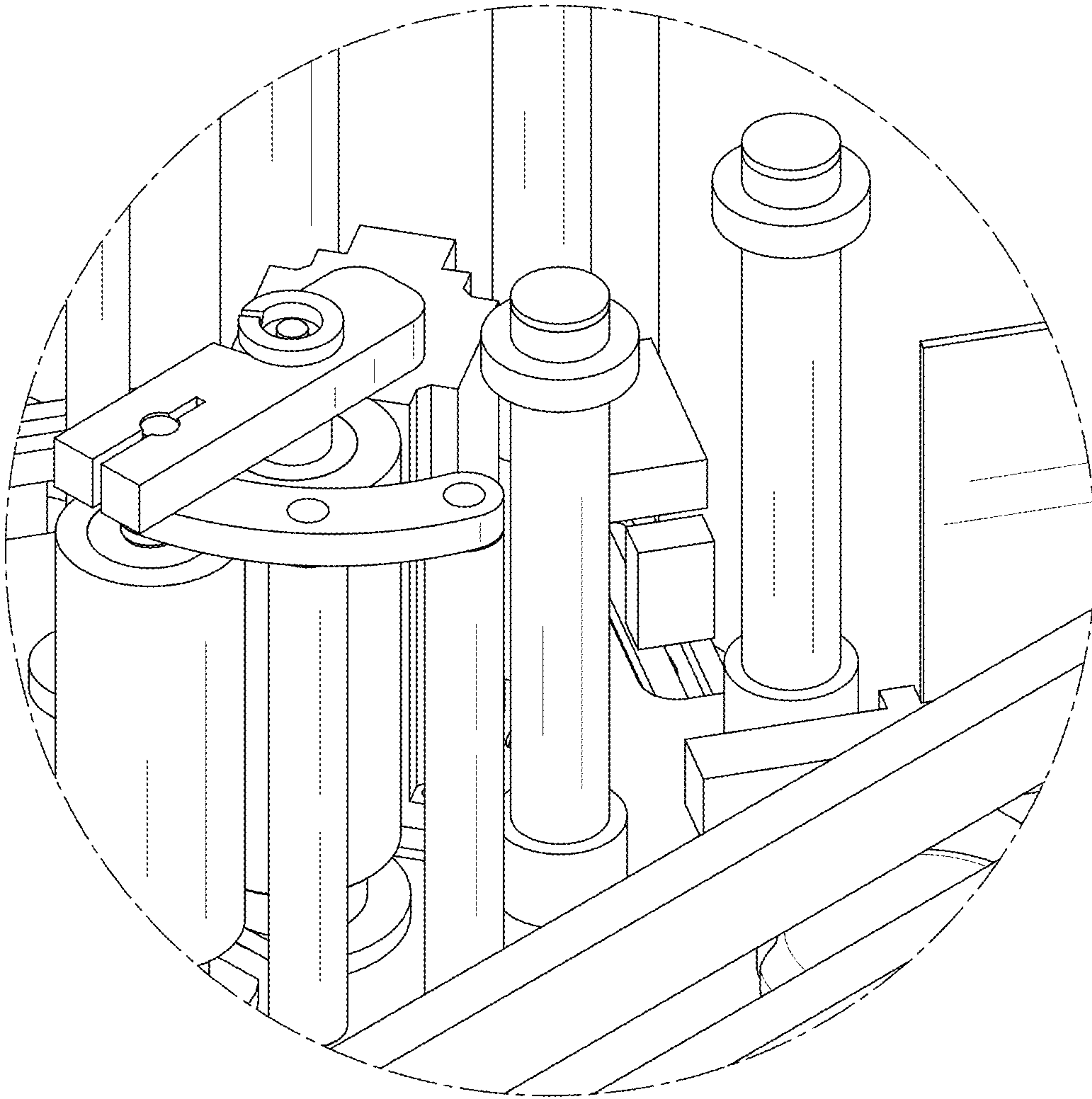

FIG. 10

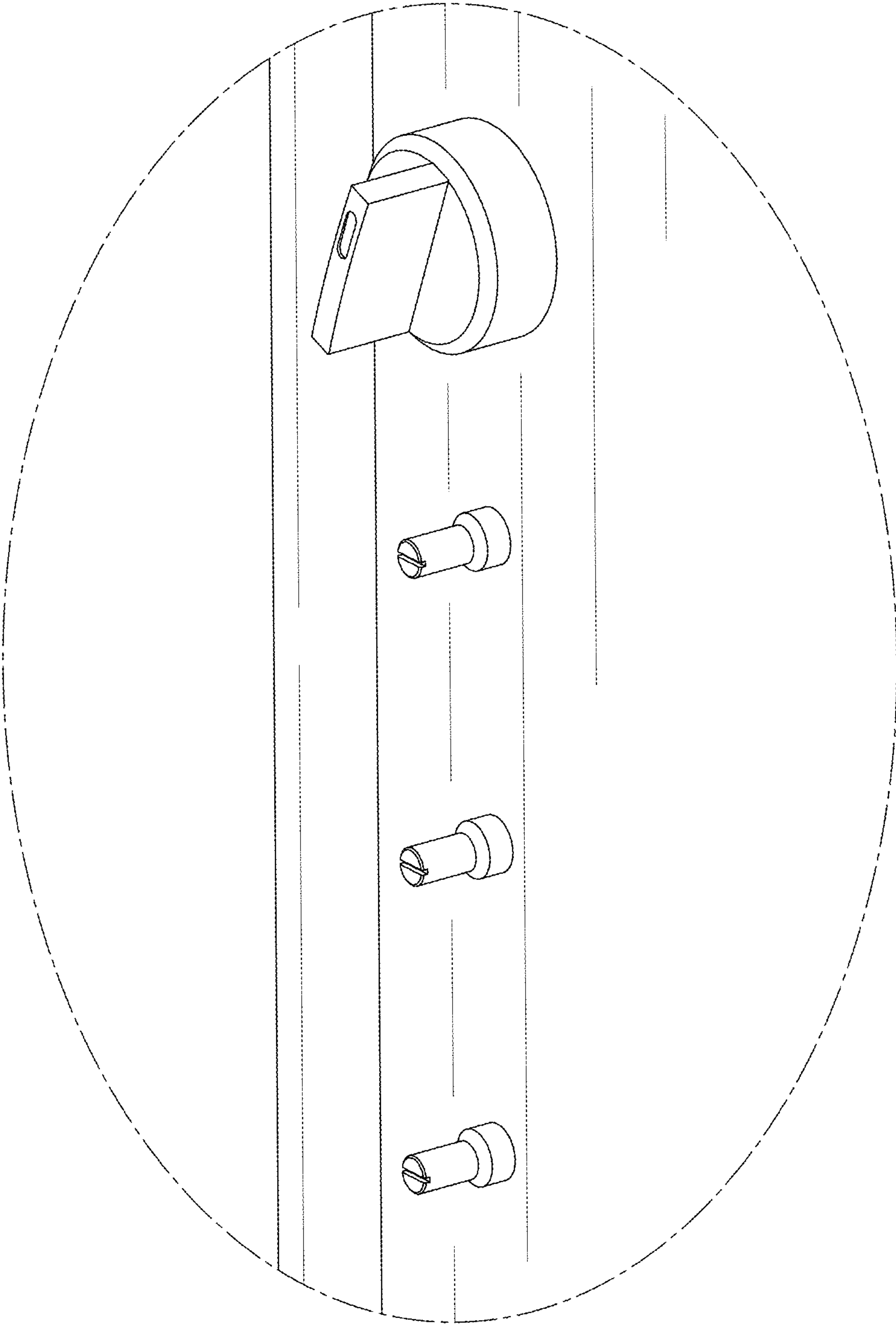

FIG. 11

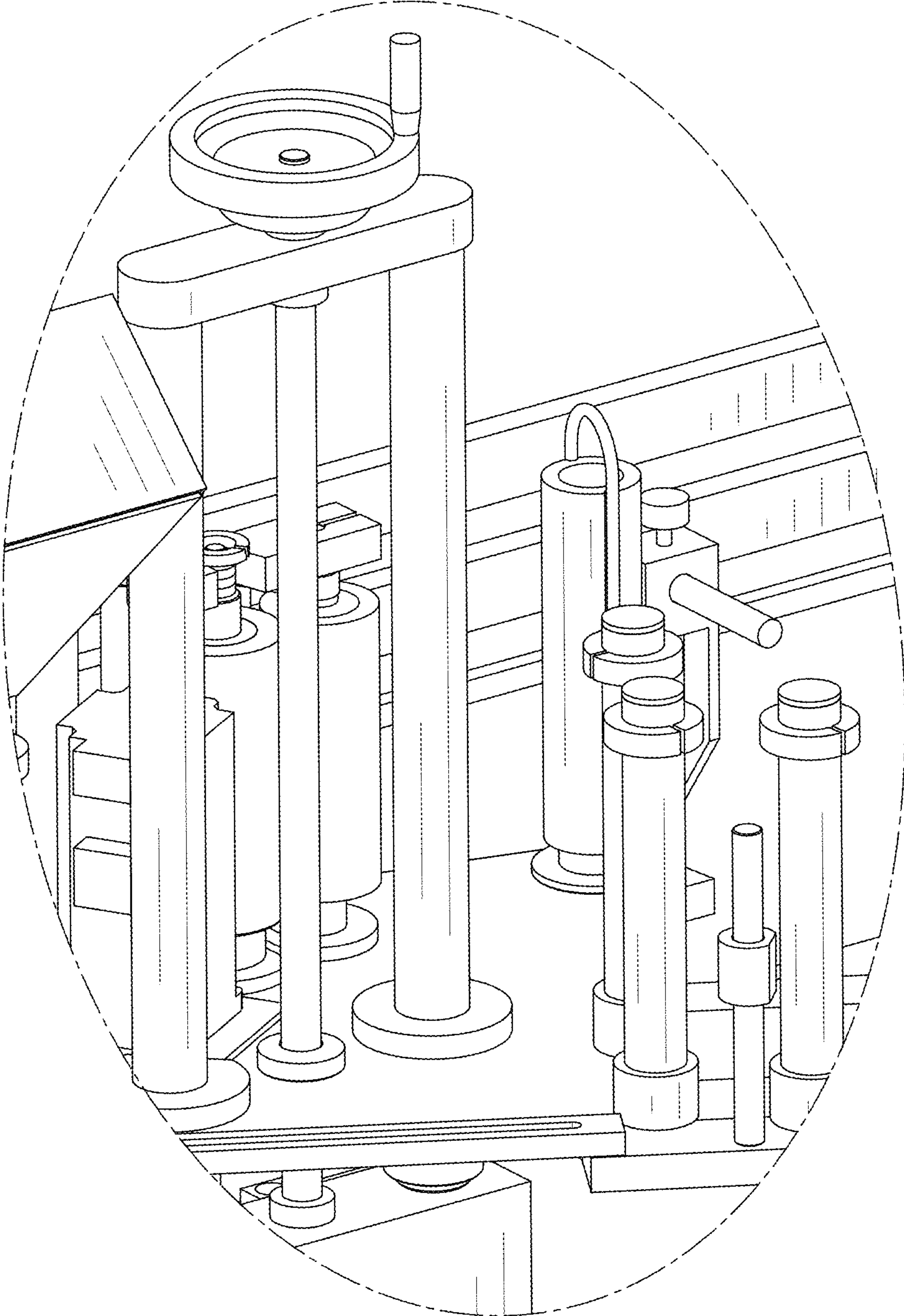

FIG. 12