

US00D978400S

(12) **United States Design Patent** (10) **Patent No.:** **US D978,400 S**
Wu (45) **Date of Patent:** **** Feb. 14, 2023**

(54) **SOLAR GARDEN LAMP**
(71) Applicant: **Hanxiang Wu, Jiujiang (CN)**
(72) Inventor: **Hanxiang Wu, Jiujiang (CN)**
(**) Term: **15 Years**

D925,084 S * 7/2021 Chen D26/63
D925,100 S * 7/2021 Hui D26/68
D930,225 S * 9/2021 Jiang D26/68
D930,889 S * 9/2021 Liu D26/68
D944,434 S * 2/2022 Li D26/63

(21) Appl. No.: **29/802,990**
(22) Filed: **Aug. 10, 2021**
(51) **LOC (14) Cl.** **26-05**
(52) **U.S. Cl.**
USPC **D26/63**
(58) **Field of Classification Search**
USPC D26/63, 67-71
CPC F21S 8/08; F21S 8/081; F21S 8/083; F21S
8/088; F21S 9/03; F21S 9/037; F21V
21/0824; F21W 2111/02; F21W 2131/109
See application file for complete search history.

OTHER PUBLICATIONS

Amazon.com, AloftSun Motion Sensor Solar Landscape Spotlights
30 LEDs, Dec. 7, 2021, <https://www.amazon.com/dp/B09N6YVJQ9>
(Year: 2021).*

* cited by examiner

Primary Examiner — Nathan M Johnston
(74) *Attorney, Agent, or Firm* — Che-Yang Chen; Law
Office of Michael Chen

(57) **CLAIM**

The ornamental design for a solar garden lamp, as shown
and described.

DESCRIPTION

FIG. 1 is a perspective view of the solar garden lamp
showing my new design;
FIG. 2 is a perspective view thereof from another angle;
FIG. 3 is a front elevational view thereof;
FIG. 4 is a rear elevational view thereof;
FIG. 5 is a left side elevational view thereof;
FIG. 6 is a right side elevational view thereof;
FIG. 7 is a top plan view thereof;
FIG. 8 is a bottom plan view thereof; and,
FIG. 9 is a partial enlarged view of the top portion of the
solar garden lamp in FIG. 1.
The broken lines show portions of the solar garden lamp that
form no part of the claimed design.

(56) **References Cited**

U.S. PATENT DOCUMENTS

D542,959 S 5/2007 Yao
D551,789 S * 9/2007 Mullen D26/68
D839,472 S * 1/2019 Hu D26/118
D859,718 S * 9/2019 Groat D26/63
D868,330 S 11/2019 Ji
D875,289 S * 2/2020 Hu D26/63
D887,059 S 6/2020 Liu
D903,921 S * 12/2020 Zhuo D26/63
D905,312 S * 12/2020 Zhuo D26/63
D921,261 S 6/2021 Qiu
D922,646 S * 6/2021 Huang D26/63
D923,845 S * 6/2021 Kong D26/63

1 Claim, 9 Drawing Sheets

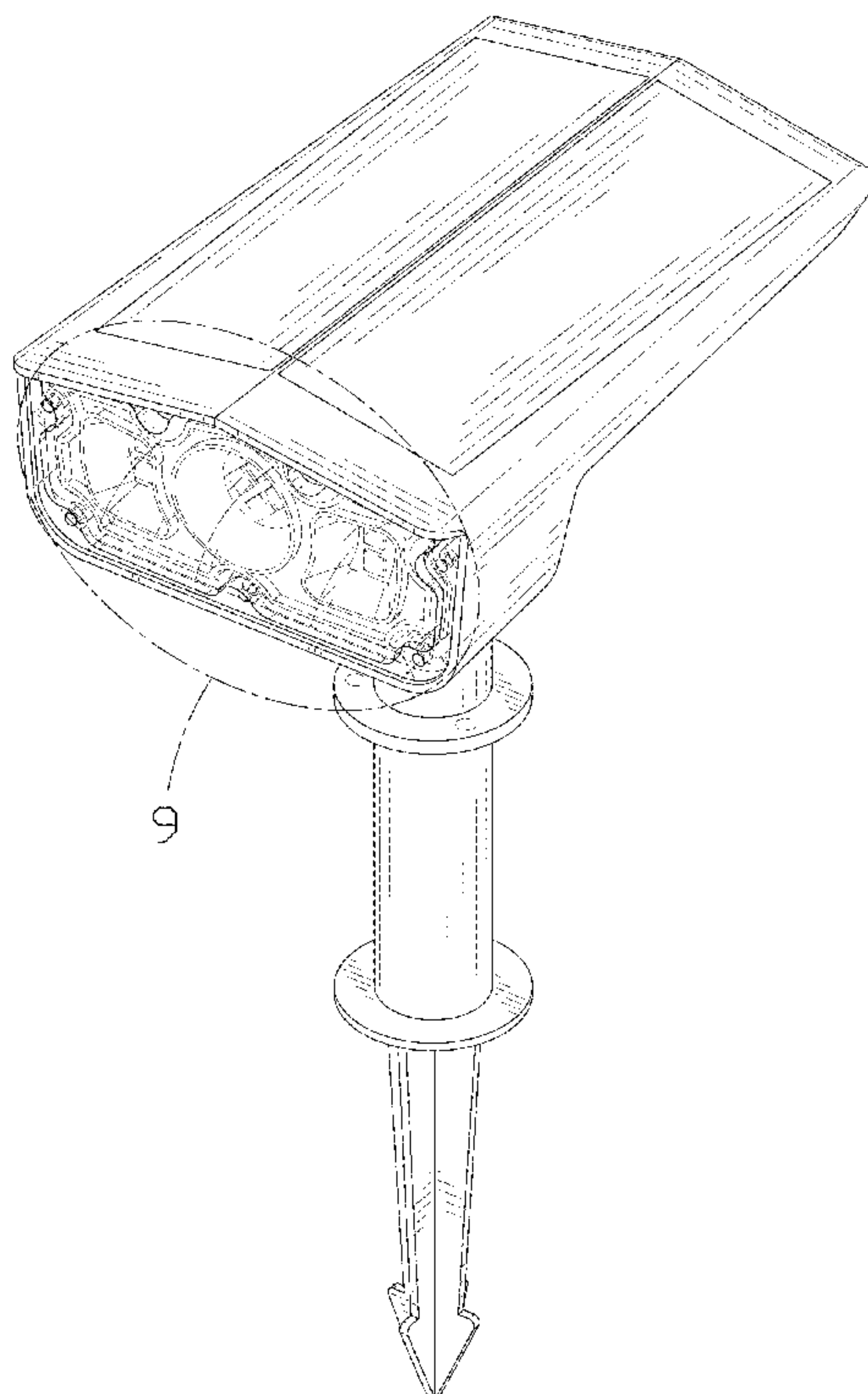

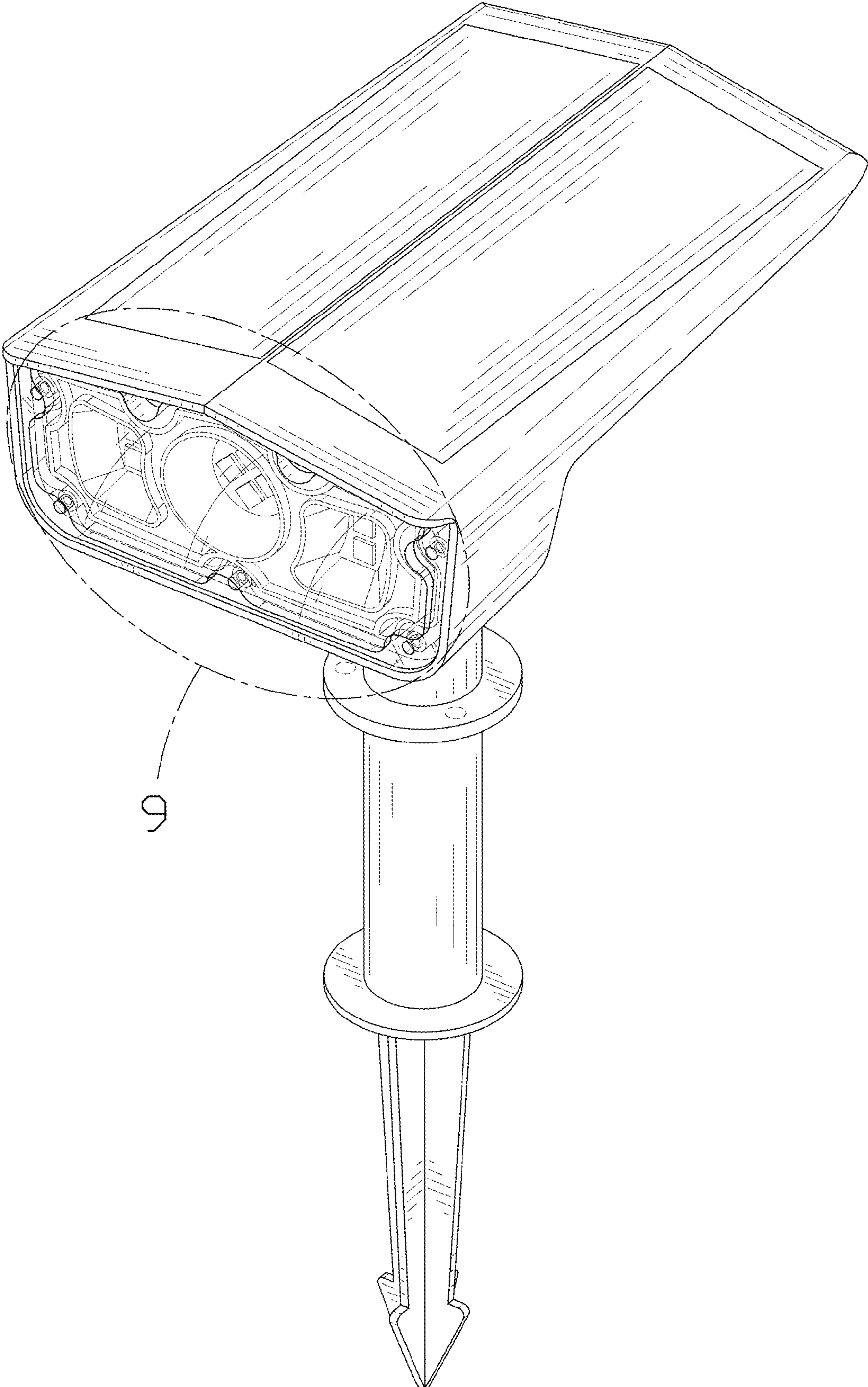

FIG. 1

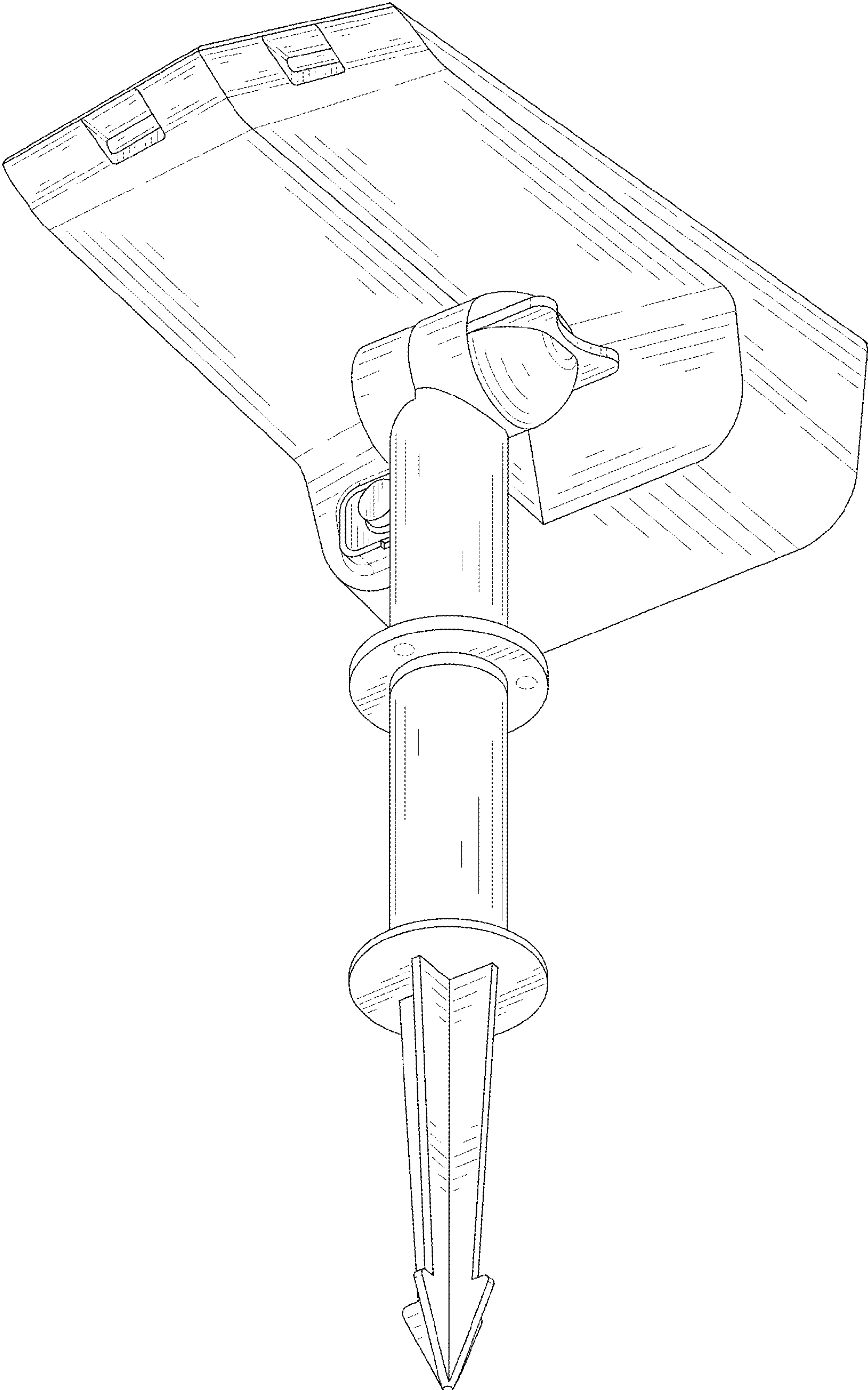

FIG. 2

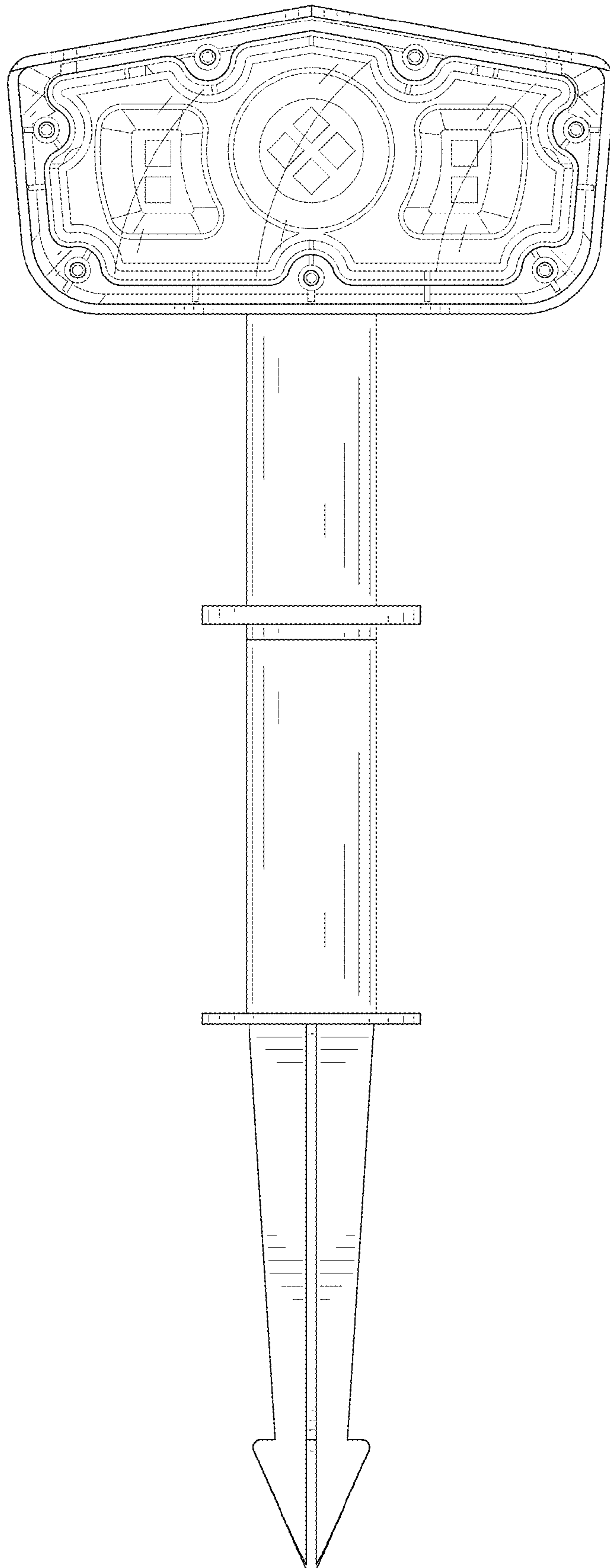

FIG. 3

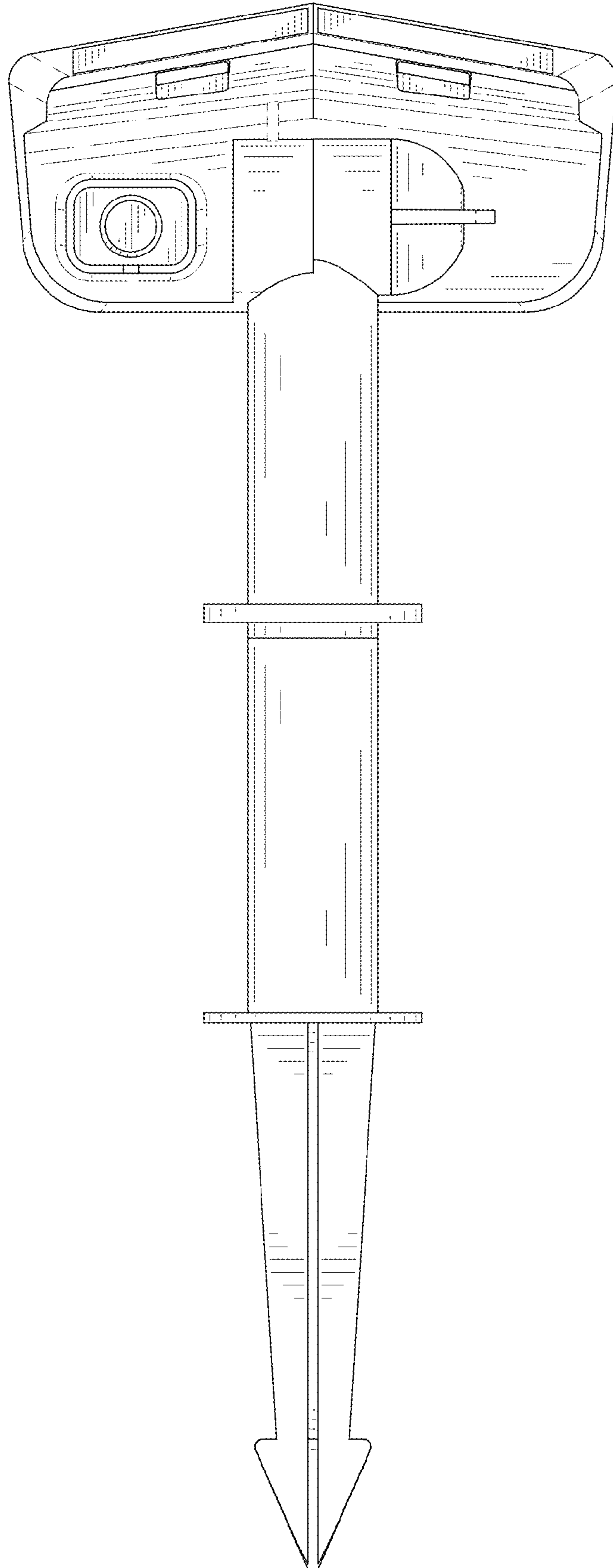

FIG. 4

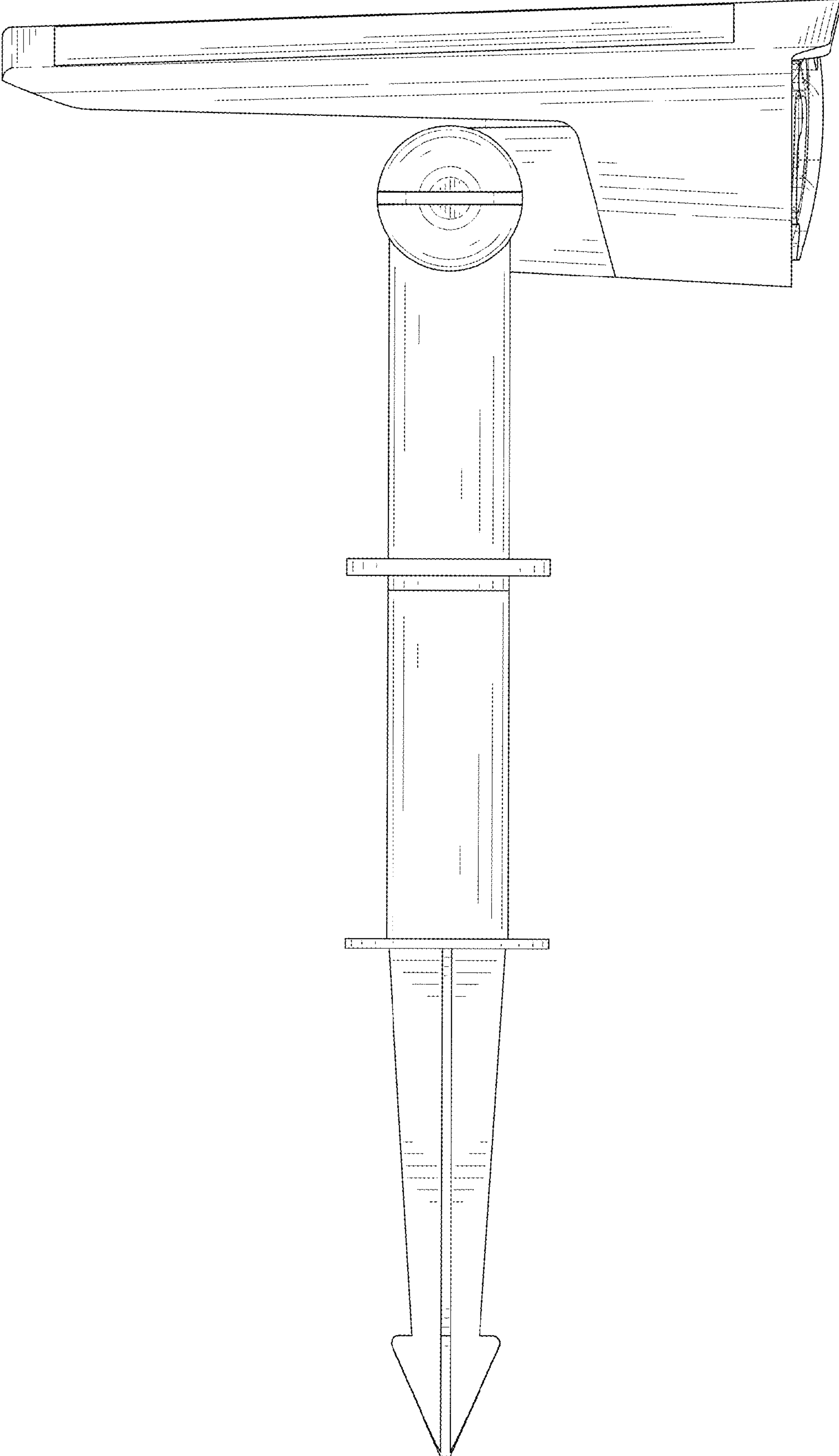

FIG. 5

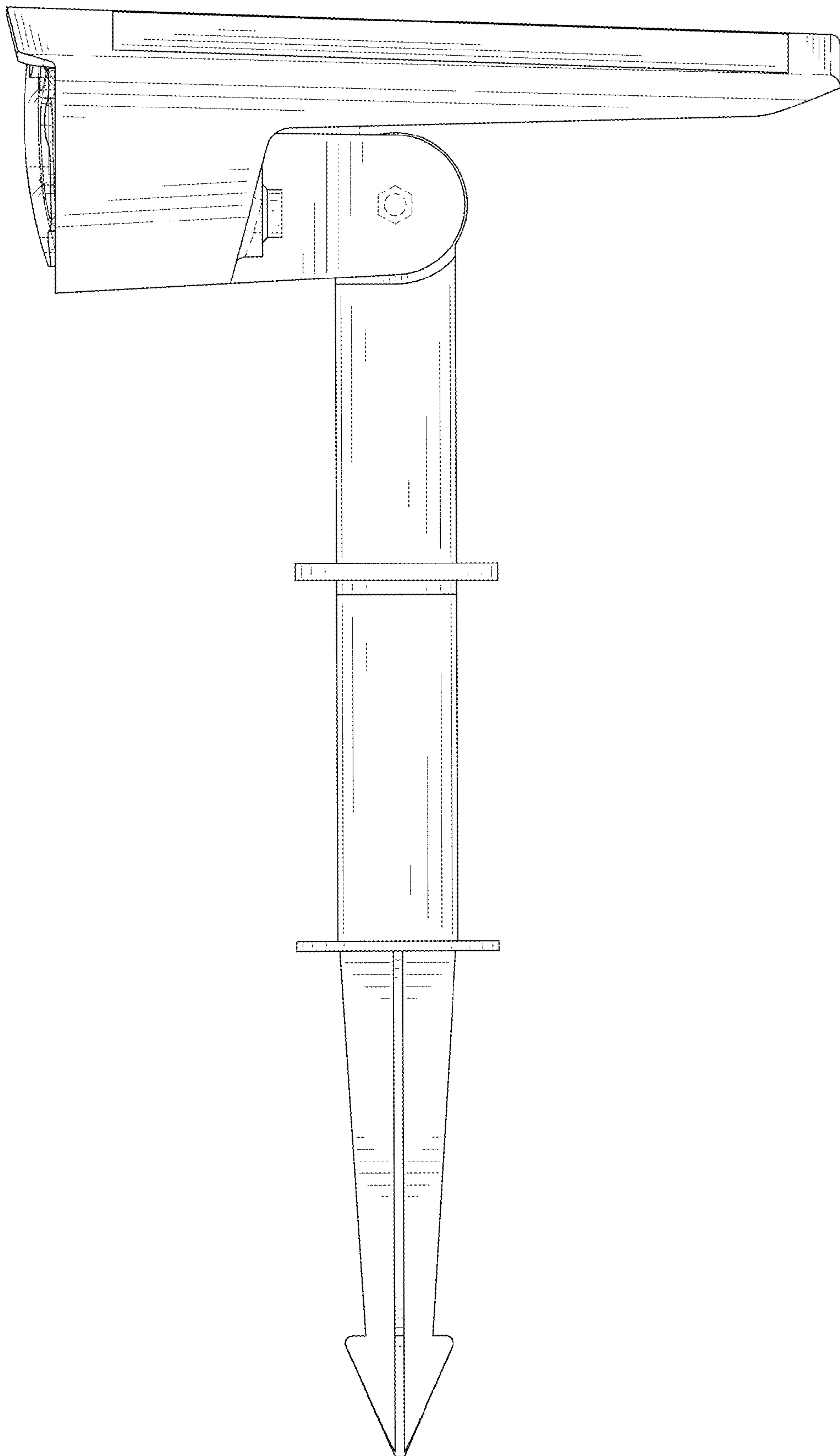

FIG. 6

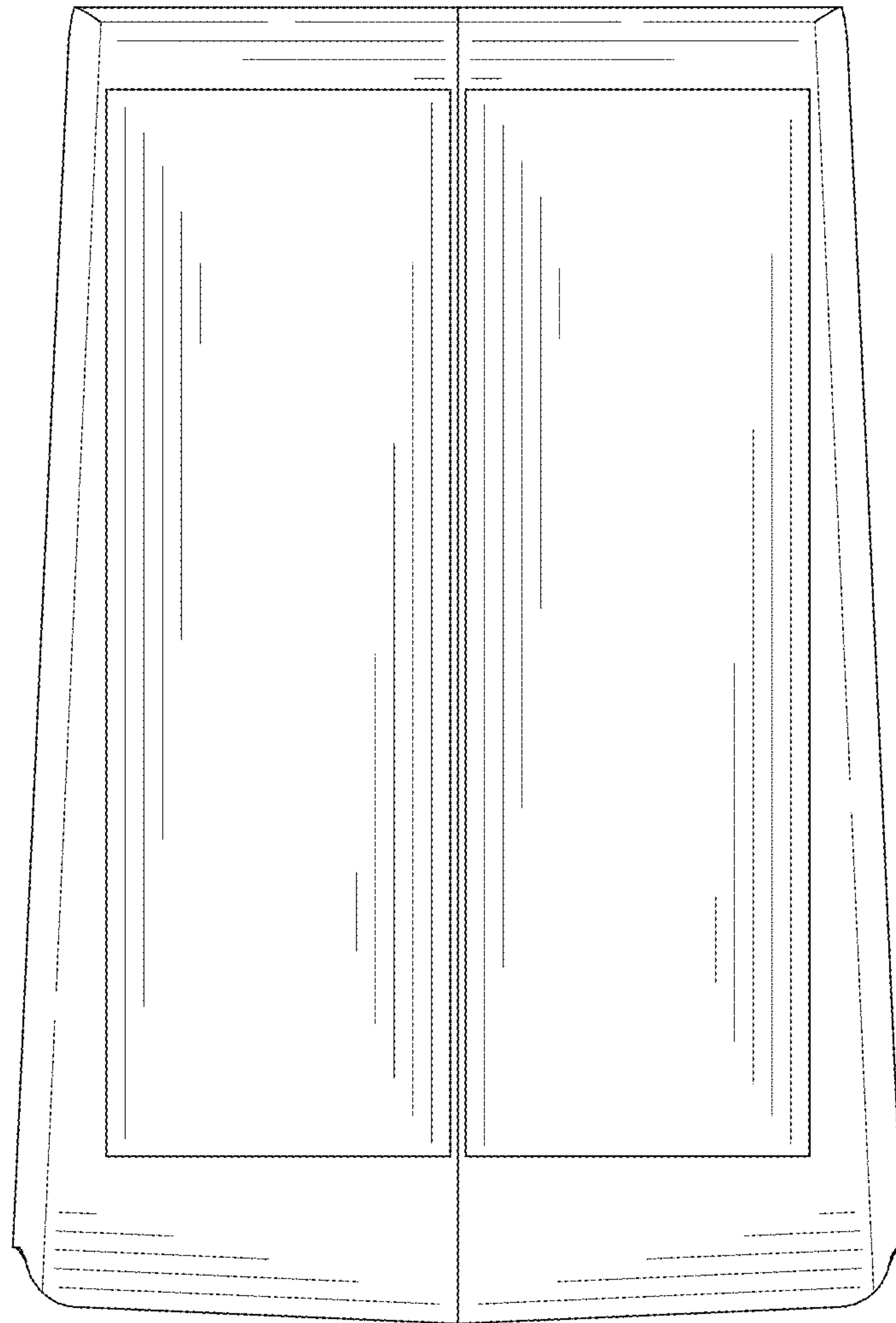

FIG. 7

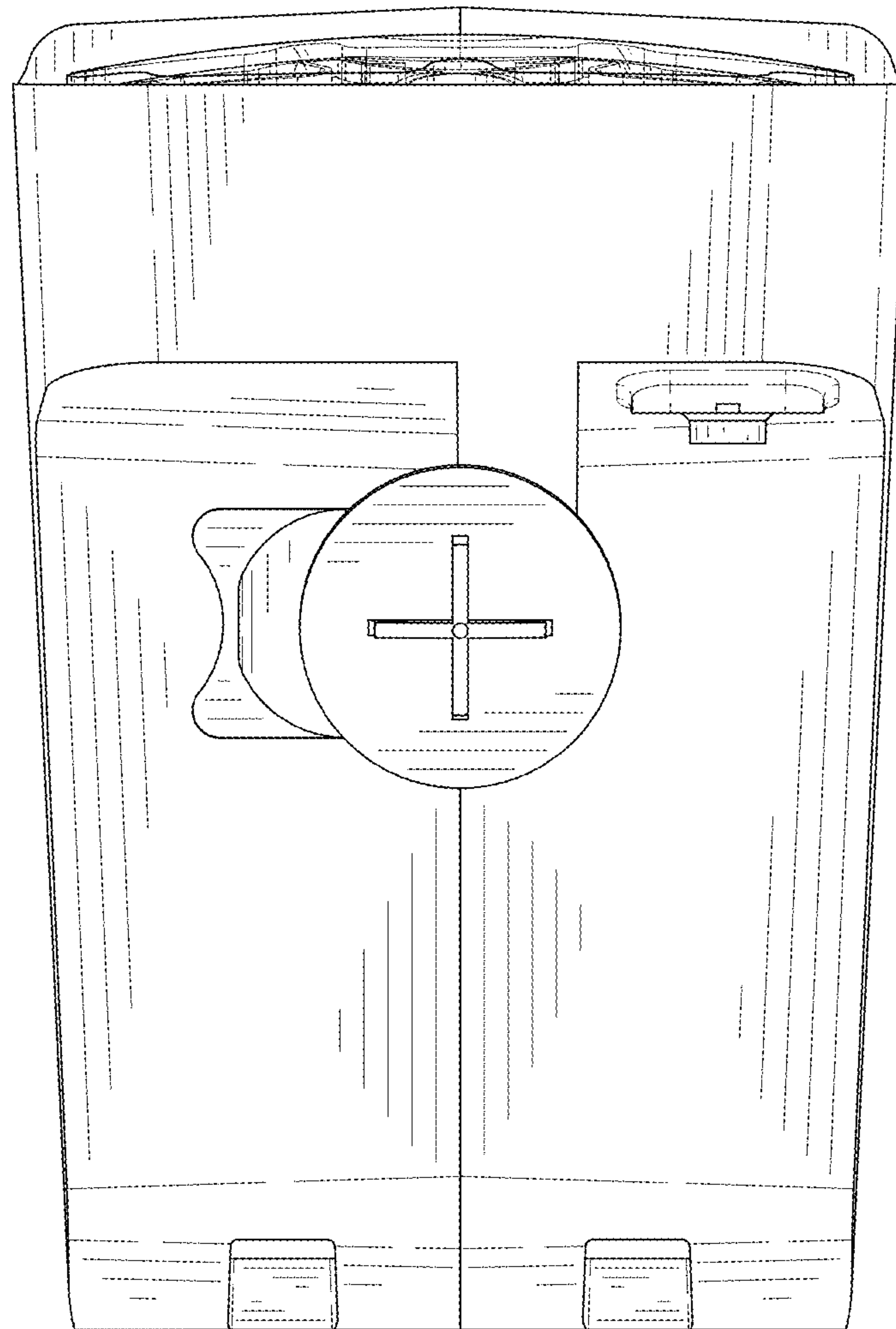

FIG. 8

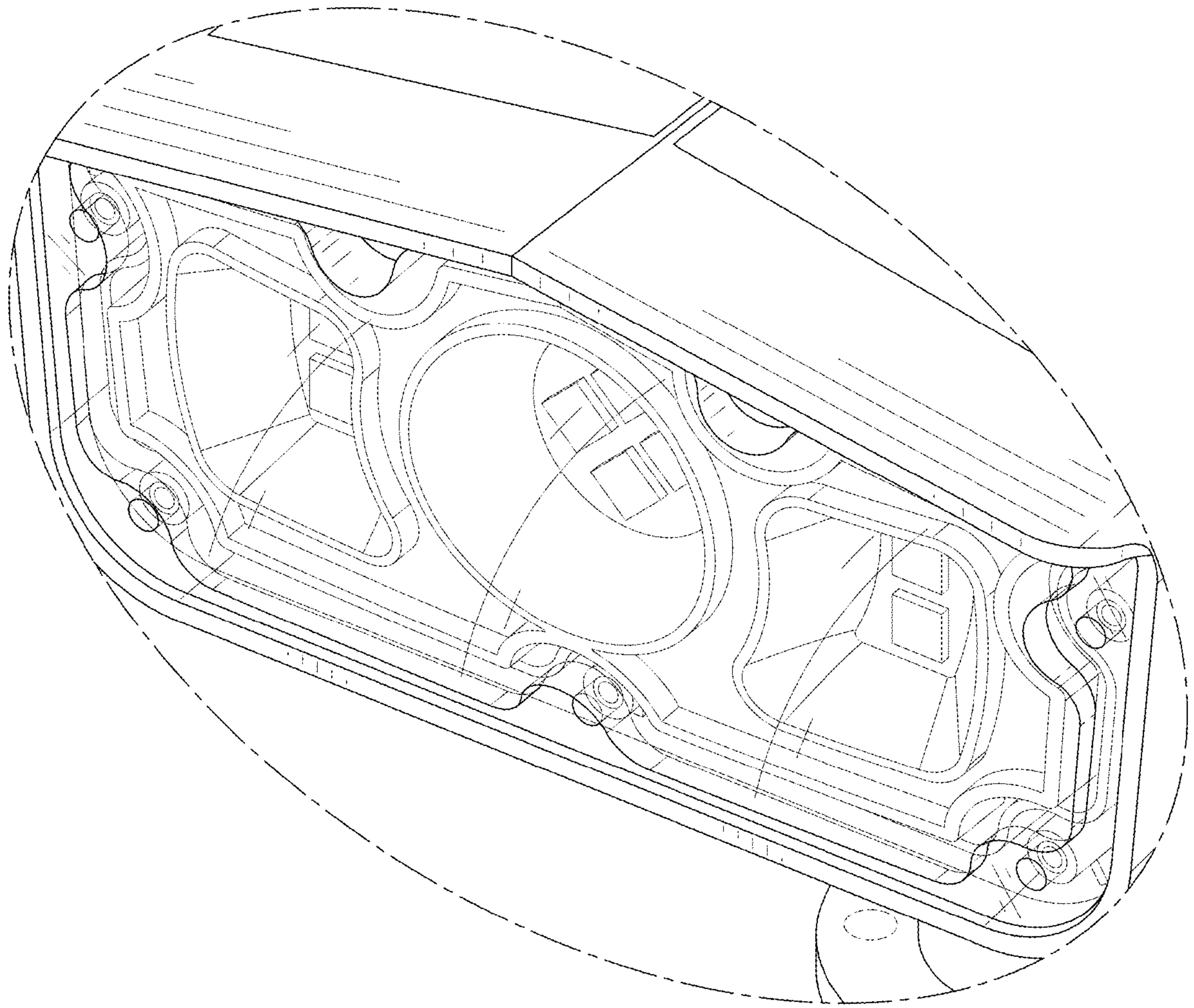

FIG. 9