



US00D977845S

(12) **United States Design Patent**
Lee et al.

(10) **Patent No.:** **US D977,845 S**
(45) **Date of Patent:** **** Feb. 14, 2023**

(54) **MIRROR DISPLAY**
(71) Applicant: **LG DISPLAY CO., LTD.**, Seoul (KR)
(72) Inventors: **Chiyong Lee**, Paju-si (KR); **Jeongeon Seong**, Paju-si (KR); **Soonmin Kwon**, Paju-si (KR); **Hyunjung Song**, Paju-si (KR); **Seungwon Seol**, Paju-si (KR); **Jongyoung Park**, Paju-si (KR)

D586,395 S * 2/2009 Kang D19/113
D586,396 S * 2/2009 Kang D19/113
D708,459 S * 7/2014 Heirakuji D6/675
(Continued)

(73) Assignee: **LG Display Co., Ltd.**, Seoul (KR)
(**) Term: **15 Years**
(21) Appl. No.: **29/766,896**
(22) Filed: **Jan. 19, 2021**

FOREIGN PATENT DOCUMENTS

CN 306679608 * 7/2021
TW 213102-0001 * 8/2021
WO WO-2016181654 A1 * 11/2016 A47G 1/00

(30) **Foreign Application Priority Data**

Jul. 20, 2020 (KR) 30-2020-0033458

(51) **LOC (14) Cl.** **06-07**
(52) **U.S. Cl.**
USPC **D6/302**

(58) **Field of Classification Search**
USPC D6/300, 301, 302, 303, 304, 307, 308,
D6/309, 310, 311, 312, 313, 314, 675,
D6/675.1; D28/64.1-64.7; D14/126,
D14/336, 374; D19/113, 114; D20/10,
D20/27, 42; D25/59
CPC A45D 42/00; A45D 42/10; A45D 42/16;
A45D 42/20; A45D 42/24; A47G 1/00;
A47G 1/02; A47G 1/04; A47G 1/0622;
B60J 3/0282

See application file for complete search history.

(56) **References Cited**

U.S. PATENT DOCUMENTS

D353,716 S * 12/1994 Schur D6/301
D392,468 S * 3/1998 O'Reilly D6/310
D455,788 S * 4/2002 Gentelia D20/10

OTHER PUBLICATIONS

Echelon Reflect Touch Smart Fitness Mirror [online], [site visited Aug. 11, 2022]. Available from internet, URL: <https://echelonfit.com/products/reflect-large?gclid=CjwKCAjw0dKXBhBPEiwA2bmObZj3hZyVuLGQfzkIkXCsI0gZMX8gtMGI1j0hDt0cdQ5PKq92YOnN%E2%80%A6> (Year: 2022).*

Primary Examiner — Cynthia Ramirez

Assistant Examiner — Xavier Marti-Santos

(74) *Attorney, Agent, or Firm* — Birch, Stewart, Kolasch & Birch, LLP

(57) **CLAIM**

The ornamental design for a mirror display, as shown and described.

DESCRIPTION

FIG. 1 is a front, right perspective view of a mirror display showing our new design;
FIG. 2 is a front view thereof;
FIG. 3 is a rear view thereof;
FIG. 4 is a left side view thereof;
FIG. 5 is a right side view thereof;
FIG. 6 is a top plan view thereof;
FIG. 7 is a bottom plan view thereof; and,
FIG. 8 is an enlarged view of a portion of FIG. 6 thereof.
The broken lines in the figures are for the purpose of illustrating portions of the display mirror, which form no part of the claimed design. The dot-dot-dash broken line

(Continued)

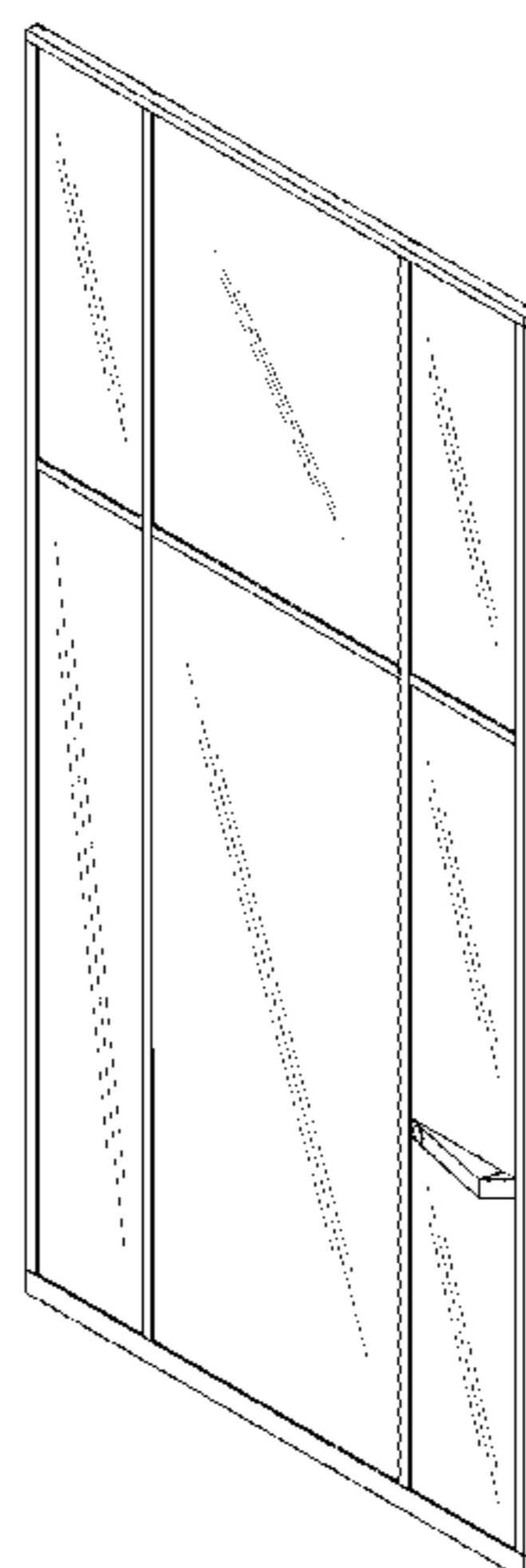

showing in FIGS. 6 and 8 is for the purpose of illustrating a partially enlarged view of FIG. 6 only and forms no part of the claimed design.

1 Claim, 8 Drawing Sheets

(56)

References Cited

U.S. PATENT DOCUMENTS

D807,054 S	*	1/2018	Gilad	D6/300
D925,484 S	*	7/2021	Easton	D14/126
D949,972 S	*	4/2022	Lee	D14/126

* cited by examiner

FIG. 1

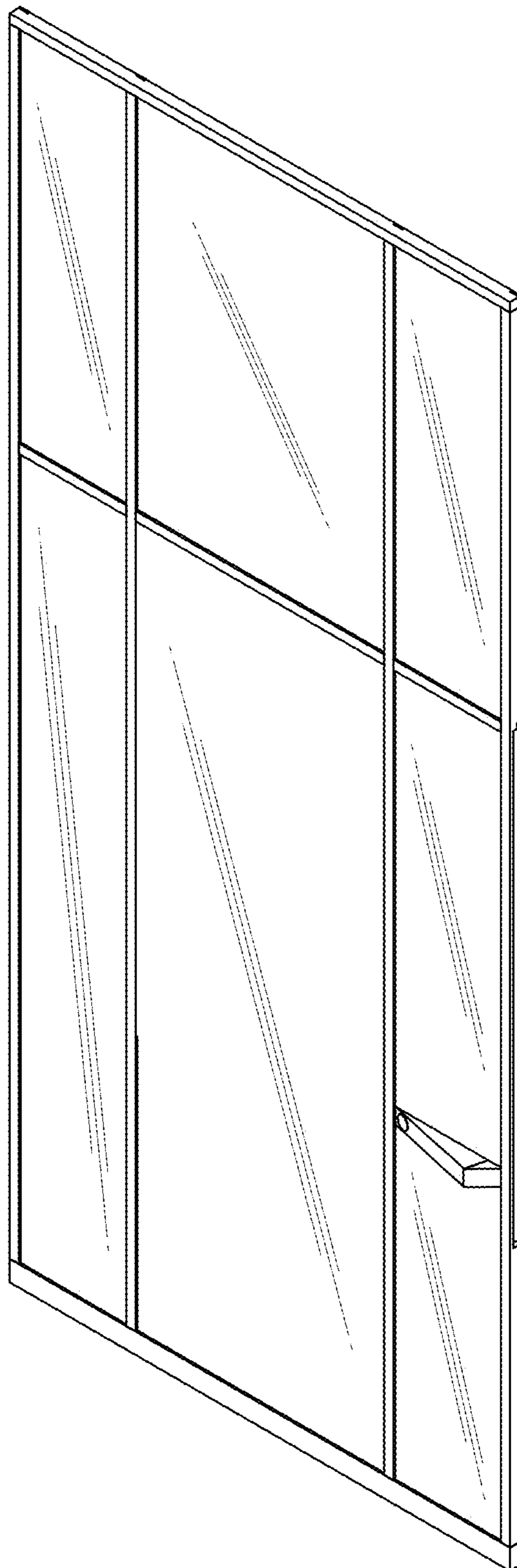

FIG. 2

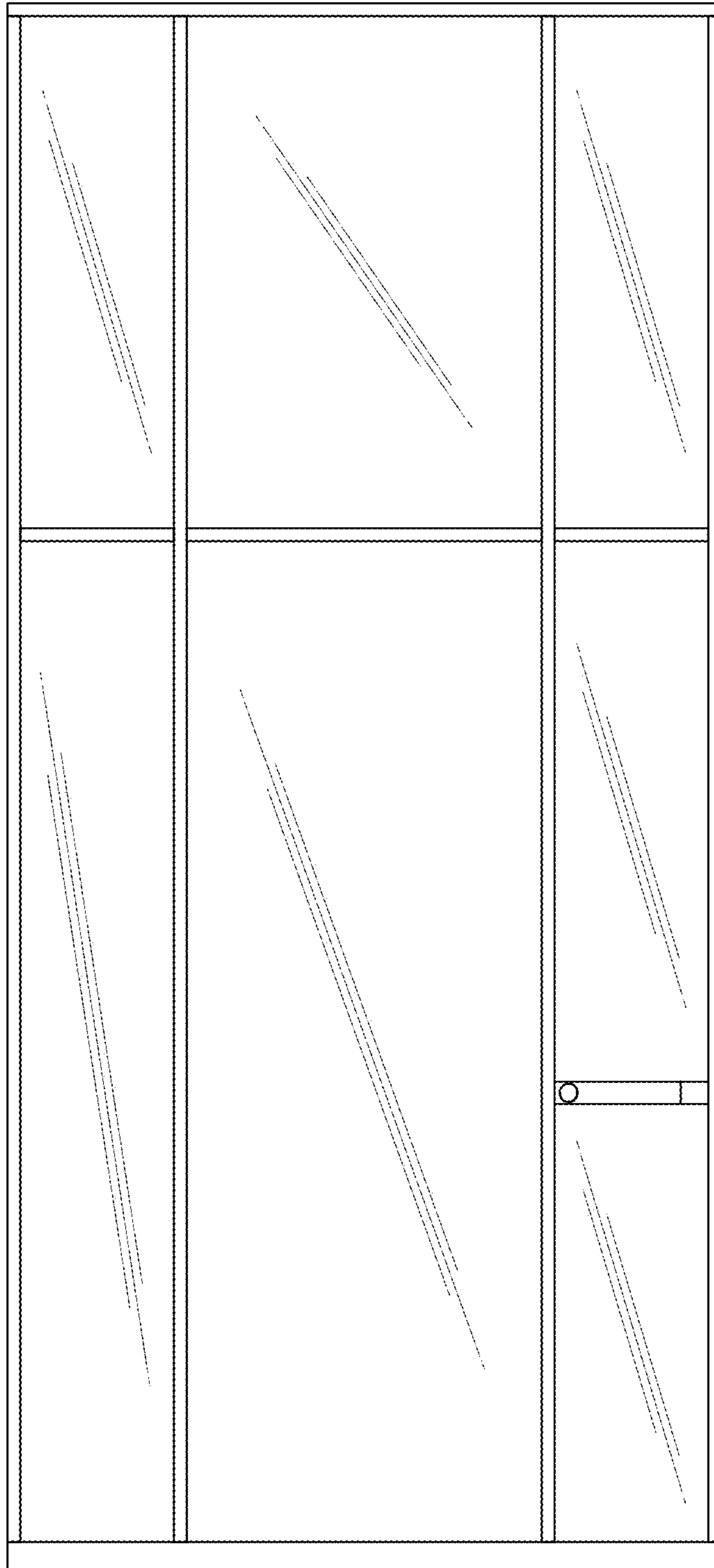

FIG. 3

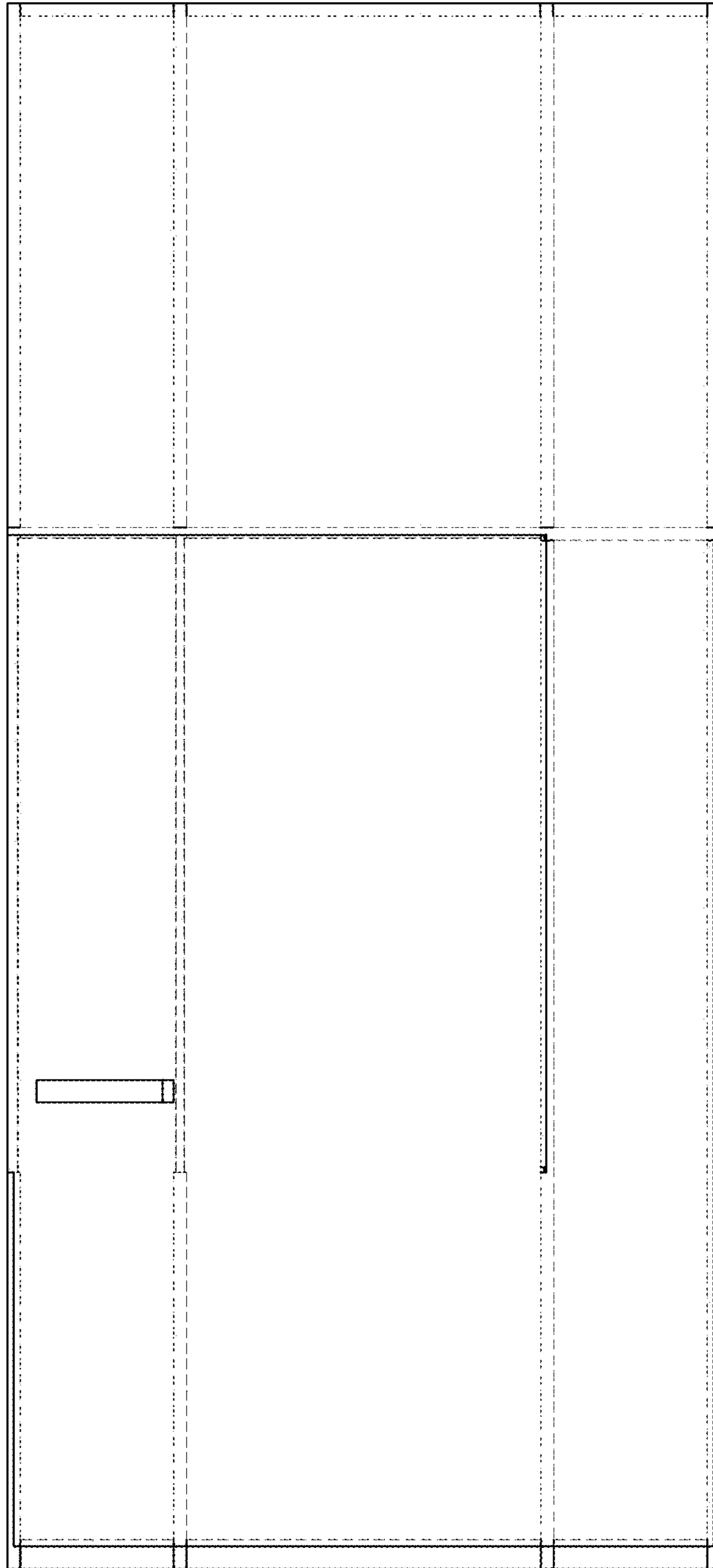

FIG. 4

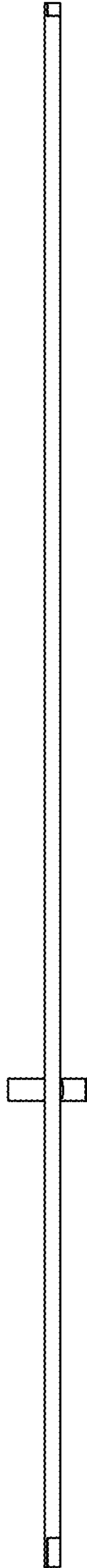

FIG. 5

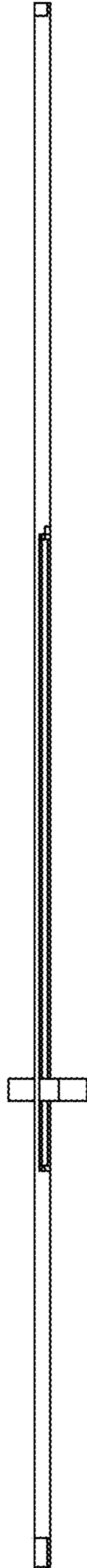

FIG. 6

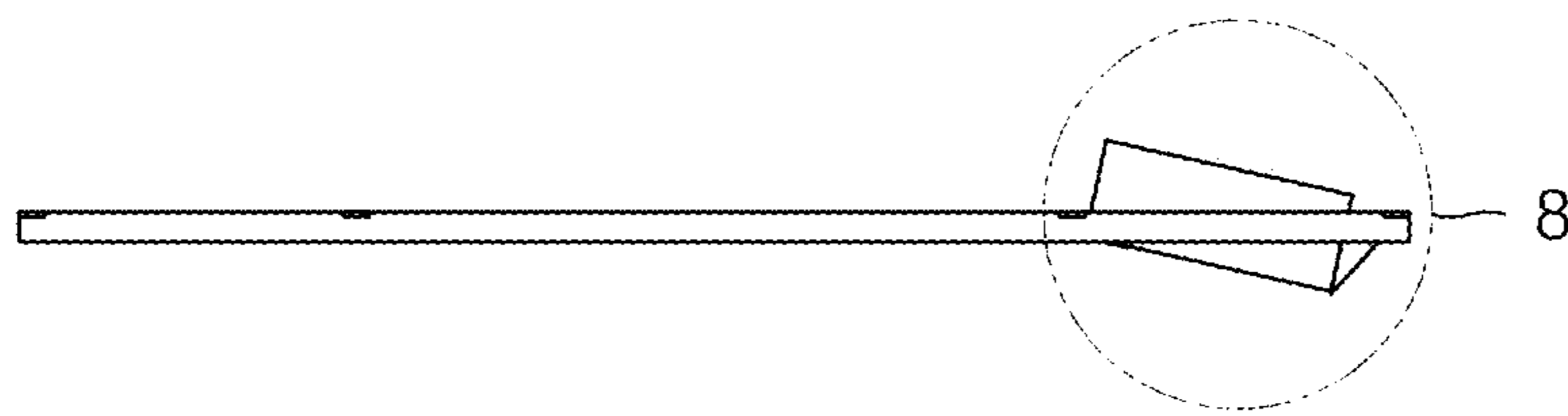

FIG. 7

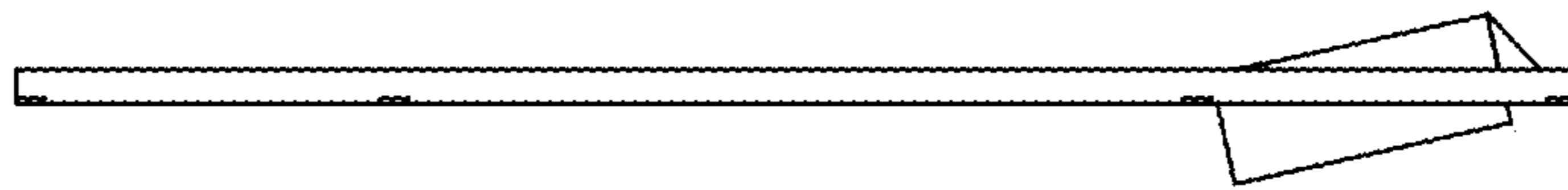

FIG. 8

