



US00D976354S

(12) **United States Design Patent**
Stengel

(10) **Patent No.:** **US D976,354 S**
(45) **Date of Patent:** **** Jan. 24, 2023**

(54) **ROLLER COASTER TRACK SECTION**

(71) Applicant: **Ingenieurbuero Stengel GmbH**,
Munich (DE)

(72) Inventor: **Werner Stengel**, Munich (DE)

(73) Assignee: **INGENIEURBUERO STENGEL**
GIMBH, Munich (DE)

(**) Term: **15 Years**

(21) Appl. No.: **29/750,446**

(22) Filed: **Sep. 14, 2020**

(30) **Foreign Application Priority Data**

Mar. 13, 2020 (EM) 007751201-0002
Mar. 13, 2020 (EM) 007751201-0004
Mar. 13, 2020 (EM) 007751201-0006
Mar. 13, 2020 (EM) 007751201-0019
Mar. 13, 2020 (EM) 007751201-0020

(51) **LOC (14) Cl.** **21-03**

(52) **U.S. Cl.**
USPC **D21/814**

(58) **Field of Classification Search**
USPC D21/811, 814, 828-833
CPC A63G 7/00; A63G 21/00-22; B61B
13/00-127; E01B 25/00-34
See application file for complete search history.

(56) **References Cited**

U.S. PATENT DOCUMENTS

3,889,605 A * 6/1975 Bacon A63G 7/00
104/246
3,949,680 A * 4/1976 Doughty A63G 21/04
104/69
4,489,659 A * 12/1984 Kamohara E01B 25/24
403/205
5,463,962 A * 11/1995 Gnezdilov A63G 7/00
104/53

5,566,620 A * 10/1996 Siewert E01B 25/00
104/138.1
5,595,121 A * 1/1997 Elliott A63G 7/00
104/53
6,047,645 A * 4/2000 Cornwell B61B 13/04
104/55
7,594,473 B2 * 9/2009 Kitchen A63G 7/00
104/53
D670,781 S * 11/2012 Kitchen D21/830
D671,609 S * 11/2012 Kitchen D21/830
8,375,863 B2 * 2/2013 Roodenburg A63G 7/00
104/53
D678,450 S * 3/2013 Kitchen D21/830

(Continued)

OTHER PUBLICATIONS

<http://www.Formfonts.com>; 3D roller coaster models; May 13, 2022.*

(Continued)

Primary Examiner — Mitchell I. Siegel
(74) *Attorney, Agent, or Firm* — Muncy, Geissler, Olds & Lowe, P.C.

(57) **CLAIM**

The ornamental design for a roller coaster track section, as shown and described.

DESCRIPTION

FIG. 1 is a perspective view of a first embodiment of a roller coaster track section, showing my new design;
FIG. 2 is a top plan view thereof;
FIG. 3 is a front elevational view thereof, the rear elevational view being a mirror image thereof;
FIG. 4 is a perspective view of a second embodiment of a roller coaster track section, showing my new design;
FIG. 5 is a top plan view thereof; and,
FIG. 6 is a front elevational view thereof, the rear elevational view being a mirror image thereof.

1 Claim, 6 Drawing Sheets

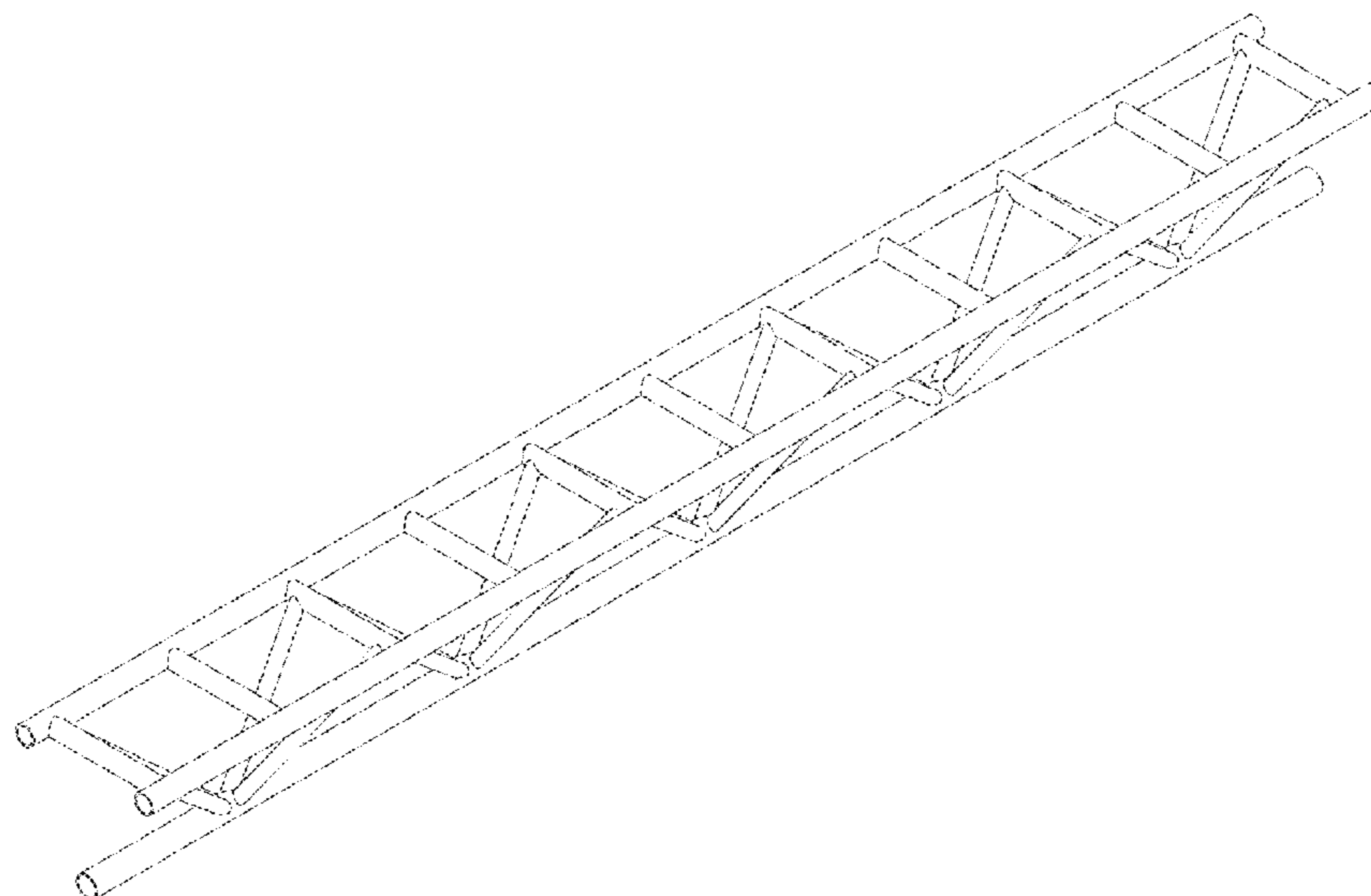

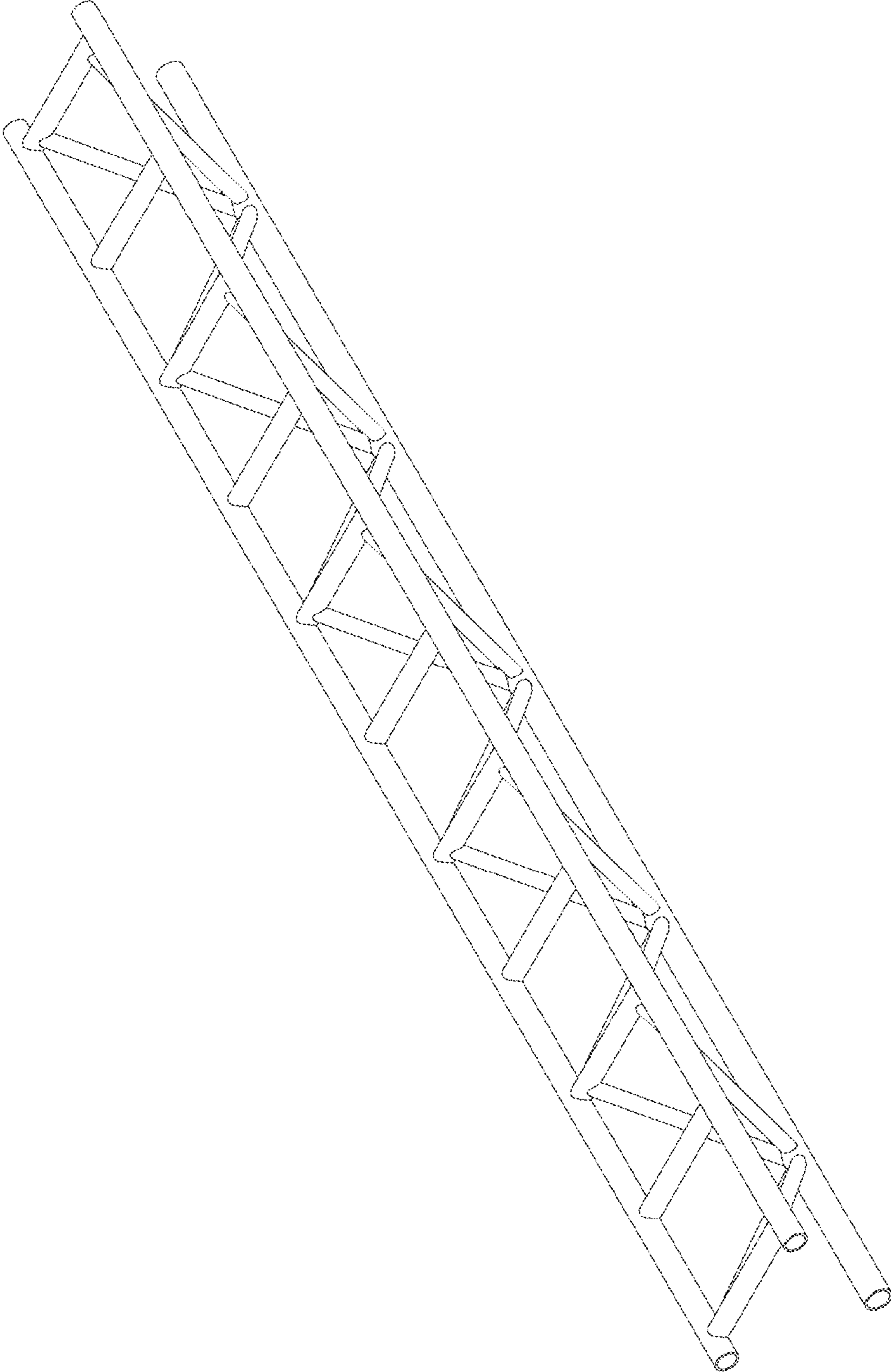

FIG. 1

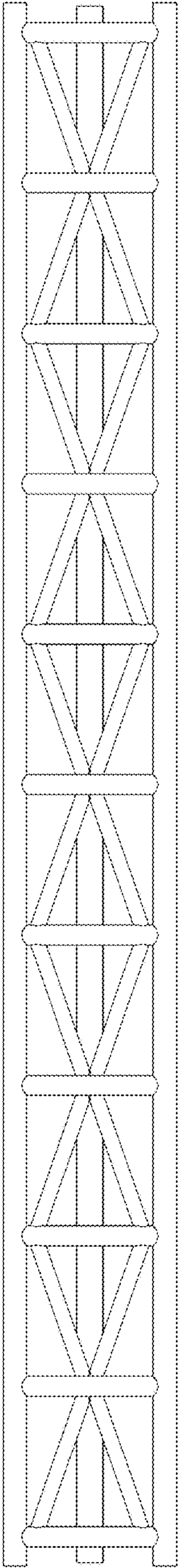

FIG. 2

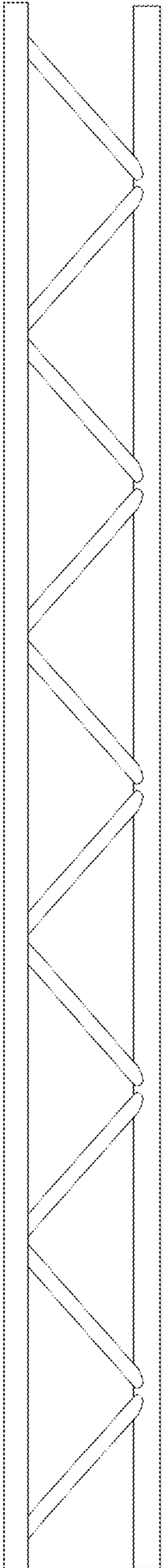

FIG. 3

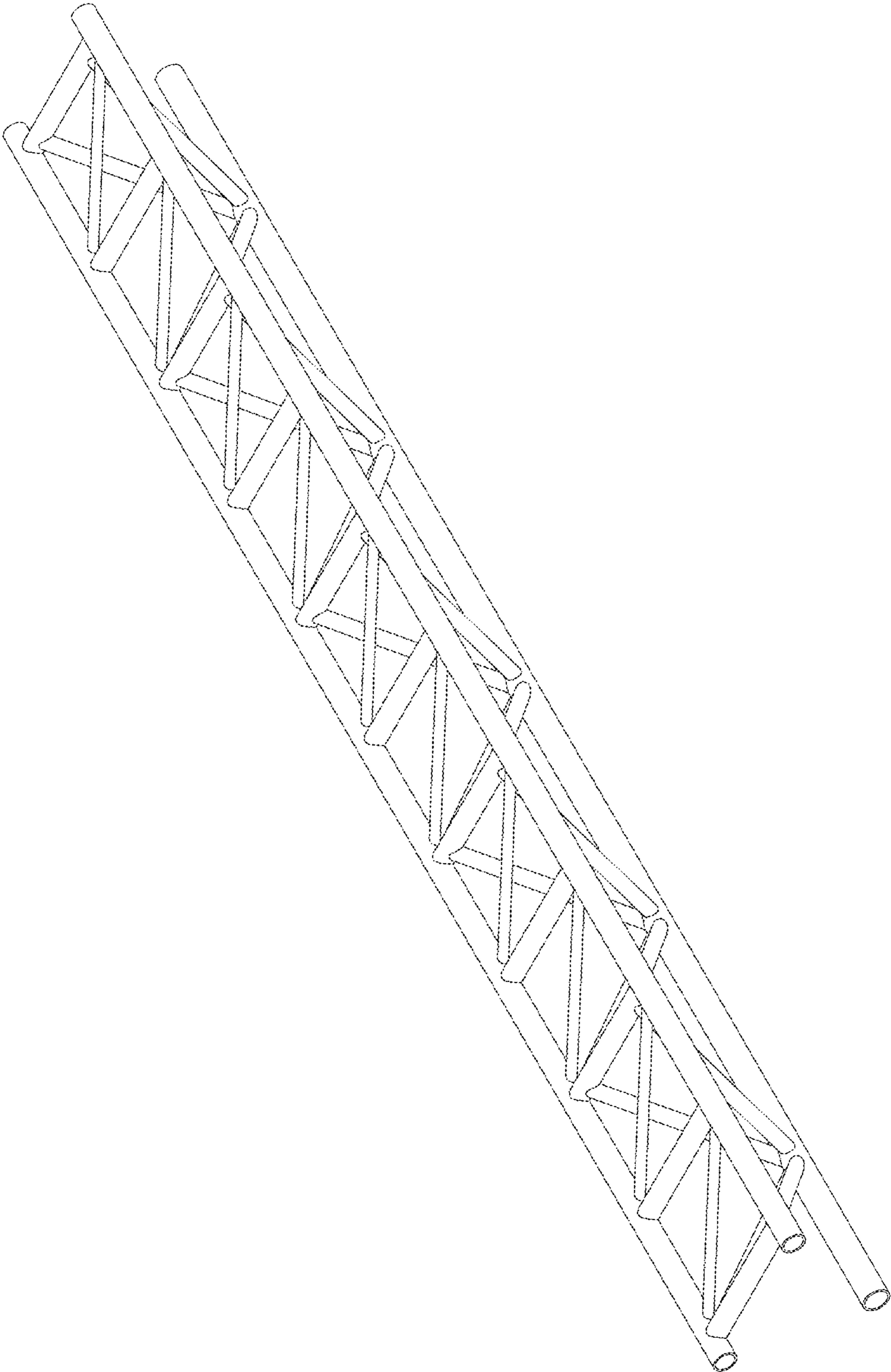

FIG. 4

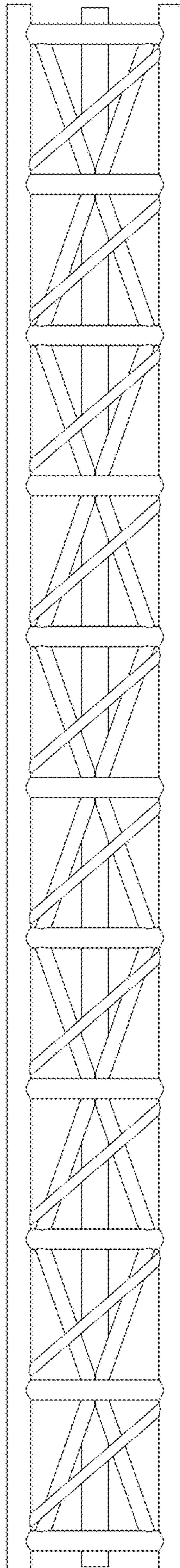

FIG. 5

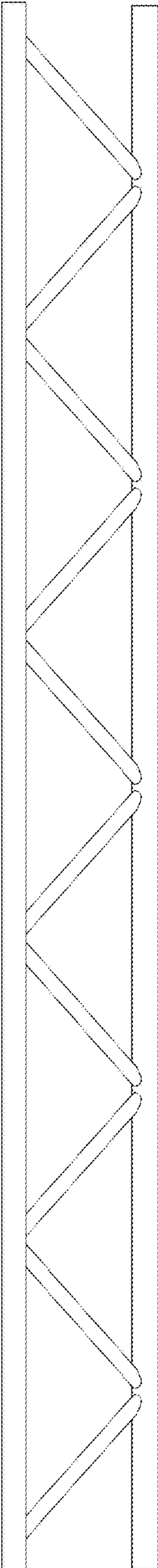

FIG. 6