



US00D974422S

(12) **United States Design Patent**  
**Varotto**

(10) **Patent No.:** **US D974,422 S**  
(45) **Date of Patent:** **\*\* Jan. 3, 2023**

(54) **CUTTING MACHINE**  
(71) Applicant: **DALLAN S.P.A.**, Treviso (IT)  
(72) Inventor: **Paolo Varotto**, Padua (IT)  
(73) Assignee: **DALLAN S.p.A.**, Treviso (IT)  
(\*\*) Term: **15 Years**  
(21) Appl. No.: **35/511,777**  
(22) Filed: **Apr. 16, 2021**  
(80) **Hague Agreement Data**  
Int. Filing Date: **Apr. 16, 2021**  
Int. Reg. No.: **DM/213859**  
Int. Reg. Date: **Apr. 16, 2021**  
Int. Reg. Pub. Date: **Apr. 30, 2021**

4,651,404 A \* 3/1987 Shorrock ..... B23Q 1/66  
29/563  
D302,165 S \* 7/1989 Itoh ..... D15/127  
D422,289 S \* 4/2000 Mariotta ..... D15/127  
D489,077 S \* 4/2004 Bloch ..... D15/127  
D495,723 S \* 9/2004 Kawamura ..... D15/127  
D497,922 S \* 11/2004 Kawamura ..... D15/127  
D559,283 S \* 1/2008 Takeda ..... D15/127  
D559,871 S \* 1/2008 Kittaka ..... D15/127  
D567,263 S \* 4/2008 Sugihara ..... D15/122  
D577,043 S \* 9/2008 Arisue ..... D15/122  
D578,144 S \* 10/2008 Arisue ..... D15/122  
D584,322 S \* 1/2009 Arisue ..... D15/130  
D588,173 S \* 3/2009 Arisue ..... D15/130  
D597,570 S \* 8/2009 Yoshida ..... D15/138  
D620,508 S \* 7/2010 Jacquet ..... D15/122  
D627,375 S \* 11/2010 Jacquet ..... D15/122  
D635,595 S \* 4/2011 Hiroshima ..... D15/122  
D635,596 S \* 4/2011 Hiroshima ..... D15/122  
D637,631 S \* 5/2011 Hiroshima ..... D15/122  
D667,030 S \* 9/2012 Hiroshima ..... D15/122  
D690,331 S \* 9/2013 Kitamura ..... D15/122  
D731,566 S \* 6/2015 Shimano ..... D15/127

(Continued)

(30) **Foreign Application Priority Data**  
Oct. 23, 2020 (IT) ..... 402020000003148

*Primary Examiner* — Richard E Chilcot

(51) **LOC (14) Cl.** ..... **15-09**  
(52) **U.S. Cl.**  
USPC ..... **D15/127**  
CPC ..... **B23K 37/00** (2013.01)

(74) *Attorney, Agent, or Firm* — Thomas | Horstemeyer, LLP

(58) **Field of Classification Search**  
USPC ..... D15/122, 127, 135, 199; 414/737, 749,  
414/750, 751, 752, 753  
CPC ..... B23P 21/00; B23P 25/003; B23P 2700/12;  
B23K 26/16; B23K 26/0869; B23K  
26/38; B23K 26/0846; B23K 10/00;  
B23K 26/702; B23K 26/0838  
See application file for complete search history.

(57) **CLAIM**

The ornamental design for a cutting machine, as shown and described.

(56) **References Cited**  
U.S. PATENT DOCUMENTS

**DESCRIPTION**

**1.1** is a front perspective view of a cutting machine, showing my new design;  
**1.2** is a rear perspective view thereof;  
**1.3** is a left view thereof;  
**1.4** is a right view thereof;  
**1.5** is a front view thereof;  
**1.6** is rear view thereof; and  
**1.7** is a top view thereof.  
A bottom view of the cutting machine is not shown because it is featureless and forms no part of the claim design.

4,443,929 A \* 4/1984 Bayer ..... B23Q 3/15713  
D15/127  
D286,407 S \* 10/1986 Itoh ..... D15/127

**1 Claim, 7 Drawing Sheets**

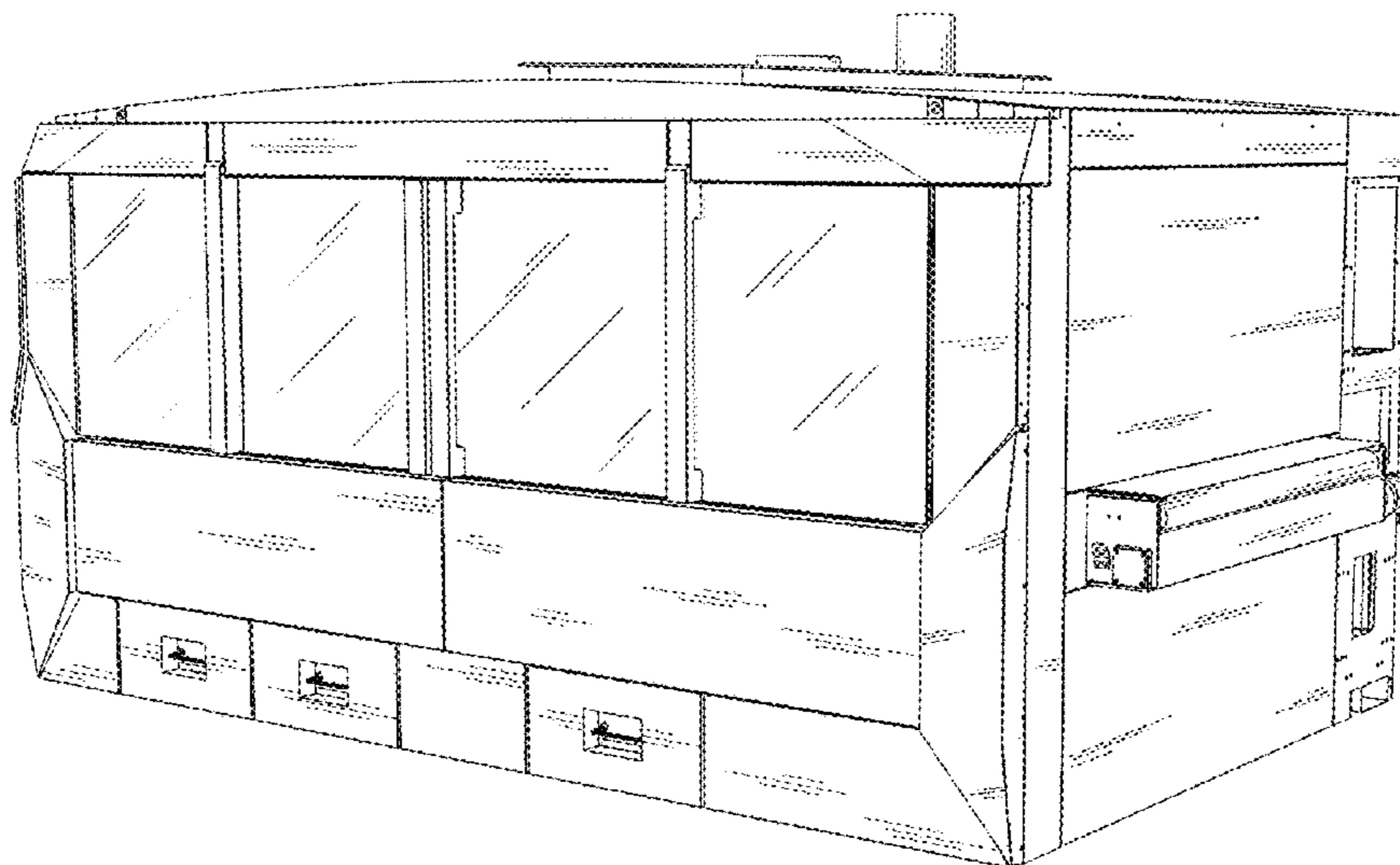

(56)

**References Cited**

## U.S. PATENT DOCUMENTS

|              |    |   |         |               |       |             |
|--------------|----|---|---------|---------------|-------|-------------|
| D736,839     | S  | * | 8/2015  | Shimano       | ..... | D15/127     |
| D748,696     | S  | * | 2/2016  | Lee           | ..... | D15/127     |
| D753,735     | S  | * | 4/2016  | Shimano       | ..... | D15/127     |
| D755,862     | S  | * | 5/2016  | Lee           | ..... | D15/127     |
| D791,204     | S  | * | 7/2017  | Hynek         | ..... | D15/131     |
| D797,822     | S  | * | 9/2017  | Grobe         | ..... | D15/122     |
| D884,754     | S  | * | 5/2020  | André         | ..... | E21B 7/024  |
|              |    |   |         |               |       | D15/122     |
| D920,399     | S  | * | 5/2021  | Shin          | ..... | D15/127     |
| D921,071     | S  | * | 6/2021  | Park          | ..... | D15/127     |
| D923,669     | S  | * | 6/2021  | Tavares Andre | ..... | E21B 7/024  |
|              |    |   |         |               |       | D15/122     |
| D932,523     | S  | * | 10/2021 | Son           | ..... | D15/127     |
| D932,525     | S  | * | 10/2021 | Son           | ..... | D15/127     |
| D932,526     | S  | * | 10/2021 | Son           | ..... | D15/127     |
| 2019/0105738 | A1 | * | 4/2019  | Dalian        | ..... | B23P 21/00  |
| 2019/0151998 | A1 | * | 5/2019  | Dalian        | ..... | B23K 10/006 |
| 2020/0114472 | A1 | * | 4/2020  | Dalian        | ..... | B23K 37/04  |

\* cited by examiner

1.1

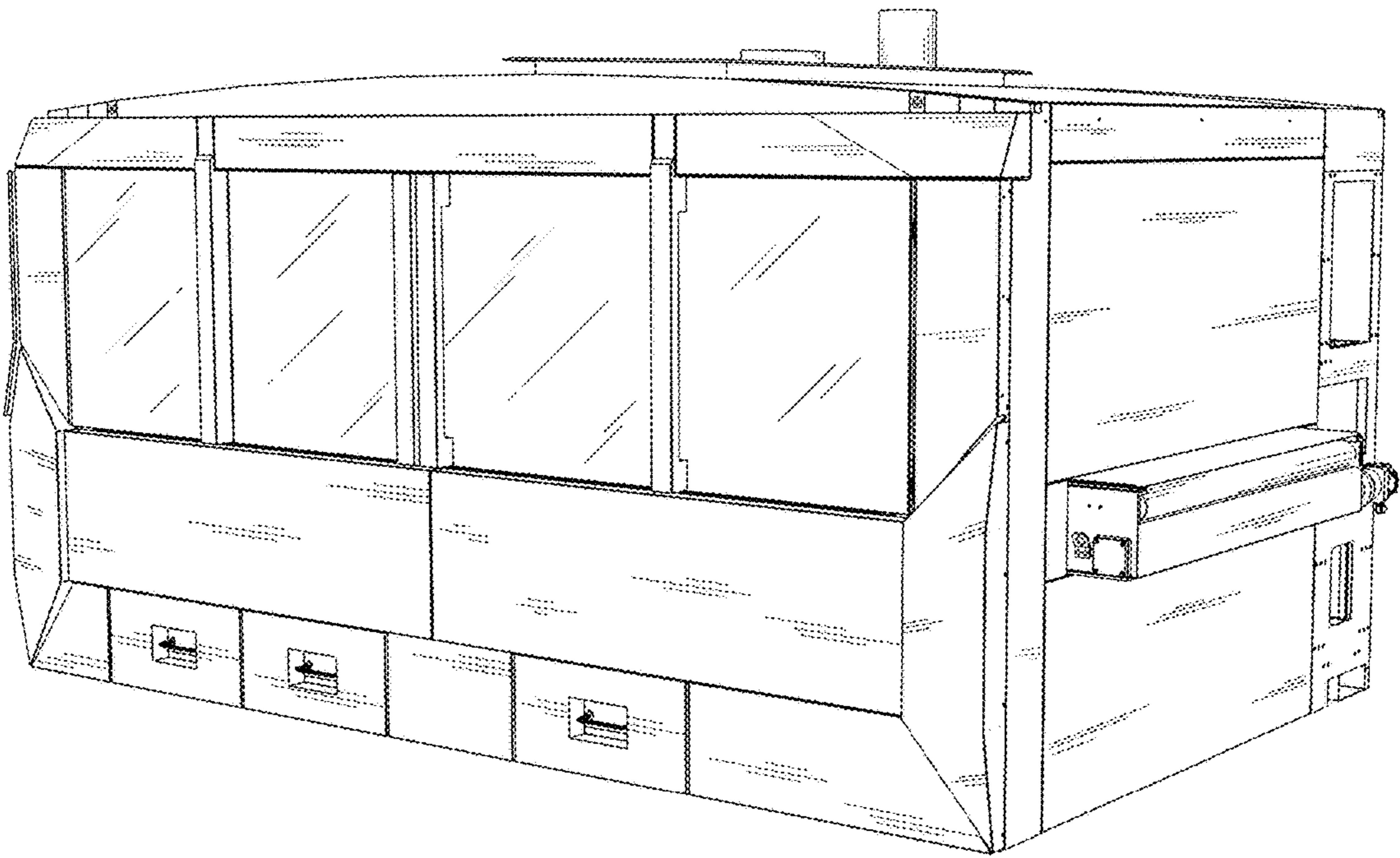

1.2

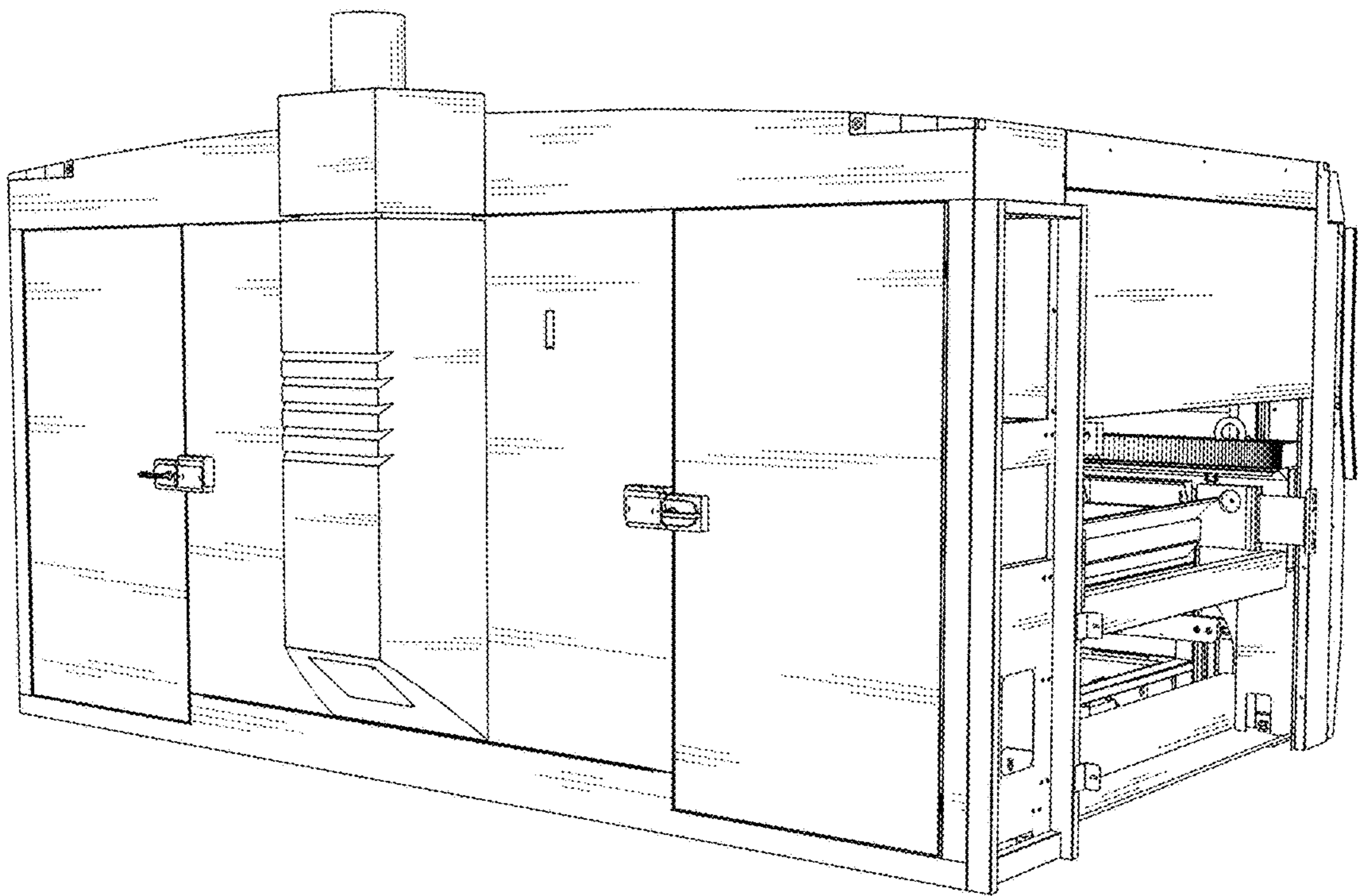

1.3

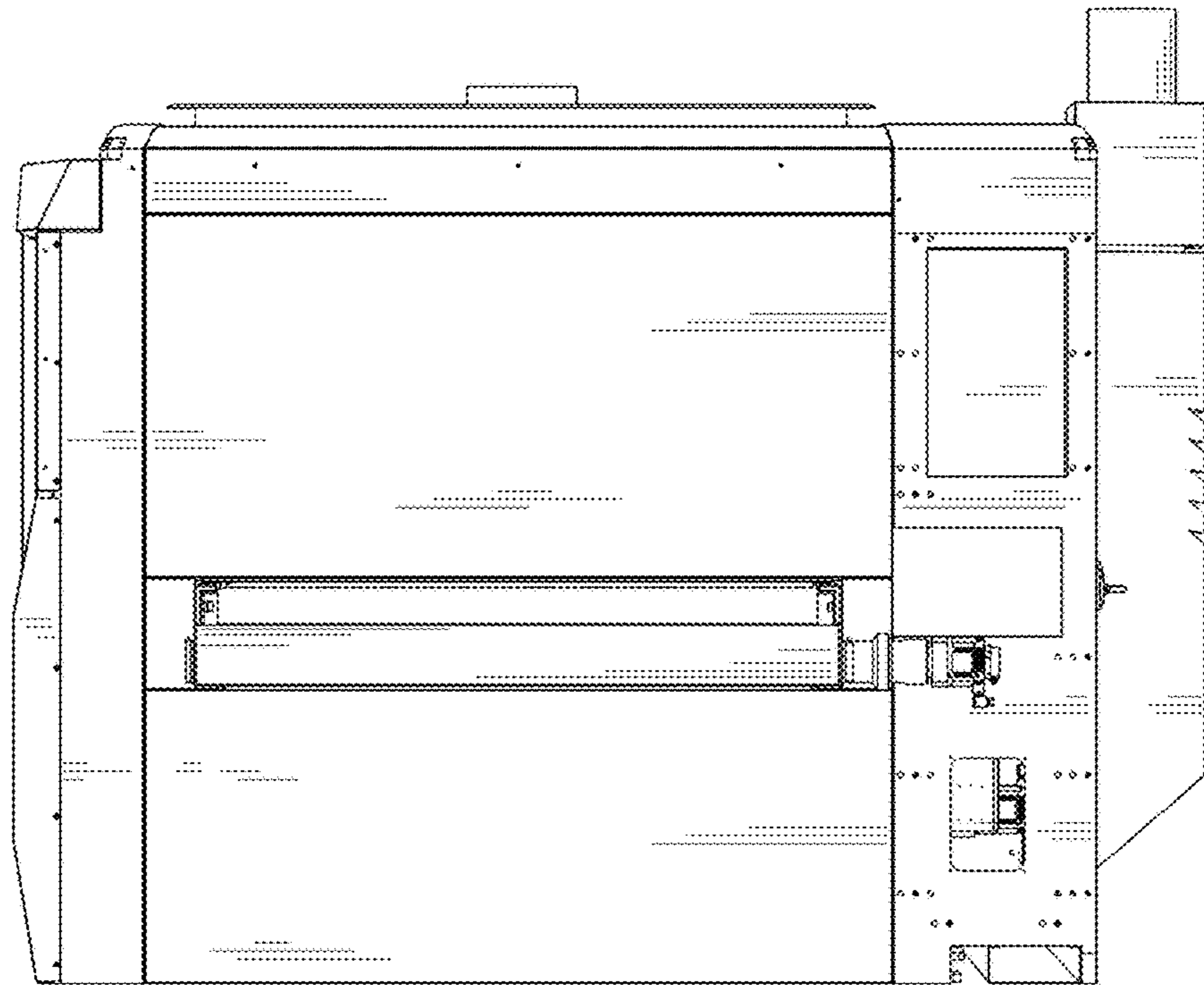

1.4

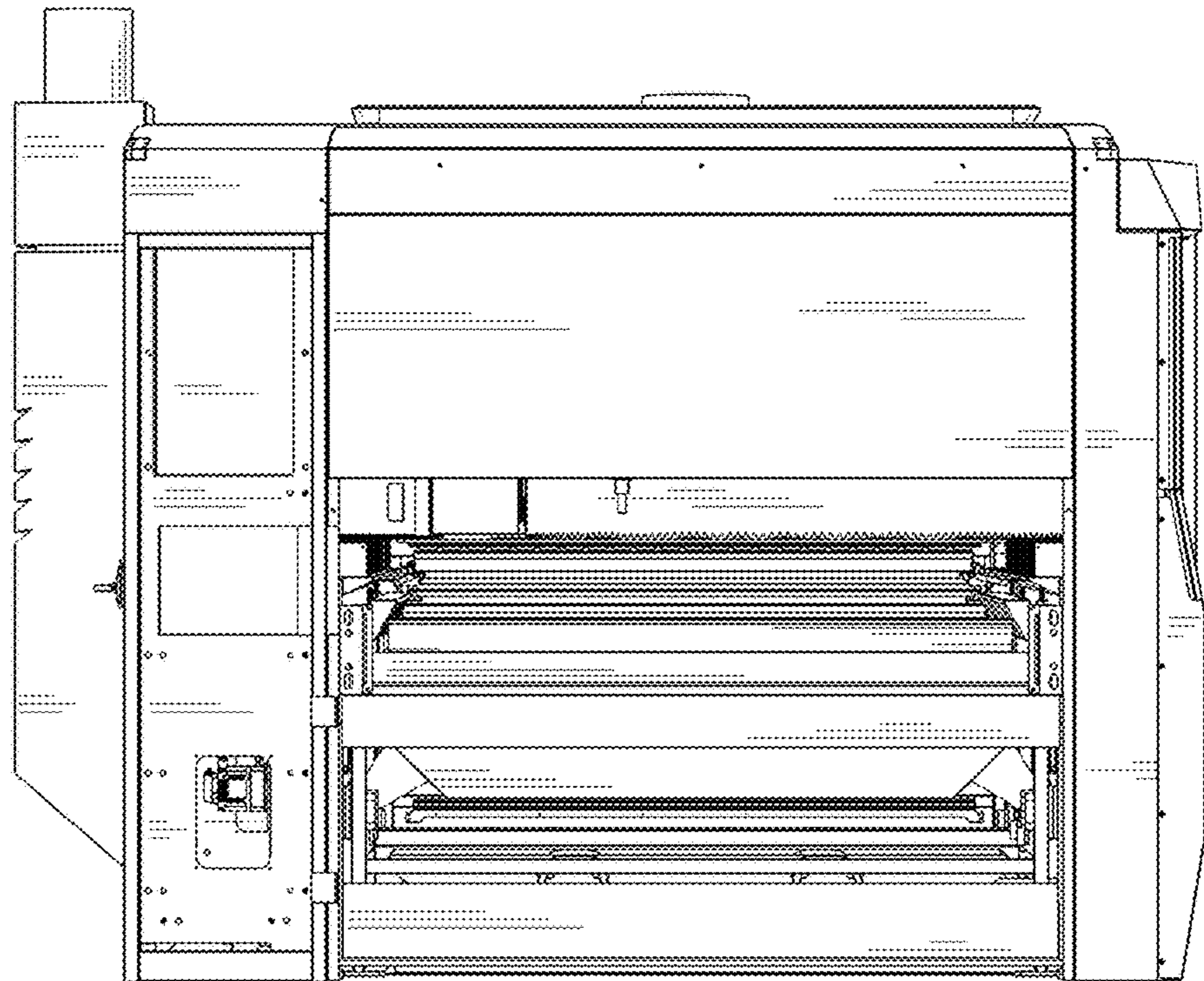

1.5

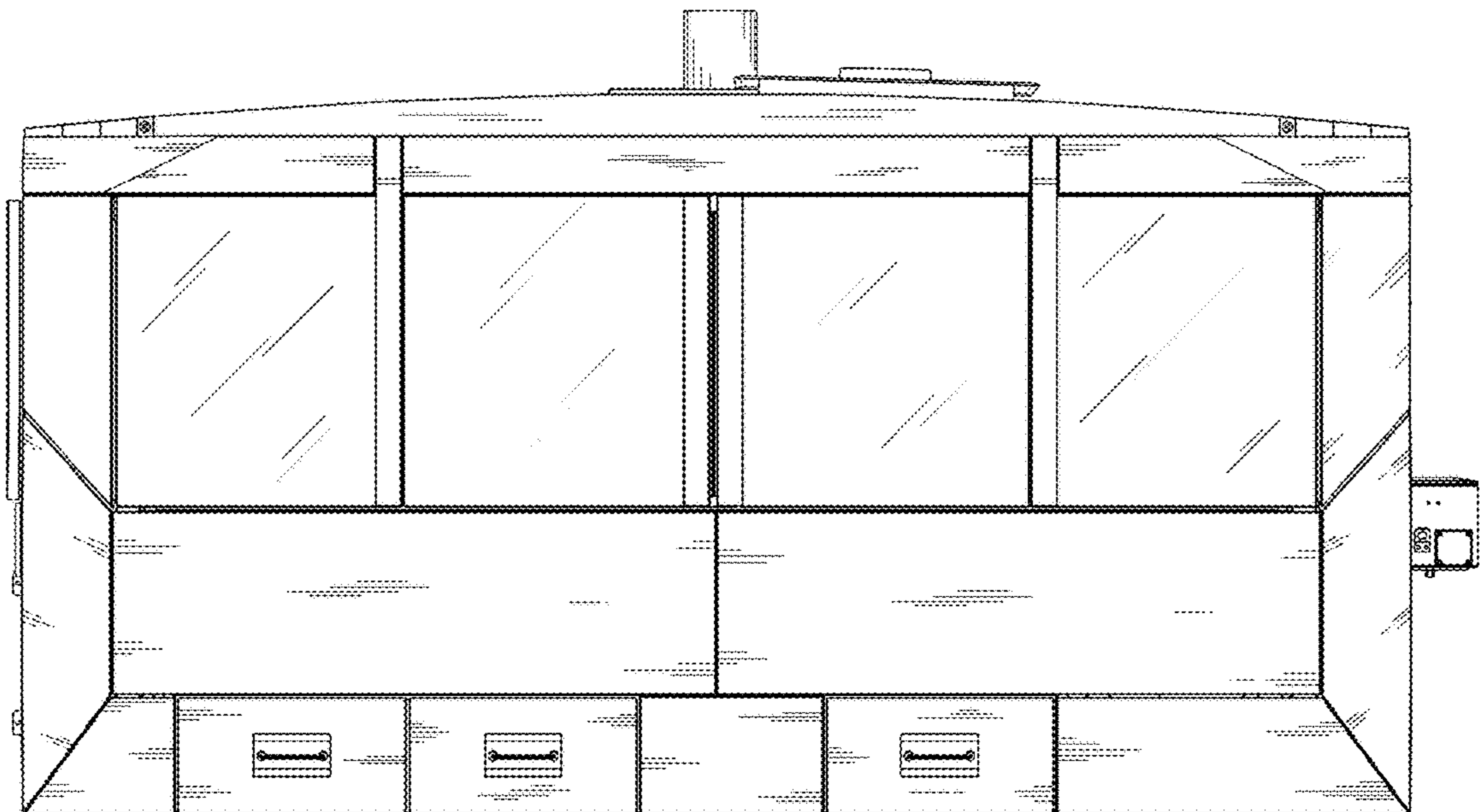

1.6

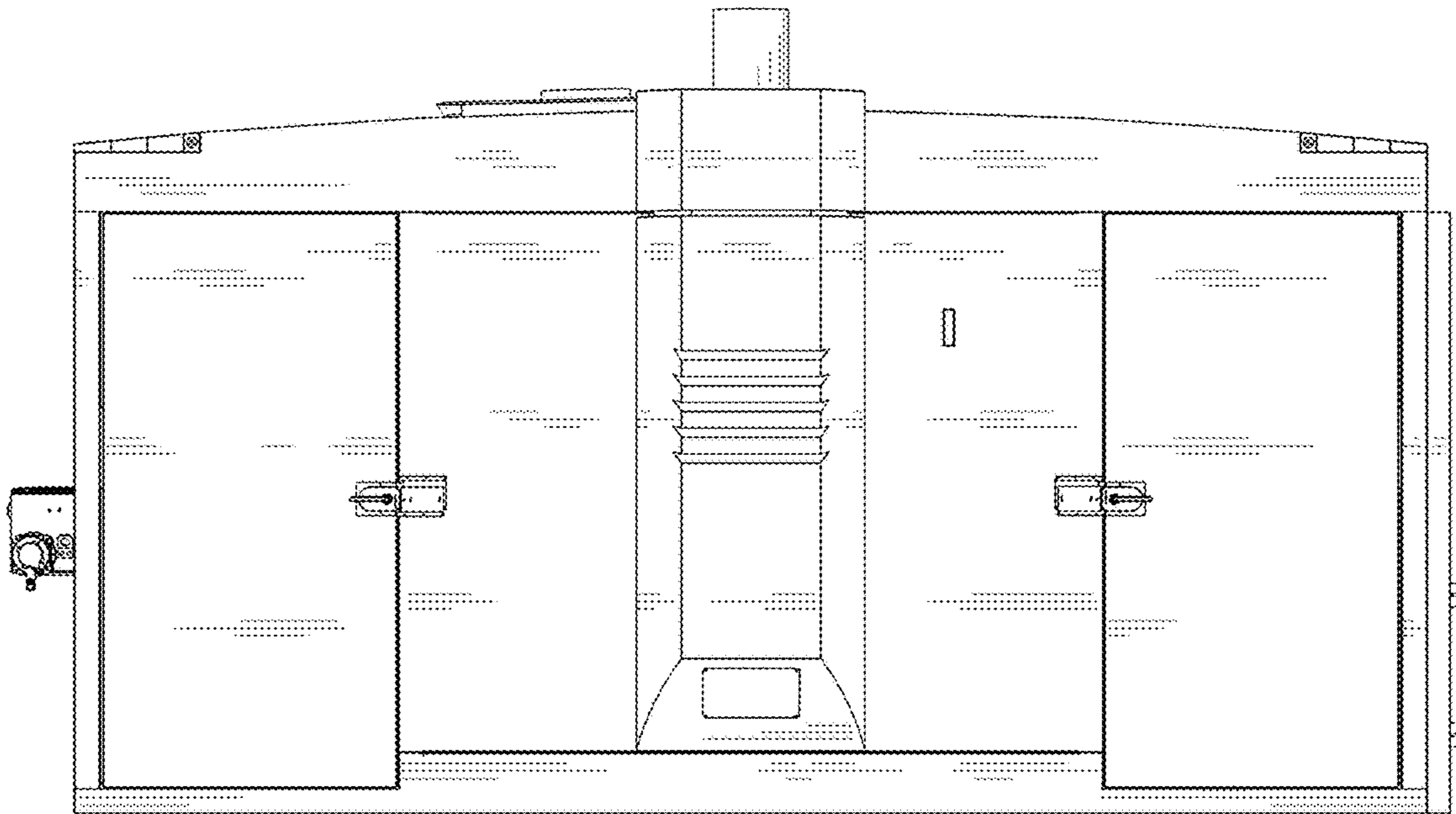



1.7

