



US00D973065S

(12) **United States Design Patent**
Jeon et al.

(10) **Patent No.:** **US D973,065 S**
(45) **Date of Patent:** **** Dec. 20, 2022**

(54) **DISPLAY SCREEN OR PORTION THEREOF WITH TRANSITIONAL GRAPHICAL USER INTERFACE**

FOREIGN PATENT DOCUMENTS

CN 2014301287156 2/2015
CN 2015302758692 3/2016

(Continued)

(71) Applicant: **Samsung Electronics Co., Ltd.**,
Suwon-si (KR)

OTHER PUBLICATIONS

(72) Inventors: **Hankyung Jeon**, Suwon-si (KR);
Saebuk Sheen, Suwon-si (KR)

Hongyue, Guan "SimpleWeather—Moon" [2018] www.dribbble.com Nov. 20, 2018 <https://dribbble.com/shots/5580252-SimpleWeather-Moon?utm_source=Clipboard_Shot&utm_campaign=hongexe&utm_content=SimpleWeather%20-%20Moon&utm_medium=Social_Share>.

(73) Assignee: **Samsung Electronics Co., Ltd.**,
Suwon-si (KR)

(Continued)

(**) Term: **15 Years**

Primary Examiner — Rachel A. Voorhies

(21) Appl. No.: **29/744,395**

(74) *Attorney, Agent, or Firm* — NSIP Law

(22) Filed: **Jul. 29, 2020**

(57) **CLAIM**

(30) **Foreign Application Priority Data**

We claim the ornamental design for a display screen or portion thereof with transitional graphical user interface, as shown and described.

Jan. 31, 2020 (KR) 30-2020-0004378

DESCRIPTION

(51) **LOC (13) Cl.** **14-04**

FIG. 1 is the first image in a sequence for a display screen or portion thereof with transitional graphical user interface showing our new design;

(52) **U.S. Cl.**

USPC **D14/485**

FIG. 2 is the second image thereof;

(58) **Field of Classification Search**

USPC D14/485–495

CPC H04M 1/724–72484

See application file for complete search history.

FIG. 3 is the third image thereof;

FIG. 4 is the fourth image thereof; and,

FIG. 5 is the fifth image thereof.

(56) **References Cited**

The outer perimeter broken line depicting the display screen or portion thereof is for environmental purposes only and forms no part of the claimed design.

U.S. PATENT DOCUMENTS

The remaining broken lines in the figures depict portions of the transitional graphical user interface which form no part of the claimed design.

D493,177 S * 7/2004 Retuta D14/486

D541,810 S * 5/2007 Cummins D14/487

D654,925 S * 2/2012 Nishizawa D14/488

D656,950 S * 4/2012 Shallcross D14/488

D712,422 S 9/2014 Anzures

D745,527 S * 12/2015 Wang D14/485

D756,379 S * 5/2016 Apodaca D14/485

The appearance of the transitional graphical user interface sequentially transitions between the images shown in FIGS. 1 through 5. The process or period in which one image transitions to another forms no part of the claimed design.

(Continued)

1 Claim, 5 Drawing Sheets

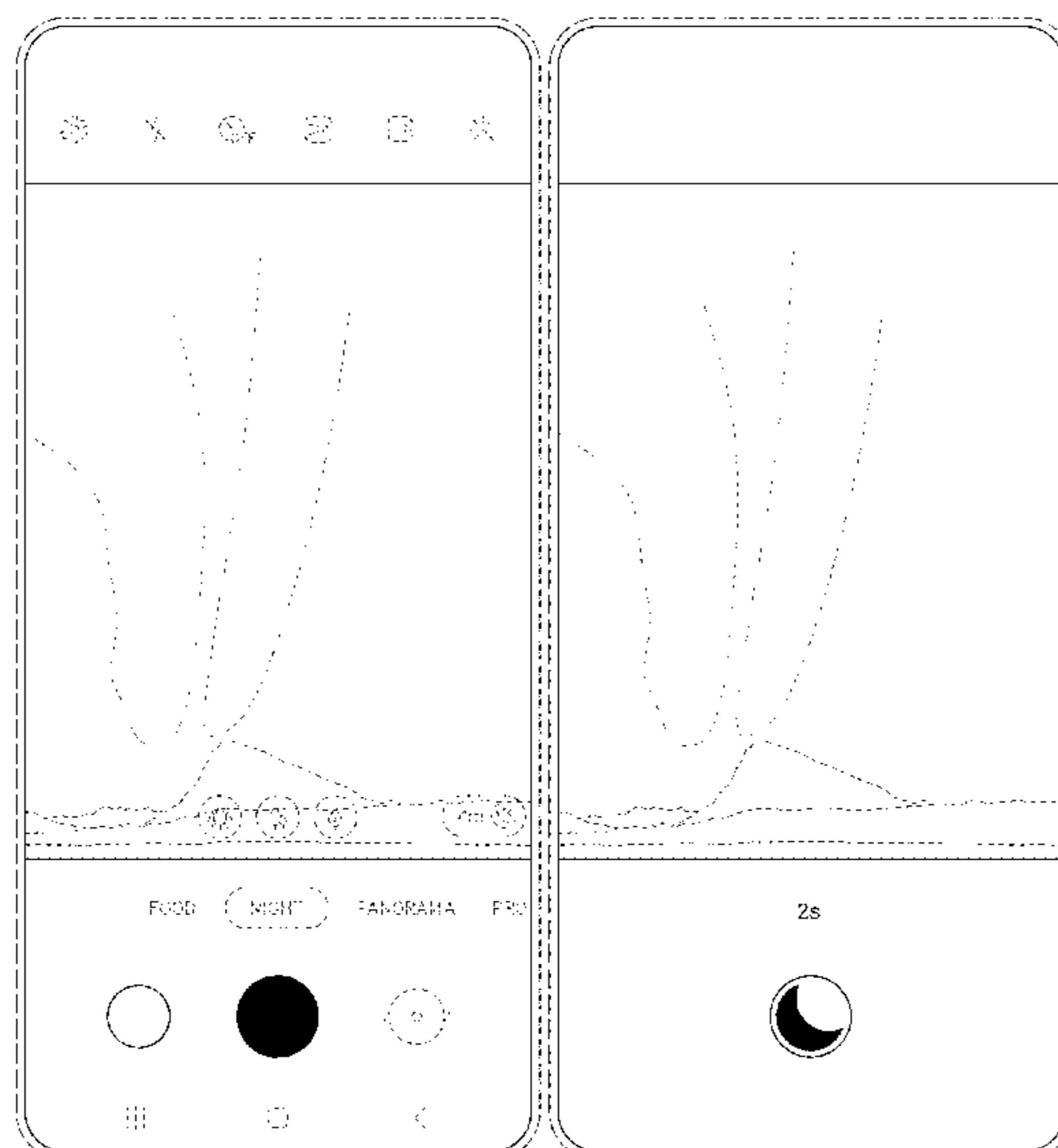

(56)

References Cited

U.S. PATENT DOCUMENTS

D766,254 S * 9/2016 Kawakami D14/485
D776,682 S * 1/2017 Kim D14/485
D787,549 S * 5/2017 Lee G06V 10/44
D14/488
D815,645 S * 4/2018 Felt D14/485
D828,364 S * 9/2018 Felt D14/485
D835,669 S * 12/2018 Hong D14/492
10,270,983 B1 * 4/2019 Van Os H04N 5/23219
D870,771 S * 12/2019 Butcher D14/489
D880,523 S * 4/2020 Kim D14/490
10,645,294 B1 * 5/2020 Manzari H04N 5/232127
D898,752 S * 10/2020 Lee D14/485
D900,153 S * 10/2020 Ryono D14/489
D902,221 S * 11/2020 Barlier D14/485
D910,696 S * 2/2021 Lee D14/487
D914,753 S * 3/2021 Takenaga D14/489
D915,459 S * 4/2021 Chipley D14/489
D916,795 S * 4/2021 Yu D14/486
D918,228 S * 5/2021 Ramamurthy D14/485
D920,352 S * 5/2021 Nakafuji D14/485

D925,597 S * 7/2021 Chandran D14/491
D955,417 S * 6/2022 Feng D14/488
2017/0094161 A1 * 3/2017 Graham G06V 10/44
2018/0335848 A1 * 11/2018 Moussette G06F 3/04817
2021/0124903 A1 * 4/2021 Gao G06F 3/0488

FOREIGN PATENT DOCUMENTS

CN 2016301328329 8/2016
CN 2016302501315 11/2016
CN 2018301052017 5/2018
CN 2017304698498 7/2018
CN 2018302691499 11/2018
CN 2018303154848 4/2019
KR 30-2014-0029673 10/2014

OTHER PUBLICATIONS

“Solar Eclipse” [2020] www.pinterest.com Jul. 28, 2020 <<https://www.pinterest.co.kr/pin/393783561155220601/>>.

* cited by examiner

FIG. 1

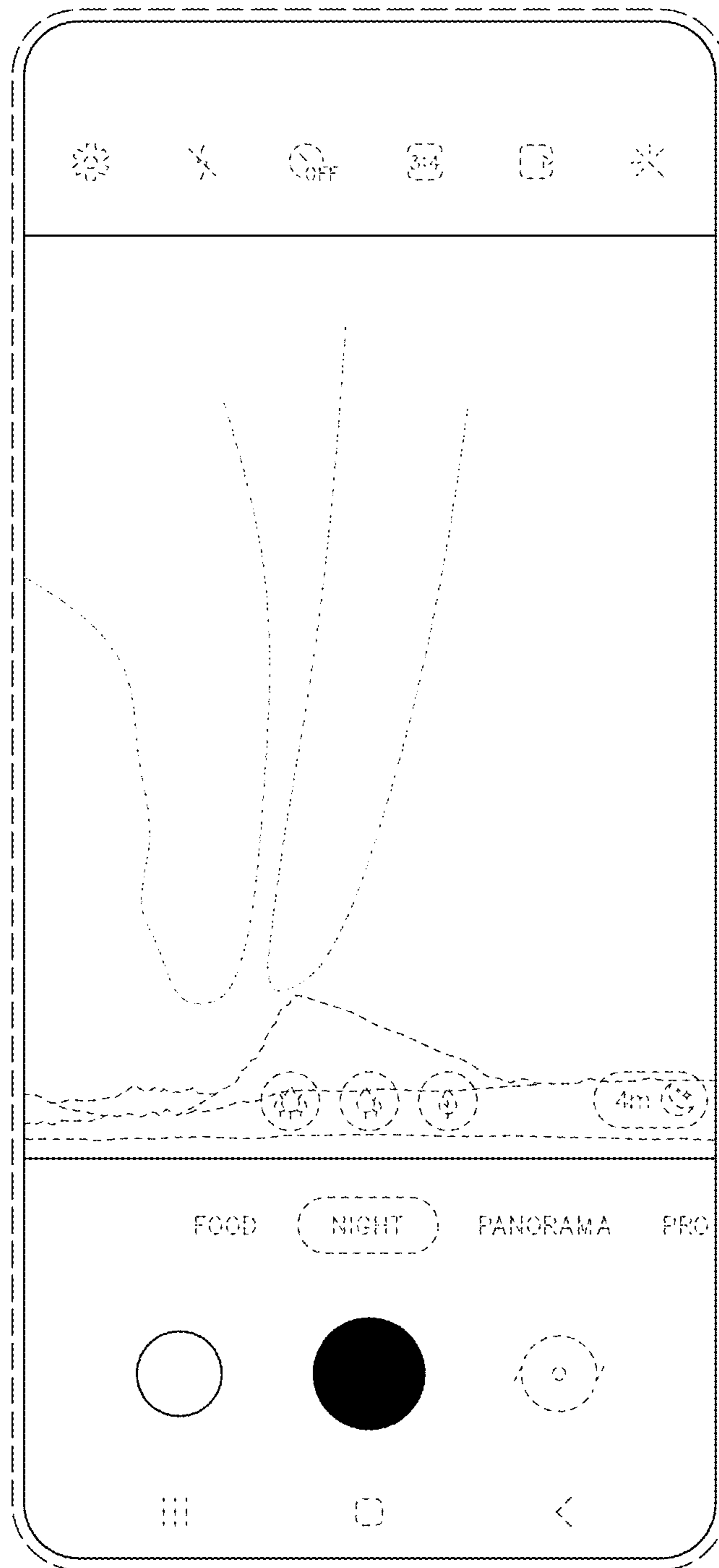

FIG. 2

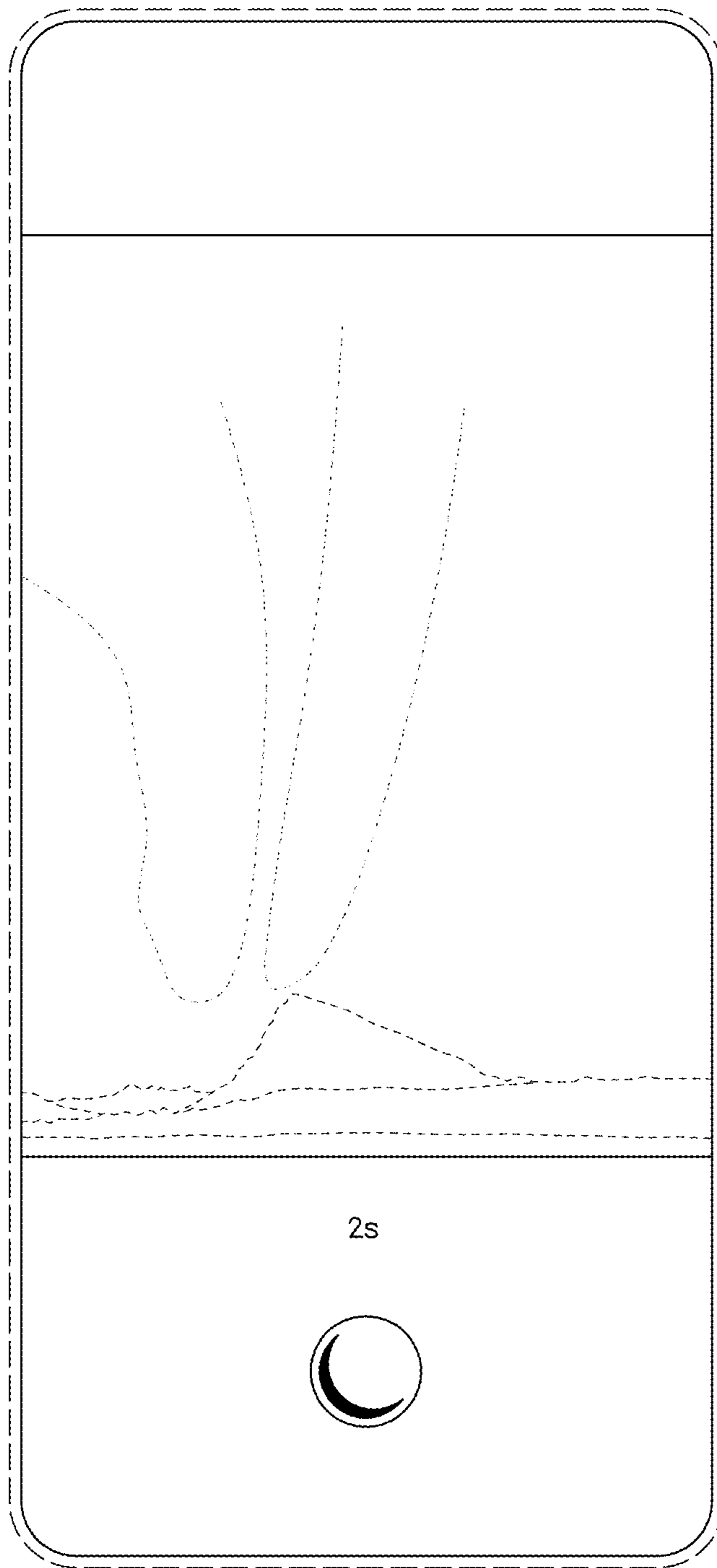

FIG. 3

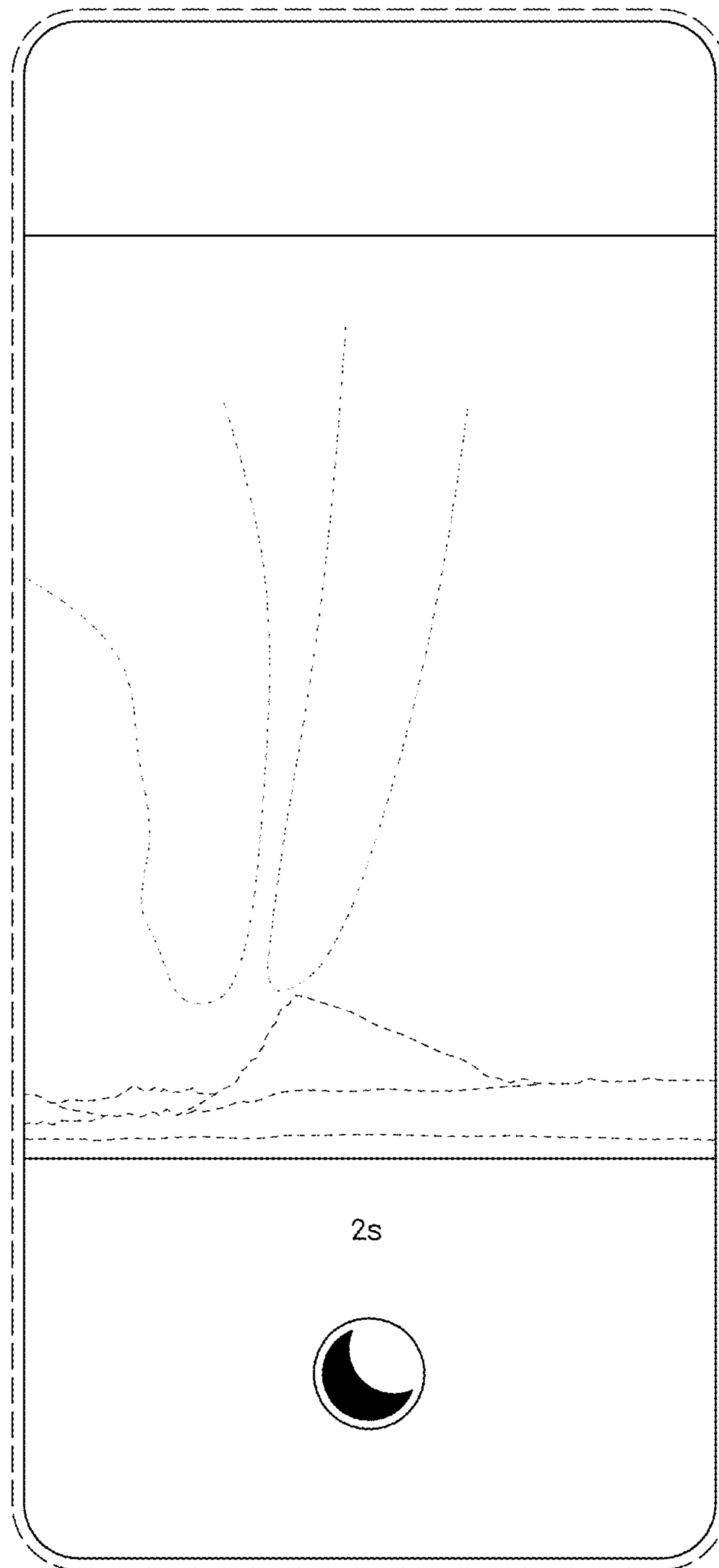

FIG. 4

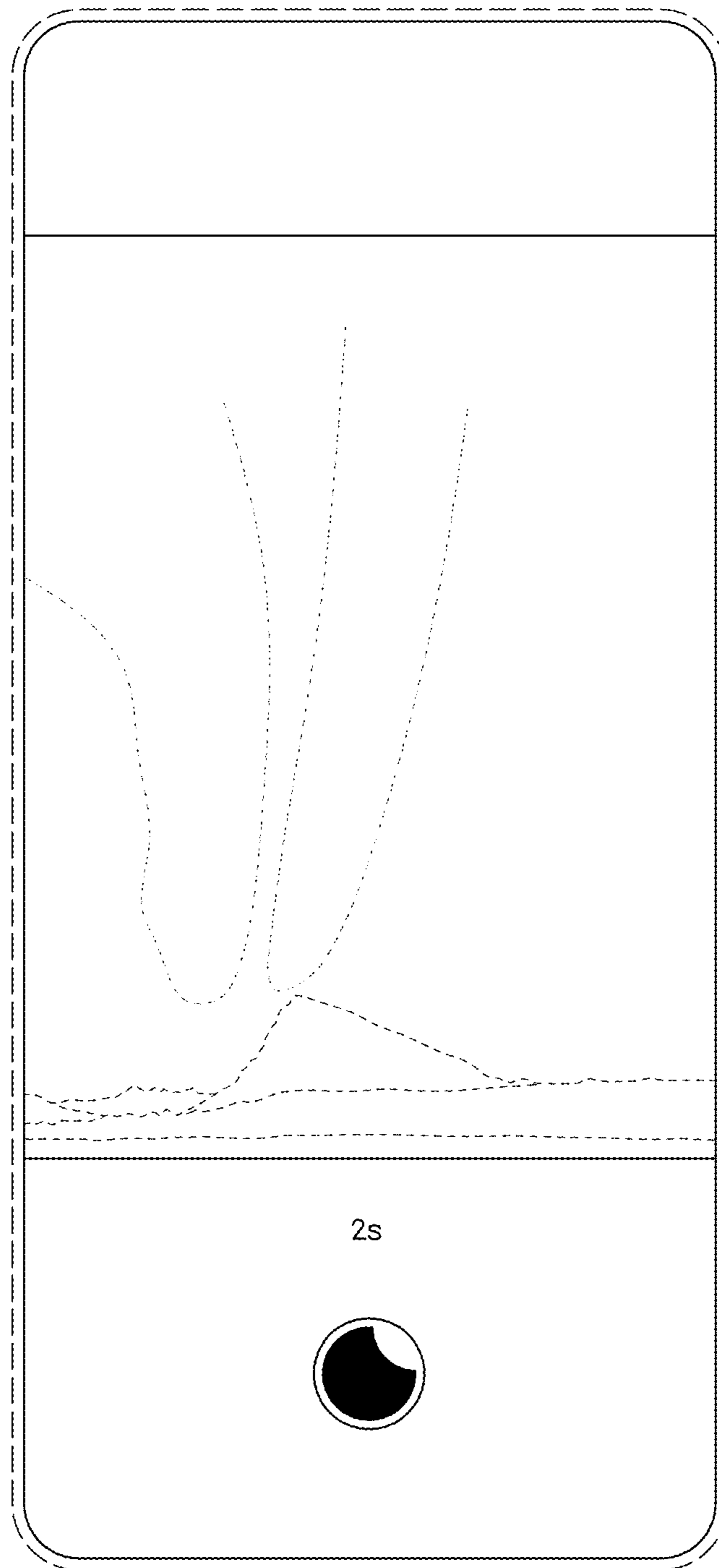

FIG. 5

