



US00D971240S

(12) **United States Design Patent** (10) **Patent No.:** **US D971,240 S**
Xu et al. (45) **Date of Patent:** **** Nov. 29, 2022**

(54) **DISPLAY SCREEN WITH GRAPHICAL USER INTERFACE**

(71) Applicant: **Hangzhou Ruisheng Software Co., Ltd.**, Zhejiang (CN)

(72) Inventors: **Qingsong Xu**, Zhejiang (CN); **Qing Li**, Zhejiang (CN)

(73) Assignee: **Hangzhou Ruisheng Software Co., Ltd.**, Zhejiang (CN)

(**) Term: **15 Years**

(21) Appl. No.: **29/841,673**

(22) Filed: **Jun. 8, 2022**

(51) **LOC (13) Cl.** **14-04**

(52) **U.S. Cl.**
USPC **D14/485**

(58) **Field of Classification Search**
USPC D14/485–495

CPC H04N 5/232933; H04N 5/23216; G06V 10/255; G06V 20/20; G06V 30/1916; G06T 11/00; G06K 9/6292; G06F 3/04817; G06F 3/0482; G06F 3/04847; G06F 3/0488; G06F 3/017; G06F 3/0483; G06F 3/0484; G06F 3/04842

See application file for complete search history.

(56) **References Cited**

U.S. PATENT DOCUMENTS

| | | | | |
|--------------|---------|-------------|-------|---------|
| D274,711 S * | 7/1984 | Sun | | D11/139 |
| D762,685 S * | 8/2016 | Eom | | D14/486 |
| D803,239 S * | 11/2017 | Yuk | | D14/492 |
| D807,912 S * | 1/2018 | Kim | | D14/488 |
| D890,193 S | 7/2020 | Xu et al. | | |
| D918,250 S * | 5/2021 | Xu | | D14/486 |
| D921,660 S | 6/2021 | Reid et al. | | |
| D921,661 S * | 6/2021 | Reid | | D14/488 |
| D923,650 S * | 6/2021 | Kim | | D14/488 |
| D933,705 S | 10/2021 | Xu et al. | | |

| | | | | |
|--------------|---------|------------------|-------|---------|
| D936,693 S * | 11/2021 | Li | | D14/486 |
| D938,482 S | 12/2021 | Underwood et al. | | |
| D940,153 S | 1/2022 | Pazmino et al. | | |
| D943,631 S | 2/2022 | Machniewska | | |
| D946,605 S * | 3/2022 | Toida | | D14/486 |
| D947,231 S | 3/2022 | Kim et al. | | |

(Continued)

OTHER PUBLICATIONS

“Mushroom identification app” Sep. 18, 2021, YouTube, site visited Sep. 19, 2022: <https://www.youtube.com/watch?v=vdA2CDIHHtU> (Year: 2021).*

(Continued)

Primary Examiner — Katherine A Holbrow
Assistant Examiner — Christopher M Spivey
(74) *Attorney, Agent, or Firm* — JCIPRNET

(57) **CLAIM**

The ornamental design for a display screen with graphical user interface, as shown and described.

DESCRIPTION

FIG. 1 is a front view of a first image in a sequence of a display screen with graphical user interface; FIG. 2 is a front view of a second image thereof; FIG. 3 is a front view of a third image thereof; FIG. 4 is a front view of a fourth image thereof; FIG. 5 is a front view of a fifth image thereof; FIG. 6 is a front view of a sixth image thereof; and, FIG. 7 is a front view of a seventh image thereof.

The appearance of the transitional image sequentially transitions between the images shown in FIGS. 1-7. The process or period in which one image transitions to another image forms no part of the claimed design. The dot-dash broken lines illustrate the display screen and form no part of the claimed design. The remaining broken lines illustrate portions of the graphical user interface that form no part of the claimed design.

1 Claim, 7 Drawing Sheets

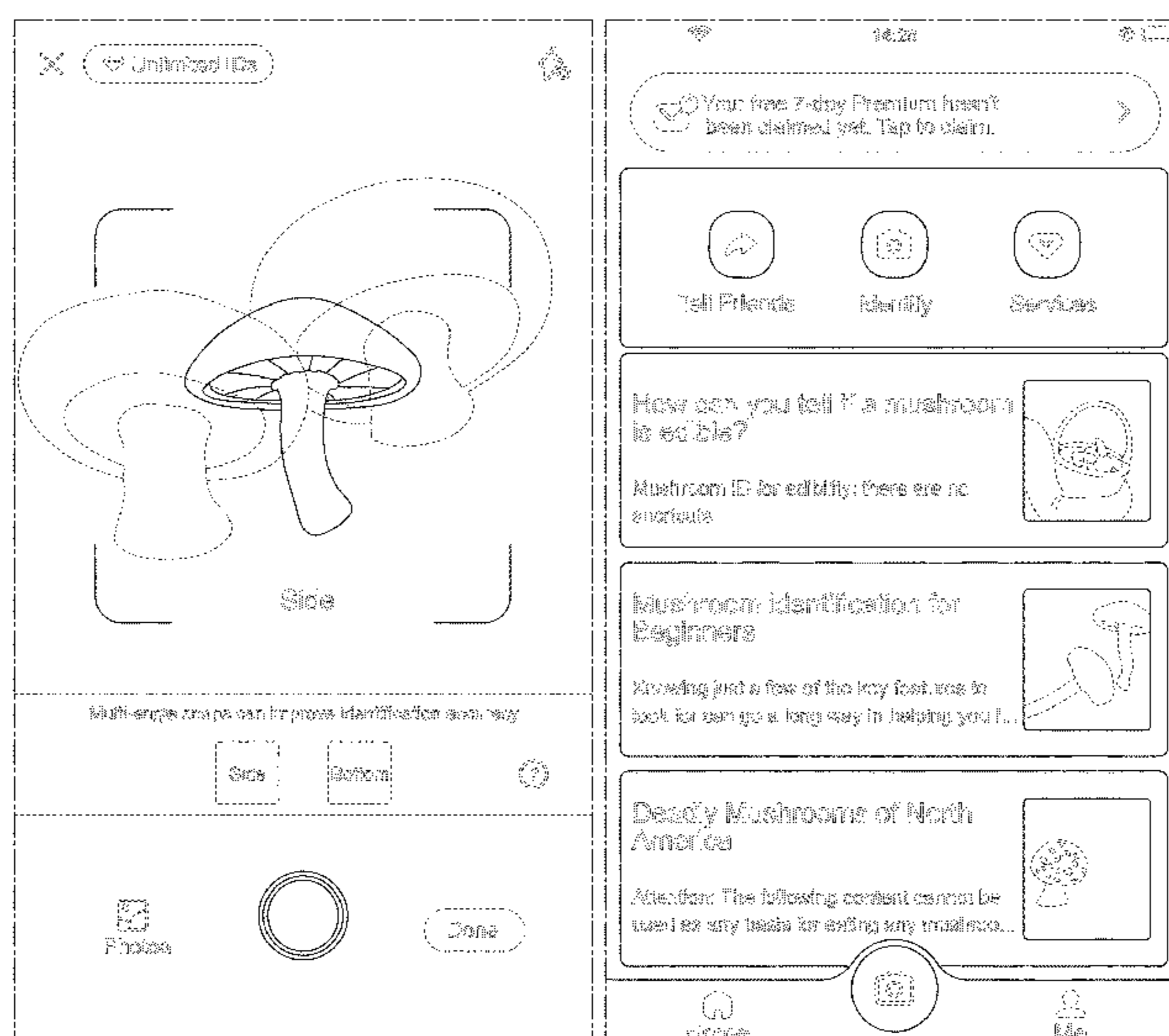

(56)

References Cited

U.S. PATENT DOCUMENTS

D949,189 S 4/2022 Machniewska
D959,482 S * 8/2022 Song D14/488
D964,397 S * 9/2022 Xu D14/485
2018/0322353 A1* 11/2018 Ralls G06K 9/6254
2021/0173553 A1* 6/2021 Nishioka G06F 3/04883

OTHER PUBLICATIONS

Hao, Cao "Plant identification and breeding procedures" Jun. 30, 2019, Dribbble, site visited Sep. 20, 2022: <https://dribbble.com/shots/6710534-Plant-identification-and-breeding-procedures> (Year: 2019).*

* cited by examiner

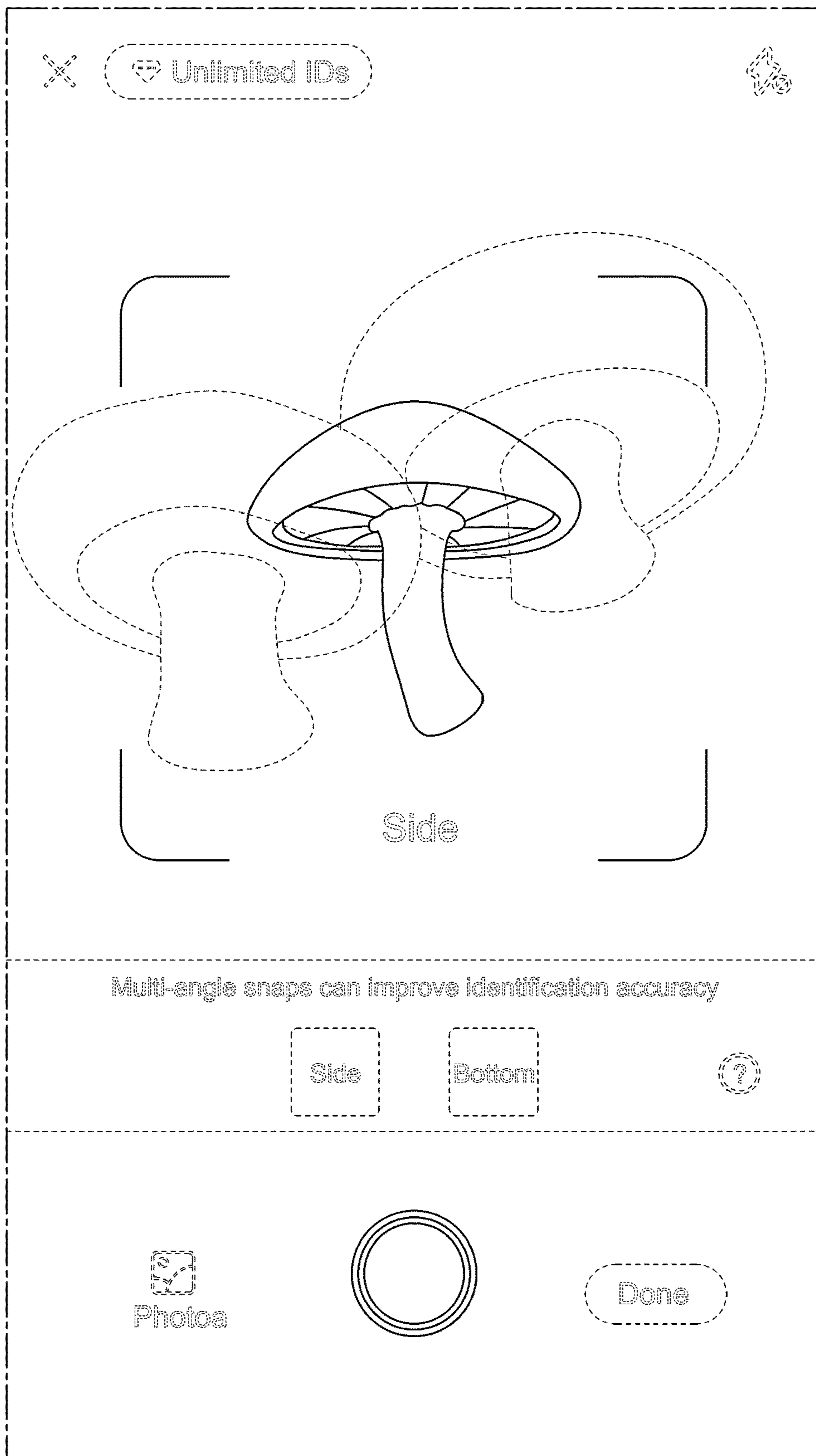

FIG. 1

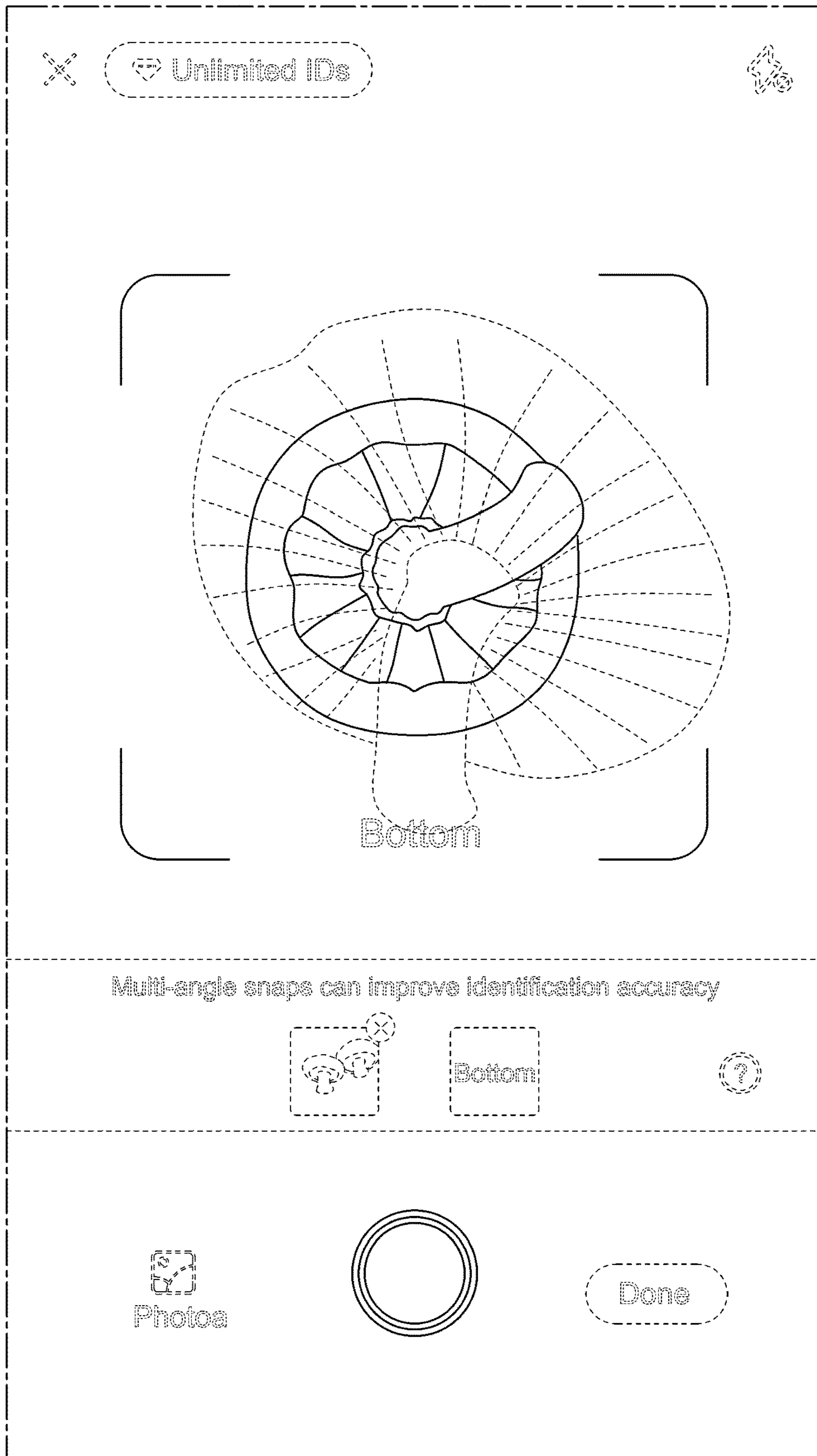

FIG. 2

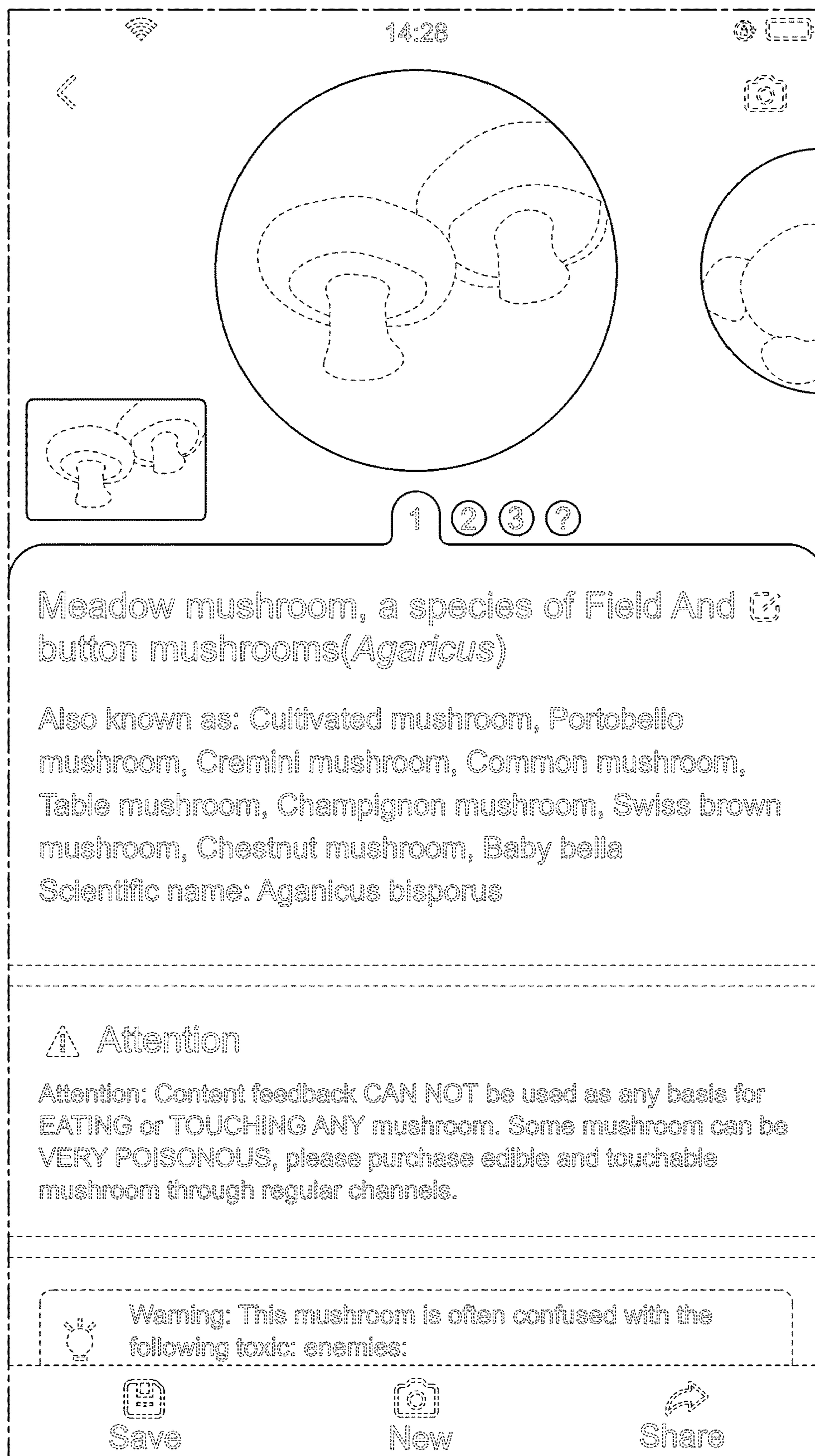

FIG. 3

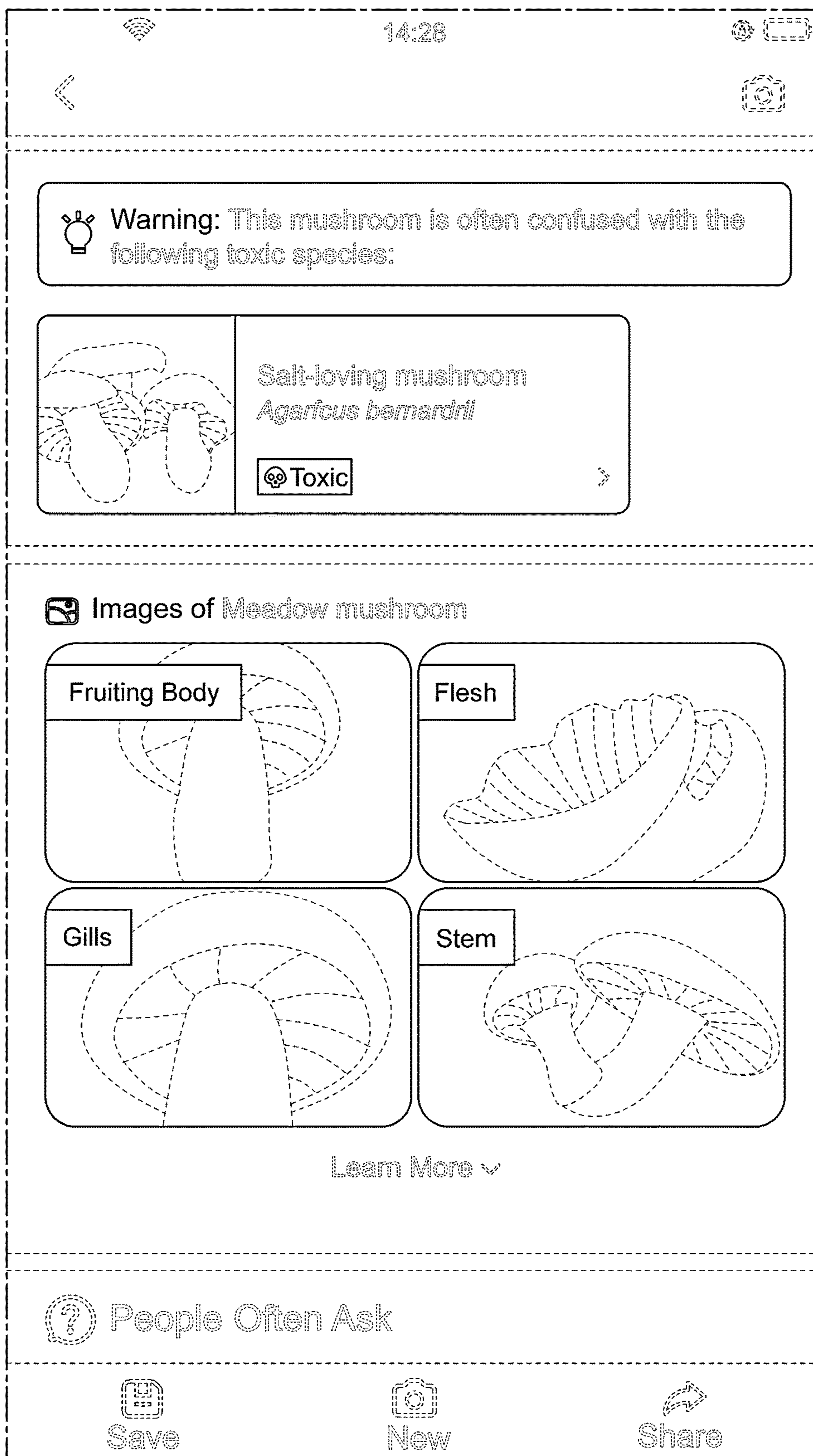

FIG. 4

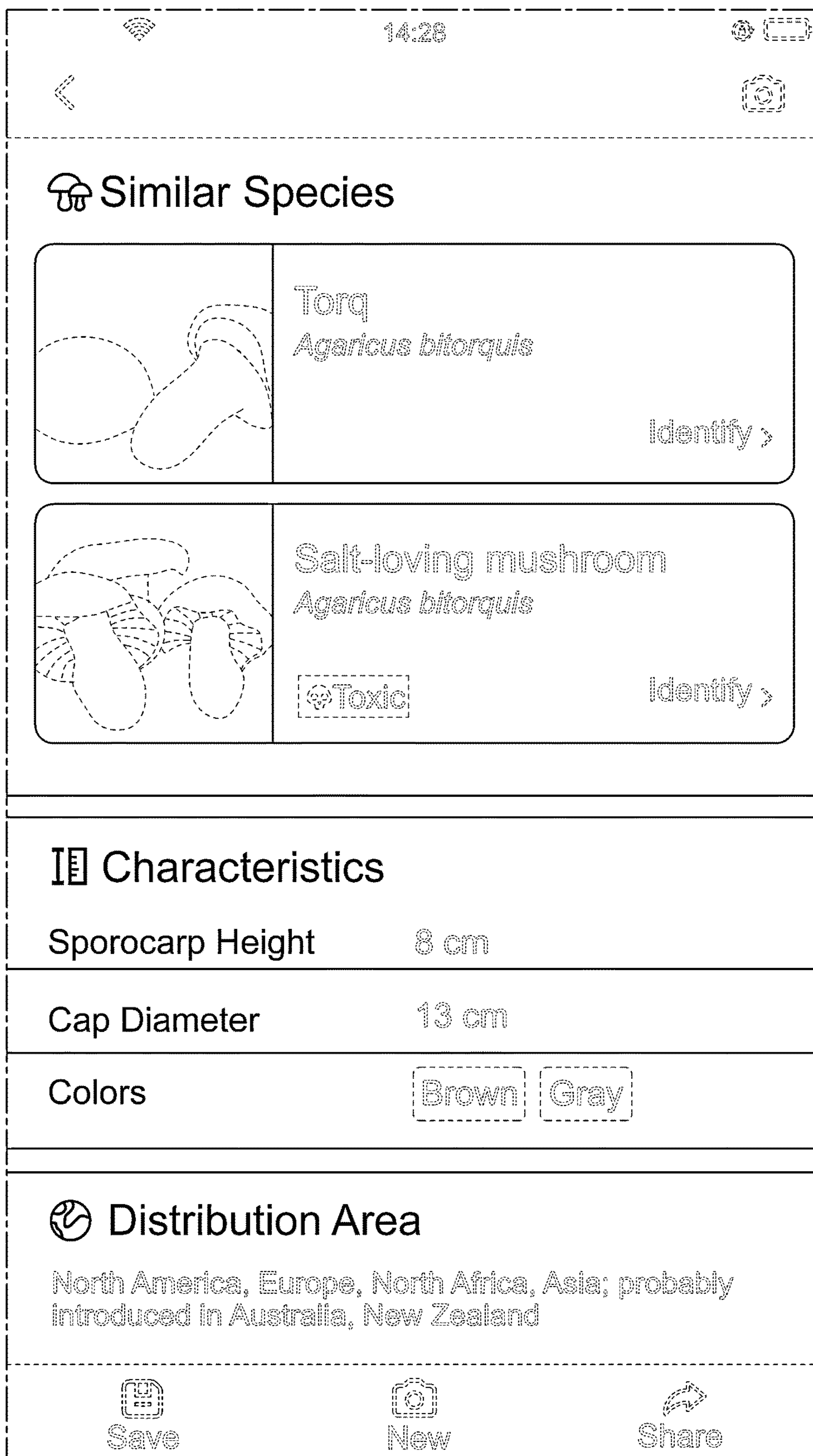

FIG. 5

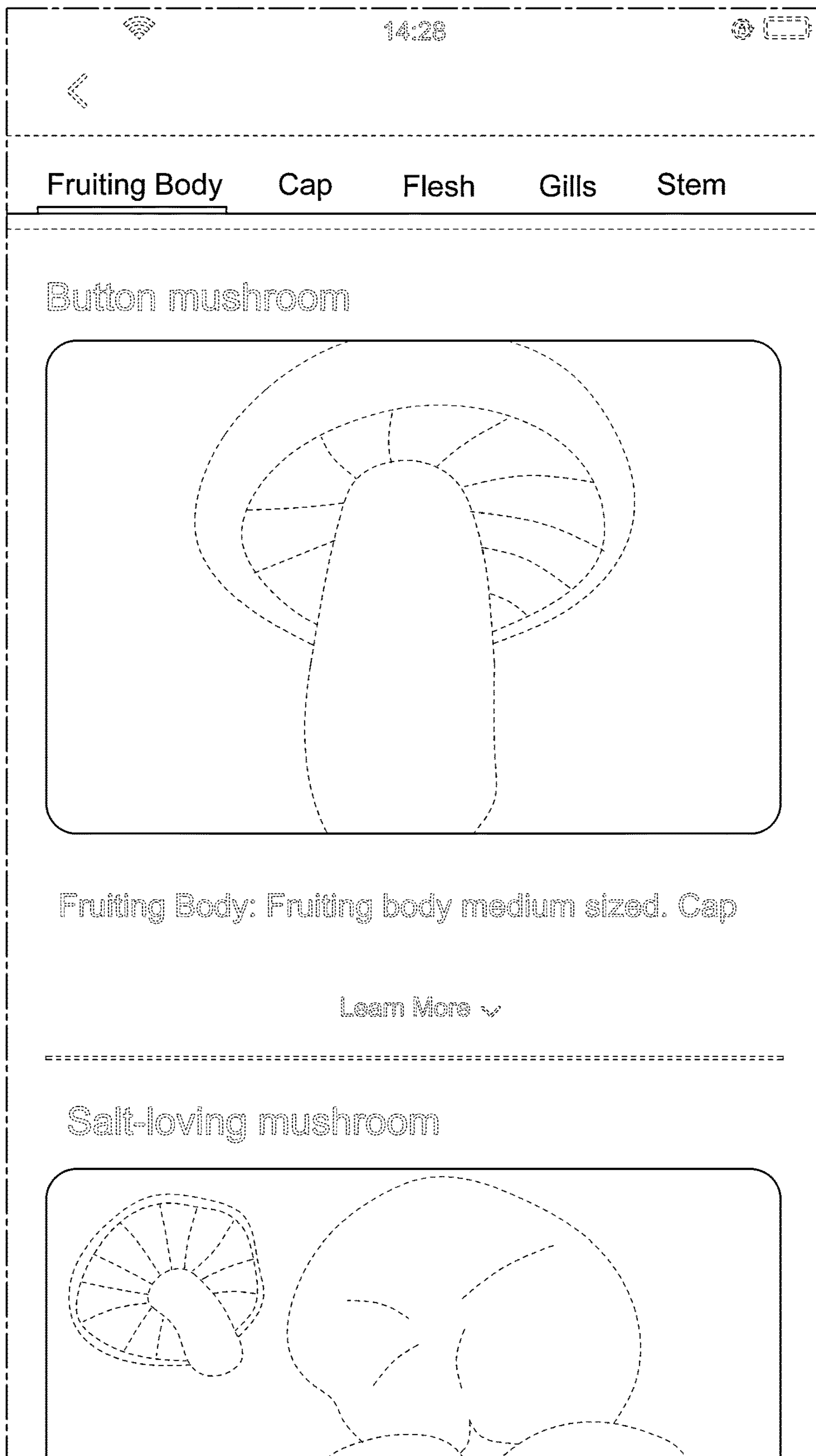

FIG. 6

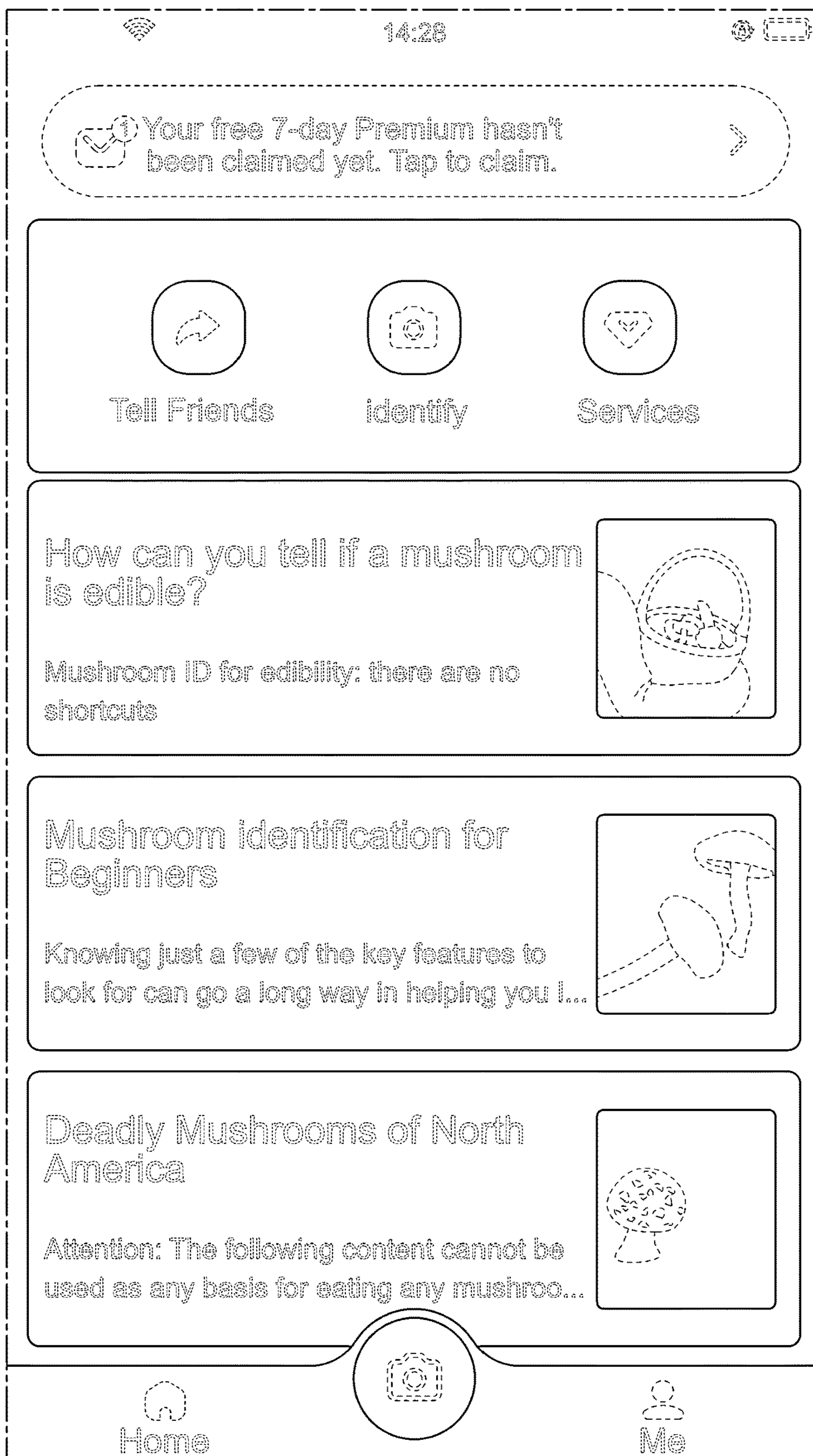

FIG. 7