



US00D971049S

(12) **United States Design Patent** (10) **Patent No.:** **US D971,049 S**
Iida (45) **Date of Patent:** **** Nov. 29, 2022**

(54) **OPERATING PANEL FOR ELEVATOR**
(71) Applicant: **Mitsubishi Electric Corporation,**
Tokyo (JP)
(72) Inventor: **Yuki Iida,** Tokyo (JP)
(73) Assignee: **Mitsubishi Electric Corporation,**
Tokyo (JP)

D681,493 S * 5/2013 Saikawa D13/164
D696,601 S * 12/2013 Saikawa D13/164
D699,142 S * 2/2014 Saikawa D13/164
D701,785 S * 4/2014 Saikawa D10/108
D703,670 S * 4/2014 Rotsaert D14/307
D705,688 S * 5/2014 Saikawa D13/164
D705,689 S * 5/2014 Saikawa D13/164
D721,661 S * 1/2015 Lofberg D13/174
D732,695 S * 6/2015 Saikawa D25/37
(Continued)

(**) Term: **15 Years**

FOREIGN PATENT DOCUMENTS

(21) Appl. No.: **29/753,521**

JP 1434911 S 3/2012

(22) Filed: **Sep. 30, 2020**

Primary Examiner — George D. Kirschbaum
(74) *Attorney, Agent, or Firm* — Studebaker & Brackett
PC

(30) **Foreign Application Priority Data**

Apr. 6, 2020 (JP) 2020-007217 D

(51) **LOC (13) Cl.** **10-05**

(52) **U.S. Cl.**
USPC **D10/108**

(58) **Field of Classification Search**
USPC D10/108, 106.95; D14/307, 491;
D13/164, 174
See application file for complete search history.

(57) **CLAIM**

The ornamental design for an operating panel for elevator, as shown and described.

(56) **References Cited**

U.S. PATENT DOCUMENTS

D363,247 S * 10/1995 Raymond D10/108
D546,724 S * 7/2007 Zemp D10/108
D587,699 S * 3/2009 Corti D14/307
D587,700 S * 3/2009 Corti D14/307
D615,896 S * 5/2010 Rusanen D10/108
D663,642 S * 7/2012 Saikawa D13/174
D673,511 S * 1/2013 Saikawa D13/164
D674,352 S * 1/2013 Saikawa D13/164
D674,353 S * 1/2013 Saikawa D13/164
D678,098 S * 3/2013 Saikawa D13/164
D678,795 S * 3/2013 Saikawa D13/164
D679,210 S * 4/2013 Saikawa D13/164
D679,619 S 4/2013 Saikawa et al.

DESCRIPTION

FIG. 1 is a perspective view of an operating panel for elevator, showing our new design;
FIG. 2 is a front view thereof;
FIG. 3 is a rear view thereof;
FIG. 4 is a left side view thereof;
FIG. 5 is a right side view thereof;
FIG. 6 is a top view thereof;
FIG. 7 is a partially enlarged view taken along line 7-7, 8-8 in FIG. 2;
FIG. 8 is an enlarged cross-sectional view thereof; taken along line 8-8 of FIG. 2, with the internal system omitted; and,
FIG. 9 is a front view of the design shown in use.
The broken line showing of an elevator car in FIG. 9 is included for the purpose of illustrating portions of the “article” and forms no part of the claimed design.

1 Claim, 9 Drawing Sheets

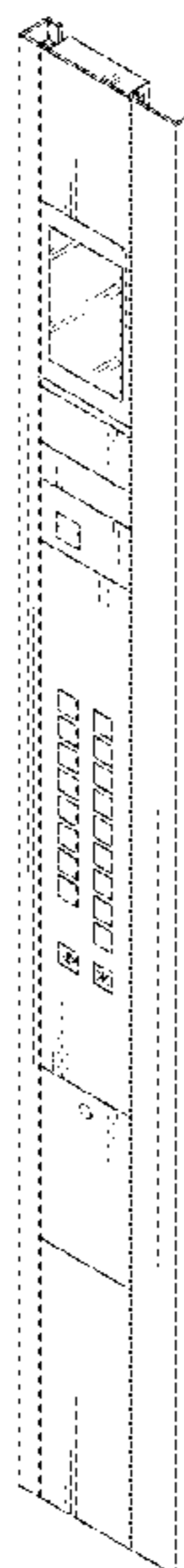

(56)

References Cited

U.S. PATENT DOCUMENTS

D880,327 S	*	4/2020	Costabile	D10/108
D923,667 S	*	6/2021	Mochizuki	D15/89
D941,694 S	*	1/2022	Costabile	D10/108
D949,037 S	*	4/2022	Kollros	D10/108
D949,728 S	*	4/2022	Kollros	D10/108
D949,729 S	*	4/2022	Kollros	D10/108
D957,278 S	*	7/2022	Kollros	D10/108

* cited by examiner

Fig. 1

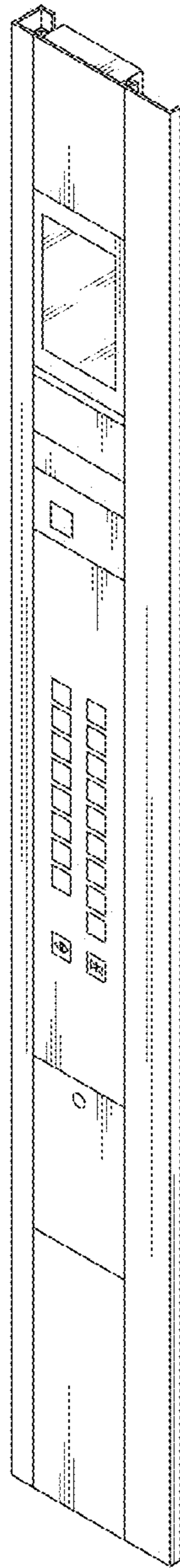

Fig.2

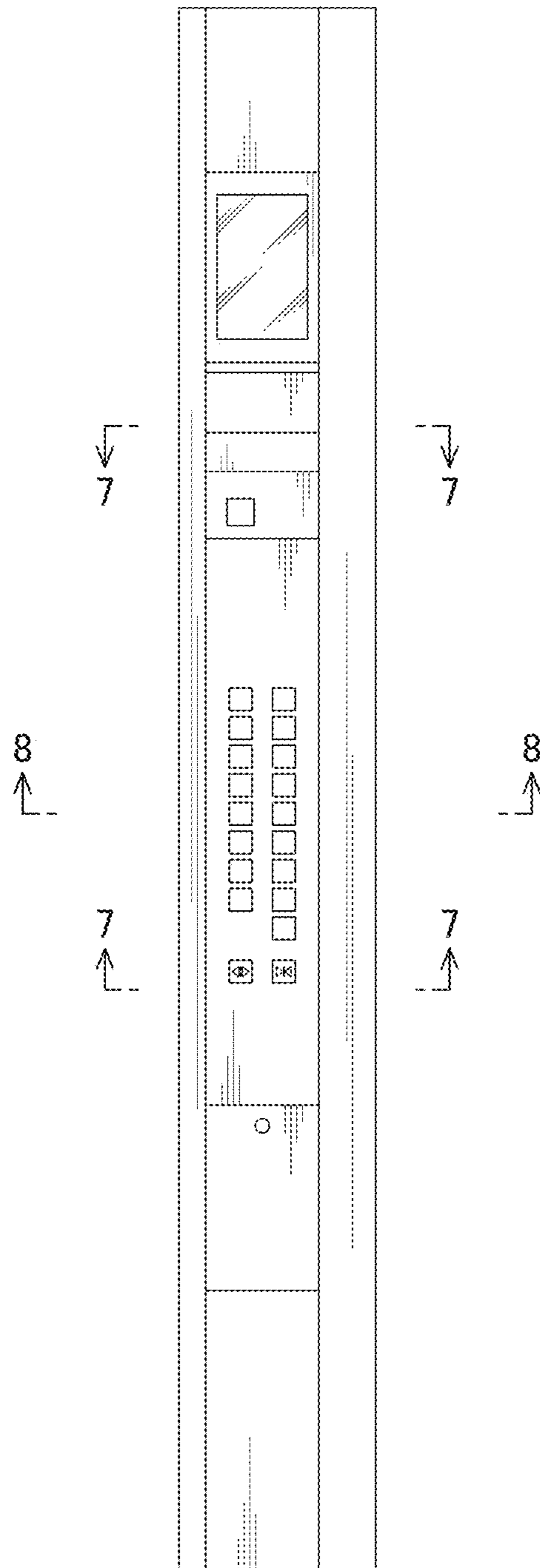

Fig.3

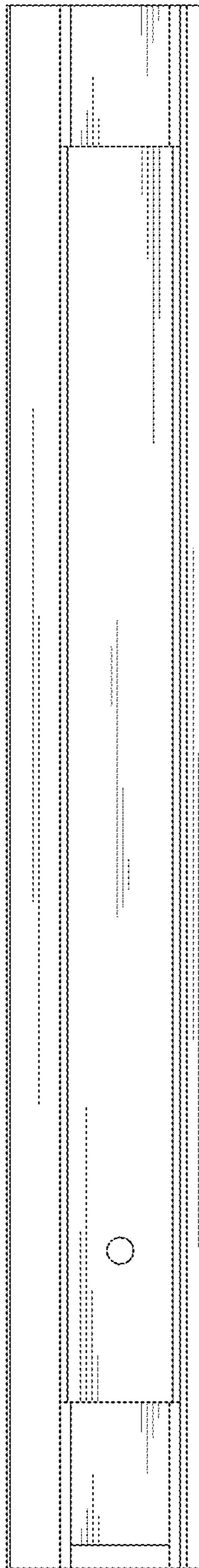

Fig.4



Fig.5

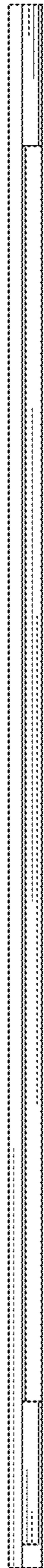

Fig.6

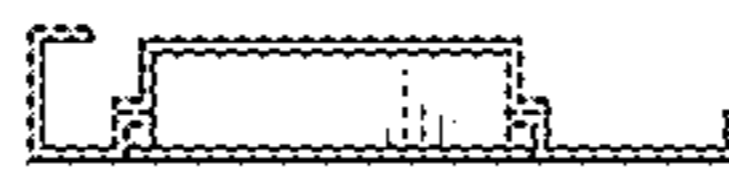

Fig.7

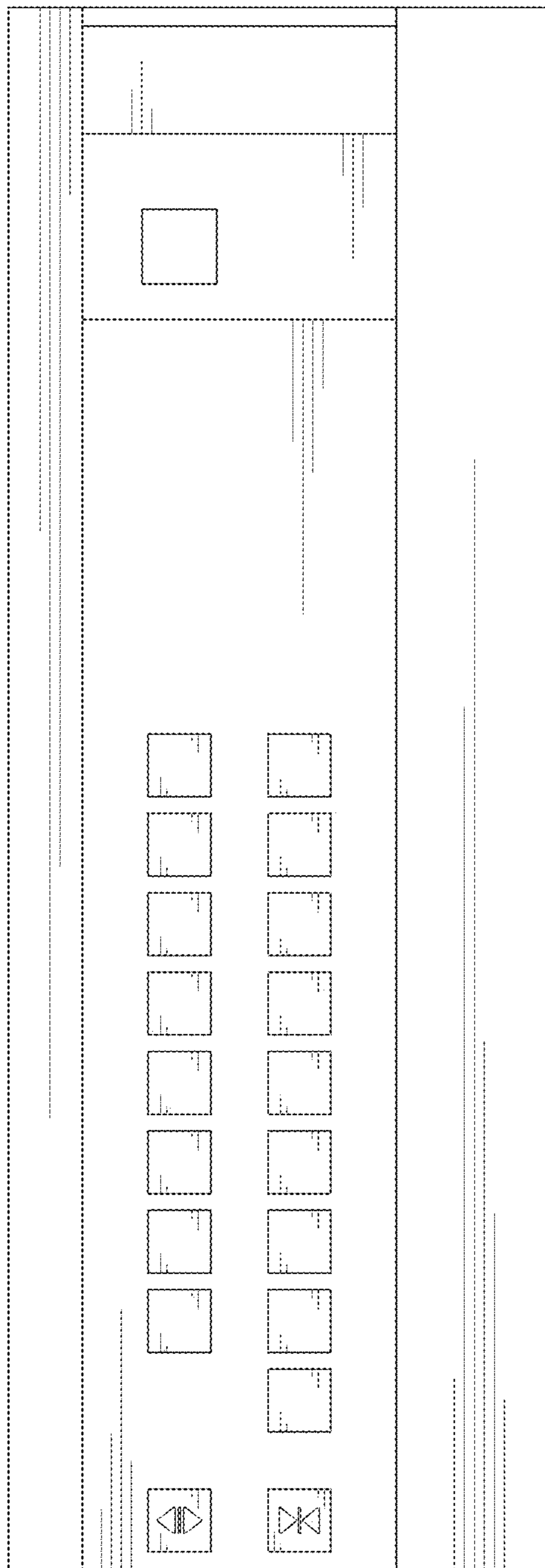

Fig.8

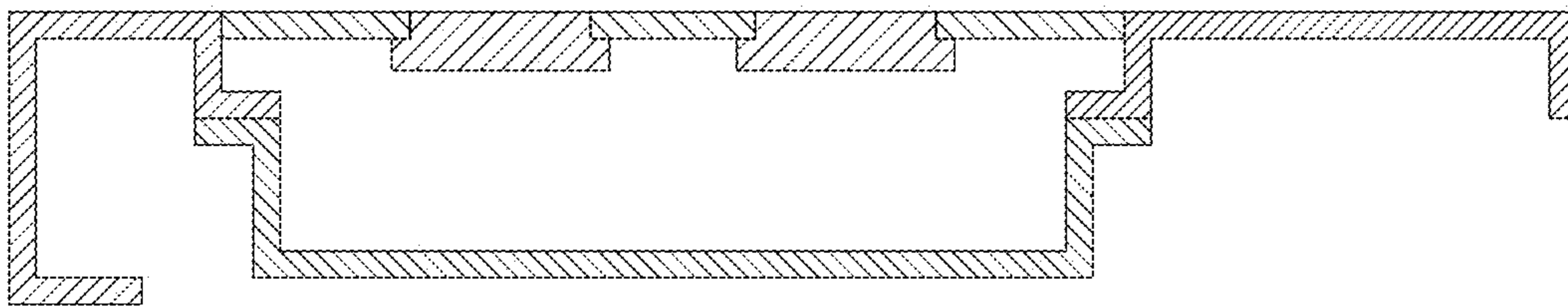

Fig.9

