



US00D970395S

(12) **United States Design Patent**
Macias

(10) **Patent No.:** **US D970,395 S**

(45) **Date of Patent:** **** Nov. 22, 2022**

(54) **BICYCLE**

(71) Applicant: **Israel Macias**, Westminster, CA (US)

(72) Inventor: **Israel Macias**, Westminster, CA (US)

(**) Term: **15 Years**

(21) Appl. No.: **29/757,327**

(22) Filed: **Nov. 5, 2020**

(51) **LOC (13) Cl.** **12-11**

(52) **U.S. Cl.**
USPC **D12/111**

(58) **Field of Classification Search**
USPC D12/111, 117; D21/412, 414, 419,
D21/423-428, 431-435
CPC B62K 3/00; B62K 3/02; B62K 3/06
See application file for complete search history.

(56) **References Cited**

U.S. PATENT DOCUMENTS

D230,144 S *	1/1974	Voytko	D12/111
3,921,745 A	11/1975	McCulloch		
D434,349 S	11/2000	Currie		
6,260,649 B1	7/2001	Carney, Jr.		
6,267,401 B1 *	7/2001	De Jong	B62K 15/008 280/287
D487,234 S *	3/2004	Chen	D12/111
6,717,280 B1	4/2004	Bienvile		
6,987,327 B1	1/2006	Lucatero		
7,055,842 B1 *	6/2006	Lin	B62K 15/008 292/164
7,156,409 B2 *	1/2007	Chuang	B62K 15/006 280/281.1
D814,361 S *	4/2018	Shi	D12/111
D833,916 S *	11/2018	Yu	D12/111
D900,680 S *	11/2020	Chen	D12/111
D904,234 S *	12/2020	von Schöning	D12/111
D914,548 S *	3/2021	Chen	D12/111
D914,549 S *	3/2021	Chen	D12/111
D925,404 S *	7/2021	Lin	D12/111

D925,405 S *	7/2021	Lin	D12/111
D928,668 S *	8/2021	Li	D12/111
D929,269 S *	8/2021	Chen	D12/111
D933,538 S *	10/2021	Chen	D12/111
D934,120 S *	10/2021	Zhu	D12/111
D934,125 S *	10/2021	Avery	D12/111
D934,126 S *	10/2021	Avery	D12/111
D934,740 S *	11/2021	Avery	D12/111
D941,190 S *	1/2022	Micacchi	D12/111
D948,384 S *	4/2022	Cai	D12/111
2002/0147079 A1	10/2002	Kalnbach		
2019/0077476 A1 *	3/2019	Lloyd	B62K 19/18
2022/0009587 A1 *	1/2022	Macias	B62H 1/04

FOREIGN PATENT DOCUMENTS

WO WO2010066511 6/2010

* cited by examiner

Primary Examiner — Darlington Ly

(57) **CLAIM**

The ornamental design for a bicycle, as shown and described.

DESCRIPTION

FIG. 1 is a front elevation view of a bicycle embodying my new design;
 FIG. 2 is a rear elevation view thereof;
 FIG. 3 is a left side elevation view thereof;
 FIG. 4 is a right side elevation view thereof;
 FIG. 5 is a top plan view thereof;
 FIG. 6 is a bottom plan view thereof;
 FIG. 7 is a top, rear, and right side perspective view thereof;
 and,
 FIG. 8 is a left side elevation view thereof, with the stand feature in an alternate position of use.
 The broken lines in FIG. 8 are illustrative of portions of the bicycle forming no part of the claimed design.

1 Claim, 8 Drawing Sheets

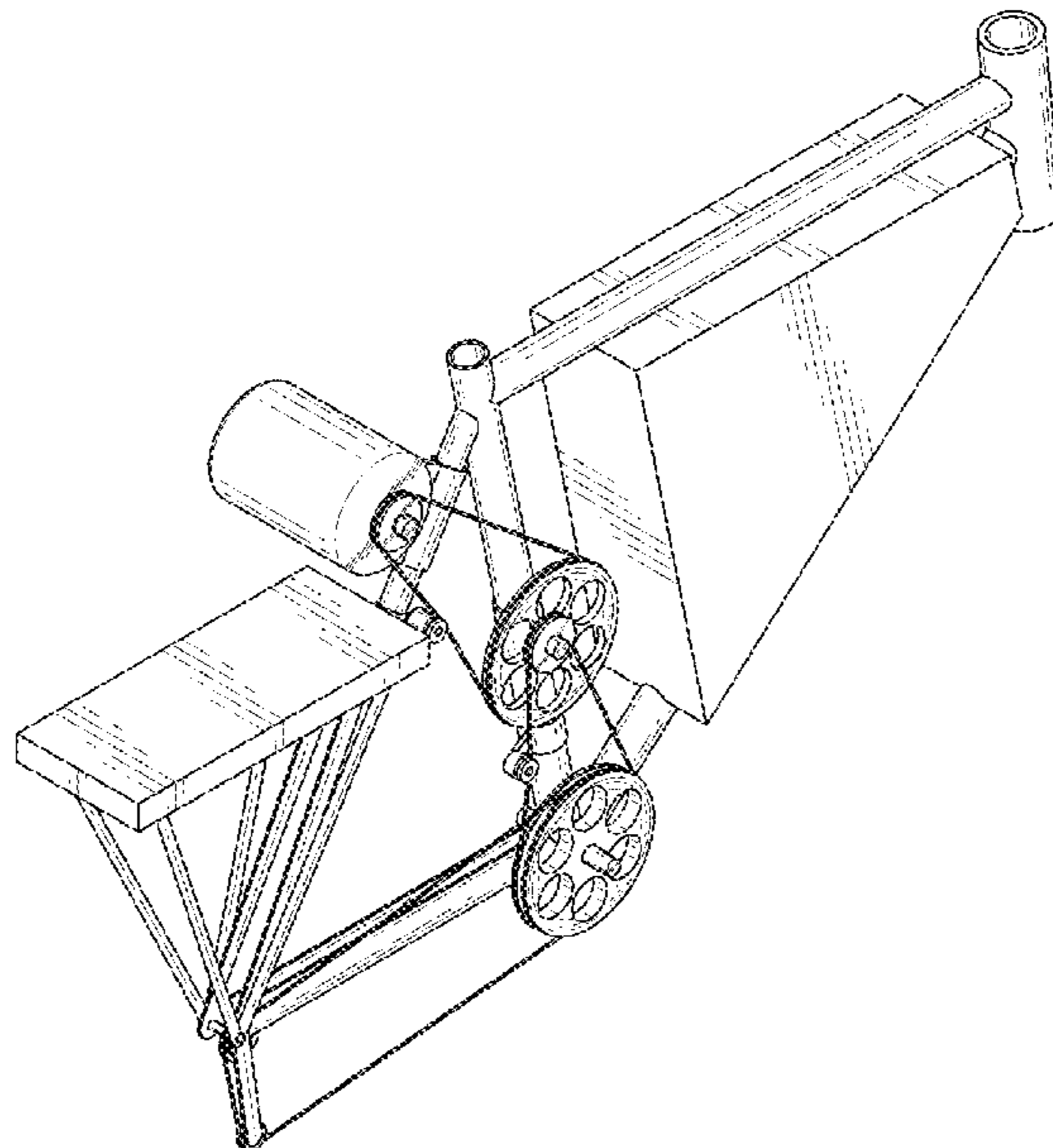

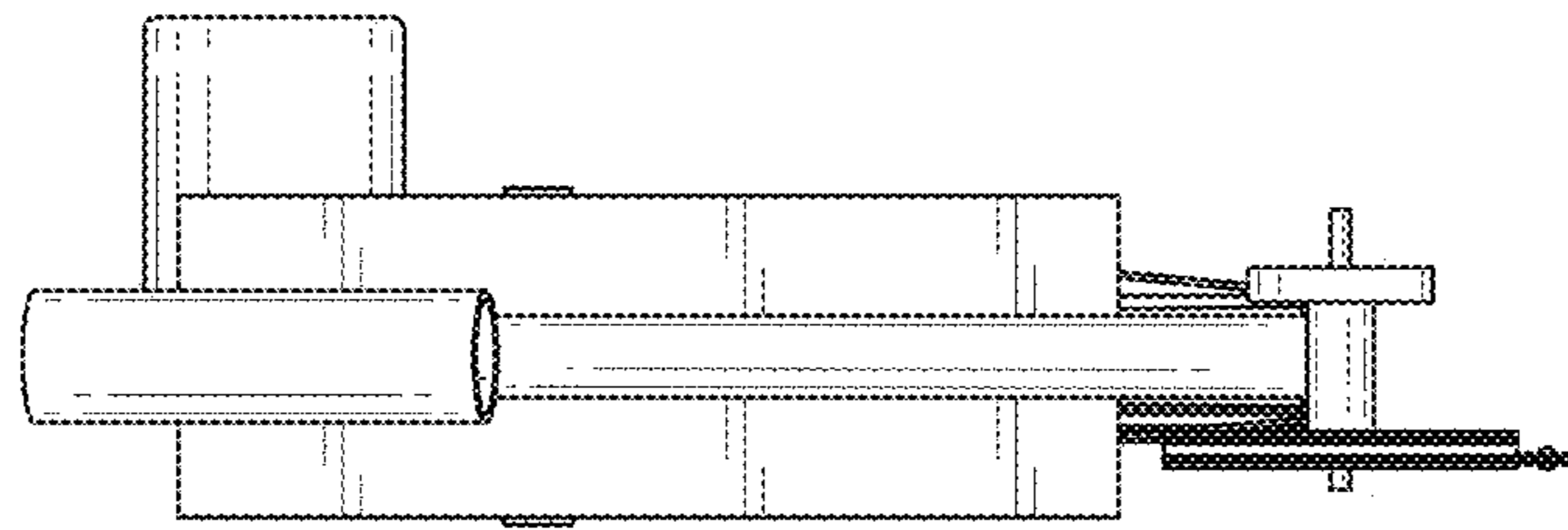

FIG. 1

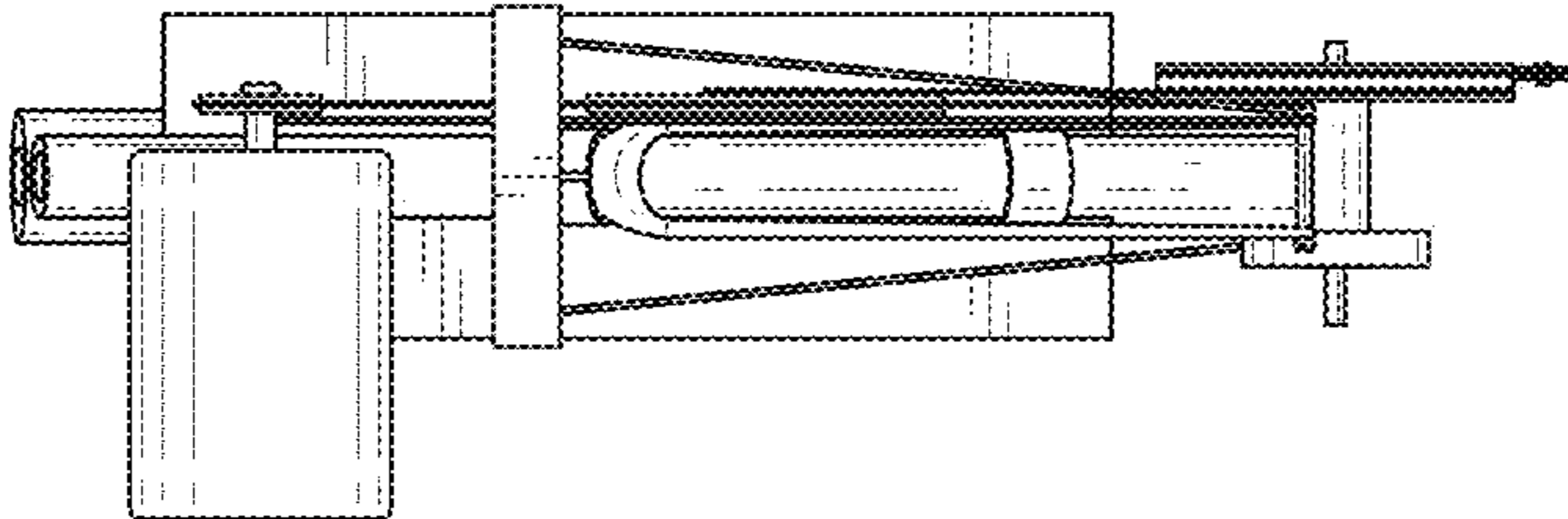

FIG. 2

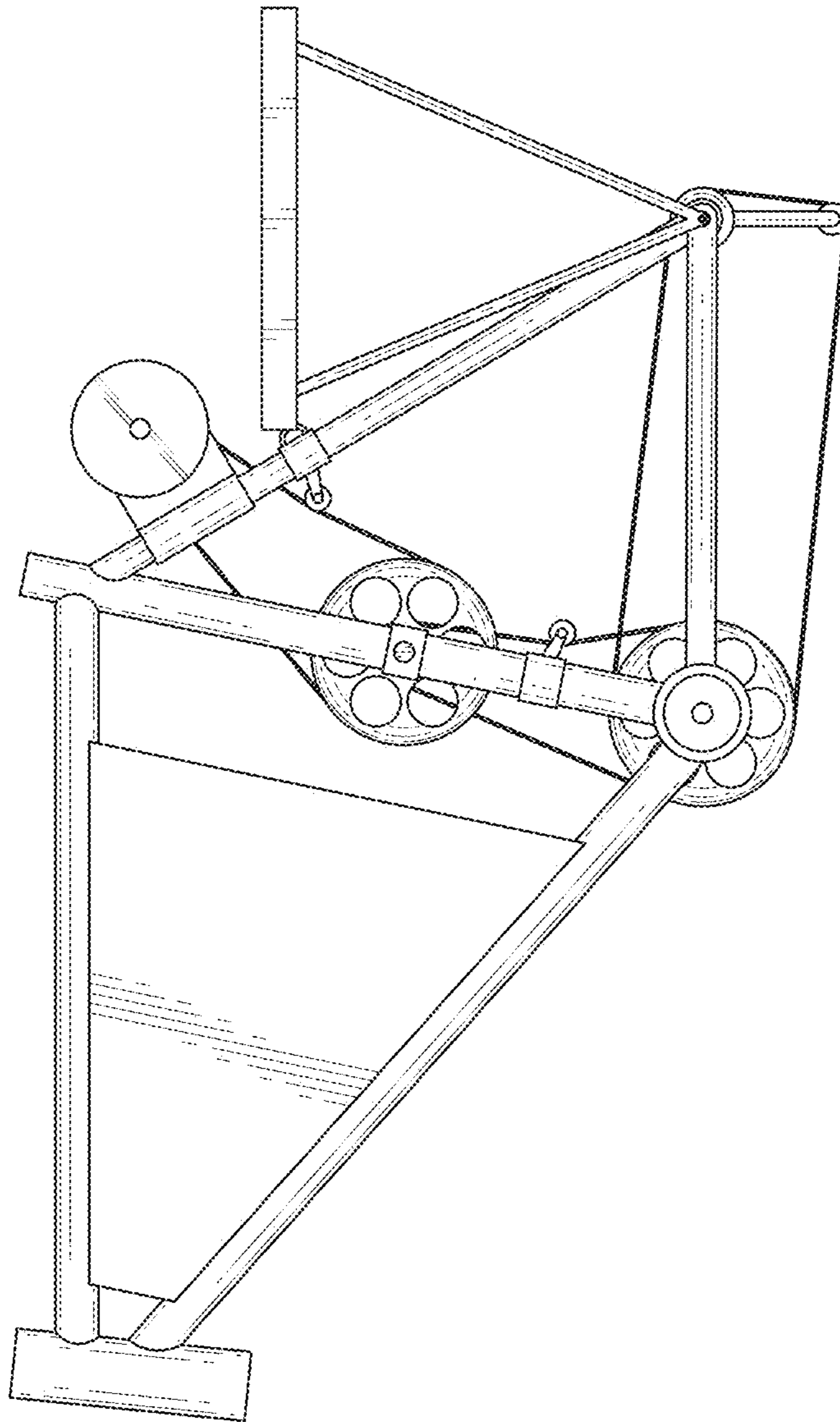

FIG. 3

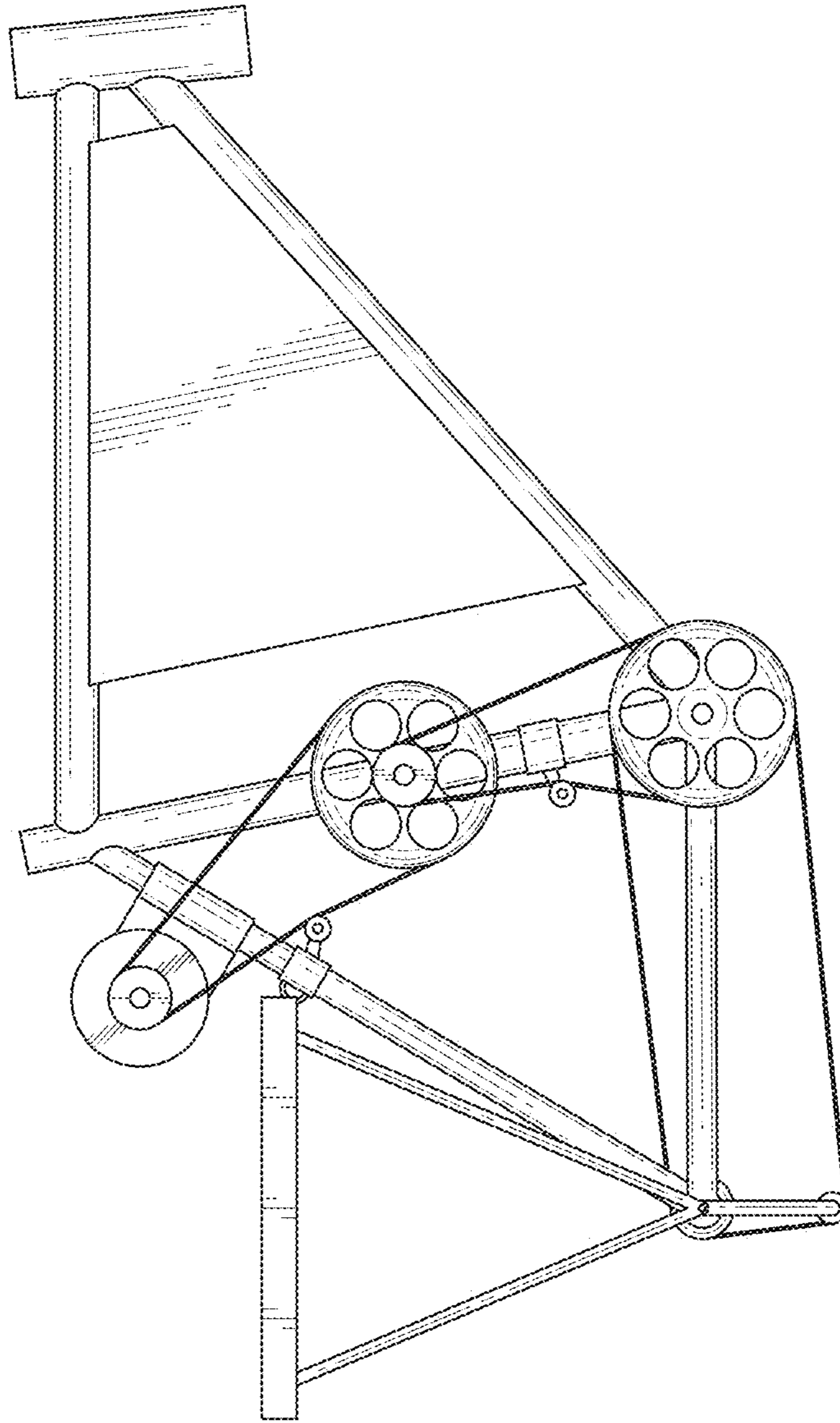

FIG. 4

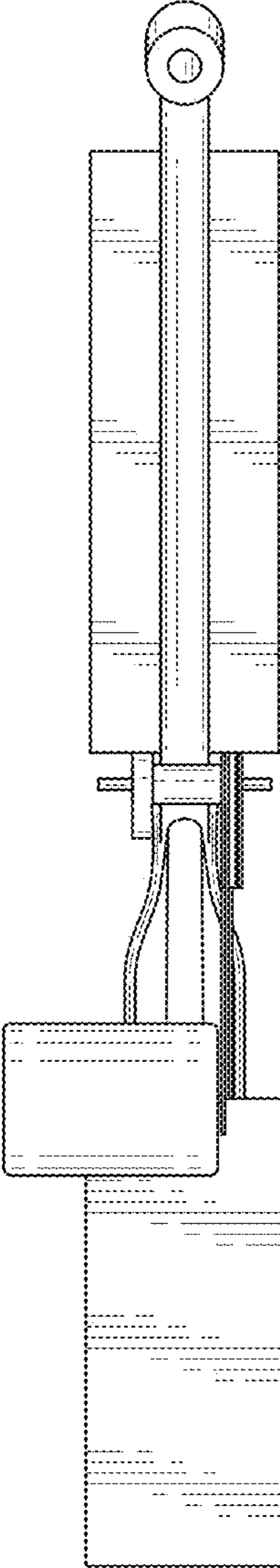

FIG. 5

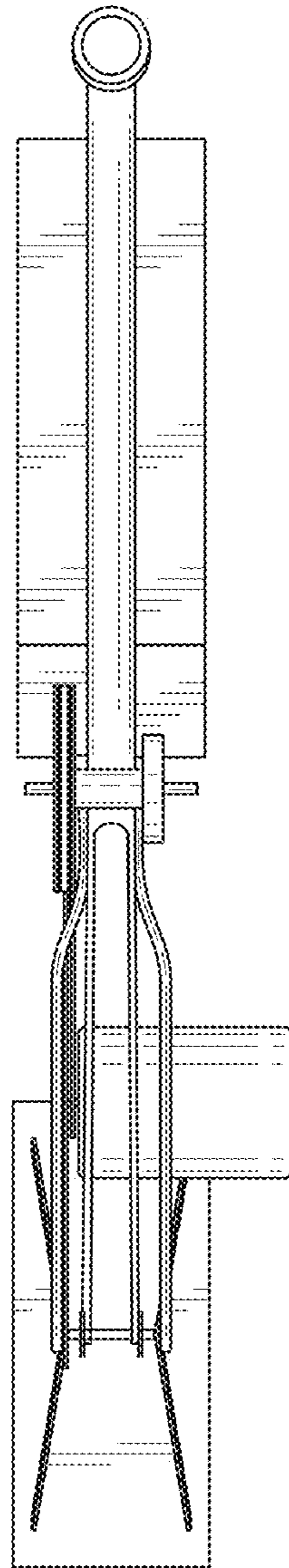

FIG. 6

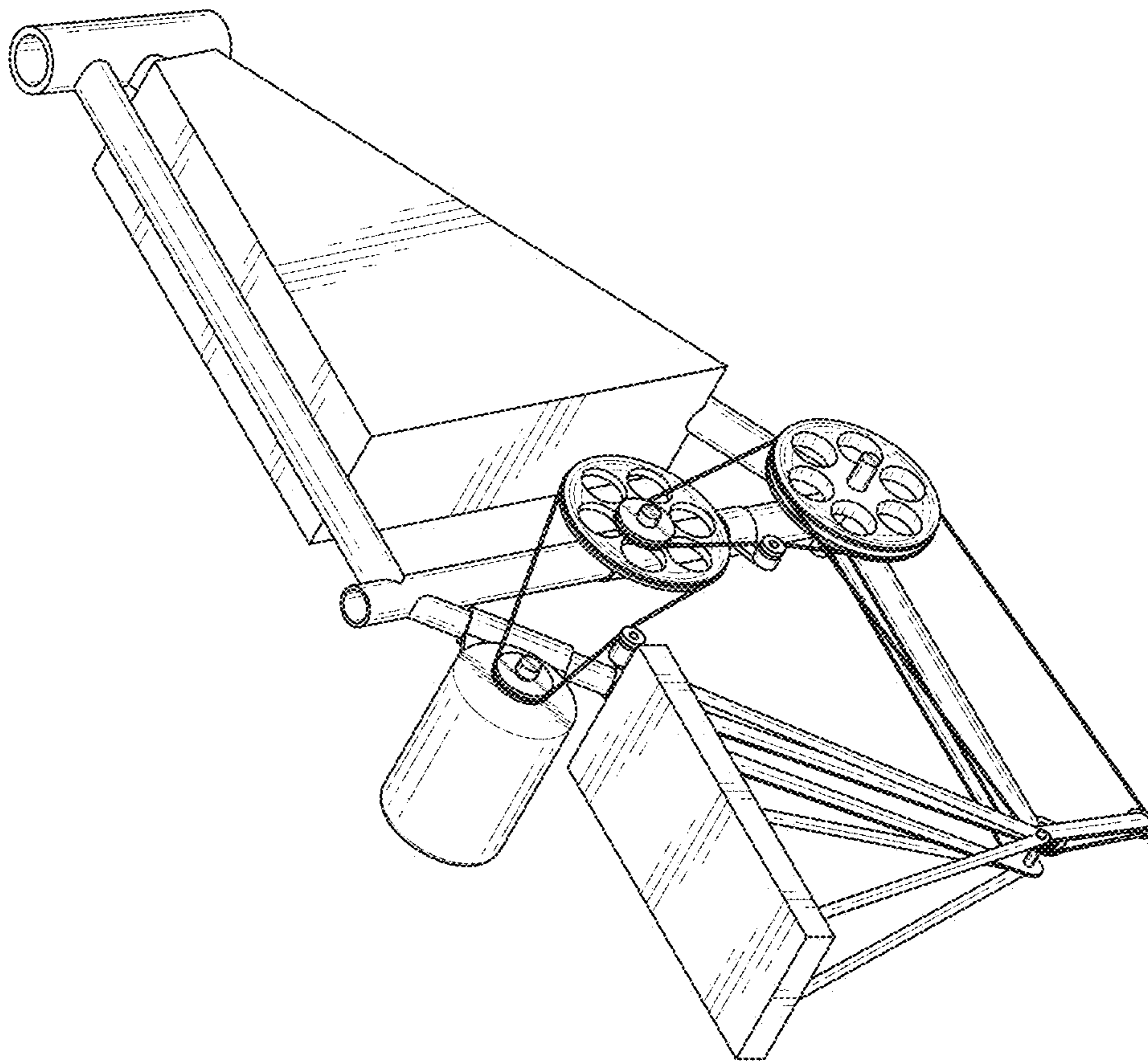

FIG. 7

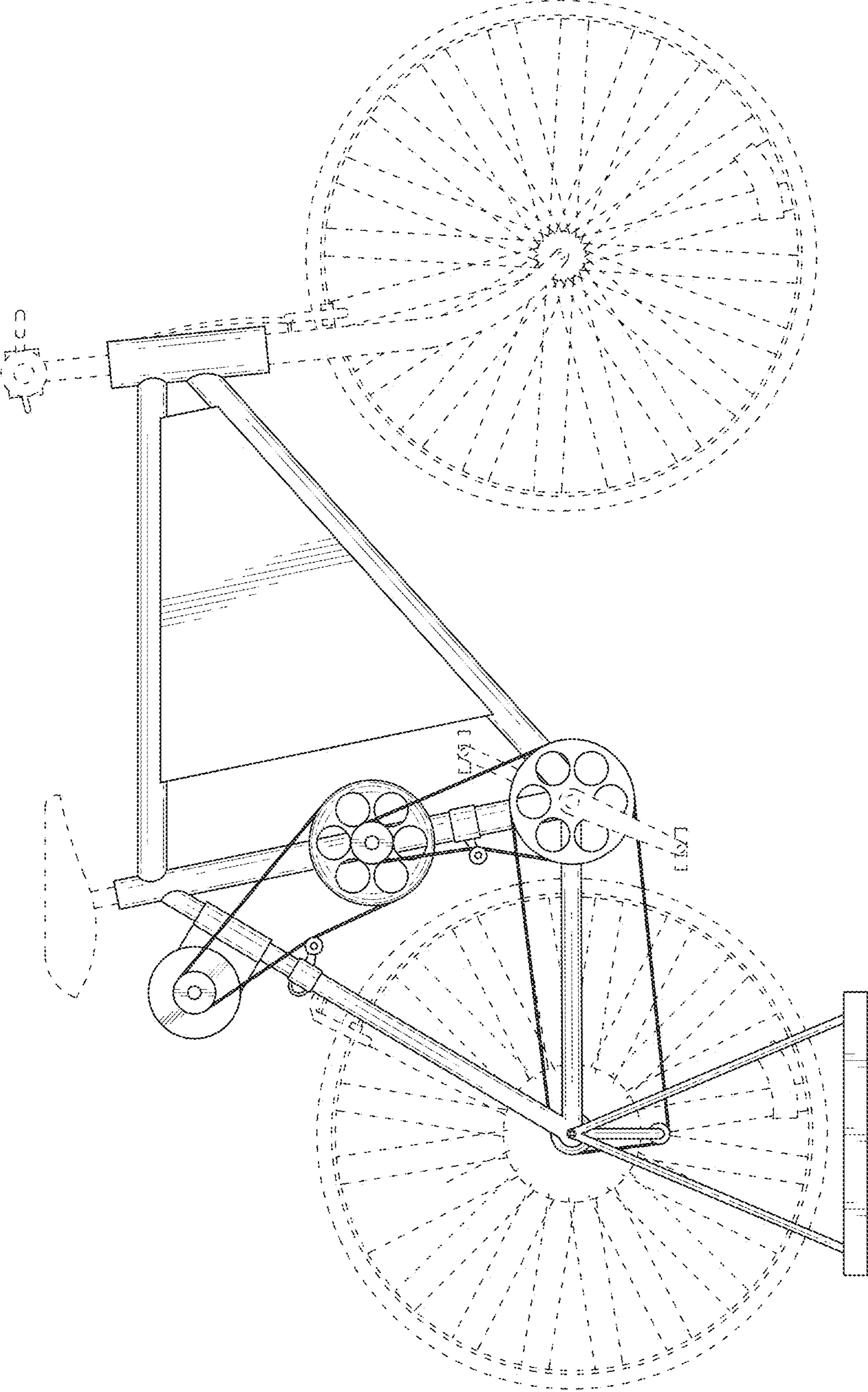

FIG. 8