



US00D968281S

(12) **United States Design Patent** (10) **Patent No.:** **US D968,281 S**
Hagler et al. (45) **Date of Patent:** **** Nov. 1, 2022**

(54) **WHEELIE BAR**
(71) Applicant: **TRAXXAS, L.P.**, McKinney, TX (US)
(72) Inventors: **Skylar Hagler**, Anna, TX (US); **Jory Sprowl**, Honey Grove, TX (US)

5,368,323 A 11/1994 Young
5,431,444 A 7/1995 Kenealy
D366,636 S 1/1996 Smith
D394,003 S 5/1998 Tate
D394,033 S 5/1998 Pingel et al.
5,809,755 A 9/1998 Velke et al.

(Continued)

(73) Assignee: **TRAXXAS, L.P.**, McKinney, TX (US)

FOREIGN PATENT DOCUMENTS

(**) Term: **15 Years**

TW D3135320 S 6/2010
TW D3139245 S 3/2011

(21) Appl. No.: **29/774,012**

OTHER PUBLICATIONS

(22) Filed: **Mar. 12, 2021**

Taiwan IPO Search Report; completed Oct. 16, 2017; in Taiwanese Design Patent Application No. 106302003.

(51) **LOC (13) Cl.** **12-16**

(52) **U.S. Cl.**
USPC **D12/171**

(Continued)

(58) **Field of Classification Search**
USPC D12/163-172, 86-92
CPC B60R 2019/527; B60R 2019/1886; B60R 19/18; B60R 19/24; B60R 19/56; B62H 1/12; B62K 3/16; B62K 5/01; B62K 5/06
See application file for complete search history.

Primary Examiner — Susan E Krakower
Assistant Examiner — Jerry Shiu-an-Hua Hsu
(74) *Attorney, Agent, or Firm* — Daryl R. Wright; Greg Carr

(56) **References Cited**

(57) **CLAIM**

U.S. PATENT DOCUMENTS

We claim the ornamental design for a wheelie bar, as shown and described.

3,997,185 A 12/1976 Parrilla
4,007,949 A 2/1977 Norcia et al.
4,012,054 A * 3/1977 Moore B62H 1/12
280/239
4,108,267 A 8/1978 Valerio
4,154,452 A 5/1979 Newman
4,522,420 A * 6/1985 Hannappel B62K 5/06
180/196
4,772,037 A * 9/1988 Jones B62K 5/01
280/755
4,773,889 A 9/1988 Rosenwinkel et al.
4,988,120 A 1/1991 Jones
5,186,269 A 2/1993 Avakian et al.
5,242,183 A * 9/1993 Oberg B62H 1/12
280/288.4
5,330,221 A 7/1994 Sutton
5,354,092 A 10/1994 Calvert

DESCRIPTION

FIG. 1 is an upper, right, front perspective view of a wheelie bar showing our new design;
FIG. 2 is a front elevation view thereof;
FIG. 3 is a rear elevation view thereof;
FIG. 4 is a left side elevation view thereof;
FIG. 5 is a right side elevation view thereof;
FIG. 6 is an upper plan view thereof;
FIG. 7 is a lower plan view thereof; and,
FIG. 8 is a lower, left, rear perspective view thereof.
In the drawings, the broken lines illustrate portions of the wheelie bar that form no part of the claimed design.

1 Claim, 5 Drawing Sheets

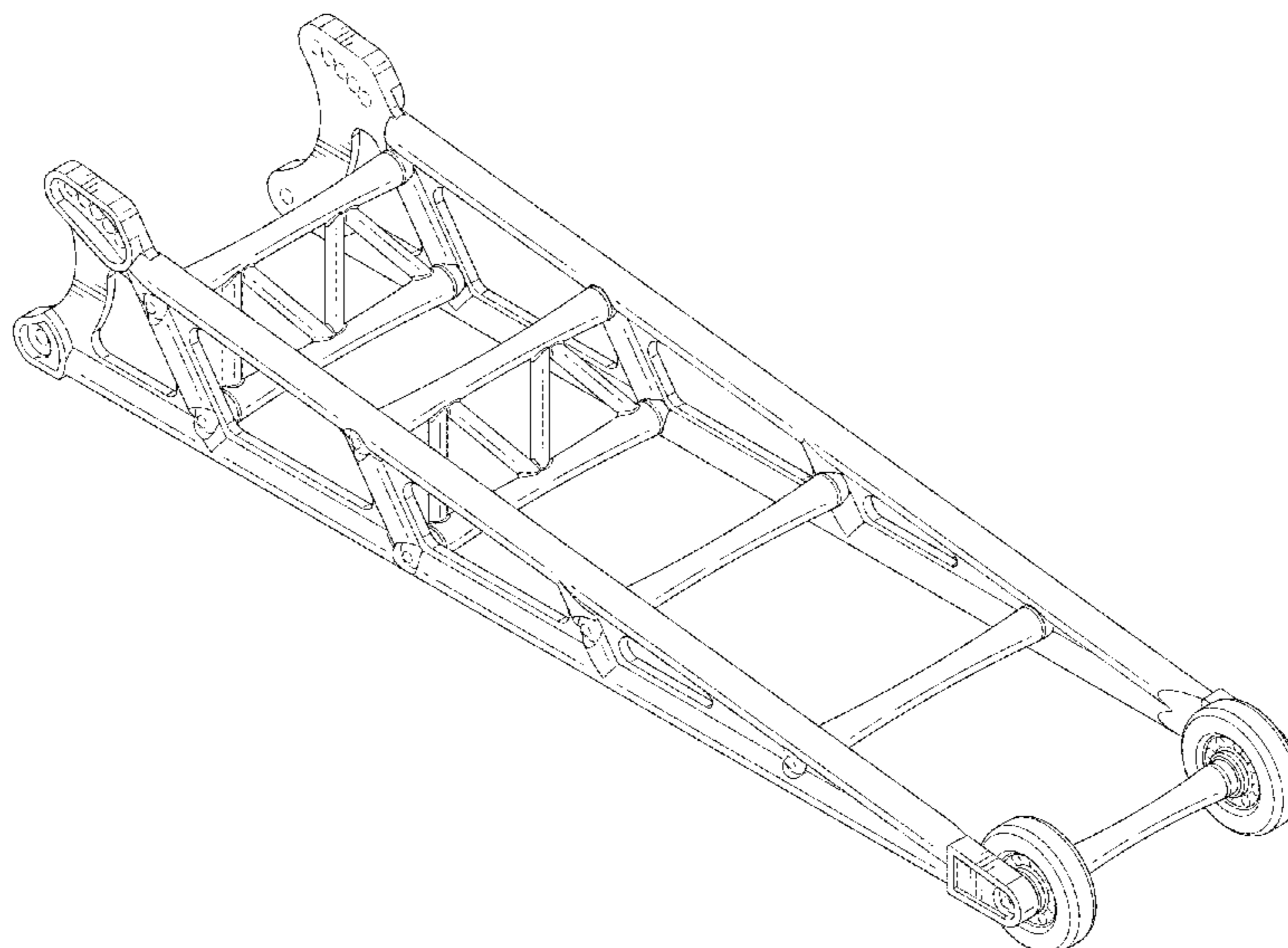

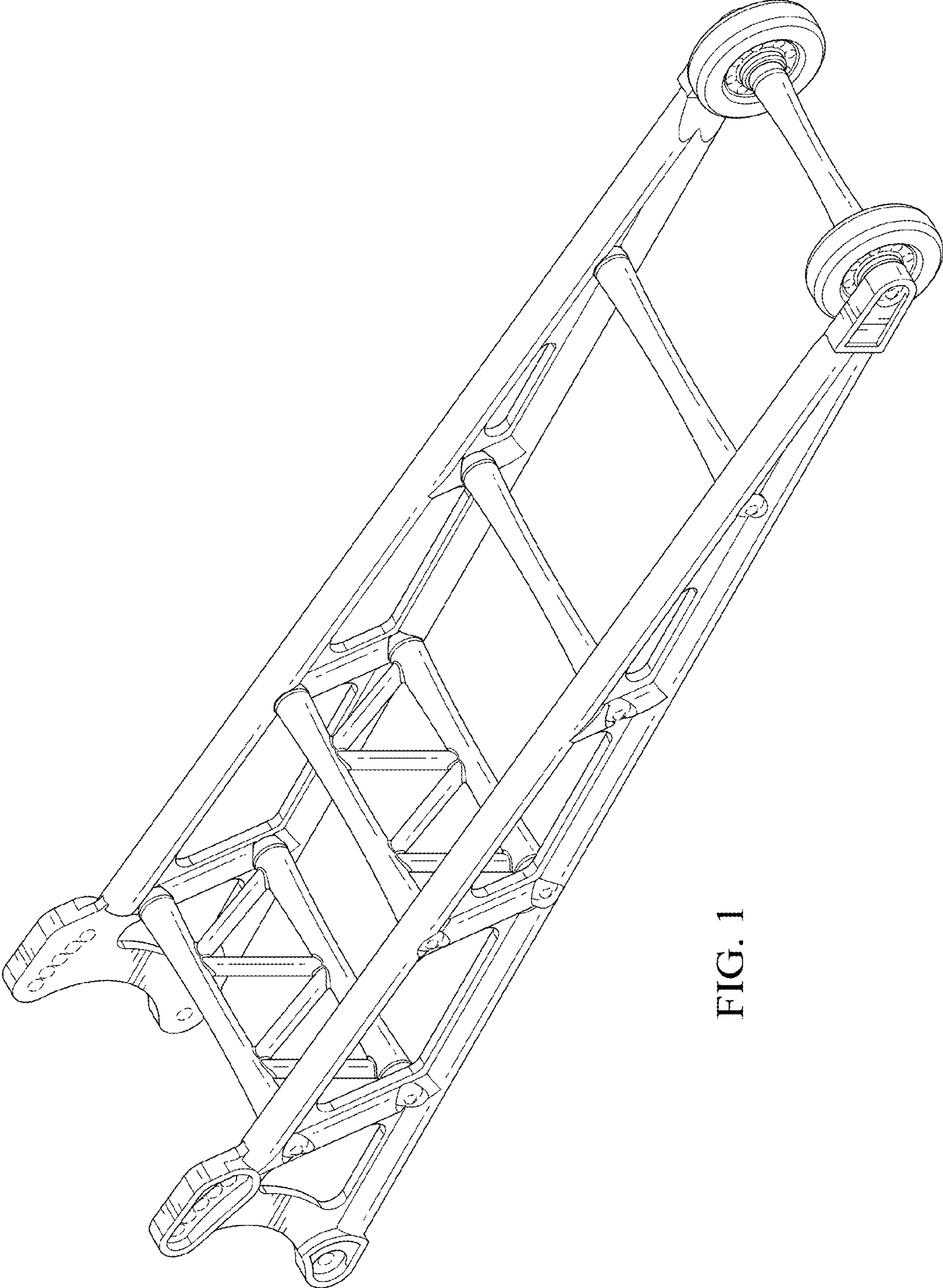

FIG. 1

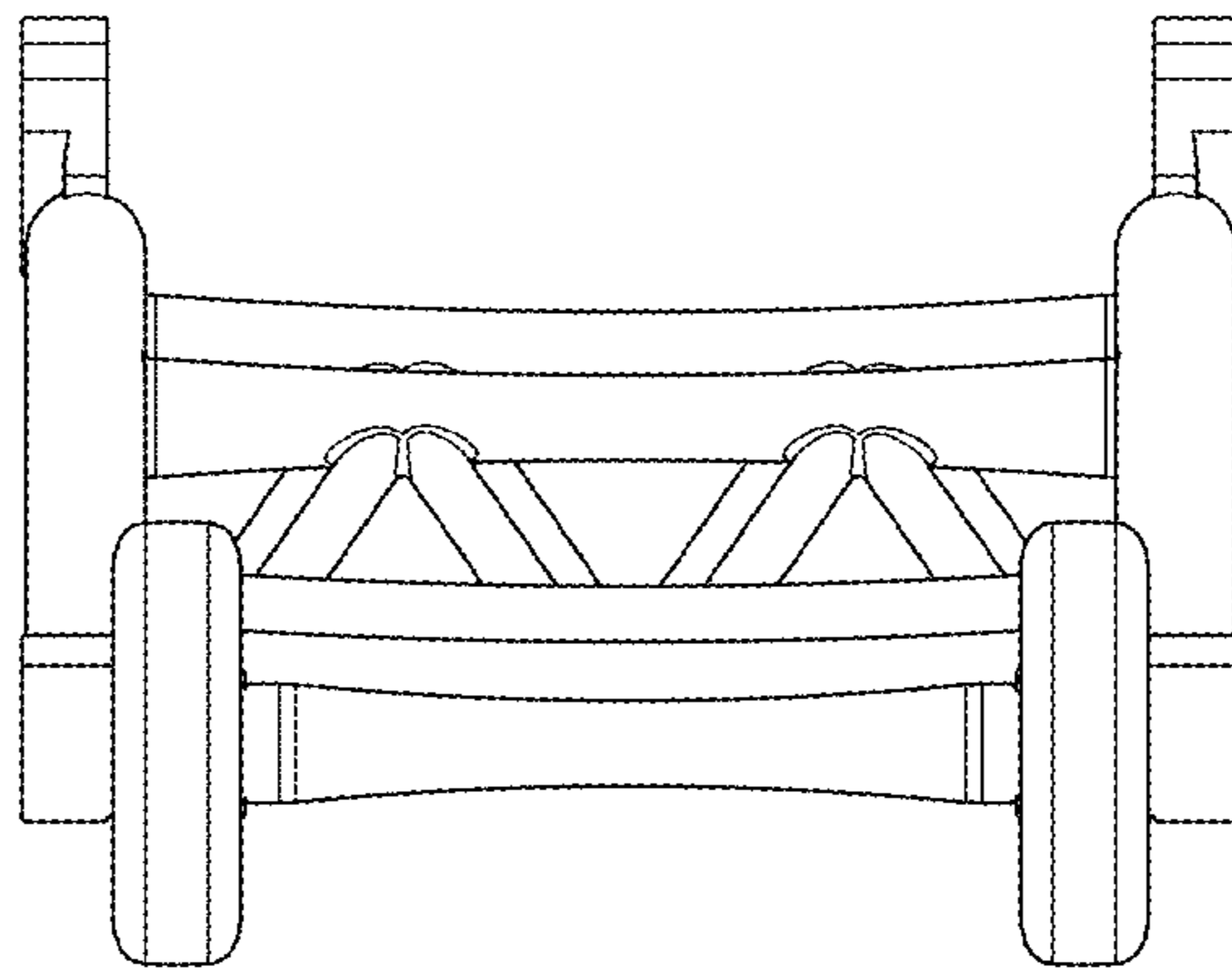

FIG. 2

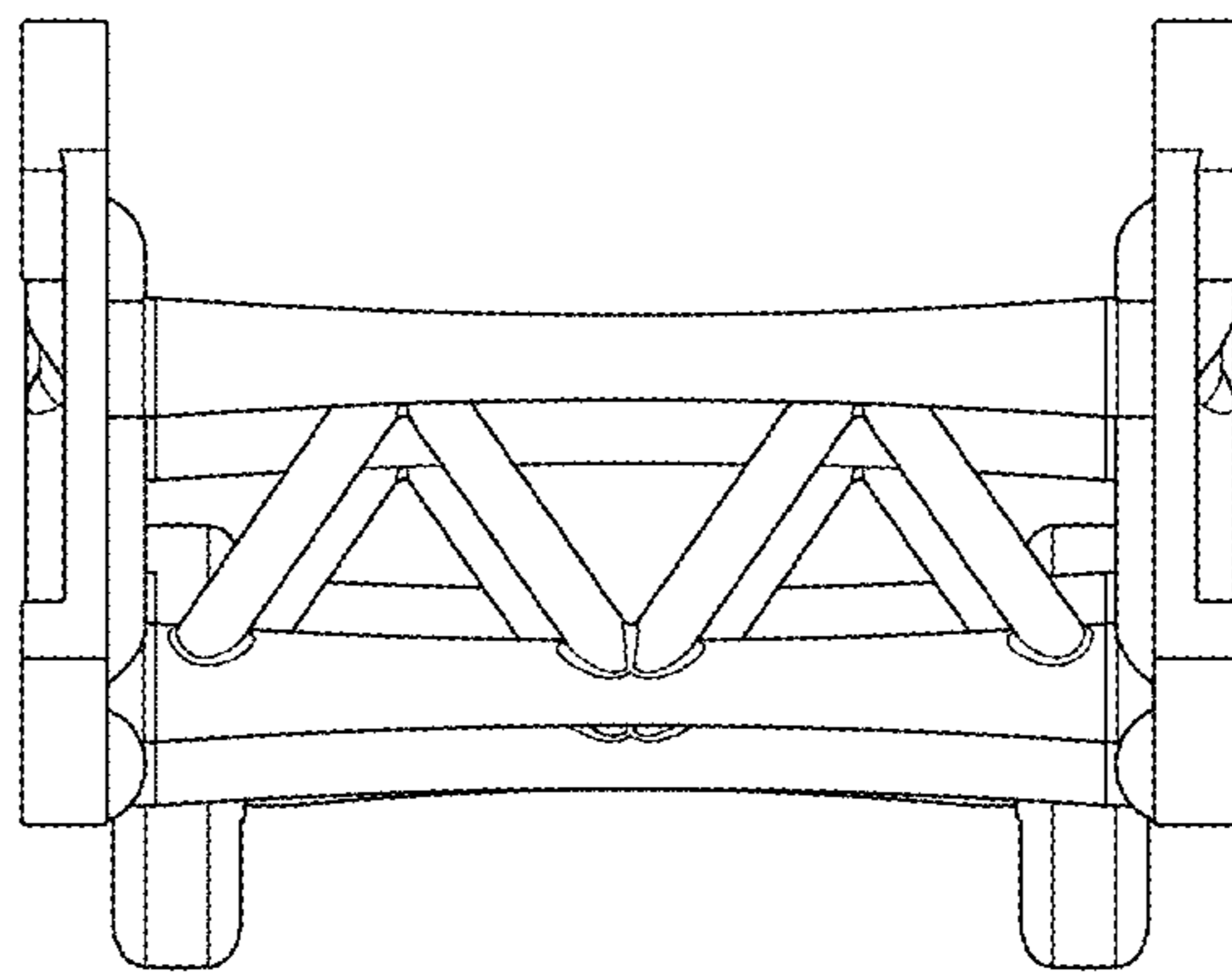

FIG. 3

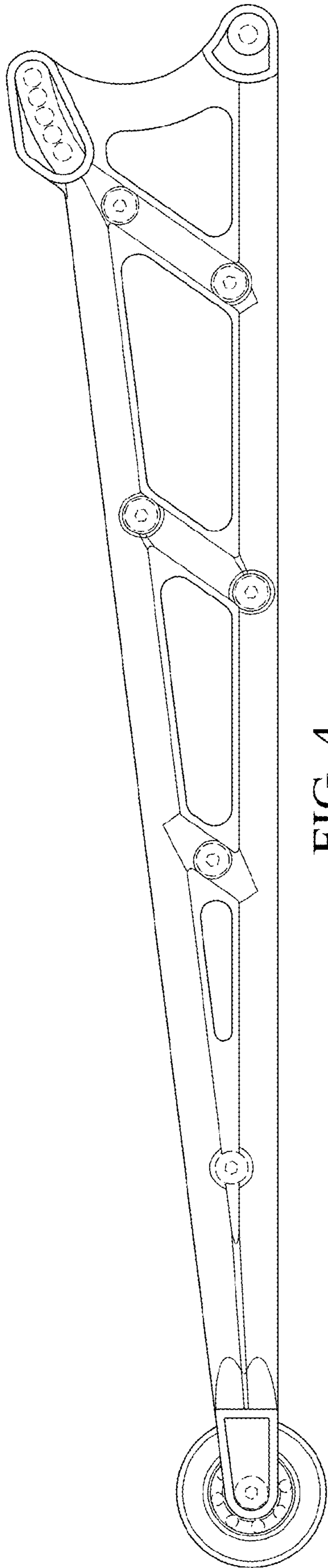

FIG. 4

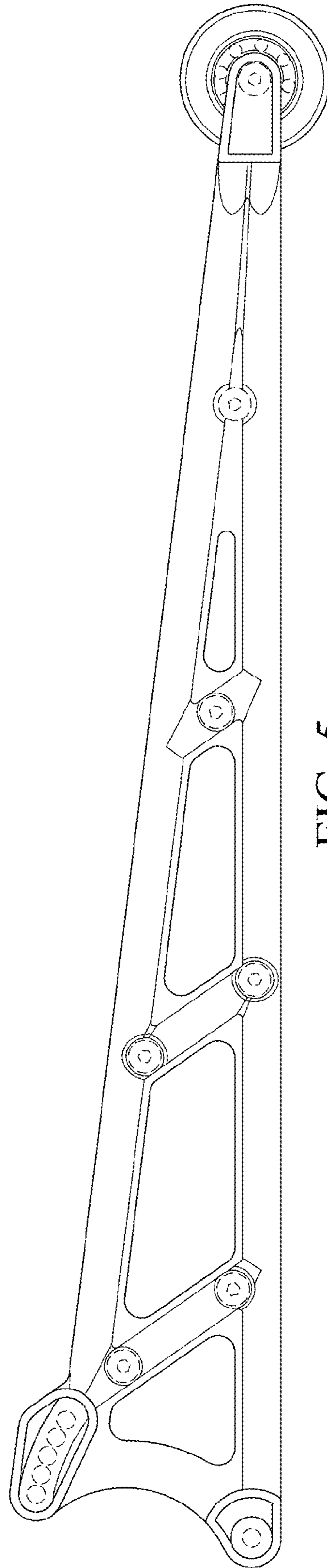

FIG. 5

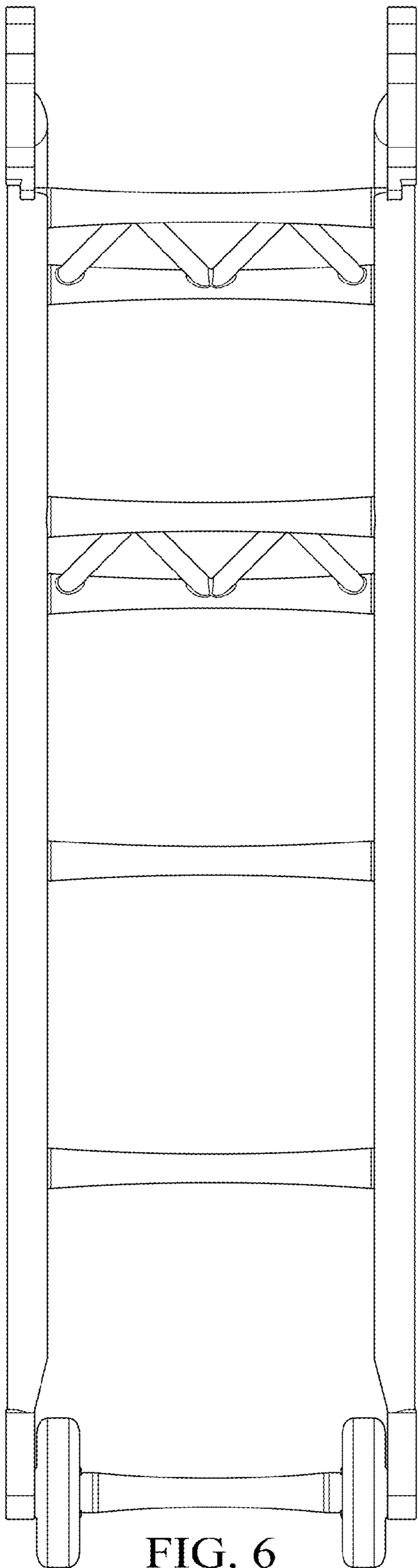

FIG. 6

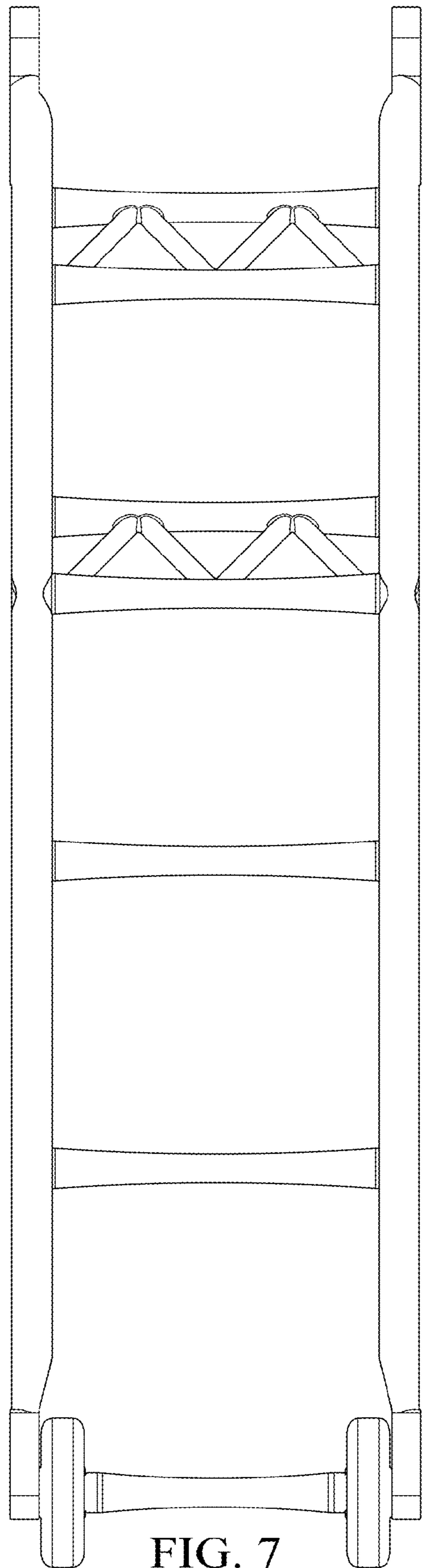

FIG. 7

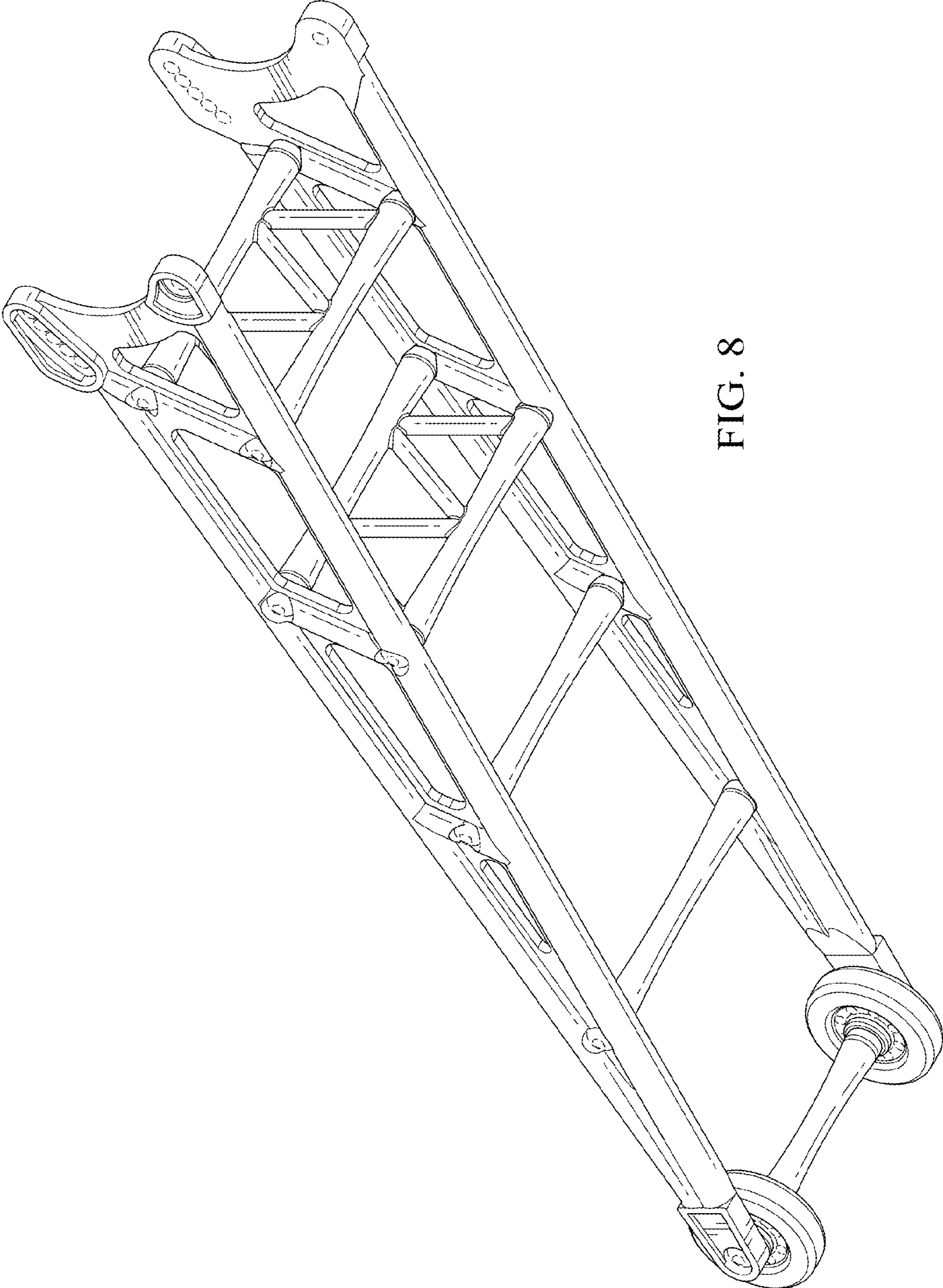

FIG. 8