



US00D967674S

(12) **United States Design Patent** (10) **Patent No.:** **US D967,674 S**
Guo (45) **Date of Patent:** **** Oct. 25, 2022**

(54) **BOTTLE SLEEVE**
(71) Applicant: **Weiwei Guo**, Yangxin (CN)
(72) Inventor: **Weiwei Guo**, Yangxin (CN)
(**) Term: **15 Years**
(21) Appl. No.: **29/790,937**
(22) Filed: **Dec. 22, 2021**
(51) **LOC (13) Cl.** **07-06**
(52) **U.S. Cl.**
USPC **D7/625**
(58) **Field of Classification Search**
USPC D7/387, 514, 515, 601-608, 619.1-620,
D7/622-625; D3/202, 229, 270, 271.1,
D3/271.3, 271.4
CPC A47G 23/02; A47G 23/0208; A47G
23/0216; A47G 23/0225; A47G 23/0233;
A47G 23/0241; A47G 23/0266; A47G
23/0275; A47G 23/0283; A47G 23/0291;
A45C 2200/20; A45F 3/16; A45F 5/00;
A45F 5/02
See application file for complete search history.

D849,483 S * 5/2019 Watson D7/515
D885,148 S 5/2020 Wang et al.
D946,353 S * 3/2022 Hazen D7/606
D957,888 S * 7/2022 Musumeci D7/622
D957,890 S * 7/2022 Hazen D7/625

OTHER PUBLICATIONS

Puffin Beverage Jacket, first available May 13, 2020, Amazon, [online], [site visited Aug. 16, 2022], Available from internet URL: <https://www.amazon.com/dp/B088KS6XW1> (Year: 2020).*
Beverage Jacket Can Cover, first available Dec. 29, 2021, Amazon, [online], [site visited Aug. 16, 2022], Available from internet URL: <https://www.amazon.com/Beverage-Jacket-Insulated-Coolers-Family/dp/B09V55Z3BF> (Year: 2021).*

* cited by examiner

Primary Examiner — Lilyana Bekic
Assistant Examiner — Natalya M Rapundalo
(74) *Attorney, Agent, or Firm* — Zhihua Han

(57) **CLAIM**

The ornamental design for a bottle sleeve, as shown and described.

DESCRIPTION

FIG. 1 is a front, top perspective view of a bottle sleeve showing my new design;
FIG. 2 is a rear, bottom perspective view thereof;
FIG. 3 is a front view thereof;
FIG. 4 is a back view thereof;
FIG. 5 is a left side view thereof;
FIG. 6 is a right side view thereof;
FIG. 7 is a top view thereof; and,
FIG. 8 is a bottom view thereof.
The broken lines shown in the drawings and the masked areas within the broken lines depict portions of the bottle sleeve that form no part of the claimed design.

1 Claim, 8 Drawing Sheets

(56) **References Cited**
U.S. PATENT DOCUMENTS
D335,614 S * 5/1993 Diab D21/805
D368,000 S * 3/1996 Mazza D7/625
D481,267 S * 10/2003 Yamane D7/625
D482,243 S * 11/2003 Yamane D7/625
D489,229 S * 5/2004 Yamane D7/625
D494,423 S * 8/2004 Wright D7/625
D499,309 S * 12/2004 Hicks D2/717
D604,995 S * 12/2009 Cepero D7/625
D696,858 S * 1/2014 Kowalsky D3/229
D781,113 S 3/2017 Kocsis
D785,807 S 5/2017 Saadia
D787,225 S * 5/2017 Bollmus D7/606

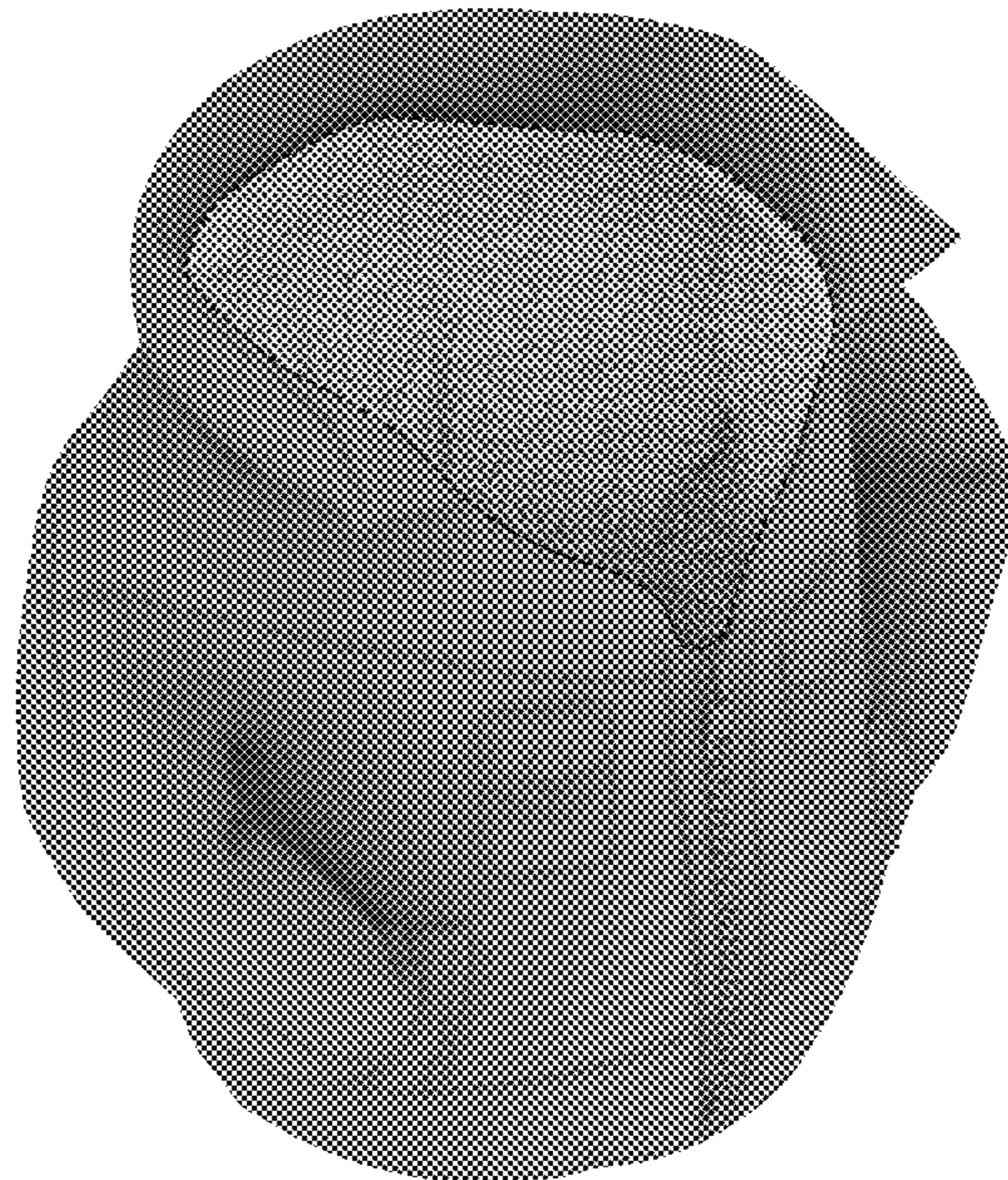



FIG. 1



FIG. 2



FIG. 3

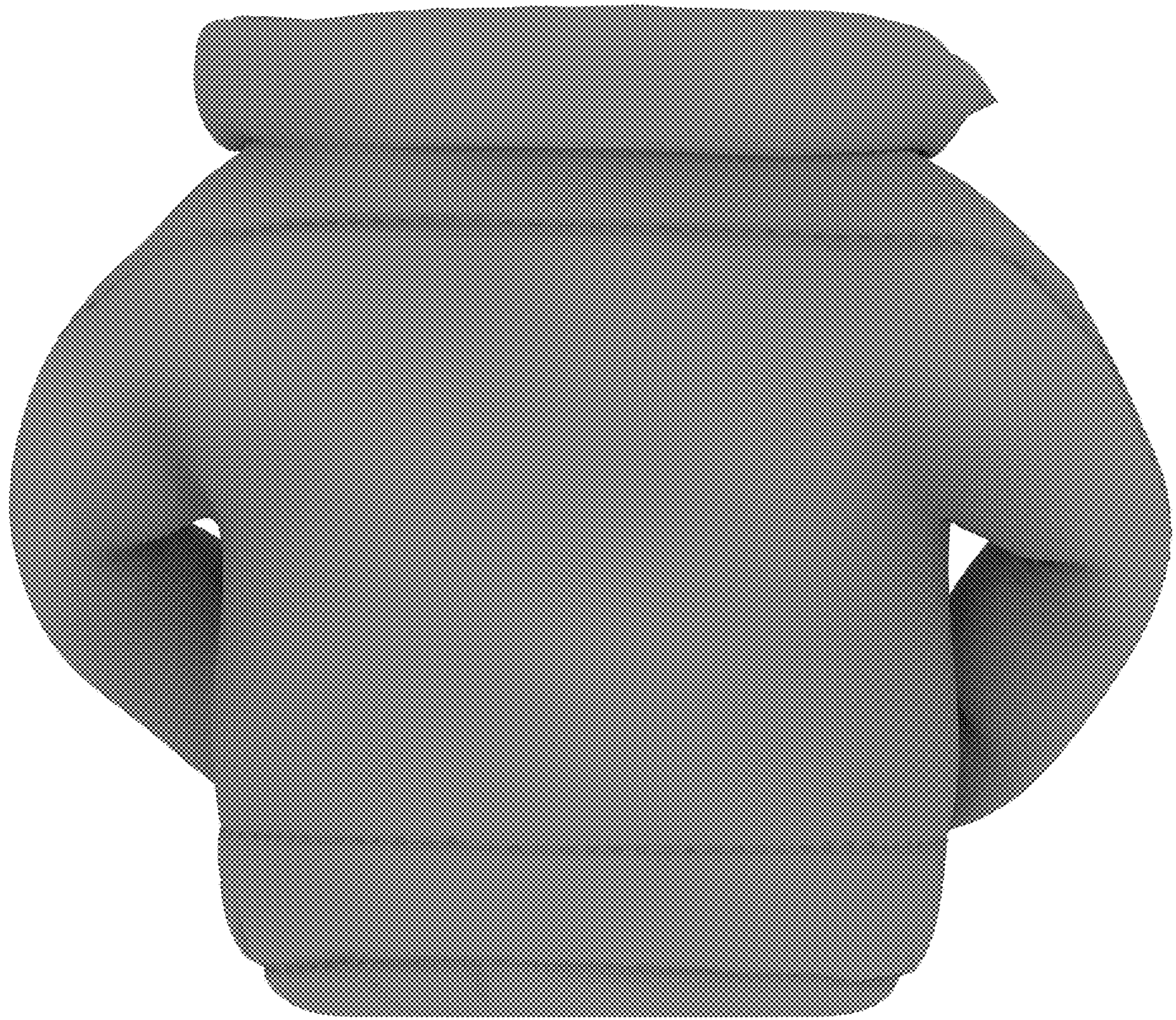

FIG. 4

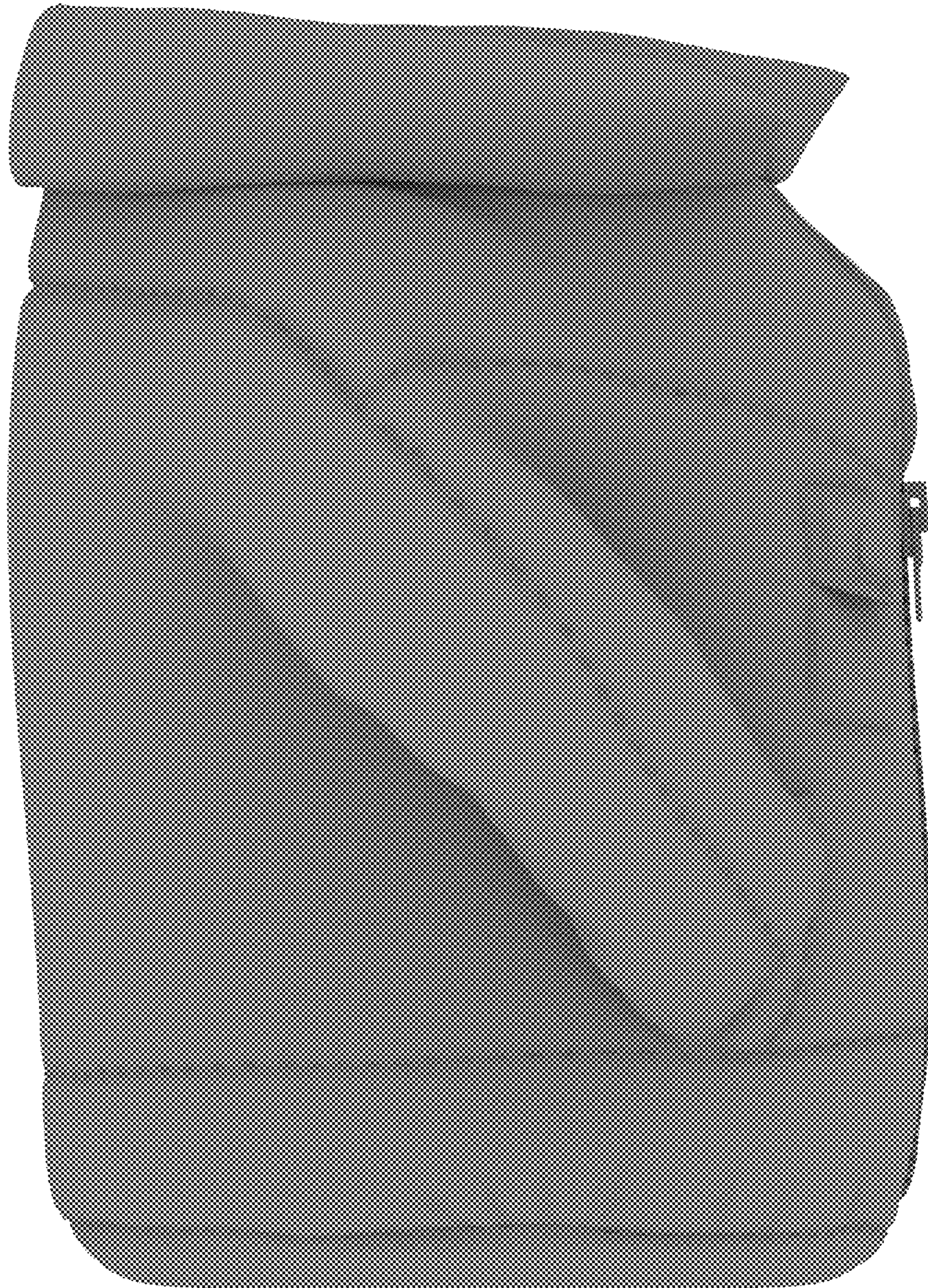

FIG. 5

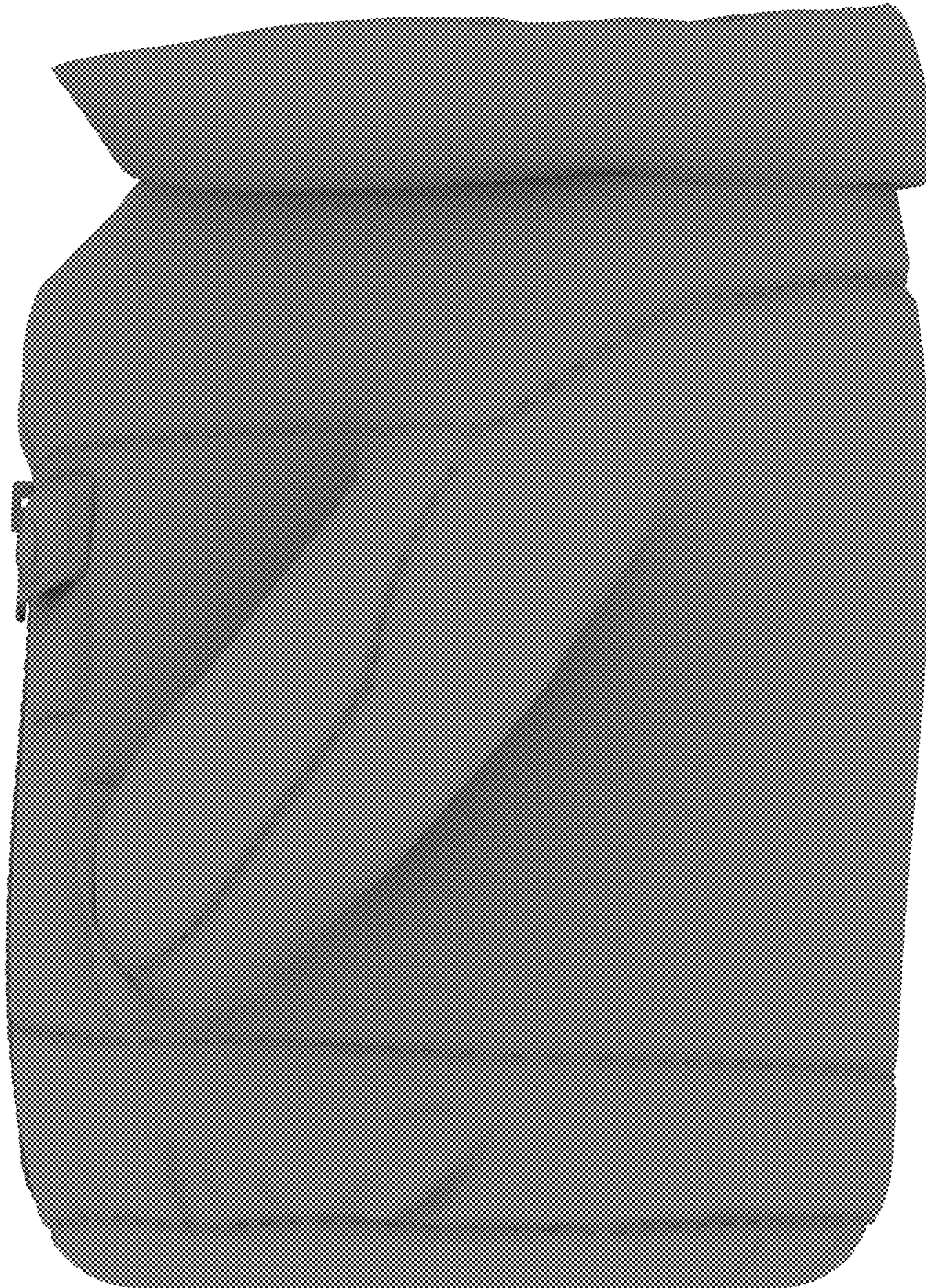

FIG. 6

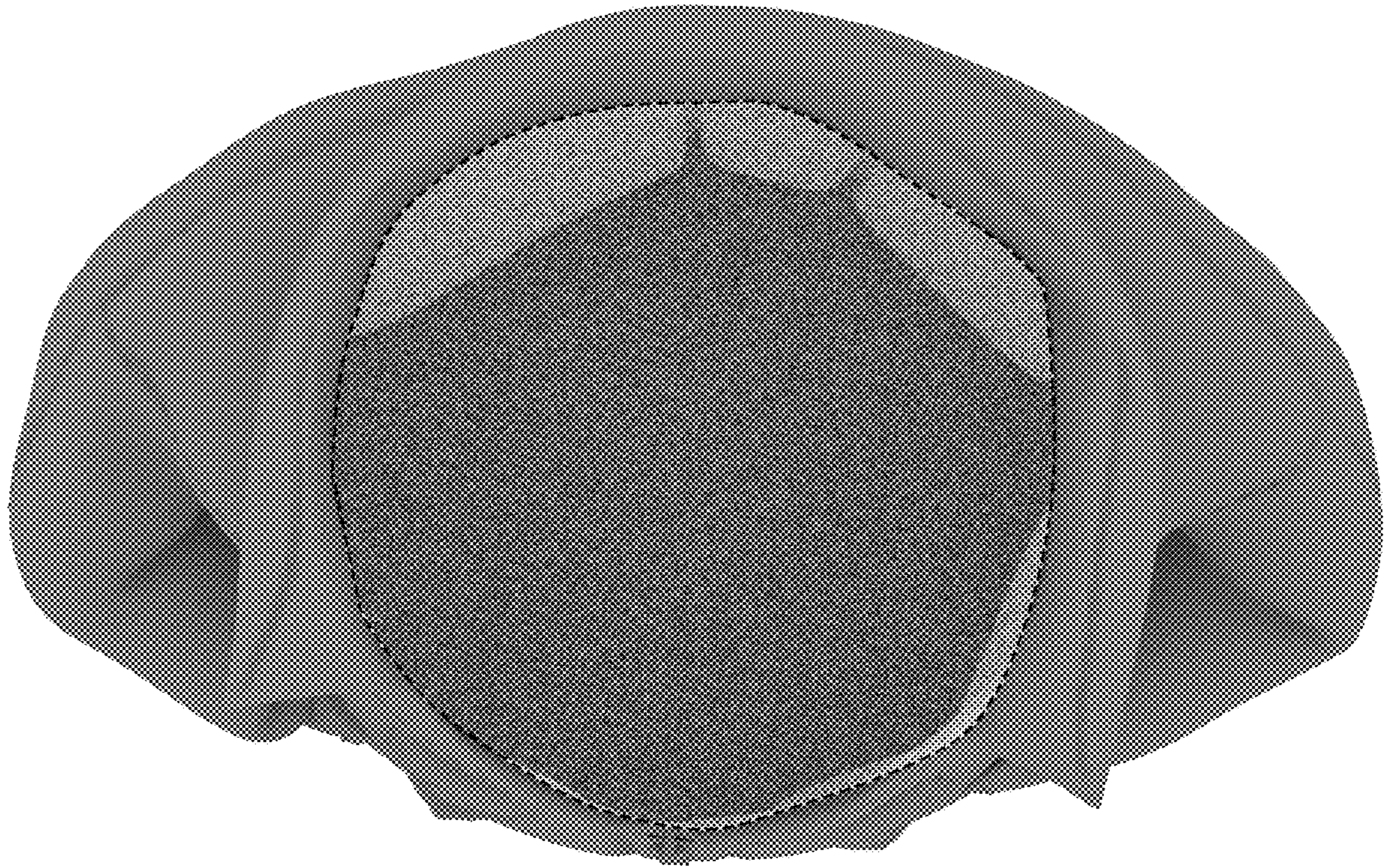

FIG. 7

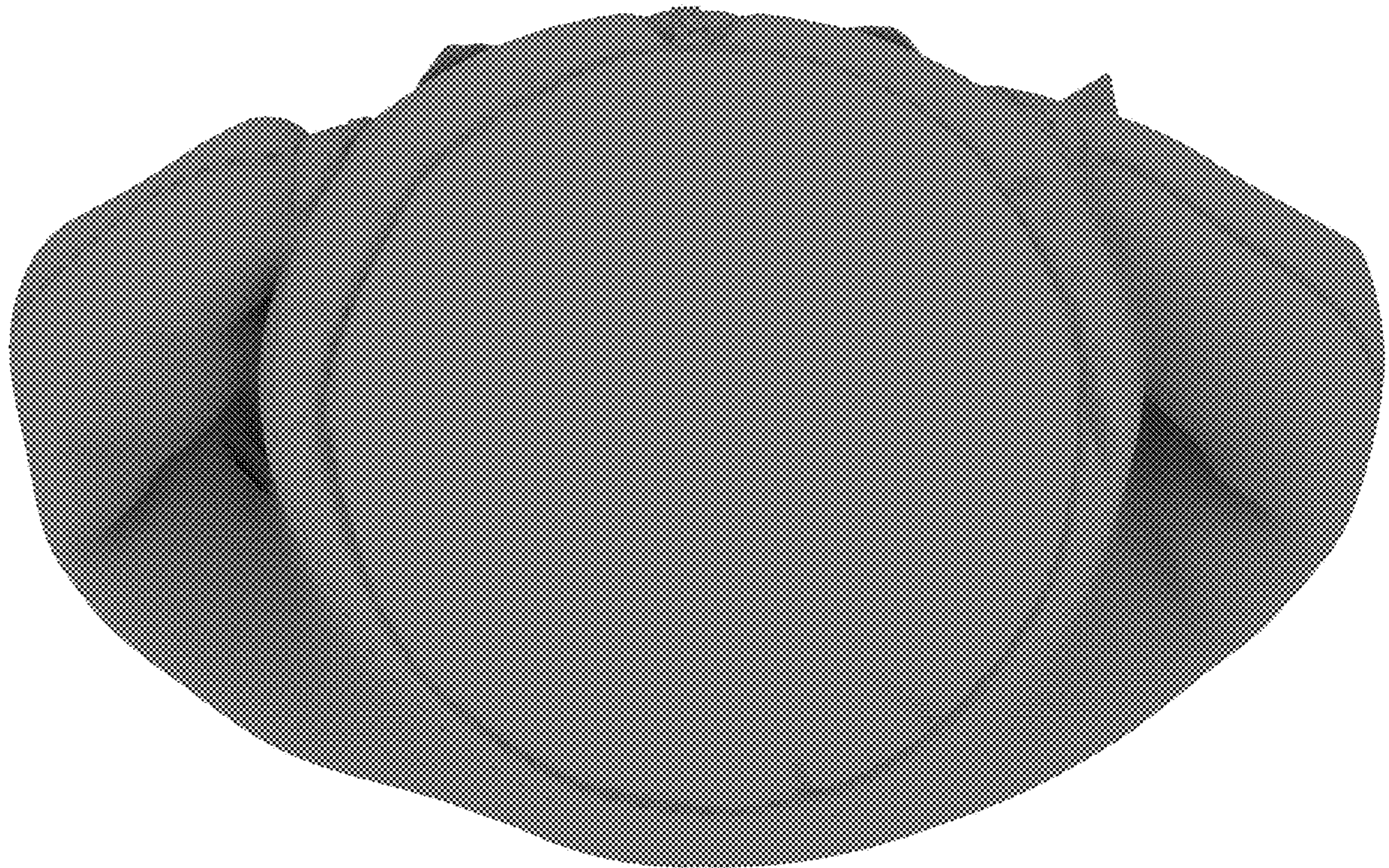

FIG. 8