



US00D967248S

(12) **United States Design Patent**
Kanehara et al.

(10) **Patent No.:** **US D967,248 S**

(45) **Date of Patent:** **** Oct. 18, 2022**

(54) **GUITAR**

(71) Applicant: **HOSHINO GAKKI CO., LTD.**, Aichi (JP)

(72) Inventors: **Kiyotaka Kanehara**, Nagoya (JP);
Shinji Ishigami, Nagoya (JP)

(73) Assignee: **HOSHINO GAKKI CO., LTD.**, Aichi (JP)

(**) Term: **15 Years**

(21) Appl. No.: **35/510,831**

(22) Filed: **Oct. 30, 2020**

(80) **Hague Agreement Data**

Int. Filing Date: **Oct. 30, 2020**

Int. Reg. No.: **DM/211249**

Int. Reg. Date: **Oct. 30, 2020**

Int. Reg. Pub. Date: **Nov. 27, 2020**

(30) **Foreign Application Priority Data**

Jul. 15, 2020 (JP) 2020-014589 D

Jul. 15, 2020 (JP) 2020-014590 D

Jul. 15, 2020 (JP) 2020-014591 D

(51) **LOC (13) Cl.** **17-03**

(52) **U.S. Cl.**
USPC **D17/20**

(58) **Field of Classification Search**
USPC D17/14, 15, 17, 18, 19, 20, 21
See application file for complete search history.

(56) **References Cited**

U.S. PATENT DOCUMENTS

D371,155 S * 6/1996 Hudnall D17/14
D384,093 S * 9/1997 Oshima D17/14

D568,927 S * 5/2008 Garnier D17/20
D594,053 S * 6/2009 Kirkland D17/14
D611,523 S * 3/2010 Chan D17/19
D650,831 S * 12/2011 Chan D17/20
D677,712 S * 3/2013 Blanc D17/20
D684,624 S * 6/2013 Graham D17/20
D766,355 S * 9/2016 Hurns, Jr. D17/20
D783,711 S * 4/2017 Holzer D17/20
D785,080 S * 4/2017 Kiesel D17/20
D803,933 S * 11/2017 Milone G10D 3/14
D17/20
D814,557 S * 4/2018 Canivell Grifols D17/20
D823,376 S * 7/2018 Smith D17/20

(Continued)

Primary Examiner — Khawaja Anwar

(57) **CLAIM**

The ornamental design for a guitar, as shown and described.

DESCRIPTION

- 1. Guitar
- 1.1 : Perspective
- 1.2 : Perspective
- 1.3 : Front
- 1.4 : Back
- 1.5 : Top
- 1.6 : Bottom
- 1.7 : Enlarged right side view
- 1.8 : Enlarged left side view
- 1.9 : Partial enlarged view
- 1.10 : Partial enlarged view
- 1.11 : Partial enlarged view
- 1.12 : Partial enlarged view
- 1.13 : Cross sectional
- 1.14 : Cross sectional
- 1.15 : Cross sectional

The broken lines in the drawings form no part of the claimed designs; the dashed-dotted lines in the drawings denote the boundary of the claimed design and form no part thereof, Figs. 1.9 through 1.12 are enlarged views of a guitar head.

1 Claim, 15 Drawing Sheets

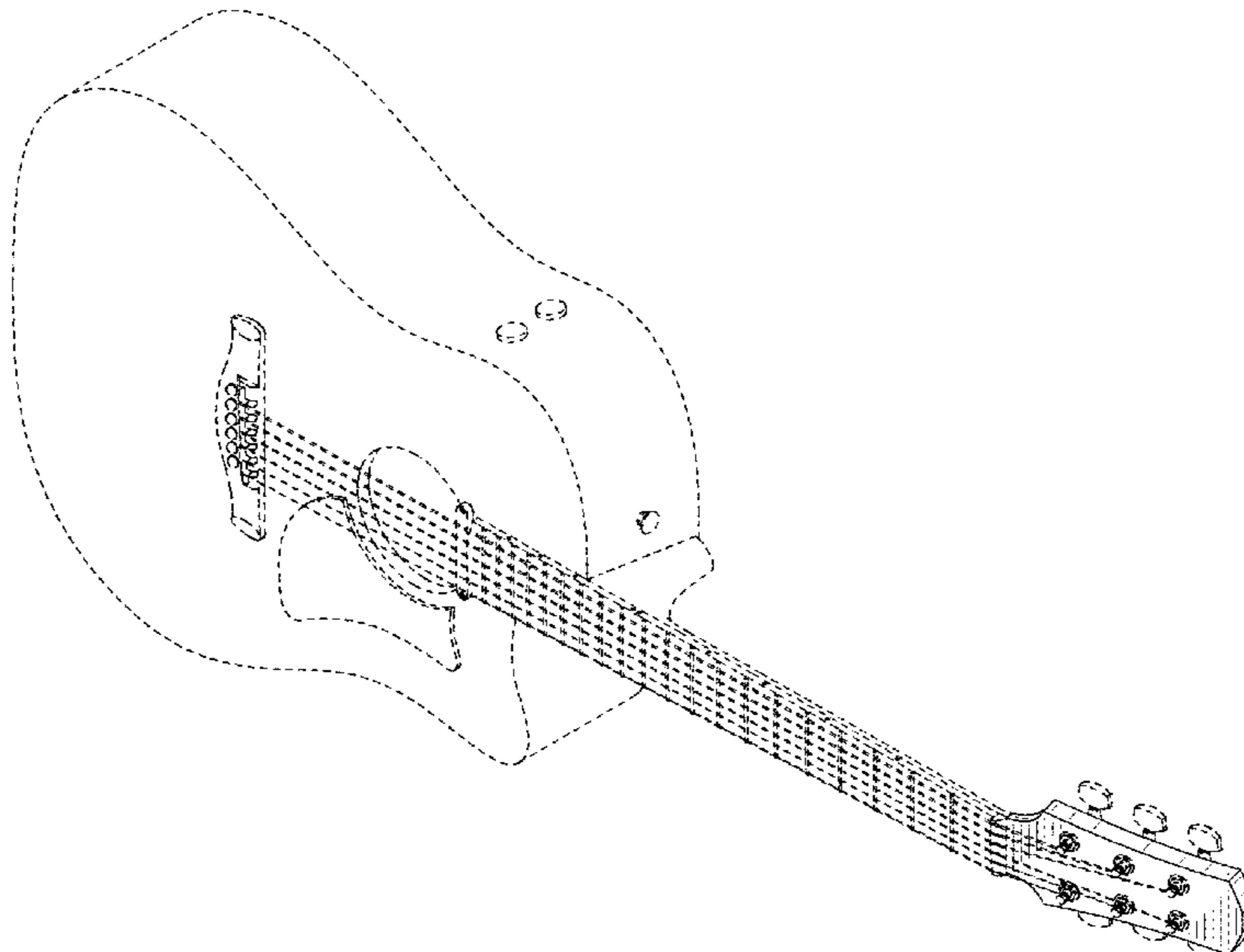

(56)

References Cited

U.S. PATENT DOCUMENTS

D862,576 S	10/2019	Kanehara et al.	
D865,858 S *	11/2019	Whitehead	D17/20
D888,820 S *	6/2020	Kiesel	D17/20
D911,432 S *	2/2021	Skogsfjord	D17/20

* cited by examiner

1.1

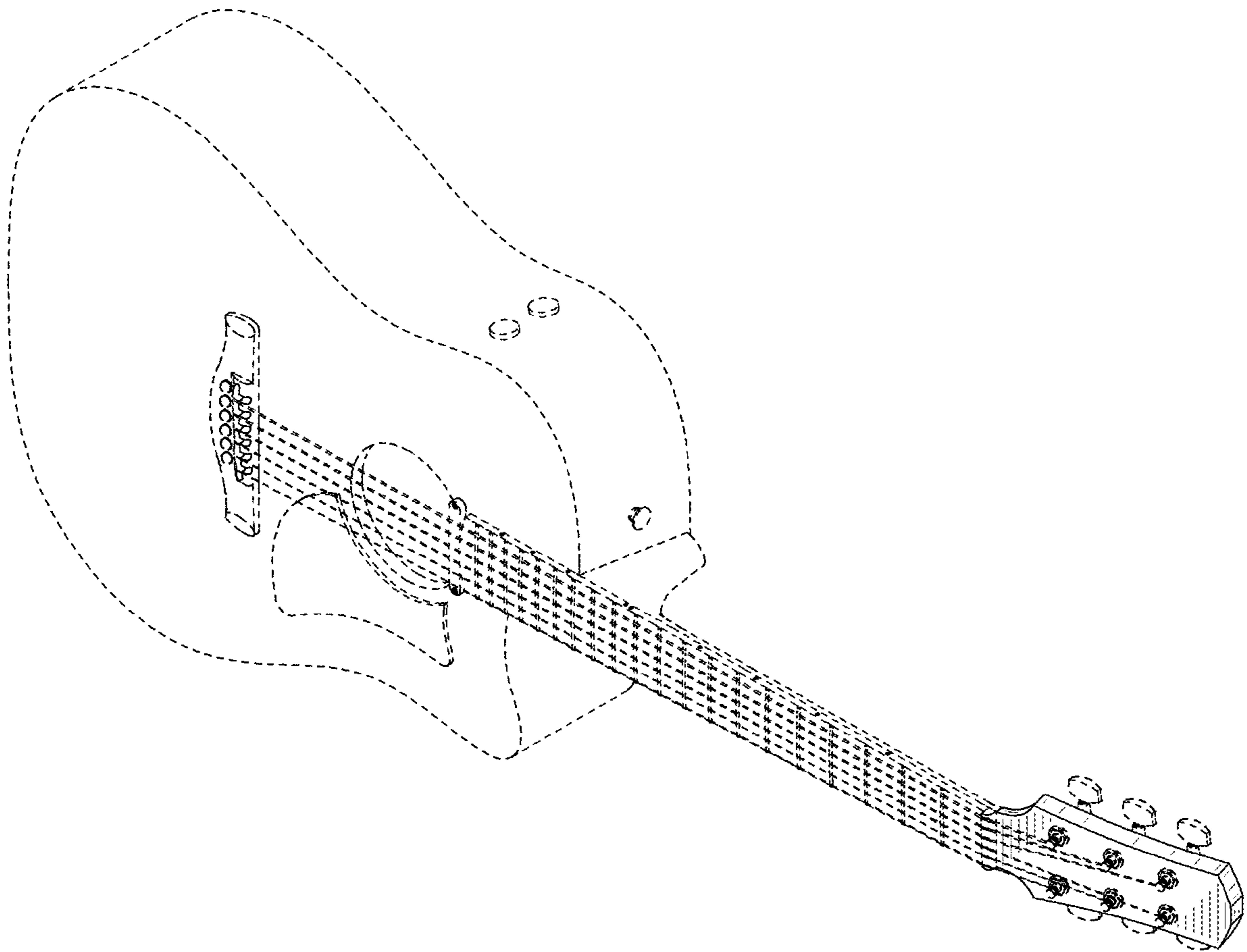

1.2

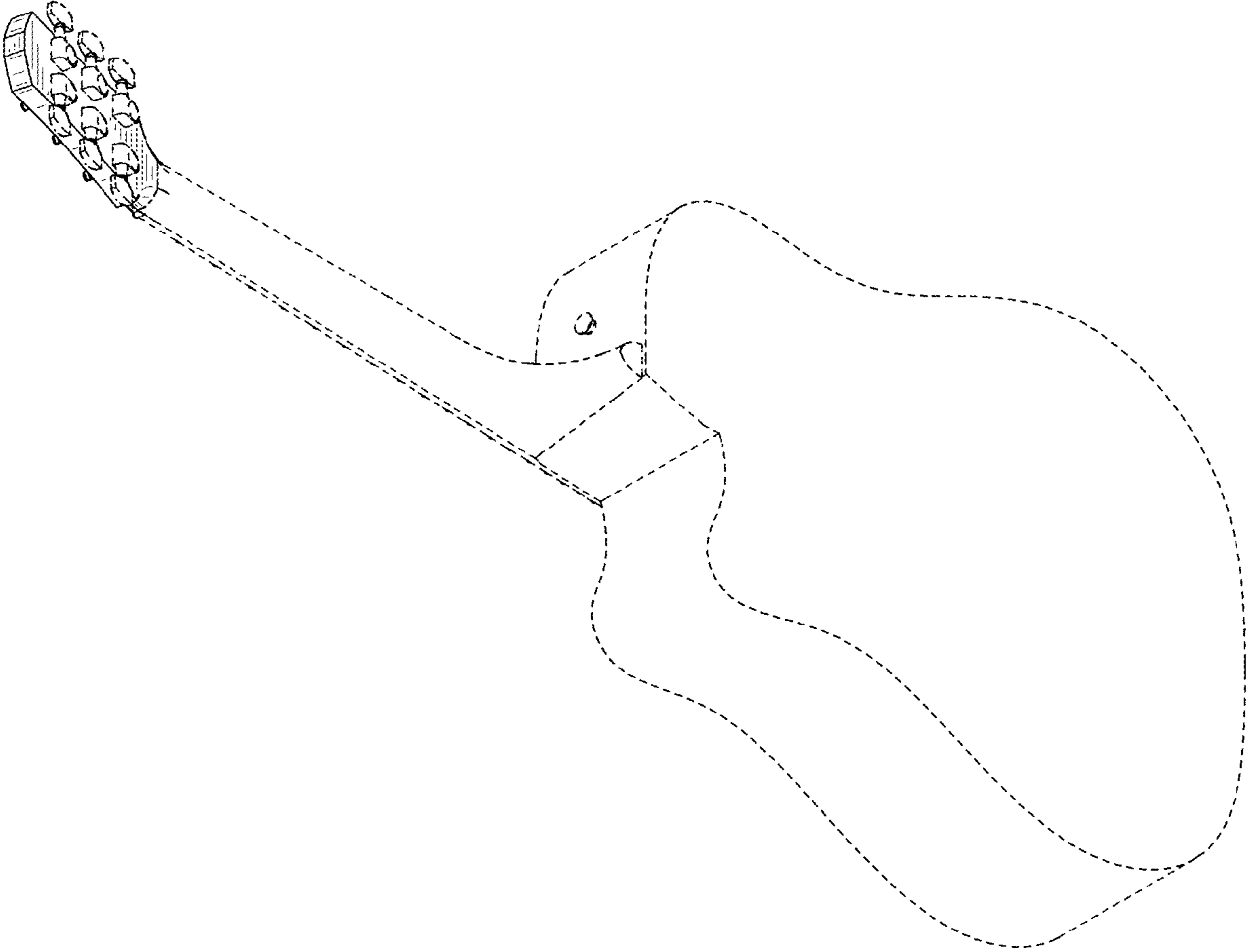

1.3

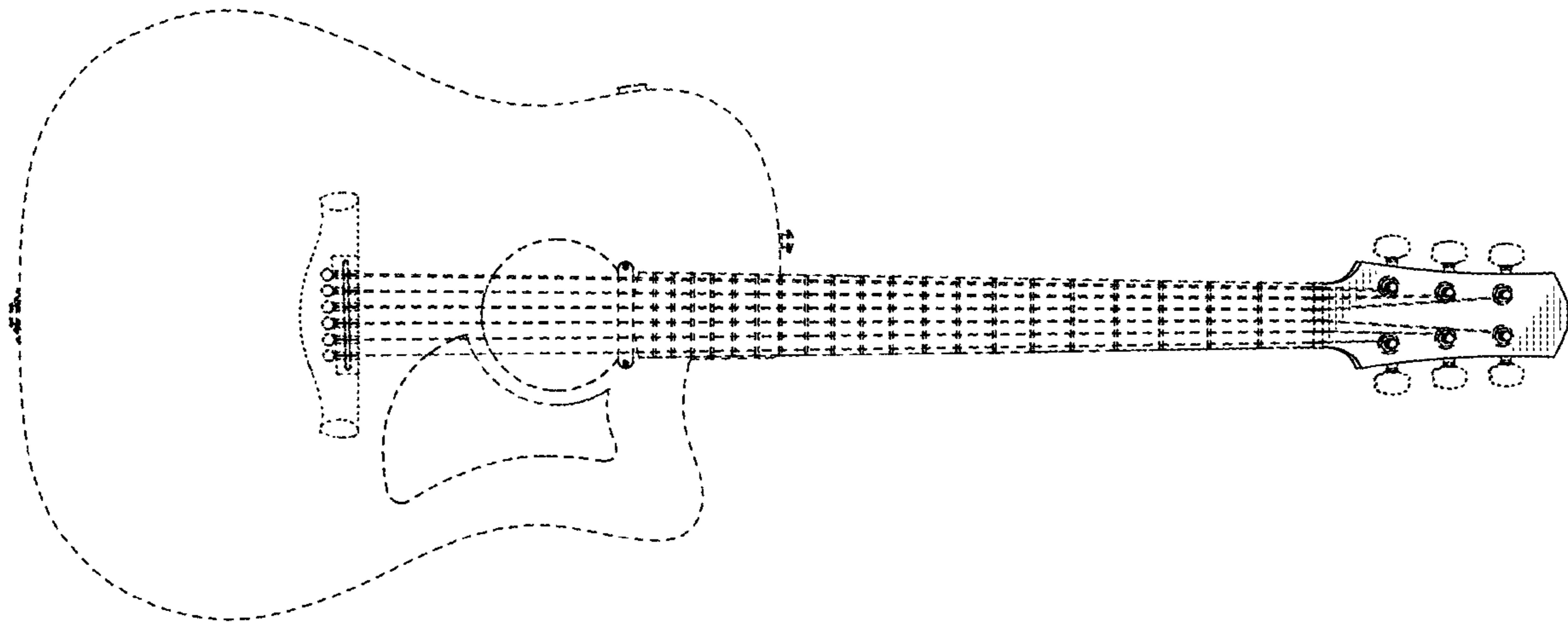

1.4

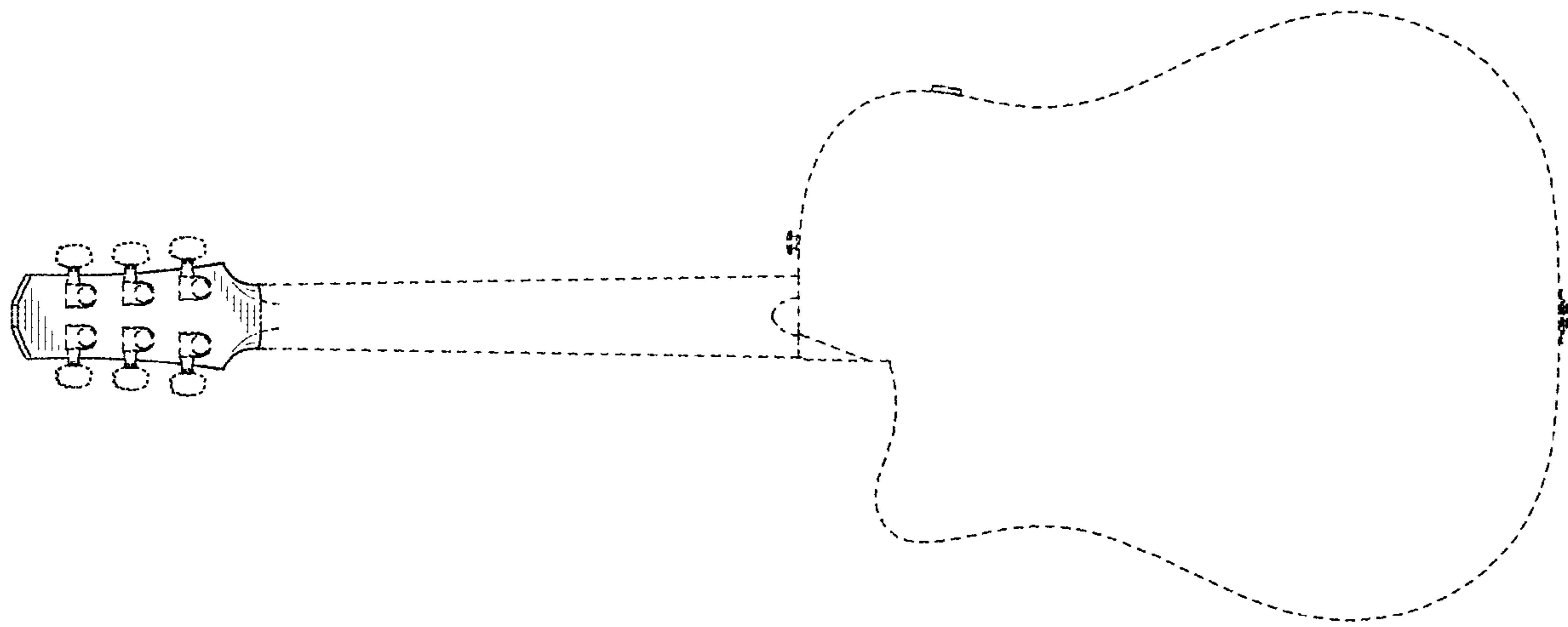

1.5

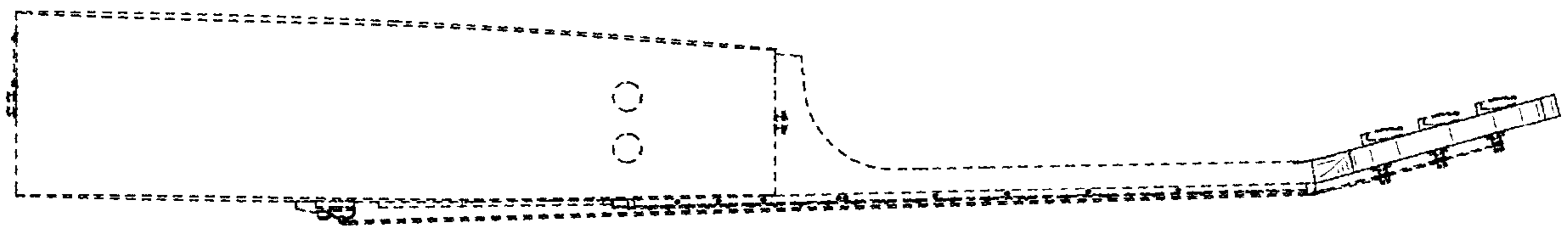

1.6

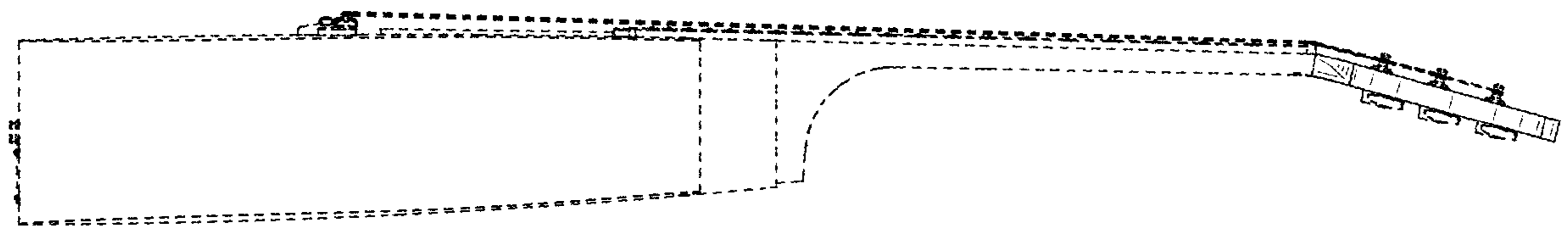

1.7

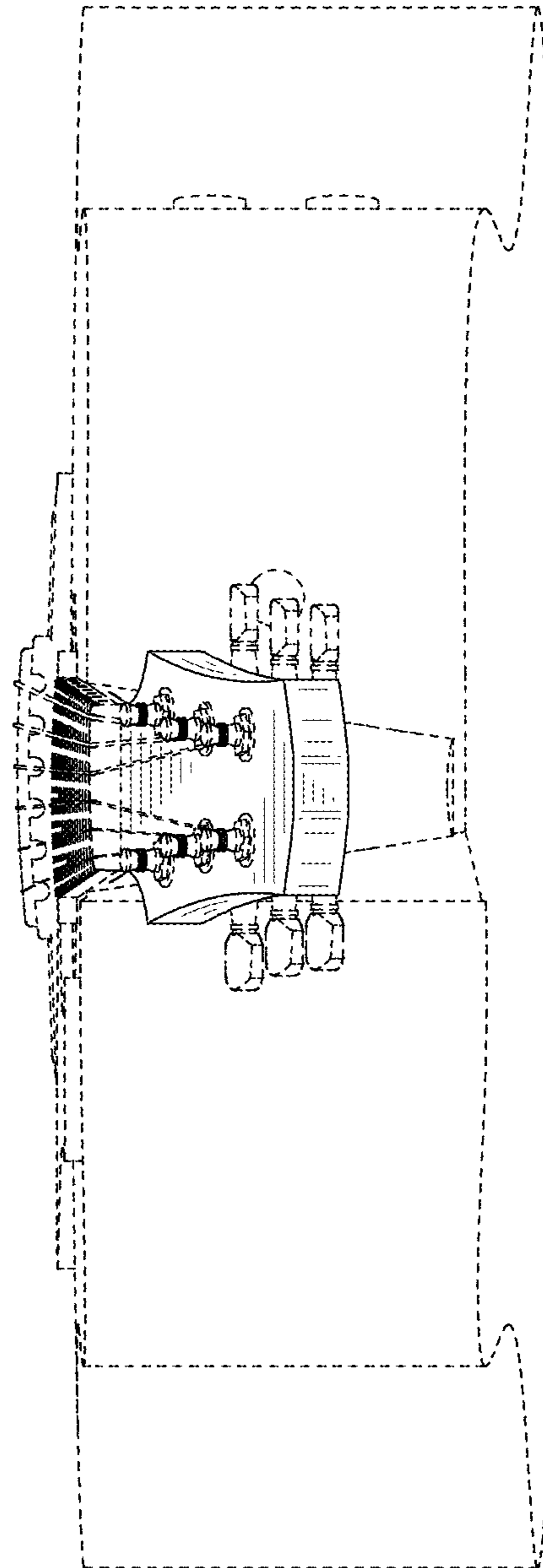

1.8

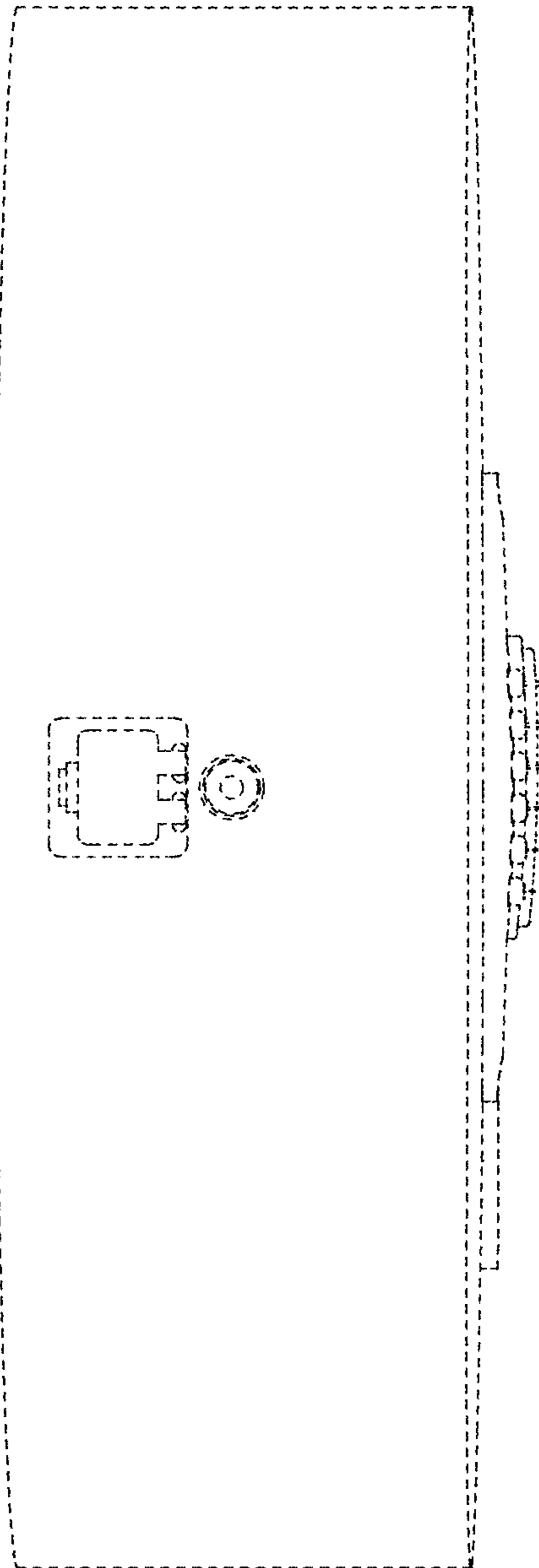

1.9

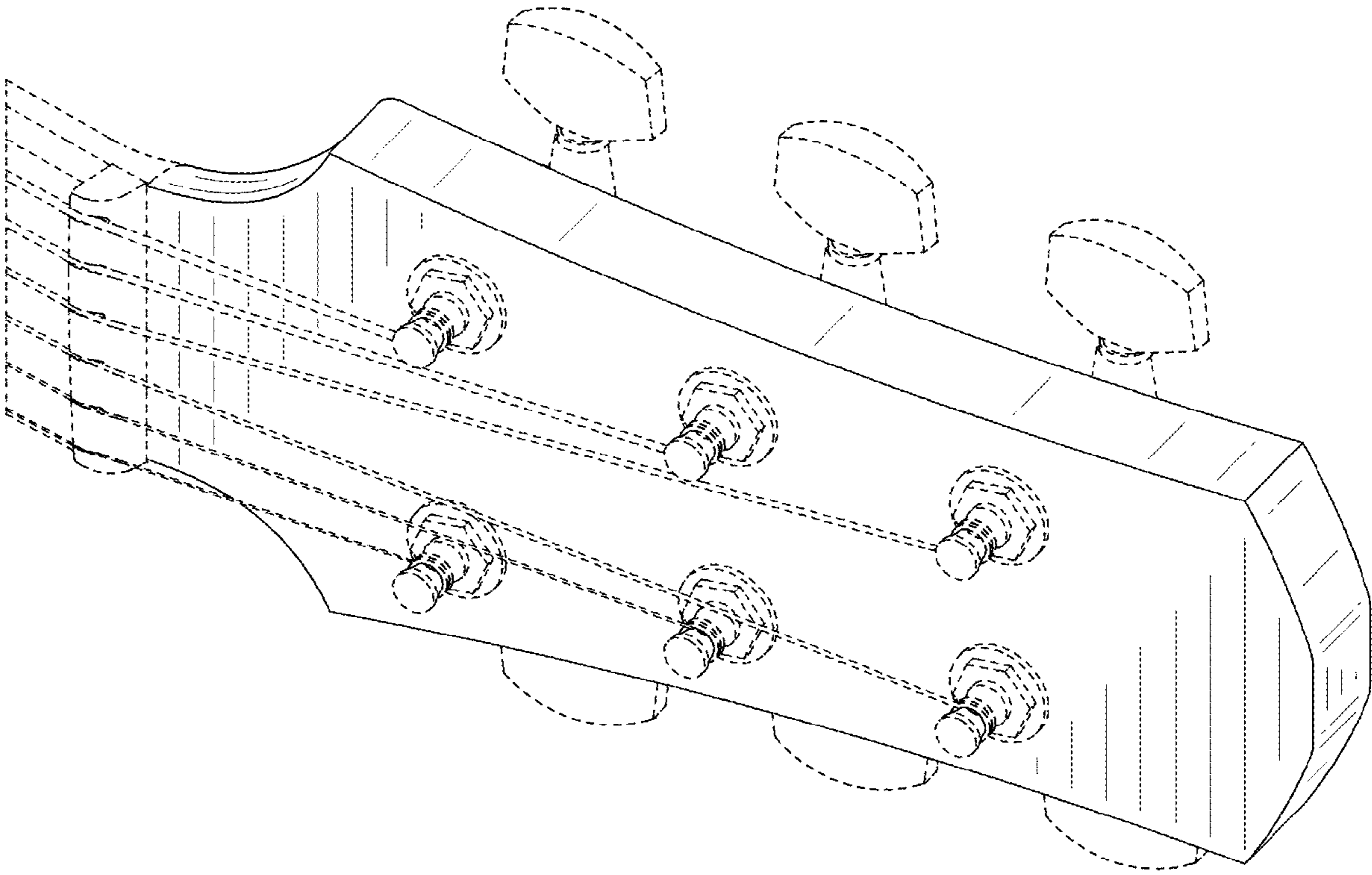

1.10

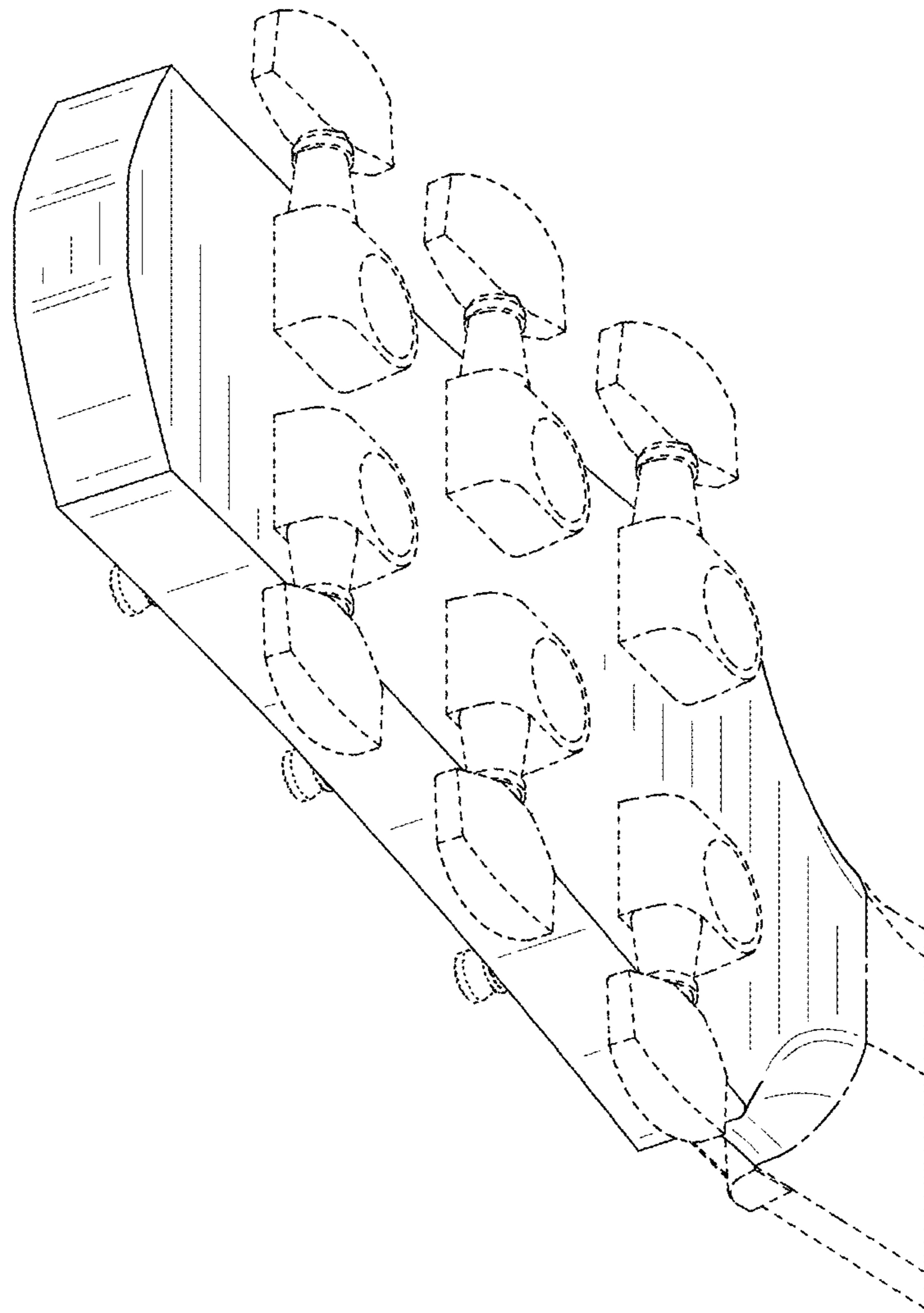

1.11

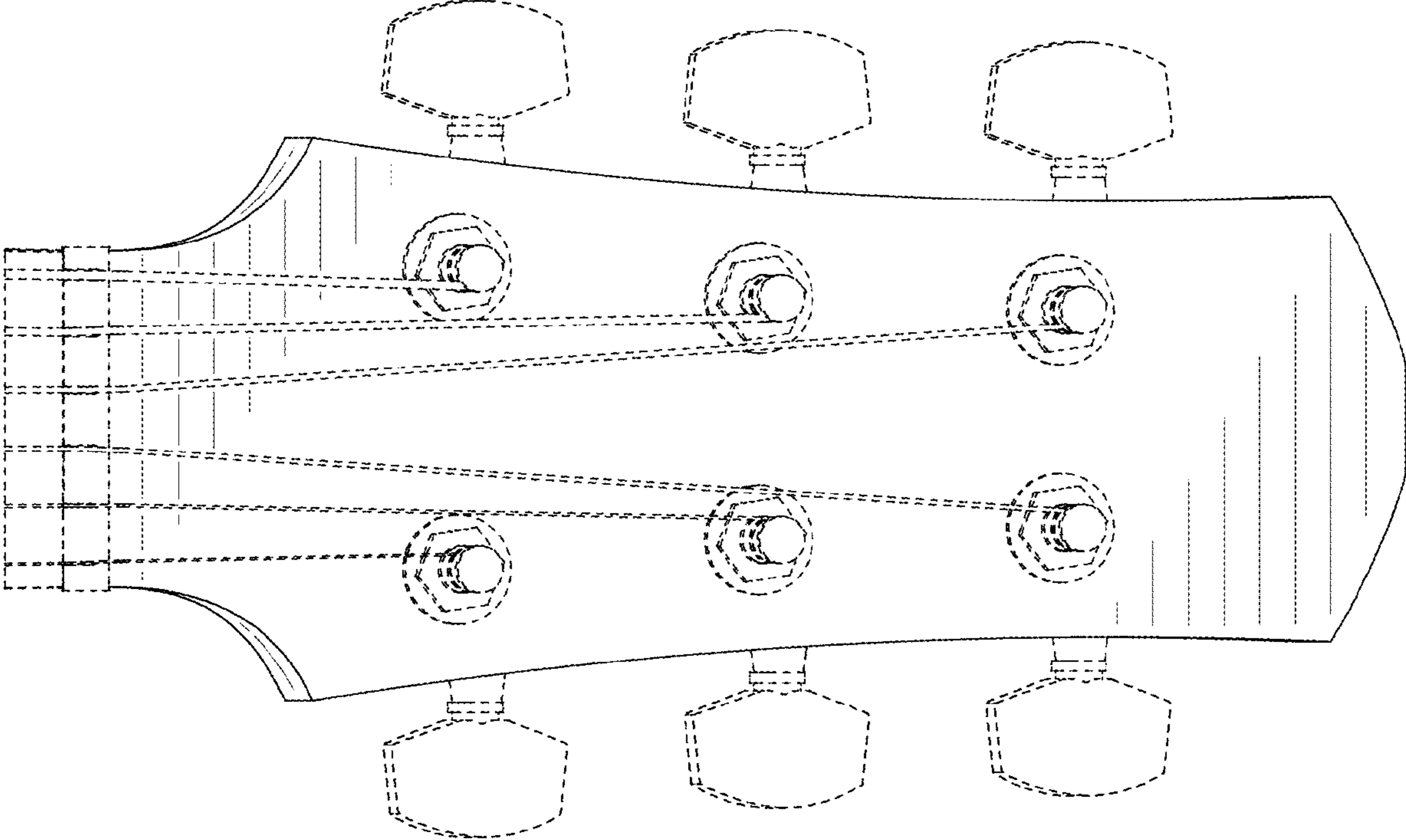

1.12

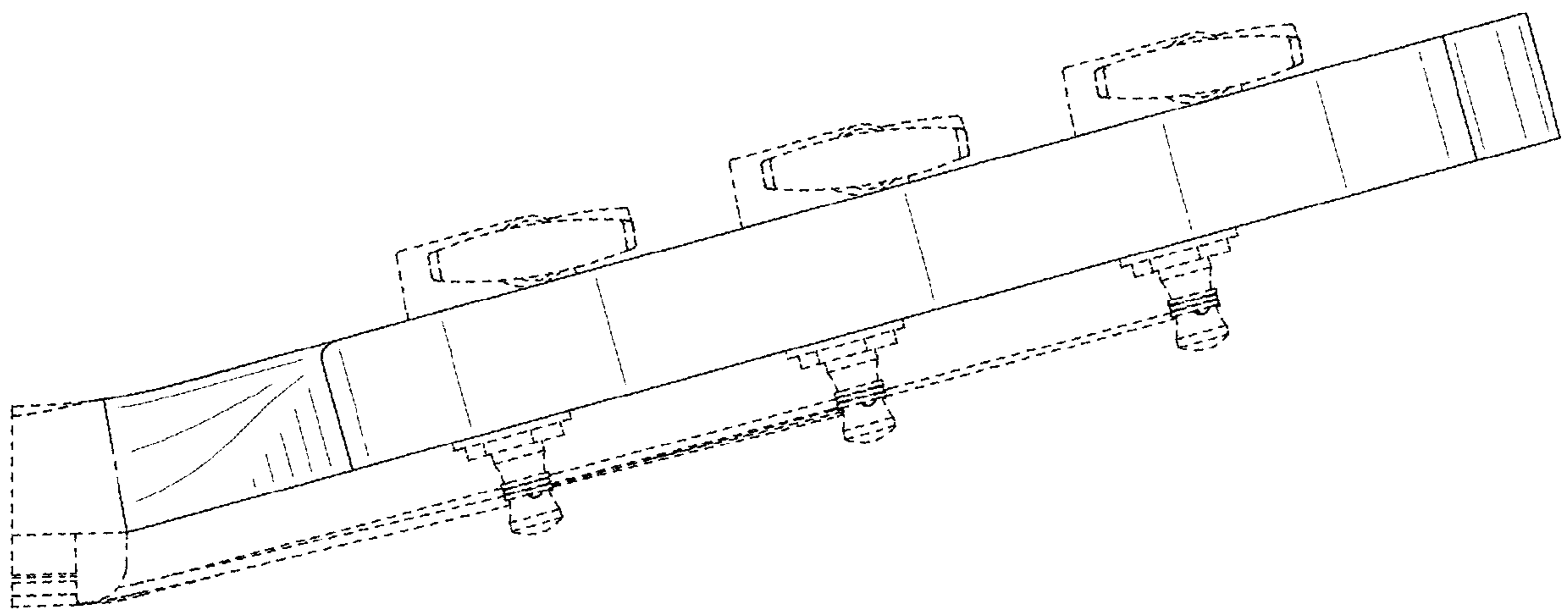

1.13

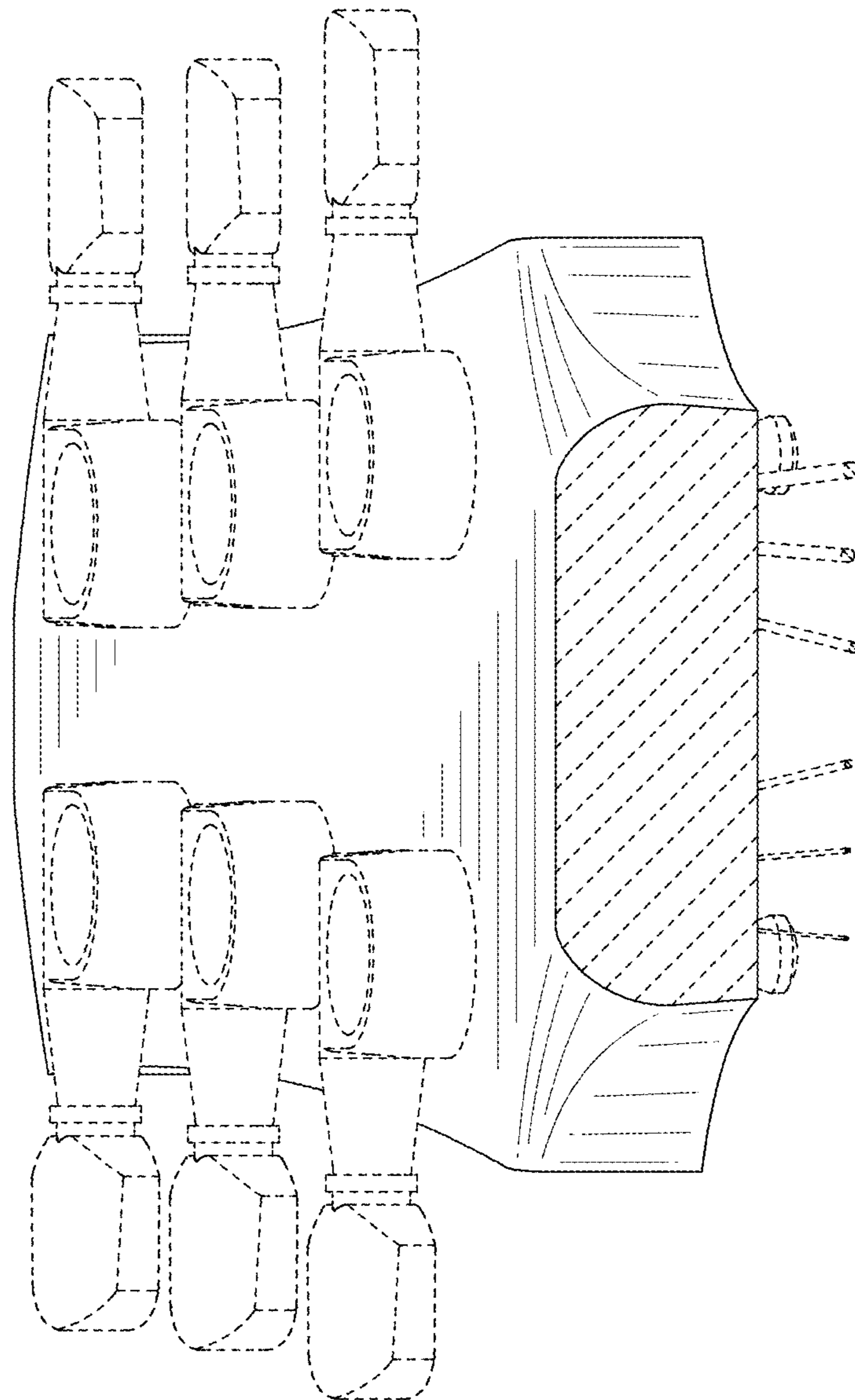

1.14

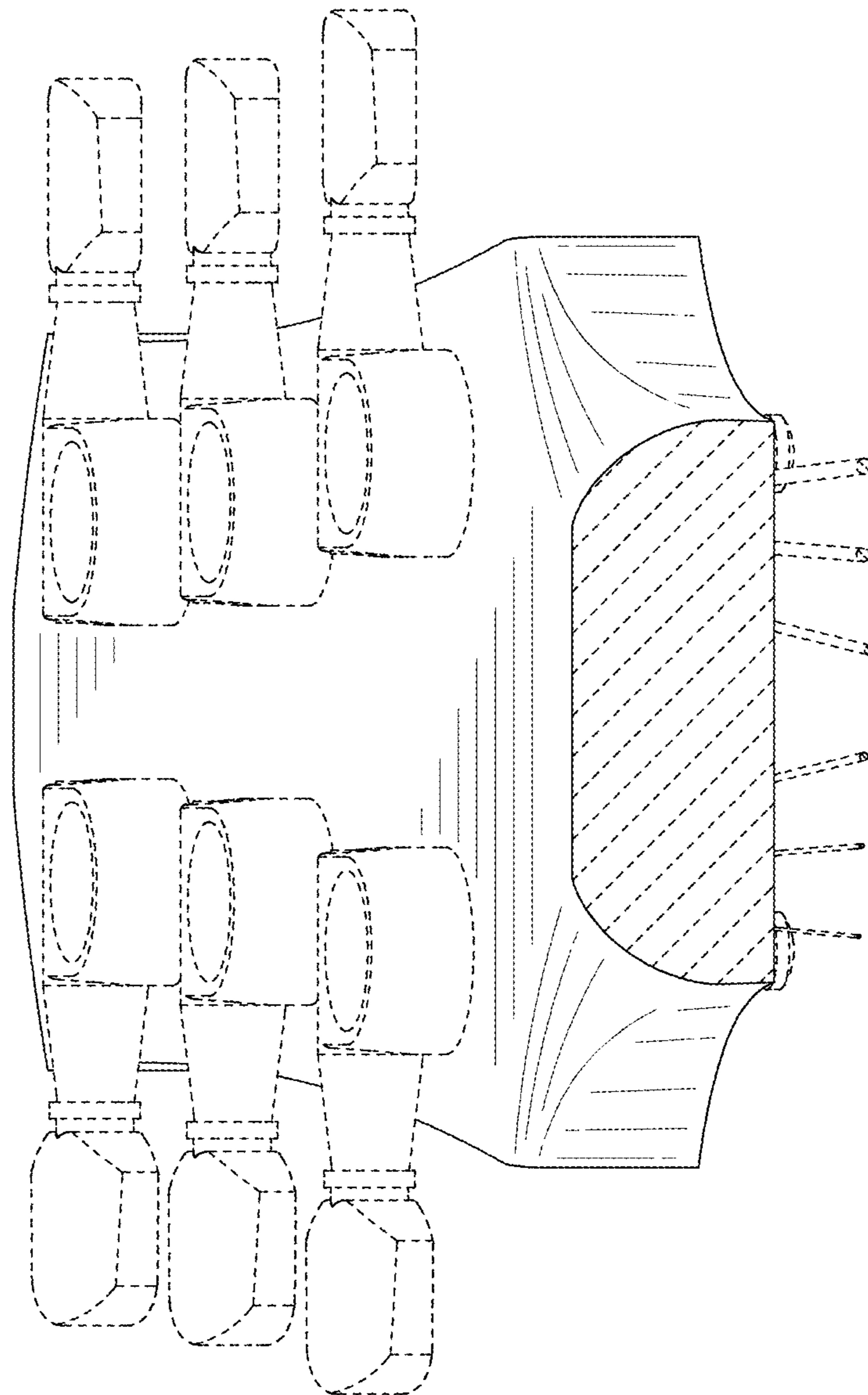

1.15

