

US00D967151S

(12) **United States Design Patent**  
**Xu et al.**

(10) **Patent No.: US D967,151 S**  
(45) **Date of Patent: \*\* Oct. 18, 2022**

(54) **DISPLAY SCREEN WITH GRAPHICAL USER INTERFACE**

(71) Applicant: **Hangzhou Ruisheng Software Co., Ltd., Zhejiang (CN)**

(72) Inventors: **Qingsong Xu, Zhejiang (CN); Qing Li, Zhejiang (CN)**

(73) Assignee: **Hangzhou Ruisheng Software Co., Ltd., Zhejiang (CN)**

(\*\*) Term: **15 Years**

(21) Appl. No.: **29/838,893**

(22) Filed: **May 16, 2022**

(51) **LOC (13) Cl. .... 14-04**

(52) **U.S. Cl.**  
USPC ..... **D14/485**

(58) **Field of Classification Search**  
USPC ..... D14/485-495; D20/11; D21/324, 325  
CPC .. G06F 3/0481; G06F 3/04817; G06F 3/0482;  
G06F 3/0483; G06F 3/04842; G06F  
3/0485; G06F 3/04855; G06F 3/0486;  
G06F 3/0488; G06F 3/04886; G06F  
9/451; G06F 40/103; G06F 40/106; G06F  
40/189; G06F 40/191; G06Q 10/06;  
G06Q 10/1097; G16H 20/30; H04N  
21/8173; A63F 13/95

See application file for complete search history.

(56) **References Cited**

**U.S. PATENT DOCUMENTS**

6,478,680 B1 \* 11/2002 Yoshioka ..... A63F 13/95  
463/31  
8,597,093 B2 \* 12/2013 Engelberg ..... G16H 20/30  
463/6

(Continued)

**OTHER PUBLICATIONS**

“Plant Diary App Design” Nov. 14, 2019, posted at behance.net, [site visited Jul. 12, 2022]. <https://www.behance.net/gallery/88131087/PLANT-DIARY-APP-DESIGN> (Year: 2019).\*

(Continued)

*Primary Examiner* — John M Otte  
(74) *Attorney, Agent, or Firm* — JCIPRNET

(57) **CLAIM**

The ornamental design for a display screen with graphical user interface, as shown and described.

**DESCRIPTION**

FIG. 1 is a front view of a display screen showing a first image of a graphical user interface;  
FIG. 2 is a front view of a display screen showing a second image of the graphical user interface;  
FIG. 3 is a front view of a display screen showing a third image of the graphical user interface;  
FIG. 4 is a front view of a display screen showing a fourth image of the graphical user interface;  
FIG. 5 is a front view of a display screen showing a fifth image of the graphical user interface;  
FIG. 6 is a front view of a display screen showing a sixth image of the graphical user interface;  
FIG. 7 is a front view of a display screen showing a seventh image of the graphical user interface;  
FIG. 8 is a front view of a display screen showing an eighth image of the graphical user interface; and,  
FIG. 9 is a front view of a display screen showing a ninth image of the graphical user interface.

The appearance of the graphical user interface of the display screen transitions between the images shown in FIGS. 1-9. The process or period in which the graphical user interface transitions forms no part of the claimed design. The long dash short dash broken lines illustrate the display screen and form no part of the claimed design. The remaining broken lines illustrate portions of the graphical user interface that form no part of the claimed design.

**1 Claim, 9 Drawing Sheets**

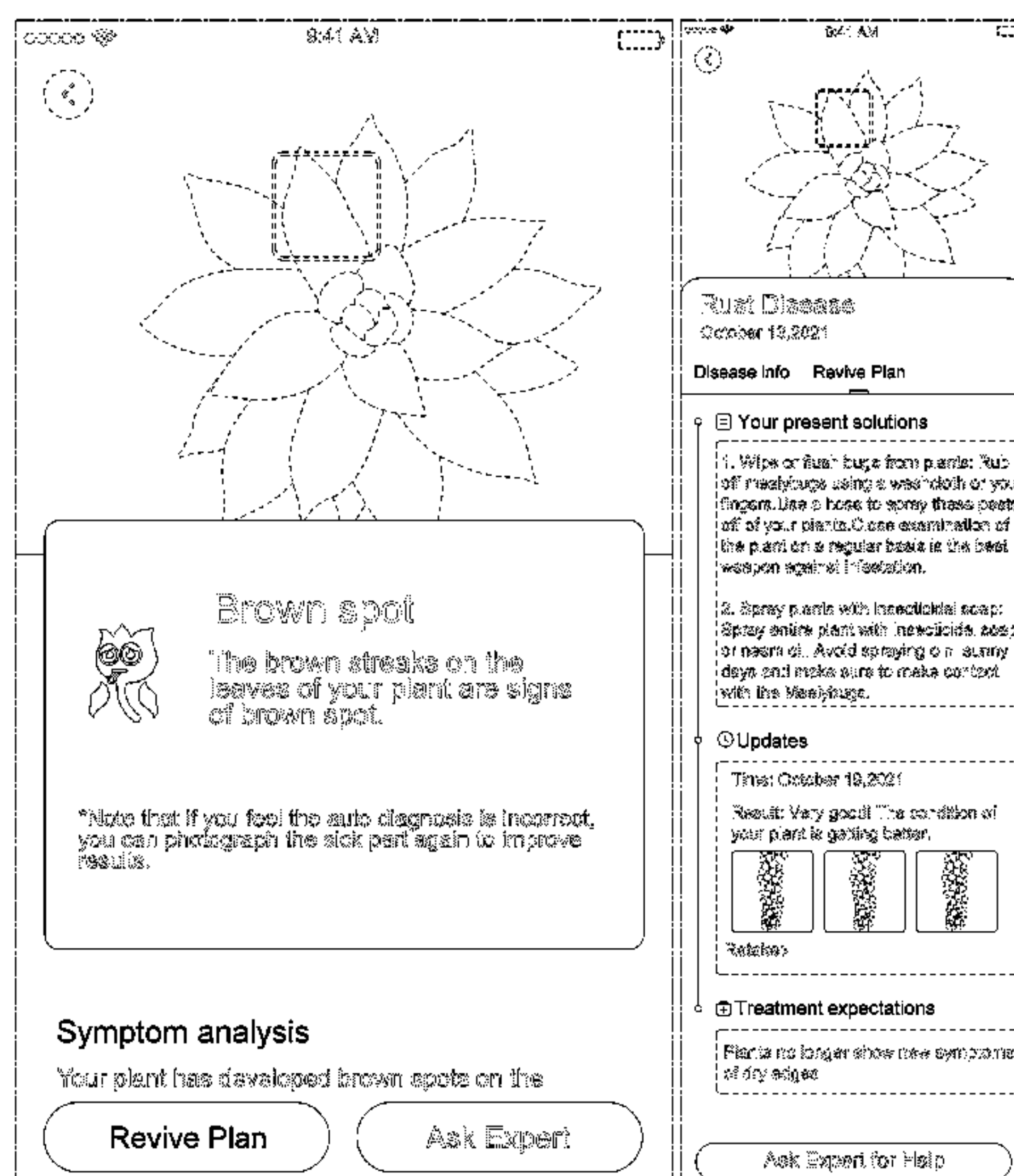

(56)

References Cited

U.S. PATENT DOCUMENTS

D781,899 S \* 3/2017 Akana ..... D14/486  
D815,130 S \* 4/2018 Phillips ..... D14/488  
D838,738 S \* 1/2019 Howland ..... D14/486  
D870,141 S \* 12/2019 Bowden ..... D14/488  
D890,193 S \* 7/2020 Xu ..... D14/485  
D895,682 S \* 9/2020 Howland ..... D14/496  
D916,875 S 4/2021 Elia et al.  
D918,250 S \* 5/2021 Xu ..... D14/486  
D922,414 S 6/2021 Haider et al.  
D923,048 S 6/2021 Hunn et al.  
D926,198 S 7/2021 Rice et al.  
D926,812 S 8/2021 d'Avignon et al.  
D927,525 S 8/2021 Trefethen et al.  
D928,822 S 8/2021 Lyons et al.

D934,284 S 10/2021 Jiang et al.  
2005/0114374 A1\* 5/2005 Juskiewicz ..... G11B 19/025  
2014/0033071 A1\* 1/2014 Gruber ..... G06Q 10/1097  
715/752  
2019/0004688 A1\* 1/2019 Bowen ..... G06F 40/186

OTHER PUBLICATIONS

“Plant finder app and it’s uses” Jul. 3, 2018, posted at youtube.com, [site visited Jul. 18, 2022]. <https://www.youtube.com/watch?v=ZnB8L5-AC90> (Year: 2018).\*

“Best Plant Identification Apps 2020” Jan. 22, 2020, posted at balconygardenweb.com, [site visited Feb. 24, 2021]. <https://balconygardenweb.com/best-plant-identification-apps> (Year: 2020).\*

\* cited by examiner

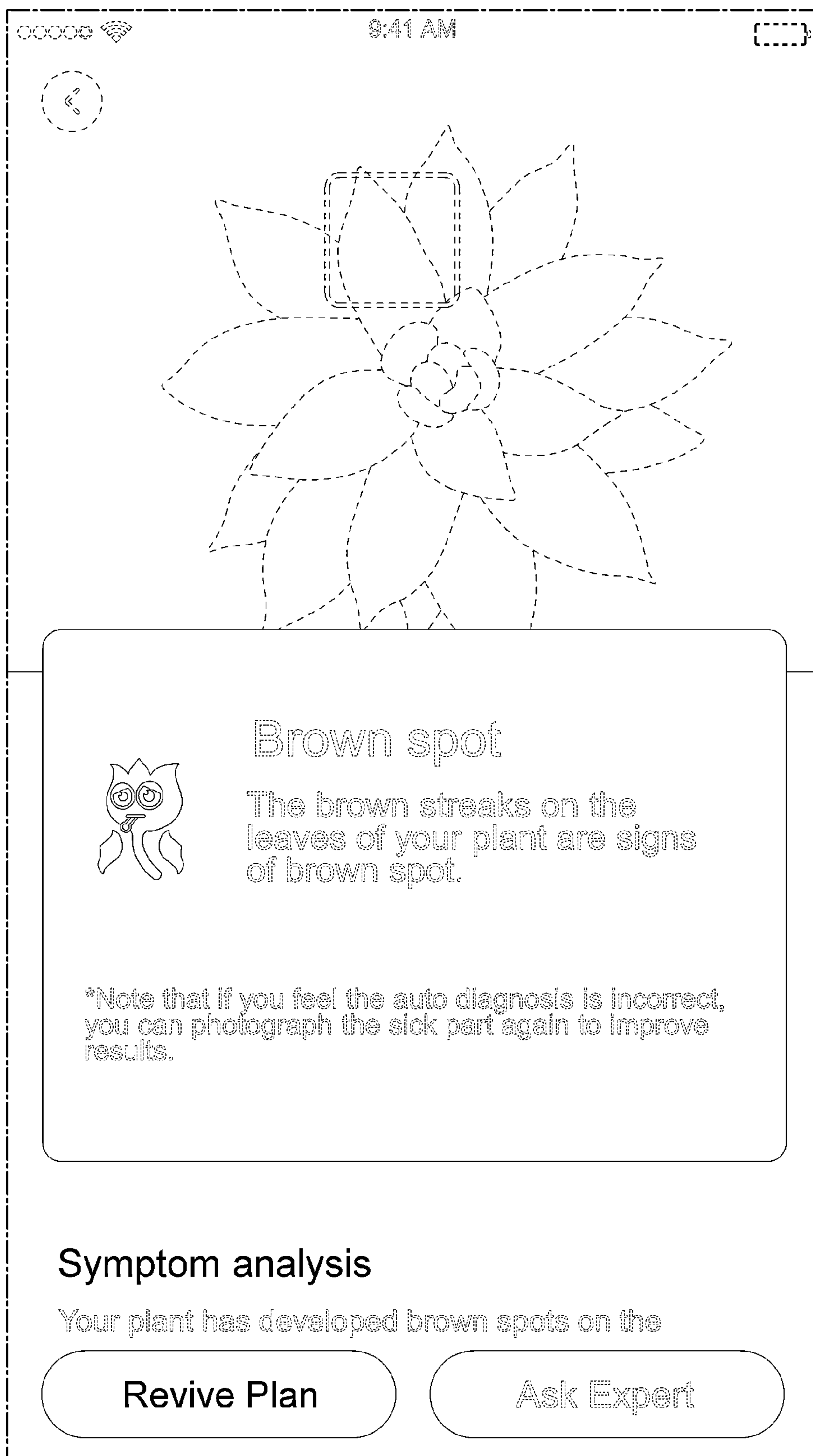

FIG. 1

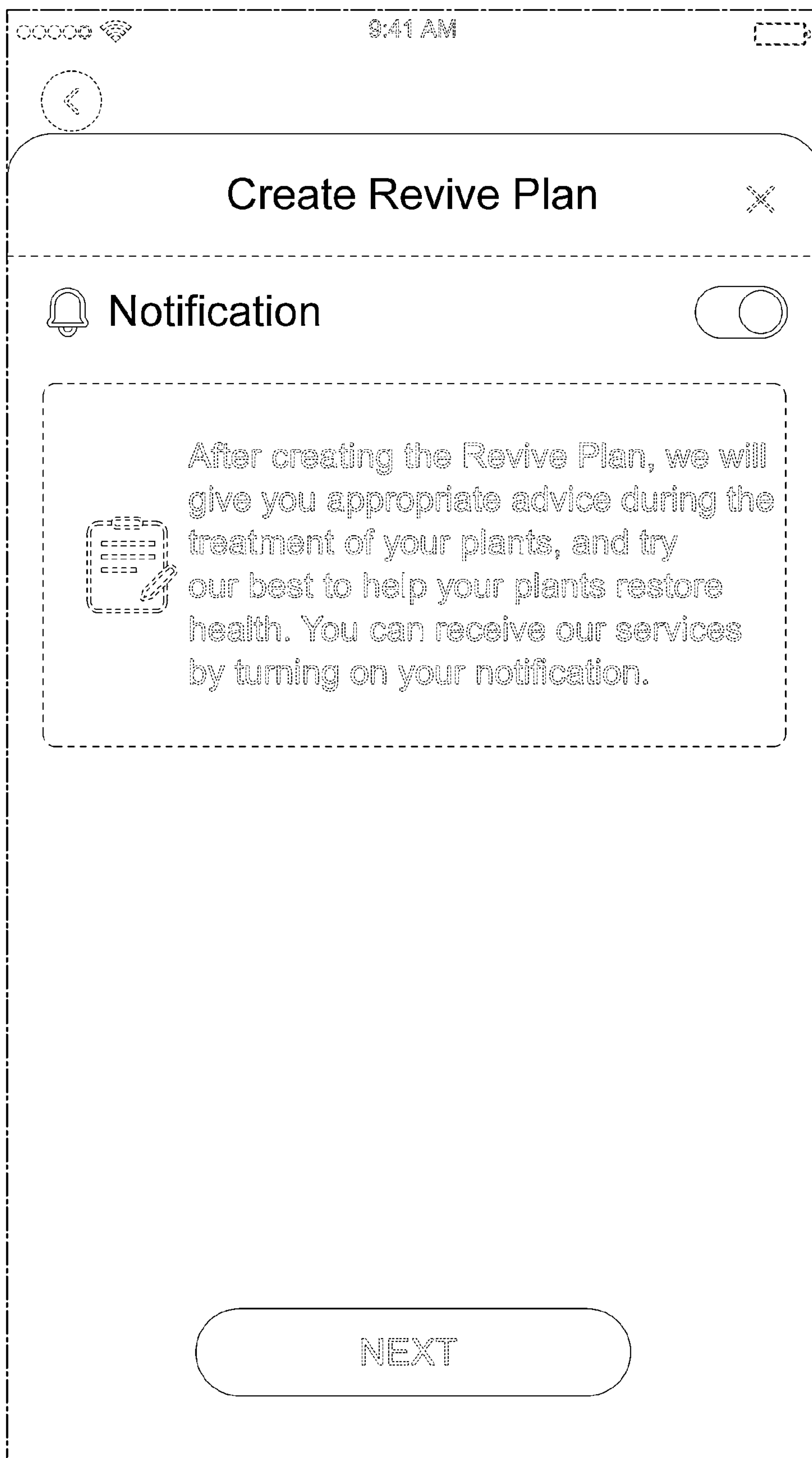

FIG. 2



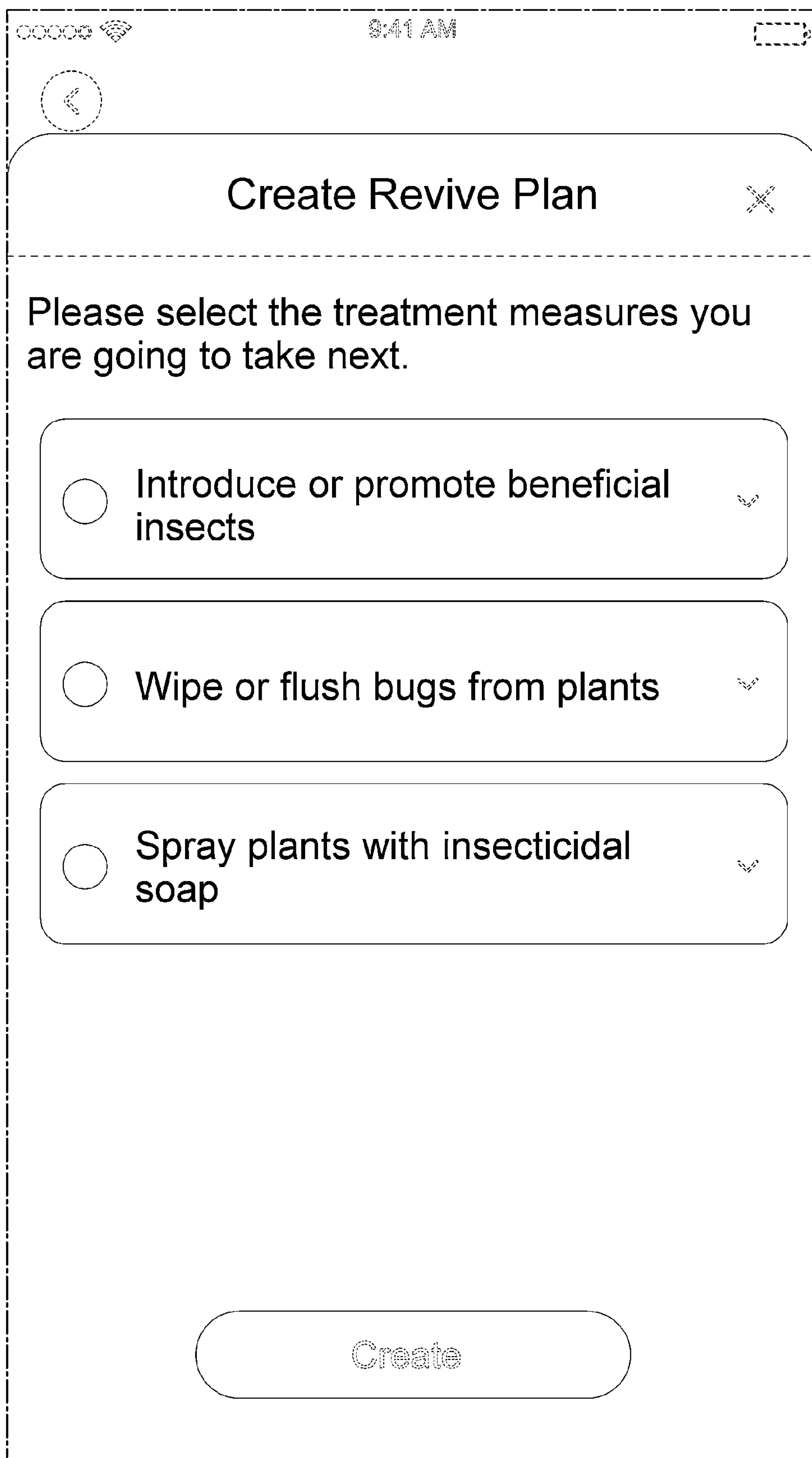

FIG. 3

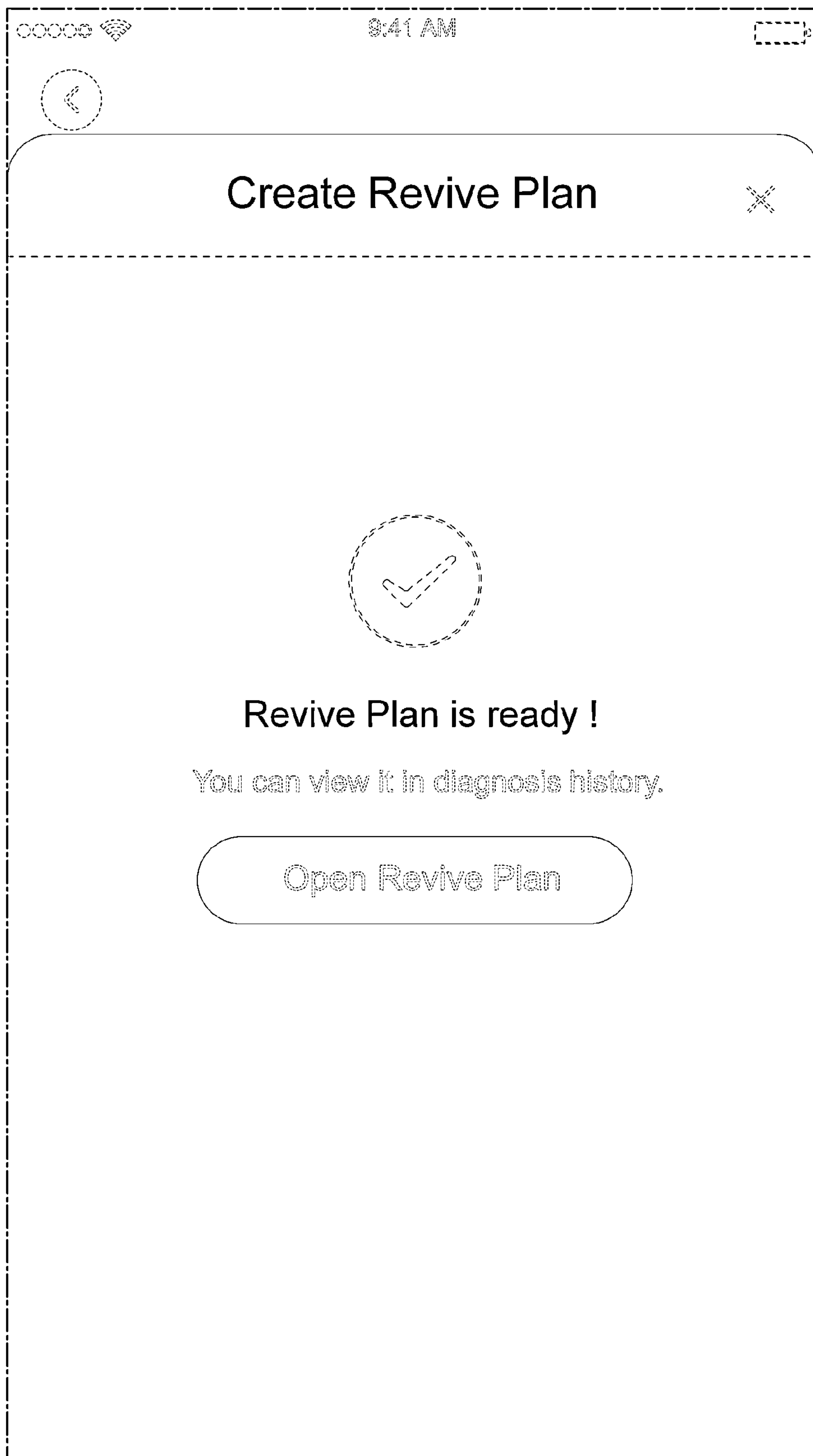

FIG. 4



FIG. 5

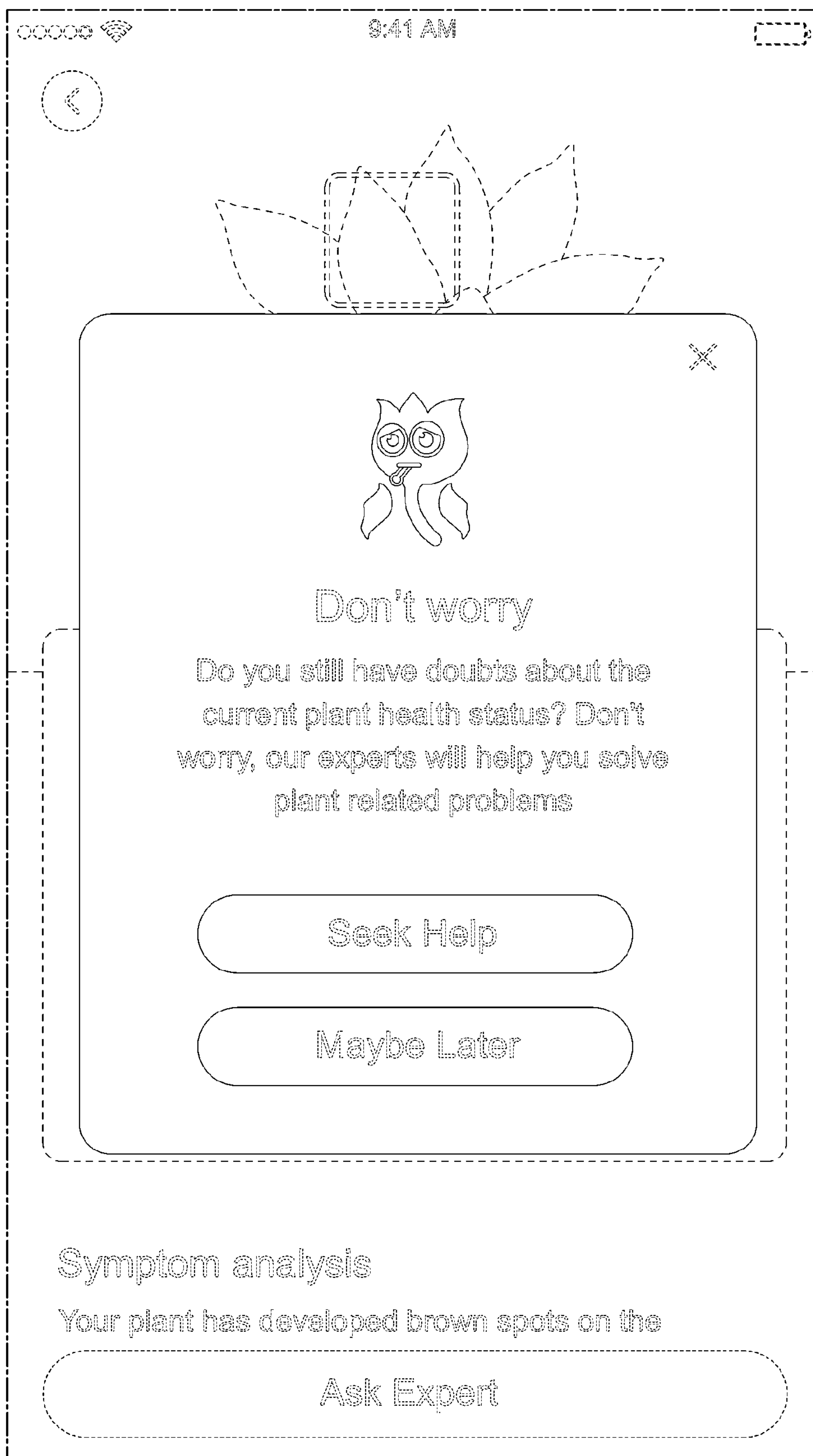

FIG. 6





FIG. 7

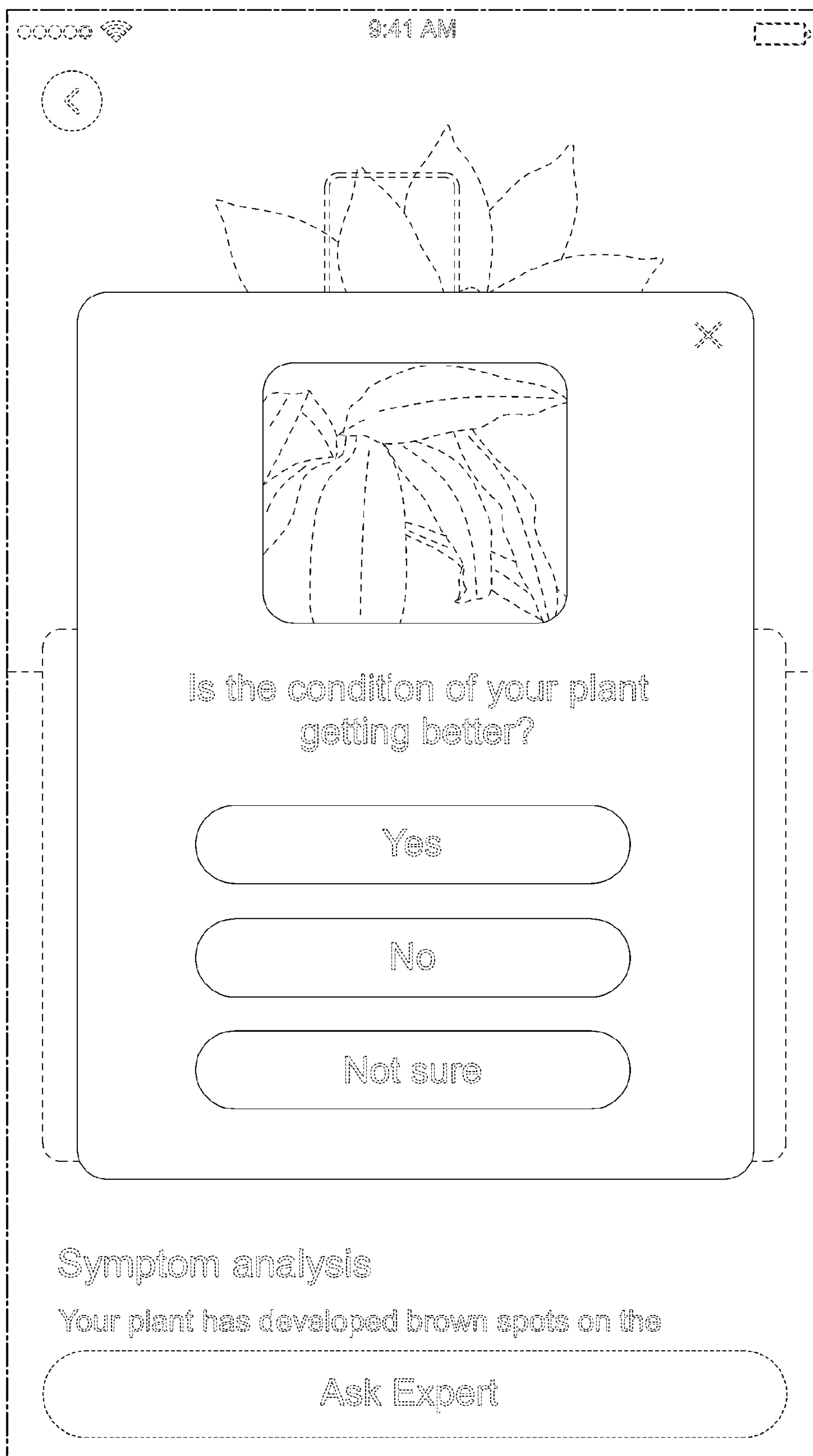

FIG. 8

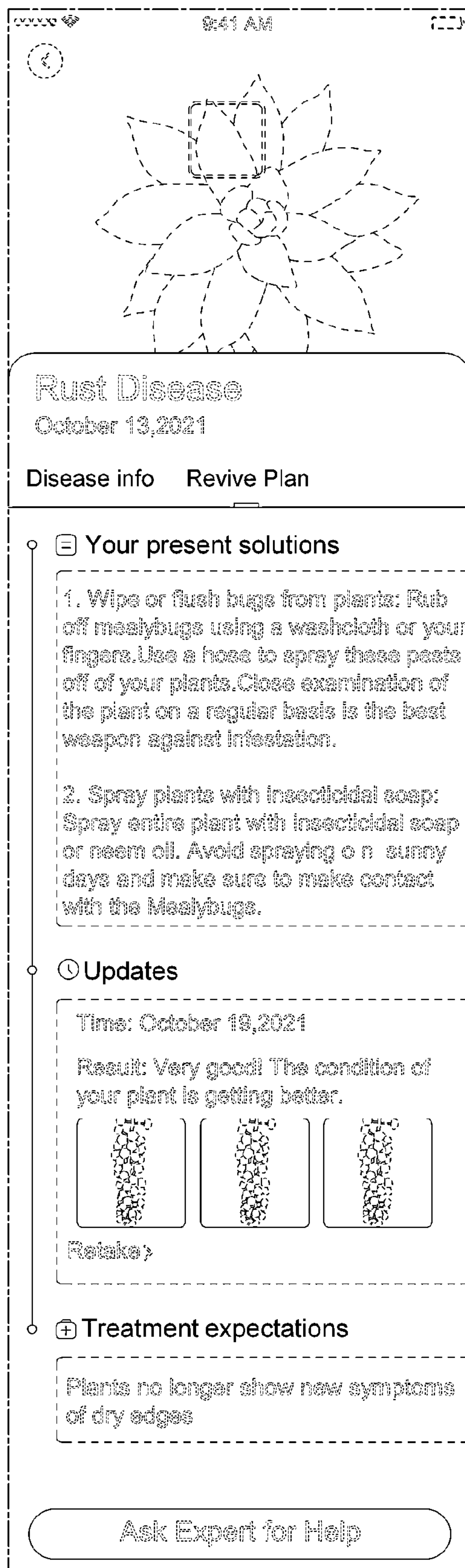

FIG. 9