



US00D967138S

(12) **United States Design Patent**
Sekine et al.

(10) **Patent No.:** **US D967,138 S**
(45) **Date of Patent:** **** Oct. 18, 2022**

(54) **DISPLAY SCREEN WITH TRANSITIONAL GRAPHICAL USER INTERFACE**

(71) Applicant: **Mitsubishi Power, Ltd.**, Kanagawa (JP)

(72) Inventors: **Susumu Sekine**, Yokohama (JP);
Tomoyuki Yamazaki, Tokyo (JP);
Toshiyuki Wada, Tokyo (JP); **Hiroto Akitaya**, Tokyo (JP); **Yutaka Kano**,
Yokohama (JP)

(73) Assignee: **MITSUBISHI HEAVY INDUSTRIES, LTD.**, Tokyo (JP)

(**) Term: **15 Years**

(21) Appl. No.: **29/772,356**

(22) Filed: **Mar. 1, 2021**

(51) **LOC (13) Cl.** **14-04**

(52) **U.S. Cl.**
USPC **D14/485**

(58) **Field of Classification Search**
USPC D14/485–495
CPC G06F 3/048; G06F 3/0481; G06F 3/04817;
G06F 3/0482; G06F 3/0483; G06F
3/04842; G06F 3/0485; G06F 3/04855;
G06F 3/0486; G06F 3/0488; G06F
3/04886; G06F 9/451; G06F 40/103;
G06F 40/106; G06F 40/189; G06F
40/191

See application file for complete search history.

(56) **References Cited**

U.S. PATENT DOCUMENTS

D774,046 S * 12/2016 Konishi D14/485
D800,149 S * 10/2017 Messineo, Jr. D14/486

D809,541 S * 2/2018 Makowski D14/492
D810,109 S * 2/2018 Makowski D14/492
D893,518 S * 8/2020 Ogawa D14/485
D894,205 S * 8/2020 Ogawa D14/485
D908,727 S * 1/2021 Araki D14/486
D925,553 S * 7/2021 Ogawa D14/485
D926,787 S * 8/2021 Ryu D14/485
D926,788 S * 8/2021 Ryu D14/485
D937,846 S * 12/2021 Ogawa D14/485
D937,878 S * 12/2021 Harvey D14/486
D937,879 S * 12/2021 Harvey D14/486

* cited by examiner

Primary Examiner — Nicole C Shiflet

(74) *Attorney, Agent, or Firm* — Wenderoth, Lind & Ponack, L.L.P.

(57) **CLAIM**

The ornamental design for a display screen with transitional graphical user interface, as shown and described.

DESCRIPTION

FIG. 1 is a front view of a first image in a sequence for a display screen with transitional graphical user interface showing our new design; and, FIG. 2 is a front view of a second image thereof. The evenly-spaced broken lines in the drawings depict elements that form no part of the claimed design. The dash-dotted broken line showing of a display screen forms no part of the claimed design. The subject matter of this patent includes a process or period in which an image sequentially transitions into another image. This process or period forms no part of the claimed design.

1 Claim, 2 Drawing Sheets

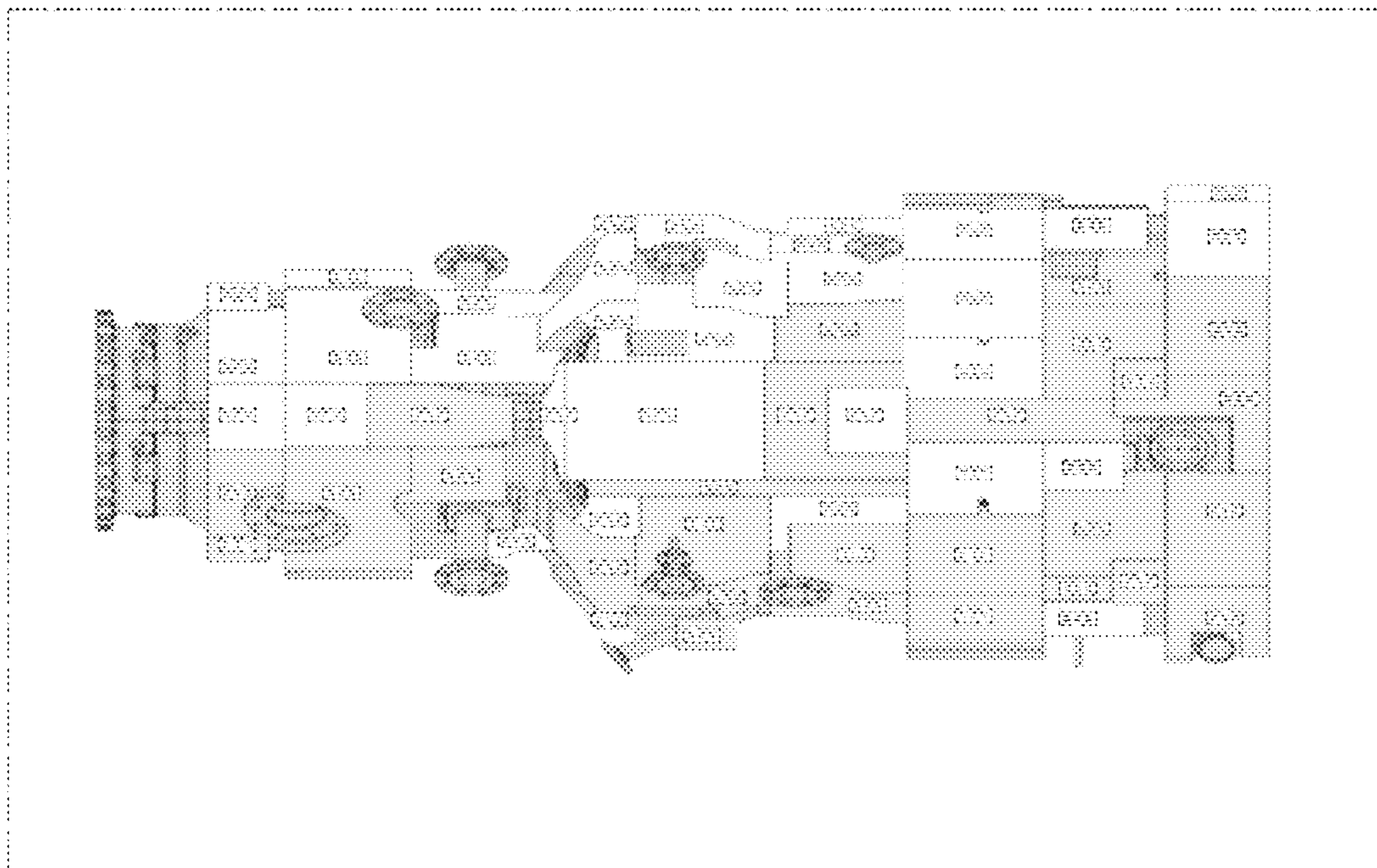

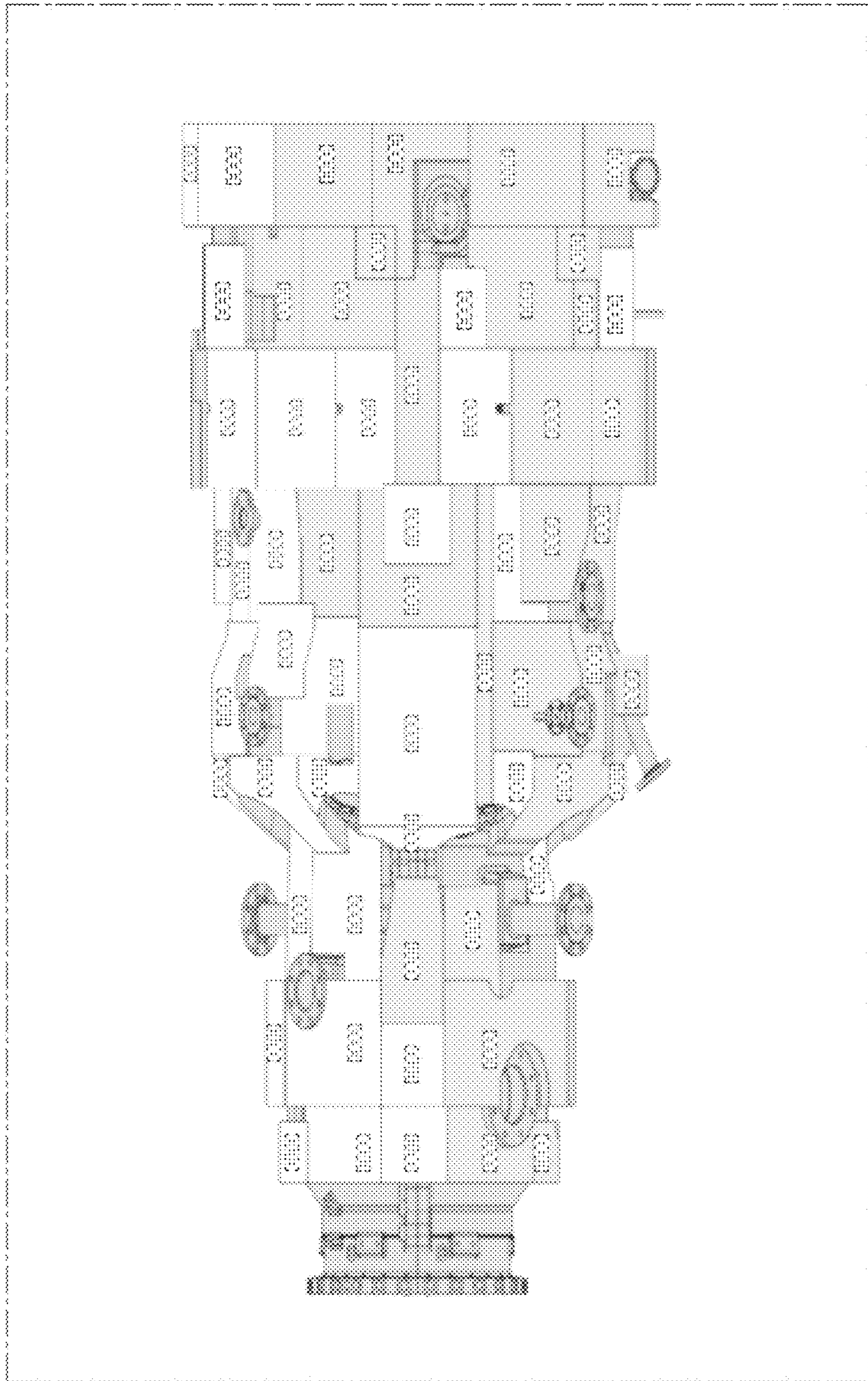
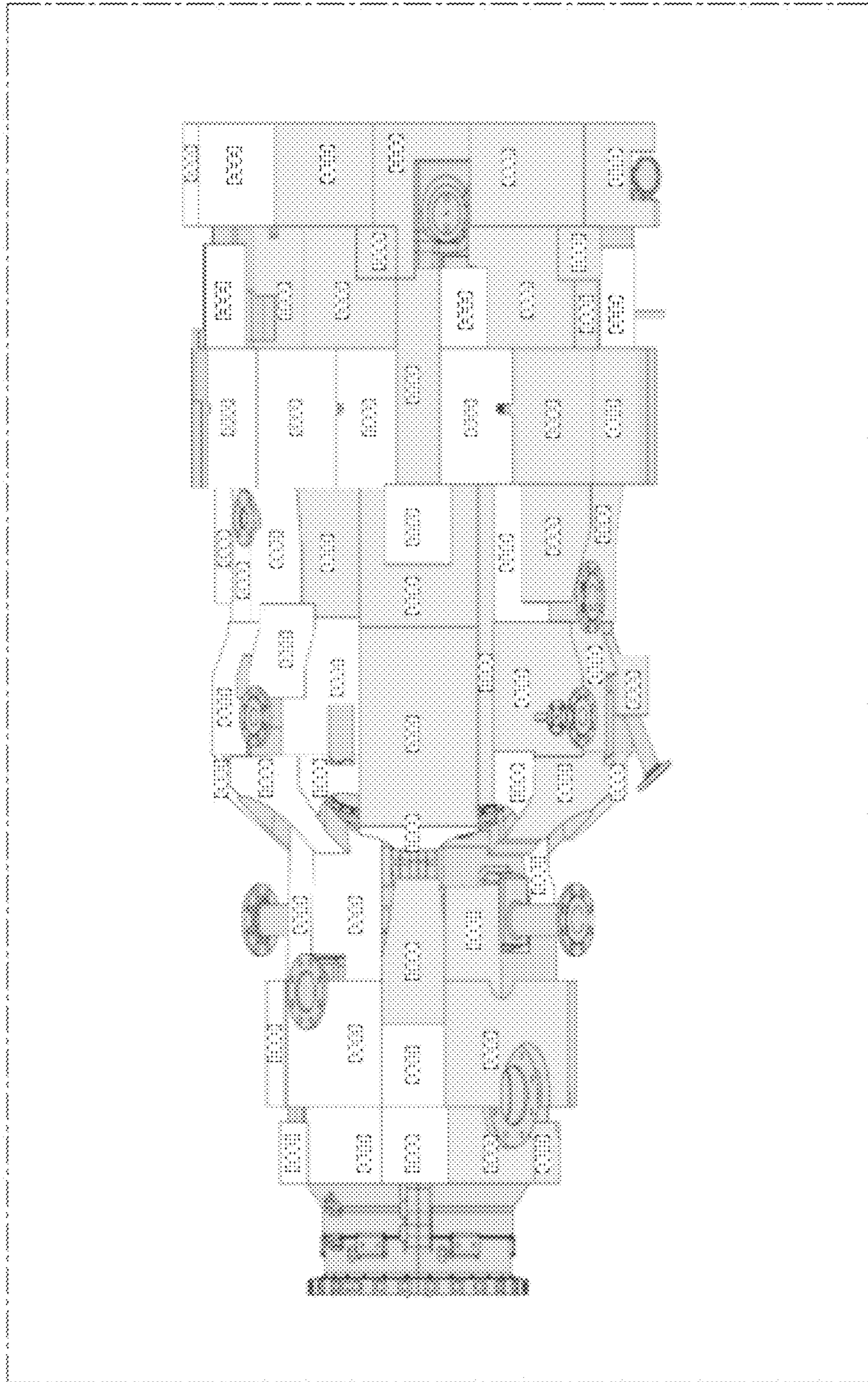

Fig. 1

Fig. 2



UNITED STATES PATENT AND TRADEMARK OFFICE
CERTIFICATE OF CORRECTION

PATENT NO. : D967,138 S
APPLICATION NO. : 29/772356
DATED : October 18, 2022
INVENTOR(S) : Susumu Sekine

Page 1 of 1

It is certified that error appears in the above-identified patent and that said Letters Patent is hereby corrected as shown below:

On the Title Page

Immediately after item (22), please insert the following missing section:

--(30) **Foreign Application Priority Data**
Sept. 2, 2020 (JP) 2020-018669 D--

Signed and Sealed this
Twenty-second Day of August, 2023



Katherine Kelly Vidal
Director of the United States Patent and Trademark Office