



US00D966575S

(12) **United States Design Patent** (10) **Patent No.:** **US D966,575 S**
Lin (45) **Date of Patent:** **** Oct. 11, 2022**

(54) **VEHICLE HEADLIGHT**
(71) Applicant: **KUEN HWA TRAFFIC INDUSTRIAL CO., LTD.**, Tainan (TW)

D851,302 S * 6/2019 Lin D26/28
D869,702 S 12/2019 Dewitt et al.
D875,282 S * 2/2020 Huang D26/28
D906,556 S * 12/2020 Yang D26/28

FOREIGN PATENT DOCUMENTS

(72) Inventor: **Chung-I Lin**, Hsinchu (TW)
(73) Assignee: **Kuen Hwa Traffic Industrial Co., Ltd.**, Tainan (TW)

EM 004496719-0001 * 3/2018
GB 6057798 * 3/2019
IN 309825-0001 * 11/2018
TW D204070 S 4/2020
TW D204072 S 4/2020
TW D204073 S 4/2020

(**) Term: **15 Years**

* cited by examiner

(21) Appl. No.: **29/755,724**

(22) Filed: **Oct. 22, 2020**

Primary Examiner — Brett Miller

(51) **LOC (13) Cl.** **26-06**

Assistant Examiner — Jasmine L. Comedy

(52) **U.S. Cl.**
USPC **D26/28**

(74) *Attorney, Agent, or Firm* — Rosenberg, Klein & Lee

(58) **Field of Classification Search**
USPC D26/24, 28, 29, 34–36, 139; D12/196
CPC B60Q 1/2615; B60Q 1/26; B60Q 1/2619;
B60Q 1/2607; B60Q 1/44; F21S 43/00;
F21S 43/10; F21S 43/13
See application file for complete search history.

(57) **CLAIM**

The ornamental design for a vehicle headlight, as shown and described.

DESCRIPTION

(56) **References Cited**

U.S. PATENT DOCUMENTS

D506,843 S * 6/2005 Lin D26/28
D542,445 S * 5/2007 Matsunami D26/28
D584,436 S * 1/2009 Hsu D26/28
D663,875 S 7/2012 Kono
D718,894 S * 12/2014 Lai D26/28
D759,866 S * 6/2016 Lai D26/35
D774,669 S * 12/2016 Lai D26/28
D787,721 S * 5/2017 Lai D26/28
D802,185 S * 11/2017 Lin D26/28

FIG. 1 is a perspective view of a vehicle headlight showing my present design;
FIG. 2 is a front view thereof;
FIG. 3 is a left view thereof;
FIG. 4 is a top plane view thereof; and,
FIG. 5 is another perspective view thereof.

The dashed lines in the drawings illustrate portions of the vehicle headlight which form no part of the claimed design. The dashed-dotted lines in the drawings depict portions of a vehicle body which represent environmental structure and form no part of the claimed design.

1 Claim, 5 Drawing Sheets

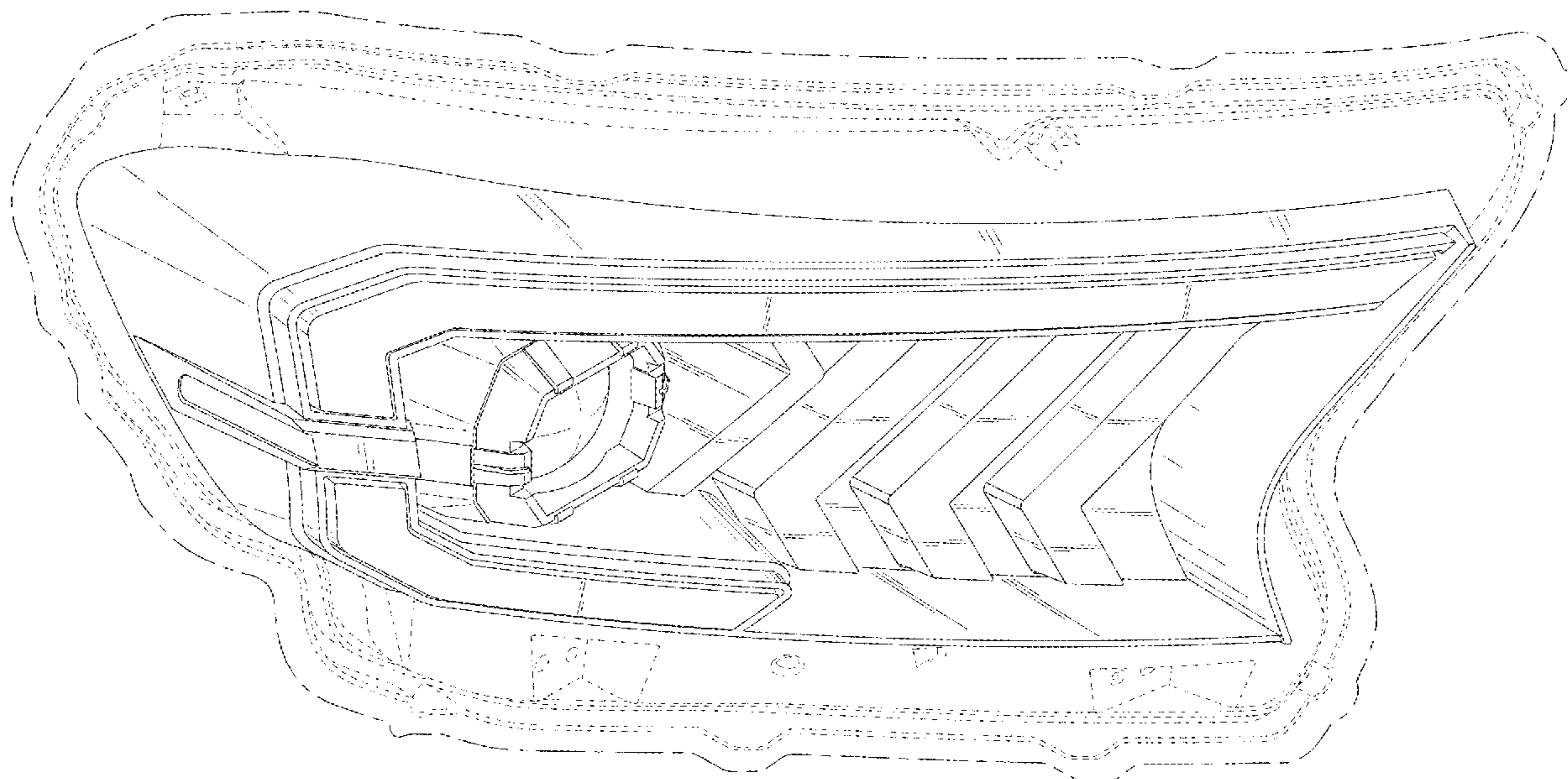

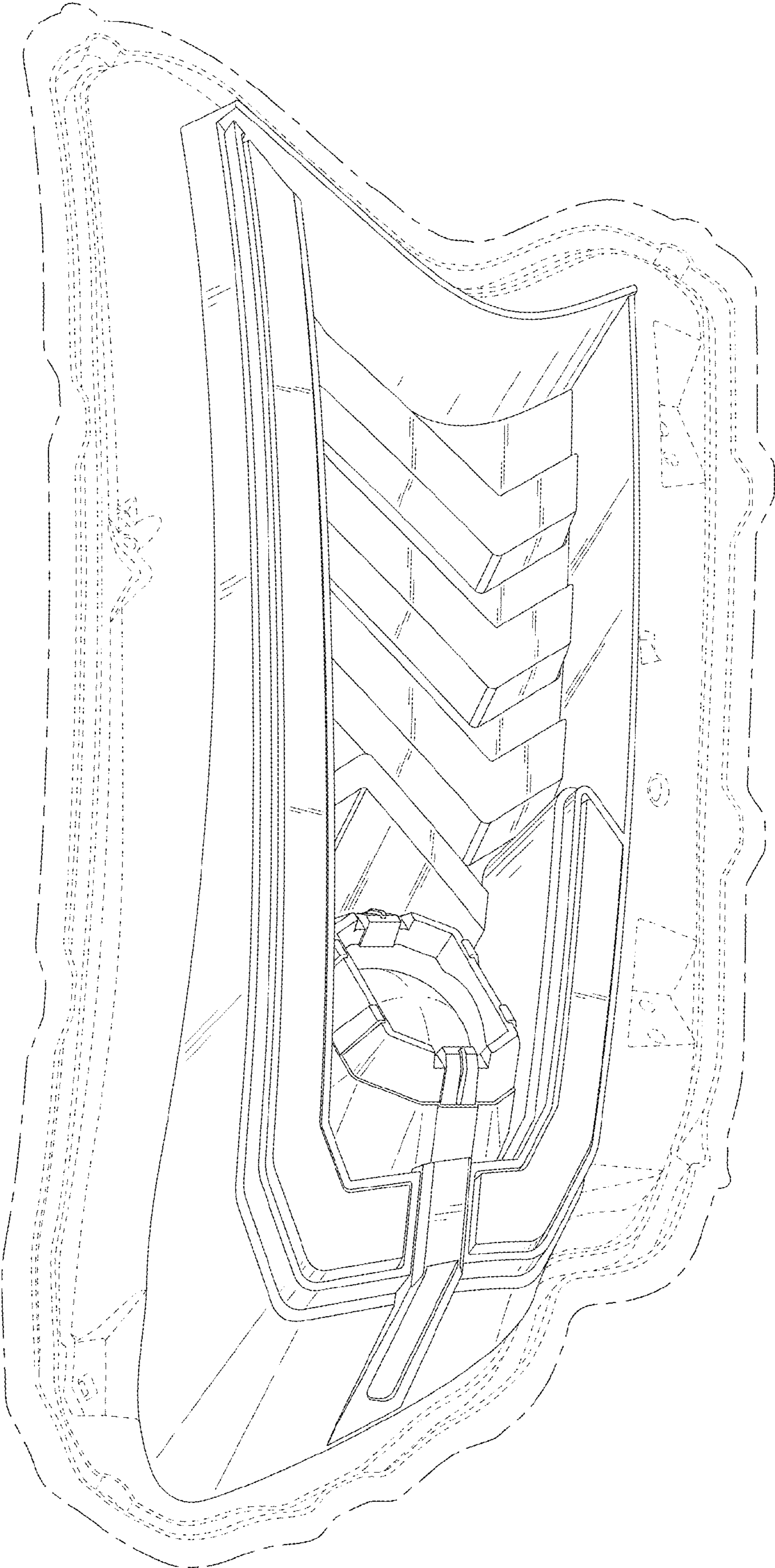

FIG. 1

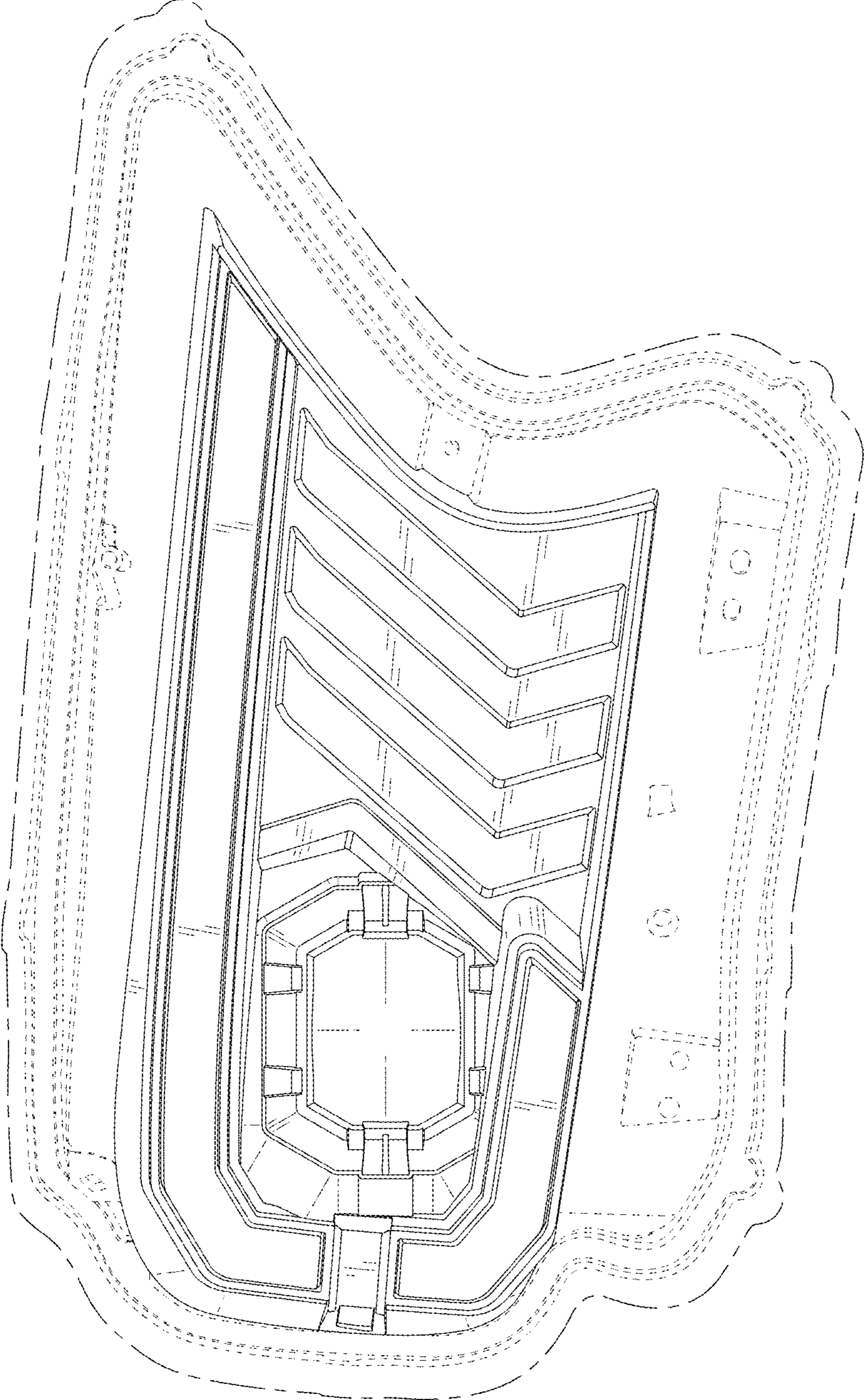

FIG. 2

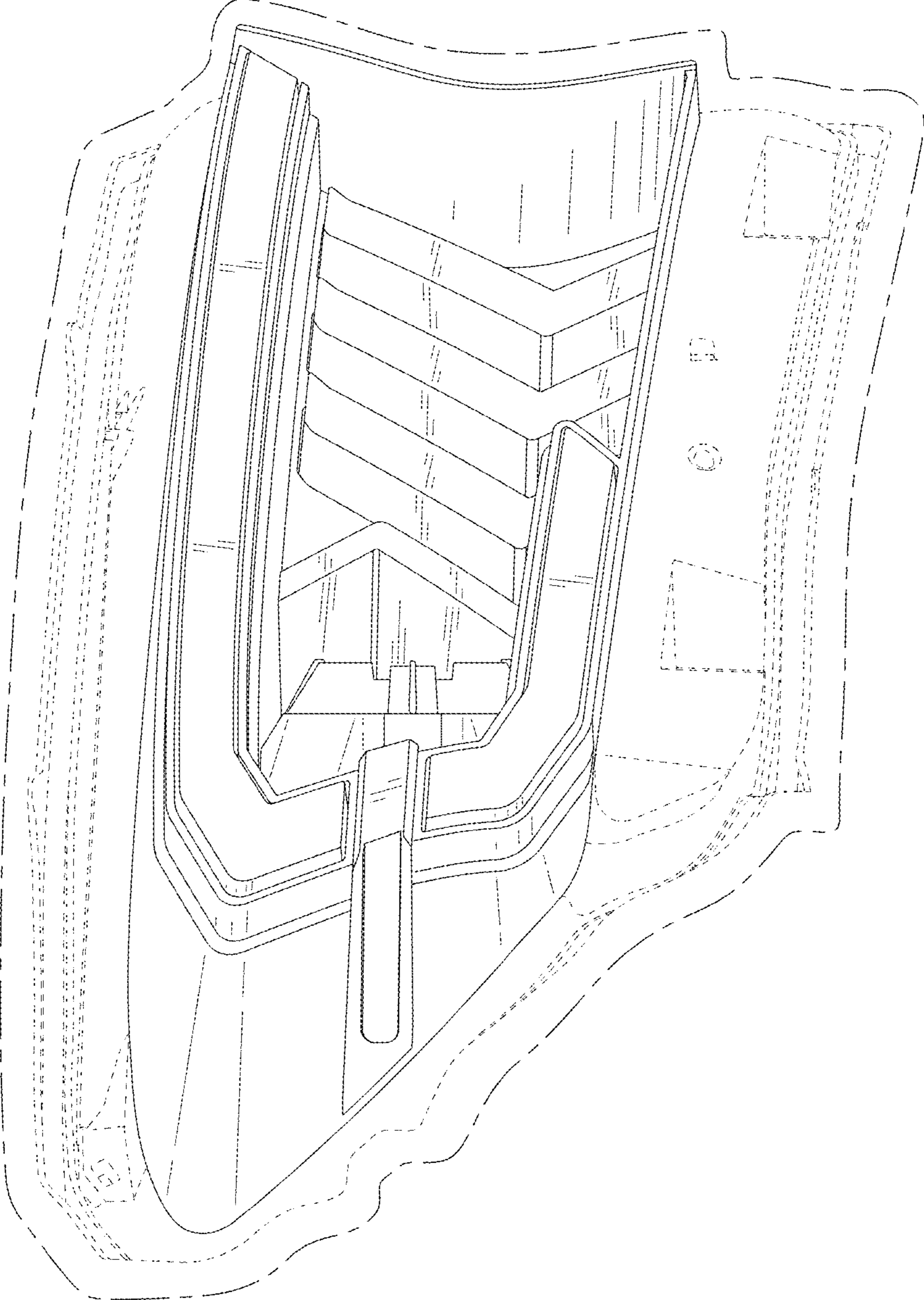

FIG. 3

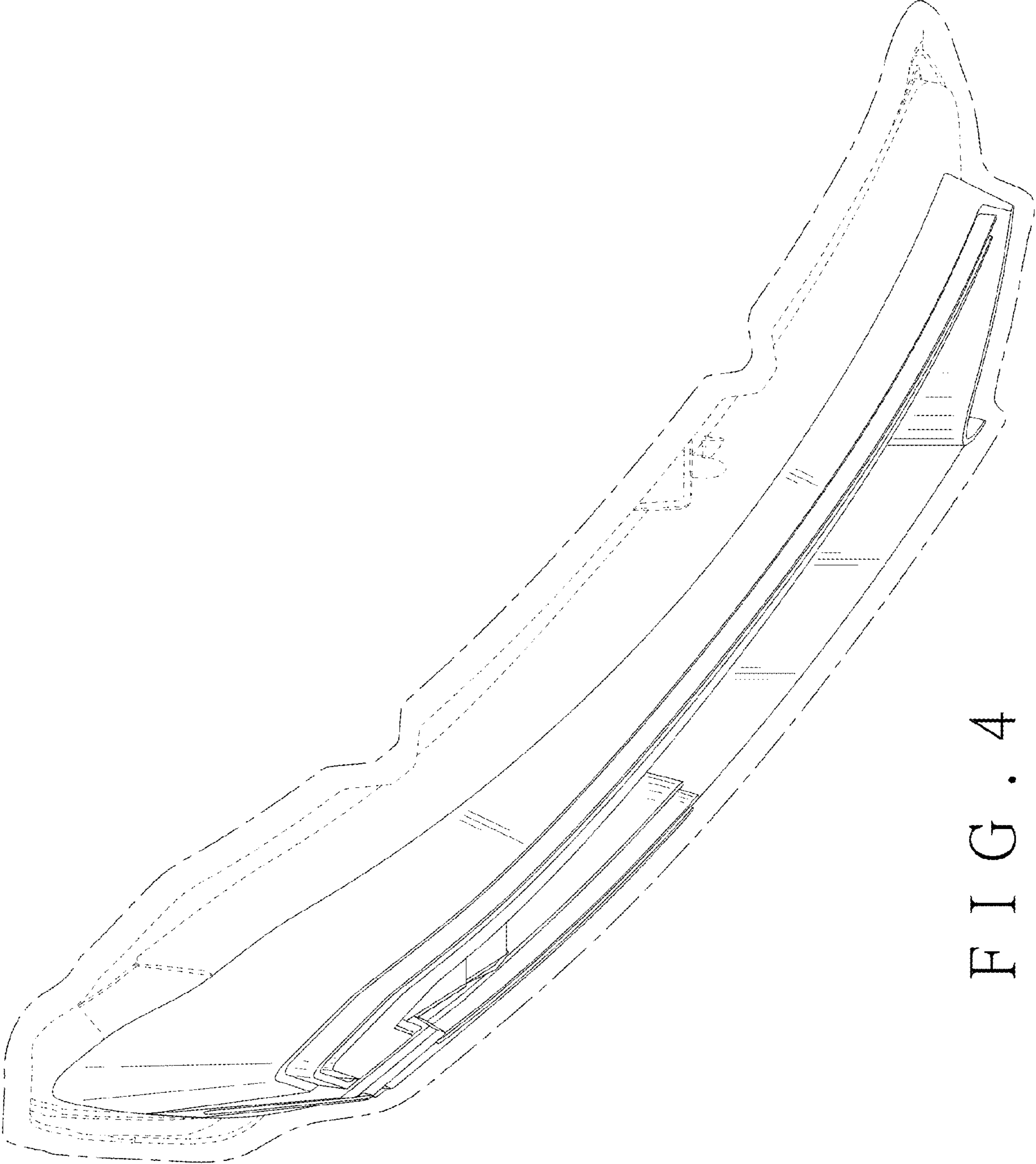

FIG. 4

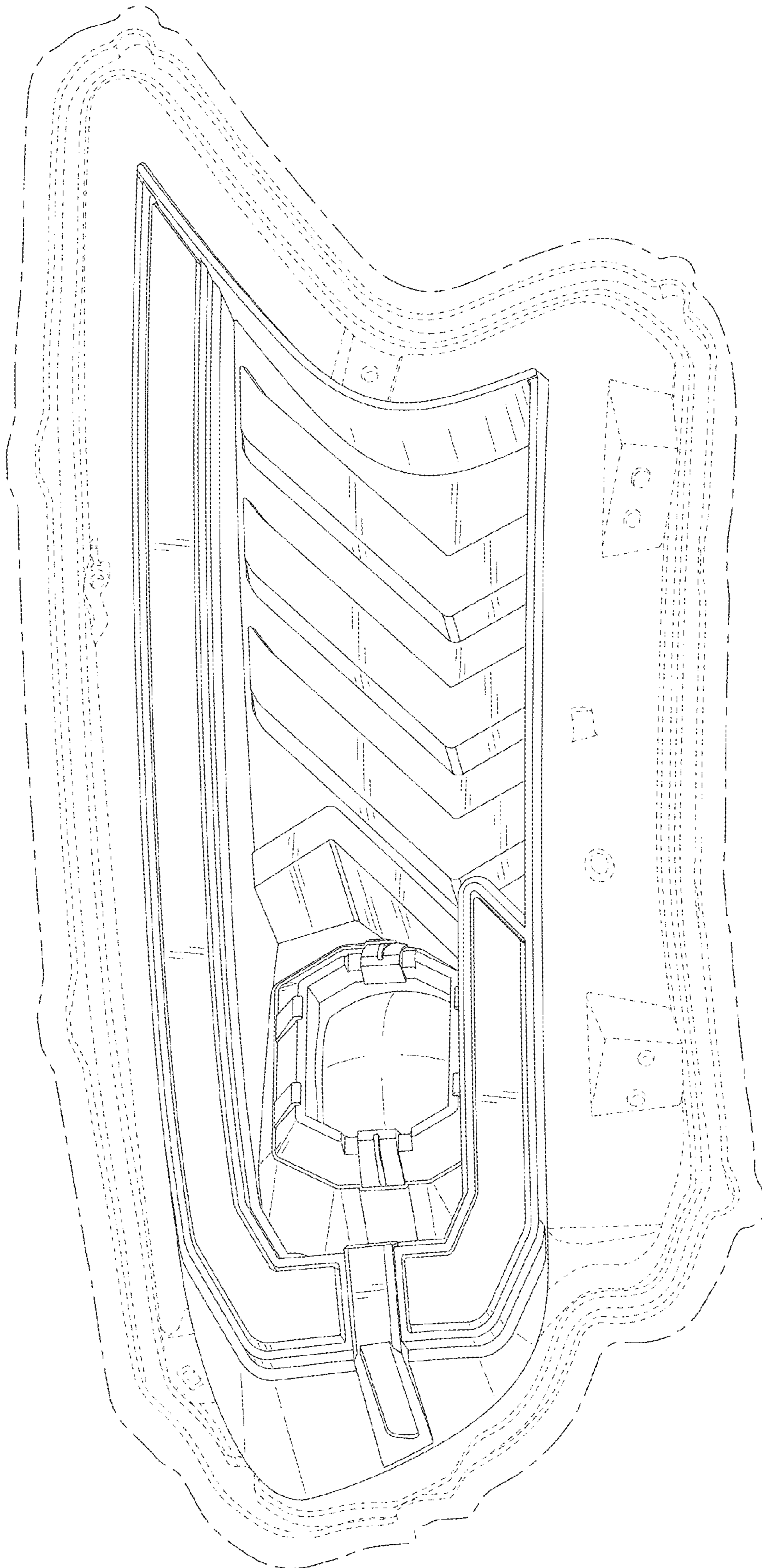

FIG. 5