



US00D966341S

(12) **United States Design Patent** (10) **Patent No.:** **US D966,341 S**  
**Shehan et al.** (45) **Date of Patent:** **\*\* Oct. 11, 2022**

(54) **EFI THROTTLE BODY**  
(71) Applicant: **Holley Performance Products, Inc.**,  
Bowling Green, KY (US)  
(72) Inventors: **Laura Shehan**, Bowling Green, KY  
(US); **Amy Gieske**, Loogootee, IN  
(US); **Jonathan Sams**, Woodburn, KY  
(US); **Adam Layman**, Alvaton, KY  
(US)

4,246,875 A 1/1981 Bier et al.  
4,294,282 A 10/1981 McCabe et al.  
4,306,441 A 12/1981 Dodson  
4,318,214 A 3/1982 Dodson  
4,325,339 A 4/1982 Bier et al.  
4,357,283 A 11/1982 Manning  
4,434,762 A 3/1984 McCabe  
4,434,763 A 3/1984 McCabe et al.

(Continued)

**FOREIGN PATENT DOCUMENTS**

(73) Assignee: **Holley Performance Products, Inc.**,  
Bowling Green, KY (US)

AU 2001014879 8/2001  
AU 339157 10/2011

(Continued)

(\*\*) Term: **15 Years**

**OTHER PUBLICATIONS**

(21) Appl. No.: **29/787,922**

Transmittal Letter of Related Cases dated Mar. 6, 2019.

(22) Filed: **Jun. 9, 2021**

(Continued)

**Related U.S. Application Data**

(62) Division of application No. 29/628,392, filed on Dec.  
4, 2017, now Pat. No. Des. 924,273.

(51) **LOC (13) Cl.** ..... **15-01**

(52) **U.S. Cl.**  
USPC ..... **D15/5**

(58) **Field of Classification Search**  
USPC ..... D8/349, 352, 354, 356, 357, 366, 380,  
D8/382, 383, 394, 396, 499; D12/87,  
D12/223; D15/1-7; D23/322, 323  
CPC ..... F02M 69/043; F02M 51/005; F02M  
63/0056; F02D 9/1035; F02D 9/105  
See application file for complete search history.

*Primary Examiner* — Michael C Stout

*Assistant Examiner* — Fritzgerald L Butac

(74) *Attorney, Agent, or Firm* — Middleton Reutlinger

(57) **CLAIM**

The ornamental design for an EFI throttle body, as shown  
and described.

**DESCRIPTION**

FIG. 1 is an upper perspective view of an EFI throttle body;  
FIG. 2 is a top view thereof;  
FIG. 3 is a bottom view thereof;  
FIG. 4 is a first side view thereof;  
FIG. 5 is a second side view thereof;  
FIG. 6 is a rear view thereof;  
FIG. 7 is a front view thereof; and,  
FIG. 8 is a lower perspective view thereof.  
The broken lines show portions of an EFI throttle body  
which form no part of the claimed design.

(56) **References Cited**

**U.S. PATENT DOCUMENTS**

4,186,708 A 2/1980 Bowler  
4,224,908 A 9/1980 Bier et al.  
4,230,645 A 10/1980 Dodson  
4,235,375 A 11/1980 Melotti

**1 Claim, 8 Drawing Sheets**

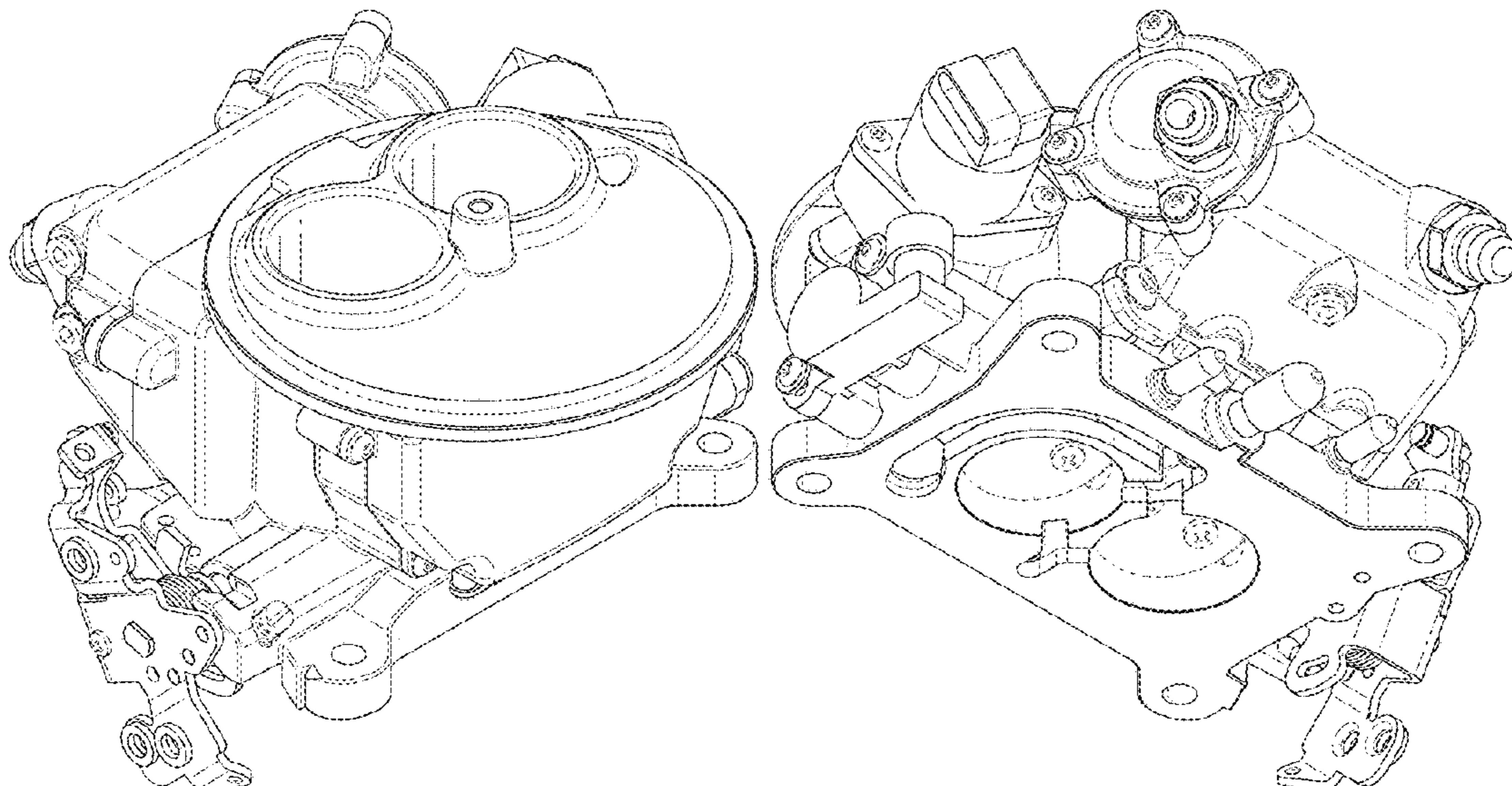

(56)

References Cited

OTHER PUBLICATIONS

U.S. PATENT DOCUMENTS

4,556,032	A	12/1985	Miller	
4,949,983	A	8/1990	Miller	
5,261,382	A	11/1993	Nikolai	
D447,147	S	8/2001	Grant	
D456,421	S	4/2002	Braswell	
D456,818	S	5/2002	Braswell	
D457,168	S	5/2002	Braswell	
6,481,698	B1	11/2002	Calvin et al.	
6,874,768	B2	4/2005	Grant	
D508,496	S	8/2005	Grant	
D517,423	S	3/2006	Jeschke	
D543,555	S	5/2007	Braswell et al.	
D555,668	S	11/2007	Benoit	
D578,550	S	10/2008	Benoit	
7,533,661	B2	5/2009	Baasch	
7,591,245	B2	9/2009	Baasch et al.	
7,658,177	B2	2/2010	Baasch et al.	
D645,058	S	9/2011	Benoit	
D648,746	S	11/2011	Tipton et al.	
D649,979	S	12/2011	Gieske	
D655,311	S	3/2012	Gieske et al.	
D659,714	S	5/2012	Gieske et al.	
D721,389	S	1/2015	Gieske	
9,115,671	B2	8/2015	Benoit	
D748,149	S	1/2016	Laws	
9,303,578	B2	4/2016	Wittkopf et al.	
9,376,997	B1	6/2016	Farrell et al.	
D760,804	S	7/2016	Shehan et al.	
9,482,198	B1	11/2016	Farrell et al.	
9,845,740	B2	12/2017	Wittkopf et al.	
D808,435	S	1/2018	Shehan et al.	
D810,142	S	2/2018	Shehan et al.	
10,012,197	B2	7/2018	Flynn et al.	
D826,280	S	8/2018	Koo et al.	
10,094,353	B2	10/2018	Bennett et al.	
D877,201	S	3/2020	Shehan	
D902,254	S *	11/2020	Whittle	D15/5
D902,257	S *	11/2020	Whittle	D15/6
D921,049	S	6/2021	Shehan	
D924,273	S	7/2021	Shehan	
D925,606	S *	7/2021	Shehan	D15/5
D933,713	S *	10/2021	Bell	D15/5
D938,993	S *	12/2021	Bell	D15/5
D938,994	S *	12/2021	Bell	D15/5
2008/0230034	A1	9/2008	Dunn	
2009/0013955	A1	1/2009	Sheridan et al.	
2013/0054121	A1	2/2013	Casoni et al.	
2013/0298871	A1	11/2013	Bennett et al.	
2017/0198672	A1	7/2017	Farrell et al.	
2018/0119656	A1	5/2018	Shehan et al.	
2019/0170069	A1	6/2019	Shehan et al.	
2019/0170070	A1	6/2019	Shehan	

FOREIGN PATENT DOCUMENTS

AU	341133	2/2012
AU	348732	5/2013
AU	348733	5/2013
AU	348734	5/2013
AU	356762	8/2014
AU	201710470	2/2017
AU	201710471	2/2017
AU	2013254906	11/2017
AU	201813353	8/2018
AU	201813355	8/2018
AU	201815034	9/2018
AU	201816623	12/2018
AU	201816624	12/2018
CA	2391589	5/2001
CN	101568711	4/2013
EM	003729599	1/2017

U.S. Appl. No. 16/208,231 entitled "Electronic Fuel Injection Throttle Body Assembly" filed Dec. 3, 2018.  
 Two-Barrel Fuel Injection Systems, posted on summitracing.com, Earliest reviewed on Mar. 5, 2018, no production date given [online]. [site visited Mar. 1, 2020], Available from Internet, URL: <https://www.summitracing.com/parts/sne-550-849k?seid=srese1&gclid=CjwKCAiA-vLyBRBWEiwAzOkGVMWU7u1iKHcPBsiPrRn> (Year: 2018).  
 Australian Divisional Design Patent Application No. 201815034 entitled "EFI Throttle Body" filed Aug. 23, 2018.  
 Holley Performance Products, Inc., 2017 New & Hot Products Catalogue—Carburetors, Nov. 1, 2016.  
 U.S. Appl. No. 62/594,526 entitled "Electronic Fuel Injection Throttle Body Assembly" filed Dec. 4, 2017.  
 Australian Patent Application No. 2017251869 entitled "Electronic Fuel Injection Throttle Body Assembly" filed Oct. 30, 2017.  
 U.S. Appl. No. 62/594,527 entitled "Electronic Fuel Injection Throttle Body Assembly" filed Dec. 4, 2017.  
 U.S. Appl. No. 29/628,394 entitled "EFI Throttle Body" filed Dec. 4, 2017.  
 U.S. Appl. No. 62/669,052 entitled "Electronic Fuel Injection Throttle Body Assembly" filed May 9, 2018.  
 U.S. Appl. No. 15/986,571 entitled "Fuel Injection Throttle Body" filed May 22, 2018.  
 U.S. Appl. No. 29/647,060 entitled "Electronic Fuel Injection Throttle Body" filed May 9, 2018.  
 U.S. Appl. No. 29/647,068 entitled "Electronic Fuel Injection Throttle Body" filed May 9, 2018.  
 U.S. Appl. No. 62/669,094 entitled "Electronic Fuel Injection Throttle Body Assembly" filed May 9, 2018.  
 U.S. Appl. No. 62/726,723 entitled "Electronic Fuel Injection Throttle Body Assembly" filed Sep. 4, 2018.  
 Australian Patent Application No. 201815036 entitled "EFI Throttle Body" filed Aug. 23, 2018.  
 U.S. Appl. No. 29/688,819 entitled "Electronic Fuel Injection Throttle Body" filed Apr. 24, 2019.  
 U.S. Appl. No. 29/693,670 entitled "Electronic Fuel Injection Throttle Body Assembly" filed Jun. 1, 2019.  
 U.S. Appl. No. 29/695,154 entitled "EFI Throttle Body Assembly" filed Jun. 17, 2019.  
 U.S. Appl. No. 29/696,092 entitled "Electronic Fuel Injection Throttle Body" filed Jun. 25, 2019.  
 Canadian Design Patent Application No. 184483 entitled "Electronic Fuel Injection Throttle Body" filed Oct. 31, 2018.  
 Canadian Design Patent Application No. 184482 entitled "Electronic Fuel Injection Throttle Body" filed Oct. 31, 2018.  
 International Search Report and Written Opinion for PCT/US2018/063660 dated Mar. 20, 2019.  
 International Search Report and Written Opinion for PCT/US2018/063668 dated Mar. 20, 2019.  
 Mexican Design Patent Application No. MX/f/2018/003332 entitled "Electronic Fuel Injection Throttle Body" filed No. 8, 2018.  
 Mexican Design Patent Application No. MX/f/2018/003333 entitled "Electronic Fuel Injection Throttle Body" filed Nov. 8, 2018.  
 U.S. Appl. No. 16/404,308 entitled "Electronic Fuel Injection Throttle Body Assembly" filed May 6, 2019.  
 U.S. Appl. No. 16/405,519 entitled "Electronic Fuel Injection Throttle Body Assembly" filed May 7, 2019.  
 International Search Report and Written Opinion for PCT/US2019/030909 dated Aug. 20, 2019.  
 International Search Report and Written Opinion for PCT/US2019/031138 dated Aug. 27, 2019.  
 Youtube video, "Holley Terminator EFI Kit Electronic Fuel Injection", May 6, 2015 Retrieved from <https://www.youtube.com/watch?v=hrTppUkNAn0>; retrieved on Jul. 1, 2019.

\* cited by examiner

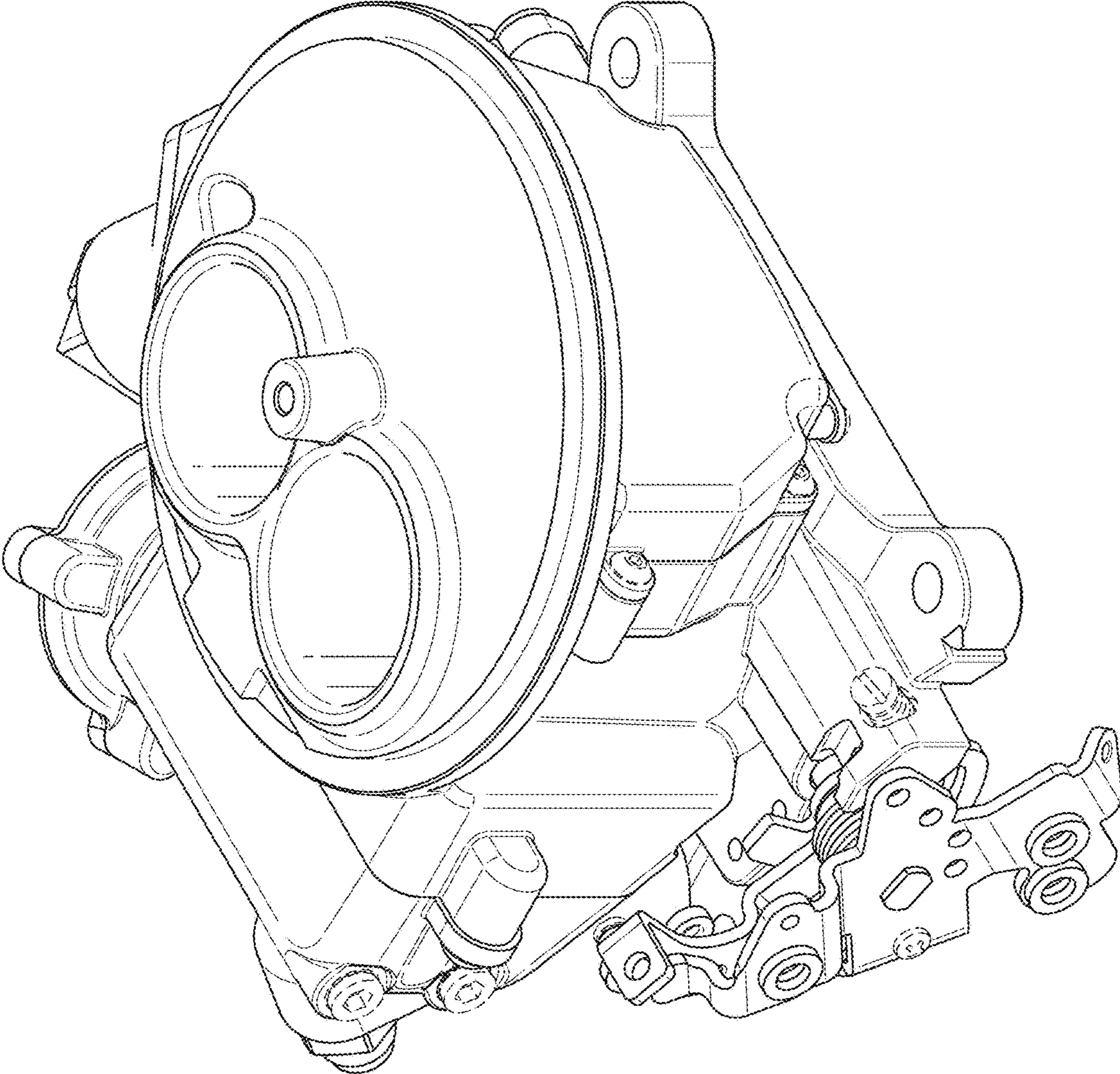

FIG. 1

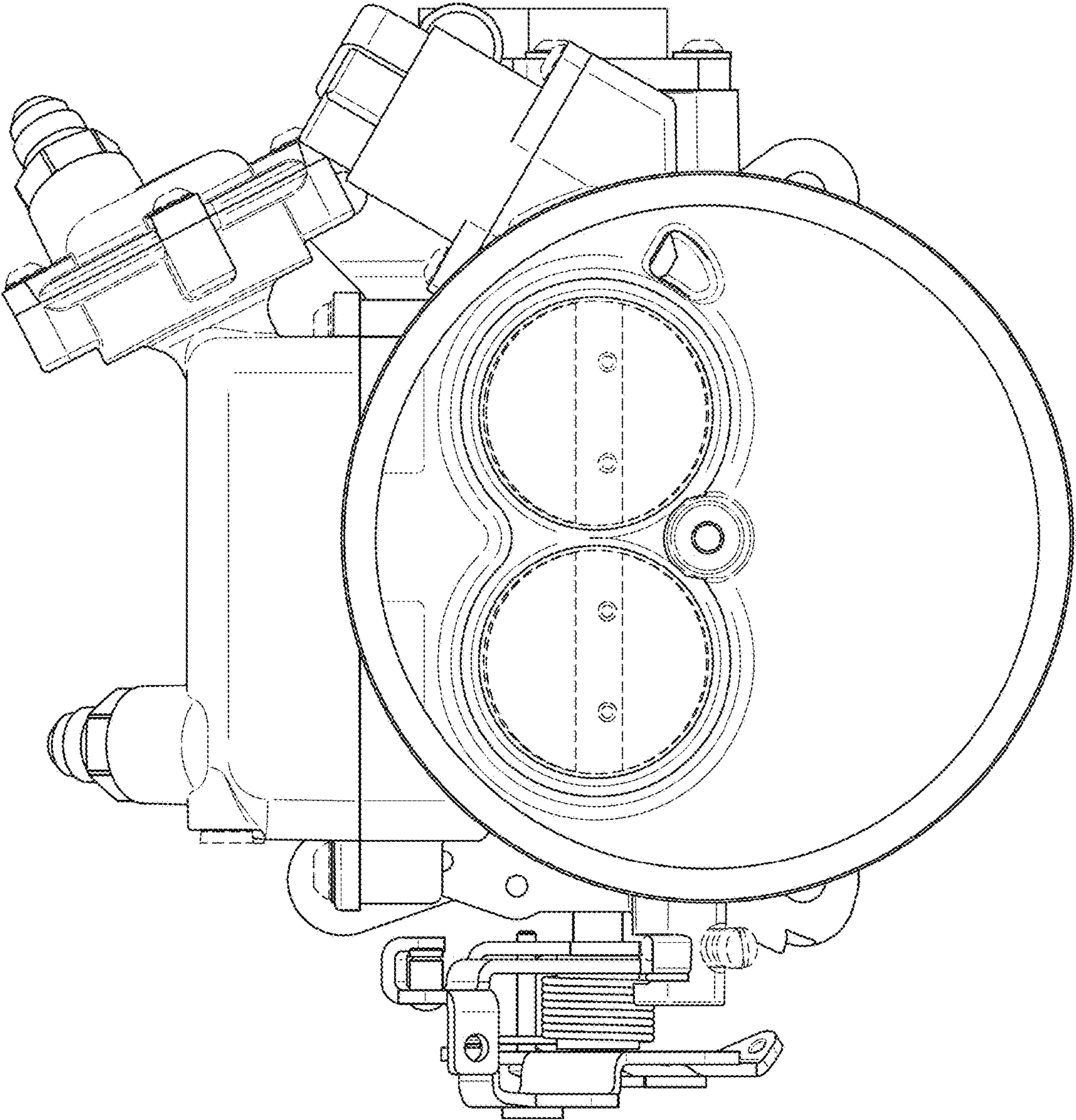

FIG. 2

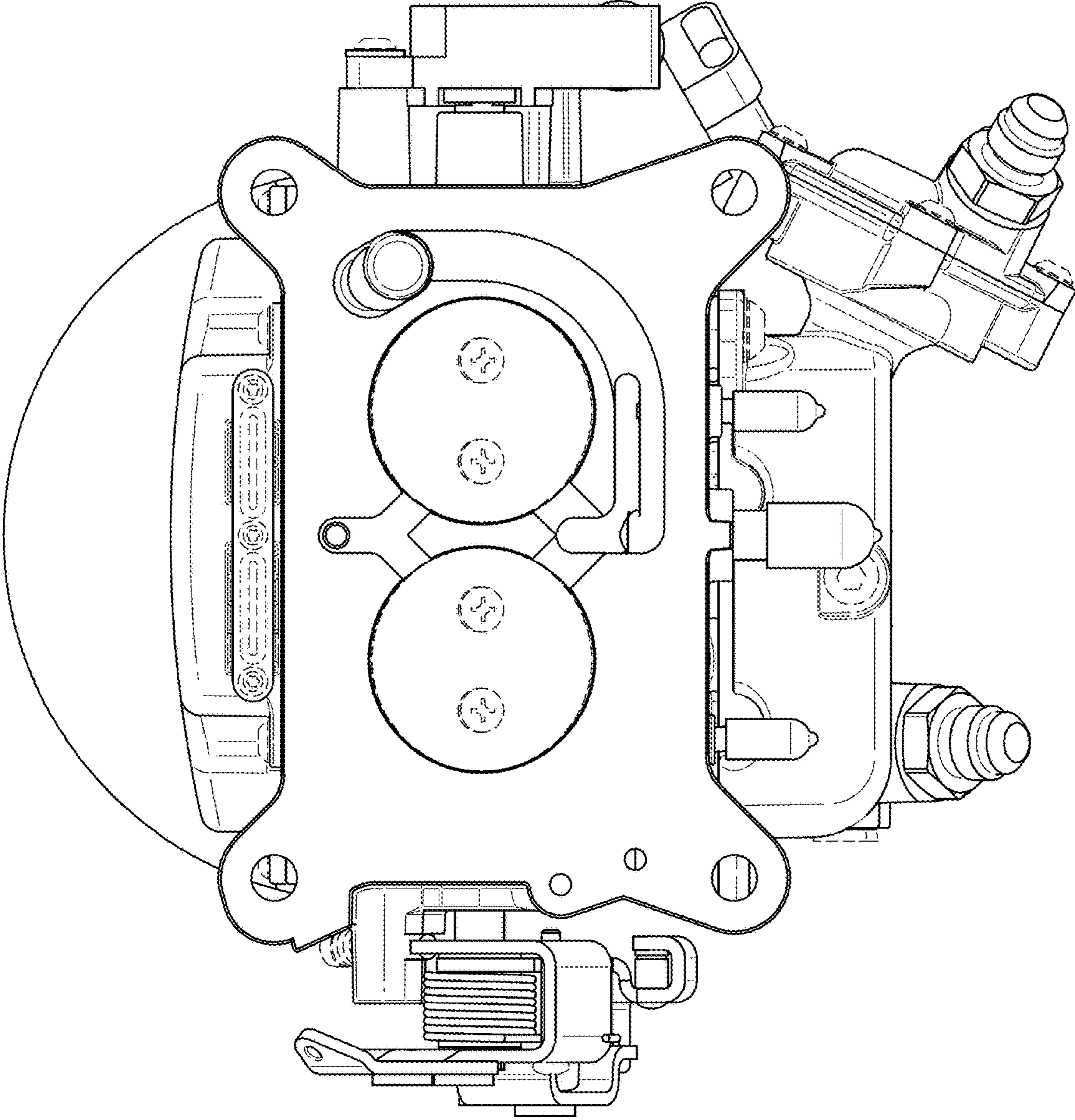

FIG. 3

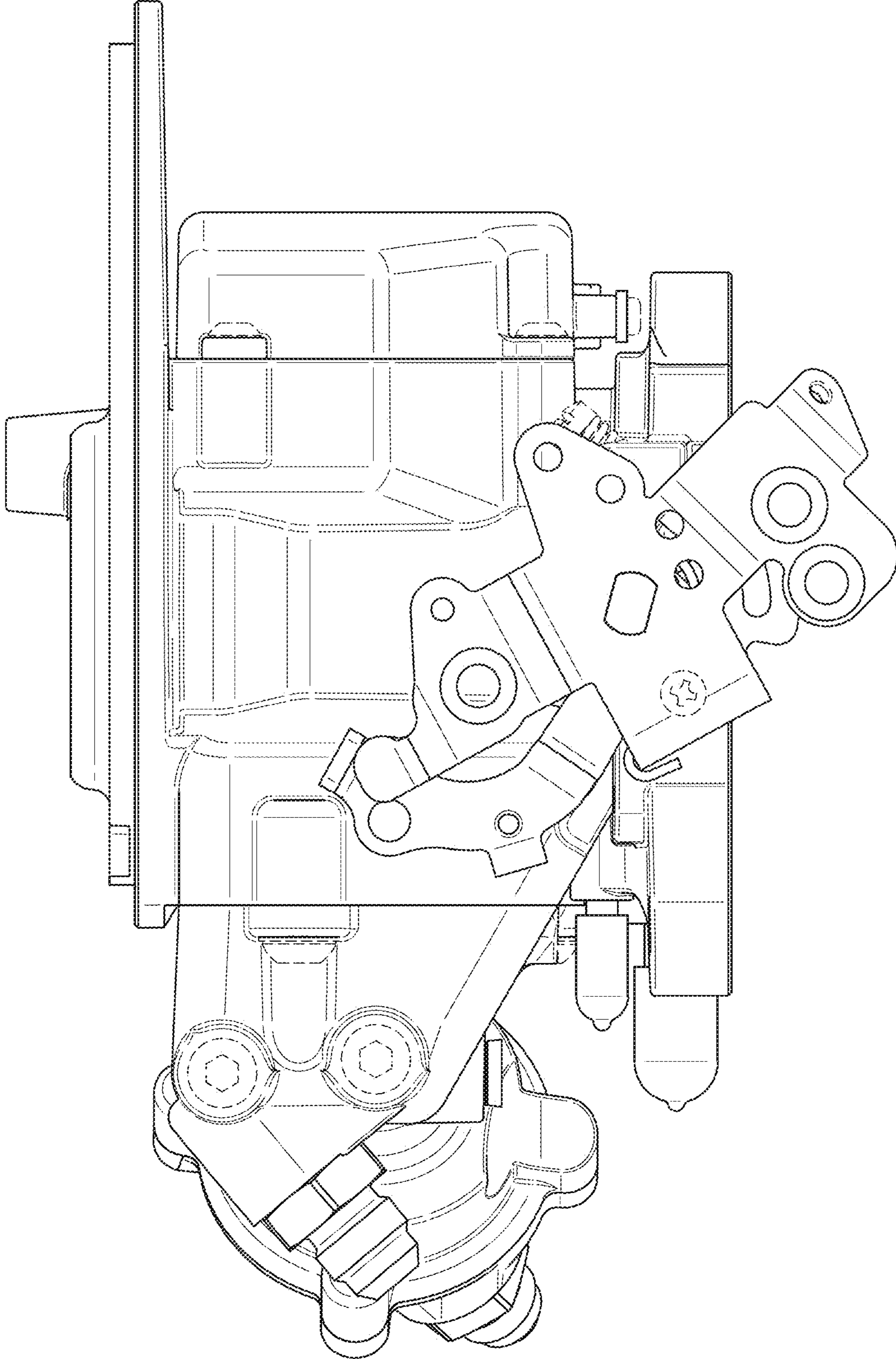

FIG. 4

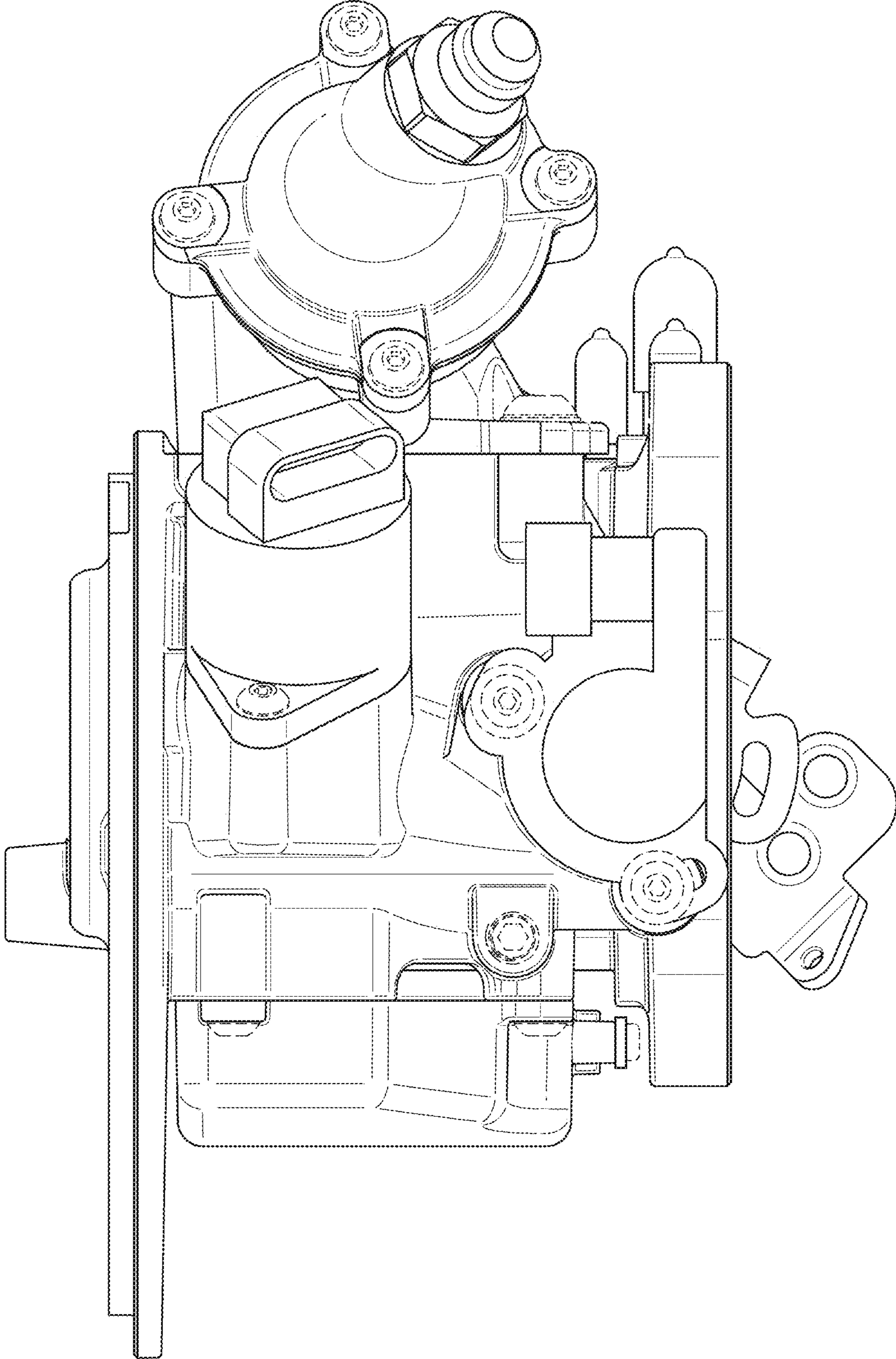

FIG. 5

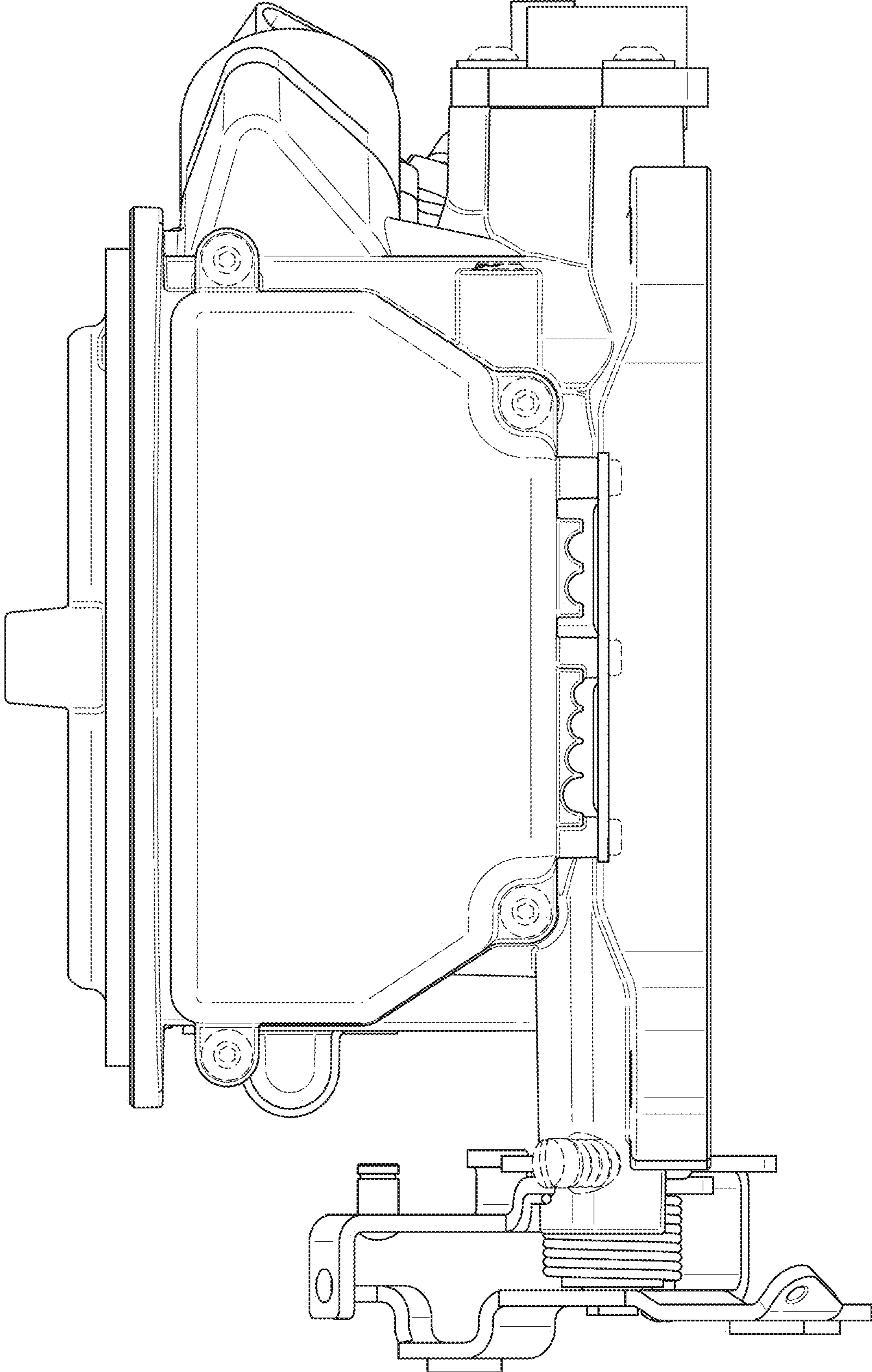

FIG. 6



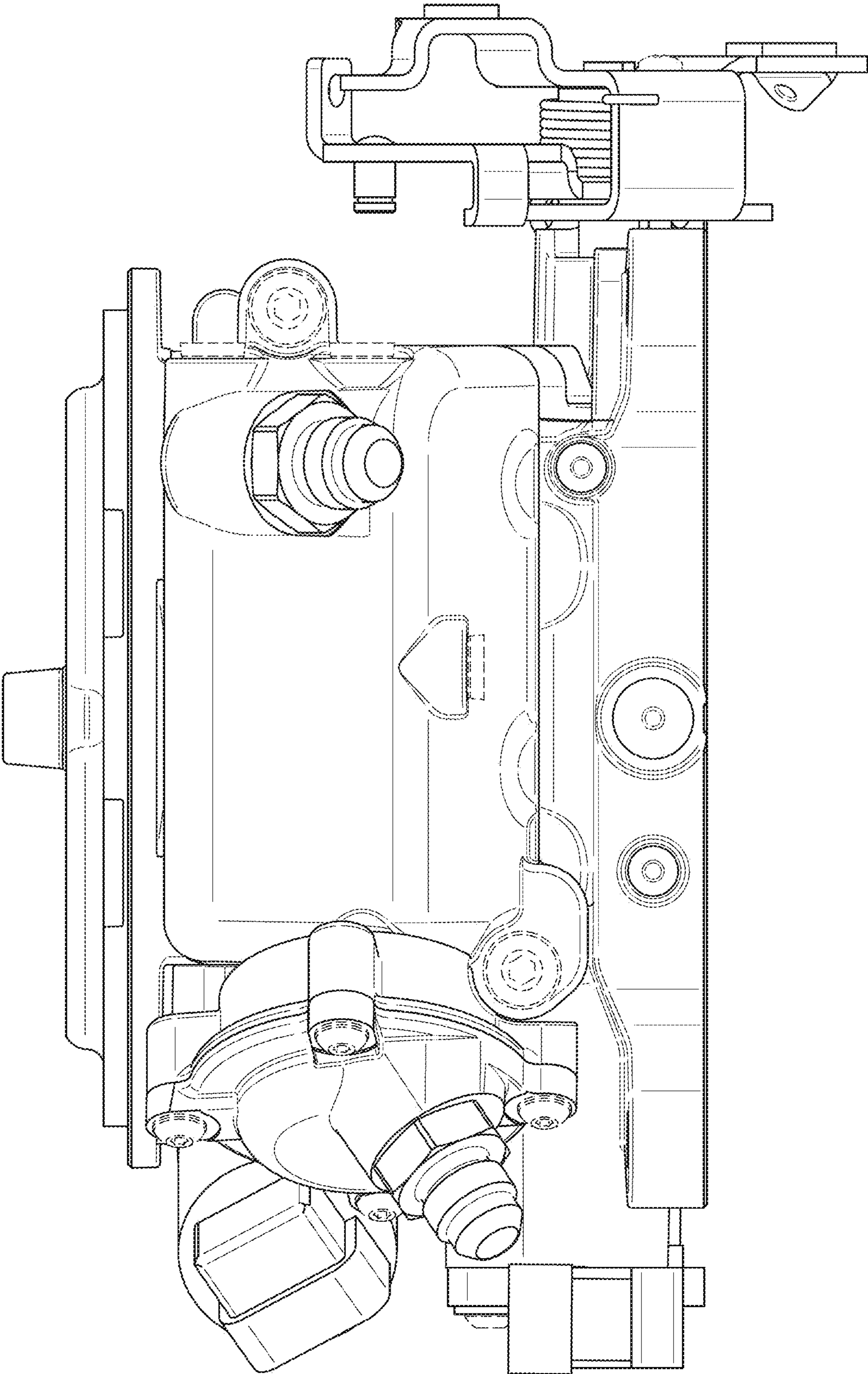

FIG. 7

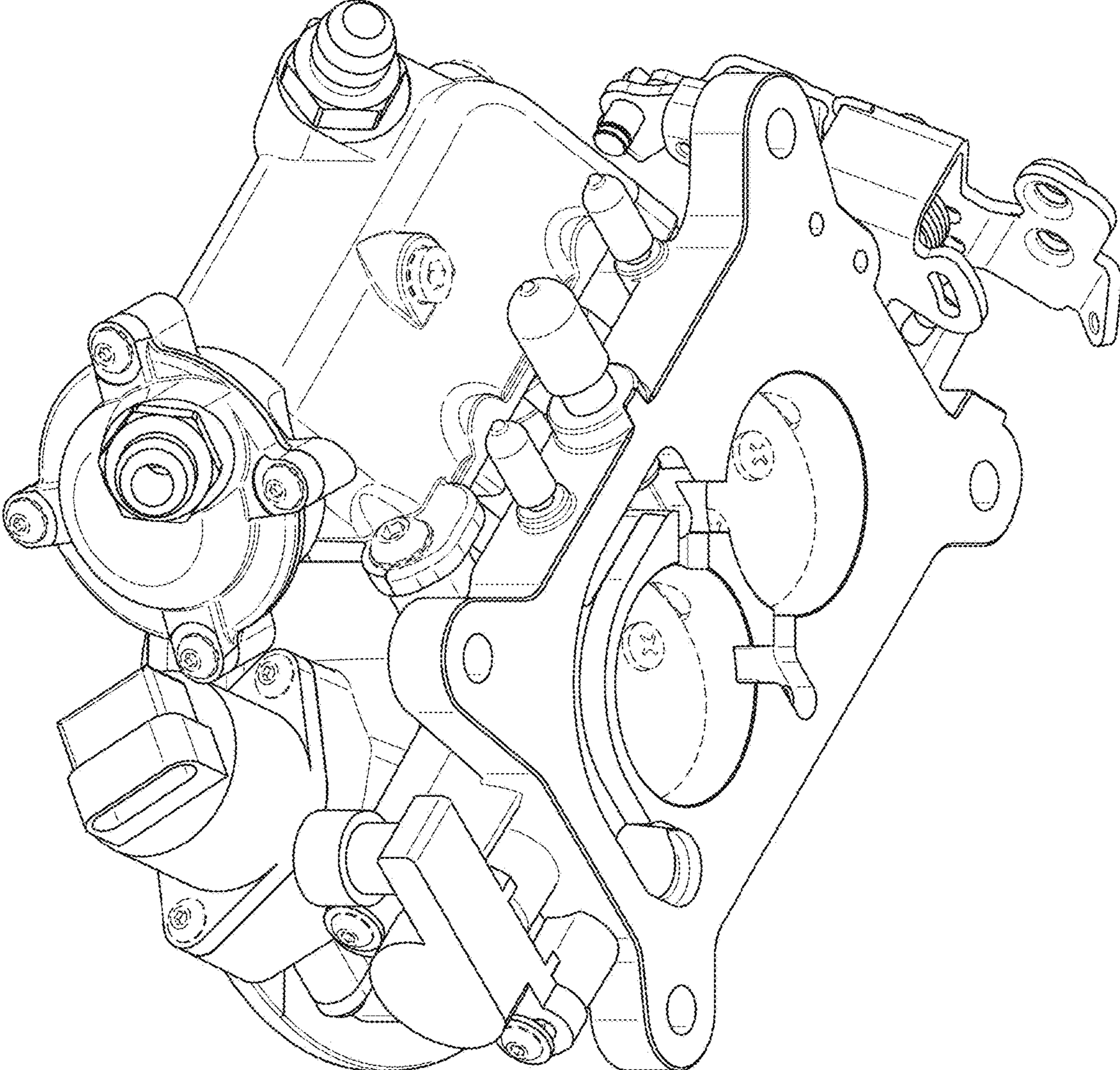

FIG. 8