



US00D965475S

(12) **United States Design Patent**
Zhang

(10) **Patent No.:** **US D965,475 S**

(45) **Date of Patent:** **** Oct. 4, 2022**

(54) **MOTORCYCLE**

OTHER PUBLICATIONS

(71) Applicant: **ZHEJIANG CHUANGTAI
MOTORCYCLE CO., LTD**, Taizhou
(CN)

“2022 Honda Grom 125/A.” Honda., Oct. 8, 2020 [online], [retrieved on Apr. 5, 2022]. Retrieved from the Internet <URL: https://cdn.powersports.honda.com/documentum/MWOM/ml.remawmom.2022_grom125_owner_s_manual.pdf>.*

(Continued)

(72) Inventor: **Dexiang Zhang**, Taizhou (CN)

Primary Examiner — Darlington Ly

(**) Term: **15 Years**

(57) **CLAIM**

(21) Appl. No.: **29/772,231**

The ornamental design for a motorcycle, as shown and described.

(22) Filed: **Feb. 28, 2021**

DESCRIPTION

(30) **Foreign Application Priority Data**

Aug. 31, 2020 (CN) 202030507394.6

(51) **LOC (13) Cl.** **12-11**

(52) **U.S. Cl.**
USPC **D12/110**

(58) **Field of Classification Search**

USPC D12/110, 111, 117; D21/432, 538

CPC B62K 11/00; B62K 11/02; B62K 11/04;

B62K 11/10; B62K 17/00; B62K 19/00;

B62K 2202/00

See application file for complete search history.

FIG. 1 is a front and top perspective view of a motorcycle, showing my new design;

FIG. 2 is a rear and bottom perspective view thereof;

FIG. 3 is a front elevation view thereof;

FIG. 4 is a rear elevation view thereof;

FIG. 5 is a left side elevation view thereof;

FIG. 6 is a right side elevation view thereof;

FIG. 7 is a top plan view thereof;

FIG. 8 is a bottom plan view thereof; and

FIG. 9 is an enlarged view of a portion labeled, ‘FIG. 9’ in FIG. 1;

FIG. 10 is an enlarged view of a portion labeled, ‘FIG. 10’ in FIG. 1;

FIG. 11 is an enlarged view of a portion labeled, ‘FIG. 11’ in FIG. 1;

FIG. 12 is an enlarged view of a portion labeled, ‘FIG. 12’ in FIG. 2;

FIG. 13 is an enlarged view of a portion labeled, ‘FIG. 13’ in FIG. 2; and,

FIG. 14 is an enlarged view of a portion labeled, ‘FIG. 14’ in FIG. 2.

The dashed broken lines in the figures illustrate portions of the article that form no part of the claimed design. The dash dot dash lines in FIGS. 1, 2, 9, 10, 11, 12, 13 and 14 are for the purpose of depicting the cut line of the enlarged view and form no part of the claim.

(56) **References Cited**

U.S. PATENT DOCUMENTS

D645,791 S * 9/2011 Lee D12/110

D723,430 S * 3/2015 Schmidt D12/110

D733,007 S * 6/2015 Futamata D12/110

D734,216 S * 7/2015 Sasanami D12/110

D735,085 S * 7/2015 Buckan D12/110

D744,906 S * 12/2015 Song D12/110

D753,552 S * 4/2016 McGinley D12/110

D756,269 S * 5/2016 Hahn-Woernle D12/110

D776,013 S * 1/2017 Kiska D12/110

D776,575 S * 1/2017 Kiska D12/110

D793,285 S * 8/2017 Toyama D12/110

(Continued)

1 Claim, 14 Drawing Sheets

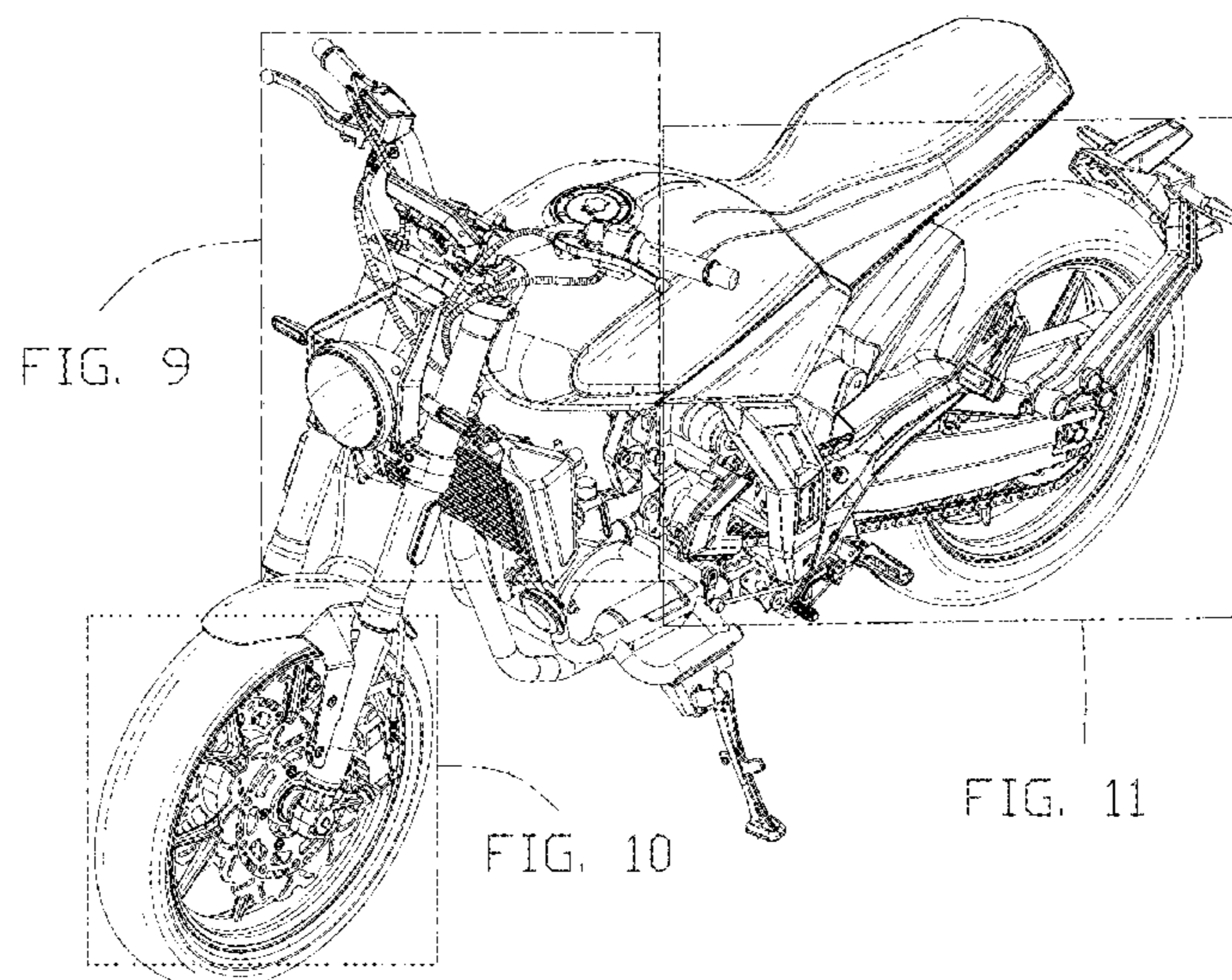

(56)

References Cited

U.S. PATENT DOCUMENTS

D796,384	S	*	9/2017	Galluzzi	D12/110
D796,385	S	*	9/2017	Galluzzi	D12/110
D800,608	S	*	10/2017	Takizawa	D12/110
D809,431	S	*	2/2018	Janyapanich	D12/110
D820,167	S	*	6/2018	Aiello	D12/110
D824,290	S	*	7/2018	Sukkar	D12/110
D828,230	S	*	9/2018	Cammorata	D12/110
D856,854	S	*	8/2019	Tamura	D12/110
D859,220	S	*	9/2019	Kishi	D12/110
D859,221	S	*	9/2019	Shigihara	D12/110
D878,971	S	*	3/2020	Li	D12/110
D880,365	S	*	4/2020	McGinley	D12/110
D880,366	S	*	4/2020	Shedjale	D12/110
D890,033	S	*	7/2020	Carducci	D12/110
D895,487	S	*	9/2020	Richards	D12/110
D911,879	S	*	3/2021	Christoph	D12/110
D940,008	S	*	1/2022	Lou	D12/110
2018/0257726	A1	*	9/2018	Bagnariol	B62K 11/04
2020/0102041	A1	*	4/2020	Pelz	F02M 35/10144

OTHER PUBLICATIONS

Greg Drevestedt. "2022 Honda Grom | First Ride Review." Rider Motorcyclist at its Best., Aug. 3, 2021 [online], [retrieved on Apr. 5, 2022]. Retrieved from the Internet <URL: <https://ridermagazine.com/2021/08/03/2022-honda-grom-first-ride-review/>>.*

* cited by examiner

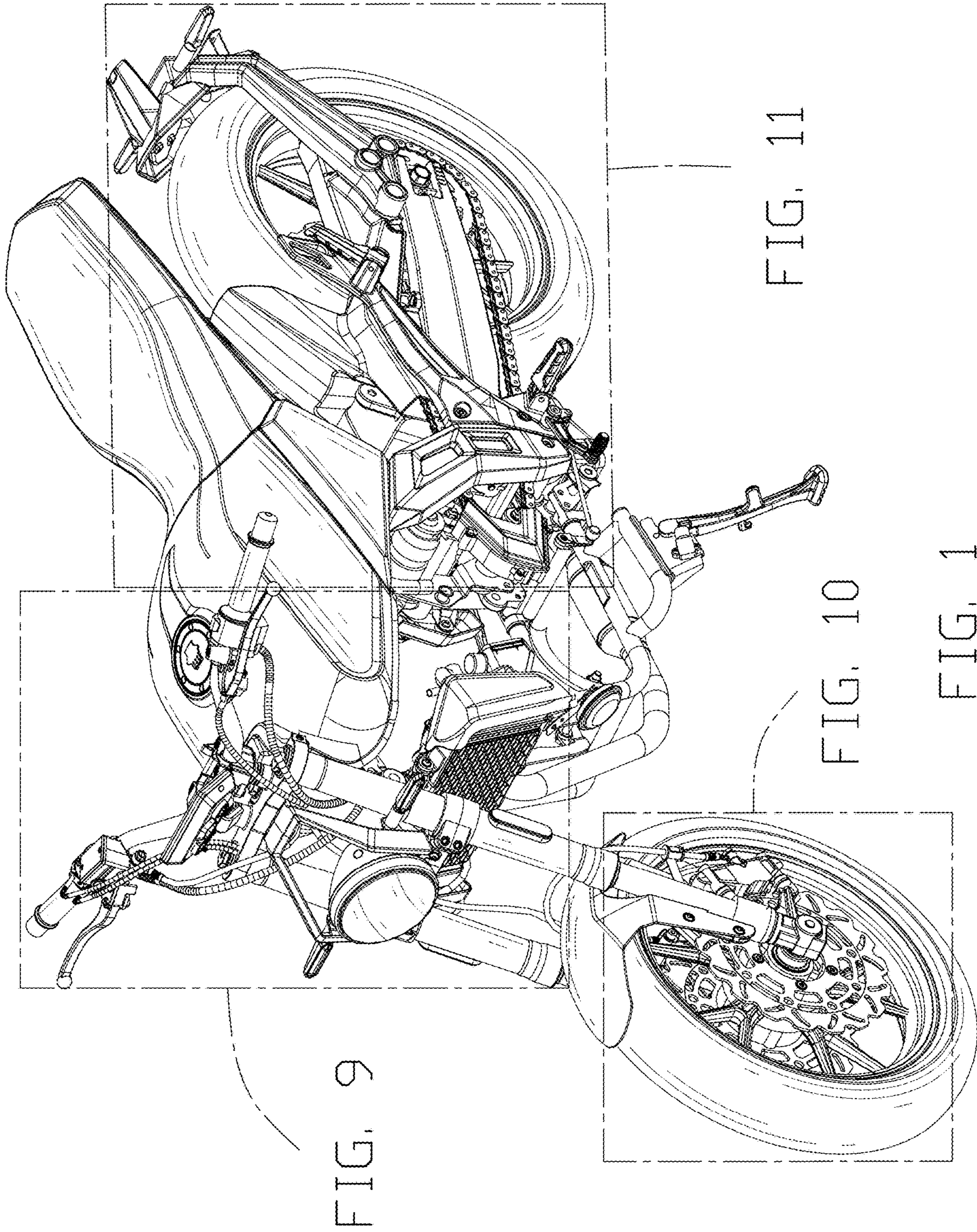

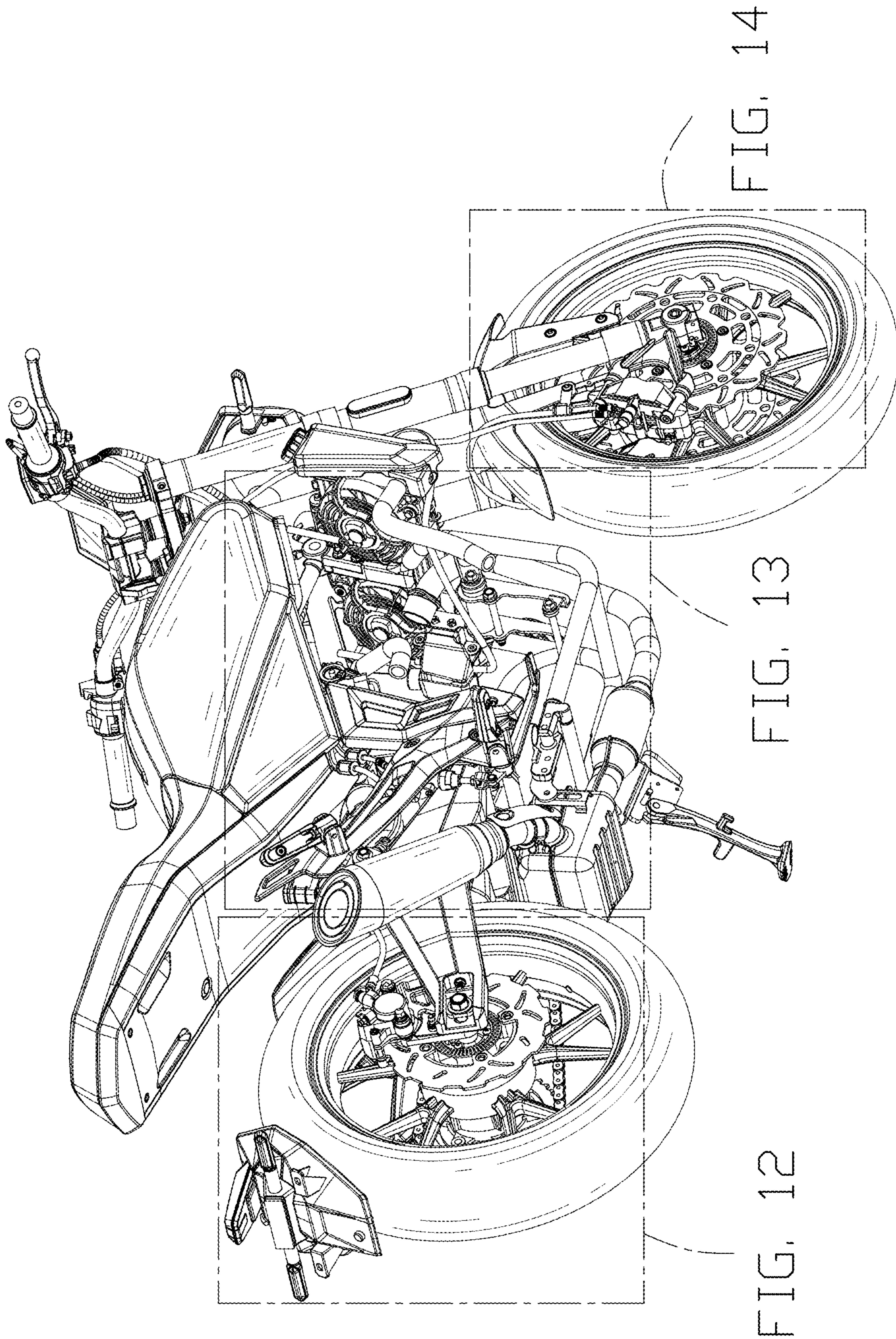

FIG. 14

FIG. 13

FIG. 12

FIG. 2

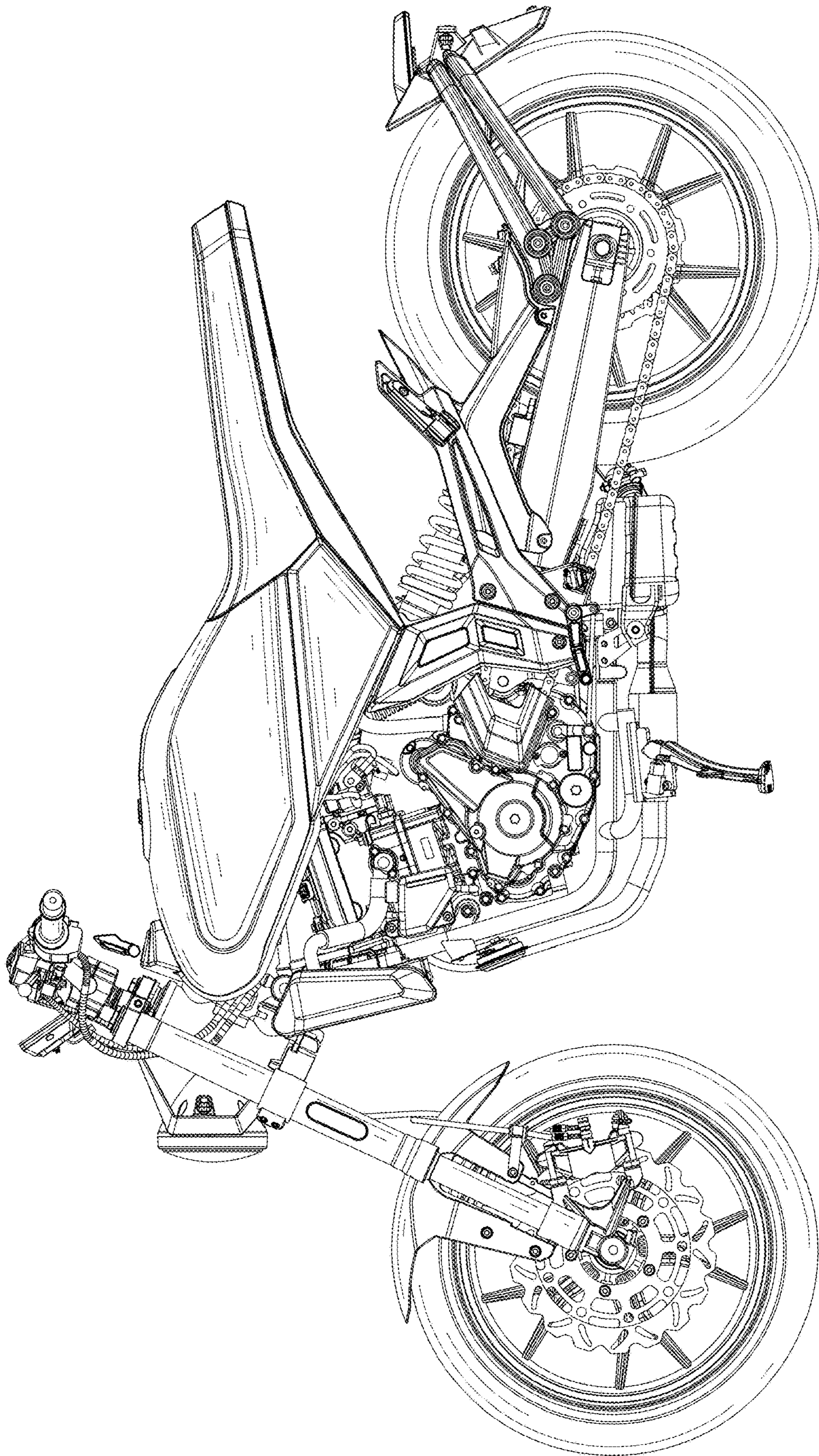

FIG. 3

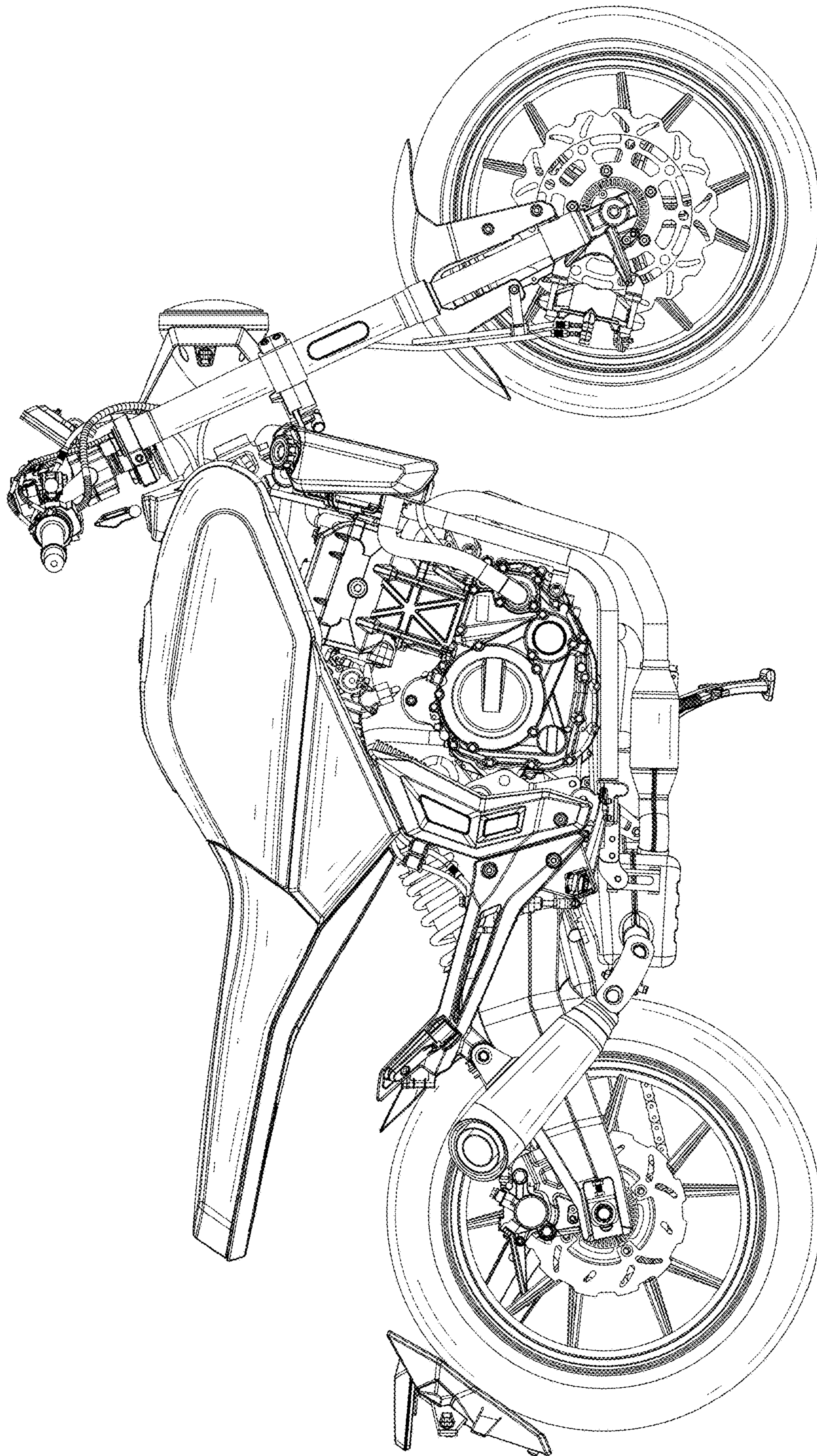

FIG. 4

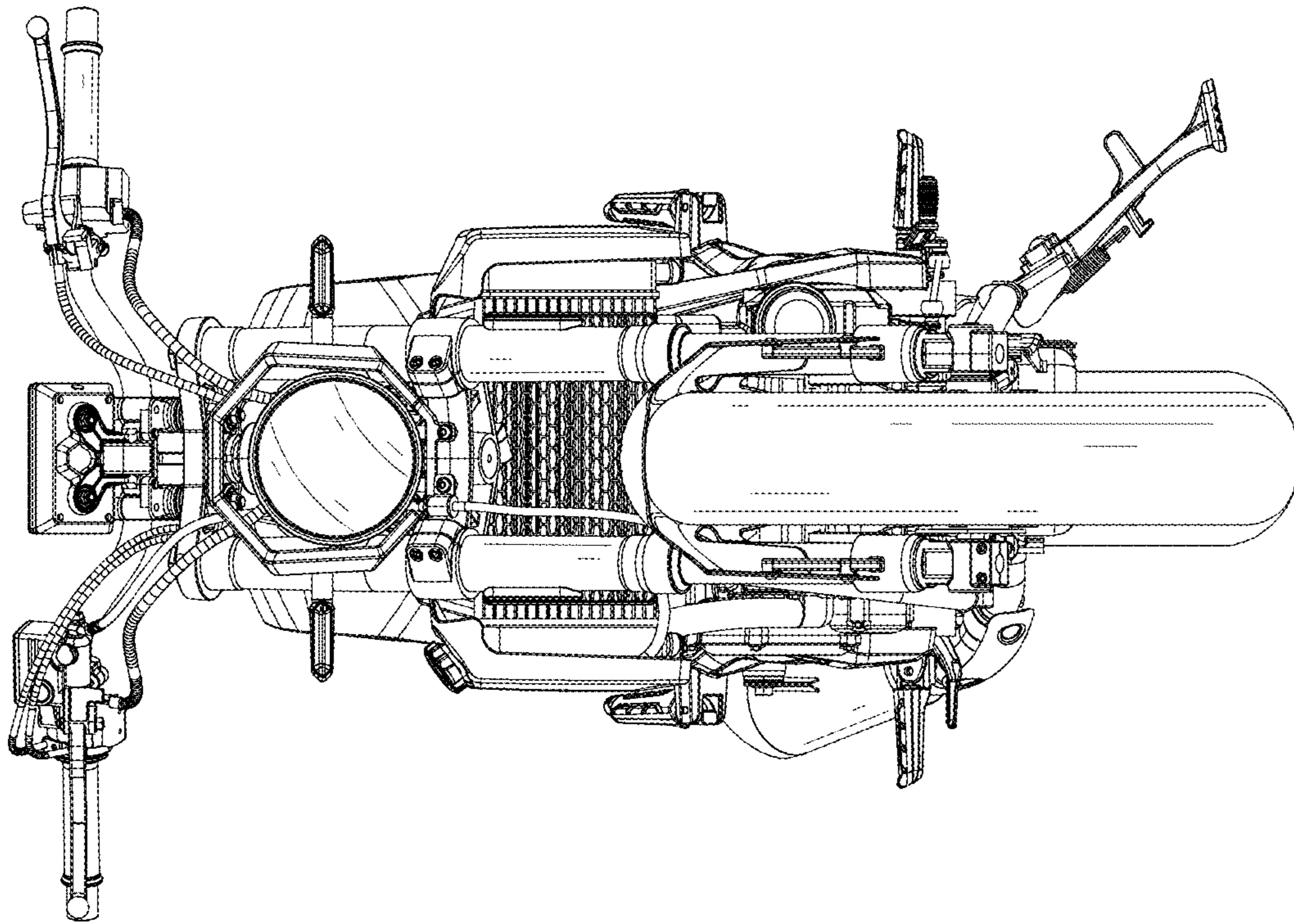

FIG. 5

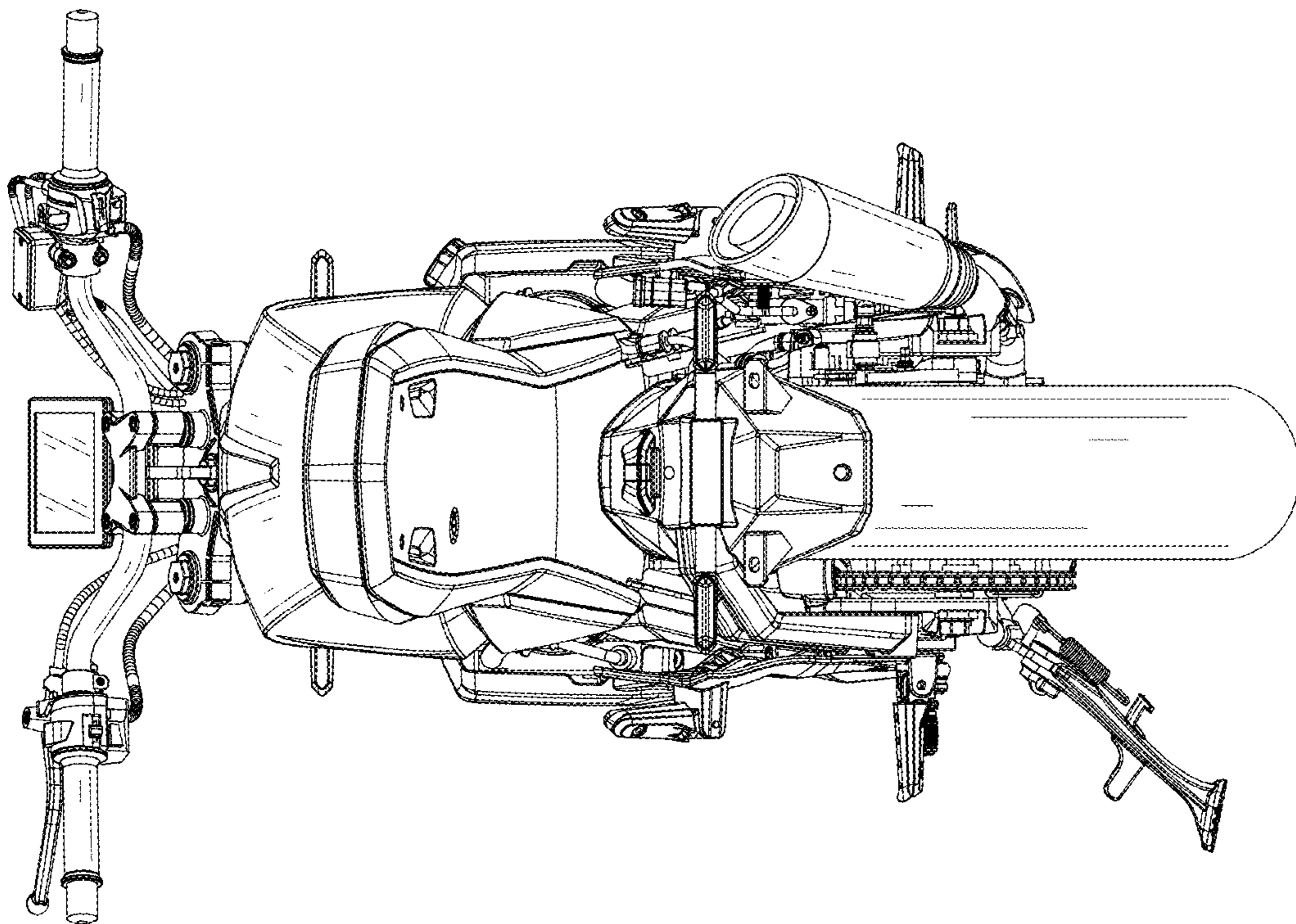

FIG. 6

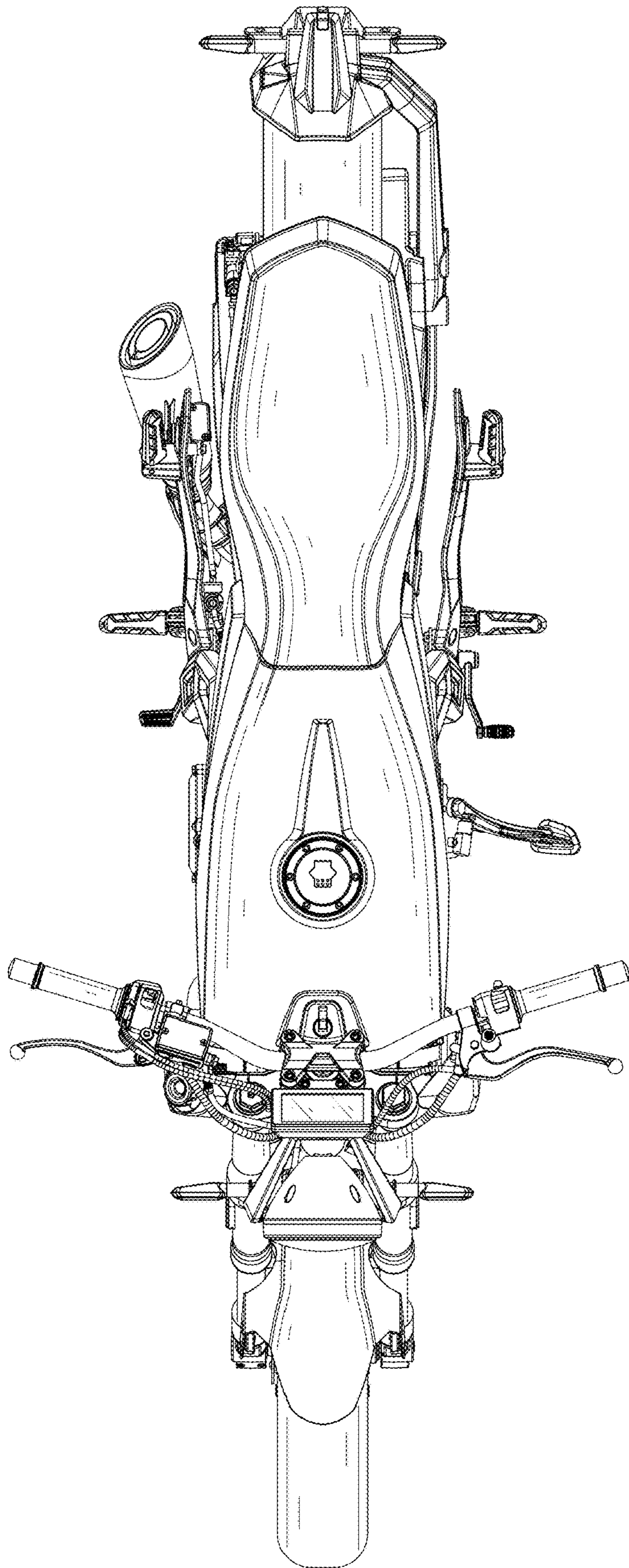

FIG. 7

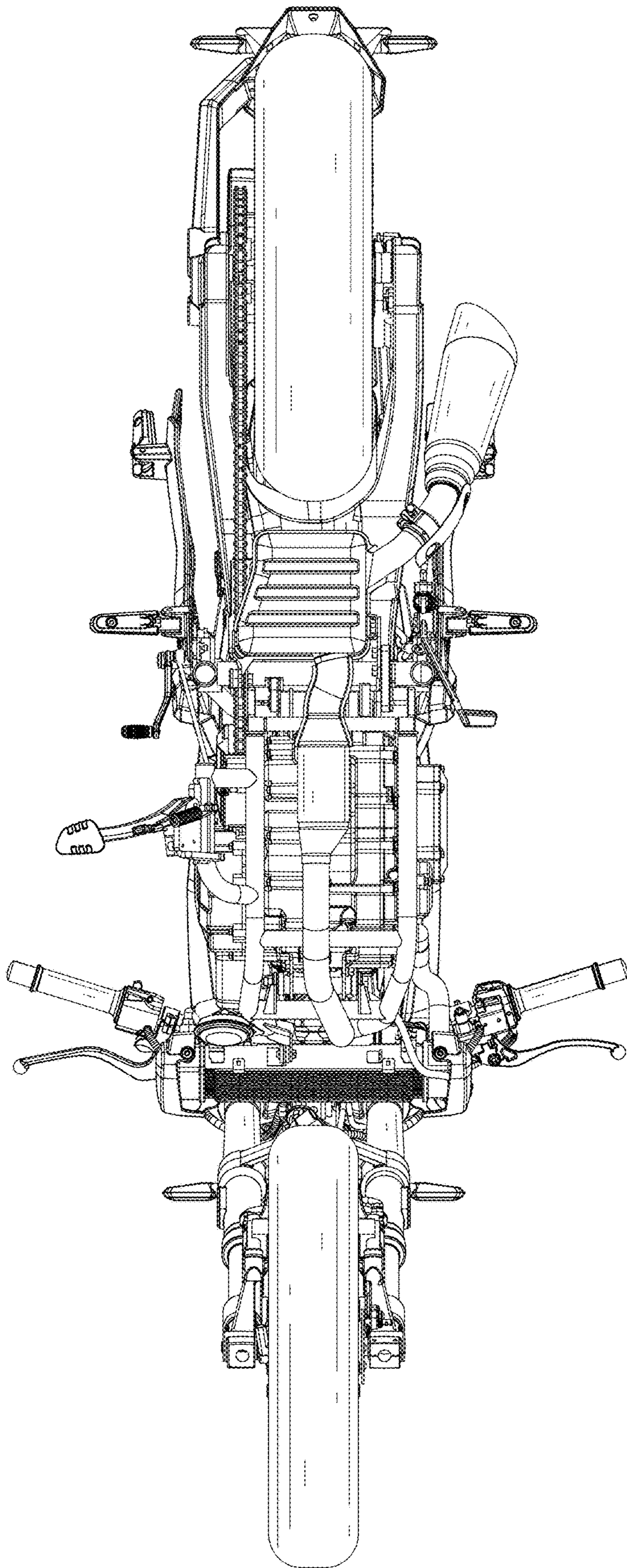

FIG. 8

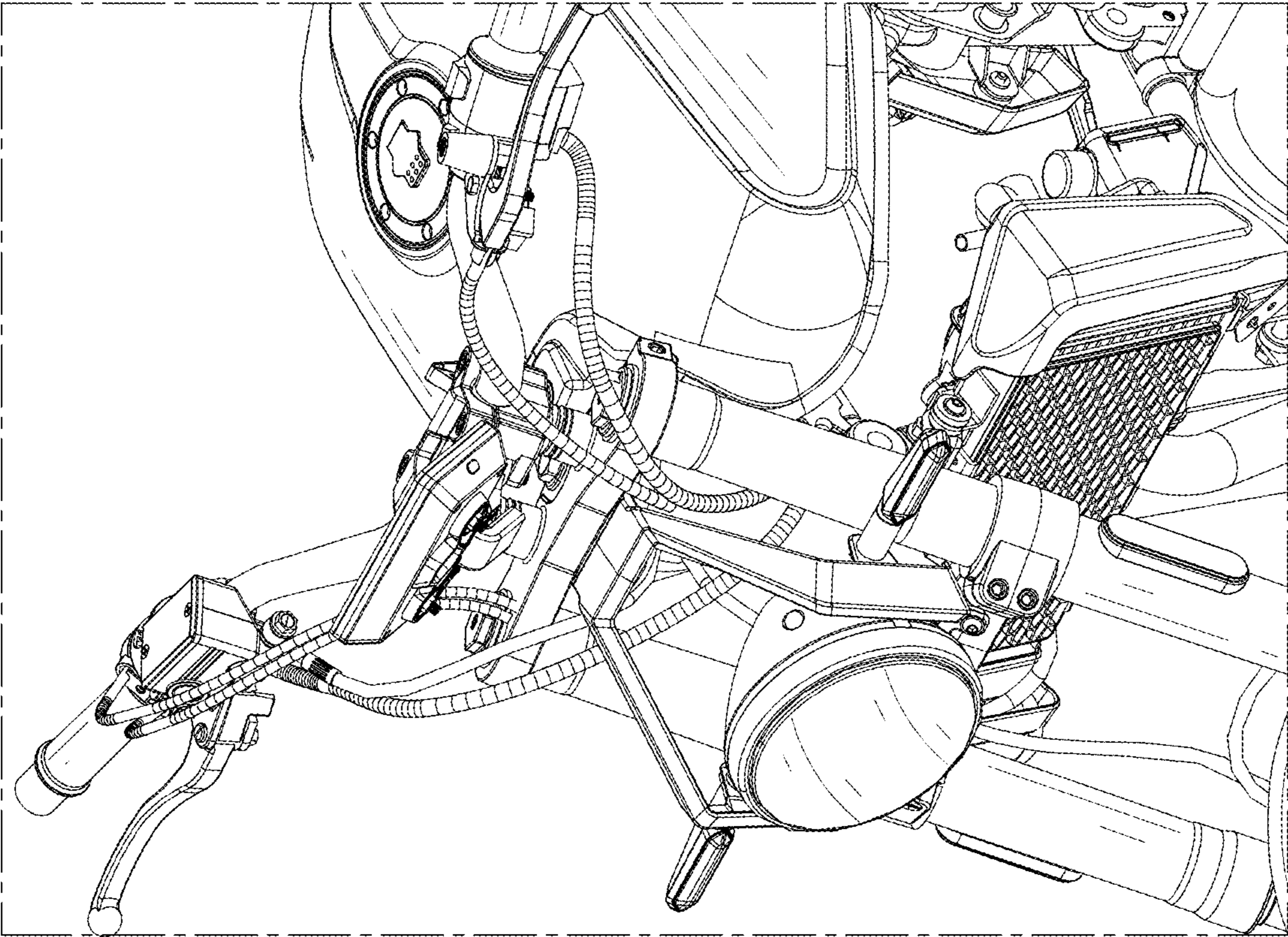

FIG. 9

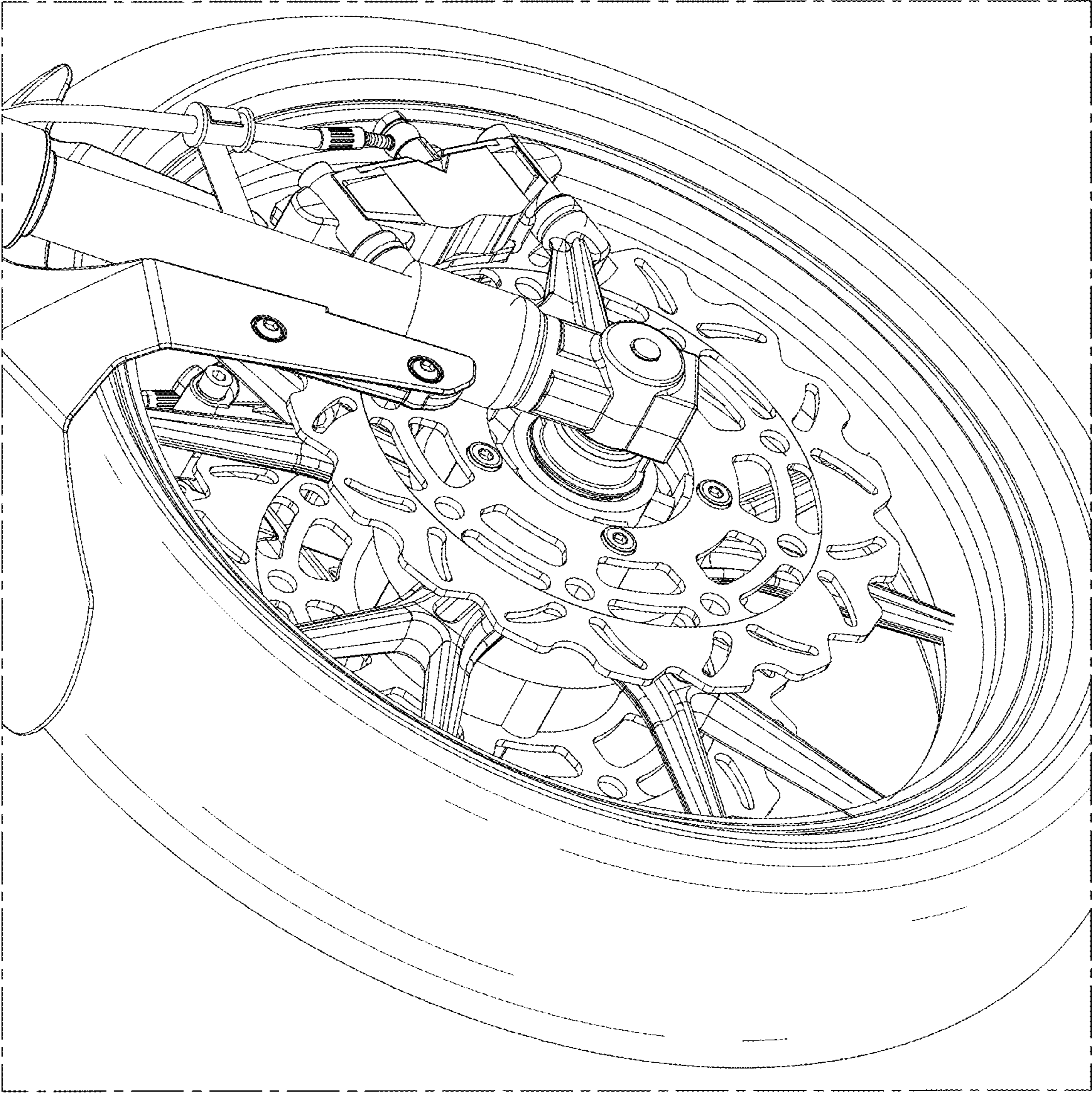

FIG. 10

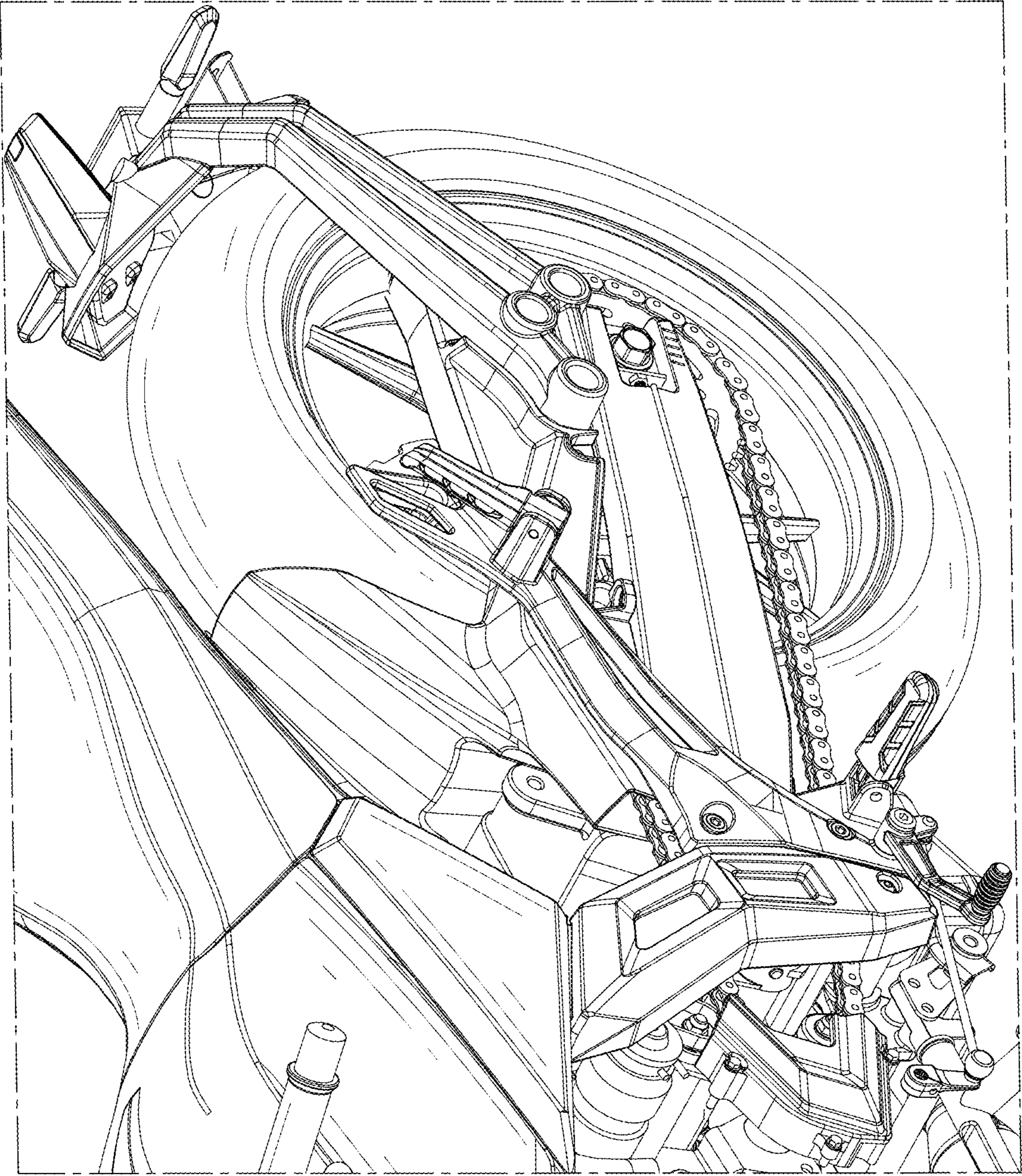

FIG. 11

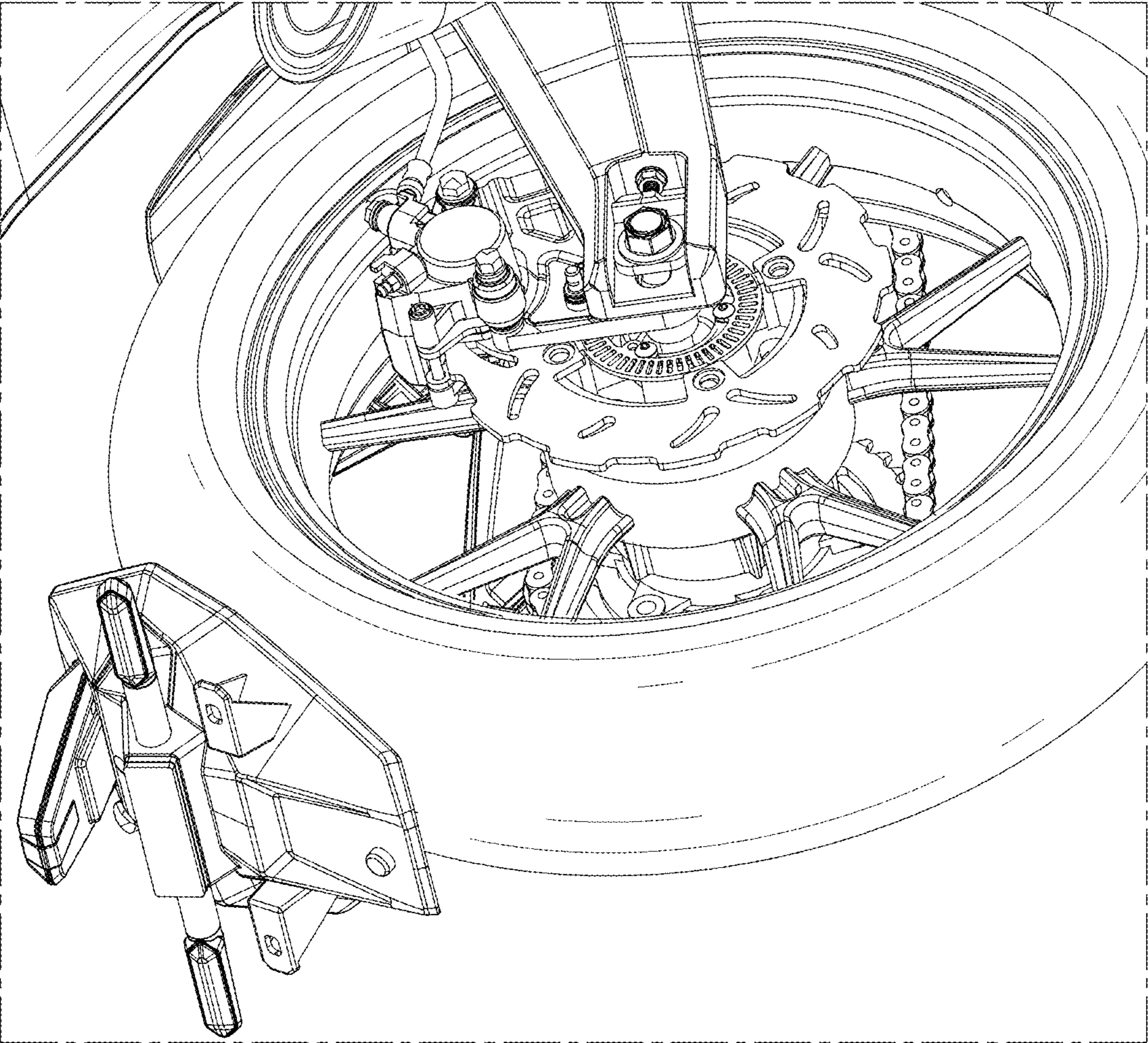

FIG. 12

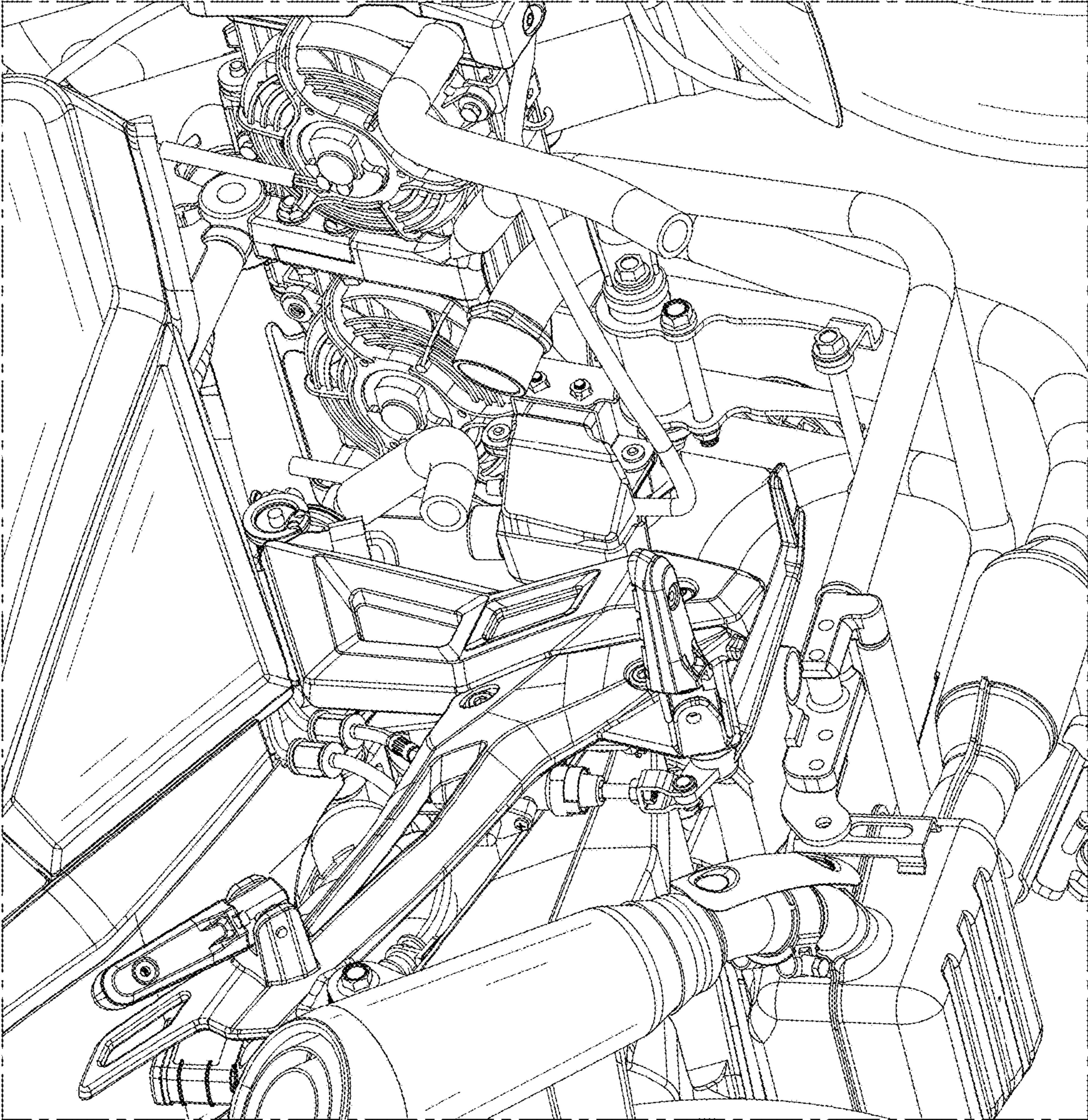

FIG. 13

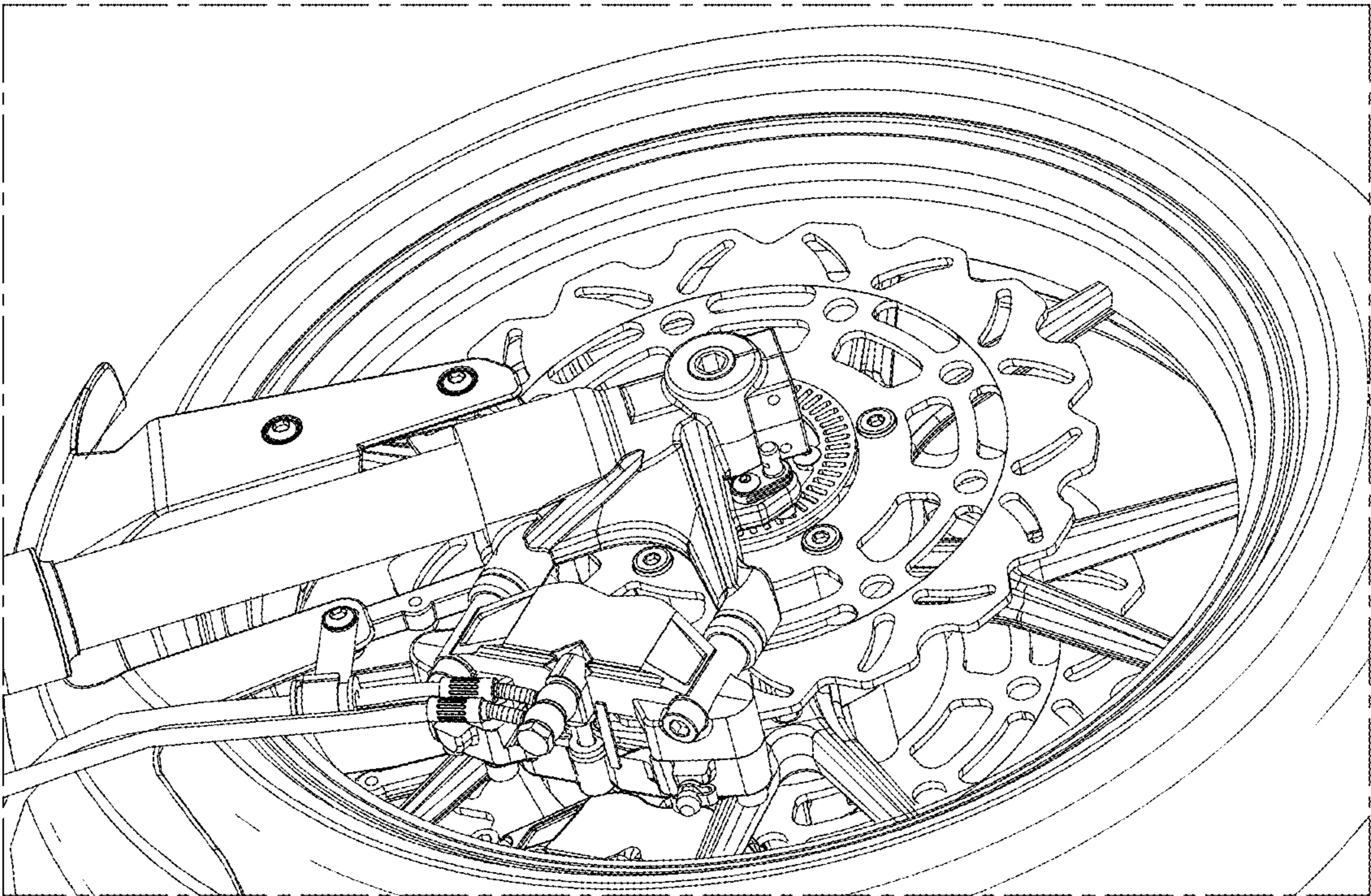

FIG. 14