



US00D965433S

(12) **United States Design Patent**
Wikstrom

(10) **Patent No.:** **US D965,433 S**
(45) **Date of Patent:** **** Oct. 4, 2022**

(54) **TAMPER-EVIDENT CONTAINER LOCK**

DESCRIPTION

- (71) Applicant: **Todd Wikstrom**, Las Vegas, NV (US)
- (72) Inventor: **Todd Wikstrom**, Las Vegas, NV (US)
- (73) Assignee: **Pizza Spice Packet, LLC**
- (**) Term: **15 Years**
- (21) Appl. No.: **29/739,604**
- (22) Filed: **Jun. 26, 2020**
- (51) **LOC (13) Cl.** **09-07**
- (52) **U.S. Cl.**
USPC **D9/449**; D9/416
- (58) **Field of Classification Search**
USPC D9/414–418, 419–421, 423, 430–436,
D9/420, 435, 443, 444, 446, 456, 449,
(Continued)

(56) **References Cited**

U.S. PATENT DOCUMENTS

- 2,349,707 A * 5/1944 Esposito B65D 5/106
229/155
- 2,664,896 A * 1/1954 Reineman D19/86
(Continued)

OTHER PUBLICATIONS

PMQ Pizza Media. Pizza Packet Introduces LLOCKED Technology for Tamper-Free Delivery. Published Feb. 2022. Visited Apr. 28, 2022. <https://www.pmq.com/llocked/> (Year: 2022).*

(Continued)

Primary Examiner — Darcey E Gottschalk
Assistant Examiner — Vanessa M. Pursley
 (74) *Attorney, Agent, or Firm* — Quickpatents, LLC;
 Kevin Prince

(57) **CLAIM**

The ornamental design for a tamper-evident container lock, as shown and described.

FIG. 1 is a front perspective view of a tamper-evident container lock, showing a first embodiment of my new design with a flap of a container lid in a forward position with a lateral tab in a flat position;
 FIG. 2 is an alternate front perspective view thereof, illustrated with the lateral tab being bent rearward so as to be insertable into a slot of a front wall of the container;
 FIG. 3 is an alternate front perspective view thereof, illustrated with the flap engaged with the slot and the container lid in a closed position;
 FIG. 4 is a rear perspective view thereof, unclaimed portions of the container omitted for clarity, the flap and tab fully engaged with the slot;
 FIG. 5 is an exploded front elevational view of FIG. 4, but with the lateral tab in the flat position;
 FIG. 6 is an exploded rear elevational view of FIG. 5;
 FIG. 7 is an exploded right-side elevational view of FIG. 5;
 FIG. 8 is an exploded left-side elevational view of FIG. 5;
 FIG. 9 is an exploded top plan view of FIG. 5;
 FIG. 10 is an exploded bottom plan view of FIG. 5;
 FIG. 11 is a front perspective view of a second embodiment showing the flap of the container lid in the forward position with the lateral tab in the flat position;
 FIG. 12 is an alternate front perspective view thereof, illustrated with the lateral tab being bent rearward so as to be insertable into the slot of a double front wall of the container;
 FIG. 13 is an alternate front perspective view thereof, illustrated with the flap engaged with the slot and the container lid in the closed position;
 FIG. 14 is a rear perspective view thereof, unclaimed portions of the container omitted for clarity, the flap and tab fully engaged with the slot;
 FIG. 15 is an exploded front elevational view of FIG. 14 but with the lateral tab in the flat position;
 FIG. 16 is an exploded rear elevational view of FIG. 15;
 FIG. 17 is an exploded right-side elevational view of FIG. 15;
 FIG. 18 is an exploded left-side elevational view of FIG. 15;
 FIG. 19 is an exploded top plan view of FIG. 15; and,
 FIG. 20 is an exploded bottom plan view of FIG. 15.

(Continued)

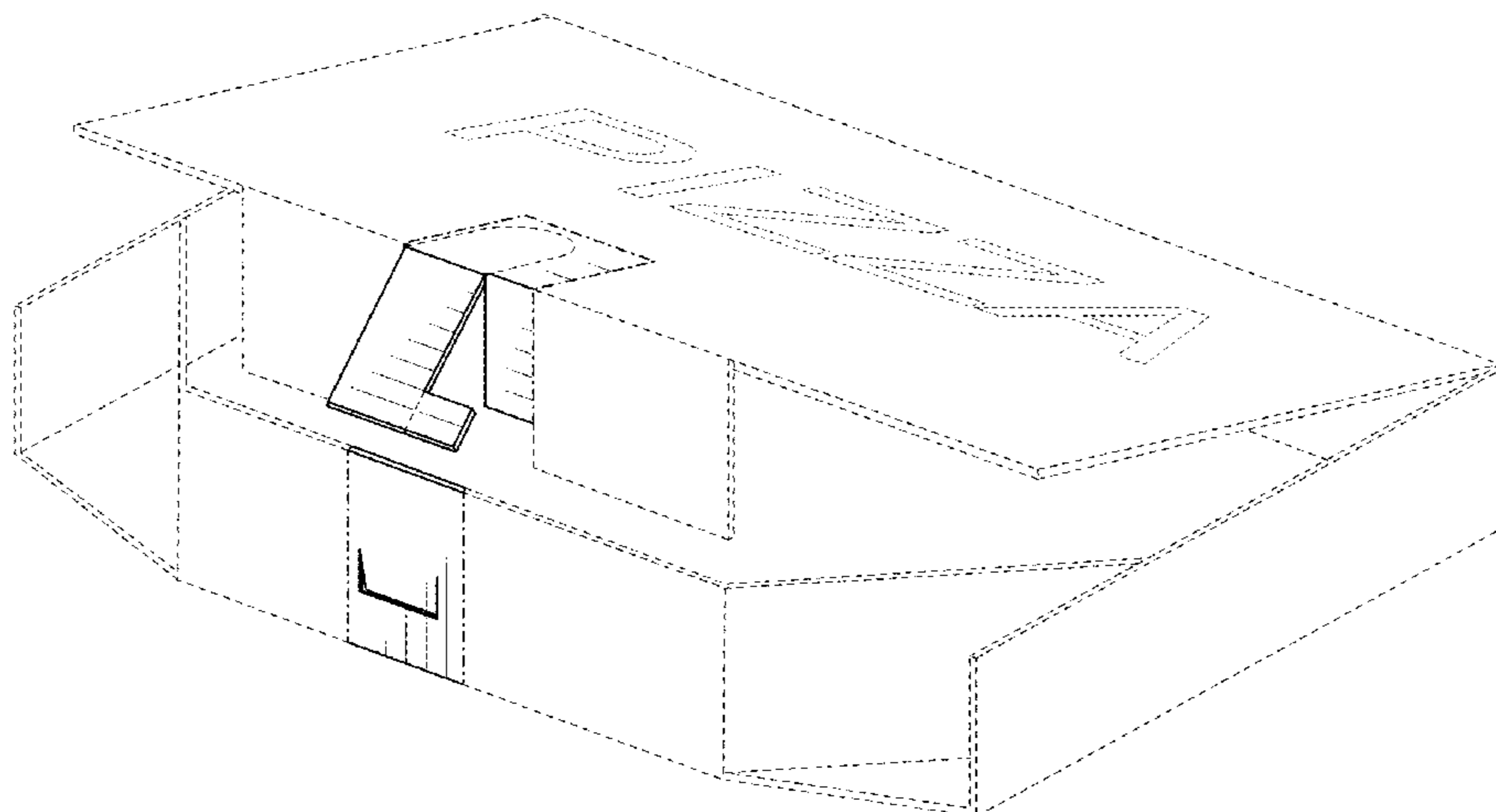

The broken lines showing a person's hand in the figures depicts environmental matter and form no part of the claimed design. The dot-dash broken lines represent a boarder of the claimed design. Evenly-spaced broken lines outside of the dot-dash boarder represent portions of the container that form no part of the claimed design, and evenly-spaced broken lines inside of the dot-dash border represent perforations and form a part of the claimed design.

1 Claim, 10 Drawing Sheets

(58) **Field of Classification Search**

USPC D9/416, 433, 434; D3/201, 273, 294;
 D7/601, 602; D19/1, 2, 3, 26, 27, 33, 65,
 D19/75, 100
 CPC . B65D 5/54; B65D 5/66; B65D 85/36; B65D
 5/546; B65D 5/6626
 See application file for complete search history.

(56) **References Cited**

U.S. PATENT DOCUMENTS

D276,695	S *	12/1984	Hanna	D7/393
4,516,718	A *	5/1985	Forbes, Jr.	B65D 5/6626
					229/148
D323,988	S *	2/1992	Ruck	D9/414
D356,254	S *	3/1995	Correll	D9/423
5,535,940	A *	7/1996	Olds	B65D 5/2033
					229/110
D415,419	S *	10/1999	Abiteboul	D9/423
D442,085	S *	5/2001	Bozlee	D9/434
D449,520	S *	10/2001	DiZoglio, III	D9/423
D456,710	S *	5/2002	Persson	D9/431
6,749,106	B2 *	6/2004	Keefe, Jr.	B65D 5/6652
					229/110
D497,308	S *	10/2004	Koizumi	D9/434
D510,519	S *	10/2005	Katayama	D9/418

D521,862	S *	5/2006	Siethoff	D9/432
D524,151	S *	7/2006	Meehan	D9/414
D548,071	S *	8/2007	Chen	D9/432
D607,321	S *	1/2010	Mark	D9/423
D613,158	S *	4/2010	Russell	D9/434
D623,938	S *	9/2010	Gordon	D9/432
D641,620	S *	7/2011	Hammond	D9/432
D649,040	S *	11/2011	Sanders	D9/432
D770,274	S *	11/2016	Sater	B65D 5/106
					D9/431
D791,589	S *	7/2017	Remash	D9/432
D794,446	S *	8/2017	Greenberg	D9/432
D907,496	S *	1/2021	Menzel, Jr.	D9/456
D914,495	S *	3/2021	Wikstrom	B65D 5/2033
					D9/432
D926,593	S *	8/2021	Frandsen	D9/734
D951,088	S *	5/2022	Wikstrom	D9/435
2013/0313150	A1 *	11/2013	Grinwald	B65D 21/0219
					206/509
2014/0217163	A1 *	8/2014	Marshall	B65D 5/0236
					229/200
2016/0001937	A1 *	1/2016	Skinner	B65D 50/046
					206/1.5
2017/0158410	A1 *	6/2017	Rubino	B65D 5/4295
2022/0017263	A1 *	1/2022	Wikstrom	B65D 5/6626
2022/0055794	A1 *	2/2022	Humberstone	B65D 5/18
2022/0106072	A1 *	4/2022	Hartinger Peña	B65D 5/563

OTHER PUBLICATIONS

Youtube. PizzaLoc™ with LLOCKED™ technology demo DN. Published Feb. 22, 2022 by "bradley52bh". Visited Apr. 28, 2022. <https://www.youtube.com/watch?v=dBam3KBF-xs> (Year: 2022).*

Facebook. Tamper Proof Pizza Box. Published Apr. 8, 2020 by "Pizza Pizza". Visited Apr. 28, 2022. <https://www.facebook.com/PizzaPizzaCanada/videos/tamper-proof-pizza-box/238807927168172/> (Year: 2020).*

Youtube. Lock Box—A Game Changer for the Pizza Industry. Published Nov. 1, 2020 by "First Pack Group". Visited Apr. 28, 2022. <https://www.youtube.com/watch?v=sfuaodfftC4> (Year: 2020).*

* cited by examiner

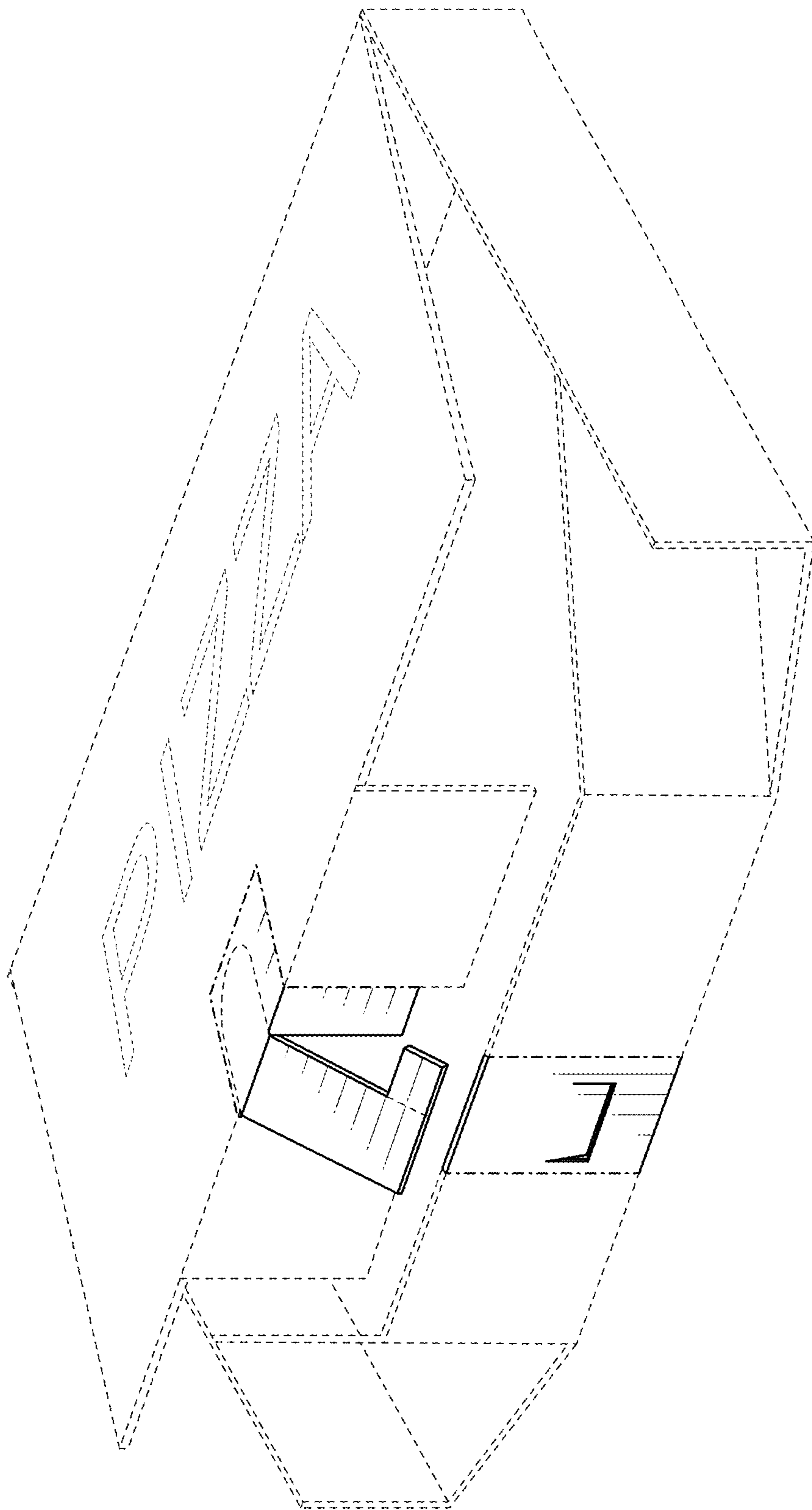

FIG. 1

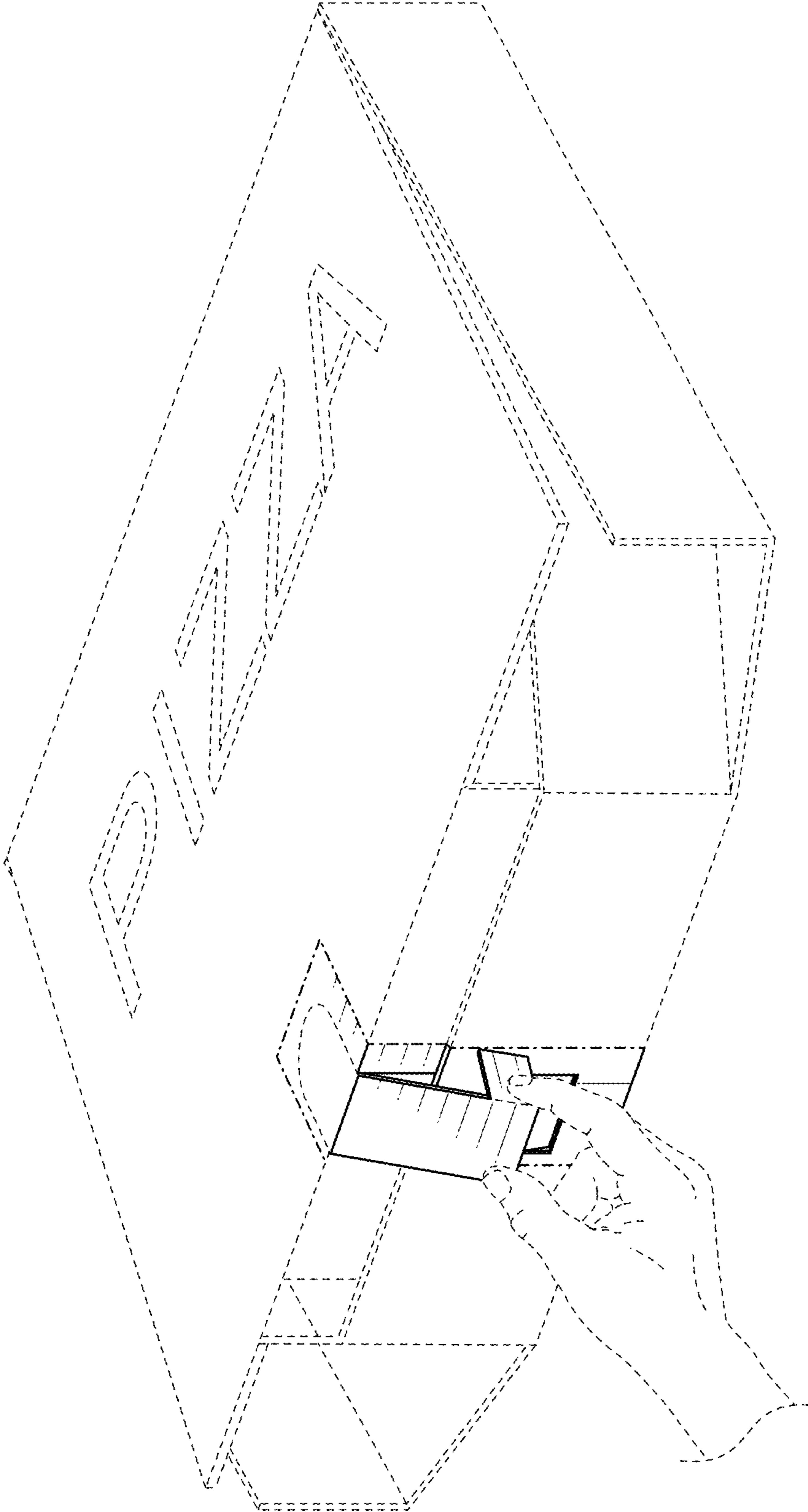

FIG. 2

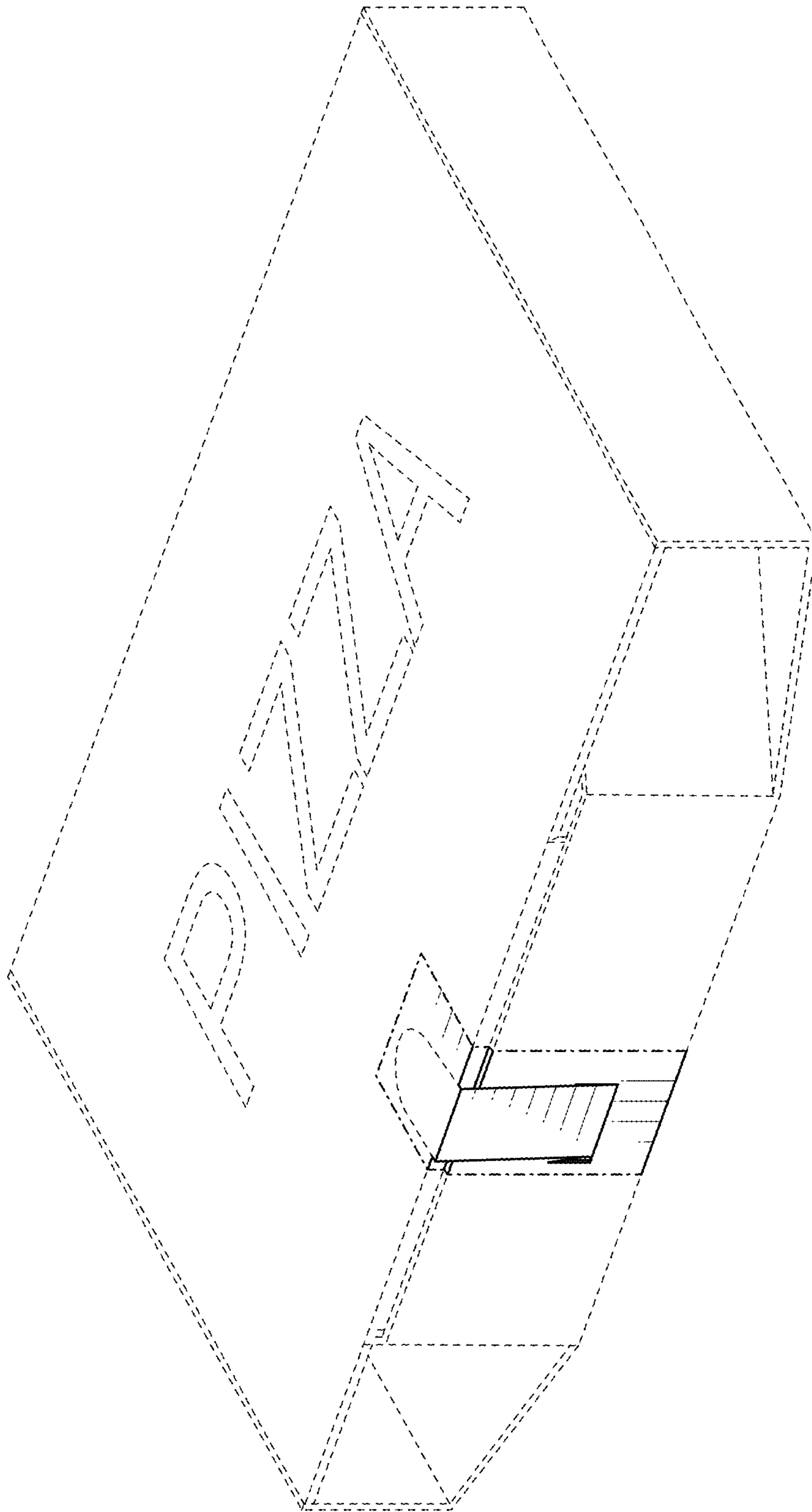

FIG. 3

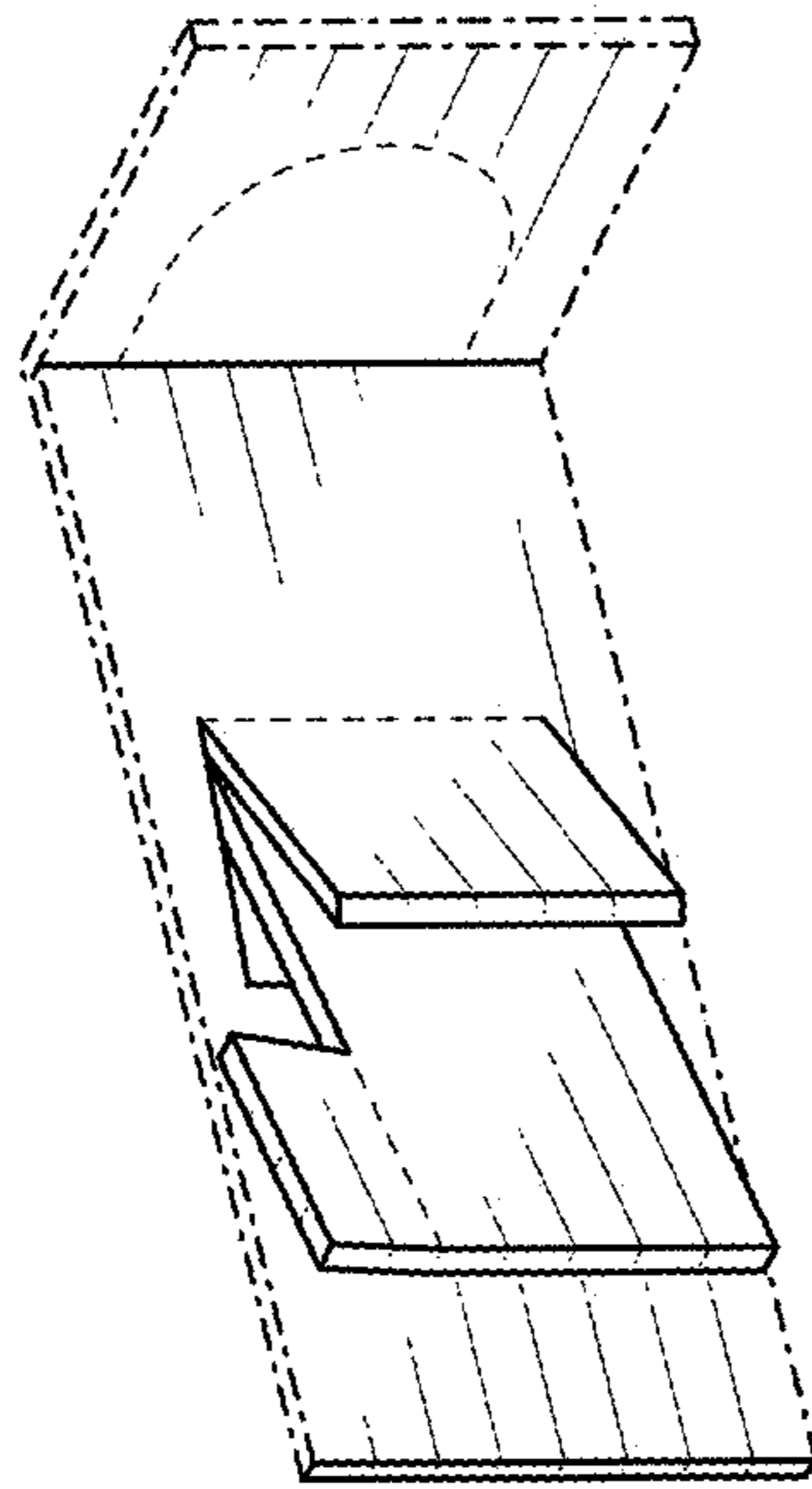

FIG. 4

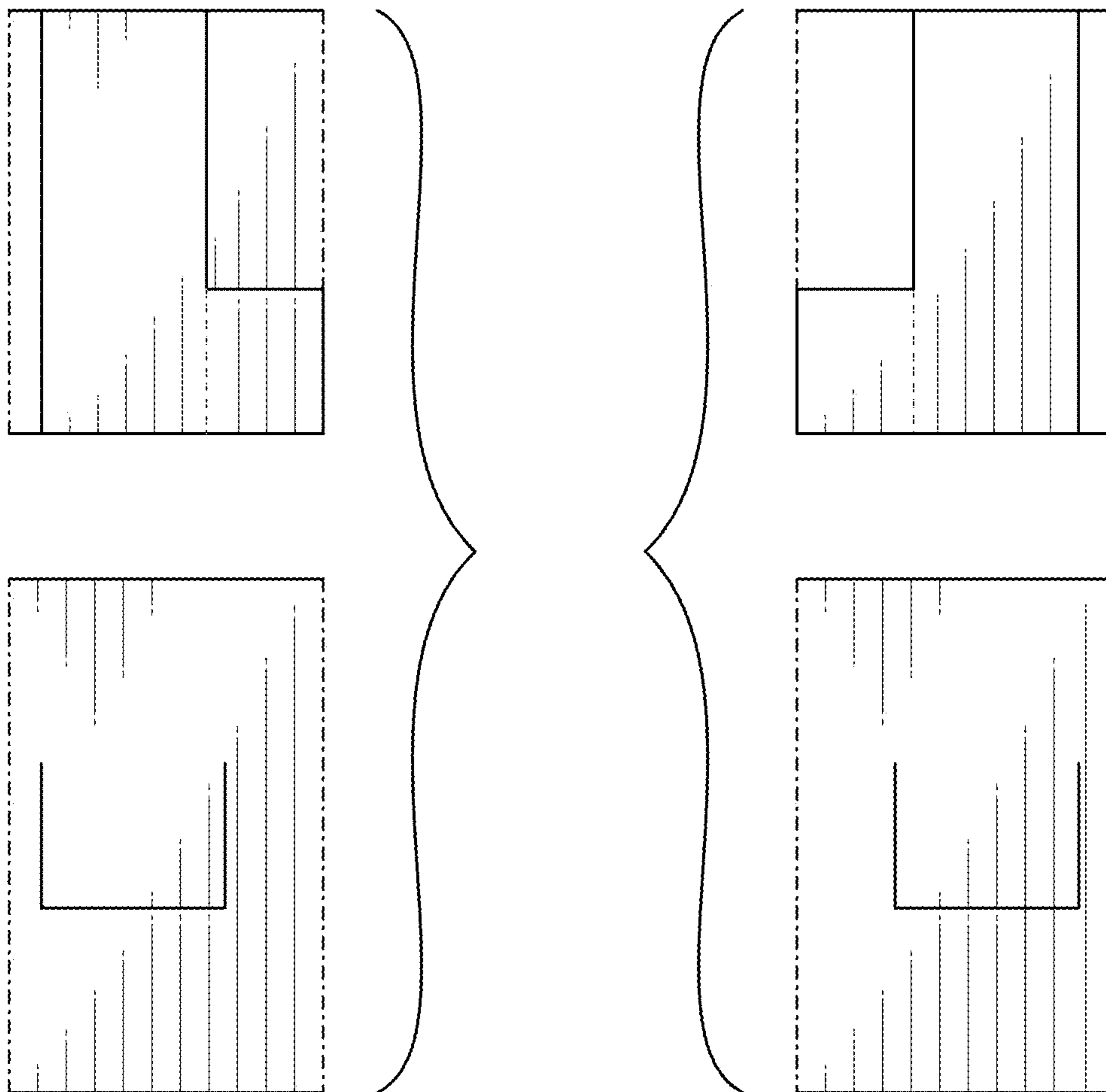

FIG. 5

FIG. 6

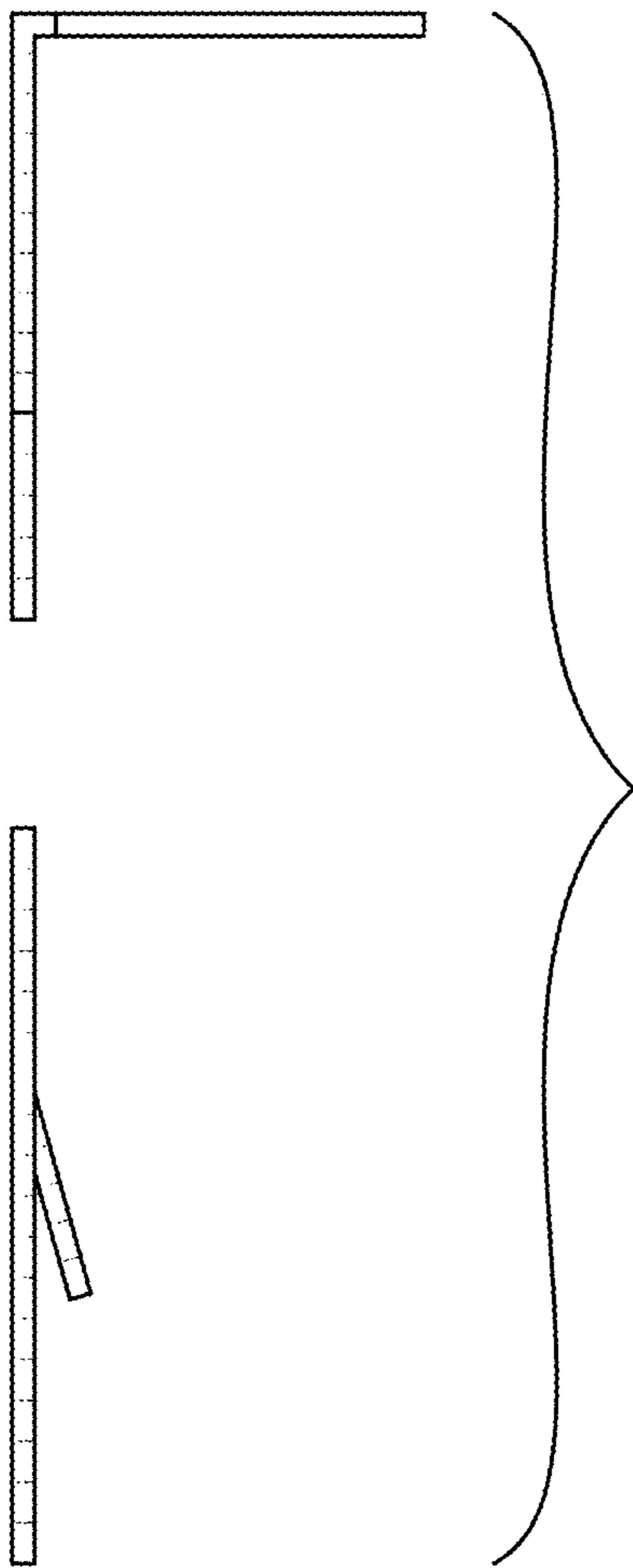

FIG. 7

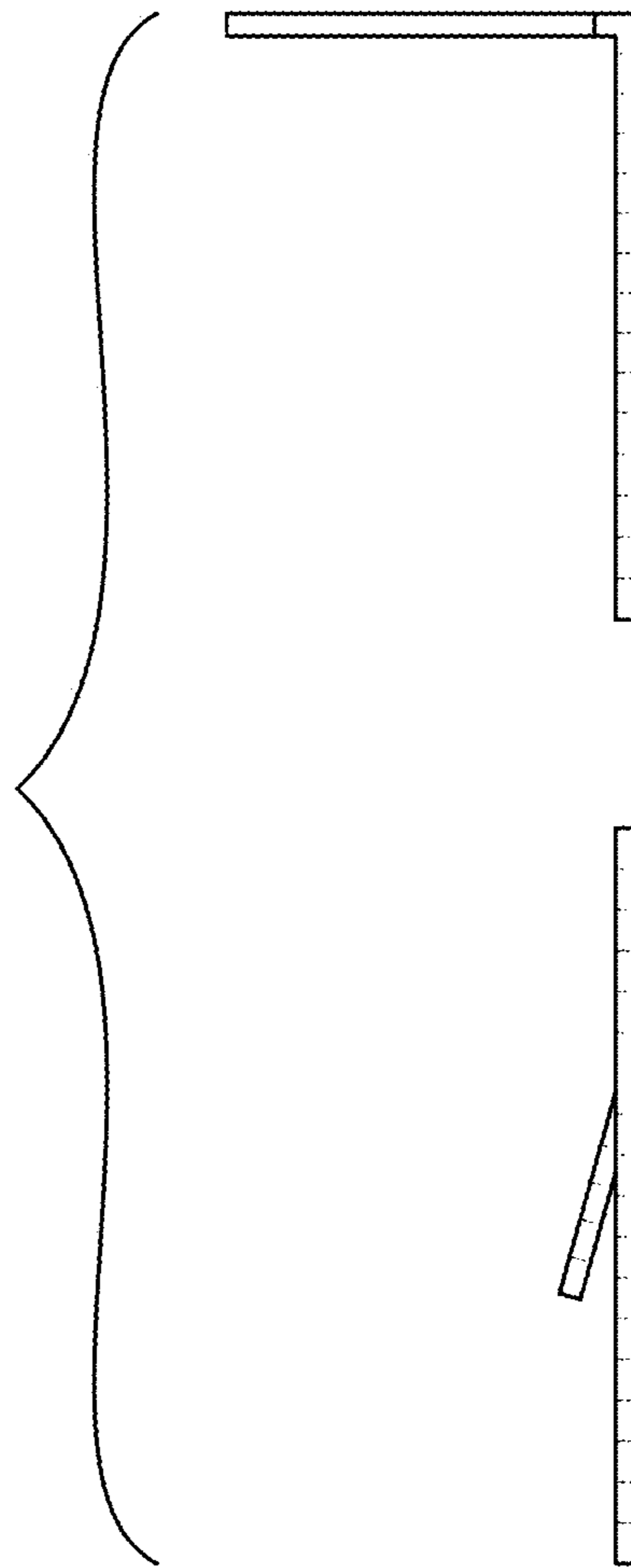

FIG. 8

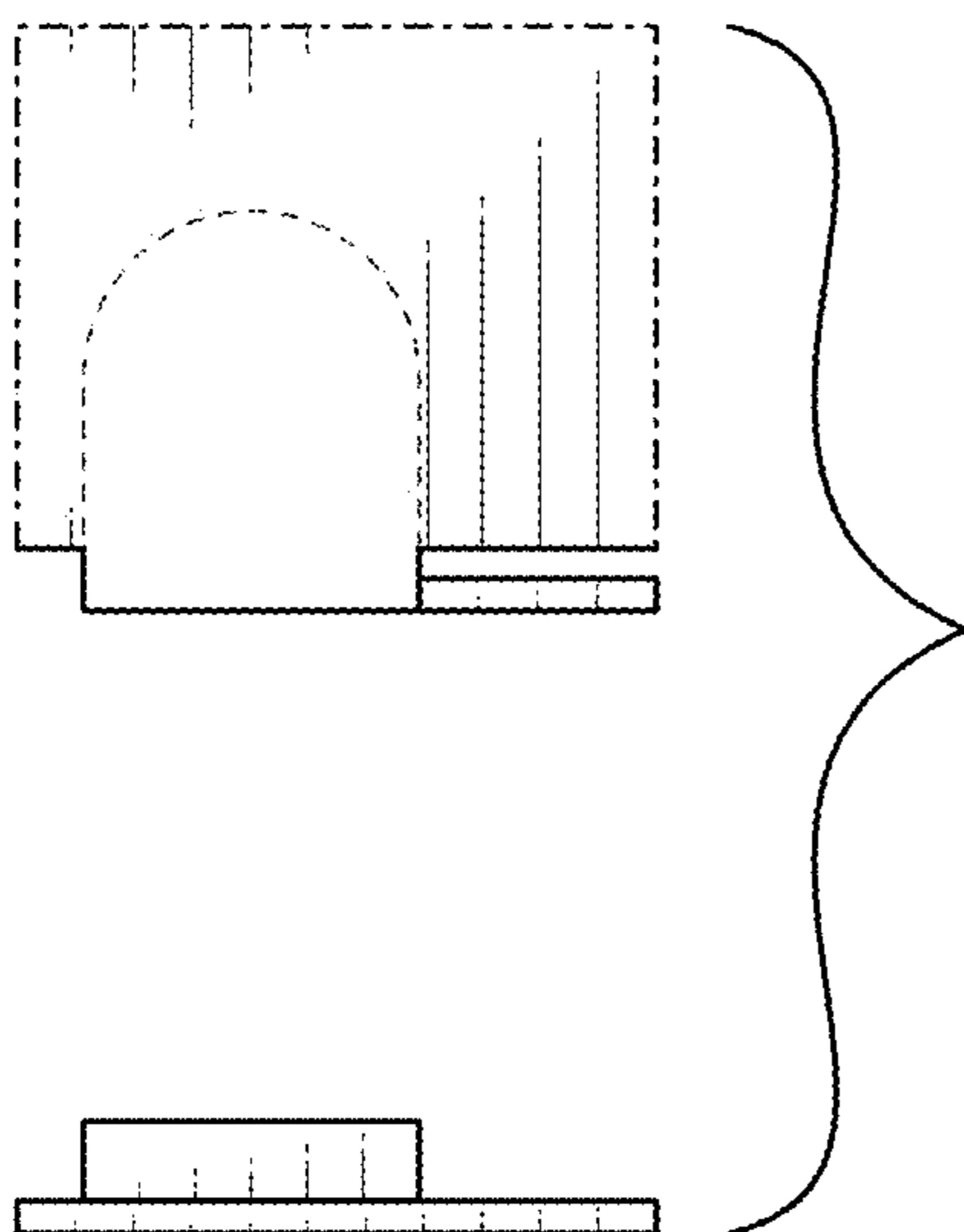

FIG. 9

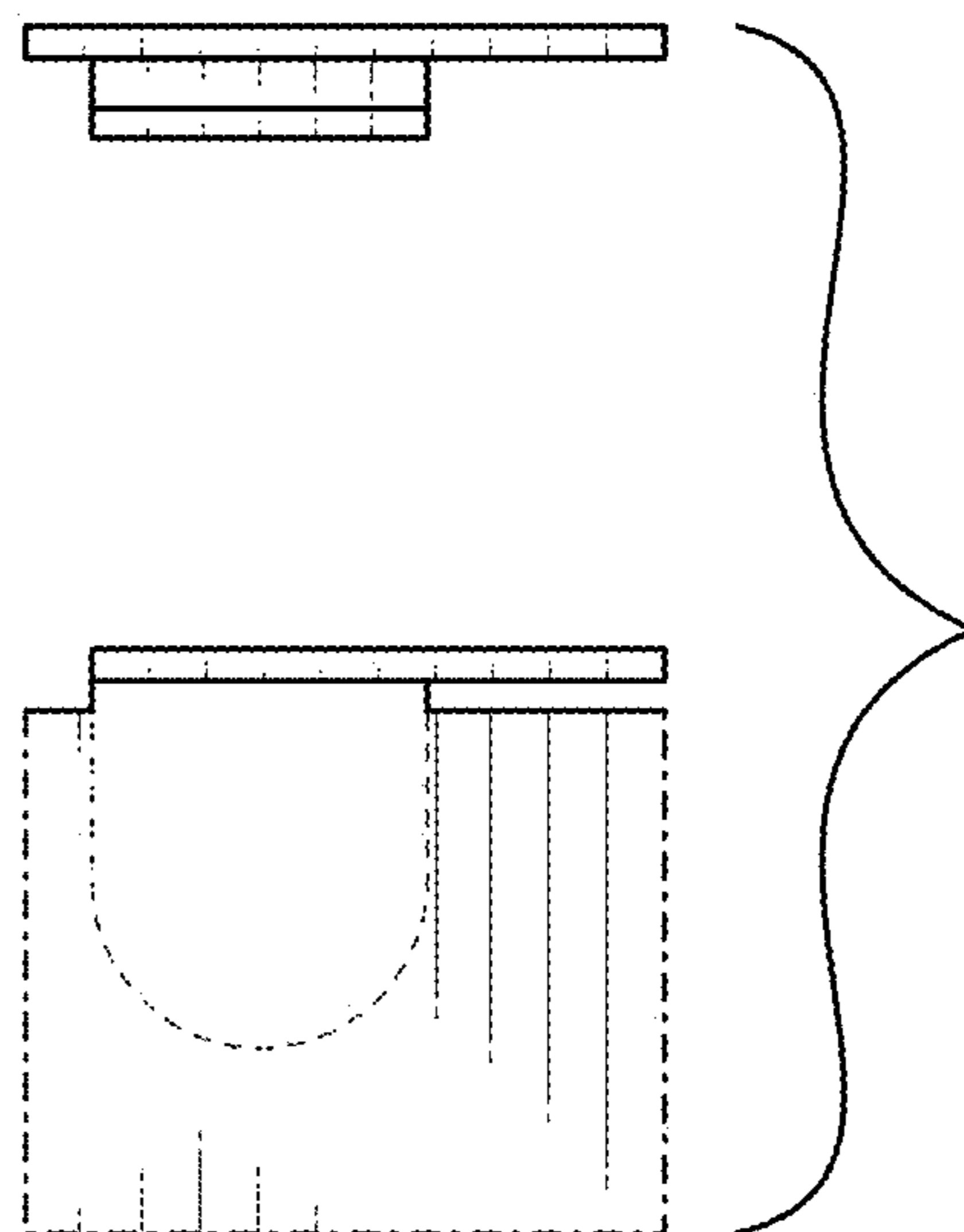

FIG. 10

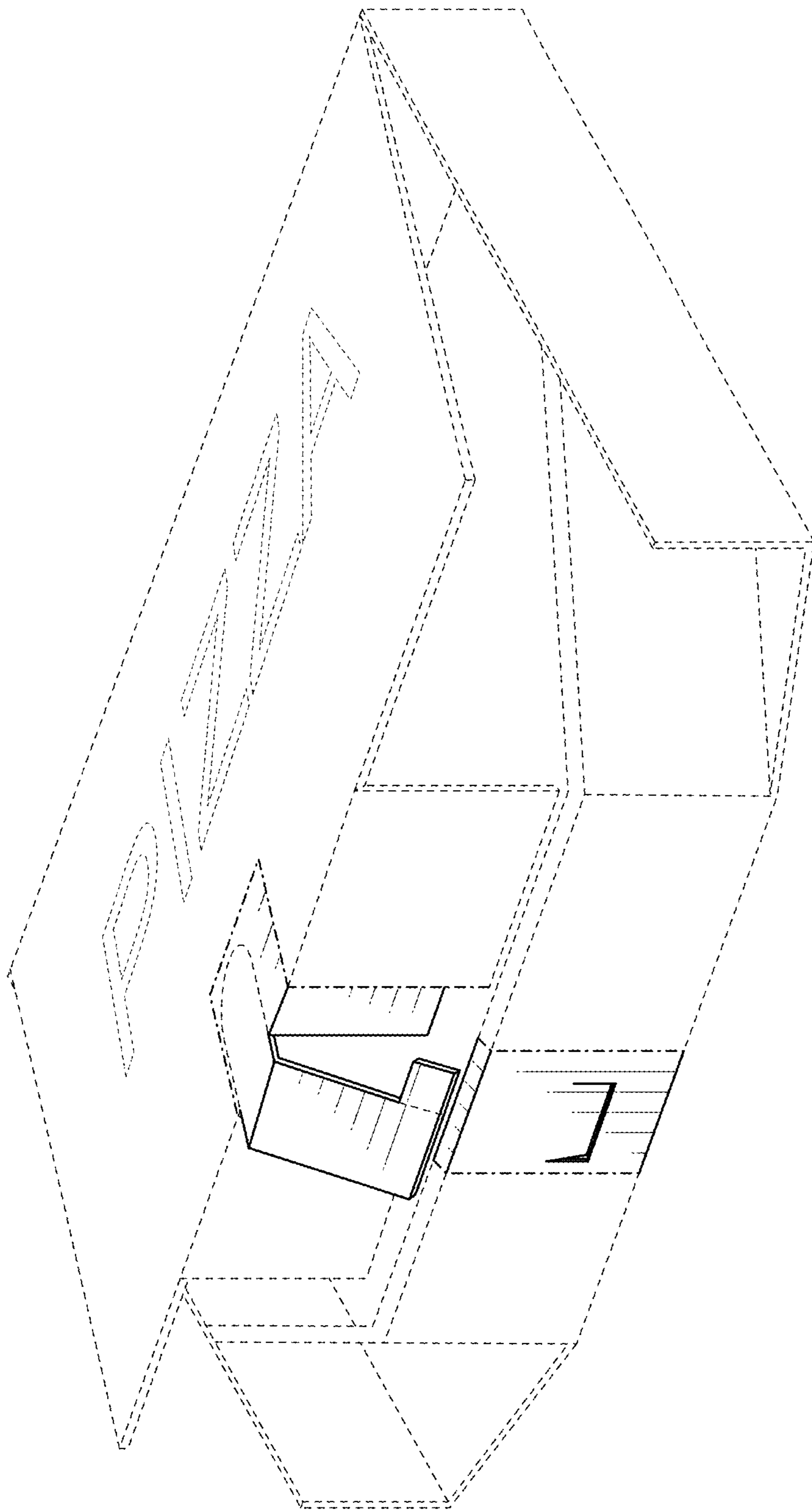

FIG. 11

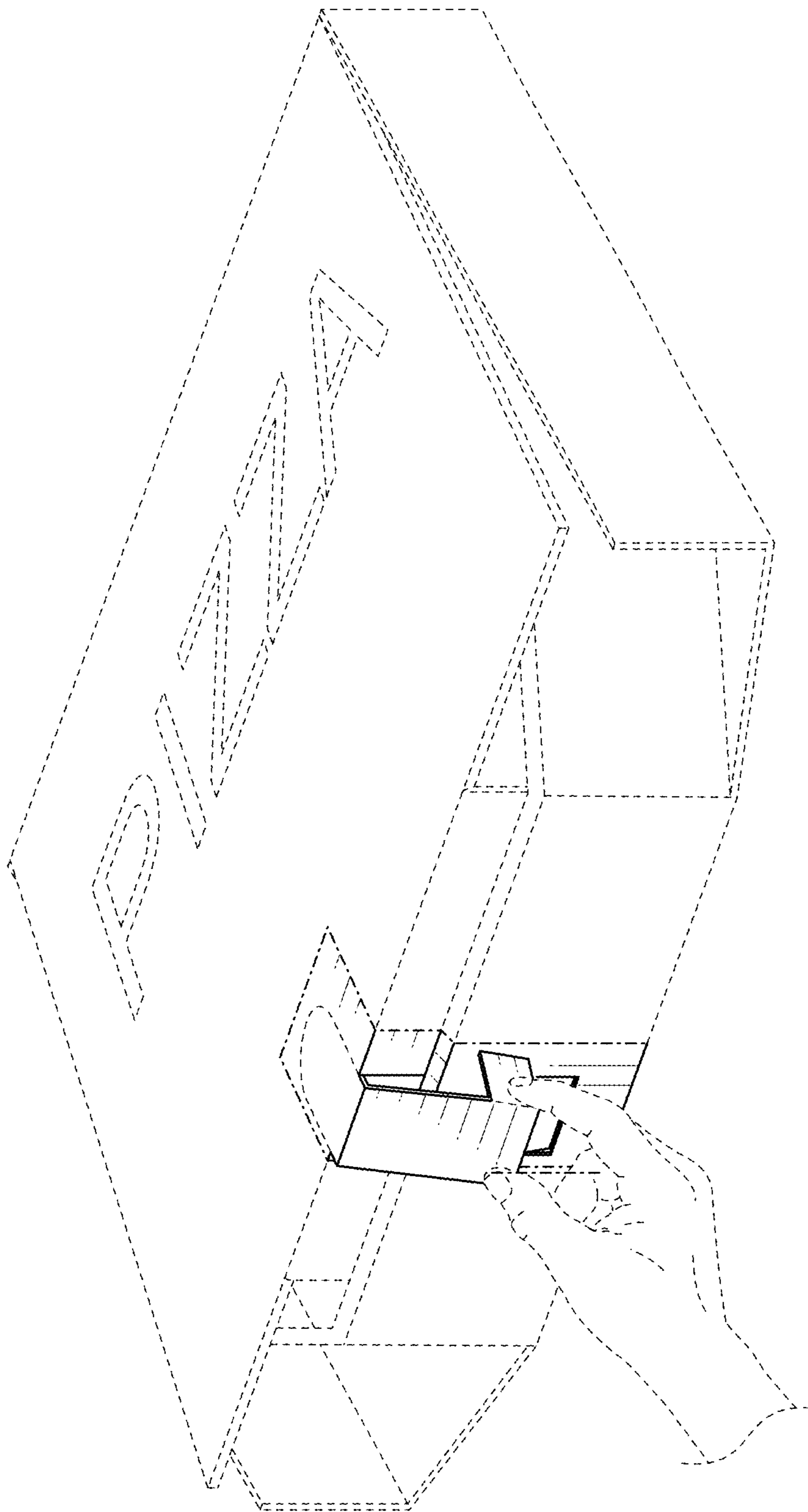

FIG. 12

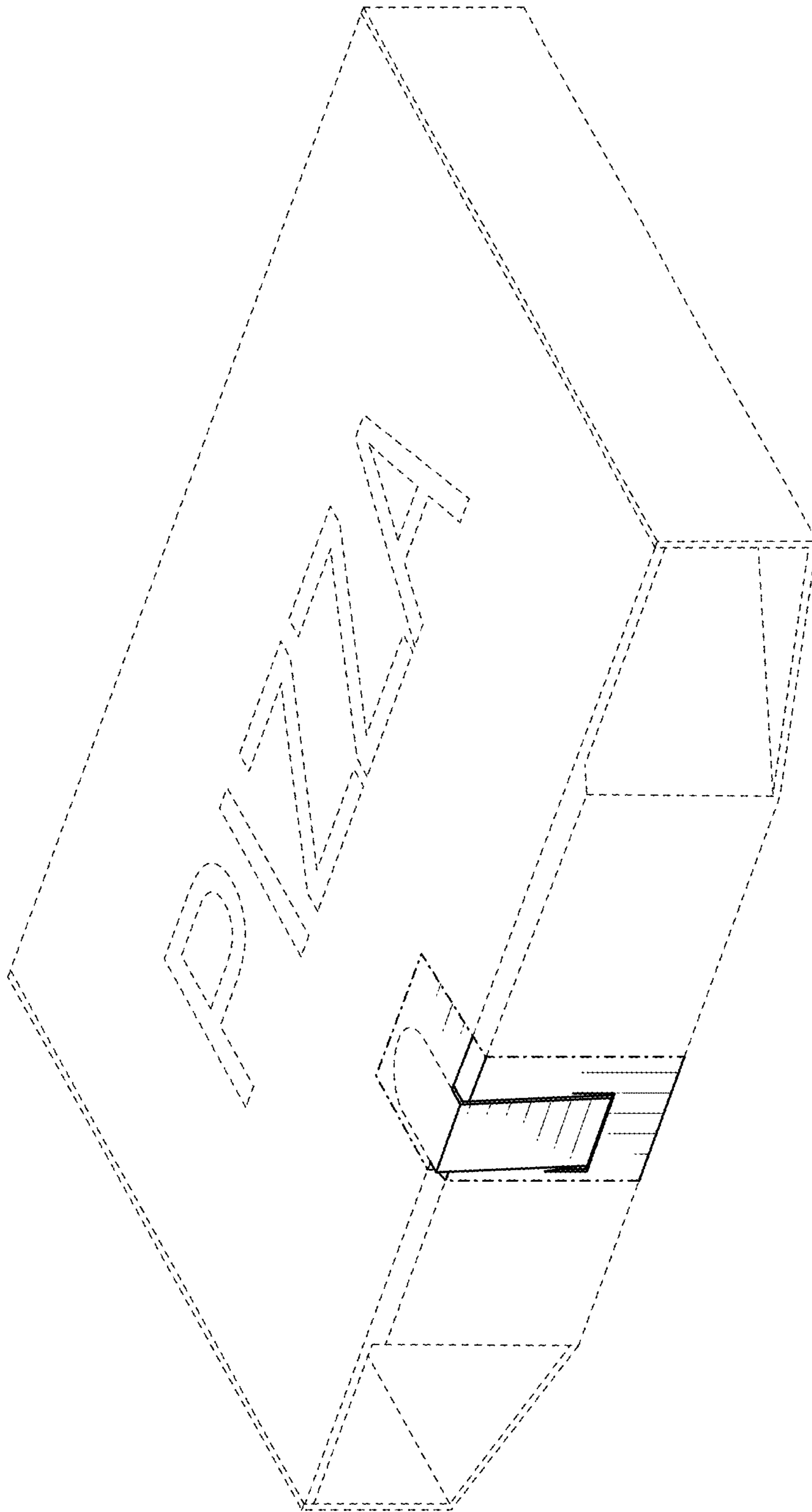

FIG. 13

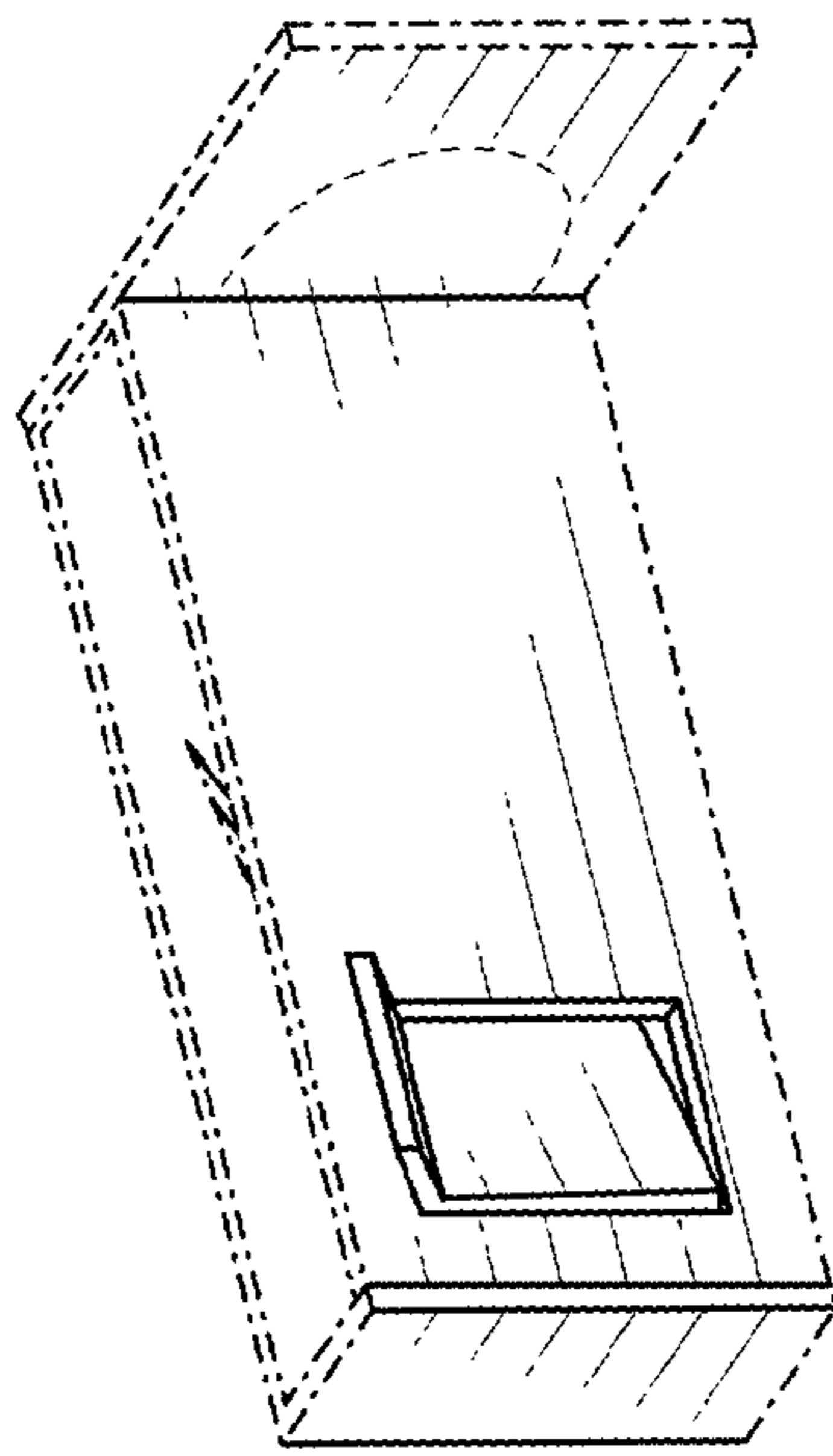

FIG. 14

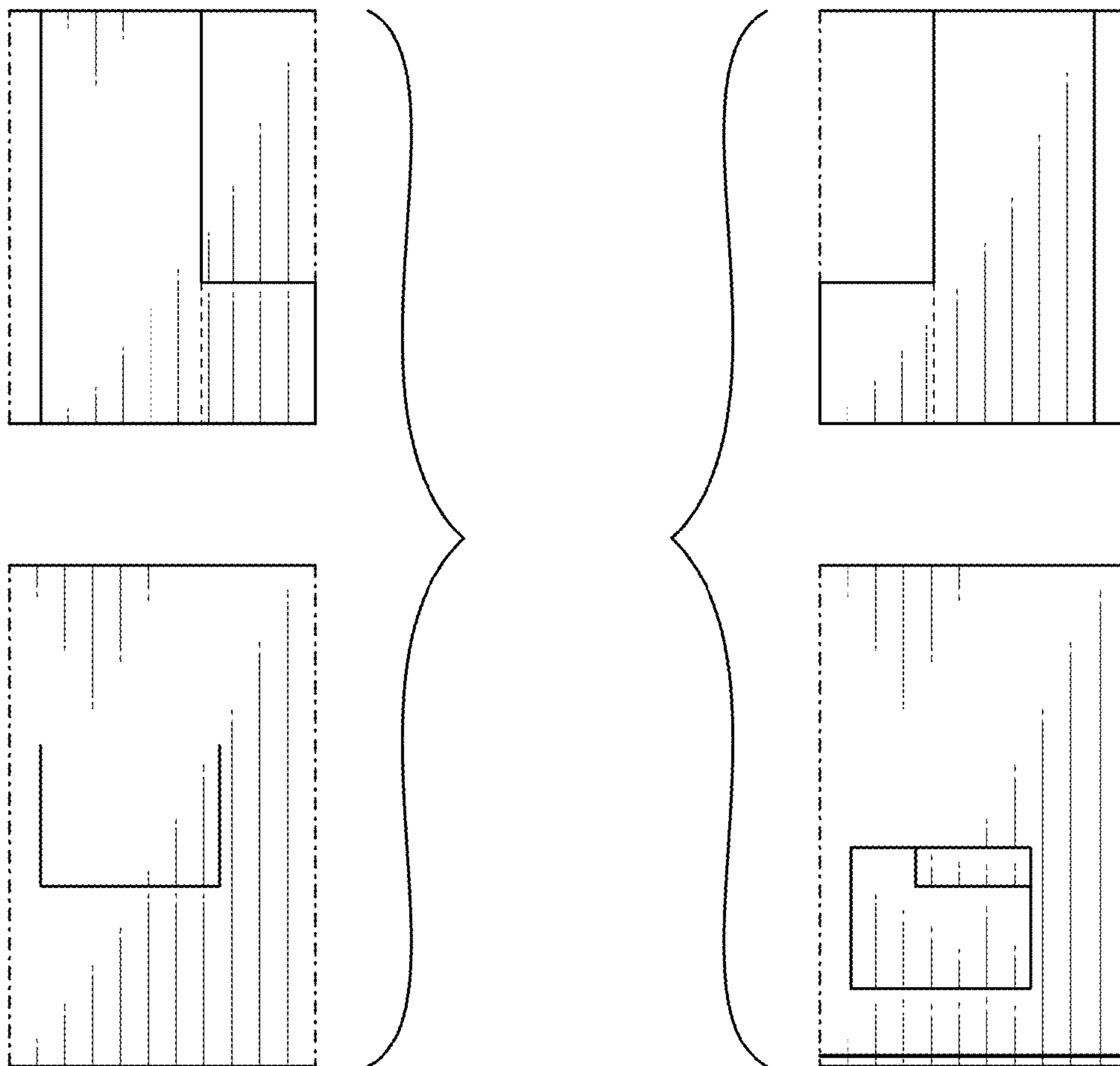

FIG. 15

FIG. 16

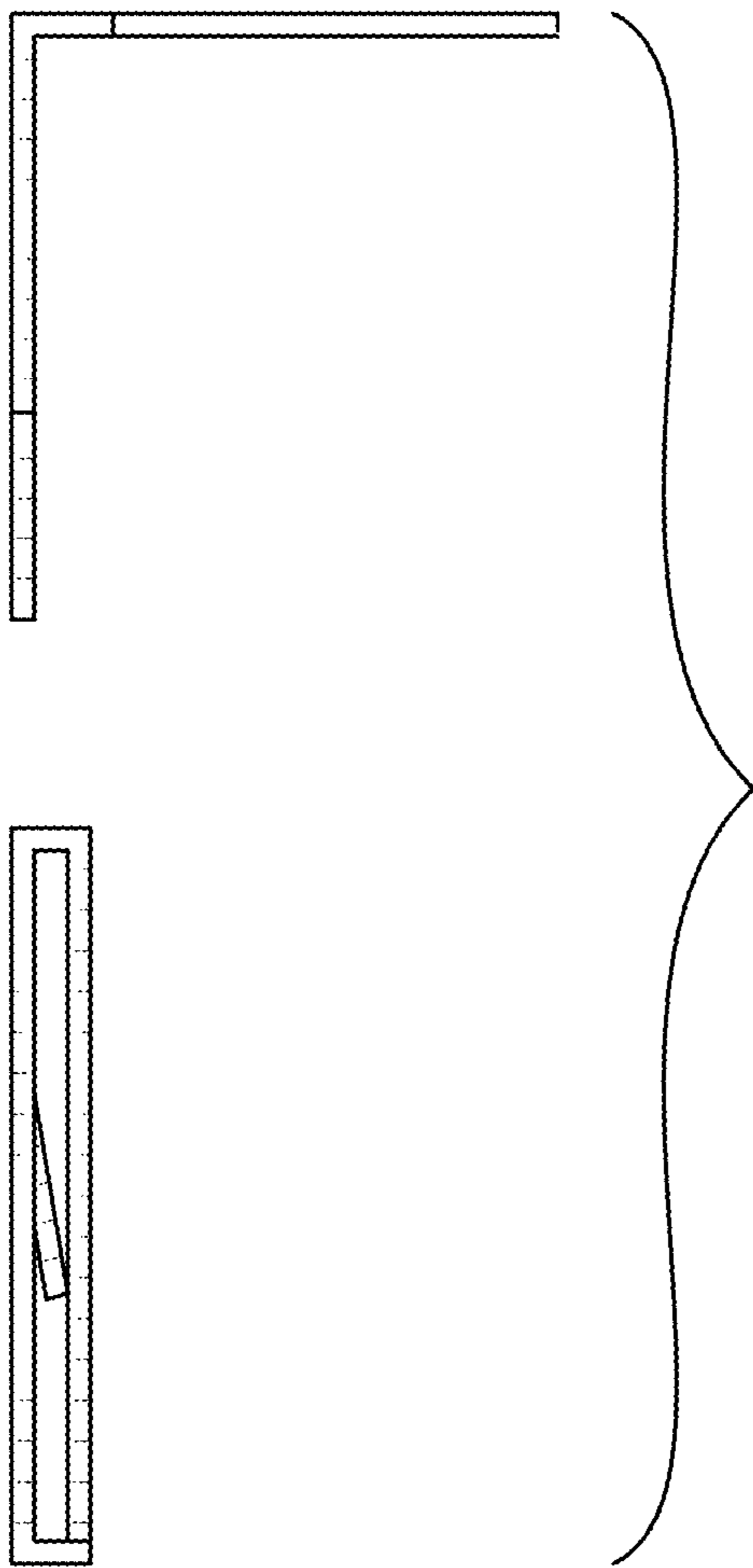

FIG. 17

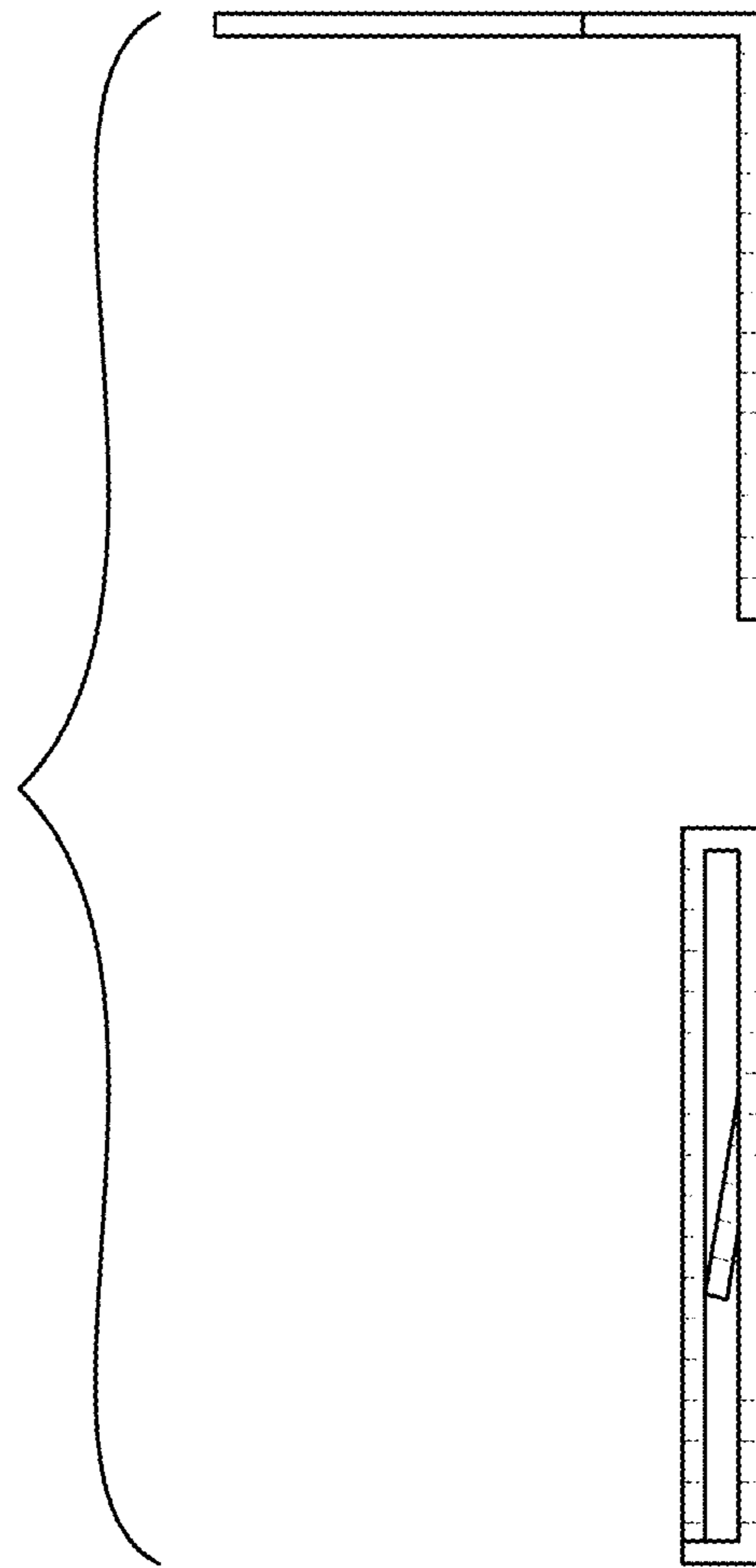

FIG. 18

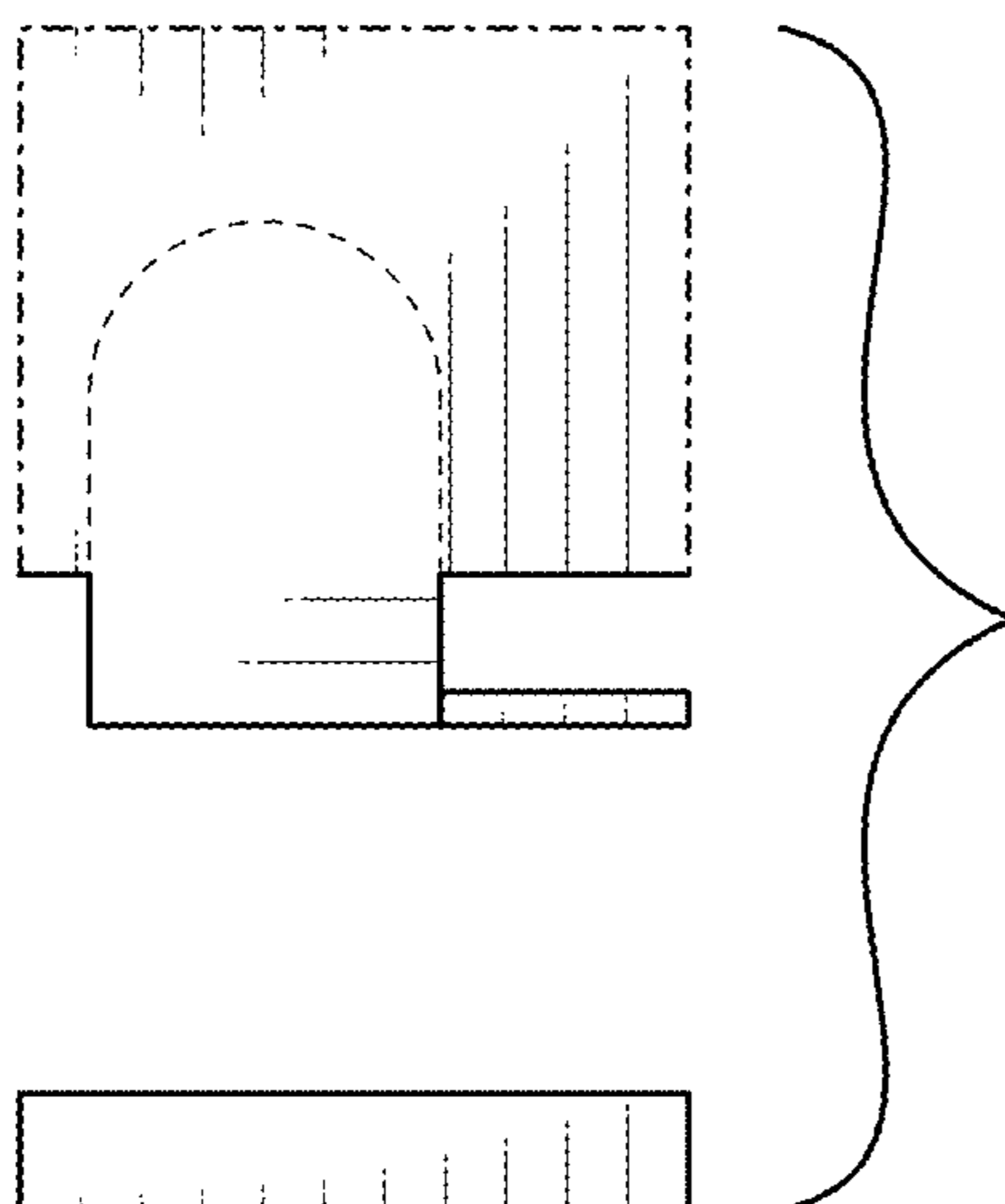

FIG. 19

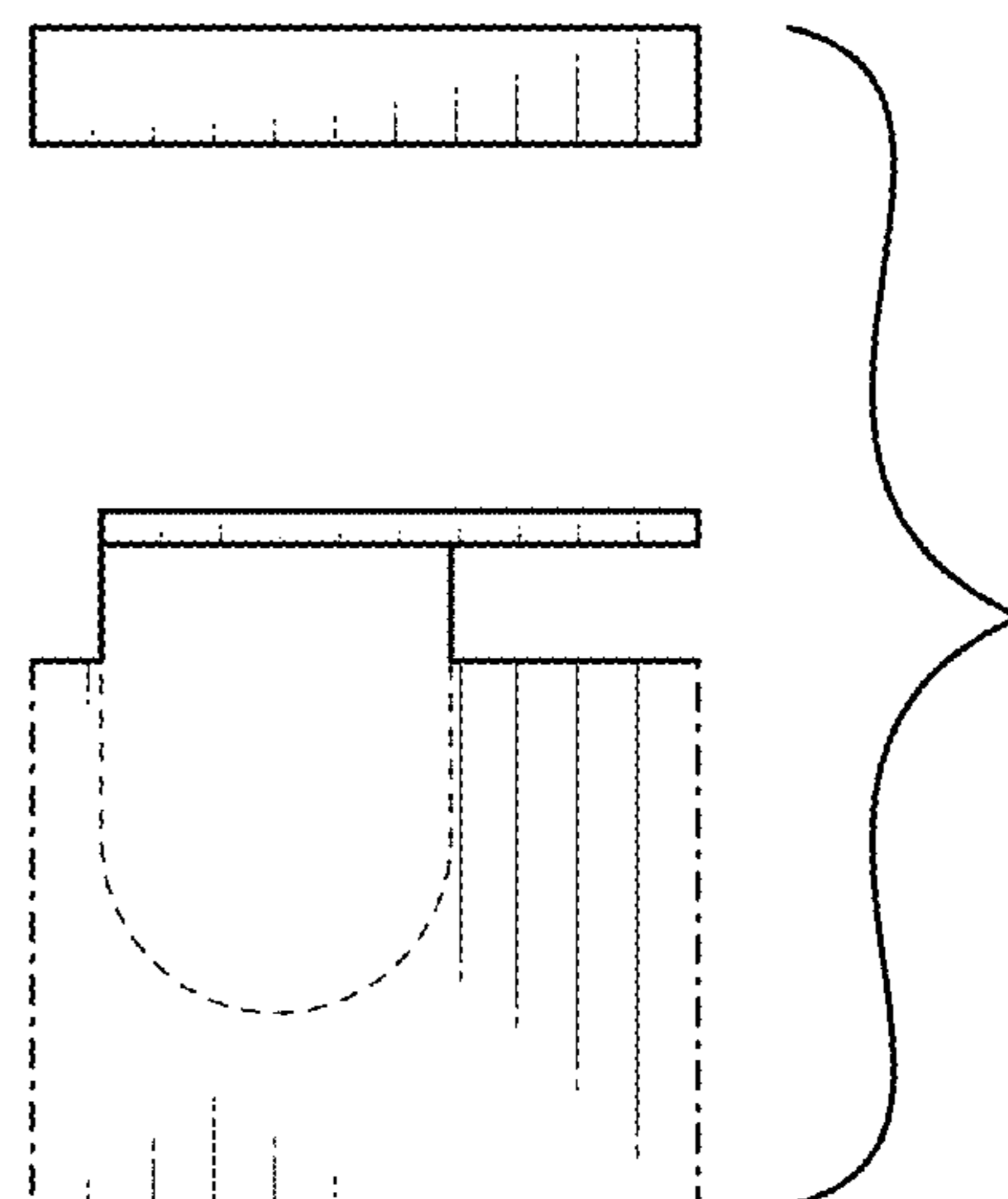

FIG. 20