



US00D965097S

(12) **United States Design Patent**  
**Yang**

(10) **Patent No.:** **US D965,097 S**  
(45) **Date of Patent:** **\*\* Sep. 27, 2022**

(54) **RAT TRAP**

(71) Applicant: **Zeguo Yang**, Guangdong (CN)

(72) Inventor: **Zeguo Yang**, Guangdong (CN)

(\*\*) Term: **15 Years**

(21) Appl. No.: **29/826,682**

(22) Filed: **Feb. 15, 2022**

(51) **LOC (13) Cl.** ..... **22-06**

(52) **U.S. Cl.**  
USPC ..... **D22/119**

(58) **Field of Classification Search**  
USPC ..... D22/119-120; 43/58, 60-61, 69, 81  
CPC ..... A01M 23/00; A01M 23/02; A01M 23/08  
See application file for complete search history.

(56) **References Cited**

**U.S. PATENT DOCUMENTS**

D244,773 S	6/1977	Curtis	
4,342,172 A *	8/1982	Guanci	A01M 23/18
			43/61
5,778,594 A *	7/1998	Askins	A01M 23/18
			43/61
7,026,942 B2 *	4/2006	Cristofori	A01M 23/04
			43/81
D898,158 S *	10/2020	Wang	D22/119
D925,000 S *	7/2021	Daniil	D22/119
D926,917 S	8/2021	Daniil	

**OTHER PUBLICATIONS**

[https://www.amazon.com/Joozer-Release-Reusable-Chipmunks-Squirrels/dp/B09TDGGKYC/ref=sr\\_1\\_5?crd=3IV3NYTPUEPG5&keywords=rat+trap+cage+with+two+openings&qid=1659553832&srprefix=rat+trap+cage+with+two+openings%2Caps%2C57&sr=8-5](https://www.amazon.com/Joozer-Release-Reusable-Chipmunks-Squirrels/dp/B09TDGGKYC/ref=sr_1_5?crd=3IV3NYTPUEPG5&keywords=rat+trap+cage+with+two+openings&qid=1659553832&srprefix=rat+trap+cage+with+two+openings%2Caps%2C57&sr=8-5) (Year: 2022).\*

\* cited by examiner

*Primary Examiner* — Catherine R Oliver-Garcia  
(74) *Attorney, Agent, or Firm* — Che-Yang Chen; Law Office of Michael Chen

(57) **CLAIM**

The ornamental design for a rat trap, as shown and described.

**DESCRIPTION**

FIG. 1 is a perspective view of the rat trap showing my new design;  
FIG. 2 is a perspective view thereof from another angle;  
FIG. 3 is a front elevational view thereof;  
FIG. 4 is a rear elevational view thereof;  
FIG. 5 is a left side elevational view thereof;  
FIG. 6 is a right side elevational view thereof;  
FIG. 7 is a top plan view thereof; and,  
FIG. 8 is a bottom plan view thereof.  
The broken lines shown in the drawings are included for the purpose of illustrating portions of the rat trap that form no part of the claimed design.

**1 Claim, 8 Drawing Sheets**

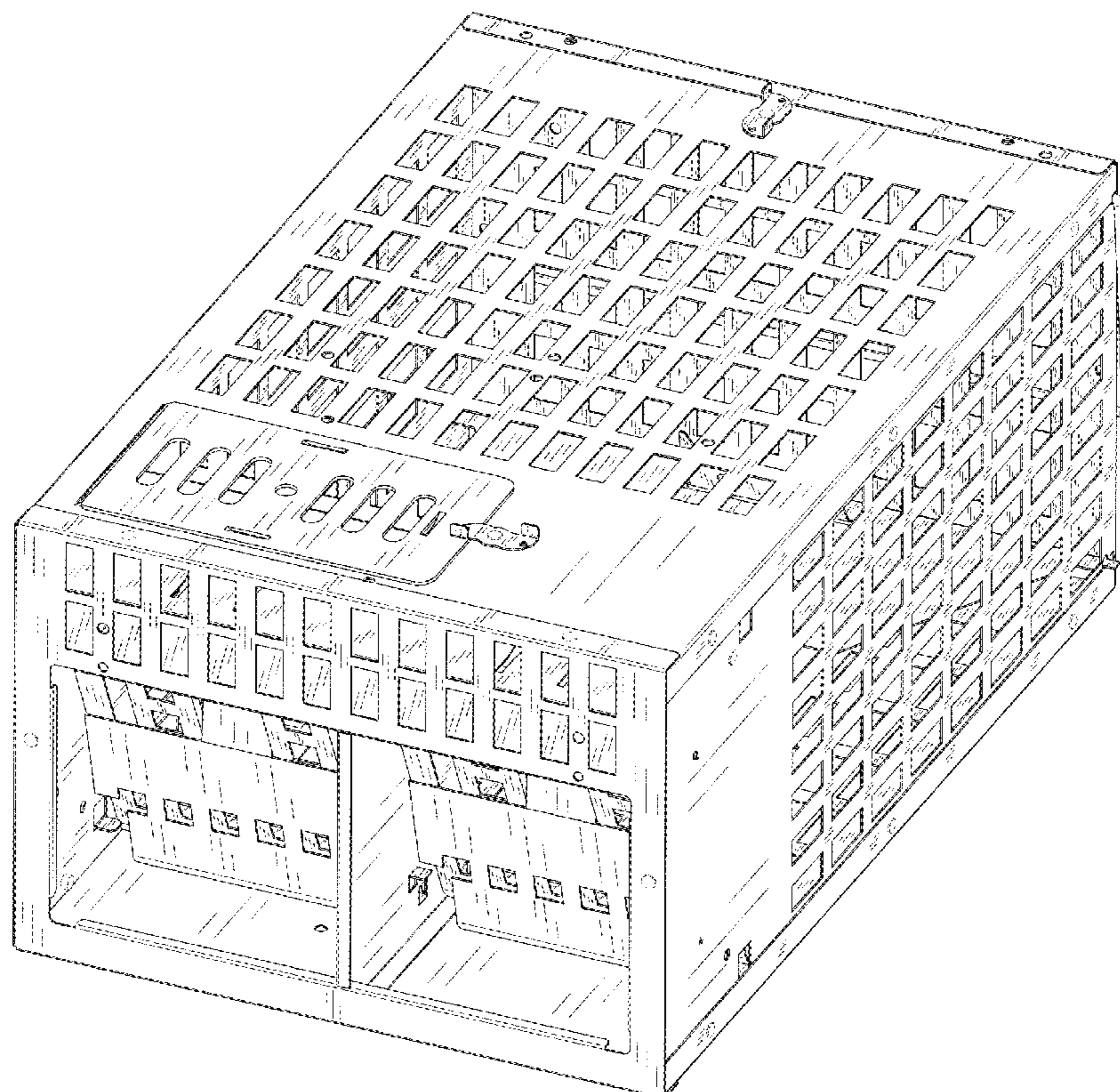

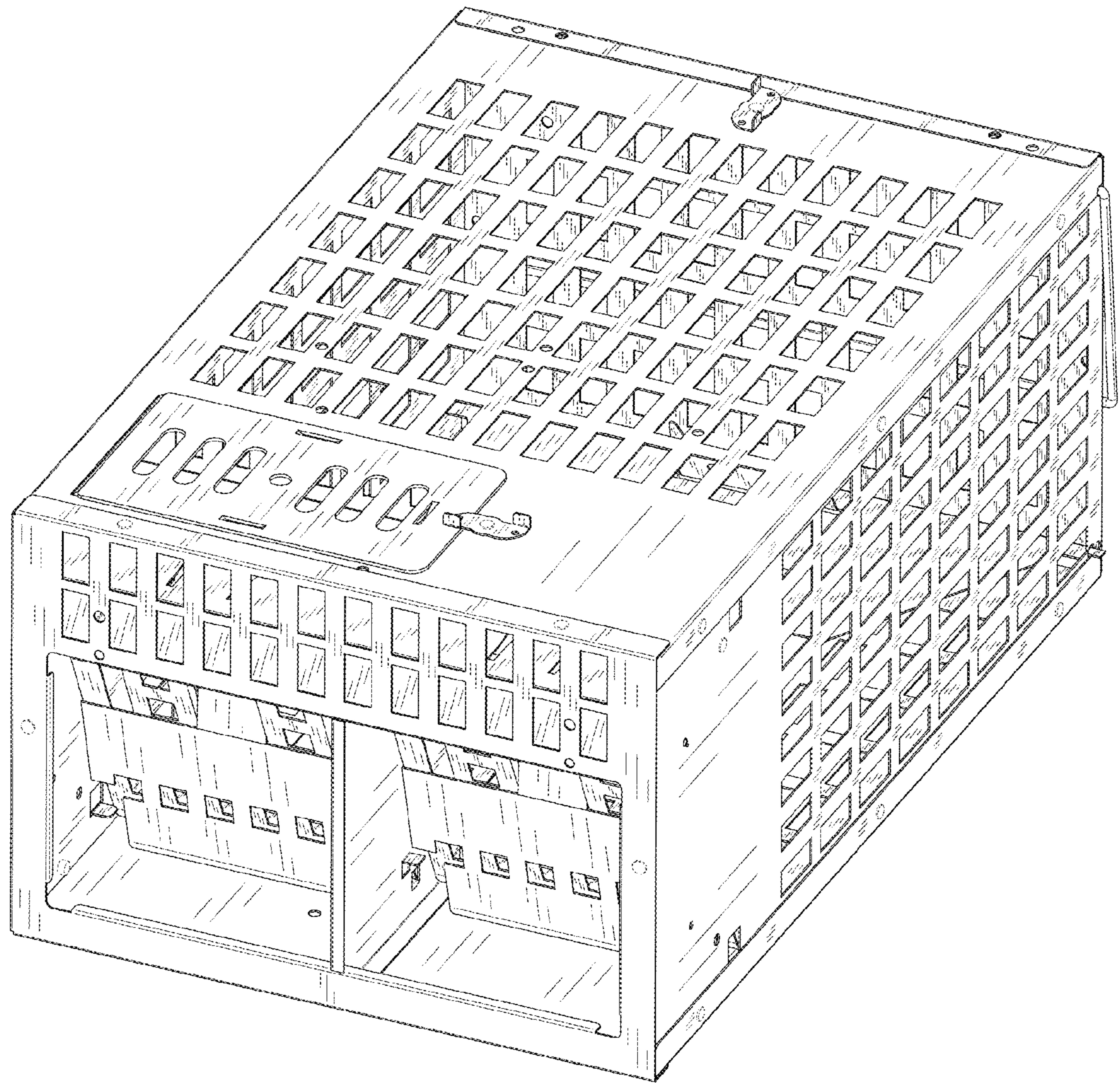

FIG. 1

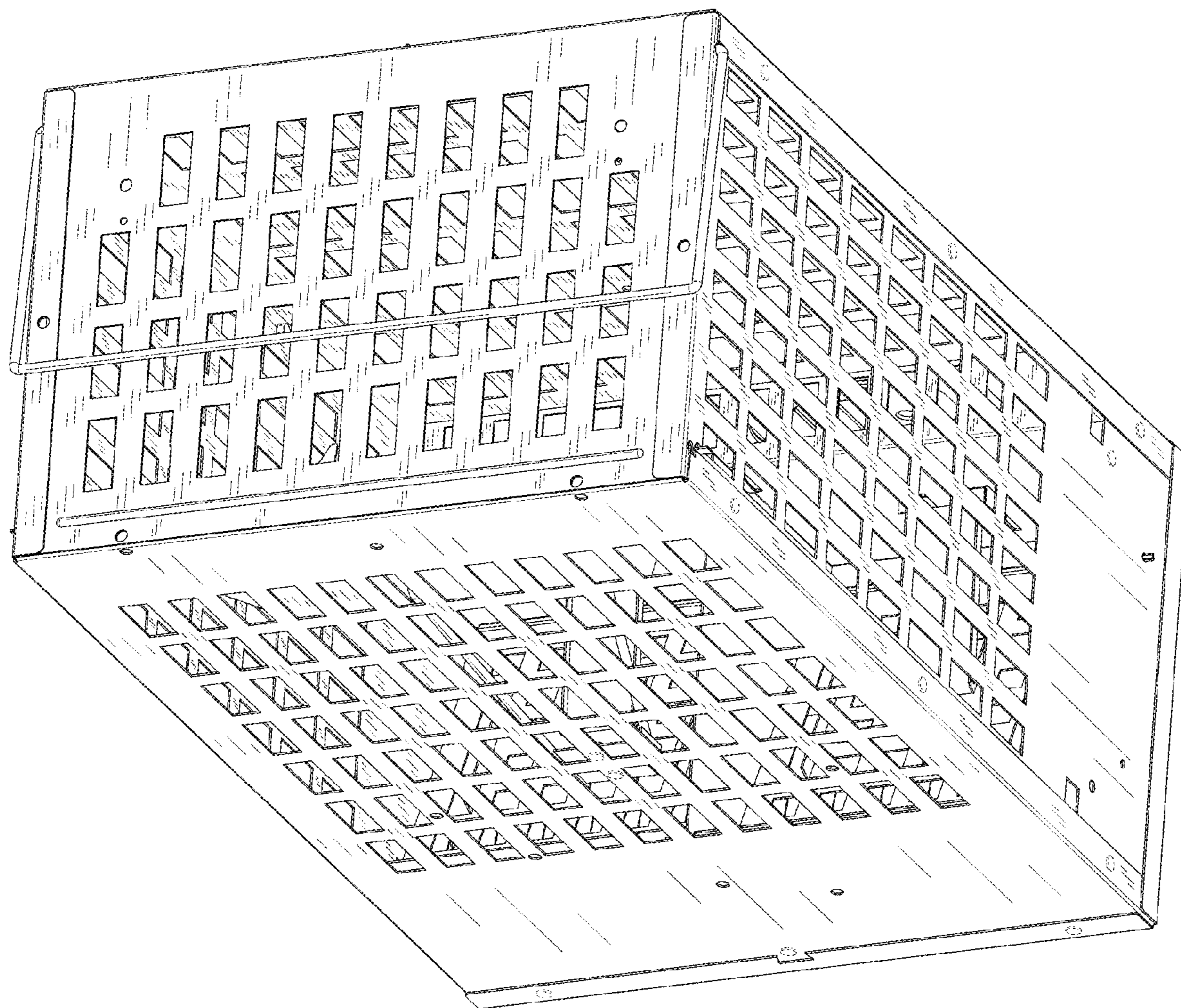

FIG. 2



FIG. 3

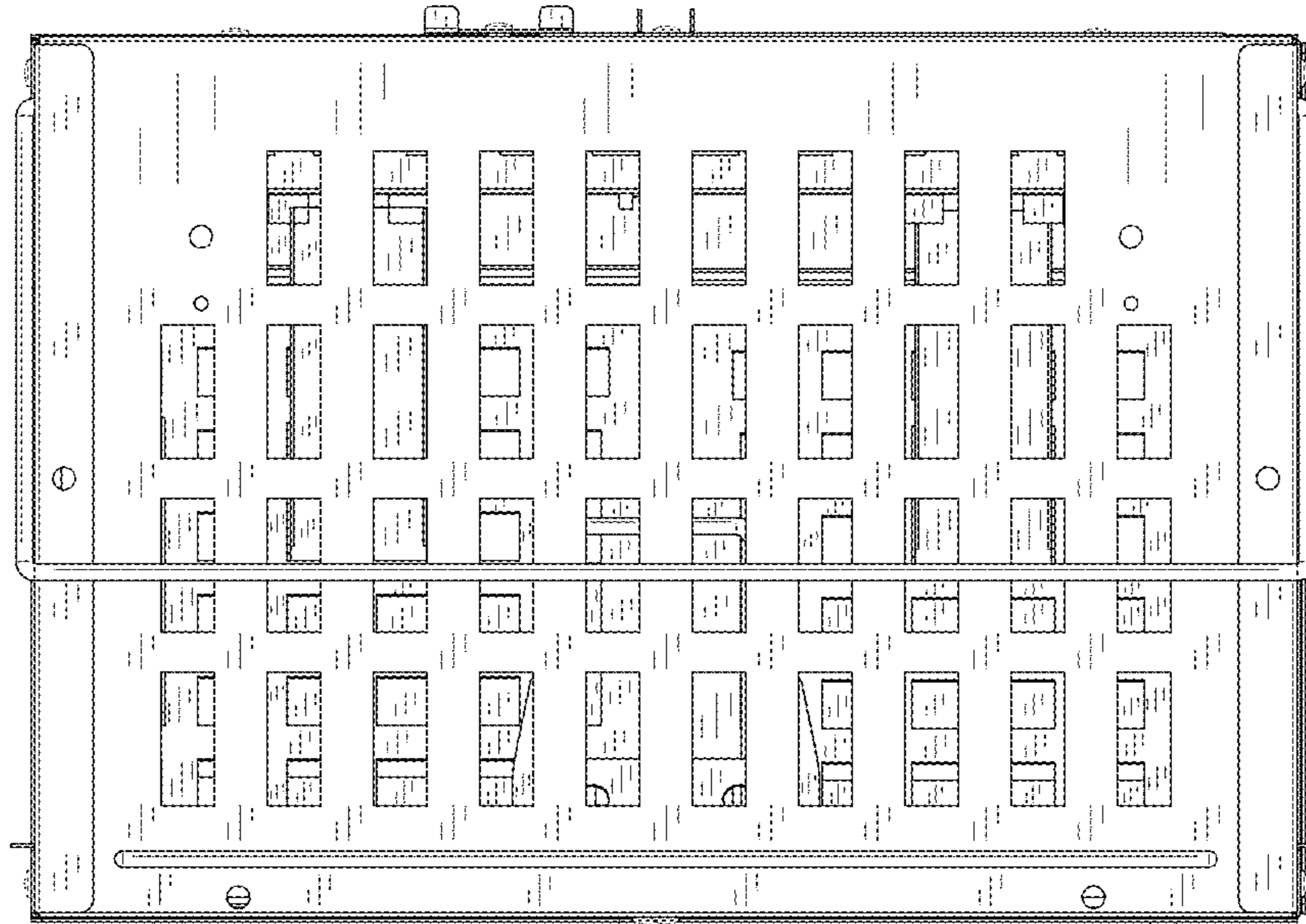

FIG. 4

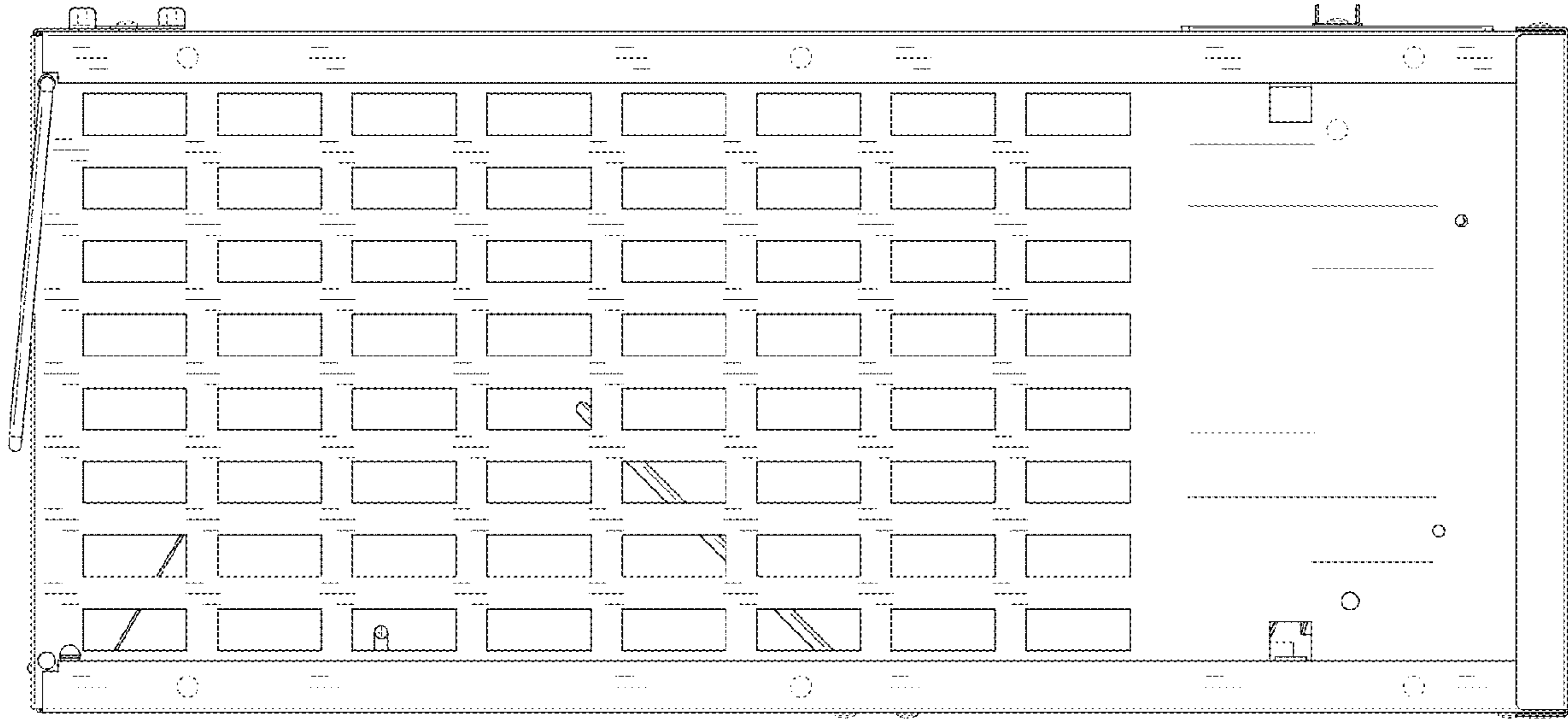

FIG. 5

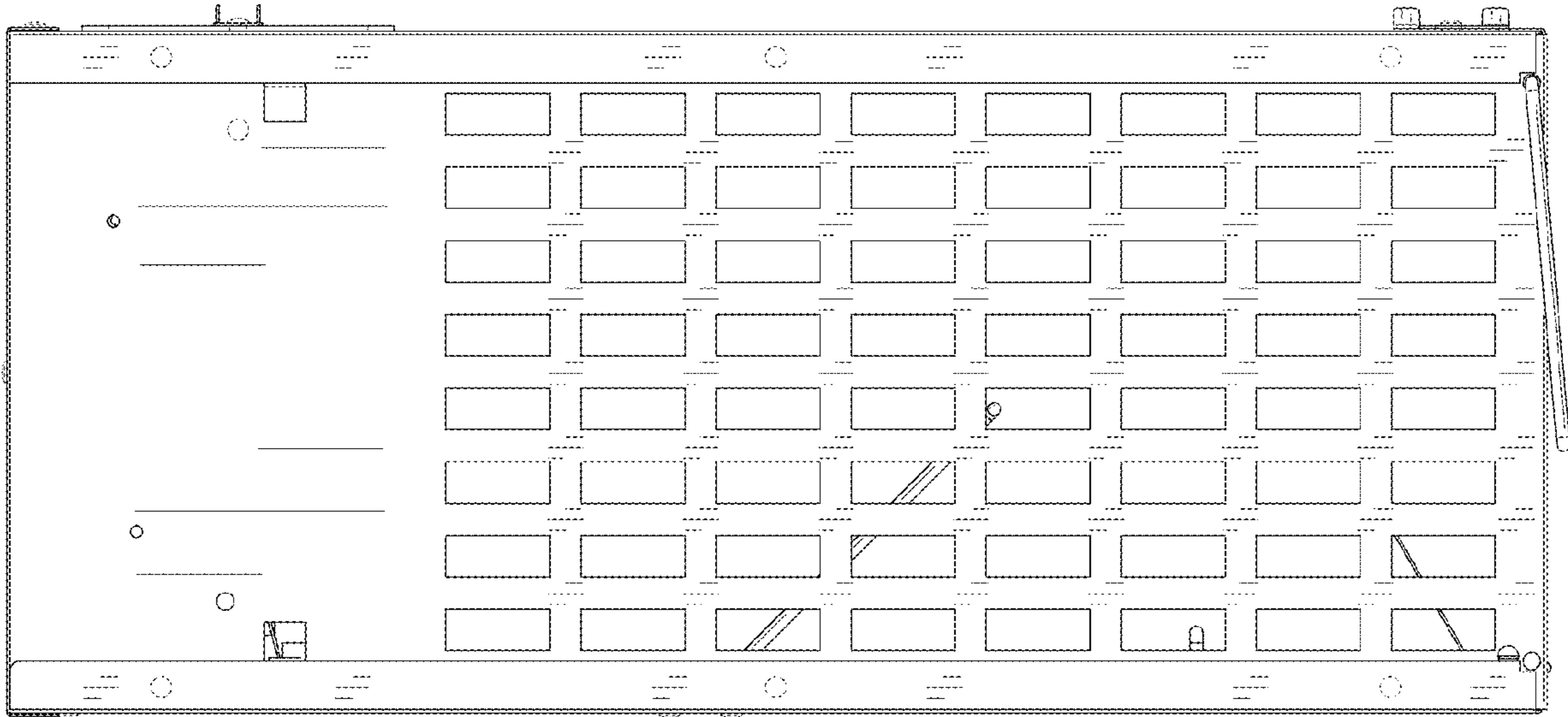

FIG. 6

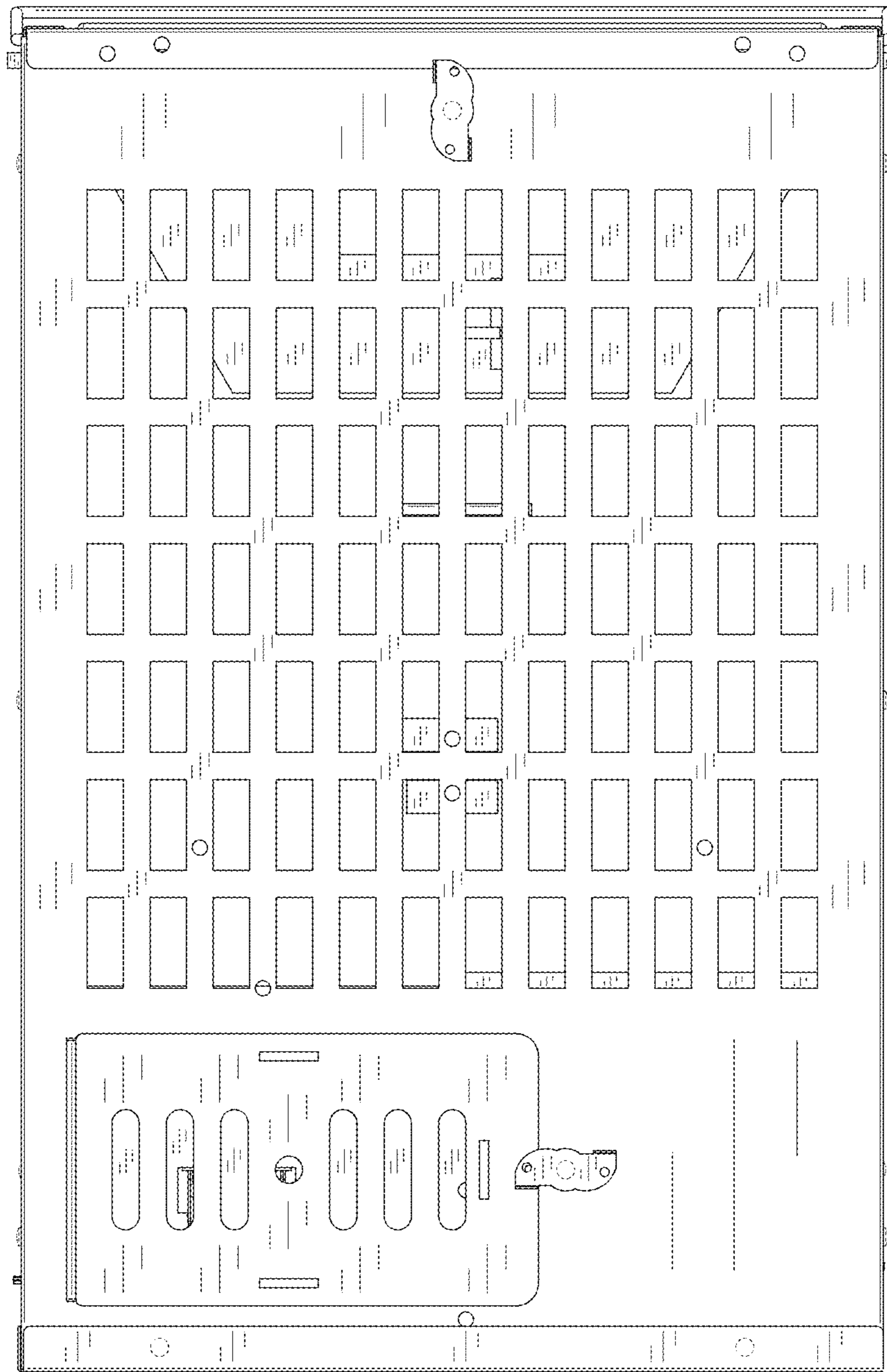

FIG. 7



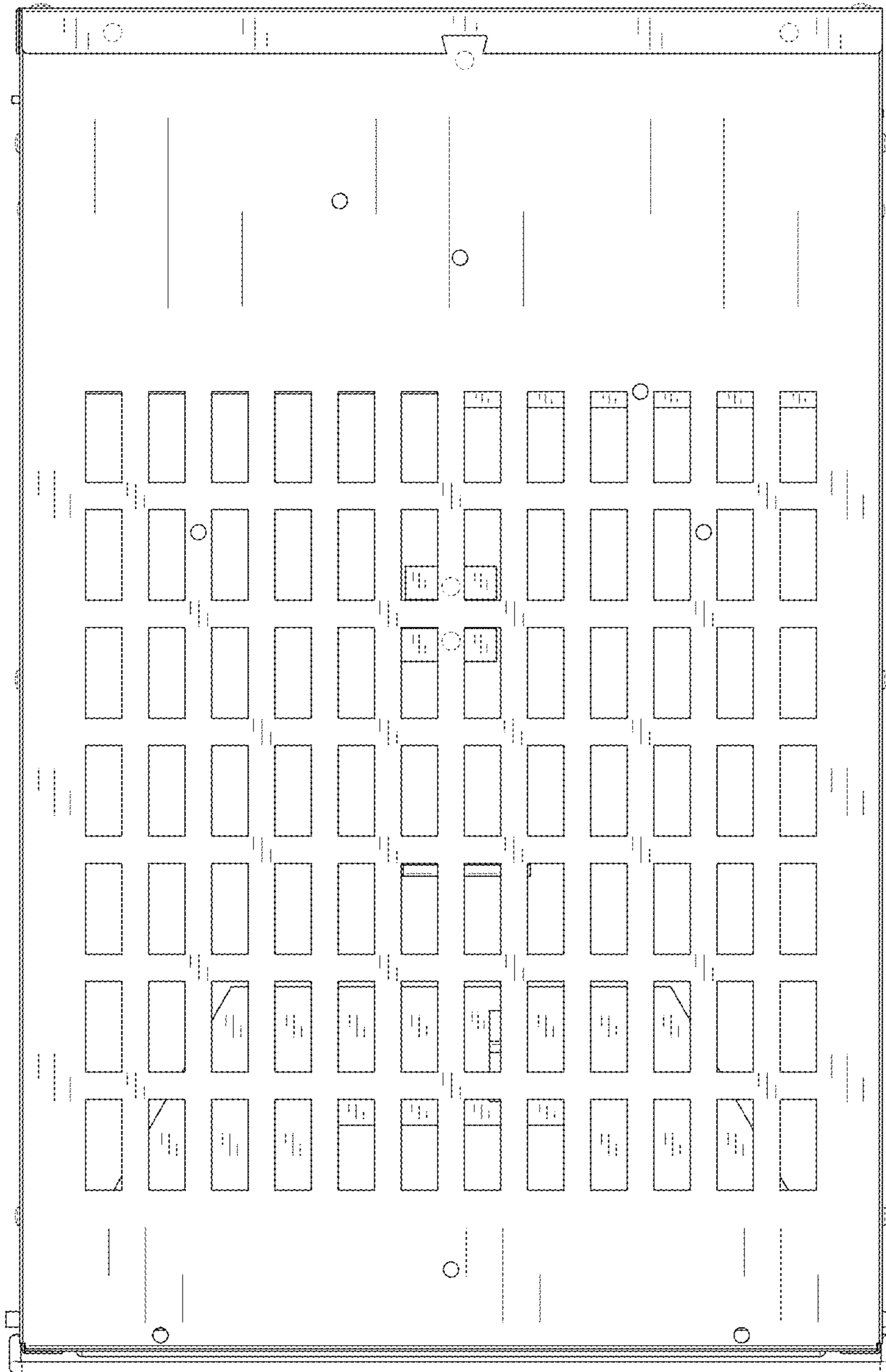

FIG. 8