



US00D964410S

(12) **United States Design Patent** (10) **Patent No.:** **US D964,410 S**
Segerud et al. (45) **Date of Patent:** **** Sep. 20, 2022**

(54) **DISPLAY SCREEN OR PORTION THEREOF WITH GRAPHICAL USER INTERFACE**

D708,213 S * 7/2014 Honda D14/489
D733,722 S * 7/2015 Ueda D14/485
D752,097 S * 3/2016 Park D14/489

(71) Applicant: **VOLVO CAR CORPORATION**,
Gothenburg (SE)

(Continued)

(72) Inventors: **Linus Segerud**, Landvetter (SE); **Kevin Orende**, Gothenburg (SE); **Sara Jange**, Gothenburg (SE)

FOREIGN PATENT DOCUMENTS

CN 304081391 * 3/2017
CN 307192346 * 3/2022

(73) Assignee: **VOLVO CAR CORPORATION**,
Gothenburg (SE)

OTHER PUBLICATIONS

(**) Term: **15 Years**

“Jaguar XE InControl Touch Pro” Sep. 24, 2021, AutoInterfaces, site visited May 20, 2022: <https://www.autointerfaces.com/interface/jaguar-2020-f-pace-incontroltouchpro-00012> (Year: 2021).*

(21) Appl. No.: **29/774,021**

(Continued)

(22) Filed: **Mar. 12, 2021**

Primary Examiner — Jack Reickel

Assistant Examiner — Christopher M Spivey

(30) **Foreign Application Priority Data**

(74) *Attorney, Agent, or Firm* — Berenato & White, LLC

Sep. 25, 2020 (EM) 008183586-0007

(51) **LOC (13) Cl.** **14-04**

(52) **U.S. Cl.**
USPC **D14/486**

(58) **Field of Classification Search**
USPC D14/485–495; D12/192
CPC B60L 2240/80; B60L 2240/34; B60L 2260/52; B60L 3/0069; B60L 58/12; B60L 2250/16; B60K 2370/11; B60K 2370/155; B60K 2370/115; B60K 2370/119; B60K 2370/1438; B60K 2370/152; B60K 2370/167; G06F 3/04817; G06F 3/0482; G06F 3/0488; G06F 3/04845; G06F 3/0481; G06F 3/017; B60H 1/00985

See application file for complete search history.

(56) **References Cited**

U.S. PATENT DOCUMENTS

D568,336 S * 5/2008 Miglietta D14/492
D589,054 S * 3/2009 Koursoumidis D14/492

(57) **CLAIM**

The ornamental design for a display screen or portion thereof with graphical user interface, as shown and described.

DESCRIPTION

FIG. 1 is a front view of a display screen or portion thereof with graphical user interface, showing our new design; and, FIG. 2 is a second image thereof.

The appearance of the transitional image sequentially transitions between the images shown in FIGS. 1-2. The process or period in which one image transitions to another image forms no part of the claimed design.

The broken line showing, in all values, of graphical user interface elements is included for the purpose of illustrating portions of the article and forms no part of the claimed design. The edge of the display screen or portion thereof is understood to be flush with edge of the claimed surface, as demarcated by tonal fill.

1 Claim, 2 Drawing Sheets

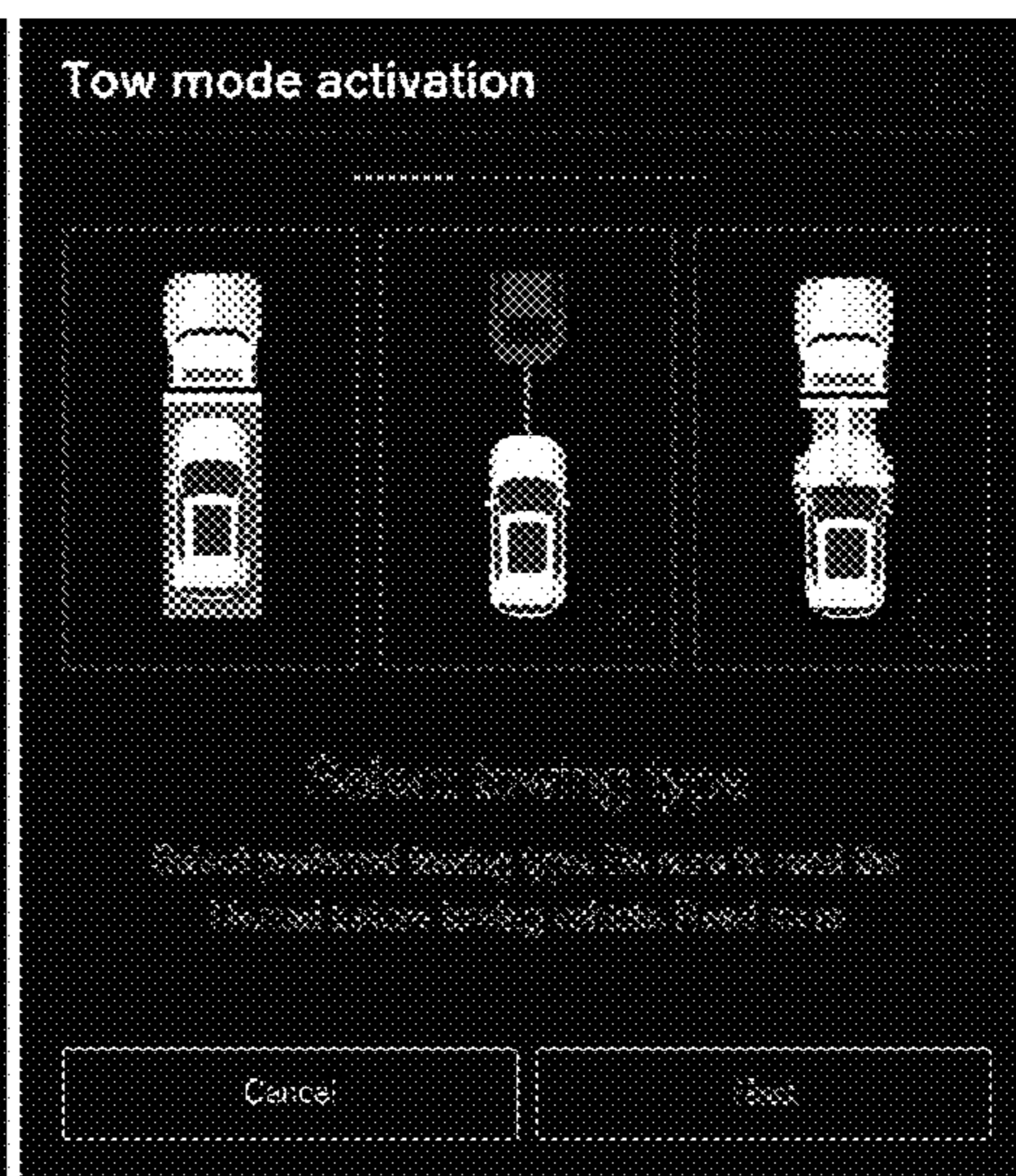
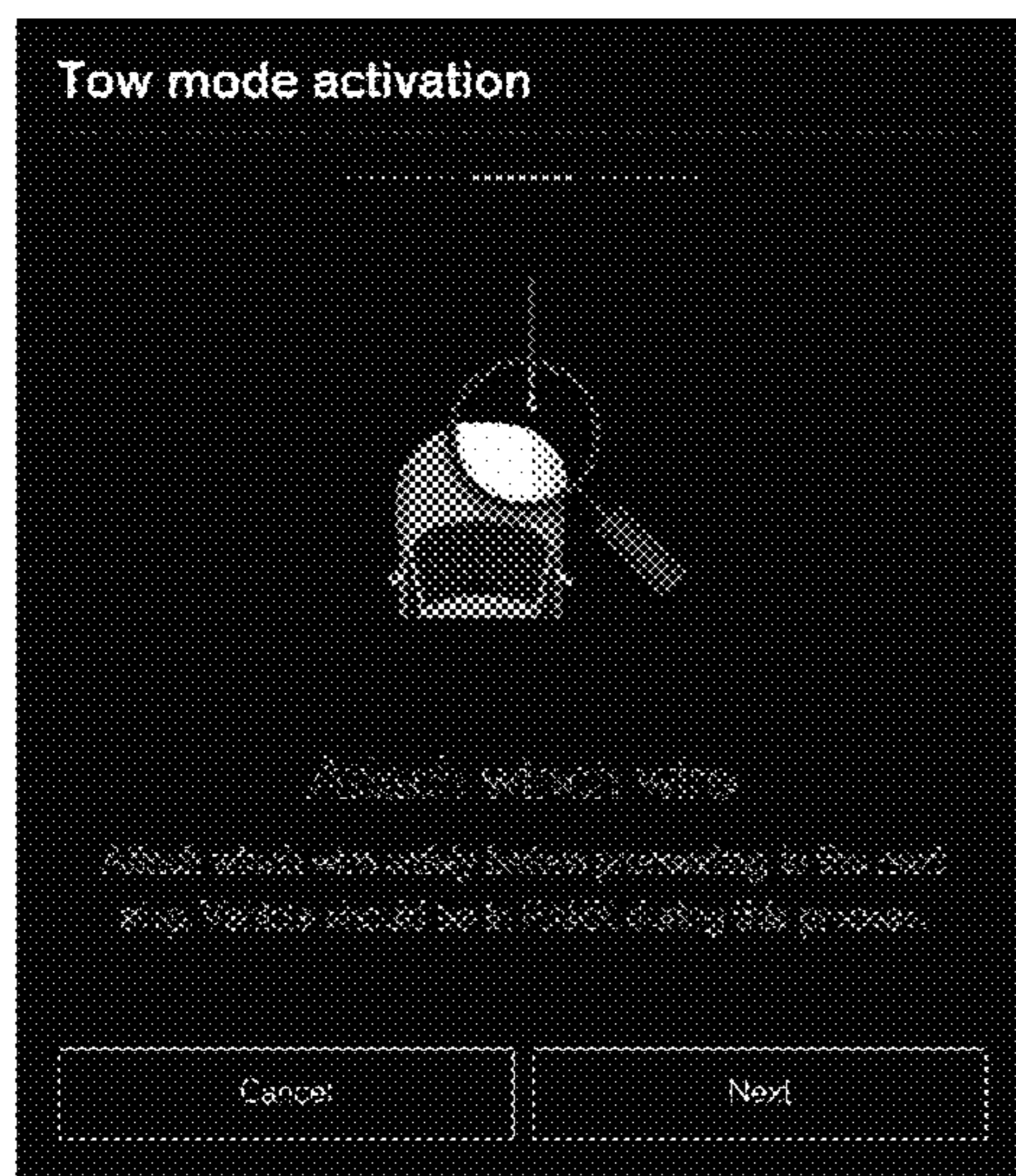

(56)

References Cited

U.S. PATENT DOCUMENTS

D774,546 S * 12/2016 Tursi D14/493
D777,760 S * 1/2017 Zhao D14/490
D839,882 S * 2/2019 Han D14/485
D888,723 S * 6/2020 Jung D14/485
D903,704 S * 12/2020 Lindberg D14/486
D905,086 S * 12/2020 Lindberg D14/486
D916,808 S * 4/2021 Lindberg D14/488
D916,919 S * 4/2021 Lindberg D14/492
D946,616 S * 3/2022 Tsai D14/488
D951,994 S * 5/2022 Imaishi D14/489
2019/0204827 A1 * 7/2019 Bhalla B60W 50/14
2021/0156705 A1 * 5/2021 Pietryka G01C 21/3658
2021/0179077 A1 * 6/2021 Tsujino B62D 15/0285
2021/0300341 A1 * 9/2021 Shoda G06V 20/588
2022/0114655 A1 * 4/2022 Chen G06Q 30/0645

OTHER PUBLICATIONS

“Tow Charging Tesla at 70MPH for 25 miles” Jun. 16, 2021,
YouTube, site visited May 20, 2022: [https://www.youtube.com/
watch?v=nLLM_DEdBqM&t=268s](https://www.youtube.com/watch?v=nLLM_DEdBqM&t=268s) (Year: 2021).*

* cited by examiner

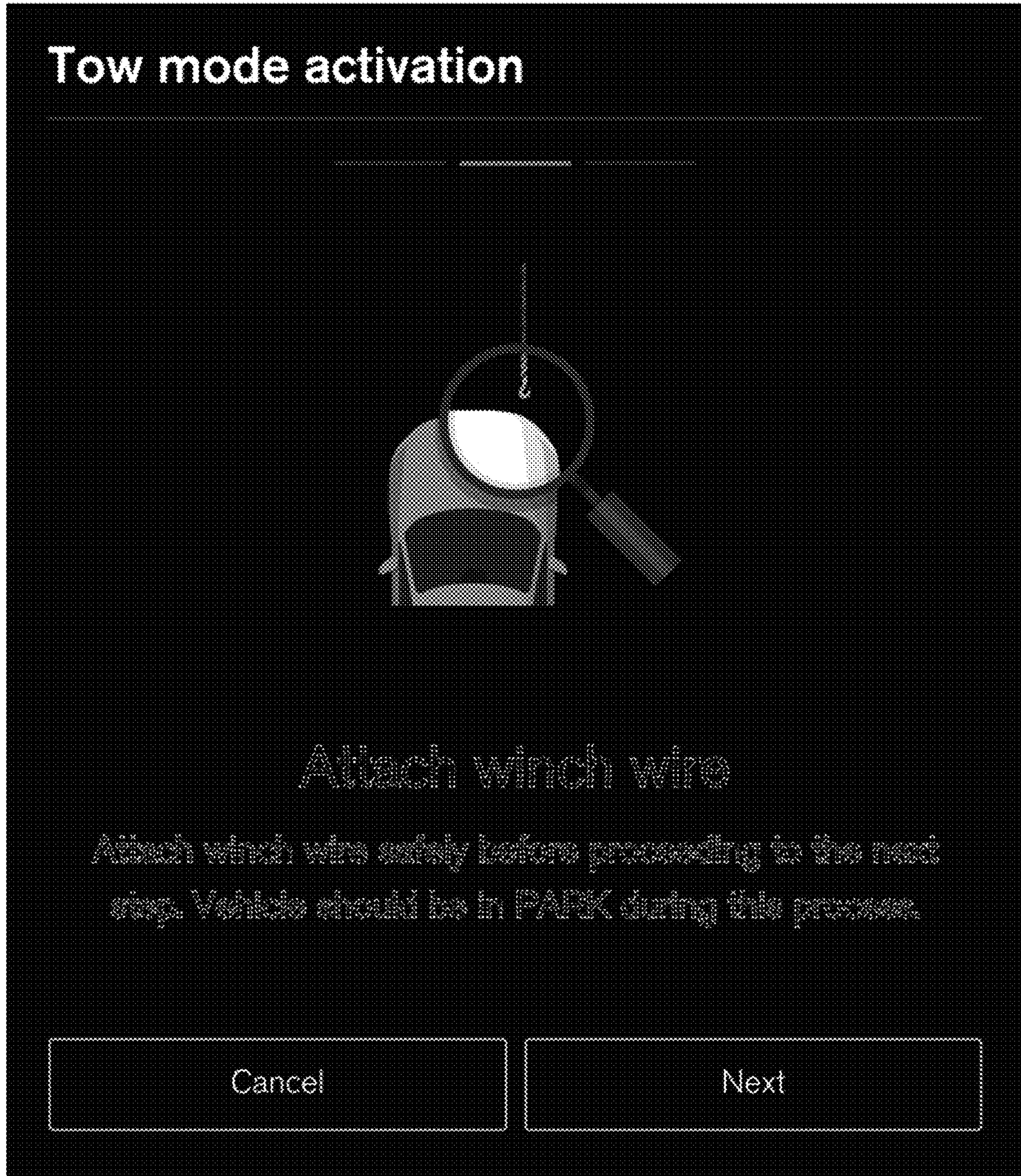

FIG. 1

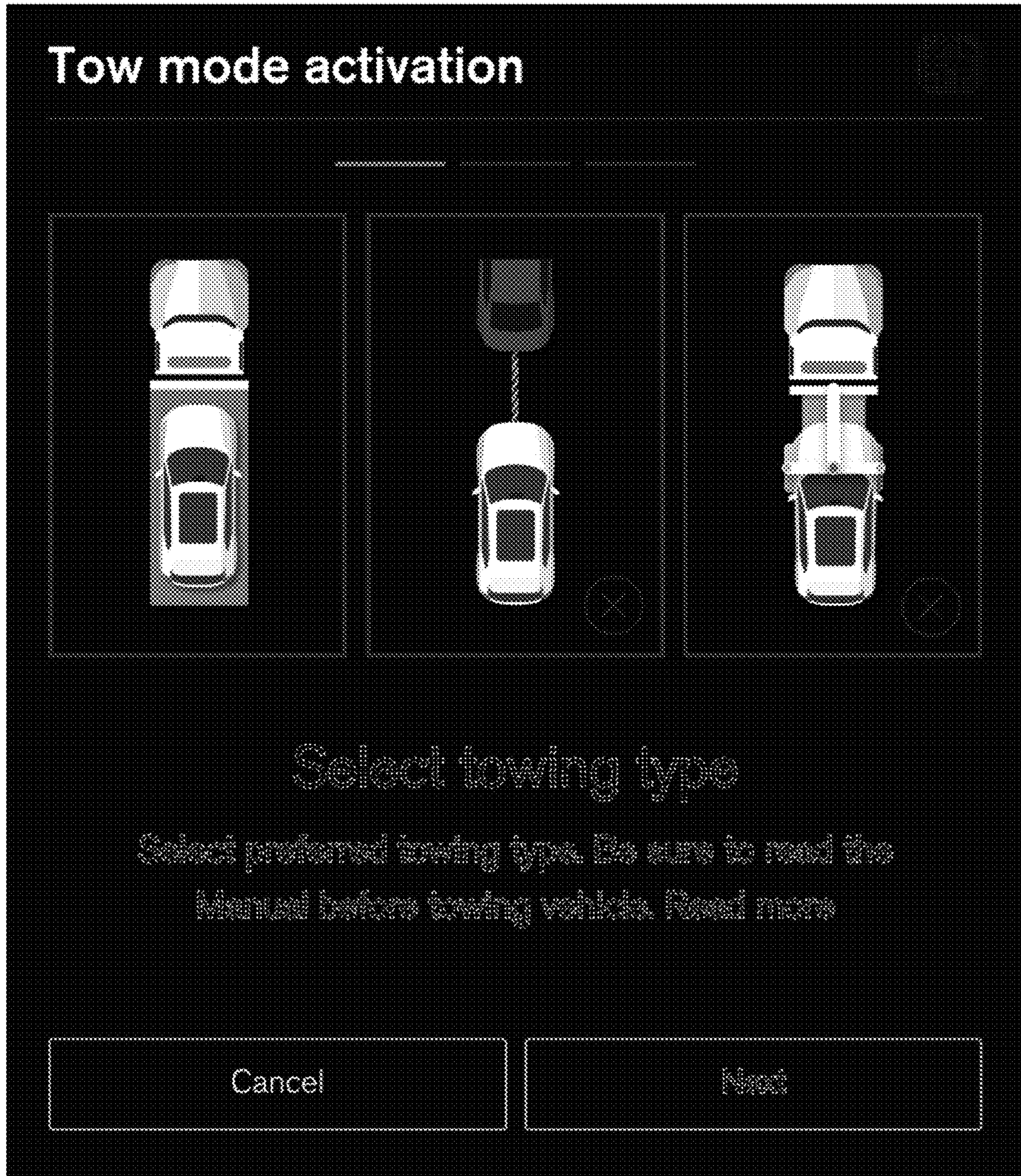

FIG. 2