

US00D964346S

(12) **United States Design Patent** (10) **Patent No.:** **US D964,346 S**
Perry (45) **Date of Patent:** **** Sep. 20, 2022**

(54) **DISPLAY**

D628,199 S * 11/2010 Yukikado D14/374
D630,210 S * 1/2011 Andre D14/374
D636,187 S 4/2011 Kim et al.

(Continued)

(71) Applicant: **Elo Touch Solutions, Inc.**, Milpitas, CA (US)

(72) Inventor: **Brian Perry**, San Jose, CA (US)

FOREIGN PATENT DOCUMENTS

(73) Assignee: **Elo Touch Solutions, Inc.**, Milpitas, CA (US)

CN 304544215 * 3/2018
CN 304672139 * 6/2018

(Continued)

(**) Term: **15 Years**

OTHER PUBLICATIONS

(21) Appl. No.: **29/708,468**

Amazon. Link: https://www.amazon.com/ANGEL-POS-Capacitive-Multi-Touch-Touchscreen/dp/B07GTYJMSM/ref=sr_1_6?dchild=1&keywords=touch+monitor&qid=1628103105&sr=8-6. Sep. 26, 2017. Angel POS. 17-Inch Capacitive LED Backlit Multi-Touch Monitor. (Year: 2017).*

(Continued)

(22) Filed: **Oct. 7, 2019**

Related U.S. Application Data

(63) Continuation of application No. 29/628,625, filed on Dec. 6, 2017, now Pat. No. Des. 864,194.

(51) **LOC (13) Cl.** **14-02**

(52) **U.S. Cl.**

USPC **D14/336**

(58) **Field of Classification Search**

USPC D14/336, 337, 373, 374, 375, 376, 377, D14/125, 128, 129, 126, 127, 371, 372, D14/341

CPC G06F 1/1601; G06F 1/1605; G06F 1/162
See application file for complete search history.

Primary Examiner — Lauren D McVey

(74) *Attorney, Agent, or Firm* — Sterne, Kessler, Goldstein & Fox P.L.L.C.

(57) **CLAIM**

The ornamental design for a display, as shown and described.

DESCRIPTION

FIG. 1 is a bottom rear perspective view of a display showing the claimed design;
FIG. 2 is a front view thereof;
FIG. 3 is a rear view thereof;
FIG. 4 is a left side view thereof;
FIG. 5 is a right side view thereof;
FIG. 6 is a top view thereof; and,
FIG. 7 is a bottom view thereof.

The dot-dash broken lines in the figures show environment that forms no part of the claimed design. The evenly spaced dashed broken lines show portions of the display that form no part of the claimed design.

1 Claim, 5 Drawing Sheets

(56) **References Cited**

U.S. PATENT DOCUMENTS

D356,548 S 3/1995 Bottcher et al.
D396,222 S * 7/1998 Morgan D14/126
D447,963 S 9/2001 Ingebritson
D462,018 S 8/2002 Markle et al.
D500,037 S 12/2004 Ozolins et al.
D582,802 S 12/2008 Branson et al.
D596,173 S * 7/2009 Arfin D14/307
D597,974 S 8/2009 Iseki
D601,143 S 9/2009 Oikawa et al.
D601,562 S 10/2009 Chiu

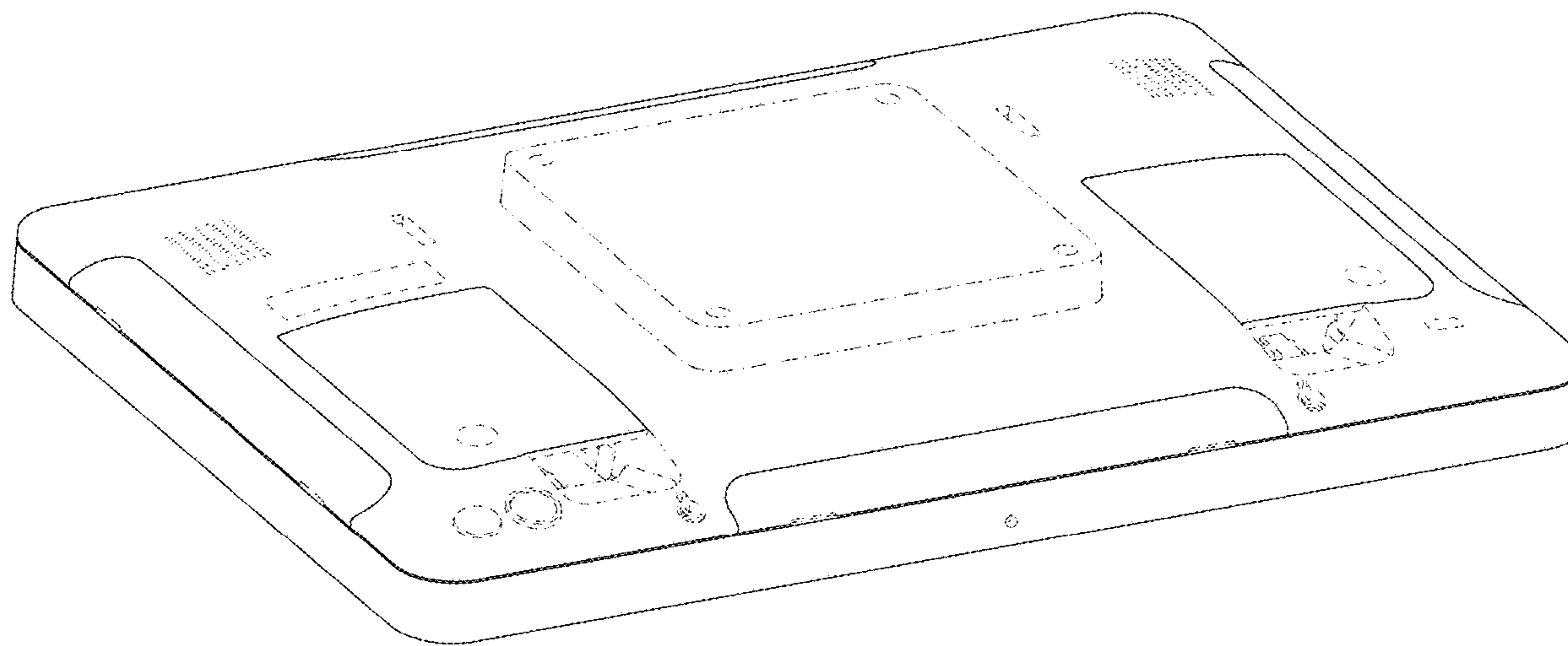

(56)

References Cited

U.S. PATENT DOCUMENTS

D639,568	S	6/2011	Lee et al.	
D673,129	S *	12/2012	Kumano	D14/126
D694,718	S	12/2013	Baumgartner et al.	
8,837,132	B2	9/2014	Lin et al.	
D726,182	S *	4/2015	Durham	D14/385
D727,898	S *	4/2015	Yum	D14/374
D733,591	S	7/2015	Golden et al.	
D755,783	S *	5/2016	Shi	D14/336
9,629,264	B2	4/2017	Le et al.	
D786,803	S	5/2017	Kim et al.	
D864,194	S *	10/2019	Perry	D14/336
D869,418	S *	12/2019	Lim	D14/126
10,835,106	B1 *	11/2020	Ubbesen	F16M 11/10
D912,049	S *	3/2021	Zhang	D14/375
D917,465	S *	4/2021	Zhang	D14/341
D920,142	S *	5/2021	Xu	D10/65
D920,324	S *	5/2021	Warren	D14/336
11,109,741	B1 *	9/2021	Ubbesen	G06F 1/1607
11,166,622	B2 *	11/2021	Ubbesen	A61B 1/00114
D947,836	S *	4/2022	Li	D14/341
2015/0362962	A1 *	12/2015	Lee	G06F 1/182 361/679.21

FOREIGN PATENT DOCUMENTS

CN	306302953	*	1/2021
CN	306308706	*	2/2021

OTHER PUBLICATIONS

Amazon. Link: https://www.amazon.com/Capacitive-Multi-Touch-Touchscreen-POS-Restaurant/dp/B089DQ569K/ref=sr_1_1?dchild=1&keywords=B089DQ569K&qid=1628103715&sr=8-1. Sep. 26,

2017. Angel POS. 15-Inch Capacitive LED Backlit Multi-Touch Monitor (Year: 2017).*

Amazon. Link: https://www.amazon.com/E829550-iTouch-Zero-Bezel-LED-Backlit-Monitor/dp/B00IU87J1C/ref=sr_1_17?dchild=1&keywords=touch+monitor&qid=1628103959&s=electronics&sr=1-17. May 2, 2014. Elo E829550 1517L iTouch Zero-Bezel 15" LED-Backlit LCD Monitor. (Year: 2014).*

BenQ 24-Inch Gaming Monitor, posted Sep. 12, 2012, [retrieved Aug. 17, 2018]. Retrieved from Internet, <URL: <https://www.amazon.com/BenQ-24-Inch-Gaming-Monitor-Discontinued/dp/B007HSKSMI>>.

Elo E222370 Interactive Digital Signage 4602L Infrared 46" 1 080p LED-Backlit LCD Flat Panel Touchscreen Display Black, posted Apr. 21, 2016, [retrieved Sep. 23, 2018]. Retrieved from Internet, <URL: <https://www.amazon.com/E222370-Interactive-Infrared-LED-Backlit-Touchscreen/dp/B01EMY47FI>>.

Elo Touch E396119 2002L 19.5" wide LCD Desktop, Fuii-HD, mini-VG, posted Sep. 11, 2016, [retrieved Sep. 23, 2018]. Retrieved from Internet, <URL: <https://www.amazon.co.uk/Touch-E396119-Desktop-Fuii-HD-mini-VG/dp/B01FRBJ7Y6>>.

"Elo E107766 Desktop Touchmonitors 2201L IntelliTouch Plus 22"" LED-Backlit LCD Monitor, Black, posted 0712712011, [retrieved Sep. 23, 2018]. Retrieved from Internet, <URL: <https://www.amazon.com/E107766-Desktop-Touchmonitors-IntelliTouch-LED-Backlit/dp/B005GKSBTG>>".

Wikipedia, "Power over Ethernet," <https://en.wikipedia.org/wiki/Power_over_Ethernet>, dated Nov. 12, 2017.

Ztech, "5 x ZXtech MonsterVision 2MP and 8 Channel Full Hd NVR HDMI P2P Complete POE IP CCTV System 2TB Hard Drive," amazon.com, <https://www.amazon.co.uk/Zxtech-MonsterVision-Channel-Complete-System/dp/80165M1YAQ/ref=1p_7122863031_1_3?srs=7122863031&ie=UTF8&qid=1513793473&sr=8-3>, first available on Oct. 4, 2015, accessed Dec. 20, 2017.

* cited by examiner

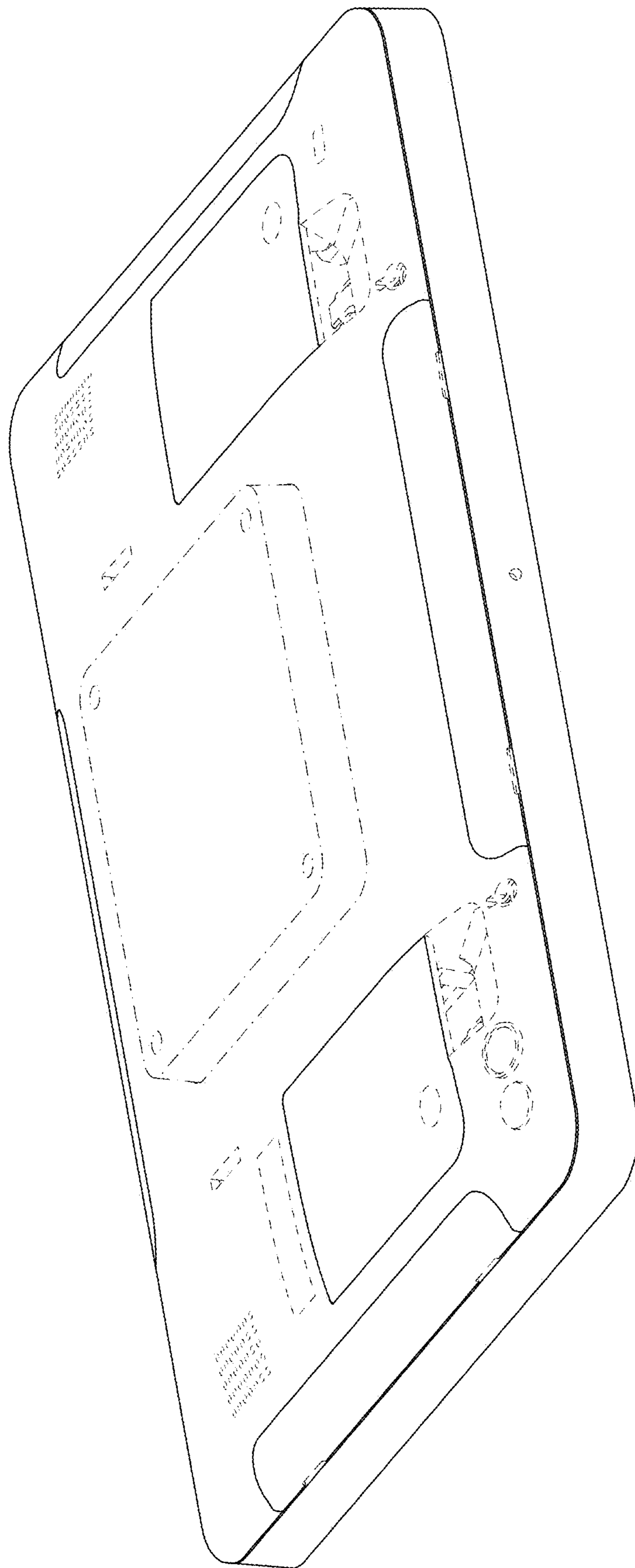

FIG. 1

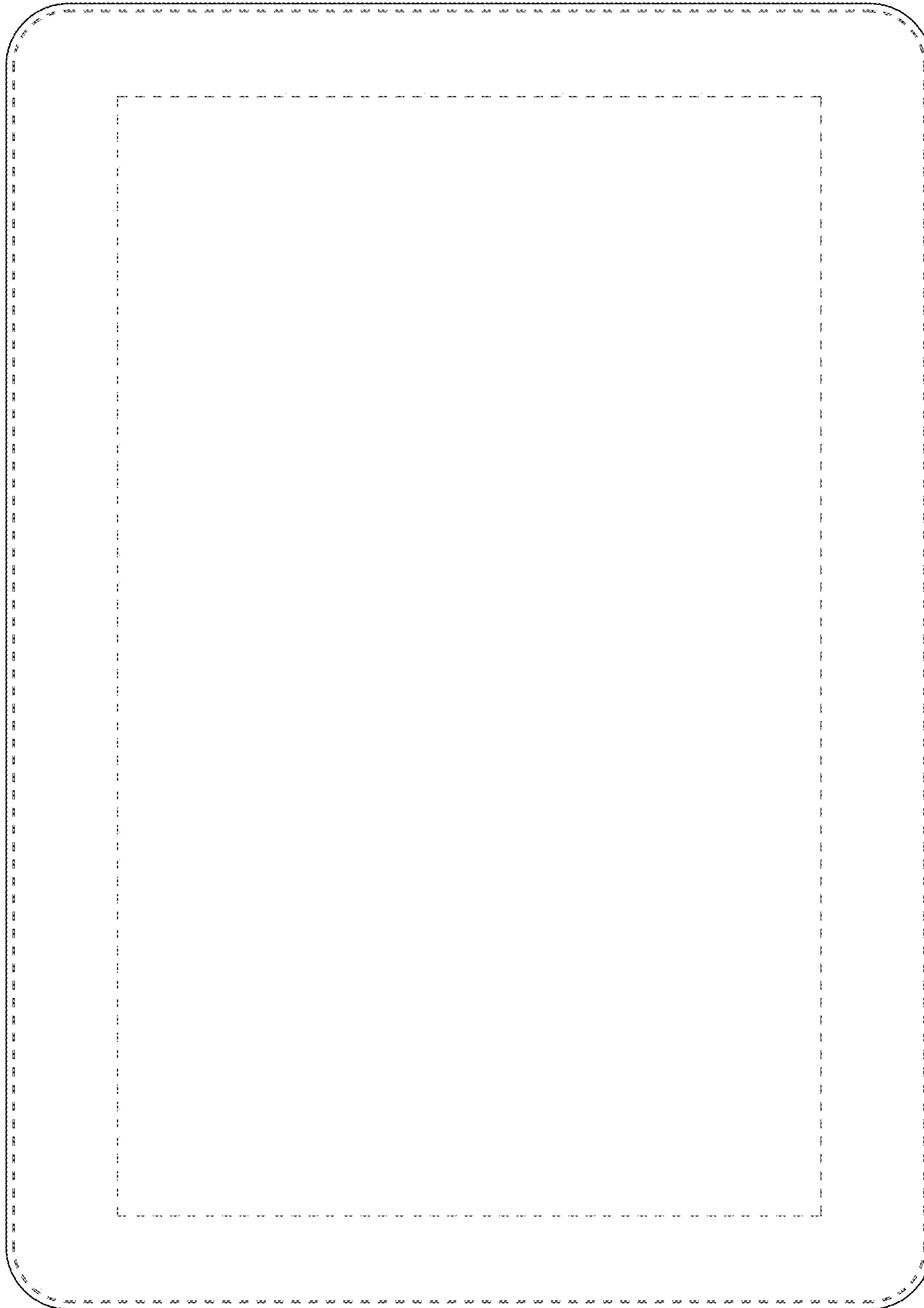

FIG. 2

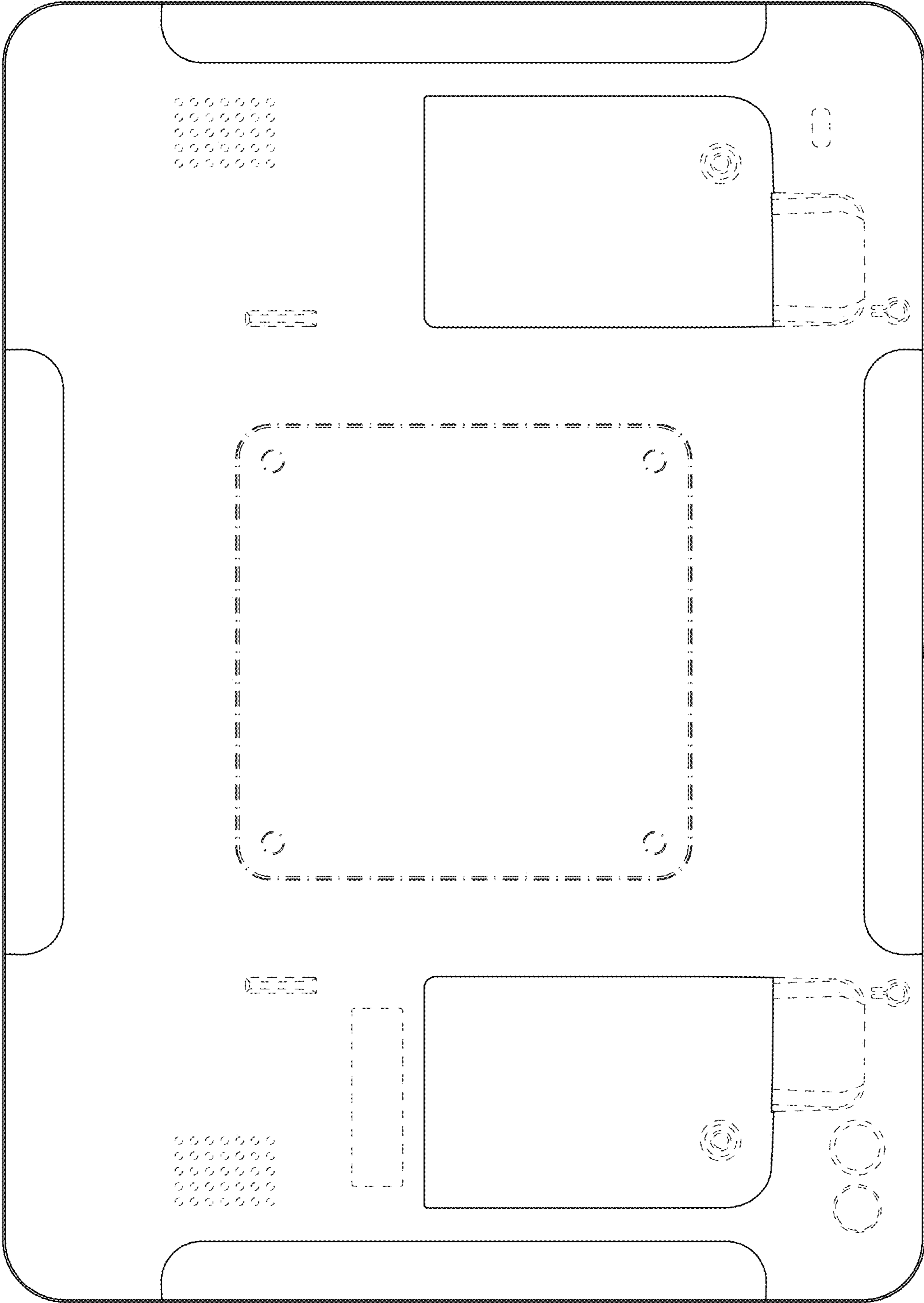

FIG. 3

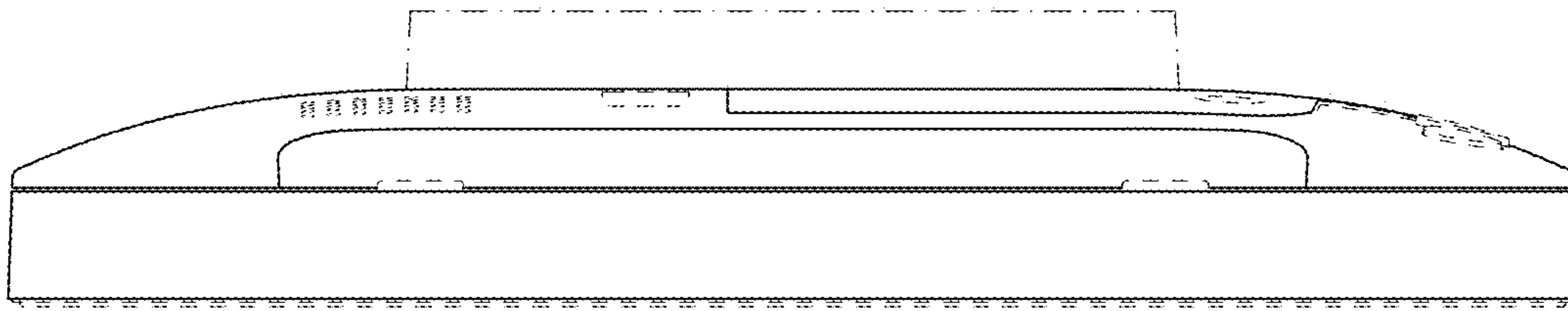

FIG. 5

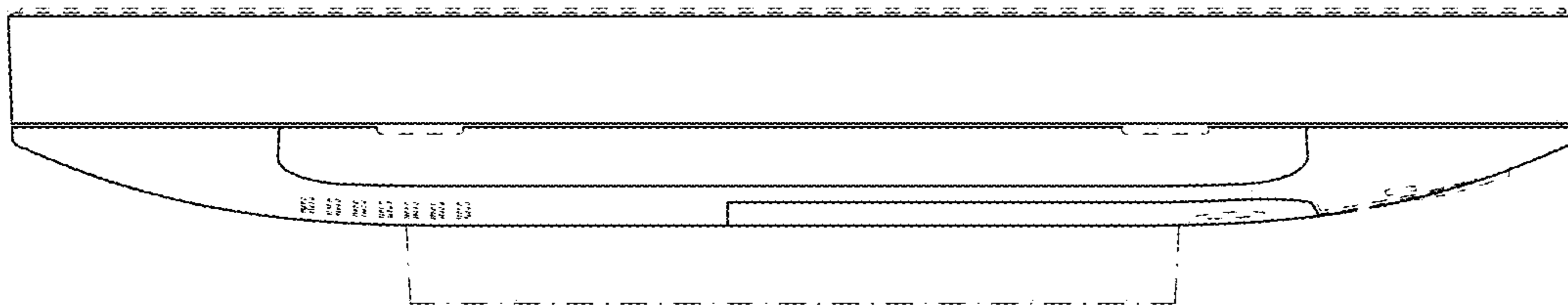

FIG. 4

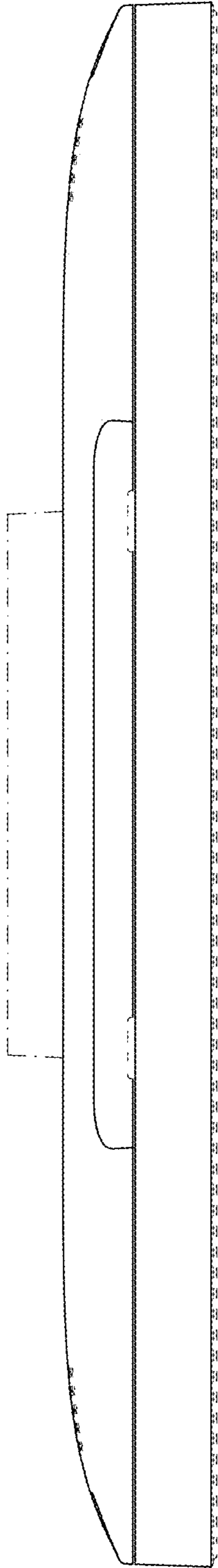

FIG. 6

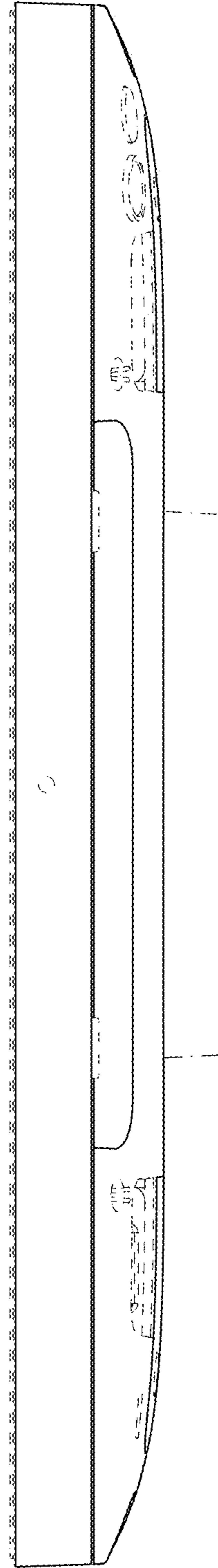

FIG. 7