



US00D963689S

(12) **United States Design Patent** (10) **Patent No.:** **US D963,689 S**
Fang et al. (45) **Date of Patent:** **** Sep. 13, 2022**

(54) **DISPLAY SCREEN OR PORTION THEREOF WITH AN ANIMATED GRAPHICAL USER INTERFACE**

(71) Applicant: **BEIJING KONGMING TECHNOLOGY CO., LTD.**, Beijing (CN)

(72) Inventors: **Lei Fang**, Beijing (CN); **Lu Yu**, Beijing (CN)

(73) Assignee: **BEIJING KONGMING TECHNOLOGY CO., LTD.**, Beijing (CN)

(**) Term: **15 Years**

(21) Appl. No.: **29/767,201**

(22) Filed: **Jan. 21, 2021**

(30) **Foreign Application Priority Data**

Jul. 21, 2020 (CN) 202030399113.X

(51) **LOC (13) Cl.** **14-04**

(52) **U.S. Cl.**
USPC **D14/486**

(58) **Field of Classification Search**
USPC D14/485–495
CPC H04L 51/32; H04L 12/587; H04N 21/488; H04N 1/00477; G06F 3/04847; G06F 3/0485; G06F 3/048; G06F 3/0488
See application file for complete search history.

(56) **References Cited**

U.S. PATENT DOCUMENTS

D758,421 S	*	6/2016	Liu	D14/488
D858,552 S	*	9/2019	Westerhold	D14/486
D870,754 S	*	12/2019	Wang	D14/485
D880,499 S	*	4/2020	Fatnani	D14/485
D881,208 S	*	4/2020	Fatnani	D14/485

D881,220 S	*	4/2020	Feng	D14/488
D889,486 S	*	7/2020	Fatnani	D14/485
D895,657 S	*	9/2020	Howland	D14/486
D896,831 S	*	9/2020	Honnette	D14/486
D896,832 S	*	9/2020	Honnette	D14/486
D920,367 S	*	5/2021	Luo	D14/488
D934,285 S	*	10/2021	Underwood	D14/487
D940,199 S	*	1/2022	Zhou	D14/492

FOREIGN PATENT DOCUMENTS

JP	HJ3111242100	9/2019
JP	RJ0308429400	8/2021
JP	RJ0308431900	8/2021
JP	RJ0308432000	8/2021
JP	1701024 S	11/2021
JP	1701025 S	11/2021

* cited by examiner

Primary Examiner — Katherine A Holbrow

(74) *Attorney, Agent, or Firm* — BakerHostetler

(57) **CLAIM**

We claim the ornamental design for a display screen or portion thereof with an animated graphical user interface, as shown and described.

DESCRIPTION

FIG. 1 is a front view of a first image in a sequence for a display screen or portion thereof with an animated graphical user interface showing our new design; and, FIG. 2 is a front view of a second image thereof.

The outermost broken line rectangle illustrates a display screen or portion thereof and forms no part of the claimed design. The remaining broken lines illustrate portions of the animated graphical user interface that form no part of the claimed design.

The appearance of the transitional image sequentially transitions between the images shown in FIGS. 1-2. The process or period in which one image transitions to another forms no part of the claimed design.

1 Claim, 1 Drawing Sheet

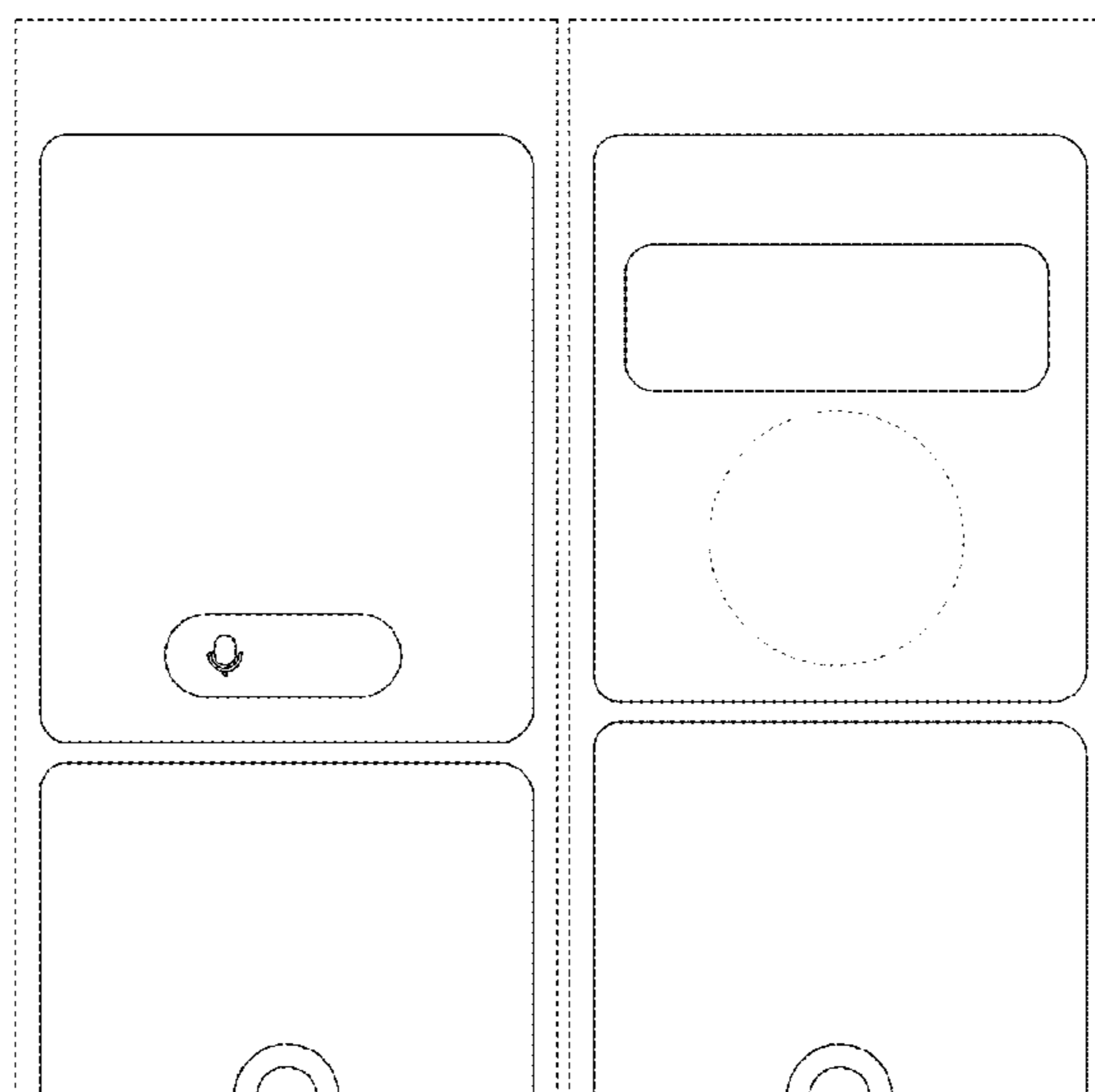

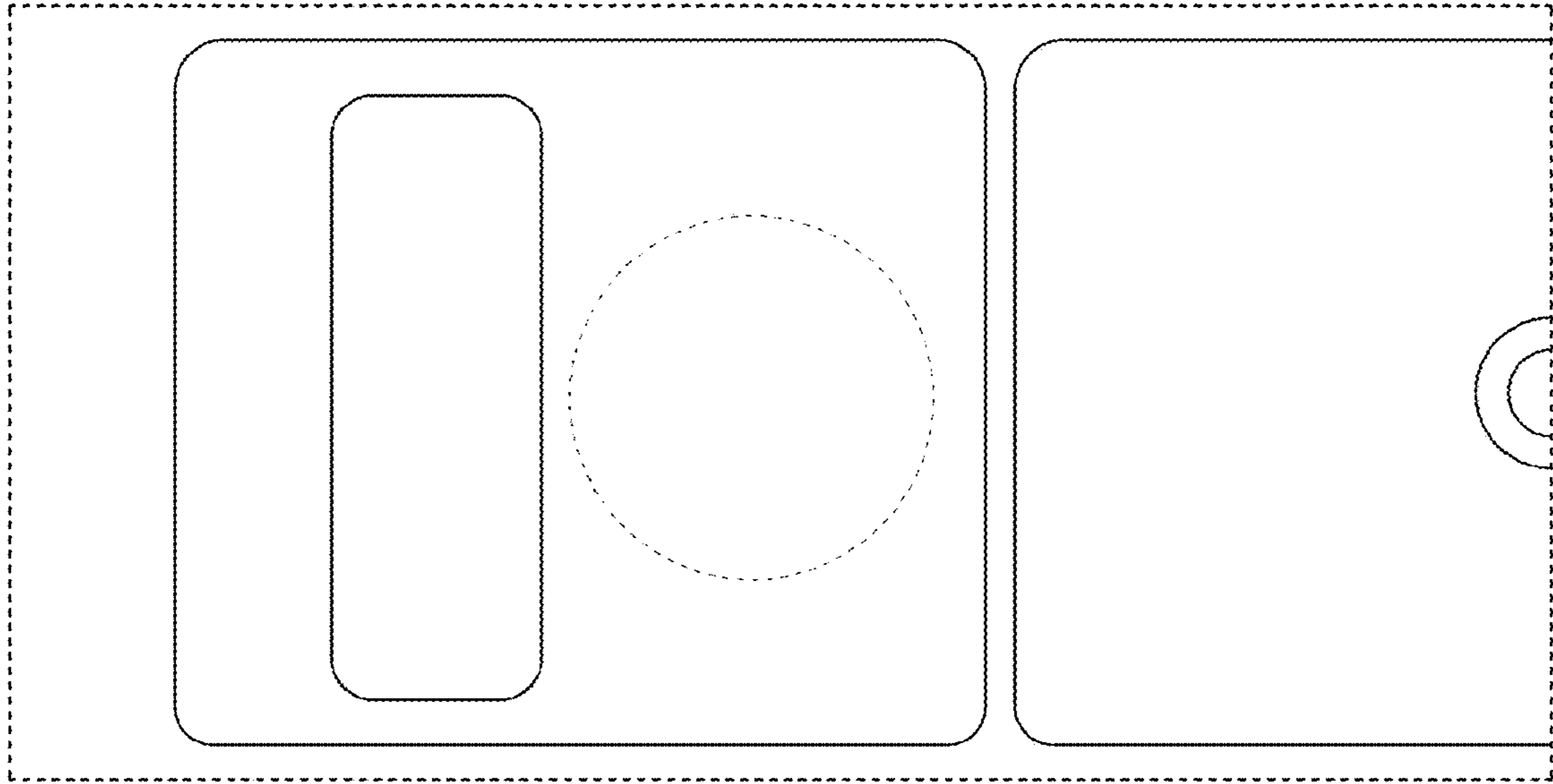

FIG. 2

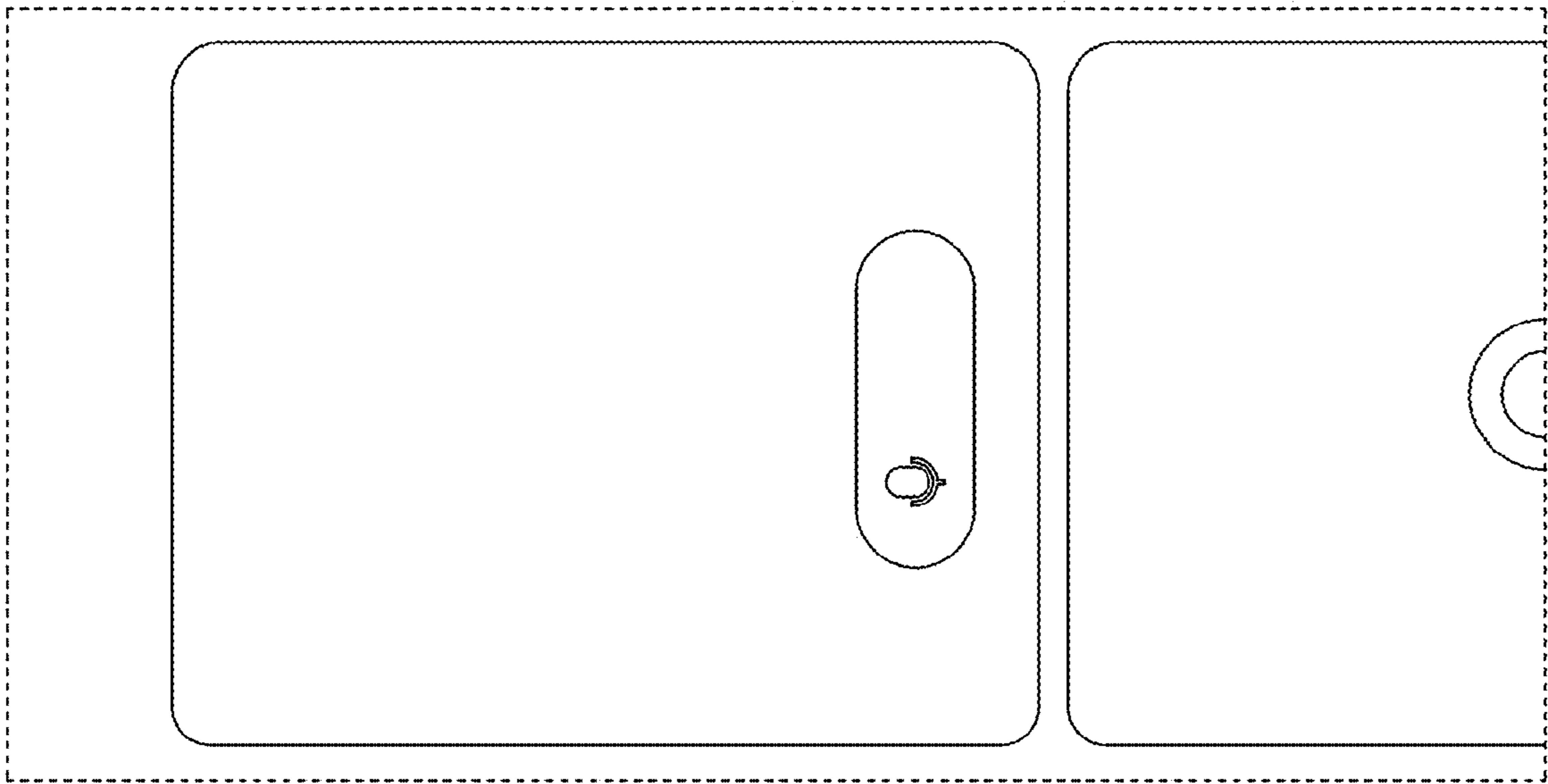

FIG. 1