



US00D961372S

(12) **United States Design Patent**  
**Monroe**

(10) **Patent No.:** **US D961,372 S**

(45) **Date of Patent:** **\*\* Aug. 23, 2022**

(54) **MANUAL PIN-OFF ASSEMBLY**

(71) Applicant: **Diversified Metal Fabricators, Inc.**,  
Atlanta, GA (US)

(72) Inventor: **Timothy Alwin Monroe**, Atlanta, GA  
(US)

(73) Assignee: **DIVERSIFIED METAL  
FABRICATORS, INC.**, Atlanta, GA  
(US)

(\*\*) Term: **15 Years**

(21) Appl. No.: **29/706,477**

(22) Filed: **Sep. 20, 2019**

(51) **LOC (13) Cl.** ..... **08-08**

(52) **U.S. Cl.**

USPC ..... **D8/382**

(58) **Field of Classification Search**

USPC ..... D8/382-383, 394-395, 330-331, 339,  
D8/344

CPC ..... F16B 12/125; F16B 12/22; F16B 12/24;  
F16B 19/00; F16B 19/008; F16B  
2005/0678; F16B 21/086; F16B 2/22;  
F16B 5/0084; F16B 5/0607; F16B  
5/0657; E05B 73/00

See application file for complete search history.

(56) **References Cited**

**U.S. PATENT DOCUMENTS**

D418,397	S	*	1/2000	Sasa	.....	D8/382
6,164,885	A	*	12/2000	Roytberg	.....	F16B 37/02 411/173
6,283,689	B1	*	9/2001	Roytberg	.....	F16B 37/02 411/182
D451,984	S	*	12/2001	Tigerholm	.....	D23/262
D656,392	S	*	3/2012	McKenna	.....	D8/382
D696,574	S	*	12/2013	Caterinacci	.....	D8/382
D700,037	S	*	2/2014	Lohmann	.....	D8/330

D703,519	S	*	4/2014	Sensenev	.....	D8/382
D743,243	S	*	11/2015	Strunk	.....	D8/382
D805,883	S	*	12/2017	Evitt	.....	D8/382
D806,516	S	*	1/2018	Alan	.....	D8/331
D881,680	S	*	4/2020	Huang	.....	D8/352
D889,383	S	*	7/2020	Wang	.....	D12/415

(Continued)

*Primary Examiner* — Susan Bennett Hattan

*Assistant Examiner* — Elizabeth S Ko

(74) *Attorney, Agent, or Firm* — Thomas|Horstemeyer,  
LLP

(57) **CLAIM**

The ornamental design for a manual pin-off assembly, as shown and described.

**DESCRIPTION**

FIG. 1 is a front perspective view of a manual pin-off assembly, showing my new design;  
 FIG. 2 is a rear perspective view thereof;  
 FIG. 3 is a front view thereof;  
 FIG. 4 is a rear view thereof;  
 FIG. 5 is a side view thereof;  
 FIG. 6 is a side view thereof, opposite that of FIG. 5;  
 FIG. 7 is a top view thereof;  
 FIG. 8 is a bottom view thereof;  
 FIG. 9 is a front perspective view of the manual pin-off assembly of FIG. 1 shown in deployed mode;  
 FIG. 10 is a rear perspective view of the manual pin-off assembly of FIG. 9;  
 FIG. 11 is a front view thereof;  
 FIG. 12 is a rear view thereof;  
 FIG. 13 is a side view thereof;  
 FIG. 14 is a side view thereof, opposite that of FIG. 13;  
 FIG. 15 is a top view thereof; and,  
 FIG. 16 is a bottom view thereof.

The broken lines depict unclaimed parts of the manual pin-off assembly, and thus form no part of the claimed design.

**1 Claim, 4 Drawing Sheets**

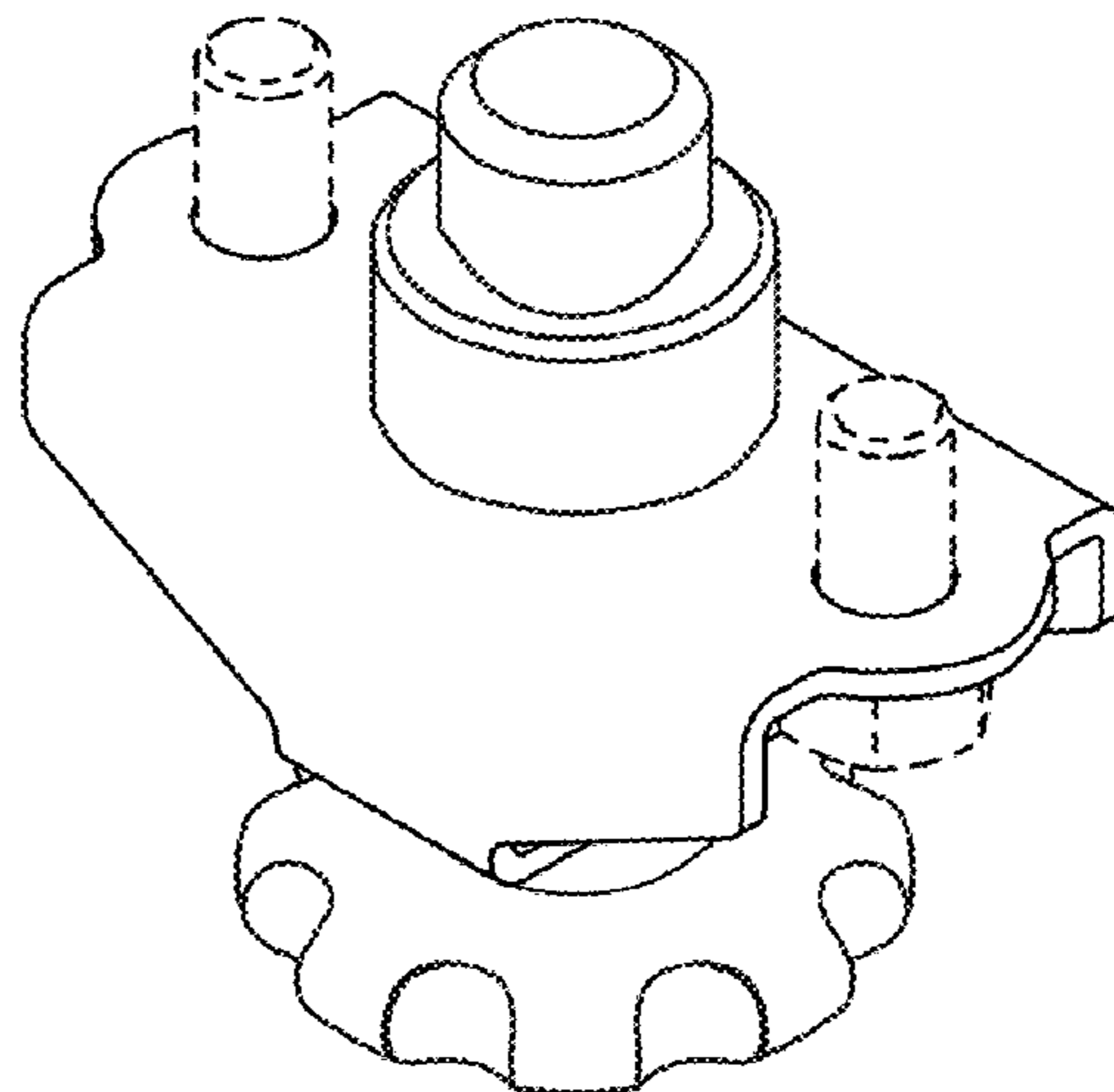
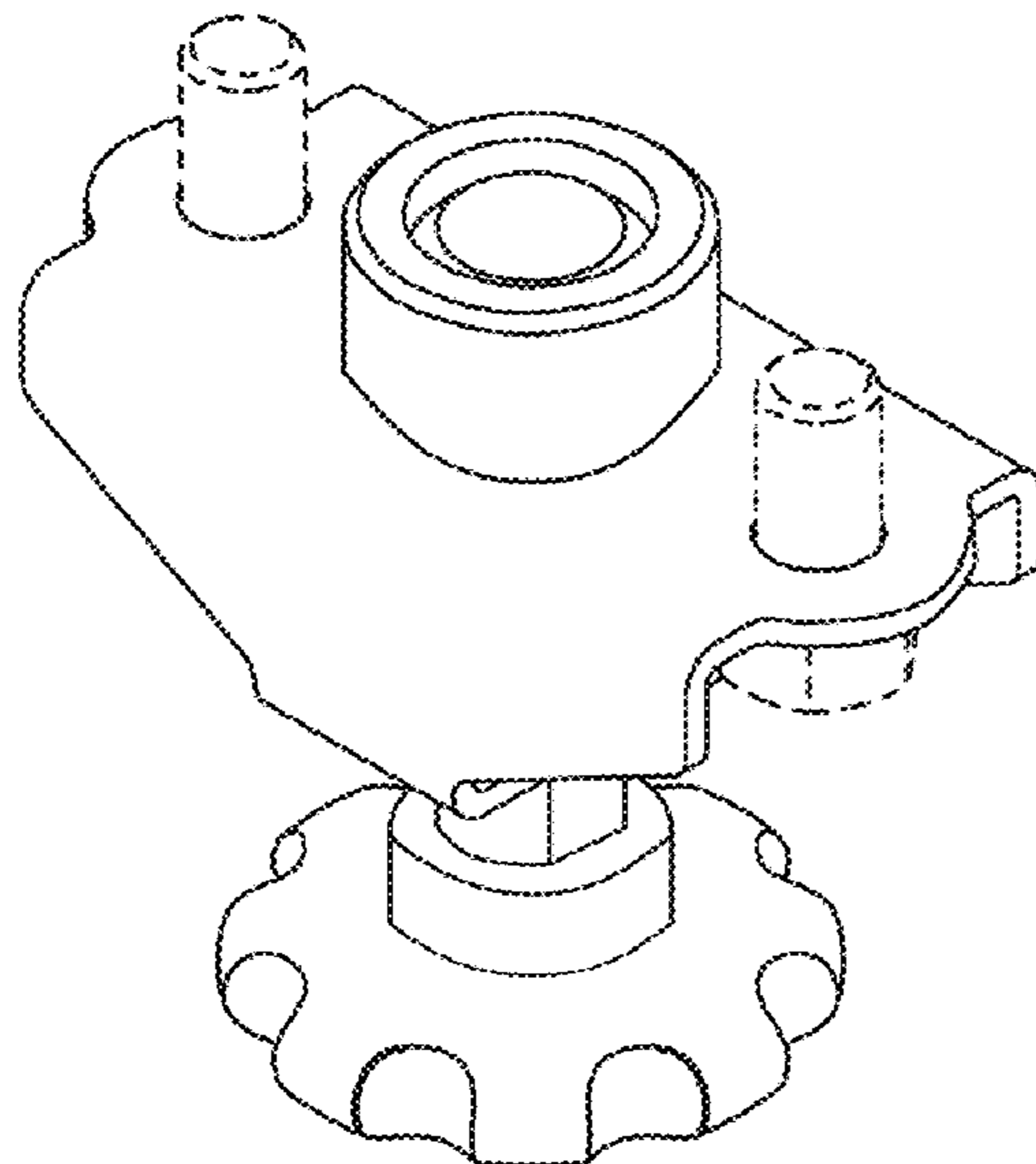

(56)

**References Cited**

U.S. PATENT DOCUMENTS

D928,220 S \* 8/2021 Liang ..... D16/242  
2011/0318093 A1\* 12/2011 Liao ..... F16M 11/041  
403/142

\* cited by examiner

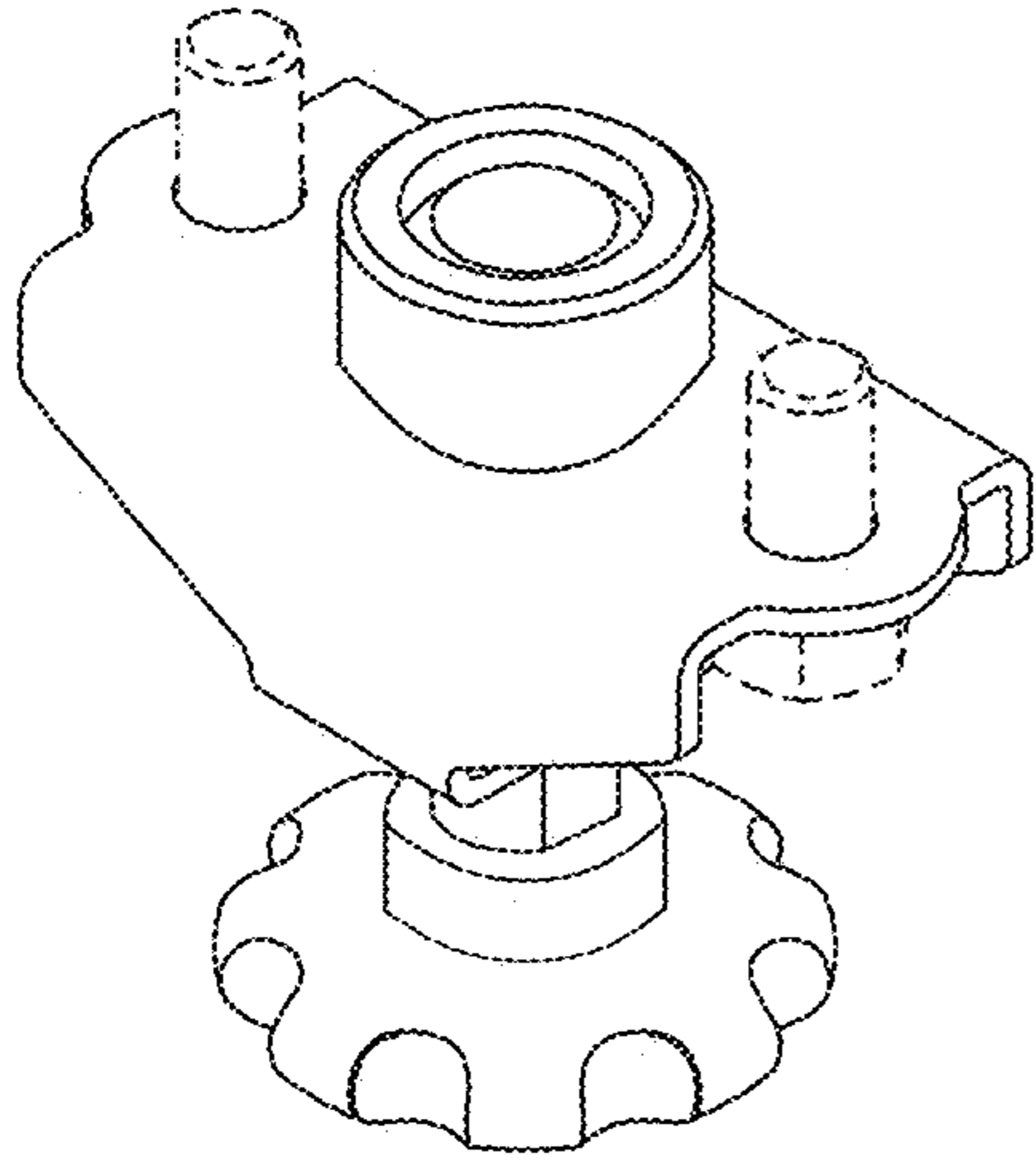

**FIG. 1**

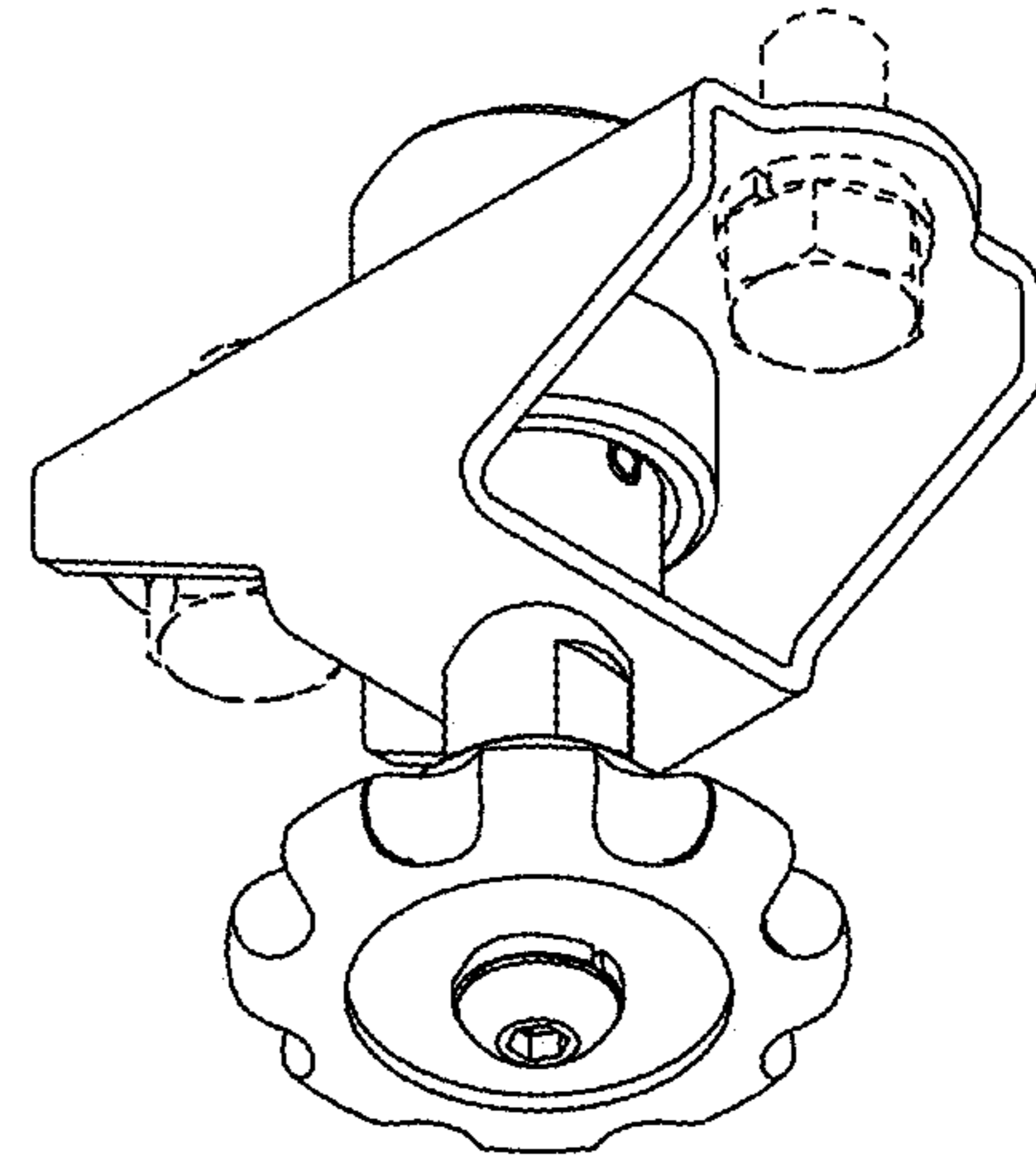

**FIG. 2**

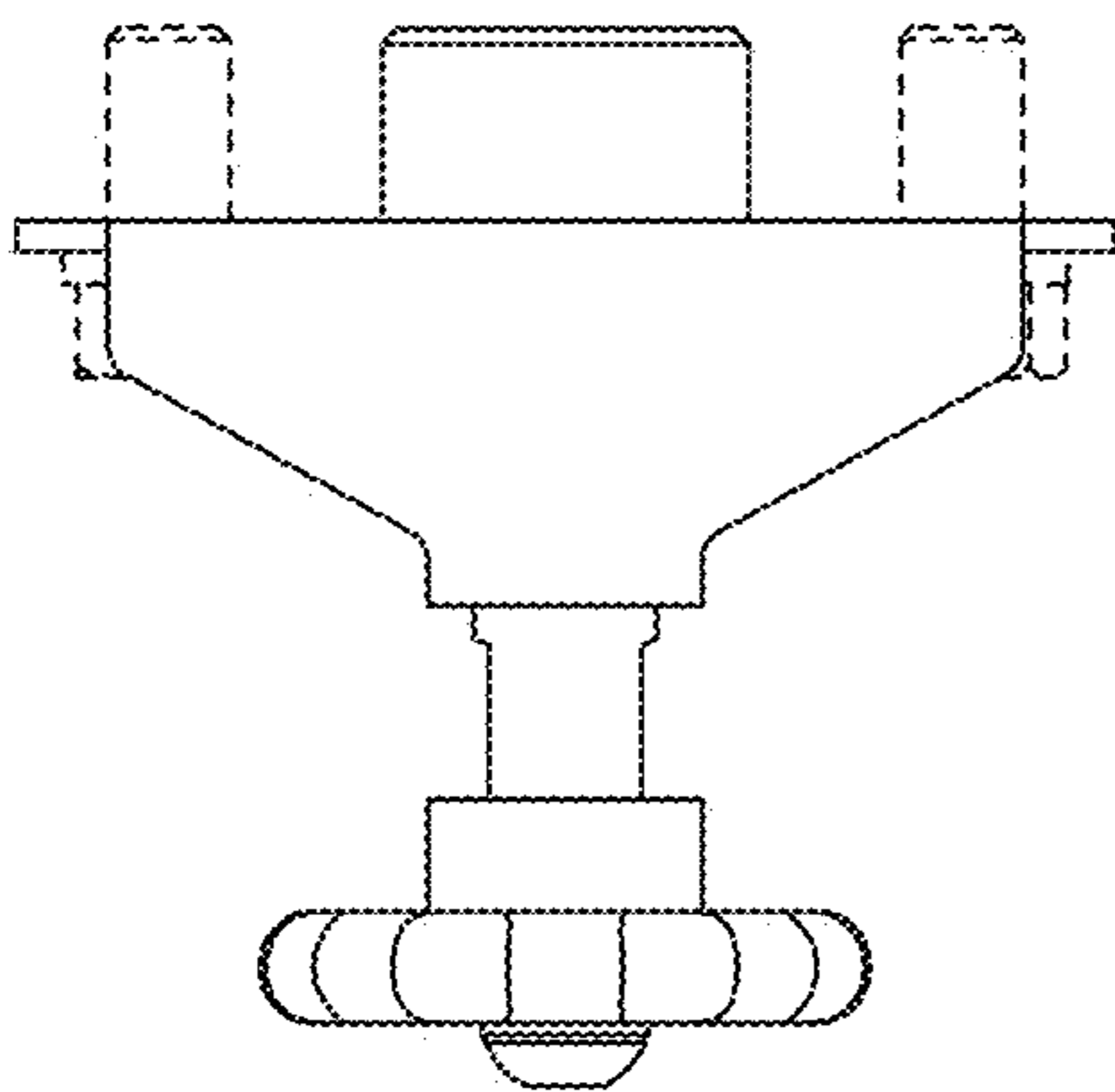

**FIG. 3**

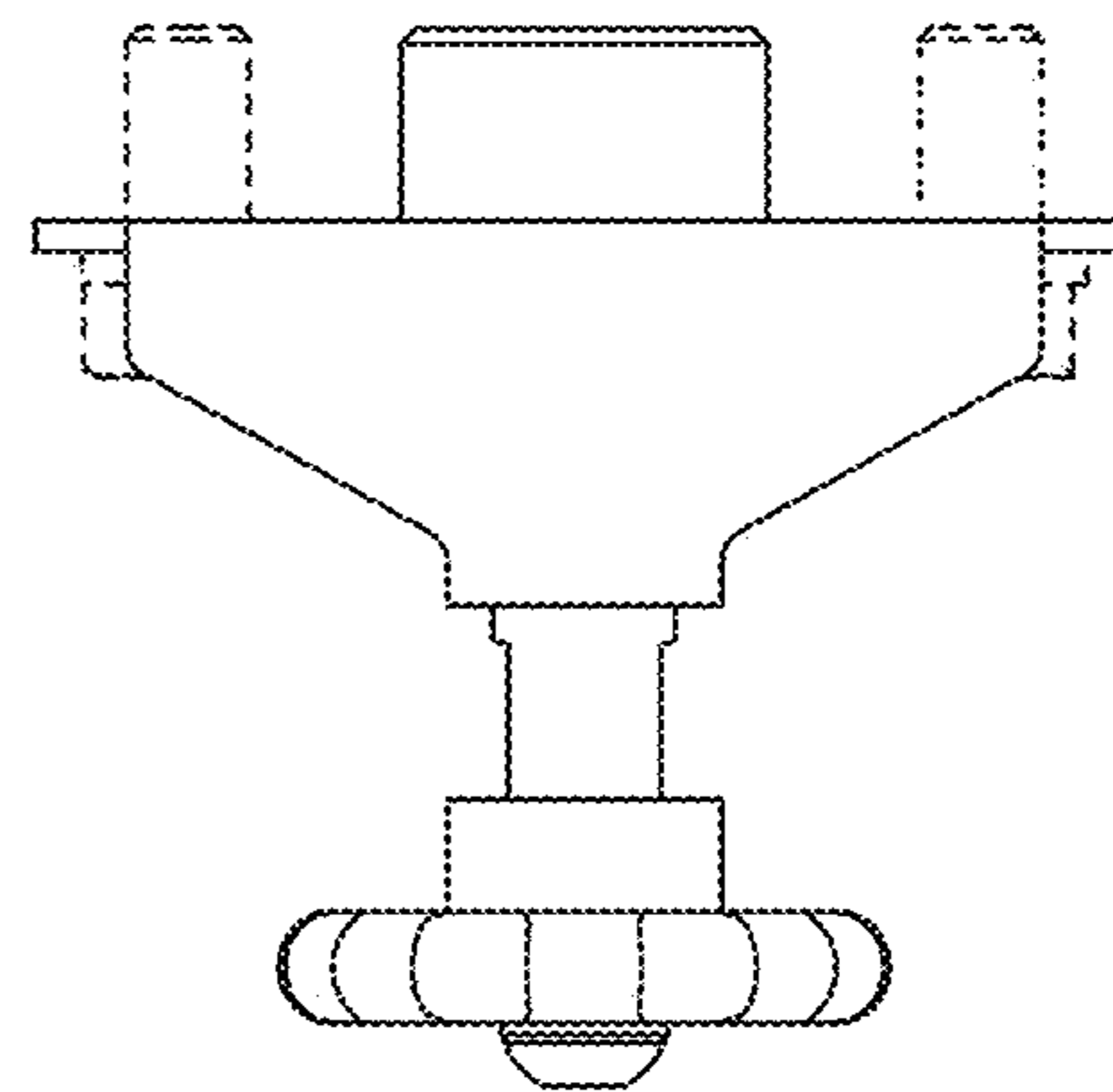

**FIG. 4**

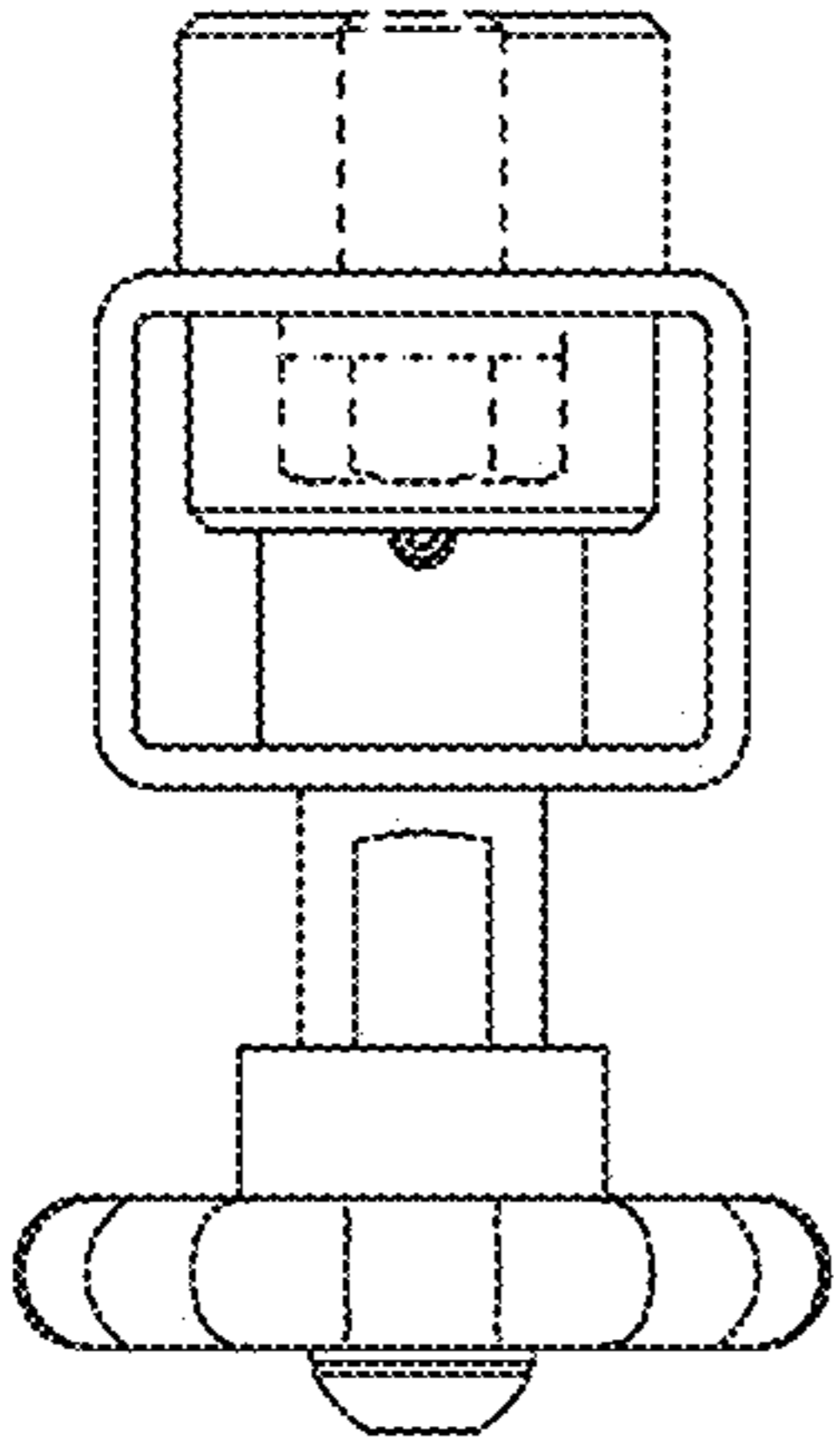

**FIG. 5**

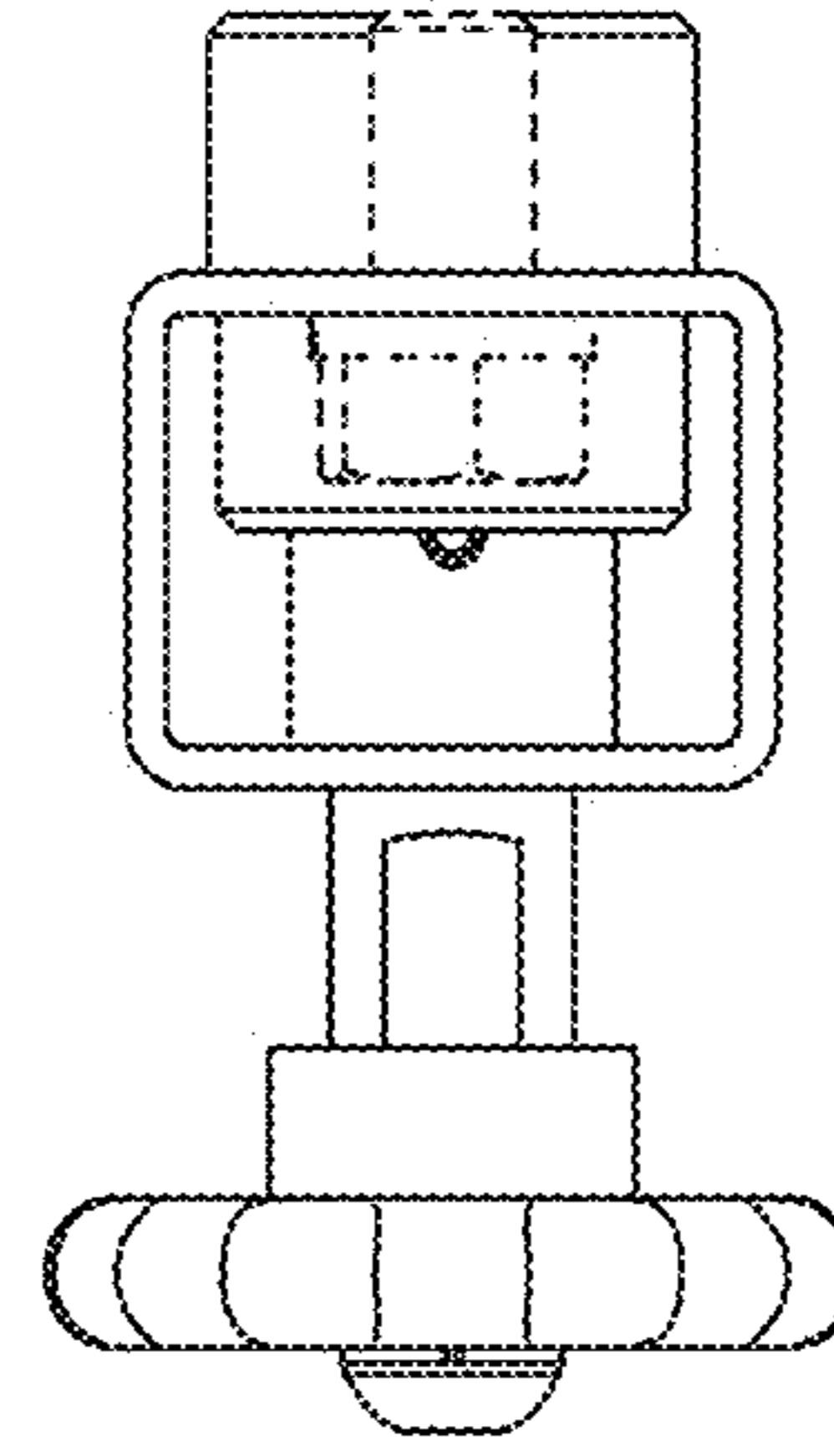

**FIG. 6**

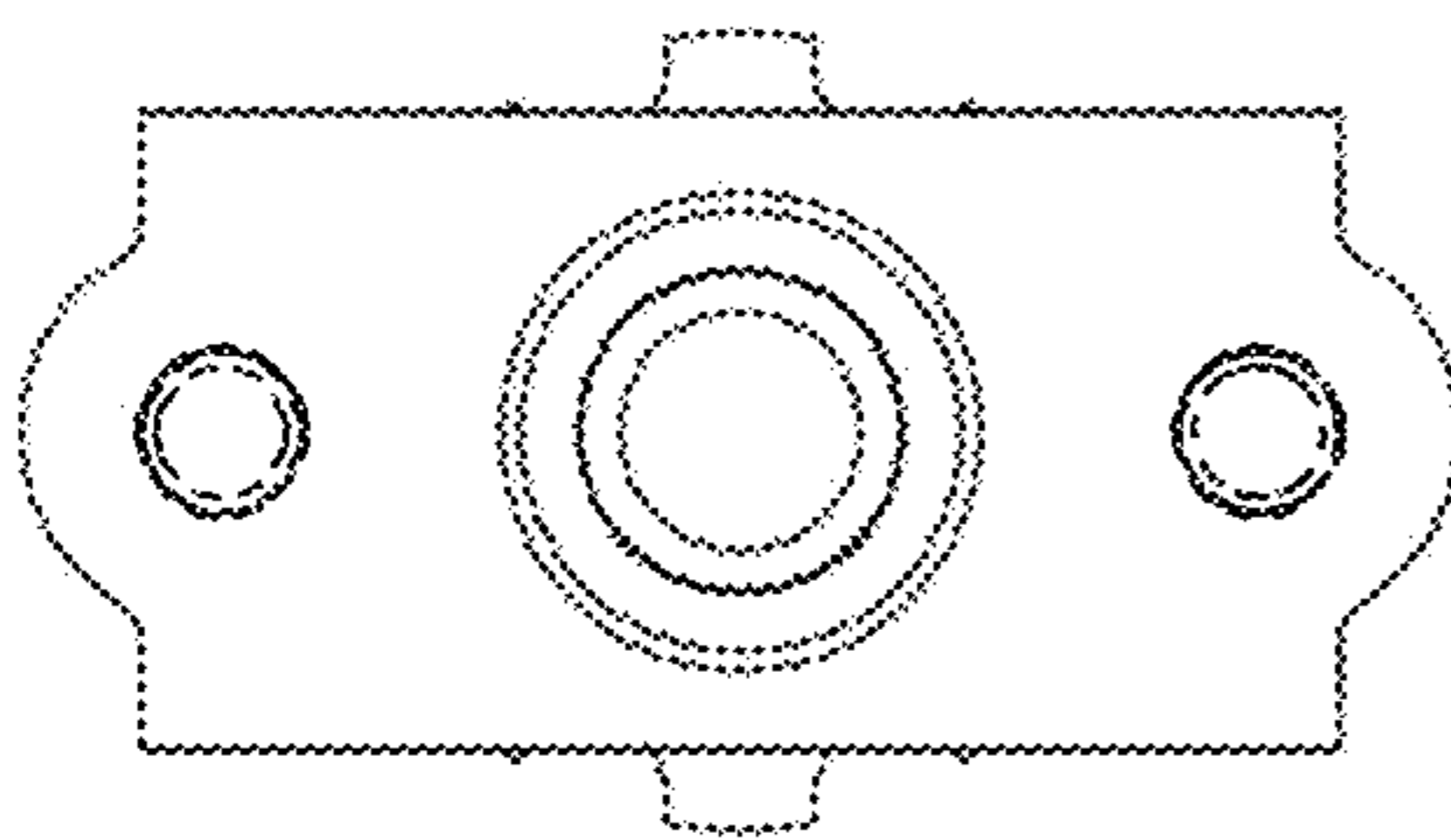

**FIG. 7**

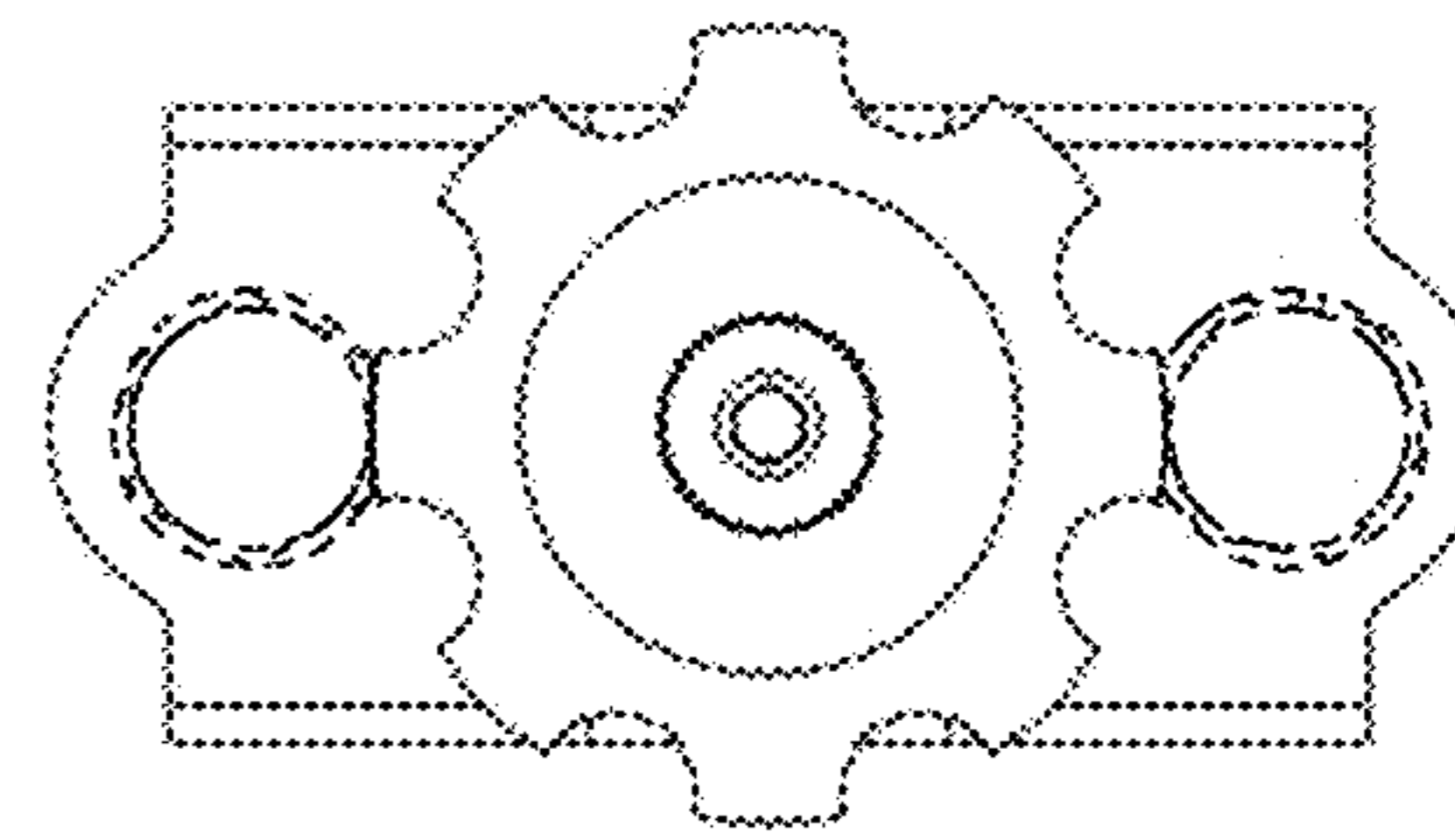

**FIG. 8**

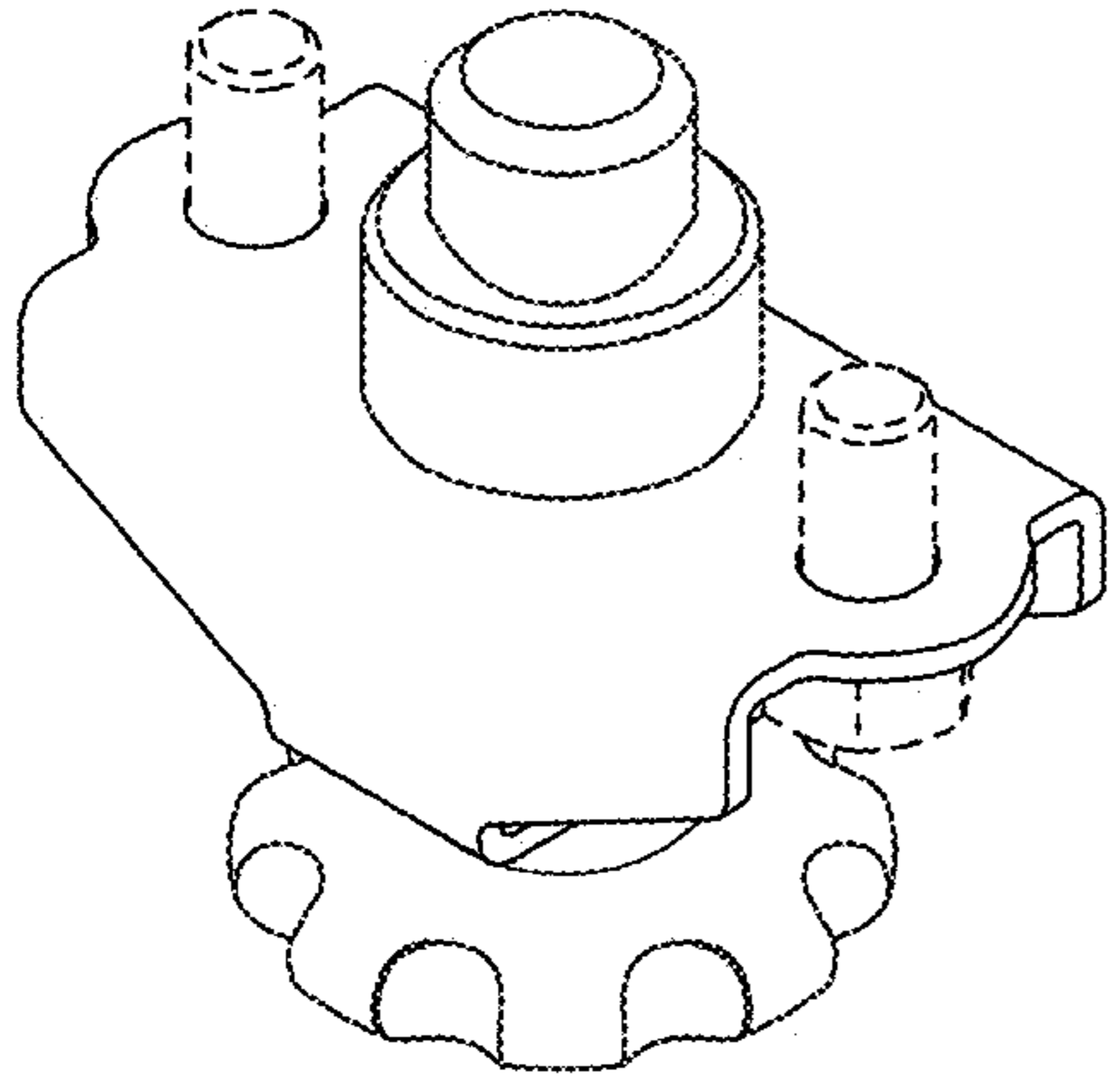

**FIG. 9**

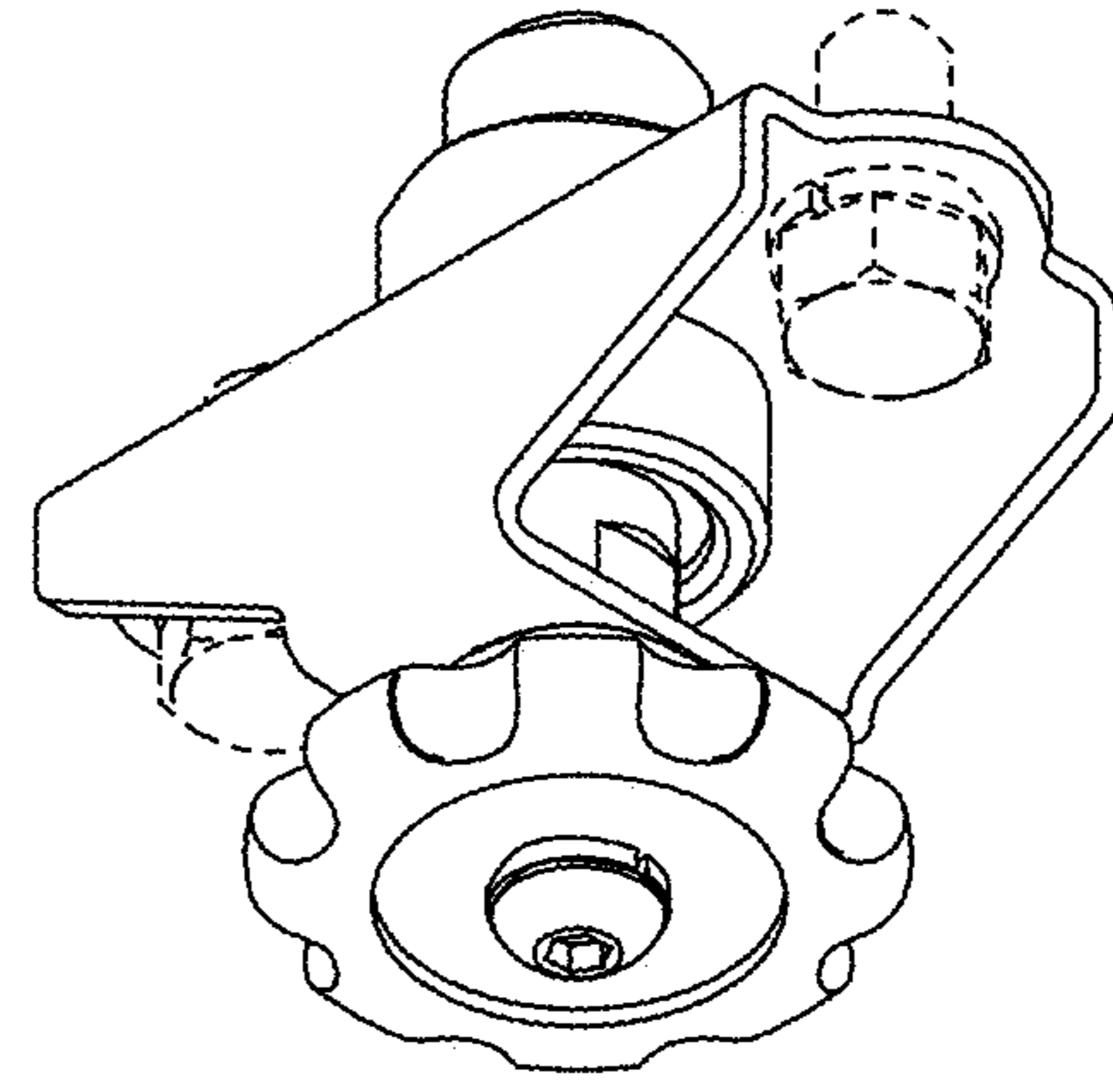

**FIG. 10**

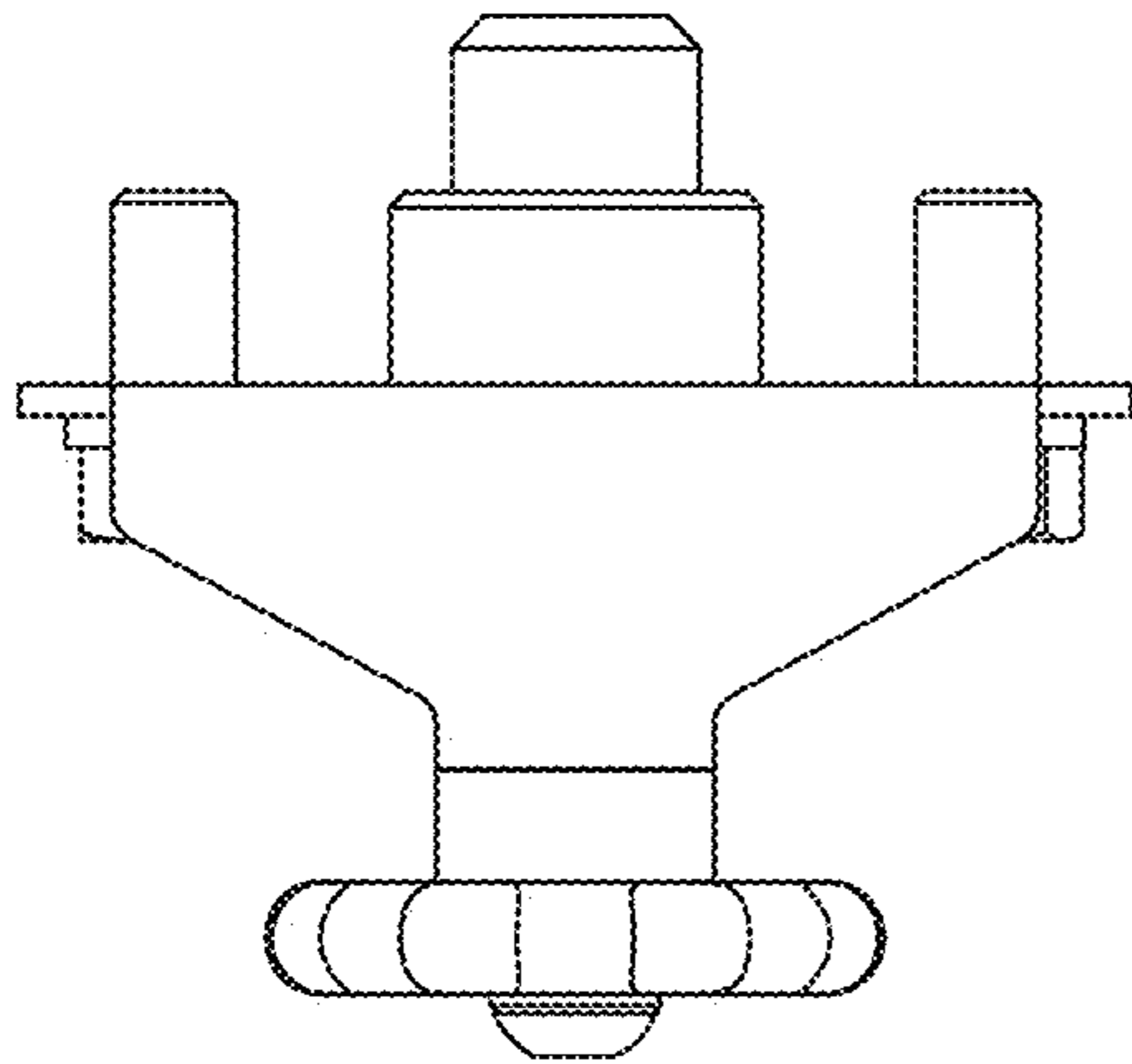

**FIG. 11**

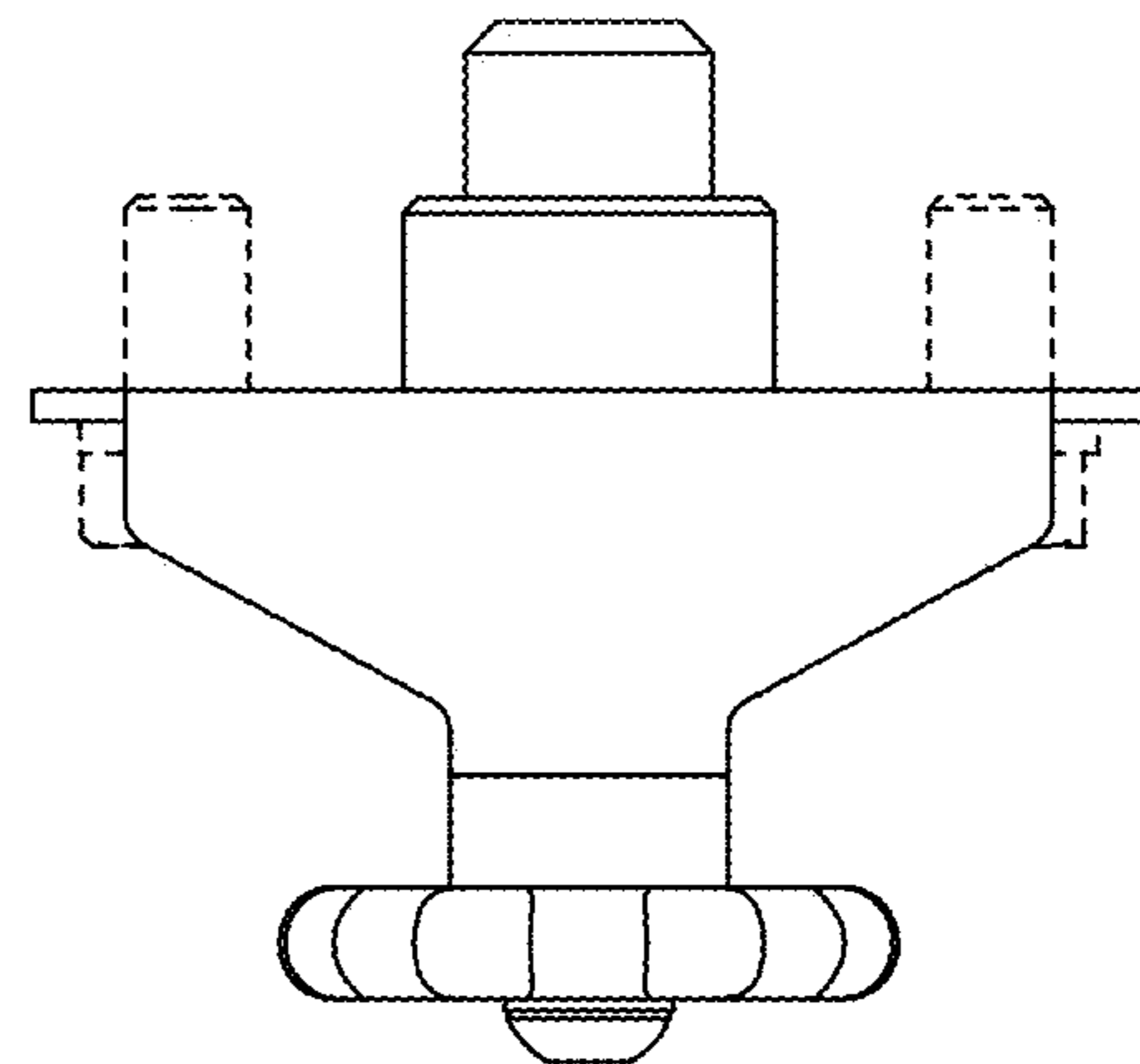

**FIG. 12**

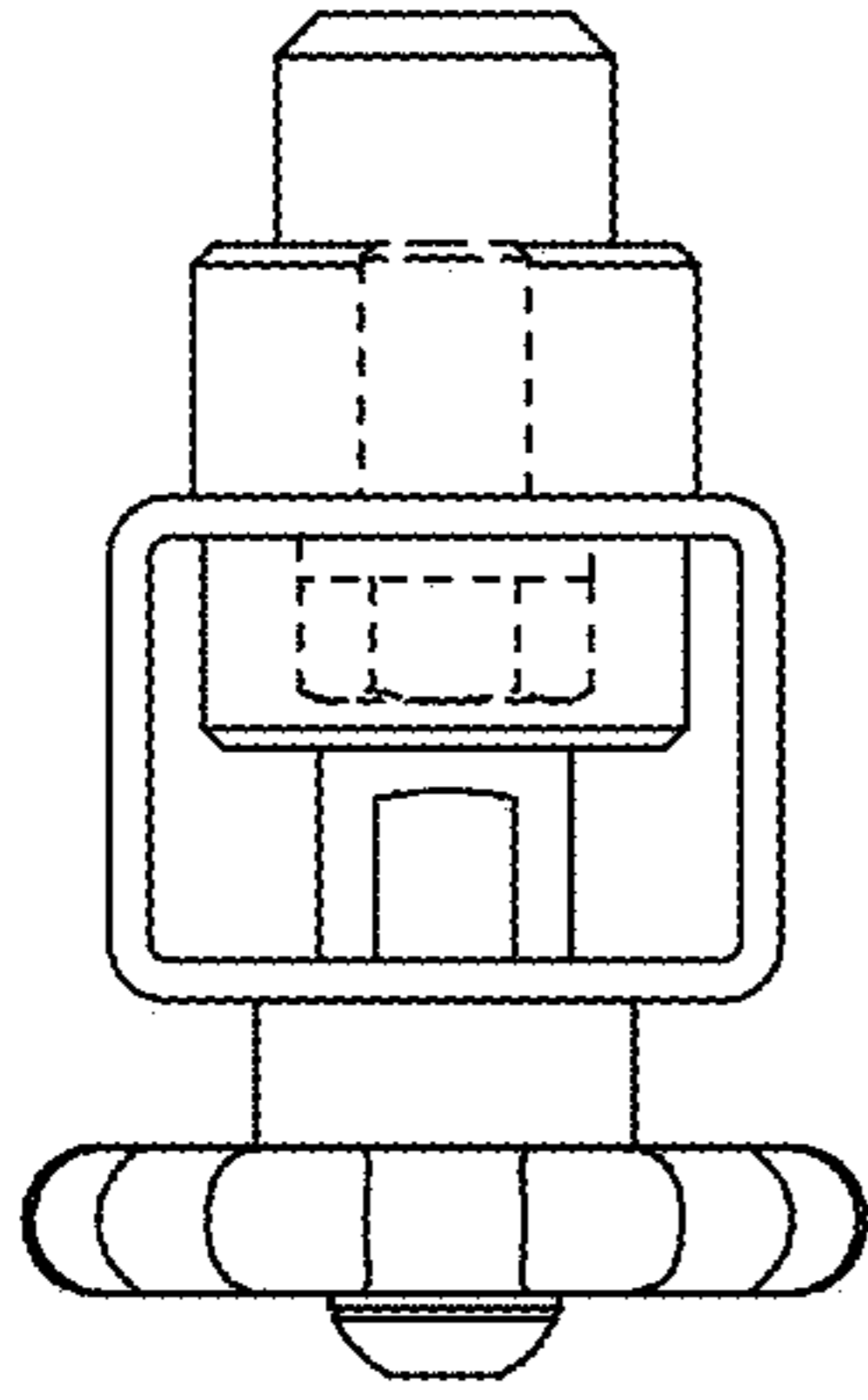

**FIG. 13**

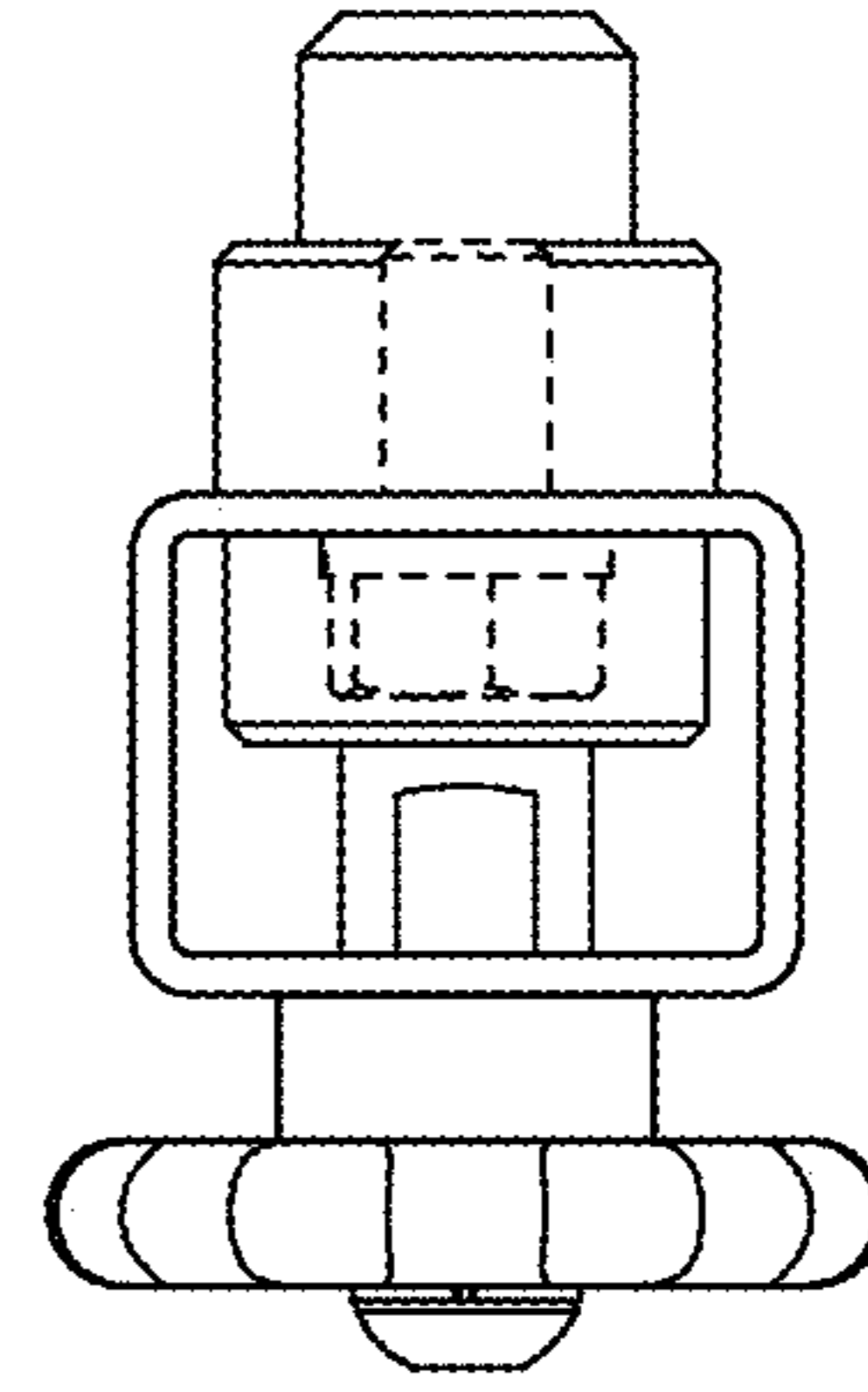

**FIG. 14**

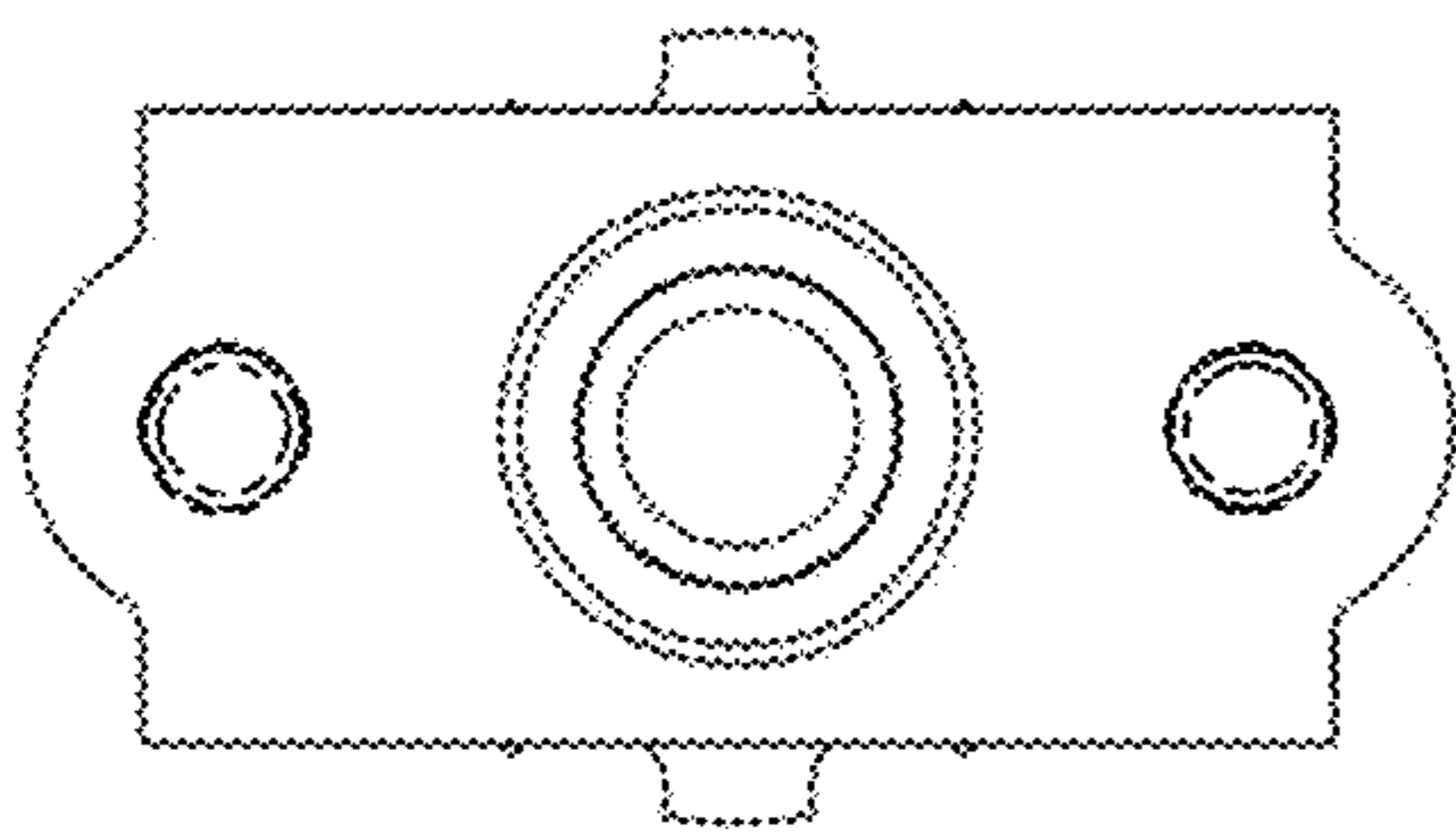

**FIG. 15**

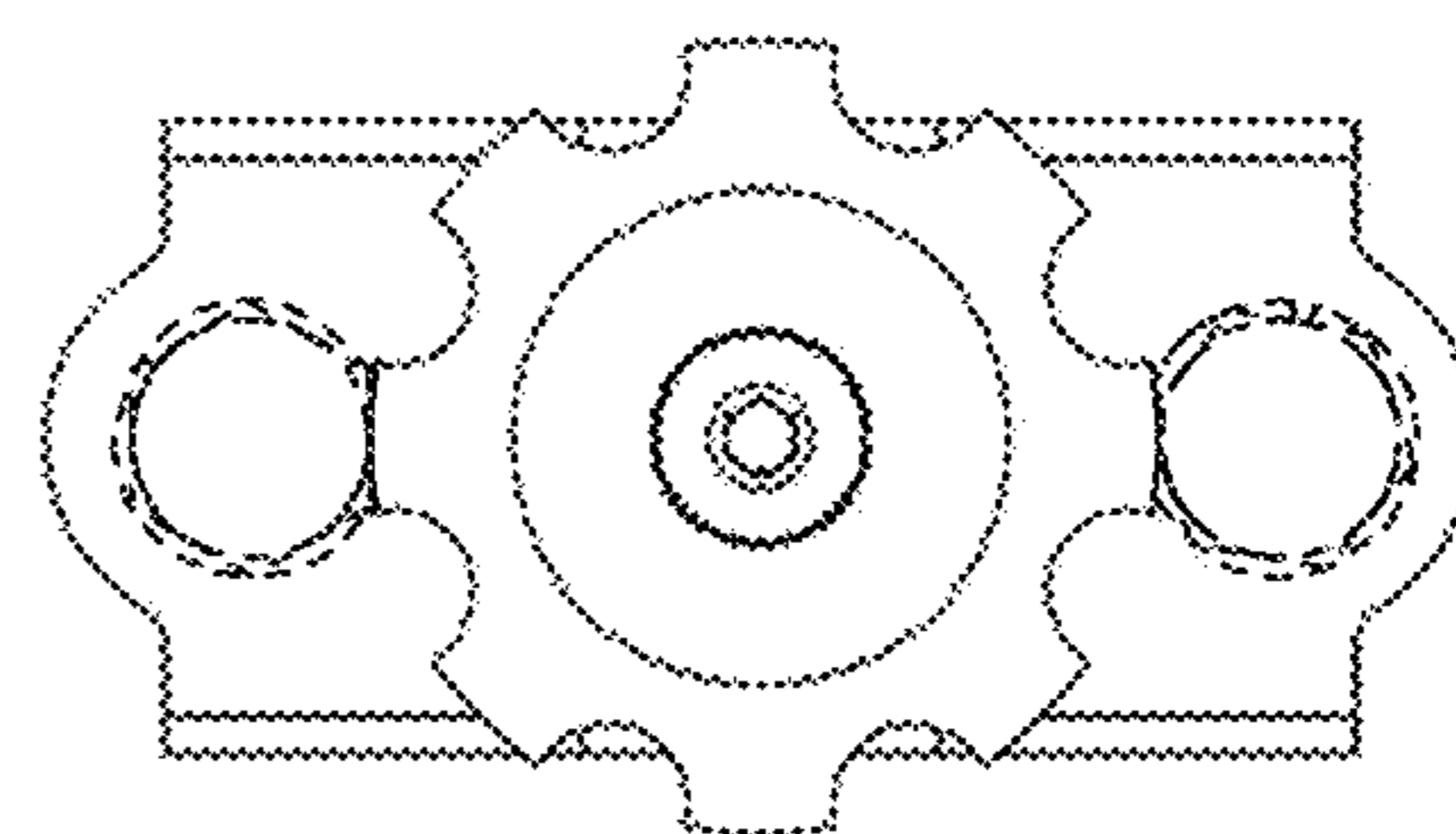

**FIG. 16**