

US00D961304S

(12) **United States Design Patent**
Castelli

(10) **Patent No.:** **US D961,304 S**

(45) **Date of Patent:** **** Aug. 23, 2022**

(54) **FURNITURE FOR BATHROOMS**
(71) Applicant: **Paolo Castelli**, Bologna (IT)
(72) Inventor: **Paolo Castelli**, Bologna (IT)

(**) Term: **15 Years**

(21) Appl. No.: **35/511,987**

(22) Filed: **May 25, 2021**

(80) **Hague Agreement Data**

Int. Filing Date: **May 25, 2021**

Int. Reg. No.: **DM/214526**

Int. Reg. Date: **May 25, 2021**

Int. Reg. Pub. Date: **Jun. 11, 2021**

(51) **LOC (13) Cl.** **06-04**

(52) **U.S. Cl.**
USPC **D6/664**; D23/286
CPC **A47K 1/04** (2013.01)

(58) **Field of Classification Search**
USPC D23/284, 293.1, 287-292, 303, 308;
D6/653.1, 657, 659-661, 663, 666, 671,
D6/691.3, 709, 661.3, 668, 688.21
CPC A47K 1/04; A47B 77/06; A47J 47/20
See application file for complete search history.

(56) **References Cited**

U.S. PATENT DOCUMENTS

D300,058 S * 2/1989 Emanuele D23/286
D331,100 S * 11/1992 Jacobsen D34/6
D338,949 S * 8/1993 Paulin D23/271
D352,992 S * 11/1994 Pajetta D23/271
D354,120 S * 1/1995 Pajetta D23/286

D362,051 S * 9/1995 Pajetta D23/286
D362,052 S * 9/1995 Pajetta D6/673
D430,276 S * 8/2000 Swensson D23/286
D443,044 S * 5/2001 Swensson D23/271
D457,249 S * 5/2002 Gilbert D24/234
6,502,254 B1 * 1/2003 De Menna A47B 77/022
4/631
D535,367 S * 1/2007 Bouroullec D23/271
D566,974 S * 4/2008 Lee D6/300
D588,676 S * 3/2009 Loberger D23/271
D593,644 S * 6/2009 Bock D23/271
D610,242 S * 2/2010 Loberger D23/308
D628,280 S * 11/2010 Loberger D23/308
D641,842 S * 7/2011 Loberger D23/308
D727,478 S * 4/2015 Mayer D23/286
D923,946 S * 7/2021 Flaig D6/309
D938,558 S * 12/2021 Flaig D23/284
D938,559 S * 12/2021 Flaig D23/284
D945,577 S * 3/2022 Stevenson D23/308
11,304,940 B2 * 4/2022 Castelli A61P 13/12

* cited by examiner

Primary Examiner — Richard E Chilcot

(57) **CLAIM**

The ornamental design for furniture for bathrooms, as shown and described.

DESCRIPTION

1. Furniture for bathrooms

- 1.1: front view;
- 1.2: top view;
- 1.3: right view;
- 1.4: left view;
- 1.5: bottom view;
- 1.6: rear view;
- 1.7: perspective view.

1 Claim, 7 Drawing Sheets

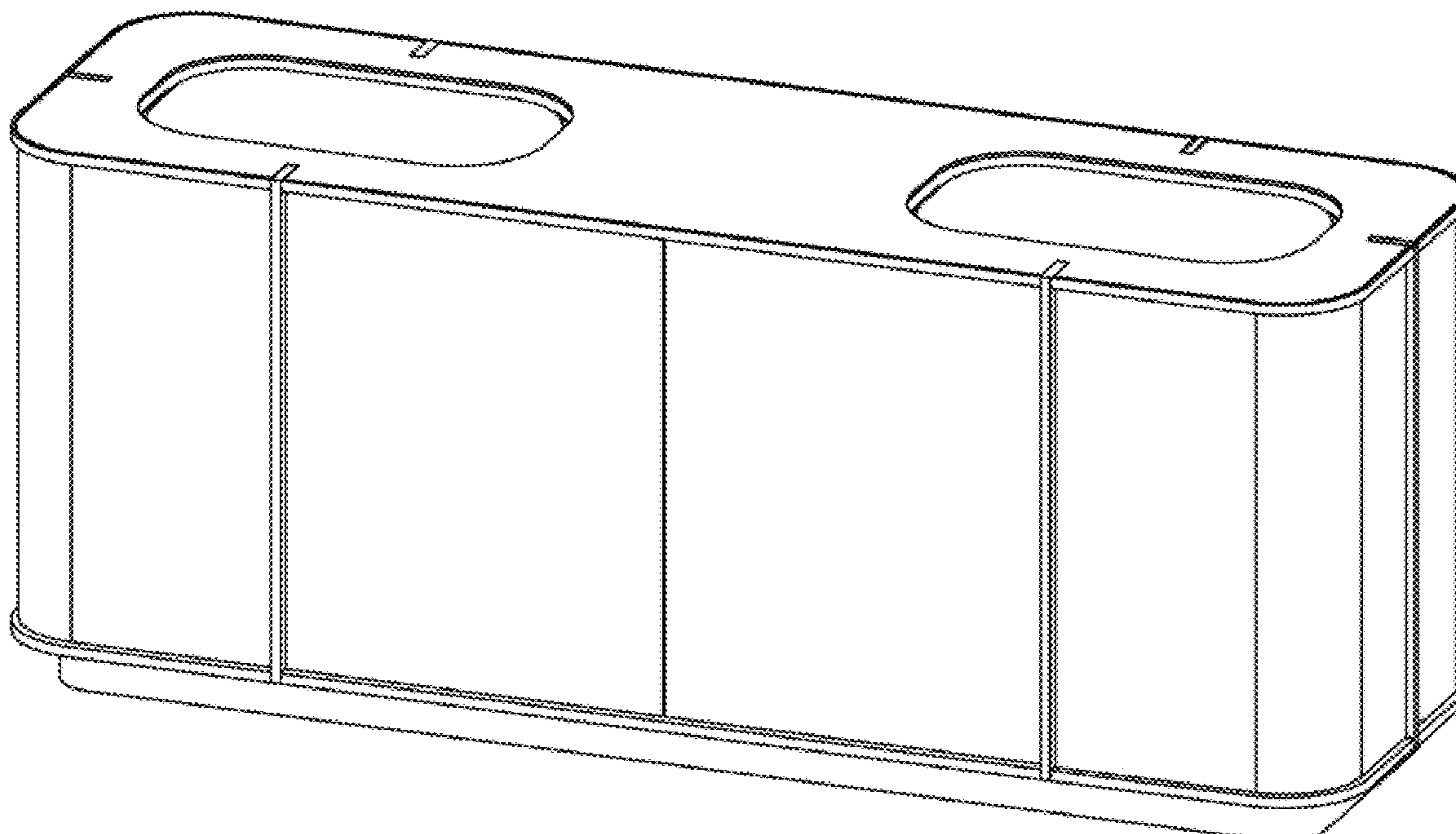

1.1

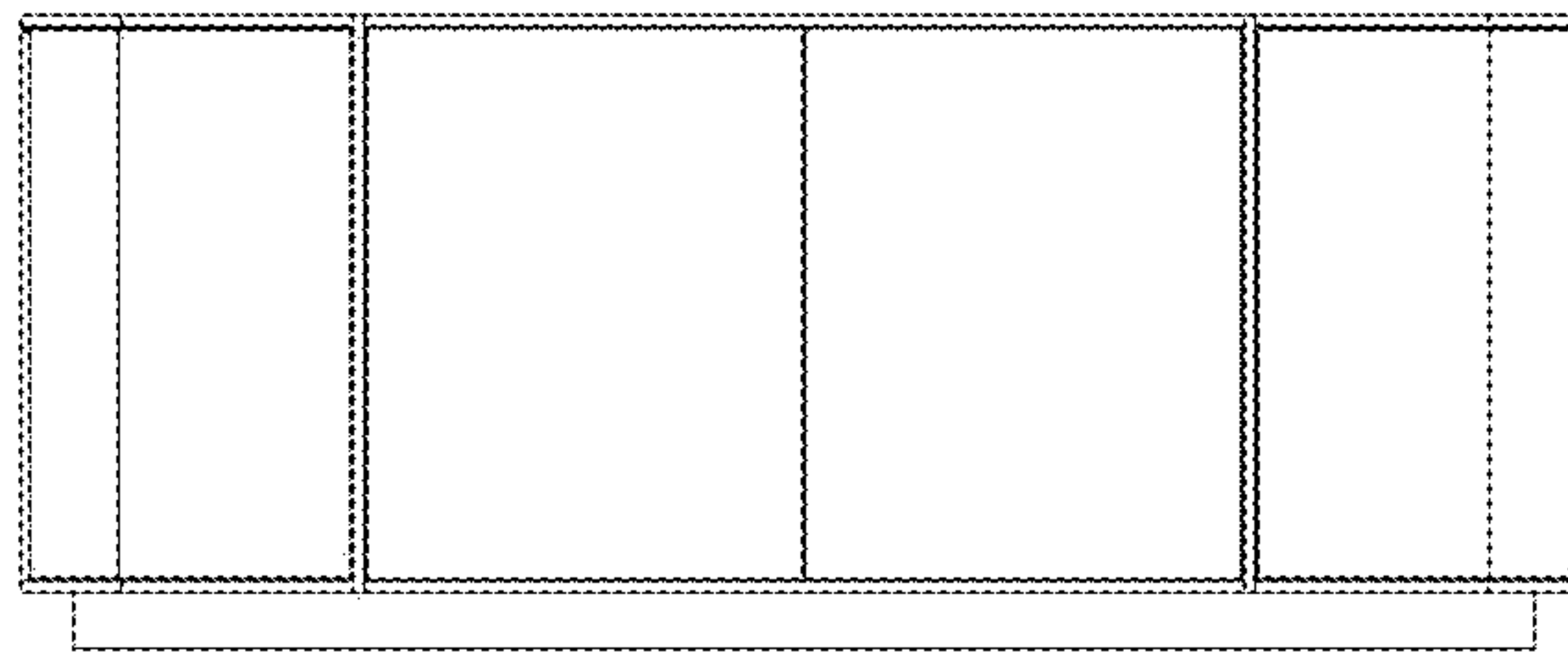

1.2

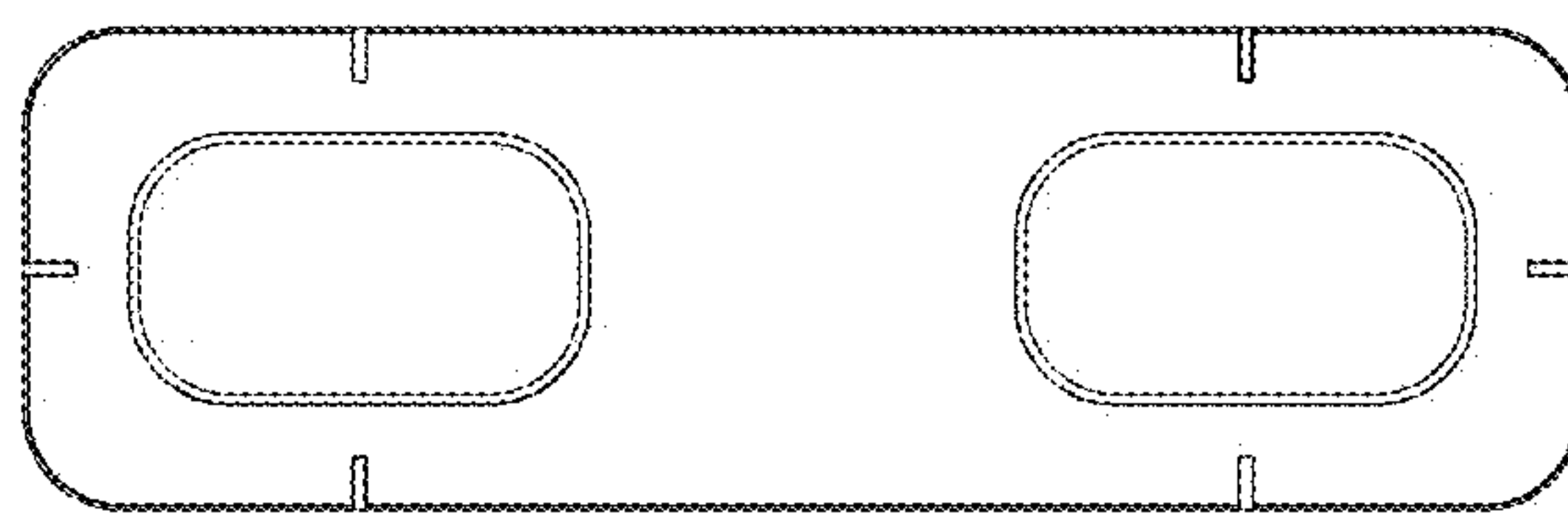

1.3

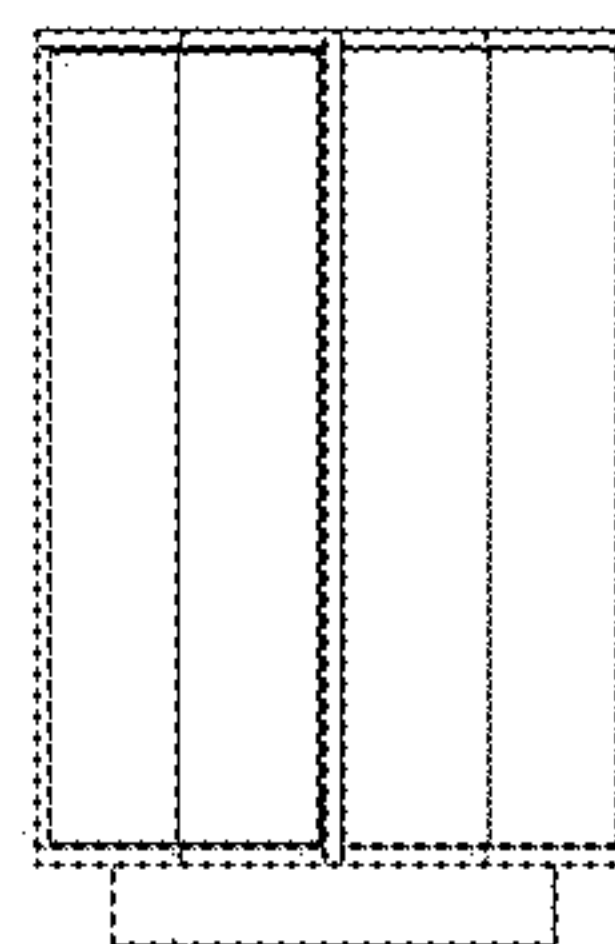

1.4

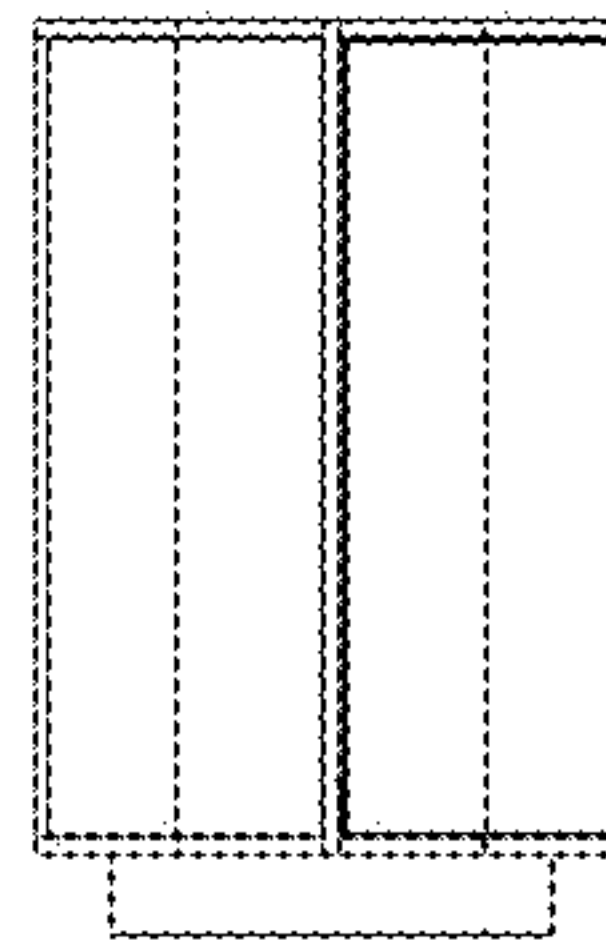

1.5

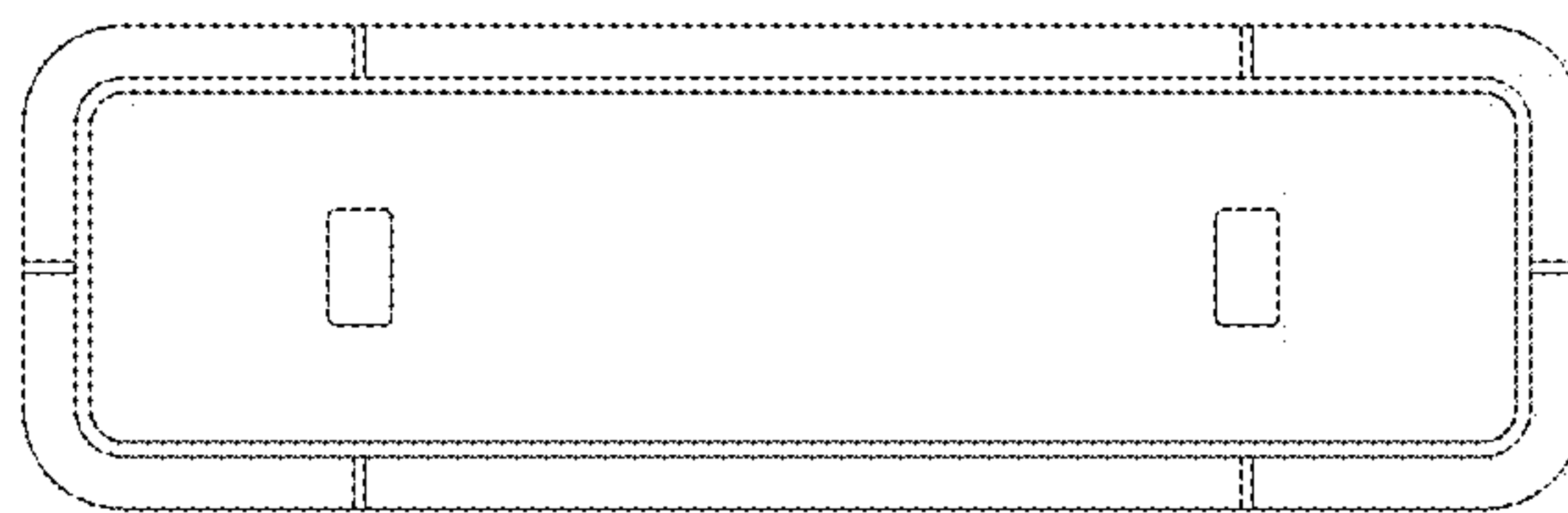

1.6

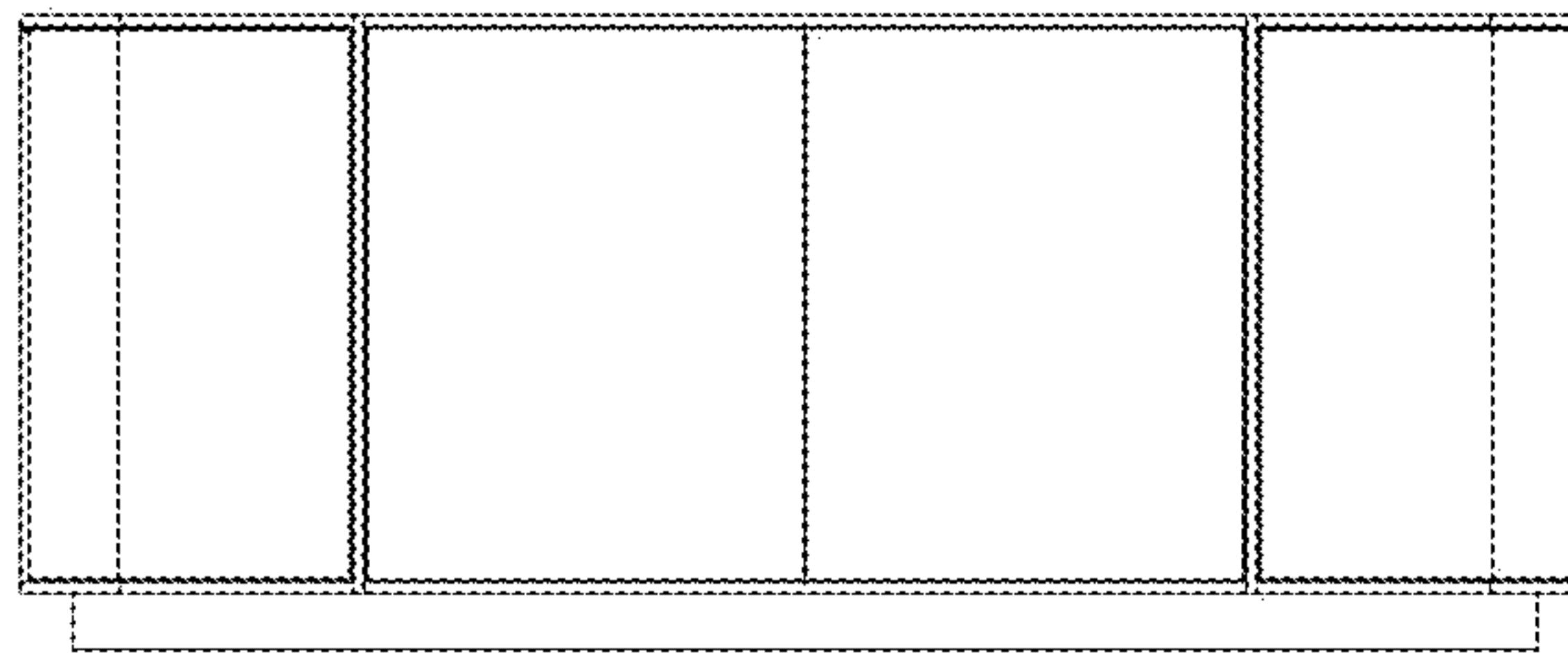

1.7

