



US00D960052S

(12) **United States Design Patent**
Chen

(10) **Patent No.:** **US D960,052 S**

(45) **Date of Patent:** **** Aug. 9, 2022**

(54) **ELECTRIC BICYCLE**

(71) Applicant: **Qiang Chen**, Guangzhou (CN)

(72) Inventor: **Qiang Chen**, Guangzhou (CN)

(**) Term: **15 Years**

(21) Appl. No.: **29/721,574**

(22) Filed: **Jan. 22, 2020**

(51) **LOC (13) Cl.** **12-11**

(52) **U.S. Cl.**
USPC **D12/111**

(58) **Field of Classification Search**
USPC D12/110, 111, 117; D21/412, 414, 419,
D21/423-428, 431-435
CPC B62K 3/00; B62K 3/02; B62K 3/06
See application file for complete search history.

(56) **References Cited**

U.S. PATENT DOCUMENTS

D620,401 S *	7/2010	Haller	D12/111
D797,609 S *	9/2017	Gonzalez-Gancedo Carrillo-Albornoz	D12/111
D843,269 S *	3/2019	Shi	D12/111
D900,680 S *	11/2020	Chen	D12/111
D903,532 S *	12/2020	Ma	D12/111
D918,778 S *	5/2021	Shi	D12/111
D932,378 S *	10/2021	Hu	D12/111
D934,121 S *	10/2021	Hu	D12/111
D934,122 S *	10/2021	Hu	D12/111
D937,134 S *	11/2021	Lu	12/111

OTHER PUBLICATIONS

“M-60 R7 cruiser e-bike” Addmotor., posted date Feb. 2, 2021 [online], [retrieved on Nov. 30, 2021]. Retrieved from the Internet <<https://www.addmotor.com/products/m-60-r7>> (Year: 2021).*

“Addmotor Motan M60 R7 Electric Bicycle” Addmotor., posted date Jan. 21, 2020 [online], [retrieved on Nov. 30, 2021]. Retrieved from the Internet <<https://roadsharkpowersports.com/product/addmotor-moton-m60-r7/>> (Year: 2020).*

“AddMotoR Motan M-60 electric bike review.” Addmotor., posted date Apr. 4, 2019 [online], [retrieved on Nov. 30, 2021]. Retrieved from the Internet <<https://www.electrifiedreviews.com/blog/addmotor-motan-m-60-electric-bike-review-cool-compact-fat-tire-cruiser/>> (Year: 2019).*

* cited by examiner

Primary Examiner — Darlington Ly

Assistant Examiner — Nasim Abdulaziz Ali

(74) *Attorney, Agent, or Firm* — Rumit Ranjit Kanakia

(57) **CLAIM**

I claim the ornamental design for an electric bicycle, as shown and described.

DESCRIPTION

FIG. 1 is a front perspective view of an electric bicycle showing my new design;
FIG. 2 is a front elevation view thereof;
FIG. 3 is a rear elevation view thereof;
FIG. 4 is a right-side elevation view thereof;
FIG. 5 is a left-side elevation view thereof;
FIG. 6 is a top plan view thereof; and,
FIG. 7 is a bottom plan view thereof.

The broken lines in the drawings illustrate portions of the electric bicycle that form no part of the claimed design.

1 Claim, 7 Drawing Sheets

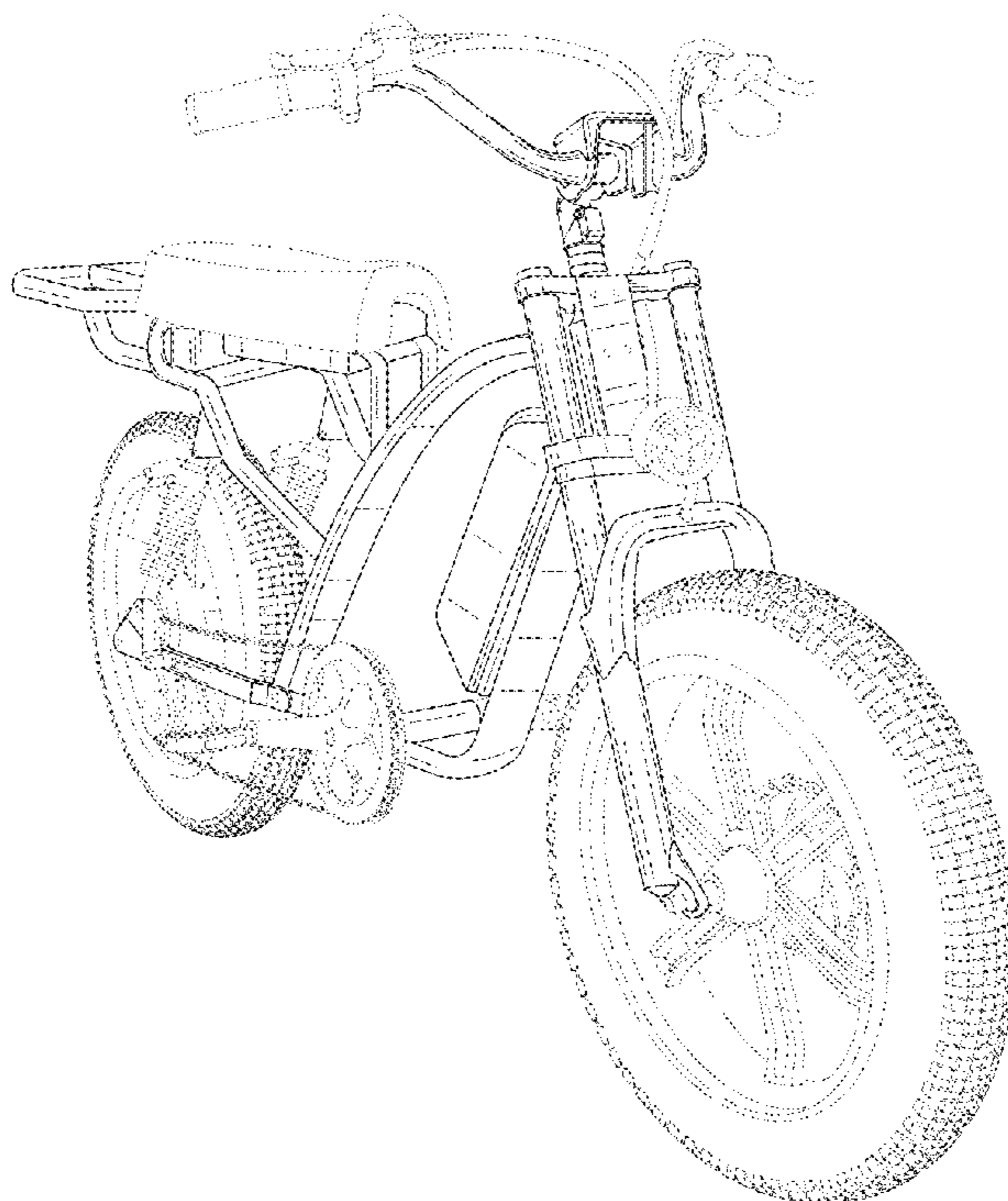

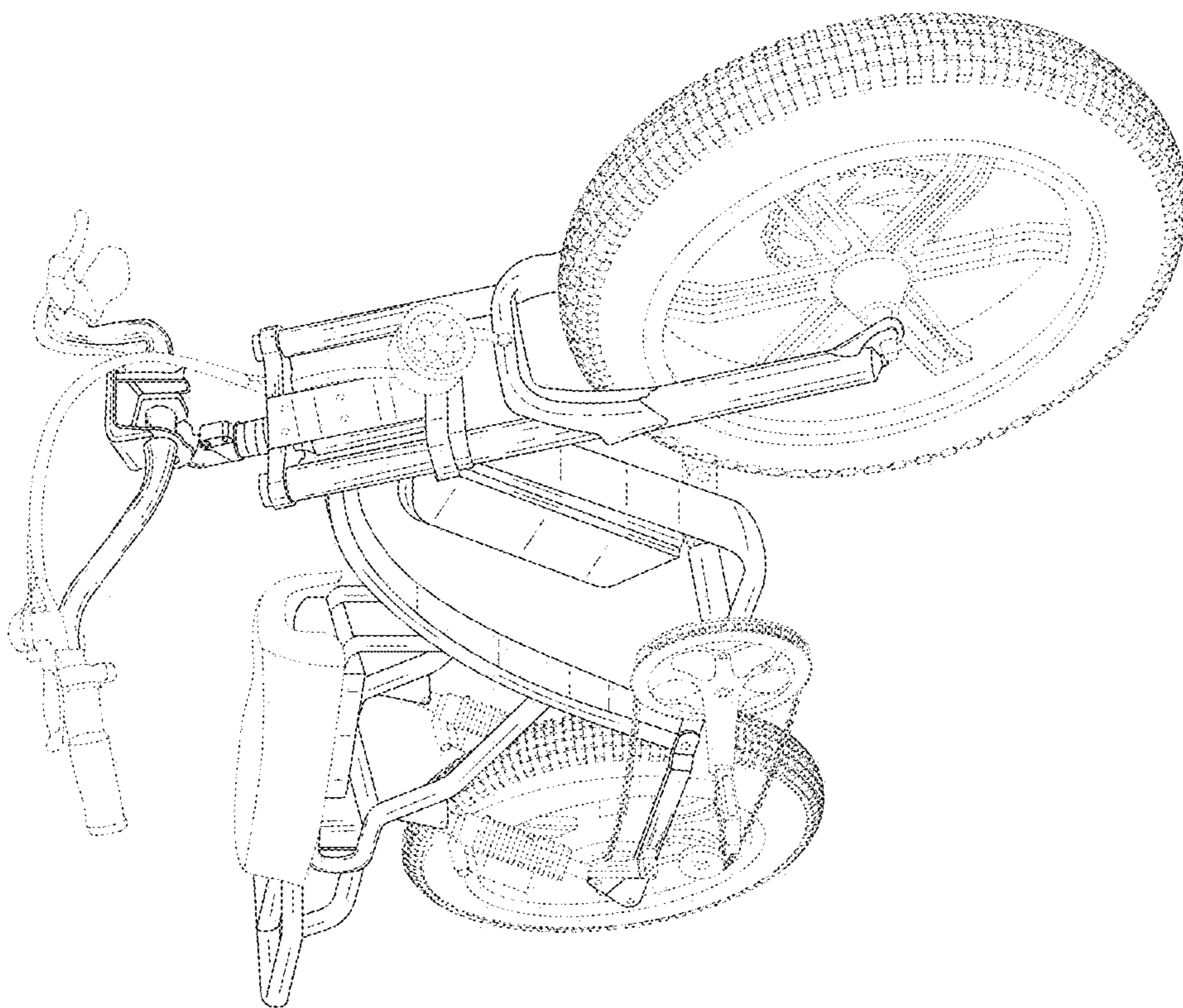

FIG. 1

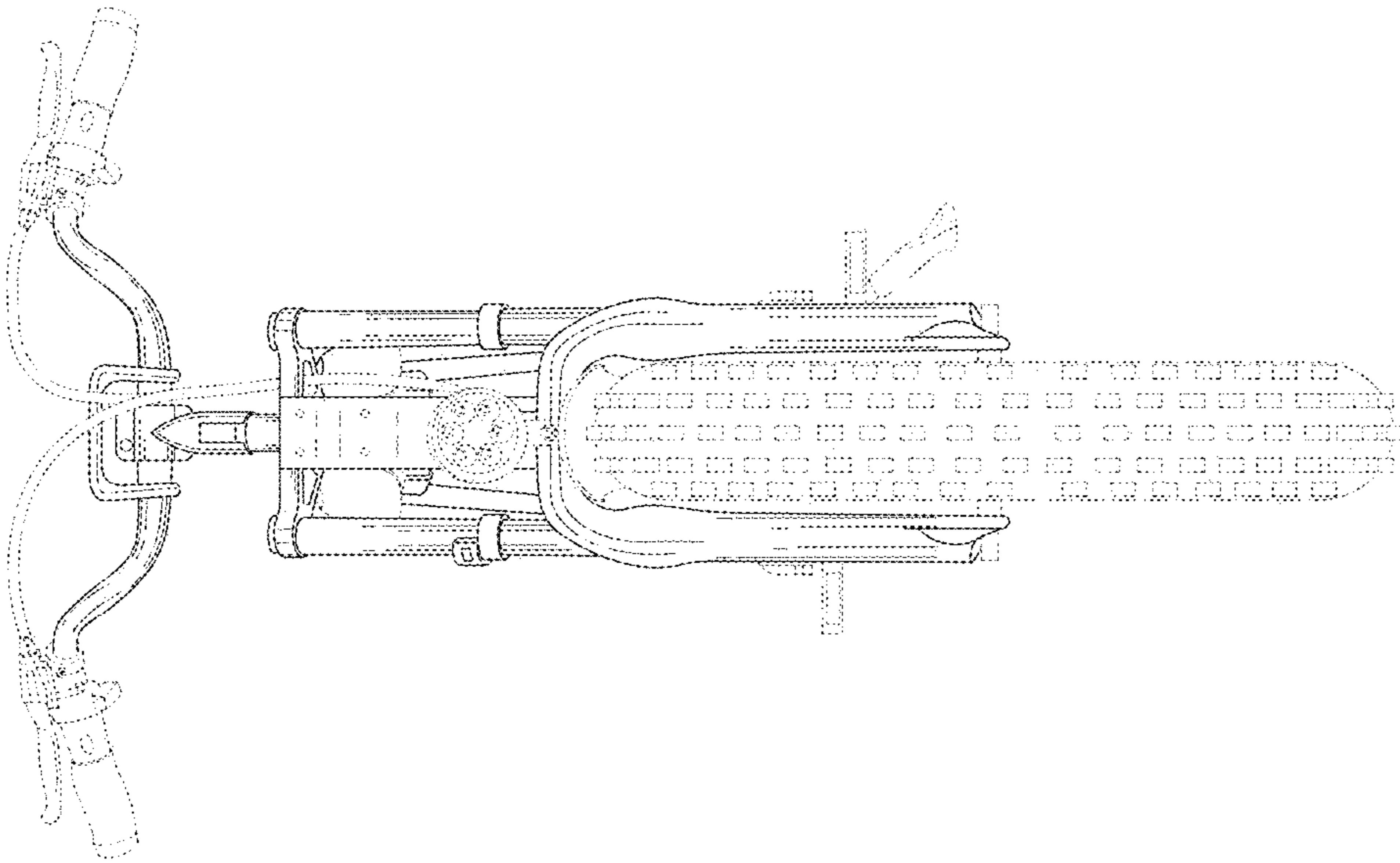

FIG. 2

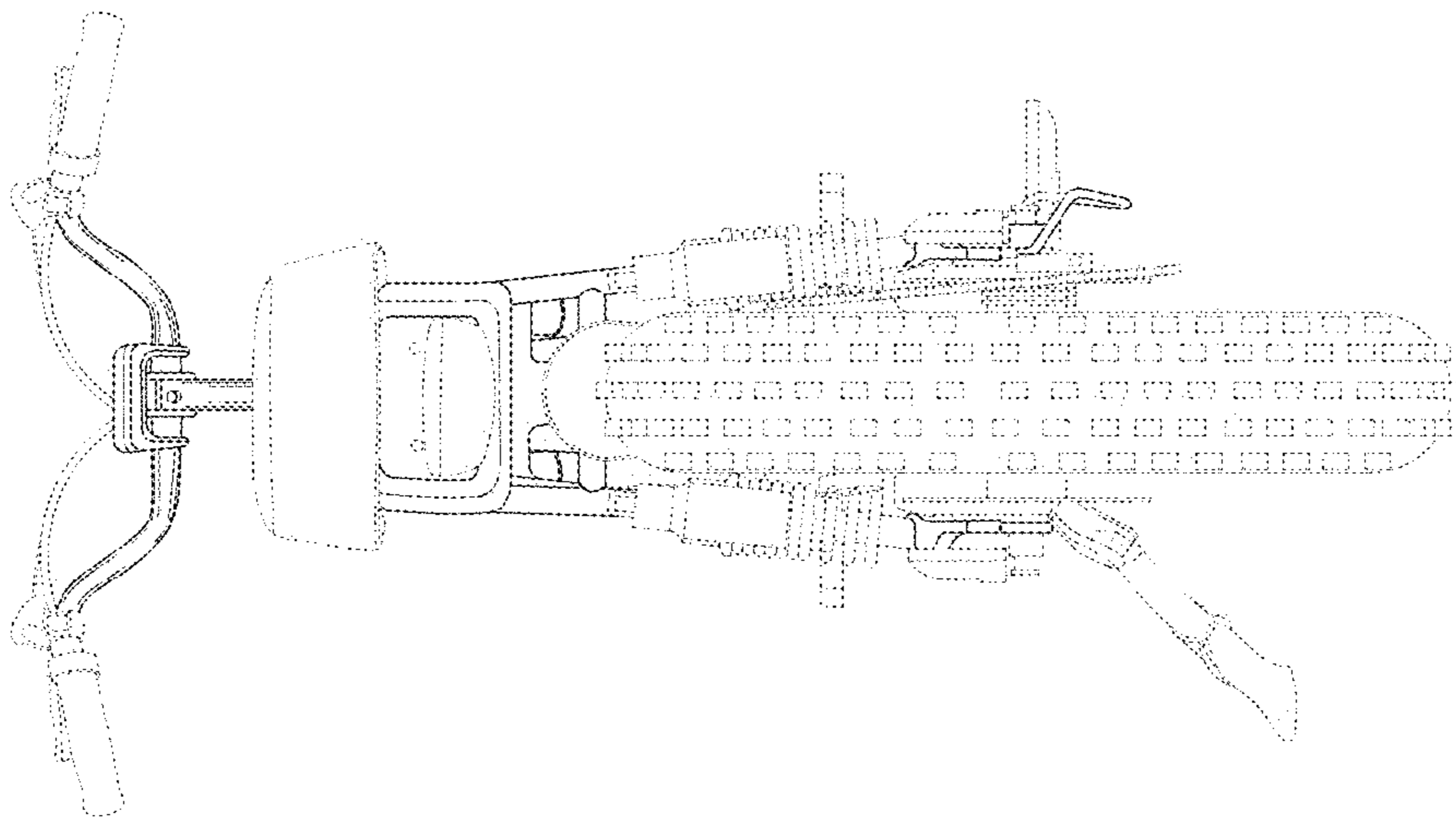

FIG. 3

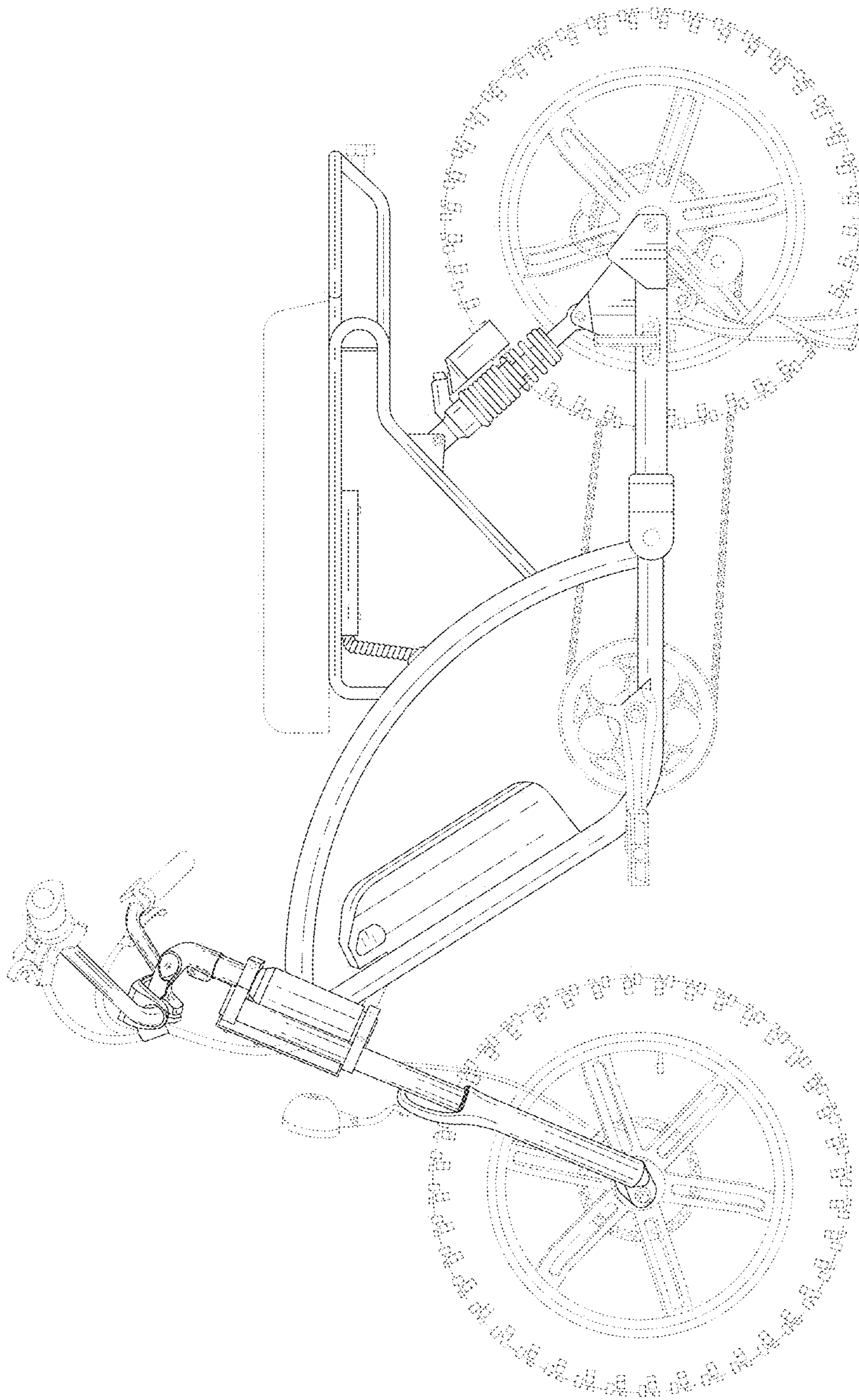

FIG. 4

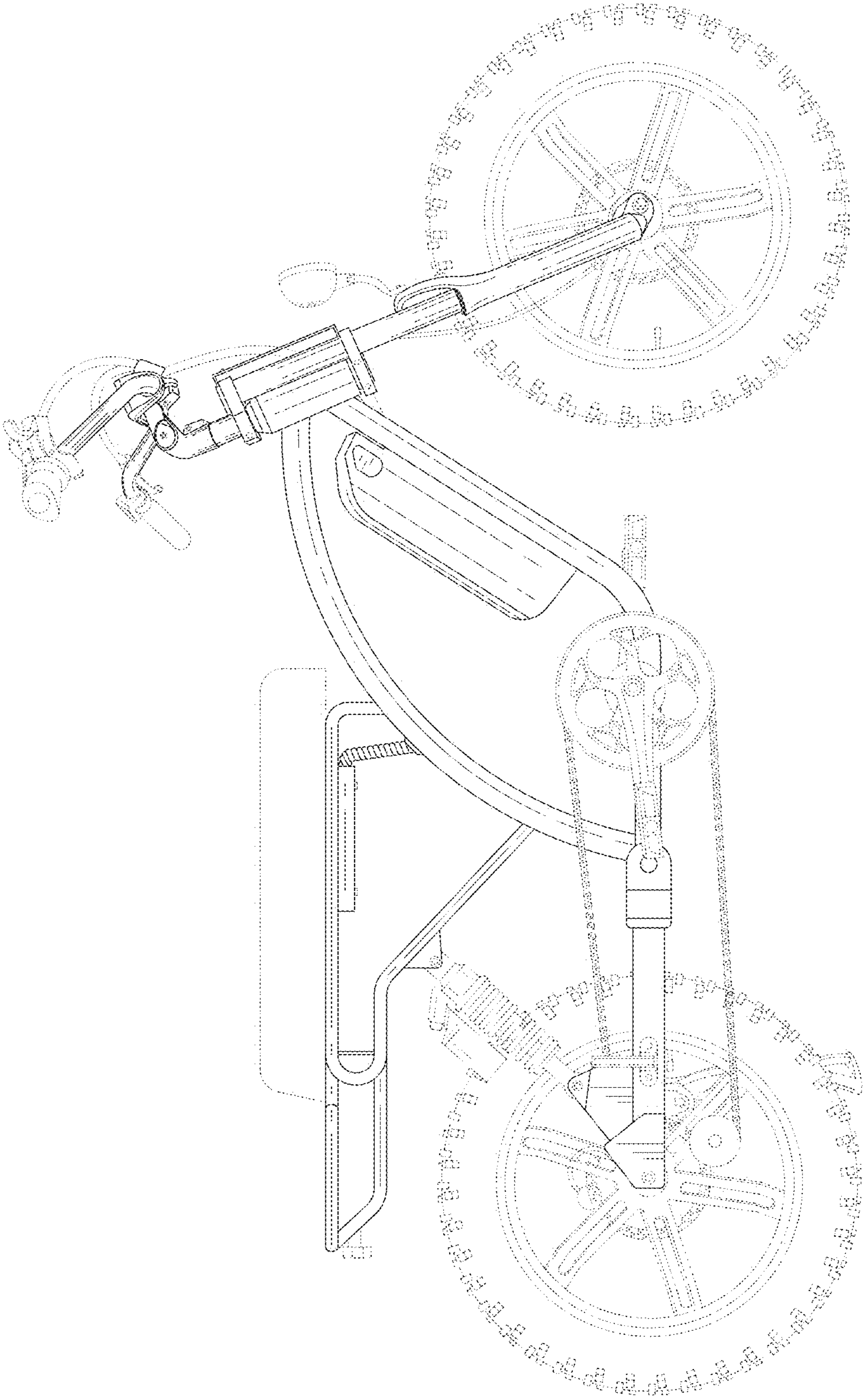

FIG. 5

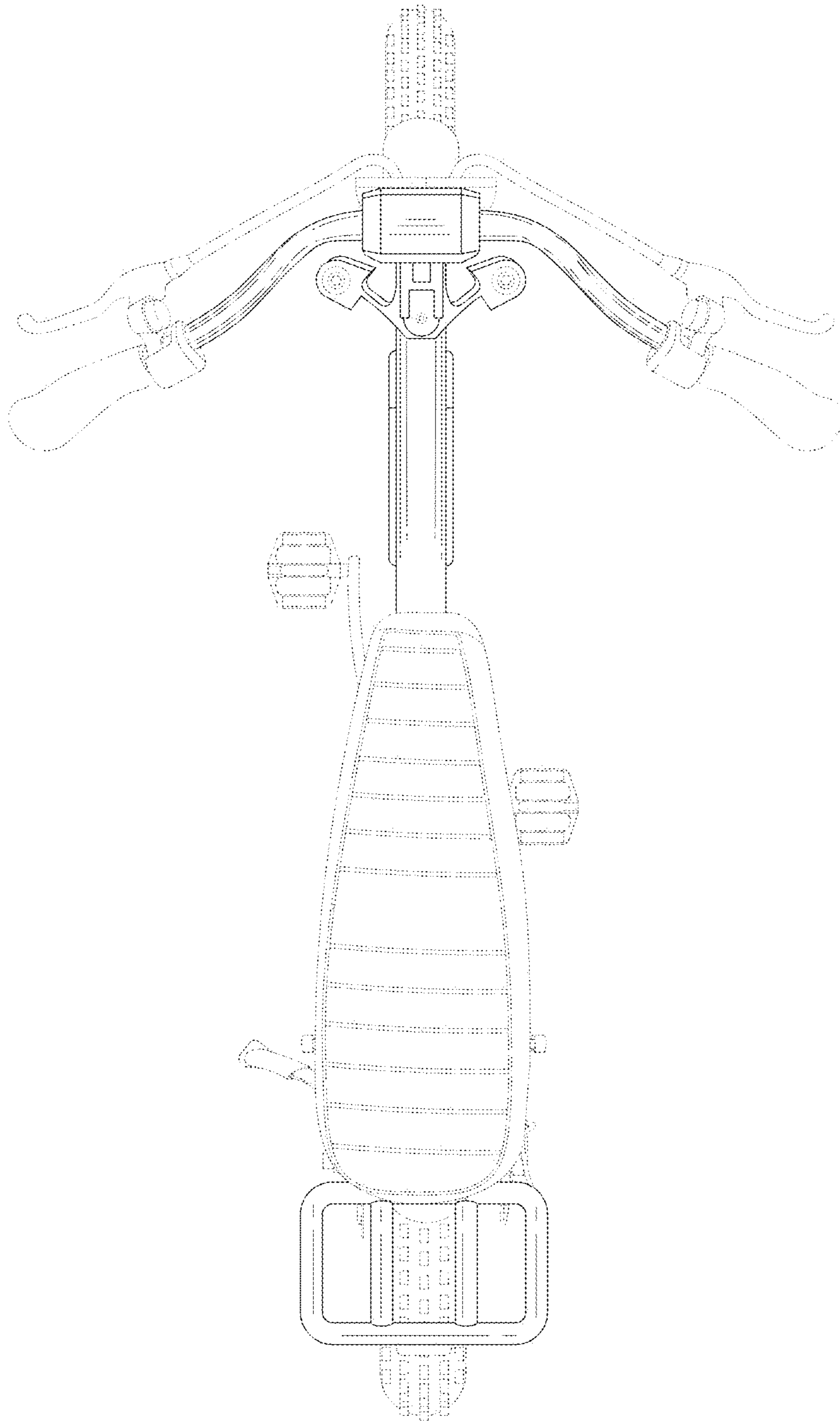

FIG. 6

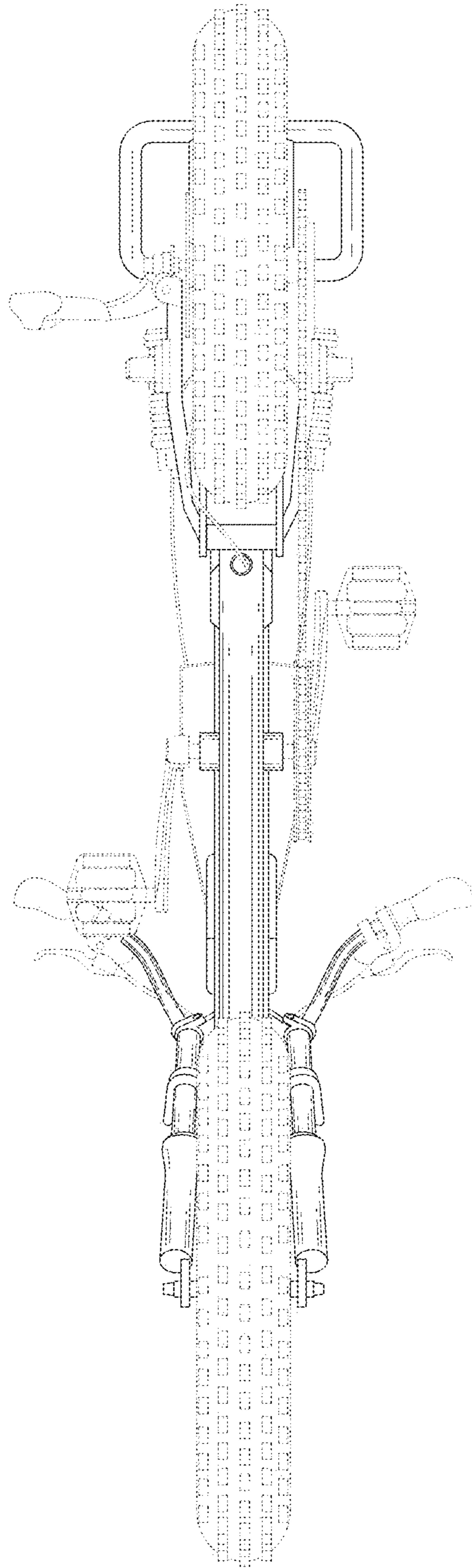

FIG. 7