

US00D959899S

(12) **United States Design Patent**
Danieli et al.

(10) **Patent No.:** **US D959,899 S**

(45) **Date of Patent:** **** Aug. 9, 2022**

- (54) **CARBONATION MECHANISM ASSEMBLY**
- (71) Applicant: **SODASTREAM INDUSTRIES LTD.**,
Kfar Saba (IL)
- (72) Inventors: **Guy Danieli**, Jerusalem (IL); **Amit Avigdor**, Kibbutz Bahan (IL); **Doron Krom**, Zichron Yaakov (IL); **Oren Shalev**, Ashdod (IL); **Allan Ring**, Mercaz Shapira (IL); **Avi Cohen**, Jerusalem (IL); **Dvir Brand**, Hod Hasharon (IL); **Amnon Shkedi**, Karkur (IL)
- (73) Assignee: **SODASTREAM INDUSTRIES LTD.**,
Kfar Saba (IL)
- (**) Term: **15 Years**
- (21) Appl. No.: **35/511,254**
- (22) Filed: **Jan. 6, 2021**

(80) **Hague Agreement Data**

Int. Filing Date: **Jan. 6, 2021**
 Int. Reg. No.: **DM/212271**
 Int. Reg. Date: **Jan. 6, 2021**
 Int. Reg. Pub. Date: **Jan. 29, 2021**

(30) **Foreign Application Priority Data**

Jul. 17, 2020 (CH) 145444

(51) **LOC (13) Cl.** **07-99**

(52) **U.S. Cl.**
USPC **D7/398**

(58) **Field of Classification Search**
USPC D9/434, 435; D7/213, 300, 392, 392.1,
D7/393, 396.2, 397, 398, 507, 510, 693
CPC A47G 19/22; A47G 19/2266
See application file for complete search history.

(56) **References Cited**

U.S. PATENT DOCUMENTS

4,082,123 A * 4/1978 Haythornthwaite
B01F 33/5014
141/97
7,975,988 B2 * 7/2011 Thomson B01F 23/2361
426/477

8,888,073 B2 * 11/2014 Leung A23L 2/54
261/38
D731,223 S * 6/2015 Hatherell D7/311
D734,635 S * 7/2015 Behar D7/311
D783,333 S * 4/2017 Burrows D7/311
D799,879 S * 10/2017 Shmueli D7/311
2020/0338507 A1 * 10/2020 Cohen B01F 23/2361

FOREIGN PATENT DOCUMENTS

CA 200809 * 11/2021
IL 66282 * 12/2021

* cited by examiner

Primary Examiner — S. Bryan Reinholdt, Jr.
 (74) *Attorney, Agent, or Firm* — Pearl Cohen Zedek
 Latzer Baratz LLP

(57) **CLAIM**

The ornamental design for a carbonation mechanism assembly, as shown and described.

DESCRIPTION

Fig. 1.1 is a perspective view of a carbonation mechanism assembly showing our new design;
 Fig. 1.2 is a front elevation view thereof;
 Fig. 1.3 is a back elevation view thereof;
 Fig. 1.4 is a left side elevation view thereof;
 Fig. 1.5 is a right side elevation view thereof;
 Fig. 1.6 is a top plan view thereof;
 Fig. 1.7 is a top bottom plan view thereof; and
 Fig. 1.8 is a perspective view of the carbonation mechanism assembly shown in use configuration with environment.
 The broken lines in FIGs. 1.3, 1.6, and 1.7 depict portions of the carbonation mechanism assembly that form no part of the claimed design. The broken lines in FIG. 1.8 depict environment that forms no part of the claimed design.

1 Claim, 8 Drawing Sheets

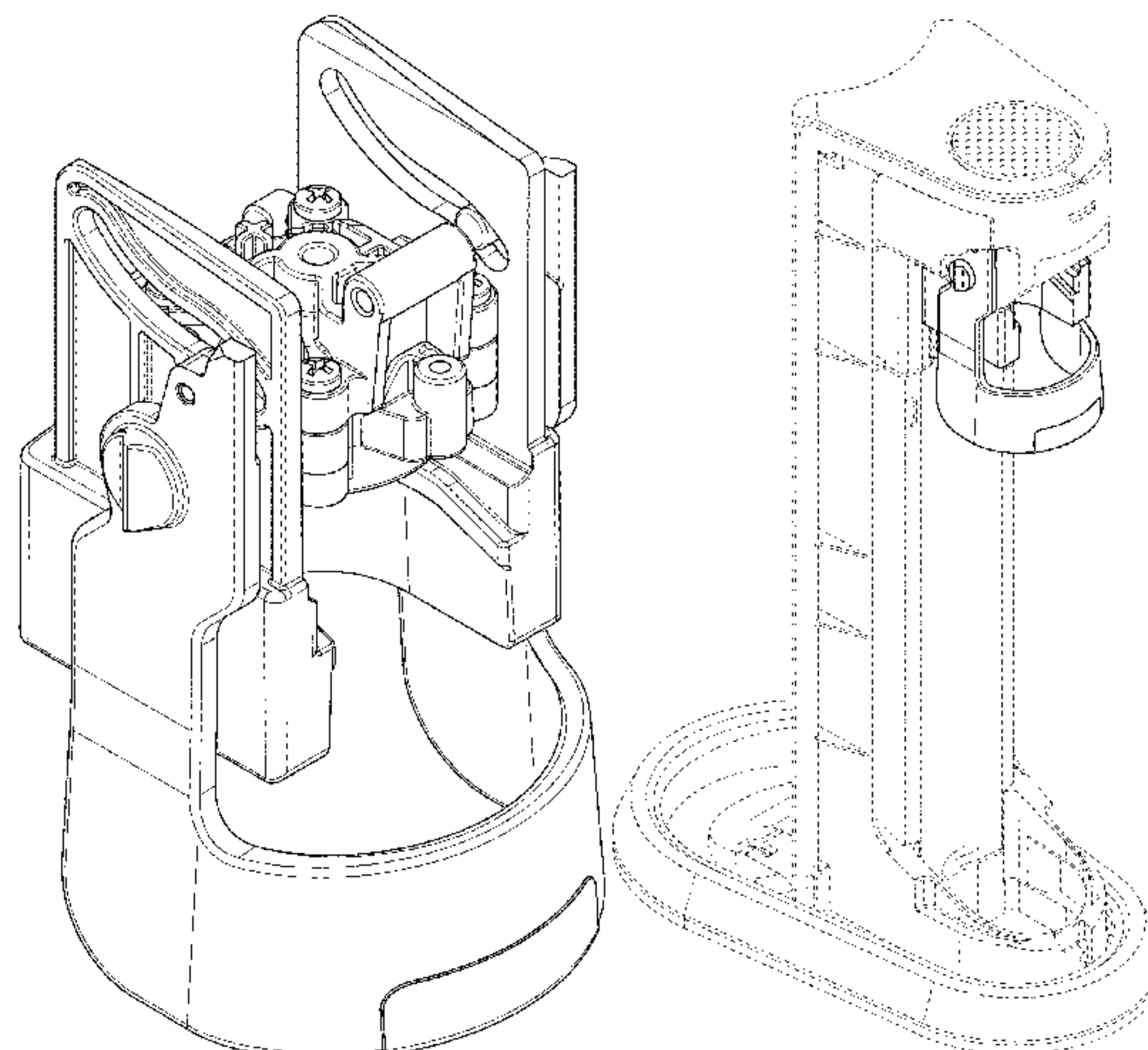

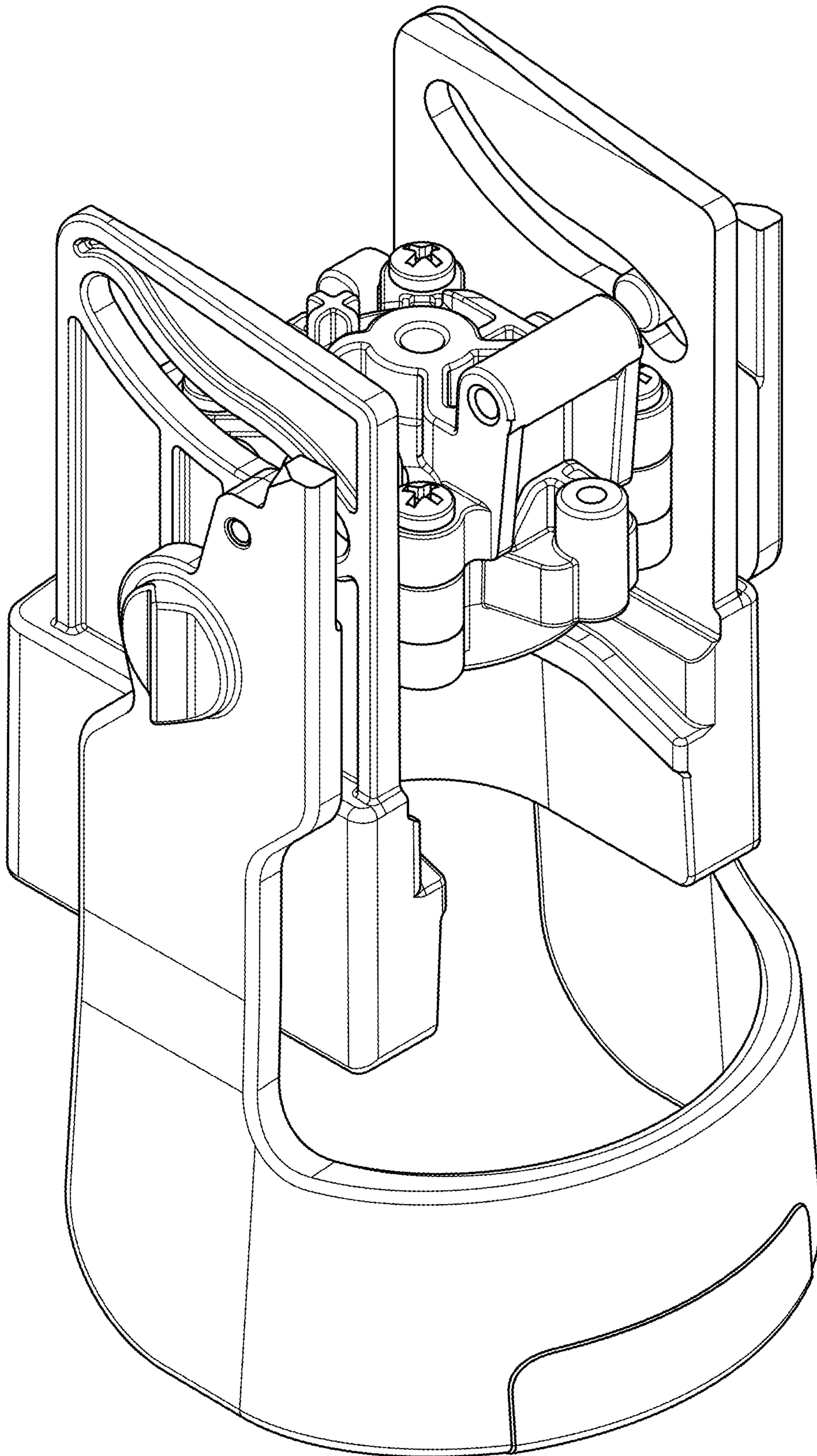

FIG. 1.1

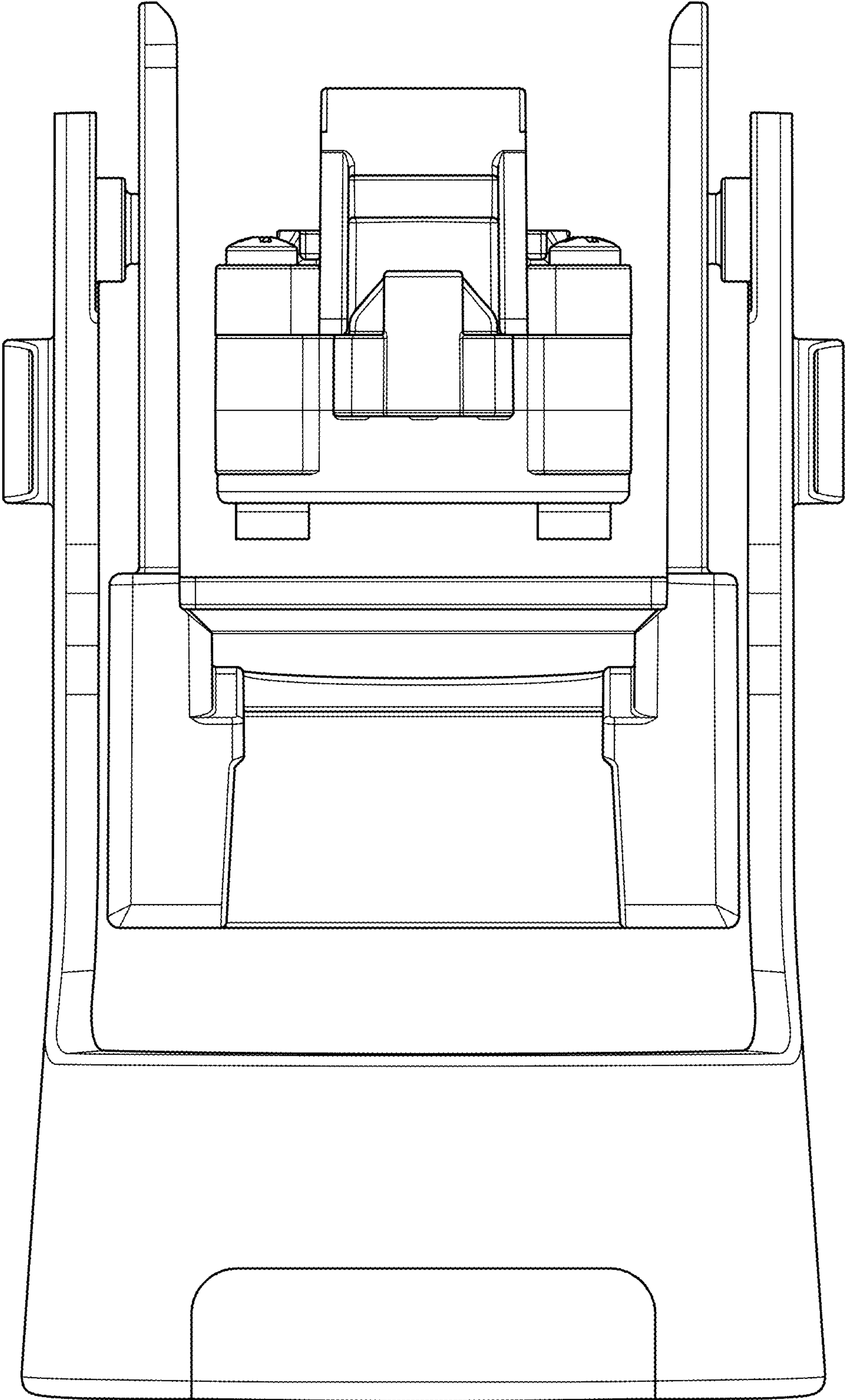

FIG. 1.2

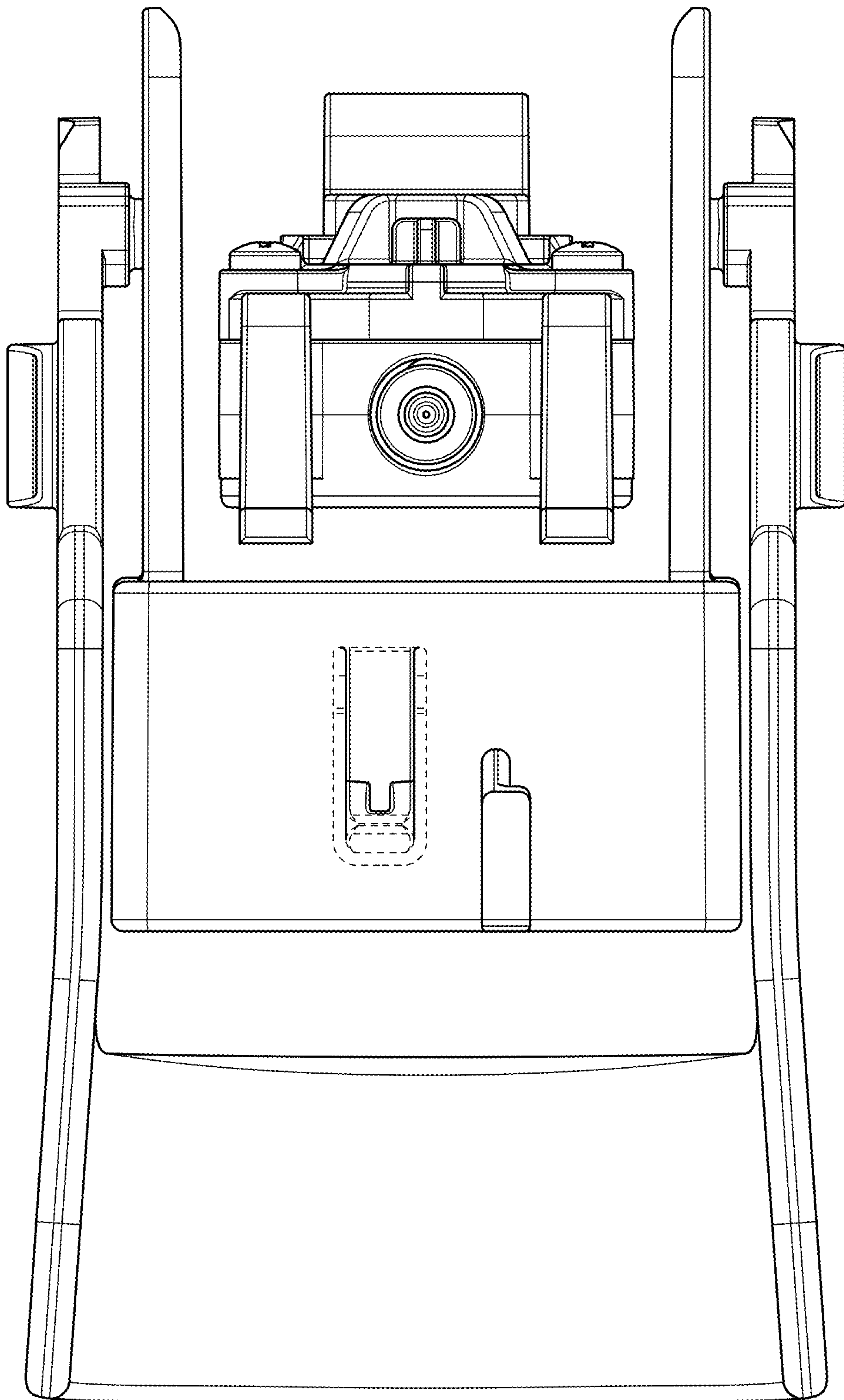

FIG. 1.3

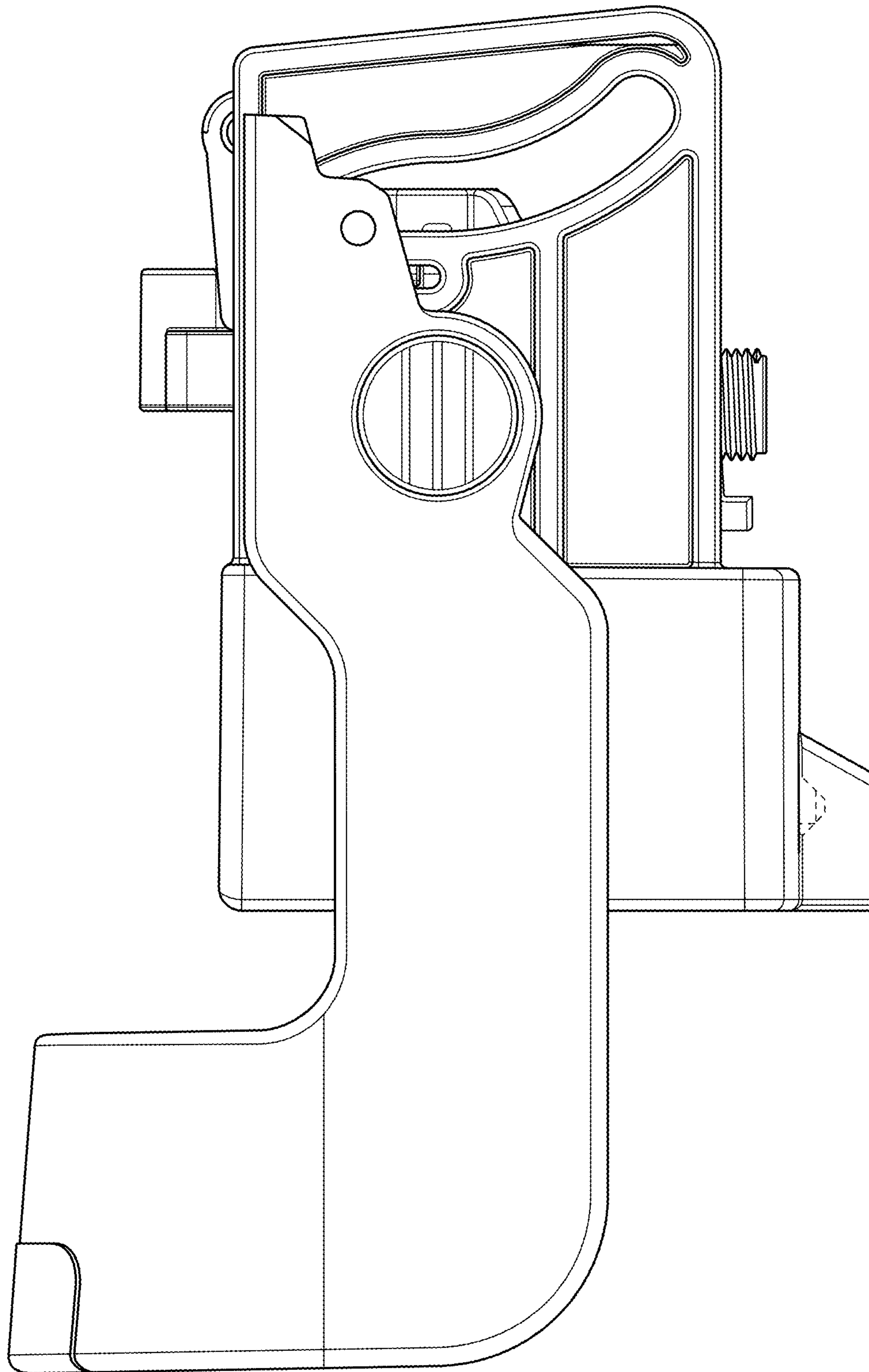

FIG. 1.4

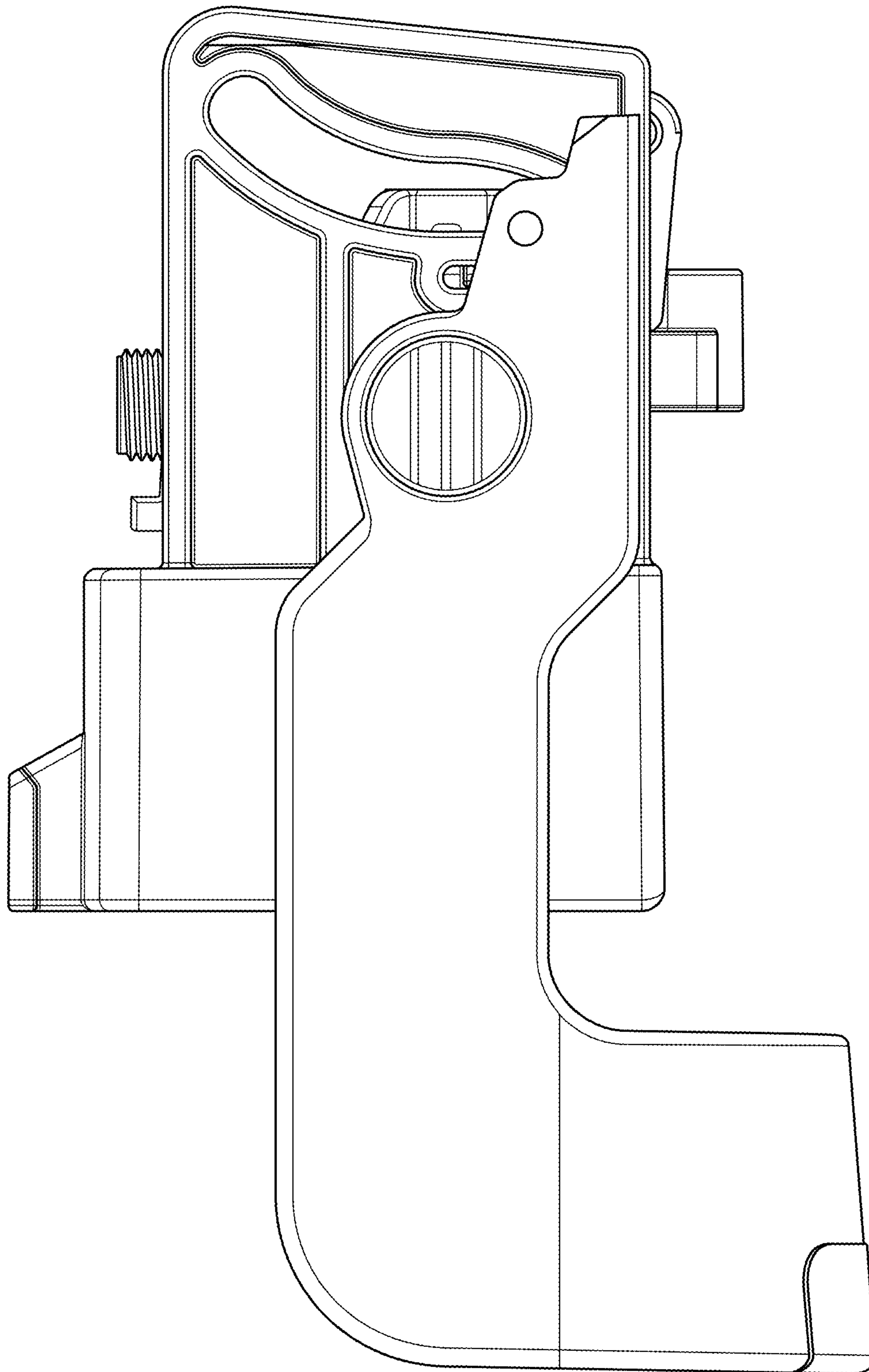

FIG. 1.5

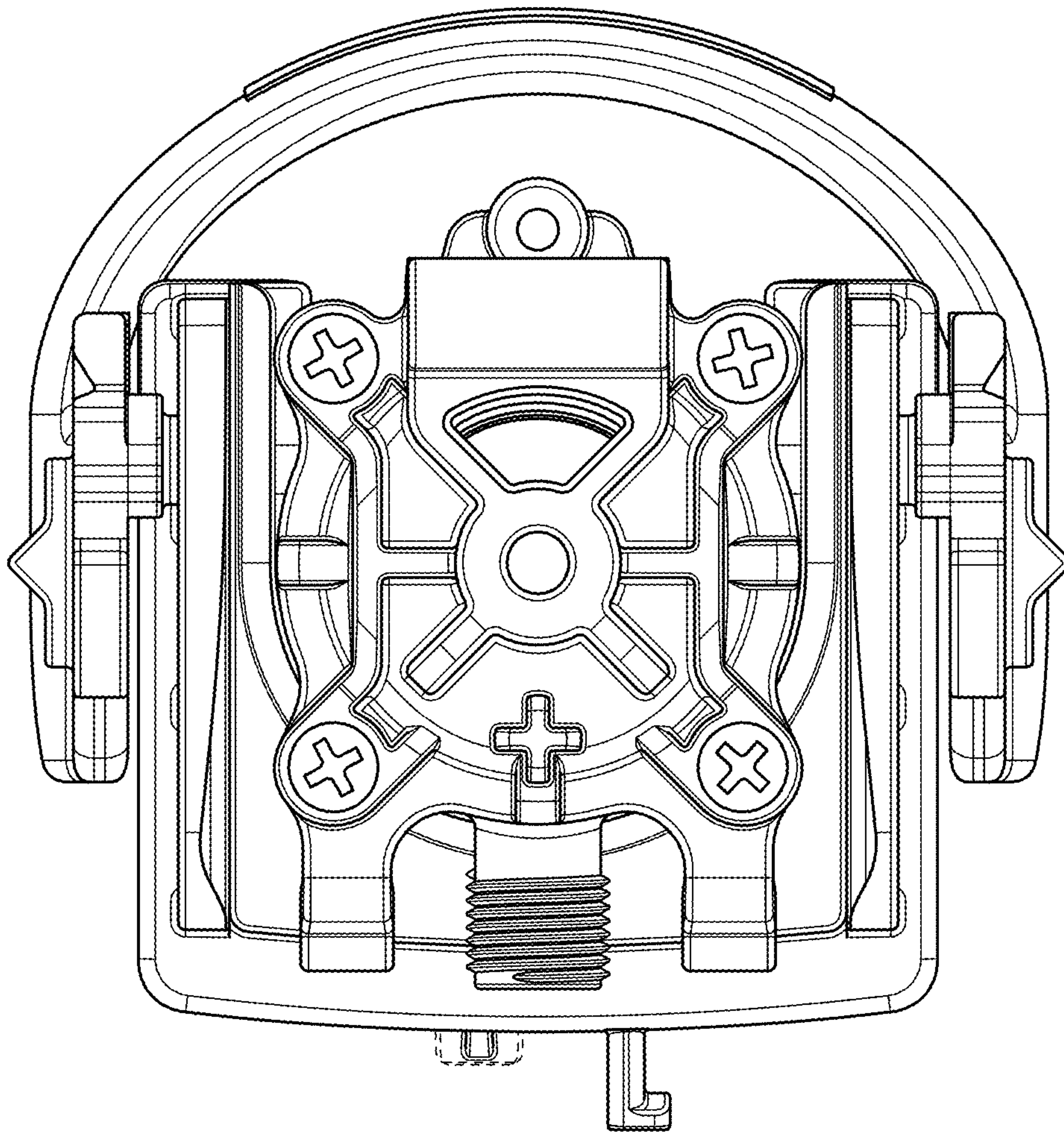

FIG. 1.6

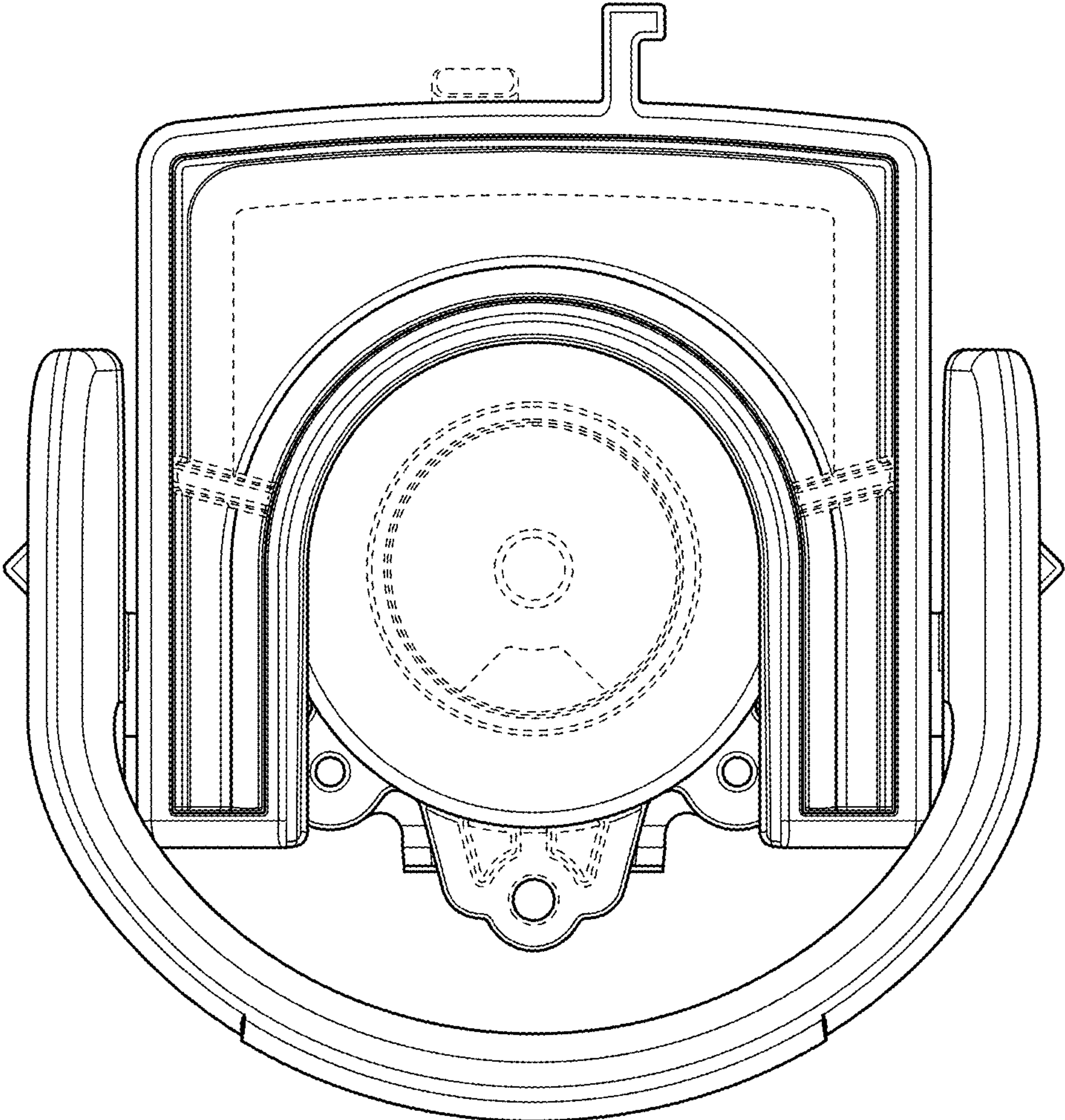

FIG. 1.7

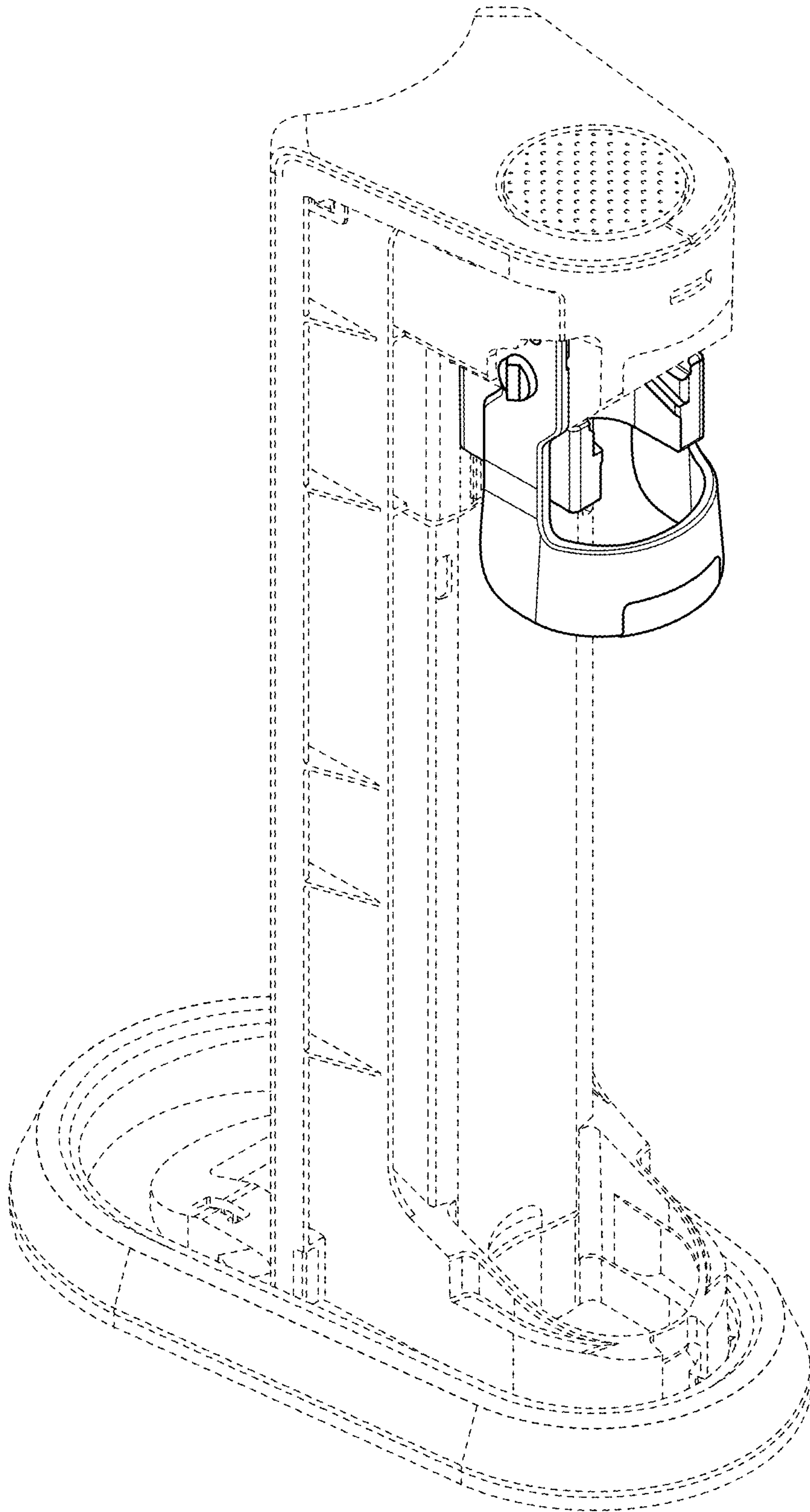

FIG. 1.8