



US00D958406S

(12) **United States Design Patent**
Pain

(10) **Patent No.:** **US D958,406 S**

(45) **Date of Patent:** **** *Jul. 19, 2022**

(54) **SWIMMING POOL WITH RAISED SPA**

(71) Applicant: **North Star Technology Limited,**
Birkirkara BKR (MT)

(72) Inventor: **Kerry R. Pain,** Yatala (AU)

(73) Assignee: **North Star Technology Limited,**
Birkirkara BKR (MT)

(*) Notice: This patent is subject to a terminal disclaimer.

(**) Term: **15 Years**

(21) Appl. No.: **29/760,052**

(22) Filed: **Nov. 27, 2020**

(30) **Foreign Application Priority Data**

May 27, 2020 (AU) 202013010

(51) **LOC (13) Cl.** **25-03**

(52) **U.S. Cl.**
USPC **D25/2**

(58) **Field of Classification Search**
USPC D25/2; D21/815; D24/201, 204, 205;
4/506; D23/277, 280.1
CPC E04H 4/00; E04H 4/0018-0093; A61H
33/0087
See application file for complete search history.

(56) **References Cited**

U.S. PATENT DOCUMENTS

D241,643 S *	9/1976	Bonsack	D23/280.1
D251,201 S *	2/1979	Mathis	D24/204
D266,697 S *	10/1982	Topete	D23/277
D266,789 S *	11/1982	Topete	D23/277
D266,947 S *	11/1982	Topete	D23/277
D385,084 S *	10/1997	Menichiello	D25/2
D408,547 S *	4/1999	Sullivan	D25/2
D408,927 S *	4/1999	Sullivan	D25/2

D417,286 S *	11/1999	Sullivan	D25/2
D430,305 S *	8/2000	Sullivan	D25/2
D446,313 S *	8/2001	Sullivan	D25/2
D490,904 S *	6/2004	Erdelac	D25/2
D509,902 S *	9/2005	Sullivan	D25/2
D510,630 S *	10/2005	Sullivan	D25/2
D561,350 S *	2/2008	Hebert	D25/2
D573,717 S *	7/2008	Sullivan	D25/2
D574,967 S *	8/2008	Sullivan	D25/2
D676,148 S *	2/2013	Sullivan	D25/2
D682,443 S *	5/2013	Gill	D25/2

(Continued)

OTHER PUBLICATIONS

IMP Digital, San Juan Fiberglass Pool Brochure, Apr. 25, 2018, FLIPHTML5, <https://fliphtml5.com/iiho/ehxl/basic> (Year: 2018).*

(Continued)

Primary Examiner — Brett Miller

(74) *Attorney, Agent, or Firm* — Martin & Ferraro, LLP

(57) **CLAIM**

The ornamental design for a swimming pool with raised spa, as shown and described.

DESCRIPTION

FIG. 1 is a front, top and left perspective view of the swimming pool with raised spa showing my new design; FIG. 2 is a front, top and right perspective view thereof; FIG. 3 is a rear, top and right perspective view thereof; FIG. 4 is a rear, top and left perspective view thereof; FIG. 5 is a top plan view thereof; FIG. 6 is a rear elevation view thereof; FIG. 7 is a front elevation view thereof; FIG. 8 is a right side elevation view thereof; FIG. 9 is a left side elevation view thereof; FIG. 10 is a cross sectional view along lines A-A of FIG. 5; and, FIG. 11 is a cross sectional view along lines B-B of FIG. 5.

1 Claim, 8 Drawing Sheets

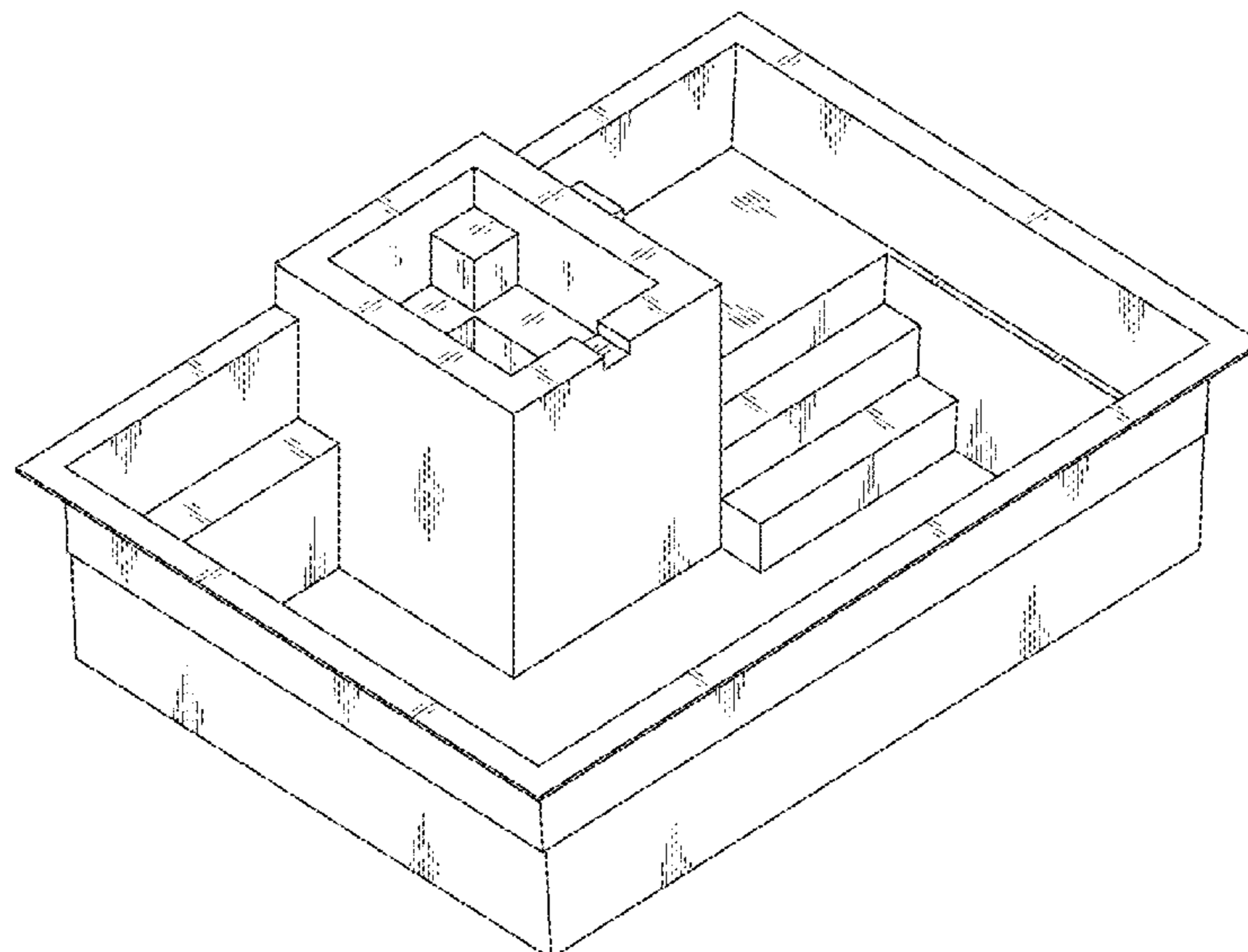

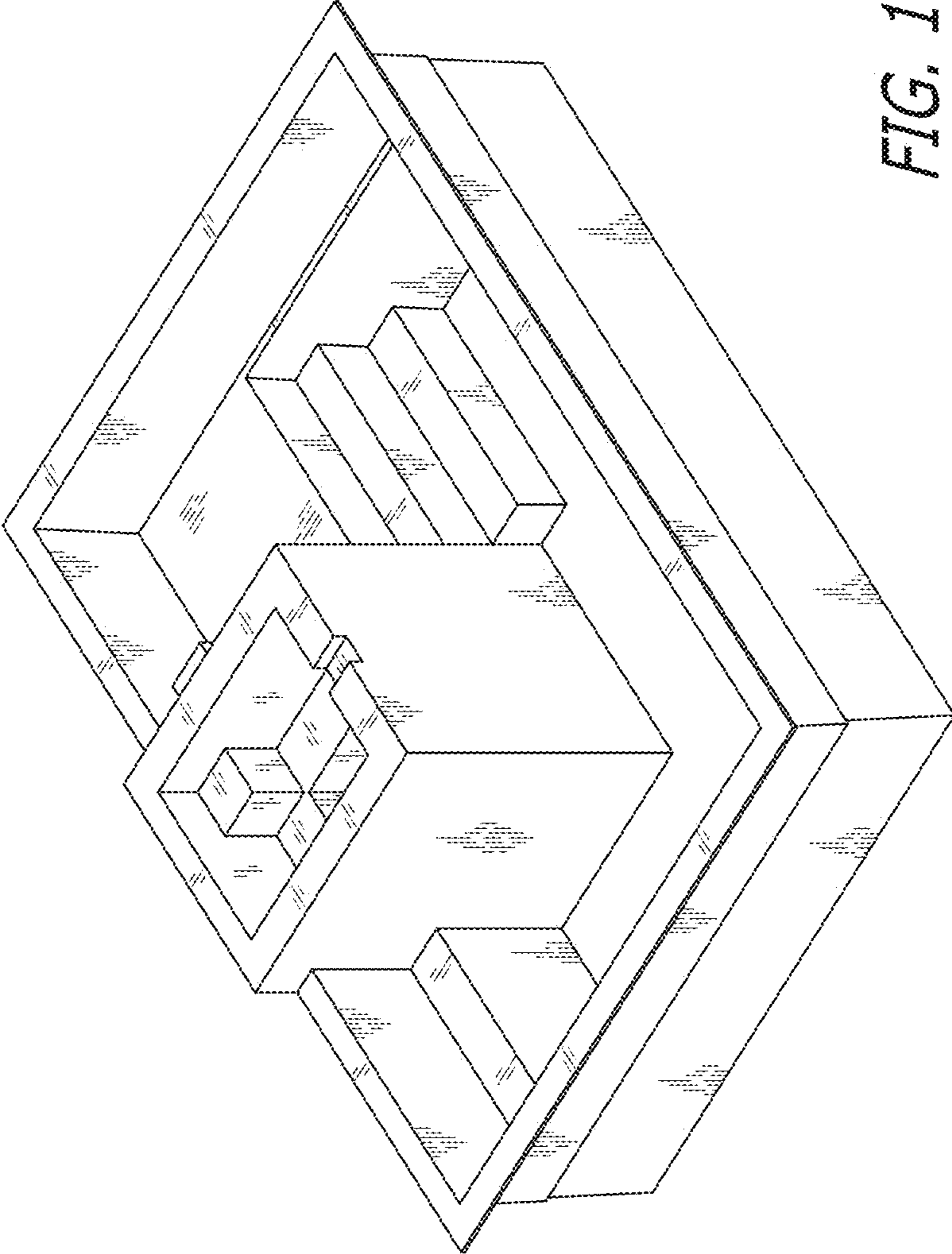

FIG. 1

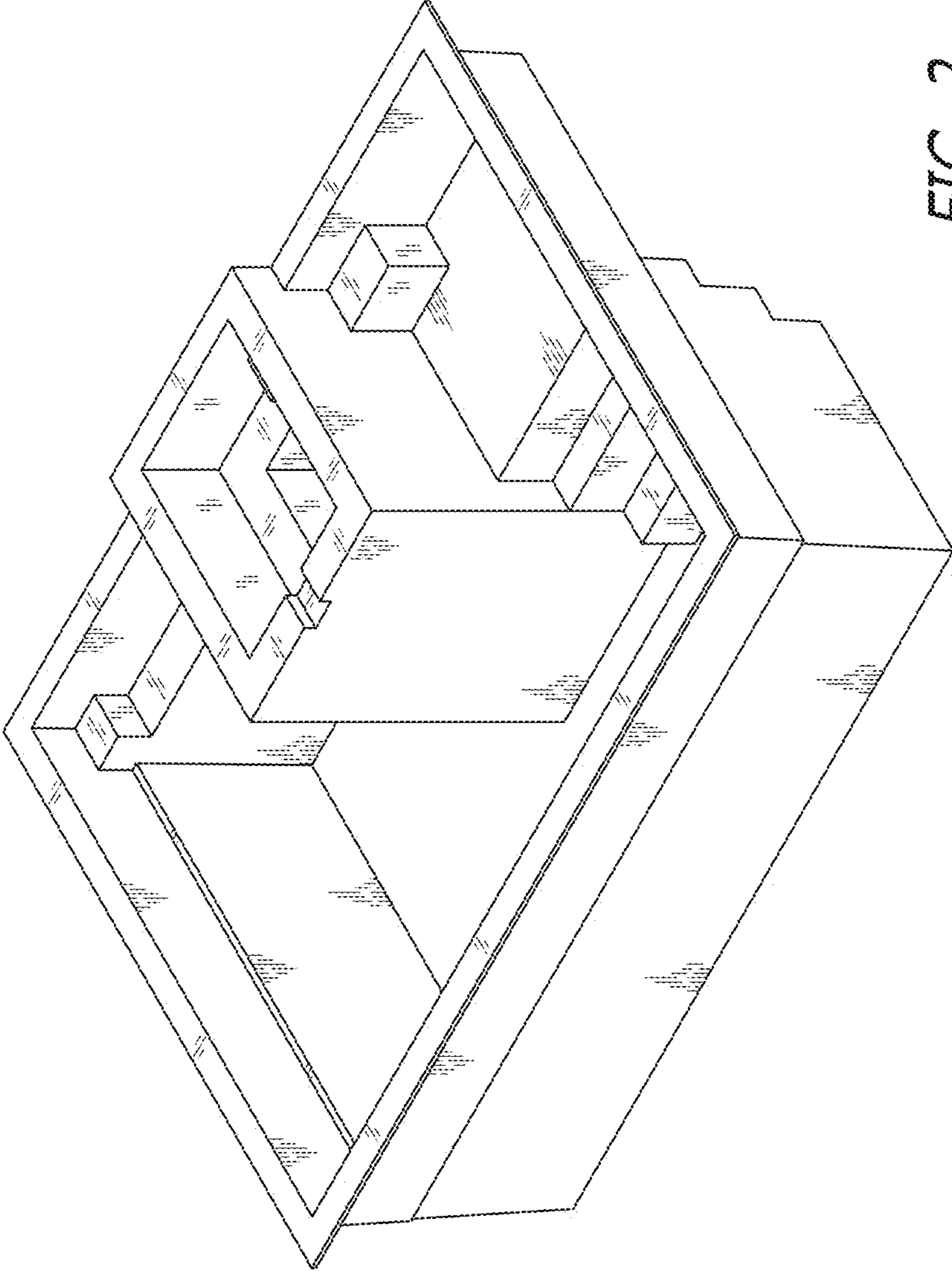

FIG. 2

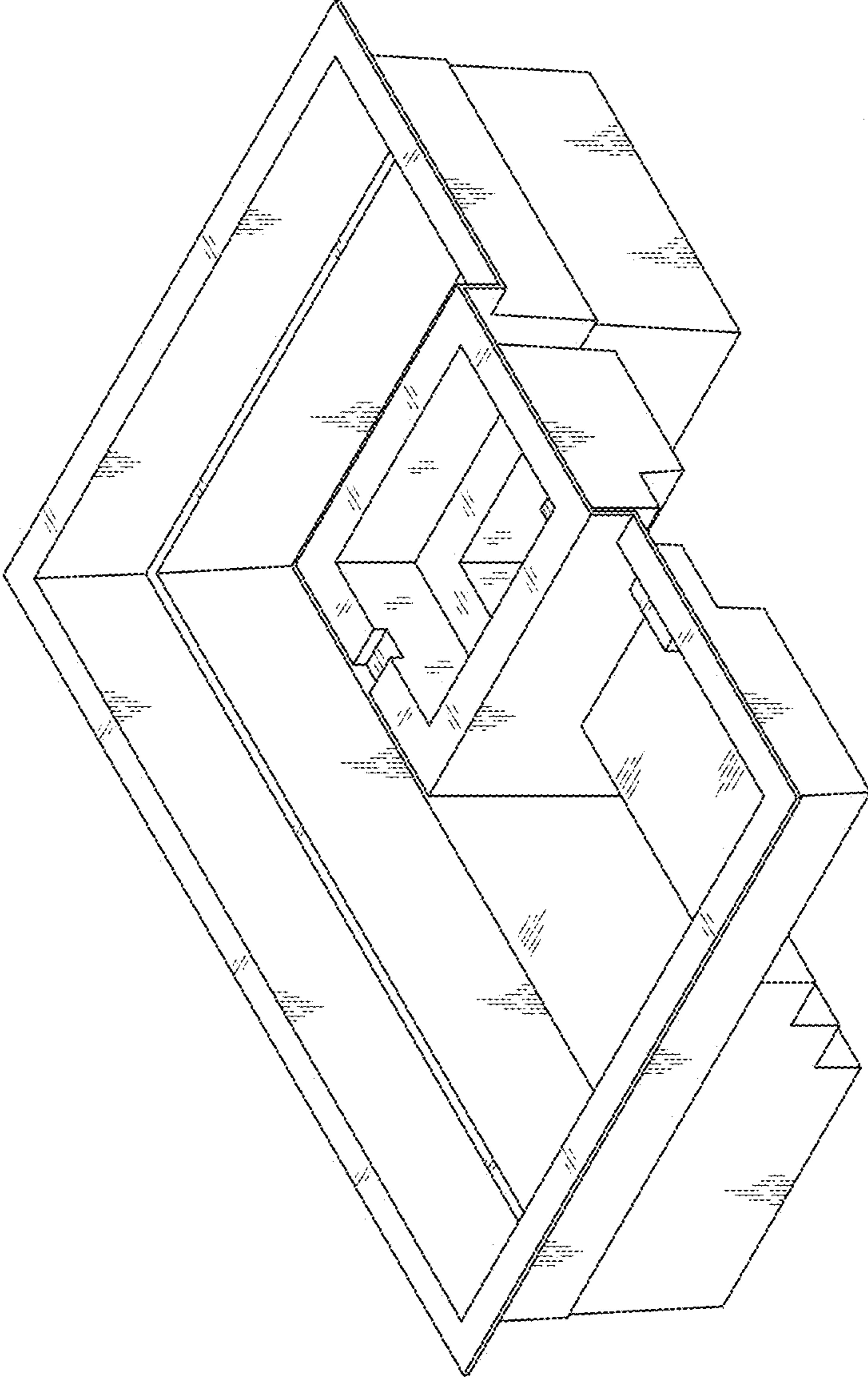

FIG. 3

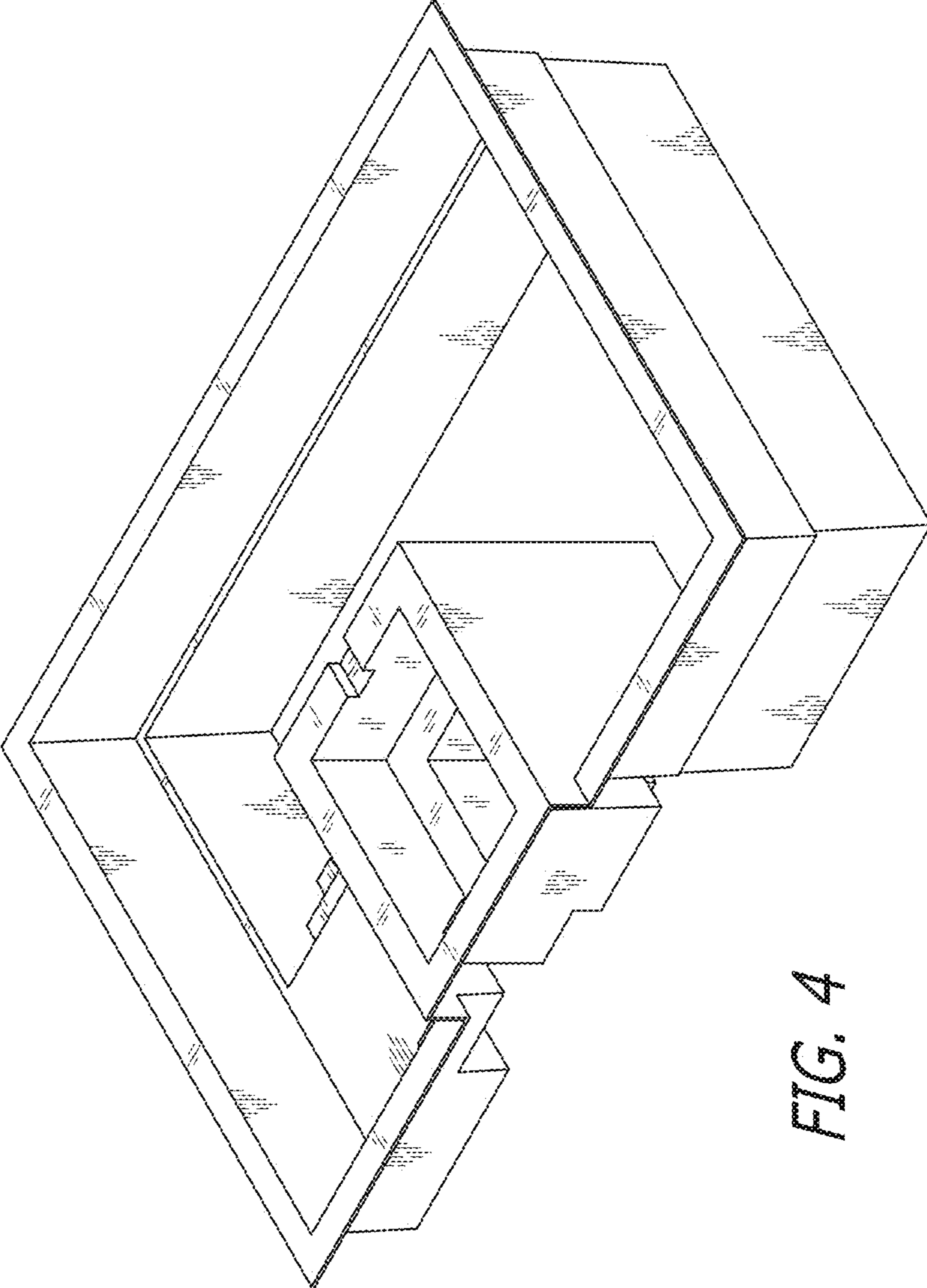

FIG. 4

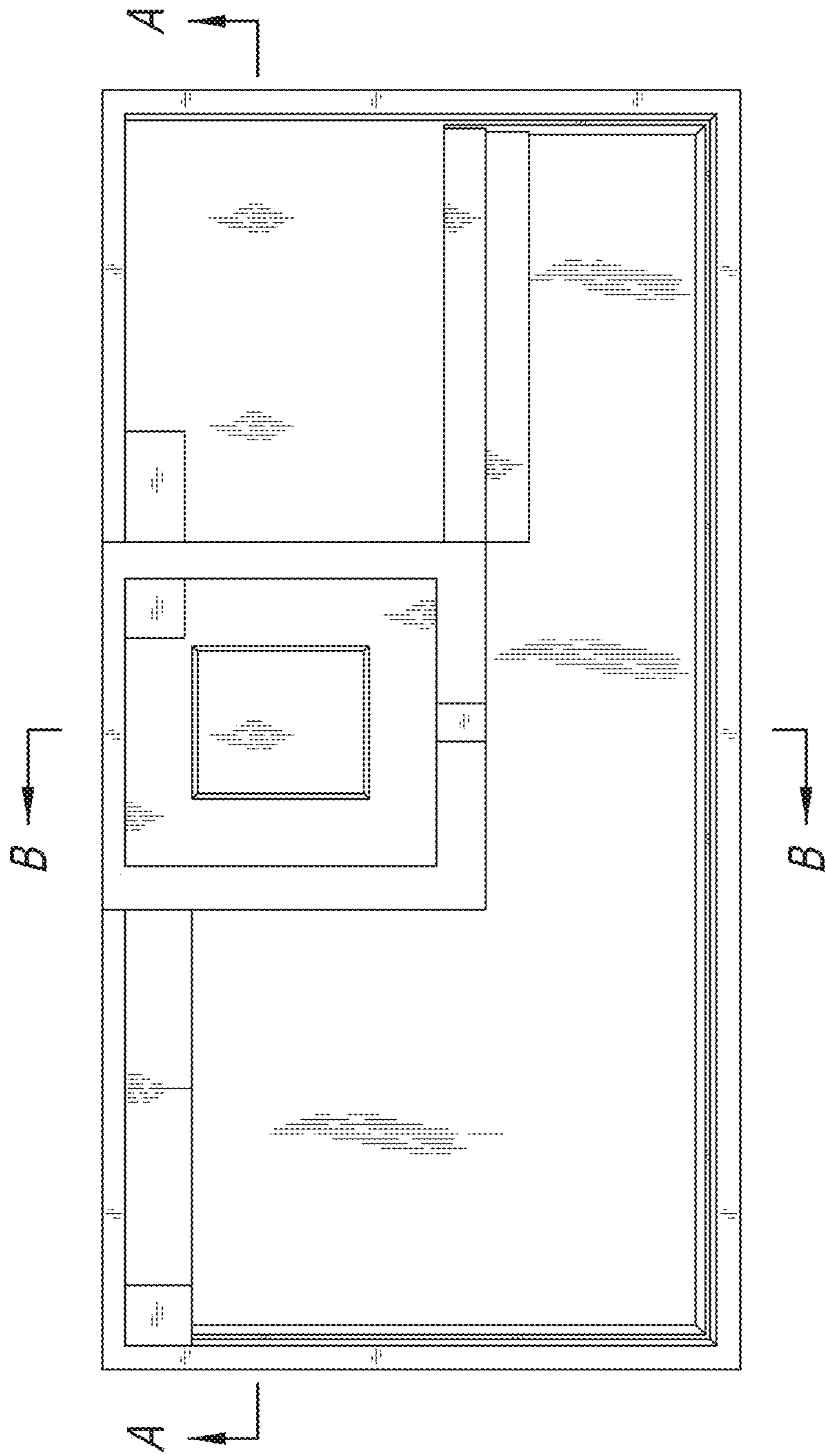

FIG. 5

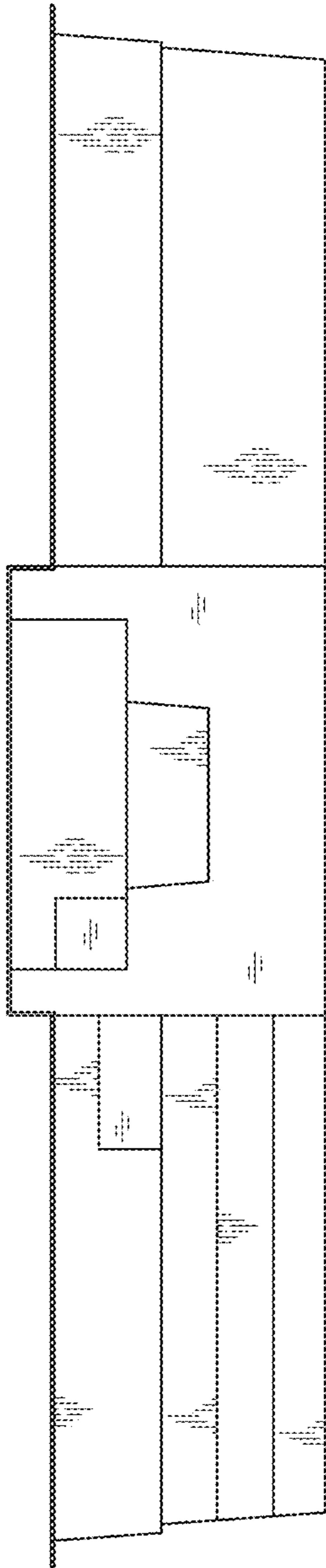

FIG. 6

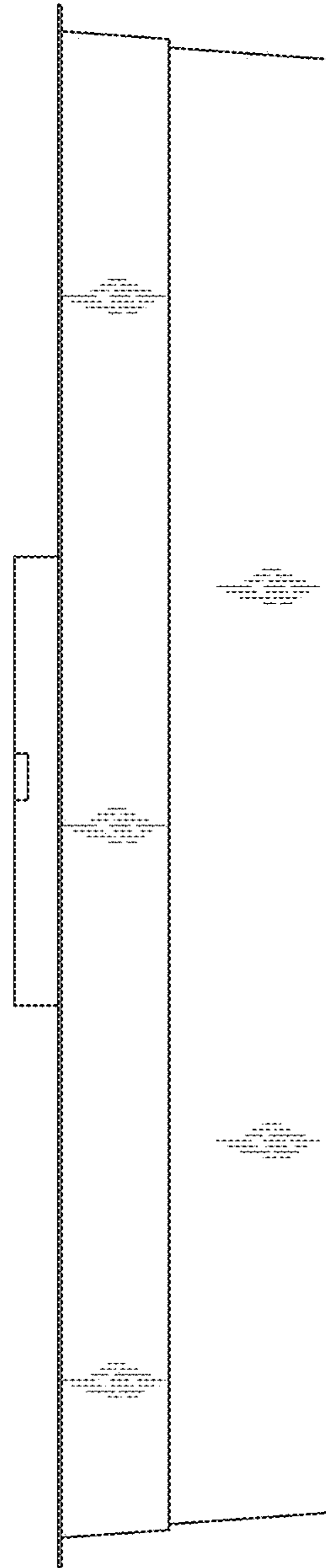

FIG. 7

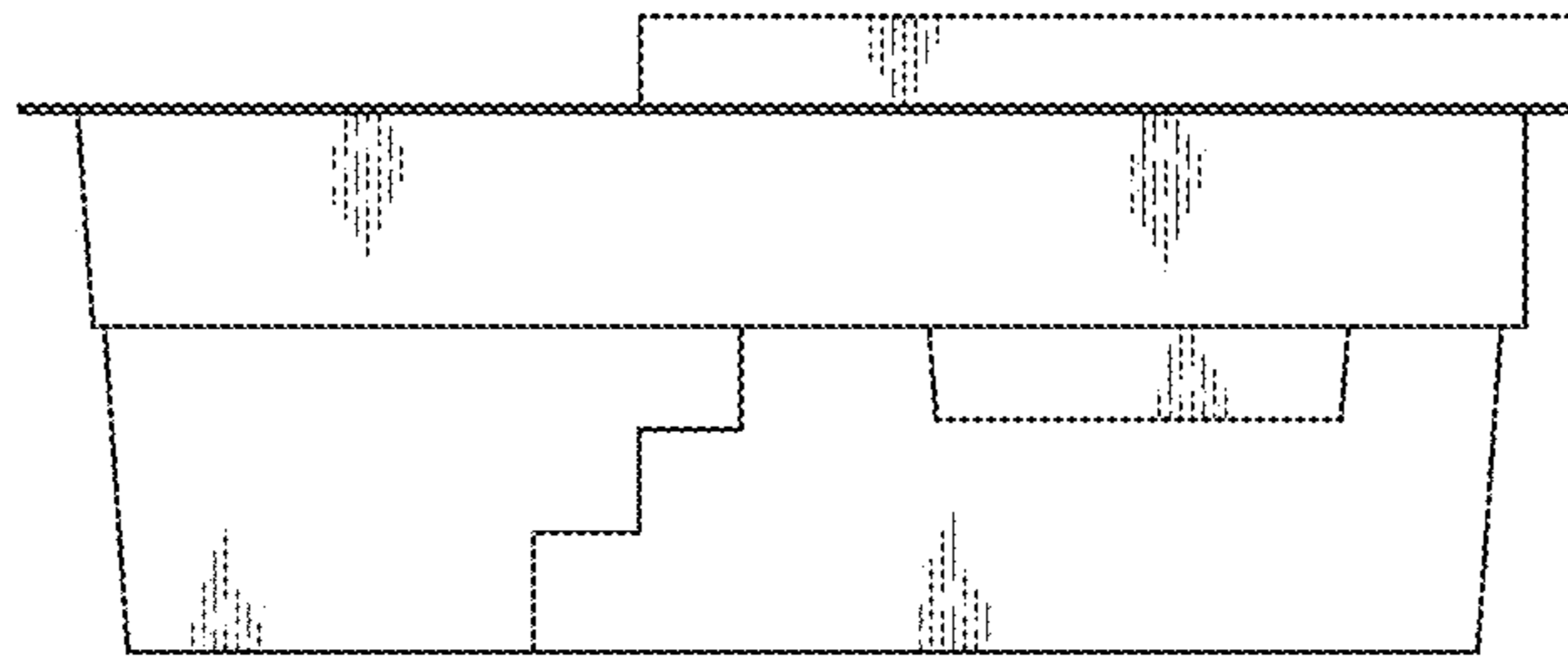

FIG. 8

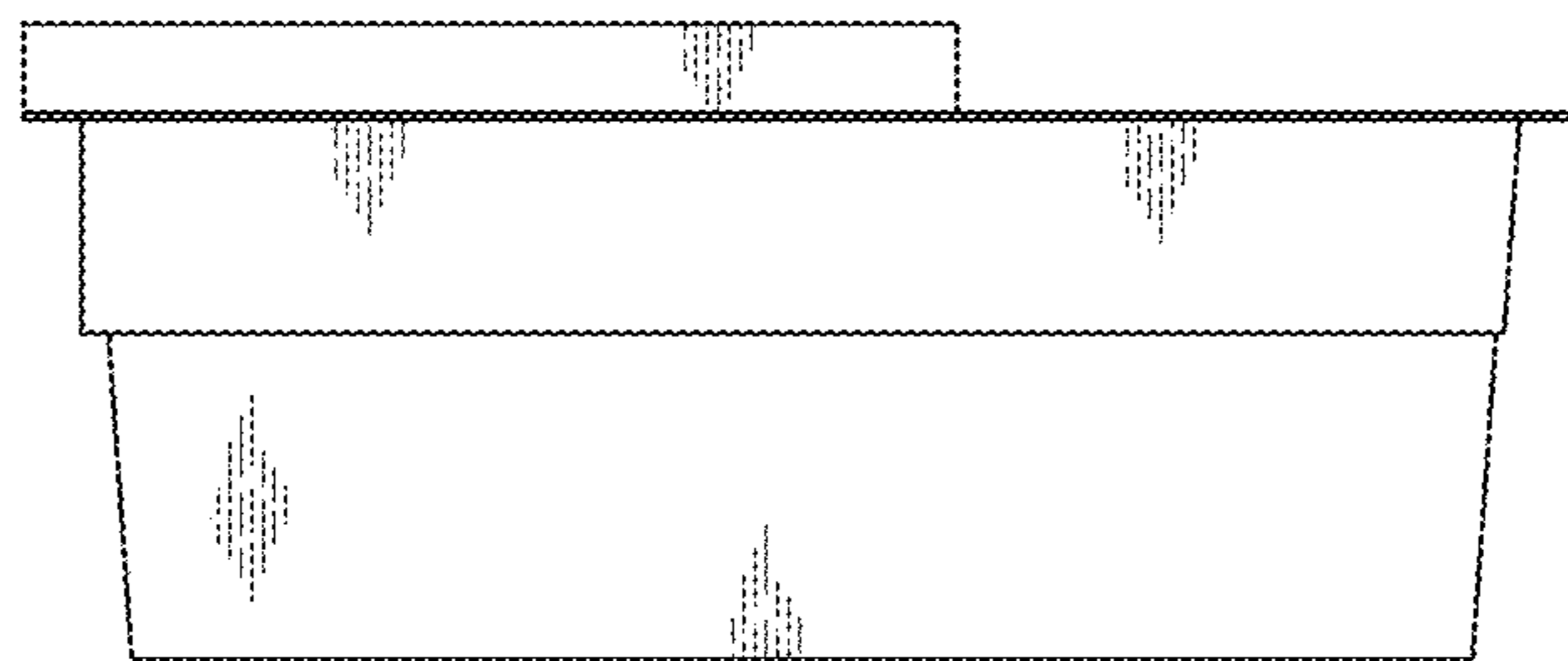
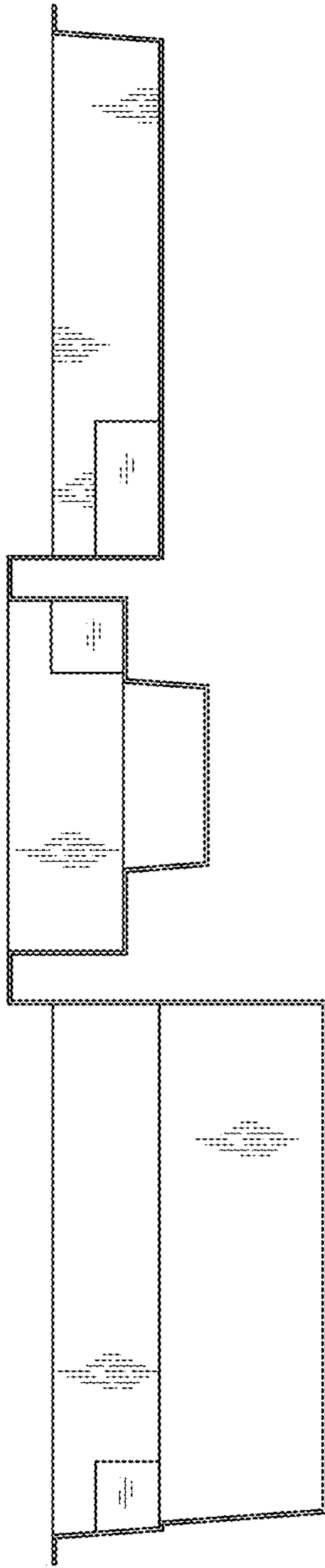
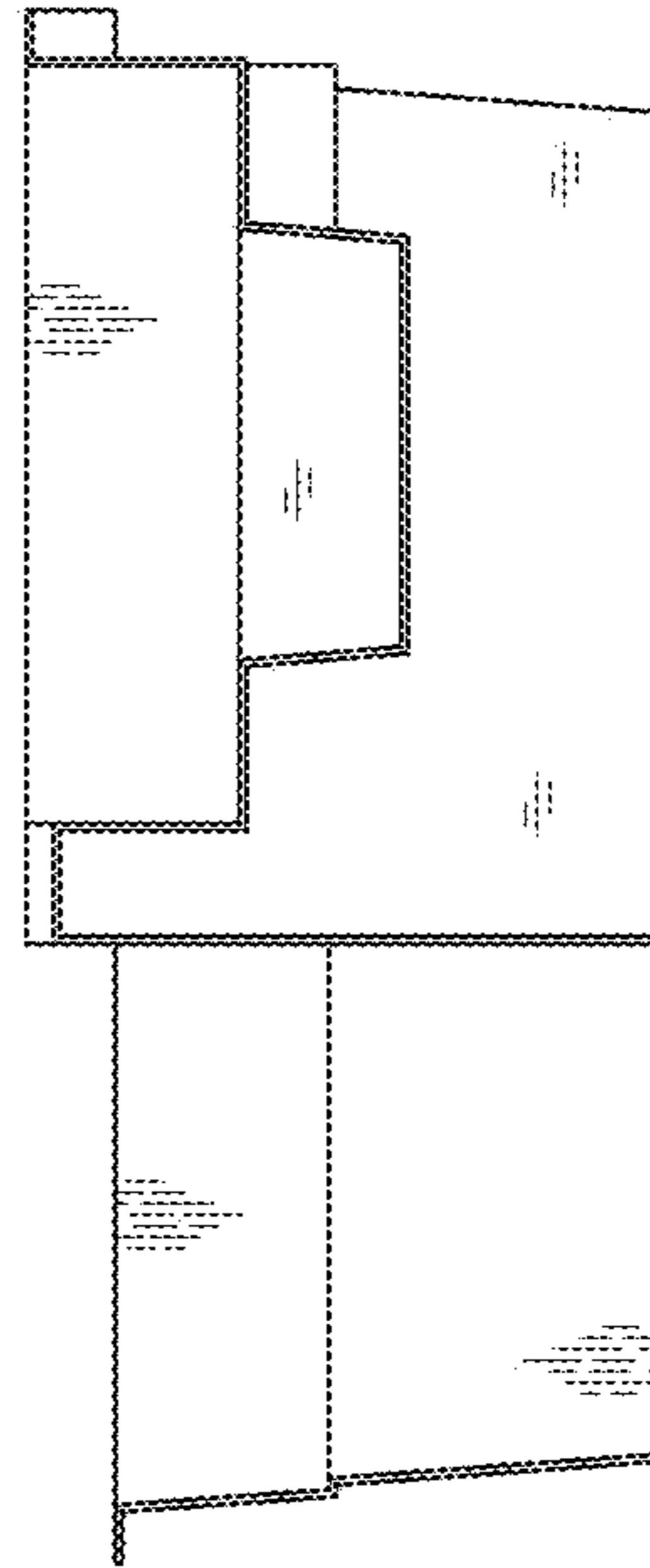

FIG. 9



SECTION A-A
FIG. 10



SECTION B-B
FIG. 11