



US00D957536S

(12) **United States Design Patent**
Zhang

(10) **Patent No.:** **US D957,536 S**
(45) **Date of Patent:** **** Jul. 12, 2022**

(54) **EDUCATIONAL TOY**

(71) Applicant: **Jianhong Zhang**, Shantou (CN)

(72) Inventor: **Jianhong Zhang**, Shantou (CN)

(**) Term: **15 Years**

(21) Appl. No.: **29/770,934**

(22) Filed: **Feb. 18, 2021**

(51) **LOC (13) Cl.** **21-01**

(52) **U.S. Cl.**
USPC **D21/475; D21/410**

(58) **Field of Classification Search**
USPC D21/325, 326, 327, 336, 341, 3, 42, 398,
D21/419, 470, 410, 405, 408, 409, 468,
D21/475, 337, 500, 589
CPC .. G07F 17/3279; G07F 17/34; G07F 17/3262;
G07F 17/3209; G07F 17/32; A63F 9/24;
A63F 9/0243; A63F 9/30; A63F
2011/0032; A63F 2250/14; A63F
2009/2447; A63F 3/00643; A63F
2009/0668; A63F 9/0666; A63F 9/00;
A63F 9/06; A63F 9/001; A63F 9/1204;
A63H 33/30; A63H 33/00; A63H 5/00;
A63B 69/0053; G09B 1/36; G09B 1/28
See application file for complete search history.

(56) **References Cited**

U.S. PATENT DOCUMENTS

1,291,202	A *	1/1919	Siegel	G10D 13/08 84/423 R
D224,936	S *	10/1972	Green	D21/410
D277,877	S *	3/1985	Chatani	D21/410
4,524,967	A *	6/1985	Hanson	A63F 9/30 273/273
D281,180	S *	10/1985	Ng	D21/468
D302,187	S *	7/1989	Kato	D21/541
5,095,468	A *	3/1992	Sato	G04C 21/02 368/72

D336,937	S *	6/1993	Sato	D21/531
D384,691	S *	10/1997	Heuser	84/404
5,674,103	A *	10/1997	Bean	A63F 9/0666 220/4.03
D419,615	S *	1/2000	Thomas	D21/470
6,132,281	A *	10/2000	Klitsner	A63H 33/042 446/408
D866,673	S *	11/2019	Jin	D21/592
D875,184	S *	2/2020	Zeng	D21/475
D907,718	S *	1/2021	Reese	A63H 5/00 D21/410
D918,309	S *	5/2021	Xu	D21/475

(Continued)

OTHER PUBLICATIONS

Rabing Wooden Pounding Bench. Date First Available: Nov. 8, 2021. Retrieved from internet: <<https://www.amazon.ca/dp/B091KTBY95>> [site visited May 3, 2022] (Year: 2021).*

(Continued)

Primary Examiner — Katherine Glennon
Assistant Examiner — Yuan Yuan

(57) **CLAIM**

The ornamental design for an educational toy, as shown and described.

DESCRIPTION

FIG. 1 is a perspective view of an educational toy showing my new design;
FIG. 2 is another perspective view thereof;
FIG. 3 is a front elevational view thereof;
FIG. 4 is a rear elevational view thereof;
FIG. 5 is a left side elevational view thereof;
FIG. 6 is a right side elevational view thereof;
FIG. 7 is a top plan view thereof; and,
FIG. 8 is a bottom plan view thereof.
The broken lines in the drawings depict portions of the educational toy that form no part of the claimed design.

1 Claim, 8 Drawing Sheets

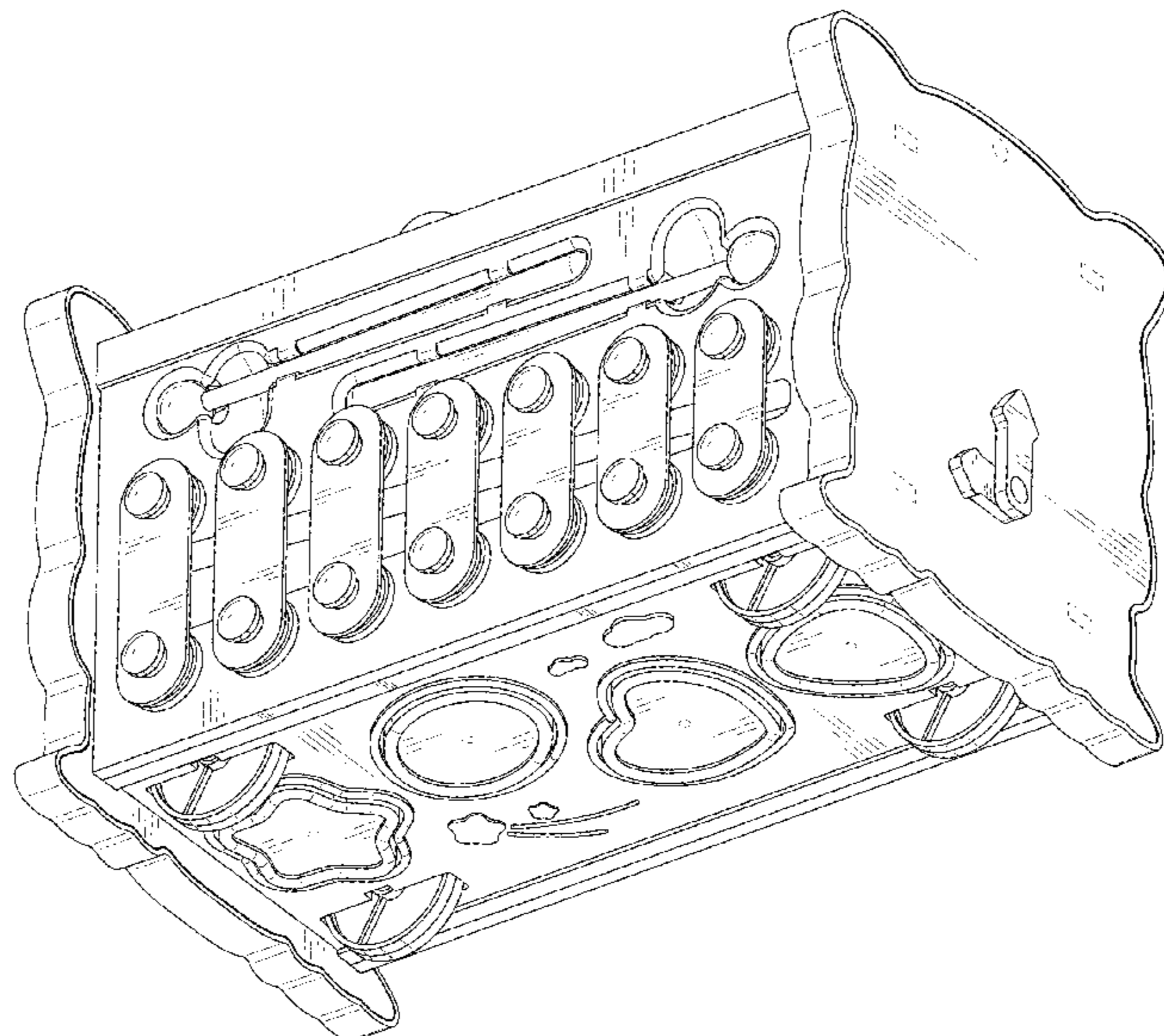

(56)

References Cited

U.S. PATENT DOCUMENTS

D931,379 S * 9/2021 Xu D21/475
D938,526 S * 12/2021 Zhang D21/475
2004/0251631 A1* 12/2004 Chou A63B 69/0053
273/378
2004/0259466 A1* 12/2004 Maxwell A63H 33/042
446/487
2006/0093995 A1* 5/2006 Brown G09B 1/36
434/171

OTHER PUBLICATIONS

Teklemon Hammering Pounding Wooden Toy. Date First Available:
Jan. 11, 2022 Retrieved from internet: <<https://www.amazon.ca/dp/B09Q5GN4GW/?th=1>> [site visited May 3, 2022] (Year: 2022).*

* cited by examiner

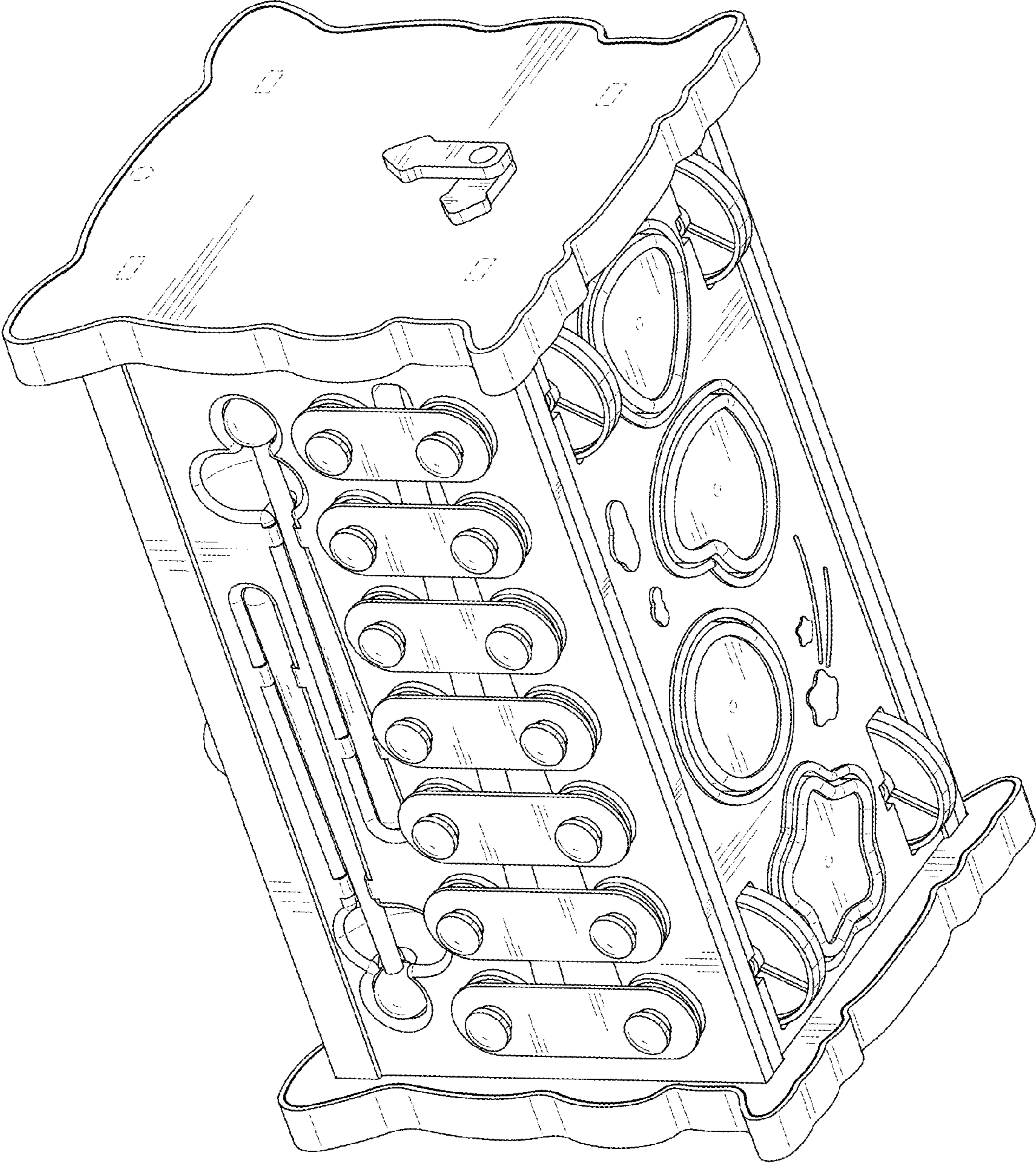

FIG. 1

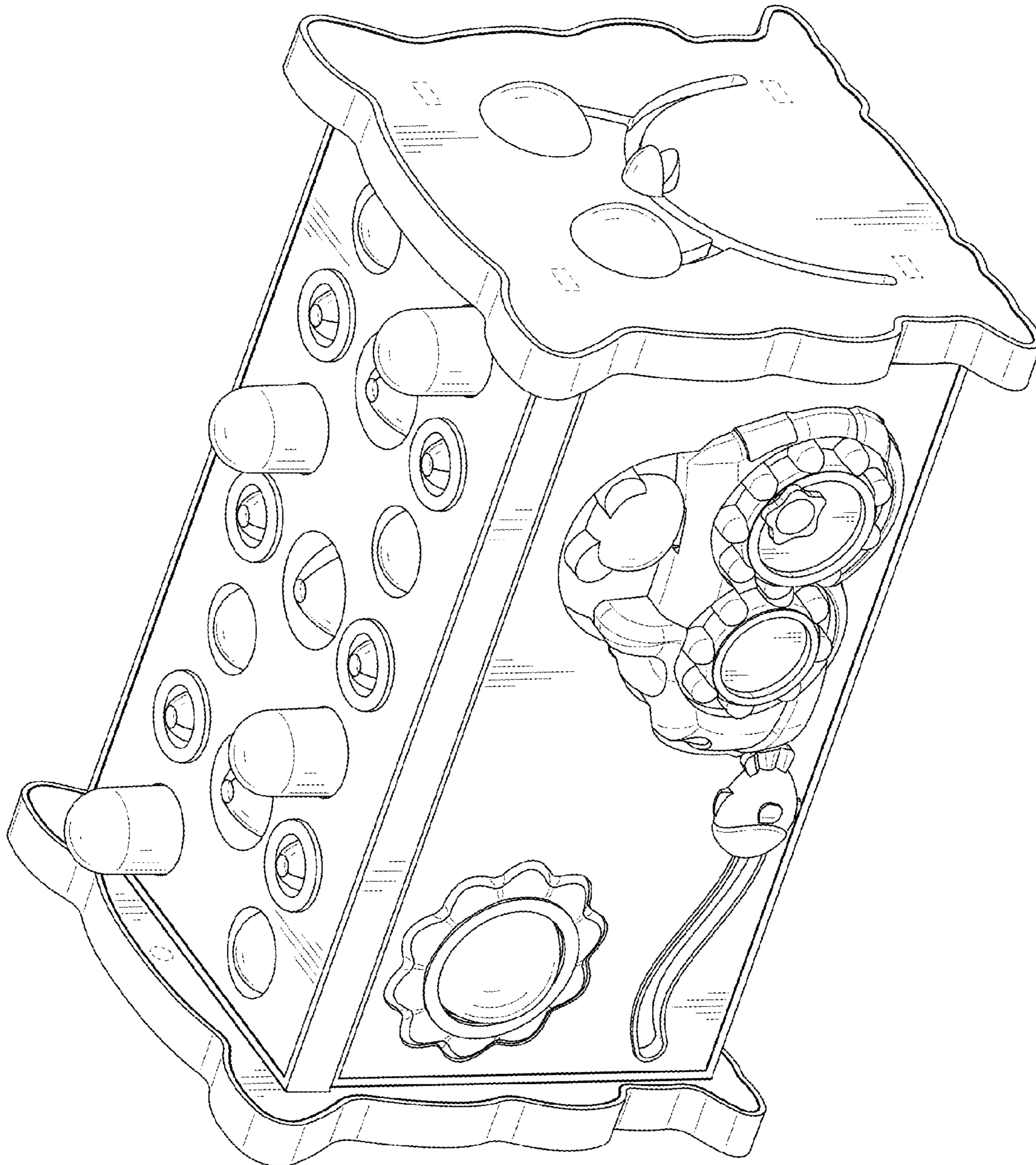

FIG. 2

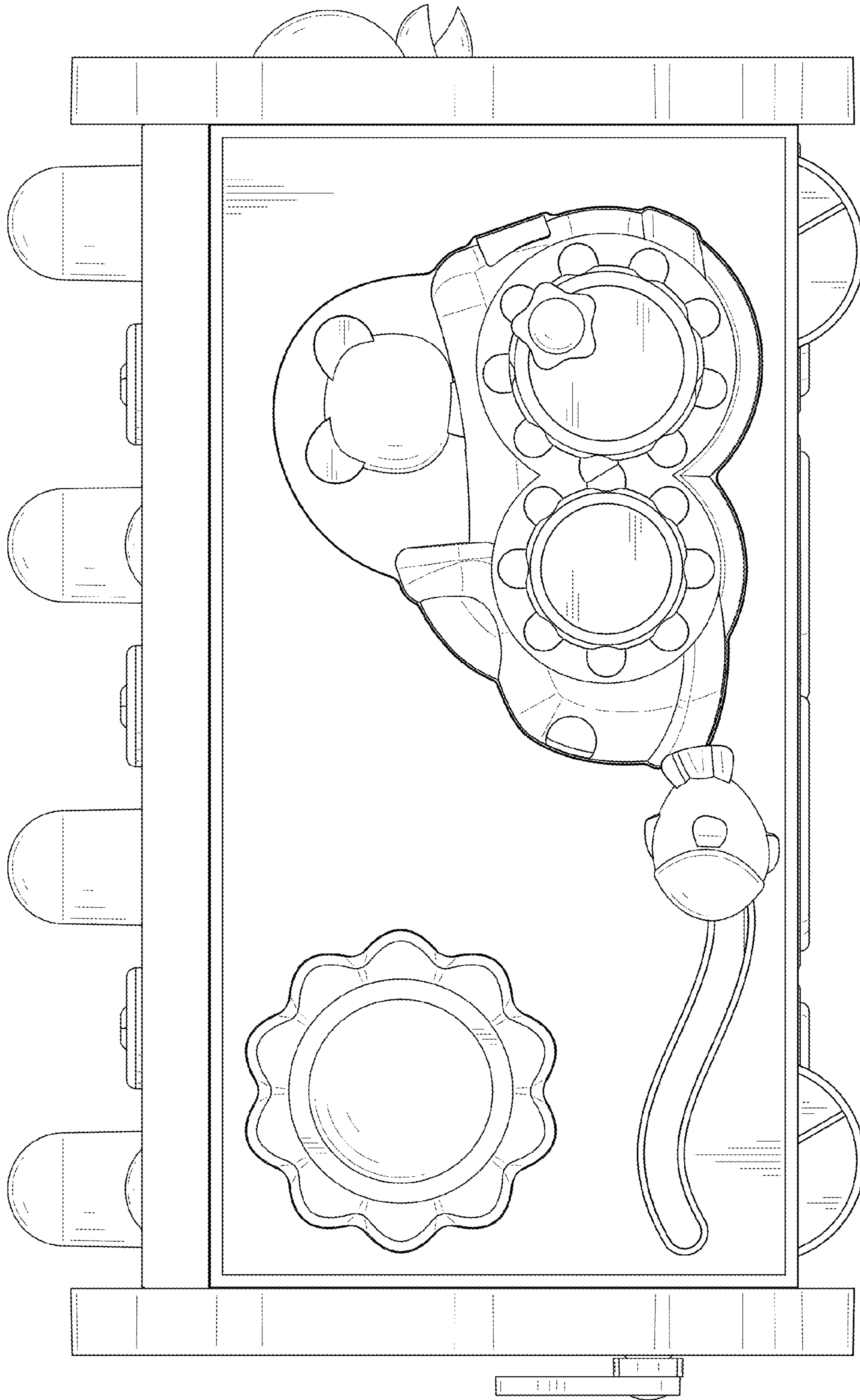

FIG. 3

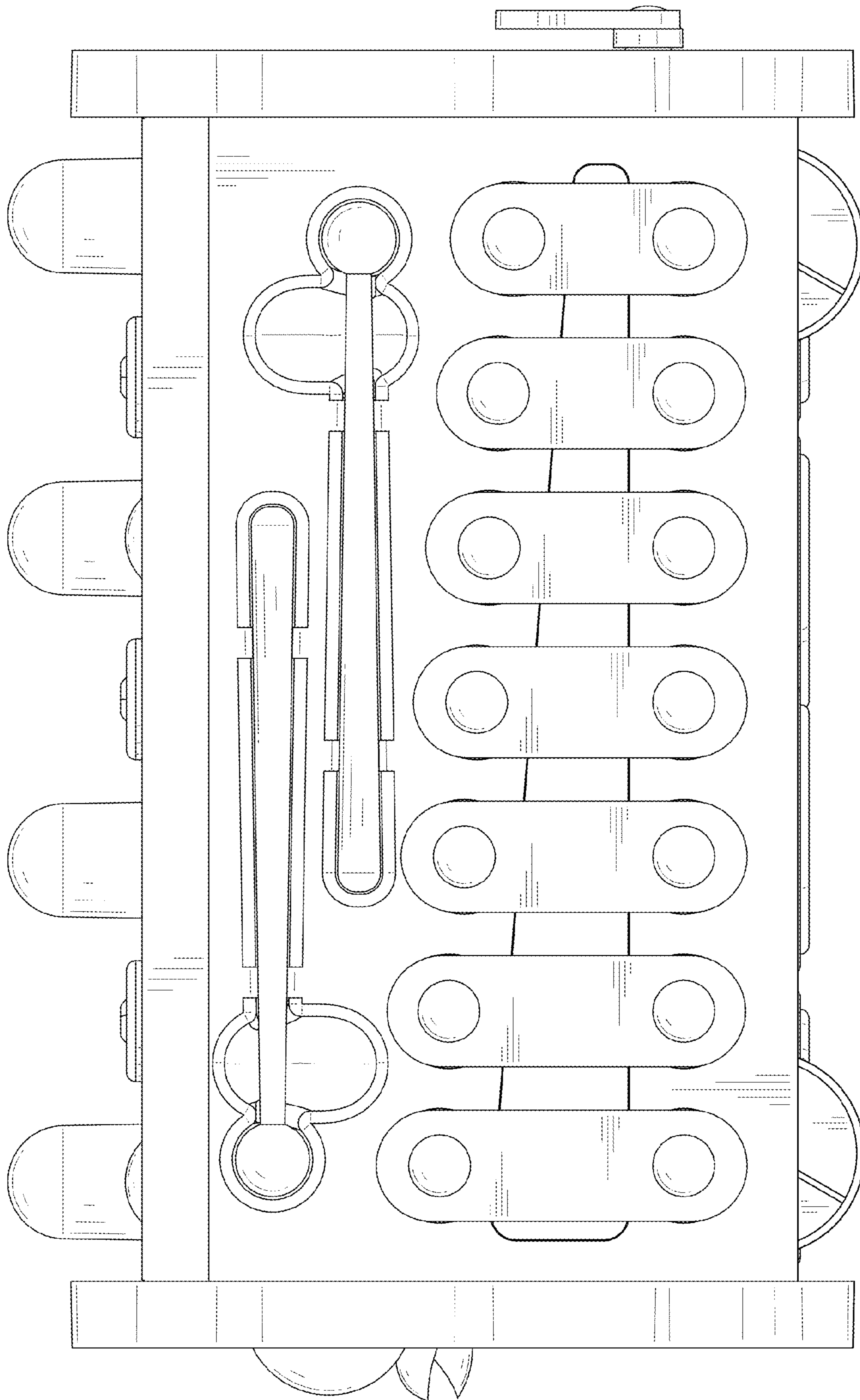

FIG. 4

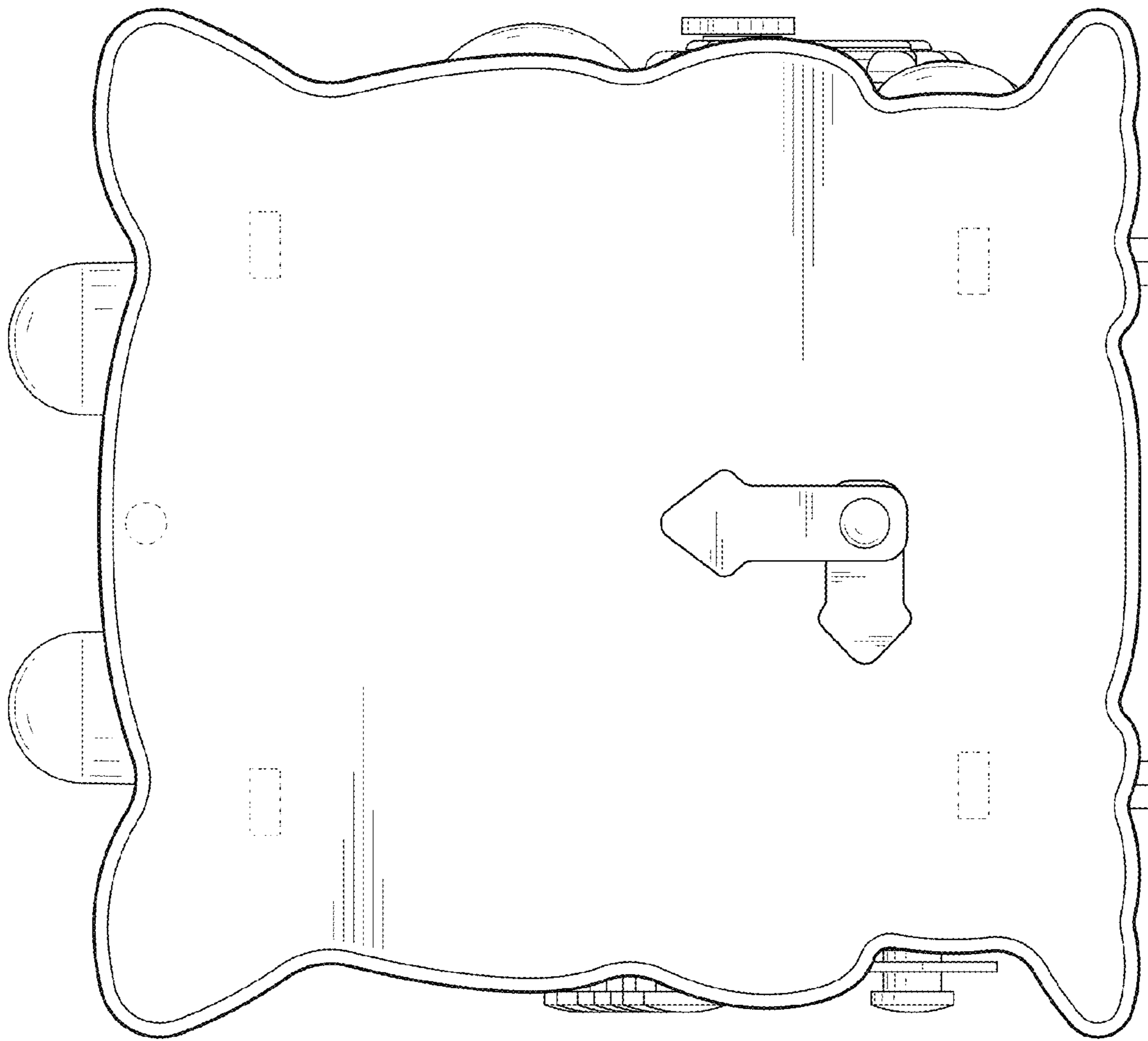

FIG. 5

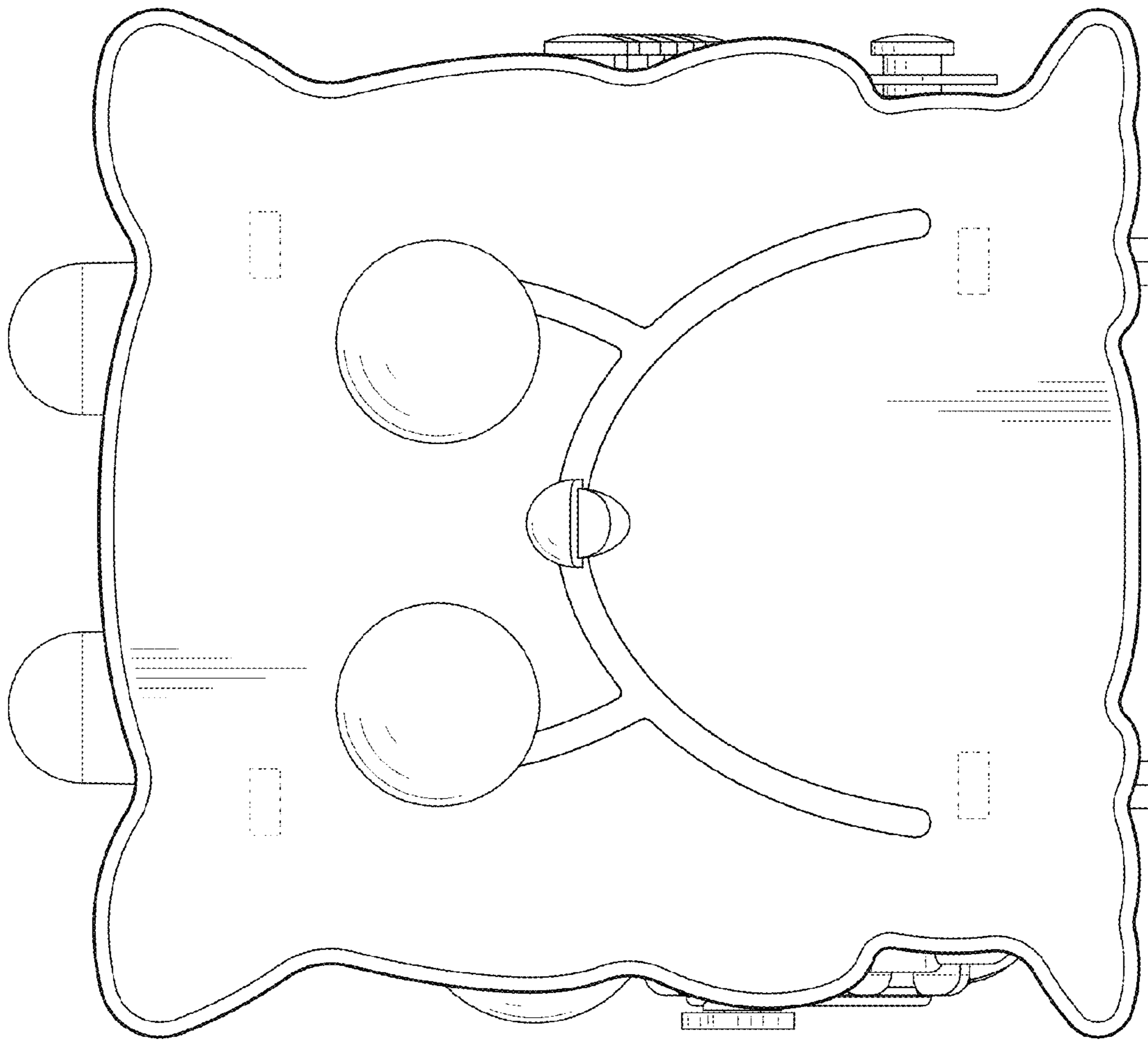

FIG. 6

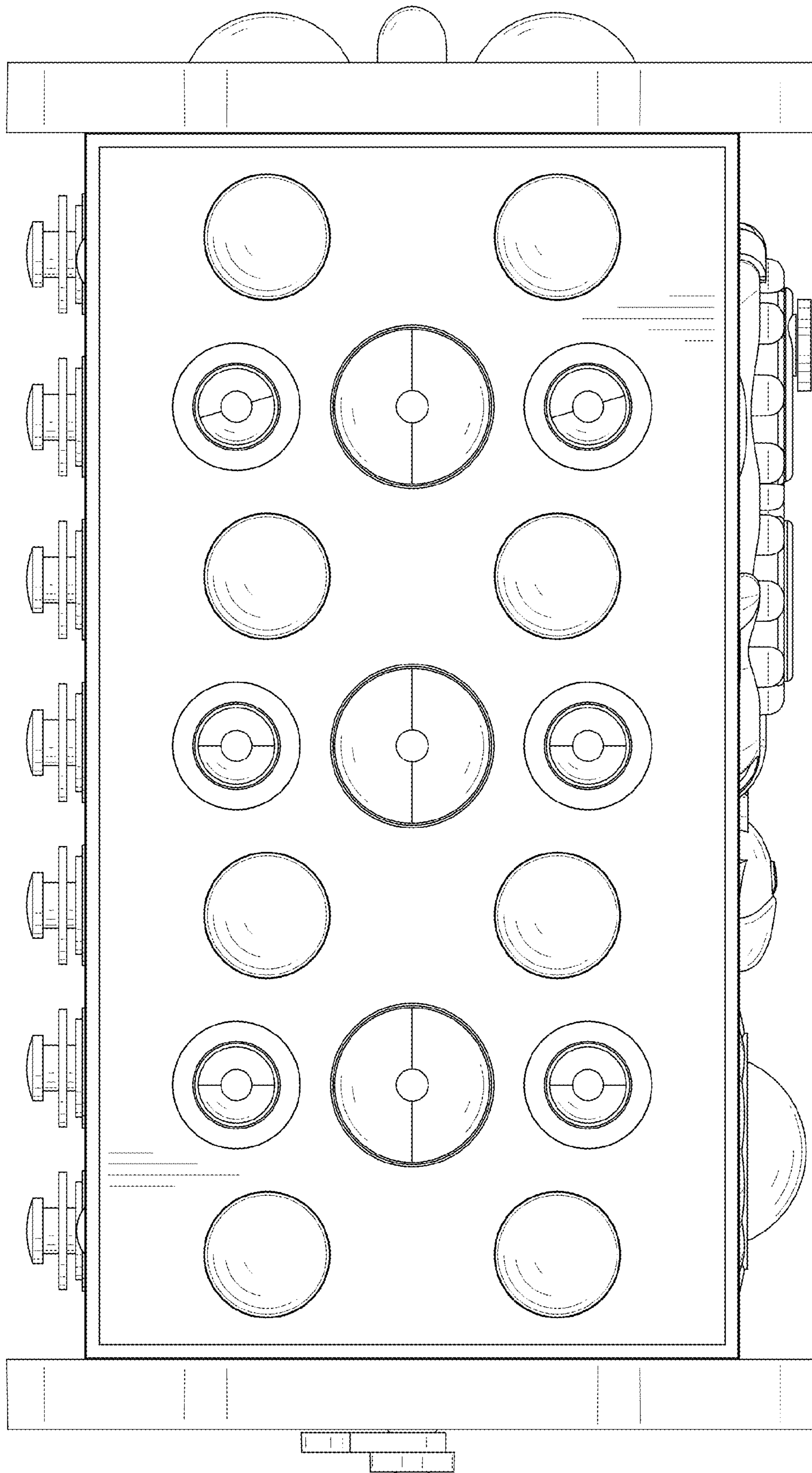

FIG. 7

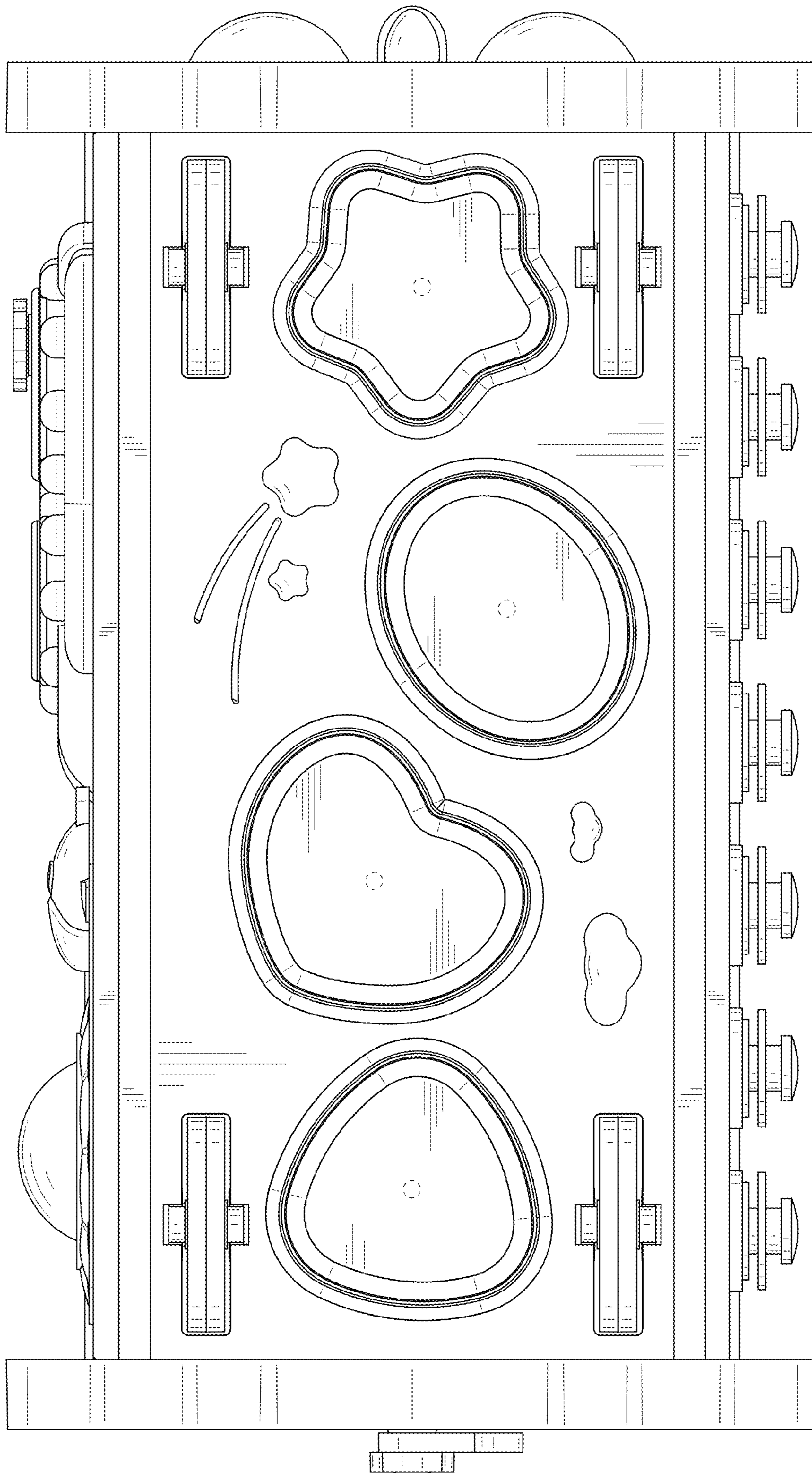

FIG. 8