



US00D957014S

(12) **United States Design Patent** (10) **Patent No.:** **US D957,014 S**  
**Jeong et al.** (45) **Date of Patent:** **\*\* Jul. 5, 2022**

(54) **REAR COMBINATION LAMP FOR VEHICLES**

(71) Applicants: **HYUNDAI MOTOR COMPANY**, Seoul (KR); **KIA MOTORS CORPORATION**, Seoul (KR)  
(72) Inventors: **Da-Young Jeong**, Seongnam-si (KR); **Joon-Bo Shim**, Seoul (KR); **Chan-Hee Lee**, Hwaseong-si (KR)  
(73) Assignees: **Hyundai Motor Company**, Seoul (KR); **Kia Motors Corporation**, Seoul (KR)

(\*\*) Term: **15 Years**

(21) Appl. No.: **35/510,919**

(22) Filed: **Nov. 19, 2020**

(80) **Hague Agreement Data**

Int. Filing Date: **Nov. 19, 2020**  
Int. Reg. No.: **DM/211493**  
Int. Reg. Date: **Nov. 19, 2020**  
Int. Reg. Pub. Date: **Dec. 11, 2020**

(30) **Foreign Application Priority Data**

Jul. 1, 2020 (KR) ..... 30-2020-0030003

(51) **LOC (13) Cl.** ..... **26-06**

(52) **U.S. Cl.**  
USPC ..... **D26/28**

(58) **Field of Classification Search**  
USPC ..... D26/28, 29, 34, 35, 36  
CPC ..... F21S 41/00; F21S 41/14; F21S 41/141; F21S 41/20; F21S 41/30; F21S 43/00; F21S 43/10; F21S 43/14; F21S 43/15; F21S 43/20; F21S 43/30; B60Q 1/26; B60Q 1/2619; B60Q 1/22; B60Q 1/28; B60Q 1/30; B60Q 1/34; B60Q 1/44; B60Q 1/46

See application file for complete search history.

(56) **References Cited**

U.S. PATENT DOCUMENTS

|               |         |                |                         |
|---------------|---------|----------------|-------------------------|
| 4,153,928 A * | 5/1979  | Speedy .....   | F21S 48/2218<br>362/300 |
| D528,235 S *  | 9/2006  | Kato .....     | D26/28                  |
| D535,769 S *  | 1/2007  | Kitazumi ..... | D26/28                  |
| D536,808 S *  | 2/2007  | Hsu .....      | D26/28                  |
| D537,964 S *  | 3/2007  | Ishiguro ..... | D26/28                  |
| D539,449 S *  | 3/2007  | Suzuki .....   | D26/28                  |
| D573,280 S *  | 7/2008  | Hiranaka ..... | D26/28                  |
| D656,637 S *  | 3/2012  | Choo .....     | D26/28                  |
| D692,599 S *  | 10/2013 | Kim .....      | D26/28                  |
| D700,982 S *  | 3/2014  | Kim .....      | D26/28                  |
| D701,983 S *  | 4/2014  | Kong .....     | D26/28                  |
| D705,465 S *  | 5/2014  | Sa .....       | D26/28                  |
| D709,632 S *  | 7/2014  | Sato .....     | D26/28                  |

(Continued)

*Primary Examiner* — Steven J Czyz

(74) *Attorney, Agent, or Firm* — Fox Rothschild LLP

(57) **CLAIM**

The ornamental design for a rear combination lamp for vehicles, as shown and described.

**DESCRIPTION**

1. Rear combination lamp for vehicles  
FIG. 1.1 is a perspective view of a rear combination lamp for vehicles according to the present invention.  
FIG. 1.2 is a front view of a rear combination lamp for vehicles of FIG. 1.1.  
FIG. 1.3 is a review view of a rear combination lamp for vehicles of FIG. 1.1. FIG. 1.4 is a left side view of a rear combination lamp for vehicles of FIG. 1.1.  
FIG. 1.5 is a right side view of a rear combination lamp for vehicles of FIG. 1.1.  
FIG. 1.6 is a top view of a rear combination lamp for vehicles of FIG. 1.1.  
FIG. 1.7 is a bottom view of a rear combination lamp for vehicles of FIG. 1.1.

**1 Claim, 7 Drawing Sheets**

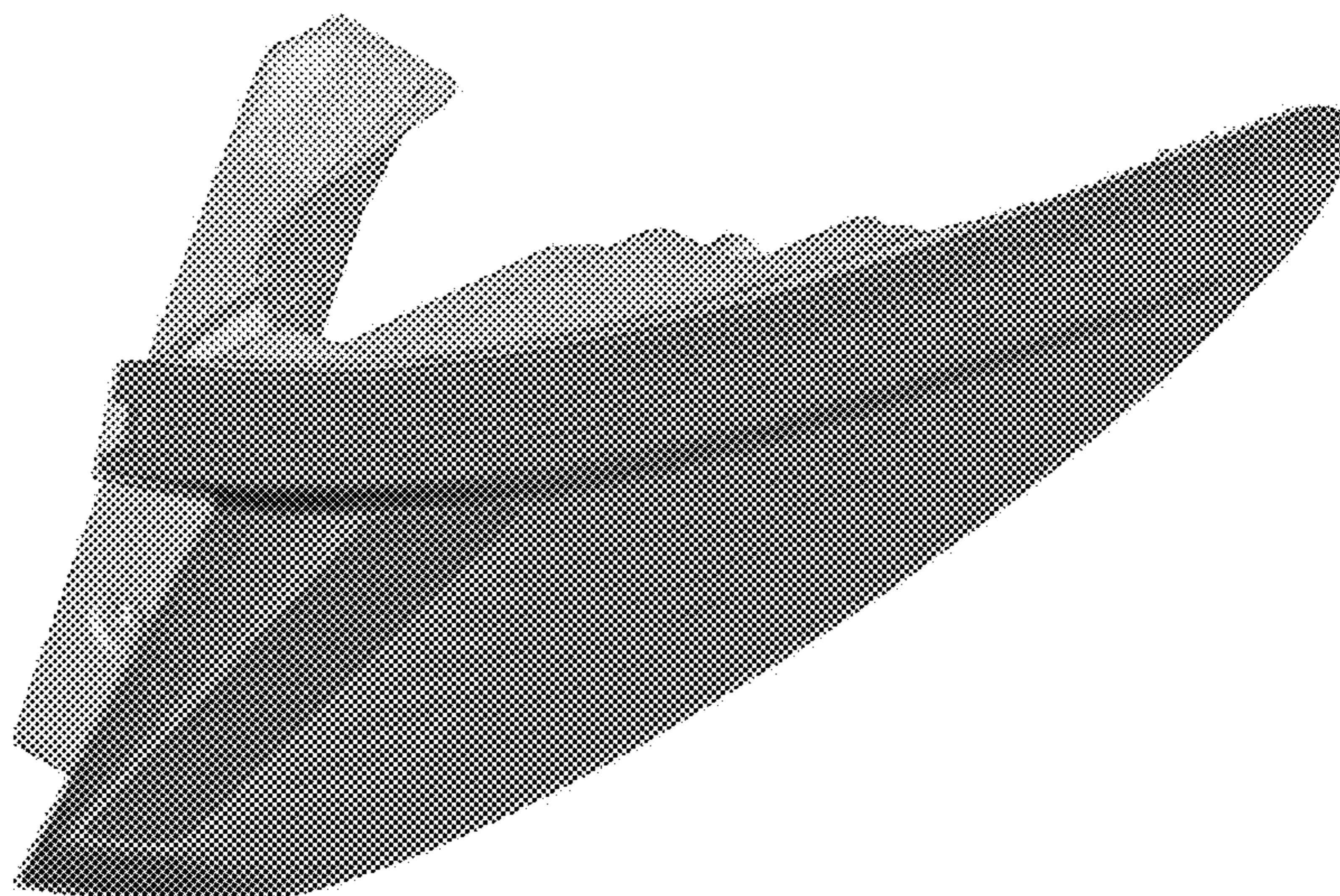



(56)

**References Cited**

## U.S. PATENT DOCUMENTS

|          |   |   |         |              |       |                      |
|----------|---|---|---------|--------------|-------|----------------------|
| D919,138 | S | * | 5/2021  | Loisch       | ..... | D26/28               |
| D919,841 | S | * | 5/2021  | Lin          | ..... | D26/28               |
| D919,858 | S | * | 5/2021  | Park         | ..... | D26/28               |
| D919,859 | S | * | 5/2021  | Park         | ..... | D26/28               |
| D919,864 | S | * | 5/2021  | Hong         | ..... | D26/28               |
| D921,238 | S | * | 6/2021  | Meyer        | ..... | D26/28               |
| D922,632 | S | * | 6/2021  | Lee          | ..... | D26/28               |
| D922,633 | S | * | 6/2021  | Jin          | ..... | D26/28               |
| D923,217 | S | * | 6/2021  | Lee          | ..... | F21S 43/00<br>D26/28 |
| D923,218 | S | * | 6/2021  | Lee          | ..... | D26/28               |
| D924,451 | S | * | 7/2021  | Nagasaka     | ..... | D26/28               |
| D933,266 | S | * | 10/2021 | Park         | ..... | D26/28               |
| D933,861 | S | * | 10/2021 | Lai          | ..... | D26/28               |
| D934,464 | S | * | 10/2021 | Allmendinger | ..... | D26/28               |
| D934,465 | S | * | 10/2021 | Allmendinger | ..... | D26/28               |
| D934,466 | S | * | 10/2021 | Allmendinger | ..... | D26/28               |
| D934,470 | S | * | 10/2021 | Chan         | ..... | D26/28               |
| D935,651 | S | * | 11/2021 | Hwang        | ..... | D26/28               |
| D935,652 | S | * | 11/2021 | Hwang        | ..... | D26/28               |
| D936,255 | S | * | 11/2021 | Ito          | ..... | D26/28               |
| D937,451 | S | * | 11/2021 | Tovey        | ..... | D26/28               |
| D937,455 | S | * | 11/2021 | Wu           | ..... | D26/28               |

\* cited by examiner

1.1

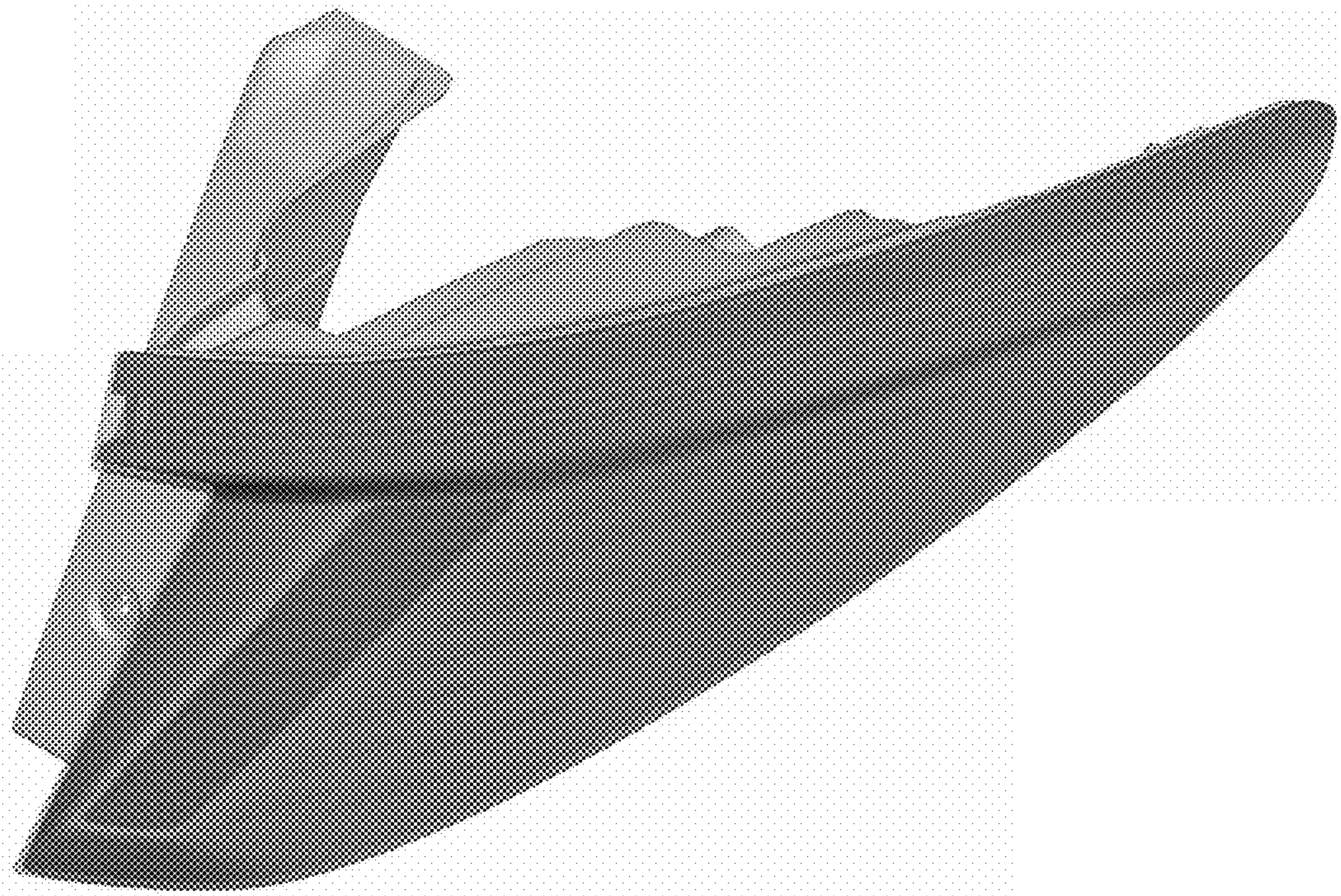

1.2

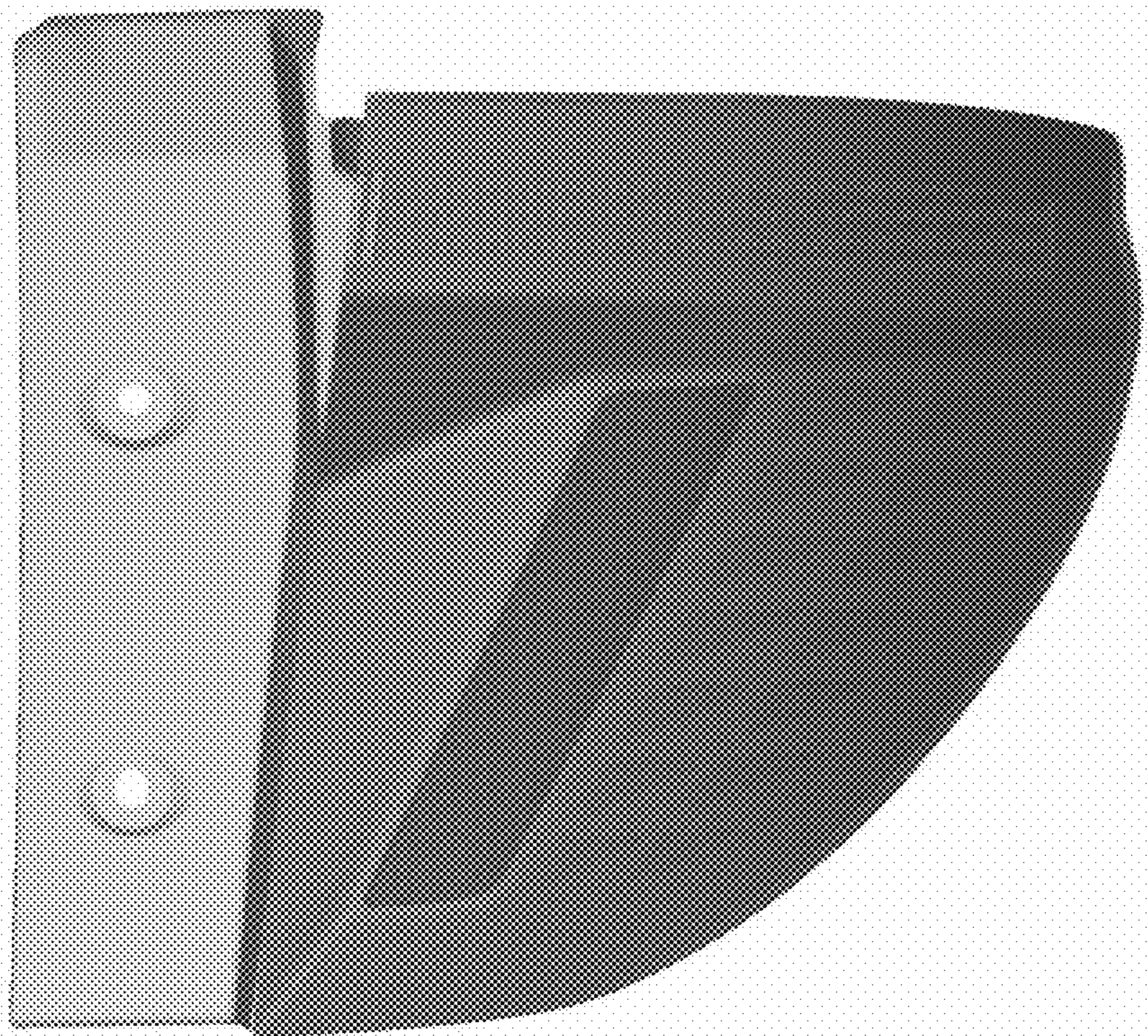

1.3

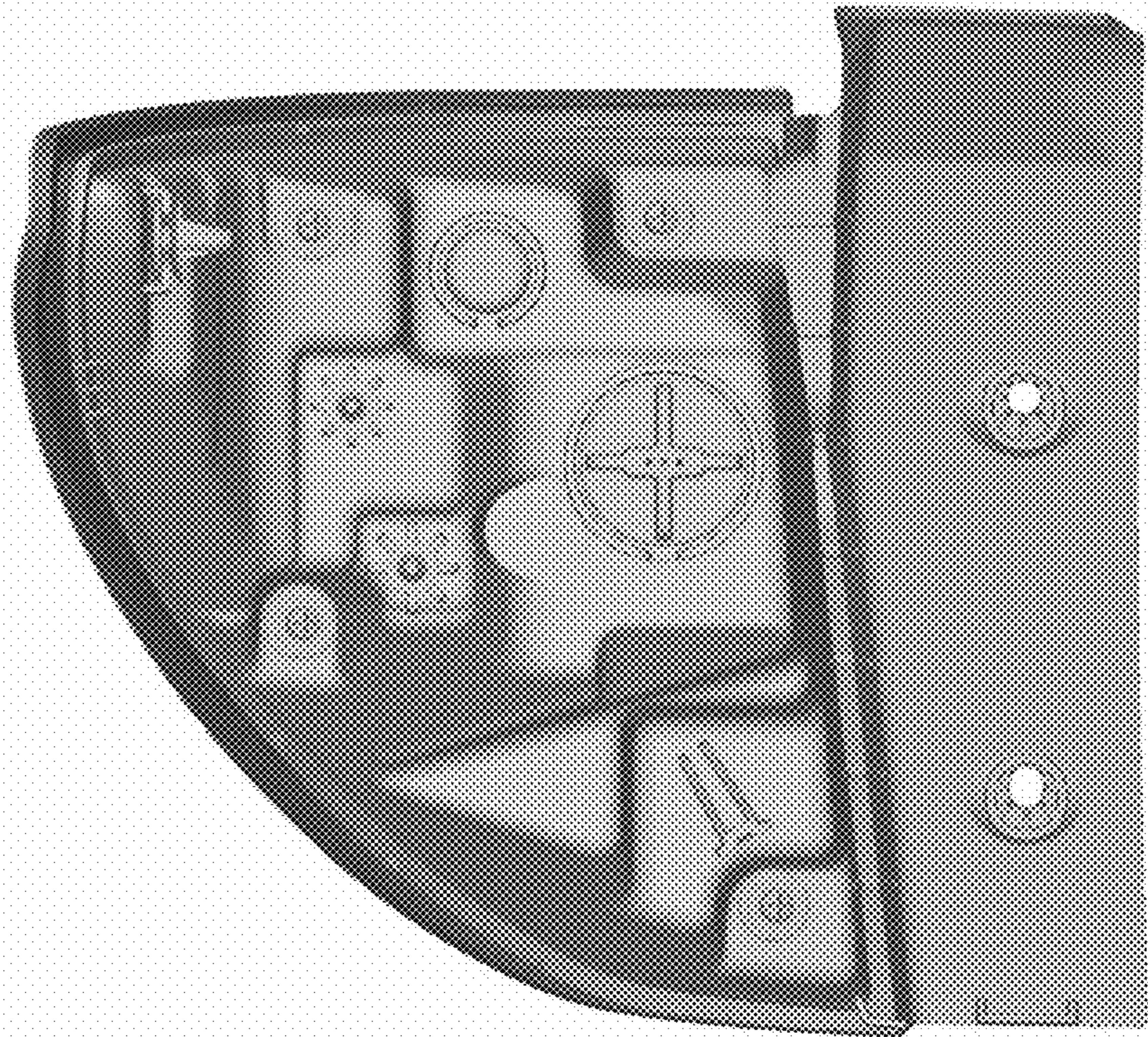

1.4

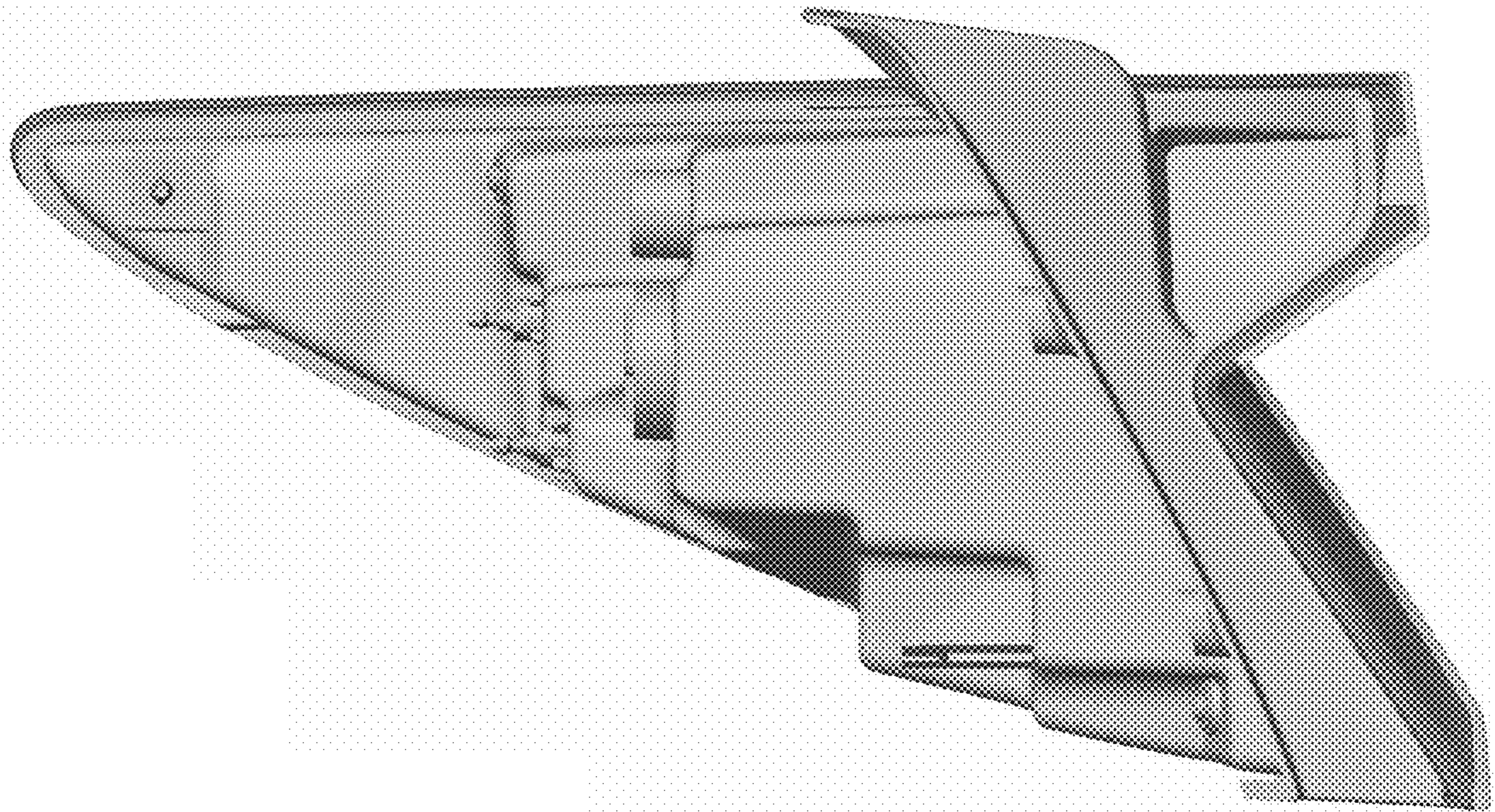

1.5

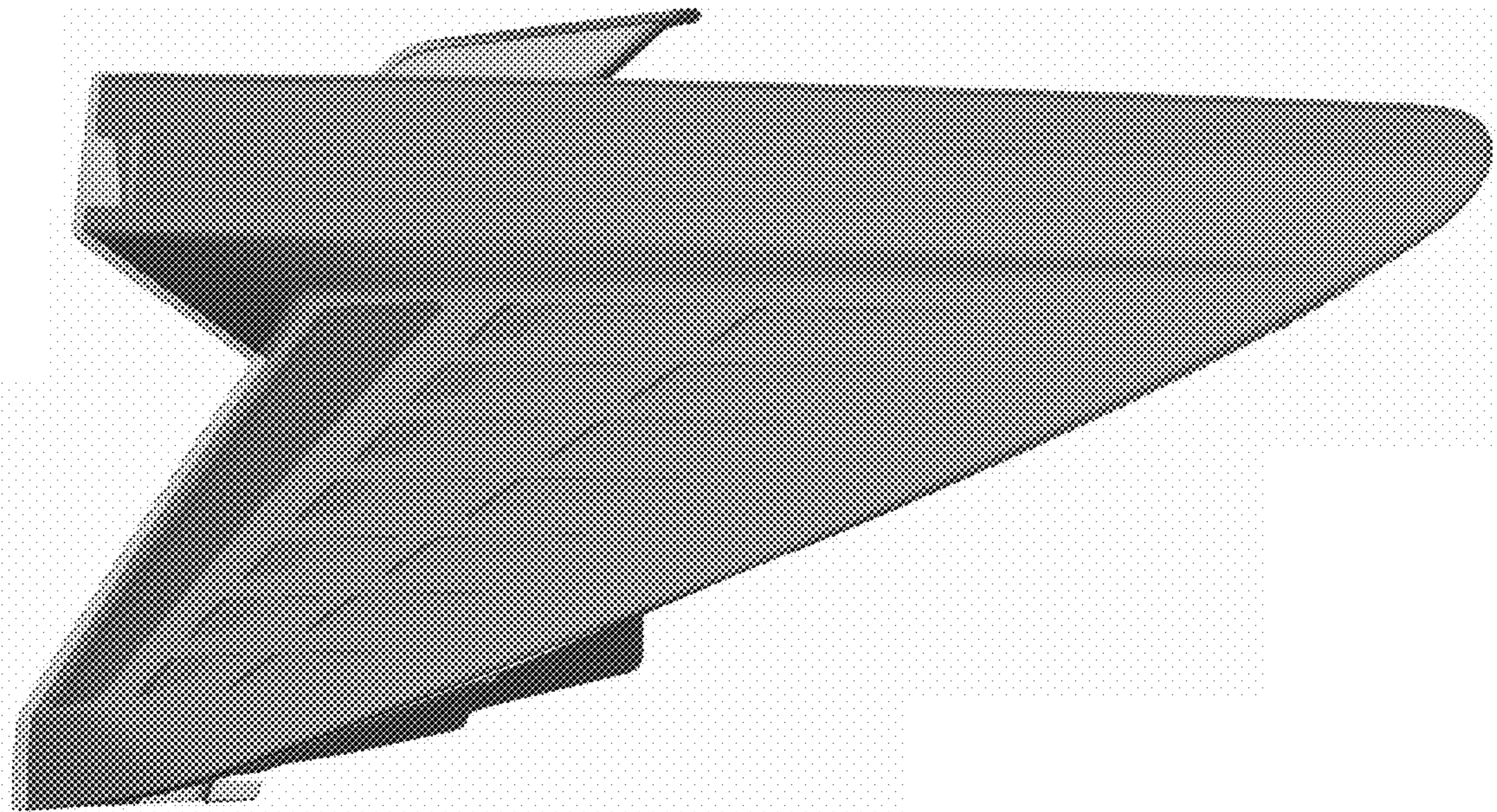



1.6

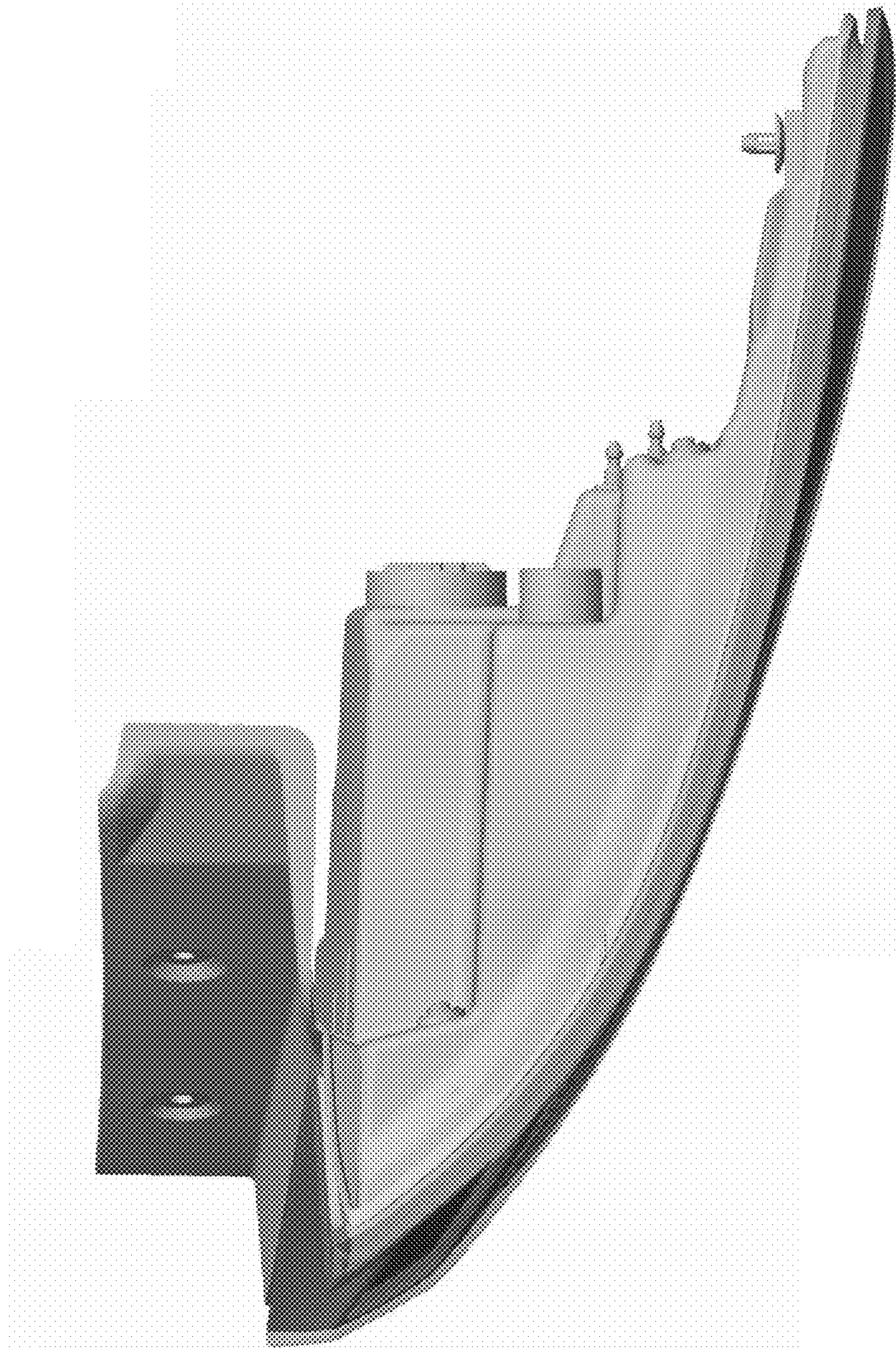

1.7

