



US00D955969S

(12) **United States Design Patent**
Huang

(10) **Patent No.:** **US D955,969 S**
(45) **Date of Patent:** **** Jun. 28, 2022**

- (54) **BICYCLE CARRIER**
- (71) Applicant: **YOTTA INNOVATION CO., LTD.**,
Apia (WS)
- (72) Inventor: **Stella Huang**, Taipei (TW)
- (73) Assignee: **YOTTA INNOVATION CO., LTD.**,
Apia (WS)

2010/0230455	A1*	9/2010	Wang	B60R 9/06 224/533
2010/0320247	A1*	12/2010	Wang	B60R 9/10 224/567
2011/0011909	A1*	1/2011	Liu	B60R 9/10 224/523
2013/0062383	A1*	3/2013	Jeli	B60R 9/10 224/549
2013/0062487	A1*	3/2013	Liu	B60R 9/10 248/297.31

(Continued)

(**) Term: **15 Years**

(21) Appl. No.: **29/758,469**

(22) Filed: **Nov. 16, 2020**

(51) **LOC (13) Cl.** **12-11**

(52) **U.S. Cl.**
USPC **D12/407**

(58) **Field of Classification Search**
USPC D12/407, 408, 406, 412, 414, 402, 115
CPC .. B60R 9/06; B60R 9/10; B60R 9/045; B60R
9/048

See application file for complete search history.

(56) **References Cited**

U.S. PATENT DOCUMENTS

6,047,869	A *	4/2000	Chiu	B60R 9/06 224/493
D467,220	S *	12/2002	Walstrom	D12/408
6,491,195	B1 *	12/2002	McLemore	B60R 9/10 224/521
D672,704	S *	12/2012	Grago	D12/408
9,802,549	B1 *	10/2017	Shen	B60R 9/10
D817,256	S *	5/2018	Adler	D12/408
10,183,627	B1 *	1/2019	Liu	B60R 9/06
D877,685	S *	3/2020	Larsson	D12/406
2008/0099522	A1 *	5/2008	Clausen	B60R 9/06 224/519
2008/0230579	A1 *	9/2008	Wang	B60R 9/10 224/400
2009/0120984	A1 *	5/2009	Sautter	B60R 9/10 224/532

OTHER PUBLICATIONS

Hyperax Volt eco—2 E Bike Mounted Bike Rack Carrier—for 2-inch Hitch—Up to 2x60 lbs MTBs, EBikes, Road Bikes with up to 5-inch Fat Tires—Suitable for SUV, Trucks, Sedan, No RV Use!; May 11, 2021; <https://www.amazon.com/Hyperax-Volt-eco-Mounted-Suitable/dp/B094MTXKJS>; 5Pgs. (Year: 2021).*

Primary Examiner — Michelle E. Wilson

Assistant Examiner — Clese Moore, Jr.

(74) *Attorney, Agent, or Firm* — Muncy, Geissler, Olds & Lowe, P.C.

(57) **CLAIM**

I claim the ornamental design for a bicycle carrier, as shown and described.

DESCRIPTION

FIG. 1 is a top, front, right perspective view of a bicycle carrier showing my new design; FIG. 2 is a front elevational view thereof; FIG. 3 is a rear elevational view thereof; FIG. 4 is a left side view thereof; FIG. 5 is a right side view thereof; FIG. 6 is a top plan view thereof; and, FIG. 7 is a bottom plan view.

The broken lines in the drawings illustrate portions of the bicycle carrier which form no part of the claimed design.

1 Claim, 7 Drawing Sheets

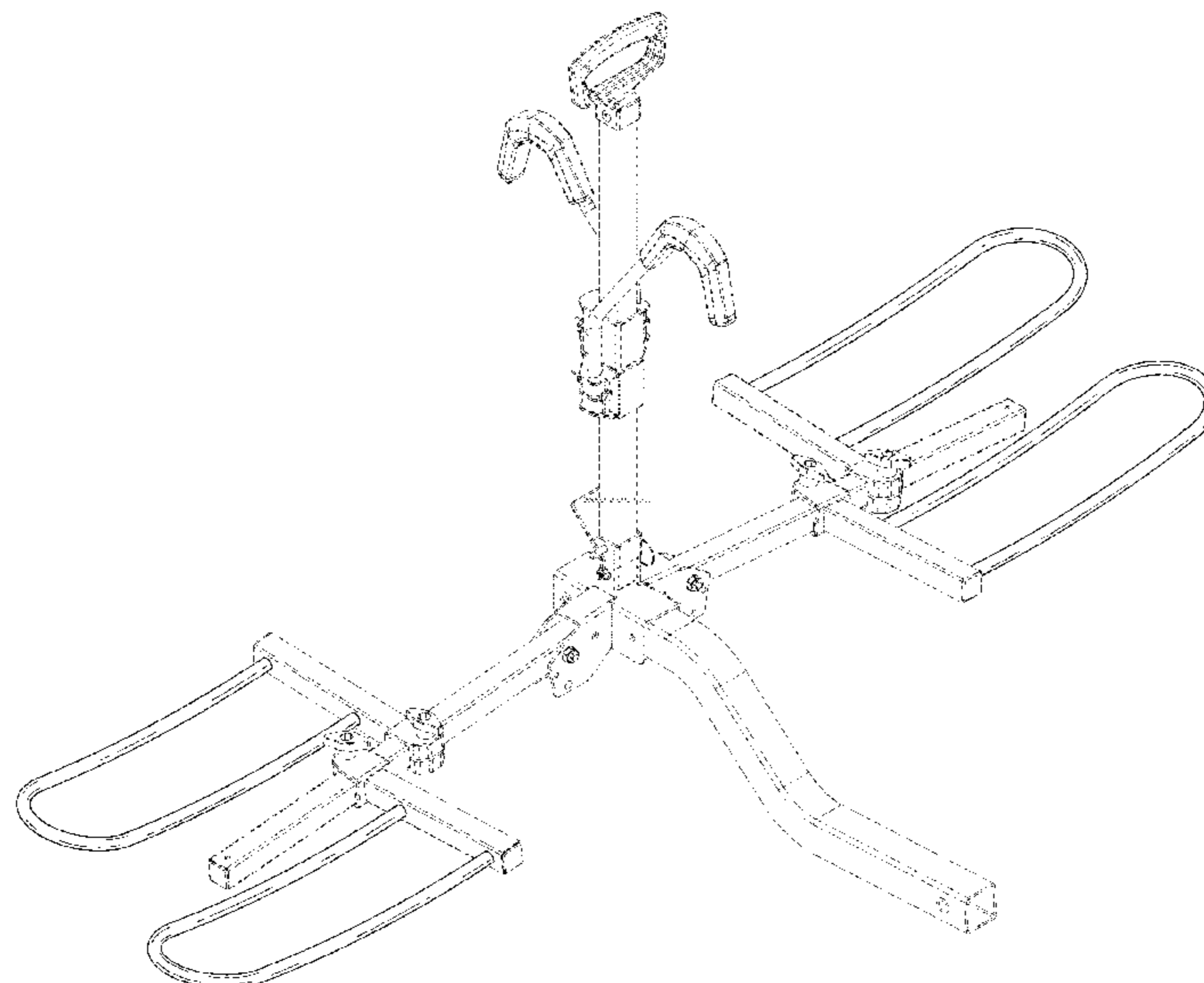

(56)

References Cited

U.S. PATENT DOCUMENTS

2014/0183237 A1* 7/2014 Wolfe B60R 9/10
224/403
2015/0232041 A1* 8/2015 Wolfe B60P 3/077
224/403
2017/0349111 A1* 12/2017 Ramsdell B60R 9/06
2018/0134229 A1* 5/2018 Shen B60R 9/06
2020/0156724 A1* 5/2020 Kuschmeader B60R 9/10

* cited by examiner

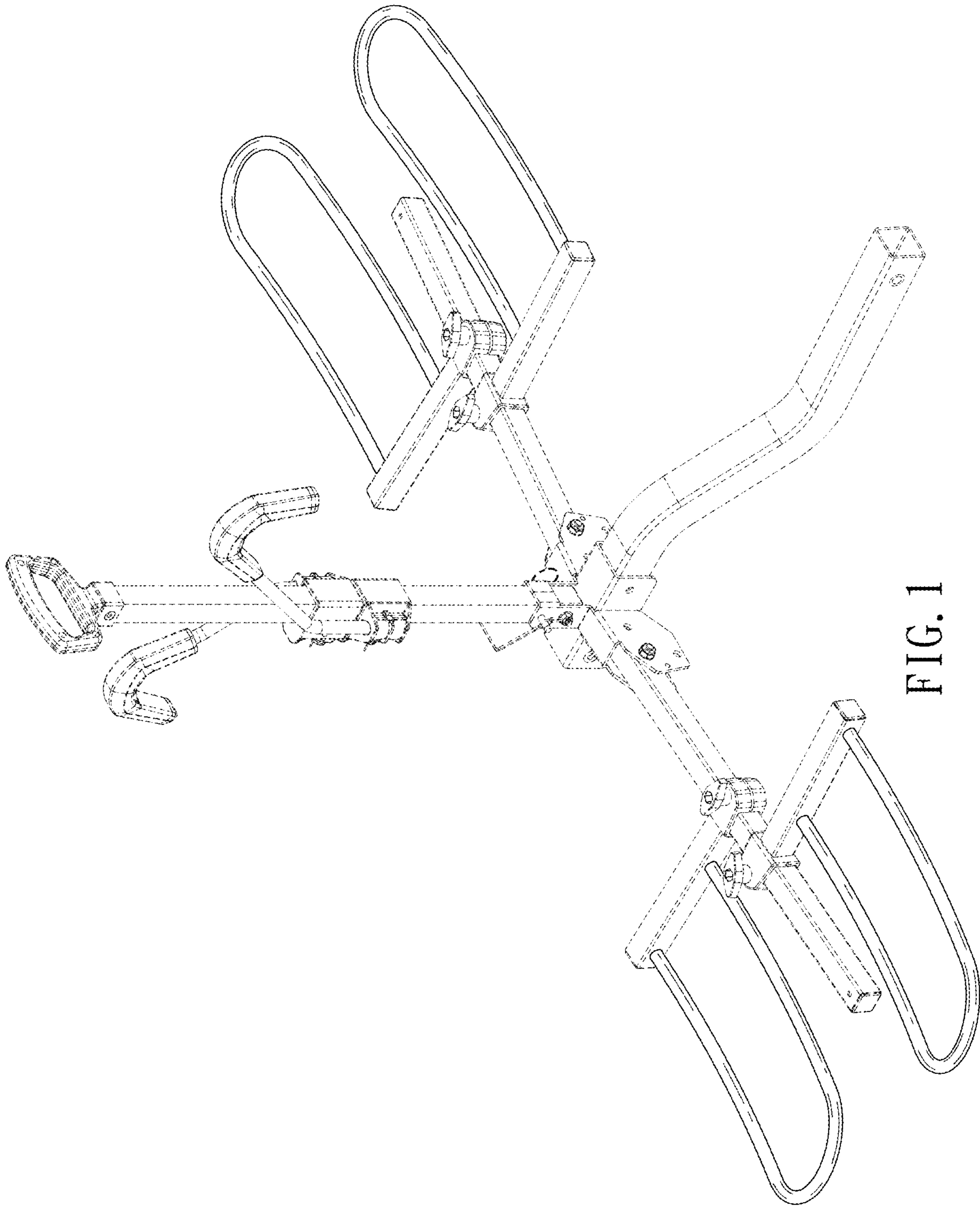

FIG. 1

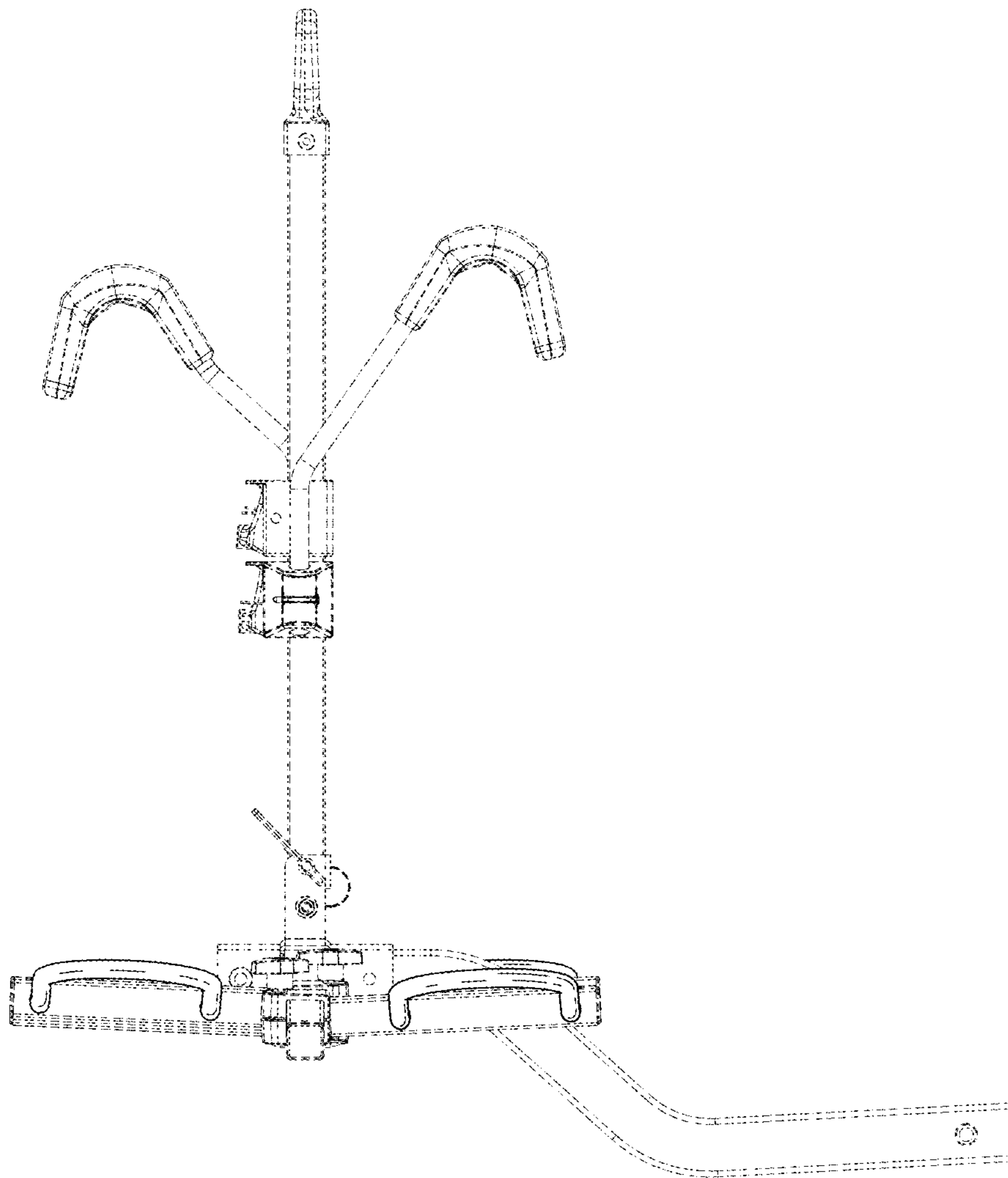

FIG. 2

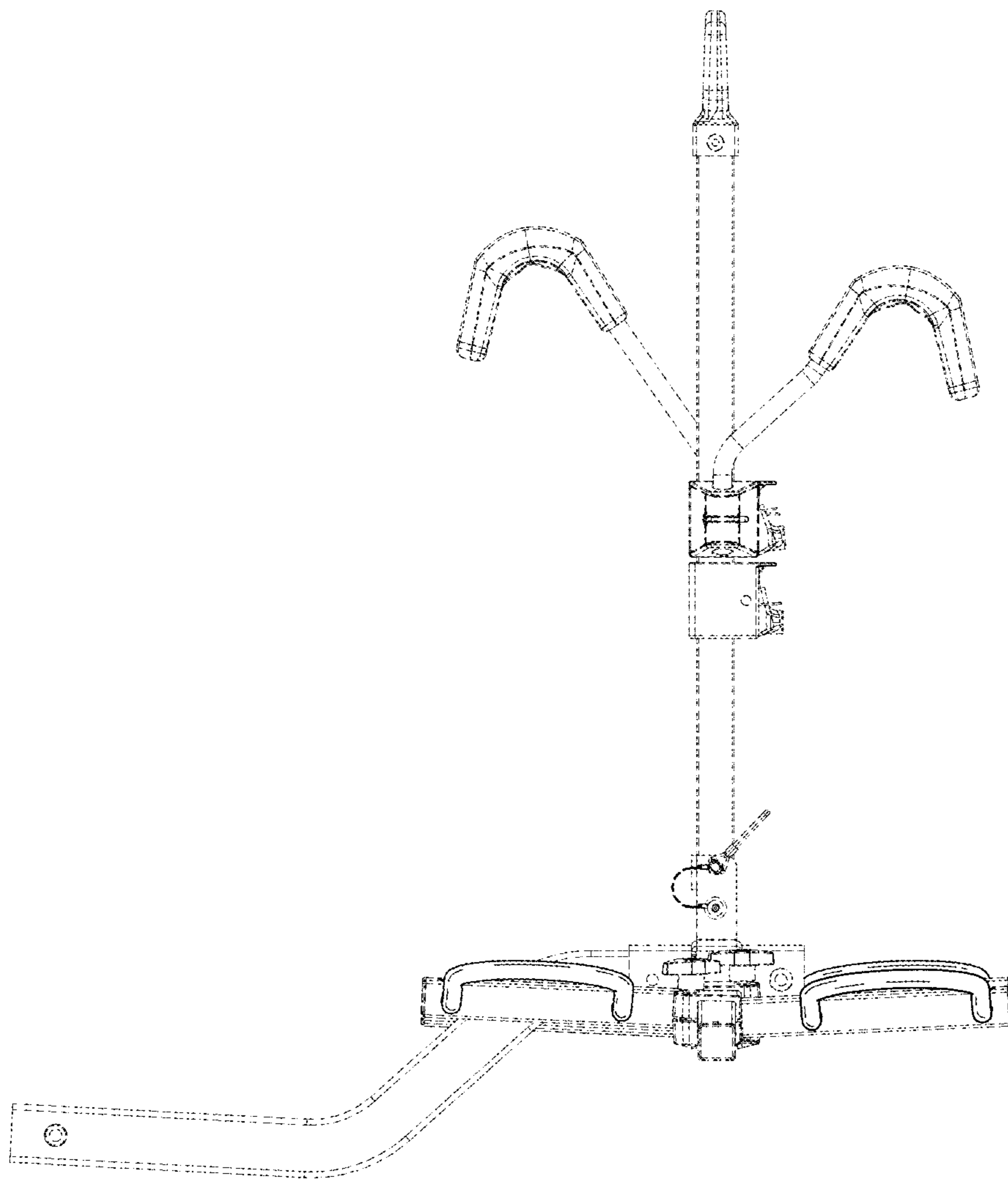

FIG. 3

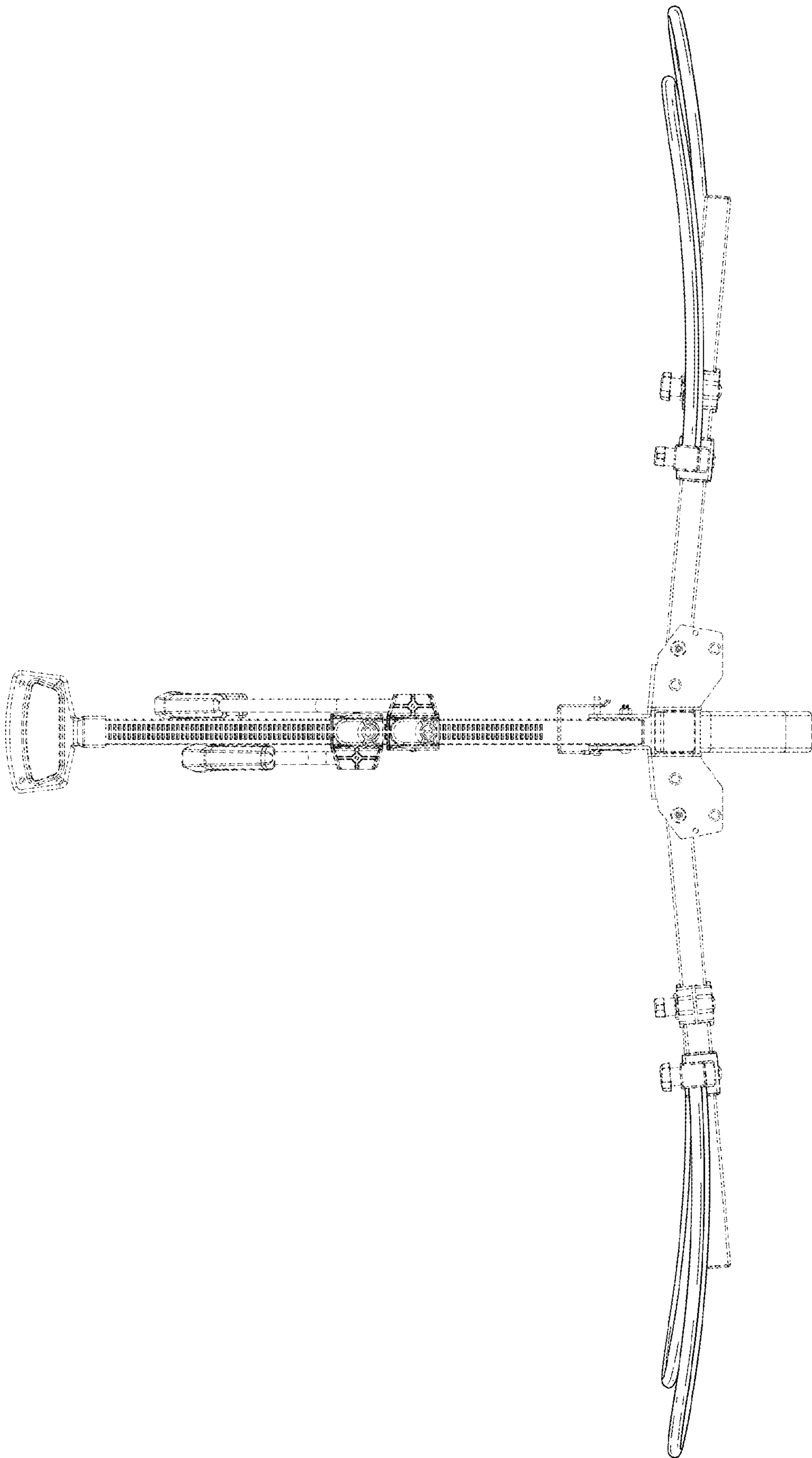

FIG. 4

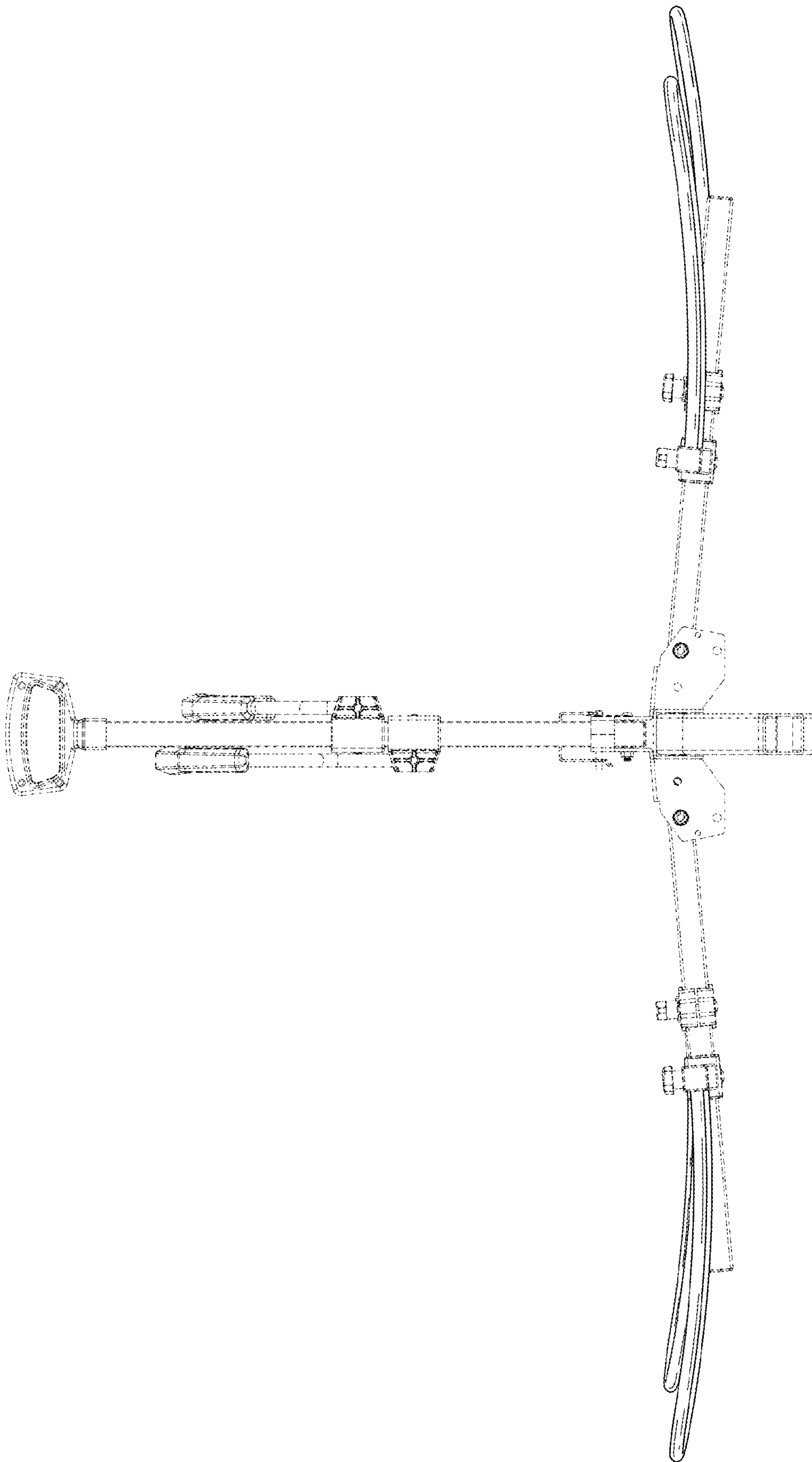

FIG. 5

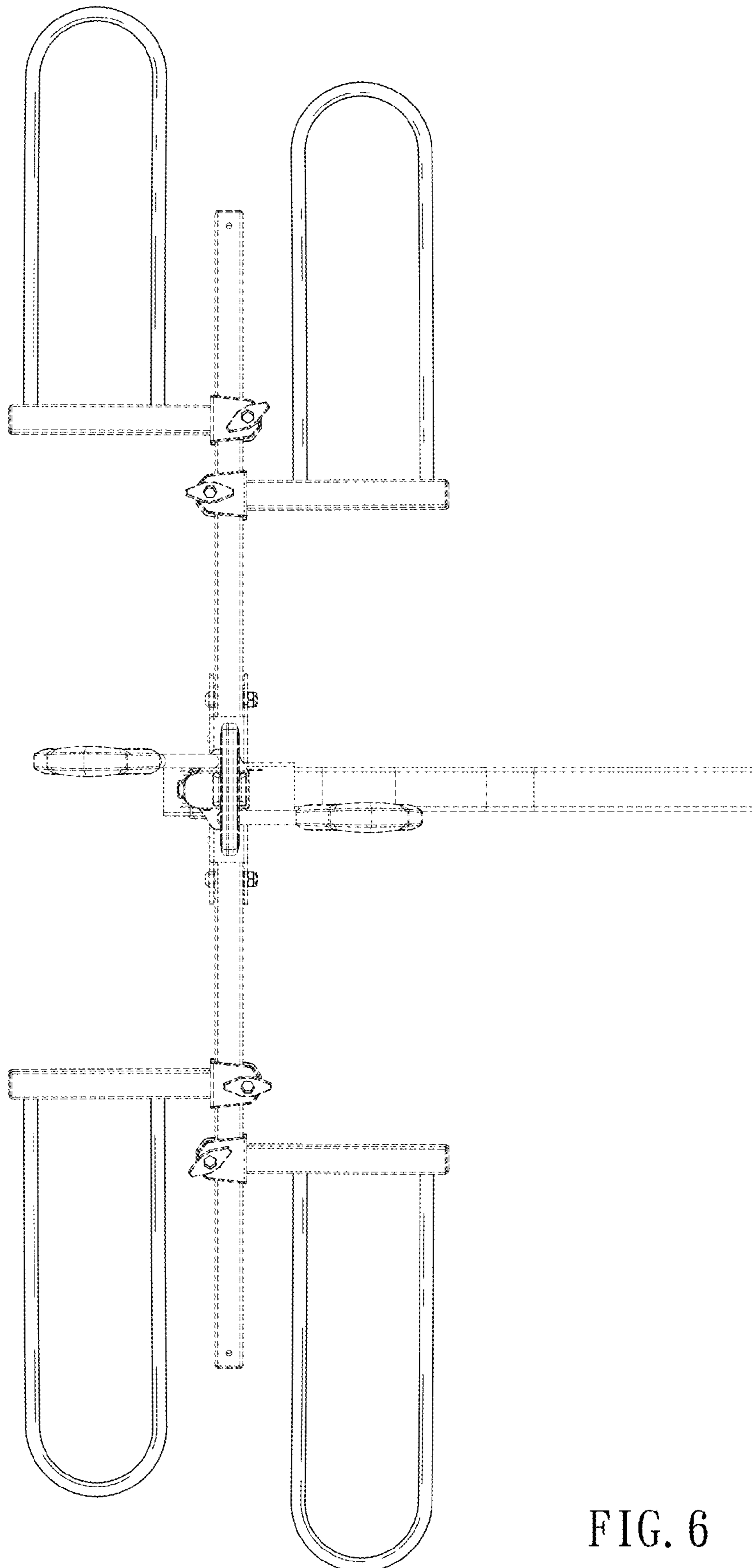

FIG. 6

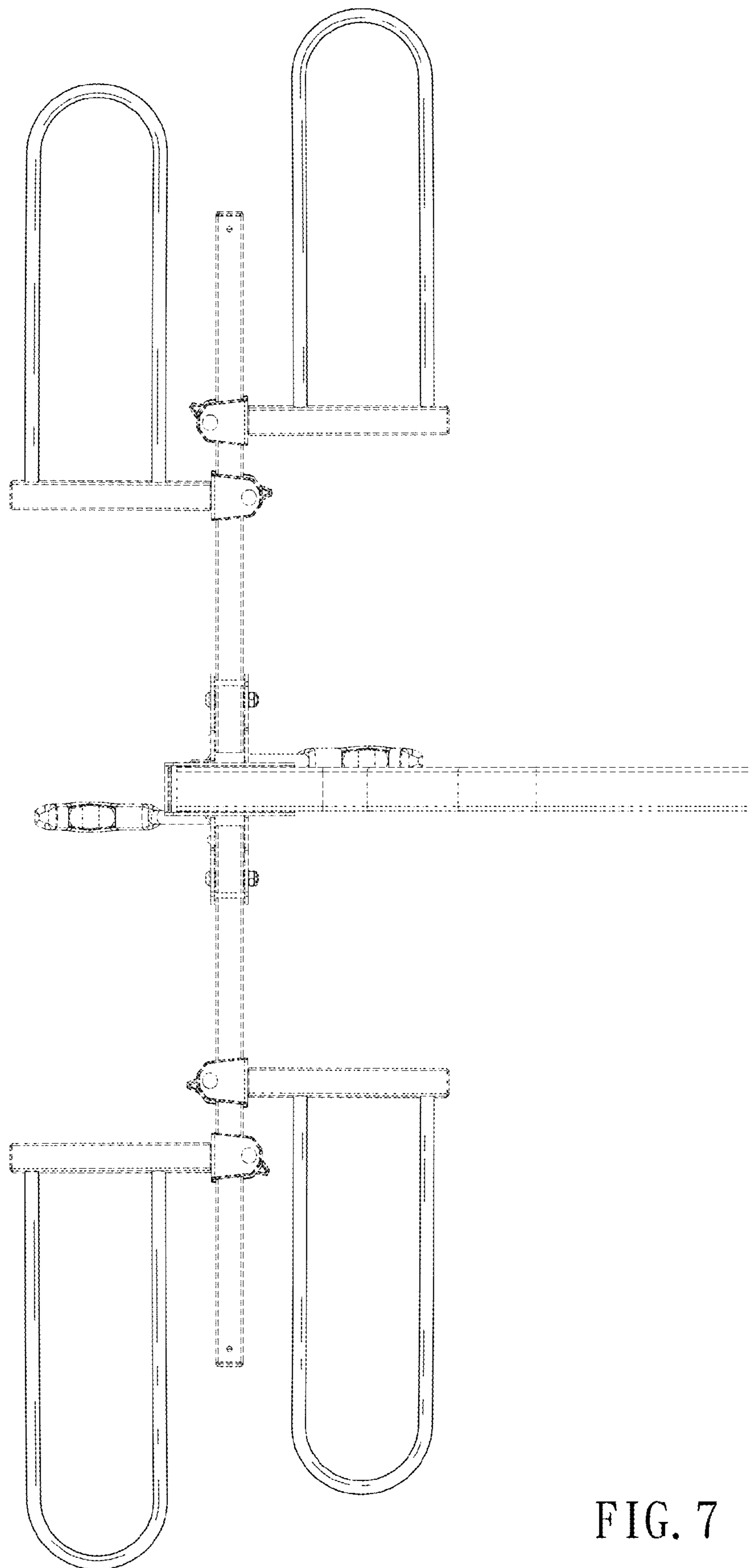

FIG. 7