



US00D954772S

(12) **United States Design Patent**
Proell

(10) **Patent No.:** **US D954,772 S**
(45) **Date of Patent:** **** Jun. 14, 2022**

- (54) **TELESCOPE**
- (71) Applicant: **SWAROVSKI-OPTIK KG., Absam (AT)**
- (72) Inventor: **Julian Proell, Linz (AT)**
- (73) Assignee: **SWAROVSKI-OPTIK KG., Absam (AT)**
- (**) Term: **15 Years**
- (21) Appl. No.: **29/683,619**
- (22) Filed: **Mar. 14, 2019**

Related U.S. Application Data

- (62) Division of application No. 35/504,576, filed on Feb. 22, 2018 (U.S. filing date under 35 U.S.C. 384), and having an international filing date of Feb. 22, 2018, now Pat. No. Des. 860,285.
- (51) **LOC (13) Cl.** **16-06**
- (52) **U.S. Cl.**
USPC **D16/132**
- (58) **Field of Classification Search**
USPC D16/130-136; D22/100, 108, 109, 110
CPC G02B 23/00; G02B 23/02; G02B 23/12;
G02B 23/16; G02B 7/04
See application file for complete search history.

(56) **References Cited**

U.S. PATENT DOCUMENTS

D123,486 S *	11/1940	Miles	D16/132
D165,231 S	11/1951	Kieffer, III et al.		
D215,355 S *	9/1969	Weatherby	D16/132
D272,916 S *	3/1984	Tomatsuri	D16/132
D285,698 S	9/1986	Ogasawara		
D288,210 S *	2/1987	Mise	D16/132
D344,531 S *	2/1994	Nemoto	D16/130

D374,022 S	9/1996	Meinzer		
D374,679 S *	10/1996	Palmer	D16/133
D395,440 S	6/1998	Ogasawara et al.		
5,946,132 A *	8/1999	Phillips	F41G 1/345 359/351
D438,221 S	2/2001	Hedrick et al.		
D439,259 S	3/2001	Yamaguchi		
6,349,905 B1 *	2/2002	Mills	F16M 11/14 248/126
D454,144 S	3/2002	Ogasawara et al.		
D454,899 S	3/2002	Hedrick et al.		
D479,255 S *	9/2003	Hamamura	D16/132
D482,709 S *	11/2003	Meinzer	D16/132
D484,898 S	1/2004	Moro		
D490,097 S *	5/2004	Regan	D16/132
D512,449 S *	12/2005	Regan	D16/132
D522,550 S	6/2006	Kung		
D534,193 S	12/2006	Ono		
D550,263 S	9/2007	Zhou		
D572,740 S	7/2008	Kitera		
D587,290 S *	2/2009	Meinzer	D16/132
D675,239 S	1/2013	Wunnicke et al.		
D695,327 S	12/2013	Hoelbl		

(Continued)

Primary Examiner — Holly E Thurman

(74) *Attorney, Agent, or Firm* — Collard & Roe, P.C.

(57) **CLAIM**

The ornamental design for a telescope, as shown and described.

DESCRIPTION

FIG. 1 is a perspective view of telescope showing my new design;
 FIG. 2 is a rear view thereof;
 FIG. 3 is a left side view thereof;
 FIG. 4 is a top view thereof;
 FIG. 5 is a right side view thereof;
 FIG. 6 is a bottom view thereof; and,
 FIG. 7 is a front view thereof.

1 Claim, 7 Drawing Sheets

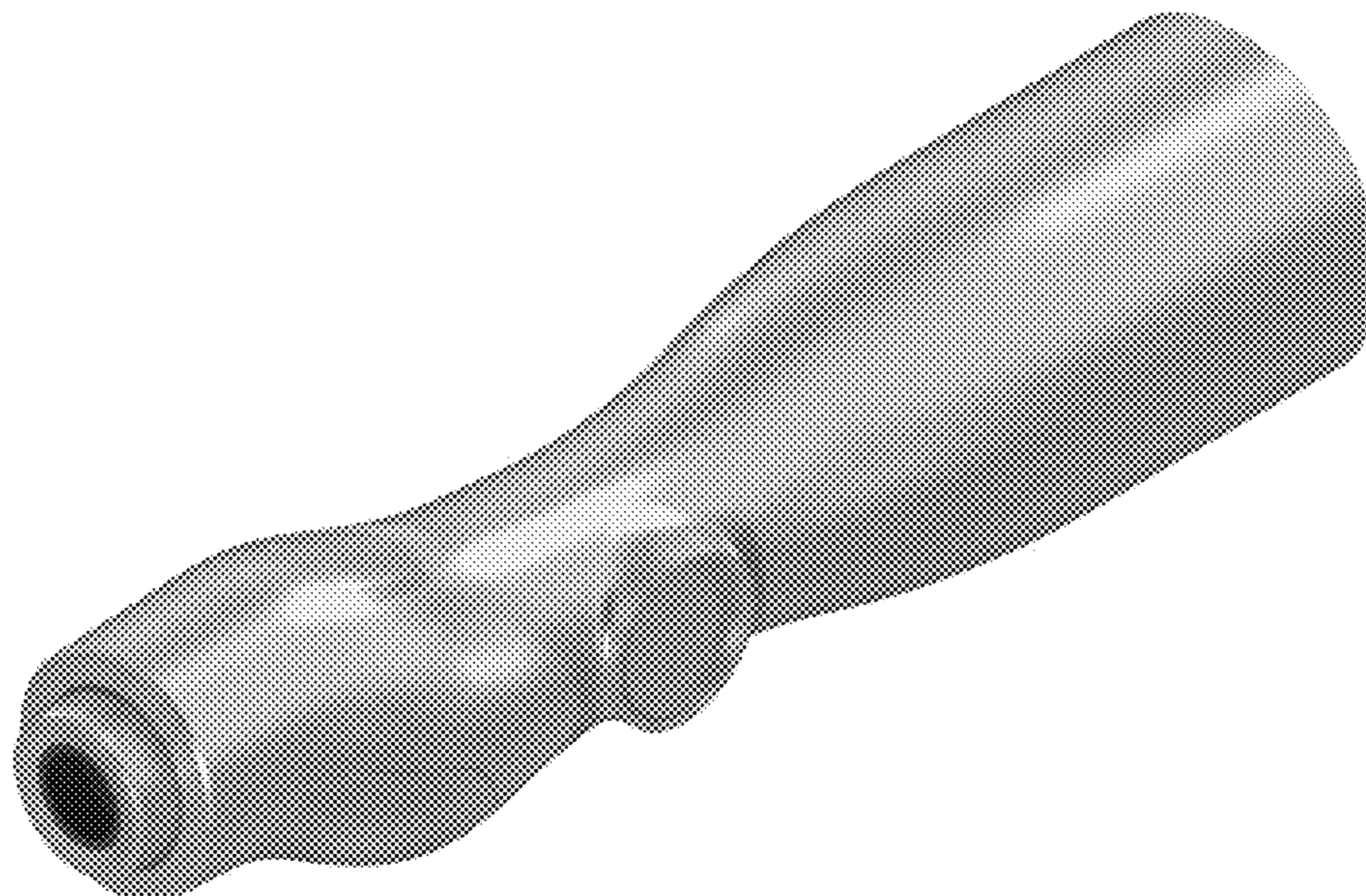

(56)

References Cited

U.S. PATENT DOCUMENTS

D705,840 S * 5/2014 Iwabuchi G02B 23/16
D16/132
D724,129 S 3/2015 Marsiglia et al.
D731,571 S 6/2015 Imamizu
D815,676 S * 4/2018 Perry D16/132
D816,795 S 5/2018 Vogl et al.
D817,376 S 5/2018 Vogl et al.
D818,512 S 5/2018 Massegg et al.
D860,285 S * 9/2019 Proll D16/132
2004/0207750 A1 * 10/2004 Wu G02B 23/12
348/375
2019/0113298 A1 * 4/2019 Fudala F41A 23/14

* cited by examiner

FIG. 1

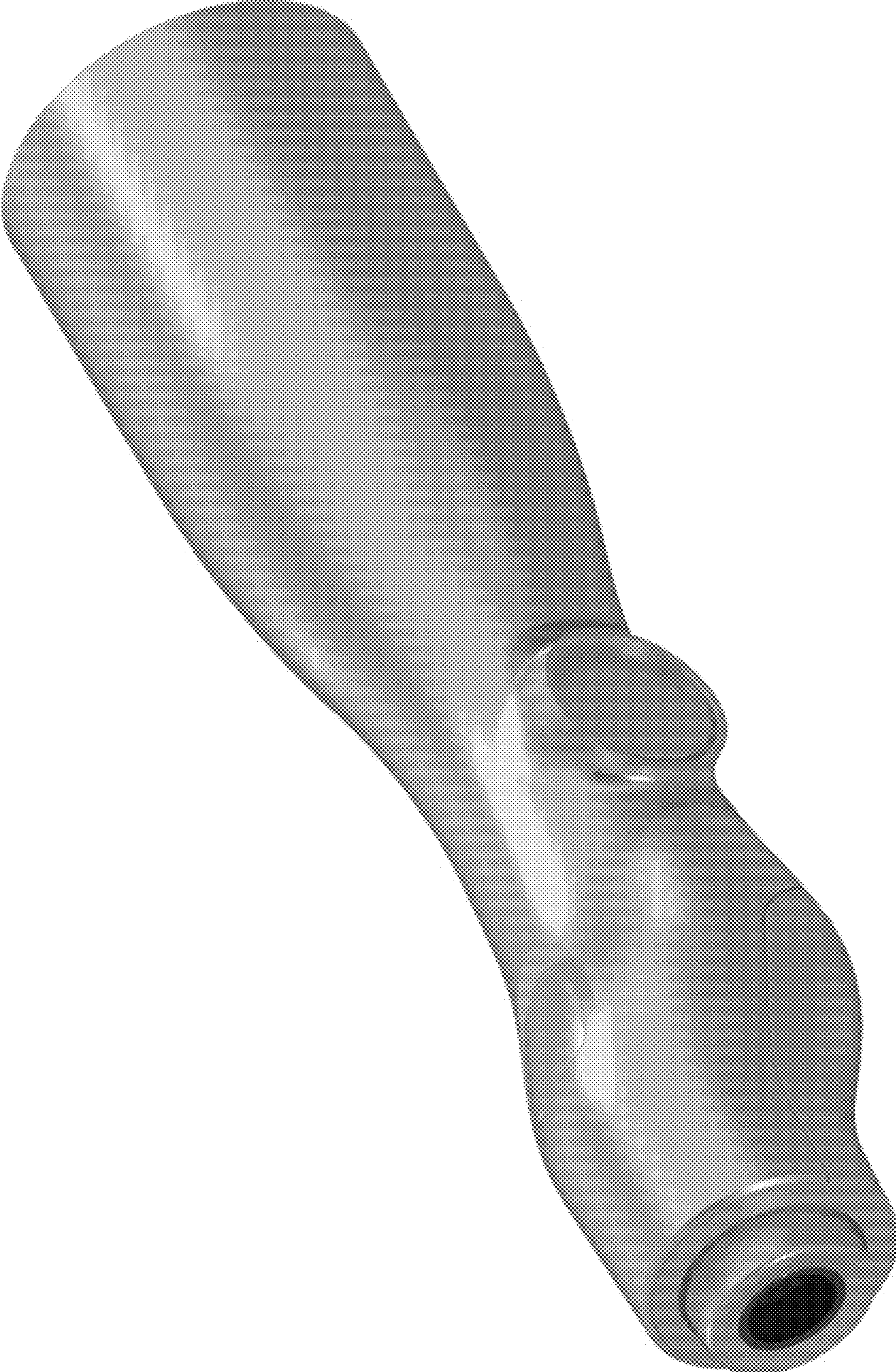

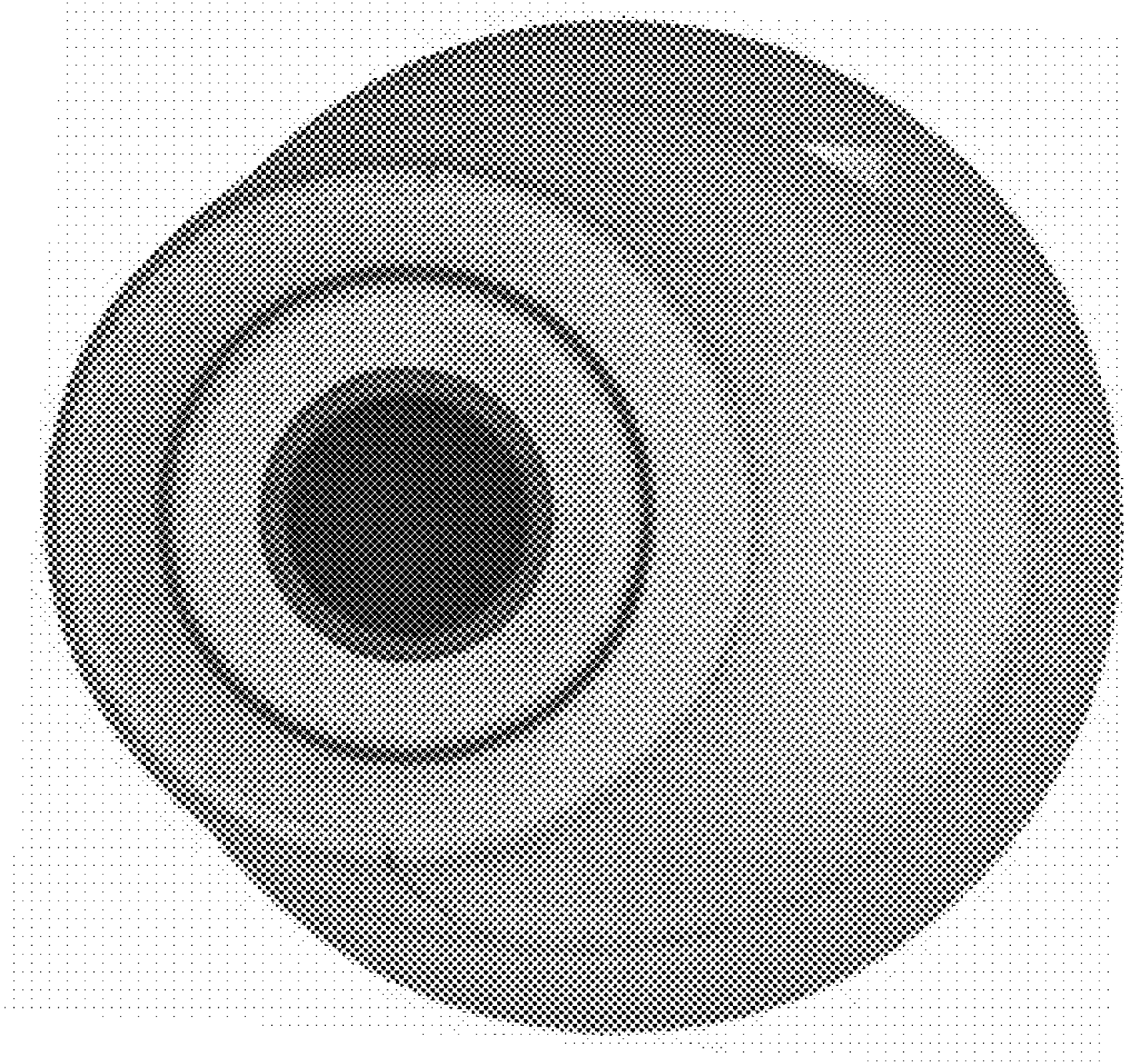

FIG. 2

FIG. 3

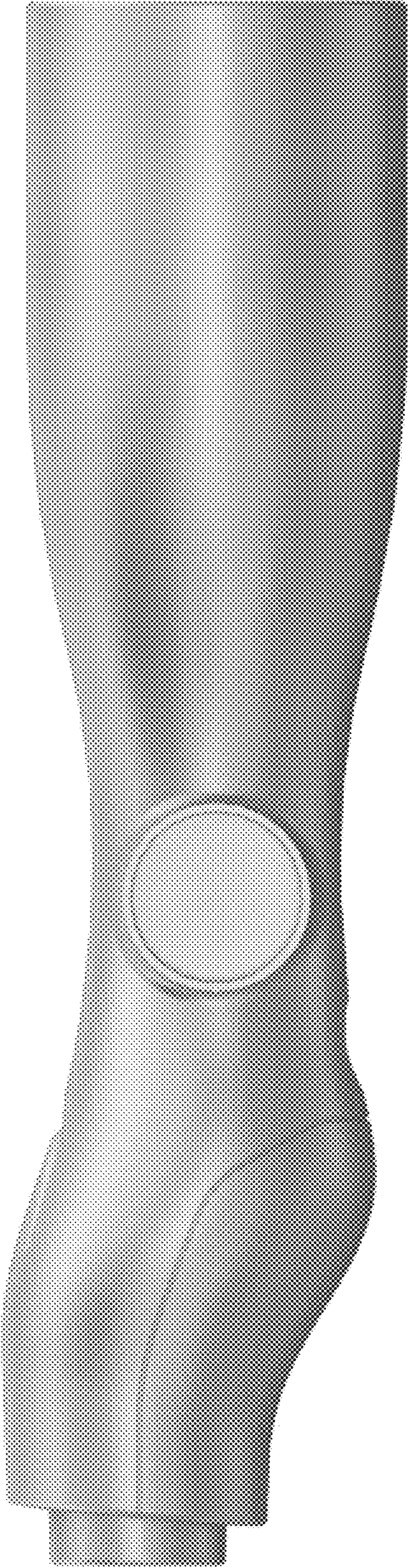

FIG. 4

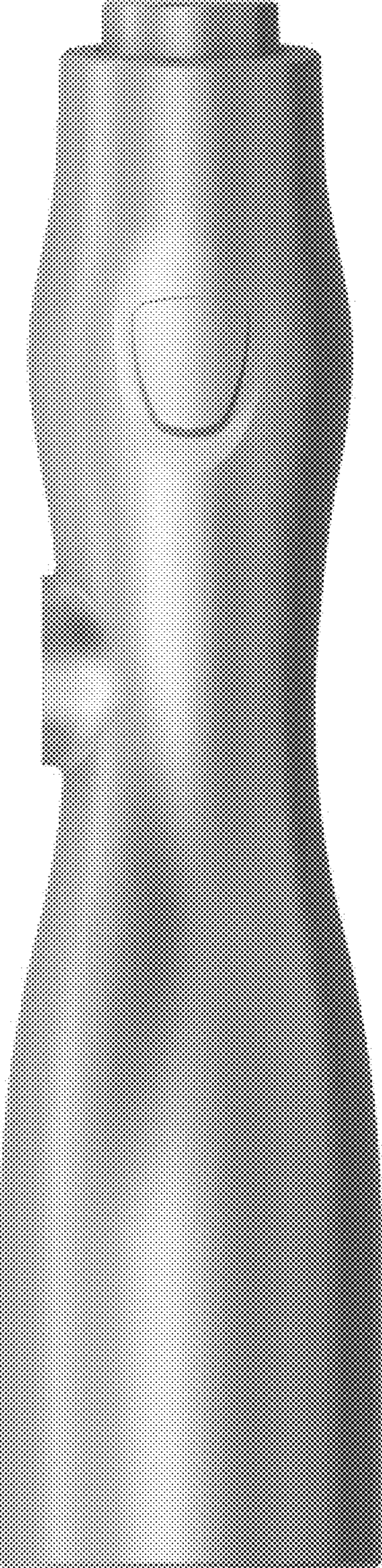

FIG. 5

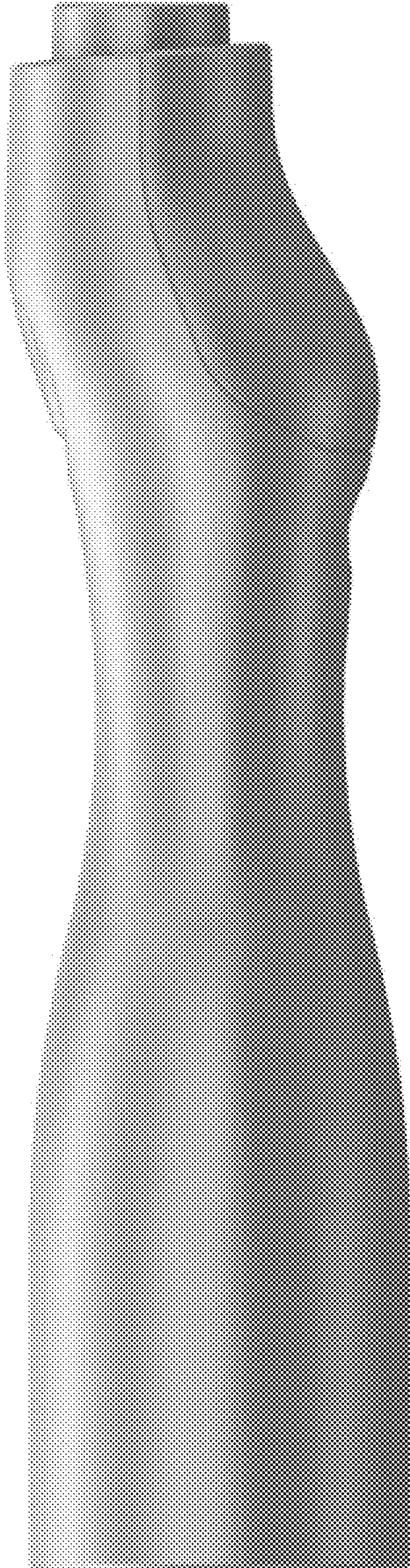
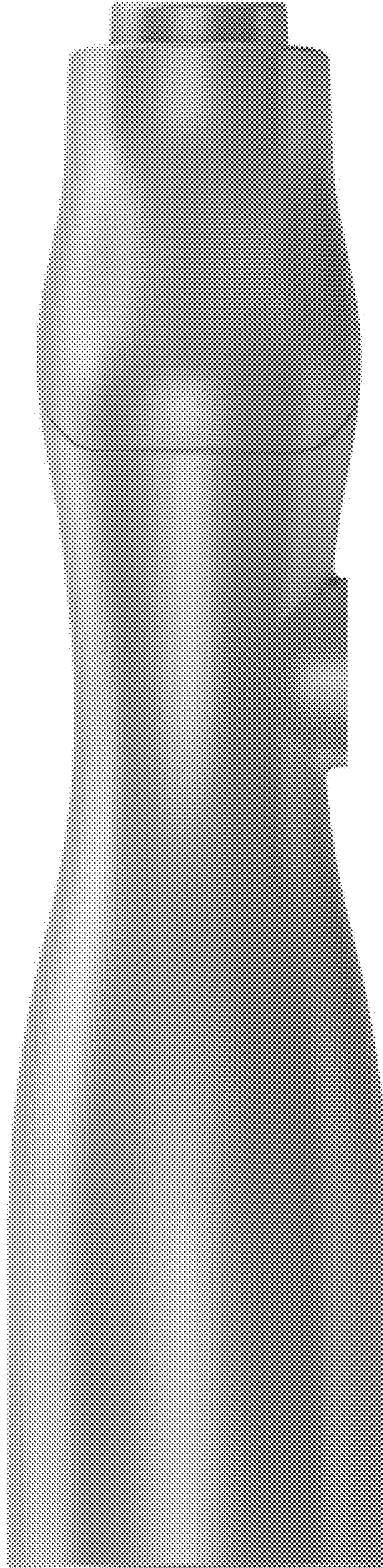

FIG. 6



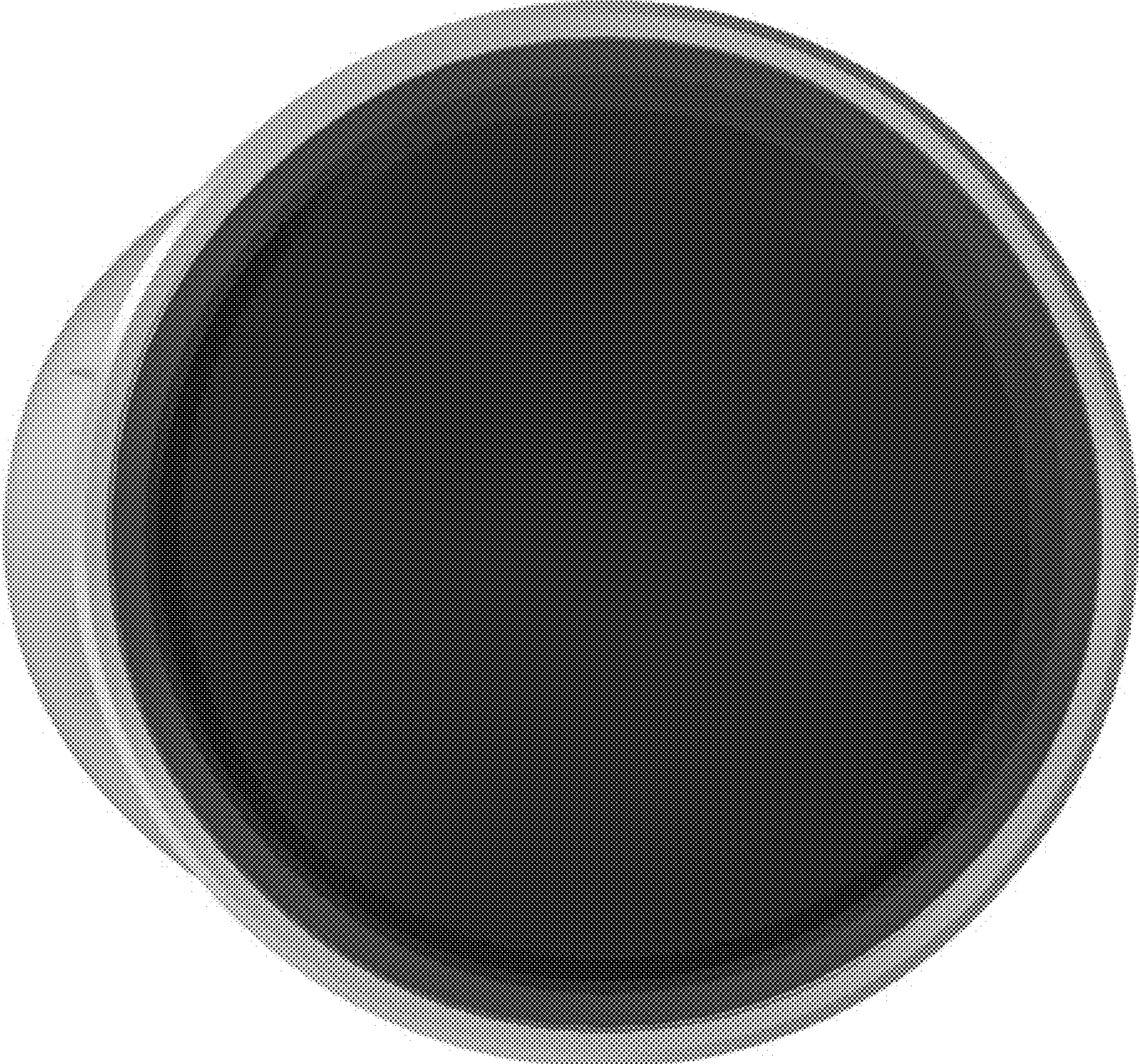

FIG. 7