



US00D953315S

(12) **United States Design Patent**  
**Levi**

(10) **Patent No.:** **US D953,315 S**

(45) **Date of Patent:** **\*\* May 31, 2022**

(54) **TELEVISION COVER**

(71) Applicant: **Vendition 360 LLC**, Mooresville, NC  
(US)

(72) Inventor: **Robert Levi**, Mooresville, NC (US)

(73) Assignee: **VENDITION 360 LLC**, Mooresville,  
NC (US)

(\*\*) Term: **15 Years**

(21) Appl. No.: **29/744,440**

(22) Filed: **Jul. 29, 2020**

(51) **LOC (13) Cl.** ..... **14-03**

(52) **U.S. Cl.**  
USPC ..... **D14/239; D3/300**

(58) **Field of Classification Search**  
USPC ..... **D3/300; D6/610; 150/165**  
CPC ..... **B65D 65/02**  
See application file for complete search history.

(56) **References Cited**

**U.S. PATENT DOCUMENTS**

D382,260 S *	8/1997	Smith	.....	D14/448
D567,245 S *	4/2008	Edwards	.....	D14/448
D664,129 S *	7/2012	Mora	.....	D14/239
8,910,680 B1 *	12/2014	Jacobs	.....	G06F 1/1601 150/165
D744,042 S *	11/2015	Kreindel	.....	D20/99
D806,086 S *	12/2017	Garside	.....	D14/448

D812,046 S *	3/2018	Miller	.....	D14/239
D856,035 S *	8/2019	Fu	.....	D6/610
D874,825 S *	2/2020	Liang	.....	D3/301
2016/0166026 A1 *	6/2016	Webster	.....	A45C 5/02 206/320

\* cited by examiner

*Primary Examiner* — Khawaja Anwar

*Assistant Examiner* — Megan Tiana Rakos

(74) *Attorney, Agent, or Firm* — Shumaker, Loop &  
Kendrick, LLP

(57) **CLAIM**

The ornamental design for a television cover, as shown and described.

**DESCRIPTION**

FIG. 1 is a perspective view of the new design for the television cover;  
FIG. 2 is a back view thereof;  
FIG. 3 is a front view thereof;  
FIG. 4 is a bottom view thereof;  
FIG. 5 is a top view thereof;  
FIG. 6 is a right side view thereof; and,  
FIG. 7 is a left side view thereof.

In the drawings, portions shown in broken lines are directed to environmental structure and form no part of the claimed design.

**1 Claim, 5 Drawing Sheets**

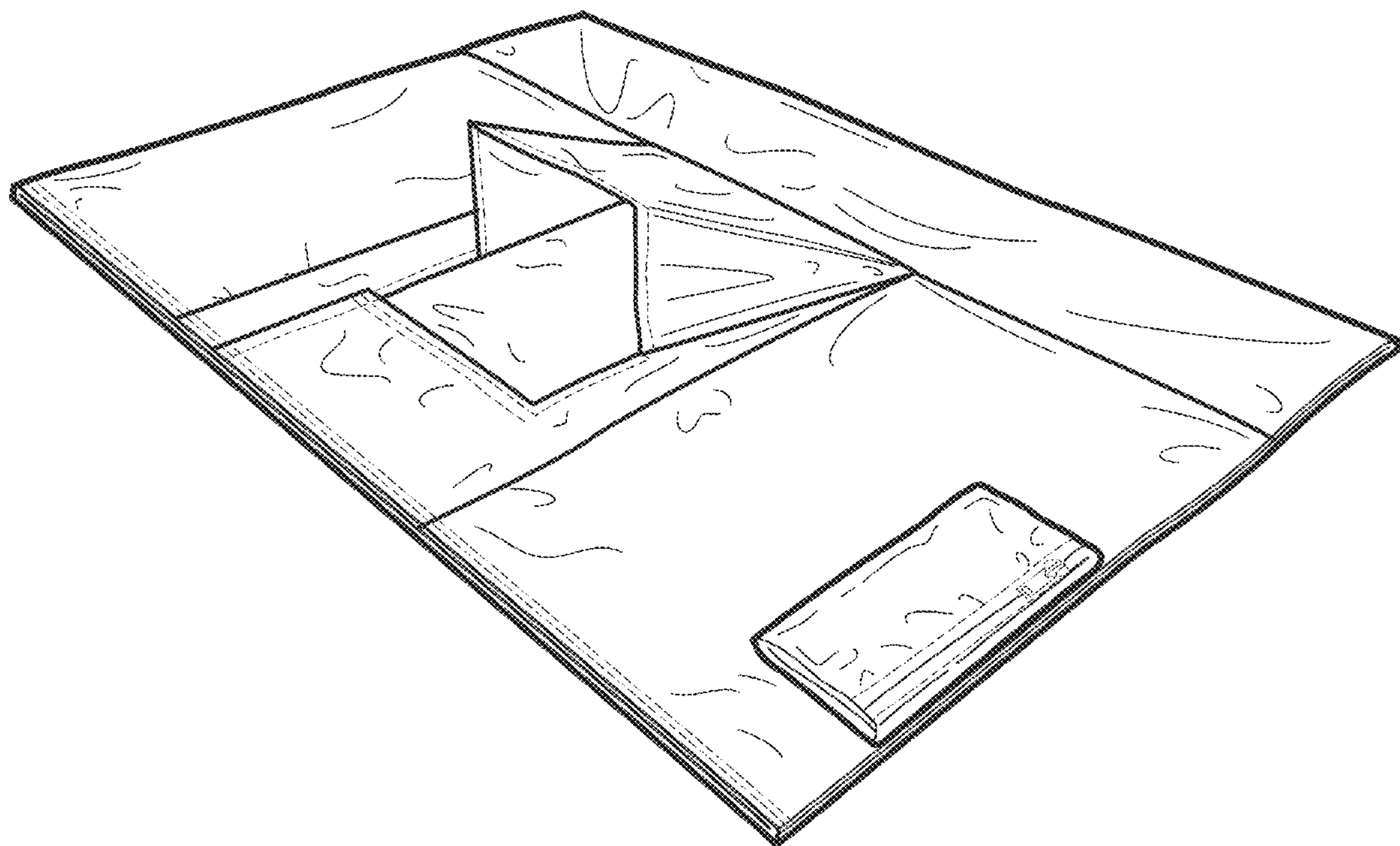

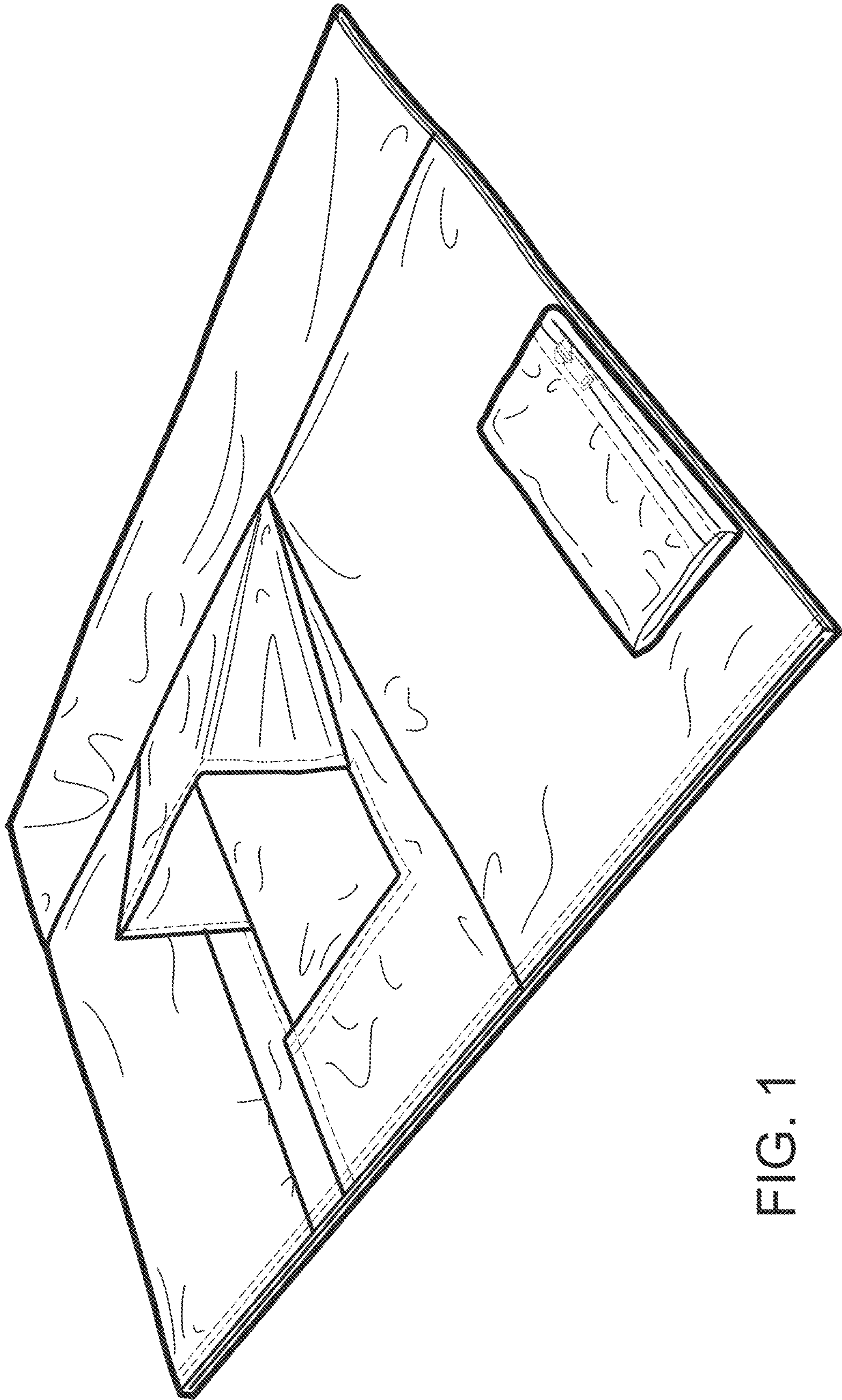

FIG. 1



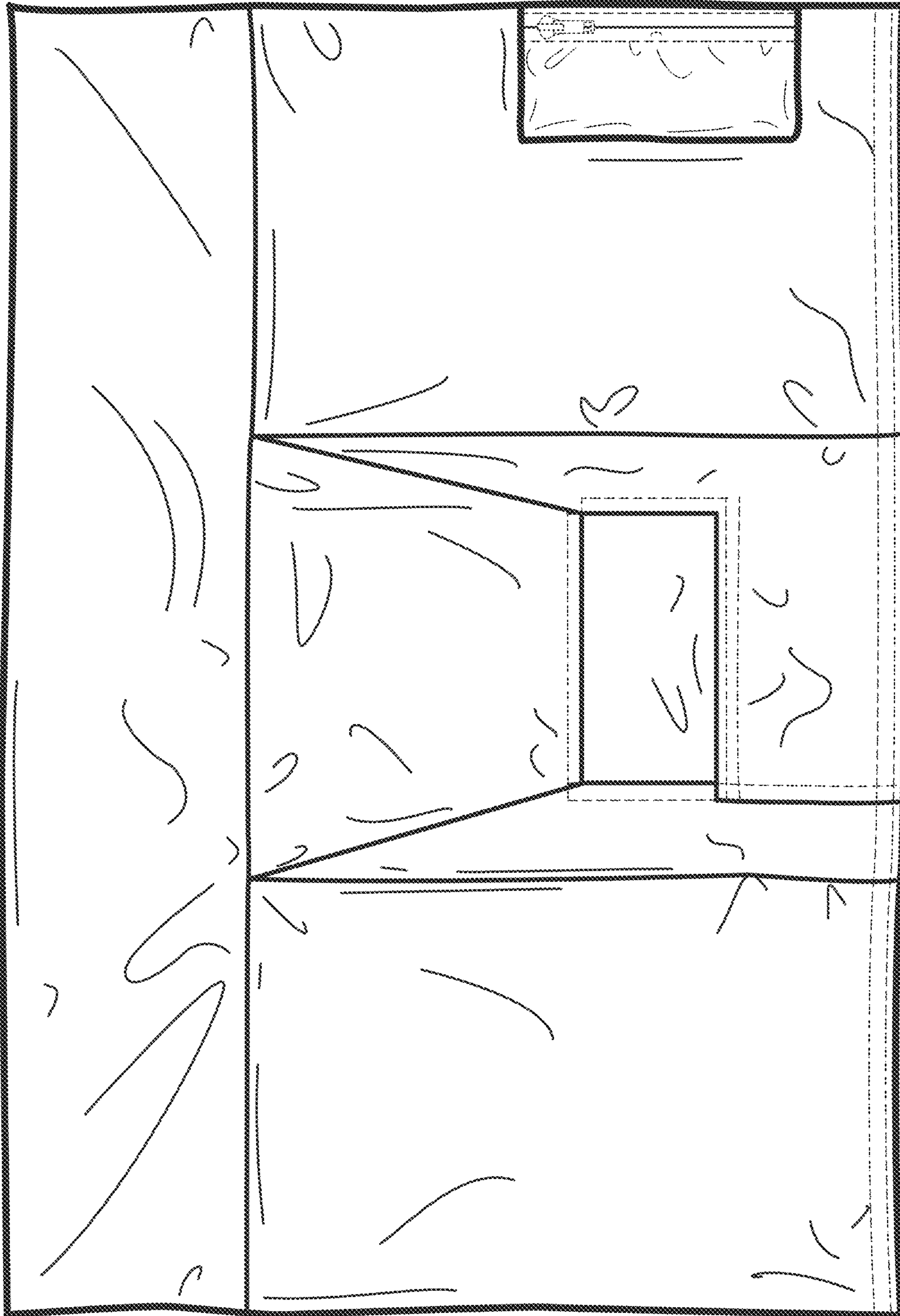

FIG 2

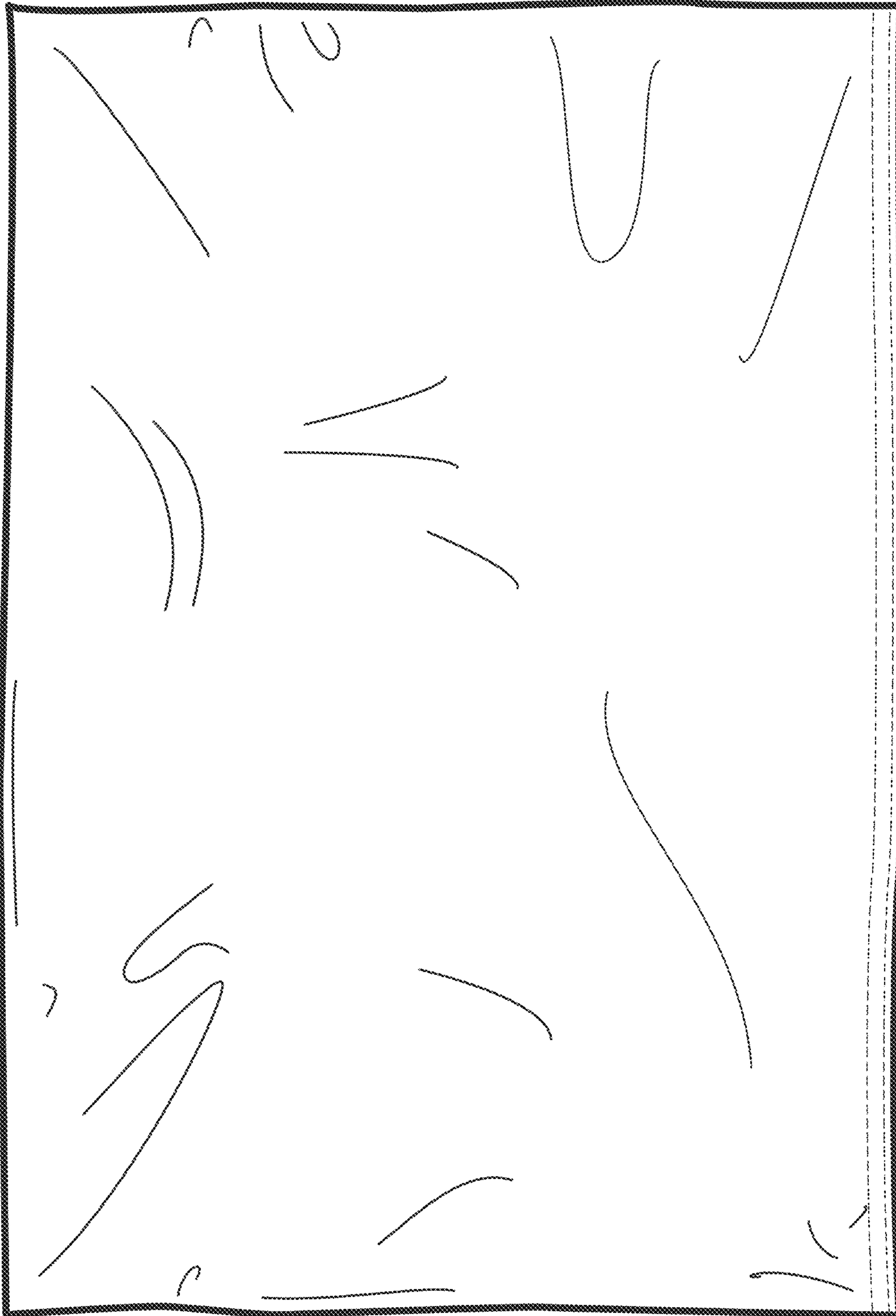

FIG 3

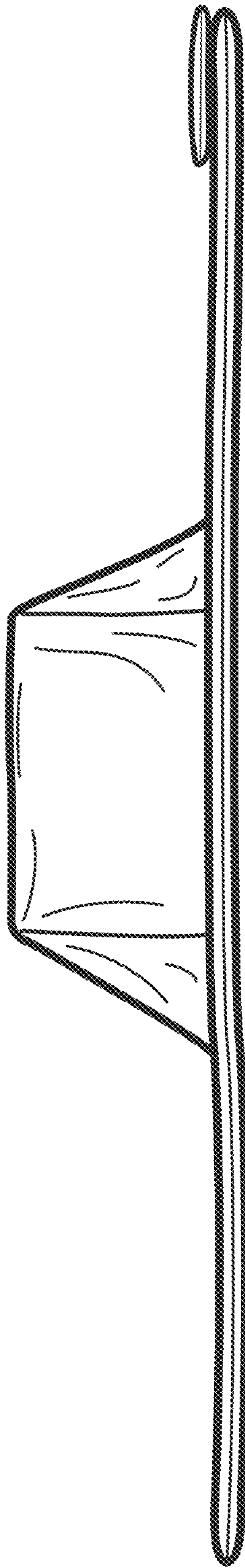

FIG. 4

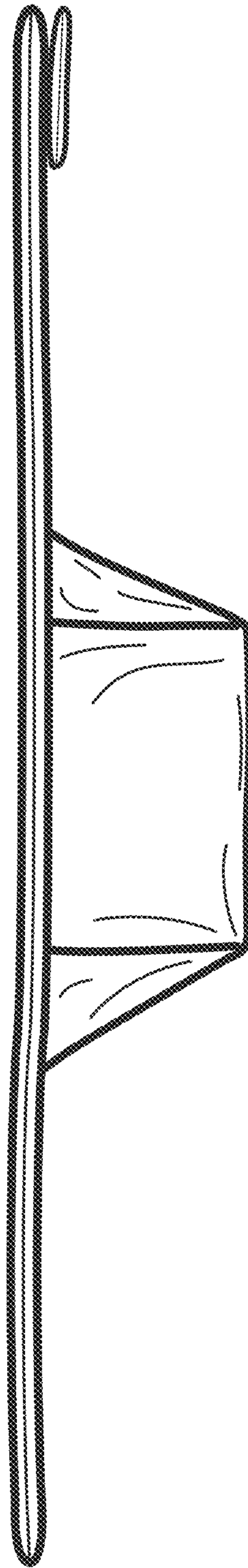

FIG. 5

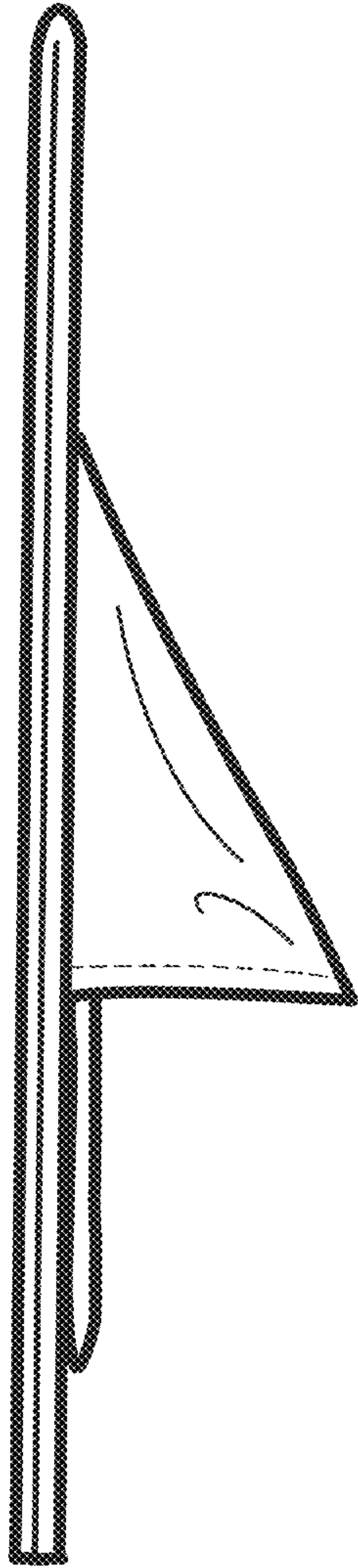

FIG. 6

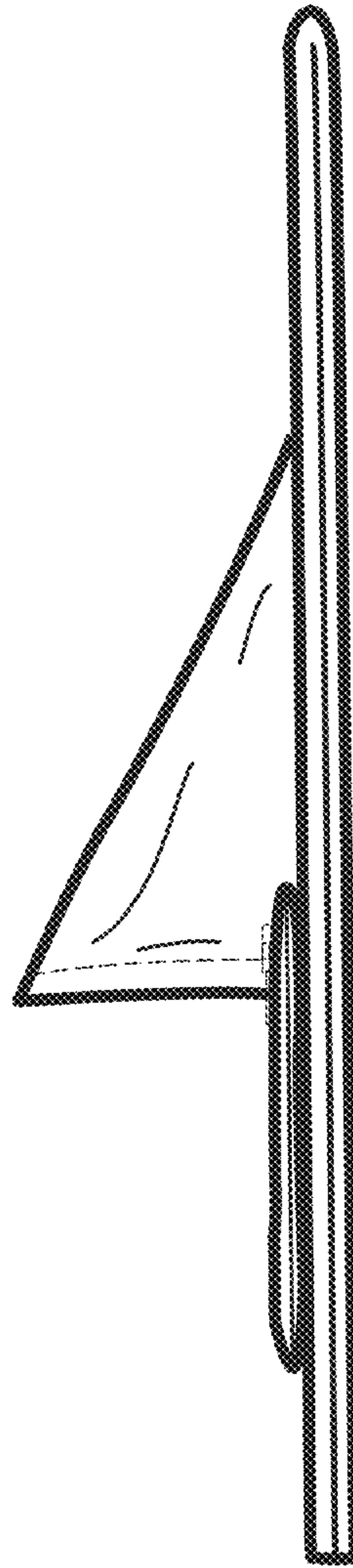

FIG. 7