



US00D953114S

(12) **United States Design Patent**
Sebastian Azpiazu et al.

(10) **Patent No.:** **US D953,114 S**
(45) **Date of Patent:** **** May 31, 2022**

(54) **BOTTLE**

(71) Applicant: **LEKUE, S.L.**, Barcelona (ES)
(72) Inventors: **Rafael Sebastian Azpiazu**, Barcelona (ES); **Luis Cortegoso Marquez**, Barcelona (ES); **Guido Mancini**, Barcelona (ES)

(**) Term: **15 Years**

(21) Appl. No.: **29/700,967**

(22) Filed: **Aug. 7, 2019**

(51) **LOC (13) Cl.** **07-01**

(52) **U.S. Cl.**
USPC **D7/510; D9/503; D9/531**

(58) **Field of Classification Search**
USPC D9/422, 428, 500–505, 549, 557, 558, D9/575, 716, 737–747; D7/510, 511, 608
CPC .. B65D 41/04; B65D 23/0885; B65D 1/0261; A47G 23/0241; A47G 19/2205
See application file for complete search history.

(56) **References Cited**

U.S. PATENT DOCUMENTS

D327,818 S *	7/1992	Haralson	D7/511
D429,119 S *	8/2000	Hurlbut	D7/608
D444,702 S *	7/2001	Castleberry, II	D9/746
D456,266 S *	4/2002	Cross	D9/504
D512,874 S *	12/2005	Poulson	D7/510
D651,086 S *	12/2011	Gullickson	D9/504
D672,609 S *	12/2012	Aziz	D7/510
D695,616 S *	12/2013	Li	D9/503
D696,117 S *	12/2013	Lee	D9/500
D703,000 S *	4/2014	Marina	D9/503
D703,487 S *	4/2014	Marina	D9/500

(Continued)

FOREIGN PATENT DOCUMENTS

GB	4043655	*	1/2016
GB	6052735	*	1/2019

(Continued)

OTHER PUBLICATIONS

Raven1, Jun. 16, 2019, Bindle Bottle 24oz Glacier Blue Amazon.com Product Review Post, URL: https://www.amazon.com/Bindle-Stainless-Integrated-Compartment-Eco-Friendly/dp/B07CJ1GH6G/ref=sr_1_3?dchild=1&keywords=water%2Bbottle%2Bwith%2Bstorage%2Bcompartment&qid=1631909178&sr=8-3&th=1 (Year: 2019).*

Primary Examiner — Brett Miller

Assistant Examiner — Rani J Abdallah

(74) *Attorney, Agent, or Firm* — Eugenio J. Torres-Oyola; Rafael Rodriguez-Muriel; Victor M. Rodriguez-Reyes

(57) **CLAIM**

The ornamental design for a bottle, as shown and described.

DESCRIPTION

FIG. 1 is an exploded perspective view of a bottle, showing the present design;
FIG. 2 is a rear perspective view of the present design;
FIG. 3 is a side view of the present design;
FIG. 4 is a rear view of the present design;
FIG. 5 is a front view of the present design;
FIG. 6 is a top view of the present design;
FIG. 7 is a bottom view of the present design;
FIG. 8 is a second exploded perspective view containing additional components of a bottle, showing the present design;
FIG. 9 is a rear perspective view of the present design;
FIG. 10 is a side view of the present design;
FIG. 11 is a rear view of some components of the present design;
FIG. 12 is a front view of the present design;
FIG. 13 is a top view of the present design; and,
FIG. 14 is a bottom view of the present design.
The broken lines are included for the purpose of illustrating environmental structures and form no part of the claimed design.

1 Claim, 14 Drawing Sheets

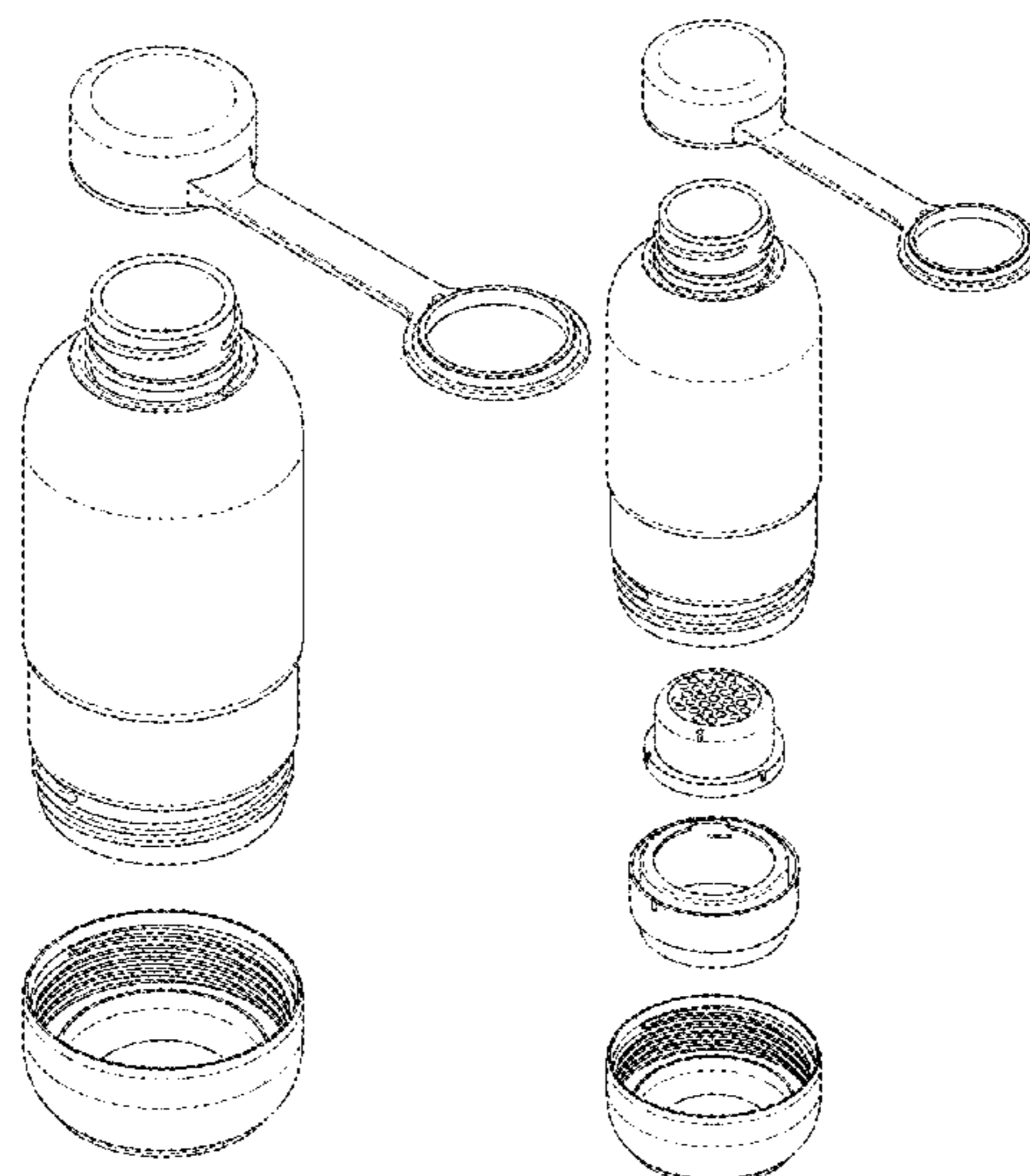

(56)

References Cited

U.S. PATENT DOCUMENTS

D709,387 S * 7/2014 Marina D9/738
 D723,333 S * 3/2015 Lin D7/511
 D724,385 S * 3/2015 Hurley D7/511
 D727,171 S * 4/2015 Marina D9/738
 D739,740 S * 9/2015 Sturdevant D9/504
 D753,442 S * 4/2016 Weernink D7/510
 D756,797 S * 5/2016 Fine D9/500
 D764,232 S * 8/2016 Marina D9/740
 D790,920 S * 7/2017 Goodwin D7/510
 D803,064 S * 11/2017 Marina D9/537
 D804,906 S * 12/2017 Diener D7/510
 D807,177 S * 1/2018 Belinsky D9/500
 D811,818 S * 3/2018 Wu D7/510
 D812,428 S * 3/2018 Wu D7/510
 D814,241 S * 4/2018 Nickley D7/510
 D820,043 S * 6/2018 Leslie-Shattenkirk
 B65D 1/0276
 D820,091 S * 6/2018 Phillips D9/503
 D823,537 S * 7/2018 Beaver D9/504
 D828,723 S * 9/2018 Gauss D7/510
 D829,101 S * 9/2018 Spivey D9/504
 D832,650 S * 11/2018 Diebel D7/511
 D833,230 S * 11/2018 Libby D7/608
 D838,141 S * 1/2019 Bertsch D7/510
 D839,674 S * 2/2019 Lyu D7/511
 D839,683 S * 2/2019 Wong D7/608
 D839,741 S * 2/2019 Hawry D9/504
 D842,108 S * 3/2019 Latour D9/500
 D842,700 S * 3/2019 Blomberg D9/500
 D845,131 S * 4/2019 Moretti D9/500
 D851,996 S * 6/2019 Umholtz D7/511
 D852,001 S * 6/2019 Campbell D7/608
 D856,082 S * 8/2019 Yao D7/507
 D857,456 S * 8/2019 Bell D7/511

D860,806 S * 9/2019 Phillips D9/503
 D861,430 S * 10/2019 Yueh D7/510
 D862,993 S * 10/2019 Allsop D7/608
 D865,450 S * 11/2019 Jacobsen D7/511
 D866,259 S * 11/2019 Jacobsen D7/511
 D866,260 S * 11/2019 Jacobsen D7/511
 D867,068 S * 11/2019 Jacobsen D7/511
 D867,519 S * 11/2019 Furgurson D9/503
 D867,820 S * 11/2019 Jacobsen D7/511
 D868,537 S * 12/2019 Jacobsen D7/511
 D868,538 S * 12/2019 Jacobsen D7/511
 D869,909 S * 12/2019 Campbell D7/608
 D870,371 S * 12/2019 Storz D9/503
 D871,840 S * 1/2020 Meyers D7/510
 D871,844 S * 1/2020 Adams, Jr. D7/510
 D878,863 S * 3/2020 Ke D7/510
 D885,836 S * 6/2020 Wang D7/510
 D891,867 S * 8/2020 Faria D7/510
 D901,250 S * 11/2020 McCabe D7/511
 D906,761 S * 1/2021 Lundstrom D7/511
 D908,430 S * 1/2021 McCabe D7/510
 D912,515 S * 3/2021 Alvarez D9/503
 D917,231 S * 4/2021 Wang D7/510
 D917,969 S * 5/2021 Eyal D7/511
 D918,041 S * 5/2021 Huaping D9/504
 D922,829 S * 6/2021 Campbell D7/608
 2011/0259843 A1 * 10/2011 Wu B65D 23/0885
 215/12.1
 2017/0073110 A1 * 3/2017 Campbell B65D 41/0414
 2019/0075913 A1 * 3/2019 Huang A47J 31/005
 2019/0375548 A1 * 12/2019 Campbell B65D 81/3876

FOREIGN PATENT DOCUMENTS

GB 6057005 * 3/2019
 WO D100409-001 * 4/2018

* cited by examiner

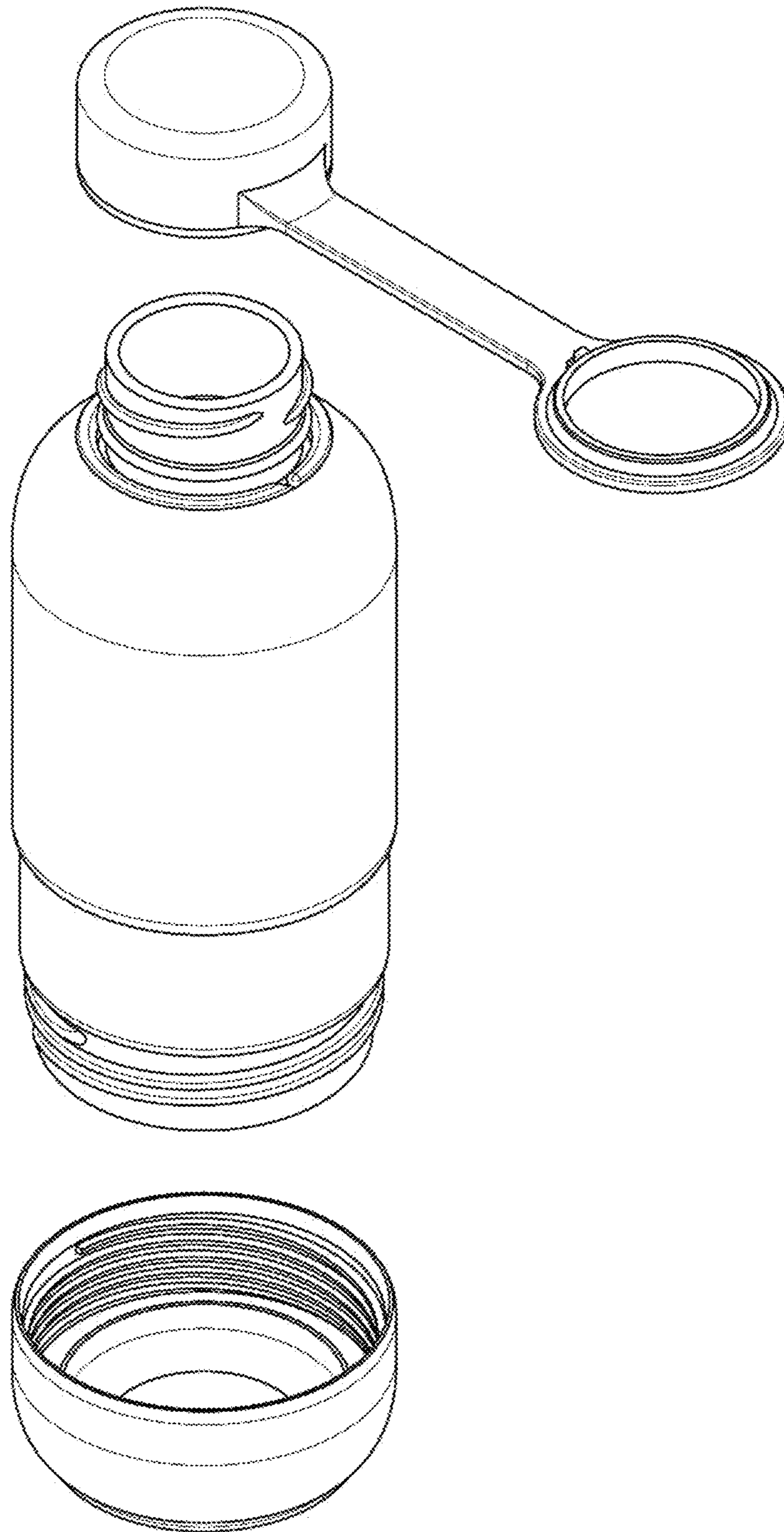

Fig. 1

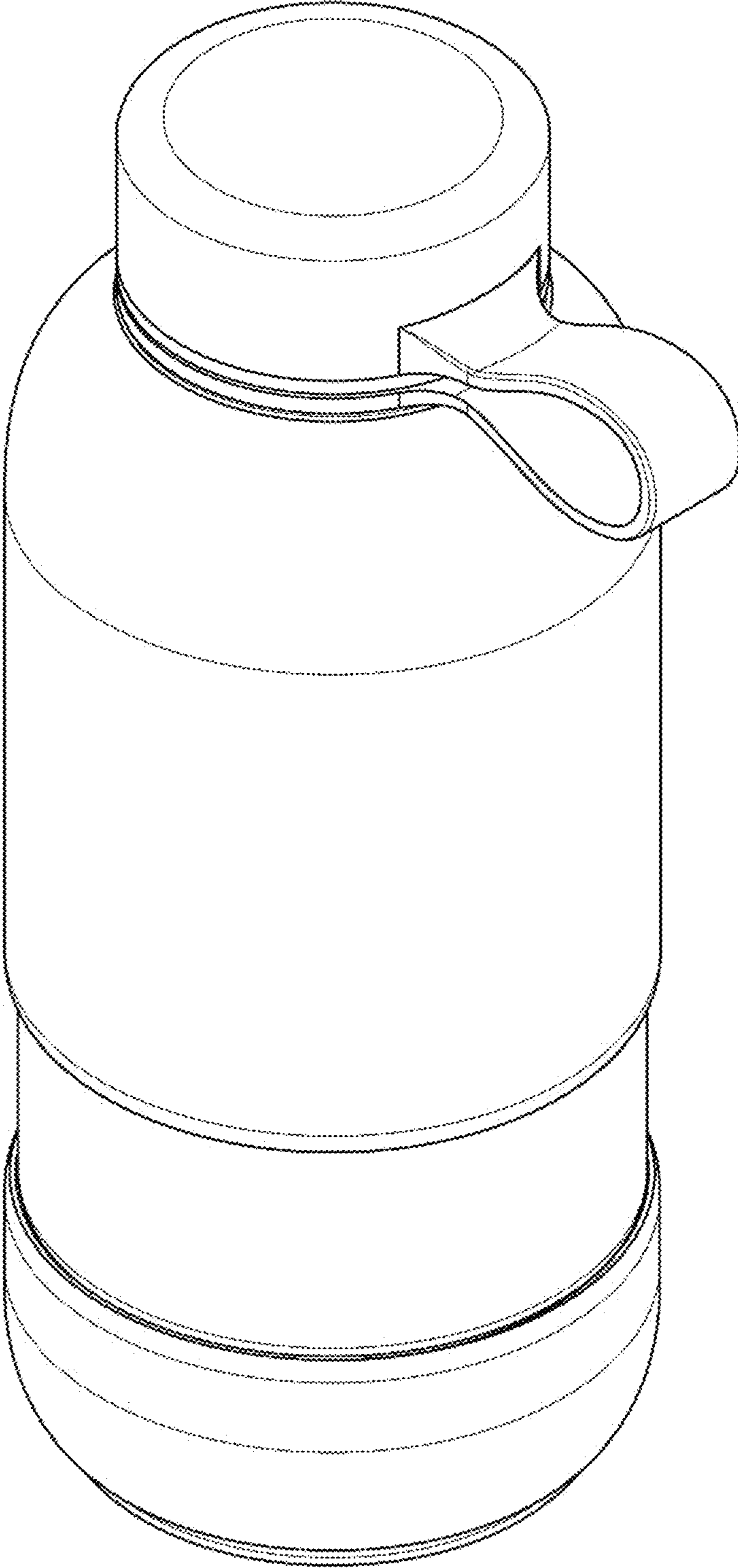

Fig. 2

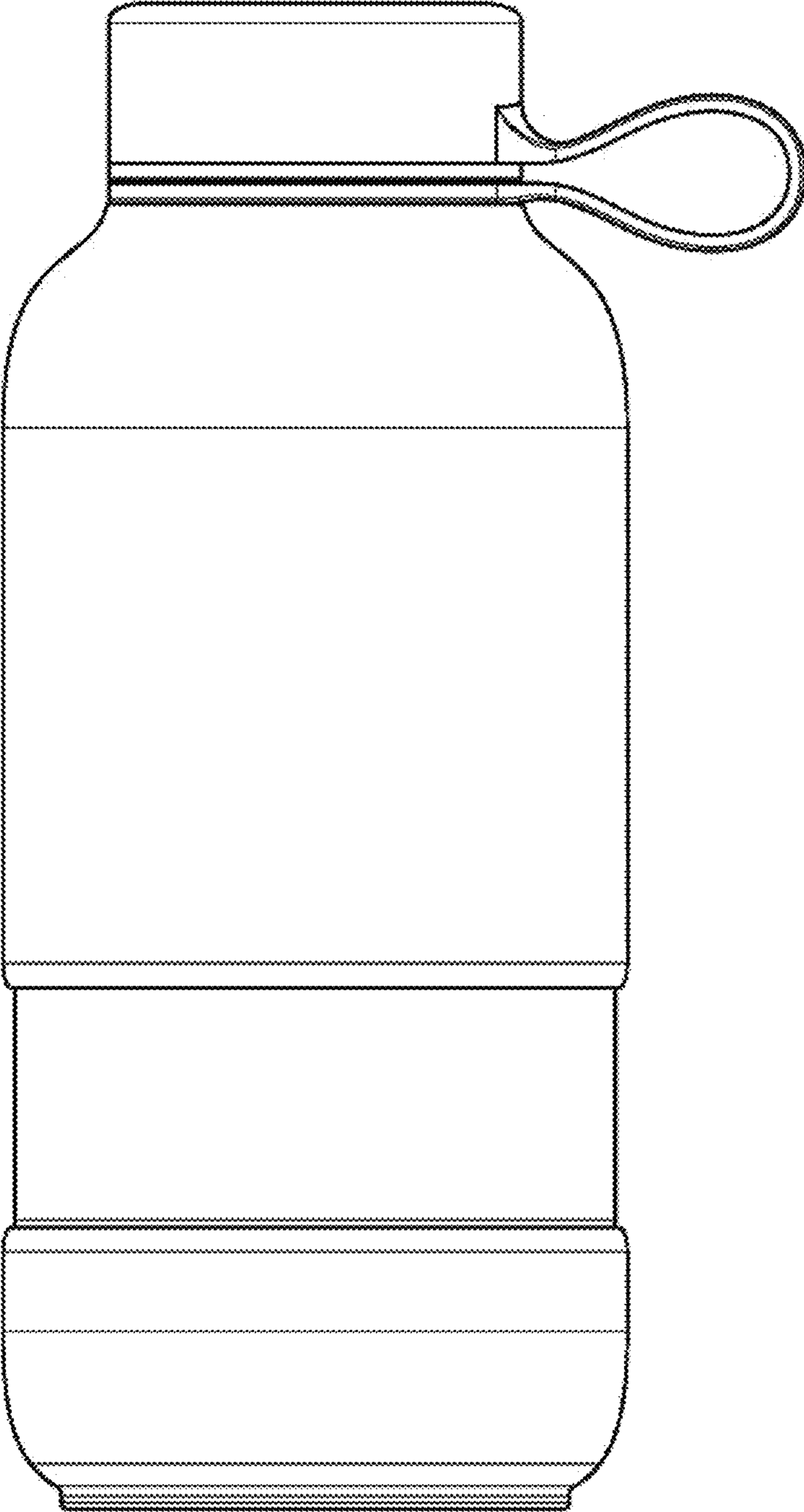

Fig. 3

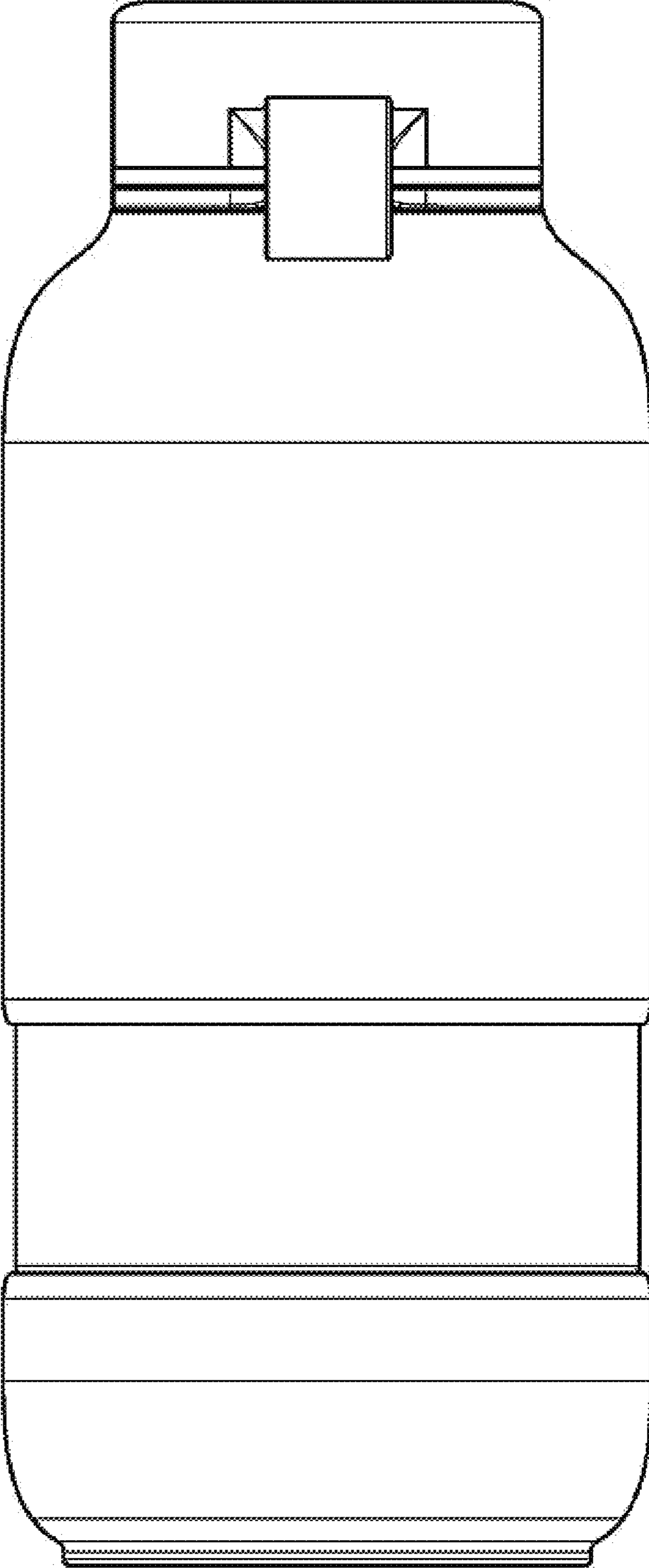

Fig. 4

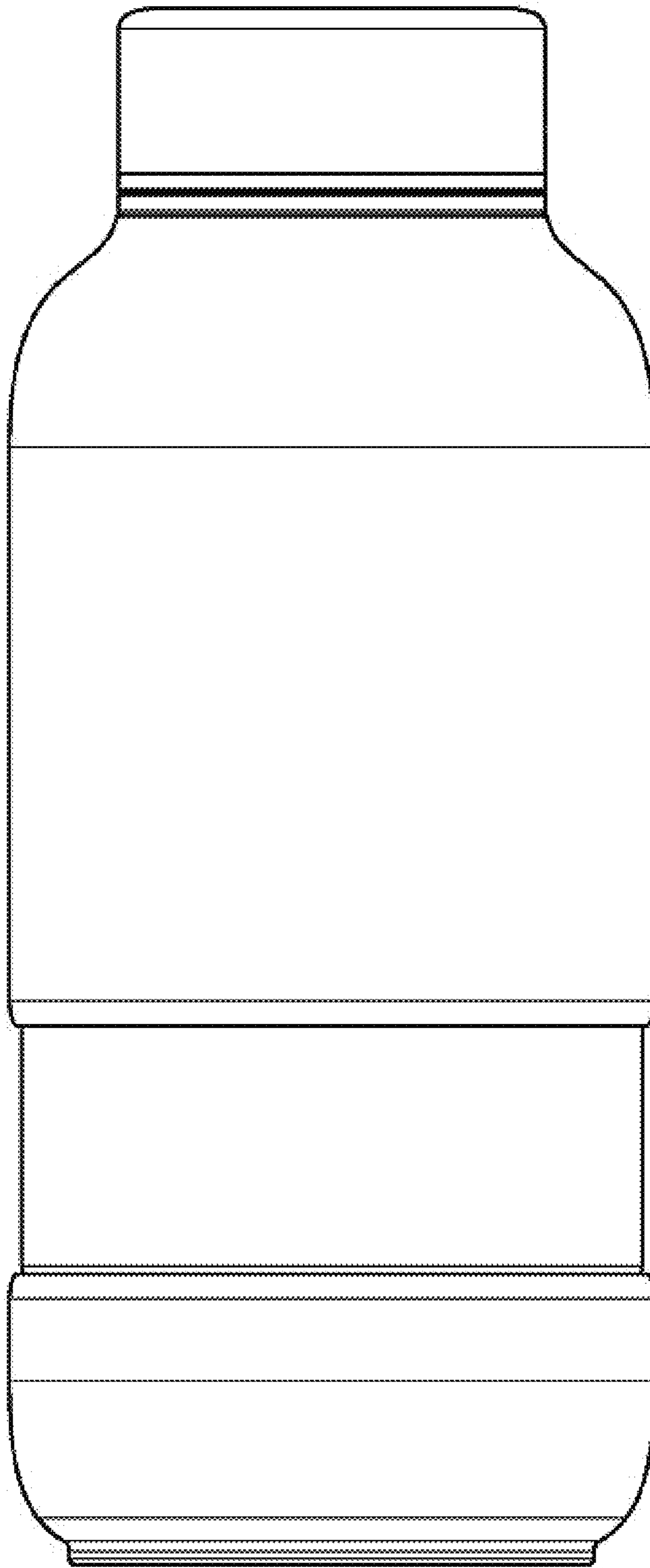

Fig. 5

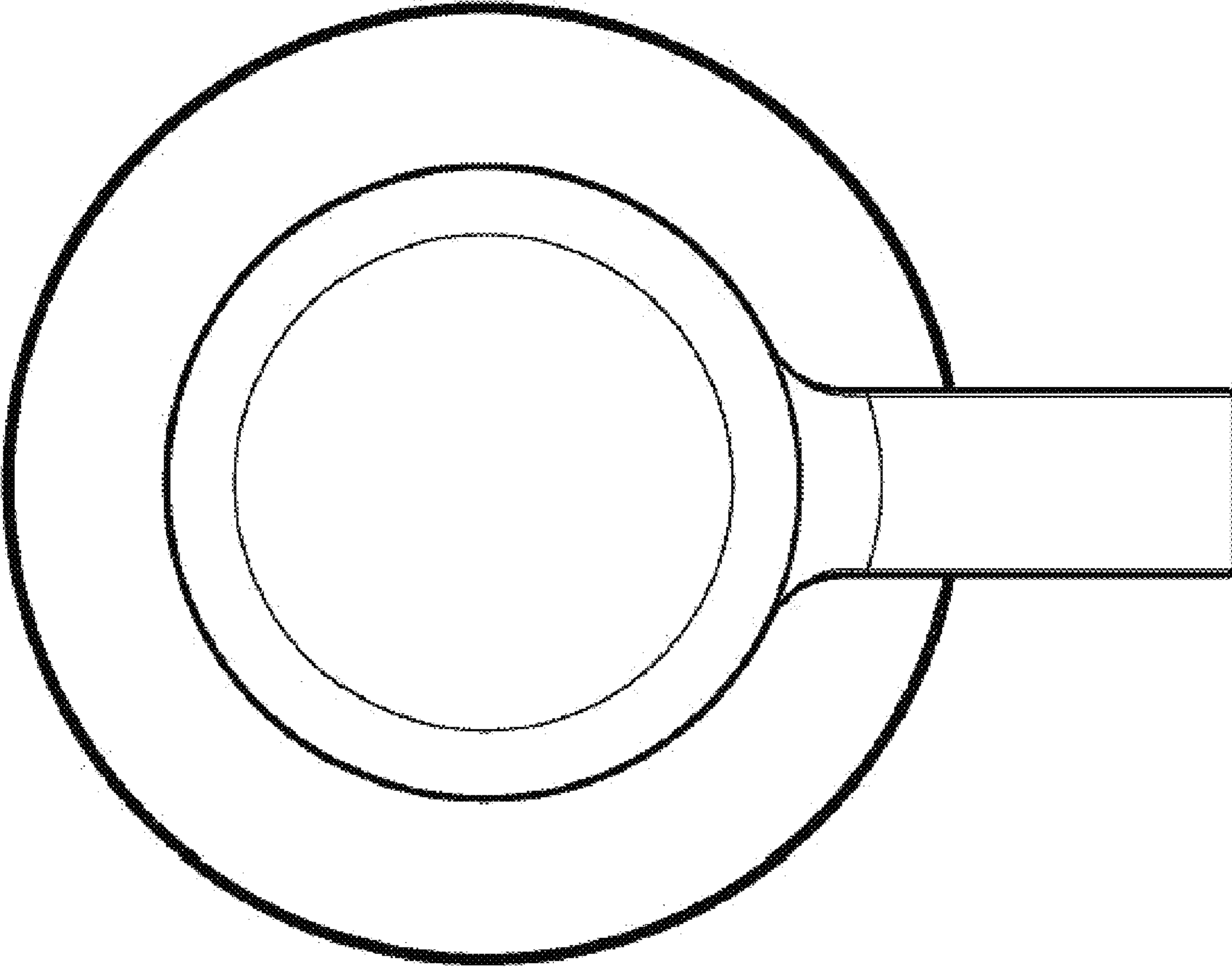

Fig. 6

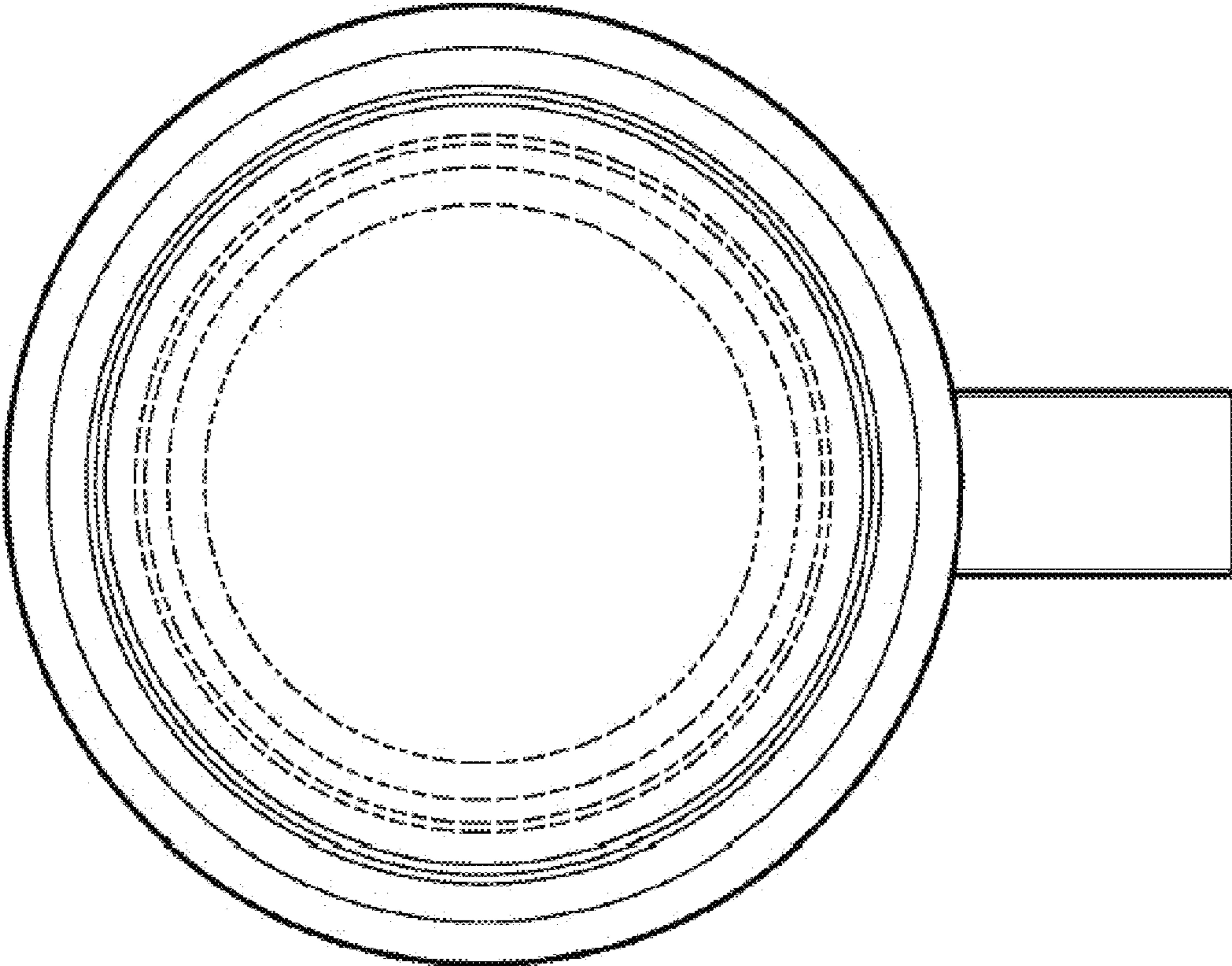

Fig. 7

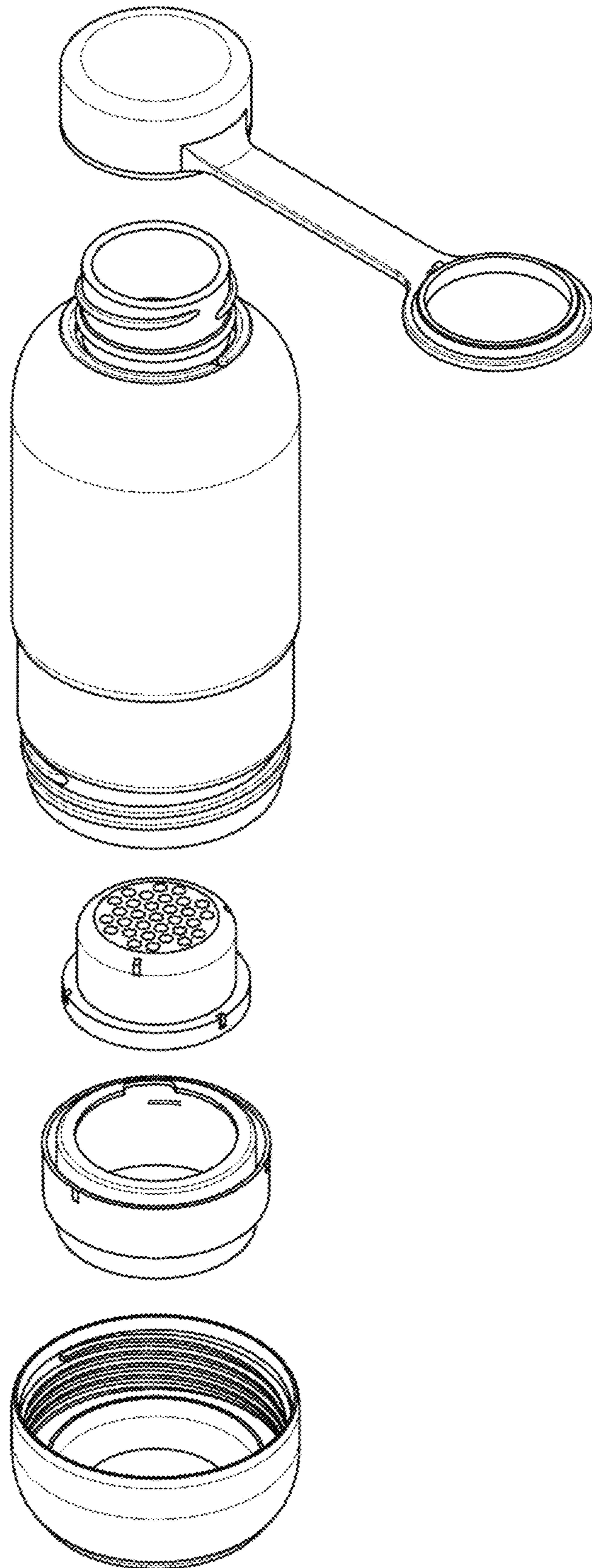

Fig. 8

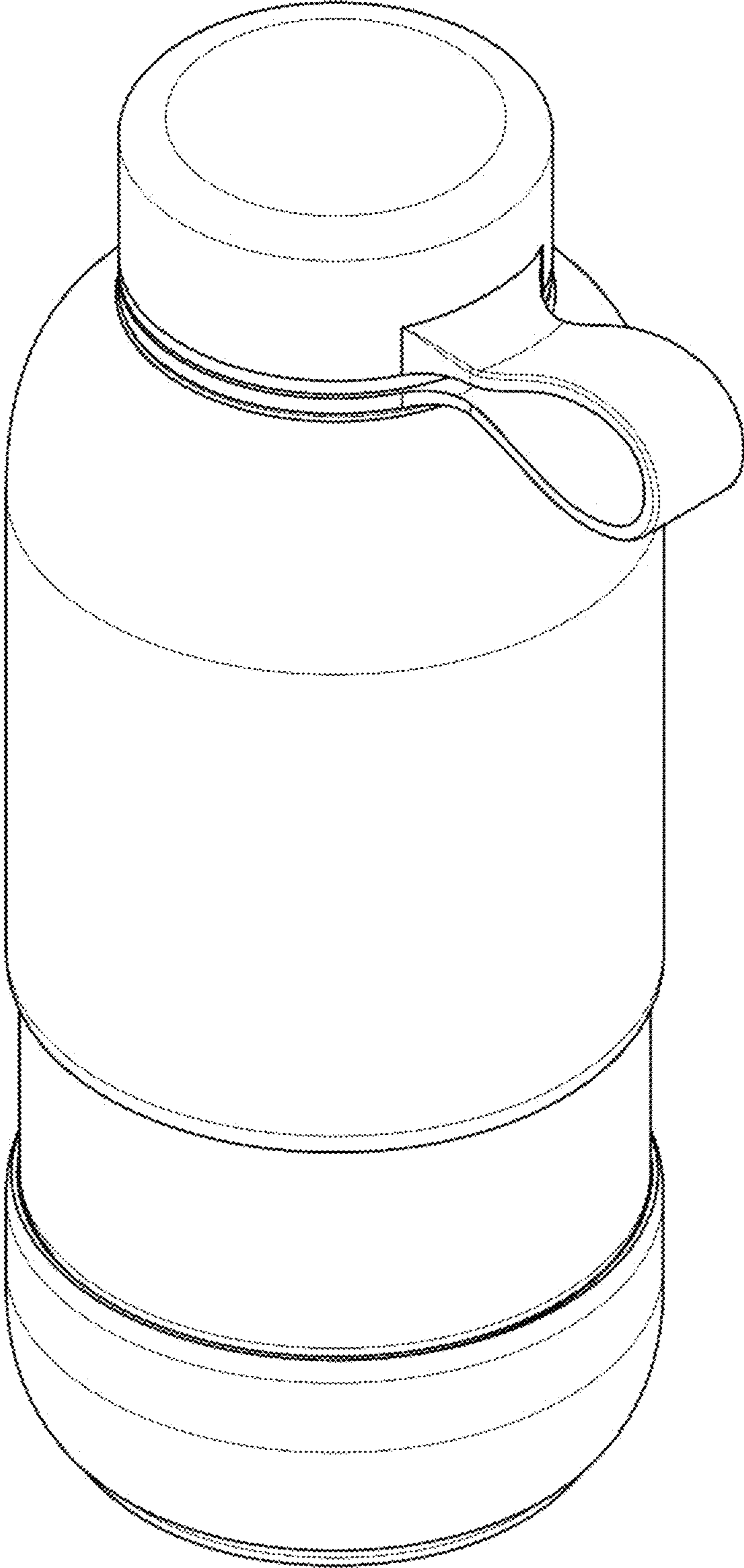

Fig. 9

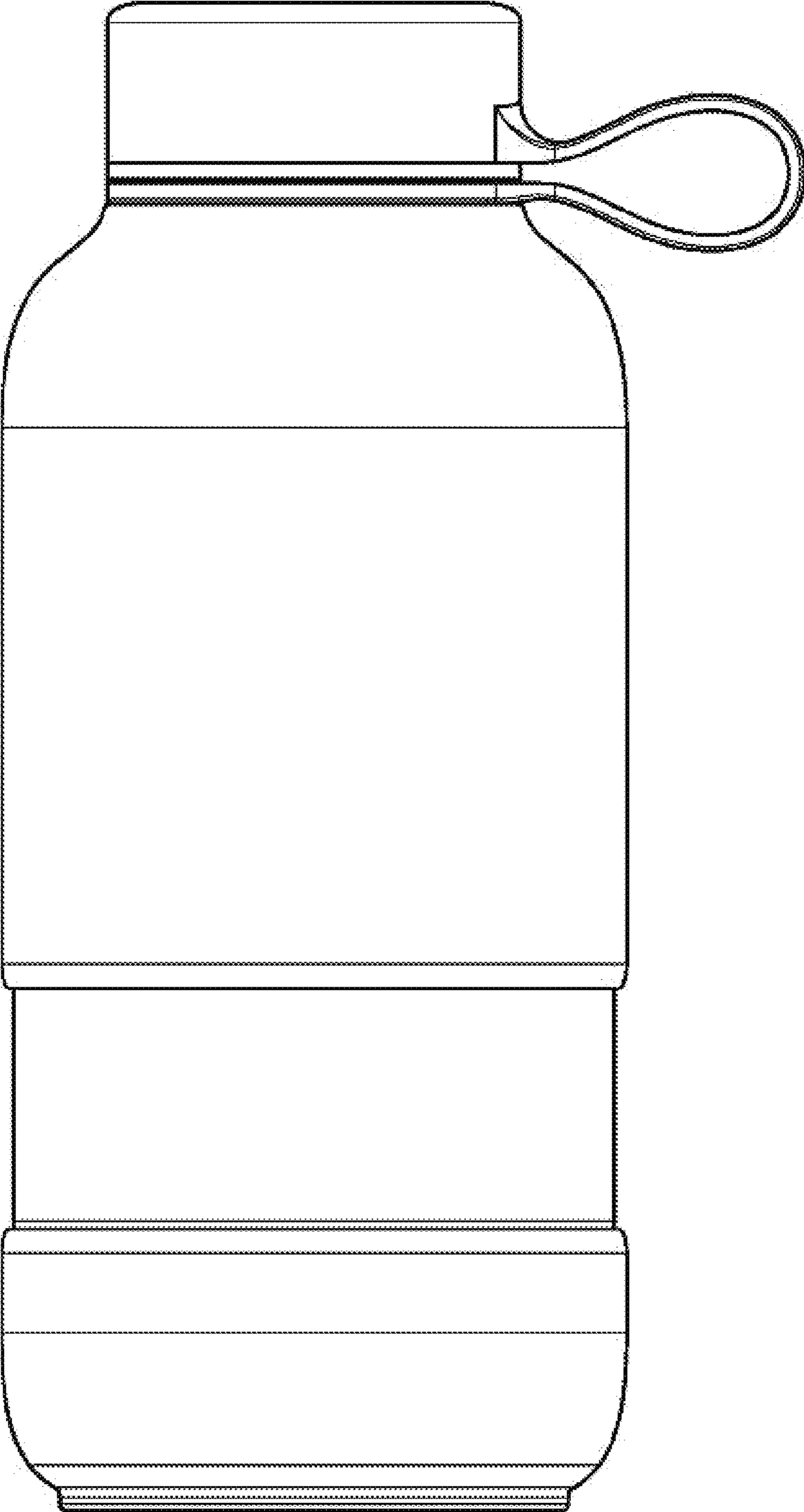

Fig. 10

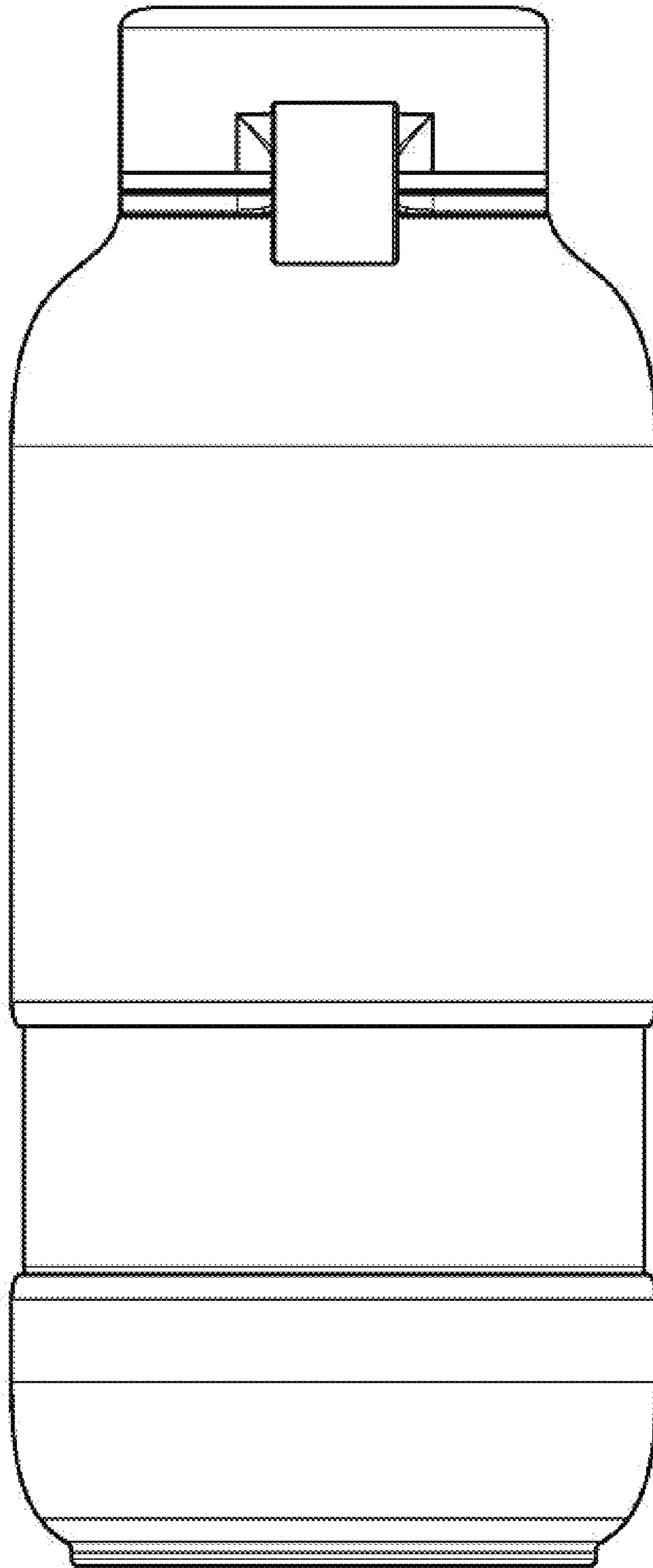

Fig. 11

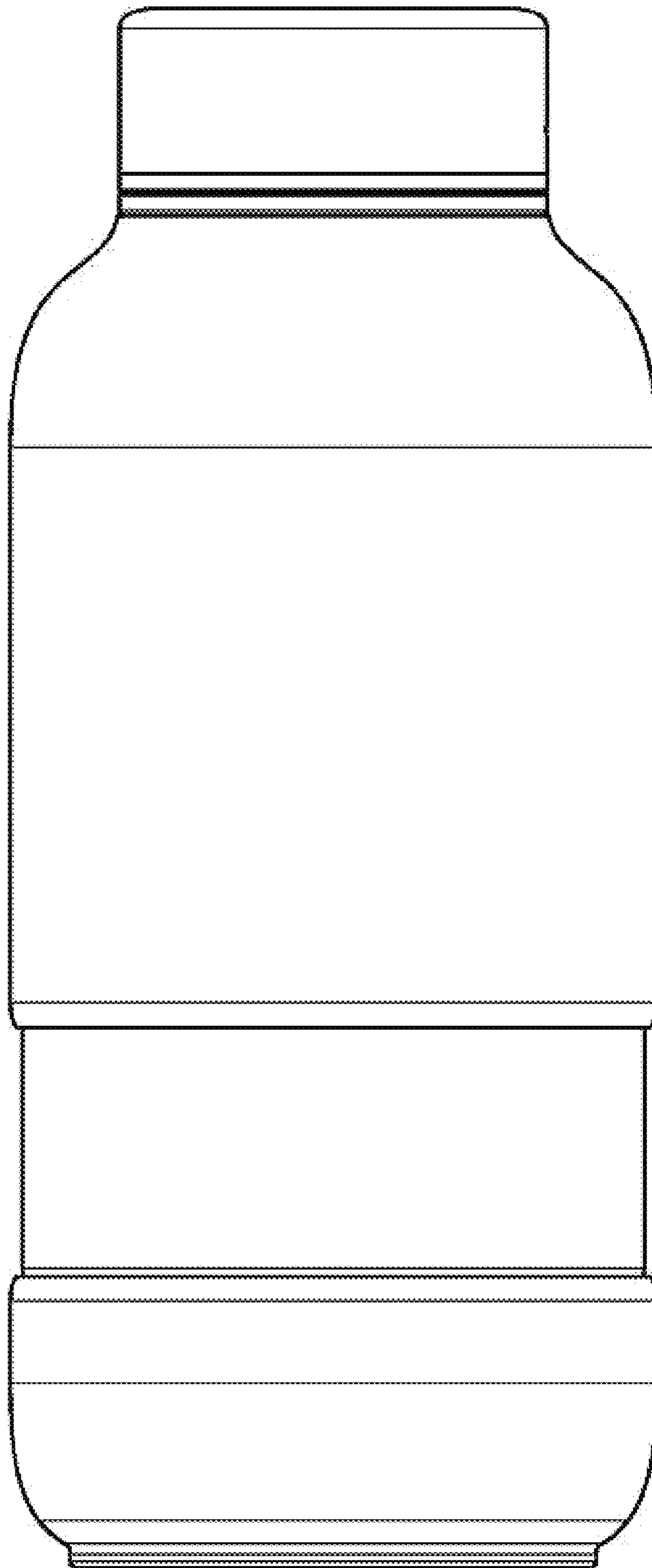

Fig. 12

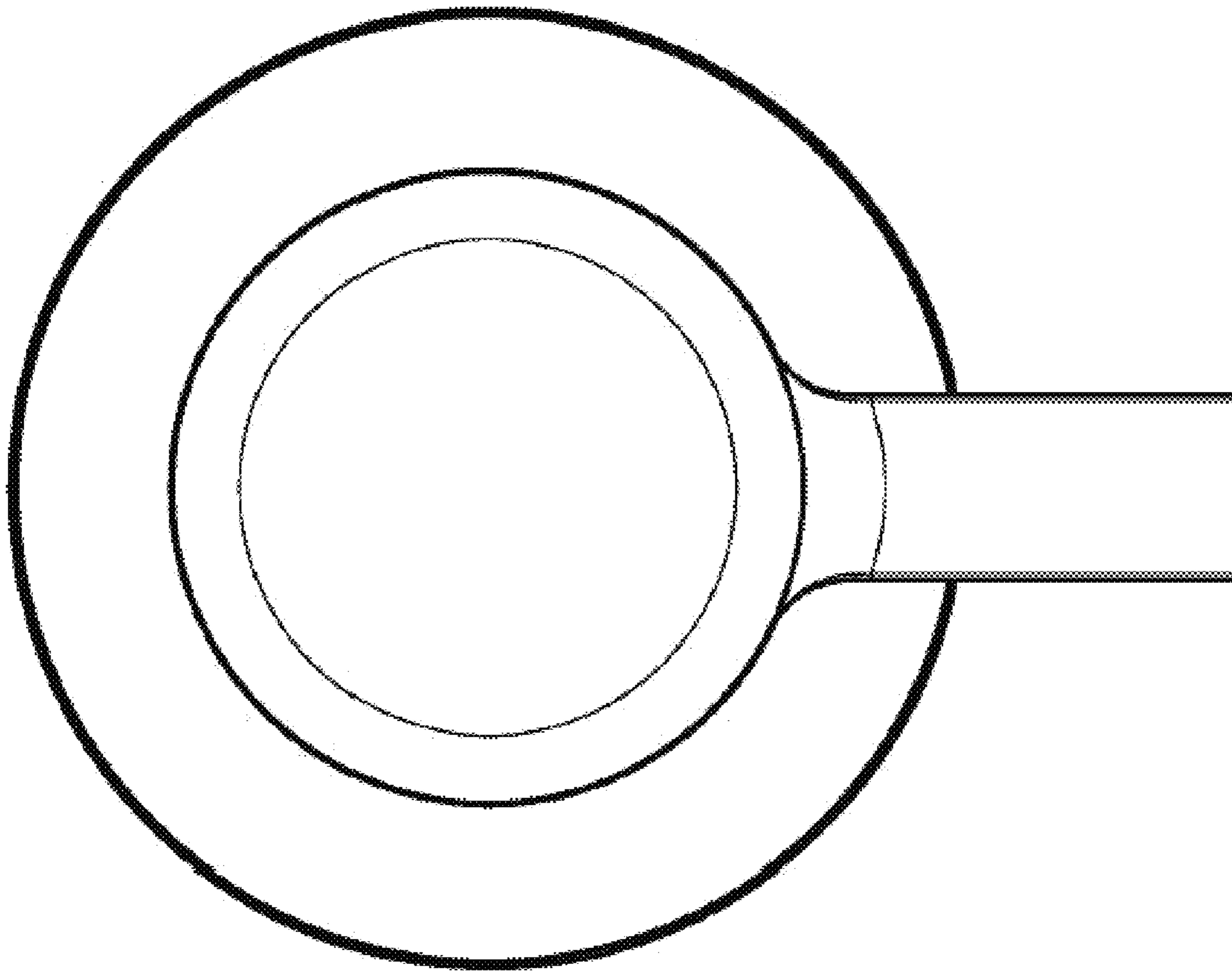

Fig. 13

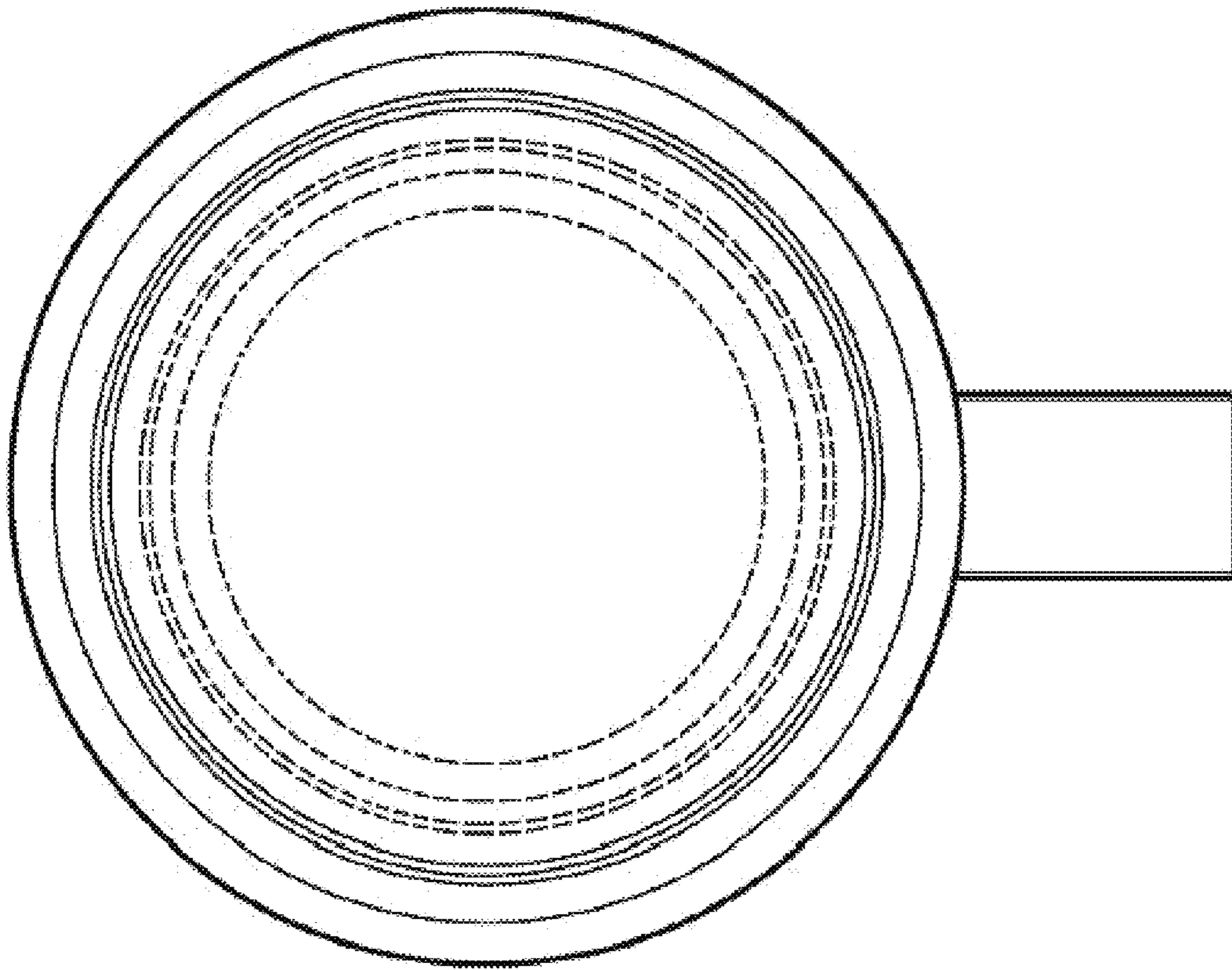

Fig. 14