



US00D950419S

(12) **United States Design Patent**  
**Lou et al.**

(10) **Patent No.:** **US D950,419 S**

(45) **Date of Patent:** **\*\* May 3, 2022**

- (54) **ALL-TERRAIN VEHICLE**
- (71) Applicant: **ZHEJIANG TAOTAO VEHICLES CO., LTD.**, Lishui (CN)
- (72) Inventors: **Guidong Lou**, Lishui (CN); **Jie Xu**, Lishui (CN); **Junhui Li**, Lishui (CN); **Weihao Liu**, Lishui (CN); **Yali Ying**, Lishui (CN)
- (73) Assignee: **ZHEJIANG TAOTAO VEHICLES CO., LTD.**, Lishui (CN)
- (\*\*) Term: **15 Years**
- (21) Appl. No.: **29/758,899**
- (22) Filed: **Nov. 19, 2020**

- D374,416 S \* 10/1996 Miyamoto ..... D12/107
- D383,095 S \* 9/1997 Miyamoto ..... D12/107
- D405,029 S \* 2/1999 Deutschman ..... D12/107
- D421,935 S \* 3/2000 Fujieda ..... D12/107
- D428,363 S \* 7/2000 Sugimoto ..... D12/107
- D429,663 S \* 8/2000 Tamashima ..... D12/107
- D436,559 S \* 1/2001 Fujieda ..... D12/107
- D480,991 S \* 10/2003 Rondeau ..... D12/107
- D492,916 S \* 7/2004 Rondeau ..... D12/107
- D493,750 S \* 8/2004 Crepeau ..... D12/107
- D496,308 S \* 9/2004 Wu ..... D12/107
- D511,717 S \* 11/2005 Lin ..... D12/107
- D513,718 S \* 1/2006 Itaya ..... D12/107
- D516,467 S \* 3/2006 Wu ..... D12/107
- D517,951 S \* 3/2006 Luh ..... D12/107
- D517,952 S \* 3/2006 Luh ..... D12/107
- D518,759 S \* 4/2006 Kettler ..... D12/107
- D520,912 S \* 5/2006 Knight ..... D12/107
- D520,914 S \* 5/2006 Luh ..... D12/107

(Continued)

**Related U.S. Application Data**

- (62) Division of application No. 29/652,135, filed on May 18, 2020, now Pat. No. Des. 926,636.

**Foreign Application Priority Data**

- Nov. 18, 2019 (CN) ..... 201930635074.6
- Dec. 14, 2019 (CN) ..... 201930699606.2

- (51) **LOC (13) Cl.** ..... **12-11**

- (52) **U.S. Cl.**  
USPC ..... **D12/107**

- (58) **Field of Classification Search**  
USPC ..... D12/3, 86, 87, 107, 110  
CPC ..... B60K 5/12; B60K 13/04; B60K 17/354  
See application file for complete search history.

**References Cited**

**U.S. PATENT DOCUMENTS**

- D297,132 S \* 8/1988 Ryuzoji ..... D12/107
- D298,811 S \* 12/1988 Morita ..... D12/107
- D305,999 S \* 2/1990 Ueda ..... D12/107

*Primary Examiner* — Darlington Ly

(74) *Attorney, Agent, or Firm* — Schwegman Lundberg & Woessner, P.A.

(57) **CLAIM**

The ornamental design for an all-terrain vehicle, as shown and described.

**DESCRIPTION**

FIG. 1 is a front perspective view of an all-terrain vehicle embodying our new design;  
 FIG. 2 is rear perspective view thereof;  
 FIG. 3 is a front elevation view thereof;  
 FIG. 4 is a rear elevation view thereof;  
 FIG. 5 is a left side elevation view thereof;  
 FIG. 6 is a right side elevation view thereof;  
 FIG. 7 is a top plan view thereof; and,  
 FIG. 8 is a bottom plan view thereof.

The broken lines in the drawings illustrate portions of the all-terrain vehicle that form no part of the claimed design.

**1 Claim, 8 Drawing Sheets**

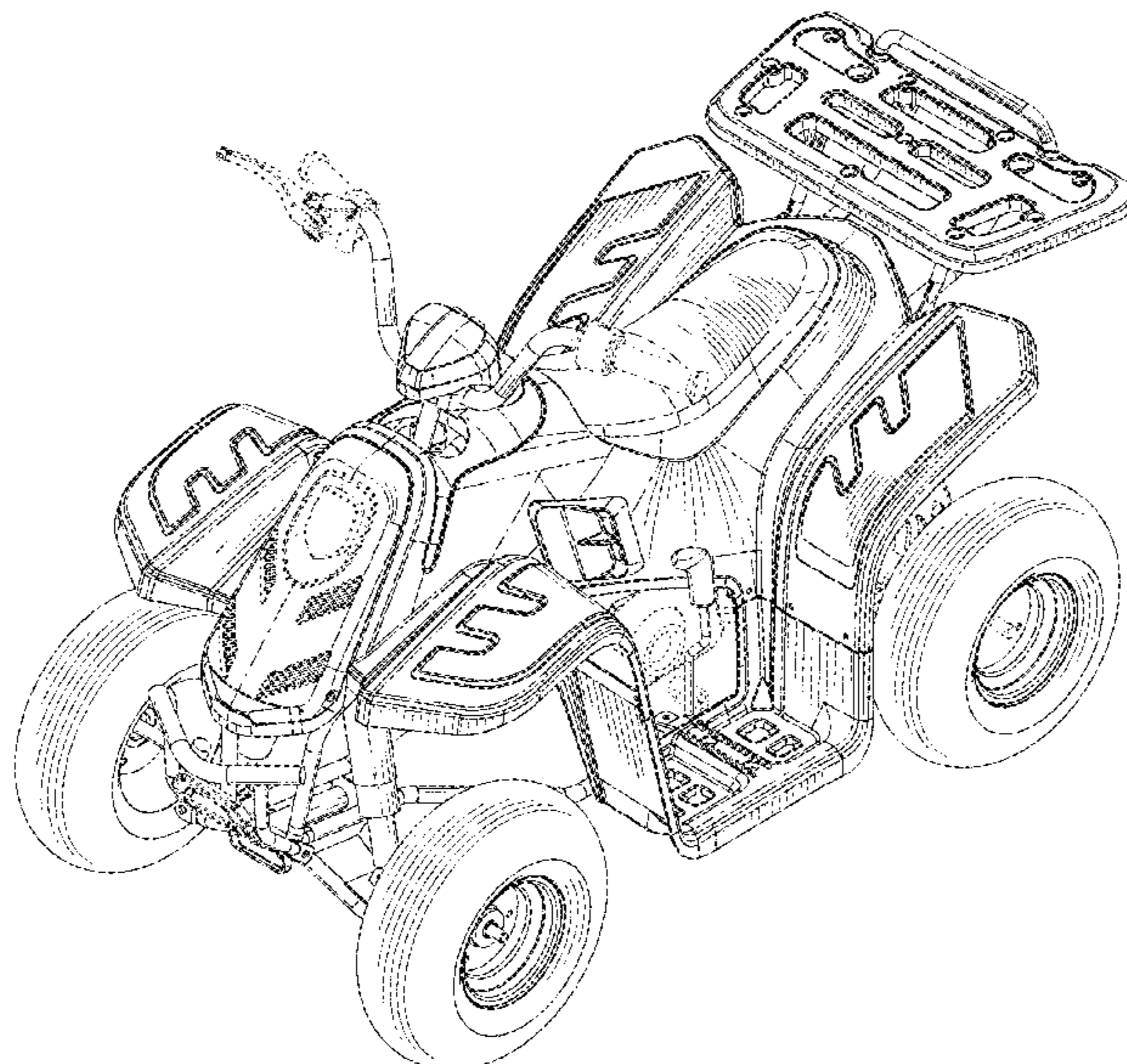

(56)

References Cited

U.S. PATENT DOCUMENTS

D522,924 S *	6/2006	Yokoyama	.....	D12/107	D628,520 S *	12/2010	Lin	.....	D12/107
D523,782 S *	6/2006	Lin	.....	D12/107	D638,755 S *	5/2011	Bracy	.....	D12/107
D529,414 S *	10/2006	Wu	.....	D12/107	D640,604 S *	6/2011	Lai	.....	D12/107
D531,088 S *	10/2006	Lin	.....	D12/107	D640,605 S *	6/2011	Lai	.....	D12/107
D532,339 S *	11/2006	Hishiki	.....	D12/107	D643,781 S *	8/2011	Nagao	.....	D12/107
D539,705 S *	4/2007	Ichikawa	.....	D12/107	D657,720 S *	4/2012	Eck	.....	D12/107
D542,186 S *	5/2007	Lai	.....	D12/107	D657,721 S *	4/2012	Miyanishi	.....	D12/107
D542,188 S *	5/2007	Miwa	.....	D12/107	D668,184 S *	10/2012	Tashiro	.....	D12/107
D561,064 S *	2/2008	Crepeau	.....	D12/107	D671,037 S *	11/2012	Wu	.....	D12/107
D584,661 S *	1/2009	Tanaka	.....	D12/107	D674,728 S *	1/2013	Matsumura	.....	D12/107
D585,792 S *	2/2009	Chao	.....	D12/107	D680,468 S *	4/2013	Li	.....	D12/107
D592,556 S *	5/2009	Mehra	.....	D12/107	D680,469 S *	4/2013	Li	.....	D12/107
D592,557 S *	5/2009	Mehra	.....	D12/107	D691,519 S *	10/2013	Fisher	.....	D12/107
D595,188 S *	6/2009	Tandrup	.....	D12/107	D694,671 S *	12/2013	Lai	.....	D12/107
D596,080 S *	7/2009	Lai	.....	D12/107	8,596,398 B2 *	12/2013	Bennett	.....	B60K 17/22 180/90.6
D597,890 S *	8/2009	Lai	.....	D12/107	D721,300 S *	1/2015	Li	.....	D12/107
D599,250 S *	9/2009	Hirano	.....	D12/107	D735,615 S *	8/2015	Itaya	.....	D12/107
D599,251 S *	9/2009	Yin	.....	D12/107	D751,467 S *	3/2016	Lai	.....	D12/107
D606,905 S *	12/2009	Yao	.....	D12/107	D761,698 S *	7/2016	Umemoto	.....	D12/107
D609,136 S *	2/2010	Renchuan	.....	D12/107	D774,955 S *	12/2016	Lai	.....	D12/107
D620,399 S *	7/2010	Wu	.....	D12/107	D774,957 S *	12/2016	Umemoto	.....	D12/107
					2014/0262584 A1 *	9/2014	Lovold	.....	B60K 13/04 180/246

\* cited by examiner

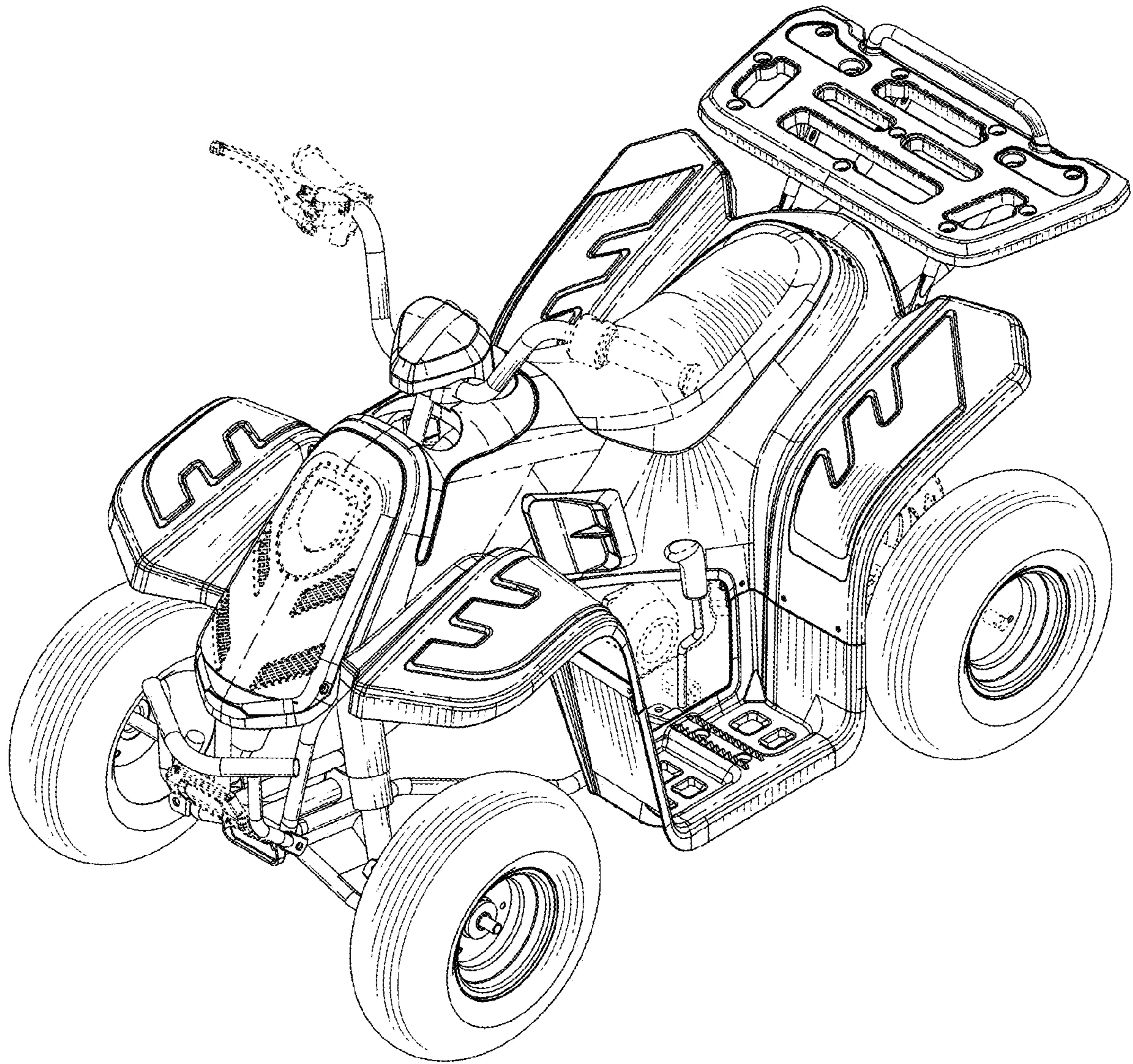

FIG. 1

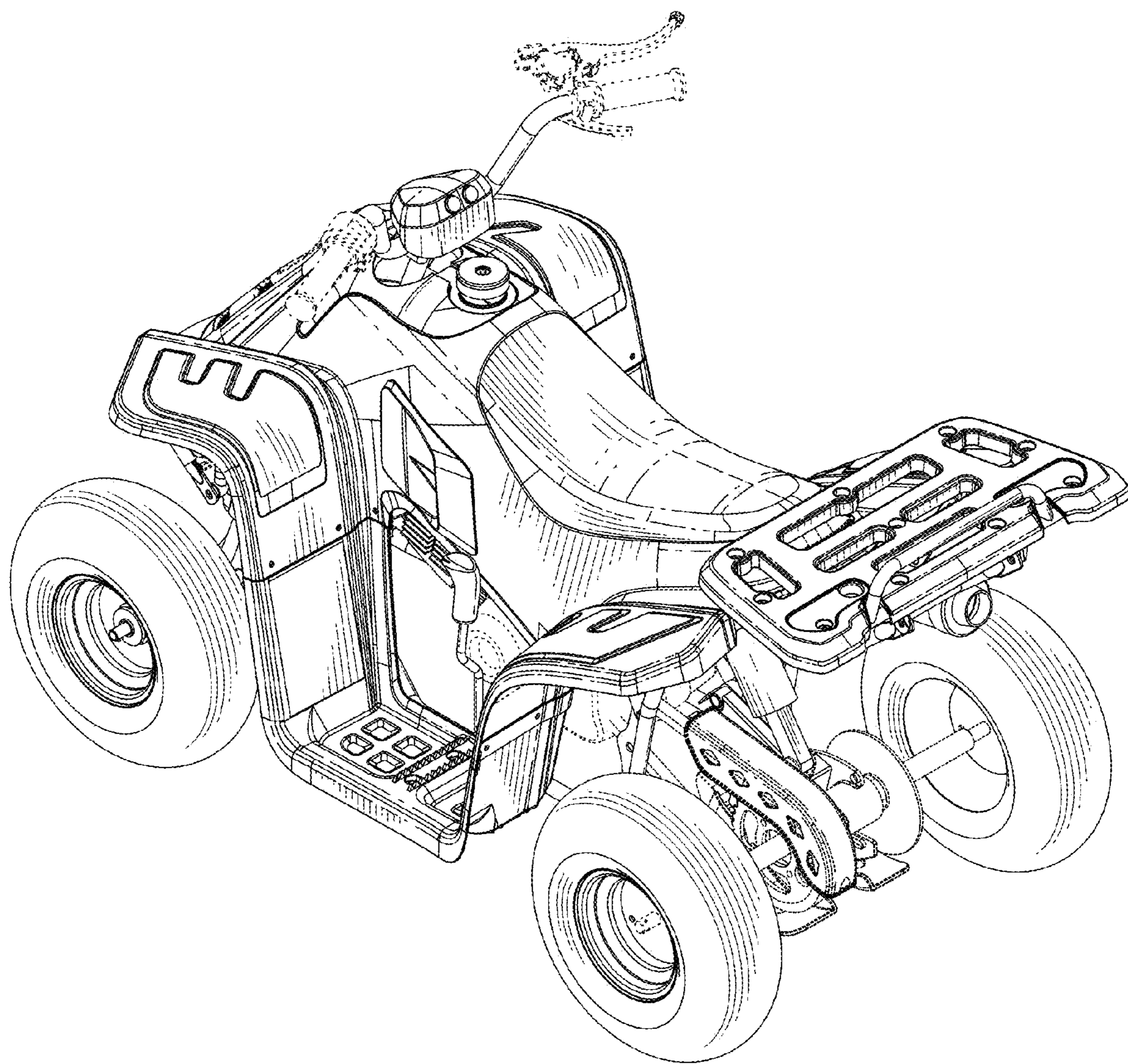

FIG. 2

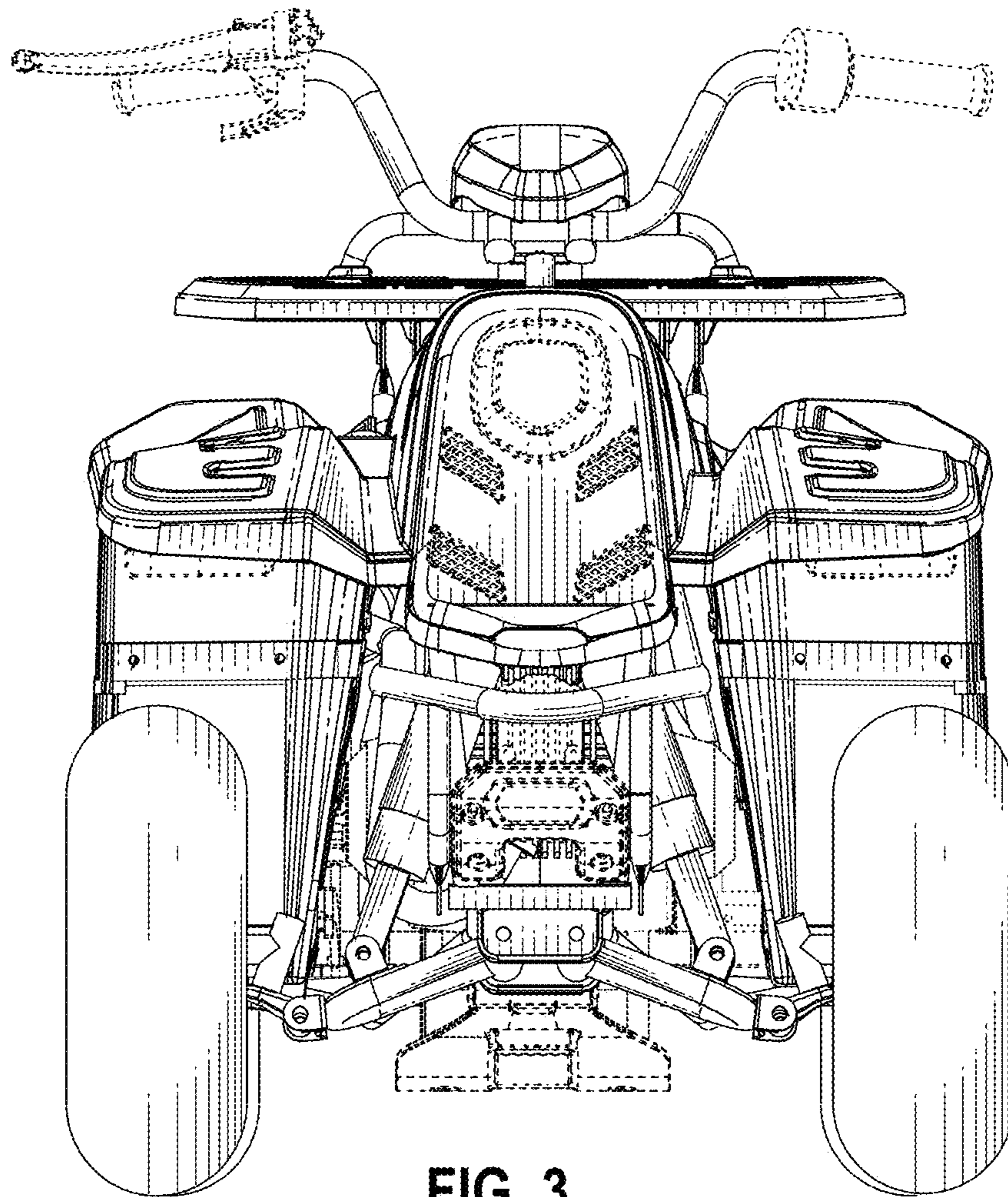

FIG. 3

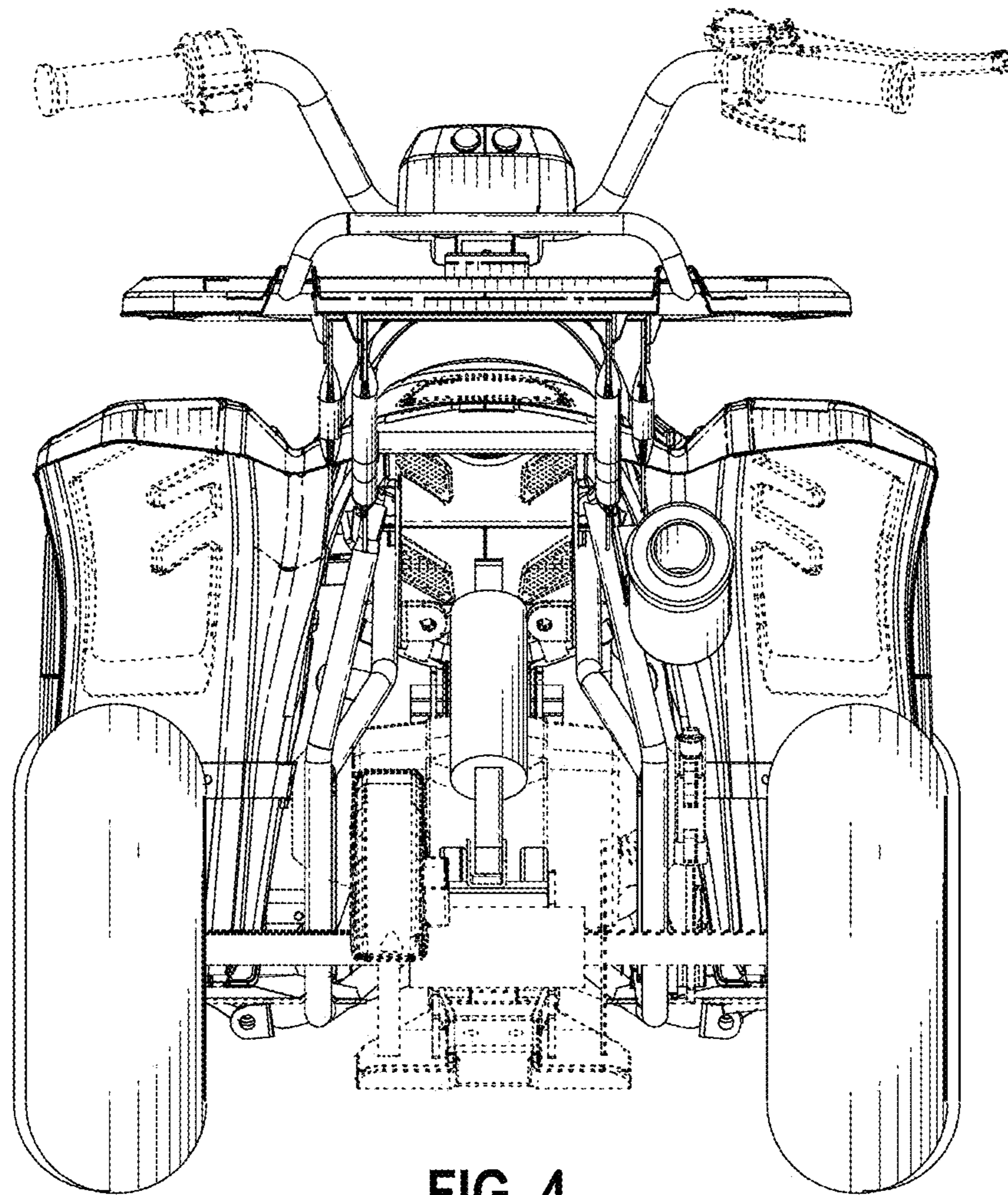

FIG. 4

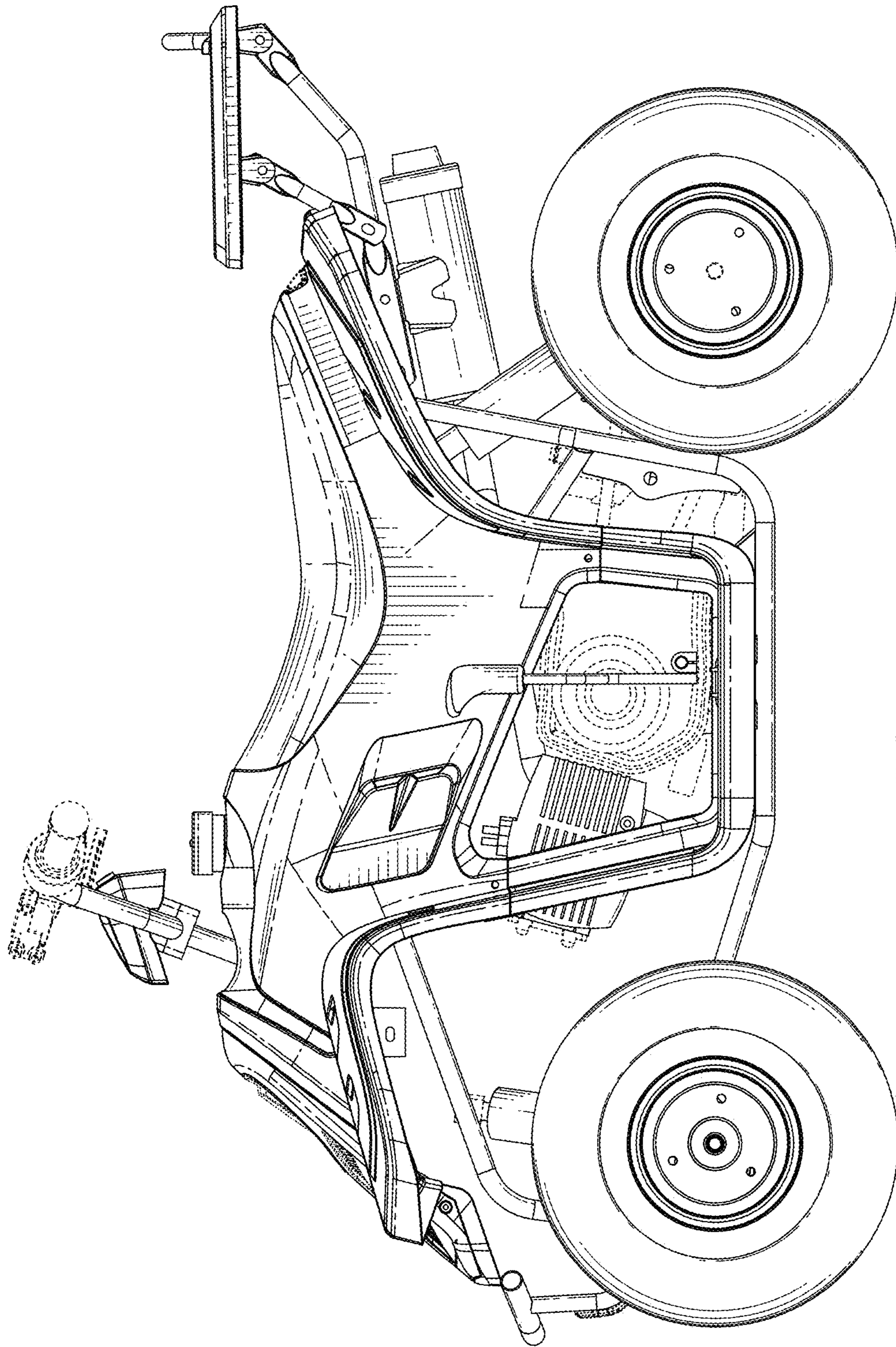

FIG. 5

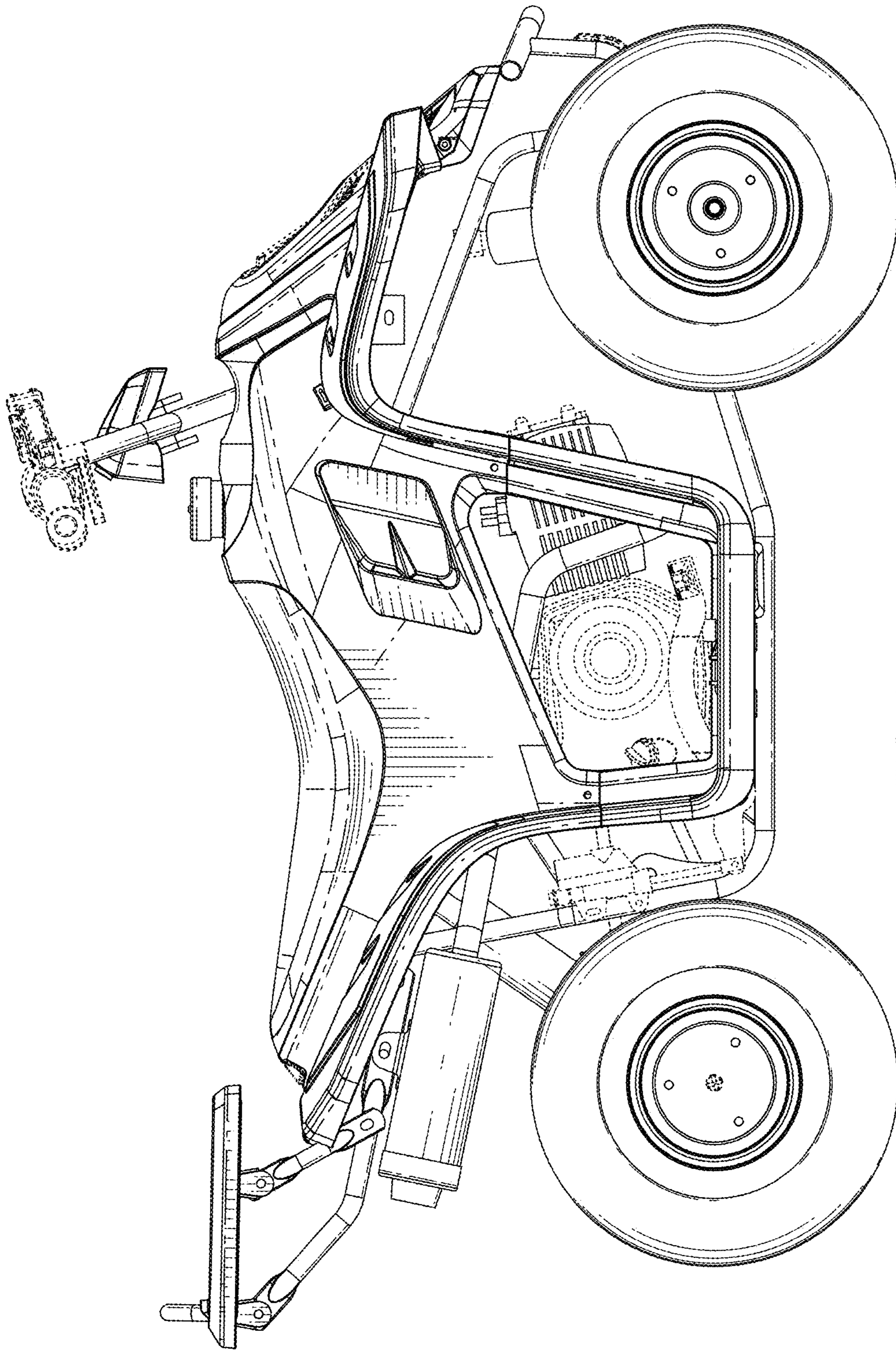

FIG. 6



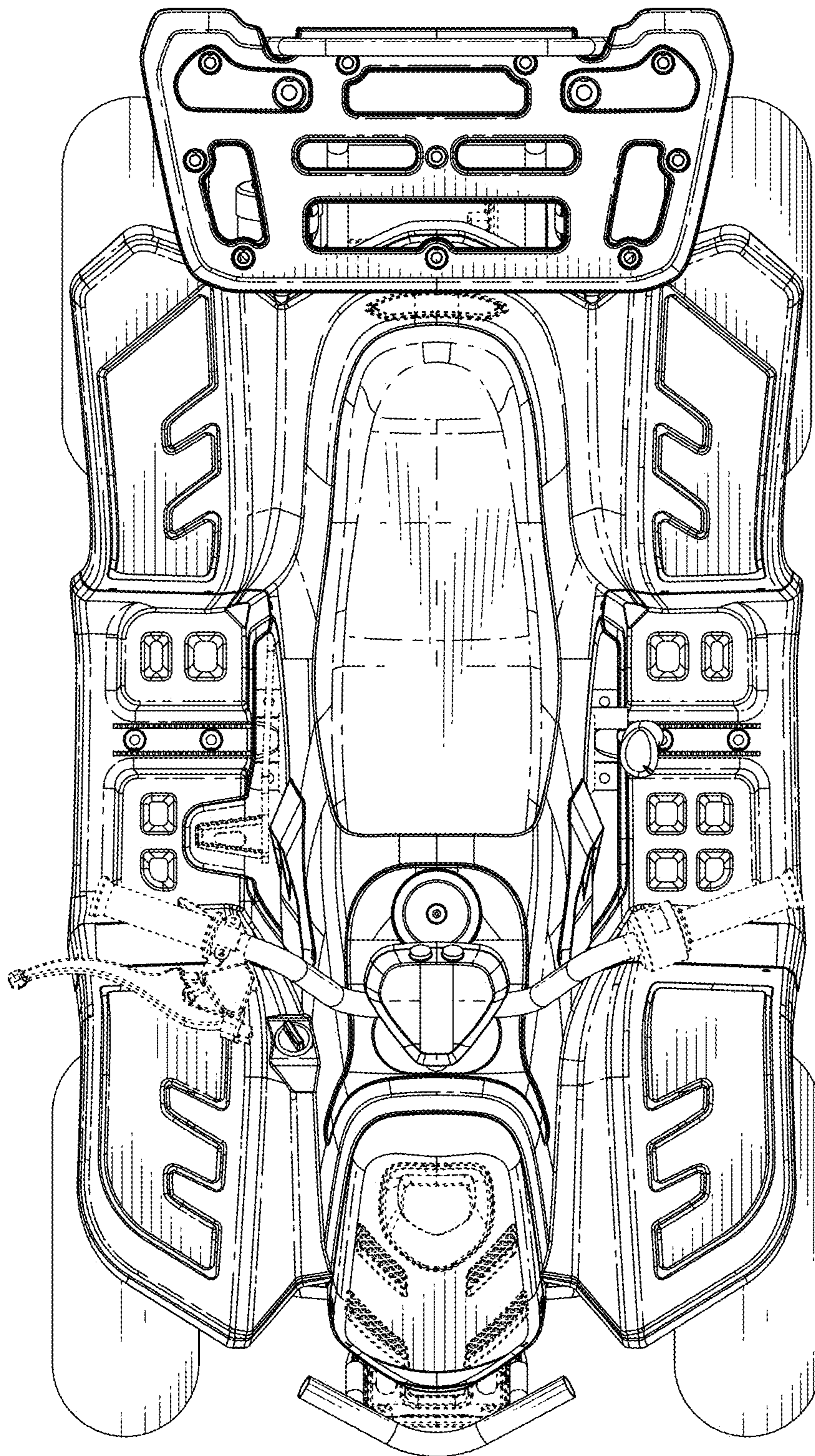

FIG. 7

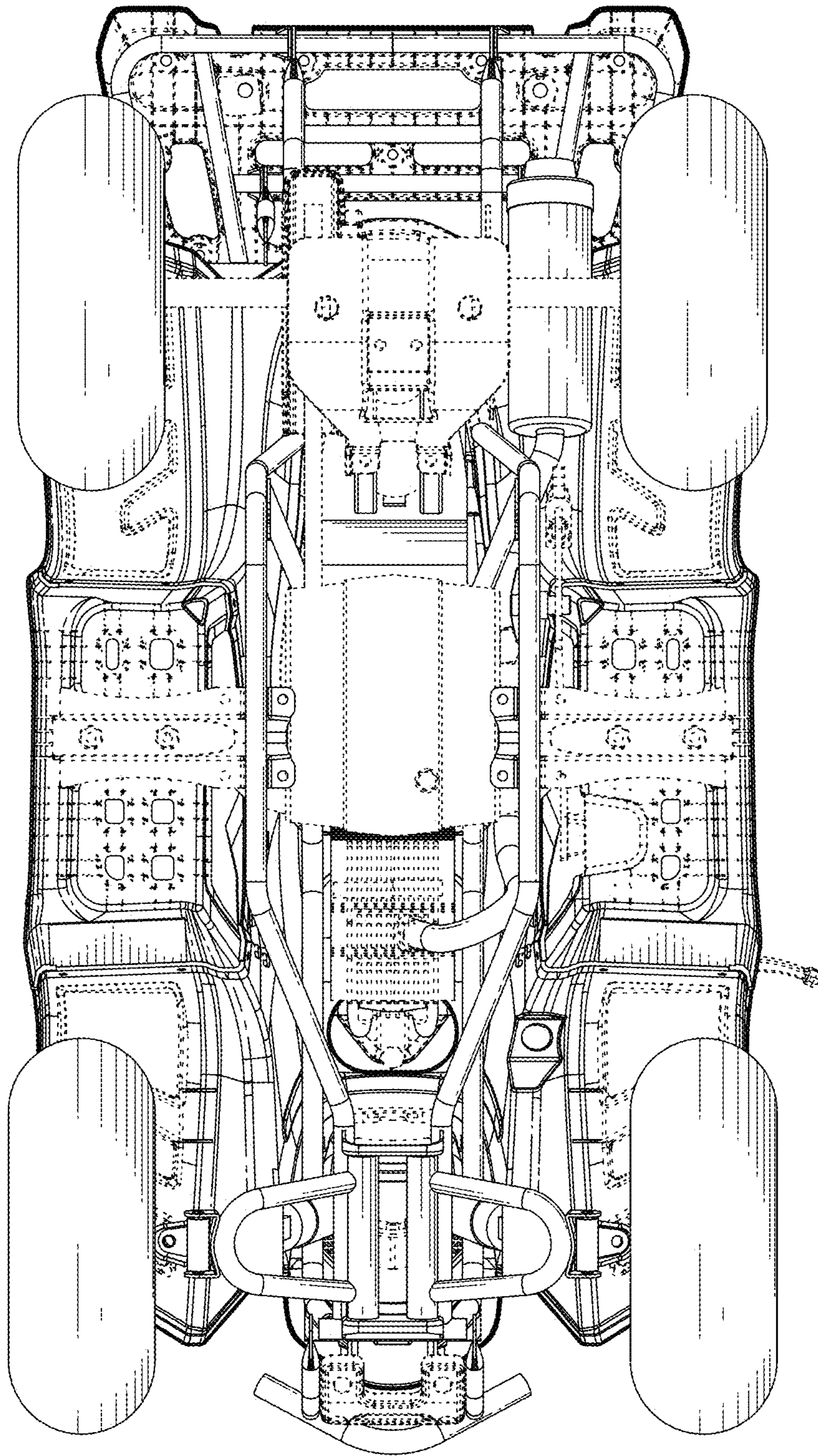

FIG. 8