



US00D950286S

(12) **United States Design Patent** (10) **Patent No.:** **US D950,286 S**
Hu (45) **Date of Patent:** **** May 3, 2022**

(54) **GLASS DESKTOP WITH HONEYCOMB PATTERN**
(71) Applicant: **Yajun Hu**, El Dorado Hills, CA (US)
(72) Inventor: **Yajun Hu**, El Dorado Hills, CA (US)
(73) Assignees: **Yajun Hu**, El Dorado Hills, CA (US); **EUREKA LLC**, EL Dorado Hills, CA (US)

(**) Term: **15 Years**

(21) Appl. No.: **29/734,951**

(22) Filed: **May 16, 2020**

(51) **LOC (13) Cl.** **06-06**

(52) **U.S. Cl.**
USPC **D6/707.19**

(58) **Field of Classification Search**
USPC ... D6/641, 642, 647, 648, 648.1–648.4, 656, D6/656.1, 656.12–656.19, 685, 686, 691, D6/691.1–691.9, 702, 703, 704, 705, D6/705.2, 705.5, 707, 707.15, 707.18, D6/707.19, 707.22–707.24, 707.26
CPC A47B 5/00; A47B 5/02; A47B 7/00; A47B 9/00; A47B 9/04; A47B 11/00; A47B 13/00; A47B 13/08; A47B 13/081; A47B 13/083; A47B 13/12; A47B 17/00; A47B 21/00; A47B 21/02; A47B 2200/0001

See application file for complete search history.

(56) **References Cited**

U.S. PATENT DOCUMENTS

4,514,113 A * 4/1985 Neumann E02D 29/0233
405/262
4,555,116 A * 11/1985 Fields A63F 3/02
273/282.1
D414,976 S * 10/1999 Su E04C 2/365
D6/596
D478,225 S 8/2003 Wang

D499,273 S 12/2004 Chang
D499,576 S 12/2004 Long
D526,812 S 8/2006 Chen
D547,970 S 8/2007 Chou
D549,009 S 8/2007 Lin
D609,922 S * 2/2010 Bridges D5/58
D622,965 S * 9/2010 Bridges G06F 1/203
D5/53
D622,966 S * 9/2010 Bridges D5/53
8,075,073 B2 * 12/2011 Huang G06F 1/203
312/223.1
9,591,919 B2 3/2017 Ergun et al.
9,635,932 B2 5/2017 Kelley et al.
D825,082 S * 8/2018 Darrow D25/160
D834,094 S * 11/2018 Pouliot D21/334
D845,031 S * 4/2019 Huang E02D 29/0233
D12/203

(Continued)

OTHER PUBLICATIONS

Glasholm Tabletop, by Ikea—D&D players discover that Ikea are selling a hex crawl table by Andrew Girdwood GeekNative—Jun. 15, 2019 <https://www.geeknative.com/66718/dd-players-discover-that-ikea-are-selling-a-hex-crawl-table/> retrieved from the internet on Feb. 15, 2022.*

Primary Examiner — Mary Ann Calabrese

(57) **CLAIM**

The ornamental design for a glass desktop with honeycomb pattern, as shown and described.

DESCRIPTION

FIG. 1 is a perspective view of a glass desktop with honeycomb pattern, showing my design;
FIG. 2 is a front view thereof;
FIG. 3 is a bottom view thereof;
FIG. 4 is a top view thereof;
FIG. 5 is a rear side view thereof;
FIG. 6 is a left side view thereof; and,
FIG. 7 is a right side view thereof.

1 Claim, 7 Drawing Sheets

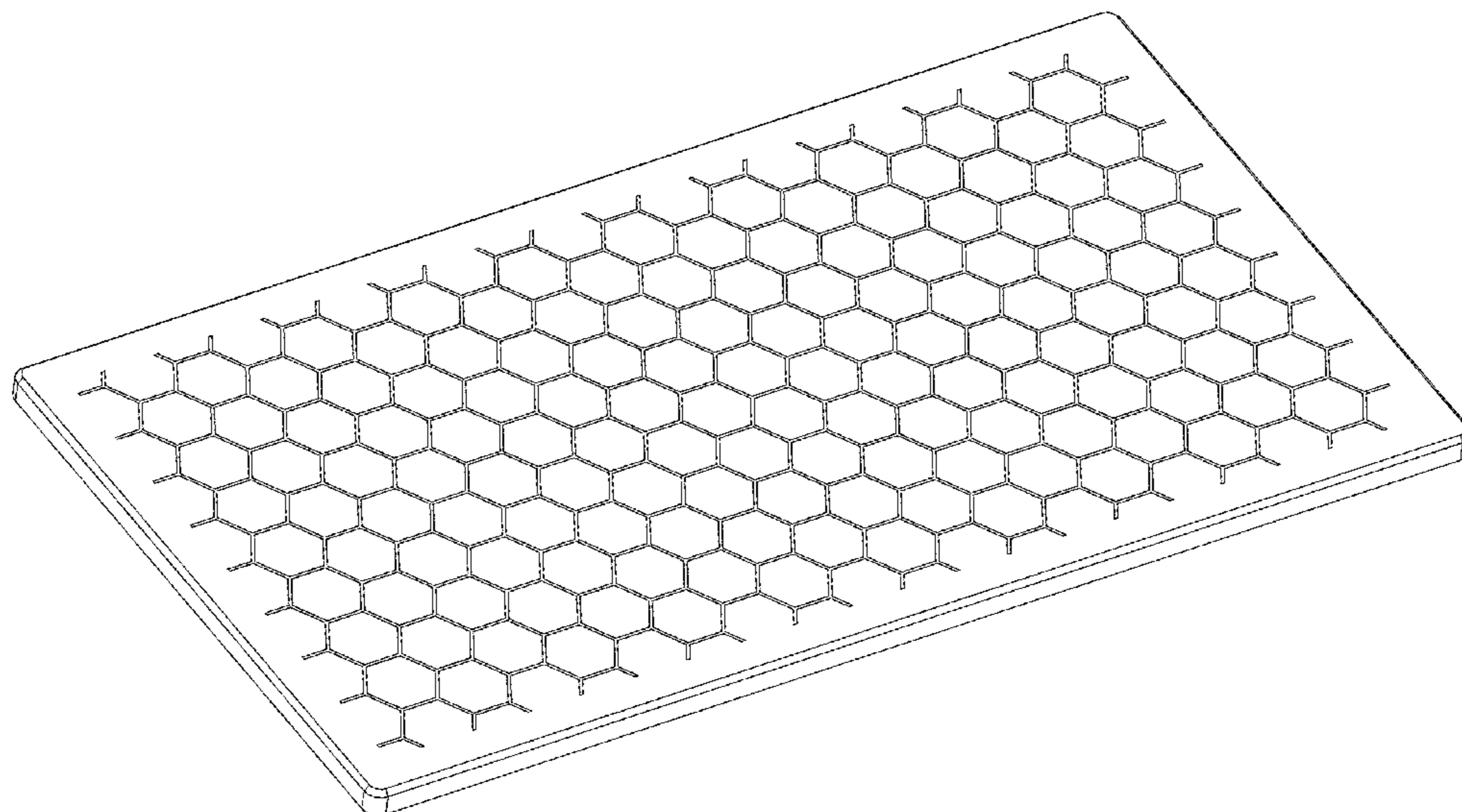

(56)

References Cited

U.S. PATENT DOCUMENTS

D860,687 S * 9/2019 Parikh A63F 3/02
D6/655.1
D894,640 S * 9/2020 Hu F41H 5/04
D6/656.16
D915,110 S * 4/2021 Hu A43B 13/181
D6/707.19
2001/0008053 A1* 7/2001 Belli A43B 13/181
473/549
2005/0019531 A1* 1/2005 Bazbaz B65D 19/44
428/156
2008/0113143 A1* 5/2008 Taylor F41H 5/04
428/47
2009/0324872 A1* 12/2009 Leng B32B 3/12
428/73
2012/0090812 A1* 4/2012 King F24H 7/00
165/53
2016/0157467 A1* 6/2016 Banta A01K 47/06
449/64
2017/0350125 A1* 12/2017 De Cauwer E04C 2/365

* cited by examiner

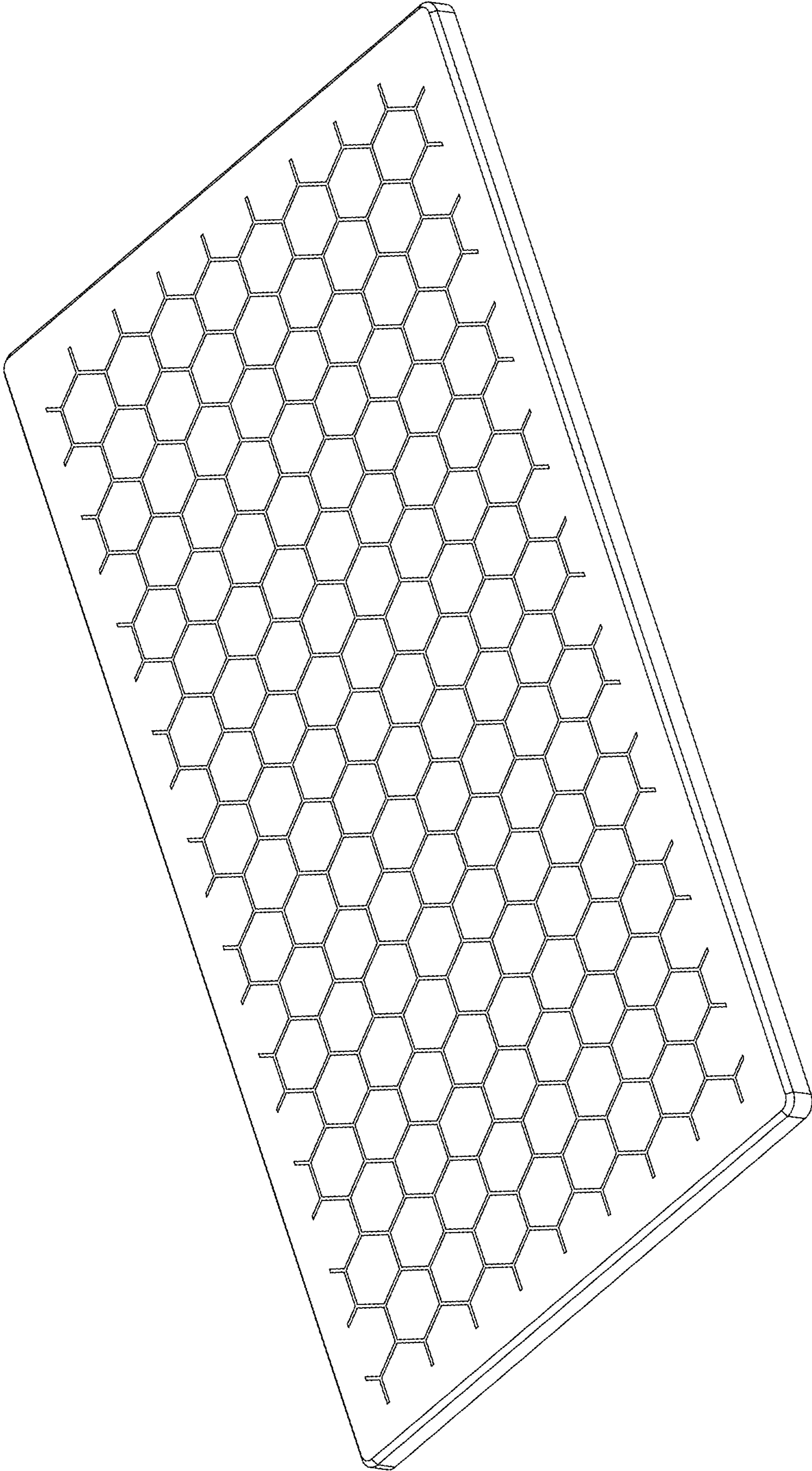

FIG.1

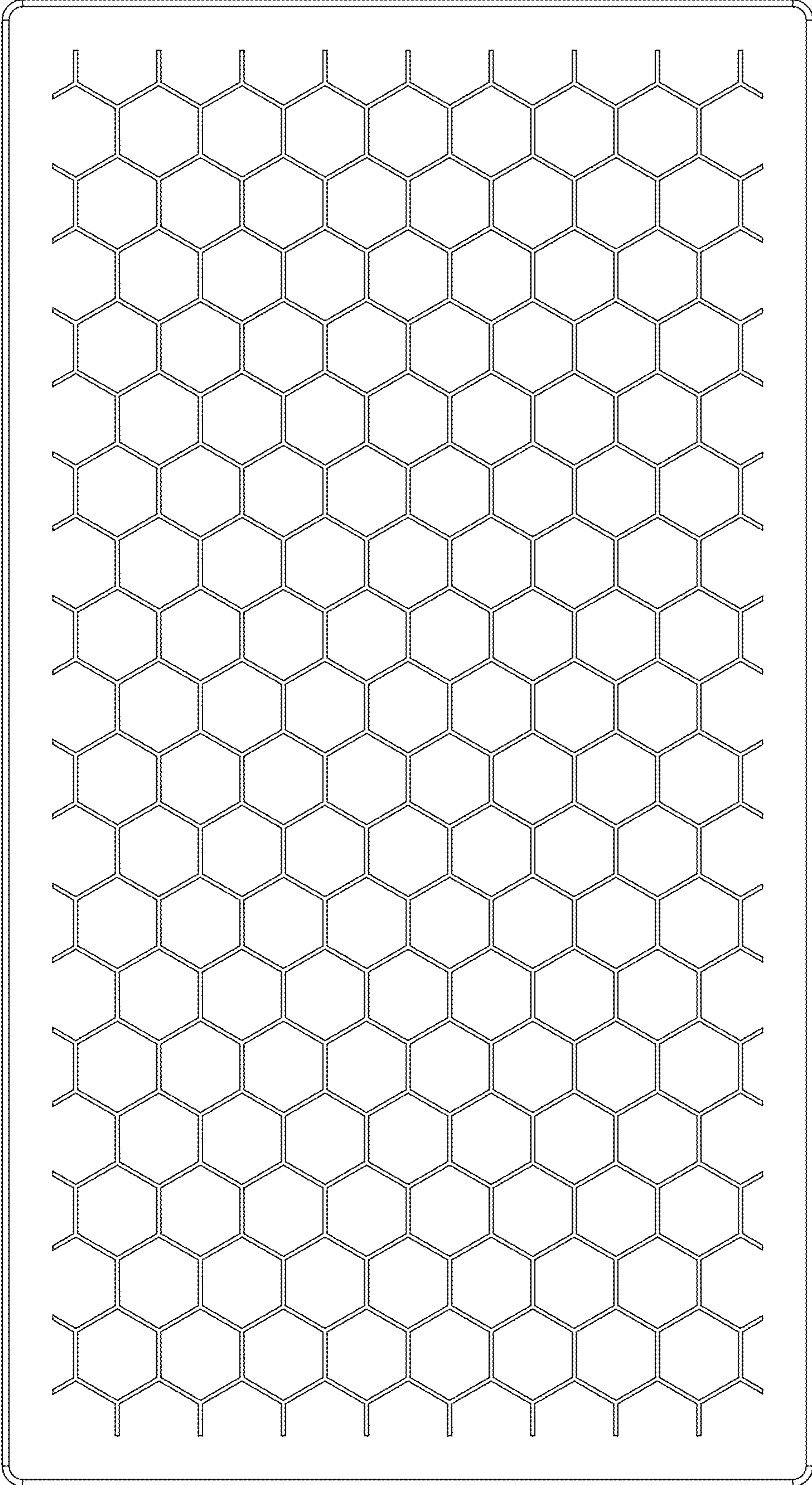

FIG.2

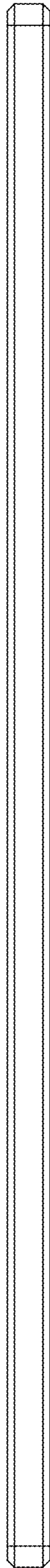

FIG.3

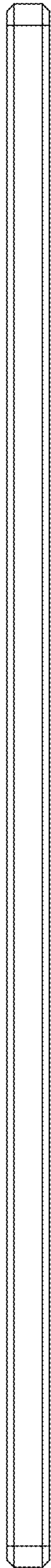

FIG.4

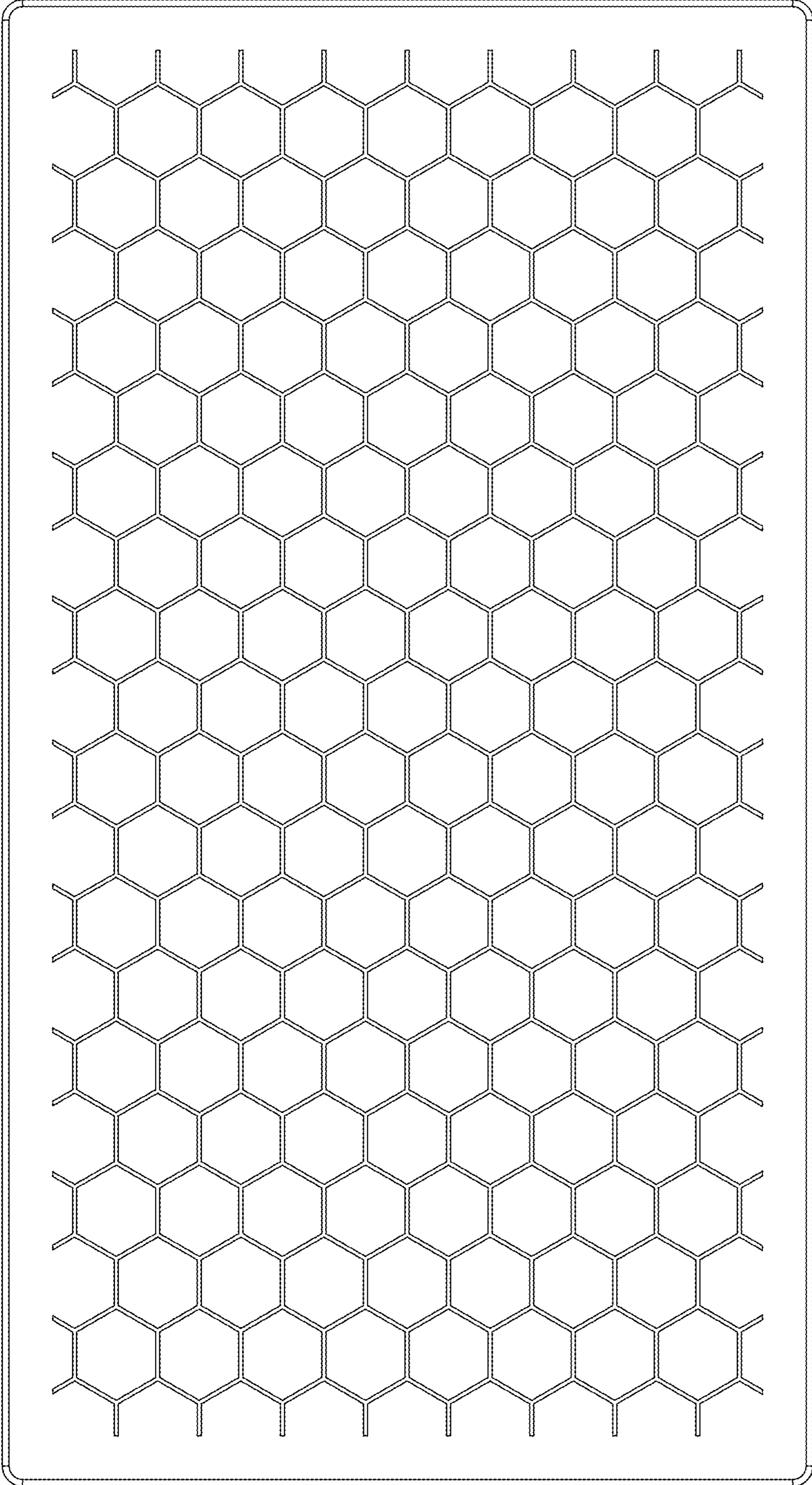

FIG.5

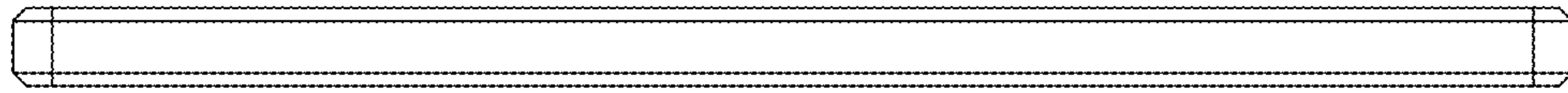

FIG.6

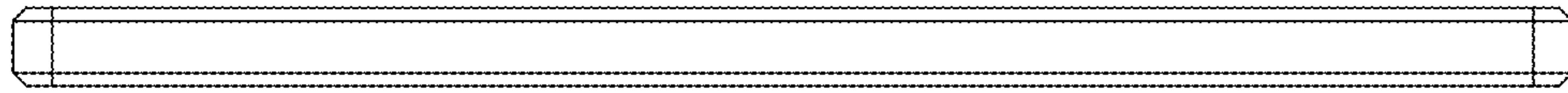

FIG. 7