

US00D949064S

(12) **United States Design Patent**  
**Kyeong**

(10) **Patent No.:** **US D949,064 S**

(45) **Date of Patent:** **\*\* Apr. 19, 2022**

(54) **HITCH PIN LOCK**

(71) Applicant: **Ju Ho Kyeong**, Icheon (KR)

(72) Inventor: **Ju Ho Kyeong**, Icheon (KR)

(\*\*) Term: **15 Years**

(21) Appl. No.: **29/760,909**

(22) Filed: **Dec. 4, 2020**

(51) **LOC (13) Cl.** ..... **12-16**

(52) **U.S. Cl.**  
USPC ..... **D12/162**

(58) **Field of Classification Search**  
USPC ..... D12/159-162  
CPC . B60D 1/60; B60D 1/065; B60D 1/00; B60D  
1/06; B60D 1/36; B62D 33/033  
See application file for complete search history.

(56) **References Cited**

**U.S. PATENT DOCUMENTS**

D687,353 S *	8/2013	Dunn	.....	D12/162
D841,526 S *	2/2019	Siegel	.....	D12/162
D866,412 S *	11/2019	Williams	.....	D12/162
D869,997 S *	12/2019	Borkholder	.....	D12/162
D873,723 S *	1/2020	Borkholder	.....	D12/162
D897,245 S *	9/2020	Borkholder	.....	D12/162

D904,237 S *	12/2020	Qiu	.....	B60R 9/06 D12/162
D907,537 S *	1/2021	Goodner	.....	D12/162
D909,922 S *	2/2021	Siegel	.....	D12/162
D918,787 S *	5/2021	Cotter	.....	D12/162
D927,366 S *	8/2021	Repic	.....	B60R 9/06 D12/162
D935,952 S *	11/2021	Minetto	.....	D12/162

\* cited by examiner

*Primary Examiner* — Katrina A Betton

(74) *Attorney, Agent, or Firm* — Lewis Roca Rothgerber  
Christie LLP

(57) **CLAIM**

The ornamental design for a hitch pin lock, as shown and described.

**DESCRIPTION**

FIG. 1 is a perspective view of the hitch pin lock;  
FIG. 2 is a front view thereof;  
FIG. 3 is a rear view thereof;  
FIG. 4 is a left side view thereof;  
FIG. 5 is a right side view thereof;  
FIG. 6 is a top view thereof; and,  
FIG. 7 is a bottom view thereof.

The broken lines in the drawings depict portions of the article that form no part of the claimed design.

**1 Claim, 7 Drawing Sheets**

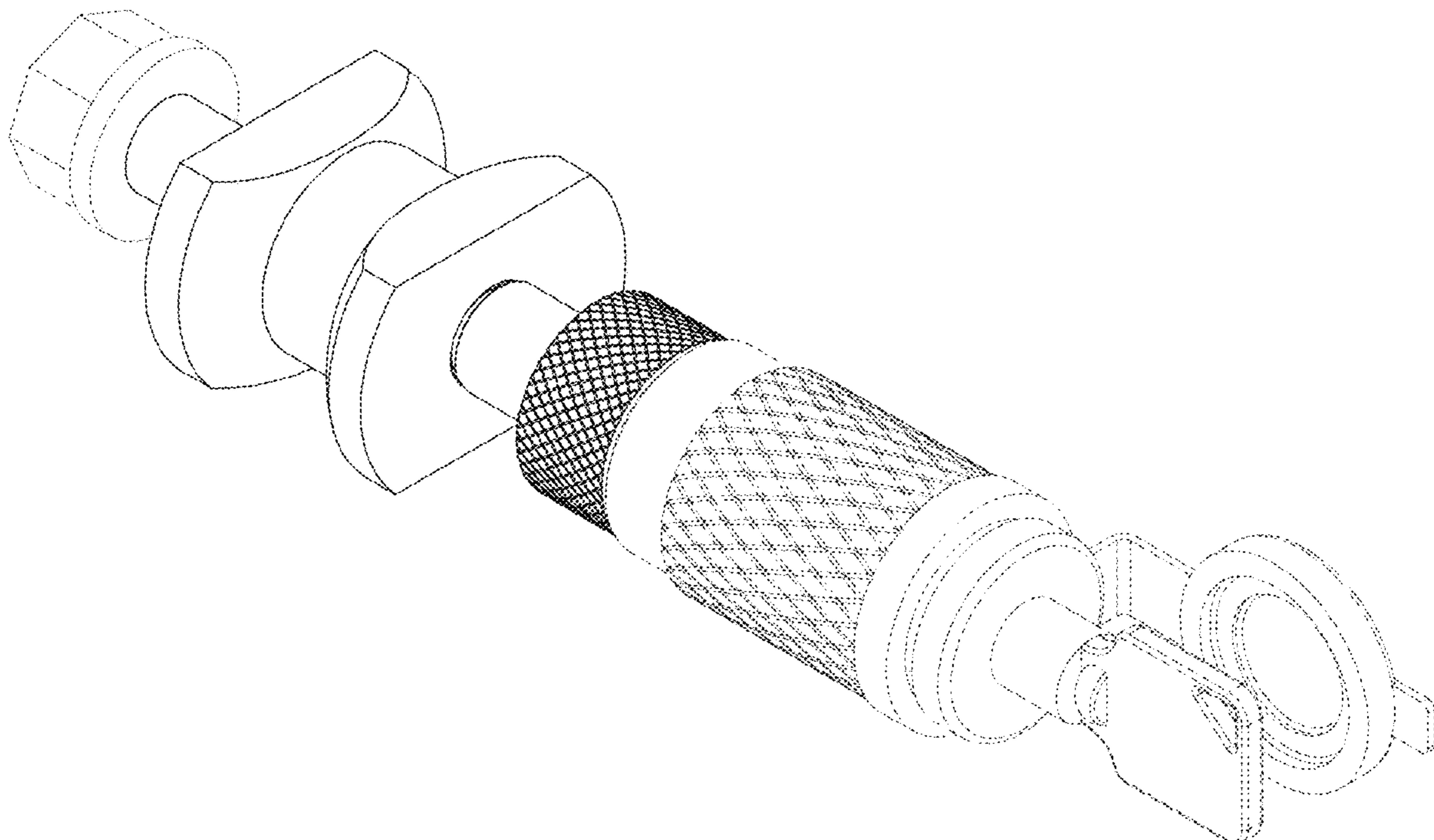

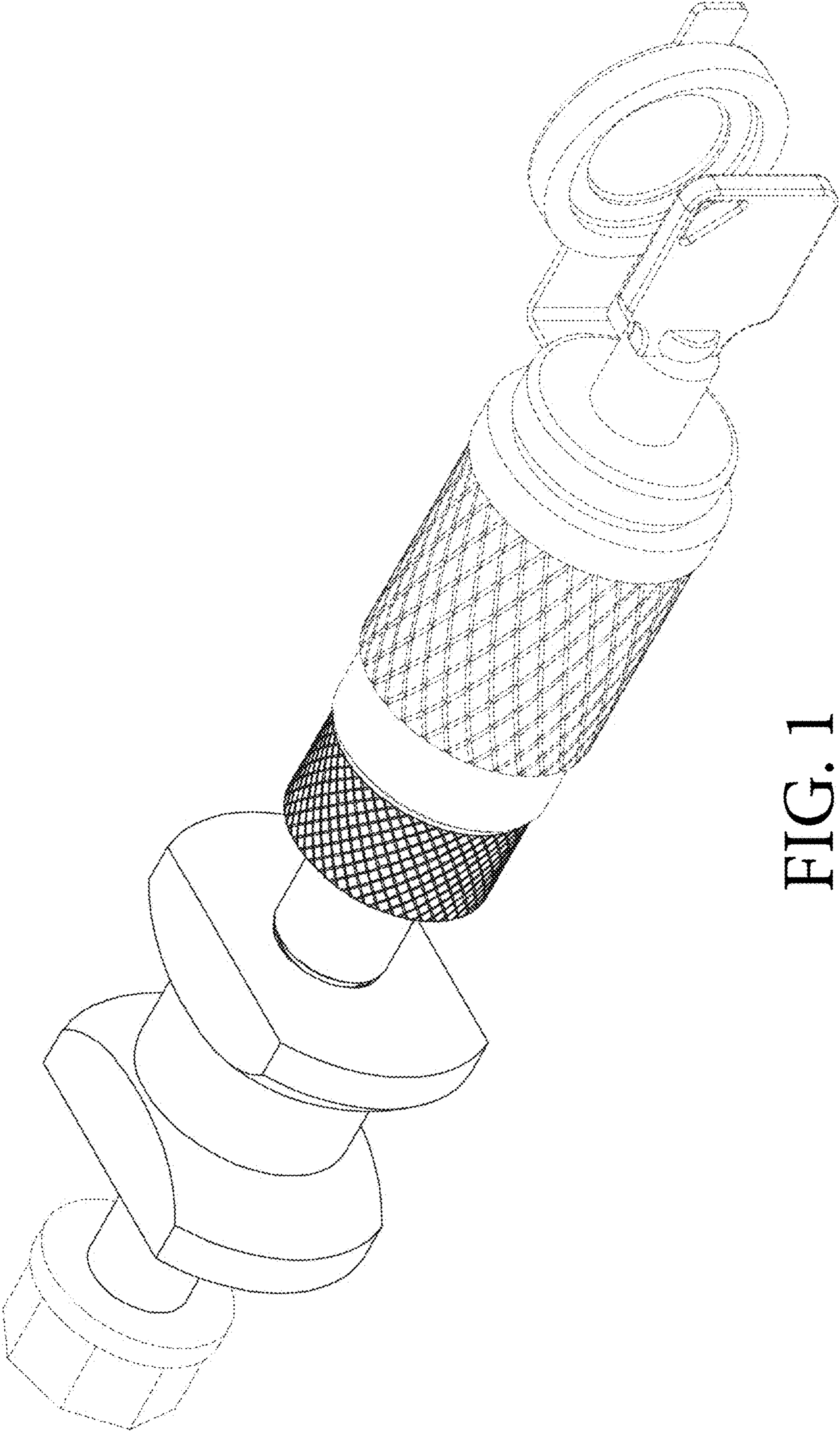

FIG. 1

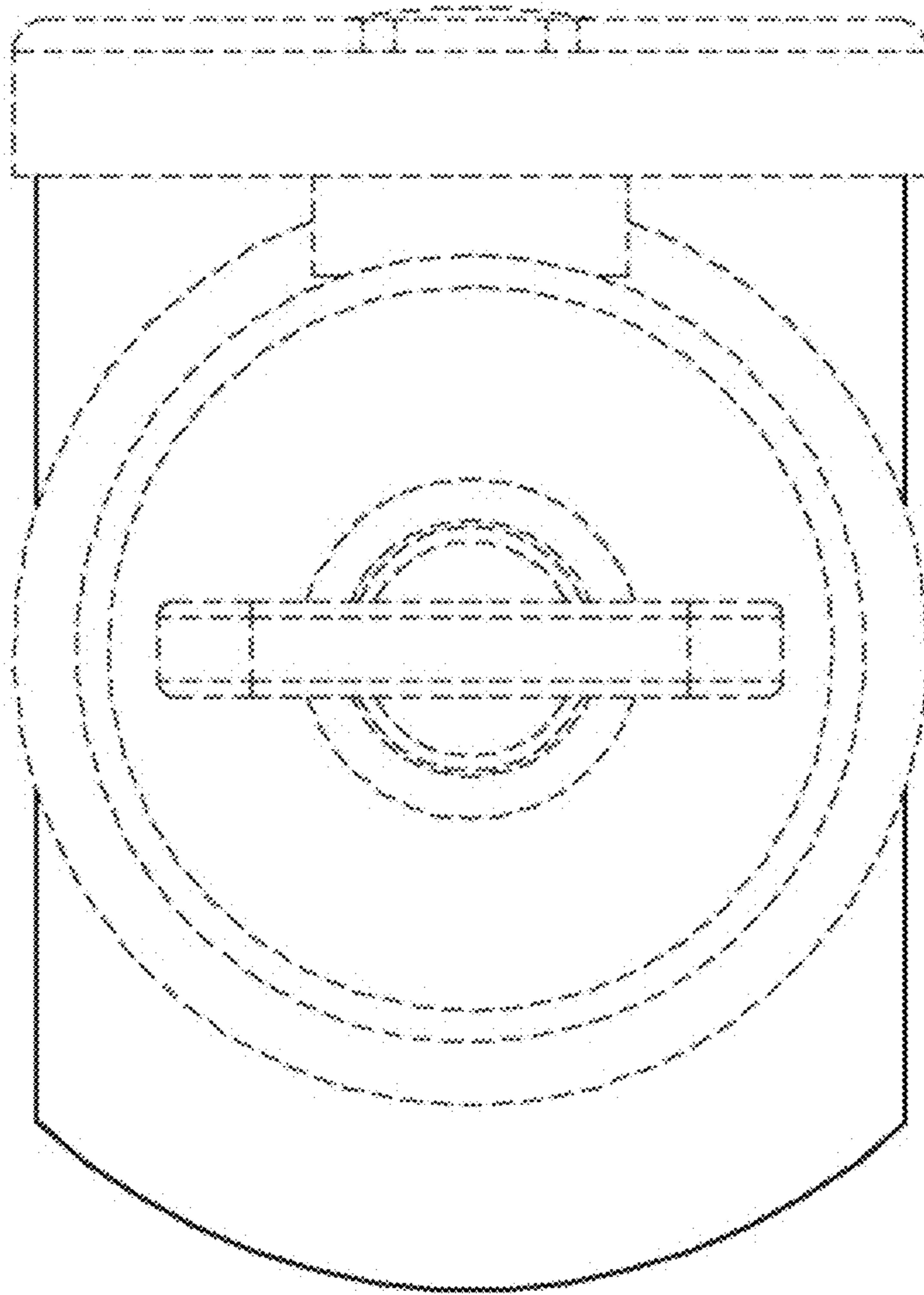

FIG. 2

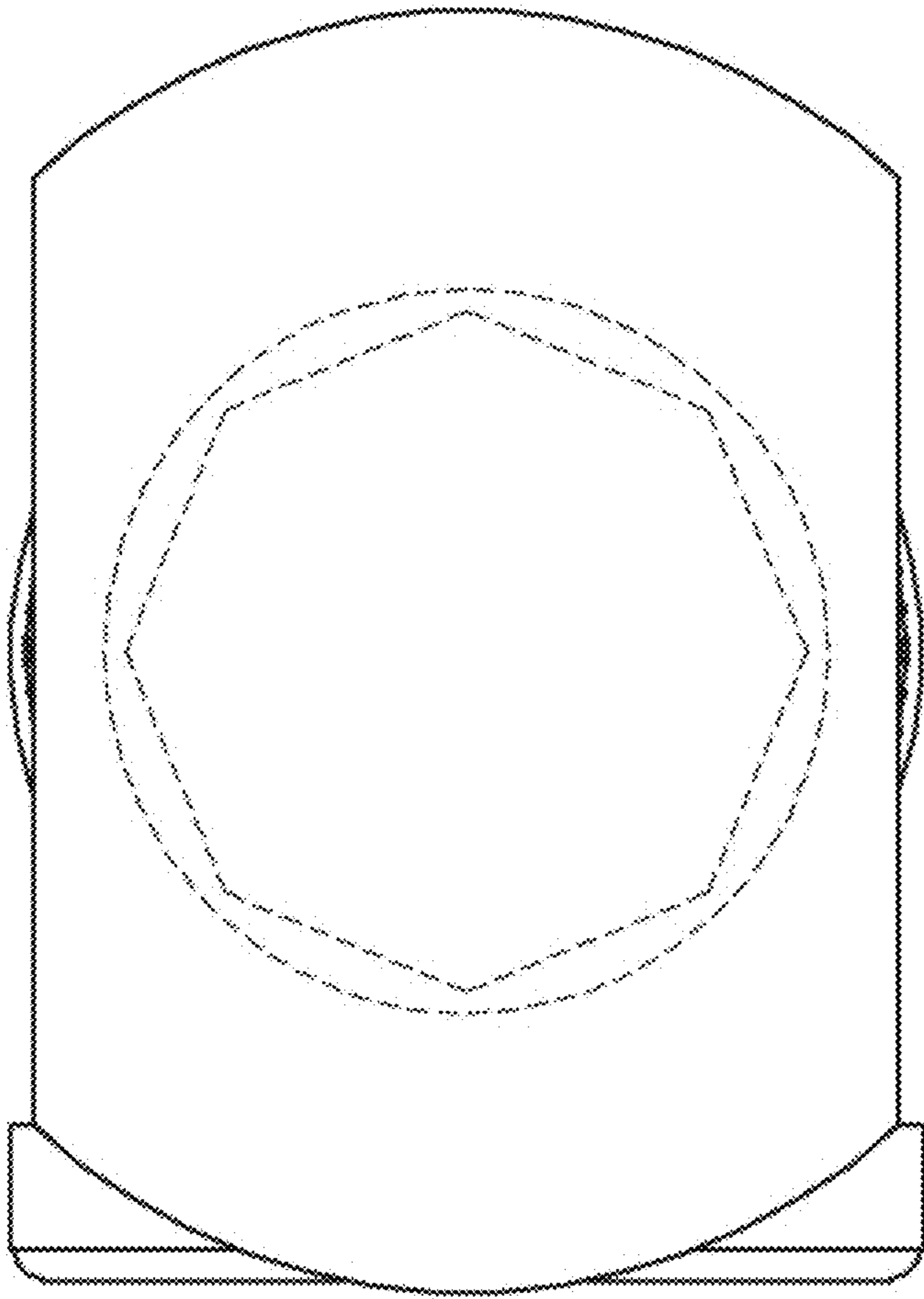

FIG. 3

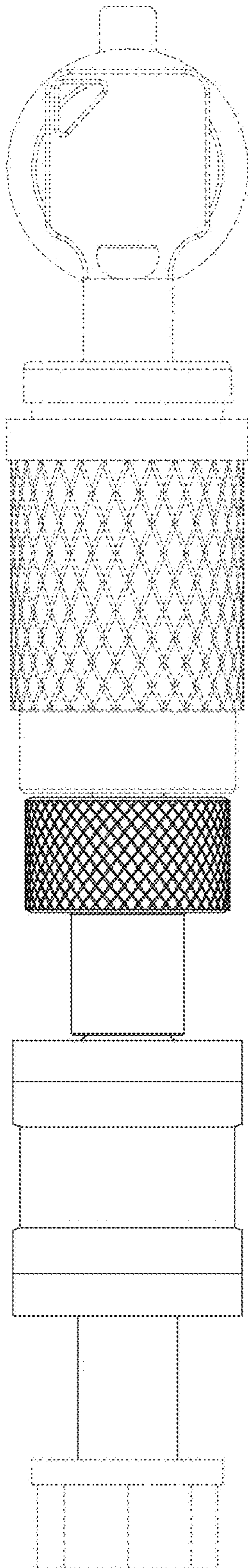

FIG. 4

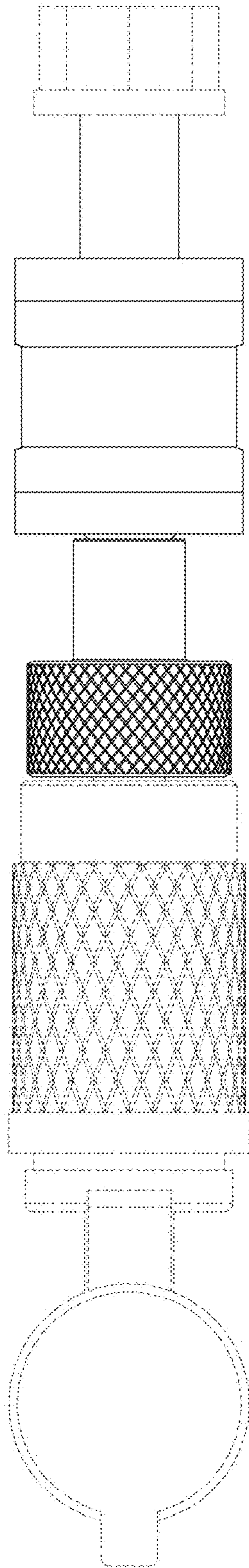

FIG. 5

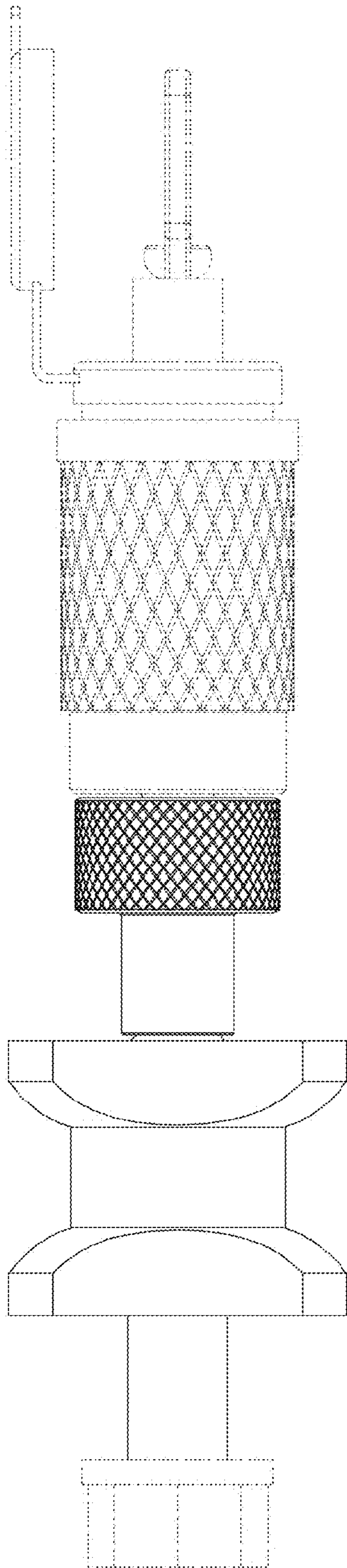

FIG. 6

