



US00D947935S

(12) **United States Design Patent** (10) **Patent No.:** **US D947,935 S**
Shiozaki (45) **Date of Patent:** **** Apr. 5, 2022**

(54) **PRINTER**

FOREIGN PATENT DOCUMENTS

(71) Applicant: **Canon Kabushiki Kaisha**, Tokyo (JP)

JP D206127-004 * 2/2020

(72) Inventor: **Akihisa Shiozaki**, Tokyo (JP)

OTHER PUBLICATIONS

(73) Assignee: **Canon Kabushiki Kaisha**, Tokyo (JP)

Canon Pixma TS6320 Wireless, p. 8, Aug. 13, 2019—https://www.amazon.com/Canon-TS6320-Amazon-Replenishment-enabled/dp/B07W8K3C1H/ref=sr_1_3?keywords=canon%2Bpixma%2Bts6320&qid=1638206075&qsid=140-6837505-4449240&sr=8-3&sres=B07W8K3C1H%2CB00B0IC37E%2CB00BGICULC%2CB08Q43T76Q%2CB074V5CMYK%2019.
TS Series Pixma TS6320 Canon USA, p. 1, 2019, www.cannonusa.com-29723388-https://www.usa.canon.com/internet/portal/us/home/products/details/printers/inkjet-multifunction/ts-series-inkjet/pixma-ts6320 (Year: 2019).*

(**) Term: **15 Years**

(21) Appl. No.: **29/723,388**

(22) Filed: **Feb. 6, 2020**

(30) **Foreign Application Priority Data**

Aug. 7, 2019 (JP) 2019-017606

(51) **LOC (13) Cl.** **14-02**

(52) **U.S. Cl.**
USPC **D18/53**

(58) **Field of Classification Search**
USPC D18/4.1, 4.4, 4.6, 37, 38, 39, 50, 53, 54,
D18/55, 59; D14/300, 301, 302, 307,
D14/308, 314, 321, 365; D6/514, 672,
D6/681, 2, 691, 9
CPC ... H04N 2201/0094; H04N 2201/0081; H04N
1/00278

See application file for complete search history.

(56) **References Cited**

U.S. PATENT DOCUMENTS

D369,180 S *	4/1996	Fukaya	D18/50
D675,674 S *	2/2013	Sato	D18/50
8,995,036 B2 *	3/2015	Ishida	H04N 1/00551 358/527
D752,138 S *	3/2016	Seki	D18/50
D770,565 S *	11/2016	Tanaka	D18/50
D813,299 S *	3/2018	Yamamoto	D18/56
D816,156 S *	4/2018	Tanaka	D18/56
D917,614 S *	4/2021	Odachi	D18/56
D923,701 S *	6/2021	Lim	D18/50
2017/0251120 A1 *	8/2017	Nakashima	H04N 1/00748

* cited by examiner

Primary Examiner — Jennifer L Rempfer
Assistant Examiner — Danielle Nichole Bowly
(74) *Attorney, Agent, or Firm* — Venable LLP

(57) **CLAIM**

The ornamental design for a printer, as shown and described.

DESCRIPTION

FIG. 1 is a front view of a printer showing my new design;
FIG. 2 is a rear view thereof;
FIG. 3 is a top plan view thereof;
FIG. 4 is a bottom plan view thereof;
FIG. 5 is a left side view thereof;
FIG. 6 is a right side view thereof;
FIG. 7 is a right perspective view thereof; and,
FIG. 8 is a left perspective view thereof.
The dash-dotted broken lines define the bounds of the claimed design; the evenly spaced broken lines form no part of the claimed design.

1 Claim, 6 Drawing Sheets

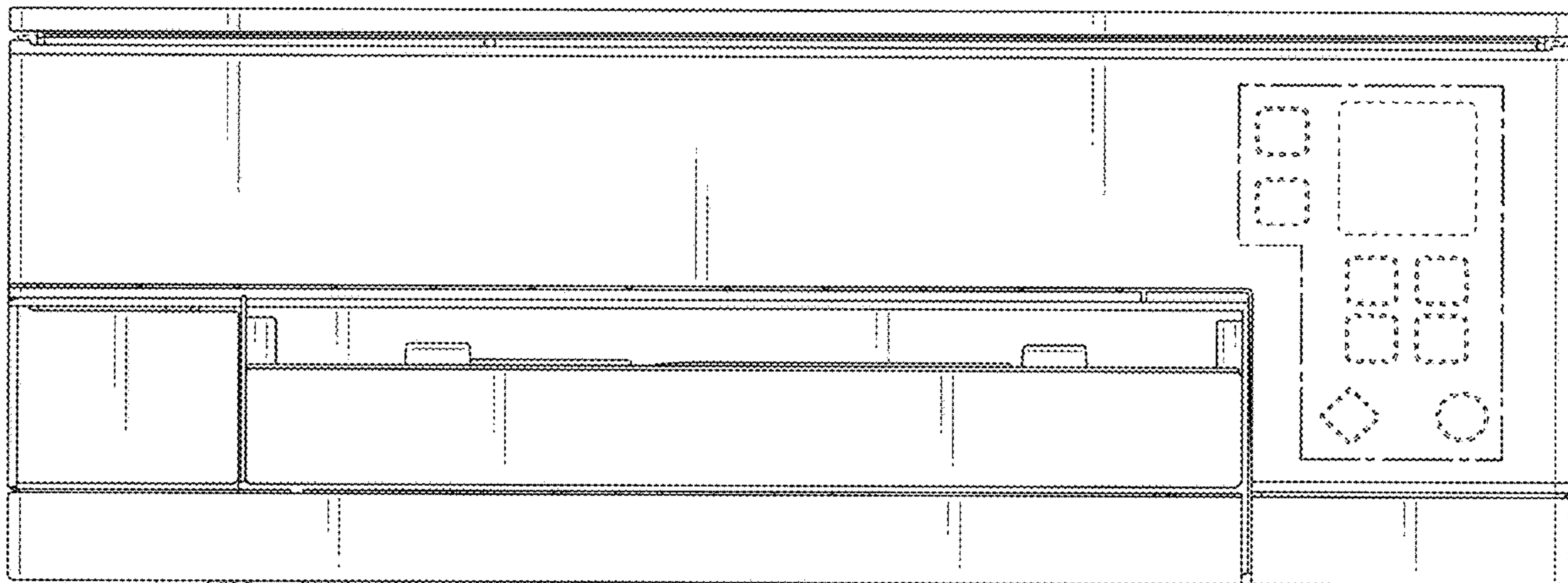

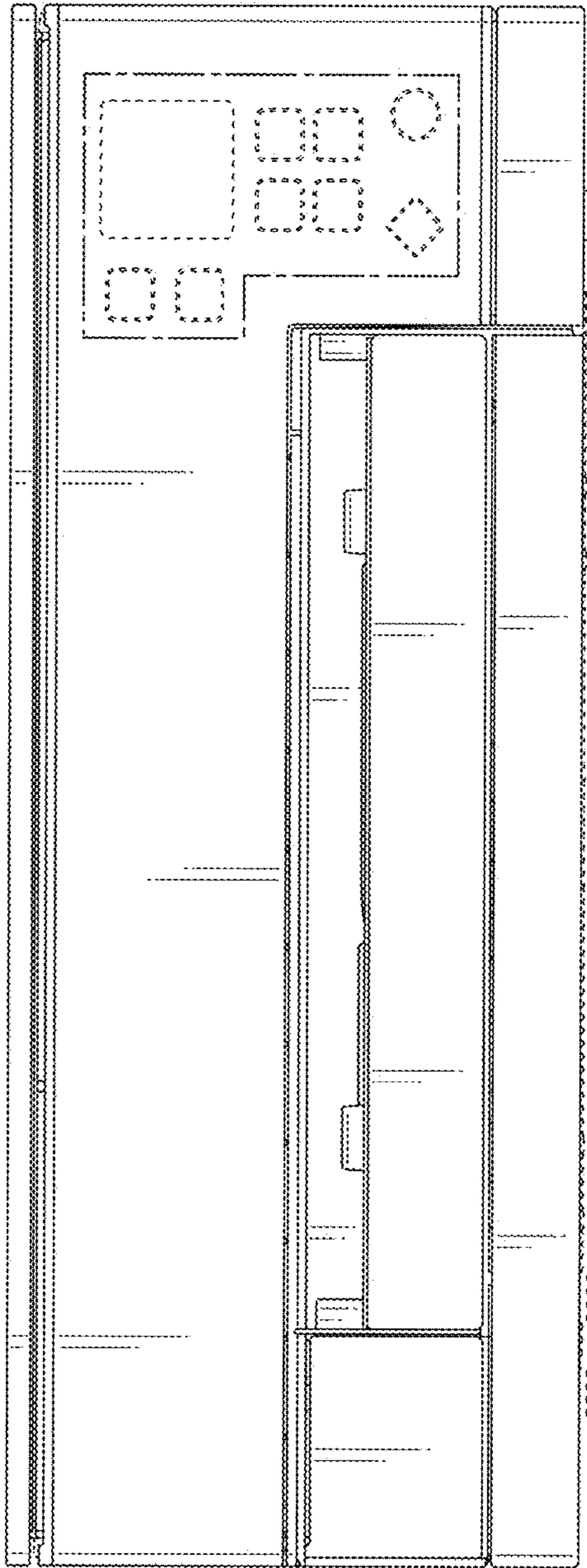

FIG. 1

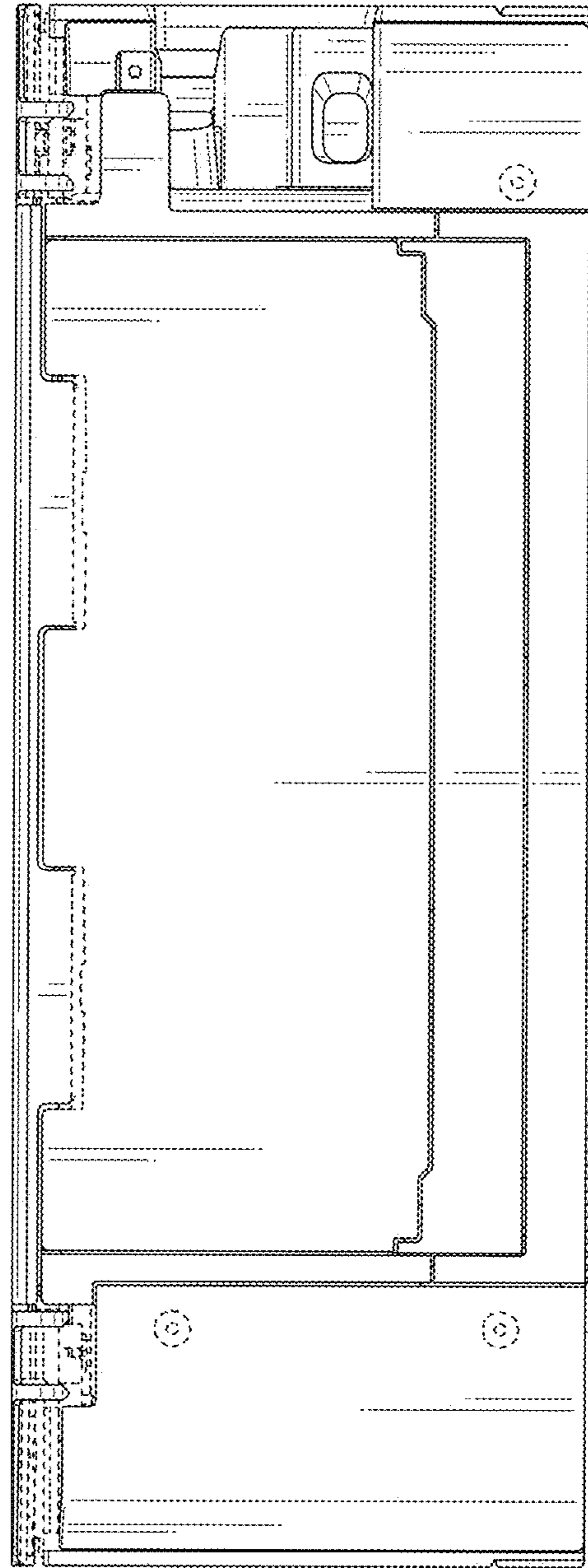

FIG. 2

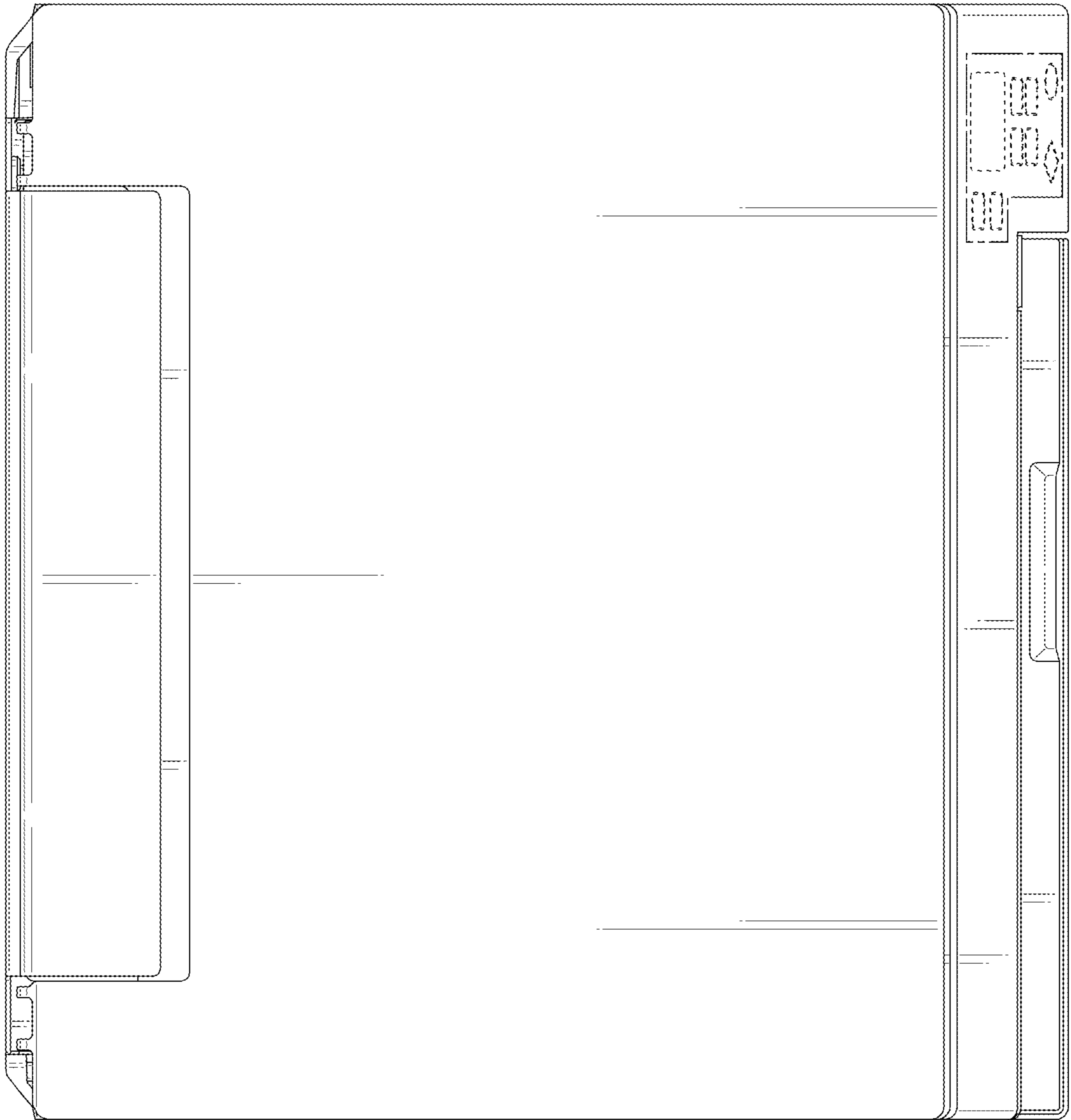

FIG. 3

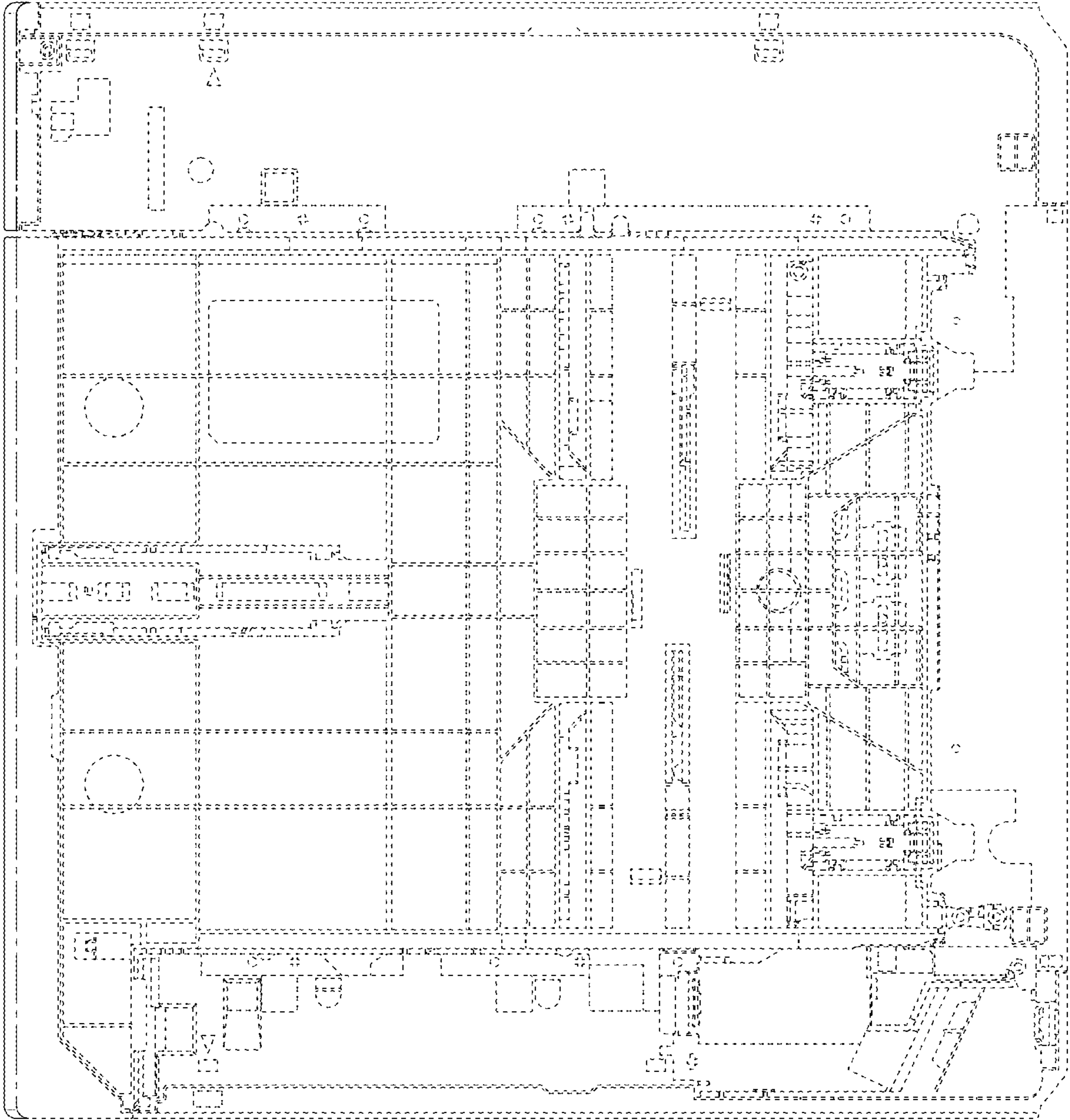

FIG. 4

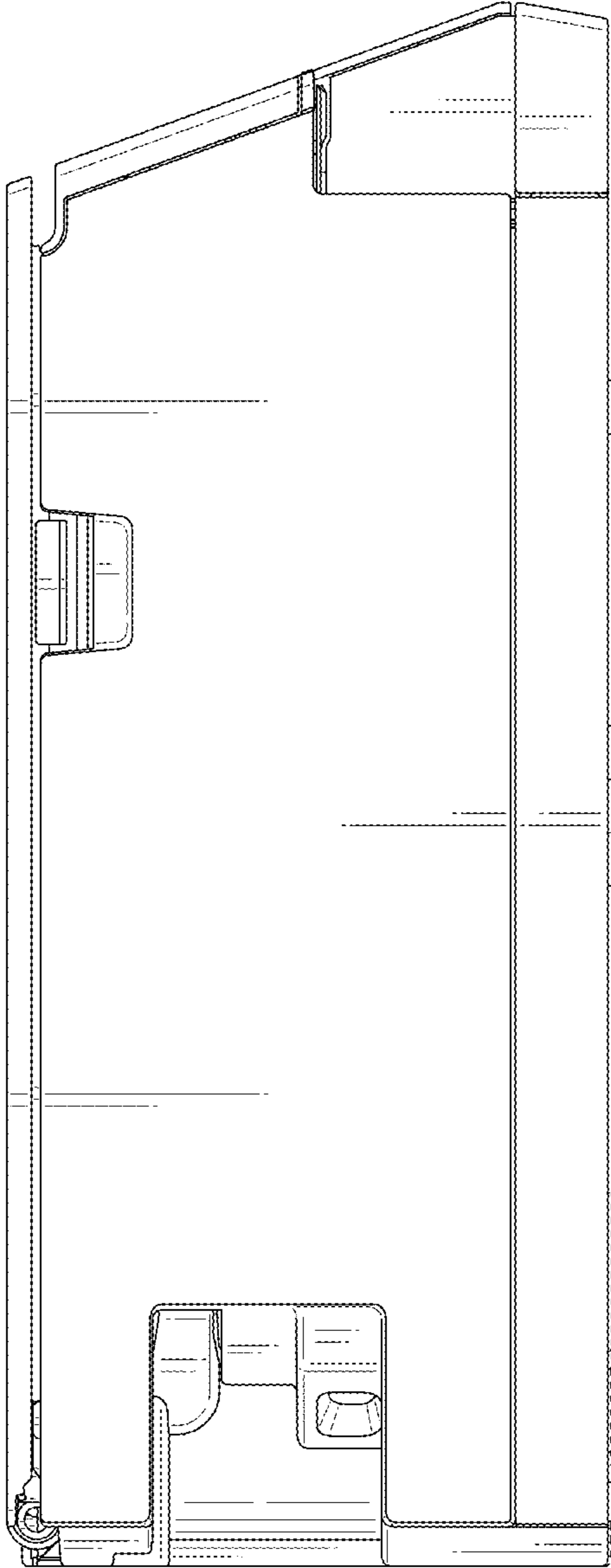

FIG. 5

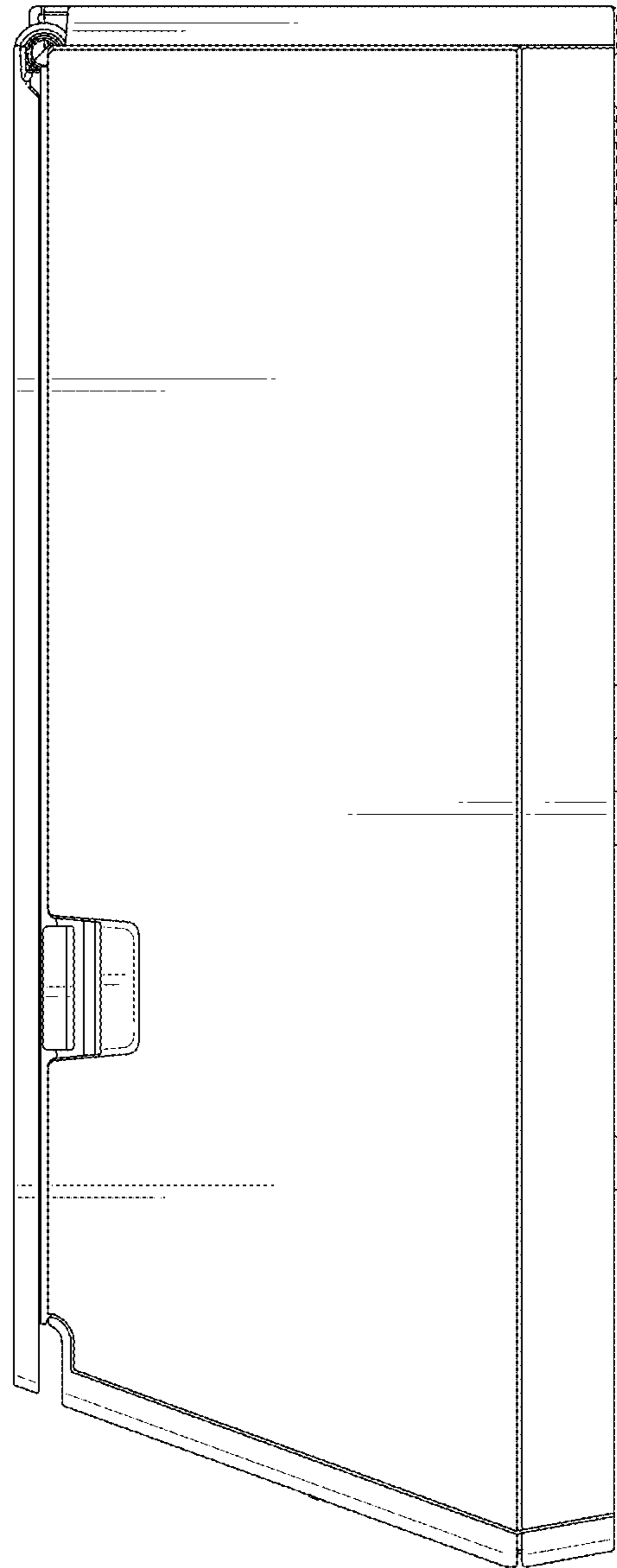

FIG. 6

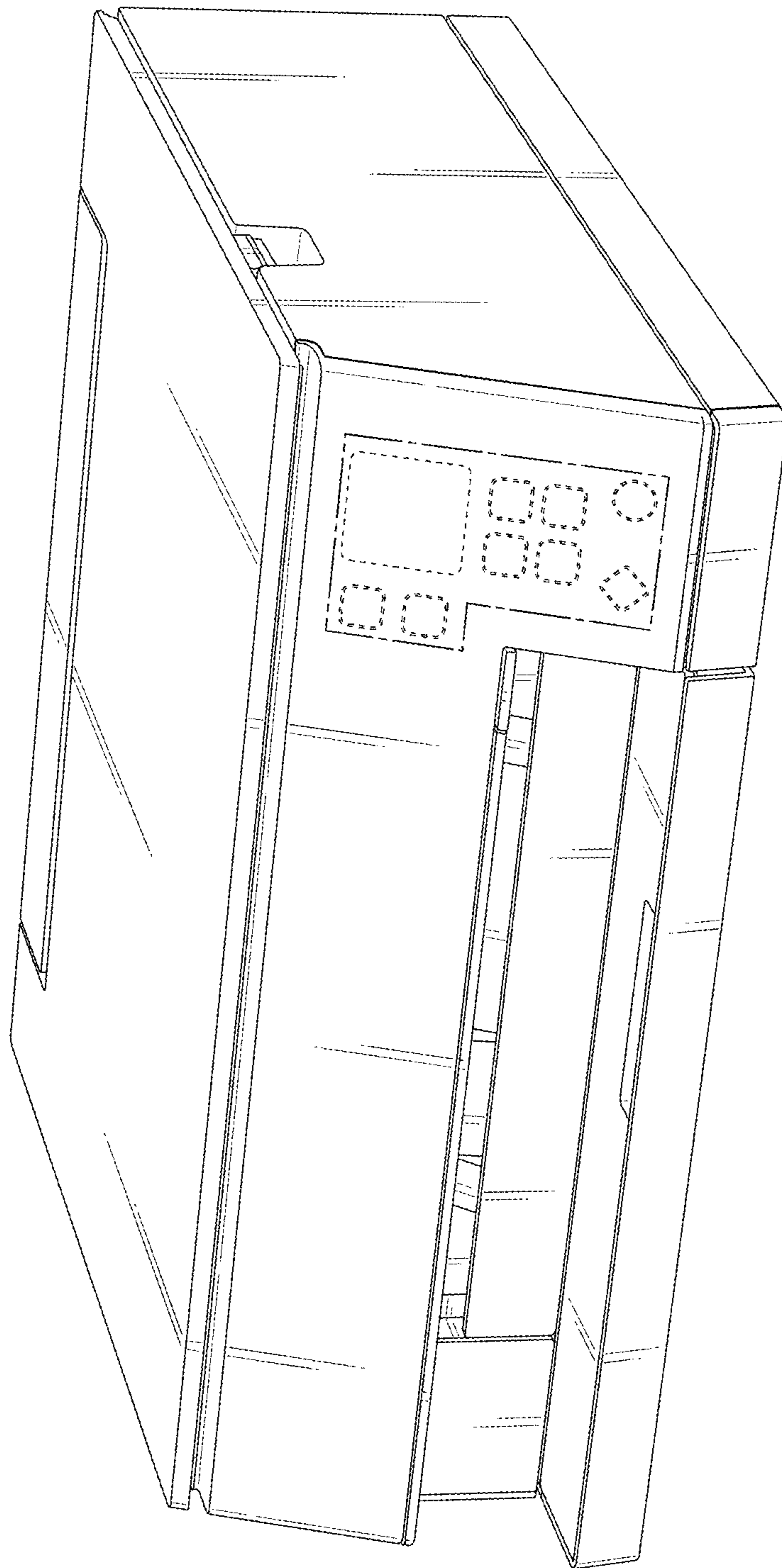

FIG. 7

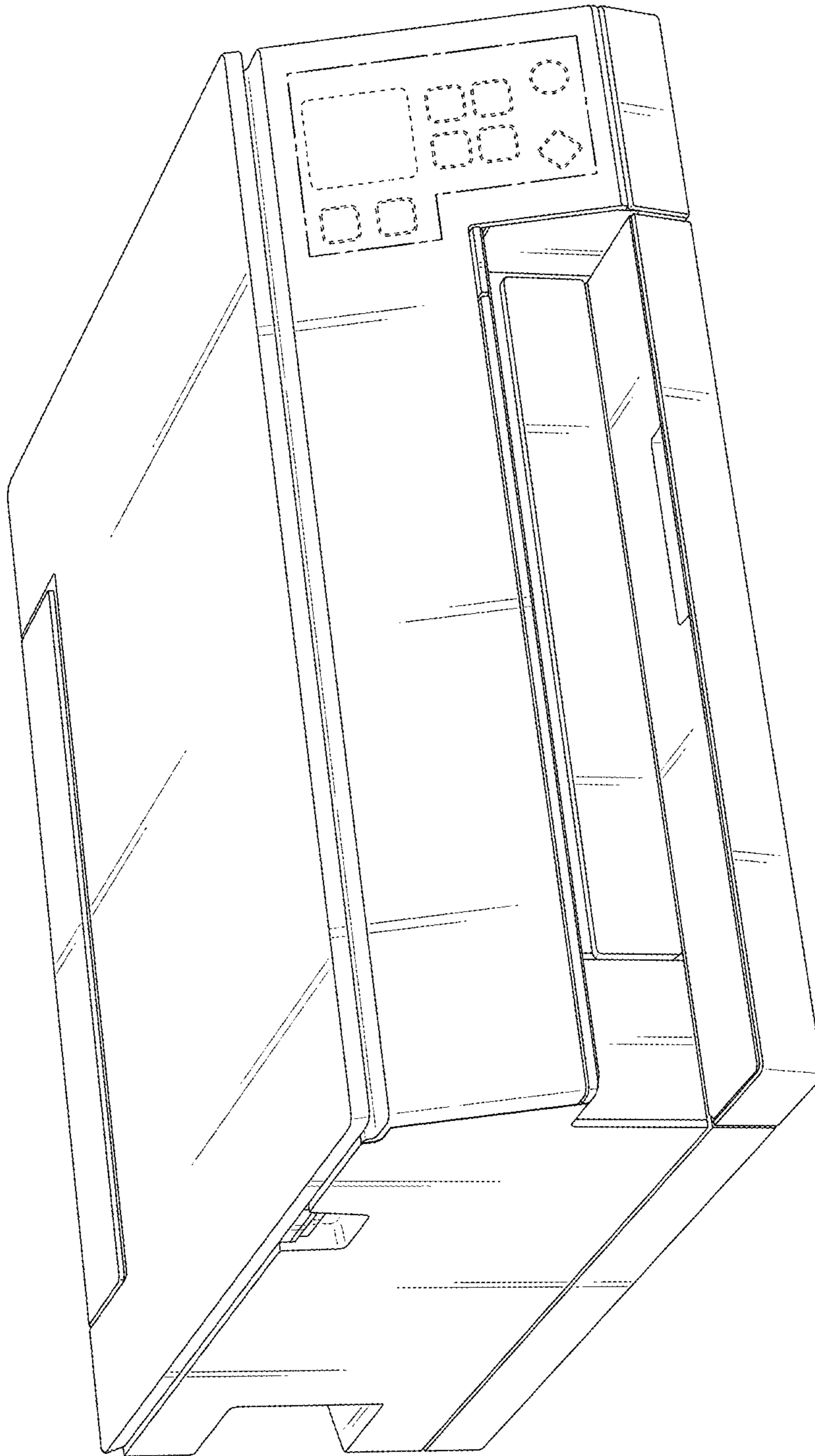

FIG. 8