

US00D947377S

(12) **United States Design Patent**
Frey et al.

(10) **Patent No.:** **US D947,377 S**
(45) **Date of Patent:** **** Mar. 29, 2022**

(54) **COMBINATION DRILLING DEPTH AND CONTROL APPARATUS**

(71) Applicant: **Mighty Oak Medical, Inc.**, Englewood, CO (US)

(72) Inventors: **George Frey**, Englewood, CO (US);
Caleb Voelkel, West Glover, VT (US);
Adam Jensen, Golden, CO (US); **Sean Starkman**, Centennial, CO (US)

(73) Assignee: **Mighty Oak Medical, Inc.**, Englewood, CO (US)

(**) Term: **15 Years**

(21) Appl. No.: **29/770,056**

(22) Filed: **Feb. 9, 2021**

Related U.S. Application Data

(63) Continuation of application No. 17/156,330, filed on Jan. 22, 2021.

(51) **LOC (13) Cl.** **24-02**

(52) **U.S. Cl.**
USPC **D24/140**

(58) **Field of Classification Search**
USPC D24/140, 135, 133; D15/139, 140, 21;
D8/70

(Continued)

(56) **References Cited**

U.S. PATENT DOCUMENTS

D329,496 S * 9/1992 Wotton D24/140
5,480,387 A * 1/1996 Gabriel A61M 5/20
604/134

(Continued)

Primary Examiner — Bridget L Eland

(74) *Attorney, Agent, or Firm* — FisherBroyles LLP; Ian R. Walsworth

(57) **CLAIM**

The ornamental design for a combination drilling depth and control apparatus, as shown and described.

DESCRIPTION

FIG. 1 is a top perspective view of the combination drilling depth and control apparatus;

FIG. 2 is a bottom perspective view thereof;

FIG. 3 is a front elevation view thereof;

FIG. 4 is a rear elevation view thereof;

FIG. 5 is a right elevation view thereof;

FIG. 6 is a left elevation view thereof;

FIG. 7 is a top plan view thereof;

FIG. 8 is a bottom plan view thereof;

FIG. 9 is a top perspective view of the combination drilling depth and control apparatus of FIG. 1, shown removed in order to show aspects of the design that are not otherwise apparent;

FIG. 10 is a bottom perspective view thereof;

FIG. 11 is a front elevation view thereof;

FIG. 12 is a rear elevation view thereof;

FIG. 13 is a right elevation view thereof;

FIG. 14 is a left elevation view thereof;

FIG. 15 is a top plan view thereof;

FIG. 16 is a bottom plan view thereof;

FIG. 17 is an exploded top perspective view of the combination drilling depth and control apparatus of FIG. 9;

FIG. 18 is a bottom perspective view thereof;

FIG. 19 is a front elevation view thereof;

FIG. 20 is a rear elevation view thereof;

FIG. 21 is a right elevation view thereof;

FIG. 22 is a left elevation view thereof;

FIG. 23 is a top plan view thereof; and,

FIG. 24 is a bottom plan view thereof.

The broken lines in the drawings are for the purpose of illustrating portions of the combination drilling depth and control apparatus that form no part of the claimed design. The dot-dash broken lines in FIGS. 17-24 indicate the path along which the male and female cylindrical structures connect and forms no part of the claimed design.

1 Claim, 23 Drawing Sheets

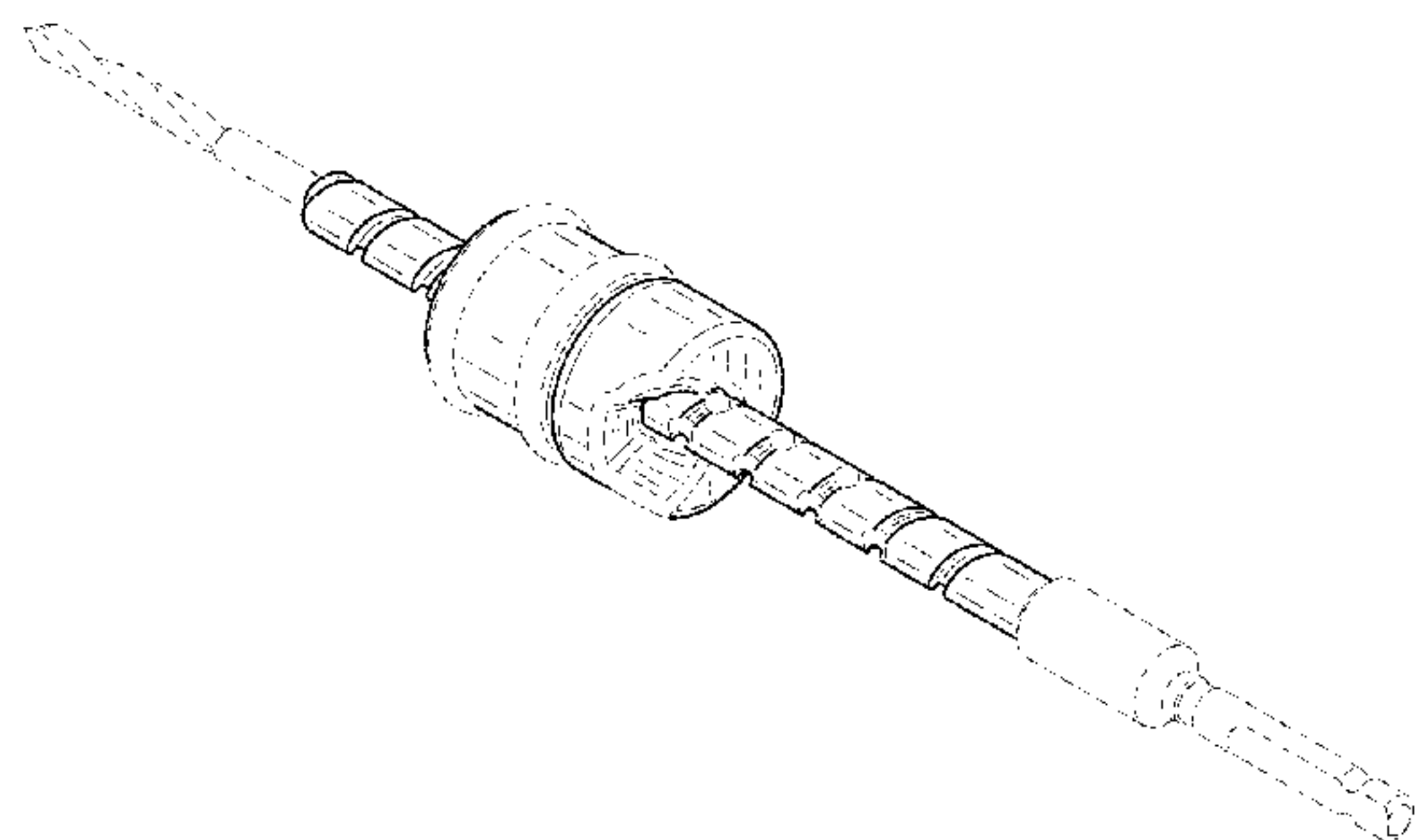

(58) **Field of Classification Search**

CPC .. A61B 17/1626; A61B 17/1633; A61B 17/17
See application file for complete search history.

(56) **References Cited**

U.S. PATENT DOCUMENTS

D616,095 S * 5/2010 Kim D24/140
D625,805 S * 10/2010 Hereford D24/140
D627,461 S * 11/2010 Cantu D24/140
D649,638 S * 11/2011 Habegger D24/140
D719,594 S * 12/2014 Leugers D15/139
D723,896 S * 3/2015 Durfee D8/70
D727,985 S * 4/2015 Leugers D15/139
D732,364 S * 6/2015 Rinaldis D8/70
D793,831 S * 8/2017 Russell D8/70
D793,832 S * 8/2017 Russell D8/70
D806,147 S * 12/2017 Inkster D15/131
D868,966 S * 12/2019 Jamison D24/140
D893,027 S * 8/2020 Peters D24/140
2008/0167653 A1 * 7/2008 Watlington A61B 17/1688
606/81
2008/0177200 A1 * 7/2008 Ikehara A61B 10/025
600/567
2012/0065590 A1 * 3/2012 Bierman A61M 25/06
604/164.05
2014/0276880 A1 * 9/2014 Li A61B 17/17
606/96
2021/0077788 A1 * 3/2021 Lesch A61M 29/02

* cited by examiner

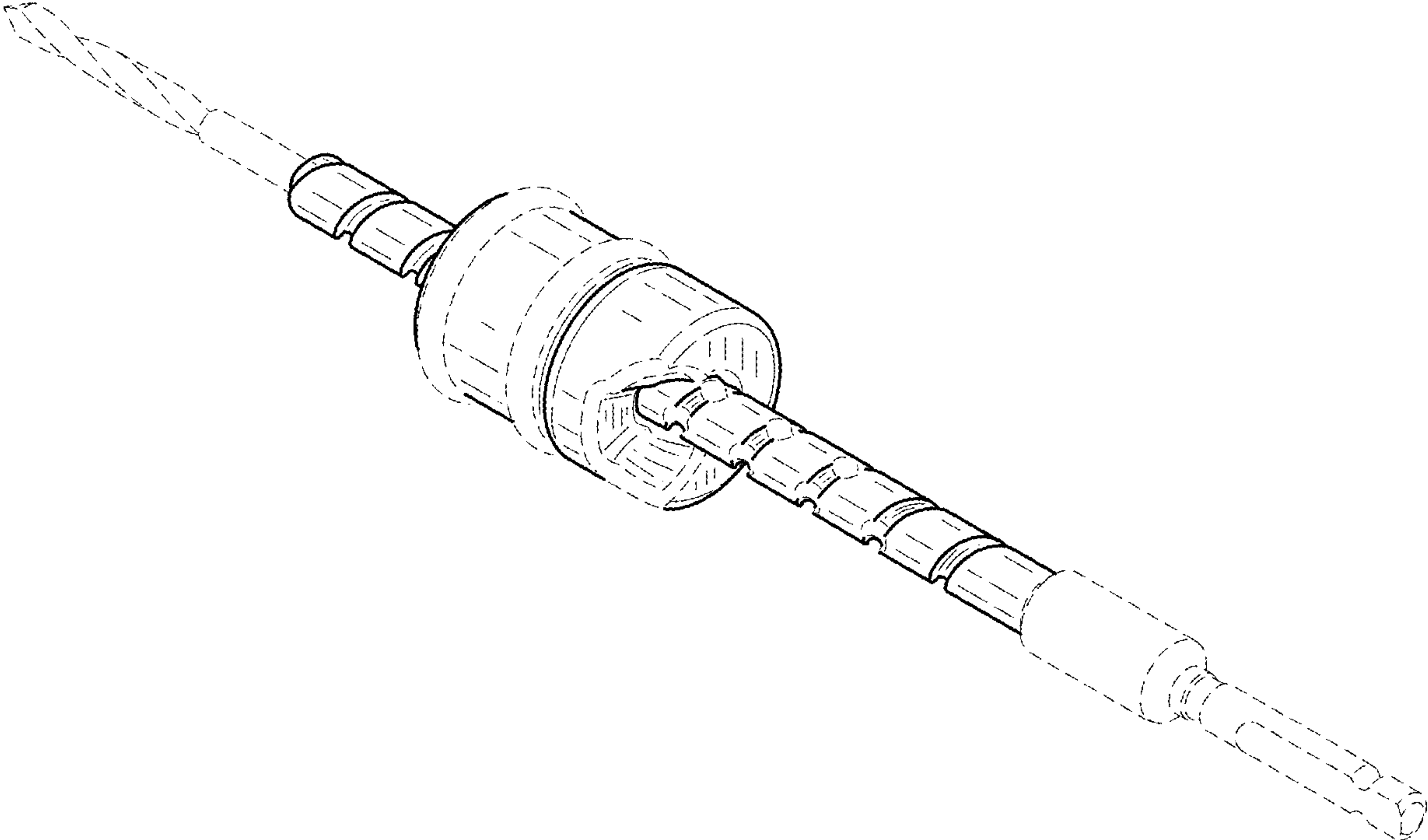

FIG.1

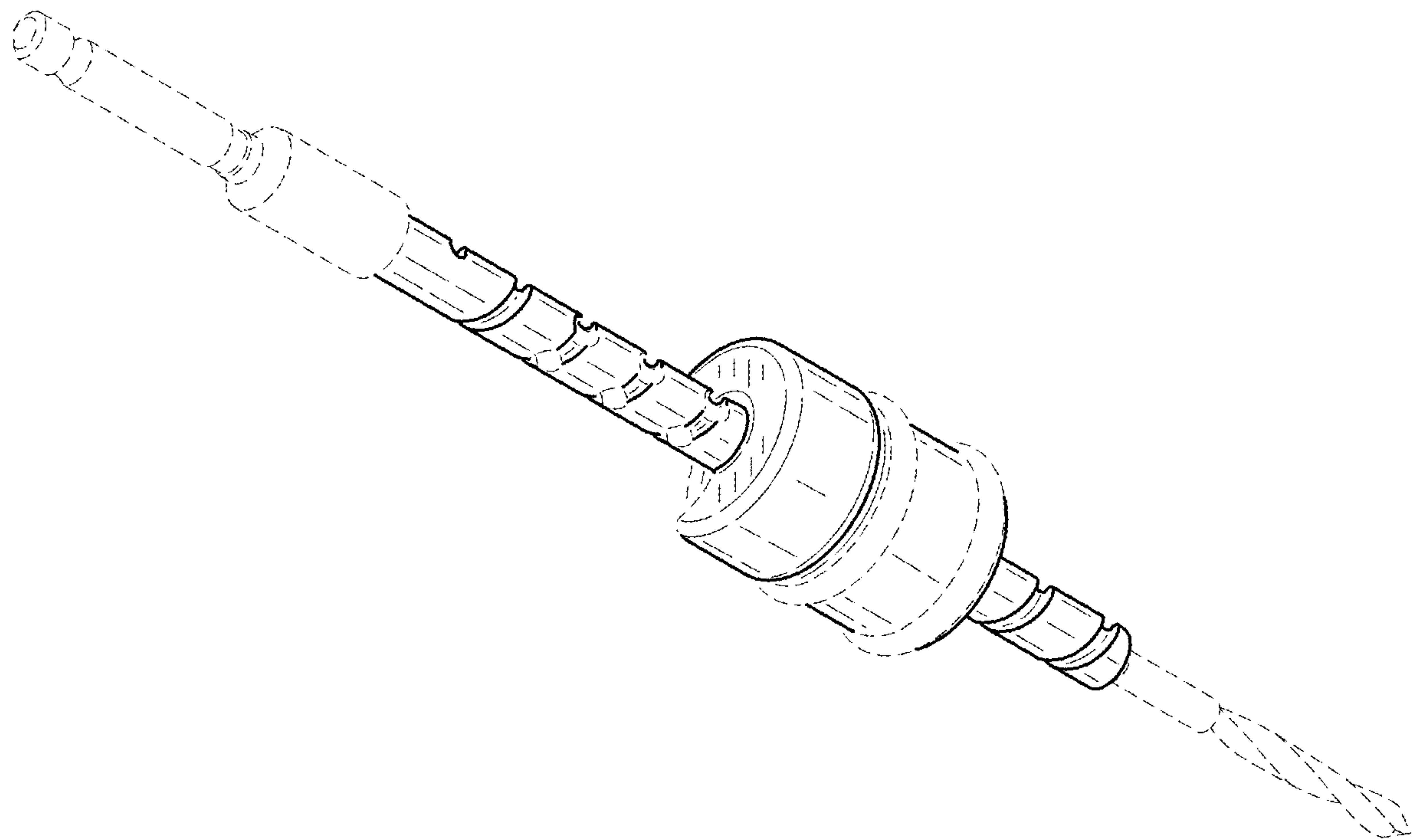

FIG.2

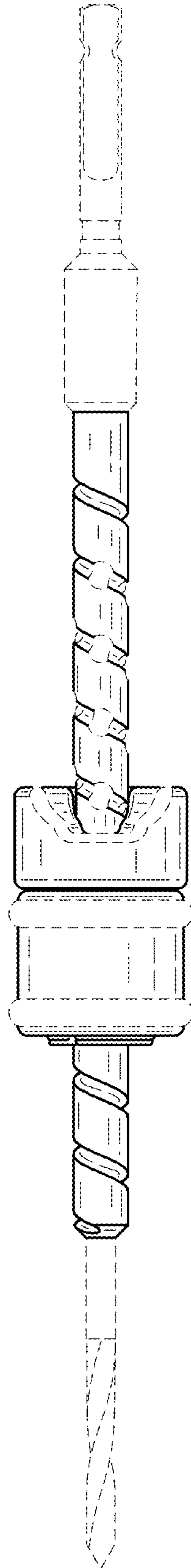

FIG.3

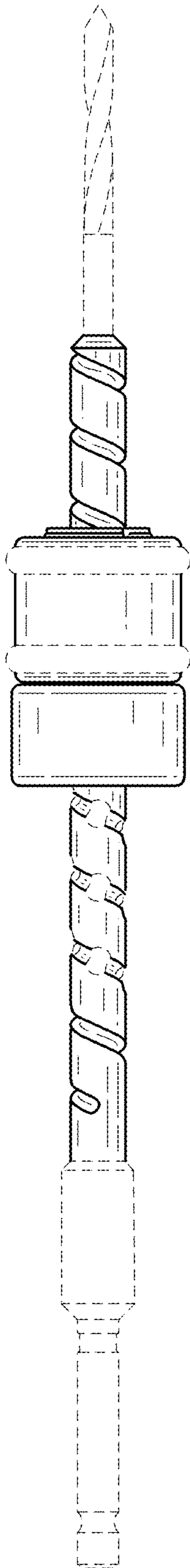

FIG.4

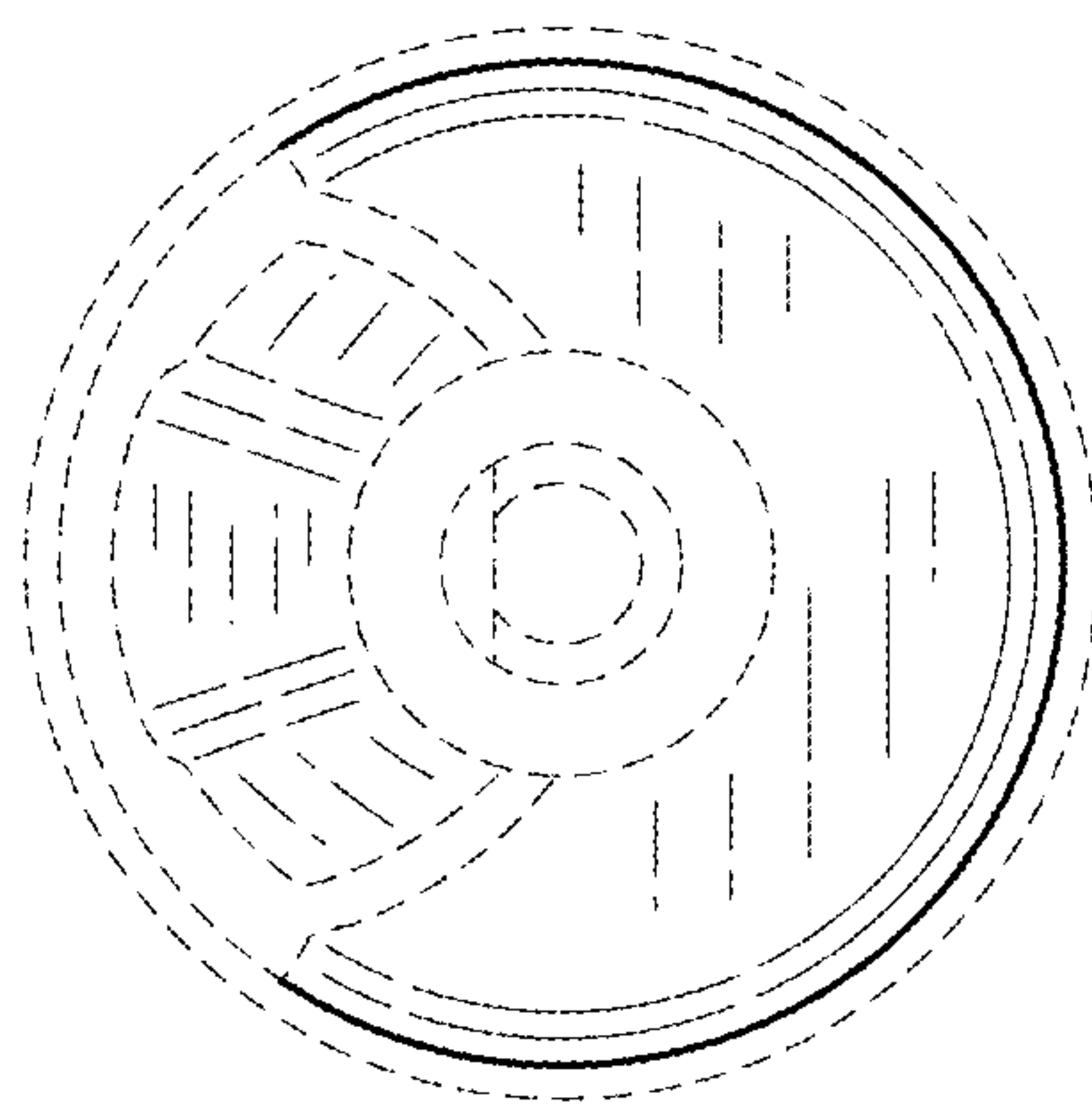

FIG.5

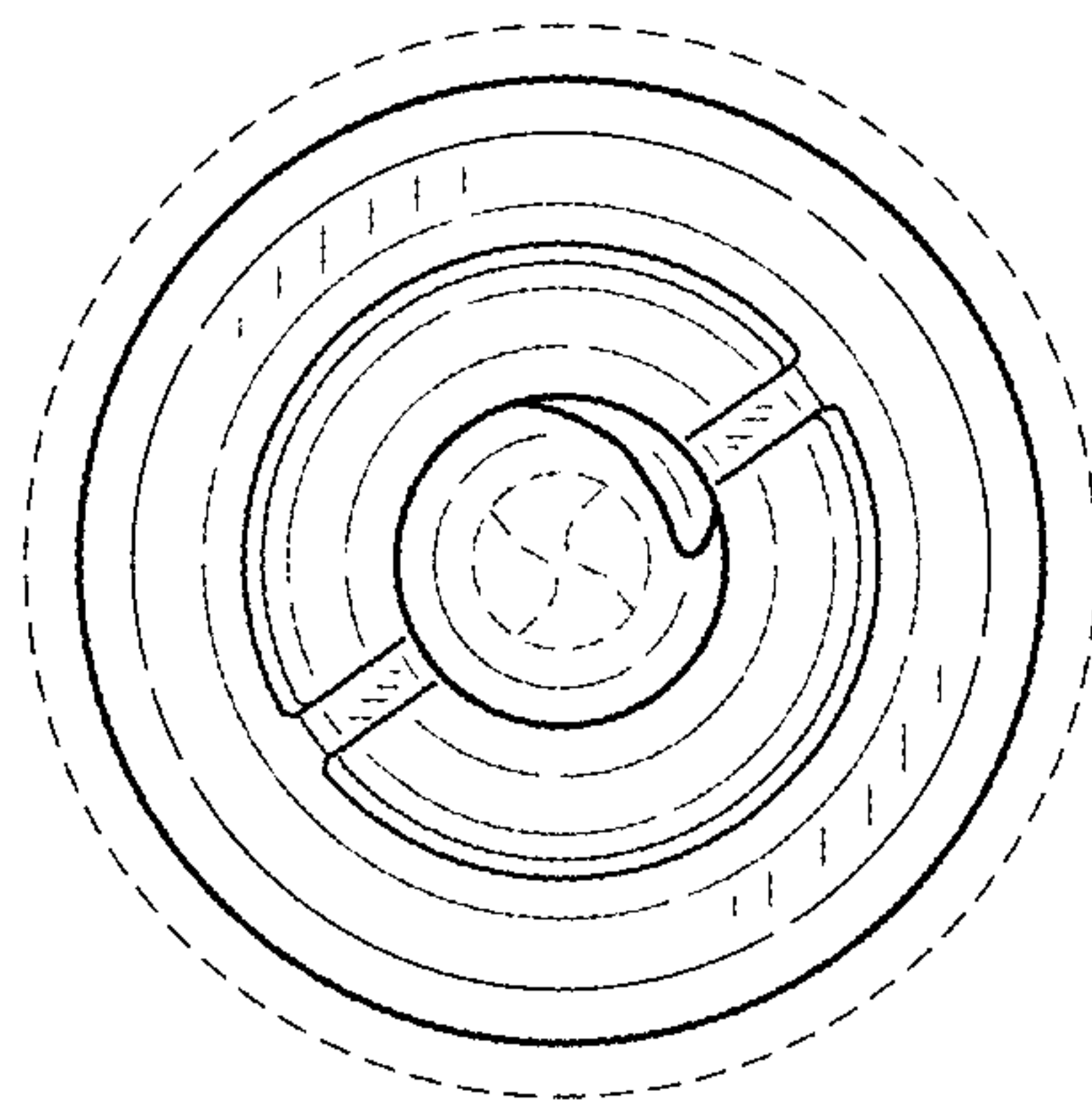

FIG.6

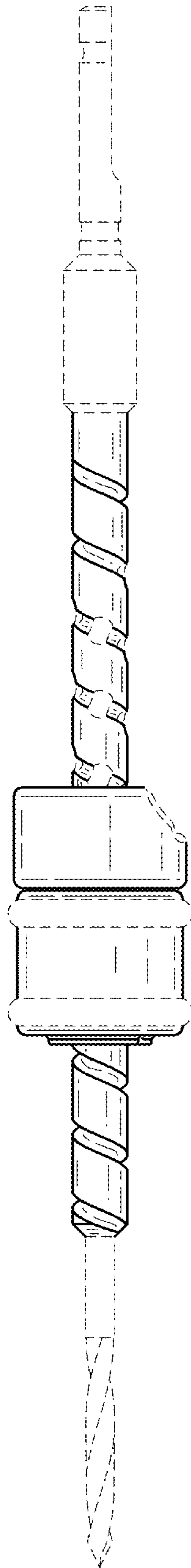

FIG. 7

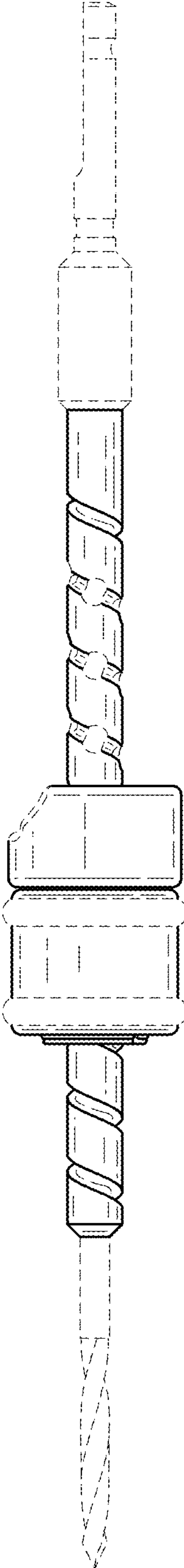

FIG.8

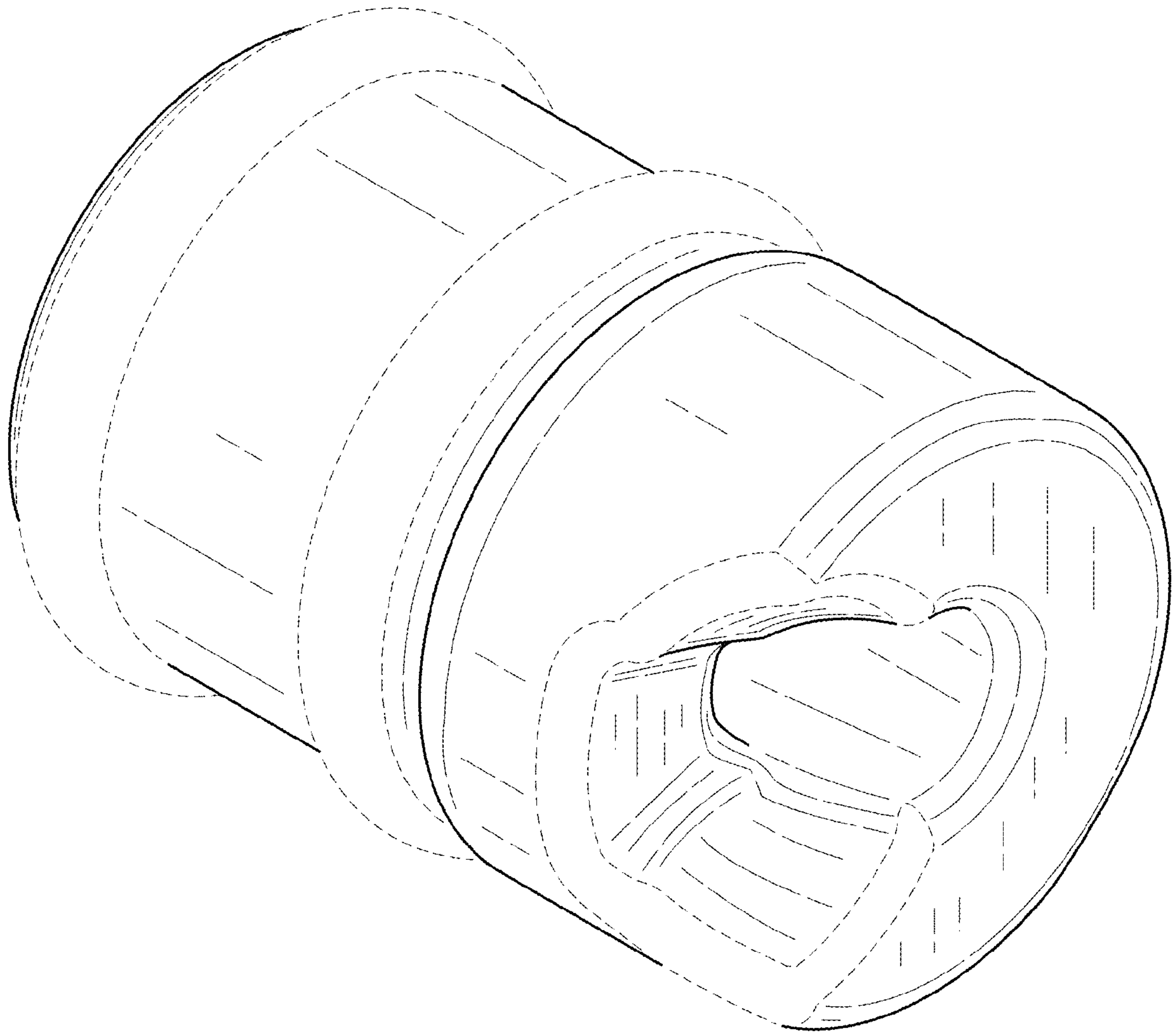

FIG.9

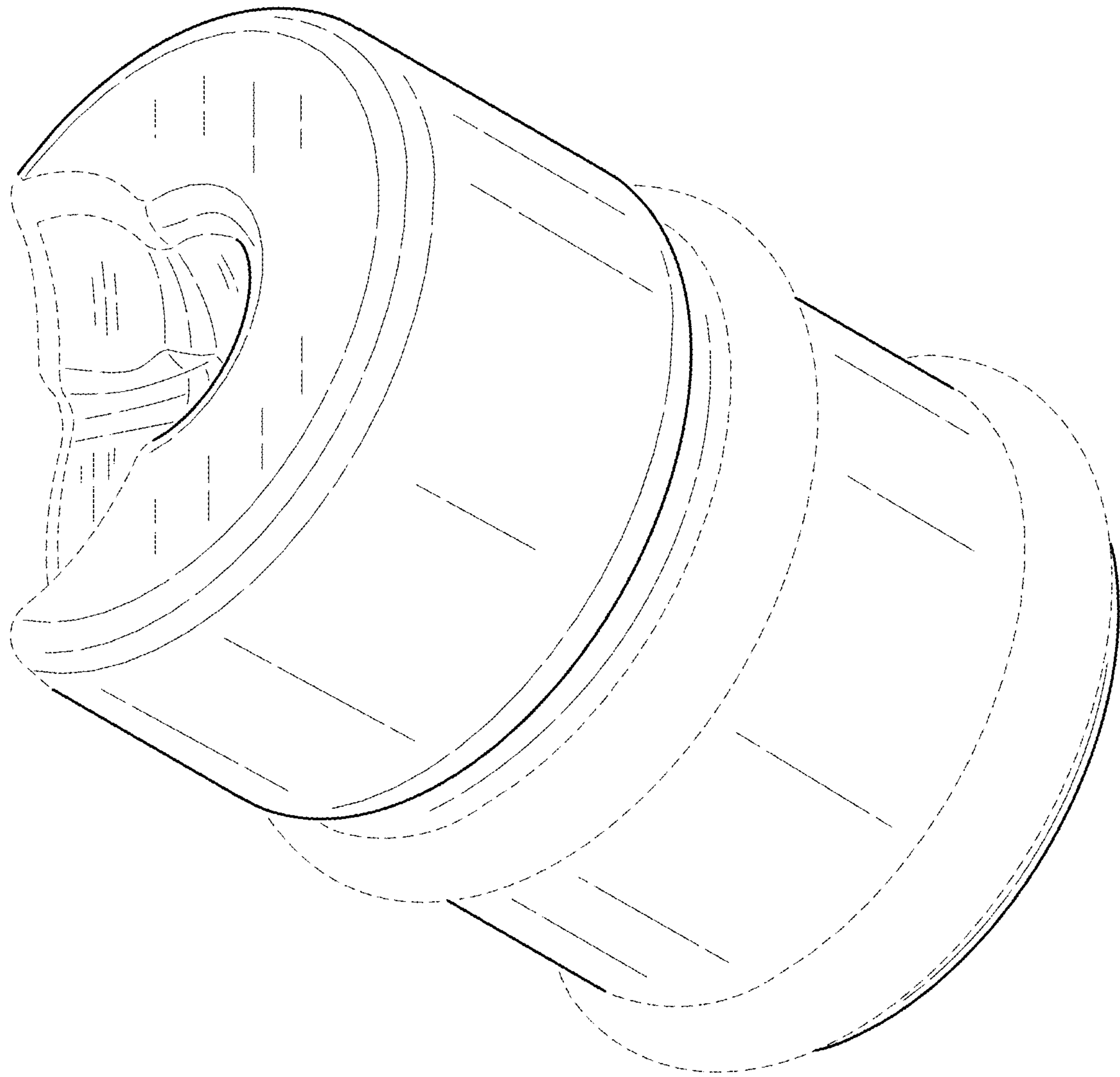

FIG.10

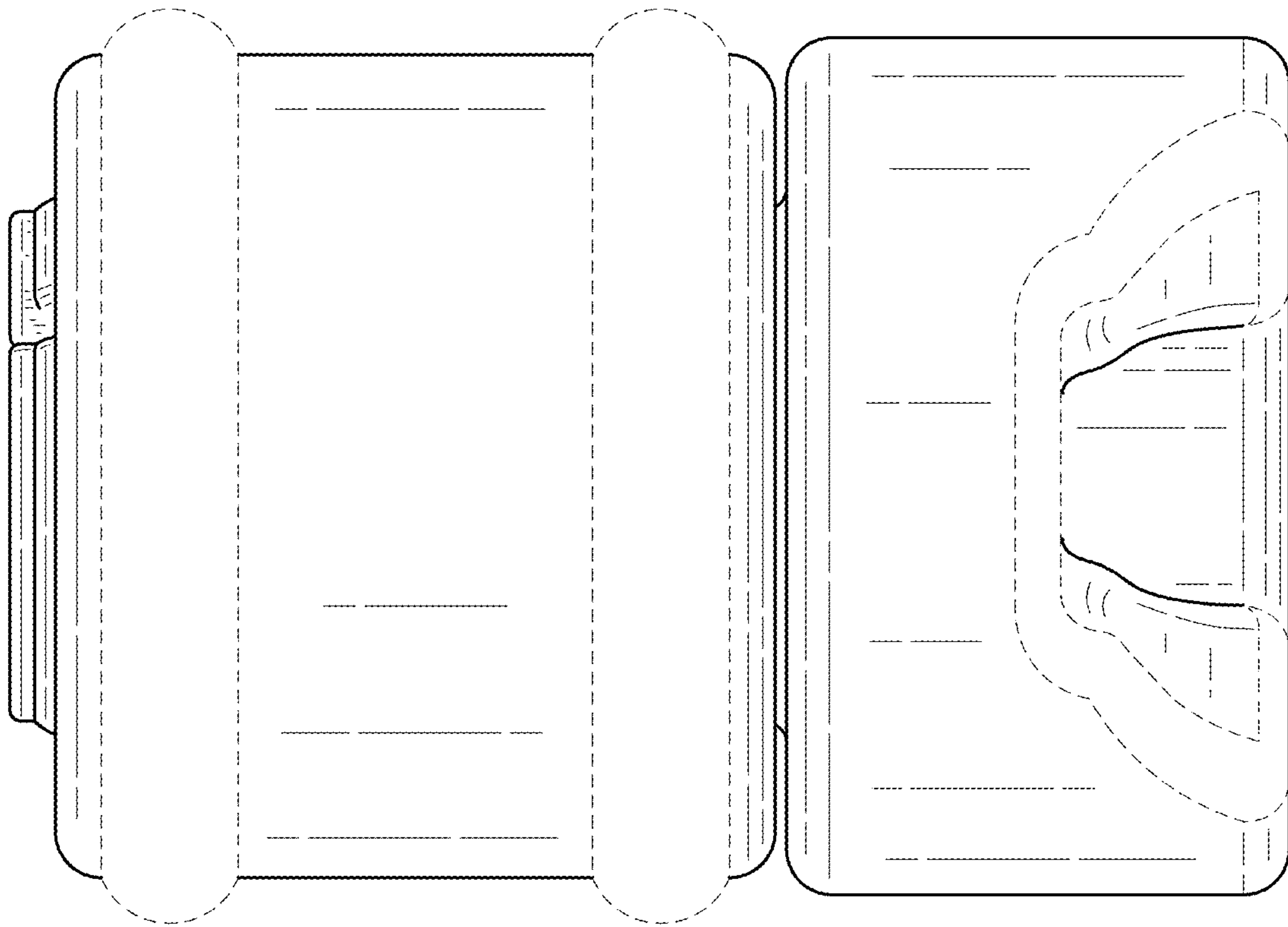

FIG. 11

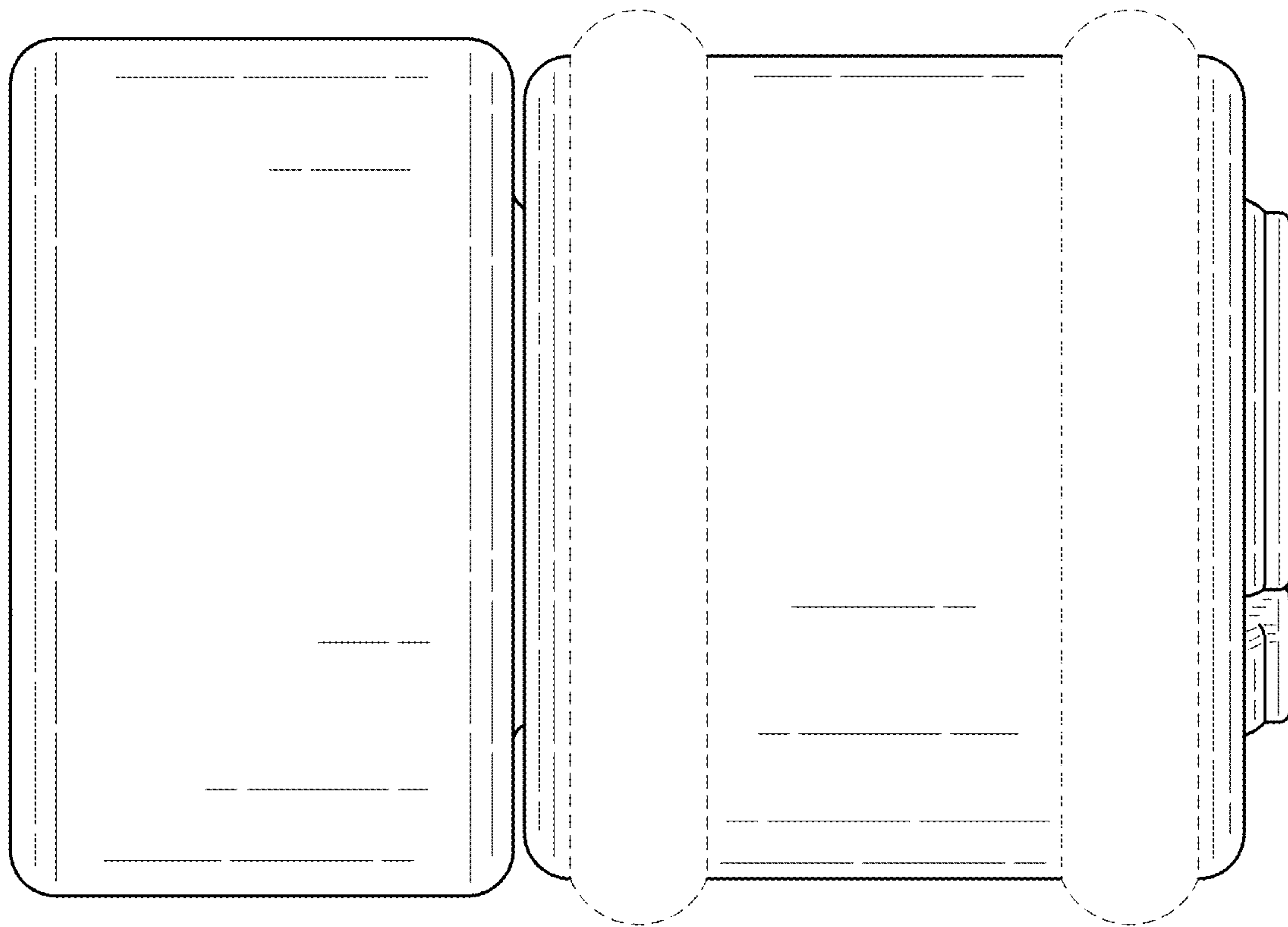

FIG.12

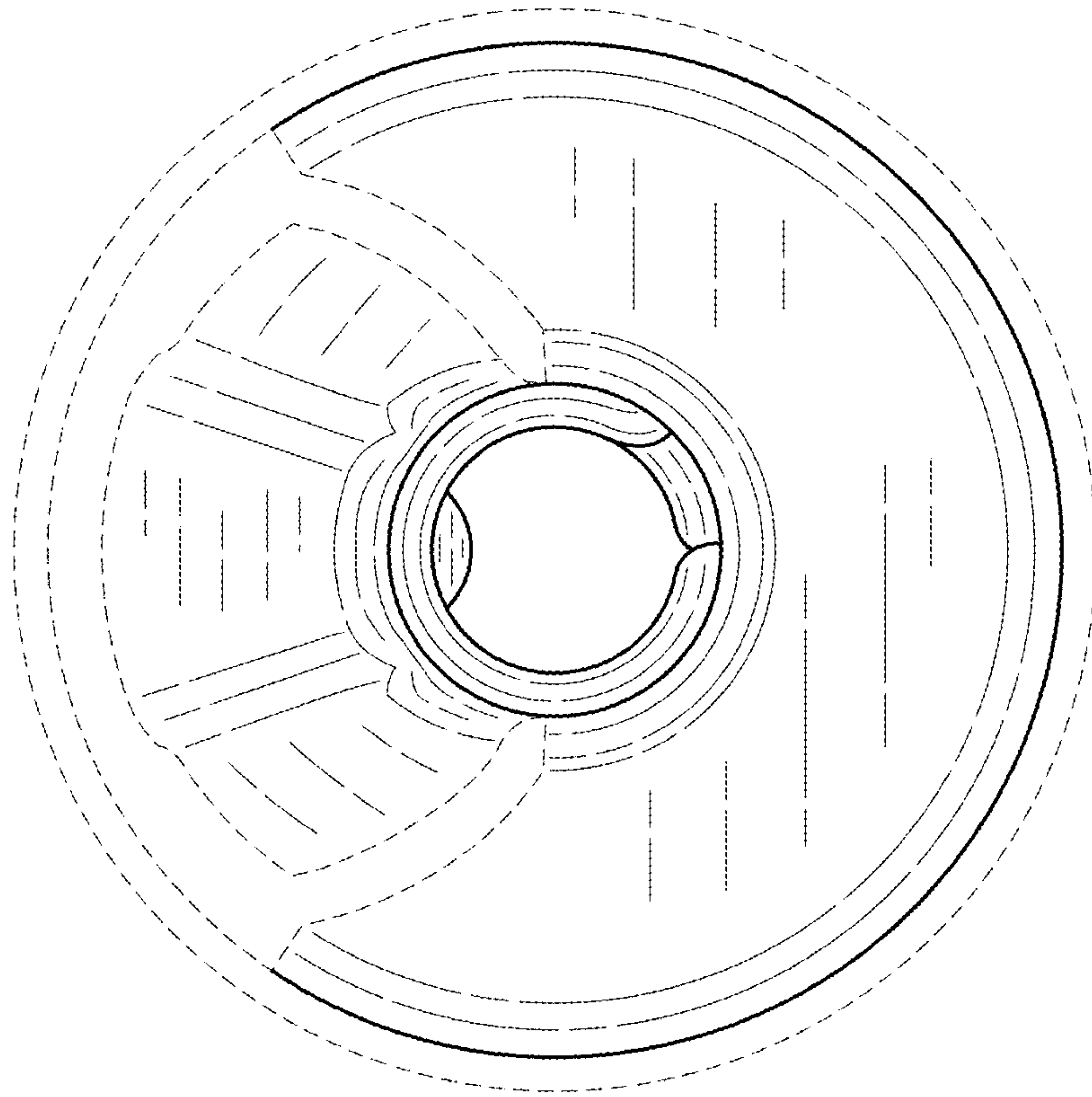

FIG.13

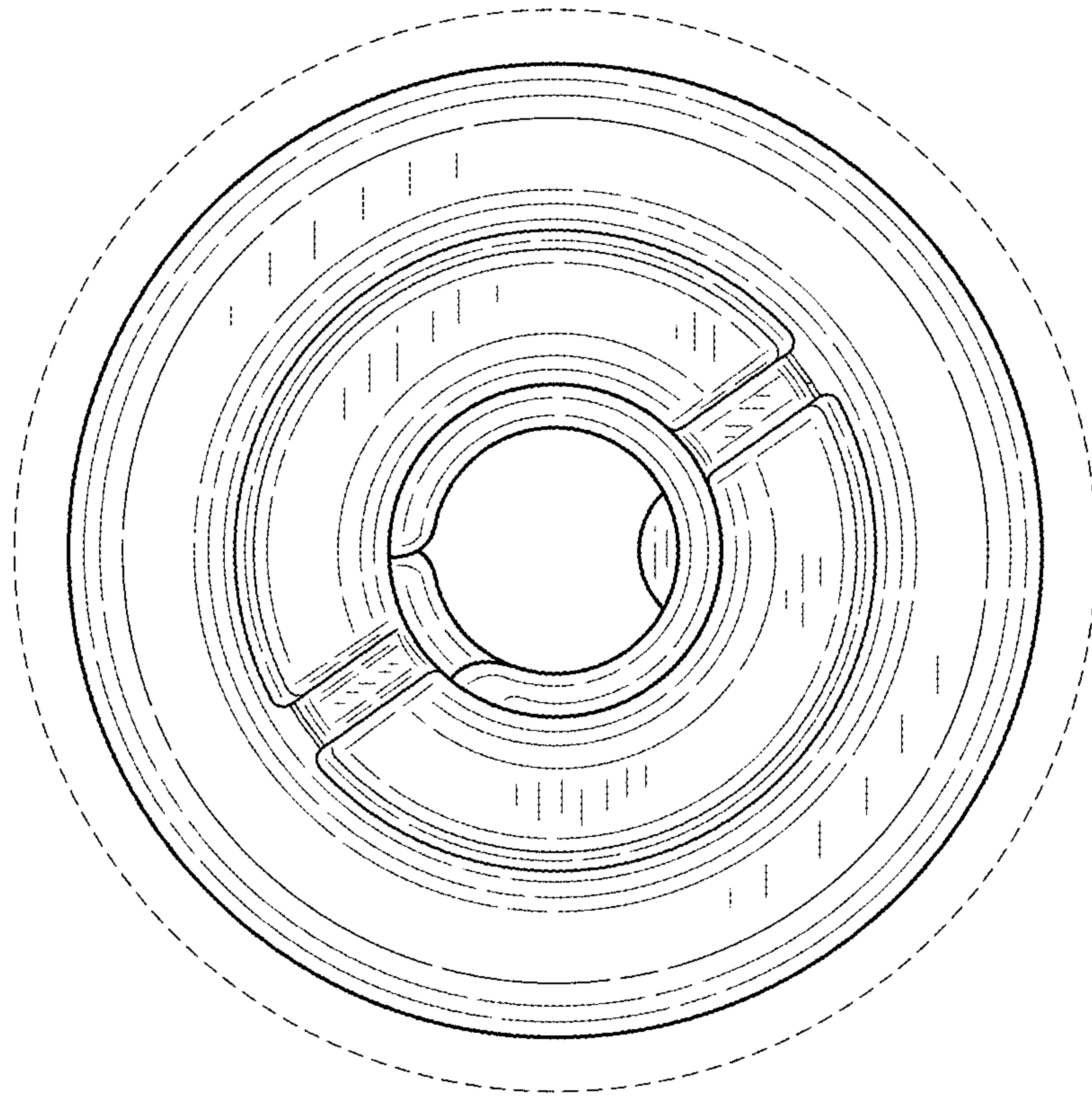

FIG.14

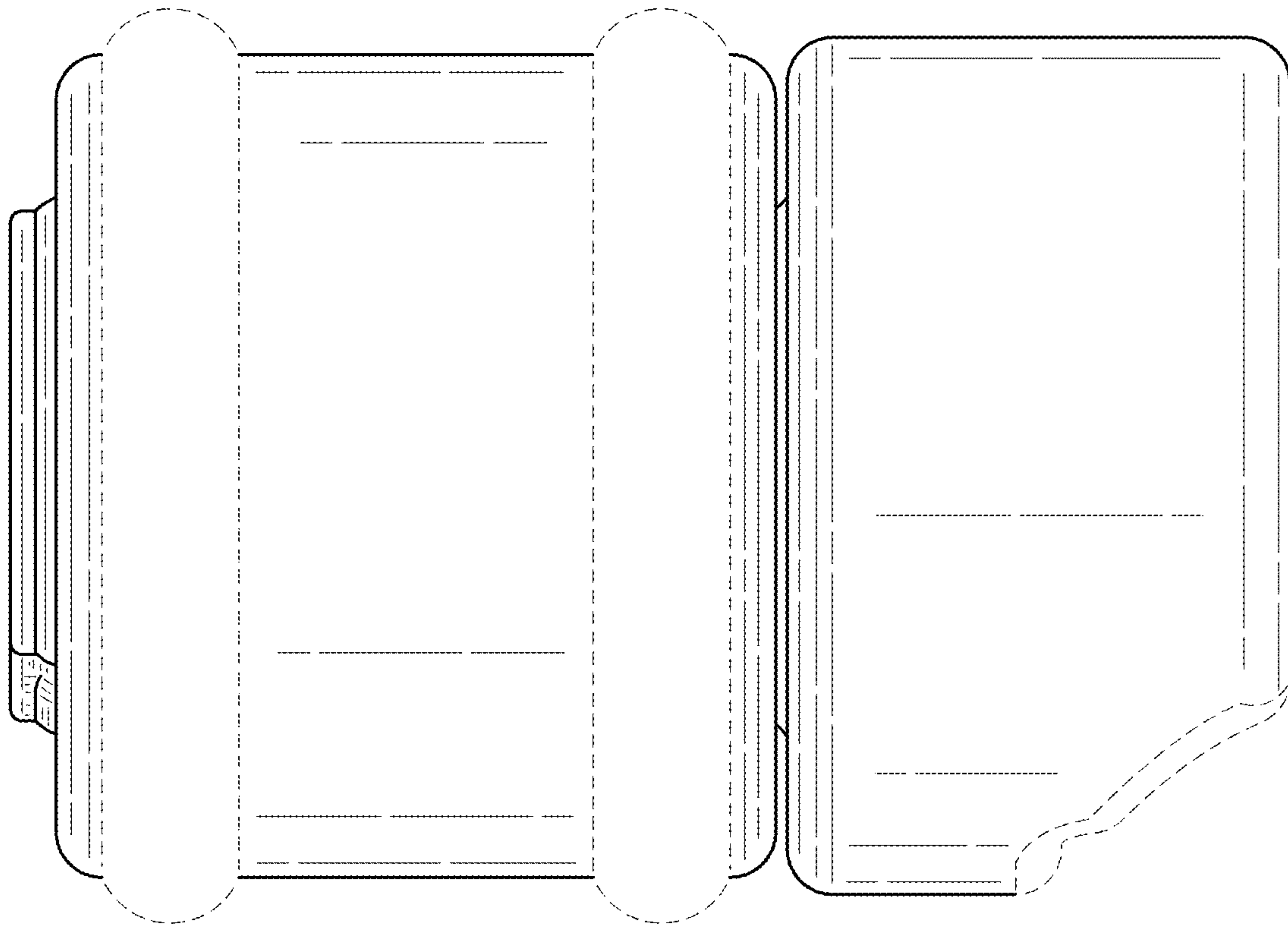

FIG. 15

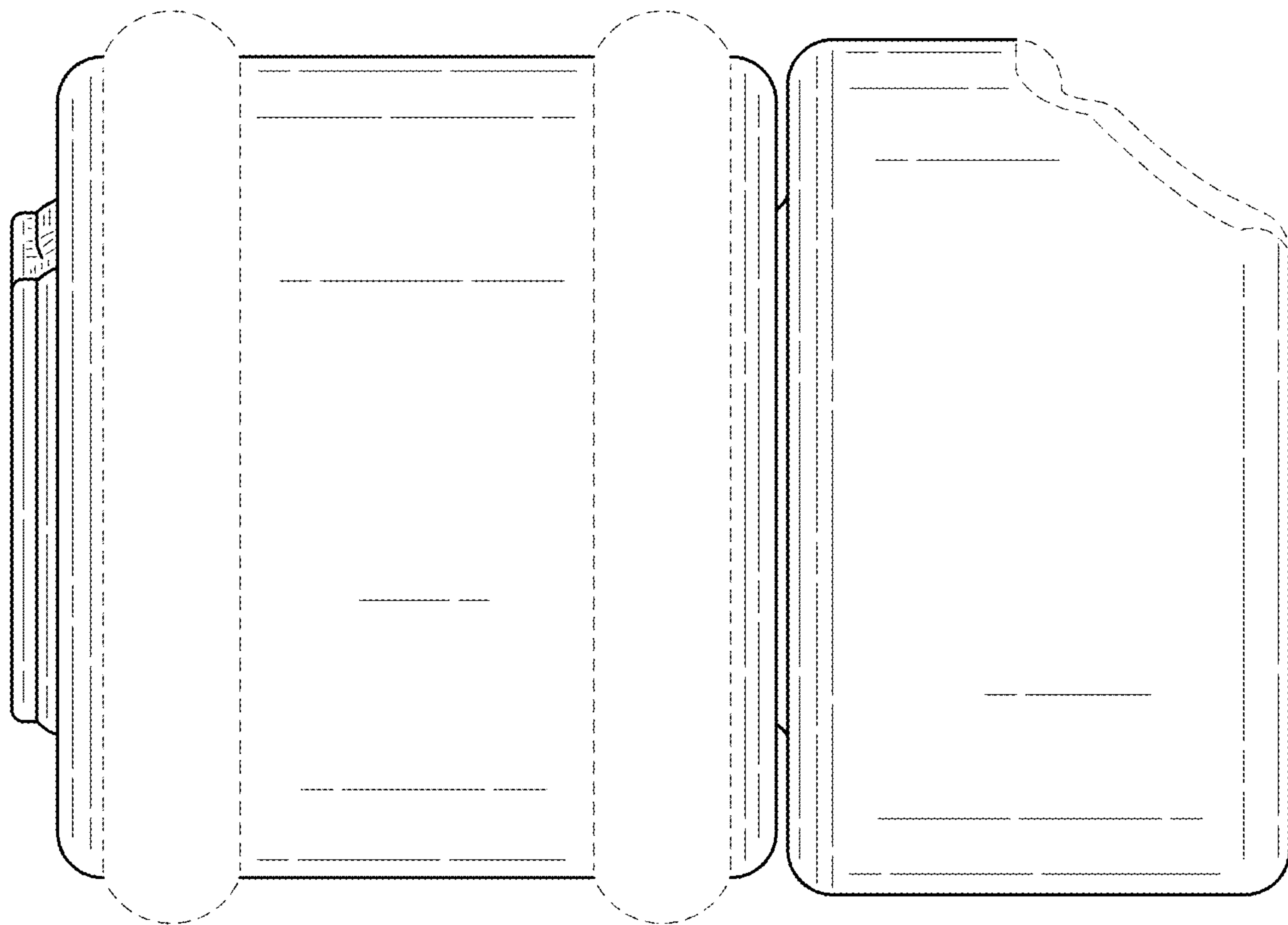

FIG.16

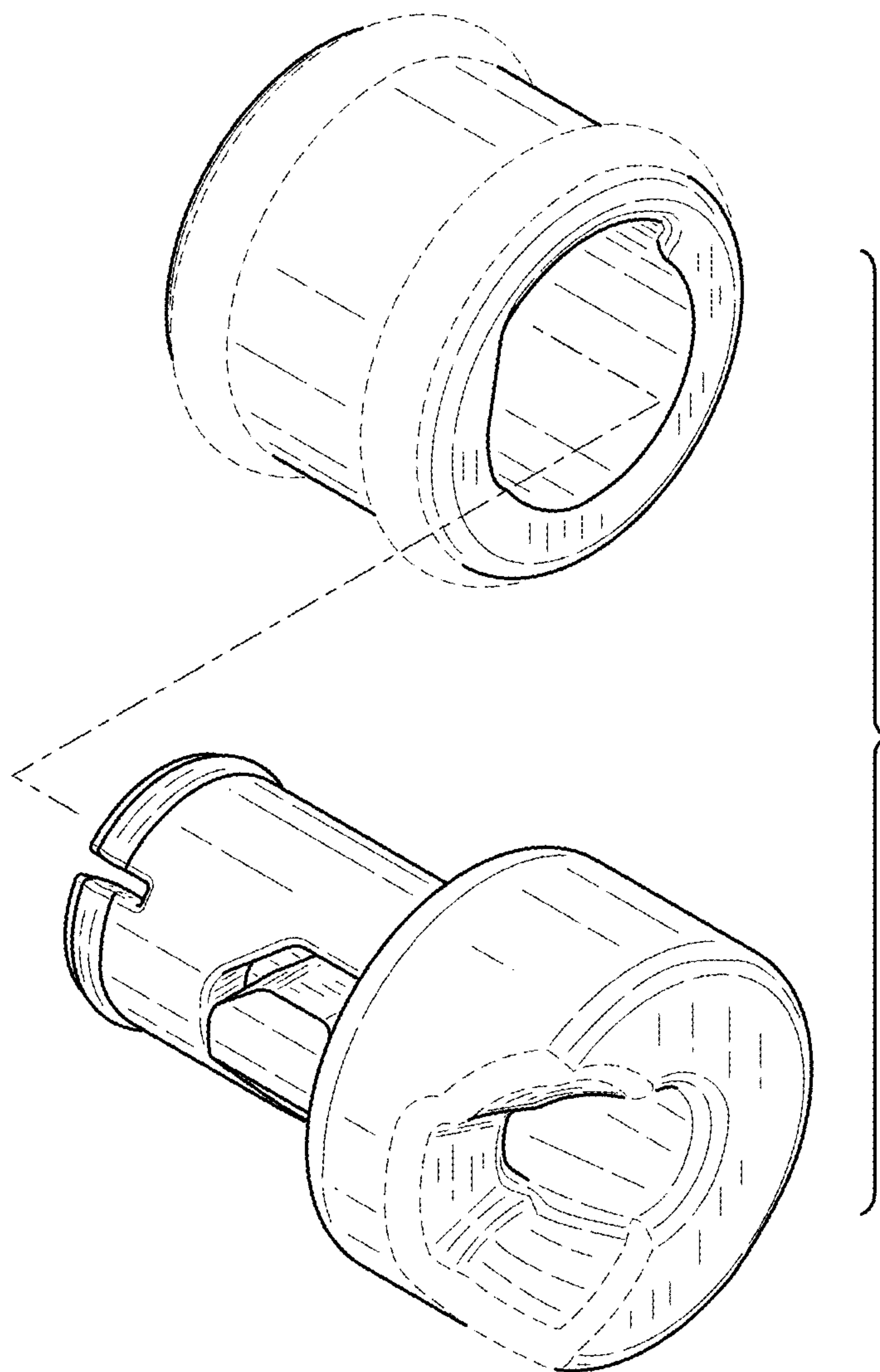

FIG.17

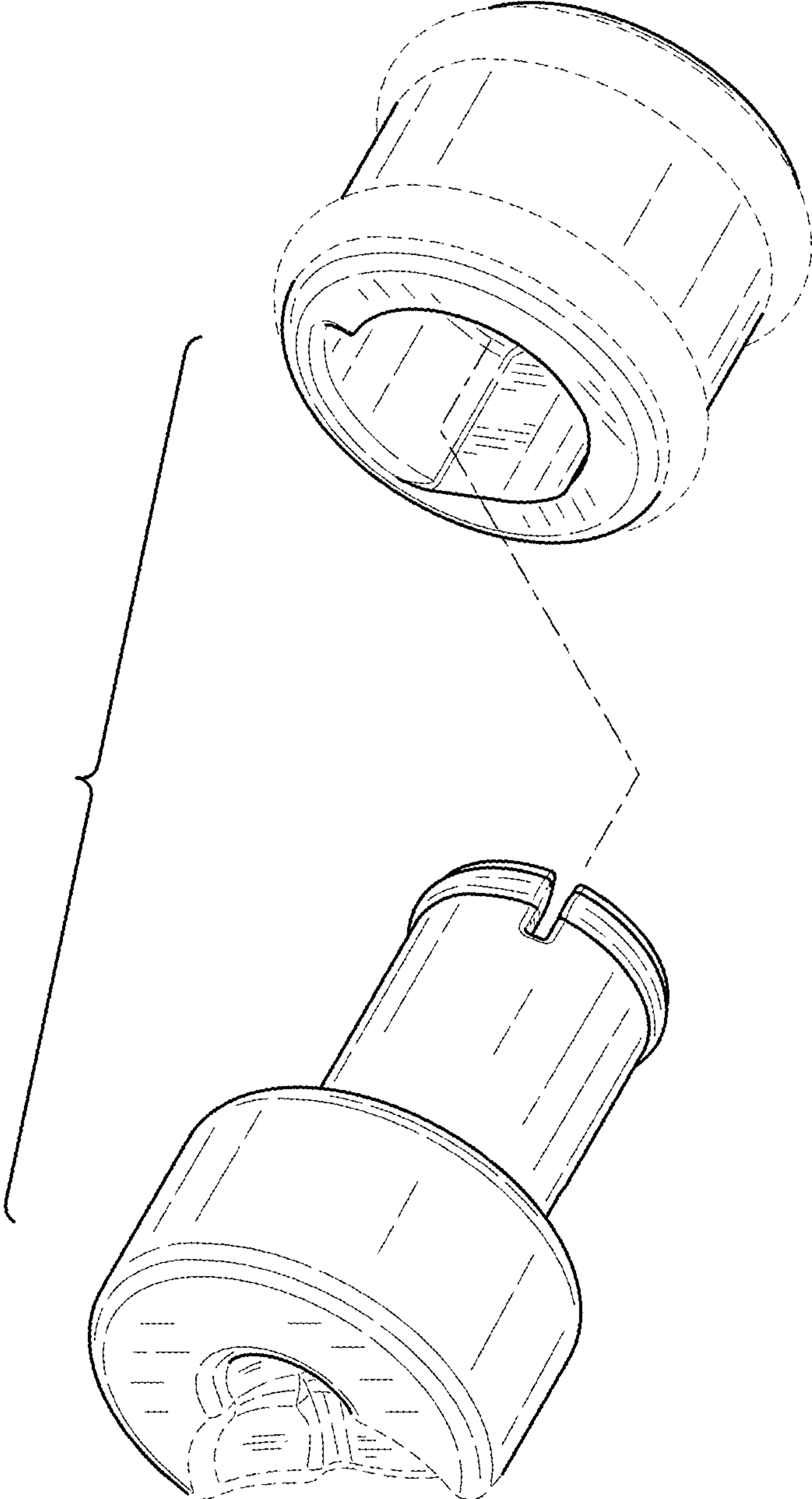

FIG.18

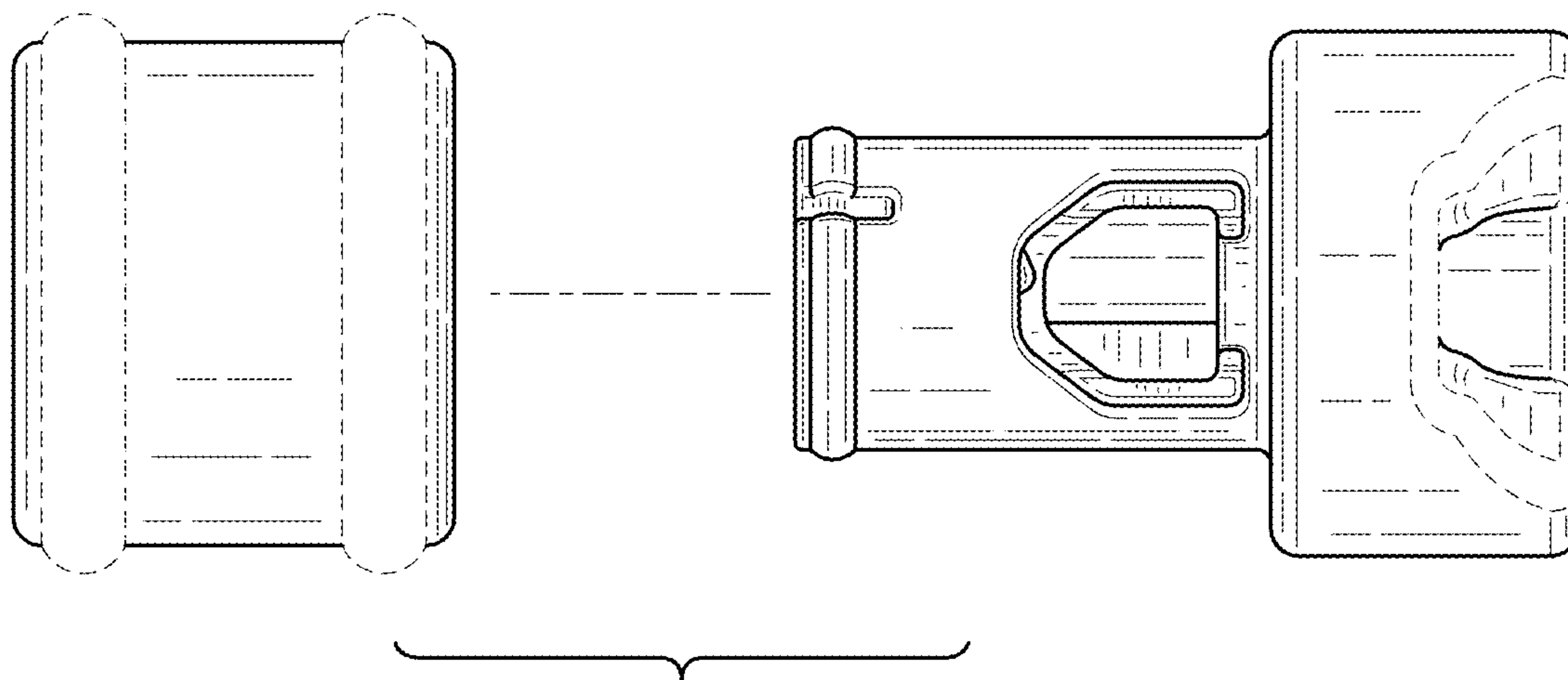

FIG.19

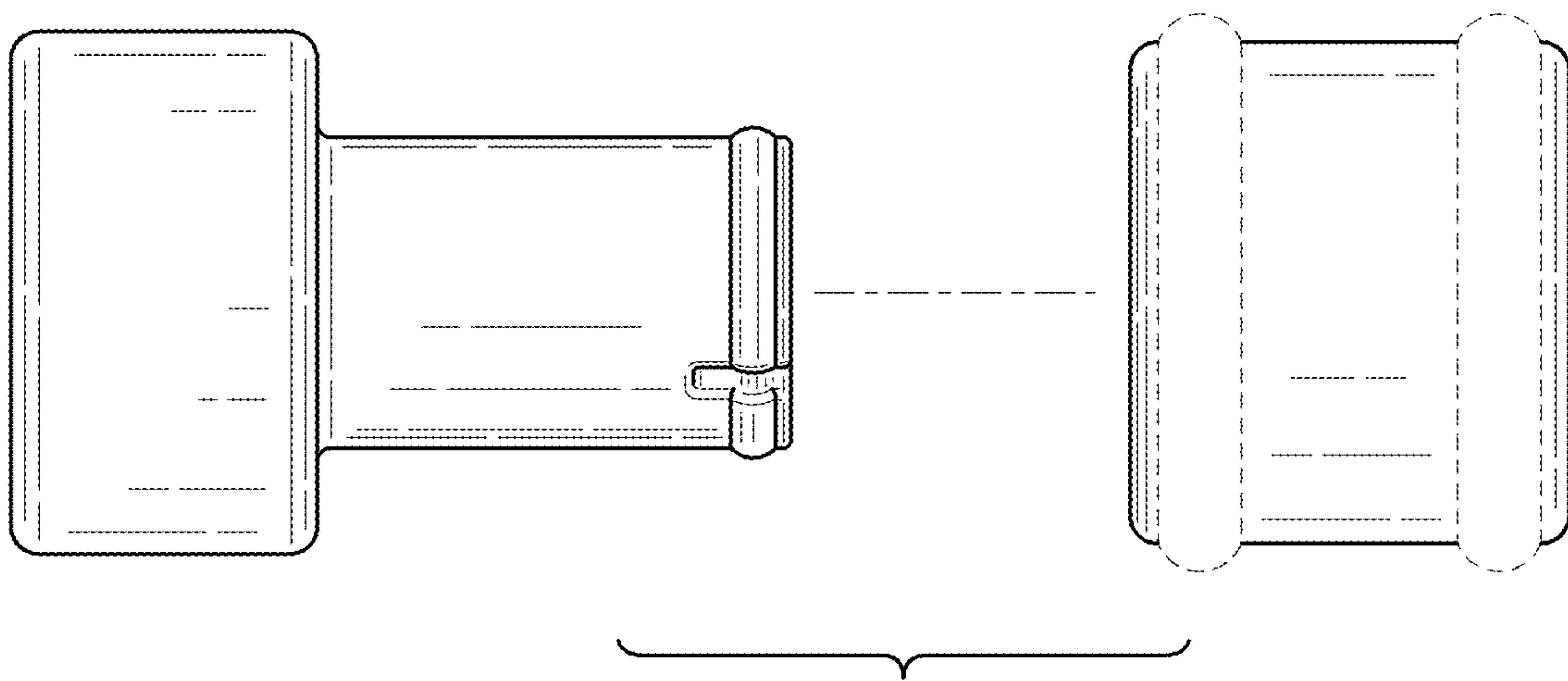

FIG.20

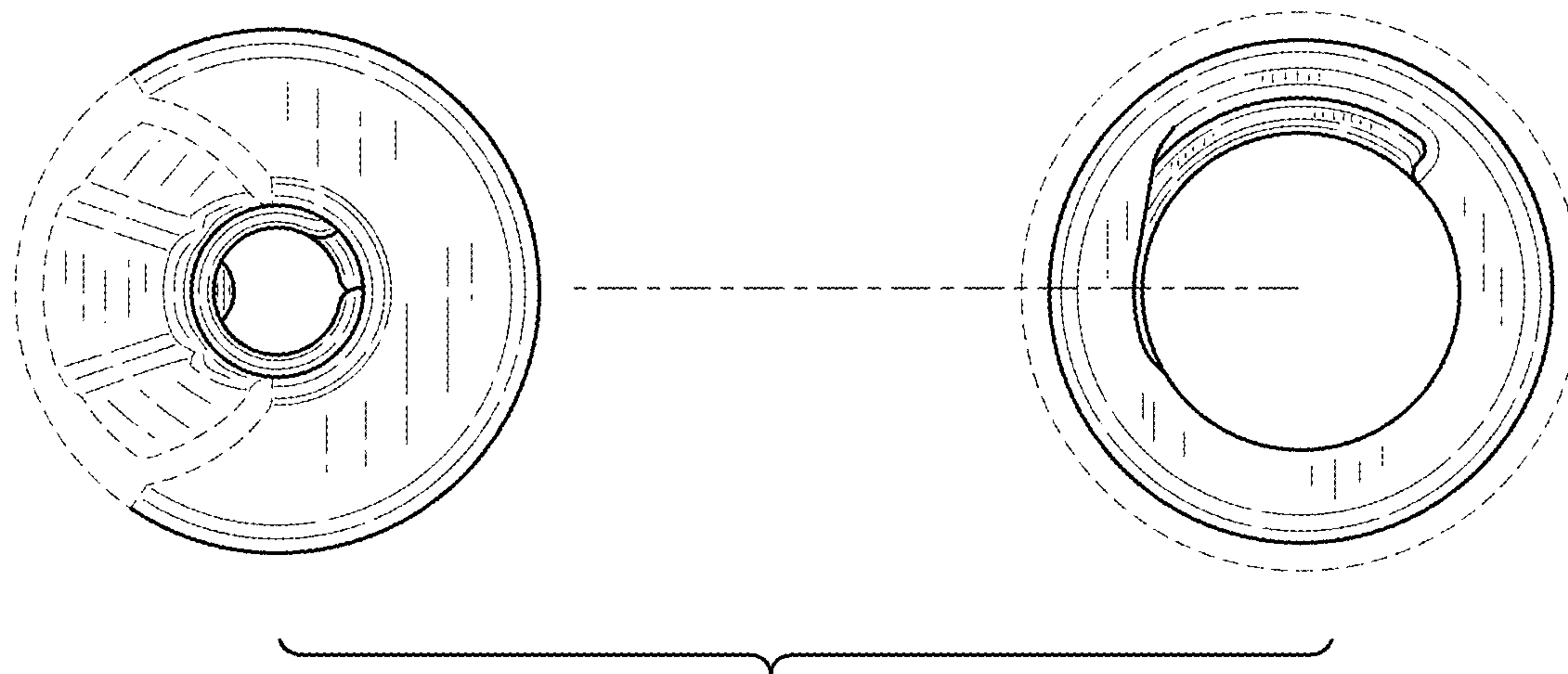

FIG.21

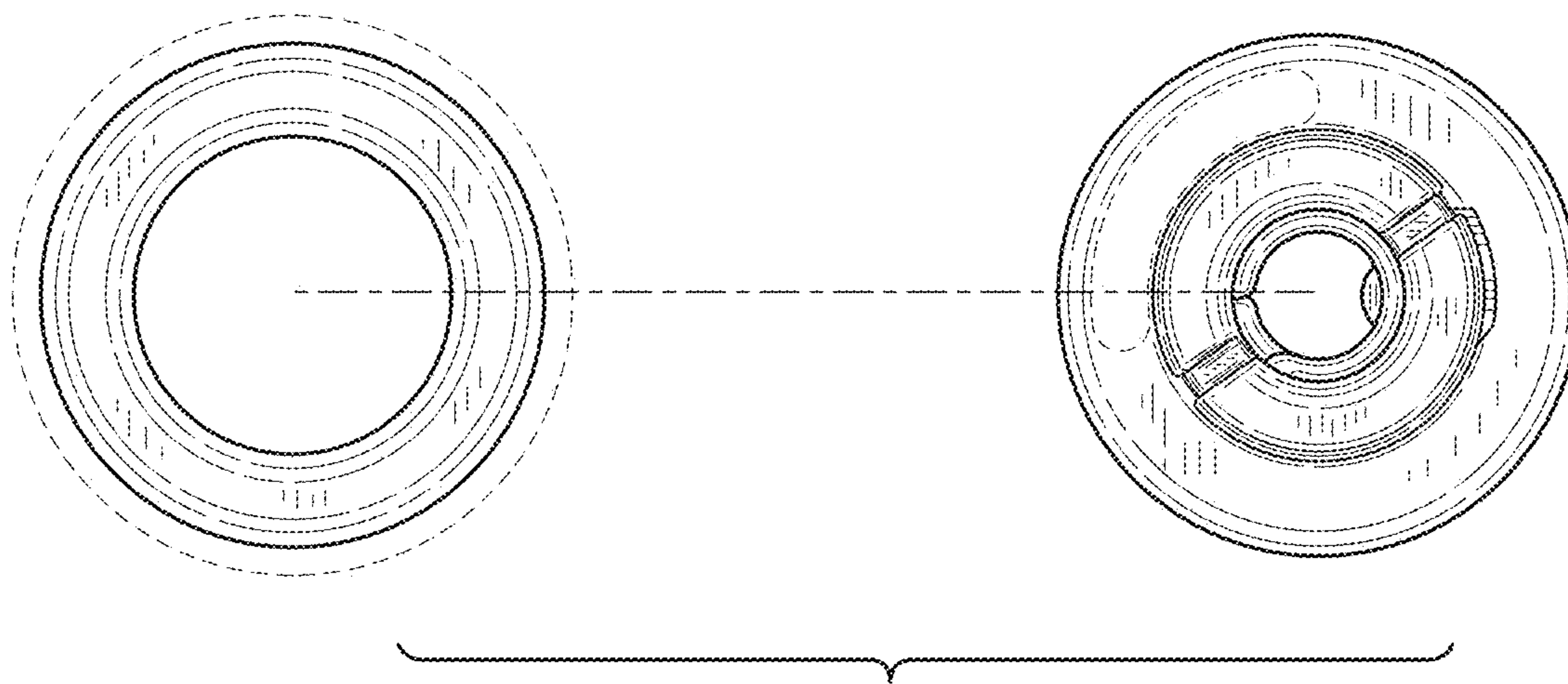

FIG.22

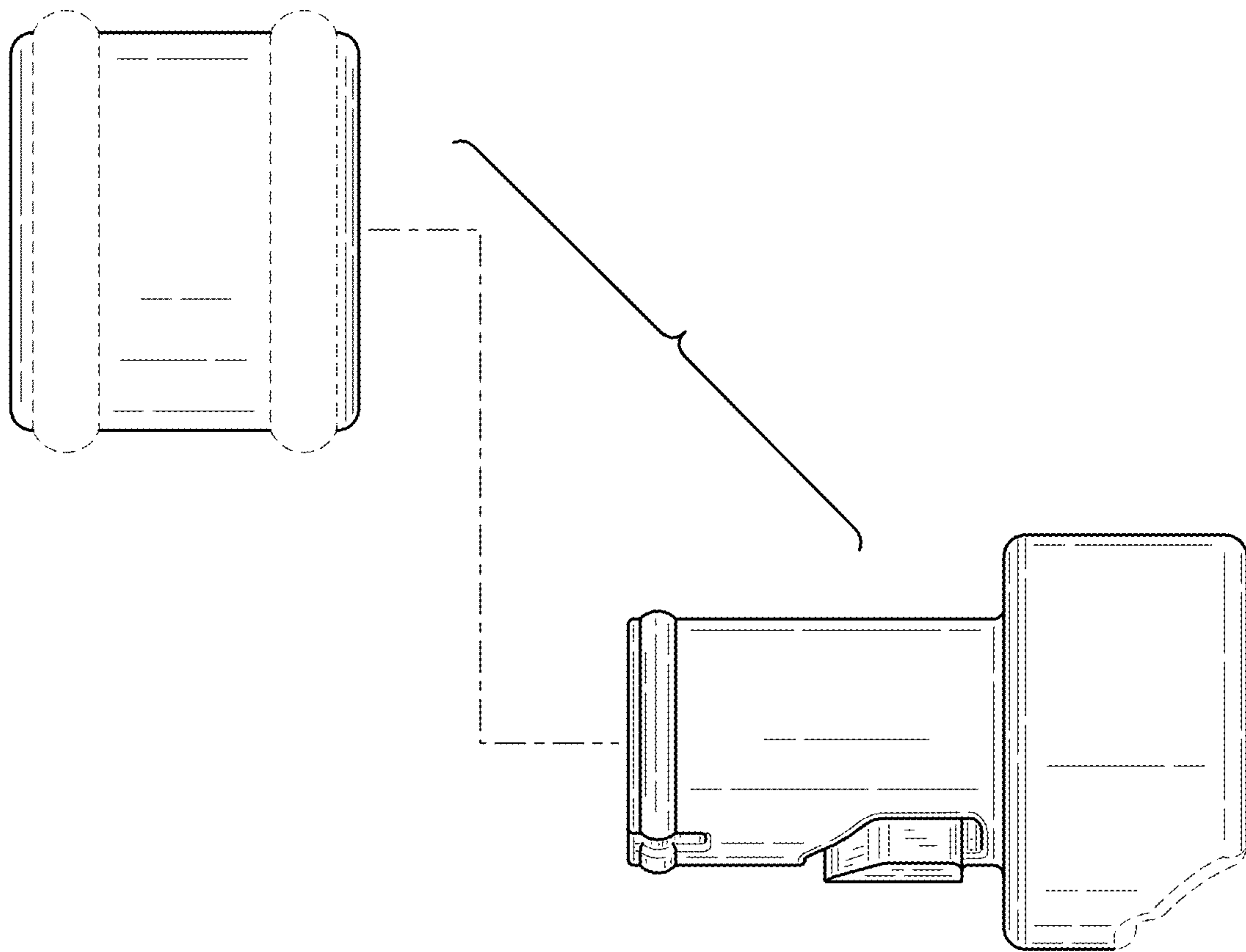

FIG.23

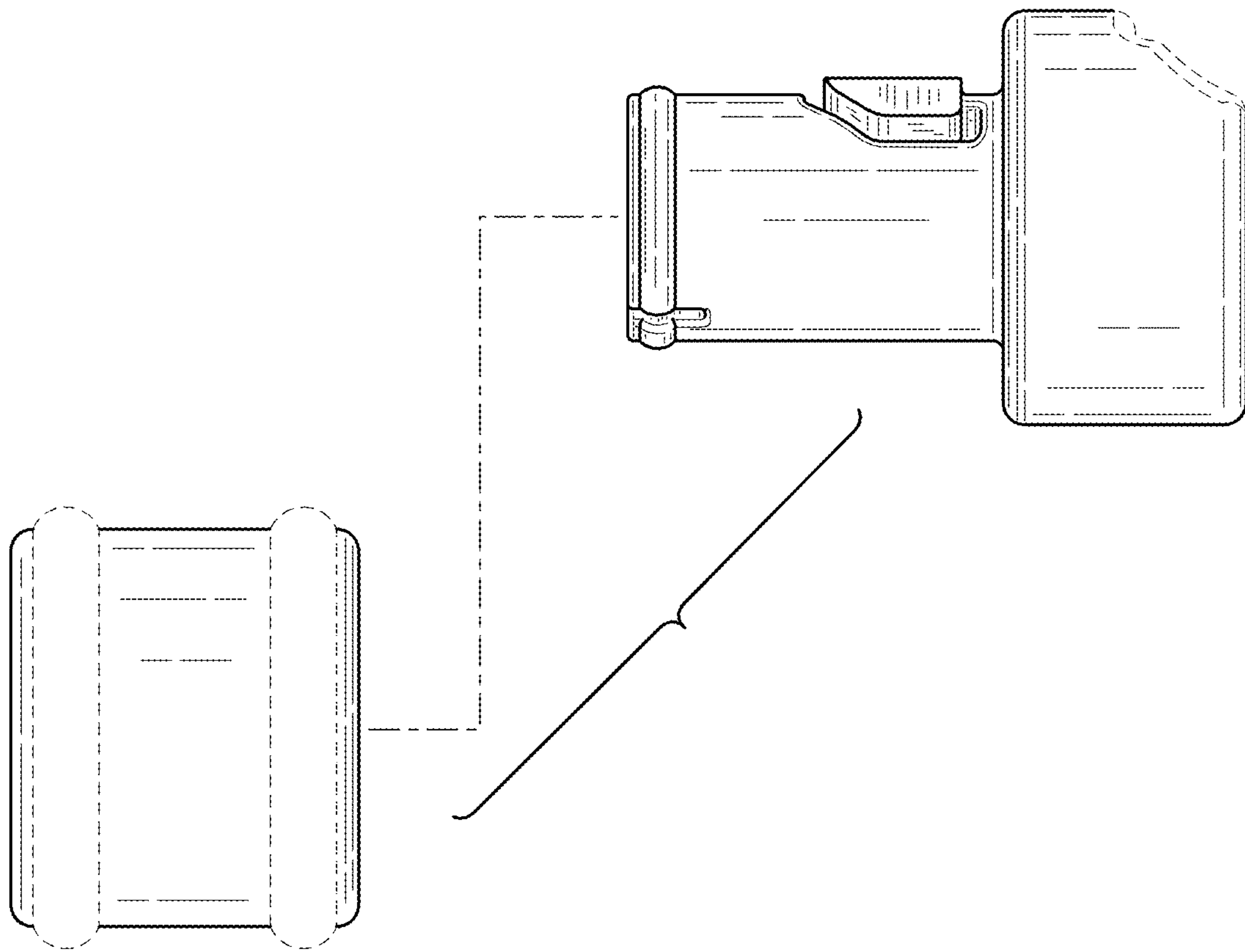

FIG.24