



US00D947350S

(12) **United States Design Patent**
Hyon et al.

(10) **Patent No.:** **US D947,350 S**

(45) **Date of Patent:** **** Mar. 29, 2022**

(54) **KITCHEN HOOD**

(71) Applicant: **LG ELECTRONICS INC.**, Seoul (KR)

(72) Inventors: **Chinsoo Hyon**, Seoul (KR); **Hyunbyung Cha**, Seoul (KR); **Younju Oh**, Seoul (KR); **Hyunju Kim**, Seoul (KR); **Heejeong Heo**, Seoul (KR)

(73) Assignee: **LG ELECTRONICS INC.**, Seoul (KR)

(**) Term: **15 Years**

(21) Appl. No.: **29/732,652**

(22) Filed: **Apr. 27, 2020**

(30) **Foreign Application Priority Data**

Nov. 21, 2019 (KR) 30-2019-0055850

(51) **LOC (13) Cl.** **23-04**

(52) **U.S. Cl.**
USPC **D23/372**

(58) **Field of Classification Search**
USPC D23/351, 353, 355, 364, 370-372, 385, D23/393, 395
CPC .. F24C 15/20; F24C 15/2007; F24C 15/2071; F24C 15/2078; F24C 15/2092
See application file for complete search history.

(56) **References Cited**

U.S. PATENT DOCUMENTS

| | | | | |
|--------------|--------|-----------|-------|------------|
| D452,907 S * | 1/2002 | Tamura | | D23/372 |
| D489,805 S * | 5/2004 | Vetter | | F24C 15/20 |
| | | | | D23/371 |
| D490,887 S * | 6/2004 | Segers | | D23/372 |
| D516,695 S * | 3/2006 | Vetter | | D23/372 |
| D527,088 S * | 8/2006 | Hendrickx | | D23/372 |
| D550,343 S * | 9/2007 | Chen | | D23/364 |

| | | | | |
|-------------------|---------|------------|-------|--------------|
| D576,264 S * | 9/2008 | Grobleben | | D23/372 |
| D621,022 S * | 8/2010 | Funnell | | D23/372 |
| D730,507 S * | 5/2015 | Borjesson | | D23/372 |
| D771,789 S * | 11/2016 | Smith | | D23/393 |
| D879,273 S * | 3/2020 | Shih | | D23/356 |
| D895,093 S * | 9/2020 | Nakamura | | D23/364 |
| 2015/0114384 A1 * | 4/2015 | Bruin-Slot | | F24C 15/2071 |
| | | | | 126/299 D |
| 2021/0123605 A1 * | 4/2021 | Heo | | F24C 15/2042 |
| 2021/0243854 A1 * | 8/2021 | Langford | | H05B 6/6423 |

* cited by examiner

Primary Examiner — Sharon S Oum

(74) *Attorney, Agent, or Firm* — Birch, Stewart, Kolasch & Birch, LLP

(57) **CLAIM**

We claim the ornamental design for a kitchen hood, as shown and described.

DESCRIPTION

FIG. 1 is a perspective view of a kitchen hood showing our new design in a first position of use;
 FIG. 2 is a front elevation view thereof;
 FIG. 3 is a rear elevation view thereof;
 FIG. 4 is a left side elevation view thereof;
 FIG. 5 is a right side elevation view thereof;
 FIG. 6 is a top plan view thereof;
 FIG. 7 is a bottom plan view thereof;
 FIG. 8 is a perspective view of the kitchen hood of FIG. 1 shown in a second position of use;
 FIG. 9 is a front elevation view thereof;
 FIG. 10 is a rear elevation view thereof;
 FIG. 11 is a left side elevation view thereof;
 FIG. 12 is a right side elevation view thereof;
 FIG. 13 is a top plan view thereof; and,
 FIG. 14 is a bottom plan view thereof.
 The broken lines shown in FIGS. 6 and 13 depict portions of the kitchen hood that form no part of the claimed design.

1 Claim, 14 Drawing Sheets

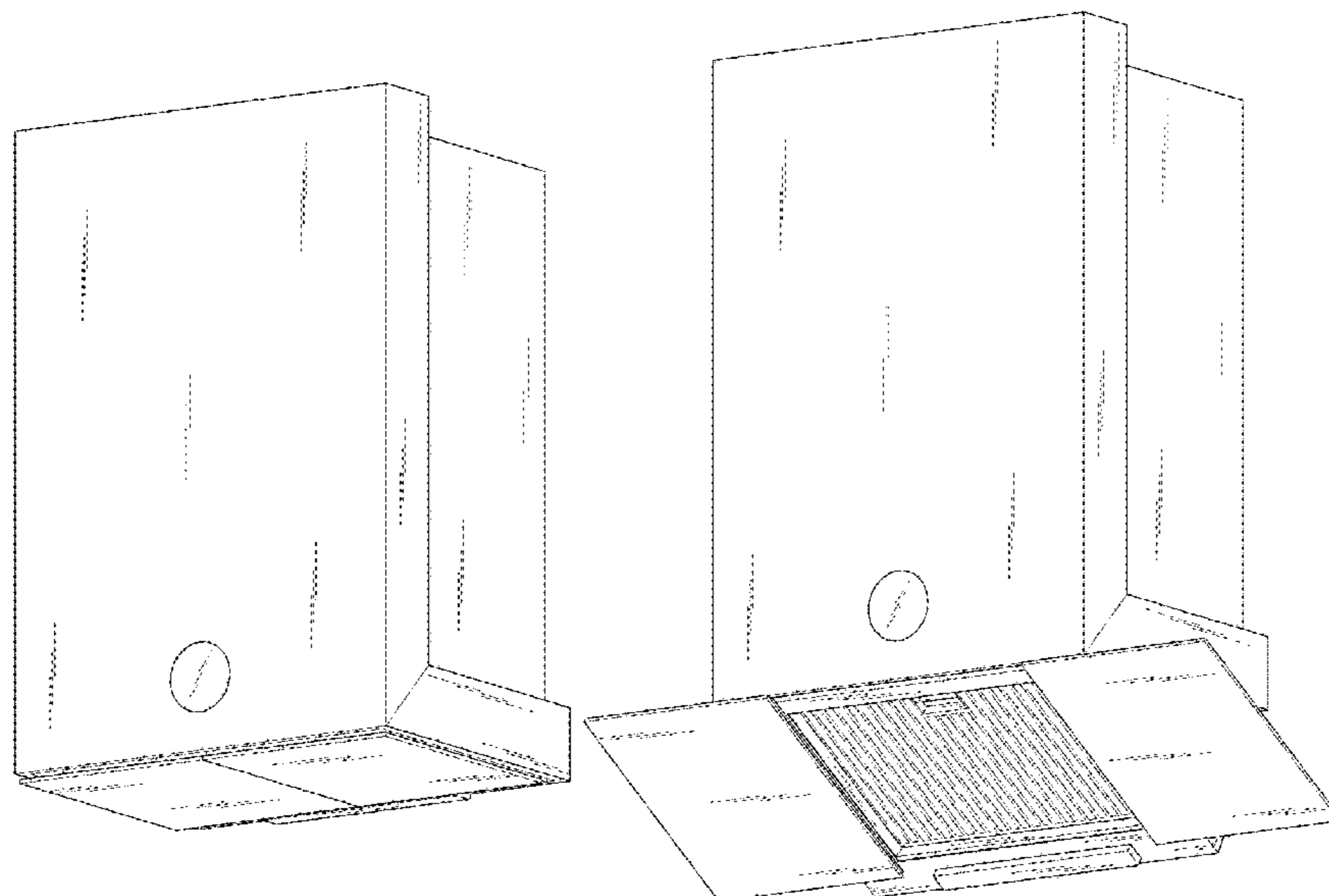

FIG. 1

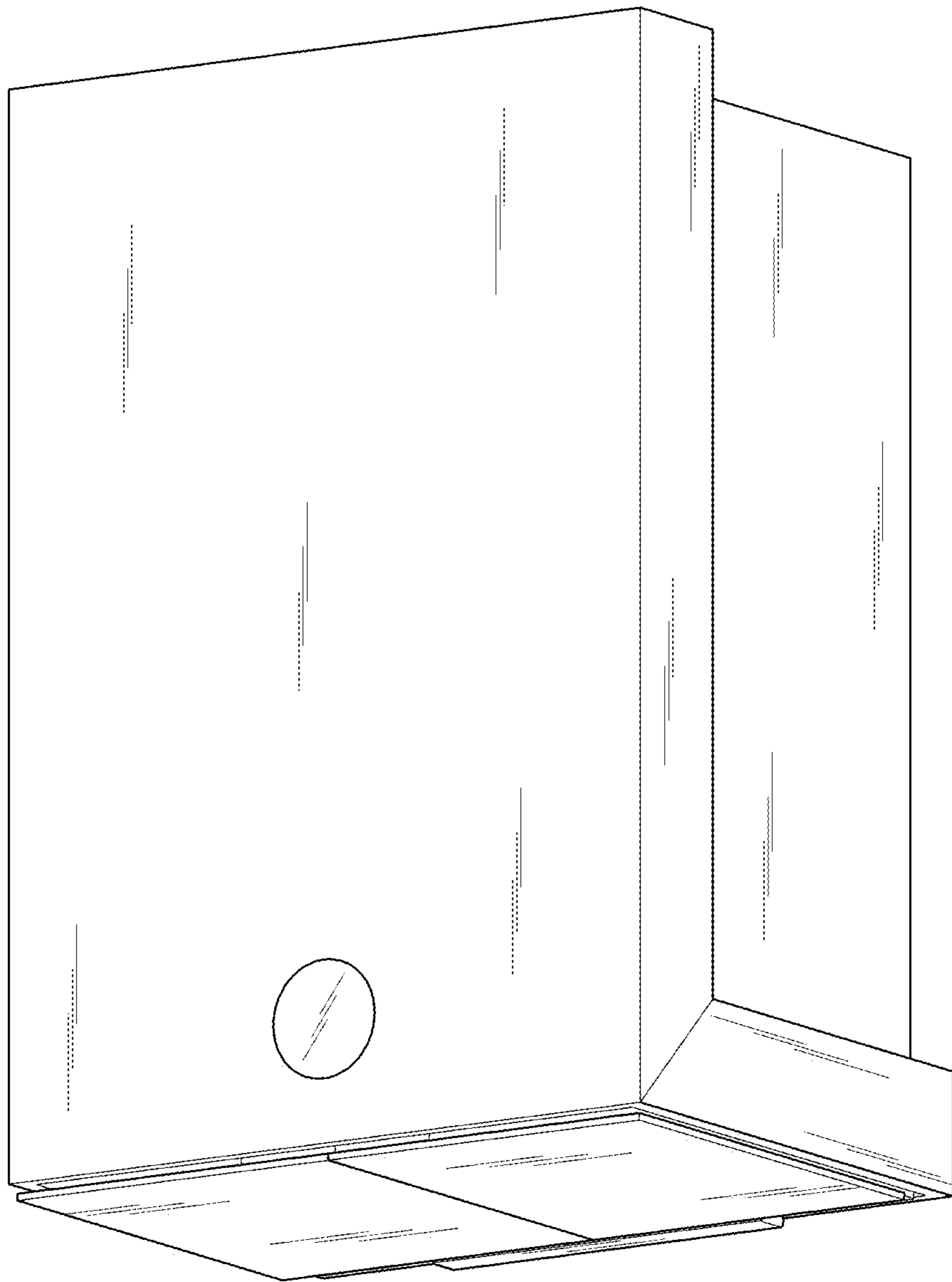

FIG. 2

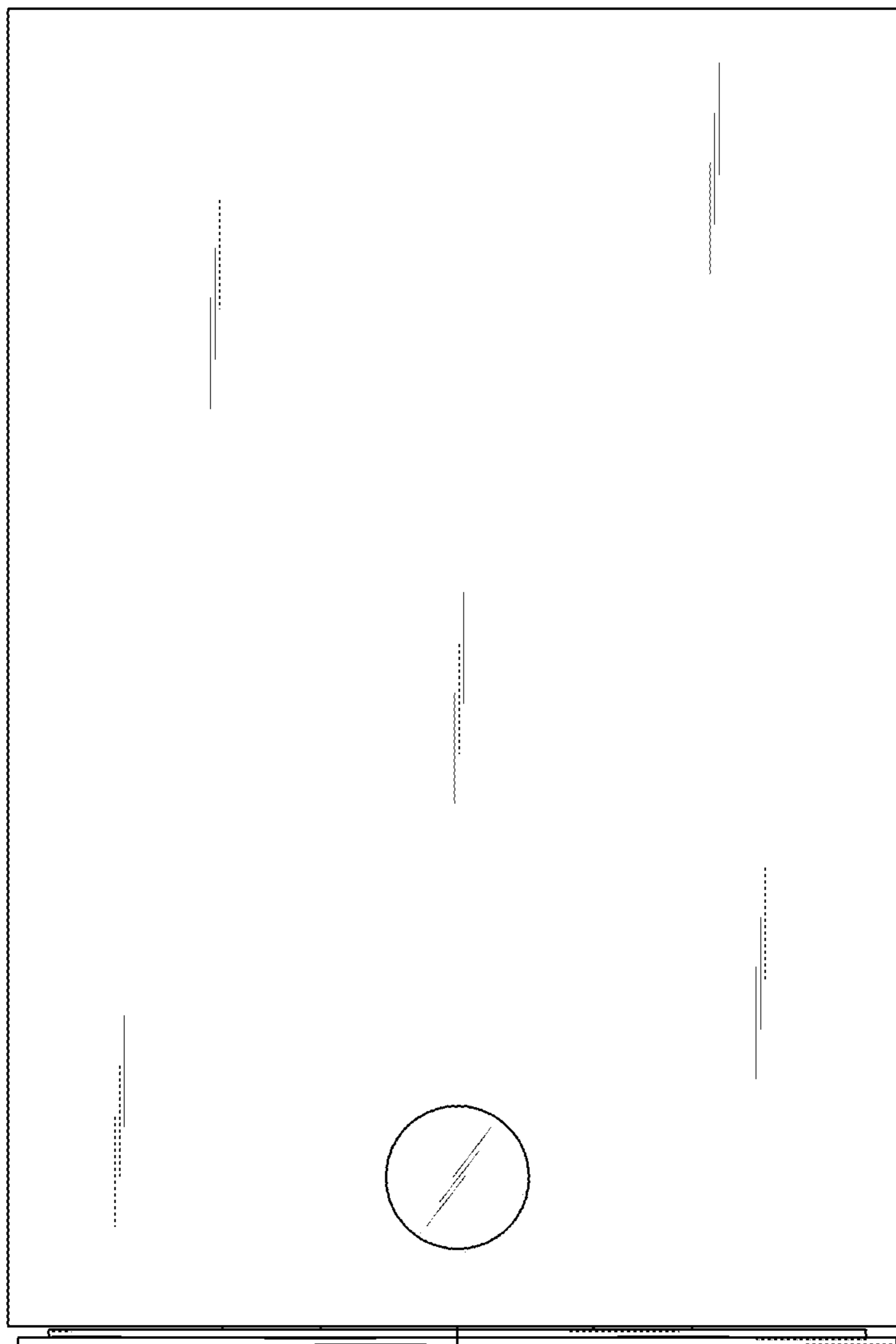

FIG. 3

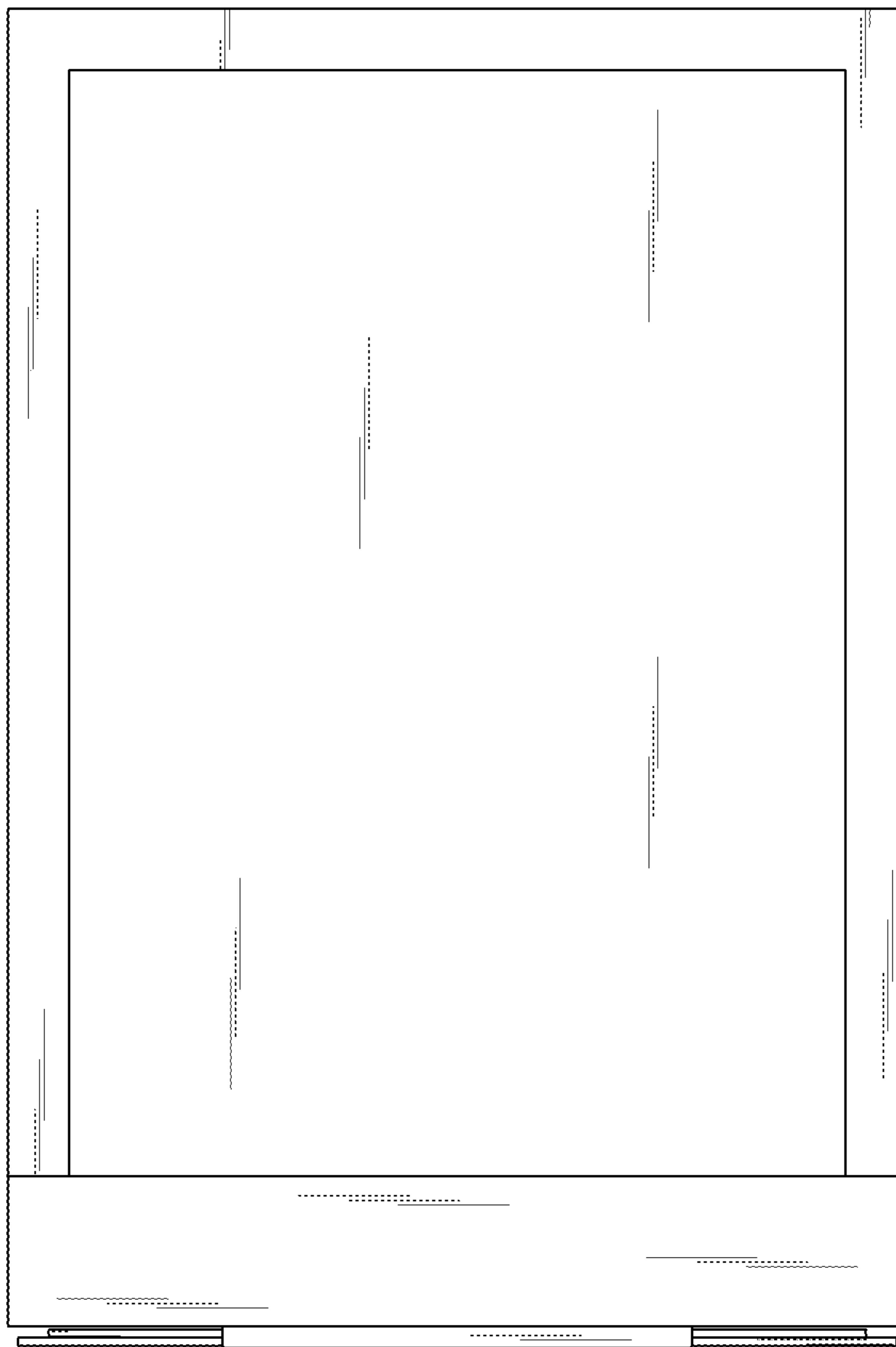

FIG. 4

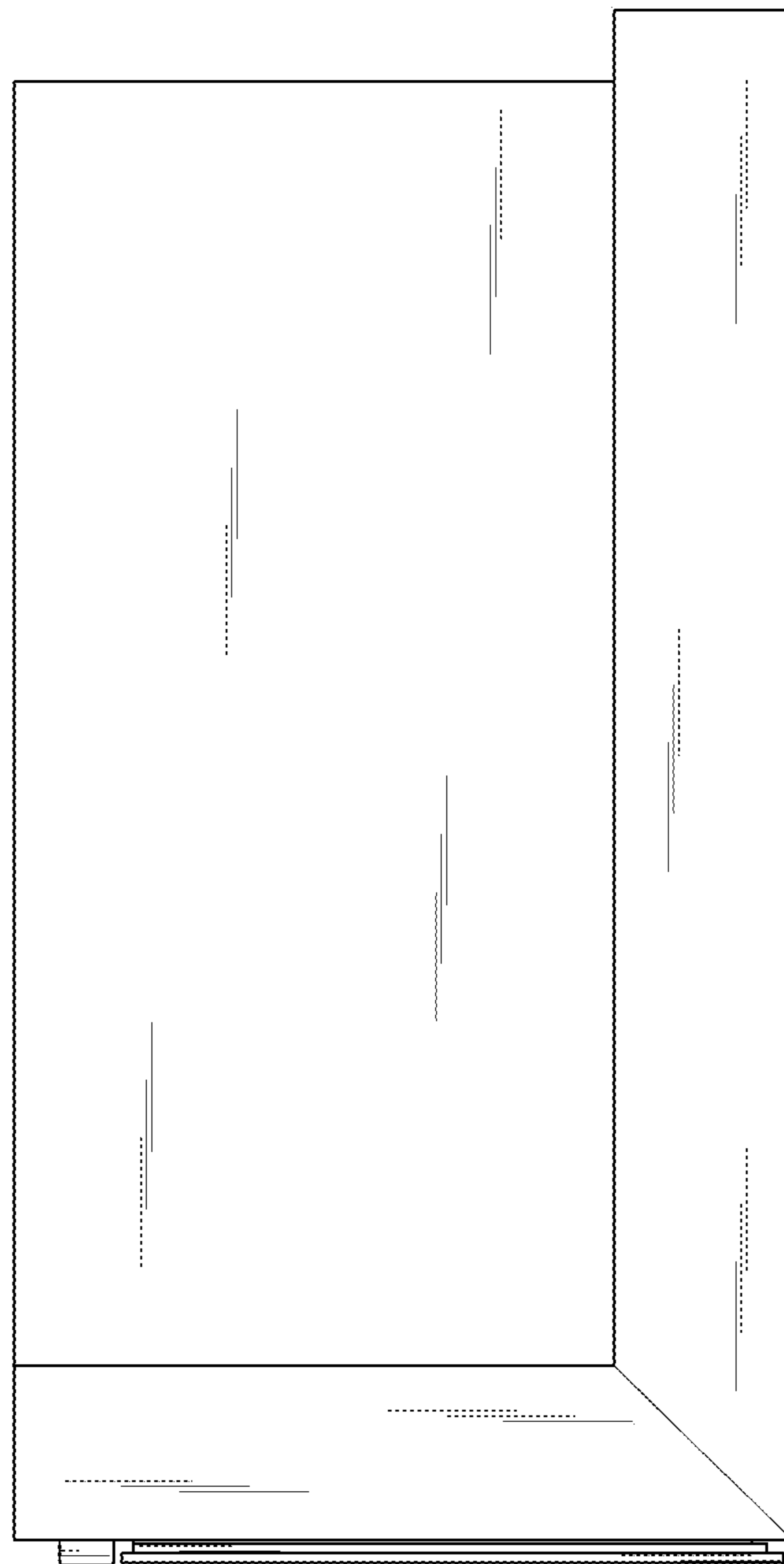

FIG. 5

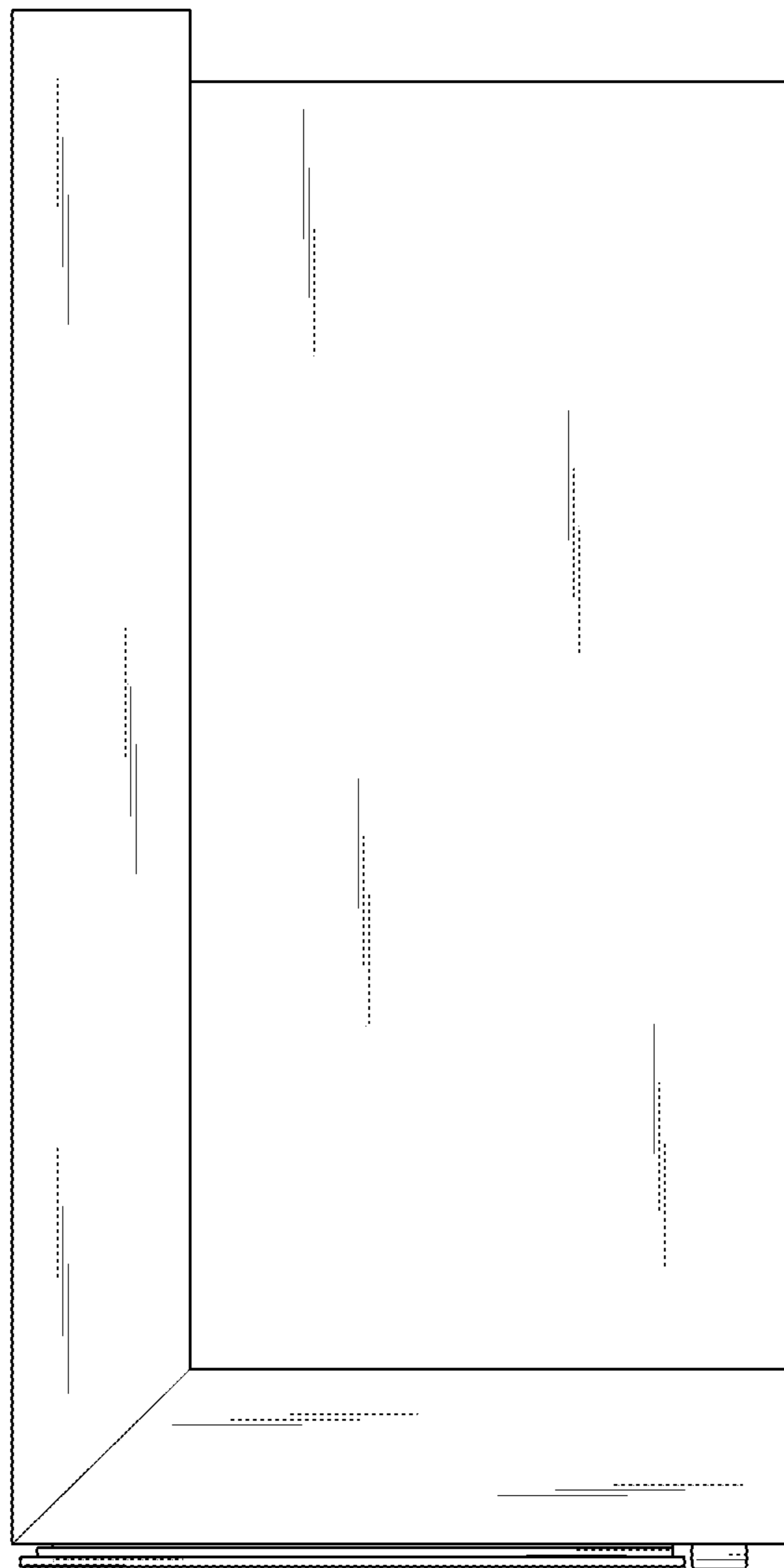

FIG. 6

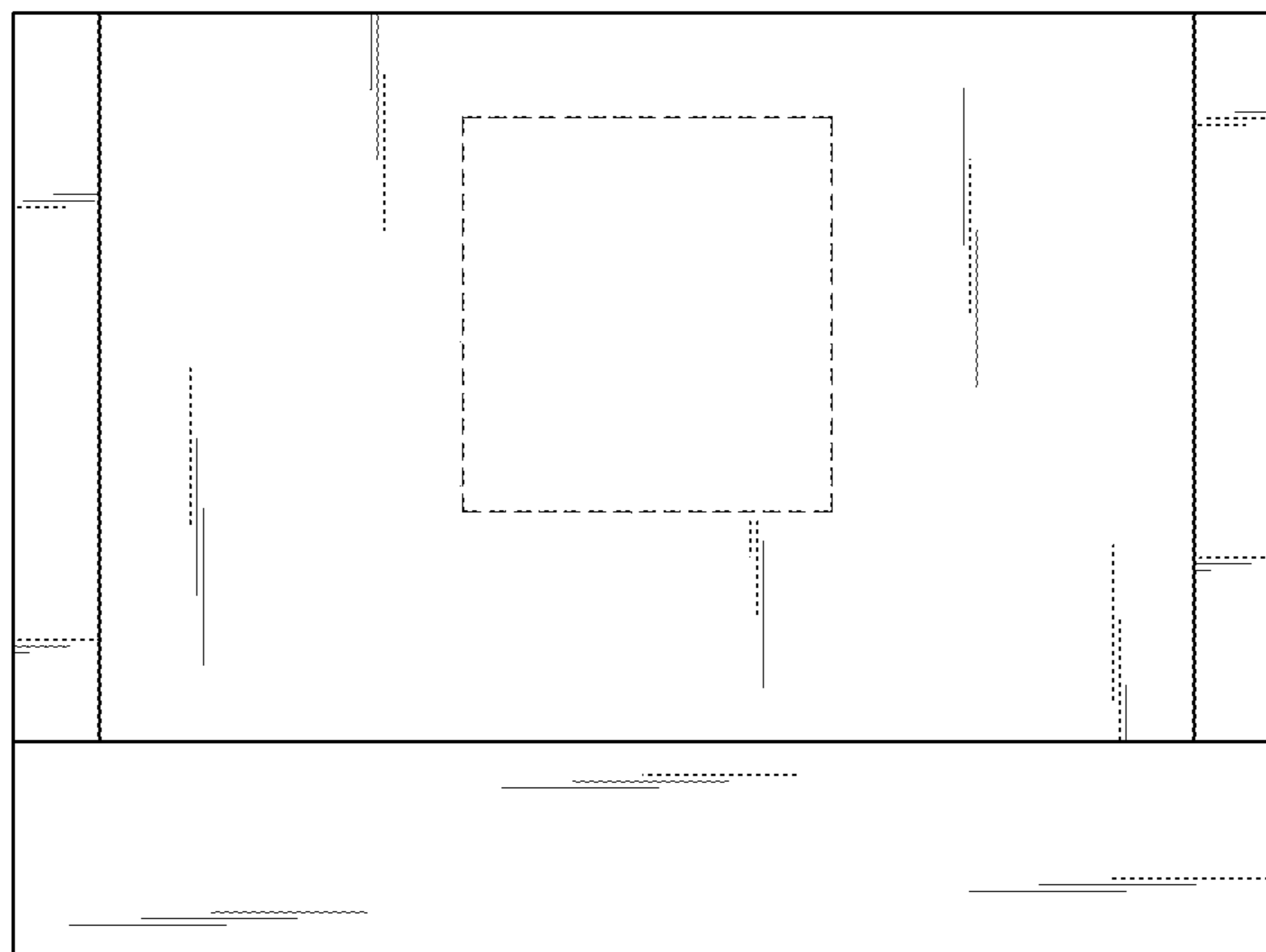

FIG. 7

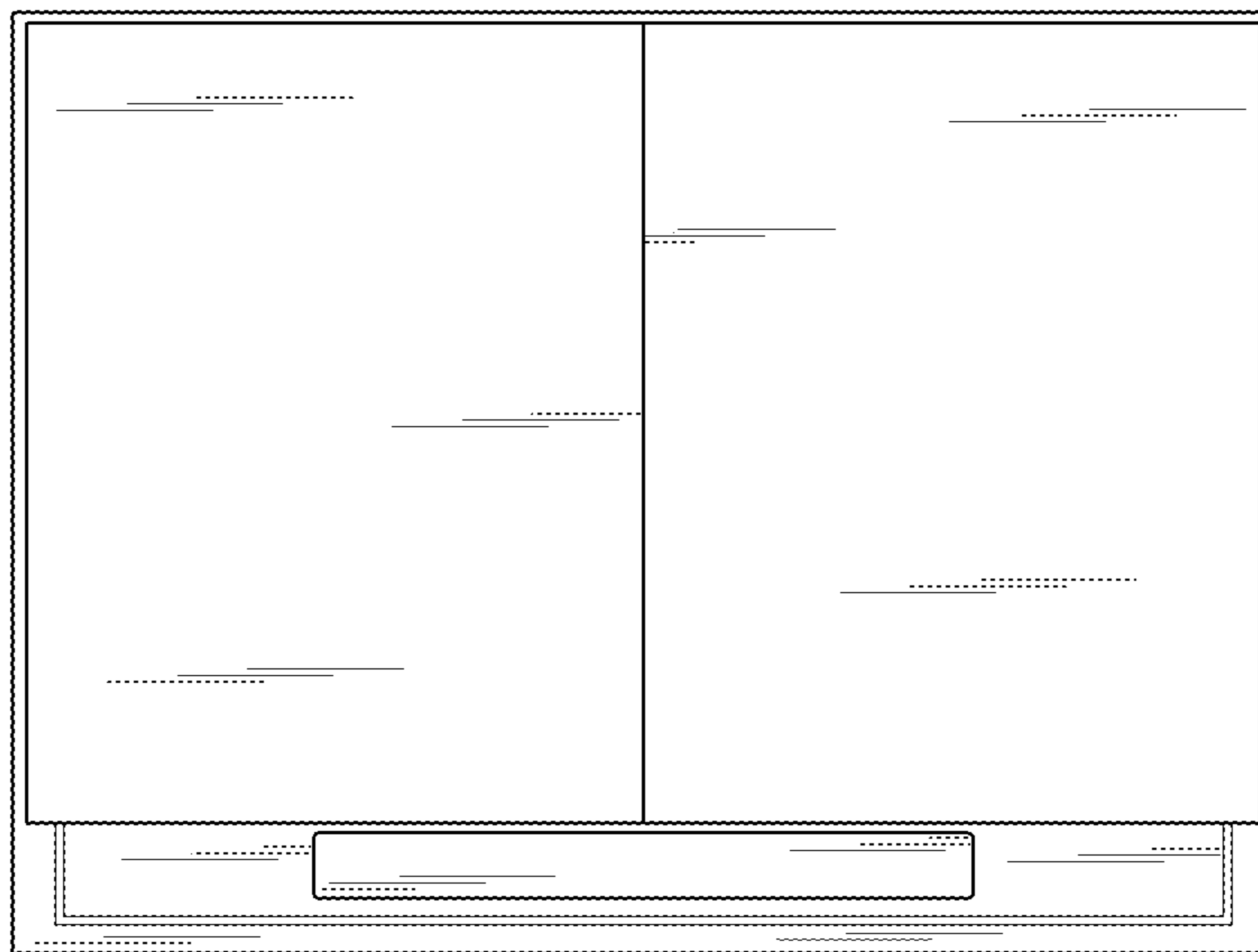

FIG. 8

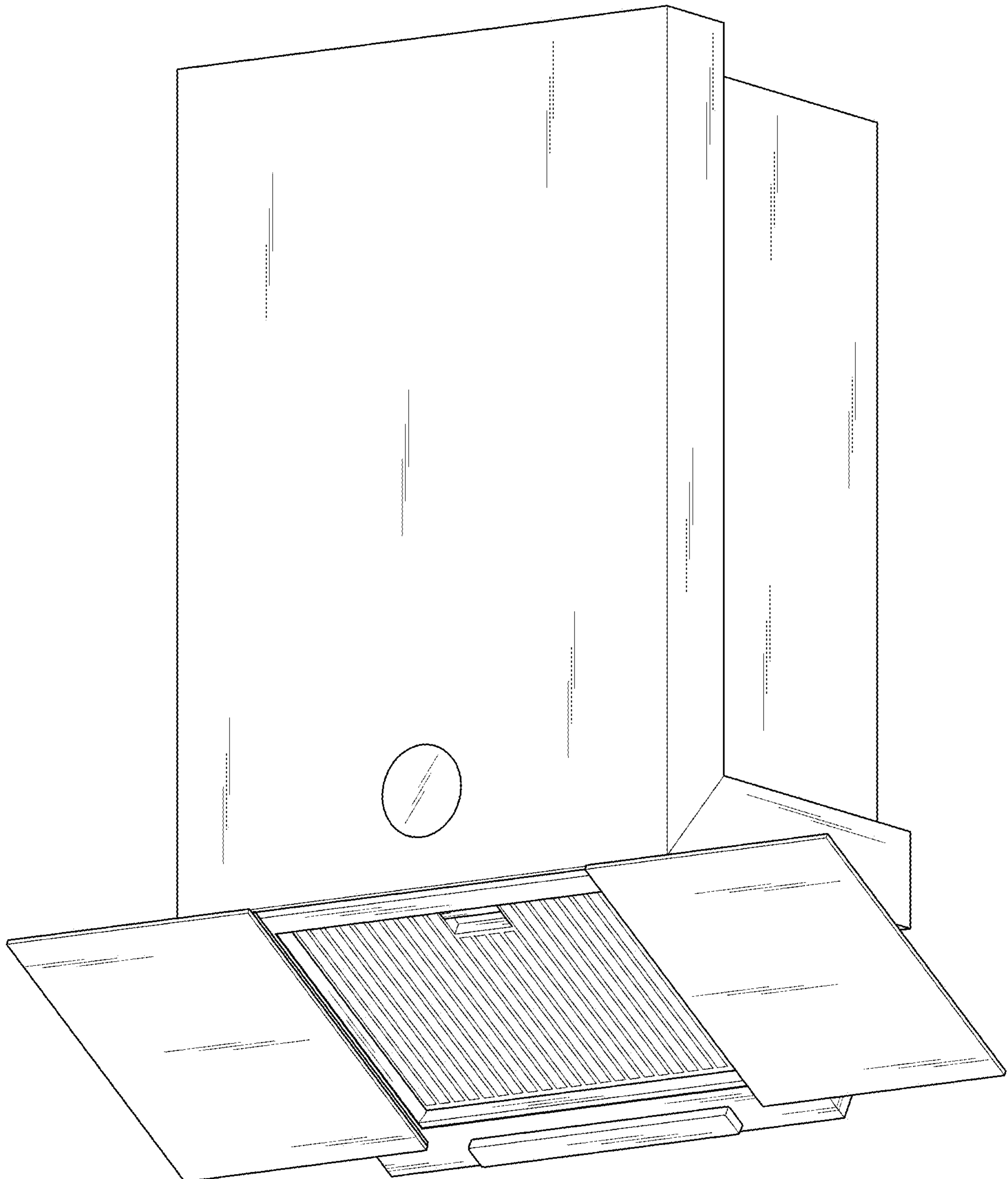

FIG. 9

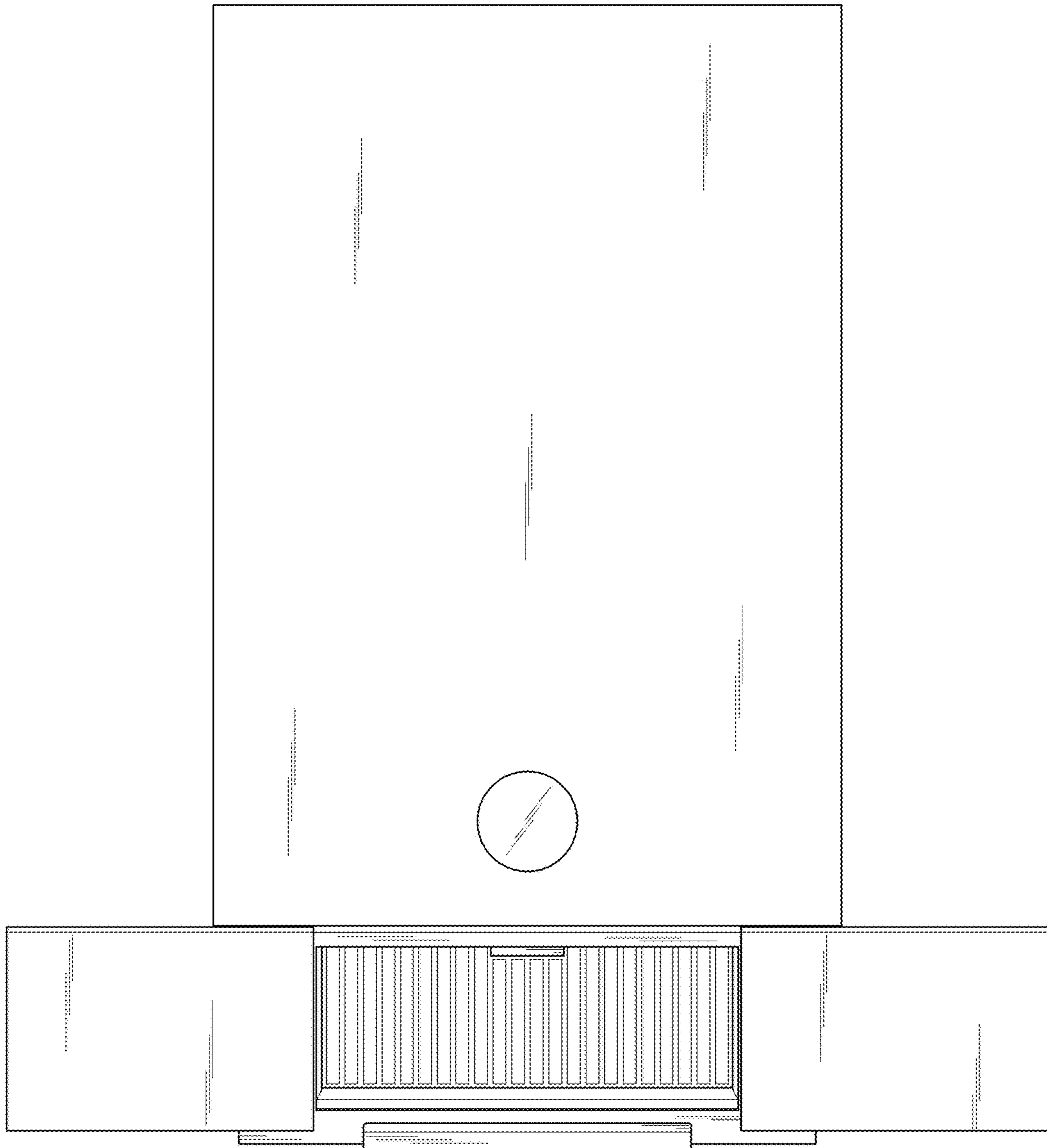

FIG. 10

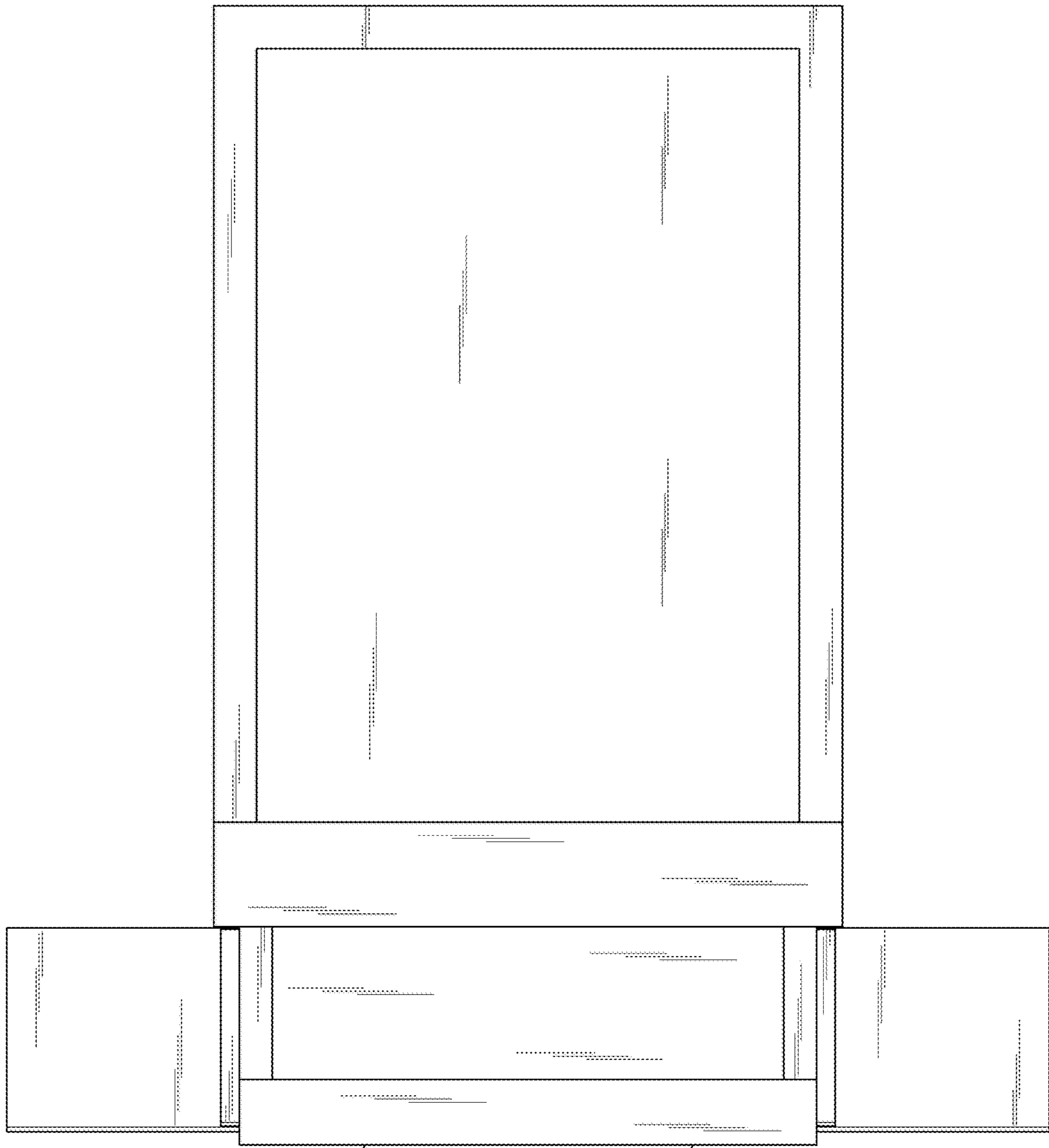

FIG. 11

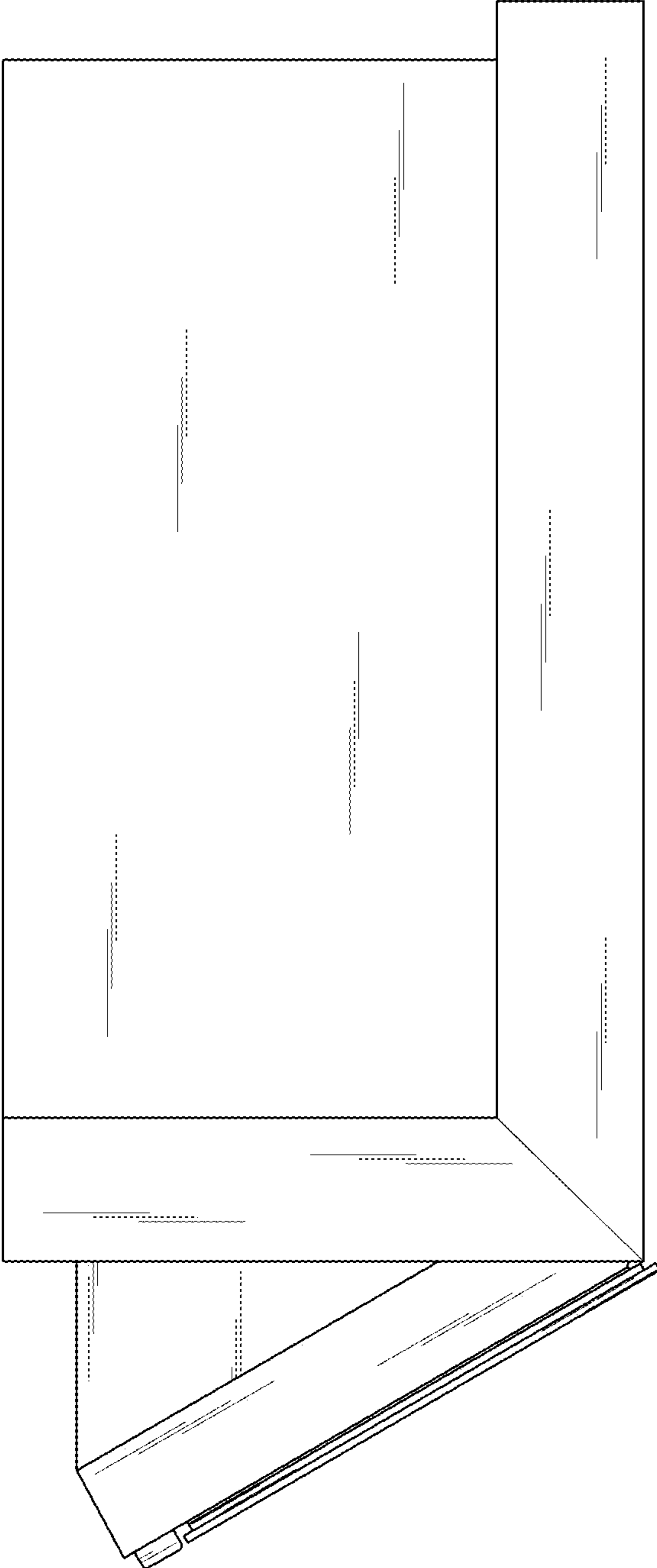

FIG. 12

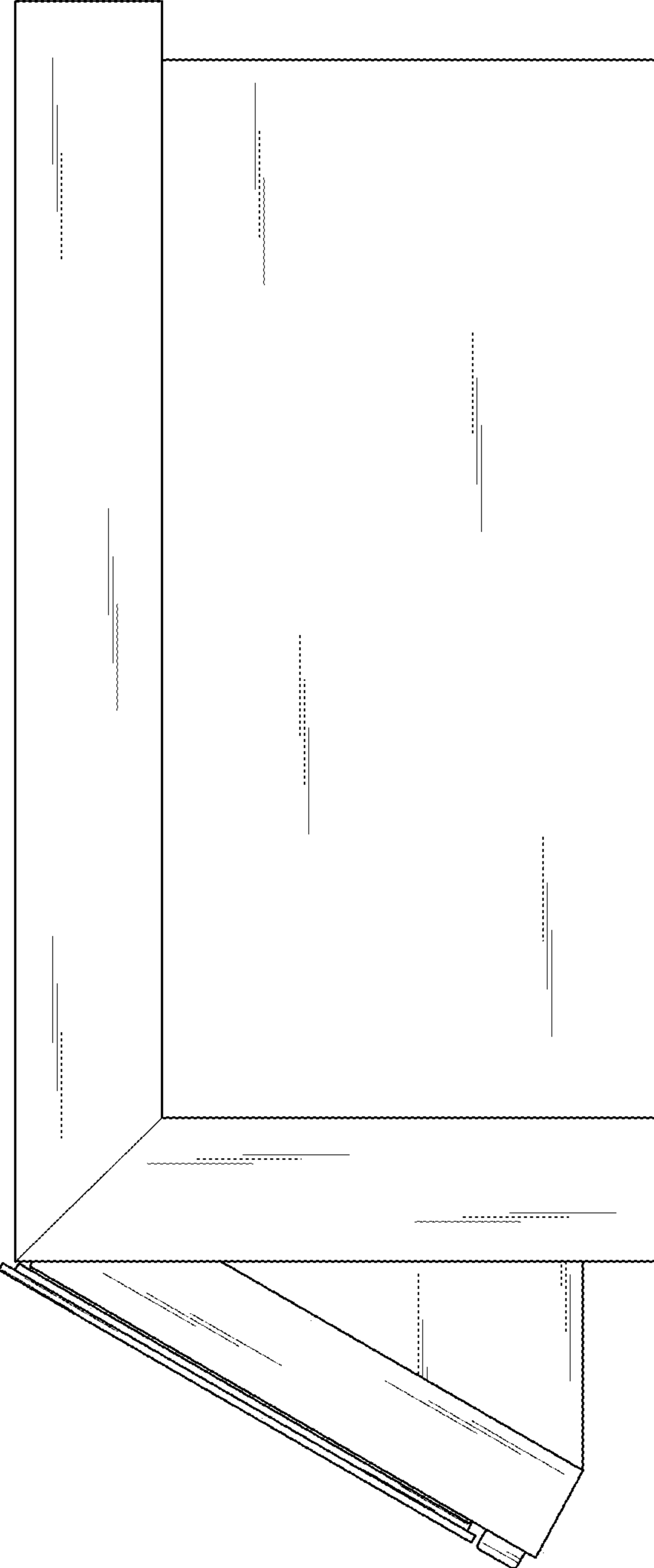

FIG. 13

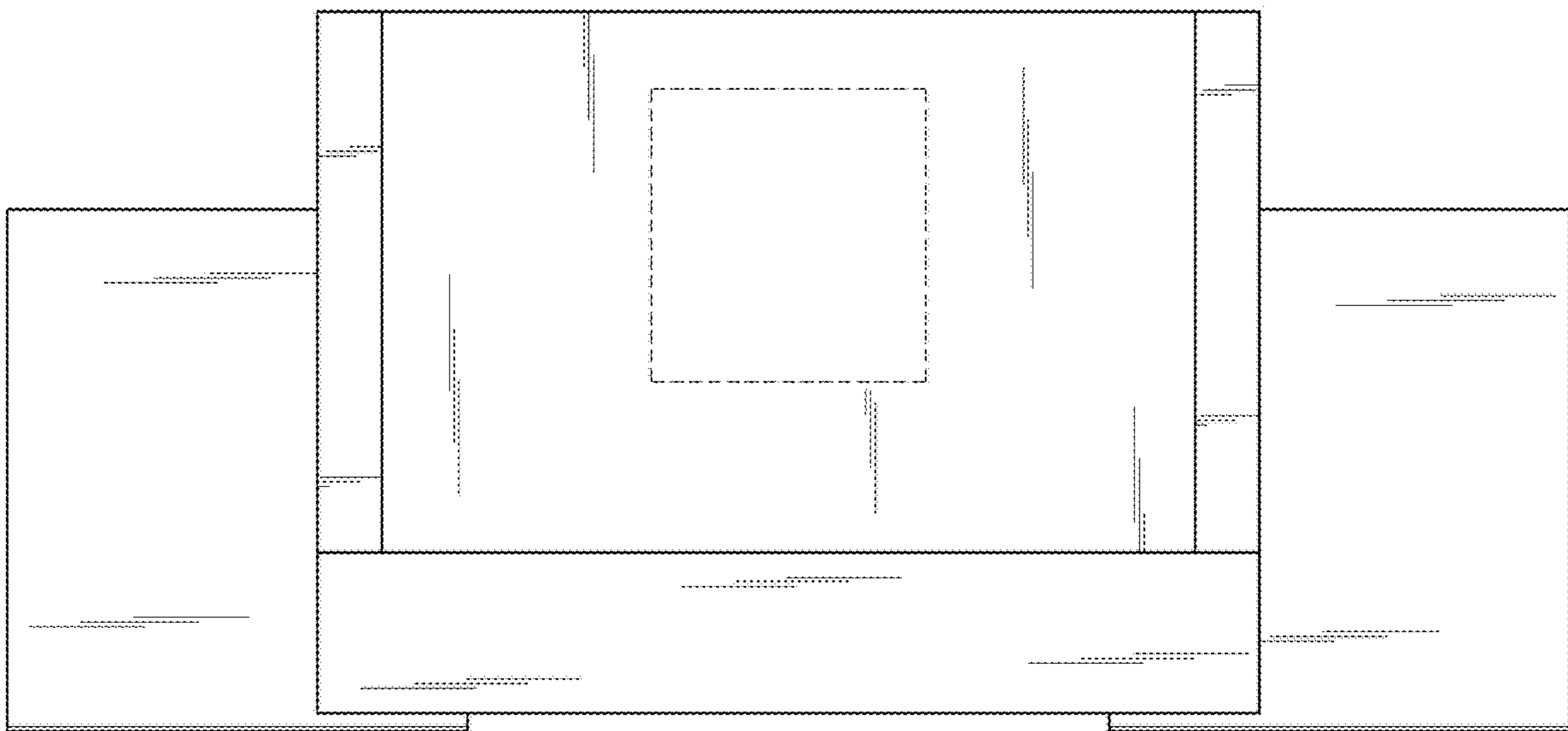

FIG. 14

